

Madison, Wisconsin

# CITY OF MADISON

## CITY ENGINEERING DIVISION

### DEPARTMENT OF PUBLIC WORKS

# PLAN OF PROPOSED IMPROVEMENT

PUBLIC IMPROVEMENT PROJECT APPROVED

DECEMBER 11, 2012

BY THE COMMON COUNCIL OF MADISON, WISCONSIN

PUBLIC IMPROVEMENT DESIGN APPROVED BY:

*Michael R. Quiley* 3/25/2013  
 City Engineer Date

PATH AND SIDEWALK GEOMETRIC DESIGNED BY:



PATH GRADES DESIGNED BY:



INDEX OF SHEETS - REVISED 7/5/2013

SHEET NO.	TITLE
1	
DI-D3	DETAILS
MI-M2	PAVEMENT MARKING PLAN
PI-P3	STREET PLAN & PROFILE
XI-X7	CROSS SECTIONS
VI	UTILITY PLAN AND PROFILE

## E. JOHNSON STREET PATH, FIRST STREET TO THIRD STREET

CITY PROJECT NO. 53WI246

CONTRACT NO. 6787

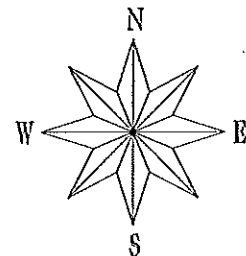

CONVENTIONAL SIGNS	
FIELD VERIFY ALL UTILITY LOCATIONS	
GAS	— G —
STORM SEWER	— ST —
SANITARY SEWER	— SAN —
WATER	— W —
OVERHEAD ELECTRIC	— OH —
POWER POLE	□
ADA COMPLIANT RAMP W/ DETECTABLE WARNING FIELD	
COMBUSTIBLE FLUIDS	

## CONSTRUCTION PROJECT LOCATION

NOTES:

ALL GUTTERS SHALL DRAIN WITH A MINIMUM GRADE OF 0.50% TOWARD STORM SEWER INLETS.

SIDEWALK RAMPS AND CURB THRU SIDEWALK RAMPS SHALL HAVE A MAXIMUM SLOPE OF 1" PER 12". SIDEWALK AND CURB RAMPS SHALL BE CONSTRUCTED WITH A SIDE SLOPE OF 2.00%.

SIDEWALK SHALL HAVE A MINIMUM LONGITUDINAL SLOPE OF 0.50% AND A MAXIMUM LONGITUDINAL SLOPE OF 5.00% EXCEPT WHERE STREET GRADES EXCEED 5.00%.

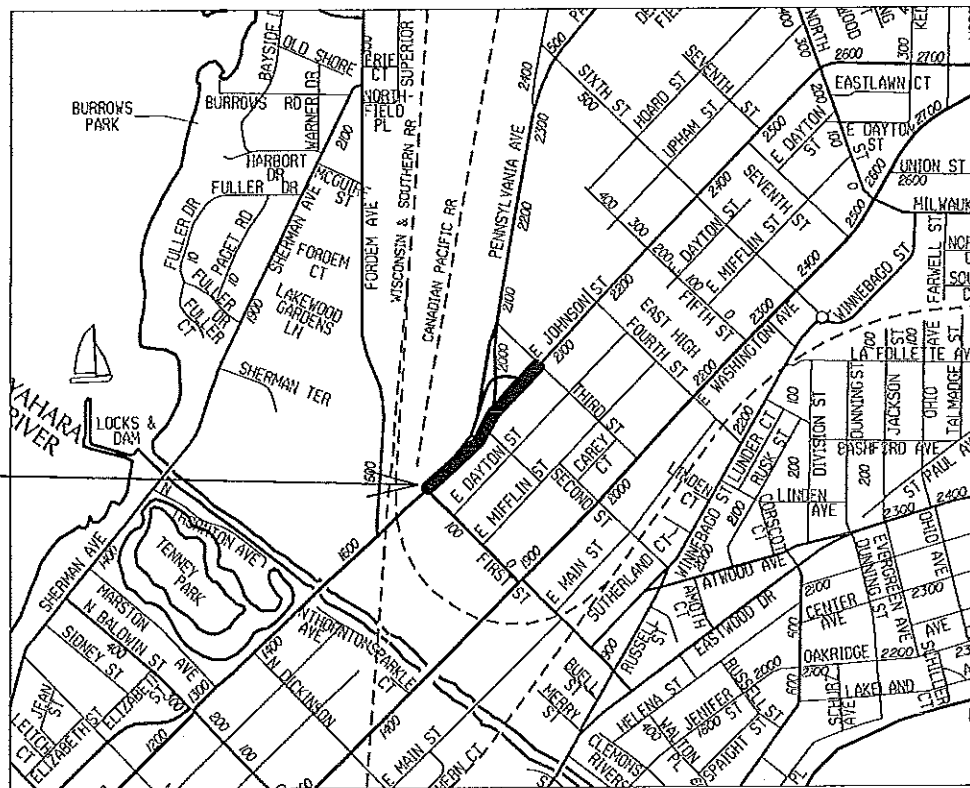

EARTH WORK SUMMARY:

UNCLASSIFIED EXCAVATION CUT (PLAN QUANTITY)	15 C.Y.
ESTIMATED UNDISTRIBUTED UNDERCUT	15 C.Y.
EXCAVATION CUT	30 C.Y.
ADJUSTED FILL	65 C.Y.
FILL BORROW	50 C.Y.

PLOT SCALE:

PLOT NAME:

REV. DATE:

ORIGINATOR: CITY OF MADISON, STREETS DIVISION

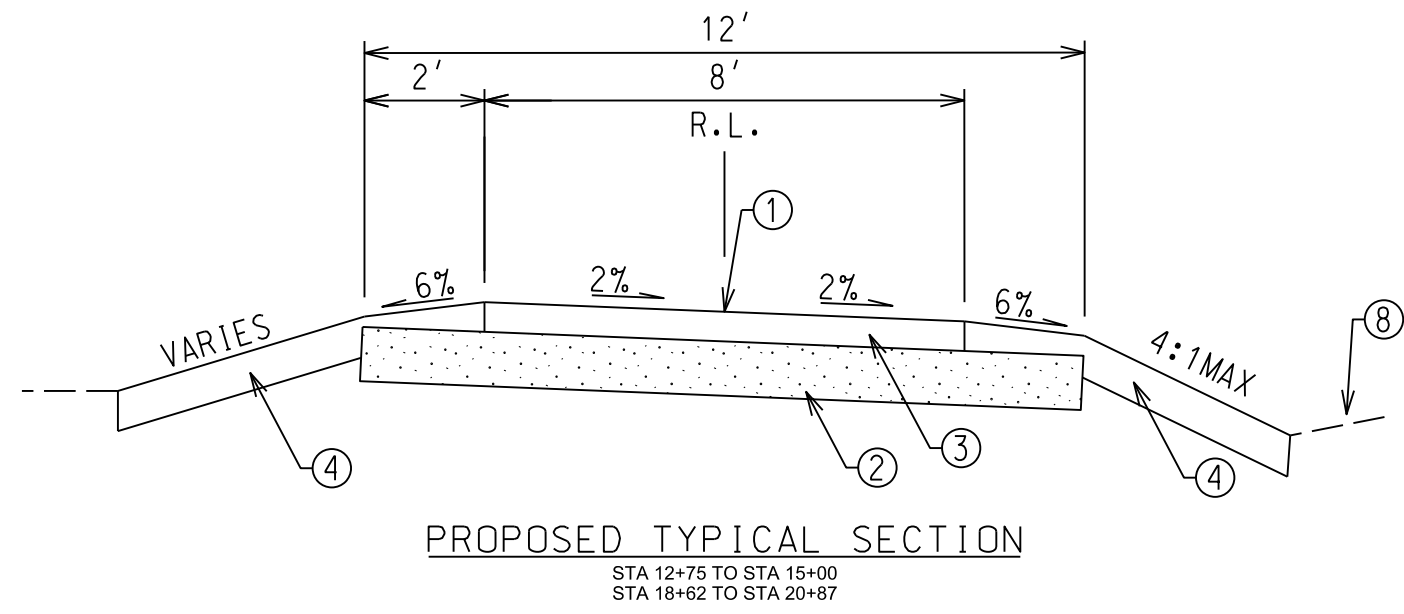
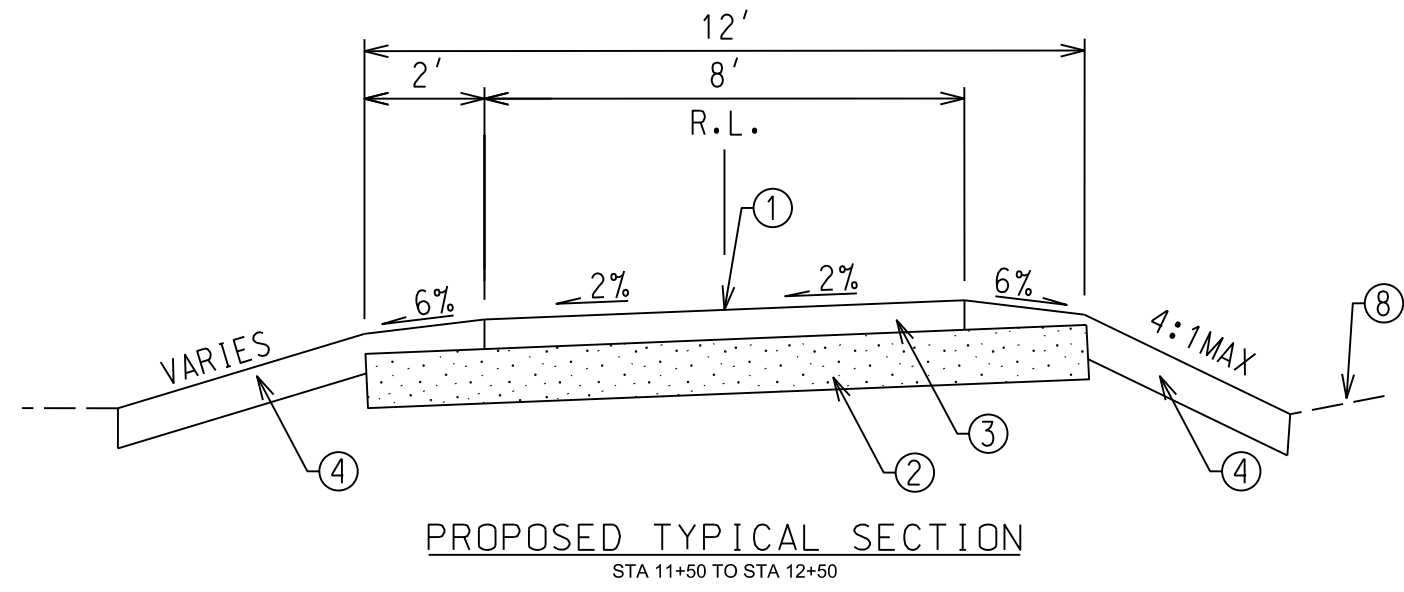
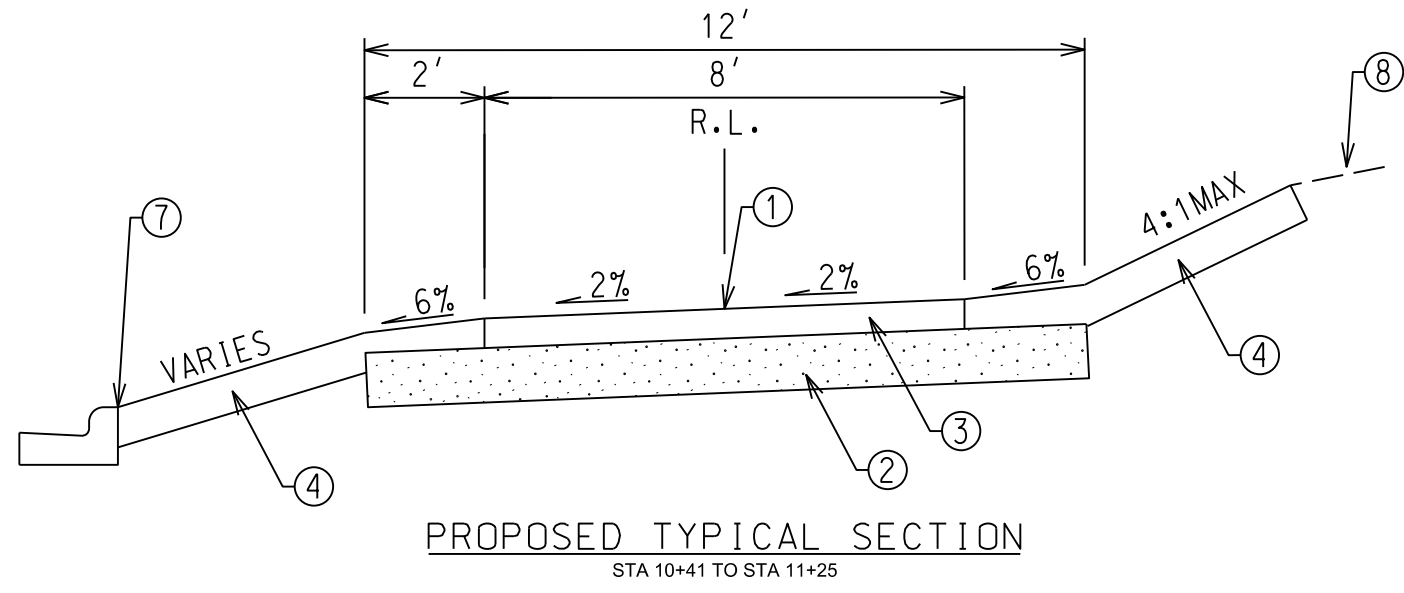

**NOTES:**

- ① POINT REFERED TO ON PROFILE
- ② 8-INCH CRUSHED AGGREGATE BASE
- ③ 3-INCH HMA TYPE E-1
- ④ 4-INCH OF TOPSOIL, SEED, AND EROSION MAT CLASS 1, TYPE URBAN
- ⑤ 7-INCH CONCRETE SIDEWALK
- ⑥ 2-INCH SELECT GRANULAR FILL (INCIDENTAL)
- ⑦ MATCH TOP OF EXISTING CURB
- ⑧ EXISTING GROUND

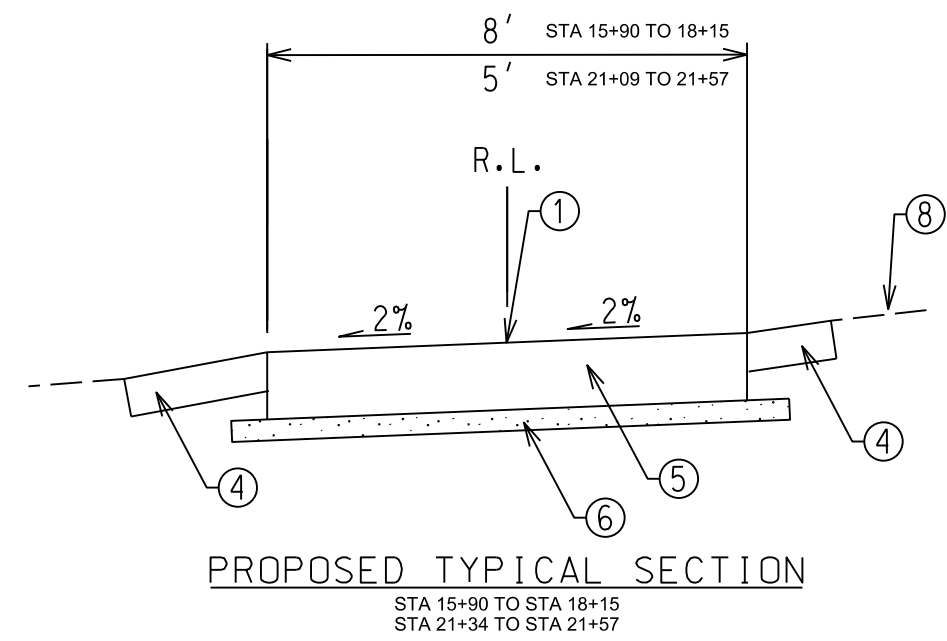

PLOT SCALE: \_\_\_\_\_

PLOT NAME: \_\_\_\_\_

REV. DATE: \_\_\_\_\_

ORIGINATOR: CITY OF MADISON, STREETS DIVISION

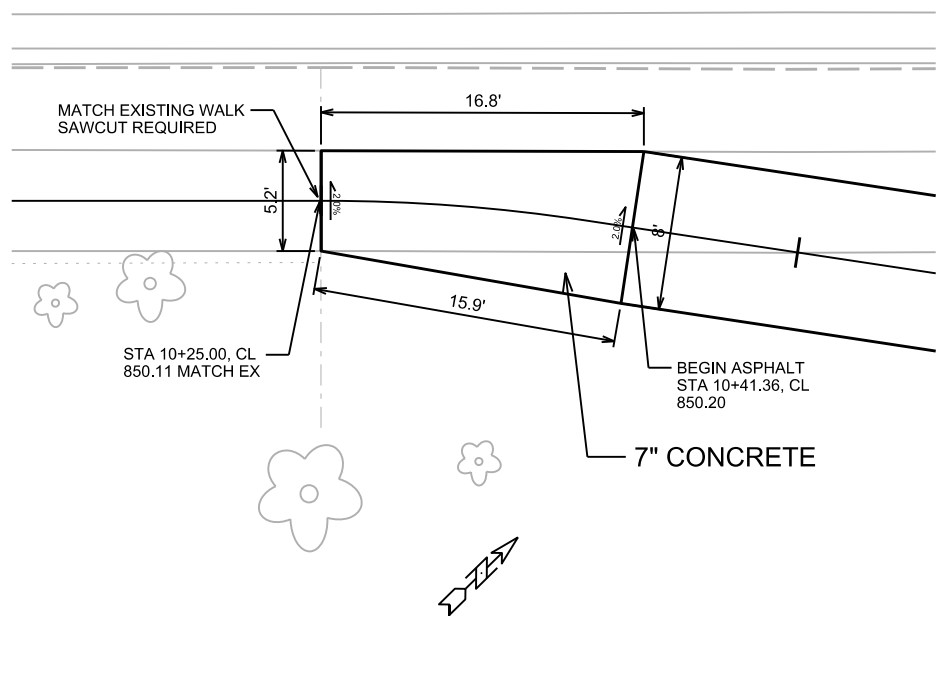

D.1 - PLAN  
CONCRETE TRANSITION

SEE S.D.D. 3.14  
FOR ADDITIONAL DETAILS

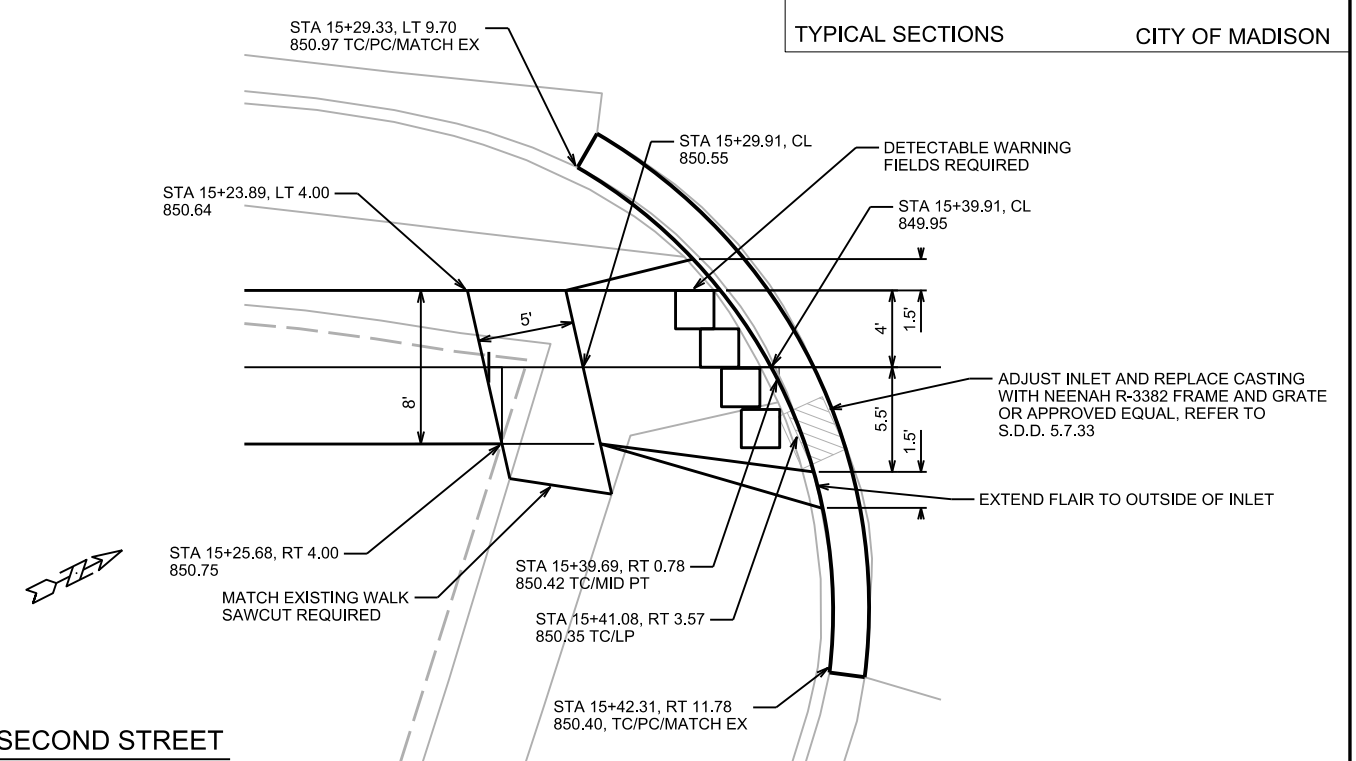

D.2 - SECOND STREET  
WEST RAMP

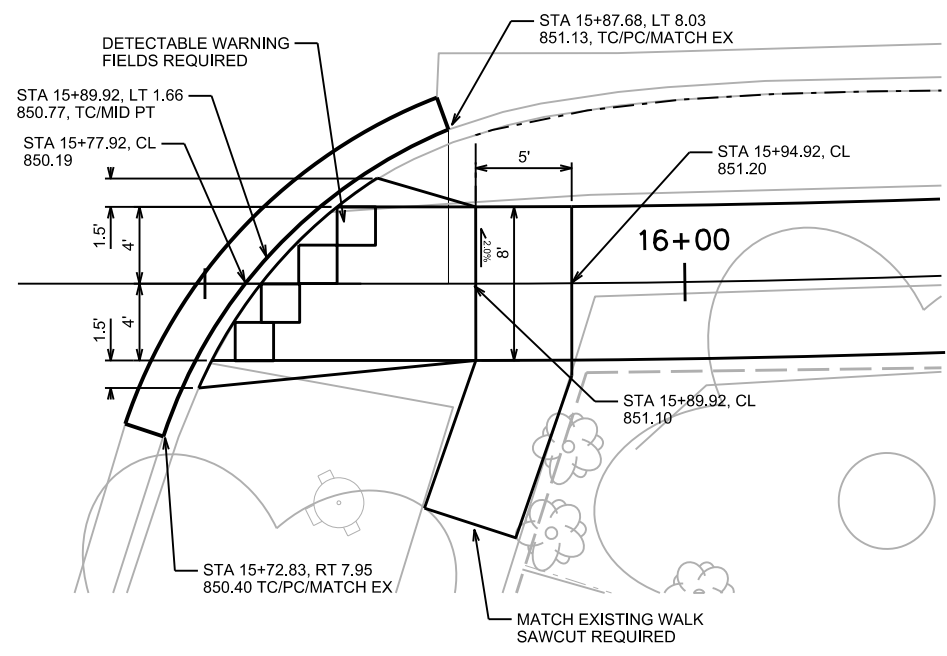

D.3 - SECOND STREET  
EAST RAMP

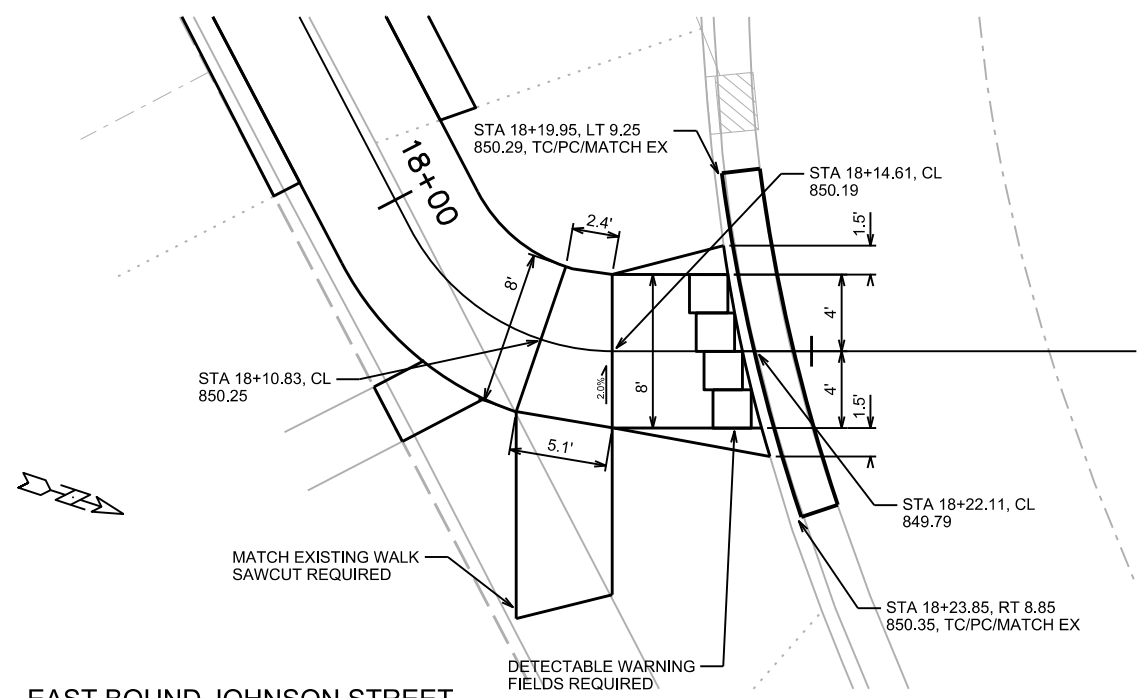

D.4 - EAST BOUND JOHNSON STREET  
SOUTH RAMP

PLOT SCALE: \_\_\_\_\_

PLOT NAME: \_\_\_\_\_

REV. DATE: \_\_\_\_\_

ORIGINATOR: \_\_\_\_\_

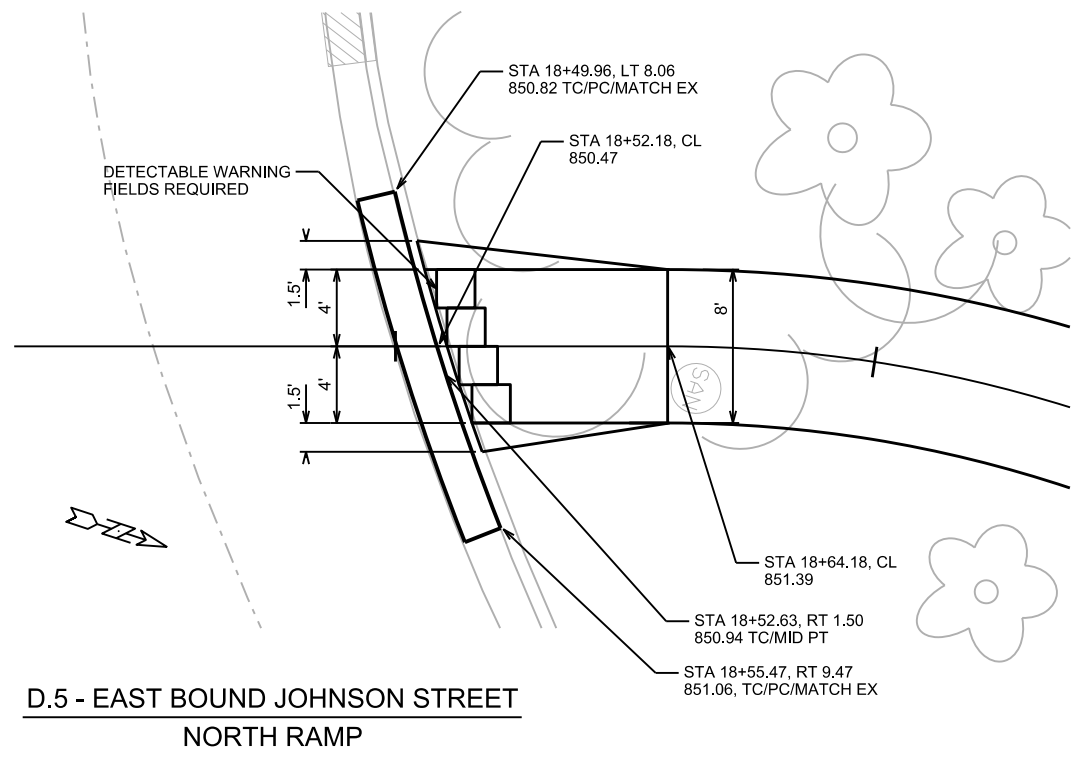

**D.5 - EAST BOUND JOHNSON STREET  
NORTH RAMP**

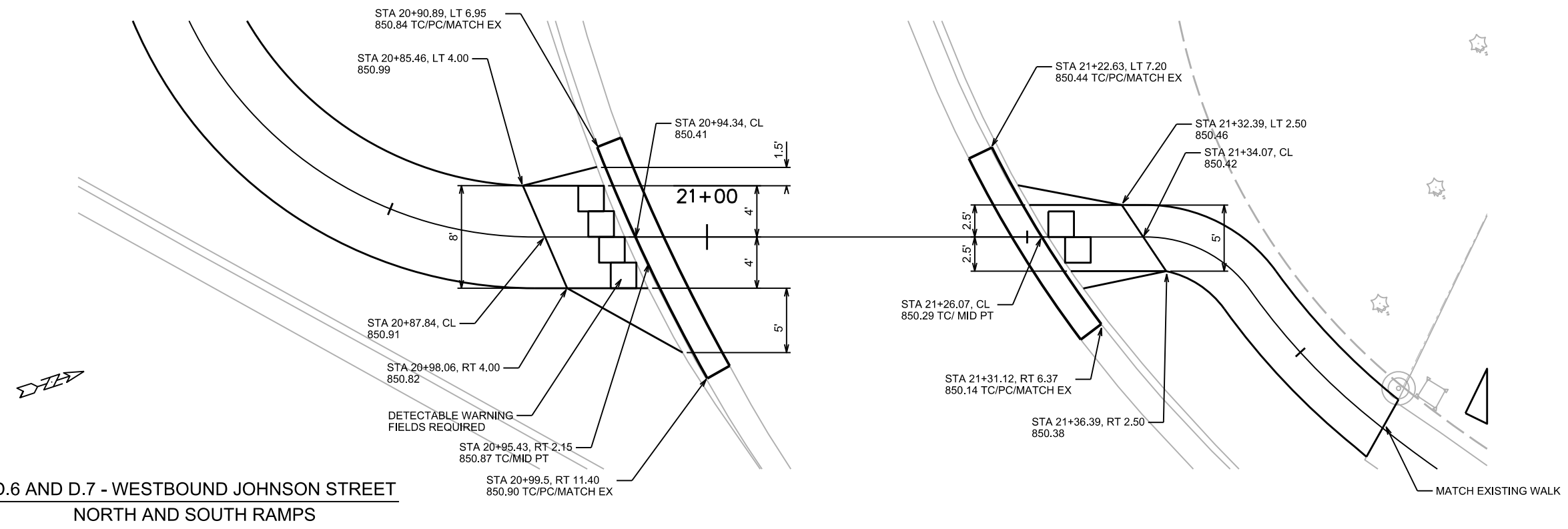

**D.6 AND D.7 - WESTBOUND JOHNSON STREET  
NORTH AND SOUTH RAMPS**

PLOT SCALE: \_\_\_\_\_

PLOT NAME: \_\_\_\_\_

REV. DATE: \_\_\_\_\_

ORIGINATOR: \_\_\_\_\_

PLOT SCALE:

PLOT NAME:

REV. DATE:

ORIGINATOR: CITY OF MADISON, TRAFFIC ENG. DIV.

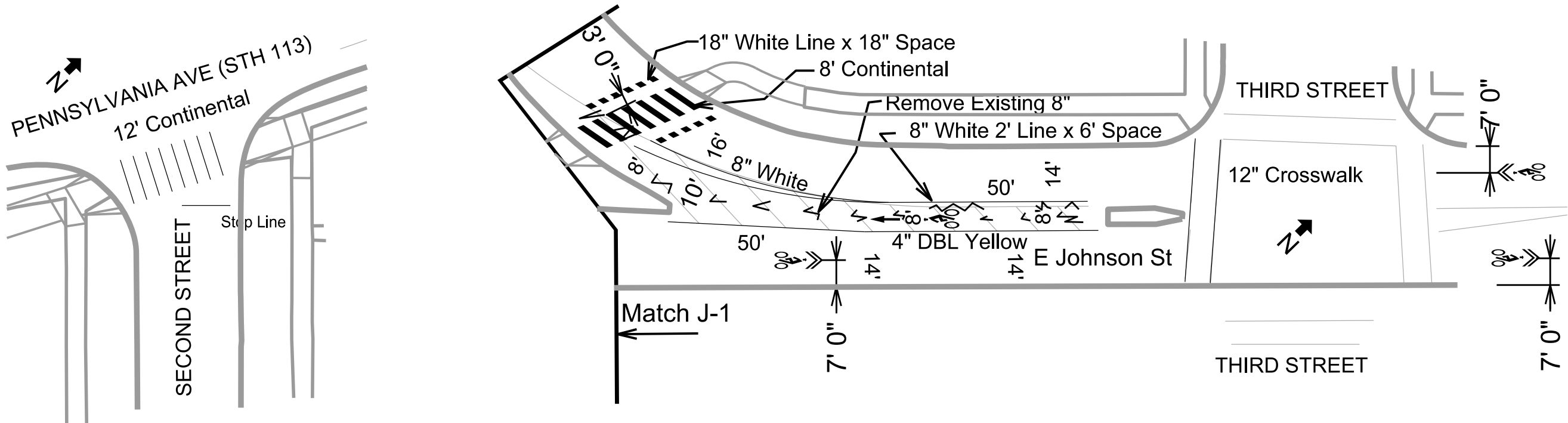
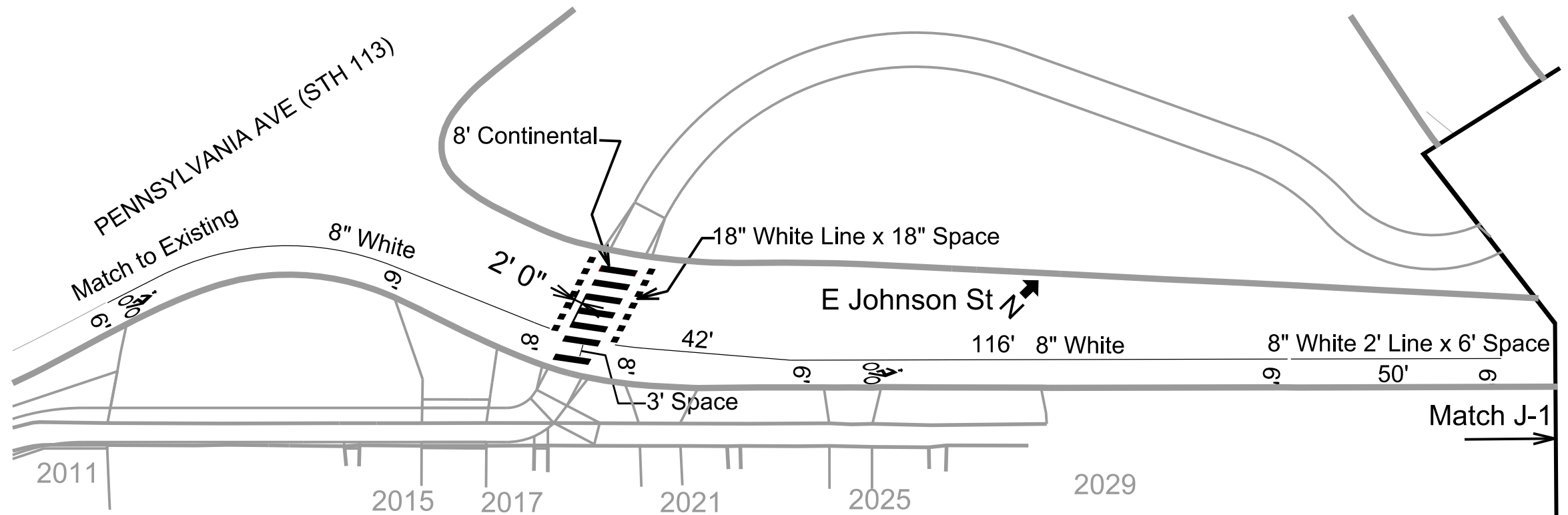

PLOT SCALE:

PLOT NAME:

REV. DATE:

ORIGINATOR: CITY OF MADISON, TRAFFIC ENG. DIV.

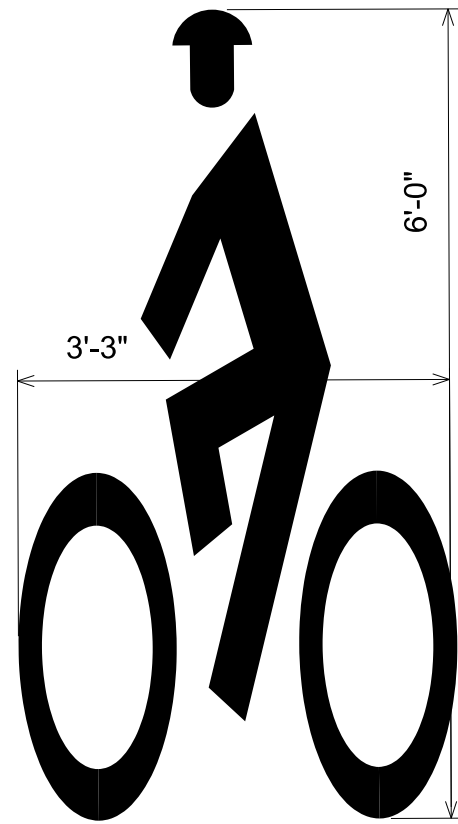

BIKE LANE SYMBOL  
FACING TRAFFIC LANE

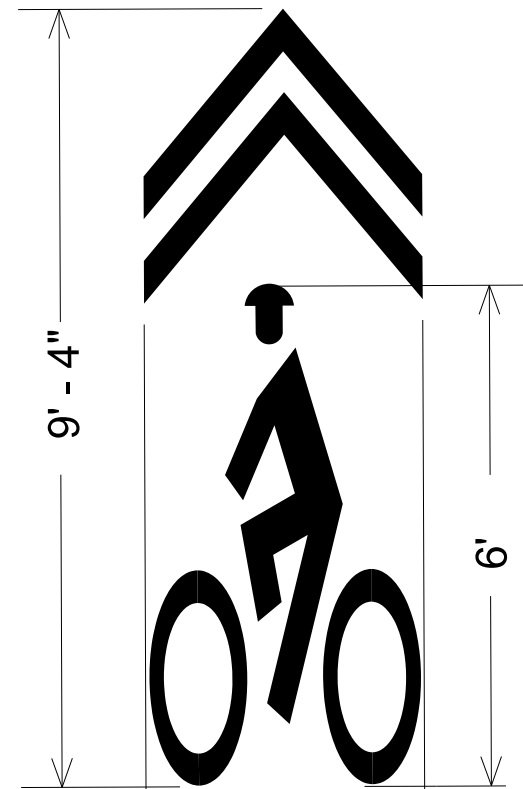

SHAROW DETAIL

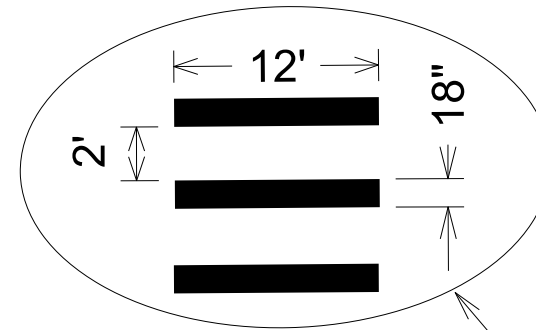

CONTINENTAL CROSSWALKS

CONTINENTAL CROSSWALKS HAVE 18 INCH WIDE 12 FOOT LONG CROSSBARS PLACED IN LINE WITH THE TRAFFIC FLOW.

THE SPACING OR GAP BETWEEN THE CROSSBARS IS 24 INCHES

THE CROSSBARS SHOULD BE PLACED IN A MANNER THAT MINIMIZES CONTACT WITH VEHICLES TIRES.

ALIGN WITH FACE OF CURB  
EXTENDED FROM CROSS STREET,  
TYPICAL.

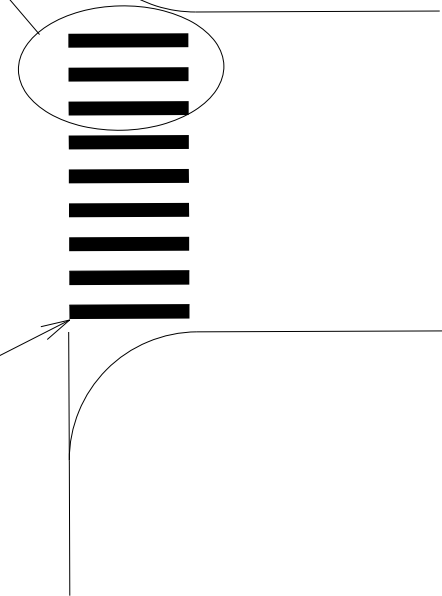

CONTINENTAL X-WALK DETAIL

PLAN AND PROFILE

E. JOHNSON ST CITY OF MADISON

CIRCULAR  
PI STA = 13+84.80  
N = 490262.25  
E = 827441.68

R = 150.00'  
D = 13°49'39.69"  
T = 18.19'  
L = 36.20'  
PC STA = 13+66.60  
PT STA = 14+02.80

CIRCULAR  
PI STA = 12+13.50  
N = 490145.85  
E = 827319.87

R = 150.00'  
D = 21°38'45.60"  
T = 28.68'  
L = 56.67'  
PC STA = 11+84.82  
PT STA = 12+41.49

CP # 5  
N = 490078.78  
E = 827168.30  
ELEV = 851.05

CP # 7  
N = 490346.68  
E = 827428.63  
ELEV = 851.07

CP # 2  
N = 490331.51  
E = 827492.64  
ELEV = 851.70

EAST JOHNSON STREET (STH 113)

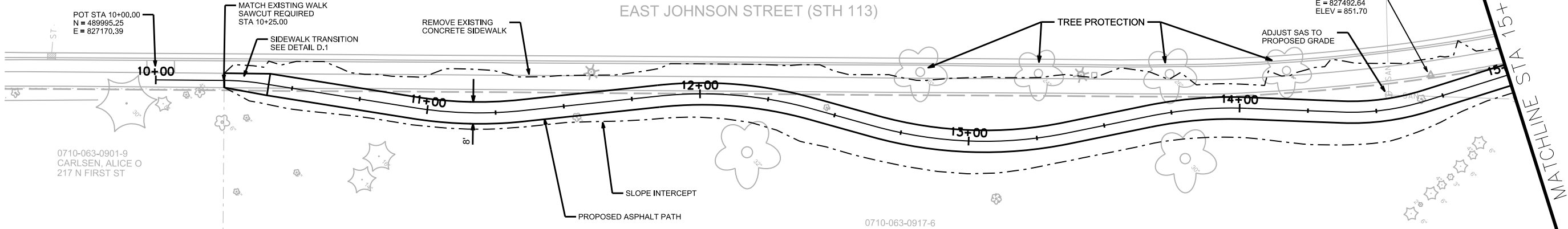

CIRCULAR  
PI STA = 11+15.12  
N = 490068.16  
E = 827259.33

R = 150.00'  
D = 15°07'16.61"  
T = 19.91'  
L = 39.60'  
PC STA = 10+95.33  
PT STA = 11+34.92

CIRCULAR  
PI STA = 13+00.70  
N = 490190.70  
E = 827396.24

R = 150.00'  
D = 27°09'04.59"  
T = 36.22'  
L = 71.08'  
PC STA = 12+65.16  
PT STA = 13+36.25

CIRCULAR  
PI STA = 14+53.16  
N = 490309.65  
E = 827491.20

R = 90.00'  
D = 19°42'49.06"  
T = 15.64'  
L = 30.97'  
PC STA = 14+37.52  
PT STA = 14+68.48

0710-063-0901-9  
CARLSEN, ALICE O  
217 N FIRST ST

0710-063-0917-6  
CITY OF MADISON PARKS  
1915 E JOHNSON ST

PLOT SCALE: \_\_\_\_\_

PLOT NAME: \_\_\_\_\_

REV. DATE: \_\_\_\_\_

ORIGINATOR: CITY OF MADISON, STREETS DIVISION

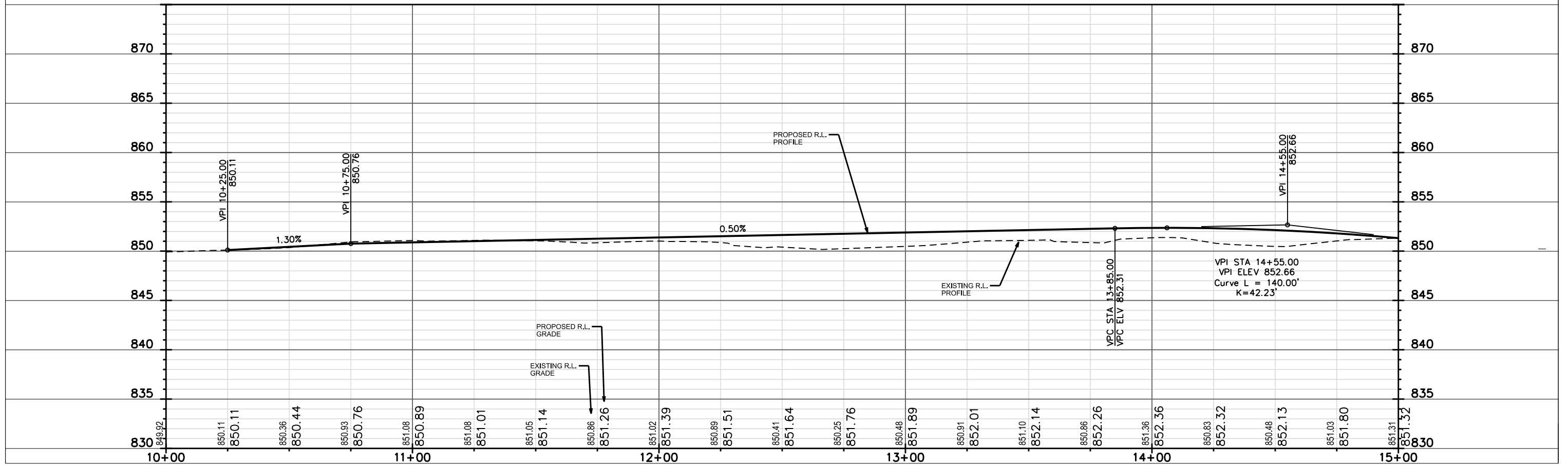

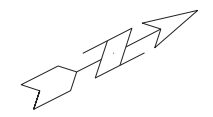

CIRCULAR  
PI STA = 16+10.75  
N = 490450.92  
E = 827561.74  
R = 732.00'  
D = 3°26'26.51"  
T = 22.00'  
L = 43.96'  
PC STA = 15+89.11  
PT STA = 16+32.72

CIRCULAR  
PI STA = 16+93.31  
N = 490526.88  
E = 827594.13  
R = 50.00'  
D = 21°06'13.37"  
T = 9.31'  
L = 18.42'  
PC STA = 16+84.00  
PT STA = 17+02.41

CIRCULAR  
PI STA = 18+08.90  
N = 490609.90  
E = 827674.86  
R = 12.00'  
D = 62°22'36.07"  
T = 7.26'  
L = 13.06'  
PC STA = 18+01.63  
PT STA = 18+14.61

CIRCULAR  
PI STA = 19+25.17  
N = 490721.76  
E = 827638.13  
R = 70.00'  
D = 82°02'48.51"  
T = 60.90'  
L = 100.25'  
PC STA = 18+64.27  
PT STA = 19+64.50

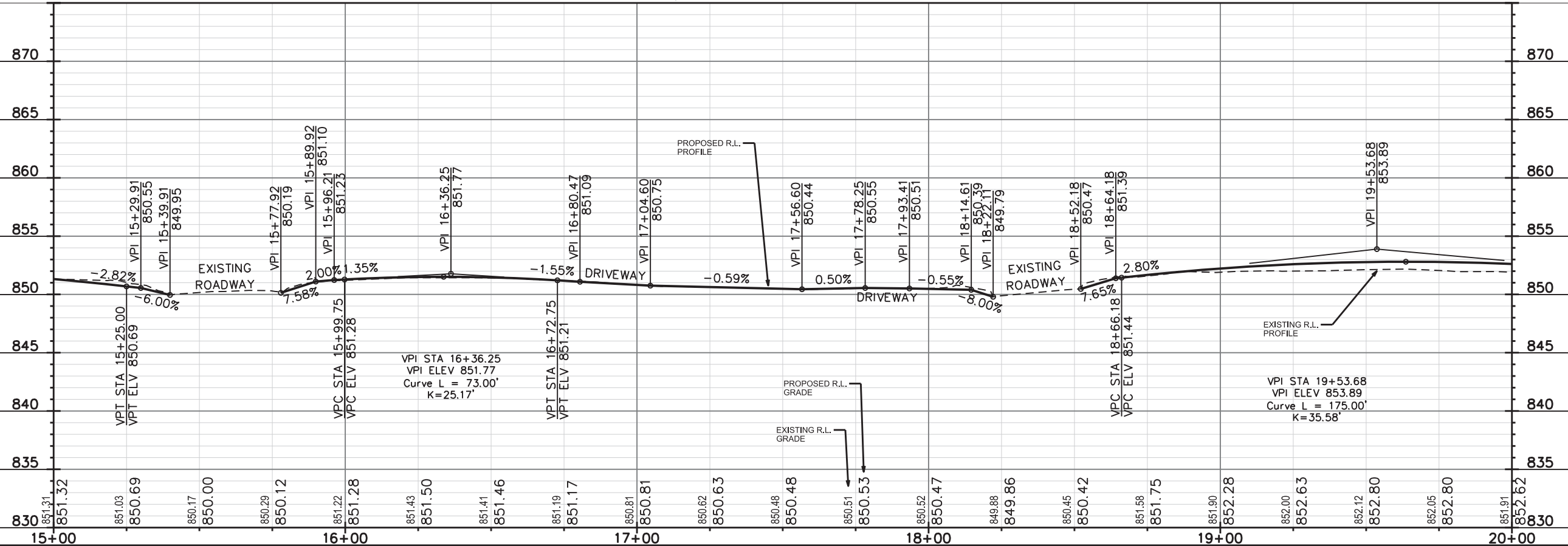
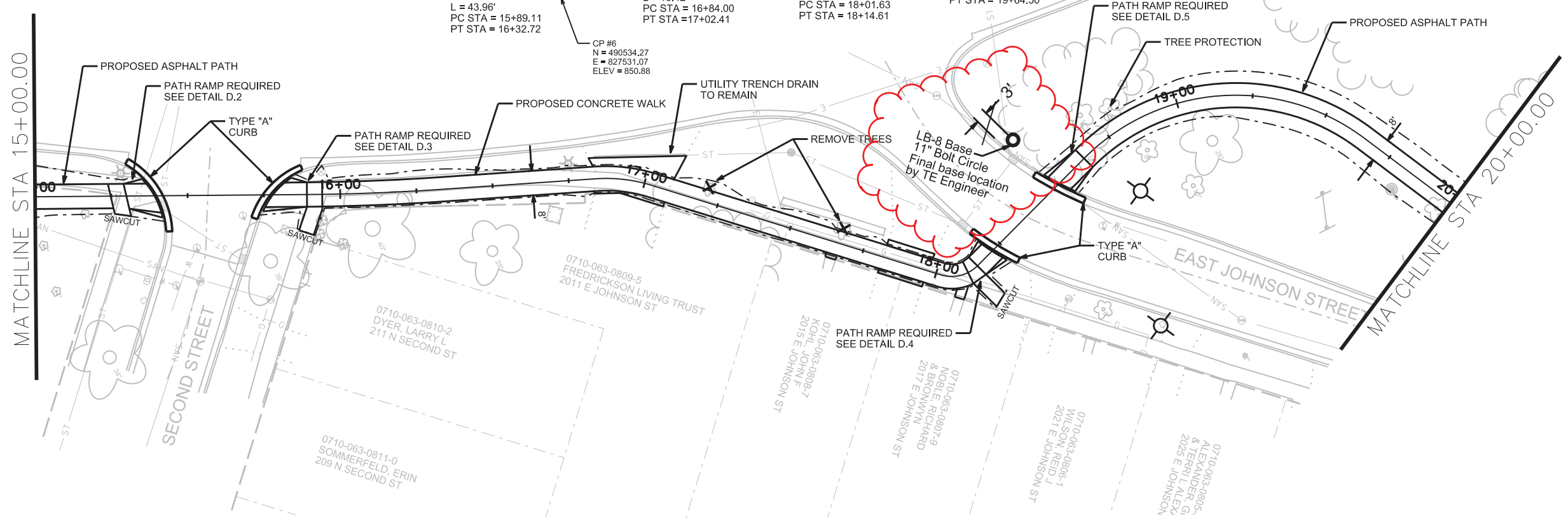

PLOT SCALE: \_\_\_\_\_

REV. DATE: \_\_\_\_\_

ORIGINATOR: CITY OF MADISON, STREETS DIVISION



\* REVISED 4-3-13

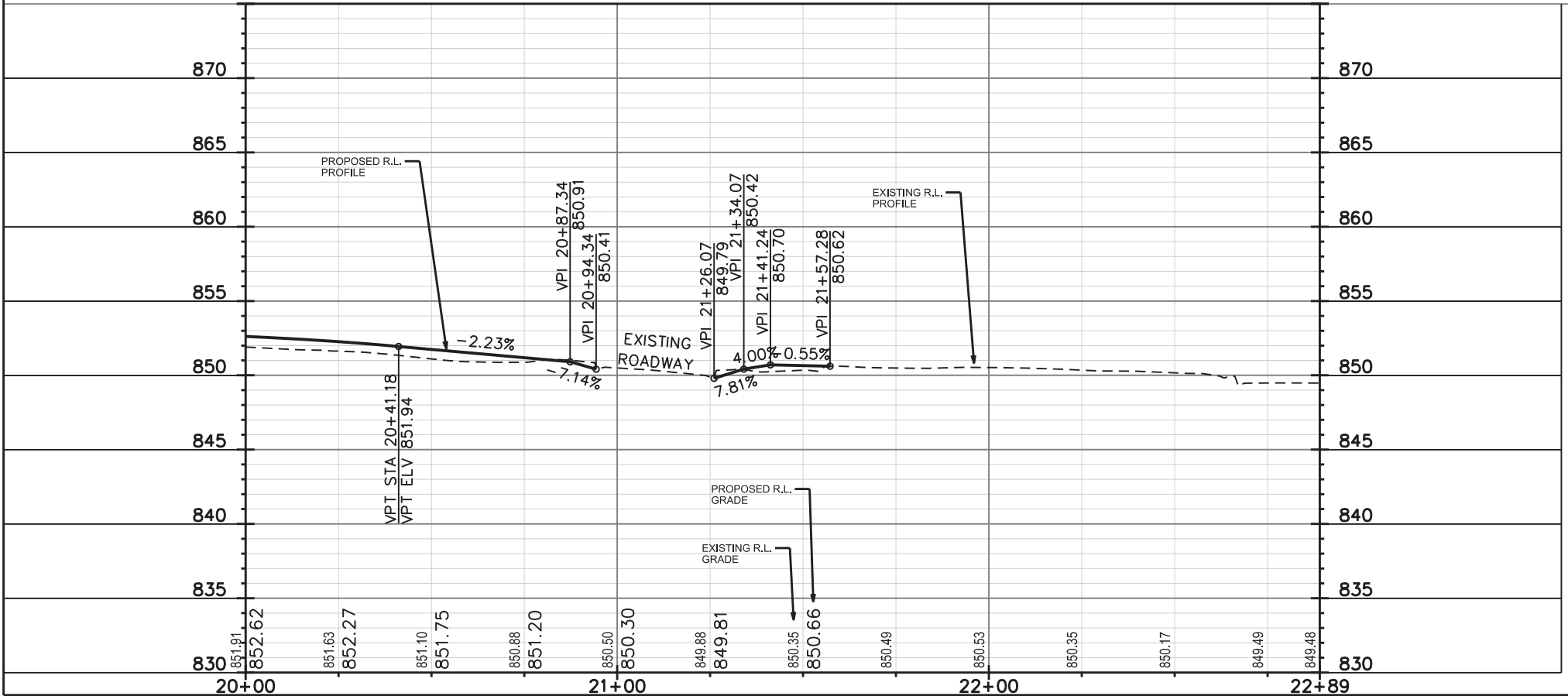
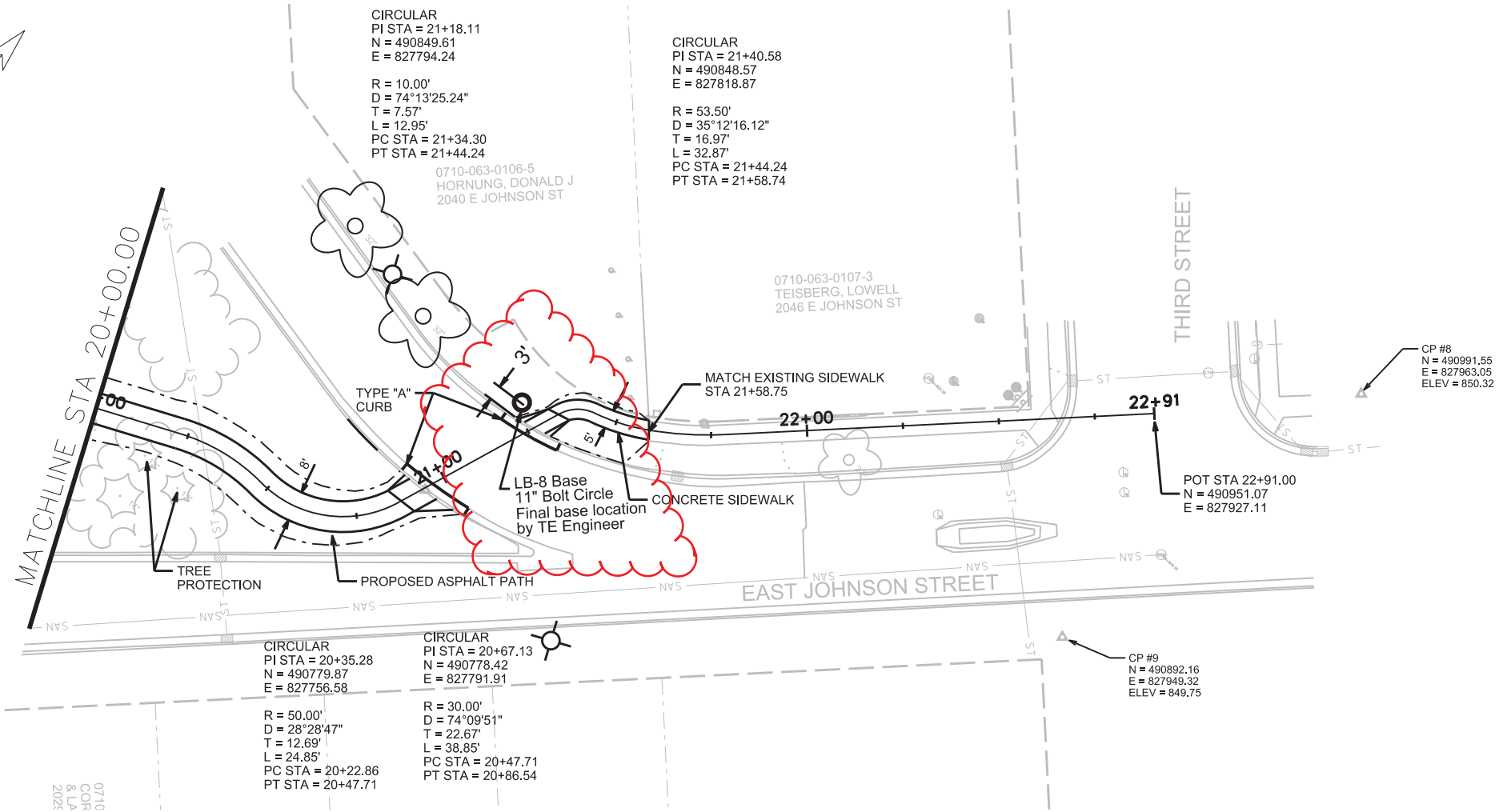

PLOT SCALE: \_\_\_\_\_

PLOT NAME: \_\_\_\_\_

REV. DATE: \_\_\_\_\_

ORIGINATOR: CITY OF MADISON, STREETS DIVISION

CROSS SECTIONS

E. JOHNSON ST

CITY OF MADISON

PLOT SCALE: \_\_\_\_\_

PLOT NAME: \_\_\_\_\_

REV. DATE: \_\_\_\_\_

ORIGINATOR: CITY OF MADISON, STREETS DIVISION

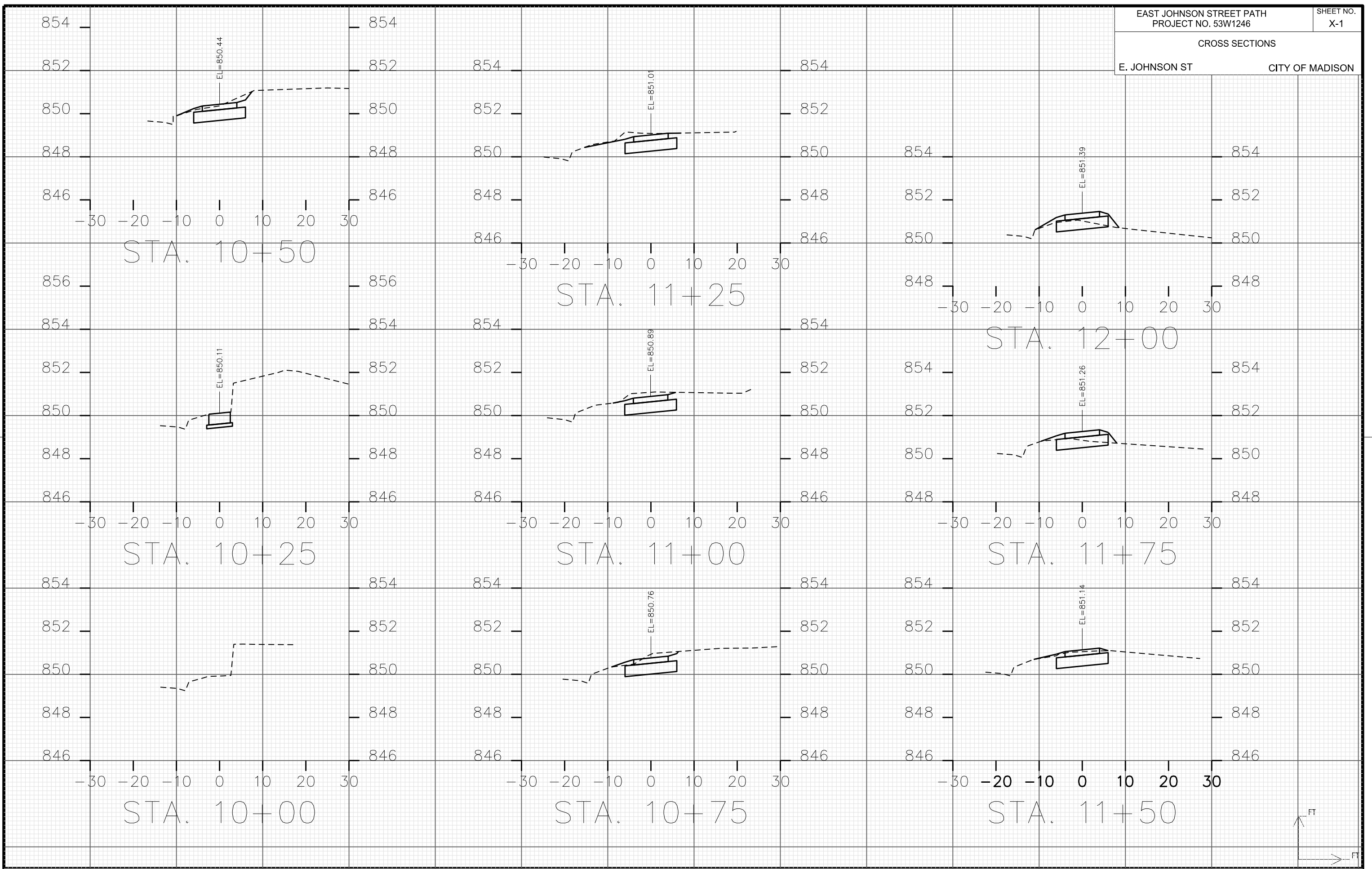

CROSS SECTIONS

E. JOHNSON ST

CITY OF MADISON

PLOT SCALE: \_\_\_\_\_

PLOT NAME: \_\_\_\_\_

REV. DATE: \_\_\_\_\_

ORIGINATOR: CITY OF MADISON, STREETS DIVISION

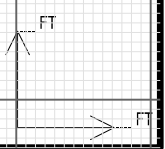
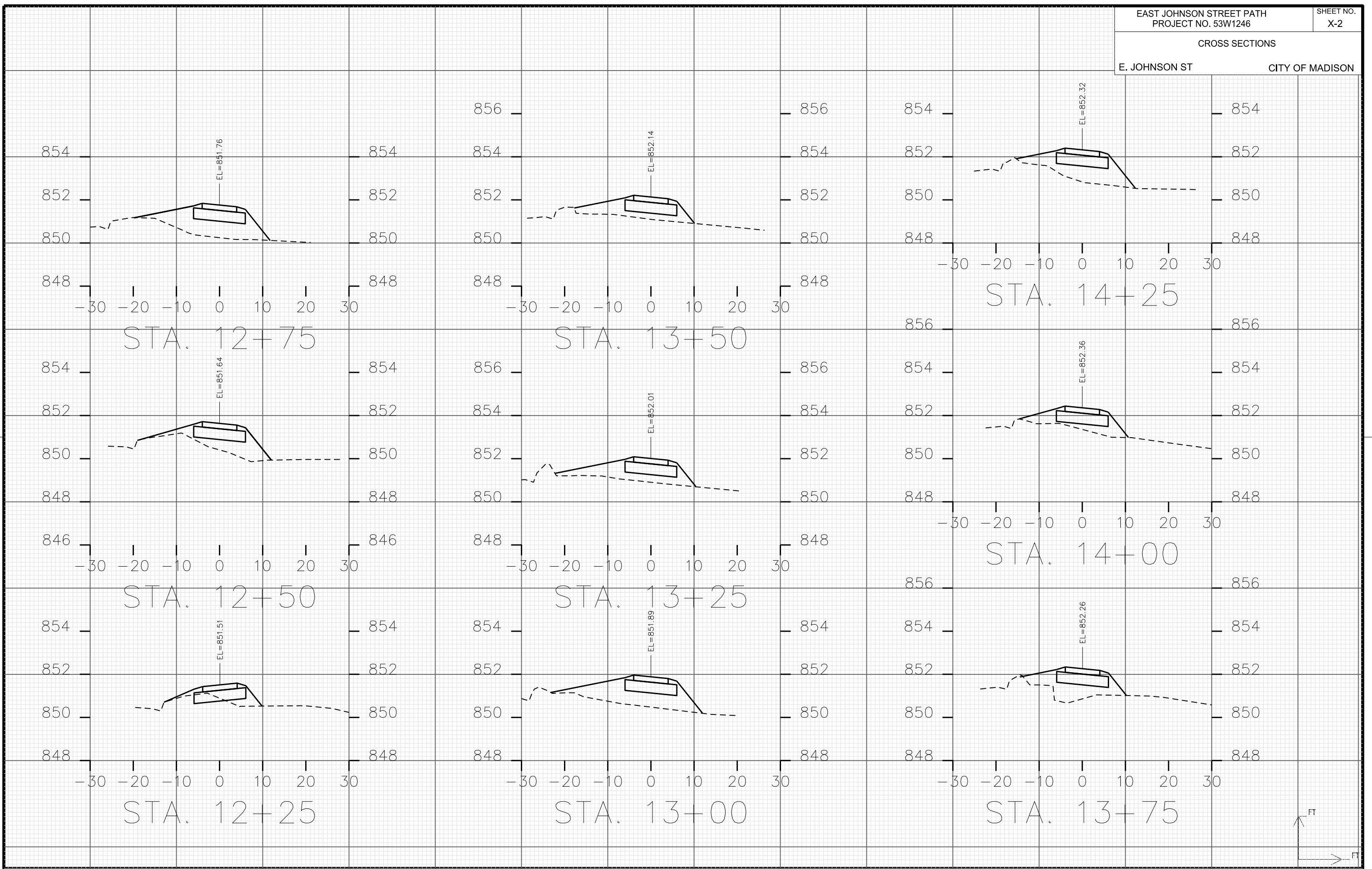

CROSS SECTIONS

E. JOHNSON ST

CITY OF MADISON

PLOT SCALE: \_\_\_\_\_

PLOT NAME: \_\_\_\_\_

REV. DATE: \_\_\_\_\_

ORIGINATOR: CITY OF MADISON, STREETS DIVISION

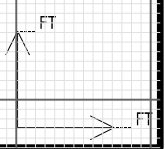
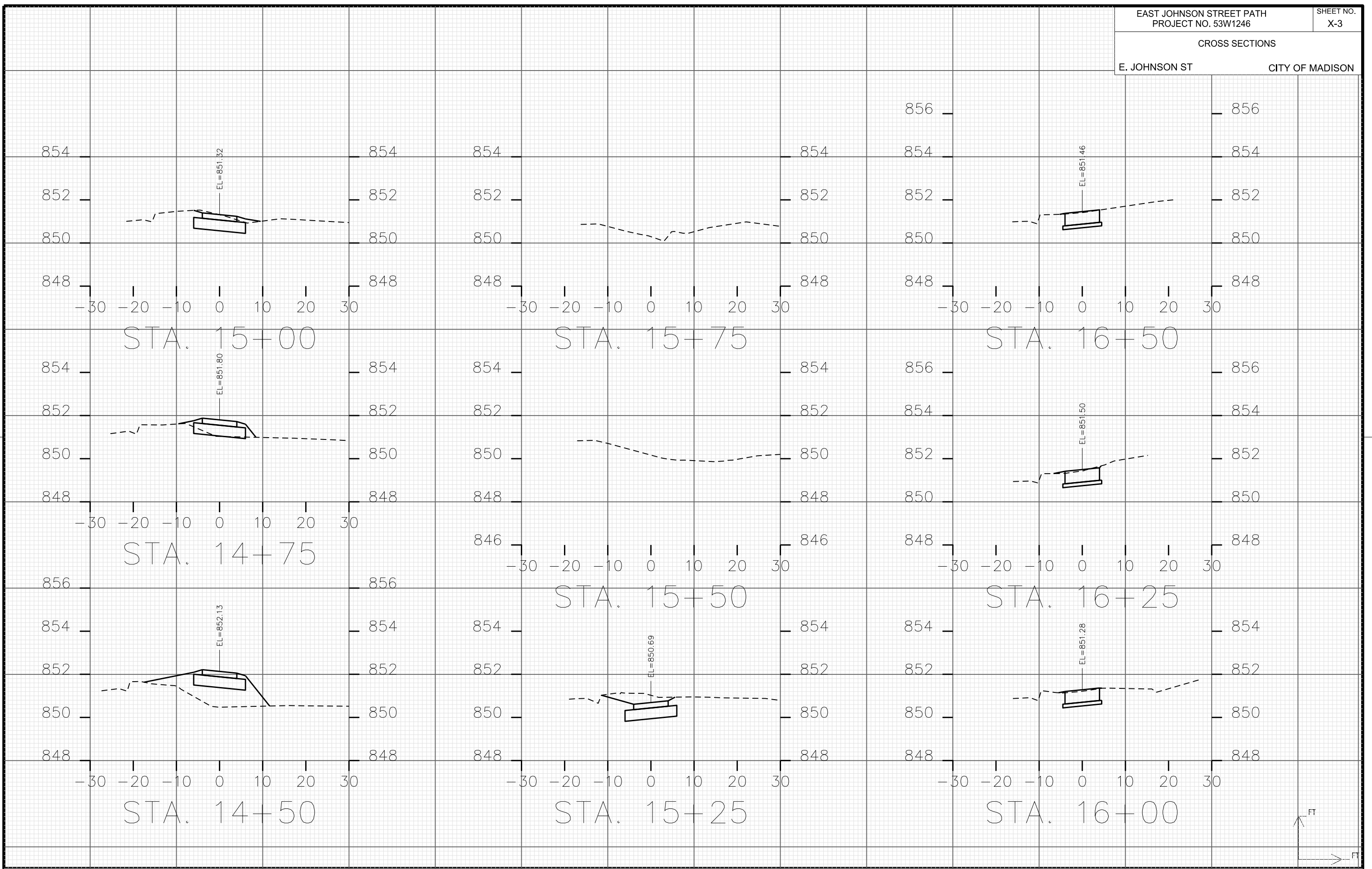

CROSS SECTIONS

E. JOHNSON ST

CITY OF MADISON

PLOT SCALE: \_\_\_\_\_

PLOT NAME: \_\_\_\_\_

REV. DATE: \_\_\_\_\_

ORIGINATOR: CITY OF MADISON, STREETS DIVISION

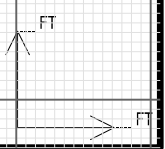
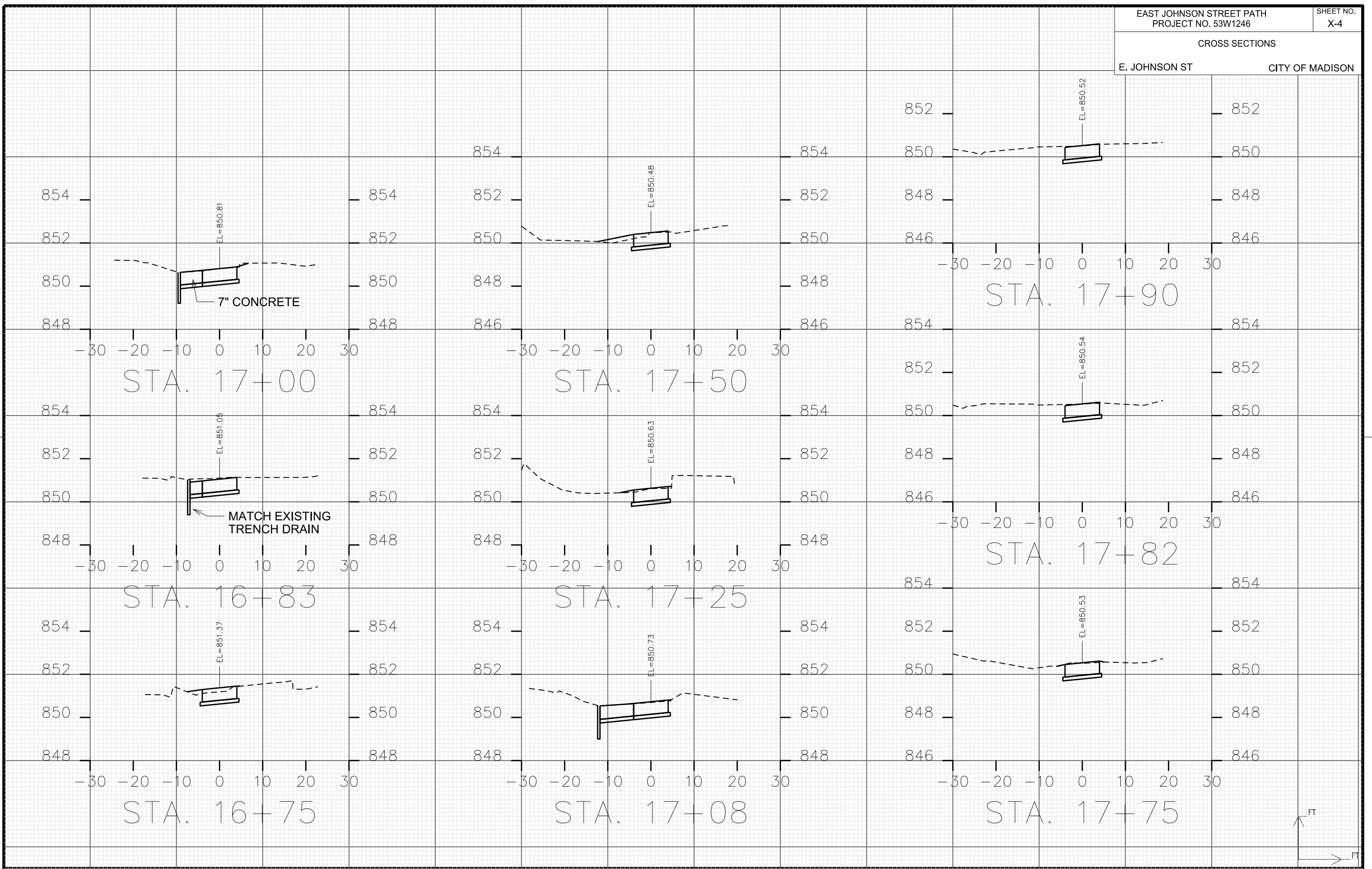

CROSS SECTIONS

E. JOHNSON ST

CITY OF MADISON

PLOT SCALE: \_\_\_\_\_

PLOT NAME: \_\_\_\_\_

REV. DATE: \_\_\_\_\_

ORIGINATOR: CITY OF MADISON, STREETS DIVISION

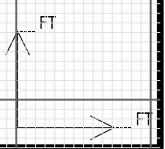
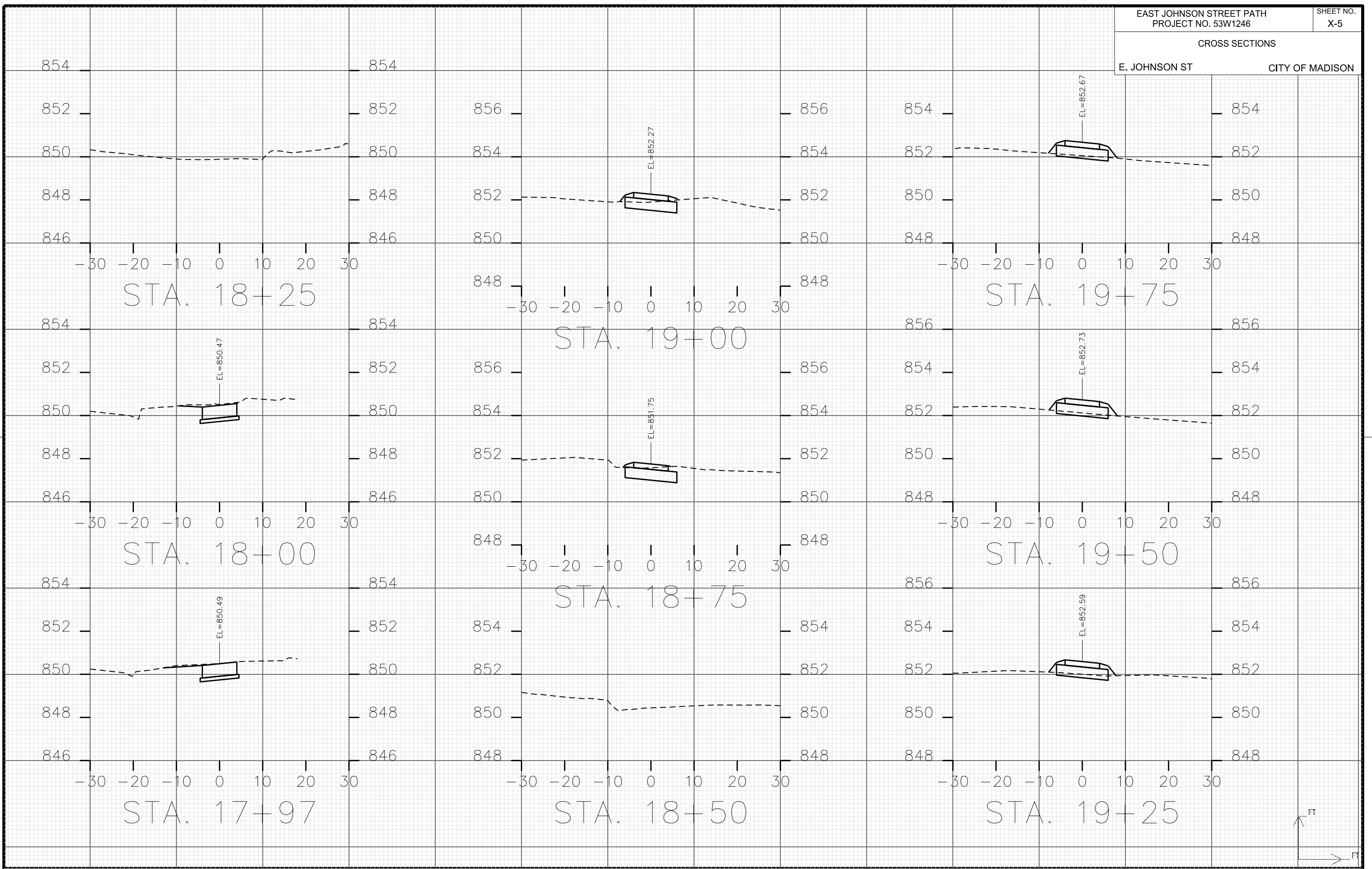

CROSS SECTIONS

E. JOHNSON ST

CITY OF MADISON

PLOT SCALE: \_\_\_\_\_

PLOT NAME: \_\_\_\_\_

REV. DATE: \_\_\_\_\_

ORIGINATOR: CITY OF MADISON, STREETS DIVISION

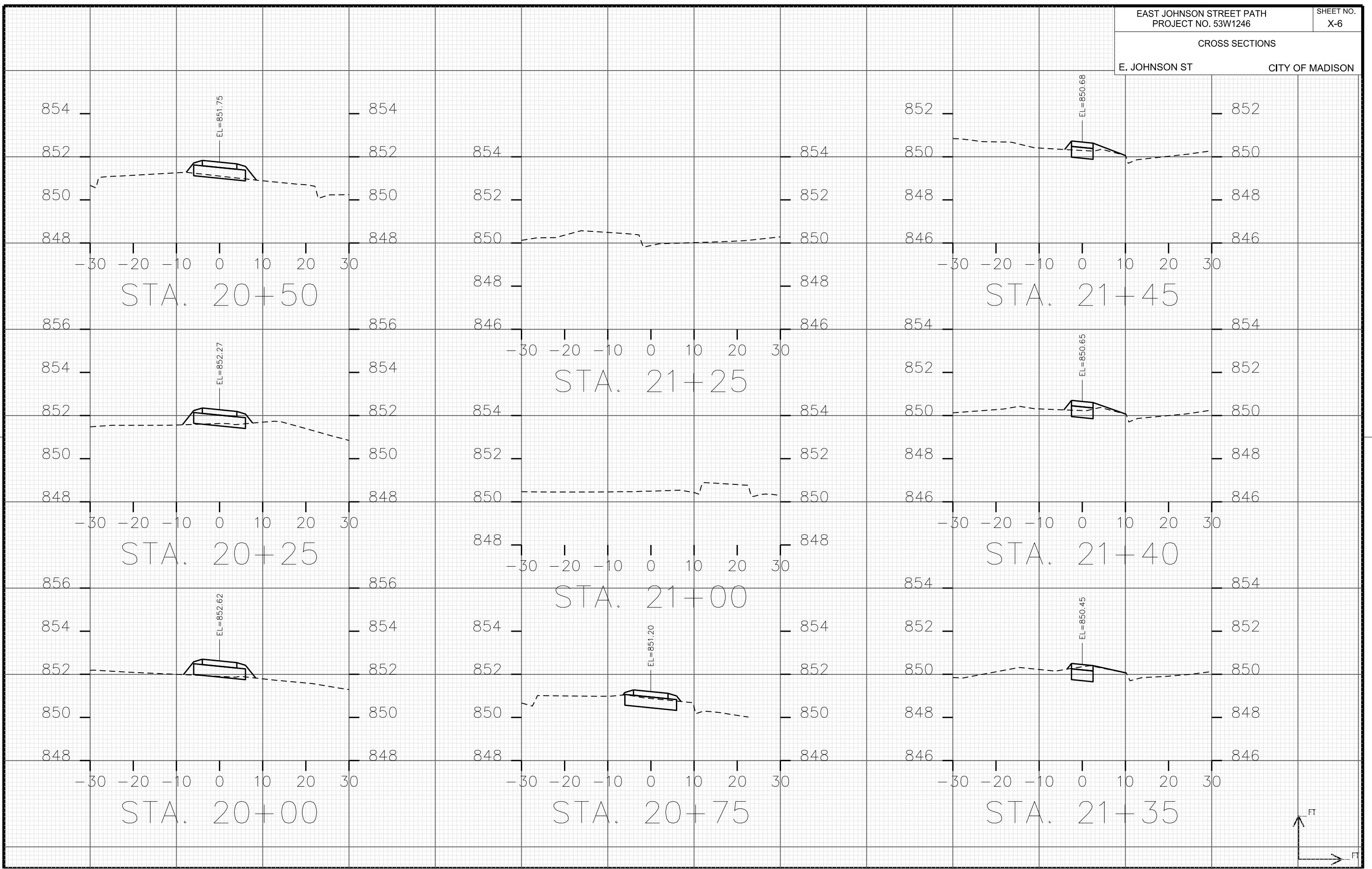

CROSS SECTIONS

E. JOHNSON ST

CITY OF MADISON

PLOT SCALE: \_\_\_\_\_

PLOT NAME: \_\_\_\_\_

REV. DATE: \_\_\_\_\_

ORIGINATOR: CITY OF MADISON, STREETS DIVISION

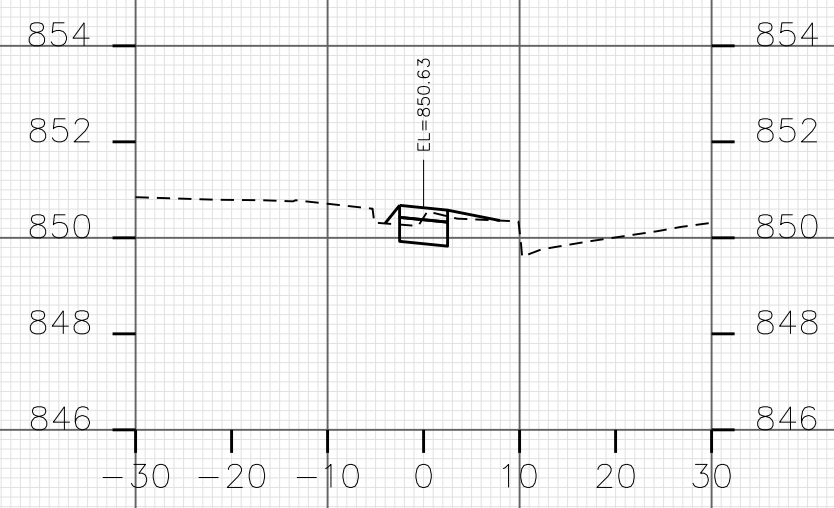

STA. 21+55

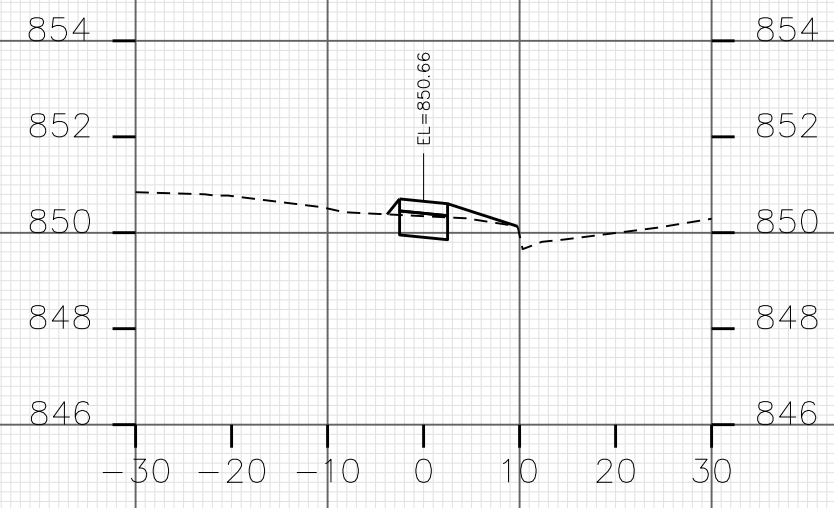

STA. 21+50

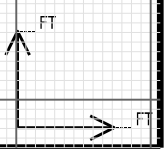



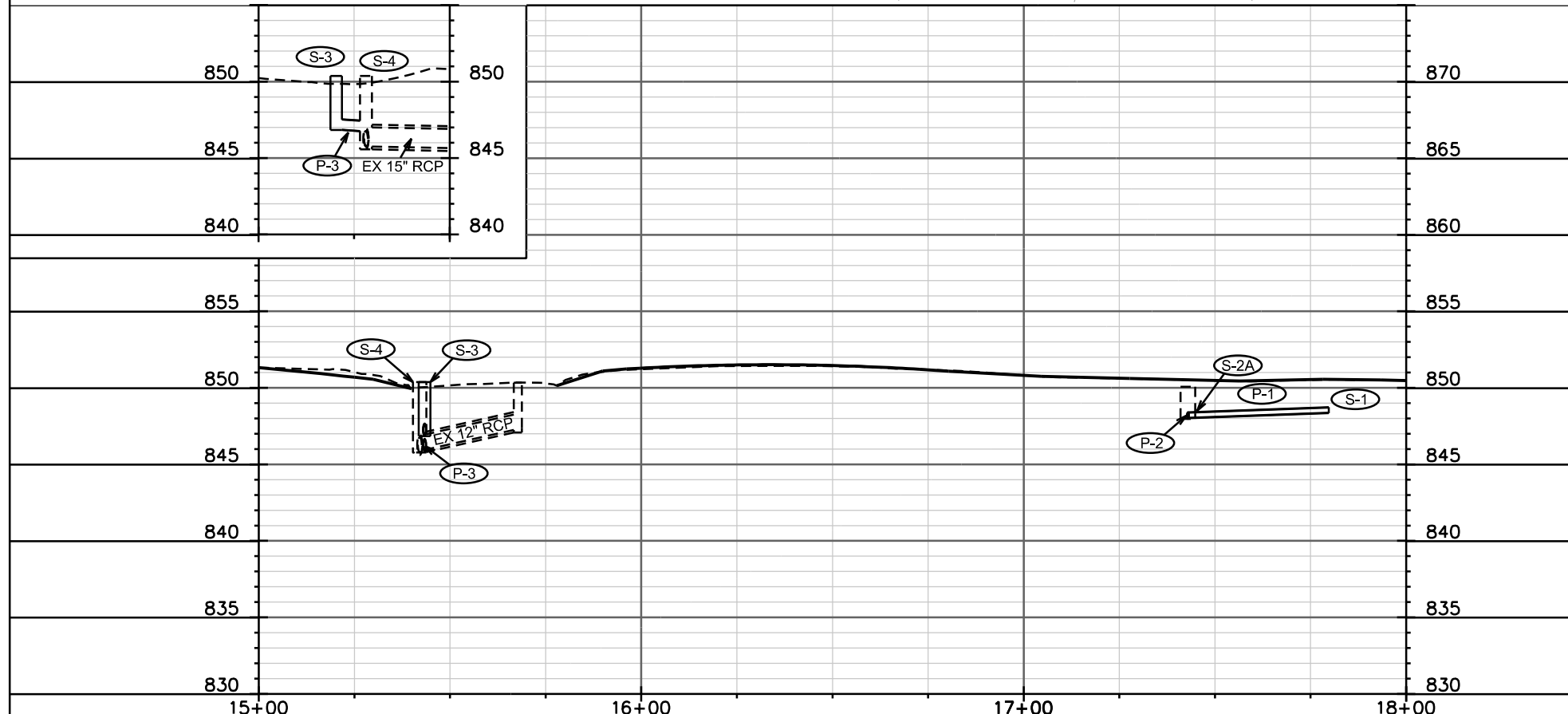
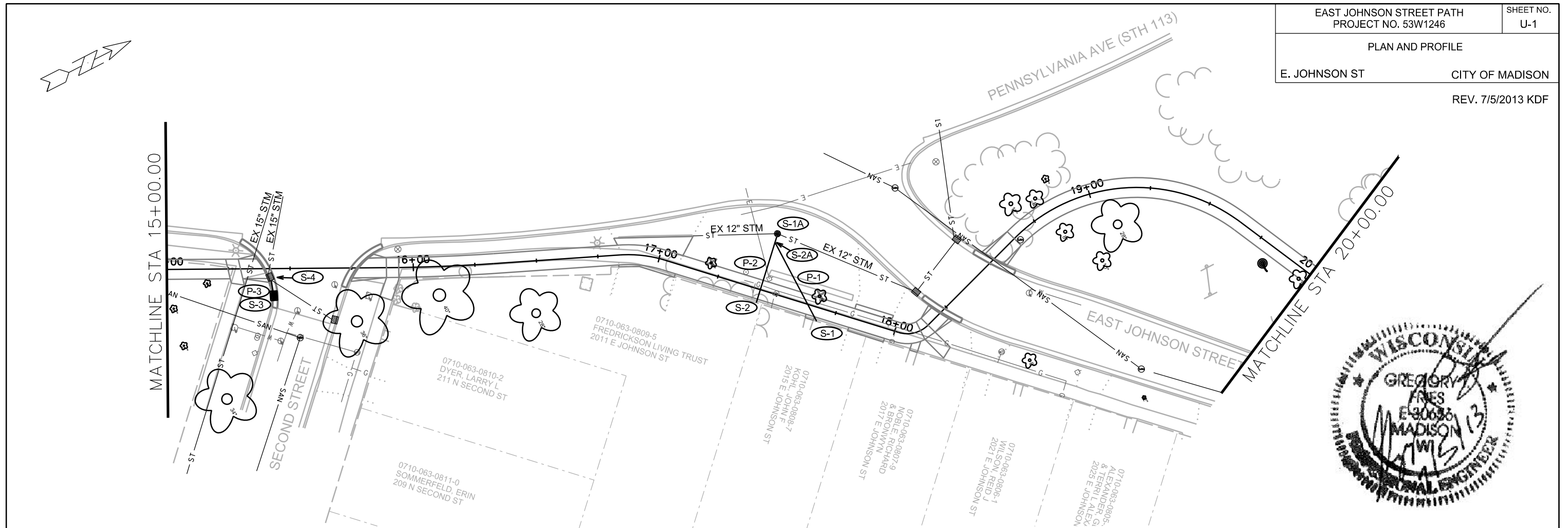

### STORM SCHEDULE

PROPOSED STORM STRUCTURES

STRUC. NO.	STATION	LOCATION (OFFSET)	TYPE	TOP OF CASTING	E.I.	DEPTH	NOTES
S-1	17+68.60	RT - 5.50'	STM STUB	--	848.38	--	
S-1A	17+42.95	LT - 23.77'	STM TAP	--	848.00	--	TAP EX CB 5541-064
S-2A	17+42.95	LT - 20.10'	WYE CONNECT.	--	848.02	--	INSTALL MARKER BALL
S-2	17+42.95	RT - 5.50'	STM STUB	--	848.28	--	
S-3	15+43.34	RT - 11.02'	H INLET	850.37	846.85	3.52	
S-4	15+43.08	RT - 3.31'	STM TAP	--	846.77	--	TAP EX IN 5541-028, (1)

PROPOSED STORM PIPES

PIPE NO.	FROM (DNSTM)	TO (UPSTM)	LGTH (FT)	DISCH. E.I.	INLET E.I.	SLOPE (%)	PIPE SIZE	TYPE	NOTES
P-1	S-2A	S-1	36	848.02	848.38	1.00%	4"	PVC	--
P-2	S-1A	S-2	29	848.00	848.28	1.00%	4"	PVC	--
P-3	S-4	S-3	8	846.77	846.85	1.00%	8"	PVC	C900

SPECIFIC NOTES

- (1) REMOVE CASTING AND REPLACE WITH 1" STEEL PLATE