

BID OF _____

2012

PROPOSAL, CONTRACT, BOND AND SPECIFICATIONS

FOR

NORTH ORCHARD STREET AND SPRING STREET RECONSTRUCTION
ASSESSMENT DISTRICT - 2012

CONTRACT NO. 6793

IN

MADISON, DANE COUNTY, WISCONSIN

AWARDED BY THE COMMON COUNCIL
MADISON, WISCONSIN ON _____

PLEASE RETURN PLANS AND SPECIFICATIONS TO:

**CITY ENGINEERING DIVISION
1600 EMIL STREET
MADISON, WISCONSIN 53713**

www.cityofmadison.com/business/pw

**NORTH ORCHARD STREET AND SPRING STREET RECONSTRUCTION
ASSESSMENT DISTRICT - 2012
CONTRACT NO. 6793**

INDEX

SECTION A: ADVERTISEMENT FOR BIDSA-1

SECTION B: INSTRUCTIONS TO BIDDERSB-1

SECTION C: SBEC-1

SECTION D: SPECIAL PROVISIONSD-1

SECTION E: PROPOSALE-1

SECTION F: BID BONDF-1

SECTION G: AGREEMENTG-1

SECTION H: PAYMENT AND PERFORMANCE BONDH-1

SECTION I: PREVAILING WAGE RATEI-1

This Proposal, and Agreement have
been prepared by:

**CITY ENGINEERING DIVISION
CITY OF MADISON
MADISON, DANE COUNTY, WISCONSIN**

Robert F. Phillips, P.E., City Engineer

SECTION A: ADVERTISEMENT FOR BIDS

REQUEST FOR BID FOR PUBLIC WORKS CONSTRUCTION CITY OF MADISON, WISCONSIN

A BEST VALUE CONTRACTING MUNICIPALITY

CONTRACT NO.	PROJECT NAME:
6793	NORTH ORCHARD STREET AND SPRING STREET RECONSTRUCTION ASSESSMENT DISTRICT - 2012
SBE GOAL	8%

Plans and Specifications are available at 1600 Emil Street, Madison, WI 53713; 608-267-1197 or on our website at www.cityofmadison.com/business/pw/contracts/openforBid.cfm.

PREQUALIFICATIONS

Bidders who have not been prequalified by the City Engineer and Affirmative Action Director for the period of **February 1, 2012 to January 31, 2013** must submit their application on or before 1:00 p.m., JANUARY 27, 2012, Room 115, City-County Building, Madison, WI 53703. Postmark is not applicable. Contractors be prequalified by the City Engineer including an affirmative action plan approved by the Affirmative Action Director prior to the bid opening or the bid will be rejected. Forms are available at the same location or on our website at www.cityofmadison.com/business/pw/forms.cfm.

PRE-BID MEETING

Representatives of the Affirmative Action Department will be present to discuss the Small Business Enterprise requirements on JANUARY 20, 2012 at 1:00 PM at 1600 Emil Street, Madison Wisconsin.

OTHER REQUIREMENTS

Sealed bids must be accompanied with a Bid Bond equal to at least 5% of the bid or a Certificate of Annual/Biennial Bid Bond or certified check, payable to the City Treasurer.

Prevailing Wage Rates may be required and are attached in Section I of the contract. See Special Provisions to determine applicability.

Deadline for the Submittal of Bid is JANUARY 27, 2012 by 1:00 PM, at 1600 Emil Street, Madison, WI 53713.

Bid Opening will be on FEBRUARY 3, 2012 at 1:30 PM at 1600 Emil Street, Madison, WI 53713.

REQUEST FOR BIDS FOR PUBLIC WORKS CONSTRUCTION FOR THE CITY OF MADISON, WISCONSIN

A BEST VALUE CONTRACTING MUNICIPALITY

Plans and Specifications for Public Works Projects that are open for bid are available on the City of Madison website at <http://www.cityofmadison.com/business/PW/contracts/openforBid.cfm> or by calling City Engineering at 608-266-4751.

Sealed bids must be accompanied with a Bid Bond equal to at least 5% of the bid or a Certificate of Annual/Biennial Bid Bond or certified check, payable to the City Treasurer.

Prevailing Wage Rates may be required and are attached in Section I of the contract. See Special Provisions to determine applicability.

Bidders must be prequalified with the City Engineer and the Affirmative Action Director. Deadline date for submittal of application is noticed on our website. Forms are available on the web at <http://www.cityofmadison.com/business/pw/forms.cfm> or by contacting City Engineering at 608-266-4620

Publ. WSJ JANUARY 13 & 20, 2012

SECTION B: INSTRUCTIONS TO BIDDERS

The City of Madison Standard Specifications for Public Works Construction - 2011 Edition, as supplemented and amended from time to time, forms a part of these contract documents as if attached hereto.

These standard specifications are available on the City of Madison Public Works website at www.cityofmadison.com/Business/PW/specs.cfm or by contacting City Engineering Division, Room 115, City-County Building, 210 Martin Luther King Jr. Blvd., Madison, WI 53703.

The Contractor shall review these Specifications prior to preparation of proposals for the work to be done under this contract, with specific attention to Article 102 **“BIDDING REQUIREMENTS AND CONDITIONS”** and Article 103 **“AWARD AND EXECUTION OF THE CONTRACT.”** For the convenience of the bidder, below are highlights of three subsections of the specifications.

Section 102.1: Pre-Qualification of Bidders

In accordance with Wisconsin State Statutes 66.0901 (2) and (3), all bidders must submit to the Board of Public Works proof of responsibility on forms furnished by the City. The City requires that all bidders be qualified on a biennial basis.

Bidders must present satisfactory evidence that they have been regularly engaged in the type of work specified herein and they are fully prepared with necessary capital, materials, machinery and supervisory personnel to conduct the work to be contracted for to the satisfaction of the City. All bidders must be pre-qualified by the Board of Public Works for the type of construction on which they are bidding prior to the opening of the bid.

In accordance with Section 39.02(9)(a)l. of the Madison General Ordinances, all bidders shall submit in writing to the Affirmative Action Division Manager of the City of Madison, a Certificate of Compliance or an Affirmative Action Plan at the same time or prior to the submission of the proof of responsibility forms. The bidder shall be disqualified if the bidder fails to or refuses to, prior to opening of the bid, submit a Certificate of compliance, Affirmative Action Plan or Affirmative Action Data Update, as applicable, as defined by Section 39.02 of the Madison General Ordinances (entitled Affirmative Action) and as required by Section 102.11 of the Standard Specifications.

Section 102.4: Proposals

No bid will be accepted that does not contain an adequate or reasonable price for each and every item named in the Schedule of Unit Prices.

A lump sum bid for the work in accordance with the plans and specifications is required. The lump sum bid must be the same as the total amounts bid for the various items and it shall be inserted in the space provided.

All papers bound with or attached to the proposal form are considered a part thereof and must not be detached or altered when the proposal is submitted. The plans, specifications and other documents designated in the proposal form will be considered a part of the proposal whether attached or not.

A proposal submitted by an individual shall be signed by the bidder or by a duly authorized agent. A proposal submitted by a partnership shall be signed by a member/partner or by a duly authorized agent thereof. A proposal submitted by a corporation shall be signed by an authorized officer or duly authorized registered agent of such corporation, and the proposal shall show the name of the State under the laws of

which such corporation was chartered. The required signatures shall in all cases appear in the space provided therefore on the proposal.

Each proposal shall be placed, together with the proposal guaranty, in a sealed envelope, so marked as to indicate name of project, the contract number or option to which it applies, and the name and address of the Contractor. Proposals will be received at the place and until the hour on the date designated in the advertisement. When sent by mail, the sealed proposal marked as indicated above shall be enclosed in an additional envelope. Proposals sent by mail, submitted in person or otherwise delivered must be in the hands of the official conducting the letting by the hour on the date designated in the advertisement. Proposals received after the date designated will be returned to the bidder unopened.

The Bidder shall execute form ERD-7777 (R.9/03), a part of these proposal pages and submit same with the bidder's proposal, if applicable. REFER TO PROPOSAL SECTION.

Section 102.5: Bid Deposit (Proposal Guaranty)

No proposal shall be considered unless either (i) it is accompanied by a bid deposit of the character and amount described in the Advertisement for Bids or (ii) a biennial bid bond in an amount and form acceptable to the City of Madison has been previously submitted.

Bid deposits of unsuccessful bidders shall be returned following the award of the contract by the Common Council. Bid deposit of the successful bidders shall be returned within forty-eight (48) hours following execution of the contract and bond as required.

Bidders for this Contract(s) must be Pre-Qualified for at least one of the following type(s) of construction denoted by an

Building Demolition

- | | |
|---|--|
| 101 <input type="checkbox"/> Asbestos Removal | 110 <input type="checkbox"/> Building Demolition |
| 120 <input type="checkbox"/> House Mover | |

Street, Utility and Site Construction

- | | |
|---|---|
| 201 <input type="checkbox"/> Asphalt Paving | 265 <input type="checkbox"/> Retaining Walls, Precast Modular Units |
| 205 <input type="checkbox"/> Blasting | 270 <input type="checkbox"/> Retaining Walls, Reinforced concrete |
| 210 <input type="checkbox"/> Boring/Pipe Jacking | 275 <input checked="" type="checkbox"/> Sanitary, Storm Sewer & Water Main Const. |
| 215 <input type="checkbox"/> Concrete Paving | 280 <input type="checkbox"/> Sewer Lateral Drain Cleaning/Internal TV Insp. |
| 220 <input type="checkbox"/> Con. Sidewalk/Curb & Gutter/Misc. Concrete Work | 285 <input type="checkbox"/> Sewer Lining |
| 221 <input type="checkbox"/> Concrete Bases and Other Concrete Work | 290 <input type="checkbox"/> Sewer Pipe Bursting |
| 225 <input type="checkbox"/> Dredging | 295 <input type="checkbox"/> Soil Borings |
| 230 <input type="checkbox"/> Fencing | 300 <input type="checkbox"/> Soil Nailing |
| 235 <input type="checkbox"/> Fiber Optic Cable/Conduit Installation | 305 <input type="checkbox"/> Storm & Sanitary Sewer Laterals & Water Svc. |
| 240 <input type="checkbox"/> Grading and Earthwork | 310 <input checked="" type="checkbox"/> Street Construction |
| 242 <input type="checkbox"/> Infrared Seamless Patching | 315 <input type="checkbox"/> Street Lighting |
| 245 <input type="checkbox"/> Landscaping, Maintenance | 318 <input type="checkbox"/> Tennis Court Resurfacing |
| 250 <input type="checkbox"/> Landscaping, Site and Street | 330 <input type="checkbox"/> Traffic Control During Construction |
| 251 <input type="checkbox"/> Parking Ramp Maintenance | 320 <input type="checkbox"/> Traffic Signals |
| 255 <input type="checkbox"/> Pavement Sealcoating and Crack Sealing | 325 <input type="checkbox"/> Traffic Signing & Marking |
| 260 <input type="checkbox"/> Petroleum Above/Below Ground Storage Tank Removal/Installation | 335 <input type="checkbox"/> Trucking |
| | 399 <input type="checkbox"/> Other _____ |

Bridge Construction

- 501 Bridge Construction and/or Repair

Building Construction

- | | |
|--|---|
| 401 <input type="checkbox"/> Floor Covering (including carpet, ceramic tile installation, rubber, VCT) | 435 <input type="checkbox"/> Masonry |
| 402 <input type="checkbox"/> Building Automation Systems | 437 <input type="checkbox"/> Metals |
| 403 <input type="checkbox"/> Concrete | 440 <input type="checkbox"/> Painting and Wallcovering |
| 404 <input type="checkbox"/> Doors and Windows | 445 <input type="checkbox"/> Plumbing |
| 405 <input type="checkbox"/> Electrical - Power, Lighting & Communications | 450 <input type="checkbox"/> Pump Repair |
| 410 <input type="checkbox"/> Elevator - Lifts | 455 <input type="checkbox"/> Pump Systems |
| 412 <input type="checkbox"/> Fire Suppression | 460 <input type="checkbox"/> Roofing and Moisture Protection |
| 413 <input type="checkbox"/> Furnishings - Furniture and Window Treatments | 461 <input type="checkbox"/> Solar Photovoltaic/Hot Water Systems |
| 415 <input type="checkbox"/> General Building Construction, Equal or Less than \$250,000 | 465 <input type="checkbox"/> Soil/Groundwater Remediation |
| 420 <input type="checkbox"/> General Building Construction, \$250,000 to \$1,500,000 | 466 <input type="checkbox"/> Warning Sirens |
| 425 <input type="checkbox"/> General Building Construction, Over \$1,500,000 | 470 <input type="checkbox"/> Water Supply Elevated Tanks |
| 428 <input type="checkbox"/> Glass and/or Glazing | 475 <input type="checkbox"/> Water Supply Wells |
| 429 <input type="checkbox"/> Hazardous Material Removal | 480 <input type="checkbox"/> Wood, Plastics & Composites-Structural & Architectural |
| 430 <input type="checkbox"/> Heating, Ventilating and Air Conditioning (HVAC) | 499 <input type="checkbox"/> Other _____ |
| 433 <input type="checkbox"/> Insulation - Thermal | |

State of Wisconsin Certifications

- 1 Class 5 Blaster - Blasting Operations and Activities 2500 feet and closer to inhabited buildings for quarries, open pits and road cuts.
- 2 Class 6 Blaster - Blasting Operations and Activities 2500 feet and closer to inhabited buildings for trenches, site excavations, basements, underwater demolition, underground excavations, or structures 15 feet or less in height.
- 3 Class 7 Blaster - Blasting Operations and Activities for structures greater than 15 ' in height, bridges, towers, and any of the objects or purposes listed as "Class 5 Blaster or Class 6 Blaster".
- 4 Petroleum Above/Below Ground Storage Tank Removal and Installation (Attach copies of State Certifications.)
- 5 Hazardous Material Removal (Contractor to be certified for asbestos and lead abatement per the Wisconsin Department of Health Services, Asbestos and Lead Section (A&LS).) See the following link for application: <http://www.dhs.wisconsin.gov/Asbestos/Cert/Index.htm>. State of Wisconsin Performance of Asbestos Abatement Certificate must be attached.
- 6 Other _____

SECTION C: SBE

Instructions to Bidders City of Madison SBE Program Information

2 Small Business Enterprise (SBE) Program Information

2.1 Policy and Goal

The City of Madison reaffirms its policy of nondiscrimination in the conduct of City business by maintaining a procurement process which remains open to all who have the potential and ability to sell goods and services to the City. It is the policy of the City of Madison to allow Small Business Enterprises (SBE) maximum feasible opportunity to participate in City of Madison contracting.

Please refer to the "ADVERTISEMENT FOR BIDS" for the goal for the utilization of SBEs on this project. SBEs may participate as subcontractors, vendors and/or suppliers, which provide a commercially useful function.

A bidder which achieves or exceeds the SBE goal will be in compliance with the SBE requirements of this project. In the event that the bidder is unable to achieve the SBE goal, the bidder must demonstrate that a good faith effort to do so was made. Failure to either achieve the goal or demonstrate a good faith effort to do so will be grounds for the bidder being deemed a nonresponsible contractor ineligible for award of this contract.

2.2 Contract Compliance

Questions concerning the SBE Program shall be directed to the Contract Compliance Officer of the City of Madison Department of Civil Rights, Affirmative Action Division, 210 Martin Luther King, Jr. Blvd., Room 523, Madison, WI 53703; telephone (608) 266-4910.

2.3 Certification of SBE by City of Madison

The Affirmative Action Department maintains a directory of SBEs which are currently certified as such by the City of Madison. Contact the Contract Compliance Officer as indicated in Section 2.2 to receive a copy of the SBE Directory or you may access the SBE Directory online at www.cityofmadison.com/dcr/aaTBDir.cfm.

All contractors, subcontractors, vendors and suppliers seeking SBE status must complete and submit **Schedule C, SBE Certification Application** to the City of Madison Affirmative Action Department by the time and date established for receipt of bids. A copy of Schedule C is available by contacting the Contract Compliance Officer at the address and telephone indicated in Section 1.2. Submittal of Schedule C by the time specified does not guarantee that the applicant will be certified as a SBE eligible to be utilized towards meeting the SBE goal for this project.

2.4 Small Business Enterprise Compliance Report

2.4.1 Good Faith Efforts

Bidders shall take all necessary affirmative steps to assure that SBEs are utilized when possible and that the established SBE goal for this project is achieved. When a bidder is unable to achieve the established SBE goal, the bidder must demonstrate that a good faith effort to do so was made. Such a good faith effort should include the following:

- 2.4.1.1 Attendance at the pre-bid meeting.
- 2.4.1.2 Using the City of Madison's directory of certified SBEs to identify SBEs from which to solicit bids.
- 2.4.1.3 Assuring that SBEs are solicited whenever they are potential sources.
- 2.4.1.4 Referring prospective SBEs to the City of Madison Affirmative Action Department for certification.
- 2.4.1.5 Dividing total project requirements into smaller tasks and/or quantities, where economically feasible, to permit maximum feasible SBE participation.
- 2.4.1.6 Establishing delivery schedules, where requirements permit, which will encourage participation by SBEs.
- 2.4.1.7 Providing SBEs with specific information regarding the work to be performed.
- 2.4.1.8 Contacting SBEs in advance of the deadline to allow such businesses sufficient time to prepare a bid and engage in negotiation.
- 2.4.1.9 Negotiating directly with SBEs including those which volunteer a bid.
- 2.4.1.10 Utilizing the bid of a qualified and competent SBE when the bid of such a business is deemed reasonable, although not necessarily low.

2.4.2 Reporting SBE Utilization and Good Faith Efforts

The Small Business Enterprise Compliance Report is to be submitted by the bidder in a separate sealed envelope marked: **"ENVELOPE 2 - SBE COMPLIANCE REPORT."** This report is due by the specified bid closing time and date. Bids submitted without a completed SBE Compliance Report as outlined below will be deemed nonresponsive and the bidder ineligible for award of this contract.

- 2.4.2.1 If the Bidder meets or exceeds the goal established for SBE utilization, the Small Business Enterprise Compliance Report shall consist of the following:
 - 2.4.2.1.1 **Cover Page**, Page SBE-1; and
 - 2.4.2.1.2 **Summary Page**, SBE-2.
- 2.4.2.2 If the bidder does not meet the goal established for SBE utilization, the Small Business Enterprise Compliance Report shall consist of the following:
 - 2.4.2.2.1 **Cover Page**, Page SBE-1;
 - 2.4.2.2.2 **Summary Page**, SBE-2; and

2.4.2.2.3 **SBE Contact Report**, SBE-3 and SBE-4. (A separate Contact Report must be completed for each SBE which is not utilized.)

2.5 **Appeal Procedure**

A bidder which does not achieve the established goal and is deemed nonresponsive for failure to demonstrate a good faith effort to achieve such goal and subsequently denied eligibility for award of contract may, within 72 hours of receiving such notification, appeal that decision to a special appeals committee composed of three (3) members of the Affirmative Action Commission, three (3) members of the Board of Public Works and a seventh member appointed by the Mayor. All appeals must be made in writing to the Director of Public Works and received within 72 hours of City of Madison's notice. Postmark not applicable.

A bidder which is deemed nonresponsive may not appeal the City's decision to deny eligibility for award of contract.

2.6 **SBE Requirements After Award of the Contract**

The successful bidder shall identify SBE subcontractors, suppliers and vendors on the subcontractor list in accordance with the specifications. The Contractor shall submit a detailed explanation of any variances between the listing of SBE subcontractors, vendors and/or suppliers on the subcontractor list and the Contractor's SBE Compliance Report for SBE participation. Failure to provide a satisfactory explanation in these variances may result in the City invoking the sanctions contained in Paragraph 5(g) of the Agreement contained within this project manual.

No change in SBE subcontractors, vendors and/or suppliers from those SBEs indicated in the SBE Compliance Report will be allowed without prior approval from the City of Madison Affirmative Action Department. The contractor shall submit in writing to the City of Madison Affirmative Action Department a request to change any SBE citing specific reasons which necessitate such a change. The Affirmative Action Department will use a general test of reasonableness in approving or rejecting the contractor's request for change. If the request is approved, the Contractor will make every effort to utilize another SBE if available.

The City will monitor the project to ensure that the actual percentage commitment to SBE firms is carried out.

2.7 **SBE Definition and Eligibility Guidelines**

A Small Business Enterprise is a business concern awarded certification by the City of Madison. For the purposes of this program a Small Business Enterprise is defined as:

- A. An independent business operated under a single management. The business may not be a subsidiary of any other business and the stock or ownership may not be held by any individual or any business operating in the same or a similar field. In determining whether an entity qualifies as a SBE, the City shall consider all factors relevant to being an independent business including, but not limited to, the date the business was established, adequacy of its resources for the work in which it proposes to involve itself, the degree to which financial, equipment

leasing and other relationships exist with other ineligible firms in the same or similar lines of work. SBE owner(s) shall enjoy the customary incidents of ownership and shall share in the risks and profits commensurate with their enjoyment interests, as demonstrated by an examination of the substance rather than form or arrangements that may be reflected in its ownership documents.

- B. A business with annual gross receipts of less than \$750,000 when averaged over the past three years period;

Firm and/or individuals that submit fraudulent documents/testimony may be barred from doing business with the City and/or forfeit existing contracts.

SBE certification is valid for one (1) year unless challenged.

**NORTH ORCHARD STREET AND SPRING STREET RECONSTRUCTION
ASSESSMENT DISTRICT - 2012
CONTRACT NO. 6793**

Small Business Enterprise Compliance Report

Cover Sheet

**This information MUST be submitted in a separate sealed envelope marked
"ENVELOPE NO. 2 - SBE COMPLIANCE REPORT."**

Prime Bidder Information:

Company: _____

Address: _____

Telephone Number: _____ Fax Number: _____

Contact Person/Title: _____

Prime Bidder Certification:

I, _____, _____ of
Name Title

_____ certify that the information
Company

contained in this SBE Compliance Report is true and correct to the best of my knowledge and belief.

Witness' Signature

Bidder's Signature

Date

**NORTH ORCHARD STREET AND SPRING STREET RECONSTRUCTION
ASSESSMENT DISTRICT - 2012
CONTRACT NO. 6793**

Small Business Enterprise Compliance Report

SBE Contact Report

**This information MUST be submitted in a separate sealed envelope marked
“ENVELOPE NO. 2 - SBE COMPLIANCE REPORT.”**

Submit separate copy of this form for each SBE which you are not able to utilize towards meeting the SBE goal for this project. Attach separate sheets if necessary.

SBE Information:

Company: _____

Address: _____

Telephone Number: _____

Contact Person/Title: _____

1. Outline below all efforts to solicit a bid from the above SBE. Include date, means of contact, who from your company made this contact and the result.

2. Describe the information provided to the aforementioned SBE regarding the scope of work for which he/she was to provide a bid?

Is this the same scope of work on which the subcontractor you intend to utilize based his/her bid?

Yes No

3. Did this SBE submit a bid? Yes No

4. If you responded “Yes” to Question 3, please check the items below which apply and provide the requested detail. If you responded “No” to Question 3, please skip ahead to Question 5.

The SBE listed above is unavailable for work on this project for the following reasons. Provide specific detail for this conclusion.

The SBE listed above is unqualified for work on this project. Provide specific details for this conclusion.

The SBE listed above provided a price that was unreasonable. Provide specific detail for this conclusion including the SBE’s price and the price of the subcontractor you intend to utilize.

Other; please specify reason(s) other than listed above which made it impossible for you to utilize this SBE on this project.

5. Describe any other good faith efforts:

SECTION D: SPECIAL PROVISIONS

NORTH ORCHARD STREET AND SPRING STREET RECONSTRUCTION ASSESSMENT DISTRICT - 2012 CONTRACT NO. 6793

It is the intent of these Special Provisions to set forth the final contractual intent as to the matter involved and shall prevail over the Standard Specifications and plans whenever in conflict therewith. In order that comparisons between the Special Provisions can be readily made, the numbering system for the Special Provisions is equivalent to that of the Specifications.

Whenever in these Specifications the term "Standard Specifications" appears, it shall be taken to refer to the City of Madison Standard Specifications for Public Works Construction and Supplements thereto.

SECTION 102.10: MINIMUM RATE OF WAGE SCALE

For this project, payment of prevailing wages (white sheet) is not required if either: a single trade accounts for 85% or more of the total labor costs of the project and the bid is less than \$48,000; or no single trade accounts for 85% or more of the total labor costs of the project and the bid is less than \$100,000. For bids not meeting either of these conditions, prevailing wages shall be required.

If required, the wages and benefits paid on the contract shall not be less than those specified in the Prevailing Wage Determination included with these contract documents for the following types of work:

- Building and Heavy Construction
- Sewer, Water, and Tunnel Construction
- Local Street and Miscellaneous Paving Operations
- Residential and Agricultural Construction

All bidders are notified that all labor employed on City contracts must be paid in accordance with the minimum rate of wage scale included in the Contract Documents.

For the information of the employees working on the project, a copy of the wage scale included in the contract documents and the provisions of Section 66.0903(8) of the Wisconsin Statutes shall be kept posted by the employer and in at least one conspicuous and easily accessible place at the site of the project.

The Contractor shall keep weekly payroll records setting forth the name, address, telephone number, classification, wage rate and fringe benefit package of each employee who worked on such City project and all other projects the employee worked in the same period, and the Contractor must keep records of the individual time each employee worked on the project and for each day of the project. Such records shall also set forth the total number of hours of overtime credited to each such employee for each day and week and the amount of overtime pay received in that week. Such records shall, in addition, set forth the full weekly wages earned by each such employee and the actual hourly wage paid to that employee. The Contractor shall

submit payroll records to the Engineer every week for those periods when work is being done on the project. Said submittal shall be within twenty-one (21) calendar days of the end of the Contractor's weekly pay period.

The Contractor shall ensure that employees shall be paid unconditionally and shall receive the full amounts accrued at the time of payment, computed at rates not less than those stated in the City of Madison "Minimum Rate of Wage Scale" and that each employee's rate shall be determined by the work that is done within the trade or occupation classification which should be properly assigned to such employee. Questions regarding an employee's classification or rate of pay within that classification, shall be resolved by the practice that predominates in the industry and on which the trade or occupation rate/classification is based. Therefore, rate of pay, classification and work jurisdiction disputes shall be resolved by relying upon practices established by collective bargaining agreements and guidelines used in such determinations by appropriate recognized trade unions operating within the City of Madison.

The Contractor shall agree that the normal rate of wage paid to the Contractor's employees on other projects shall not be reduced or otherwise diminished as a result of the requirement to pay no less than the minimum rate of wage scale on a City project. Mulcting of employees on City projects by contractors, such as by kickbacks or other such devices, is prohibited.

These contract provisions shall apply to all work performed on the contract by the Contractor with its own organization and with assistance of laborers under its immediate superintendency and to all work performed by piecework or by subcontract. No laborer, worker, or mechanic shall be employed directly upon the site of the work except on a wage basis, but this shall not be construed to prohibit the rental of equipment from individuals.

In the event of a refusal by the Contractor to submit payroll records as required by the contract, the City of Madison shall have the option to cancel this contract and request the Surety to perform or to relet the balance of the work for bids, and in that event, to charge the Contractor for any loss which the City may incur thereby.

SECTION 102.12: BEST VALUE CONTRACTING

This Contract shall be considered a Best Value Contract if the Contractor's bid is equal to or greater than \$51,500 for a single trade contract; or equal to or greater than \$251,000 for a multi-trade contract pursuant to MGO 33.07(7).

ARTICLE 104 - SCOPE OF WORK

The project limits for the work to be done are on North Orchard Street from Regent Street to Dayton Street and on Spring Street from North Randall Avenue to North Charter Street and on Capitol Court from North Orchard Street approximately 200 feet to the east. The project is approximately 2000 feet in length.

Within the project limits is an inactive railroad spur that was formerly operated by Wisconsin and Southern Railroad (WSOR). WSOR will be removing the crossing materials at the N. Orchard Street, N. Charter Street and N. Mills Street crossings. Work to prepare these former

crossings for repaving and the repaving of these crossings, as shown in the plan, is included within the scope of this project.

The work under this contract shall include but not be limited to installation of sanitary sewer, water main, storm sewer, street lighting, curb and gutter, drive aprons, base preparation, asphalt pavement, topsoil placement and seeding and sidewalk repair.

The Contractor shall view the site prior to bidding to become familiar with the existing conditions. It will be the responsibility of the Contractor to work with the utilities located in the right of way to resolve conflicts during the construction process.

SECTION 104.6 DECREASED AND DELETED ITEMS

The electrical quantities include estimates for work that may or may not be required. If actual quantities are less than estimated, or if items are deleted from the contractor's work, the decreased quantities or deleted items shall not constitute the basis for a claim for damages for anticipated profits for the work dispensed with.

SECTION 105.1: AUTHORITY OF THE ENGINEER

The Engineer shall resolve all questions which arise as to the quality and acceptability of materials furnished, work performed, manner of performance, rate of progress of the work, interpretation of the plans and Specifications, acceptable fulfillment of the contract, compensation, and disputes and mutual rights between Contractors under the Specifications. The Engineer shall determine the amount and quantity of work performed and materials furnished.

All decisions of the Engineer shall, when so requested, be rendered in writing. They shall be final and conclusive in all matters unless within ten (10) days after such decision the Contractor applies in writing to the Board of Public Works for a review of such decision.

Any change proposed by a Contractor in SBE subcontractors, vendors or suppliers from those SBEs indicated on the SBE Compliance Report must be approved by the Engineer and the City's Manager of the Affirmative Action Division (hereafter, AAD). When requested, such decision shall be rendered in writing. Such decisions shall be final and conclusive in all matters unless within ten (10) days after such decision the Contractor or the affected SBE applies in writing to the Board of Public Works for a review of such decision.

In the event the Engineer and the AAD disagree over the proper decision to be made regarding an SBE, the Mayor shall appoint a third person to resolve the disagreement, within 30 days of appointment. The decision thus rendered may be reviewed by the Board of Public Works upon request of the Contractor or the affected SBE as set forth in Sections 105.1 and 105.2 of the City's standard specifications.

SECTION 105.12 COOPERATION BY THE CONTRACTOR

The City of Madison has been given to understand that work will be undertaken by others in approximately the same time frame and the same area as the proposed project. It shall be the Contractor's responsibility to verify this information and any subsequent changes in the

scheduling of the work by others and to make corrections in his/her construction timetable as required.

The Wisconsin and Southern Railroad (WSOR) will be removing railroad crossing materials at N. Orchard Street, N. Charter Street and N. Mills Street. Work required to prepare the crossings for repaving and the repaving of these crossings is included in this contract and shall be paid under each respective Bid Item. The Contractor shall coordinate the timing of the removals and repaving of these three railroad crossings with Roger Schaalma, of WSOR at (414) 750-3702.

The Contractor shall note that properties within the project area include businesses and large, multi-unit residences which are all considered commercial properties. Access to all properties must be maintained per Article 107 of the Standard Specifications for commercial properties. Coordinate work affecting the UW Atmospheric, Oceanic and Space Sciences building (1225 W. Dayton Street) with the facility manager, JoAnn Banks at (608) 263-6764. Coordinate work affecting the UW Primate Center (1223 Capital Court) and the UW Primate Annex (1220 Capital Court) with the Building Manager, Bruce Pape at (608) 263-3521.

The Contractor shall use care around existing trees, plantings, fences, walls, steps and driveways that are indicated on the plans to remain. Damage to these items during construction shall be repaired or replaced at the Contractor's expense. No trees shall be cut without the approval of the Engineer and the City Forester; the abutting property owners shall be notified in accordance with the City's Administrative Procedure Memorandum No. 6-2.

SECTION 105.13 ORDER OF COMPLETION

It is anticipated that the Contractor will need to install proposed water utility main and service on N. Orchard St. between Spring St. and Dayton St. before installing the sanitary main along this same stretch. This would require the Contractor install the sanitary main under crossing water service laterals. No additional compensation will be paid for the work required to install under the water service laterals.

SECTION 107.7 MAINTENANCE OF TRAFFIC

The Contractor shall submit an acceptable Traffic Control Plan to the office of the City Traffic Engineer, attention: Bob Arseneau, at 215 Martin Luther King, Jr. Blvd, Suite 100, Madison, WI 53703 or may be sent by e-mail, in "PDF" format (or other agreed upon format), to the Traffic Engineering contact, Bob Arseneau (contact information is listed at the end of this section), prior to the pre-construction meeting. The Traffic Control Plan shall address all requirements of this section of the Special Provisions. The successful bidder shall contact the Traffic Engineering contact, within two (2) working days of the acceptance of their bid, by the Common Council, to provide the name and contact information of the Contractor or Contractor's representative who will have the authority and responsibility for providing traffic control plans to the Traffic Engineering Division and for installing, maintaining, modifying and removing traffic control. The Contractor or Contractor's representative is encouraged to seek advice and direction, from the Traffic Engineering Division, concerning the development and preparation of their traffic control plan. The Contractor shall not start work on this project until the Traffic Engineering Division has approved their traffic control plan and traffic control devices have been installed, in accordance with the approved plan. Failure of the Contractor to obtain approval of a Traffic

Control Plan, as specified above, may prevent the Contractor from starting work and shall be considered a delay of the project, caused by the Contractor.

The Contractor shall be responsible for installing, maintaining and removing traffic control, including pavement markings, in accordance with the approved Traffic Control Plan and as directed by the City Traffic Engineer. The traffic control plan may need to be altered as conditions change in the field or as unexpected conditions occur. This may include relocating existing traffic control or providing additional traffic control. The Contractor shall install and maintain any necessary modifications or additions to the traffic control, as directed by the City Traffic Engineer, at no cost to the City.

All signing and barricading shall conform to the Federal Highways Administrations "Manual on Uniform Traffic Control Devices" (MUTCD).

North Orchard Street, Spring Street and Capitol Court may be closed to through traffic at the project limits, for the duration of the project. Local and emergency vehicle access shall be maintained at all times.

Regent Street shall remain open to two-way traffic at all times with at least one lane of traffic in each direction at all times. No work shall be completed and no lanes restricted on Regent Street during peak traffic hours. Peak hours are defined as 7:00am to 8:30am and 4:00pm to 5:30pm. The westbound curb/parking lane of Regent Street may be closed during off-peak traffic hours for a maximum of one (1) day for sanitary sewer construction and one (1) day for water main construction. A portion of the westbound lanes of Regent Street, which is not closer than twenty-four (24) feet from the south face of curb or south face of curb extended, of Regent Street, and not further than one hundred (100) feet from the center line of N. Orchard Street (200 feet maximum total length), may be closed during off-peak hours for a maximum of one (1) day (final milling and paving may be completed during this closure). The Contractor shall notify the office of the City Traffic Engineer, a minimum of three (3) working days prior to any lane closures on Regent Street.

North Charter Street may be closed for a maximum of one (1) day to accommodate the removal of the railroad crossing materials and repaving of the crossing area. The Contractor shall provide traffic control as necessary to close North Charter Street to accommodate this work. North Charter Street shall not be closed while North Mills Street is closed. The Contractor shall notify the office of the City Traffic Engineer, a minimum of three (3) working days, prior to any lane closures on North Charter Street.

North Mills Street may be closed for a maximum of four (4) hours, during off-peak traffic hours, to accommodate the removal of the railroad crossing materials and repaving of the crossing area. The Contractor shall provide traffic control as necessary to close North Mills Street to accommodate this work. North Mills Street shall not be closed while the Southwest Bike Path is closed. North Mills Street shall not be closed while North Charter Street is closed. The Contractor shall notify the office of the City Traffic Engineer, a minimum of three (3) working days prior to any lane closures on North Mills Street. The Contractor shall notify Tim Sobota of Madison Metro Transit at 261-4289 five days prior to closing North Mills Street.

The Southwest Bike Path crossing of North Orchard Street shall be maintained for as much of the duration of construction as possible on existing pavement or on temporary paved patches. The bike path may be closed for a maximum of 4 days total during the project. The bike path may be closed twice. Once closure shall be for a maximum of three (3) consecutive days (for installation of utilities) and the other closure shall be for not more than one (1) day (for the final paving operation). The path shall be reopened, immediately at the end of the first closure time, and maintained as a paved crossing until the second closure time begins.

It is anticipated that the bike path crossing will be maintained on existing pavement or pavement patches and left in place until other areas of the project are prepared for placement of curb and gutter and base course material. The work required for the reconstruction of the street at the bike path crossing location (including excavation, concrete removals, base preparation, placement of base course, placement of curb and gutter and concrete aprons) shall be phased such that the crossing may continue to be used by bikes. During this phase of construction, the bike path crossing of N. Orchard Street may be maintained on a gravel surface with appropriate signage and advance warning of construction and work zones, including signage instructing bikers to dismount and walk bikes across N. Orchard Street. During this phase of construction, the location of the crossing may be shifted to the north or south so as to allow the work to continue and allow bike path users to continue to cross N. Orchard Street. During this phase of construction, the bike path crossing of N. Orchard Street may be maintained as a compacted, gravel crossing for a maximum of 10 calendar days to complete the required surface work at the crossing location.

At any time the bike path crossing of N. Orchard Street is open, the Contractor shall maintain a well defined and safe route for bicyclists to cross N. Orchard Street, which is at least ten (10) feet wide, has a smooth surface, no cross slopes in excess of 2% and no longitudinal grades in excess of 5%. Any grades exceeding these, must be approved in advance, by the City Engineer. Appropriate advance warning of construction and work zone protection shall be provided for users of the bike path at all times.

At any time the bike path crossing of N. Orchard Street is closed, the Contractor shall maintain a signed detour route for bikes utilizing North Randall Avenue, West Dayton Street and North Mills Street. Pavement markings, including but not limited to sharrows, lane lines and bike boxes may be required for this detour. An acceptable detour plan showing this detour route shall be included with the traffic control plan required by these special provisions. A minimum of five (5) working days prior to closing the bike path, the Contractor shall provide advance notification signage on the bike path notifying users of the dates of the upcoming closure. The Contractor shall notify the office of the City Traffic Engineer, a minimum of five (5) working days prior to any closure of the southwest bike path.

The Contractor shall provide ADA/Handicap Accessible pedestrian access at all intersections within the construction area at all times.

Construction equipment and materials are not to be stored within the street right-of-way that is outside the project limits as shown on the approved plan.

The work areas shall be backfilled, plated, or protected by traffic control devices during non-working hours. If steel plates are used, the Contractor shall notify the City of Madison Streets Division, 266-4681, one (1) working day prior to placement of the plates.

Contact Bob Arseneau, Traffic Engineering Division, barseneau@cityofmadison.com or (608) 267-8849, with any questions concerning these traffic control specifications, traffic control requirements or traffic control plans.

SECTION 107.8 NOTIFICATION WHEN CLOSING STREET

The Contractor shall not remove traffic signs. For removal or replacement of traffic and parking signs, contact the City of Madison Traffic Engineering Field Operations, 1120 Sayle Street, 266-4767, 8:00 a.m. to 4:00 p.m., a minimum of twenty-four (24) hours in advance of when any existing signs need to be removed. This service is provided free of charge. If the Contractor removes the signs, the Contractor will be billed for the reinstallation of, and any damage to, the signing equipment.

SECTION 107.10 OPENING OF SECTION OF HIGHWAY TO TRAFFIC

Upon completion of all concrete work, final surface course of pavement, landscaping, topsoil, seed or sod, the City Construction Engineer shall certify that it is complete and shall contact the City of Madison Traffic Operations Section, 266-4767. The Contractor shall leave all barricades and traffic control in place until such time that the permanent pavement marking and signing has been installed by the City. The City shall notify the Contractor when the final pavement marking and signing is complete and the Contractor shall remove all temporary construction signs and barricades within 24 hours of the notification.

SECTION 108.2 PERMITS

The City of Madison has submitted a DNR Water Resources Application for Projects Permits (WRAPP) to obtain coverage under the Construction Site General Permit No. WI-S067831-2 for construction site erosion control as the disturbed area is more than one (1) acre. A City of Madison Erosion Control permit has been obtained and weekly inspections shall be completed by City Staff.

The Contractor shall meet the conditions of the City permit by properly installing and maintaining the erosion control measures as shown on the plans, specified in these Special Provisions, or as directed by the Construction Engineer or his designees. This work will be paid for under the appropriate contract bid items.

The City's obtaining of these permits is not intended to be exhaustive of all permits that may be required to be obtained by the Contractor for construction of this project. It shall be the responsibility of the Contractor to identify and obtain any other permits needed for construction.

It is expected that the Contractor will be required to obtain a dewatering permit. In regards to this dewatering permit, there is known residual petroleum soil and groundwater contamination located on 1230 Regent Street. This petroleum contamination may have entered City right of

way. If the Construction Engineer deems the water to be dewatered as contaminated, it shall be the Contractor's responsibility to discharge the water to the sanitary sewer system.

SECTION 109.2 PROSECUTION OF WORK

The Contractor shall begin work on or before MAY 21, 2012. The total time of completion of the contract shall be EIGHTY TWO (82) calendar days.

Work shall begin only after the start work letter is received. The Contractor shall limit workdays to 7:00 a.m. to 7:00 p.m. unless approved by the Engineer in writing.

ARTICLE 201 EXCAVATION CUT

Work under this section shall be accomplished in accordance with the Standard Specifications and as modified herein.

Soil boring B-4 indicates concrete pavement or a concrete patch is present beneath the asphalt pavement on North Orchard Street near station 13+75. An estimated quantity of concrete pavement removal is included in the proposal as Bid Item 20321 based on the concrete present at this boring location. The actual quantity of concrete pavement removed must be measured and recorded for payment when encountered. The total quantity for excavation cut includes the volume of concrete pavement present beneath the asphalt pavement.

SECTION 203.2 DISPOSING OF MATERIALS

The Contractor shall comply with Section 203.2 of the City of Madison Standard Specifications for Public Works Construction with regard to salvaging castings.

BID ITEM 20401 – CLEARING **BID ITEM 20403 – GRUBBING**

It is anticipated City Forestry will remove trees based on their review of potential sanitary lateral conflicts and present tree condition. There are six trees identified to be removed in the plan. If City Forestry has not removed the trees prior to the start of the project, then it will be the Contractor's responsibility to remove the trees. It is the Contractor's responsibility to grub stumps for any trees removed by City Forestry and as directed by the Construction Engineer. Grubbing of stumps shall be to a depth of 18-inches below existing ground elevation.

SECTION 210 EROSION CONTROL

The standards specifications for Erosion Control are supplemented as follows. The Contractor shall be responsible for final stabilizing (seeding/matting/sodding/...as called for in the contract) the disturbed terrace area within 10 calendar days after the pouring of adjacent curb and gutter, unless alternate phasing is approved by the Construction Engineer. This specification shall be interpreted by the Contractor to require multiple trips to the job site by the landscaping subcontractor and the Contractor shall plan for that to occur.

BID ITEM 21013 – STREET SWEEPING

Work under this bid item shall be in accord with the City of Madison Standard Specifications for Public Works Construction. Street sweeping shall be completed as directed by the Construction Engineer and shall remove all loose material to the satisfaction of the Construction Engineer. The Contractor shall note that the Street Sweeping Item shall include sweeping of the southwest bike path crossing in the vicinity of the N. Orchard Street bike path crossing. It is expected that sweeping may be required on a daily basis depending on the hauling methods utilized by the Contractor.

BID ITEM 21014 – CONSTRUCTION ENTRANCE

Work under this bid item shall be in accord with the City of Madison Standard Specifications for Public Works Construction. Construction Entrances shall be located by the Construction Engineer and the Contractor based on site needs. The Contractor shall be aware that specifications call for a construction entrance to be 50' long, construction of an entrance not meeting this specification will result in no payment for this item not a partial payment.

ARTICLE 401 CRUSHED AGGREGATE BASE COURSE

The clear stone base course and the crushed stone base course shall be placed on the same day as the existing stone base is removed.

The Contractor shall maintain a minimum of six (6") inches of stone base course (existing or new) on all portions of the roadway open to vehicle access. No additional compensation will be given for stone used to maintain the six (6") required for access.

Crushed stone base course shall be used for bringing temporary ramps to grade. This material shall be reused after ramp is removed.

The material commonly known as crusher run or breaker run shall be used in undercut areas as designated by the Engineer.

ARTICLE 501 SEWER AND SEWER STRUCTURES GENERAL

STORM SEWER GENERAL

The designer of this project is Max Conway (261-9127).

Storm sewer work will consist of the replacement and adjustment of various storm sewer and storm sewer structures within the project limits. The project will also include the abandonment and slurry fill of select storm sewer within the project limits.

Reconnection of existing pipes at new structures, or new pipes at new structures, shall be considered to be part of the work required to construct the new structure or to construct the new sewer pipe and shall not be rewarded with additional compensation, except when a private storm sewer is being reconnected to new or existing storm sewer. Reconnection of private storm sewer will be paid under BID ITEM #90030. However, if the structure being removed is larger than

the new structure, thus requiring additional pipe, the new pipe shall be paid under the appropriate bid item and the connection of the old pipe to the new pipe shall be accomplished with a concrete collar.

Where a new structure is to be constructed at an existing pipe, it is expected that the contractor shall saw cut the existing pipe in the required location to accommodate the placement of the new structure. If the contractor for his or her convenience deems it more suitable to remove the existing pipe to a full joint, the additional pipe and concrete collar required to reconnect to the new structure shall be the contractor's responsibility and shall not be compensated.

If there are structures where the pipe walls are to be poured into the structure roof of both the pipe walls and the structure casting are to be poured in the structure roof, the contractor shall not be provided additional compensation for complying with the structure requirements detailed on the storm sewer chart and plans.

Precast structures are only allowed where field poured structures are not specifically called for, and no precast structures are allowed until ULO's are completed and approval of the design engineer has been received.

SANITARY SEWER GENERAL

The designer of this project is Max Conway (261-9127).

This project consists of the installation of 1531' of sanitary sewer main and 1069' of sanitary lateral. Sanitary sewer pipe work shall include installing new PVC SDR 26 and PVC SDR 35 at the sizes and locations that are specified on the plan set and in accordance with the Standard Specifications.

All new sanitary sewer access structures shall include the Neenah R-1550-0054 with the new City of Madison casting detail (see S.D.D. 5.7.16 of the City of Madison Standard Specification for Public Works Construction Latest Edition). All new sewer main connections may be factory cored and shall be included in the structure. All existing lateral and main connections shall be field cored to accommodate existing conditions and shall be compensated under BID ITEM 50791 SANITARY SEWER TAP. All sewer main and/or laterals not slated for replacement that are damaged during the installation of a structure shall be replaced by the Contractor and shall be considered incidental to the project. All benches and flowlines shall have a smooth trowel finish.

It is advised that the Contractor visit the site prior to bidding to determine the type of trench protection that will be necessary for the sanitary sewer main installation.

Per the City of Madison Standard Specifications for sanitary sewer lateral construction on street reconstruction projects, Contractors are encouraged to begin installation of sanitary lateral pipe at the proposed sewer main. If Contractor starts excavation for the lateral at the property line, it shall be at the Contractor's risk. A portion of the sanitary sewer laterals were located and surveyed prior to design. Laterals located are marked on the plan as LATERAL LOCATED (TYP.). When tree conflicts are encountered during the sanitary lateral replacement process, contractors are instructed to follow the new policy set in the Standard Specification for Public Works Construction, Latest Edition. No Utility Line Openings (ULOs) will be granted for the

inability to locate the sanitary lateral at the property line. Any extra sidewalk removal will not be compensated to the Contractor looking for an existing sanitary lateral at the property line. Contractors are encouraged to have a locator device on-site if they intend to start laying lateral pipe at the property line to minimize the amount of extra sidewalk removal. Each Sanitary lateral shall have a maximum of 4 sidewalk squares removed and replaced. No additional compensation shall be awarded beyond this amount for the replacement of a sewer lateral.

The majority of the sanitary sewer laterals were located and surveyed prior to design. Laterals that were not located are shown on the plans per City records. Proposed sanitary lateral locations near trees are subject to change based upon data obtained in the field and property owner involvement. Excavation near trees shall comply with Article 107.13 of the Standard Specifications. If 5 ft of separation from the tree to the excavation cannot be maintained, lateral replacement shall stop at the curb.

Tunneling is expected to be required at the existing utility crossings. Any utility tunneling required shall be considered incidental to the pipe being installed. Where the sewer and laterals are less than 6' deep, the Contractor shall install Styrofoam insulation incidental to the sewer main and lateral bid items.

There are 3 MMSD Manholes with castings being called for being adjusted or replaced, also 2 MMSD manhole called for being tapped. MMSD will provide the castings and rubber adjustment rings. Please notify MMSD 3 days in advanced to arrange for inspection by MMSD. The contact person from MMSD is John Podebradsky cell (608)516-5862, JohnP@madsewer.org . Work shall be completed in conformance of MMSD's specifications.

BID ITEM 50354 – SEWER ELECTRONIC MARKERS

With regard to the City of Madison Standard Specifications for Public Works Construction Latest Edition Article 503.3(c), each sanitary lateral shall have a minimum of two (2) electronic markers with the City providing the Contractor with the required number of electronic markers. For sanitary laterals which only include the installation of a wye, a marker ball shall be installed directly above the wye connection to the main.

SECTION 601 ELECTRICAL, GENERAL REQUIREMENTS

The existing signal and lighting poles, conduits, handholes, and manholes not scheduled for removal or abandonment shall be protected during construction. If the contractor believes that damage to such facilities is unavoidable, the contractor shall not damage or remove any facilities until the City Traffic Engineering electrical inspector has reviewed and approved such actions. Any damage or removal of City electrical conduit, wire, fiber, or structures, without the specific approval by the City Traffic Engineering electrical inspector shall be promptly repaired or replaced by and at the expense of the contractor. The City may elect to do repair work with City crews. The cost for any repair work done by the City will be billed to the contractor.

Any damage or removal of City street lighting facilities shall be repaired or replaced within 24 hours, but any resulting street light outage resulting from such damage or removal shall be confined to as few numbers of street lights as possible. The streetlight circuits shall remain operational each and every night. If any street light outage continues beyond 24 hours, the City

shall have the right to make temporary or permanent repairs, with the full cost of such work, including engineering time, billed to the general contractor.

The City of Madison Traffic Engineering Division will install new light poles and wire.

SECTION 601.10 MATERIALS FURNISHED BY THE CITY OF MADISON

The following electrical materials will be furnished to the Contractor at the Traffic Operations Shop, 1120 Sayle Street. The Contractor shall notify the Traffic Operations Shop (Dennis Rowe at 266-9034) twenty four (24) hours prior to picking up any materials. Complete quantities of an item shall be picked up on one appointment unless Dennis Rowe agrees to a partial quantity disbursement.

3/4" x 24" Anchor Bolts: 112

SECTION 602.4(b) ELECTRICAL CONDUIT

Item 60241, Gopher Raceway, shall include any and all work associated with determining locations of existing utilities, such as underground locates. Item 60241 shall include raceways created by pushing, gophering or boring. The measured quantity will only include distances installed directly underneath curb and gutter, roadway, and sidewalk sections that are not removed or constructed with this project. Minor alterations in conduit location may be made by the City Traffic Engineering Electrical Inspector to avoid gopher installation.

Where curb and gutter is being replaced, the new conduit to be installed parallel to the curb and gutter shall be placed according to the Typical Conduit Installation detail shown on the plan sheet. When existing utilities preclude placing conduit as shown in the detail, the conduit shall be placed under the curb or as close to the curb as possible.

When curb and gutter is not being replaced, the new conduit to be installed parallel to the curb and gutter shall be placed in the roadway, three feet from the edge of gutter, and as approved by the City Traffic Engineering Electrical Inspector.

ARTICLE 607 ELECTRICAL HANDHOLES

The contractor shall furnish Type I handholes conforming to this section and the Standard Detail Drawings. Electrical Handhole, Type I shall be gray colored polymer concrete construction. Box dimensions for Type I shall be 19" wide X 32" long X 24" deep and come with a cover rated to withstand 15,000 lbs over a 10" square with a minimum test load of 22,568 lbs.

SECTION 701 PROVISIONS FOR WATER INSTALLATION AND ABANDONMENT

This project consists of furnishing and installing 8-inch ductile iron water main on North Orchard Street from Regent Street to West Dayton Street. The new main includes connections into the existing mains at the cross streets of Capital Court and Spring Street. Spring Street has existing parallel 4-inch cast iron and 12-inch PVC water mains. The 4-in water main is to be abandoned from Randall Avenue to North Charter Street. The existing 12-in PVC water main will remain in service. All service laterals off the 4-inch main shall be re-connected to the 12-

inch main except those specified to be abandoned. The project also includes abandoning the existing water main within the project limits on Orchard Street including water valves, valve access structures and hydrants.

Once the new systems have passed the pressure and water quality tests, cut off, extend as necessary, and reconnect the existing water service laterals to the new water mains unless the service is to be abandoned. All services that may require relocation due to conflicts with trees or any other issue must be authorized and the new location approved in advance by the Water Utility inspector. Any broken curb stops, buried curb boxes or otherwise dysfunctional service components must be approved for adjustment, removal and/or replacement by the Water Utility inspector in advance of any work being performed.

Water Shut-Off Notification

Notify all affected users of water shut-offs per Standard Specifications. Coordinate planned outages with all large and multi-unit building representatives and ensure all units are properly noticed. Coordinate all shut-offs affecting the UW Atmospheric, Oceanic and Space Sciences building (1225 W. Dayton Street) with contact JoAnn Banks at (608) 263-6764. Coordinate all shut-offs affecting the UW Primate Center (1223 Capital Court), UW Primate Annex (1220 Capital Court) and the Harlow Primate Lab (22 North Charter Street) with contact Stuart Statz at (608) 576-5335.

Utility Line Openings

ULO W-1 is to expose the 12-in gas main (steel, 20 psi) at the intersection of Regent and N. Orchard Streets. The critical elevation is the bottom of pipe. ULO W-2 is to expose the steam conduit on Orchard Street near its intersection with W. Dayton Street. The critical elevation is bottom of conduit.

Gate Valve Replacement at 1218 Spring Street

When re-connecting the 2-in service lateral at 1218 Spring Street, abandon the existing gate-style curb stop and box and furnish and install a new standard quarter-turn curb stop and box.

Protection of Existing Water Utility System

Take all necessary precautions to protect the existing Madison Water Utility system and ensure its proper functioning during construction. Note that some of the existing water main dates back to the 1890's. Take care to protect the hydrant at the intersection of Orchard Street and Capital Court from damage during the installation of the 4-inch service lateral at 1223 Capital Court.

View the sites prior to bidding and become familiar with existing conditions and utilities.

SECTION 702 MATERIALS

Furnish all materials, labor and equipment necessary to complete this project except the tapping sleeves, tapping valves and tapping valve boxes. Water Utility will furnish the tapping sleeves, tapping valves, tapping valve boxes, and the crew to perform the taps.

Note the requirement for 4-in x 3-in heavy-bodied DI reducers.

Be responsible for supplying and installing all necessary PVC to ductile iron fittings.

Note the depth of the proposed main and account for required extensions.

SECTION 703 CONSTRUCTION METHODS

Perform all work in accordance with these provisions and the City of Madison Standard Specifications adopted March 1, 2011. Keep all valves accessible and functioning throughout the duration of the work or directed otherwise by the Water Utility representative.

Regarding the cut-in connection to the water main on Capital Court: Tie into the existing water main on Capital Court beyond the 8-in x 6-in reducer but before the 45-degree bend turned down. If the connection is made while the existing 6-in water main on Orchard is still live, then cap the 6-in Orchard main on both sides of the connection. Be aware of the dead-ended mains.

All water main and ductile iron service pipe that cannot be disinfected per Standard Specification section 704.14(c) shall be hand disinfected by a method acceptable to the Water Utility inspector.

Replace all cast-iron services with ductile iron pipe at least to within 8 feet of the property line. Known cast iron services include 1223 Capital Court, 1301, 1308 & 1315 Spring Street and 45 N. Orchard Street. Note that the 6-inch service at 27 N. Randall Avenue (facing Orchard St) is already ductile iron.

WATER UTILITY GENERAL NOTES FOR SPECIFIC WORK:

- WN1 Replace the existing lead service with a new copper service.
- WN2 Extend and reconnect the existing copper service to the new water main.
- WN3 Existing service to be abandoned when water main is cut-off.
- WN4 Disconnect service from the old water main and reconnect the existing copper water service lateral to the new water main.
- WN5 Relocate the existing fire hydrant.
- WN6 Abandon water valve access structure.
- WN7 Furnish and install the new top section for the water access structure.
- WN8 Abandon the valve box.
- WN9 Furnish the ditch, compaction and all materials and labor for the installation of new service lateral.
- WN10 Remove and salvage existing hydrant.

- WN11 Replace the existing copper service with a new copper service.
- WN20+ See Overall Water Plan Sheets for connection point isolation and water shut-off notification information.

BID ITEM 90001 TYPE "A" MODIFIED CONCRETE CURB AND GUTTER

DESCRIPTION

Work under this item shall include all work, materials, labor and incidentals necessary to install TYPE "A" CURB AND GUTTER with reinforcement.

MATERIALS

See sheet D-1 in the plan set for details on materials of this bid item.

CONSTRUCTION

See Sheet D-1 in the plan set for details on construction of this bid item.

METHOD OF MEASUREMENT

TYPE "A" MODIFIED CONCRETE CURB AND GUTTER shall be measured by the installed linear foot.

BASIS OF PAYMENT

TYPE "A" MODIFIED CONCRETE CURB AND GUTTER shall be measured as described above which shall be full compensation for all work, materials and incidentals to complete the work as described above.

BID ITEM 90002 – PAVED SURFACE TEMPORARY

DESCRIPTION

This work shall include all work, materials, labor and incidentals necessary to construct a 2" minimum thick HMA pavement or 4" minimum concrete pavement suitable for use as a temporary pedestrian, bike or motor vehicle access during the construction and meeting ADA accessibility standards. The Contractor shall determine if additional depth needed to ensure an ADA safe surface remains for the duration the patch is needed. Preparation for the temporary pavement is included with this item including excavation or fill as needed. The Contractor shall be responsible for maintaining the temporary pavement and all components with no additional compensation.

Removal and disposal of the Paved Surface Temporary and all related components, upon no longer needing the surface, shall be incidental to this item. Restoration of the areas of the Paved Surface Temporary will be paid for under respective bid items.

METHOD OF MEASUREMENT

Paved Surface Temporary shall be measured by the square yard.

BASIS OF PAYMENT

Paved Surface Temporary shall be measured as described above shall be full payment for all work, materials and incidentals required to complete the work in accordance with the description.

BID ITEM 90003 - Excavation, Hauling and Disposal of Contaminated Soil

Description

This work shall conform with the requirements of Standard specifications, pertinent parts of the Wisconsin Administration Code (Department of Natural Resources Environmental Investigation and Remediation of Environmental Contamination, Chapters NR 700-736) and as supplemented herein.

The Contractor shall note that the property located at 1230 Regent Street is a former gas station business location and is a closed WI DNR Leaking Underground Storage Tank Site. An initial screening of WI DNR records indicates it is unlikely that contaminated soil will be encountered within the right-of-way, however, given the history of the business operations in the area, contaminated soil may be encountered.

This work shall consist of excavating, loading, hauling, and disposal of petroleum-contaminated soil at a City of Madison approved bio-remediation site, herein referred to as "Biopile Facility." The City of Madison is to be listed as the generator of this material for disposal purposes. The Biopile Facility to be used is the Waste Management Madison Prairie Landfill, 3490 Nelson Road, Sun Prairie, WI 53590, phone (608) 837-9031, fax (608) 837-7852 (contact Peggy Slind - 888-964-4700). The Biopile Facility will bill the City of Madison directly for tipping/treatment fees for contaminated soil delivered to the Biopile Facility by the Contractor.

Per NR 718.07, a solid waste collection and transportation service operating license is required under NR 502.06 whenever excavated contaminated soils are transported.

Coordination

The City of Madison will provide an Environmental Consultant (staff member or hired consultant) should contaminated material be discovered. Contact Brynn Bemis, City of Madison Engineering Department at (608) 267-1986 to coordinate the onsite activities and testing.

The role of the Environmental Consultant will be limited to: (1) determining the location and limits of contaminated soil to be excavated based on soil analytical results from previous investigations, visual observations, and field screening of soil that is excavated; (2) identifying contaminated soils to be hauled to the treatment/disposal facility; and (3) documenting that activities associated with management of contaminated soil are in conformance with the contaminated soil management methods for this project as specified herein.

Provide at least 14 calendar days notice of the pre-construction conference date to the Environmental Consultant. At the pre-construction conference, provide a schedule for all excavation activities in the areas of possible contamination to the Environmental Consultant. Notify the engineer and Environmental Consultant at least 14 calendar days prior to commencement of excavation activities in each of the possible contaminated areas.

Coordinate with the Environmental Consultant to ensure that the Environmental Consultant is present during excavation activities in the possible contaminated areas. Excavation work in each of the possible contaminated areas shall proceed on a continuous basis until excavation work is completed.

The Environmental Consultant will be responsible for obtaining the necessary approvals for disposal of contaminated soils from the treatment/disposal facility. Do not transport contaminated soil off-site without prior approval from the Environmental Consultant.

Construction

Excavated soil will be periodically field screened by the Environmental Consultant. Assist the Environmental Consultant in collecting soil samples using excavation equipment. Soil samples will be collected by the Environmental Consultant from the bucket of the excavation equipment. The sampling frequency shall be a maximum of one sample for every 10 cubic yards excavated. Field screening of soil is expected to take up to 10 minutes for each sample. During the time the Environmental Consultant is screening the soil, the contractor may continue to excavate up to an additional 30 cubic yards of soil, provided the soil is loaded into trucks and the trucks remain on site. Following field screening of soil, the Environmental Consultant will identify contaminated soils to be hauled to the Biopile Facility and notify the contractor if the excavation can be backfilled. The ends of the storm sewer, sanitary sewer, and water main trenches shall have bentonite clay dams installed.

Soils designated by the Environmental Consultant as contaminated shall be hauled directly to the Biopile Facility. Use loading and hauling practices that are appropriate to prevent any spills or releases of petroleum contaminated soils and residues. If spills or releases occur, immediately notify the Environmental Consultant and engineer. Immediately recover all petroleum contaminated soil, residue, and any new contamination that was caused by the spill or release.

Prior to start of construction in the Potential Contaminated Soil Areas, the Environmental Consultant will prepare the application to treat or dispose of contaminated soil (Form 4400-120) and submit the form to the Wisconsin Department of Natural Resources for approval. The Environmental Consultant will also obtain approvals from the Biopile Facility for the treatment and disposal of contaminated soil.

Documentation of contaminated soil disposal at the Biopile Facility shall include copies of original Biopile Facility weight tickets, signed by the scale attendant, clearly documenting final and tare weights of the soil received by the Biopile Facility, the date and time of weighing, and the contractor's truck number. Submit copies of all weight tickets to the engineer and the Environmental Consultant following completion of hauling activities. Arrange to have the soil

treatment certificate from the Biopile Facility submitted to the engineer and the Environmental Consultant following completion of soil treatment.

D. Measurement

Excavation, Hauling and Disposal of Petroleum Contaminated Soil will be measured in tons of material disposed of at the Biopile Facility.

E. Payment

The department will pay for measured quantities at the contract unit price under the following bid item:

ITEM NUMBER	DESCRIPTION	UNIT
SPV.0195.01	Excavation, Hauling and Disposal of Petroleum Contaminated Soil	TONS

Payment is full compensation for contaminated soil excavation, segregation, hauling, and disposal; assistance with soil sampling; dewatering soil prior to transport; bentonite clay dams; temporary stockpiling; replacement fill material; weighing of trucks; obtaining weight tickets from scale attendant; providing original copies of weight tickets to the engineer and the Environmental Consultant; arranging to have certificate of soil treatment submitted to the engineer and the Environmental Consultant; and for furnishing all labor, tools, equipment, and incidentals necessary to complete the work.

BID ITEM 90030 – RECONNECT PRIVATE STORM SEWER

DESCRIPTION

Work under this item shall include all work, materials, labor and incidentals necessary to reconnect the existing storm line from its current location at an existing inlet/manhole/sewer line to the new storm structure location. This item shall be used for new structure locations that are up to six (6) feet away from the existing structure location. Where a structure is being moved further than six (6) feet from the existing structure a pipe and collar will be specified as separate bid items.

Specifically, this item includes the following: up to six (6) feet of storm pipe of the needed size up to and including 12” storm pipe, select backfill and a concrete collar or pressure fitting to reconnect to the existing lateral. The Contractor is made aware that in the concrete collar may be used as a field bend and this usage is allowed as part of this bid item.

The Contractor shall complete the following as part of this item:

- 1) Find the end of the existing system. This will be done during removal of the existing structure. However, as part of this item the Contractor shall minimize the removal of existing pipe associated with removal of the existing structure. This shall be done by saw cutting the existing pipe as close to the existing structure as possible.

If the Contractor chooses to remove a full section of pipe, as part of the structure removal, this item shall still be used to make the reconnection

regardless of the pipe length required exceeding six (6) feet. In that case, the Contractor shall provide any amount of pipe necessary to reconnect to the existing storm main.

- 2) Connect to the existing pipe with a concrete collar/bend directing the pipe underground to the new structure location.
- 3) The new pipe shall then be connected to the new storm sewer structure as located on the plan set.

METHOD OF MEASUREMENT

Reconnect Private Storm Sewer shall be measured as complete when each completed unit is installed in the field.

BASIS OF PAYMENT

Reconnect Private Storm Sewer shall be measured as described above which shall be full compensation for all work, materials and incidentals to complete the work as described above.

BID ITEM 90031 – INLET CAPPING

DESCRIPTION

Work under this item shall include the removal of an existing inlet casting and adjusting rings and other materials down to a stable and sound wall structure. Castings shall be salvaged in accord with the Standard Specifications for Public Works Construction. A new 1" thick steel plate shall be provided to act as the new structure roof. This plate will have two (2") inches overhang on either side of the outside walls of the structure and shall be and secured with mastic over the entire circumference of top of the inlet walls. All materials, work, and incidentals required to complete this work are included in this bid item.

METHOD OF MEASUREMENT

Inlet Capping shall be measured by each completed repair/reconstruction.

BASIS OF PAYMENT

Inlet Capping shall be measured as described above and shall be paid for at the contract price which shall be full compensation for all work, materials, labor, and incidentals required to complete the work as set forth in the description.

BID ITEM 90032 – RECONNECT EXISTING TWIN 36” STORM PIPES

DESCRIPTION

Work under this item shall include the reconnection of twin 36” storm pipes to storm structure AS 4652-096. The Contractor may use any method to remove the patched concrete from the storm structure and reconnect the storm pipes that results in a clean finish and no damage to the existing storm structure or pipes. The quality of work shall be subject to approval by the Engineer. Any repair to the existing structure or storm pipes necessary due to damage by the Contractor shall be considered incidental to this item.

METHOD OF MEASUREMENT

Reconnection of existing storm pipes shall be measured as a lump sum for all work and incidentals required to complete the work as described above.

BASIS OF PAYMENT

Reconnection of existing storm pipes shall be measured as described above and shall be paid for at the contract price which shall be full compensation for all work, materials, labor, and incidentals required to complete the work as set forth in the description.

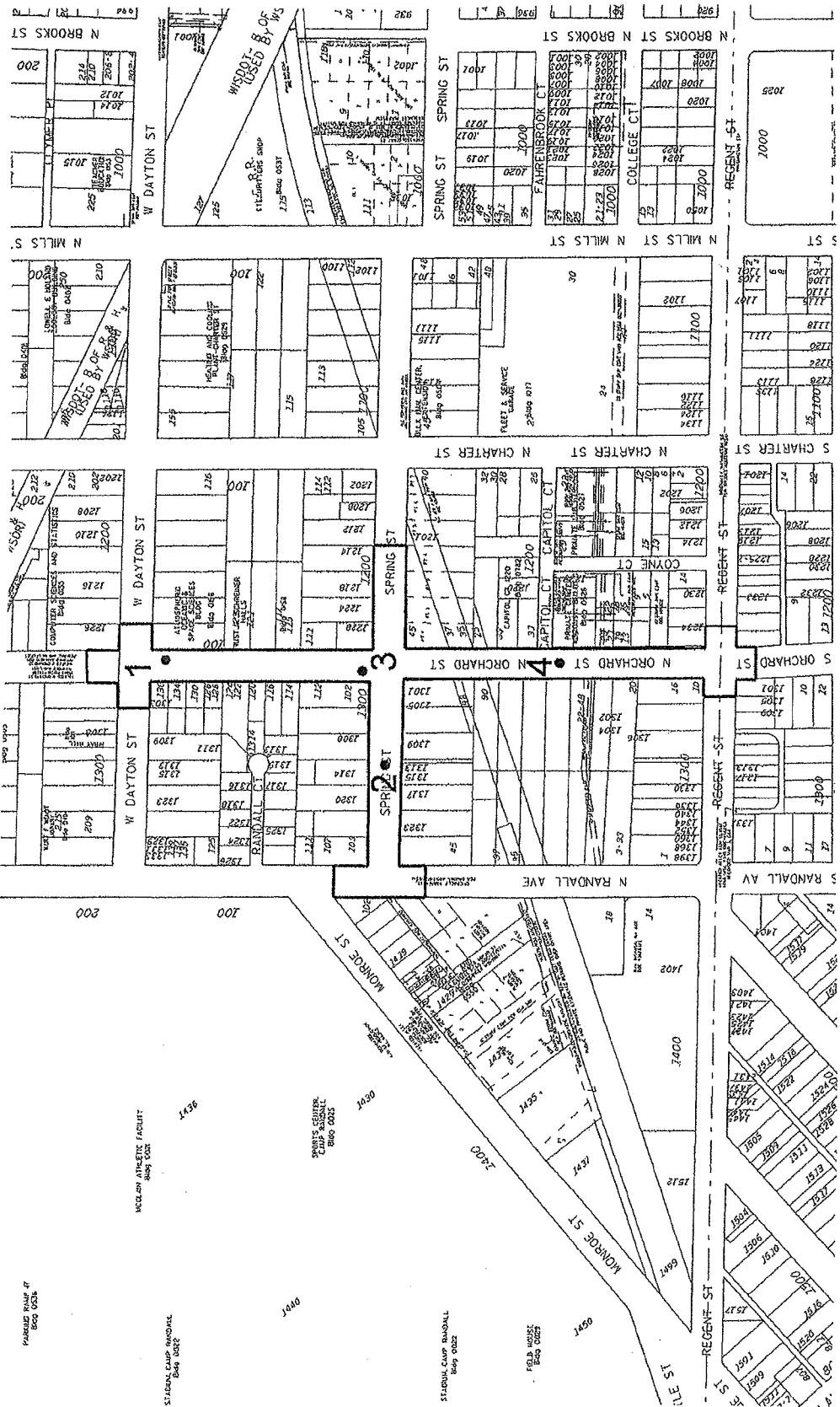

Legend

• Denotes Boring Location (approximate)

Notes

1. Soil borings performed by J&J Soil Testing in December 2010

SOIL BORING LOCATION MAP
 Orchard Street Area
 Madison, Wisconsin

CGC, Inc.

APPD: MNS

Date: 1/10

C10041-49

DWN: -



LOG OF TEST BORING

Project Orchard Street Area
 Location Orchard : 85'S of Dayton, 10'W of CL
Madison, WI

Boring No. 1
 Surface Elevation (ft) 94.8*
 Job No. C10041-49
 Sheet 1 of 1

2921 Perry Street, Madison, WI 53713 (608) 288-4100, FAX (608) 288-7887

SAMPLE					VISUAL CLASSIFICATION and Remarks	SOIL PROPERTIES				
No.	TYPE	Rec (in.)	Moist	N		Depth (ft)	qu (qa) (tsf)	W	LL	PL
					2.5 in. Asphalt Pavement/3 in. Base Course					
1X 1		15	M	14	FILL: Brown CLAY (CL)					
					Very Stiff, Brown Lean CLAY, Little To Fine Sand, Trace Gravel	(3.5)				
2		18	M	6	Loose, Brown Fine to Medium SAND, Little to Some Silt (SP-SM/SM)					
					Medium Dense, Light Brown SILT (ML)					
3		18	M	17						
					Hard, Brown Lean Clay with Silt Partings and Lenses (CL)	(4.5+)				
4		18	M	27						
5		18	M	27		(4.5+)				
					End Boring at 15 ft					
					Borehole backfilled with bentonite chips					
					*Elevation determined using an assumed datum of 100.0 ft referencing the top nut of a hydrant situated at the NE corner of the intersection of Dayton & Orchard.					

WATER LEVEL OBSERVATIONS					GENERAL NOTES				
While Drilling	<u>∇</u>	<u>NW</u>	Upon Completion of Drilling	<u>NW</u>	Start	<u>12/7/10</u>	End	<u>12/7/10</u>	
Time After Drilling					Driller	<u>J&J</u>	Chief	<u>JP</u>	Rig <u>CME-45</u>
Depth to Water					Logger	<u>JP</u>	Editor	<u>ESF</u>	
Depth to Cave in					Drill Method	<u>2 1/4 in. HSA</u>			
The stratification lines represent the approximate boundary between soil types and the transition may be gradual.									



LOG OF TEST BORING

Project Orchard Street Area
 Spring: 165'W of Orchard, 11'S of CL
 Location Madison, WI

Boring No. 2
 Surface Elevation (ft) 98.3*
 Job No. C10041-49
 Sheet 1 of 1

2921 Perry Street, Madison, WI 53713 (608) 288-4100, FAX (608) 288-7887

SAMPLE					VISUAL CLASSIFICATION and Remarks	SOIL PROPERTIES				
No.	TYPE RECORDED	Rec (in.)	Moist	N		Depth (ft)	qu (qa) (tsf)	W	LL	PL
					5.5	5.5 in. Asphalt Pavement/7 in. Base Course				
1		18	M	20	7	Loose to Medium Dense, Light Brown Fine SAND, Trace to Little Silt and Gravel (SP/SP-SM) Some Thin (1 in.) Seams of Stratified Silt and Lean Clay Beginning at 7 ft				
2		18	M	8	8					
3		18	M	15	15					
4		18	M	14	14					
5X 5		18	M/W	17	17					
					15	Medium Dense, Light Brown Sandy SILT (ML)				
					15	End Boring at 15 ft Borehole backfilled with bentonite chip				
					20	*Elevation determined using an assumed datum of 100.0 ft referencing the top nut of a hydrant situated at the NE corner of the intersection of Orchard & Spring				

WATER LEVEL OBSERVATIONS	GENERAL NOTES
While Drilling ∇ <u>14'</u> Upon Completion of Drilling <u>14'</u> Time After Drilling _____ Depth to Water _____ Depth to Cave in _____	Start <u>12/7/10</u> End <u>12/7/10</u> Driller <u>J&J</u> Chief <u>JP</u> Rig <u>CME-45</u> Logger <u>JP</u> Editor <u>ESF</u> Drill Method <u>2 1/4 in. HSA</u>
The stratification lines represent the approximate boundary between soil types and the transition may be gradual.	



LOG OF TEST BORING

Project Orchard Street Area
Orchard: 90'N of Spring, 10'E of CL
 Location Madison, WI

Boring No. 3
 Surface Elevation (ft) 97.8
 Job No. C10041-49
 Sheet 1 of 1

2921 Perry Street, Madison, WI 53713 (608) 288-4100, FAX (608) 288-7887

SAMPLE					VISUAL CLASSIFICATION and Remarks	SOIL PROPERTIES				
No.	Rec (in.)	Moist	N	Depth (ft)		qu (qa) (tsf)	W	LL	PL	LI
1	3	M	11	11	3 in. Asphalt Pavement FILL: Brown Silty Sand and Gravel					
2	8	M	11	11						
5					End Boring at 6 ft due to crooked drill stem along side of unmarked 48 in. storm sewer; moved 6.5'W and performed B3A Borehole backfilled with bentonite chips and asphalt patch *Elevation determined using an assumed datum of 100.0 ft referencing the top nut of a hydrant situated at the NE corner of the intersection of Orchard & Spring					
10										
15										
20										

WATER LEVEL OBSERVATIONS					GENERAL NOTES						
While Drilling	<input checked="" type="checkbox"/>	NW	Upon Completion of Drilling	<input type="checkbox"/>	NW	Start	12/7/10	End	12/7/10		
Time After Drilling						Driller	J&J	Chief	JP	Rig	CME-45
Depth to Water					<input checked="" type="checkbox"/>	Logger	JP	Editor	ESF		
Depth to Cave in						Drill Method	2 1/4 in. HSA				
The stratification lines represent the approximate boundary between soil types and the transition may be gradual.											



LOG OF TEST BORING

Project Orchard Street Area
Orchard: 90'N of Spring, 3.5'E of CL
 Location Madison, WI

Boring No. 3A
 Surface Elevation (ft) 98.0
 Job No. C10041-49
 Sheet 1 of 1

2921 Perry Street, Madison, WI 53713 (608) 288-4100, FAX (608) 288-7887

SAMPLE					VISUAL CLASSIFICATION and Remarks	SOIL PROPERTIES				
No.	Rec (in.)	Moist	N	Depth (ft)		qu (qa) (tsf)	W	LL	PL	LI
					X	2 in. Asphalt Pavement/2.5 in. Base Course/8 in. Clayey Fill				
1	14	M	10		/	Very Stiff, Brown Lean CLAY, Trace Sand (CL)				
					-	Loose Brown Fine SAND, Some Clay (SC)				
2	18	M	8		/	Very Stiff, Brown Lean CLAY, Trace to Little Sand (CL)				
					-	Medium Dense, Brown Fine SAND, Trace to Little Silt (SP/SP-SM)				
3	18	M	16			Occasional Silt Lenses Near 9 ft				
4	18	M	10							
5	18	M	16			End Boring at 15 ft Borehole backfilled with bentonite chips and asphalt patch *Elevation determined using an assumed datum of 100.0 ft referencing the top nut of a hydrant situated at the NE corner of the intersection of Orchard & Spring				

WATER LEVEL OBSERVATIONS					GENERAL NOTES		
While Drilling	<input checked="" type="checkbox"/> NW	Upon Completion of Drilling	<input type="checkbox"/> NW	Start	12/7/10	End	12/7/10
Time After Drilling	_____			Driller	J&J	Chief	JP
Depth to Water	_____			Logger	JP	Editor	ESF
Depth to Cave in	_____			Drill Method	2 1/4 in. HSA		
The stratification lines represent the approximate boundary between soil types and the transition may be gradual.							



LOG OF TEST BORING

Project Orchard Street Area
 Location Orchard: 50'S of Capitol, 9'W of CL
Madison, WI

Boring No. 4
 Surface Elevation (ft) 92.2*
 Job No. C10041-49
 Sheet 1 of 1

2921 Perry Street, Madison, WI 53713 (608) 288-4100, FAX (608) 288-7887

SAMPLE					VISUAL CLASSIFICATION and Remarks	SOIL PROPERTIES				
No.	RECYCLED (in.)	Rec (in.)	Moist	N		Depth (ft)	qu (qa) (tsf)	W	LL	PL
					3.75 in. Asphalt Pavement/6.5 in. Concrete/3 in. Clayey Fill					
1		14	M	5	FILL: Brown Sand with Some Glass, Brick and Gravel		36.5			9.8
AS					Loose, Black Organic SILT (OL) (Buried Topsoil), Brown Lean CLAY (CL)					
2		18	M	12	Medium Dense, Brown Sandy SILT to Silty Fine SAND (ML/SM)					
3		18	M	19	Medium Dense, Brown Fine SAND, Trace to Little Silt, (SP/SP-SM)					
4		18	W	16	Loose, Brown Sandy SILT (ML)					
5		18	W	8	End Boring at 15 ft					
					Borehole backfilled with bentonite chips					
					*Elevation determined using an assumed datum of 100.0 ft referencing the top nut of a hydrant situated at the NE corner of the intersection of Dayton & Orchard					

WATER LEVEL OBSERVATIONS

GENERAL NOTES

While Drilling ∇ 8.5 Upon Completion of Drilling 10'
 Time After Drilling _____
 Depth to Water _____
 Depth to Cave in _____

Start 12/7/10 End 12/7/10
 Driller J&J Chief JP Rig CME-45
 Logger JP Editor ESF
 Drill Method 2 1/4 in. HSA

The stratification lines represent the approximate boundary between soil types and the transition may be gradual.

SECTION E: PROPOSAL

NORTH ORCHARD STREET AND SPRING STREET RECONSTRUCTION
ASSESSMENT DISTRICT - 2012
CONTRACT NO. 6793

Bidder must state a Unit Price and Total Bid for each item. The Total Bid for each item must be the product of quantity, by Unit Price. The Grand Total must be the sum of the Total Bids for the various items. In case of multiplication errors or addition errors, the Grand Total with corrected multiplication and/or addition shall determine the Grand Total bid for each contract. The Unit Price and Total Bid must be entered numerically in the spaces provided. All words and numbers shall be written in ink.

1. The undersigned having familiarized himself/herself with the Contract documents, including Advertisement for Bids, Instructions to Bidders, Form of Proposal, City of Madison Standard Specifications for Public Works Construction - 2011 Edition thereto, Form of Agreement, Form of Bond, and Addenda issued and attached to the plans and specifications on file in the office of the City Engineer, hereby proposes to provide and furnish all the labor, materials, tools, and expendable equipment necessary to perform and complete in a workmanlike manner the specified construction on this project for the City of Madison; all in accordance with the plans and specifications as prepared by the City Engineer, including Addenda to the Contract Nos. _____ through _____ issued thereto, at the prices for said work as contained in this proposal.
2. If awarded the Contract, we will initiate action within seven (7) days after notification or in accordance with the date specified in the contract to begin work and will proceed with diligence to bring the project to full completion within the number of work days allowed in the Contract or by the calendar date stated in the Contract.
3. The undersigned Bidder or Contractor certifies that he/she is not a party to any contract, combination in form of trust or otherwise, or conspiracy in restraint of trade or commerce or any other violation of the anti-trust laws of the State of Wisconsin or of the United States, with respect to this bid or contract or otherwise.
4. Accompanying this Proposal is Bid Bond or Certified Check in the amount of _____ Dollars (\$ _____) or a Certificate of Biennial Bid Bond as required by the Advertisement for Bids.
(IF BID BOND IS USED, IT SHALL BE SUBMITTED ON THE FORMS PROVIDED BY THE CITY. FAILURE TO DO SO MAY RESULT IN REJECTION OF THE BID).
5. I hereby certify that all statements herein are made on behalf of _____
(name of corporation, partnership, or person submitting bid)
a corporation organized and existing under the laws of the State of _____ a
partnership consisting of _____; an individual trading as _____; of
the City of _____; State of _____; that I have examined and carefully prepared this
Proposal, from the plans and specifications and have checked the same in detail before submitting
this Proposal; that I have fully authority to make such statements and submit this Proposal in (its,
their) behalf; and that the said statements are true and correct.

SIGNATURE

TITLE, IF ANY

Sworn and subscribed to before me this
_____ day of _____, 20_____

(Notary Public or other officer authorized to administer oaths)

My Commission Expires _____

Bidders shall not add any conditions or qualifying statements to this Proposal.

**NORTH ORCHARD STREET AND SPRING STREET RECONSTRUCTION ASSESSMENT
DISTRICT - 2012
CONTRACT NO. 6793**

State of Wisconsin
Department of Workforce Development
Equal Rights Division
Labor Standards Bureau

Disclosure of Ownership

Notice required under Section 15.04(1)(m), Wisconsin Statutes. The statutory authority for the use of this form is prescribed in Sections 66.0903(12)(d) and 103.49(7)(d), Wisconsin Statutes. The use of this form is mandatory. The penalty for failing to complete this form is prescribed in Section 103.005(12), Wisconsin Statutes. Personal information you provide may be used for secondary purposes.

- (1) On the date a contractor submits a bid to or completes negotiations with a state agency or local governmental unit, on a project subject to Section 66.0903 or 103.49, Wisconsin Statutes, the contractor shall disclose to such state agency or local governmental unit the name of any "other construction business", which the contractor, or a shareholder, officer or partner of the contractor, owns or has owned within the preceding three (3) years.
- (2) The term "other construction business" means any business engaged in the erection, construction, remodeling, repairing, demolition, altering or painting and decorating of buildings, structures or facilities. It also means any business engaged in supplying mineral aggregate, or hauling excavated material or spoil as provided by Sections 66.0903(3), 103.49(2) and 103.50(2), Wisconsin Statutes.
- (3) This form must **ONLY** be filed, with the state agency or local governmental unit that will be awarding the contract, if **both (A) and (B) are met.**
 - (A) The contractor, or a shareholder, officer or partner of the contractor:
 - (1) Owns at least a 25% interest in the "other construction business", indicated below, on the date the contractor submits a bid or completes negotiations.
 - (2) Or has owned at least a 25% interest in the "other construction business" at any time within the preceding three (3) years.
 - (B) The Wisconsin Department of Workforce Development (DWD) has determined that the "other construction business" has failed to pay the prevailing wage rate or time and one-half the required hourly basic rate of pay, for hours worked in excess of the prevailing hours of labor, to any employee at any time within the preceding three (3) years.

Other Construction Business

Name of Business			
Street Address or P O Box	City	State	Zip Code
Name of Business			
Street Address or P O Box	City	State	Zip Code
Name of Business			
Street Address or P O Box	City	State	Zip Code
I hereby state under penalty of perjury that the information, contained in this document, is true and accurate according to my knowledge and belief.			
Print the Name of Authorized Officer			
Signature of Authorized Officer		Date Signed	
Name of Corporation, Partnership or Sole Proprietorship			
Street Address or P O Box	City	State	Zip Code

If you have any questions call (608) 266-0028

**NORTH ORCHARD STREET AND SPRING STREET RECONSTRUCTION
ASSESSMENT DISTRICT - 2012
CONTRACT NO. 6793**

Best Value Contracting

1. The Contractor shall indicate the non-apprenticeable trades used on this contract.

2. Some Contractors are exempt due to the size of the work force. Apprenticeable trades are those trades considered apprenticeable by the State of Wisconsin.

Check Here if the Contractor has a total skilled work force of four or less individuals in all apprenticeable trades combined. This contractor is exempt from Best Value Contracting.

3. The Contractor shall indicate on page E-4 which apprenticeable trades are to be used on this Contract and shall indicate by checking the appropriate box for the trades used, how the contractor will comply with Madison General Ordinance 33.07(7).

Legend

Number of Journeyworkers	The Contractor shall indicated for trades to be used on this Contract only, the number of journeyworkers that the Contractor has employed company wide.
W-ATT	The Contractor is an active trade trainer in the State of Wisconsin for the trade indicated.
US-ATT	The Contractor is an active trade trainer in an apprenticeship program approved by the U.S. Department of Labor or another state apprenticeship agency in the trade indicated.
SB-ATT	The Contractor shall become an active trade trainer prior to beginning work on the Contract in the trade indicated.

The Contractor has reviewed the list on page E-4 and shall not use any apprenticeable trades on this project.

The Contractor has reviewed this list on E-4 and has checked the appropriate box by each apprenticeable trade to be used on the project.

**NORTH ORCHARD STREET AND SPRING STREET RECONSTRUCTION
ASSESSMENT DISTRICT - 2012
CONTRACT NO. 6793**

Apprenticeable Trades

Check the box in the column "Trade Used on This Project" for each apprenticeable trades used on this project. For those trades used on the project indicated the number of journeyworkers that are employed company wide and check a box to the right of the trade as to how the Contractor will comply MGO 33.07(7). Refer to the legend on page E-3 for the meaning associated with each heading. The Contractor must check one of the boxes on the right for each apprenticeable trade used and checked on the left.

Trade Used on Contract	Apprenticeable Trades	Number of Journeyworkers	W-ATT	US-ATT	SB-ATT
<input type="checkbox"/>	Bricklayer		<input type="checkbox"/>	<input type="checkbox"/>	<input type="checkbox"/>
<input type="checkbox"/>	Carpenter		<input type="checkbox"/>	<input type="checkbox"/>	<input type="checkbox"/>
<input type="checkbox"/>	Cement Mason / Concrete Finisher		<input type="checkbox"/>	<input type="checkbox"/>	<input type="checkbox"/>
<input type="checkbox"/>	Cement Mason (Heavy Highway)		<input type="checkbox"/>	<input type="checkbox"/>	<input type="checkbox"/>
<input type="checkbox"/>	Construction Craft Laborer		<input type="checkbox"/>	<input type="checkbox"/>	<input type="checkbox"/>
<input type="checkbox"/>	Data Communication Installer		<input type="checkbox"/>	<input type="checkbox"/>	<input type="checkbox"/>
<input type="checkbox"/>	Electrician		<input type="checkbox"/>	<input type="checkbox"/>	<input type="checkbox"/>
<input type="checkbox"/>	Environmental Systems Technician / HVAC Service Tech/HVAC Install / Service		<input type="checkbox"/>	<input type="checkbox"/>	<input type="checkbox"/>
<input type="checkbox"/>	Glazier		<input type="checkbox"/>	<input type="checkbox"/>	<input type="checkbox"/>
<input type="checkbox"/>	Heavy Equipment Operator / Operating Engineer		<input type="checkbox"/>	<input type="checkbox"/>	<input type="checkbox"/>
<input type="checkbox"/>	Insulation Worker (Heat & Frost)		<input type="checkbox"/>	<input type="checkbox"/>	<input type="checkbox"/>
<input type="checkbox"/>	Iron Worker		<input type="checkbox"/>	<input type="checkbox"/>	<input type="checkbox"/>
<input type="checkbox"/>	Iron Worker (Assembler, Metal Bldgs)		<input type="checkbox"/>	<input type="checkbox"/>	<input type="checkbox"/>
<input type="checkbox"/>	Painter & Decorator		<input type="checkbox"/>	<input type="checkbox"/>	<input type="checkbox"/>
<input type="checkbox"/>	Plasterer		<input type="checkbox"/>	<input type="checkbox"/>	<input type="checkbox"/>
<input type="checkbox"/>	Plumber		<input type="checkbox"/>	<input type="checkbox"/>	<input type="checkbox"/>
<input type="checkbox"/>	Residential Electrician		<input type="checkbox"/>	<input type="checkbox"/>	<input type="checkbox"/>
<input type="checkbox"/>	Rofer & Waterproofer		<input type="checkbox"/>	<input type="checkbox"/>	<input type="checkbox"/>
<input type="checkbox"/>	Sheet Metal Worker		<input type="checkbox"/>	<input type="checkbox"/>	<input type="checkbox"/>
<input type="checkbox"/>	Sprinklerfitter		<input type="checkbox"/>	<input type="checkbox"/>	<input type="checkbox"/>
<input type="checkbox"/>	Steamfitter		<input type="checkbox"/>	<input type="checkbox"/>	<input type="checkbox"/>
<input type="checkbox"/>	Steamfitter (Refrigeration)		<input type="checkbox"/>	<input type="checkbox"/>	<input type="checkbox"/>
<input type="checkbox"/>	Steamfitter (Service)		<input type="checkbox"/>	<input type="checkbox"/>	<input type="checkbox"/>
<input type="checkbox"/>	Taper & Finisher		<input type="checkbox"/>	<input type="checkbox"/>	<input type="checkbox"/>
<input type="checkbox"/>	Telecommunications (Voice, Data & Video) Installer-Technician		<input type="checkbox"/>	<input type="checkbox"/>	<input type="checkbox"/>
<input type="checkbox"/>	Tile Setter		<input type="checkbox"/>	<input type="checkbox"/>	<input type="checkbox"/>

NAME OF BIDDER

PROPOSAL

NORTH ORCHARD STREET AND SPRING STREET RECONSTRUCTION ASSESSMENT
DISTRICT - 2012

CONTRACT NO. 6793

ITEM	TYPE OF WORK	ESTIMATED QUANTITIES	UNIT PRICE BID	TOTAL BID
------	--------------	----------------------	----------------	-----------

STREET ACCOUNT NO. CS53-58250-810355-00-53W0608

10701	TRAFFIC CONTROL	1.00	LS		\$
10911	MOBILIZATION	1.00	LS		\$
10801	ROOT CUTTING - CURB & GUTTER	150.00	LF		\$
10802	ROOT CUTTING - SIDEWALK	150.00	LF		\$
20101	EXCAVATION CUT	3,833.00	CY		\$
20130	UNDERDRAIN	750.00	LF		\$
20140	GEOTEXTILE FABRIC TYPE SAS (NON-WOVEN)	1,000.00	SY		\$
20219	BREAKER RUN	1,450.00	TON		\$
20221	TOPSOIL	4,100.00	SY		\$
20301	SAWCUT CONCRETE PAVEMENT, FULL DEPTH	260.00	LF		\$
20303	SAWCUT BITUMINOUS PAVEMENT, FULL DEPTH	450.00	LF		\$
20321	REMOVE CONCRETE PAVEMENT	850.00	SY		\$
20322	REMOVE CONCRETE CURB & GUTTER	3,785.00	LF		\$
20323	REMOVE CONCRETE SIDEWALK & DRIVE	15,650.00	SF		\$
20401	CLEARING	115.00	I.D.		\$
20403	GRUBBING	115.00	I.D.		\$
20701	TERRACE SEEDING	4,100.00	SY		\$
30201	TYPE 'A' CONCRETE CURB & GUTTER	3,725.00	LF		\$

**NORTH ORCHARD STREET AND SPRING STREET RECONSTRUCTION ASSESSMENT
DISTRICT - 2012**

CONTRACT NO. 6793

ITEM	TYPE OF WORK	ESTIMATED QUANTITIES		UNIT PRICE BID	TOTAL BID
30203	TYPE 'X' CONCRETE CURB & GUTTER	60.00	LF		\$
30208	HAND FORMED CURB AND GUTTER (TREE LOCATIONS) UNDISTRIBUTED	100.00	LF		\$
30301	5" CONCRETE SIDEWALK	6,750.00	SF		\$
30302	7" CONCRETE SIDEWALK AND DRIVE	8,900.00	SF		\$
30340	CURB RAMP DETECTABLE WARNING FIELD	144.00	SF		\$
40101	CRUSHED AGGREGATE BASE COURSE, GRADATION 1	1,460.00	TON		\$
40102	CRUSHED AGGREGATE BASE COURSE, GRADATION 2	3,375.00	TON		\$
40202	HMA PAVEMENT TYPE E-1	1,575.00	TON		\$
40211	BITUMINOUS TACK COAT	80.00	GAL		\$
40231	ASPHALT DRIVE & TERRACE	30.00	SY		\$
40402	9 INCH CONCRETE PAVEMENT	105.00	SY		\$
90001	TYPE 'A' MODIFIED CONCRETE CURB & GUTTER	80.00	LF		\$
90002	PAVED SURFACE TEMPORARY	50.00	SY		\$
90003	EXCAVATION, HAULING AND DISPOSAL OF CONTAMINATED SOIL (UNDISTRIBUTED)	50.00	TON		\$

STREET ACCOUNT NO. CS53-58270-810355-00-53W0608

20217	CLEAR STONE	500.00	TON		\$
21001	EROSION CONTROL PLAN AND IMPLEMENTATION	1.00	LS		\$
21002	EROSION CONTROL INSPECTION	12.00	EACH		\$
21011	CONSTRUCTION ENTRANCE	5.00	EACH		\$
21012	STREET CONSTRUCTION ENTRANCE BERM	4.00	EACH		\$

**NORTH ORCHARD STREET AND SPRING STREET RECONSTRUCTION ASSESSMENT
DISTRICT - 2012**

CONTRACT NO. 6793

ITEM	TYPE OF WORK	ESTIMATED QUANTITIES		UNIT PRICE BID	TOTAL BID
21013	STREET SWEEPING	1.00	LS		\$
21021	SILT FENCE COMPLETE	100.00	LF		\$
21024	SILT SOCK (UNDISTRIBUTED)	500.00	LF		\$
21046	INLET PROTECTION TYPE D MODIFIED-PROVIDE & INSTALL	36.00	EACH		\$
21047	INLET PROTECTION TYPE D MODIFIED-MAINTAIN	108.00	EACH		\$
21048	INLET PROTECTION TYPE D MODIFIED-REMOVE	36.00	EACH		\$
21052	POLYMER STABILIZATION	1,000.00	SY		\$
50411	12 INCH RCP STORM SEWER PIPE	500.00	LF		\$
50741	TYPE H INLET	16.00	EACH		\$

STORM ACCOUNT NO. ESTM-58270-810381-00-53W0608

10912	MOBILIZATION FOR STORM SEWER INSTALLATION	1.00	LS		\$
20311	REMOVE STORM SEWER ACCESS STRUCTURE	5.00	EACH		\$
20313	REMOVE STORM INLET	7.00	EACH		\$
20314	REMOVE STORM PIPE	122.00	LF		\$
20335	ABANDON STORM PIPE WITH SLURRY	18.00	CY		\$
20336	PIPE PLUG	10.00	EACH		\$
20501	ADJUST STORM SAS	5.00	EACH		\$
20503	ADJUST INLET (UNDISTRIBUTED)	1.00	EACH		\$
50211	SELECT BACKFILL FOR STORM	564.00	TF		\$
50412	15" RCP STORM SEWER PIPE	64.00	LF		\$
50499	CONCRETE COLLAR	3.00	EACH		\$
50723	3' X 3' STORM SAS	3.00	EACH		\$

**NORTH ORCHARD STREET AND SPRING STREET RECONSTRUCTION ASSESSMENT
DISTRICT - 2012**

CONTRACT NO. 6793

ITEM	TYPE OF WORK	ESTIMATED QUANTITIES		UNIT PRICE BID	TOTAL BID
50725	5' X 5' STORM SAS	2.00	EACH		\$
50792	STORM SEWER TAP	2.00	EACH		\$
50801	ULO	10.00	EACH		\$
90030	RECONNECT PRIVATE STORM SEWER	10.00	EACH		\$
90031	INLET CAP	1.00	EACH		\$
90032	RECONNECT EXISTING TWIN 36" STORM SEWER	1.00	LS		\$

STORM WATER QUALITY ACCOUNT NO. ESTM-58270-810551-00-53W0608

50722	6' X 6' CATCHBASIN	1.00	EACH		\$
-------	--------------------	------	------	--	----

SANITARY SEWER ACCOUNT NO. ES01-58275-810332-00-53W0608

10704	TRAFFIC CONTROL FOR SANITARY SEWER	1.00	LS		\$
10914	MOBILIZATION FOR SANITARY SEWER	1.00	LS		\$
20311	REMOVE SEWER ACCESS STRUCTURE	10.00	EACH		\$
20315	REMOVE SANITARY PIPE (UNDISTRIBUTED)	50.00	LF		\$
20331	ABANDON SEWER ACCESS STRUCTURE	6.00	EACH		\$
20336	PIPE PLUGS - SANITARY	68.00	EACH		\$
20501	ADJUST SEWER ACCESS STRUCTURE	6.00	EACH		\$
40202	HMA PAVEMENT TYPE E-1	64.00	TON		\$
40301	FULL WIDTH GRIDING	531.00	SY		\$
50103	RECONSTRUCT BENCH AND FLOWLINES	3.00	EACH		\$
50202	TYPE II DEWATERING	1.00	LS		\$
50212	SELECT BACKFILL FOR SANITARY SEWER	2,566.00	TF		\$
50225	UTILITY TRENCH PATCH TYPE III	190.00	TF		\$

**NORTH ORCHARD STREET AND SPRING STREET RECONSTRUCTION ASSESSMENT
DISTRICT - 2012**

CONTRACT NO. 6793

ITEM	TYPE OF WORK	ESTIMATED QUANTITIES		UNIT PRICE BID	TOTAL BID
50301	8 INCH PVC SANITARY SEWER PIPE	1,061.00	LF		\$
50302	10 INCH PVC SANITARY SEWER PIPE	470.00	LF		\$
50353	SANITARY SEWER LATERAL	1,069.00	LF		\$
50354	RECONNECT	37.00	EACH		\$
50361	WASTEWATER CONTROL	1.00	LS		\$
50390	SEWER ELECTRONIC MARKERS	74.00	EACH		\$
50701	4' SANITARY SEWER MANHOLE (DEPTH AS PER PLAN)	9.00	EACH		\$
50771	INTERNAL CHIMNEY SEAL	4.00	EACH		\$
50780	CLEANOUT (UNDISTRIBUTED)	2.00	EACH		\$
50791	SANITARY SEWER TAP	5.00	EACH		\$
50802	CONCRETE SUPPORTS	7.00	EACH		\$
70413	FURNISH AND INSTALL STYROFOAM INSULATION	250.00	LF		\$

STREET LIGHTING ACCOUNT NO. CS53-58545-810355-00-53W0608

60222	FURNISH & INSTALL 3 INCH PVC (SCHEDULE 80) CONDUIT	100.00	L.F.		\$
60224	FURNISH & INSTALL 3 INCH PVC (SCHEDULE 40) CONDUIT	1200.00	L.F.		\$
60230	FURNISH & INSTALL 2 INCH PVC (SCHEDULE 80) CONDUIT	370.00	L.F.		\$
60232	FURNISH & INSTALL 2 INCH PVC (SCHEDULE 40) CONDUIT	3250.00	L.F.		\$
60236	FURNISH & INSTALL 1 INCH PVC (SCHEDULE 40) CONDUIT	40.00	L.F.		\$
60241	GOPHER RACEWAY FOR ELECTRICAL CONDUIT OR CABLE-IN-DUCT	50.00	L.F.		\$
60401	CONSTRUCT LB-1 BASE	28.00	EACH		\$
60261	ELECTRICAL TRENCH	3800.00	L.F.		\$

**NORTH ORCHARD STREET AND SPRING STREET RECONSTRUCTION ASSESSMENT
DISTRICT - 2012**

CONTRACT NO. 6793

ITEM	TYPE OF WORK	ESTIMATED QUANTITIES		UNIT PRICE BID	TOTAL BID
60702	CONSTRUCT ELECTRICAL HANDHOLE TYPE I	10.00	EACH		\$

WATER ACCOUNT NO. EW01-58273-810455-00-53W0608

10703	TRAFFIC CONTROL FOR WATER MAIN INSTALLATION	1.00	L.S		\$
10913	MOBILIZATION FOR WATER MAIN INSTALLATION	1.00	L.S		\$
50801	UTILITY LINE OPENING (ULO)	2.00	EACH		\$
70001	FURNISH AND INSTALL 4 INCH PIPE & FITTINGS	180.00	L.F.		\$
70002	FURNISH AND INSTALL 6 INCH PIPE & FITTINGS	80.00	L.F.		\$
70003	FURNISH AND INSTALL 8 INCH PIPE & FITTINGS	1160.00	L.F.		\$
70005	FURNISH AND INSTALL 12 INCH PIPE & FITTINGS	20.00	L.F.		\$
70405	CUT-IN CONNECTION	6.00	EACH		\$
70407	FURNISH AND INSTALL HYDRANT	4.00	EACH		\$
70408	SELECT FILL - SAND FOR WATER	1380.00	L.F.		\$
70409	UNDERCUT	30.00	C.Y.		\$
70413	FURNISH AND INSTALL STYROFOAM	112.00	L.F.		\$
70414	CUT OFF EXISTING WATER MAIN	6.00	EACH		\$
70415	ABANDON WATER VALVE BOX	14.00	EACH		\$
70416	ABANDON HYDRANT	2.00	EACH		\$
70417	ABANDON WATER VALVE ACCESS STRUCTURE	2.00	EACH		\$
70418	ADJUST WATER VALVE BOX	5.00	EACH		\$
70427	FURNISH AND INSTALL 4 INCH VALVE	5.00	EACH		\$
70428	FURNISH AND INSTALL 6 INCH VALVE	5.00	EACH		\$

**NORTH ORCHARD STREET AND SPRING STREET RECONSTRUCTION ASSESSMENT
DISTRICT - 2012**

CONTRACT NO. 6793

ITEM	TYPE OF WORK	ESTIMATED QUANTITIES		UNIT PRICE BID	TOTAL BID
70429	FURNISH AND INSTALL 8 INCH VALVE	4.00	EACH		\$
70431	FURNISH AND INSTALL 12 INCH VALVE	2.00	EACH		\$
70440	EXTEND AND RECONNECT SERVICE LATERAL - 1 INCH	45.00	L.F.		\$
70441	EXTEND AND RECONNECT SERVICE LATERAL - 1.5 INCHES	30.00	L.F.		\$
70442	EXTEND AND RECONNECT SERVICE LATERAL - 2 INCHES	45.00	L.F.		\$
70443	RECONNECT / DISCONNECT SERVICE LATERAL - 1 INCH	6.00	EACH		\$
70444	RECONNECT / DISCONNECT SERVICE LATERAL - 1.5 INCHES OR 2 INCHES	4.00	EACH		\$
70450	FURNISH AND INSTALL CURB BOX	4.00	EACH		\$
70451	FURNISH AND INSTALL CURB STOP	4.00	EACH		\$
70452	ADJUST WATER SERVICE BOX	8.00	EACH		\$
70453	ABANDON EXISTING CURB BOX	5.00	EACH		\$
70454	REPLACE COPPER SERVICE LATERAL	2.00	L.F.		\$
70455	PIPE PLUG FOR WATER MAIN INSTALLATION	5.00	EACH		\$
70456	FURNISH EXCAVATION AND DITCH FOR LIVE TAP	2.00	EA		\$

GRAND TOTAL

SECTION F: BID BOND

KNOW ALL MEN BY THESE PRESENT, THAT _____
(a corporation of the State of _____) (individual), (partnership), hereinafter referred to as
the "Principal") and _____, a corporation of the State of _____ (hereinafter referred
to as the "Surety") and licensed to do business in the State of Wisconsin, are held and firmly bound unto
the City of Madison, (hereinafter referred to as the "Obligee"), in the sum of five per cent (5%) of the
amount of the total bid or bids of the Principal herein accepted by the Obligee, for the payment of which
the Principal and the Surety bind themselves, their heirs, executors, administrators, successors and
assigns, jointly and severally, firmly by these presents.

The conditions of this obligation are such that, whereas the Principal has submitted, to the City of
Madison a certain bid, including the related alternate, and substitute bids attached hereto and hereby made
a part hereof, to enter into a contract in writing for the construction of:

NORTH ORCHARD STREET AND SPRING STREET RECONSTRUCTION ASSESSMENT DISTRICT - 2012 CONTRACT NO. 6793

1. If said bid is rejected by the Obligee, then this obligation shall be void.
2. If said bid is accepted by the Obligee and the Principal shall execute and deliver a contract in the
form specified by the Obligee (properly completed in accordance with said bid) and shall furnish
a bond for his/her faithful performance of said contract, and for the payment of all persons
performing labor or furnishing materials in connection therewith, and shall in all other respects
perform the agreement created by the acceptance of said bid, then this obligation shall be void.

If said bid is accepted by the Obligee and the Principal shall fail to execute and deliver the
contract and the performance and payment bond noted in 2. above executed by this Surety, or
other Surety approved by the City of Madison, all within the time specified or any extension
thereof, the Principal and Surety agree jointly and severally to forfeit to the Obligee as liquidated
damages the sum mentioned above, it being understood that the liability of the Surety for any and
all claims hereunder shall in no event exceed the sum of this obligation as stated, and it is further
understood that the Principal and Surety reserve the right to recover from the Obligee that portion
of the forfeited sum which exceed the actual liquidated damages incurred by the Obligee.

The Surety, for value received, hereby stipulates and agrees that the obligations of said Surety
and its bond shall be in no way impaired or affected by an extension of the time within which the
Obligee may accept such bid, and said Surety does hereby waive notice of any such extension.

IN WITNESS WHEREOF, the Principal and the Surety have hereunto set their hands and seals, and such of them as are corporations have caused their corporate seals to be hereto affixed and these presents to be signed by their proper officers, on the day and year set forth below.

Seal

Principal

Date

By:

Name of Surety

By:

Date

This certifies that I have been duly licensed as an agent for the above company in Wisconsin under License No. _____ for the year _____, and appointed as attorney in fact with authority to execute this bid bond and the payment and performance bond referred to above, which power of attorney has not been revoked.

Date

Agent

Address

City, State and Zip Code

Telephone Number

NOTE TO SURETY & PRINCIPAL

The bid submitted which this bond guarantees may be rejected if the following instrument is not attached to this bond:

Power of Attorney showing that the agent of Surety is currently authorized to execute bonds on behalf of the Surety, and in the amounts referenced above.

Certificate of Biennial Bid Bond

TIME PERIOD - VALID (FROM/TO)
NAME OF SURETY
NAME OF CONTRACTOR
CERTIFICATE HOLDER <p style="text-align: center;">City of Madison, Wisconsin</p>

This is to certify that a biennial bid bond issued by the above-named Surety is currently on file with the City of Madison.

This certificate is issued as a matter of information and conveys no rights upon the certificate holder and does not amend, extend or alter the coverage of the biennial bid bond.

Cancellation: Should the above policy be cancelled before the expiration date, the issuing Surety will give thirty (30) days written notice to the certificate holder indicated above.

Signature of Authorized Contractor Representative

Date

SECTION G: AGREEMENT

THIS AGREEMENT made this _____ day of _____ in the year Two Thousand and Twelve between _____ hereinafter called the Contractor, and the City of Madison, Wisconsin, hereinafter called the City.

WHEREAS, the Common Council of the said City of Madison under the provisions of a resolution adopted _____, _____, and by virtue of authority vested in the said Council, has awarded to the Contractor the work of performing certain construction.

NOW, THEREFORE, the Contractor and the City, for the consideration hereinafter named, agree as follows:

1. **Scope of Work.** The Contractor shall, perform the construction, execution and completion of the following listed complete work or improvement in full compliance with the Plans, Specifications, Standard Specifications, Supplemental Specifications, Special Provisions and contract; perform all items of work covered or stipulated in the proposal; perform all altered or extra work; and shall furnish, unless otherwise provided in the contract, all materials, implements, machinery, equipment, tools, supplies, transportation, and labor necessary to the prosecution and completion of the work or improvements:

NORTH ORCHARD STREET AND SPRING STREET RECONSTRUCTION ASSESSMENT DISTRICT - 2012 CONTRACT NO. 6793

2. **Completion Date/Contract Time.** Construction work must begin within seven (7) calendar days after the date appearing on mailed written notice to do so shall have been sent to the Contractor and shall be carried on at a rate so as to secure full completion SEE SPECIAL PROVISIONS, the rate of progress and the time of completion being essential conditions of this Agreement.
3. **Contract Price.** The City shall pay to the Contractor at the times, in the manner and on the conditions set forth in said specifications, the sum of _____ (\$ _____) Dollars being the amount bid by such Contractor and which was awarded to him/her as provided by law.
4. **Wage Rates for Employees of Public Works Contractors**

General and Authorization. The Contractor shall compensate its employees at the prevailing wage rate in accordance with section 66.0903, Wis. Stats., DWD 290 of the Wisconsin Administrative Code and as hereinafter provided.

“Public Works” shall include building or work involving the erection, construction, remodeling, repairing or demolition of buildings, parking lots, highways, streets, bridges, sidewalks, street lighting, traffic signals, sanitary sewers, water mains and appurtenances, storm sewers, and the grading and landscaping of public lands.

“Building or work” includes construction activity as distinguished from manufacturing, furnishing of materials, or servicing and maintenance work, except for the delivery of mineral aggregate such as sand, gravel, bituminous asphaltic concrete or stone which is incorporated into the work under contract with the City by depositing the material directly in final place from transporting vehicle.

“Erection, construction, remodeling, repairing” means all types of work done on a particular building or work at the site thereof in the construction or development of the project, including without limitation, erecting, construction, remodeling, repairing, altering, painting, and decorating, the transporting of materials and supplies to or from the building or work done by the employees of the Contractor, Subcontractor, or Agent thereof, and the manufacturing or furnishing of materials, articles, supplies or equipment on the site of the building or work, by persons employed by the Contractor, Subcontractor, or Agent thereof.

“Employees working on the project” means laborers, workers, and mechanics employed directly upon the site of work.

“Laborers, Workers, and Mechanics” include preapprentices, helpers, trainees, learners and properly registered and indentured apprentices but exclude clerical, supervisory, and other personnel not performing manual labor.

Establishment of Wage Rates. The Department of Public Works shall periodically obtain a current schedule of prevailing wage rates from DWD. The schedule shall be used to establish the City of Madison Prevailing Wage Rate Schedule for Public Works Construction (prevailing wage rate). The Department of Public Works may include known increases to the prevailing wage rate which can be documented and are to occur on a future specific date. The prevailing wage rate shall be included in public works contracts subsequently negotiated or solicited by the City. Except for known increases contained within the schedule, the prevailing wage rate shall not change during the contract. The approved wage rate is attached hereto.

Workforce Profile. The Contractor shall, at the time of signature of the contract, notify the City Engineer in writing of the names and classifications of all the employees of the Contractor, Subcontractors, and Agents proposed for the work. In the alternative, the Contractor shall submit in writing the classifications of all the employees of the Contractor, Subcontractors and Agents and the total number of hours estimated in each classification for the work. This workforce profile(s) shall be reviewed by the City Engineer who may, within ten (10) days, object to the workforce profile(s) as not being reflective of that which would be required for the work. The Contractor may request that the workforce profile, or a portion of the workforce profile, be submitted after the signature of the contract but at least ten (10) days prior to the work commencing. Any costs or time loss resulting from modifications to the workforce profile as a result of the City Engineer’s objections shall be the responsibility of the Contractor.

Payrolls and Records. The Contractor shall keep weekly payroll records setting forth the name, address, telephone number, classification, wage rate and fringe benefit package of all the employees who work on the contract, including the employees of the Contractor’s subcontractors and agents. Such weekly payroll records must include the required information for all City contracts and all other contracts on which the employee worked during the week in which the employee worked on the contract. The Contractor shall also keep records of the individual time each employee worked on the project and for each day of the project. Such records shall also set forth the total number of hours of overtime credited to each such employee for each day and week and the amount of overtime pay received in that week. The records shall set forth the full weekly wages earned by each employee and the actual hourly wage paid to the employee.

The Contractor shall submit the weekly payroll records, including the records of the Contractor’s subcontractors and agents, to the City Engineer for every week that work is being done on the contract. The submittal shall be within twenty-one (21) calendar days of the end of the Contractor’s weekly pay period.

Employees shall receive the full amounts accrued at the time of the payment, computed at rates not less than those stated in the prevailing wage rate and each employee's rate shall be determined by the work that is done within the trade or occupation classification which should be properly assigned to the employee.

An employee's classification shall not be changed to a classification of a lesser rate during the contract. If, during the term of the contract, an employee works in a higher pay classification than the one which was previously properly assigned to the employee, then that employee shall be considered to be in the higher pay classification for the balance of the contract, receive the appropriate higher rate of pay, and she/he shall not receive a lesser rate during the balance of the contract. For purposes of clarification, it is noted that there is a distinct difference between working in a different classification with higher pay and doing work within a classification that has varying rates of pay which are determined by the type of work that is done within the classification. For example, the classification "Operating Engineer" provides for different rates of pay for various classes of work and the Employer shall compensate an employee classified as an "Operating Engineer" based on the highest class of work that is done in one day. Therefore, an "Operating Engineer's" rate may vary on a day to day basis depending on the type of work that is done, but it will never be less than the base rate of an "Operating Engineer". Also, as a matter of clarification, it is recognized that an employee may work in a higher paying classification merely by chance and without prior intention, calculation or design. If such is the case and the performance of the work is truly incidental and the occurrence is infrequent, inconsequential and does not serve to undermine the single classification principle herein, then it may not be required that the employee be considered to be in the higher pay classification and receive the higher rate of pay for the duration of the contract. However, the Contractor is not precluded or prevented from paying the higher rate for the limited time that an employee performs work that is outside of the employee's proper classification.

Questions regarding an employee's classification, rate of pay or rate of pay within a classification, shall be resolved by reference to the established practice that predominates in the industry and on which the trade or occupation rate/classification is based. Rate of pay and classification disputes shall be resolved by relying upon practices established by collective bargaining agreements and guidelines used in such determination by appropriate recognized trade unions operating within the City of Madison.

The Contractor, its Subcontractors and Agents shall submit to interrogation regarding compliance with the provisions of this ordinance.

Mulcting of the employees by the Contractor, Subcontractor, and Agents on Public Works contracts, such as by kickbacks or other devices, is prohibited. The normal rate of wage of the employees of the Contractor, Subcontractor, and Agents shall not be reduced or otherwise diminished as a result of payment of the prevailing wage rate on a public works contract.

Hourly contributions. Hourly contributions shall be determined in accordance with the prevailing wage rate and with DWD. 290.01(10), Wis. Admin. Code.

Apprentices and Subjourneypersons. Apprentices and subjourneypersons performing work on the project shall be compensated in accordance with the prevailing wage rate and with DWD 290.02, and 290.025, respectively, Wis. Admin. Code.

Straight Time Wages. The Contractor may pay straight time wages as determined by the prevailing wage rate and DWD 290.04, Wis. Admin. Code.

Overtime Wages. The Contractor shall pay overtime wages as required by the prevailing wage rate and DWD 290.05, Wis. Admin. Code.

Posting of Wage Rates and Hours. A clearly legible copy of the prevailing wage rate, together with the provisions of Sec. 66.0903(10)(a) and (11)(a), Wis. Stats., shall be kept posted in at least one conspicuous and easily accessible place at the project site by the Contractor and such notice shall remain posted during the full time any laborers, workers or mechanics are employed on the contract.

Evidence of Compliance by Contractor. Upon completion of the contract, the Contractor shall file with the Department of Public Works an affidavit stating:

- a. That the Contractor has complied fully with the provisions and requirements of Sec. 66.0903(3), Wis. Stats., and Chapter DWD 290, Wis. Admin. Code; the Contractor has received evidence of compliance from each of the agents and subcontractors; and the names and addresses of all of the subcontractors and agents who worked on the contract.
- b. That full and accurate records have been kept, which clearly indicate the name and trade or occupation of every laborer, worker or mechanic employed by the Contractor in connection with work on the project. The records shall show the number of hours worked by each employee and the actual wages paid therefor; where these records will be kept and the name, address and telephone number of the person who will be responsible for keeping them. The records shall be retained and made available for a period of at least three (3) years following the completion of the project of public works and shall not be removed without prior notification to the municipality.

Evidence of Compliance by Agent and Subcontractor. Each agent and subcontractor shall file with the Contractor, upon completion of their portion of the work on the contract an affidavit stating that all the provisions of Sec. 66.0903(3), Wis. Stats., have been fully complied with and that full and accurate records have been kept, which clearly indicate the name and trade or occupation of every laborer, worker or mechanic employed by the Contractor in connection with work on the project. The records shall show the number of hours worked by each employee and the actual wages paid therefor; where these records shall be kept and the name, address and telephone number of the person who shall be responsible for keeping them. The records shall be retained and made available for a period of at least three (3) years following the completion of the project of public works and shall not be removed without prior notification to the municipality.

Failure to Comply with the Prevailing Wage Rate. If the Contractor fails to comply with the prevailing wage rate, she/he shall be in default on the contract.

5. **Affirmative Action.** In the performance of the services under this Agreement the Contractor agrees not to discriminate against any employee or applicant because of race, religion, marital status, age, color, sex, disability, national origin or ancestry, income level or source of income, arrest record or conviction record, less than honorable discharge, physical appearance, sexual orientation, political beliefs, or student status. The Contractor further agrees not to discriminate against any subcontractor or person who offers to subcontract on this contract because of race, religion, color, age, disability, sex or national origin.

The Contractor agrees that within thirty (30) days after the effective date of this agreement, the Contractor will provide to the City Affirmative Action Division certain workforce utilization statistics, using a form to be furnished by the City.

If the contract is still in effect, or if the City enters into a new agreement with the Contractor, within one year after the date on which the form was required to be provided, the Contractor will provide updated workforce information using a second form, also to be furnished by the City. The second form will be submitted to the City Affirmative Action Division no later than one year after the date on which the first form was required to be provided.

The Contractor further agrees that, for at least twelve (12) months after the effective date of this contract, it will notify the City Affirmative Action Division of each of its job openings at facilities in Dane County for which applicants not already employees of the Contractor are to be considered. The notice will include a job description, classification, qualifications and application procedures and deadlines. The Contractor agrees to interview and consider candidates referred by the Affirmative Action Division if the candidate meets the minimum qualification standards established by the Contractor, and if the referral is timely. A referral is timely if it is received by the Contractor on or before the date started in the notice.

Articles of Agreement

Article I

The Contractor shall take affirmative action in accordance with the provisions of this contract to insure that applicants are employed, and that employees are treated during employment without regard to race, religion, color, age, marital status, disability, sex or national origin and that the employer shall provide harassment free work environment for the realization of the potential of each employee. Such action shall include, but not be limited to, the following: employment, upgrading, demotion or transfer, recruitment or recruitment advertising, layoff or termination, rates of pay or other forms of compensation and selection for training including apprenticeship insofar as it is within the control of the Contractor. The Contractor agrees to post in conspicuous places available to employees and applicants notices to be provided by the City setting out the provisions of the nondiscrimination clauses in this contract.

Article II

The Contractor shall in all solicitations or advertisements for employees placed by or on behalf of the Contractor state that all qualified or qualifiable applicants will be employed without regard to race, religion, color, age, marital status, disability, sex or national origin.

Article III

The Contractor shall send to each labor union or representative of workers with which it has a collective bargaining agreement or other contract or understanding a notice to be provided by the City advising the labor union or worker's representative of the Contractor's equal employment opportunity and affirmative action commitments. Such notices shall be posted in conspicuous places available to employees and applicants for employment.

Article V

The Contractor agrees that it will comply with all provisions of the Affirmative Action Ordinance of the City of Madison, including the contract compliance requirements. The Contractor agrees to submit the model affirmative action plan for public works contractors in a form approved by the Director of Affirmative Action.

Article VI

The Contractor will maintain records as required by Section 39.02(9)(f) of the Madison General Ordinances and will provide the City Affirmative Action Division with access to such records and to persons who have relevant and necessary information, as provided in Section 39.02(9)(f). The City agrees to keep all such records confidential, except to the extent that public inspection is required by law.

Article VII

In the event of the Contractor's or subcontractor's failure to comply with the Equal Employment Opportunity and Affirmative Action Provisions of this contract or Section 39.03 and 39.02 of the Madison General Ordinances, it is agreed that the City at its option may do any or all of the following:

1. Cancel, terminate or suspend this Contract in whole or in part.
2. Declare the Contractor ineligible for further City contracts until the Affirmative Action requirements are met.
3. Recover on behalf of the City from the prime Contractor 0.5 percent of the contract award price for each week that such party fails or refuses to comply, in the nature of liquidated damages, but not to exceed a total of five percent (5%) of the contract price, or five thousand dollars (\$5,000), whichever is less. Under public works contracts, if a subcontractor is in noncompliance, the City may recover liquidated damages from the prime Contractor in the manner described above. The preceding sentence shall not be construed to prohibit a prime Contractor from recovering the amount of such damage from the non-complying subcontractor.

Article VIII

The Contractor shall include the above provisions of this contract in every subcontract so that such provisions will be binding upon each subcontractor. The Contractor shall take such action with respect to any subcontractor as necessary to enforce such provisions, including sanctions provided for noncompliance.

Article IX

The Contractor shall allow the maximum feasible opportunity to small business enterprises to compete for any subcontracts entered into pursuant to this contract.

SECTION H: PAYMENT AND PERFORMANCE BOND

KNOW ALL MEN BY THESE PRESENTS, that we _____
as principal, and _____
Company of _____ as surety, are held and firmly bound unto the City of
Madison, Wisconsin, in the sum of _____ (\$ _____) Dollars, lawful money of the
United States, for the payment of which sum to the City of Madison, we hereby bind ourselves and our
respective executors and administrators firmly by these presents.

The condition of this Bond is such that if the above bounden shall on his/her part fully and faithfully
perform all of the terms of the Contract entered into between him/herself and the City of Madison for the
construction of:

**NORTH ORCHARD STREET AND SPRING STREET RECONSTRUCTION
ASSESSMENT DISTRICT - 2012
CONTRACT NO. 6793**

in Madison, Wisconsin, and shall pay all claims for labor performed and material furnished in the
prosecution of said work, and save the City harmless from all claims for damages because of negligence
in the prosecution of said work, and shall save harmless the said City from all claims for compensation
(under Chapter 102, Wisconsin Statutes) of employees and employees of subcontractor, then this Bond is
to be void, otherwise of full force, virtue and effect.

Signed and sealed this _____ day of _____,

Countersigned:

Company Name (Principal)

Witness

President Seal

Secretary

Approved as to form:

Surety Seal
 Salary Employee Commission

City Attorney

By _____
Attorney-in-Fact

This certifies that I have been duly licensed as an agent for the above company in Wisconsin under
License No. _____ for the year 20_____, and appointed as attorney-in-fact with
authority to execute this payment and performance bond which power of attorney has not been revoked.

Date

Agent

MINIMUM WAGE SCALE

FOR

PUBLIC WORKS IMPROVEMENTS

APPROVED BY: BOARD OF PUBLIC WORKS

MADISON, WISCONSIN

February 7, 2012

The attached "Prevailing Wage Rate Determination: (Pages 1 through 30), issued February 7, 2012, is hereby approved as the Minimum Wage Scale of the City of Madison.

State of Wisconsin
Department of Workforce Development
Equal Rights Division

DEPARTMENTAL ORDER

ISSUE DATE: 1/13/2012

PROJECT:

ALL PUBLIC WORKS PROJECTS UNDER SEC 66.0903, STATS - CITY OF MADISON
MADISON CITY, DANE COUNTY, WI
Determination No. 201200105

PROJECT OWNER:

ROBERT F. PHILLIPS, CITY ENGINEER
CITY OF MADISON-ENGINEERING
210 MARTIN L KING JR BLVD, RM 115
MADISON, WI 53703

REQUESTER:

ROBERT F. PHILLIPS, CITY ENGINEER
CITY OF MADISON-ENGINEERING
210 MARTIN L KING JR BLVD, RM 115
MADISON, WI 53703

ADDITIONAL CONTACT:

NORMAN DAVIS, CONTRACT COMPLIANCE
CITY OF MADISON-DEPT OF CIVIL RTS-AA DIV
210 MARTIN L KING JR BLVD, RM 523
MADISON, WI 537033342

The department received an application for prevailing wage rate determination for the above-captioned project. The department conducted a survey to determine the prevailing wage rate for the trade(s) or occupation(s) needed to complete the project. The survey's findings appear in the attached project determination.

If you believe that the wage rate for any trade or occupation does not accurately reflect the prevailing wage rate in the city, village or town where the project is located, you may ask the department to conduct an administrative review of such wage rate. You must submit this request in writing within 30 days from the date indicated above. Additionally, your request must include wage rate information from at least three similar projects in the city, village or town where the proposed project is located and on which some work has been performed by the contested trade(s) during the current survey period and was previously considered by the department in issuing the attached determination. See DWD 290.10 of the Wisconsin Administrative Code and either s. 66.0903(3)(br), s. 66.0904(4)(e), or s. 103.49(3)(c), Stats., for a complete explanation of the administrative review process.

Enclosures

It is hereby ordered that the prevailing wage rates set forth in the attached project determination shall only be applicable to the above referenced project. This order is a **FINAL ORDER** of the department unless a timely request for an administrative review is filed with the department.

ISSUED BY:

Equal Rights Division
Labor Standards Bureau
Construction Wage Standards Section
PO Box 8928 Madison, WI 53708-8928
(608)266-6861

Web Site: <http://dwd.wisconsin.gov/er/>

PREVAILING WAGE RATE DETERMINATION

Issued by the State of Wisconsin
Department of Workforce Development
Pursuant to s. 66.0903, Wis. Stats.
Issued On: 1/13/2012

DETERMINATION NUMBER: 201200105

EXPIRATION DATE: Prime Contracts MUST Be Awarded or Negotiated On Or Before 12/31/2012. If NOT, You MUST Reapply.

PROJECT NAME: ALL PUBLIC WORKS PROJECTS UNDER SEC 66.0903, STATS.-CITY OF MADISON

PROJECT LOCATION: MADISON CITY, DANE COUNTY, WI

CONTRACTING AGENCY: CITY OF MADISON-ENGINEERING

CLASSIFICATION:	Contractors are responsible for correctly classifying their workers. Either call the Department of Workforce Development (DWD) with trade or classification questions or consult DWD's Dictionary of Occupational Classifications & Work Descriptions on the DWD website at: dwd.wisconsin.gov/er/prevailing_wage_rate/Dictionary/dictionary_main.htm .
OVERTIME:	<p>Time and one-half must be paid for all hours worked:</p> <ul style="list-style-type: none">- over 10 hours per day on prevailing wage projects- over 40 hours per calendar week- Saturday and Sunday- on all of the following holidays: January 1; the last Monday in May; July 4; the 1st Monday in September; the 4th Thursday in November; December 25;- The day before if January 1, July 4 or December 25 falls on a Saturday;- The day following if January 1, July 4 or December 25 falls on a Sunday. <p>Apply the time and one-half overtime calculation to whichever is higher between the Hourly Basic Rate listed on this project determination or the employee's regular hourly rate of pay. Add any applicable Premium or DOT Premium to the Hourly Basic Rate before calculating overtime.</p> <p>A DOT Premium (discussed below) may supersede this time and one-half requirement.</p>
FUTURE INCREASE:	When a specific trade or occupation requires a future increase, you MUST add the full hourly increase to the "TOTAL" on the effective date(s) indicated for the specific trade or occupation.
PREMIUM PAY:	If indicated for a specific trade or occupation, the full amount of such pay MUST be added to the "HOURLY BASIC RATE OF PAY" indicated for such trade or occupation, whenever such pay is applicable.
DOT PREMIUM:	This premium only applies to highway and bridge projects owned by the Wisconsin Department of Transportation and to the project type heading "Airport Pavement or State Highway Construction." DO NOT apply the premium calculation under any other project type on this determination.
APPRENTICES:	Pay apprentices a percentage of the applicable journey person's hourly basic rate of pay and hourly fringe benefit contributions specified in this determination. Obtain the appropriate percentage from each apprentice's contract or indenture.
SUBJOURNEY:	Subjourney wage rates may be available for some of the trades or occupations indicated below with the exception of laborers, truck drivers and heavy equipment operators. Any employer interested in using a subjourney classification on this project MUST complete Form ERD-10880 and request the applicable wage rate from the Department of Workforce Development PRIOR to using the subjourney worker on this project.

This document **MUST BE POSTED** by the **CONTRACTING AGENCY** in at least one conspicuous and easily accessible place on the **site of the project**. A local governmental unit may post this document at the place normally used to post public notices if there is no common site on the project. This document **MUST** remain posted during the entire time any worker is employed on the project and **MUST** be physically incorporated into the specifications and all contracts and subcontracts. If you have any questions, please write to the Equal Rights Division, Labor Standards Bureau, P.O. Box 8928, Madison, Wisconsin 53708 or call (608) 266-6861.

The following statutory provisions apply to local governmental unit projects of public works and are set forth below pursuant to the requirements of s. 66.0903(8), Stats.

s. 66.0903 (1) (f) & s. 103.49 (1) (c) "PREVAILING HOURS OF LABOR" for any trade or occupation in any area means 10 hours per day and 40 hours per week and may not include any hours worked on a Saturday or Sunday or on any of the following holidays:

1. January 1.
2. The last Monday in May.
3. July 4.
4. The first Monday in September.
5. The 4th Thursday in November.
6. December 25.
7. The day before if January 1, July 4 or December 25 falls on a Saturday.
8. The day following if January 1, July 4 or December 25 falls on a Sunday.

s. 66.0903 (10) RECORDS; INSPECTION; ENFORCEMENT.

(a) Each contractor, subcontractor, or contractor's or subcontractor's agent performing work on a project of public works that is subject to this section shall keep full and accurate records clearly indicating the name and trade or occupation of every person performing the work described in sub. (4) and an accurate record of the number of hours worked by each of those persons and the actual wages paid for the hours worked.

s. 66.0903 (11) LIABILITY AND PENALTIES.

- (a) 1. Any contractor, subcontractor, or contractor's or subcontractor's agent who fails to pay the prevailing wage rate determined by the department under sub. (3) or who pays less than 1.5 times the hourly basic rate of pay for all hours worked in excess of the prevailing hours of labor is liable to any affected employee in the amount of his or her unpaid wages or his or her unpaid overtime compensation and in an additional amount as liquidated damages as provided under subd. 2., 3., whichever is applicable.
2. If the department determines upon inspection under sub. (10) (b) or (c) that a contractor, subcontractor, or contractor's or subcontractor's agent has failed to pay the prevailing wage rate determined by the department under sub. (3) or has paid less than 1.5 times the hourly basic rate of pay for all hours worked in excess of the prevailing hours of labor, the department shall order the contractor to pay to any affected employee the amount of his or her unpaid wages or his or her unpaid overtime compensation and an additional amount equal to 100 percent of the amount of those unpaid wages or that unpaid overtime compensation as liquidated damages within a period specified by the department in the order.
3. In addition to or in lieu of recovering the liability specified in subd. 1. as provided in subd. 2., any employee for and in behalf of that employee and other employees similarly situated may commence an action to recover that liability in any court of competent jurisdiction. If the court finds that a contractor, subcontractor, or contractor's or subcontractor's agent has failed to pay the prevailing wage rate determined by the department under sub. (3) or has paid less than 1.5 times the hourly basic rate of pay for all hours worked in excess of the prevailing hours of labor, the court shall order the contractor, subcontractor, or agent to pay to any affected employee the amount of his or her unpaid wages or his or her unpaid overtime compensation and an additional amount equal to 100 percent of the amount of those unpaid wages or that unpaid overtime compensation as liquidated damages.
5. No employee may be a party plaintiff to an action under subd. 3. unless the employee consents in writing to become a party and the consent is filed in the court in which the action is brought. Notwithstanding s. 814.04 (1), the court shall, in addition to any judgment awarded to the plaintiff, allow reasonable attorney fees and costs to be paid by the defendant.

BUILDING OR HEAVY CONSTRUCTION

Includes sheltered enclosures with walk-in access for the purpose of housing persons, employees, machinery, equipment or supplies and non-sheltered work such as canals, dams, dikes, reservoirs, storage tanks, etc. A sheltered enclosure need not be "habitable" in order to be considered a building. The installation of machinery and/or equipment, both above and below grade level, does not change a project's character as a building. On-site grading, utility work and landscaping are included within this definition. Residential buildings of four (4) stories or less, agricultural buildings, parking lots and driveways are NOT included within this definition.

SKILLED TRADES

<u>CODE</u>	<u>TRADE OR OCCUPATION</u>	<u>HOURLY</u>	<u>HOURLY</u>	<u>TOTAL</u>
		<u>BASIC RATE</u>	<u>FRINGE</u>	
		<u>OF PAY</u>	<u>BENEFITS</u>	
		\$	\$	\$
101	Acoustic Ceiling Tile Installer	29.06	15.16	44.22
102	Bollermaker	31.09	23.75	54.84
103	Bricklayer, Blocklayer or Stonemason Future Increase(s): Add \$.50/hr on 6/1/2012; Add \$.80 on 6/1/2013 Premium Increase(s): DOT PREMIUM: Pay two times the hourly basic rate on Sunday, New Year's Day, Memorial Day, Independence Day, Labor Day, Thanksgiving Day & Christmas Day.	32.26	16.60	48.86
104	Cabinet Installer	29.06	15.16	44.22
105	Carpenter	29.06	15.16	44.22
106	Carpet Layer or Soft Floor Coverer	29.06	15.16	44.22
107	Cement Finisher	32.03	15.13	47.16
108	Drywall Taper or Finisher	26.10	13.65	39.75
109	Electrician Future Increase(s): Add \$.50/hr on 6/1/2012. Premium Increase(s): DOT PREMIUM: Pay two times the hourly basic rate on Sunday, New Year's Day, Memorial Day, Independence Day, Labor Day, Thanksgiving Day & Christmas Day.	32.55	18.68	51.23
110	Elevator Constructor	43.79	25.48	69.27
111	Fence Erector	25.50	0.26	25.76
112	Fire Sprinkler Fitter	36.39	16.75	53.14
113	Glazier	36.23	11.22	47.45
114	Heat or Frost Insulator	33.28	22.51	55.79
115	Insulator (Batt or Blown)	23.62	11.55	35.17
116	Ironworker	30.90	19.11	50.01
117	Lather	29.06	15.16	44.22

Fringe Benefits Must Be Paid On <u>All</u> Hours Worked		HOURLY BASIC RATE OF PAY	HOURLY FRINGE BENEFITS	TOTAL
CODE	TRADE OR OCCUPATION	\$	\$	\$
118	Line Constructor (Electrical)	35.97	18.08	54.05
119	Marble Finisher	31.16	16.27	47.43
120	Marble Mason	32.66	16.20	48.86
121	Metal Building Erector	22.00	4.11	26.11
122	Millwright	30.66	15.21	45.87
123	Overhead Door Installer	18.00	4.86	22.86
124	Painter	25.65	14.11	39.76
125	Pavement Marking Operator	26.00	0.00	26.00
126	Piledriver	29.56	15.16	44.72
127	Pipeline Fuser or Welder (Gas or Utility)	29.54	18.84	48.38
129	Plasterer	29.03	15.16	44.19
130	Plumber	36.20	15.02	51.22
132	Refrigeration Mechanic Future Increase(s): Add \$.85/hr on 12/1/11; Add \$.90/hr on 6/1/12; Add \$.85/hr on 12/1/12.	40.35	16.21	56.56
133	Rofer or Waterproofer	28.06	0.00	28.06
134	Sheet Metal Worker	34.23	20.19	54.42
135	Steamfitter Future Increase(s): Add \$.85/hr on 12/1/11; Add \$.90/hr on 6/1/12; Add \$.85/hr on 12/1/12.	40.35	16.21	56.56
137	Teledata Technician or Installer	21.26	6.99	28.25
138	Temperature Control Installer	32.55	18.68	51.23
139	Terrazzo Finisher	18.00	5.35	23.35
140	Terrazzo Mechanic	31.16	16.27	47.43
141	Tile Finisher Future Increase(s): Add \$.50/hr on 6/1/2012; Add \$.80/hr on 6/1/2013.	23.77	16.00	39.77
142	Tile Setter Future Increase(s): Add \$.50/hr on 6/1/2012; Add \$.80/hr on 6/1/2013.	29.71	16.00	45.71
143	Tuckpointer, Caulker or Cleaner	22.00	9.75	31.75
144	Underwater Diver (Except on Great Lakes)	36.20	18.81	55.01
146	Well Driller or Pump Installer	25.32	15.30	40.62

Fringe Benefits Must Be Paid On <u>All</u> Hours Worked		HOURLY BASIC RATE OF PAY	HOURLY FRINGE BENEFITS	TOTAL
<u>CODE</u>	<u>TRADE OR OCCUPATION</u>	\$	\$	\$
147	Siding Installer	16.74	2.58	19.32
150	Heavy Equipment Operator - ELECTRICAL LINE CONSTRUCTION ONLY	32.37	16.48	48.85
151	Light Equipment Operator -ELECTRICAL LINE CONSTRUCTION ONLY	28.78	15.16	43.94
152	Heavy Truck Driver - ELECTRICAL LINE CONSTRUCTION ONLY	17.80	9.00	26.80
153	Light Truck Driver - ELECTRICAL LINE CONSTRUCTION ONLY	23.38	12.48	35.86
154	Groundman - ELECTRICAL LINE CONSTRUCTION ONLY	21.30	10.97	32.27

TRUCK DRIVERS

Fringe Benefits Must Be Paid On <u>All</u> Hours Worked		HOURLY BASIC RATE OF PAY	HOURLY FRINGE BENEFITS	TOTAL
<u>CODE</u>	<u>TRADE OR OCCUPATION</u>	\$	\$	\$
201	Single Axle or Two Axle	18.00	6.98	24.98
203	Three or More Axle Future Increase(s): Add \$1.57/hr on 6/1/2012.	18.00	13.83	31.83
204	Articulated, Euclid, Dumptor, Off Road Material Hauler Future Increase(s): Add \$1/hr on 6/3/2012; Add \$1/hr on 6/2/2013.	31.89	17.98	49.87
205	Pavement Marking Vehicle	19.25	10.84	30.09
207	Truck Mechanic	18.00	13.68	31.68

LABORERS

Fringe Benefits Must Be Paid On <u>All</u> Hours Worked		HOURLY BASIC RATE OF PAY	HOURLY FRINGE BENEFITS	TOTAL
<u>CODE</u>	<u>TRADE OR OCCUPATION</u>	\$	\$	\$
301	General Laborer Future Increase(s): Add \$.50/hr. on 06/04/2012; Add \$.75/hr. on 06/03/2013 Premium Increase(s): Add \$1.00/hr for certified welder; Add \$.25/hr for mason tender	24.14	13.45	37.59
302	Asbestos Abatement Worker	23.96	12.88	36.84
303	Landscaper	17.00	6.36	23.36
310	Gas or Utility Pipeline Laborer (Other Than Sewer and Water)	20.39	12.20	32.59
311	Fiber Optic Laborer (Outside, Other Than Concrete Encased)	16.51	0.00	16.51
314	Railroad Track Laborer	14.00	4.77	18.77

**HEAVY EQUIPMENT OPERATORS
SITE PREPARATION, UTILITY OR LANDSCAPING WORK ONLY**

Fringe Benefits Must Be Paid On <u>All</u> Hours Worked				
<u>CODE</u>	<u>TRADE OR OCCUPATION</u>	<u>HOURLY BASIC RATE OF PAY</u> \$	<u>HOURLY FRINGE BENEFITS</u> \$	<u>TOTAL</u> \$
501	Air Track, Rotary or Percussion Drilling Machine &/or Hammers, Blaster; Asphalt Milling Machine; Boring Machine (Directional, Horizontal or Vertical); Backhoe (Track Type) Having a Mfgr's Rated Capacity of 130,000 Lbs. or Over; Backhoe (Track Type) Having a Mfgr's Rated Capacity of Under 130,000 Lbs., Backhoe (Mini, 15,000 Lbs. & Under); Bulldozer or Endloader (Over 40 hp); Compactor (Self-Propelled 85 Ft Total Drum Width & Over, or Tractor Mounted, Towed & Light Equipment); Concrete Batch Plant, Batch Hopper; Concrete Breaker (Large, Auto, Vibratory/Sonic, Manual or Remote); Crane, Shovel, Dragline, Clamshells; Forklift (Machinery Moving or Steel Erection, 25 Ft & Over); Gradall (Cruz-Aire Type); Grader or Motor Patrol; Master Mechanic; Mechanic or Welder; Robotic Tool Carrier (With or Without Attachments); Scraper (Self Propelled or Tractor Drawn) 5 cu yds or More Capacity; Tractor or Truck Mounted Hydraulic Backhoe; Tractor or Truck Mounted Hydraulic Crane (10 Tons or Under); Tractor (Scraper, Dozer, Pusher, Loader); Trencher (Wheel Type or Chain Type Having Over 8 Inch Bucket). Future Increase(s): Add \$1/hr on 6/3/2012; Add \$1/hr on 6/2/2013.	32.42	17.98	50.40
502	Backfiller; Broom or Sweeper; Bulldozer or Endloader (Under 40 hp); Environmental Burner; Forestry Equipment, Timbco, Tree Shear, Tub Grinder, Processor; Jeep Digger; Screed (Milling Machine); Skid Rig; Straddle Carrier or Travel Lift; Stump Chipper; Trencher (Wheel Type or Chain Type Having 8 Inch Bucket & Under).	31.89	14.44	46.33
503	Air Compressor (&/or 400 CFM or Over); Augers (Vertical & Horizontal); Compactor (Self-Propelled 84 Ft Total Drum Width & Under, or Tractor Mounted, Towed & Light Equipment); Crusher, Screening or Wash Plant; Farm or Industrial Type Tractor; Forklift; Generator (&/or 150 KW or Over); Greaser; High Pressure Utility Locating Machine (Daylighting Machine); Mulcher; Oiler; Post Hole Digger or Driver; Pump (3 Inch or Over) or Well Points; Refrigeration Plant or Freeze Machine; Rock, Stone Breaker; Skid Steer Loader (With or Without Attachments); Vibratory Hammer or Extractor, Power Pack. Future Increase(s): Add \$1/hr on 6/3/2012; Add \$1/hr on 6/2/2013.	31.89	17.98	49.87
504	Work Performed on the Great Lakes Including Diver; Wet Tender or Hydraulic Dredge Engineer.	36.20	18.81	55.01
505	Work Performed on the Great Lakes Including Crane or Backhoe Operator; Assistant Hydraulic Dredge Engineer; Hydraulic Dredge Leverman or Diver's Tender; Mechanic or Welder; 70 Ton & Over Tug Operator. Premium Increase(s): Add \$.50/hr for friction crane, lattice boom or crane certification (CCO).	37.45	19.45	56.90

Fringe Benefits Must Be Paid On <u>All</u> Hours Worked				
<u>CODE</u>	<u>TRADE OR OCCUPATION</u>	<u>HOURLY BASIC RATE OF PAY</u>	<u>HOURLY FRINGE BENEFITS</u>	<u>TOTAL</u>
		\$	\$	\$
506	Work Performed on the Great Lakes Including Deck Equipment Operator or Machineryman (Maintains Cranes Over 50 Tons or Backhoes 115,000 Lbs. or More); Tug, Launch or Loader, Dozer or Like Equipment When Operated on a Barge, Breakwater Wall, Slip, Dock or Scow, Deck Machinery.	26.80	18.52	45.32
507	Work Performed on the Great Lakes Including Deck Equipment Operator, Machineryman or Fireman (Operates 4 Units or More or Maintains Cranes 50 Tons or Under or Backhoes 115,000 Lbs. or Under); Deck Hand, Deck Engineer or Assistant Tug Operator; Off-Road Trucks - Great Lakes ONLY.	27.75	19.15	46.90

**HEAVY EQUIPMENT OPERATORS
EXCLUDING SITE PREPARATION, UTILITY, PAVING LANDSCAPING WORK**

Fringe Benefits Must Be Paid On <u>All</u> Hours Worked				
<u>CODE</u>	<u>TRADE OR OCCUPATION</u>	<u>HOURLY BASIC RATE OF PAY</u>	<u>HOURLY FRINGE BENEFITS</u>	<u>TOTAL</u>
		\$	\$	\$
508	Boring Machine (Directional); Crane, Tower Crane, Pedestal Tower or Derrick, With or Without Attachments, With a Lifting Capacity of Over 100 Tons, Self-Erecting Tower Crane With a Lifting Capacity of Over 4,000 Lbs., Crane With Boom Dollies; Crane, Tower Crane, Pedestal Tower or Derrick, With Boom, Leads &/or Jib Lengths Measuring 176 Ft or Over; Master Mechanic. Future Increase(s): Add \$1/hr on 6/3/2012; Add \$1/hr on 6/2/2013. Premium Increase(s): Add \$.50/hr at 200 ton; Add \$1.00/hr. at 300 ton; Add \$1.50/hr at 400 ton; Add \$2.00/hr at 500 ton.	34.62	17.98	52.60
509	Backhoe (Track Type) Having a Mfgr's Rated Capacity of 130,000 Lbs. or Over; Boring Machine (Horizontal or Vertical); Caisson Rig; Crane, Tower Crane, Portable Tower, Pedestal Tower or Derrick, With or Without Attachments, With a Lifting Capacity of 100 Tons or Under, Self-Erecting Tower Crane With A Lifting Capacity Of 4,000 Lbs. & Under; Crane, Tower Crane, Portable Tower, Pedestal Tower or Derrick, With Boom, Leads &/or Jib Lengths Measuring 175 Ft or Under; Pile Driver; Versl Lifts, Tri-Lifts & Gantrys (20,000 Lbs. & Over). Future Increase(s): Add \$1/hr on 6/3/2012; Add \$1/hr on 6/2/2013. Premium Increase(s): Add \$.25/hr for cranes with lifting capacity of 45 ton or over.	33.62	17.98	51.60
510	Backhoe (Track Type) Having a Mfgr.'s Rated Capacity of Under 130,000 Lbs., Backhoe (Mini, 15,000 Lbs. & Under); Concrete Bump Cutter, Grinder, Planing or Grooving Machine; Concrete Laser/Screed; Concrete Paver (Slipform); Concrete Pump (Over 46 Meter), Concrete Conveyor (Rotec or Bidwell Type); Concrete Slipform Placer Curb & Gutter Machine; Concrete Spreader & Distributor; Dredge (NOT Performing Work on the Great Lakes); Forklift (Machinery Moving or Steel Erection, 25 Ft & Over); Gradall (Cruz-Aire Type); Hydro-Blaster (10,000 PSI or Over); Milling Machine; Skid Rig; Travelling Crane (Bridge Type). Future Increase(s): Add \$1/hr on 6/3/2012; Add \$1/hr on 6/2/2013.	32.42	17.98	50.40

Fringe Benefits Must Be Paid On <u>All</u> Hours Worked		HOURLY BASIC RATE OF PAY	HOURLY FRINGE BENEFITS	TOTAL
CODE	TRADE OR OCCUPATION	\$	\$	\$
511	Air, Track, Rotary or Percussion Drilling Machine &/or Hammers, Blaster; Bulldozer or Endloader (Over 40 hp); Compactor (Self-Propelled 85 Ft Total Drum Width & Over, or Tractor Mounted, Towed & Light Equipment); Concrete Pump (46 Meter & Under), Concrete Conveyor (Rotec or Bidwell Type); Crane (Carry Deck, Mini) or Truck Mounted Hydraulic Crane (10 Tons or Under); Environmental Burner; Gantrys (Under 20,000 Lbs.); Grader or Motor Patrol; High Pressure Utility Locating Machine (Daylighting Machine); Manhoist; Material or Stack Hoist; Mechanic or Welder; Railroad Track Rail Leveling Machine, Tie Placer, Extractor, Tamper, Stone Leveler or Rehabilitation Equipment; Roller (Over 5 Ton); Scraper (Self Propelled or Tractor Drawn) 5 cu yd or More Capacity; Screed (Milling Machine); Sideboom; Straddle Carrier or Travel Lift; Tining or Curling Machine; Tractor (Scraper, Dozer, Pusher, Loader); Tractor or Truck Mounted Hydraulic Backhoe; Tractor or Truck Mounted Hydraulic Crane (10 Tons or Under); Trencher (Wheel Type or Chain Type Having Over 8-Inch Bucket). Future Increase(s): Add \$1/hr on 6/3/2012; Add \$1/hr on 6/2/2013.	31.89	17.98	49.87
512	Backfiller; Broom or Sweeper; Bulldozer or Endloader (Under 40 hp); Compactor (Self-Propelled 84 Ft Total Drum Width & Under, or Tractor Mounted, Towed & Light Equipment); Concrete Batch Plant, Batch Hopper; Concrete Breaker (Large, Auto, Vibratory/Sonic, Manual or Remote); Concrete Conveyor System; Concrete Finishing Machine (Road Type); Fireman (Pile Driver & Derrick NOT Performing Work on the Great Lakes); Grout Pump; Hoist (Tugger, Automatic); Industrial Locomotives; Jeep Digger; Lift Slab Machine; Mulcher; Robotic Tool Carrier (With or Without Attachments); Roller (Rubber Tire, 5 Ton or Under); Screw or Gypsum Pumps; Stabilizing or Concrete Mixer (Self-Propelled or 14S or Over); Stump Chipper; Trencher (Wheel Type or Chain Type Having 8-Inch Bucket & Under); Winches & A-Frames.	35.59	19.10	54.69
513	Air Compressor (&/or 400 CFM or Over); Air, Electric or Hydraulic Jacking System; Augers (Vertical & Horizontal); Boatmen (NOT Performing Work on the Great Lakes); Boiler (Temporary Heat); Crusher, Screening or Wash Plant; Elevator; Farm or Industrial Type Tractor; Fireman (Asphalt Plant NOT Performing Work on the Great Lakes); Forklift; Generator (&/or 150 KW or Over); Greaser; Heaters (Mechanical); Loading Machine (Conveyor); Oiler; Post Hole Digger or Driver; Prestress Machine; Pump (3 Inch or Over) or Well Points; Refrigeration Plant or Freeze Machine; Rock, Stone Breaker; Skid Steer Loader (With or Without Attachments); Vibratory Hammer or Extractor, Power Pack. Future Increase(s): Add \$1/hr on 6/3/2012; Add \$1/hr on 6/2/2013.	29.19	17.98	47.17
514	Gas or Utility Pipeline, Except Sewer & Water (Primary Equipment). Future Increase(s): Add \$2/hr. on 1/1/2013.	34.89	19.68	54.57
515	Gas or Utility Pipeline, Except Sewer & Water (Secondary Equipment).	30.32	17.40	47.72
516	Fiber Optic Cable Equipment	22.00	7.27	29.27

SEWER, WATER OR TUNNEL CONSTRUCTION

Includes those projects that primarily involve public sewer or water distribution, transmission or collection systems and related tunnel work (excluding buildings).

SKILLED TRADES

Fringe Benefits Must Be Paid On <u>All</u> Hours Worked				
<u>CODE</u>	<u>TRADE OR OCCUPATION</u>	<u>HOURLY BASIC RATE OF PAY</u> \$	<u>HOURLY FRINGE BENEFITS</u> \$	<u>TOTAL</u> \$
103	Bricklayer, Blocklayer or Stonemason	32.66	16.20	48.86
105	Carpenter Premium Increase(s): DOT PREMIUM: Pay two times the hourly basic rate on Sunday, New Year's Day, Memorial Day, Independence Day, Labor Day, Thanksgiving Day & Christmas Day.	33.43	19.31	52.74
107	Cement Finisher Future Increase(s): Add \$1.86 on 6/1/12; Add \$1.87 on 6/1/13; Add \$1.87 on 6/1/14; Add \$1.87 on 6/1/15; Add \$1.75 on 6/1/16. Premium Increase(s): DOT PREMIUMS: 1) Pay two times the hourly basic rate on Sunday, New Year's Day, Memorial Day, Independence Day, Labor Day, Thanksgiving Day & Christmas Day. 2) Add \$1.40/hr when the Wisconsin Department of Transportation or responsible governing agency requires that work be performed at night under artificial illumination with traffic control and the work is completed after sunset and before sunrise.	30.68	15.68	46.36
109	Electrician Future Increase(s): Add \$1.40/hr on 6/1/2012. Add \$1.60/hr on 6/1/2013. Premium Increase(s): DOT PREMIUM: Pay two times the hourly basic rate on Sunday, New Year's Day, Memorial Day, Independence Day, Labor Day, Thanksgiving Day & Christmas Day.	31.54	20.95	52.49
111	Fence Erector	25.50	0.26	25.76
116	Ironworker Premium Increase(s): DOT PREMIUM: Pay two times the hourly basic rate on Sunday, New Year's Day, Memorial Day, Independence Day, Labor Day, Thanksgiving Day & Christmas Day.	31.31	22.22	53.53
118	Line Constructor (Electrical)	35.97	18.08	54.05
125	Pavement Marking Operator	26.00	0.00	26.00
126	Piledriver	29.56	15.16	44.72
130	Plumber	36.20	15.02	51.22
135	Steamfitter	39.90	15.76	55.66
137	Teledata Technician or Installer	21.26	6.99	28.25

Fringe Benefits Must Be Paid On All Hours Worked

<u>CODE</u>	<u>TRADE OR OCCUPATION</u>	<u>HOURLY BASIC RATE OF PAY</u> \$	<u>HOURLY FRINGE BENEFITS</u> \$	<u>TOTAL</u> \$
143	Tuckpointer, Caulker or Cleaner	22.00	9.75	31.75
144	Underwater Diver (Except on Great Lakes)	36.20	18.81	55.01
146	Well Driller or Pump Installer	24.22	14.80	39.02
150	Heavy Equipment Operator - ELECTRICAL LINE CONSTRUCTION ONLY	32.37	16.48	48.85
151	Light Equipment Operator -ELECTRICAL LINE CONSTRUCTION ONLY	28.78	15.16	43.94
152	Heavy Truck Driver - ELECTRICAL LINE CONSTRUCTION ONLY	17.80	9.00	26.80
153	Light Truck Driver - ELECTRICAL LINE CONSTRUCTION ONLY	23.38	12.48	35.86
154	Groundman - ELECTRICAL LINE CONSTRUCTION ONLY	21.30	10.97	32.27

TRUCK DRIVERS

Fringe Benefits Must Be Paid On All Hours Worked

<u>CODE</u>	<u>TRADE OR OCCUPATION</u>	<u>HOURLY BASIC RATE OF PAY</u> \$	<u>HOURLY FRINGE BENEFITS</u> \$	<u>TOTAL</u> \$
201	Single Axle or Two Axle	23.00	8.64	31.64
203	Three or More Axle	21.17	9.51	30.68
204	Articulated, Euclid, Dumptor, Off Road Material Hauler Future Increase(s): Add \$1.75/hr on 6/1/2012; Add \$1.85/hr on 6/1/2013. Premium Increase(s): DOT PREMIUM: Pay two times the hourly basic rate on Sunday, New Year's Day, Memorial Day, Independence Day, Labor Day, Thanksgiving Day & Christmas Day.	22.50	16.19	38.69
205	Pavement Marking Vehicle	19.25	10.84	30.09
207	Truck Mechanic	21.17	9.51	30.68

LABORERS

Fringe Benefits Must Be Paid On All Hours Worked

<u>CODE</u>	<u>TRADE OR OCCUPATION</u>	<u>HOURLY BASIC RATE OF PAY</u> \$	<u>HOURLY FRINGE BENEFITS</u> \$	<u>TOTAL</u> \$
301	General Laborer Future Increase(s): Add \$.70/hr. on 06/04/2012; Add \$.80/hr. on 06/03/2013 Premium Increase(s): Add \$.20 for blaster, bracer, manhole builder, caulker, bottomman and power tool; Add \$.55 for pipelayer; Add \$1.00 for tunnel work 0-15 lbs. compressed air; Add \$2.00 for over 15-30 lbs. compressed air; Add \$3.00 for over 30 lbs. compressed air.	25.28	13.44	38.72

Fringe Benefits Must Be Paid On All Hours Worked

<u>CODE</u>	<u>TRADE OR OCCUPATION</u>	<u>HOURLY BASIC RATE OF PAY</u> \$	<u>HOURLY FRINGE BENEFITS</u> \$	<u>TOTAL</u> \$
303	Landscaper	17.00	6.36	23.36
304	Flagperson or Traffic Control Person	12.00	17.89	29.89
311	Fiber Optic Laborer (Outside, Other Than Concrete Encased)	16.51	0.00	16.51
314	Railroad Track Laborer	14.00	4.77	18.77

**HEAVY EQUIPMENT OPERATORS
SEWER, WATER OR TUNNEL WORK**

Fringe Benefits Must Be Paid On All Hours Worked

<u>CODE</u>	<u>TRADE OR OCCUPATION</u>	<u>HOURLY BASIC RATE OF PAY</u> \$	<u>HOURLY FRINGE BENEFITS</u> \$	<u>TOTAL</u> \$
521	Backhoe (Track Type) Having a Mfgr.'s Rated Capacity of 130,000 Lbs. or Over; Caisson Rig; Crane, Tower Crane, Pedestal Tower or Derrick, With Boom, Leads &/or Jib Lengths Measuring 176 Ft or Over; Crane, Tower Crane, Pedestal Tower or Derrick, With or Without Attachments, With a Lifting Capacity of Over 100 Tons, Self-Erecting Tower Crane With a Lifting Capacity Of Over 4,000 Lbs., Crane With Boom Dollies; Master Mechanic; Pile Driver. Future Increase(s): Add \$1/hr on 6/3/2012; Add \$1/hr on 6/2/2013. Premium Increase(s): Add \$.25/hr for cranes with lifting capacity of 45 ton or over.	33.62	17.98	51.60
522	Backhoe (Track Type) Having a Mfgr.'s Rated Capacity of Under 130,000 Lbs., Backhoe (Mini, 15,000 Lbs. & Under); Boring Machine (Directional); Concrete Bump Cutter, Grinder, Planing or Grooving Machine; Concrete Laser/Screeed; Concrete Paver (Slipform); Concrete Pump (Over 46 Meter), Concrete Conveyor (Rotec or Bidwell Type); Concrete Spreader & Distributor; Crane, Tower Crane, Portable Tower, Pedestal Tower or Derrick, With Boom, Leads &/or Jib Lengths Measuring 175 Ft or Under; Crane, Tower Crane, Portable Tower, Pedestal Tower or Derrick, With or Without Attachments, With a Lifting Capacity of 100 Tons or Under, Self-Erecting Tower Crane With a Lifting Capacity of 4,000 Lbs. & Under; Dredge (NOT Performing Work on the Great Lakes); Milling Machine; Skid Rig; Telehandler; Traveling Crane (Bridge Type). Future Increase(s): Add \$1/hr on 6/3/2012; Add \$1/hr on 6/2/2013.	32.42	17.98	50.40

Fringe Benefits Must Be Paid On <u>All</u> Hours Worked				
<u>CODE</u>	<u>TRADE OR OCCUPATION</u>	<u>HOURLY BASIC RATE OF PAY</u> \$	<u>HOURLY FRINGE BENEFITS</u> \$	<u>TOTAL</u> \$
523	Air Track, Rotary or Percussion Drilling Machine &/or Hammers, Blaster; Boring Machine (Horizontal or Vertical); Bulldozer or Endloader (Over 40 hp); Crane (Carry Deck, Mini) or Truck Mounted Hydraulic Crane (10 Tons or Under); Concrete Pump (46 Meter & Under), Concrete Conveyor (Rotec or Bidwell Type); Concrete Slipform-Placer Curb & Gutter Machine; Gradall (Cruz-Aire Type); Grader or Motor Patrol; Hydro-Blaster (10,000 PSI or Over); Manhole; Material or Stack Hoist; Mechanic or Welder; Roller (Over 5 Ton); Scraper (Self Propelled or Tractor Drawn) 5 cu yd or More Capacity; Screed (Milling Machine); Slideboom; Straddle Carrier or Travel Lift; Tractor (Scraper, Dozer, Pusher, Loader); Tractor or Truck Mounted Hydraulic Backhoe; Tractor or Truck Mounted Hydraulic Crane (10 Tons or Under); Trencher (Wheel Type or Chain Type Having Over 8-Inch Bucket). Future Increase(s): Add \$1/hr on 6/3/2012; Add \$1/hr on 6/2/2013.	31.89	17.98	49.87
524	Backfiller; Broom or Sweeper; Bulldozer or Endloader (Under 40 hp); Compactor (Self-Propelled 85 Ft Total Drum Width & Over, or Tractor Mounted, Towed & Light Equipment); Concrete Batch Plant, Batch Hopper; Concrete Breaker (Large, Auto, Vibratory/Sonic, Manual or Remote); Concrete Conveyor System; Concrete Finishing Machine (Road Type); Environmental Burner; Fireman (Pile Driver & Derrick NOT Performing Work on the Great Lakes); Forestry Equipment, Timbco, Tree Shear, Tub Grinder, Processor; Hoist (Tugger, Automatic); Grout Pump; Jeep Digger; Lift Slab Machine; Mulcher; Power Subgrader; Pump (3 Inch or Over) or Well Points; Robotic Tool Carrier (With or Without Attachments); Roller (Rubber Tire, 5 Ton or Under); Screw or Gypsum Pumps; Stabilizing or Concrete Mixer (Self-Propelled or 14S or Over); Stump Chipper; Tining or Curling Machine; Trencher (Wheel Type or Chain Type Having 8-Inch Bucket & Under); Winches & A-Frames.	30.89	17.16	48.05
525	Air Compressor (&/or 400 CFM or Over); Air, Electric or Hydraulic Jacking System; Augers (Vertical & Horizontal); Compactor (Self-Propelled 84 Ft Total Drum Width & Under, or Tractor Mounted, Towed & Light Equipment); Crusher, Screening or Wash Plant; Farm or Industrial Type Tractor; Fireman (Asphalt Plant NOT Performing Work on the Great Lakes); Generator (&/or 150 KW or Over); Heaters (Mechanical); High Pressure Utility Locating Machine (Daylighting Machine); Loading Machine (Conveyor); Post Hole Digger or Driver; Refrigeration Plant or Freeze Machine; Rock, Stone Breaker; Skid Steer Loader (With or Without Attachments); Vibratory Hammer or Extractor, Power Pack. Future Increase(s): Add \$1/hr on 6/3/2012; Add \$1/hr on 6/2/2013.	29.19	17.98	47.17
526	Boiler (Temporary Heat); Forklift; Greaser; Oiler.	29.19	17.96	47.15
527	Work Performed on the Great Lakes Including Diver; Wet Tender or Hydraulic Dredge Engineer.	36.20	18.81	55.01
528	Work Performed on the Great Lakes Including 70 Ton & Over Tug Operator; Assistant Hydraulic Dredge Engineer; Crane or Backhoe Operator; Hydraulic Dredge Leverman or Diver's Tender; Mechanic or Welder.	36.20	18.81	55.01

Fringe Benefits Must Be Paid On <u>All</u> Hours Worked				
<u>CODE</u>	<u>TRADE OR OCCUPATION</u>	<u>HOURLY BASIC RATE OF PAY</u>	<u>HOURLY FRINGE BENEFITS</u>	<u>TOTAL</u>
		\$	\$	\$
529	Work Performed on the Great Lakes Including Deck Equipment Operator or Machineryman (Maintains Cranes Over 50 Tons or Backhoes 115,000 Lbs. or More); Tug, Launch or Loader, Dozer or Like Equipment When Operated on a Barge, Breakwater Wall, Slip, Dock or Scow, Deck Machinery.	26.80	18.52	45.32
530	Work Performed on the Great Lakes Including Deck Equipment Operator; Machineryman or Fireman (Operates 4 Units or More or Maintains Cranes 50 Tons or Under or Backhoes 115,000 Lbs. or Under), Deck Hand, Deck Engineer or Assistant Tug Operator; Off Road Trucks - Great Lakes ONLY.	26.80	18.52	45.32

AIRPORT PAVEMENT OR STATE HIGHWAY CONSTRUCTION

Includes all airport projects (excluding buildings) and all projects awarded by the Wisconsin Department of Transportation (excluding buildings).

SKILLED TRADES

CODE	TRADE OR OCCUPATION	Fringe Benefits Must Be Paid On <u>All</u> Hours Worked		
		HOURLY BASIC RATE OF PAY \$	HOURLY FRINGE BENEFITS \$	TOTAL \$
103	Bricklayer, Blocklayer or Stonemason	32.66	15.92	48.58
105	Carpenter	30.23	15.16	45.39
107	Cement Finisher Future Increase(s): Add \$1.86 on 6/1/12; Add \$1.87 on 6/1/13; Add \$1.87 on 6/1/14; Add \$1.87 on 6/1/15; Add \$1.75 on 6/1/16. Premium Increase(s): DOT PREMIUMS: 1) Pay two times the hourly basic rate on Sunday, New Year's Day, Memorial Day, Independence Day, Labor Day, Thanksgiving Day & Christmas Day. 2) Add \$1.40/hr when the Wisconsin Department of Transportation or responsible governing agency requires that work be performed at night under artificial illumination with traffic control and the work is completed after sunset and before sunrise.	30.68	15.68	46.36
109	Electrician	37.25	14.68	51.93
111	Fence Erector	35.62	0.00	35.62
116	Ironworker	30.90	19.11	50.01
118	Line Constructor (Electrical)	35.97	18.08	54.05
124	Painter	28.00	11.15	39.15
125	Pavement Marking Operator	26.65	14.92	41.57
126	Piledriver	29.56	15.16	44.72
133	Roofer or Waterproofing	28.06	0.00	28.06
137	Teledata Technician or Installer	21.26	6.99	28.25
143	Tuckpointer, Caulker or Cleaner	22.00	9.75	31.75
144	Underwater Diver (Except on Great Lakes)	36.20	18.81	55.01
150	Heavy Equipment Operator - ELECTRICAL LINE CONSTRUCTION ONLY	35.42	12.90	48.32
151	Light Equipment Operator -ELECTRICAL LINE CONSTRUCTION ONLY	35.50	14.27	49.77
152	Heavy Truck Driver - ELECTRICAL LINE CONSTRUCTION ONLY	25.18	14.07	39.25
153	Light Truck Driver - ELECTRICAL LINE CONSTRUCTION ONLY	23.38	12.48	35.86

154	Groundman - ELECTRICAL LINE CONSTRUCTION ONLY	21.30	10.97	32.27
-----	---	-------	-------	-------

TRUCK DRIVERS

Fringe Benefits Must Be Paid On All Hours Worked

<u>CODE</u>	<u>TRADE OR OCCUPATION</u>	<u>HOURLY BASIC RATE OF PAY</u> \$	<u>HOURLY FRINGE BENEFITS</u> \$	<u>TOTAL</u> \$
201	Single Axle or Two Axle Future Increase(s): Add \$1.75/hr on 6/1/2012; Add \$1.85/hr on 6/1/2013. Premium Increase(s): DOT PREMIUM: Pay two times the hourly basic rate on Sunday, New Year's Day, Memorial Day, Independence Day, Labor Day, Thanksgiving Day & Christmas Day.	22.35	16.19	38.54
203	Three or More Axle Future Increase(s): Add \$1.75/hr on 6/1/2012; Add \$1.85/hr on 6/1/2013. Premium Increase(s): DOT PREMIUM: Pay two times the hourly basic rate on Sunday, New Year's Day, Memorial Day, Independence Day, Labor Day, Thanksgiving Day & Christmas Day.	22.50	16.19	38.69
204	Articulated, Euclid, Dumptor, Off Road Material Hauler	24.91	15.63	40.54
205	Pavement Marking Vehicle	23.84	14.76	38.60
206	Shadow or Pilot Vehicle	24.76	15.35	40.11
207	Truck Mechanic	24.91	15.35	40.26

LABORERS

Fringe Benefits Must Be Paid On All Hours Worked

CODE	TRADE OR OCCUPATION	HOURLY BASIC RATE OF PAY \$	HOURLY FRINGE BENEFITS \$	TOTAL \$
301	General Laborer Future Increase(s): Add \$1.60/hr on 6/1/2012; Add \$1.70/hr on 6/1/2013; Add \$1.60/hr on 6/1/2014. Premium Increase(s): Add \$.10/hr for topman, air tool operator, vibrator or tamper operator (mechanical hand operated), chain saw operator and demolition burning torch laborer; Add \$.15/hr for bituminous worker (raker and luteman), formsetter (curb, sidewalk and pavement) and strike off man; Add \$.20/hr for blaster and powderman; Add \$.25/hr for bottomman; Add \$.35/hr for line and grade specialist; Add \$.45/hr for pipelayer. / DOT PREMIUMS: 1) Pay two times the hourly basic rate on Sunday, New Year's Day, Memorial Day, Independence Day, Labor Day, Thanksgiving Day & Christmas Day. 2) Add \$1.25/hr for work on projects involving temporary traffic control setup, for lane and shoulder closures, when work under artificial illumination conditions is necessary as required by the project provisions (including prep time prior to and/or cleanup after such time period).	27.20	13.45	40.65
302	Asbestos Abatement Worker	23.96	12.88	36.84
303	Landscaper Future Increase(s): Add \$1.60/hr on 6/1/12; Add \$1.70/hr on 6/1/13; Add \$1.60/hr on 6/1/14. Premium Increase(s): DOT PREMIUMS: 1) Pay two times the hourly basic rate on Sunday, New Year's Day, Memorial Day, Independence Day, Labor Day, Thanksgiving Day & Christmas Day. 2) Add \$1.25/hr for work on projects involving temporary traffic control setup, for lane and shoulder closures, when work under artificial illumination conditions is necessary as required by the project provisions (including prep time prior to and/or cleanup after such time period).	27.20	13.45	40.65
304	Flagperson or Traffic Control Person Future Increase(s): Add \$1.60/hr on 6/1/2012; Add \$1.70/hr on 6/1/2013; Add \$1.60/hr on 6/1/2014. Premium Increase(s): DOT PREMIUMS: 1) Pay two times the hourly basic rate on Sunday, New Year's Day, Memorial Day, Independence Day, Labor Day, Thanksgiving Day & Christmas Day. 2) Add \$1.25/hr when the Wisconsin Department of Transportation or responsible governing agency requires that work be performed at night under artificial illumination with traffic control and the work is completed after sunset and before sunrise.	23.55	13.45	37.00

Fringe Benefits Must Be Paid On All Hours Worked

<u>CODE</u>	<u>TRADE OR OCCUPATION</u>	<u>HOURLY BASIC RATE OF PAY</u> \$	<u>HOURLY FRINGE BENEFITS</u> \$	<u>TOTAL</u> \$
311	Fiber Optic Laborer (Outside, Other Than Concrete Encased)	16.51	0.00	16.51
314	Railroad Track Laborer	14.00	4.77	18.77

**HEAVY EQUIPMENT OPERATORS
AIRPORT PAVEMENT OR STATE HIGHWAY CONSTRUCTION**

Fringe Benefits Must Be Paid On All Hours Worked

<u>CODE</u>	<u>TRADE OR OCCUPATION</u>	<u>HOURLY BASIC RATE OF PAY</u> \$	<u>HOURLY FRINGE BENEFITS</u> \$	<u>TOTAL</u> \$
531	Crane, Tower Crane, Pedestal Tower or Derrick, With Boom, Leads &/or Jib Lengths Measuring 176 Ft or Over; Crane, Tower Crane, Pedestal Tower or Derrick, With or Without Attachments, With a Lifting Capacity of Over 100 Tons, Self-Erecting Tower Crane With a Lifting Capacity Of Over 4,000 Lbs., Crane With Boom Dollies; Traveling Crane (Bridge Type). Future Increase(s): Add \$2/hr on 6/1/12; Add \$2/hr on 6/1/13; Add \$1.75/hr on 6/1/14. Premium Increase(s): DOT PREMIUMS: 1) Pay two times the hourly basic rate on Sunday, New Year's Day, Memorial Day, Independence Day, Labor Day, Thanksgiving Day & Christmas Day. 2) Add \$1.25/hr for work on projects involving temporary traffic control setup, for lane and shoulder closures, when work under artificial illumination conditions is necessary as required by the project provisions (including prep time prior to and/or cleanup after such time period).	34.22	18.90	53.12
532	Backhoe (Track Type) Having a Mfgr.'s Rated Capacity of 130,000 Lbs. or Over; Caisson Rig; Crane, Tower Crane, Portable Tower, Pedestal Tower or Derrick, With Boom, Leads &/or Jib Lengths Measuring 175 Ft or Under; Crane, Tower Crane, Portable Tower, Pedestal Tower or Derrick, With or Without Attachments, With a Lifting Capacity of 100 Tons or Under, Self-Erecting Tower Crane With A Lifting Capacity Of 4,000 Lbs., & Under; Dredge (NOT Performing Work on the Great Lakes); Licensed Boat Pilot (NOT Performing Work on the Great Lakes); Pile Driver. Future Increase(s): Add \$2/hr on 6/1/12; Add \$2/hr on 6/1/13; Add \$1.75/hr on 6/1/14. Premium Increase(s): DOT PREMIUMS: 1) Pay two times the hourly basic rate on Sunday, New Year's Day, Memorial Day, Independence Day, Labor Day, Thanksgiving Day & Christmas Day. 2) Add \$1.25/hr for work on projects involving temporary traffic control setup, for lane and shoulder closures, when work under artificial illumination conditions is necessary as required by the project provisions (including prep time prior to and/or cleanup after such time period).	33.72	18.90	52.62

Fringe Benefits Must Be Paid On <u>All</u> Hours Worked		HOURLY BASIC RATE OF PAY	HOURLY FRINGE BENEFITS	TOTAL
CODE	TRADE OR OCCUPATION	\$	\$	\$
533	<p>Air Track, Rotary or Percussion Drilling Machine &/or Hammers, Blaster; Asphalt Heater, Planer & Scarifier; Asphalt Milling Machine; Asphalt Screed; Automatic Subgrader (Concrete); Backhoe (Track Type) Having a Mfg.'s Rated Capacity of Under 130,000 Lbs.; Backhoe (Mini, 15,000 Lbs. & Under); Bituminous (Asphalt) Plant & Paver, Screed; Boatmen (NOT Performing Work on the Great Lakes); Boring Machine (Directional, Horizontal or Vertical); Bridge (Bidwell) Paver; Bulldozer or Endloader; Concrete Batch Plant, Batch Hopper; Concrete Breaker (Large, Auto, Vibratory/Sonic, Manual or Remote); Concrete Bump Cutter, Grinder, Planing or Grooving Machine; Concrete Conveyor System; Concrete Laser/Screed; Concrete Paver (Slipform); Concrete Pump, Concrete Conveyor (Rotec or Bidwell Type); Concrete Slipform Placer Curb & Gutter Machine; Concrete Spreader & Distributor; Crane (CARRY Deck, Mini) or Truck Mounted Hydraulic Crane (10 Tons or Under); Crane With a Lifting Capacity of 25 Tons or Under; Forestry Equipment, Timbco, Tree Shear, Tub Grinder, Processor; Gradall (Cruz-Aire Type); Grader or Motor Patrol; Grout Pump; Hydro-Blaster (10,000 PSI or Over); Loading Machine (Conveyor); Material or Stack Hoist; Mechanic or Welder; Milling Machine; Post Hole Digger or Driver; Roller (Over 5 Ton); Scraper (Self Propelled or Tractor Drawn) 5 cu yds or More Capacity; Shoulder Widener; Sideboom; Skid Rig; Stabilizing or Concrete Mixer (Self-Propelled or 14S or Over); Straddle Carrier or Travel Lift; Tractor (Scraper, Dozer, Pusher, Loader); Tractor or Truck Mounted Hydraulic Backhoe; Trencher (Wheel Type or Chain Type); Tube Finisher; Tugger (NOT Performing Work on the Great Lakes); Winches & A-Frames.</p> <p>Future Increase(s): Add \$2/hr on 6/1/12; Add \$2/hr on 6/1/13; Add \$1.75/hr on 6/1/14.</p> <p>Premium Increase(s): DOT PREMIUMS: 1) Pay two times the hourly basic rate on Sunday, New Year's Day, Memorial Day, Independence Day, Labor Day, Thanksgiving Day & Christmas Day. 2) Add \$1.25/hr for work on projects involving temporary traffic control setup, for lane and shoulder closures, when work under artificial illumination conditions is necessary as required by the project provisions (including prep time prior to and/or cleanup after such time period).</p>	33.22	18.90	52.12

Fringe Benefits Must Be Paid On <u>All</u> Hours Worked				
<u>CODE</u>	<u>TRADE OR OCCUPATION</u>	<u>HOURLY BASIC RATE OF PAY</u> \$	<u>HOURLY FRINGE BENEFITS</u> \$	<u>TOTAL</u> \$
534	Belting, Burlap, Texturing Machine; Broom or Sweeper; Compactor (Self-Propelled or Tractor Mounted, Towed & Light Equipment); Concrete Finishing Machine (Road Type); Environmental Burner; Farm or Industrial Type Tractor; Fireman (Asphalt Plant, Pile Driver & Derrick NOT Performing Work on the Great Lakes); Forklift; Greaser; Hoist (Tugger, Automatic); Jeep Digger; Joint Sawyer (Multiple Blade); Launch (NOT Performing Work on the Great Lakes); Lift Slab Machine; Mechanical Float; Mulcher; Power Subgrader; Robotic Tool Carrier (With or Without Attachments); Roller (Rubber Tire, 5 Ton or Under); Self Propelled Chlp Spreader; Shouldering Machine; Skid Steer Loader (With or Without Attachments); Telehandler; Tining or Curing Machine. Future Increase(s): Add \$2/hr on 6/1/12; Add \$2/hr on 6/1/13; Add \$1.75/hr on 6/1/14. Premium Increase(s): DOT PREMIUMS: 1) Pay two times the hourly basic rate on Sunday, New Year's Day, Memorial Day, Independence Day, Labor Day, Thanksgiving Day & Christmas Day. 2) Add \$1.25/hr for work on projects involving temporary traffic control setup, for lane and shoulder closures, when work under artificial illumination conditions is necessary as required by the project provisions (including prep time prior to and/or cleanup after such time period).	32.96	18.90	51.86
535	Air Compressor (&/or 400 CFM or Over); Air, Electric or Hydraulic Jacking System; Augers (Vertical & Horizontal); Automatic Belt Conveyor & Surge Bin; Boiler (Temporary Heat); Concrete Proportioning Plant; Crusher, Screening or Wash Plant; Generator (&/or 150 KW or Over); Heaters (Mechanical); High Pressure Utility Locating Machine (Daylighting Machine); Mudjack; Oiler; Prestress Machine; Pug Mill; Pump (3 Inch or Over) or Well Points; Rock, Stone Breaker; Screed (Milling Machine); Stump Chipper; Tank Car Heaters; Vibratory Hammer or Extractor, Power Pack. Future Increase(s): Add \$2/hr on 6/1/12; Add \$2/hr on 6/1/13; Add \$1.75/hr on 6/1/14. Premium Increase(s): DOT PREMIUMS: 1) Pay two times the hourly basic rate on Sunday, New Year's Day, Memorial Day, Independence Day, Labor Day, Thanksgiving Day & Christmas Day. 2) Add \$1.25/hr for work on projects involving temporary traffic control setup, for lane and shoulder closures, when work under artificial illumination conditions is necessary as required by the project provisions (including prep time prior to and/or cleanup after such time period).	32.67	18.90	51.57
536	Fiber Optic Cable Equipment.	22.00	7.27	29.27
537	Work Performed on the Great Lakes Including Diver; Wet Tender or Hydraulic Dredge Engineer.	36.20	18.81	55.01

Fringe Benefits Must Be Paid On <u>All</u> Hours Worked				
<u>CODE</u>	<u>TRADE OR OCCUPATION</u>	<u>HOURLY BASIC RATE OF PAY</u> \$	<u>HOURLY FRINGE BENEFITS</u> \$	<u>TOTAL</u> \$
538	Work Performed on the Great Lakes Including 70 Ton & Over Tug Operator; Assistant Hydraulic Dredge Engineer; Crane or Backhoe Operator; Hydraulic Dredge Leverman or Diver's Tender; Mechanic or Welder.	36.20	18.81	55.01
539	Work Performed on the Great Lakes Including Deck Equipment Operator or Machineryman (Maintains Cranes Over 50 Tons or Backhoes 115,000 Lbs. or More); Tug, Launch or Loader, Dozer or Like Equipment When Operated on a Barge, Breakwater Wall, Slip, Dock or Scow, Deck Machinery.	26.80	18.52	45.32
540	Work Performed on the Great Lakes Including Deck Equipment Operator, Machineryman or Fireman (Operates 4 Units or More or Maintains Cranes 50 Tons or Under or Backhoes 115,000 Lbs. or Under); Deck Hand, Deck Engineer or Assistant Tug Operator; Off Road Trucks-Great Lakes ONLY.	26.80	18.52	45.32

LOCAL STREET OR MISCELLANEOUS PAVING CONSTRUCTION

Includes roads, streets, alleys, trails, bridges, paths, racetracks, parking lots and driveways (except residential or agricultural), public sidewalks or other similar projects (excluding projects awarded by the Wisconsin Department of Transportation).

SKILLED TRADES

Fringe Benefits Must Be Paid On All Hours Worked

<u>CODE</u>	<u>TRADE OR OCCUPATION</u>	<u>HOURLY BASIC RATE OF PAY</u> \$	<u>HOURLY FRINGE BENEFITS</u> \$	<u>TOTAL</u> \$
103	Bricklayer, Blocklayer or Stonemason	32.66	16.20	48.86
105	Carpenter	29.06	15.16	44.22
107	Cement Finisher Future Increase(s): Add \$1.86 on 6/1/12; Add \$1.87 on 6/1/13; Add \$1.87 on 6/1/14; Add \$1.87 on 6/1/15; Add \$1.75 on 6/1/16. Premium Increase(s): DOT PREMIUMS: 1) Pay two times the hourly basic rate on Sunday, New Year's Day, Memorial Day, Independence Day, Labor Day, Thanksgiving Day & Christmas Day. 2) Add \$1.40/hr when the Wisconsin Department of Transportation or responsible governing agency requires that work be performed at night under artificial illumination with traffic control and the work is completed after sunset and before sunrise.	30.68	15.68	46.36
109	Electrician Future Increase(s): Add \$.50/hr. effective 06/04/2012. Premium Increase(s): DOT PREMIUM: Pay two times the hourly basic rate on Sunday, New Year's Day, Memorial Day, Independence Day, Labor Day, Thanksgiving Day & Christmas Day.	28.74	17.86	46.60
111	Fence Erector	25.50	0.26	25.76
116	Ironworker	30.90	19.11	50.01
118	Line Constructor (Electrical)	35.97	18.08	54.05
124	Painter	25.65	14.11	39.76
125	Pavement Marking Operator	26.00	0.00	26.00
126	Piledriver	29.56	15.16	44.72
133	Roofer or Waterproofer	28.06	0.00	28.06
137	Teledata Technician or Installer	21.26	6.99	28.25
143	Tuckpointer, Caulker or Cleaner	22.00	9.75	31.75
144	Underwater Diver (Except on Great Lakes)	36.20	18.81	55.01
150	Heavy Equipment Operator - ELECTRICAL LINE CONSTRUCTION ONLY	35.42	12.90	48.32

Fringe Benefits Must Be Paid On <u>All</u> Hours Worked				
<u>CODE</u>	<u>TRADE OR OCCUPATION</u>	<u>HOURLY BASIC RATE OF PAY</u> \$	<u>HOURLY FRINGE BENEFITS</u> \$	<u>TOTAL</u> \$
151	Light Equipment Operator -ELECTRICAL LINE CONSTRUCTION ONLY Premium Increase(s): DOT PREMIUM: Pay two times the hourly basic rate on Sunday, New Year's Day, Memorial Day, Independence Day, Labor Day, Thanksgiving Day & Christmas Day.	29.64	14.64	44.28
152	Heavy Truck Driver - ELECTRICAL LINE CONSTRUCTION ONLY	25.18	13.07	38.25
153	Light Truck Driver - ELECTRICAL LINE CONSTRUCTION ONLY	23.38	12.48	35.86
154	Groundman - ELECTRICAL LINE CONSTRUCTION ONLY	21.30	10.97	32.27
TRUCK DRIVERS				

Fringe Benefits Must Be Paid On <u>All</u> Hours Worked				
<u>CODE</u>	<u>TRADE OR OCCUPATION</u>	<u>HOURLY BASIC RATE OF PAY</u> \$	<u>HOURLY FRINGE BENEFITS</u> \$	<u>TOTAL</u> \$
201	Single Axle or Two Axle	15.00	0.00	15.00
203	Three or More Axle	19.50	4.97	24.47
204	Articulated, Euclid, Dumptor, Off Road Material Hauler Future Increase(s): Add \$1/hr on 6/3/2012; Add \$1/hr on 6/2/2013.	31.89	17.98	49.87
205	Pavement Marking Vehicle	19.25	10.84	30.09
206	Shadow or Pilot Vehicle	15.00	0.00	15.00
207	Truck Mechanic	19.50	4.97	24.47
LABORERS				

Fringe Benefits Must Be Paid On <u>All</u> Hours Worked				
<u>CODE</u>	<u>TRADE OR OCCUPATION</u>	<u>HOURLY BASIC RATE OF PAY</u> \$	<u>HOURLY FRINGE BENEFITS</u> \$	<u>TOTAL</u> \$
301	General Laborer	26.15	12.29	38.44
303	Landscaper	23.71	15.07	38.78
304	Flagperson or Traffic Control Person	12.00	17.89	29.89
311	Fiber Optic Laborer (Outside, Other Than Concrete Encased)	16.51	0.00	16.51
314	Railroad Track Laborer	14.00	4.77	18.77

**HEAVY EQUIPMENT OPERATORS
CONCRETE PAVEMENT OR BRIDGE WORK**

Fringe Benefits Must Be Paid On <u>All</u> Hours Worked		HOURLY BASIC RATE OF PAY	HOURLY FRINGE BENEFITS	TOTAL
CODE	TRADE OR OCCUPATION	\$	\$	\$
541	Crane, Tower Crane, Pedestal Tower or Derrick, With or Without Attachments, With a Lifting Capacity of Over 100 Tons; Self-Erecting Tower Crane With a Lifting Capacity Of Over 4,000 Lbs., Crane With Boom Dollies; Crane, Tower Crane, Pedestal Tower or Derrick, With Boom, Leads &/or Jib Lengths Measuring 176 Ft or Over; Master Mechanic. Future Increase(s): Add \$2/hr on 6/1/12; Add \$2/hr on 6/1/13; Add \$1.75/hr on 6/1/14. Premium Increase(s): DOT PREMIUMS: 1) Pay two times the hourly basic rate on Sunday, New Year's Day, Memorial Day, Independence Day, Labor Day, Thanksgiving Day & Christmas Day. 2) Add \$1.25/hr for work on projects involving temporary traffic control setup, for lane and shoulder closures, when work under artificial illumination conditions is necessary as required by the project provisions. (Including prep time prior to and/or cleanup after such time period).	34.22	18.90	53.12
542	Backhoe (Track Type) Having a Mfgr.'s Rated Capacity of 130,000 Lbs. or Over; Caisson Rig; Crane, Tower Crane, Portable Tower, Pedestal Tower or Derrick, With or Without Attachments, With a Lifting Capacity of 100 Tons or Under, Self-Erecting Tower Crane With a Lifting Capacity of 4,000 Lbs. & Under; Crane, Tower Crane Portable Tower, Pedestal Tower or Derrick, With Boom, Leads &/or Jib Lengths Measuring 175 Ft or Under; Dredge (NOT Performing Work on the Great Lakes); Licensed Boat Pilot (NOT Performing Work on the Great Lakes); Pile Driver. Future Increase(s): Add \$2/hr on 6/1/12; Add \$2/hr on 6/1/13; Add \$1.75/hr on 6/1/14. Premium Increase(s): DOT PREMIUMS: 1) Pay two times the hourly basic rate on Sunday, New Year's Day, Memorial Day, Independence Day, Labor Day, Thanksgiving Day & Christmas Day. 2) Add \$1.25/hr for work on projects involving temporary traffic control setup, for lane and shoulder closures, when work under artificial illumination conditions is necessary as required by the project provisions. (Including prep time prior to and/or cleanup after such time period).	33.72	18.90	52.62

Fringe Benefits Must Be Paid On <u>All</u> Hours Worked		HOURLY BASIC RATE OF PAY	HOURLY FRINGE BENEFITS	TOTAL
CODE	TRADE OR OCCUPATION	\$	\$	\$

543	Air Track, Rotary or Percussion Drilling Machine &/or Hammers, Blaster; Automatic Subgrader (Concrete); Backhoe (Track Type) Having a Mfgr.'s Rated Capacity of Under 130,000 Lbs., Backhoe (Mini, 15,000 Lbs. & Under); Boring Machine (Directional, Horizontal or Vertical); Bridge (Bidwell) Paver; Bulldozer or Endloader; Concrete Batch Plant, Batch Hopper; Concrete Breaker (Large, Auto, Vibratory/Sonic, Manual or Remote); Concrete Bump Cutter, Grinder, Planing or Grooving Machine; Concrete Conveyor System; Concrete Laser/Screed; Concrete Paver (Slipform); Concrete Pump, Concrete Conveyor (Rotec or Bidwell Type); Concrete Slipform Placer Curb & Gutter Machine; Concrete Spreader & Distributor; Crane (Carry Deck, Mini) or Truck Mounted Hydraulic Crane (10 Tons or Under); Crane With a Lifting Capacity of 25 Tons or Under; Forestry Equipment, Timbco, Tree Shear, Tub Grinder, Processor; Gradall (Cruz-Aire Type); Grader or Motor Patrol; Grout Pump; Hydro-Blaster (10,000 PSI or Over); Loading Machine (Conveyor); Manhoist; Material or Stack Hoist; Mechanic or Welder; Milling Machine; Post Hole Digger or Driver; Scraper (Self Propelled or Tractor Drawn) 5 cu yds or More Capacity; Shoulder Widener; Sideboom; Skid Rig; Stabilizing or Concrete Mixer (Self-Propelled or 14S or Over); Straddle Carrier or Travel Lift; Tractor (Scraper, Dozer, Pusher, Loader); Tractor or Truck Mounted Hydraulic Backhoe; Trencher (Wheel Type or Chain Type); Tube Finisher; Tugger (NOT Performing Work on the Great Lakes); Winches & A-Frames.	33.22	18.90	52.12
-----	---	-------	-------	-------

Future Increase(s):
 Add \$2/hr on 6/1/12; Add \$2/hr on 6/1/13; Add \$1.75/hr on 6/1/14.

Premium Increase(s):
 DOT PREMIUMS: 1) Pay two times the hourly basic rate on Sunday, New Year's Day, Memorial Day, Independence Day, Labor Day, Thanksgiving Day & Christmas Day. 2) Add \$1.25/hr for work on projects involving temporary traffic control setup, for lane and shoulder closures, when work under artificial illumination conditions is necessary as required by the project provisions (including prep time prior to and/or cleanup after such time period).

Fringe Benefits Must Be Paid On <u>All</u> Hours Worked		HOURLY BASIC RATE OF PAY	HOURLY FRINGE BENEFITS	TOTAL
CODE	TRADE OR OCCUPATION	\$	\$	\$
544	Backfiller; Belting, Burlap, Texturing Machine; Broom or Sweeper; Compactor (Self-Propelled or Tractor Mounted, Towed & Light Equipment); Concrete Finishing Machine (Road Type); Environmental Burner; Farm or Industrial Type Tractor; Fireman (Pile Driver & Derrick NOT Performing Work on the Great Lakes); Forklift; Greaser; Jeep Digger; Joint Sawyer (Multiple Blade); Launch (NOT Performing Work on the Great Lakes); Lift Slab Machine; Mechanical Float; Mulcher; Power Subgrader; Robotic Tool Carrier (With or Without Attachments); Self Propelled Chip Spreader; Shouldering Machine; Skid Steer Loader (With or Without Attachments); Telehandler; Tining or Curing Machine. Future Increase(s): Add \$2/hr on 6/1/12; Add \$2/hr on 6/1/13; Add \$1.75/hr on 6/1/14. Premium Increase(s): DOT PREMIUMS: 1) Pay two times the hourly basic rate on Sunday, New Year's Day, Memorial Day, Independence Day, Labor Day, Thanksgiving Day & Christmas Day. 2) Add \$1.25/hr for work on projects involving temporary traffic control setup, for lane and shoulder closures, when work under artificial illumination conditions is necessary as required by the project provisions (including prep time prior to and/or cleanup after such time period).	33.22	18.90	52.12
545	Air Compressor (&/or 400 CFM or Over); Air, Electric or Hydraulic Jacking System; Automatic Belt Conveyor & Surge Bin; Boiler (Temporary Heat); Concrete Proportioning Plant; Crusher, Screening or Wash Plant; Generator (&/or 150 KW or Over); Heaters (Mechanical); High Pressure Utility Locating Machine (Daylighting Machine); Mudjack; Oiler; Prestress Machine; Pug Mill; Pump (3 Inch or Over) or Well Points; Rock, Stone Breaker; Screed (Milling Machine); Stump Chipper; Tank Car Heaters; Vibratory Hammer or Extractor, Power Pack.	30.42	17.58	48.00
546	Fiber Optic Cable Equipment.	22.00	7.27	29.27
547	Work Performed on the Great Lakes Including Diver; Wet Tender or Hydraulic Dredge Engineer.	36.20	18.81	55.01
548	Work Performed on the Great Lakes Including 70 Ton & Over Tug Operator; Assistant Hydraulic Dredge Engineer; Crane or Backhoe Operator; Hydraulic Dredge Leverman or Diver's Tender; Mechanic or Welder.	36.20	18.81	55.01
549	Work Performed on the Great Lakes Including Deck Equipment Operator or Machineryman (Maintains Cranes Over 50 Tons or Backhoes 115,000 Lbs. or more); Tug, Launch or Loader, Dozer or Like Equipment When Operated on a Barge, Breakwater Wall, Slip, Dock or Scow, Deck Machinery.	26.80	18.52	45.32
550	Work Performed on the Great Lakes Including Deck Equipment Operator; Machineryman or Fireman (Operates 4 Units or More or Maintains Cranes 50 Tons or Under or Backhoes 115,000 Lbs. or Under); Deck Hand, Deck Engineer or Assistant Tug Operator; Off Road Trucks - Great Lakes ONLY.	26.80	18.52	45.32

**HEAVY EQUIPMENT OPERATORS
ASPHALT PAVEMENT OR OTHER WORK**

Fringe Benefits Must Be Paid On <u>All</u> Hours Worked				
<u>CODE</u>	<u>TRADE OR OCCUPATION</u>	<u>HOURLY BASIC RATE OF PAY</u> \$	<u>HOURLY FRINGE BENEFITS</u> \$	<u>TOTAL</u> \$
551	Crane, Tower Crane, Pedestal Tower or Derrick, With or Without Attachments, With a Lifting Capacity of Over 100 Tons, Self Erecting Tower Crane With a Lifting Capacity of Over 4,000 Lbs., Crane With Boom Dollies; Crane, Tower Crane, Pedestal Tower or Derrick, With Boom, Leads and/or Jib Lengths Measuring 176 Ft or Over; Master Mechanic.	34.62	17.96	52.58
552	Backhoe (Track Type) Having a Mfgr.'s Rated Capacity of 130,000 Lbs. or Over; Calsson Rig; Crane, Tower Crane, Portable Tower, Pedestal Tower or Derrick, With or Without Attachments, With a Lifting Capacity of 100 Tons or Under, Self-Erecting Tower Crane With a Lifting Capacity Of 4,000 Lbs. & Under; Crane, Tower Crane, Portable Tower, Pedestal Tower or Derrick, With Boom, Leads &/or Jib Lengths Measuring 175 Ft or Under; Dredge (NOT Performing Work on the Great Lakes); Licensed Boat Pilot (NOT Performing Work on the Great Lakes); Pile Driver. Future Increase(s): Add \$2/hr on 6/1/12; Add \$2/hr on 6/1/13; Add \$1.75/hr on 6/1/14. Premium Increase(s): DOT PREMIUMS: 1) Pay two times the hourly basic rate on Sunday, New Year's Day, Memorial Day, Independence Day, Labor Day, Thanksgiving Day & Christmas Day. 2) Add \$1.25/hr for work on projects involving temporary traffic control setup, for lane and shoulder closures, when work under artificial illumination conditions is necessary as required by the project provisions (Including prep time prior to and/or cleanup after such time period).	33.72	18.90	52.62

Fringe Benefits Must Be Paid On <u>All</u> Hours Worked		HOURLY BASIC RATE OF PAY	HOURLY FRINGE BENEFITS	TOTAL
CODE	TRADE OR OCCUPATION	\$	\$	\$
553	Air, Track, Rotary or Percussion Drilling Machine &/or Hammers, Blaster; Asphalt Heater, Planer & Scarifier; Asphalt Milling Machine; Asphalt Screed; Backhoe (Track Type) Having a Mfr.'s Rated Capacity of Under 130,000 Lbs., Backhoe (Mini, 15,000 Lbs. & Under); Bituminous (Asphalt) Plant & Paver, Screed; Boring Machine (Directional, Horizontal or Vertical); Bulldozer or Endloader; Concrete Breaker (Large, Auto, Vibratory/Sonic, Manual or Remote); Concrete Conveyor System; Concrete Laser/Screed; Concrete Slipform Placer Curb & Gutter Machine; Crane (Carry Deck, Mini) or Truck Mounted Hydraulic Crane (10 Tons or Under); Crane With a Lifting Capacity of 25 Tons or Under; Forestry Equipment, Timbco, Tree Shear, Tub Grinder, Processor; Gradall (Cruz-Aire Type); Grader or Motor Patrol; Hydro-Blaster (10,000 PSI or Over); Loading Machine (Conveyor); Manhoist; Material or Stack Hoist; Mechanic or Welder; Milling Machine; Post Hole Digger or Driver; Railroad Track Rail Leveling Machine, Tie Placer, Extractor, Tamper, Stone Leveler or Rehabilitation Equipment; Roller (Over 5 Ton); Scraper (Self Propelled or Tractor Drawn) 5 cu yds or More Capacity; Shoulder Widener; Sideboom; Skid Rig; Stabilizing or Concrete Mixer (Self-Propelled or 14S or Over); Tractor (Scraper, Dozer, Pusher, Loader); Tractor or Truck Mounted Hydraulic Backhoe; Trencher (Wheel Type or Chain Type); Tube Finisher; Tugger (NOT Performing Work on the Great Lakes); Winches & A-Frames. Future Increase(s): Add \$2/hr on 6/1/12; Add \$2/hr on 6/1/13; Add \$1.75/hr on 6/1/14.	32.67	18.55	51.22
554	Backfiller; Broom or Sweeper; Compactor (Self-Propelled or Tractor Mounted, Towed & Light Equipment); Concrete Finishing Machine (Road Type); Environmental Burner; Farm or Industrial Type Tractor; Fireman (Asphalt Plant, Pile Driver & Derrick NOT Performing Work on the Great Lakes); Forklift; Greaser; Hoist (Tugger, Automatic); Jeep Digger; Joint Sawyer (Multiple Blade); Launch (NOT Performing Work on the Great Lakes); Lift Slab Machine; Mechanical Float; Mulcher; Power Subgrader; Robotic Tool Carrier (With or Without Attachments); Roller (Rubber Tire, 5 Ton or Under); Self-Propelled Chip Spreader; Shouldering Machine; Skid Steer Loader (With or Without Attachments); Telehandler.	31.52	17.89	49.41
555	Air Compressor (&/or 400 CFM or Over); Air, Electric or Hydraulic Jacking System; Augers (Vertical & Horizontal); Automatic Belt Conveyor & Surge Bin; Boiler (Temporary Heat); Crusher, Screening or Wash Plant; Generator (&/or 150 KW or Over); Heaters (Mechanical); High Pressure Utility Locating Machine (Daylighting Machine); Mudjack; Oiler; Prestress Machine; Pug Mill; Pump (3 Inch or Over) or Well Points; Rock, Stone Breaker; Screed (Milling Machine); Stump Chipper; Tank Car Heaters; Vibratory Hammer or Extractor, Power Pack. Future Increase(s): Add \$2/hr on 6/1/12; Add \$2/hr on 6/1/13; Add \$1.75/hr on 6/1/14.	32.67	18.55	51.22
556	Fiber Optic Cable Equipment.	22.00	7.27	29.27

RESIDENTIAL OR AGRICULTURAL CONSTRUCTION

Includes single family houses or apartment buildings of no more than four (4) stories in height and all buildings, structures or facilities that are primarily used for agricultural or farming purposes, excluding commercial buildings. For classification purposes, the exterior height of a residential building, in terms of stories, is the primary consideration. All incidental items such as site work, driveways, parking lots, private sidewalks, private septic systems or sewer and water laterals connected to a public system and swimming pools are included within this definition. Residential buildings of five (5) stories and above are NOT included within this definition.

SKILLED TRADES

Fringe Benefits Must Be Paid On <u>All</u> Hours Worked		HOURLY BASIC RATE OF PAY	HOURLY FRINGE BENEFITS	TOTAL
CODE	TRADE OR OCCUPATION	\$	\$	\$
101	Acoustic Ceiling Tile Installer	27.00	2.47	29.47
102	Boilermaker	31.09	23.75	54.84
103	Bricklayer, Blocklayer or Stonemason	32.00	3.00	35.00
104	Cabinet Installer	22.00	2.74	24.74
105	Carpenter	27.00	3.46	30.46
106	Carpet Layer or Soft Floor Coverer	23.95	2.78	26.73
107	Cement Finisher	21.33	4.25	25.58
108	Drywall Taper or Finisher	23.80	1.55	25.35
109	Electrician	22.00	9.18	31.18
110	Elevator Constructor	43.79	25.48	69.27
111	Fence Erector	17.64	4.33	21.97
112	Fire Sprinkler Fitter	36.39	16.97	53.36
113	Glazier	36.23	11.22	47.45
114	Heat or Frost Insulator	29.04	19.73	48.77
115	Insulator (Batt or Blown)	18.95	1.70	20.65
116	Ironworker	30.90	19.11	50.01
117	Lather	28.15	15.14	43.29
119	Marble Finisher	31.16	16.27	47.43
120	Marble Mason	32.66	16.20	48.86
121	Metal Building Erector	17.50	2.80	20.30
123	Overhead Door Installer	17.00	0.00	17.00
124	Painter	25.65	6.33	31.98
125	Pavement Marking Operator	26.00	0.00	26.00

Fringe Benefits Must Be Paid On <u>All</u> Hours Worked		HOURLY BASIC RATE OF PAY	HOURLY FRINGE BENEFITS	TOTAL
<u>CODE</u>	<u>TRADE OR OCCUPATION</u>	\$	\$	\$
129	Plasterer	19.00	0.29	19.29
130	Plumber	30.00	10.34	40.34
132	Refrigeration Mechanic	30.96	0.00	30.96
133	Roofer or Waterproofer	29.85	1.55	31.40
134	Sheet Metal Worker	21.03	3.40	24.43
135	Steamfitter	32.59	11.05	43.64
137	Teledata Technician or Installer	19.23	5.32	24.55
138	Temperature Control Installer	22.45	4.11	26.56
139	Terrazzo Finisher	18.00	5.35	23.35
140	Terrazzo Mechanic	31.16	16.27	47.43
141	Tile Finisher	23.96	13.36	37.32
142	Tile Setter	21.00	0.00	21.00
143	Tuckpointer, Caulker or Cleaner	23.96	12.88	36.84
146	Well Driller or Pump Installer	15.10	12.38	27.48
147	Siding Installer	18.80	1.42	20.22

TRUCK DRIVERS

Fringe Benefits Must Be Paid On <u>All</u> Hours Worked		HOURLY BASIC RATE OF PAY	HOURLY FRINGE BENEFITS	TOTAL
<u>CODE</u>	<u>TRADE OR OCCUPATION</u>	\$	\$	\$
201	Single Axle or Two Axle	19.86	2.54	22.40
203	Three or More Axle	19.50	14.27	33.77
205	Pavement Marking Vehicle	19.25	10.84	30.09
207	Truck Mechanic	19.00	1.75	20.75

LABORERS

Fringe Benefits Must Be Paid On <u>All</u> Hours Worked		HOURLY BASIC RATE OF PAY	HOURLY FRINGE BENEFITS	TOTAL
<u>CODE</u>	<u>TRADE OR OCCUPATION</u>	\$	\$	\$
301	General Laborer	16.09	7.18	23.27
302	Asbestos Abatement Worker	17.00	2.21	19.21
303	Landscaper	25.00	0.54	25.54

311	Fiber Optic Laborer (Outside, Other Than Concrete Encased)	16.51	0.00	16.51
-----	--	-------	------	-------

**HEAVY EQUIPMENT OPERATORS
RESIDENTIAL OR AGRICULTURAL CONSTRUCTION**

Fringe Benefits Must Be Paid On All Hours Worked

<u>CODE</u>	<u>TRADE OR OCCUPATION</u>	<u>HOURLY BASIC RATE OF PAY</u> \$	<u>HOURLY FRINGE BENEFITS</u> \$	<u>TOTAL</u> \$
557	Asphalt Heater, Planer & Scarifier; Asphalt Milling Machine; Asphalt Screed; Backhoe (Track Type); Backhoe (Mini, 15,000 Lbs. & Under); Bituminous (Asphalt) Plant & Paver, Screed; Boring Machine (Directional, Horizontal or Vertical); Bulldozer or Endloader; Concrete Breaker (Large, Auto, Vibratory/Sonic, Manual or Remote); Concrete Bump Cutter, Grinder, Planing or Grooving Machine; Concrete Conveyor System; Concrete Laser/Screed; Concrete Paver (Slipform); Concrete Pump, Concrete Conveyor (Rotec or Bidwell Type); Concrete Slipform Placer Curb & Gutter Machine; Concrete Spreader & Distributor; Crane (Carry Deck, Mini) or Truck Mounted Hydraulic Crane (10 Tons or Under); Crane With a Lifting Capacity of 25 Tons or Under; Crane, Shovel, Dragline, Clamshells; Forestry Equipment, Timbco, Tree Shear, Tub Grinder, Processor; Grader or Motor Patrol; Grout Pump; Hydro-Blaster (10,000 PSI or Over); Loading Machine (Conveyor); Manholst; Material or Stack Hoist; Mechanic or Welder; Milling Machine; Roller (Over 5 Ton); Scraper (Self Propelled or Tractor Drawn) 5 cu yds or More Capacity; Shoulder Widener; Skid Rig; Stabilizing or Concrete Mixer (Self-Propelled or 14S or Over); Tractor (Scraper, Dozer, Pusher, Loader); Tractor or Truck Mounted Hydraulic Backhoe; Tractor or Truck Mounted Hydraulic Crane (10 Tons or Under); Trencher (Wheel Type or Chain Type); Winches & A-Frames.	29.45	15.37	44.82
558	Air Compressor (&/or 400 CFM or Over); Air, Electric or Hydraulic Jacking System; Backfiller; Belting, Burlap, Texturing Machine; Boiler (Temporary Heat); Broom or Sweeper; Compactor (Self-Propelled or Tractor Mounted, Towed & Light Equipment); Concrete Finishing Machine (Road Type); Farm or Industrial Type Tractor; Forklift; Generator (&/or 150 KW or Over); Heaters (Mechanical); High Pressure Utility Locating Machine (Daylighting Machine); Jeep Digger; Lift Slab Machine; Mulcher; Oiler; Post Hole Digger or Driver; Power Subgrader; Pump (3 Inch or Over) or Well Points; Robotic Tool Carrier (With or Without Attachments); Rock, Stone Breaker; Roller (Rubber Tire, 5 Tons or Under); Screed (Milling Machine); Self Propelled Chlp Spreader; Shouldering Machine; Skid Steer Loader (With or Without Attachments); Stump Chlpper; Telehandler; Vibratory Hammer or Extractor, Power Pack.	26.45	14.35	40.80

***** END OF RATES *****