

Madison, Wisconsin

# CITY OF MADISON

## CITY ENGINEERING DIVISION DEPARTMENT OF PUBLIC WORKS

### PLAN OF PROPOSED IMPROVEMENT

### UNIVERSITY AVENUE PARKING LOT RECONSTRUCTION - 2012 AND UNIVERSITY AVENUE/CAMPUS DRIVE/ BRESE TERRACE INTERSECTION RECONSTRUCTION

CITY PROJECT NO. 53W1351  
CONTRACT NO. 6815

**INDEX OF SHEETS**

SHEET NO.	TITLE
1	PROJECT OVERVIEW
D-1	TYPICAL SECTIONS
D-2	RETAINING WALL DETAILS
D-3	STORM SEWER DETAILS
D-4	PLAN & PROFILE - UNIVERSITY AVE SURFACE PAVEMENT
P-1	PARKING LOT PLAN
P-2	PARKING LOT GRADING PLAN
G-1	UNIVERSITY AVE/CAMPUS DRIVE/BRESE TERRACE PLAN
P-3	MEDIAN ISLAND DETAILS
P-4	ELECTRICAL PLAN - PARKING LOT
E-1	ELECTRICAL PLAN - BRESE TERRACE
E-2	PAVEMENT MARKING PLANS
M1-M6	

CONVENTIONAL SIGNS	
FIELD VERIFY ALL UTILITY LOCATIONS	
GAS	— G —
STORM SEWER	— ST —
SANITARY SEWER	— SAN —
WATER	— W —
OVERHEAD ELECTRIC	— OH —
POWER POLE	□
ADA COMPLIANT RAMP W/ DETECTABLE WARNING FIELD	▣
COMBUSTIBLE FLUIDS	☠

### UNIVERSITY AVENUE PARKING LOT RECONSTRUCTION PROJECT LOCATION

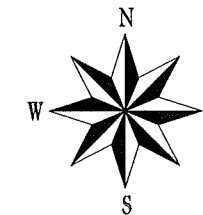
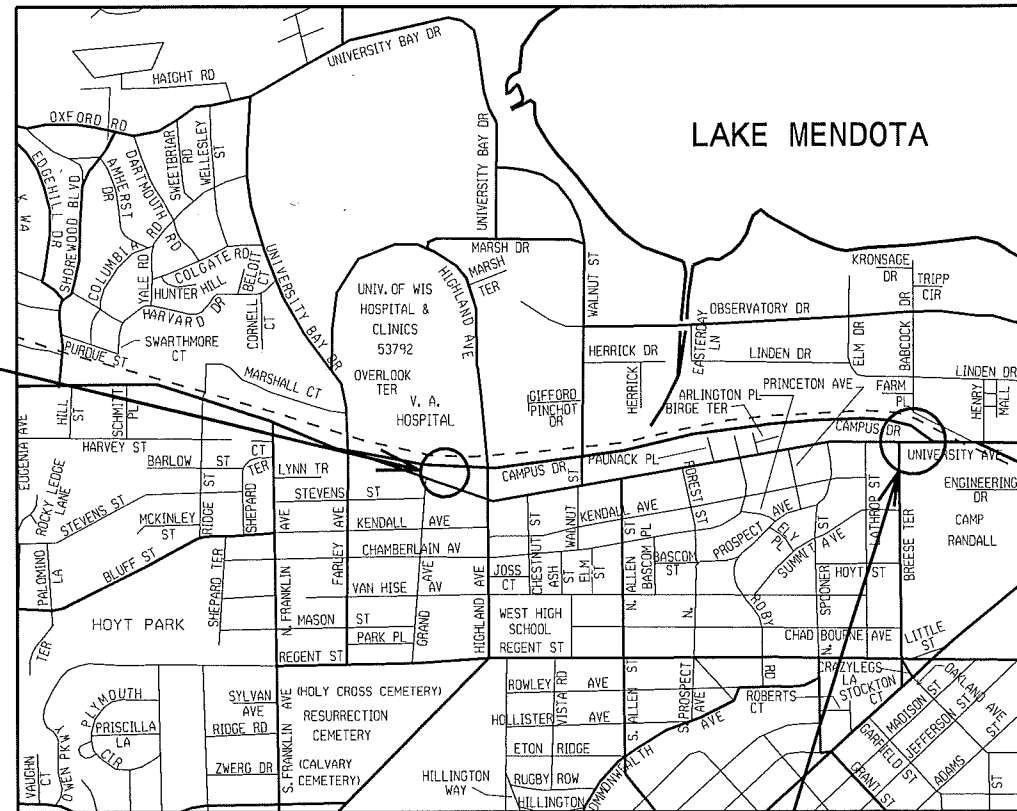

**NOTES:**

ALL GUTTERS SHALL DRAIN WITH A MINIMUM GRADE OF 0.50% TOWARD STORM SEWER INLETS.

SIDEWALK RAMPS AND CURB THRU SIDEWALK RAMPS SHALL HAVE A MAXIMUM SLOPE OF 1" PER 12". SIDEWALK AND CURB RAMPS SHALL BE CONSTRUCTED WITH A SIDE SLOPE OF 2.00%. SIDEWALK SHALL HAVE A MINIMUM LONGITUDINAL SLOPE OF 0.50% AND A MAXIMUM LONGITUDINAL SLOPE OF 5.00% EXCEPT WHERE STREET GRADES EXCEED 5.00%.

**EARTH WORK SUMMARY:**

EXCAVATION CUT (MEASURED PLAN QUANTITY).....510 C.Y.  
ESTIMATED UNDISTRIBUTED UNDERCUT.....150 C.Y.  
TOTAL UNCLASSIFIED EXCAVATION CUT.....660 C.Y.

### UNIVERSITY AVE/CAMPUS DR/ BRESE TERRACE INTERSECTION RECONSTRUCTION PROJECT LOCATION

PUBLIC IMPROVEMENT PROJECT APPROVED

MARCH 20, 2012

BY THE COMMON COUNCIL  
OF MADISON, WISCONSIN

PUBLIC IMPROVEMENT DESIGN  
APPROVED BY:

*[Signature]* 4/9/12  
City Engineer Date

STREET/PARKING LOT  
DESIGNED BY:

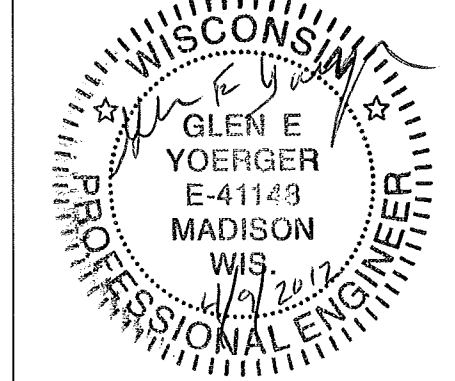

STORM SEWER  
DESIGNED BY:

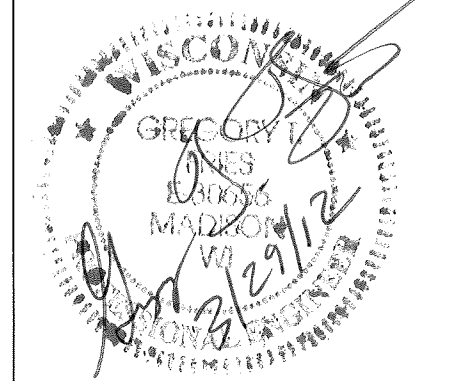

ELECTRICAL  
DESIGNED BY:

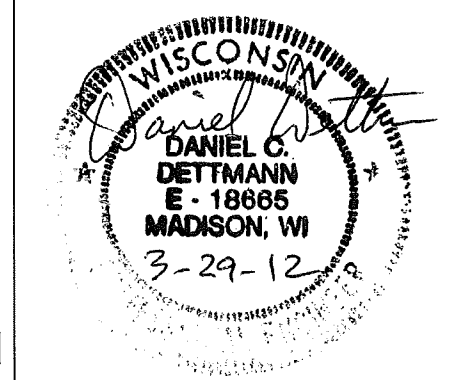

# PROJECT OVERVIEW

UNIVERSITY AVENUE PARKING LOT  
RECONSTRUCTION - 2012

AND

UNIVERSITY AVENUE/CAMPUS DRIVE/BREESE TERRACE  
INTERSECTION RECONSTRUCTION

UNIV AVE PARKING LOT RECONSTRUCT- 2012  
&  
UNIV AVE/CAMPUS DR/ BREESE TERR  
INTERSECTION RECONSTRUCTION  
PROJECT NO. 53W1351  
PROJECT OVERVIEW  
UNIVERSITY AVE CITY OF MADISON

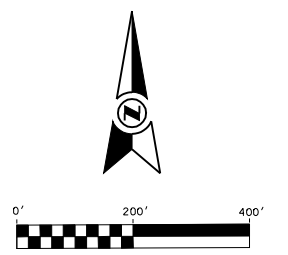

## STAGE 1 WORK

RECONSTRUCT CITY OF  
MADISON PARKING LOT

PLACE SURFACE LAYER OF  
E-3 ASPHALT PAVEMENT  
ON UNIVERSITY AVENUE

## STAGE 2 WORK

REPLACE CURB AND GUTTER & MILL  
AND OVERLAY SURFACE LAYER  
OF E-3 ASPHALT PAVEMENT  
ON UNIVERSITY AVENUE



PLOT SCALE: 1" = 100'

PLOT NAME: 53W1351

REV. DATE: 4/9/2012

ORIGINATOR: CITY OF MADISON, STREETS DIVISION

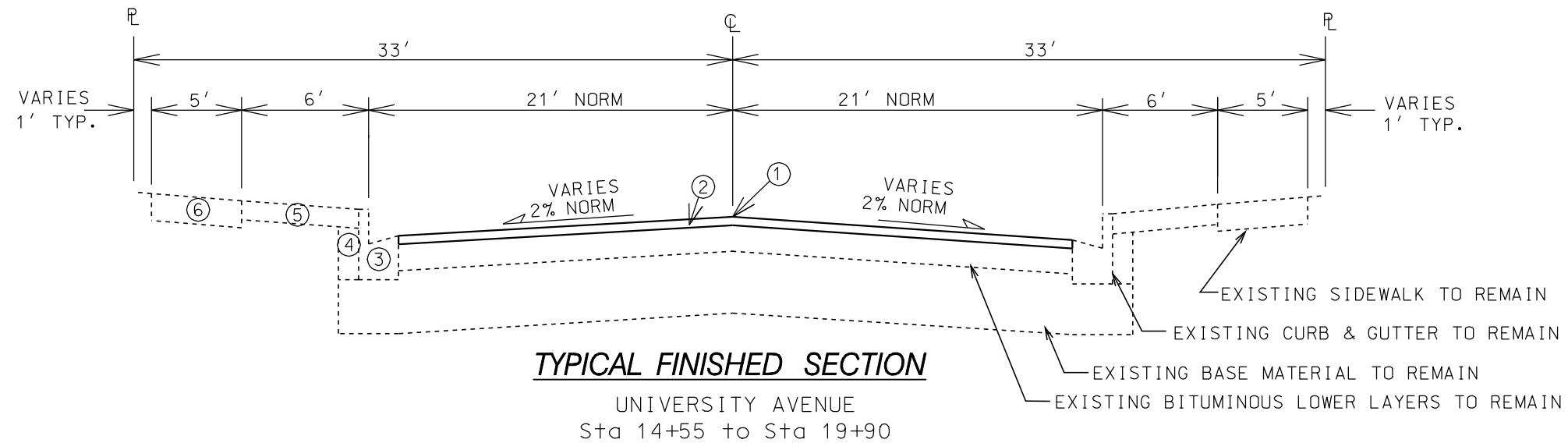

- ① POINT REFERRED TO ON PROFILE
- ② 1 3/4" BITUMINOUS UPPER LAYER, 12.5mm, TYPE E-3
- ③ EXISTING CONCRETE CURB & GUTTER - REPLACE AS SHOWN IN PLAN
- ④ FILL
- ⑤ 4" TOPSOIL & SEED ( ALL DISTURBED TERRACE AREAS)
- ⑥ 5" CONCRETE SIDEWALK (AS NEEDED - REPLACE AS SHOWN IN PLAN)

NOT TO SCALE

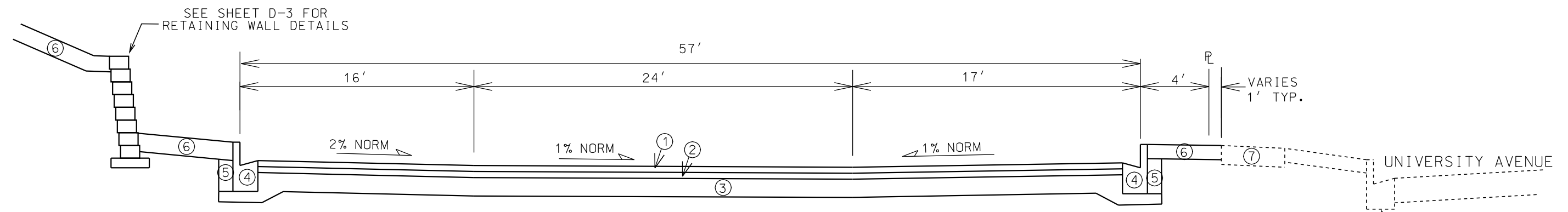

- ① 2" BITUMINOUS UPPER LAYER, 12.5mm, TYPE E-1.0
- ② 2 1/4" BITUMINOUS LOWER LAYER, 19.0 mm, TYPE E-1.0
- ③ 6" GRADATION 2 CRUSHED STONE
- ④ TYPE 'G OR 'D' CONCRETE CURB & GUTTER - AS SHOWN IN PLAN
- ⑤ FILL
- ⑥ 4" TOPSOIL & SEED ( ALL DISTURBED TERRACE AREAS)
- ⑦ 5" CONCRETE SIDEWALK (AS NEEDED - REPLACE AS SHOWN IN PLAN)

EXISTING CURB TO REMAIN

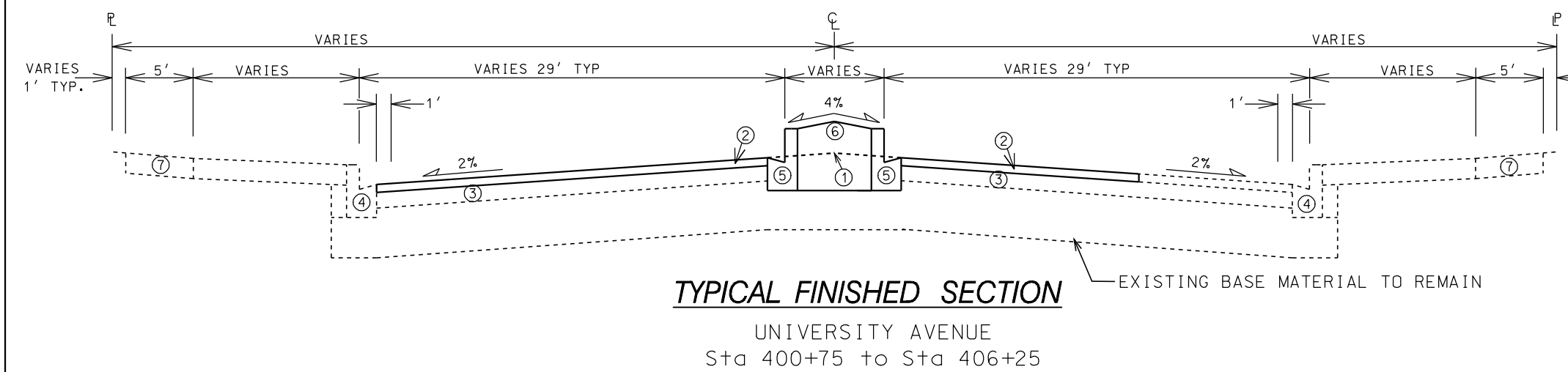

- ① EXISTING STREET CL
- ② 1 3/4" BITUMINOUS UPPER LAYER, MILL & OVERLAY, 12.5mm, TYPE E-3
- ③ BITUMINOUS LOWER LAYERS, TO REMAIN
- ④ EXISTING CONCRETE CURB & GUTTER TO REMAIN
- ⑤ TYPE 'H' CONCRETE CURB & GUTTER - AS SHOWN IN PLAN
- ⑥ 4" TOPSOIL & SEED OR COLORED TEXTURED CONCRETE AS SHOWN IN PLAN
- ⑦ EXISTING CONCRETE SIDEWALK TO REMAIN

NOT TO SCALE

PLAN - MECHANICALLY STABILIZED EARTH  
MODULAR BLOCK WALL

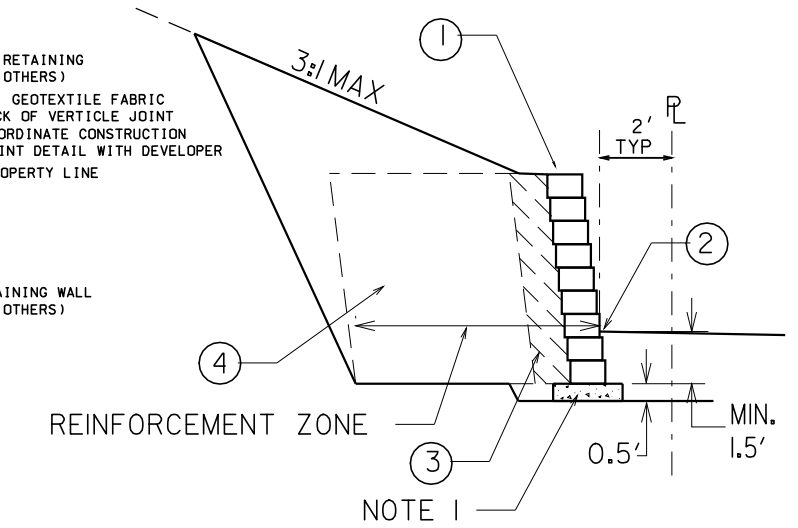
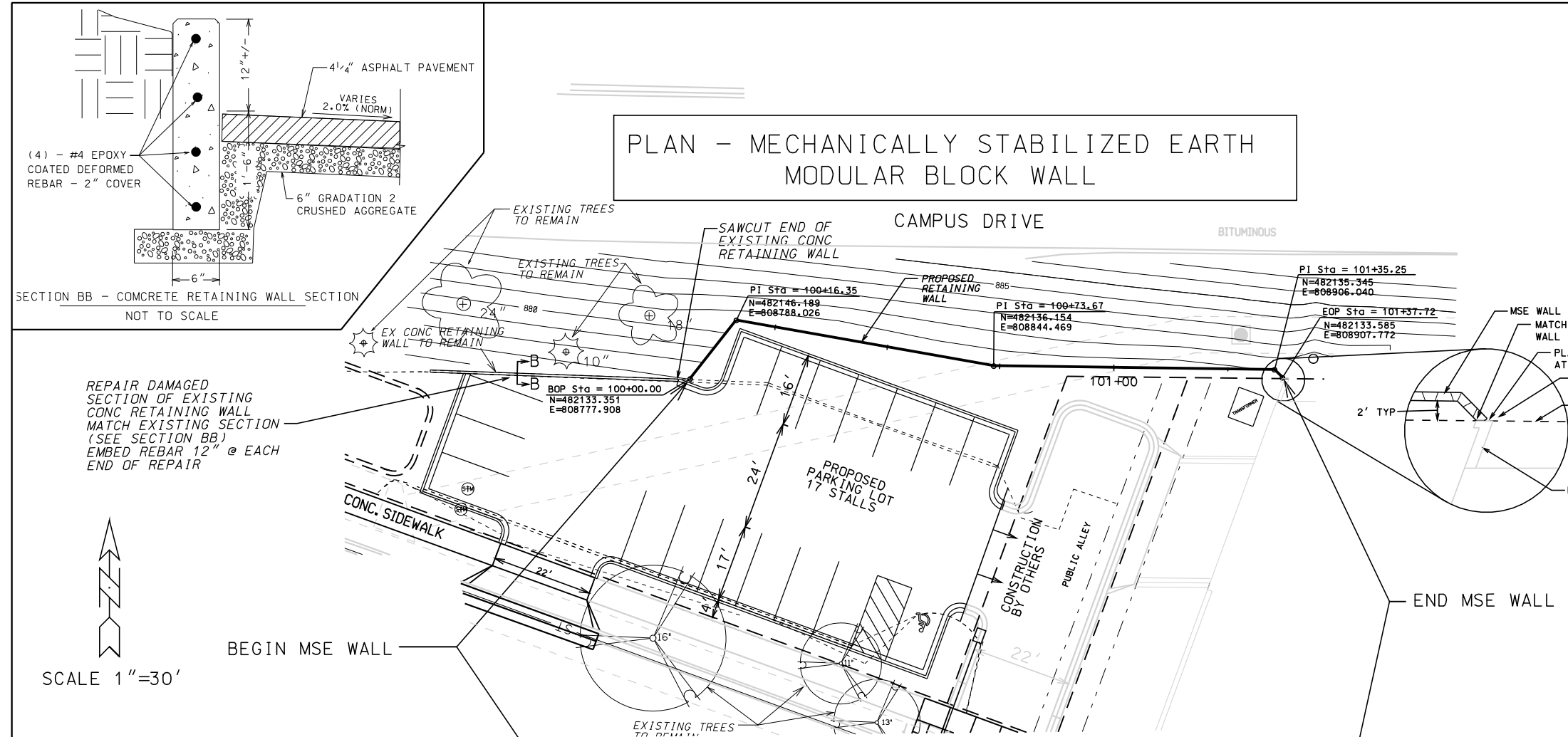

TYPICAL MSE WALL SECTION

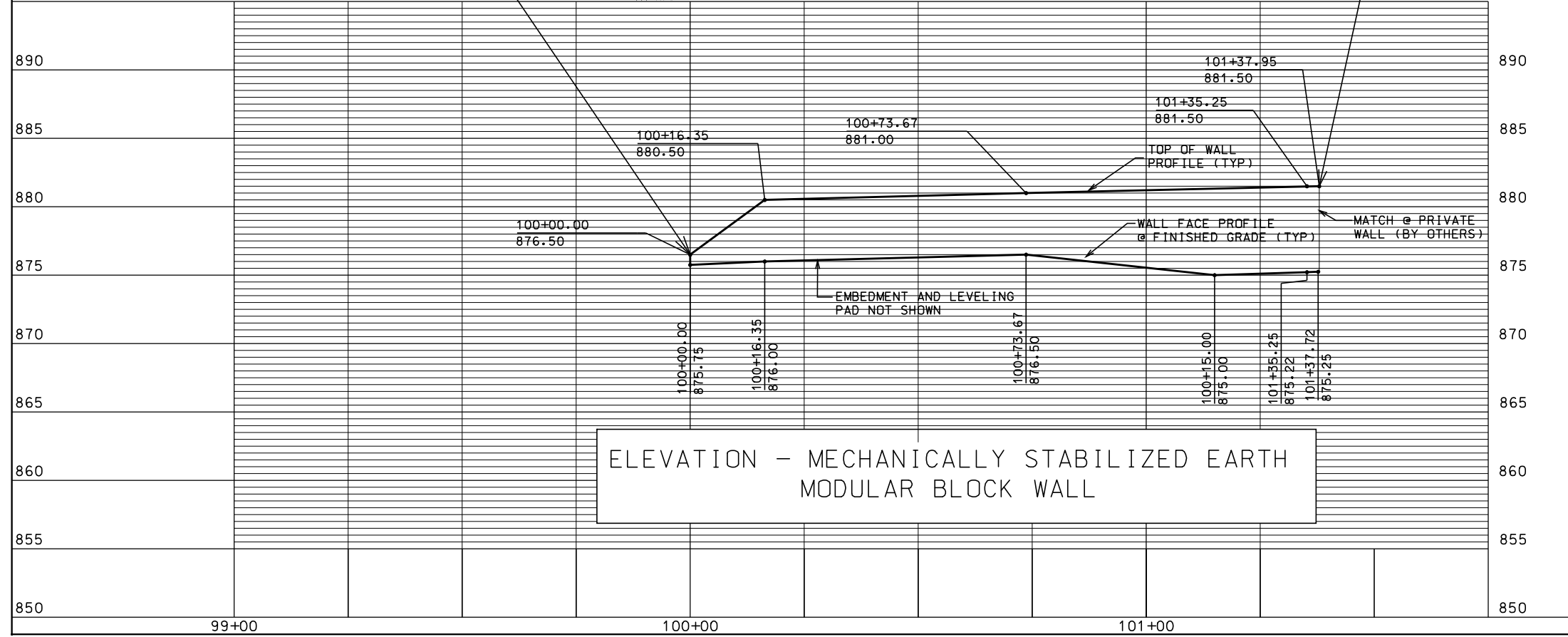

ELEVATION - MECHANICALLY STABILIZED EARTH  
MODULAR BLOCK WALL

- LEGEND
- ① TOP OF WALL AND POINT REFERRED TO ON WALL PROFILE
  - ② FINISHED GRADE AT FACE OF WALL AND POINT REFERRED TO ON WALL PROFILE
  - ③ WALL BACKFILL, TYPE A
  - ④ WALL BACKFILL, TYPE B

- NOTES:
1. CONCRETE LEVELING PAD REQUIRED. SEE SPECIAL PROVISIONS
  2. CONTRACTOR SHALL PROVIDE COMPLETE DESIGN, PLANS, DETAILS, SPECIFICATIONS AND SHOP DRAWINGS FOR RETAINING WALLS IN ACCORDANCE WITH THE SPECIAL PROVISIONS.
  3. WALL PLANS AND DETAILS ON THESE DRAWINGS ARE INTENDED TO INDICATE THE LOCATION, HEIGHT AND DETAILS COMMON TO ANY WALL SYSTEM SELECTED. CONTRACTOR SHALL VERIFY THAT THE WALL SYSTEM SELECTED WILL CONFORM TO THE REQUIRED ALIGNMENT AND DETAILS.
  4. MODULAR BLOCKS SHALL HAVE A "CUTSTONE" APPEARANCE WITH GREY COLORATION.

PLOT SCALE: .....  
PLOT NAME: .....  
REV. DATE: .....

ORIGINATOR: CITY OF MADISON, STREETS DIVISION

STORM SCHEDULE (ALL STATIONING IS TO UNIVERSITY AVENUE ALIGNMENT)

STRUCTURE NAME	STRUCTURE TYPE	STATION	LOCATION	TOP OF CASTING	E.I.	NOTES
S-1	3X3 SAS	15+02.12	LT -49.13	875.28	870.45	W/R1550-0054
S-2	2'X3' "H INLET"	15+16.66	LT -47.70	874.60	870.85	W/R-1878-B7G

PIPE NAME	FROM	TO	LENGTH (Ft)	DISCH. E.I.	INLET E.I.	SLOPE %	NOTES
P-1	S-1	S-2	14.6	870.45	870.85	2.00	12" RCP

BIORETENTION BASIN STAKING (ALL STATIONING IS TO UNIVERSITY AVENUE ALIGNMENT)

POINT	STATION	LOCATION
1	15+41.83	LT -40.69
2	15+41.83	LT -54.69
3	15+11.83	LT -54.69
4	15+11.83	LT -40.69

ULO NAME	STATION	LOCATION	TYPE
ULO 1	15+02.12	LT -49.13	STORM
ULO 1	14+98.36	LT -48.49	ELECTRIC

BIORETENTION BASIN CROSS-SECTION (NOT TO SCALE)

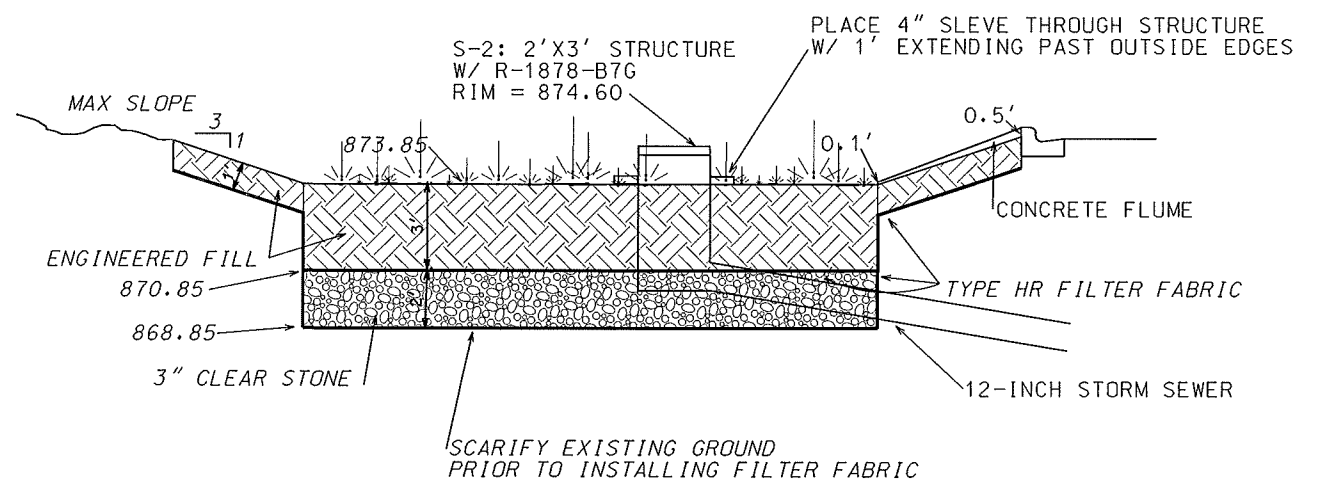

NOTE:  
ENGINEERED SOIL SHALL CONSIST OF THE FOLLOWING:  
SAND 45-55% (BY VOLUME)  
TOPSOIL 10-15%  
COMPOST 30-50%

CONCRETE FLUME DETAIL (NOT TO SCALE)

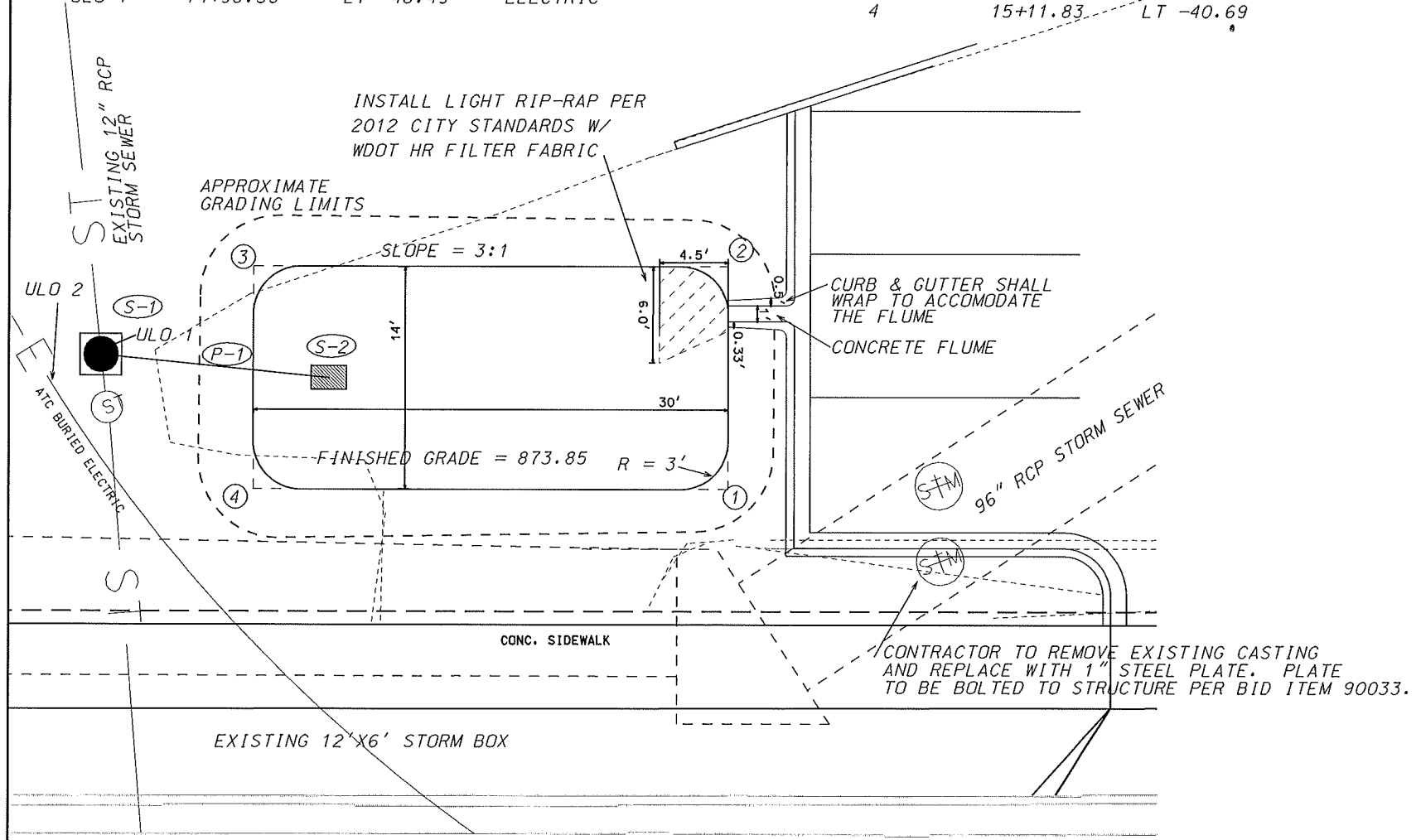
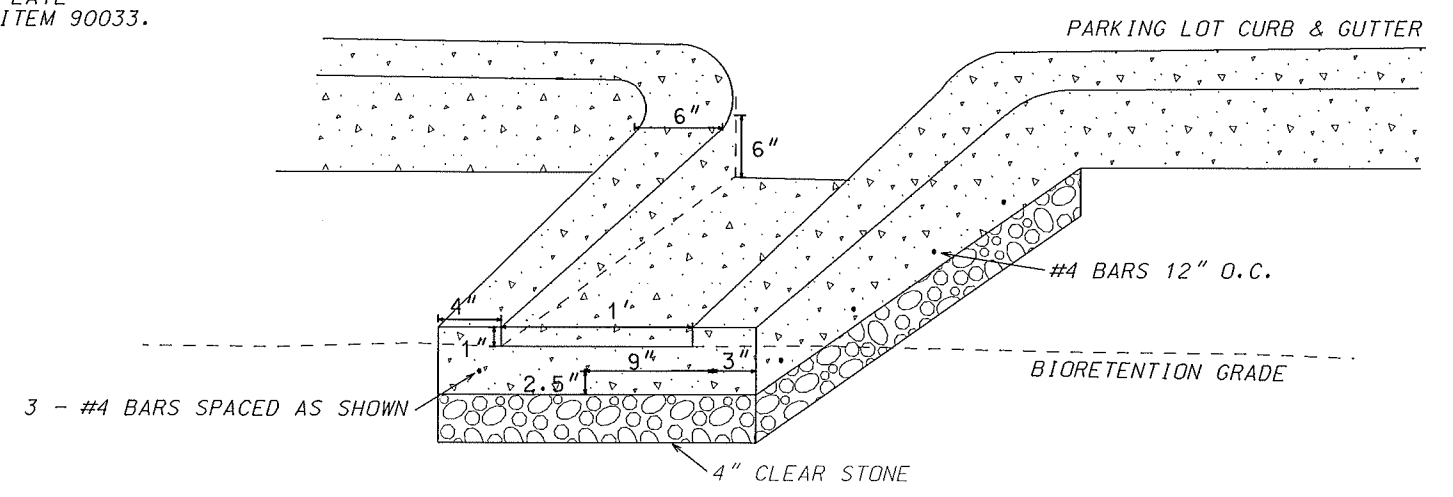

\*BIORETENTION BASIN TO BE PLANTED BY OTHERS

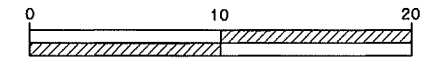
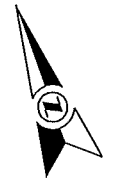

PLOT SCALE: PLOT NAME: REV. DATE:

ORIGINATOR: CITY OF MADISON, STREETS DIVISION

NOTE-BACK OF SIDEWALK GRADES ON UNIVERSITY AVE SHALL BE 0.34' ABOVE EXISTING TOP OF CURB UNLESS NOTED OTHERWISE

SEE SHEET P-2 FOR PARKING LOT LAYOUT

NOTE: PLACEMENT OF E-3 SURFACE LAYER OF ASPHALT PAVEMENT SHALL COMPLY WITH ARTICLE 403 OF THE STANDARD SPECIFICATIONS. ALL PAVEMENT CLEANING, SWEEPING, MILLING OF BUTT JOINTS AND MILLING OF RAMPED CASTINGS AS DIRECTED BY THE ENGINEER SHALL BE INCIDENTAL TO BID ITEM 40203, HMA PAVEMENT TYPE E-3.

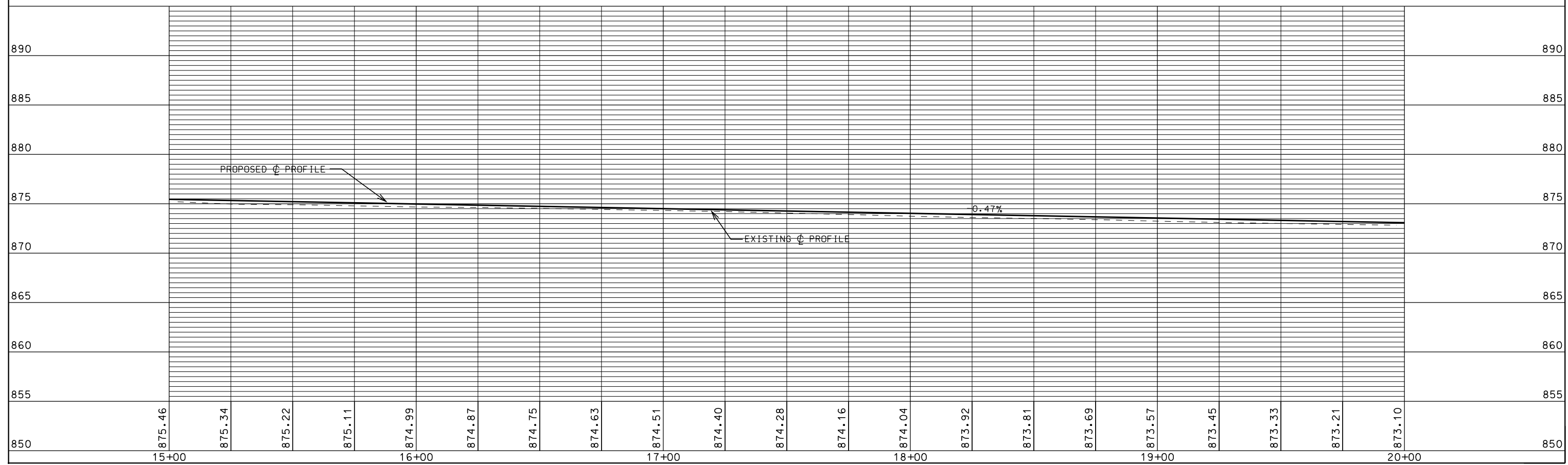
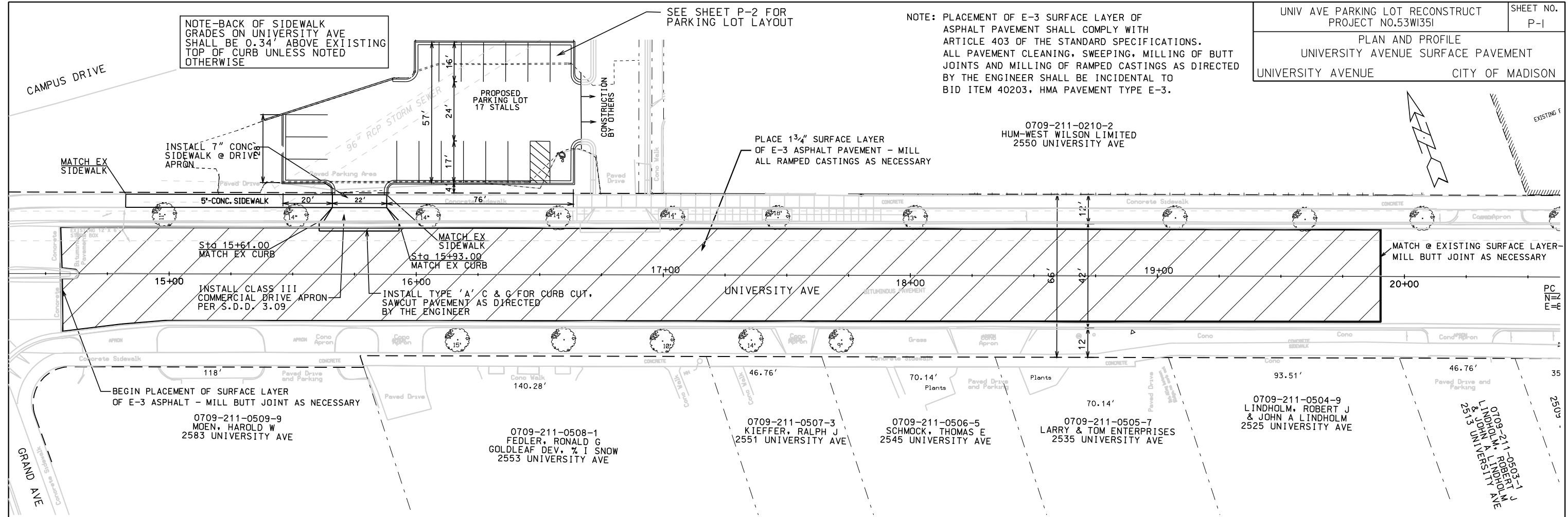

PLOT SCALE: .....

PLOT NAME: .....

REV. DATE: .....

ORIGINATOR: CITY OF MADISON, STREETS DIVISION

NOTE: CROSS HATCHED AREAS ARE TO BE RESTORED, LANDSCAPED AND PLANTED BY OTHERS. PLACE FILL AS REQUIRED TO BACK FILL CURB & GUTTER AND SIDEWALK. ALL OTHER DISTURBED AREAS ARE TO BE RESTORED WITH 4" TOPSOIL AND SEED.

CAMPUS DRIVE

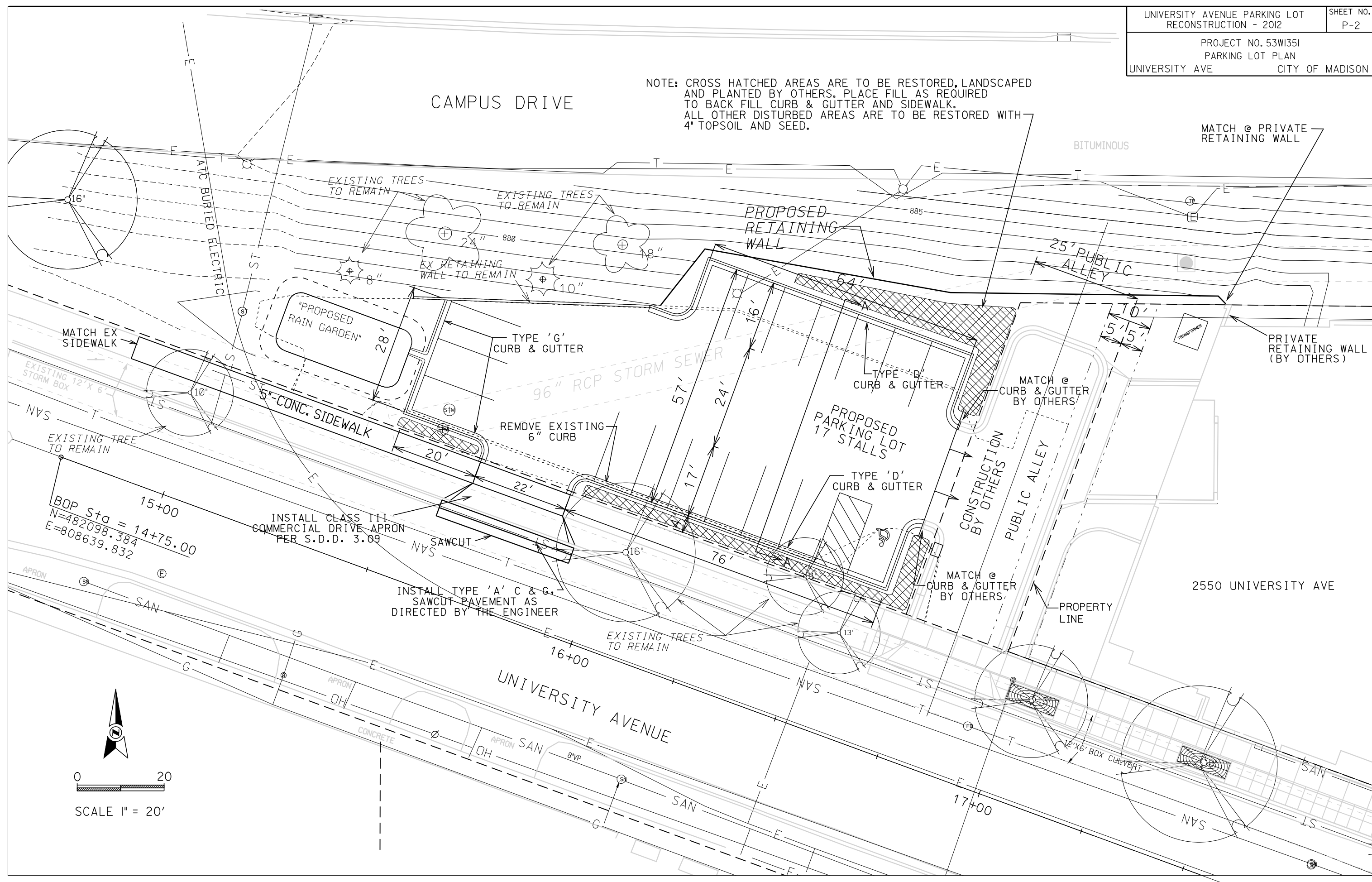

BDP Sta = 14+75.00  
N=482098.384  
E=808639.832

INSTALL CLASS III  
COMMERCIAL DRIVE APRON  
PER S.D.D. 3.09

INSTALL TYPE 'A' C & G.  
SAWCUT PAVEMENT AS  
DIRECTED BY THE ENGINEER

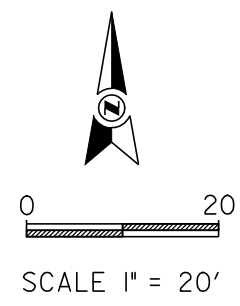

2550 UNIVERSITY AVE

CAMPUS DRIVE

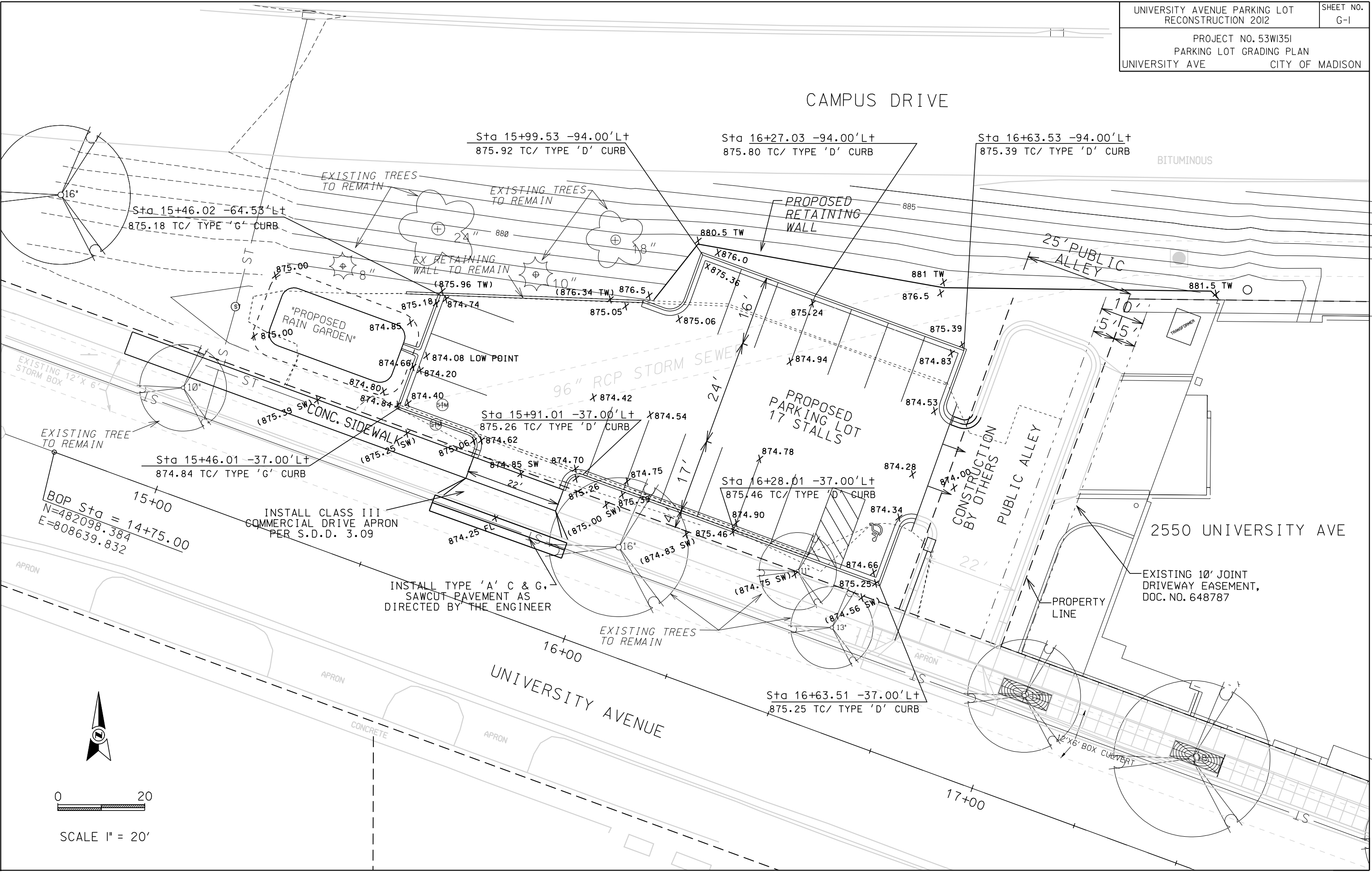

PLOT SCALE: .....  
PLOT NAME: .....  
REV. DATE: .....

BDP Sta = 14+75.00  
N=482098.384  
E=808639.832

INSTALL CLASS III  
COMMERCIAL DRIVE APRON  
PER S.D.D. 3.09

INSTALL TYPE 'A' C & G,  
SAWCUT PAVEMENT AS  
DIRECTED BY THE ENGINEER

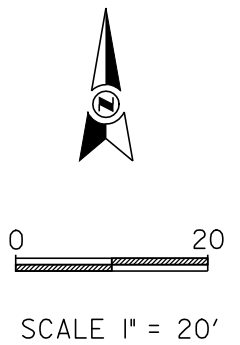

ORIGINATOR: CITY OF MADISON, STREETS DIVISION



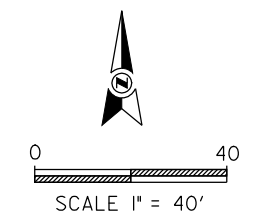

NOTE: PLACEMENT OF E-3 SURFACE LAYER OF ASPHALT PAVEMENT SHALL COMPLY WITH ARTICLE 403 OF THE STANDARD SPECIFICATIONS. ALL PAVEMENT CLEANING AND SWEEPING AS DIRECTED BY THE ENGINEER SHALL BE INCIDENTAL TO BID ITEM 40203, HMA PAVEMENT TYPE E-3.

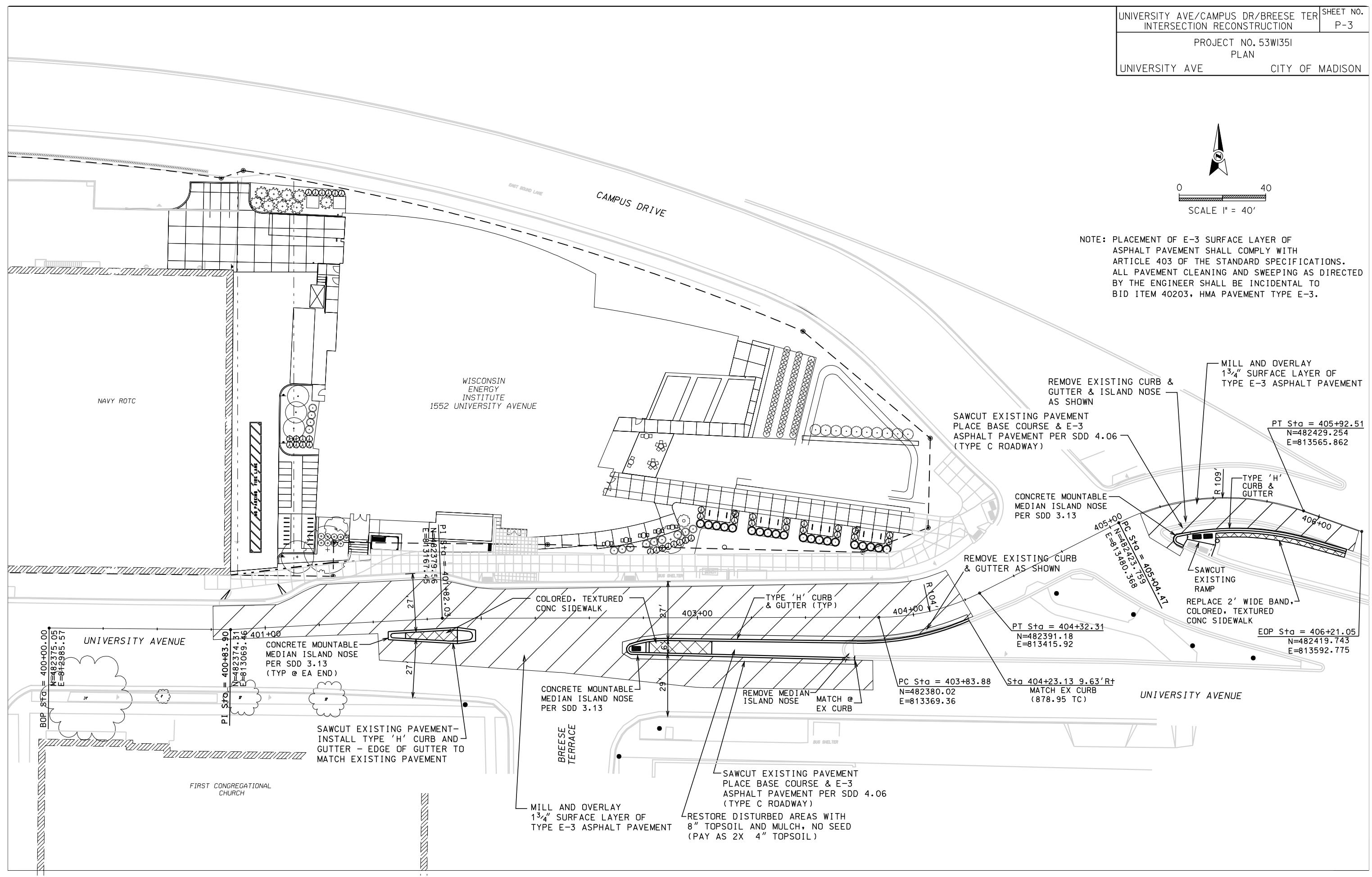

WISCONSIN ENERGY INSTITUTE  
1552 UNIVERSITY AVENUE

NAVY ROTC

FIRST CONGREGATIONAL CHURCH

COLORED, TEXTURED CONC SIDEWALK

CONCRETE MOUNTABLE MEDIAN ISLAND NOSE PER SDD 3.13

BREESE TERRACE

SAWCUT EXISTING PAVEMENT - INSTALL TYPE 'H' CURB AND GUTTER - EDGE OF GUTTER TO MATCH EXISTING PAVEMENT

CONCRETE MOUNTABLE MEDIAN ISLAND NOSE PER SDD 3.13 (TYP @ EA END)

RESTORE DISTURBED AREAS WITH 8" TOPSOIL AND MULCH, NO SEED (PAY AS 2X 4" TOPSOIL)

SAWCUT EXISTING PAVEMENT PLACE BASE COURSE & E-3 ASPHALT PAVEMENT PER SDD 4.06 (TYPE C ROADWAY)

REMOVE MEDIAN ISLAND NOSE MATCH @ EX CURB

PC Sta = 403+83.88  
N=482380.02  
E=813369.36

Sta 404+23.13 9.63'R+  
MATCH EX CURB (878.95 TC)

PT Sta = 404+32.31  
N=482391.18  
E=813415.92

REMOVE EXISTING CURB & GUTTER AS SHOWN

CONCRETE MOUNTABLE MEDIAN ISLAND NOSE PER SDD 3.13

SAWCUT EXISTING PAVEMENT PLACE BASE COURSE & E-3 ASPHALT PAVEMENT PER SDD 4.06 (TYPE C ROADWAY)

REMOVE EXISTING CURB & GUTTER & ISLAND NOSE AS SHOWN

MILL AND OVERLAY 1 3/4" SURFACE LAYER OF TYPE E-3 ASPHALT PAVEMENT

PT Sta = 405+92.51  
N=482429.254  
E=813565.862

TYPE 'H' CURB & GUTTER

REPLACE 2' WIDE BAND, COLORED, TEXTURED CONC SIDEWALK

SAWCUT EXISTING RAMP

R 109'

PC Sta = 405+04.47  
N=482423.759  
E=813480.368

405+00

406+00

UNIVERSITY AVENUE

UNIVERSITY AVENUE

CAMPUS DRIVE

EXIST BOARD LINE

BOP Sta = 400+00.00  
N=482375.05  
E=812985.57

PI Sta = 400+83.90  
N=482374.81  
E=813069.46

PI Sta = 401+82.03  
N=482379.55  
E=813167.495

27'

27'

27'

27'

R 104'

404+00

403+00

TYPE 'H' CURB & GUTTER (TYP)

CONCRETE MOUNTABLE MEDIAN ISLAND NOSE PER SDD 3.13

REMOVE EXISTING CURB & GUTTER AS SHOWN

SAWCUT EXISTING PAVEMENT PLACE BASE COURSE & E-3 ASPHALT PAVEMENT PER SDD 4.06 (TYPE C ROADWAY)

RESTORE DISTURBED AREAS WITH 8" TOPSOIL AND MULCH, NO SEED (PAY AS 2X 4" TOPSOIL)

REMOVE MEDIAN ISLAND NOSE MATCH @ EX CURB

CONCRETE MOUNTABLE MEDIAN ISLAND NOSE PER SDD 3.13

COLORED, TEXTURED CONC SIDEWALK

SAWCUT EXISTING PAVEMENT - INSTALL TYPE 'H' CURB AND GUTTER - EDGE OF GUTTER TO MATCH EXISTING PAVEMENT

CONCRETE MOUNTABLE MEDIAN ISLAND NOSE PER SDD 3.13 (TYP @ EA END)

WISCONSIN ENERGY INSTITUTE 1552 UNIVERSITY AVENUE

NAVY ROTC

FIRST CONGREGATIONAL CHURCH

BREESE TERRACE

CAMPUS DRIVE

EXIST BOARD LINE

UNIVERSITY AVE/CAMPUS DR/BREESE TER INTERSECTION RECONSTRUCTION

SHEET NO. P-3

PROJECT NO. 53WI351 PLAN

UNIVERSITY AVE CITY OF MADISON

WISCONSIN  
ENERGY  
INSTITUTE  
1552 UNIVERSITY AVENUE

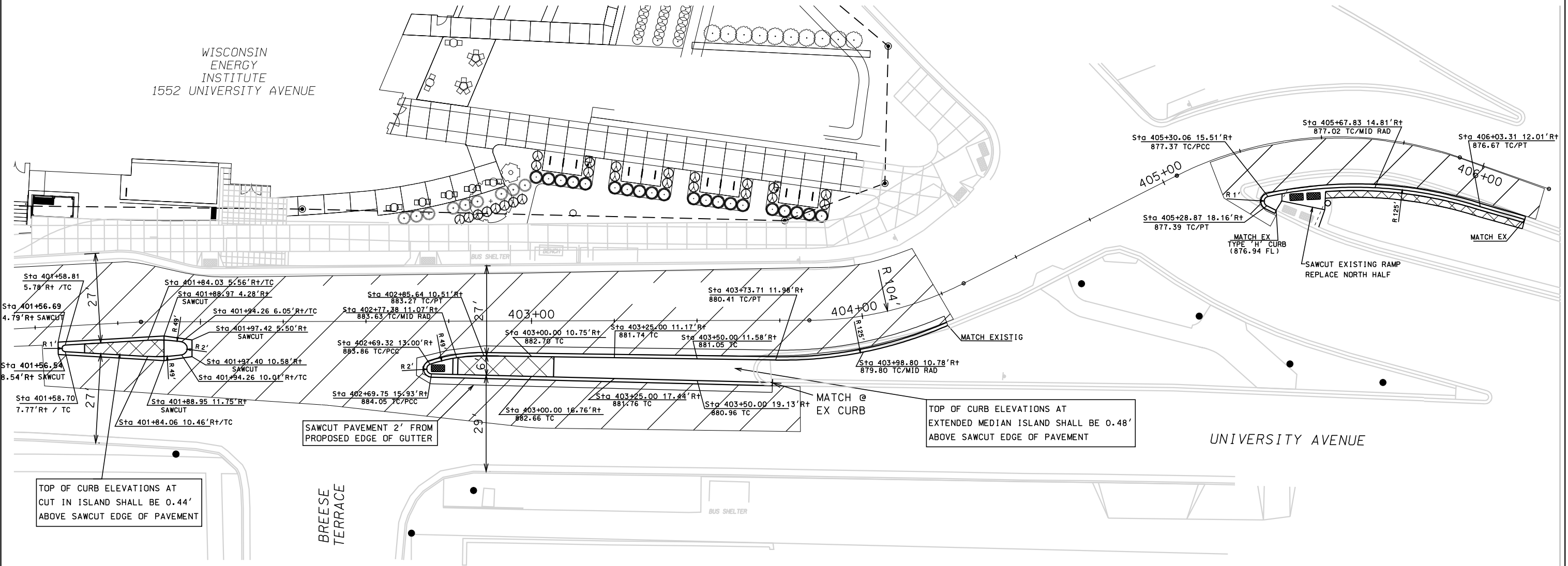

TOP OF CURB ELEVATIONS AT  
CUT IN ISLAND SHALL BE 0.44'  
ABOVE SAWCUT EDGE OF PAVEMENT

SAWCUT PAVEMENT 2' FROM  
PROPOSED EDGE OF GUTTER

TOP OF CURB ELEVATIONS AT  
EXTENDED MEDIAN ISLAND SHALL BE 0.48'  
ABOVE SAWCUT EDGE OF PAVEMENT

- NOTES:
- 1) MILL AND OVERLAY HATCHED AREAS WITH 1 3/4" SURFACE LAYER OF TYPE E-3 ASPHALT PAVEMENT
  - 2) REMOVE ANY CONCRETE PAVEMENT PATCHES ENCOUNTERED AS DIRECTED BY ENGINEER
  - 3) USE BASE PATCHING, CURB FRONT FILL AND UNDER CUT AS DIRECTED BY ENGINEER (EACH PAID UNDER RESPECTIVE BID ITEM)

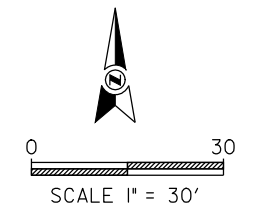

PLOT SCALE: .....  
PLOT NAME: .....  
REV. DATE: .....

ORIGINATOR: CITY OF MADISON, STREETS DIVISION

GENERAL ELECTRIC NOTES:

1. ALL LOCATIONS ARE APPROXIMATE. THE TRAFFIC ENGINEER SHALL APPROVE FINAL LOCATIONS, INCLUDING SETBACK, IN THE FIELD AFTER CONTRACTOR SURVEYS STAKING. THE CONTRACTOR SHALL NOTIFY DAN DETTMANN (266-6536) CITY TRAFFIC ENGINEERING, AT LEAST 24-HOURS IN ADVANCE OF NEEDING CONDUIT OR BASE LOCATIONS MARKED.
2. THE CONTRACTOR SHALL DO ALL WORK IN ACCORDANCE WITH "CITY OF MADISON STANDARD SPECIFICATIONS FOR PUBLIC WORKS CONSTRUCTION, 2012 EDITION" AND ALL ADDENDUMS THERETO. ALL CONDUIT SHALL BE PVC, SCHEDULE 80 UNDER PAVEMENT OR SCHEDULE 40 OTHERWISE. PULL WIRE REQUIRED AS PER STANDARD SPECIFICATIONS.
3. THE CONTRACTOR SHALL CALL MIKE CHRISTOPH (266-9031) AT THE TRAFFIC ENGINEERING SHOP AT LEAST 24-HOURS IN ADVANCE OF POURING BASES OR BURYING CONDUIT TO ARRANGE FOR INSPECTION. ANY WORK COMPLETED WITHOUT INSPECTION IS SUBJECT TO REJECTION.
4. THE CONTRACTOR SHALL ARRANGE FOR PICK UP OF THE FOLLOWING CITY FURNISHED MATERIALS, WHICH SHOULD BE ARRANGED FOR PICKUP BY CALLING DENNIS ROWE, TRAFFIC ENGINEERING SHOP, 266-9034 1120 SAYLE ST, AT LEAST 24-HOURS PRIOR TO NEEDING MATERIALS:

-1"X40" ANCHOR BOLTS 1 SET OF 4

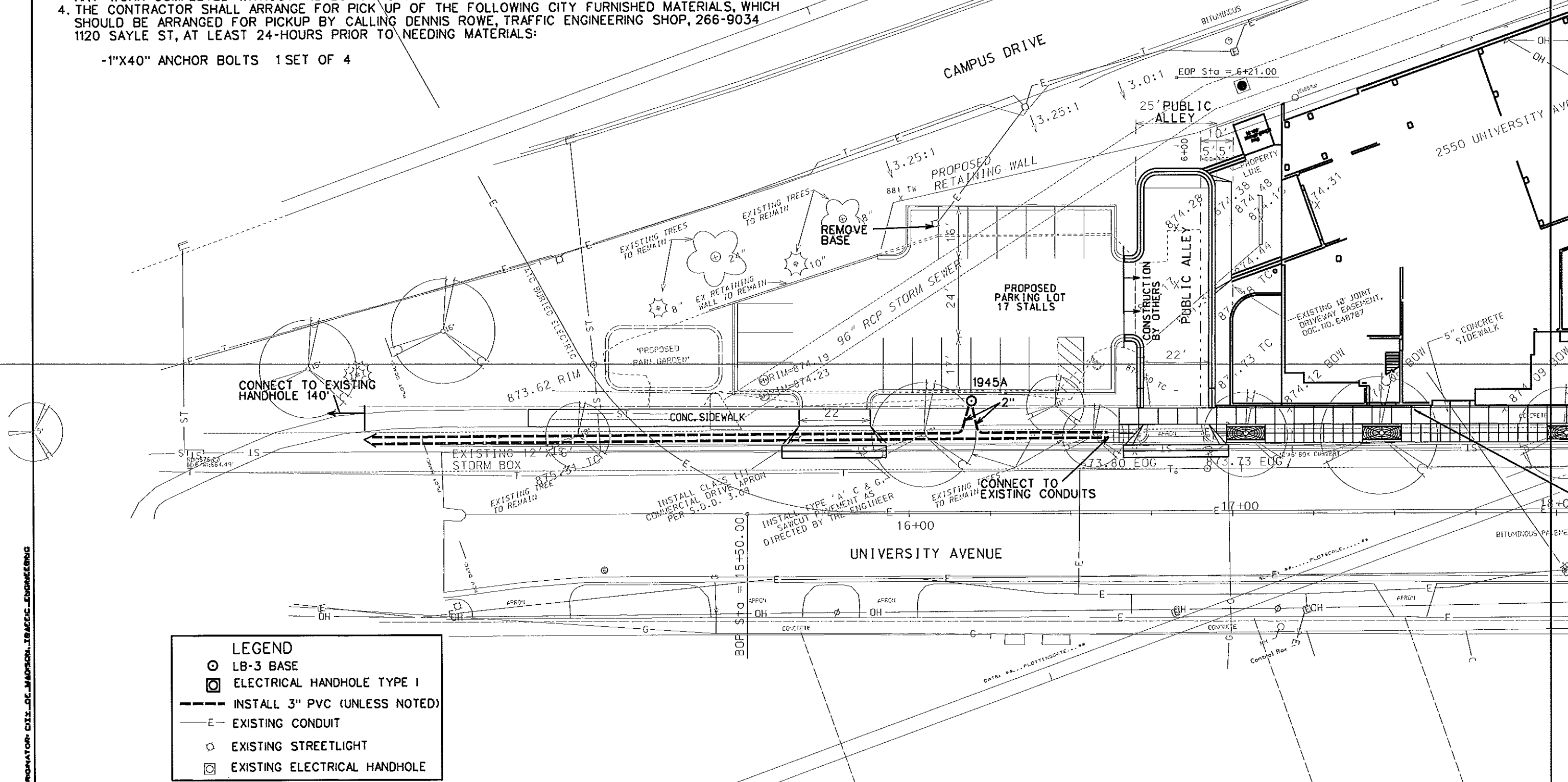

LEGEND	
	LB-3 BASE
	ELECTRICAL HANDHOLE TYPE I
	INSTALL 3" PVC (UNLESS NOTED)
	EXISTING CONDUIT
	EXISTING STREETLIGHT
	EXISTING ELECTRICAL HANDHOLE

OPERATOR: CITY OF MADISON, TRAFFIC ENGINEERING

ELECTRICAL PLAN

UNIV AVE CITY OF MADISON

3/26/12 KF SLI212.dgn



- ⊙ LB- BASE (SIZE NOTED)
- ⬡ TRAFFIC SIGNAL BASE, TYPE G
- ⊠ ELECTRICAL HANDHOLE TYPE 1
- INSTALL PVC (SIZE NOTED)
- - - EXISTING CONDUIT
- ★ EXISTING STREETLIGHT
- ⊠ EXISTING ELECTRICAL HANDHOLE
- ⊠ TRAFFIC DETECTOR LOOP

GENERAL ELECTRIC NOTES:

1. ALL LOCATIONS ARE APPROXIMATE. THE TRAFFIC ENGINEER SHALL APPROVE FINAL LOCATIONS, INCLUDING SETBACK, IN THE FIELD AFTER CONTRACTOR SURVEYS STAKING. THE CONTRACTOR SHALL NOTIFY DAN DETTMANN (266-6536) CITY TRAFFIC ENGINEERING, AT LEAST 24-HOURS IN ADVANCE OF NEEDING CONDUIT OR BASE LOCATIONS MARKED.
2. BASES INSTALLED IN MEDIAN SHALL BE CENTERED UNLESS OTHERWISE NOTED. SUBJECT TO NOTE 1 ABOVE.
3. THE CONTRACTOR SHALL DO ALL WORK IN ACCORDANCE WITH 'CITY OF MADISON STANDARD SPECIFICATIONS FOR PUBLIC WORKS CONSTRUCTION, 2012 EDITION' AND ALL ADDENDUMS THERETO. ALL CONDUIT SHALL BE PVC, SCHEDULE 80 UNDER PAVEMENT OR SCHEDULE 40 OTHERWISE. PULL WIRE REQUIRED AS PER STANDARD SPECIFICATIONS.
4. THE CONTRACTOR SHALL CALL MIKE CHRISTOPH (266-9031) AT THE TRAFFIC ENGINEERING SHOP AT LEAST 24-HOURS IN ADVANCE OF POURING BASES OR BURYING CONDUIT TO ARRANGE FOR INSPECTION. ANY WORK COMPLETED WITHOUT INSPECTION IS SUBJECT TO REJECTION.
5. THE CONTRACTOR SHALL ARRANGE FOR PICK UP OF THE FOLLOWING CITY FURNISHED MATERIALS, WHICH SHOULD BE ARRANGED FOR PICKUP BY CALLING DENNIS ROWE, TRAFFIC ENGINEERING SHOP, 266-9034 120 SAYLE ST AT LEAST 24-HOURS PRIOR TO NEEDING MATERIALS:

- 3/4" x 24" ANCHOR BOLTS - 4
- TYPE I HANDHOLES - 1

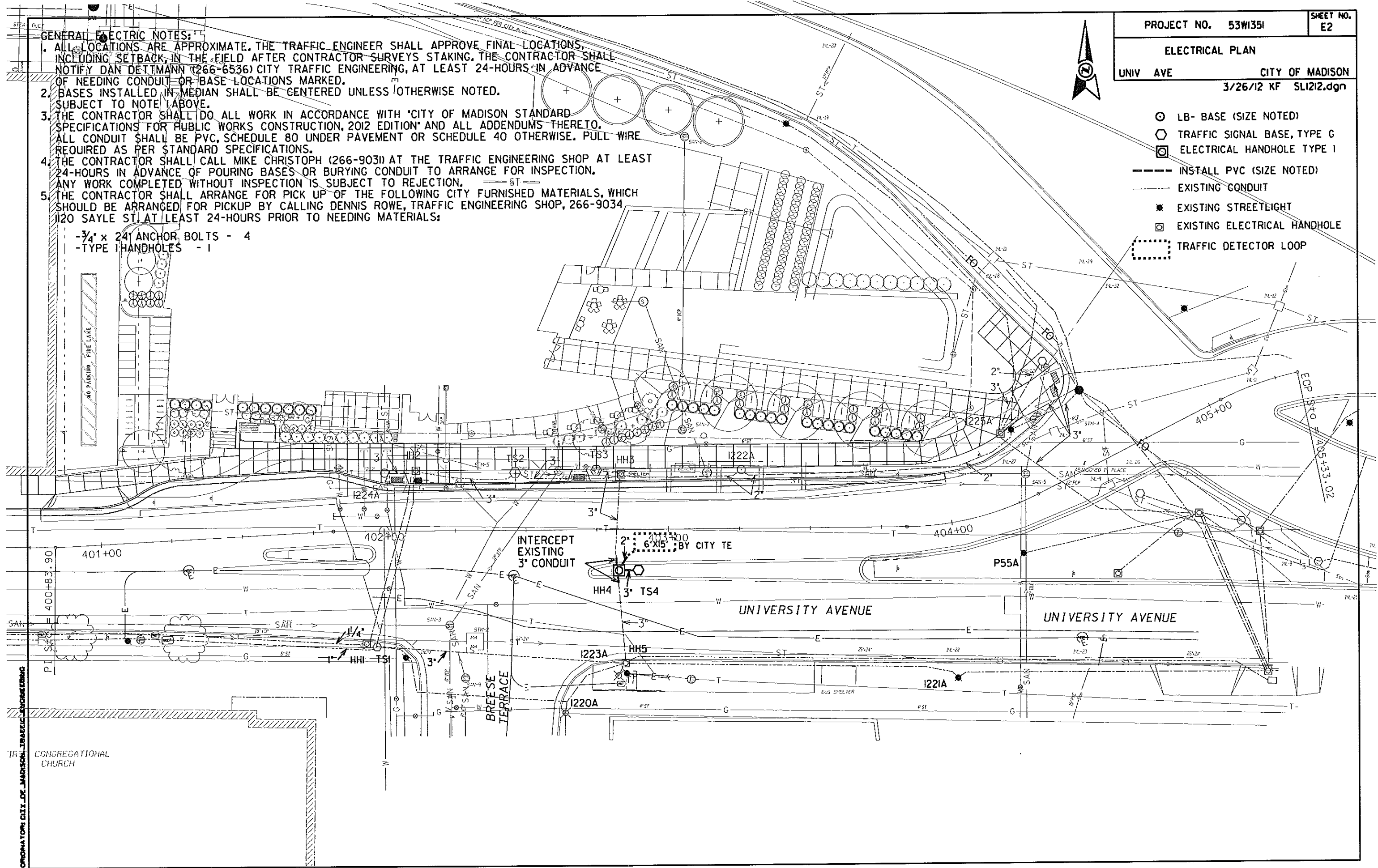

ORIGINATOR: CITY OF MADISON TRAFFIC ENGINEERING

Marking Plan

CITY OF MADISON

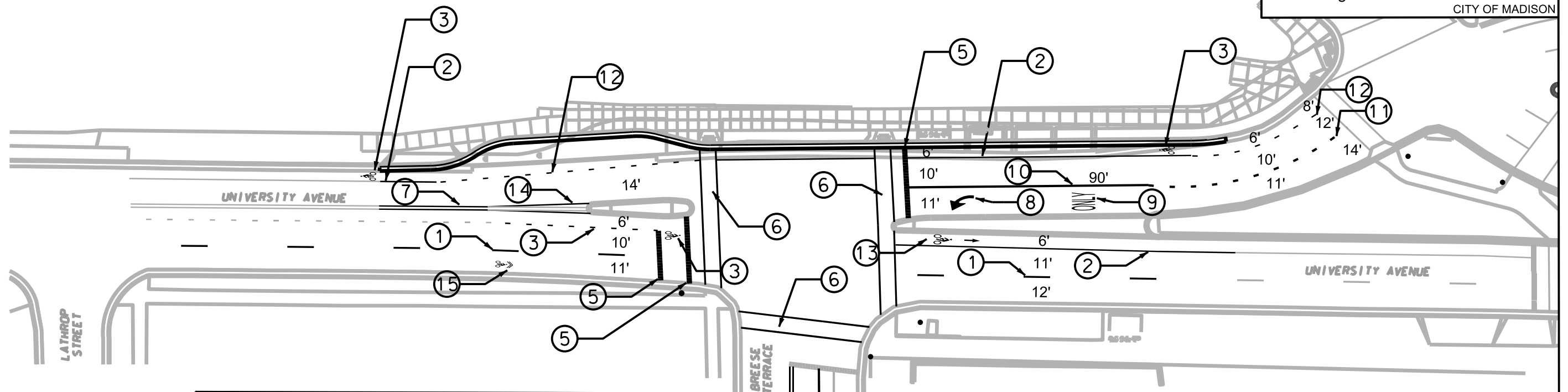

LEGEND

①	PAVEMENT MARKING EPOXY, 6-INCH, DASHED, (10' LINE, 30' GAP) WHITE
②	PAVEMENT MARKING EPOXY, 4-INCH, SOLID, WHITE
③	PAVEMENT MARKING EPOXY, BIKE LANE SYMBOL, WHITE
④	PAVEMENT MARKING EPOXY, 6-INCH, DOTTED LINE, (2' LINE, 6' GAP) WHITE
⑤	PAVEMENT MARKING EPOXY, 24-INCH, STOP LINE, WHITE
⑥	PAVEMENT MARKING EPOXY, 6-INCH, CROSSWALK, WHITE
⑦	PAVEMENT MARKING EPOXY, 4-INCH, DOUBLE YELLOW
⑧	PAVEMENT MARKING EPOXY, SYMBOL, ARROW MARKING, WHITE
⑨	PAVEMENT MARKING EPOXY, SYMBOL, ONLY MARKING, WHITE
⑩	PAVEMENT MARKING EPOXY, 8-INCH, CHANNELIZING, WHITE
⑪	PAVEMENT MARKING EPOXY, 8-INCH, DOTTED LINE, (2' LINE, 6' GAP) WHITE
⑫	PAVEMENT MARKING EPOXY, 4-INCH, DOTTED LINE, (2' LINE, 6' GAP) WHITE
⑬	PAVEMENT MARKING EPOXY, BIKE LANE SYMBOL WITH ARROW, WHITE
⑭	PAVEMENT MARKING EPOXY, 4 INCH, YELLOW
⑮	PAVEMENT MARKING EPOXY, SHARROW SYMBOL, WHITE

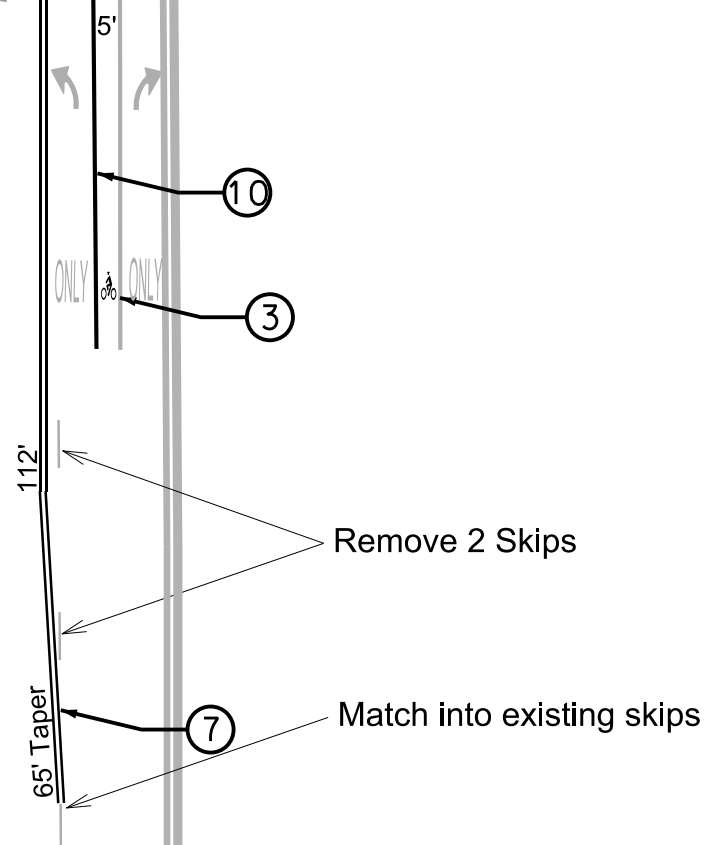

PLOT SCALE: \_\_\_\_\_

PLOT NAME: \_\_\_\_\_

REV. DATE: \_\_\_\_\_



PLOT SCALE: \_\_\_\_\_

PLOT NAME: \_\_\_\_\_

REV. DATE: \_\_\_\_\_

ORIGINATOR: CITY OF MADISON, I.E. \_\_\_\_\_

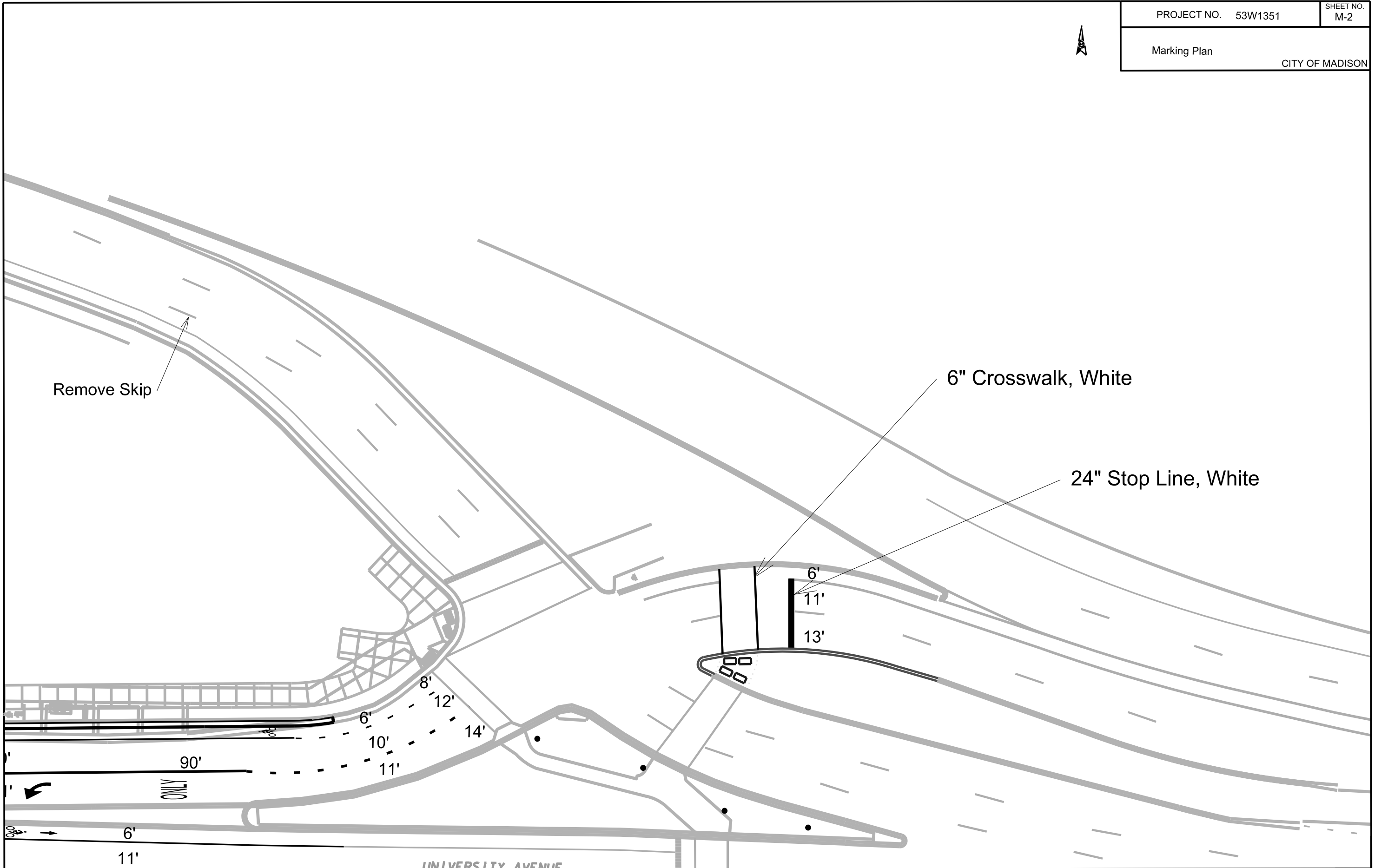

FILE NAME= \_\_\_\_\_



Line up new skips with existing 8" solid line

Remove Existing Skips

BABCOCK DR

UNIVERSITY AVENUE

Mark new 8" White Skips (2' Line, 6' Gap)

PLOT SCALE: \_\_\_\_\_

PLOT NAME: \_\_\_\_\_

REV. DATE: \_\_\_\_\_

ORIGINATOR: CITY OF MADISON, I.E. \_\_\_\_\_

FILE NAME=

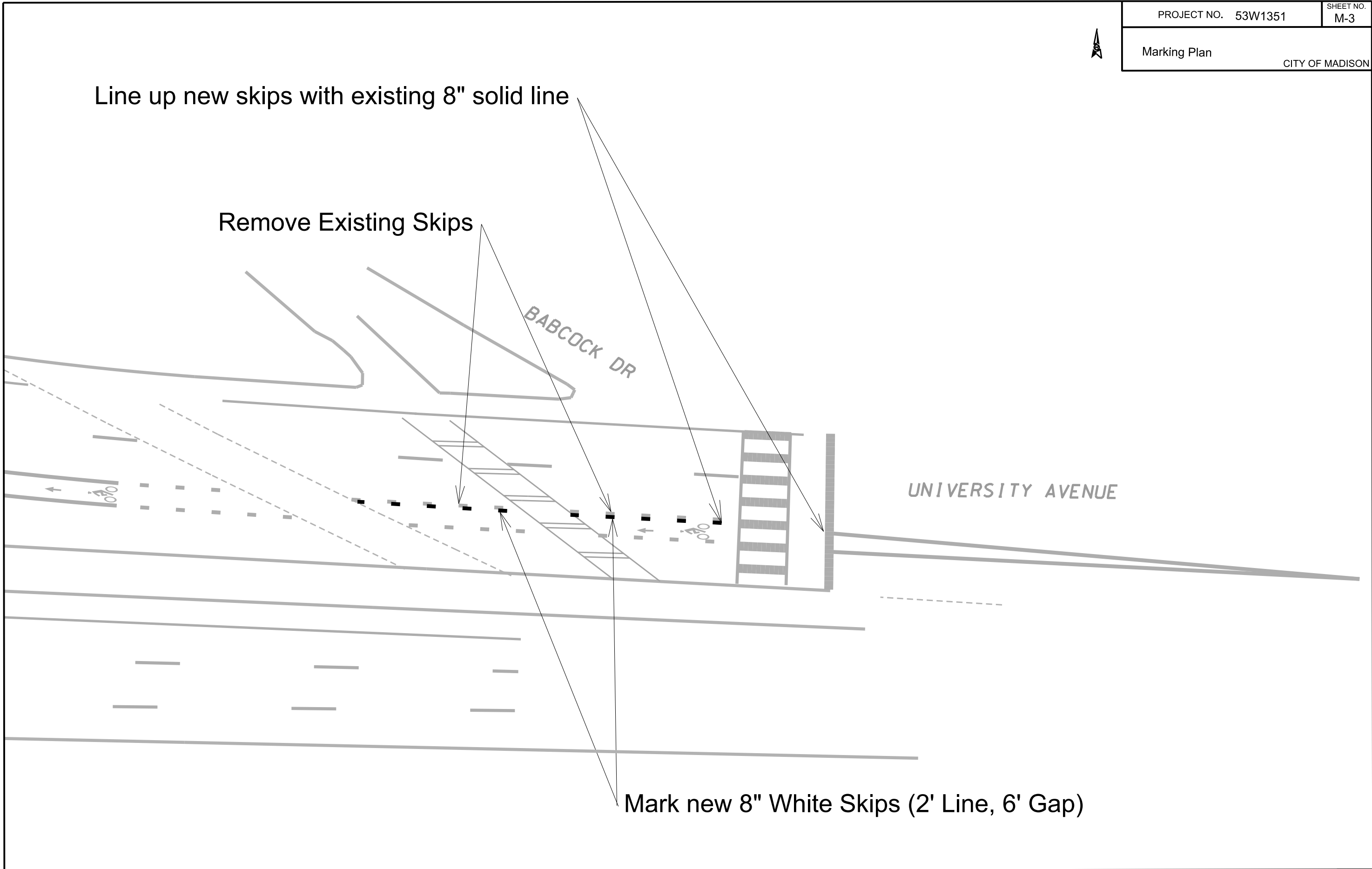



6" Crosswalk, White over existing markings

24" Stop Line, White over existing marking

24" Stop Line, White over existing marking

Double Yellow

6" Skips (10' Line, 30' Gap), White

Approximate Marking Limits

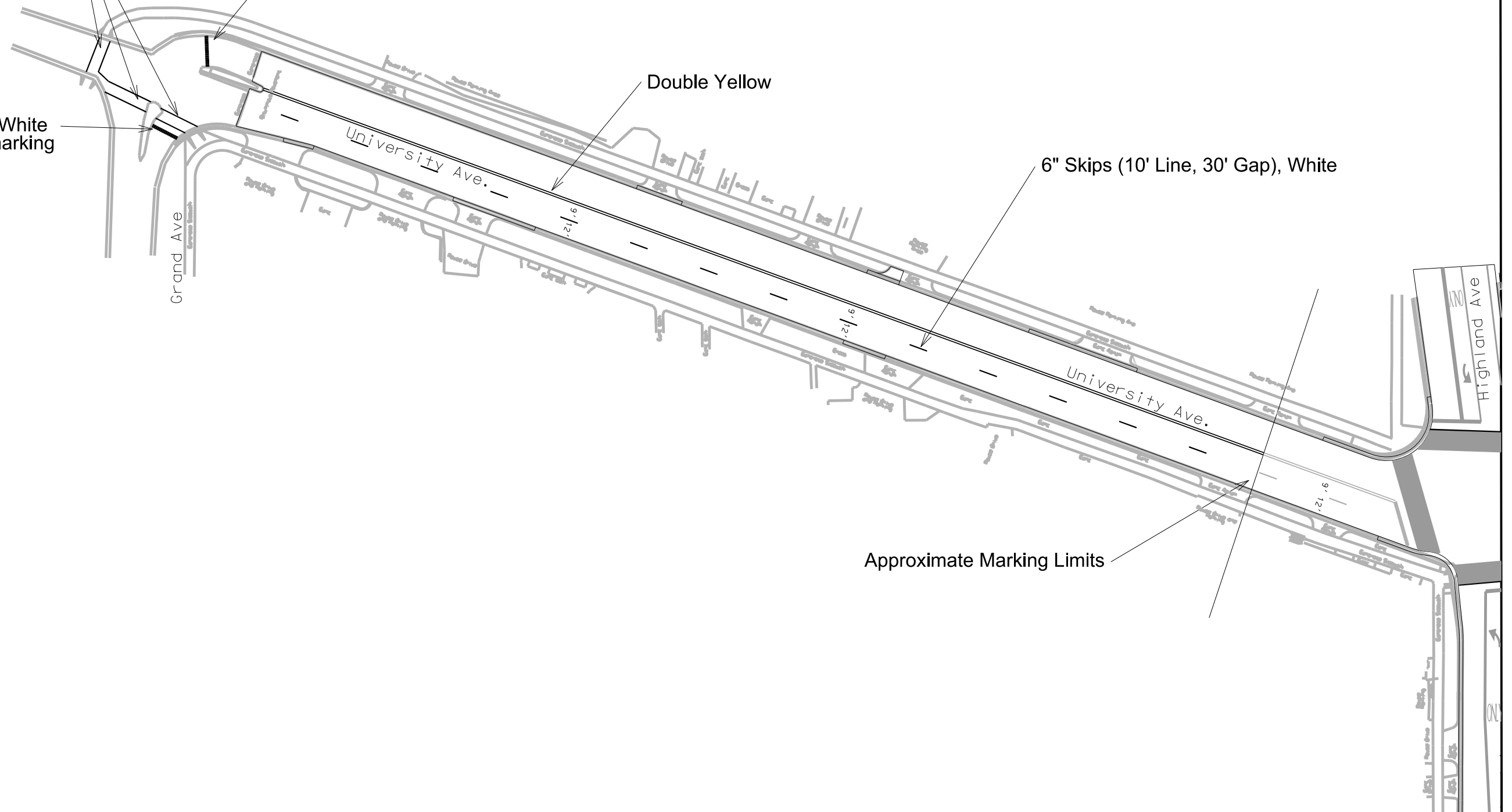

PLOT SCALE: \_\_\_\_\_

PLOT NAME: \_\_\_\_\_

REV. DATE: \_\_\_\_\_

ORIGINATOR: CITY OF MADISON, I.E. \_\_\_\_\_

FILE NAME=



### BIKE LANE MARKING DETAILS

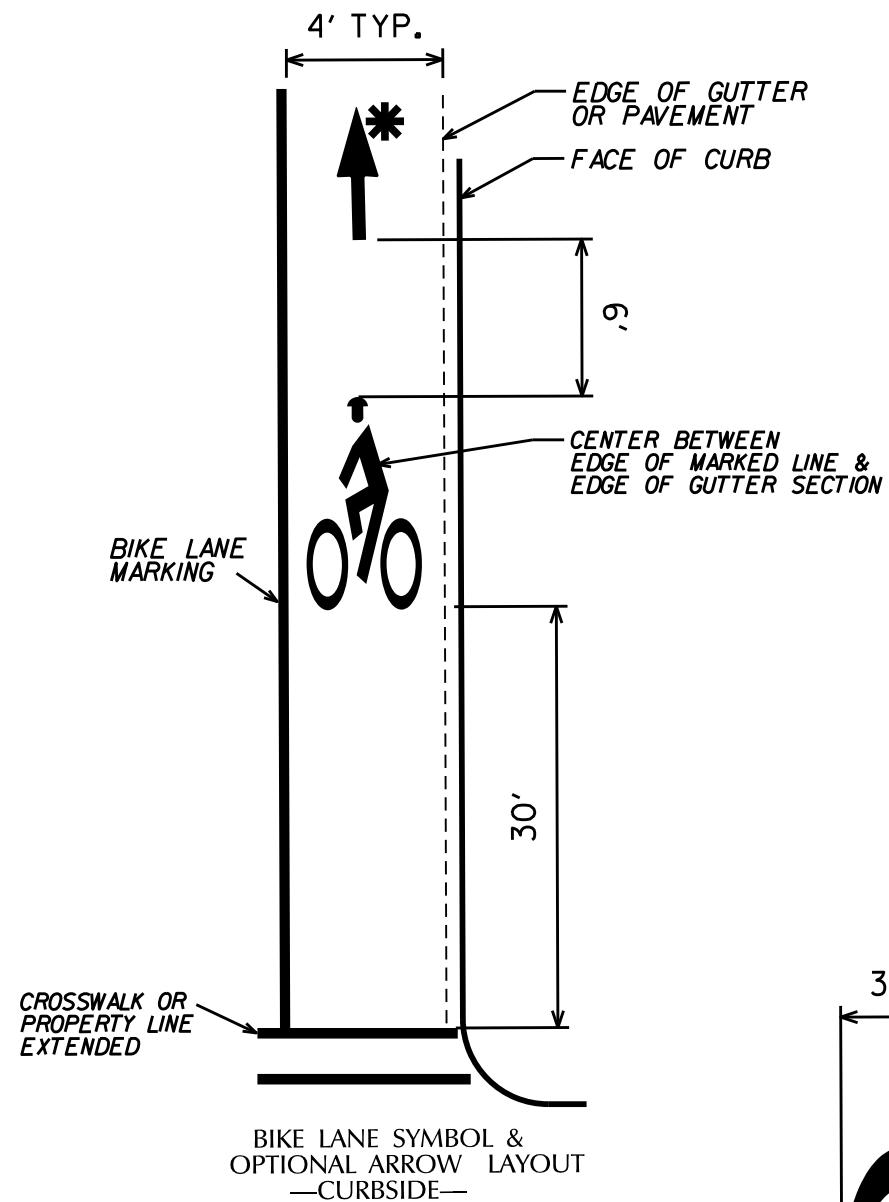

BIKE LANE SYMBOL & OPTIONAL ARROW LAYOUT —CURBSIDE—

\*ARROW OPTIONAL TO BE CALLED OUT IN PLAN

LEFT ARROW'S DIMENSIONS SAME AS SHOWN ON RIGHT ARROW

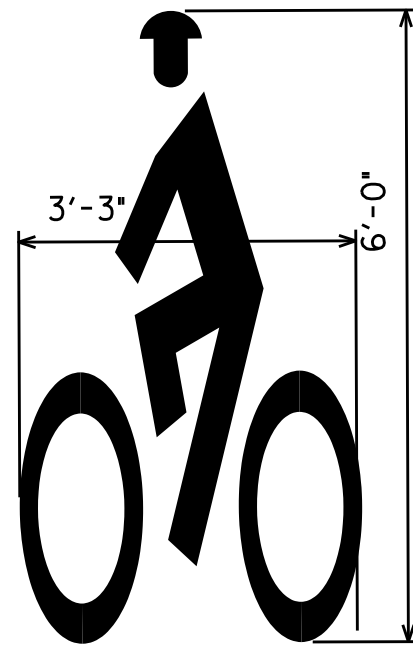
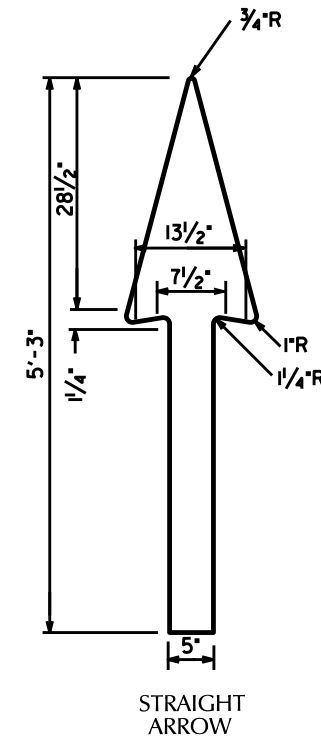
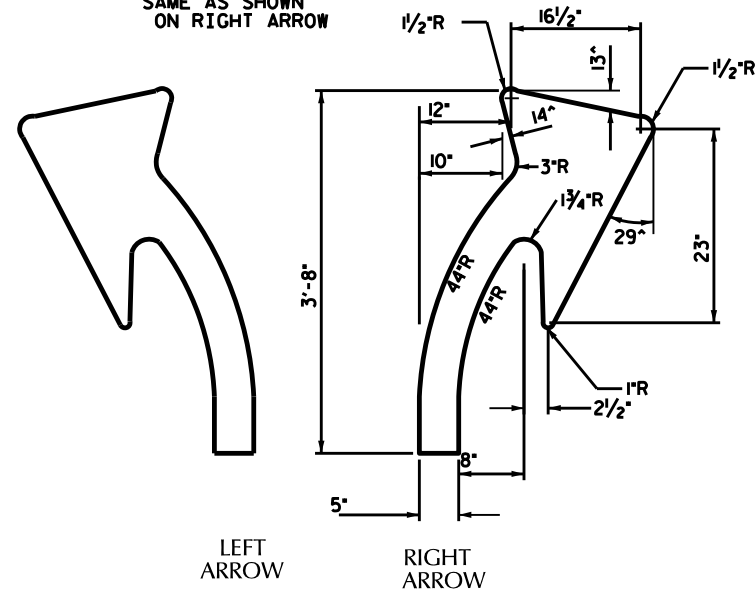

BIKE LANE SYMBOL FACING TRAFFIC LANE

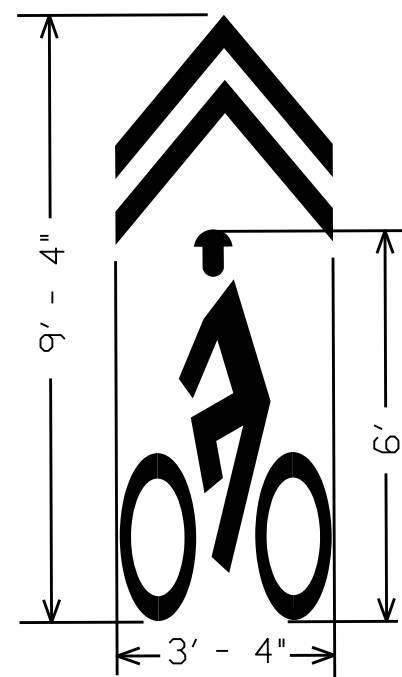

SHAROW DETAIL

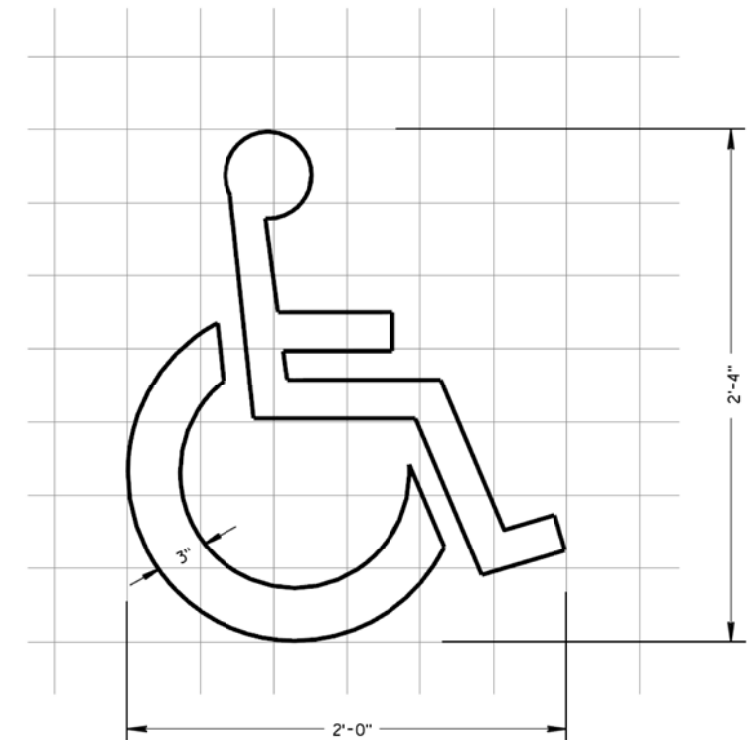

DISABLED PARKING SYMBOL

FULL SIZE PATTERNS FOR ARROWS & WORD LEGENDS ARE AVAILABLE AT:  
CITY OF MADISON TRAFFIC ENGINEERING  
FIELD OPERATIONS FACILITY  
1120 SAYLE ST. (608)266-4767

PLOT SCALE: \_\_\_\_\_

PLOT NAME: \_\_\_\_\_

REV. DATE: \_\_\_\_\_

ORIGINATOR: CITY OF MADISON, I.E. \_\_\_\_\_

CAMPUS DRIVE

BITUMINOUS

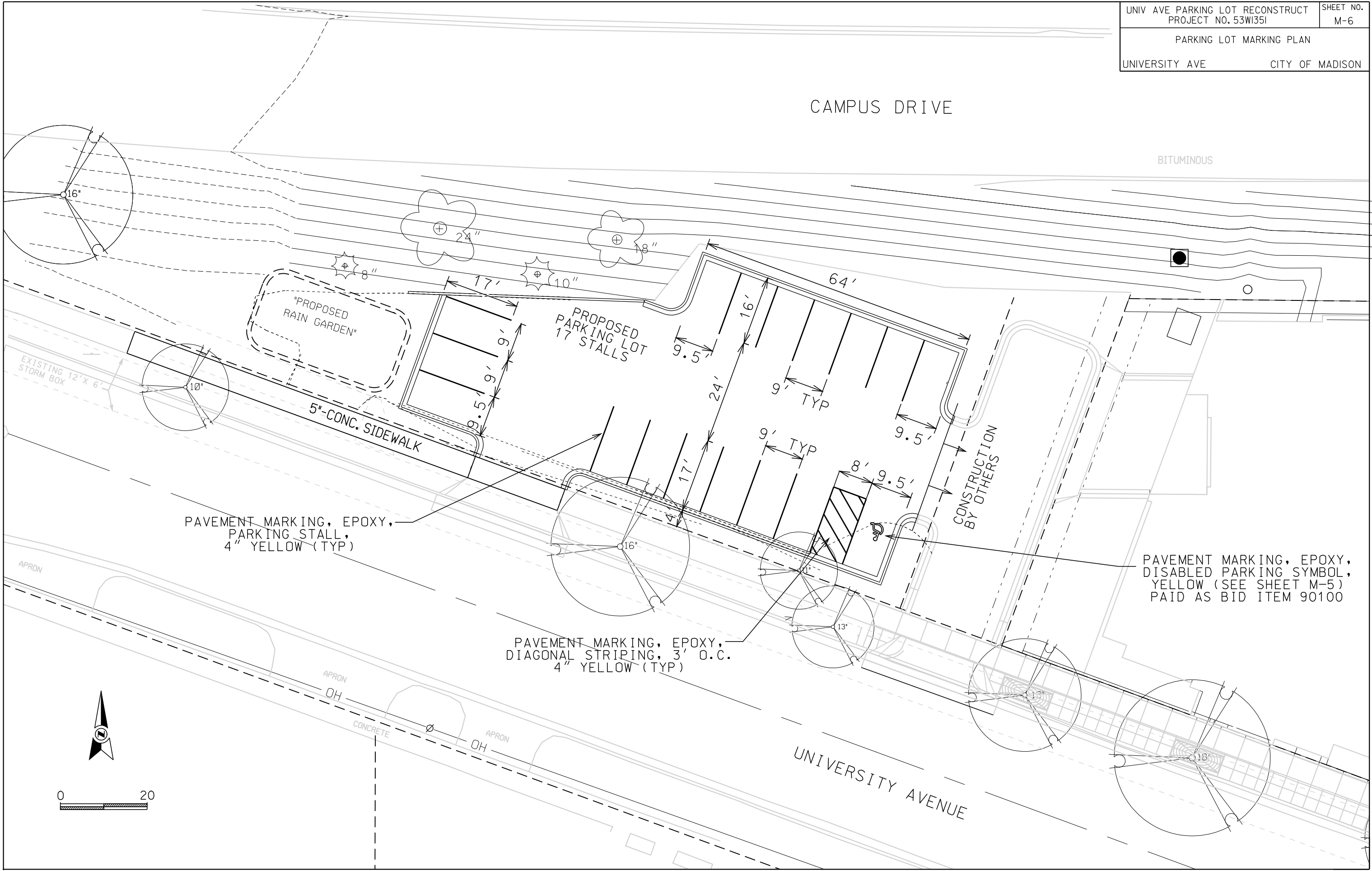

PLOT SCALE: .....  
PLOT NAME: .....  
REV. DATE: .....

PAVEMENT MARKING, EPOXY,  
PARKING STALL,  
4" YELLOW (TYP)

PAVEMENT MARKING, EPOXY,  
DIAGONAL STRIPING, 3' O.C.  
4" YELLOW (TYP)

PAVEMENT MARKING, EPOXY,  
DISABLED PARKING SYMBOL,  
YELLOW (SEE SHEET M-5)  
PAID AS BID ITEM 90100



ORIGINATOR: CITY OF MADISON, STREETS DIVISION