



Madison, Wisconsin

CONVENTIONAL SIGNS

COMBUSTIBLE FLUIDS



UNDERGROUND UTILITIES

NOTE: FIELD VERIFY UTILITIES

STORM SEWER
SANITARY SEWER
WATER
POWER POLE
RAILROAD

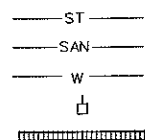

INDEX OF SHEETS

SHEET NO. U1-U4 UTILITY PLAN
SHEET NO. U5 STORM SEWER SCHEDULE

CITY OF MADISON

CITY ENGINEERING DIVISION DEPARTMENT OF PUBLIC WORKS

PLAN OF PROPOSED IMPROVEMENT

KENNEDY STORM BYPASS PIPE - 2012

PROJECT NO. 53W1377
CONTRACT NO. 6835

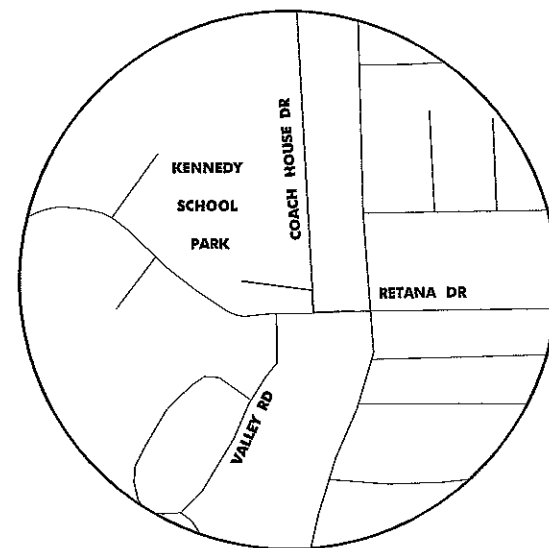
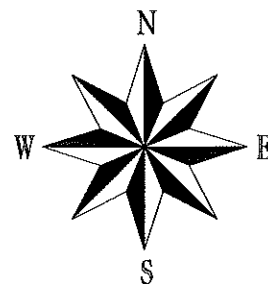

SEWER PROJECT APPROVED
MAY 15, 2011
BY THE COMMON COUNCIL
OF MADISON, WISCONSIN

DESIGN
APPROVED BY:

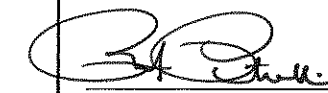
 5/25/12
City Engineer Date

STORM SEWER
DESIGNED BY:

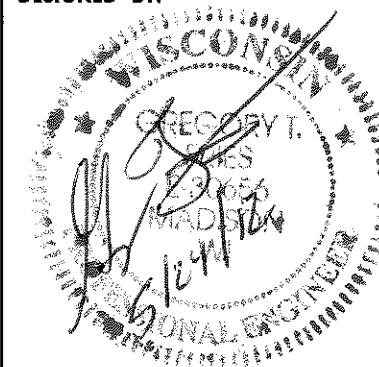

EROSION CONTROL NOTE:
-INLET PROTECTION TYPE 'D' HYBRID
REQUIRED ON ALL PROPOSED AND EXISTING
INLETS WITHIN 2 BLOCKS DOWNSTREAM OF
STREET CONSTRUCTION
-STREET TRENCH SHALL BE ROCKED AT THE
END OF DAY TO PREVENT TRACKING

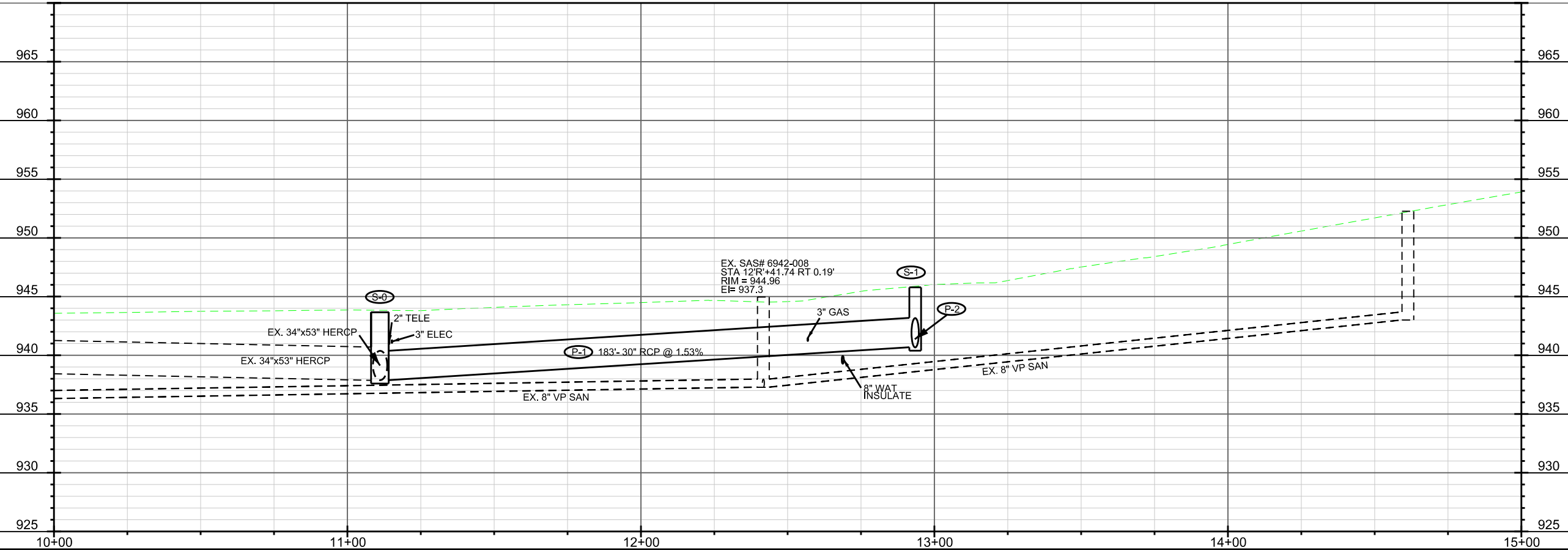
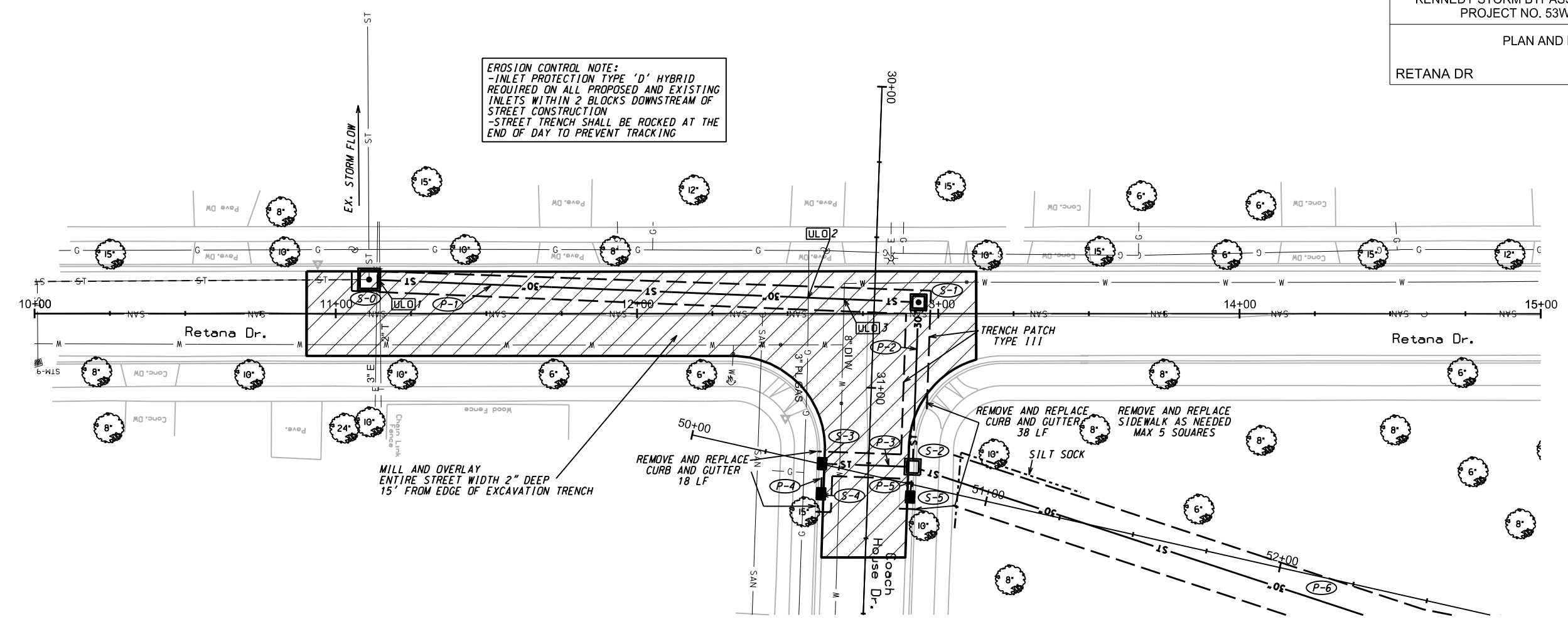

PLOT SCALE: _____
PLOT NAME: _____
REV. DATE: _____
ORIGINATOR: CITY OF MADISON, STREETS DIVISION

PLAN AND PROFILE

COACH HOUSE DR

CITY OF MADISON

REVISÉD 7/26/12 MKC

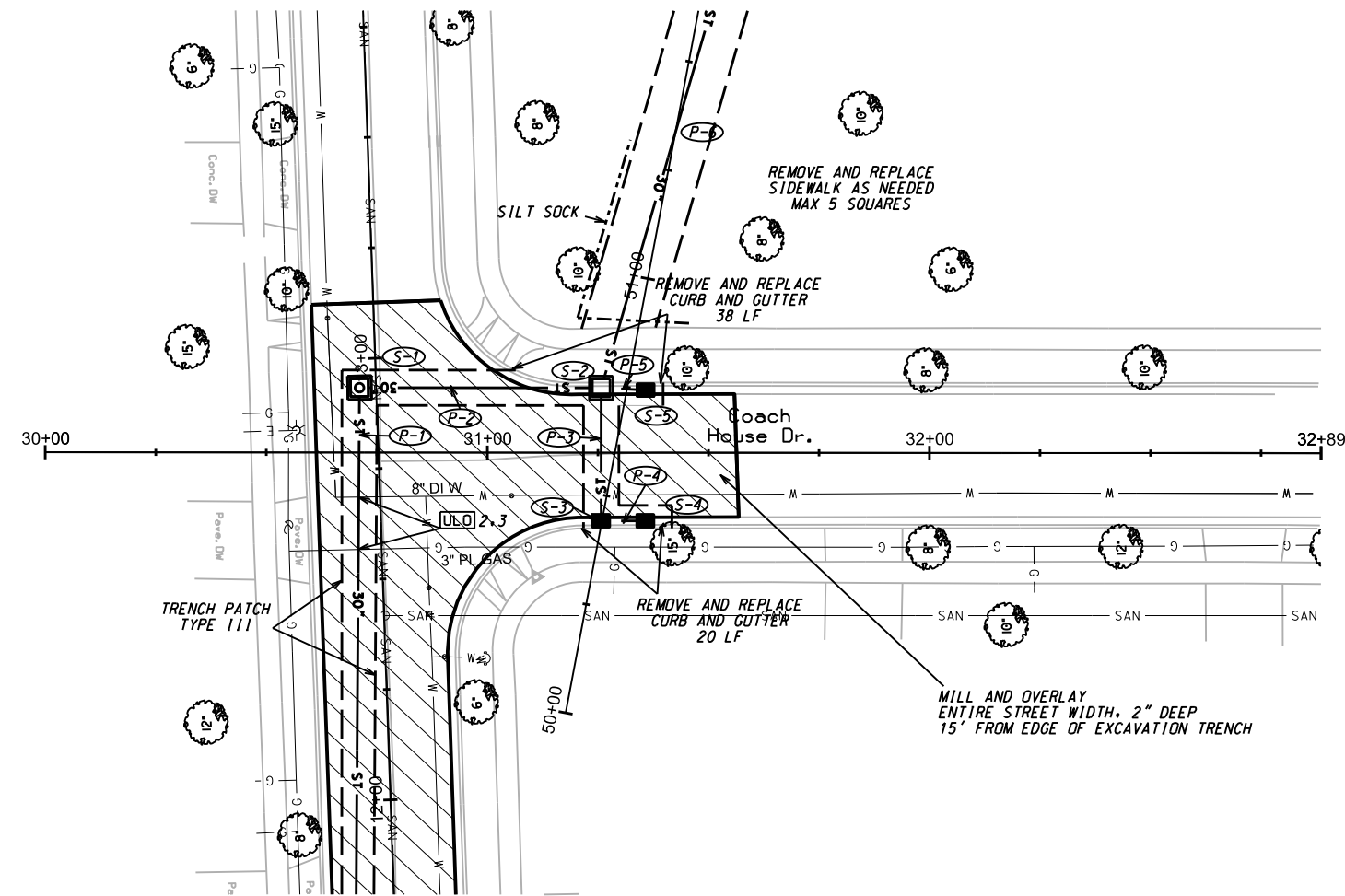

EROSION CONTROL NOTE:
 -INLET PROTECTION TYPE 'D' HYBRID
 REQUIRED ON ALL PROPOSED AND EXISTING
 INLETS WITHIN 2 BLOCKS DOWNSTREAM OF
 STREET CONSTRUCTION
 -STREET TRENCH SHALL BE ROCKED AT
 THE END OF DAY TO PREVENT TRACKING

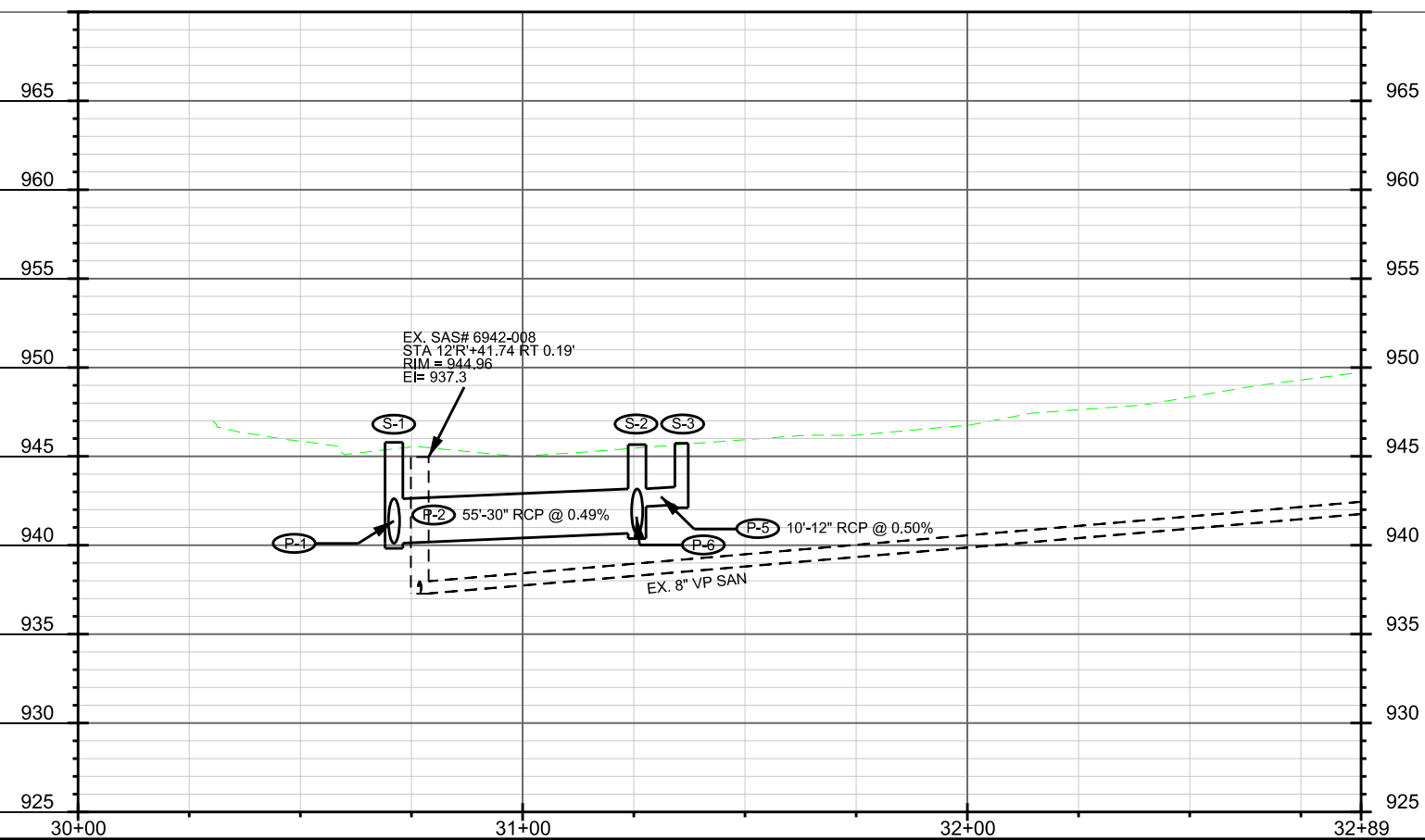

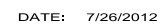
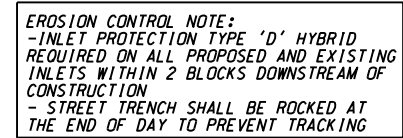

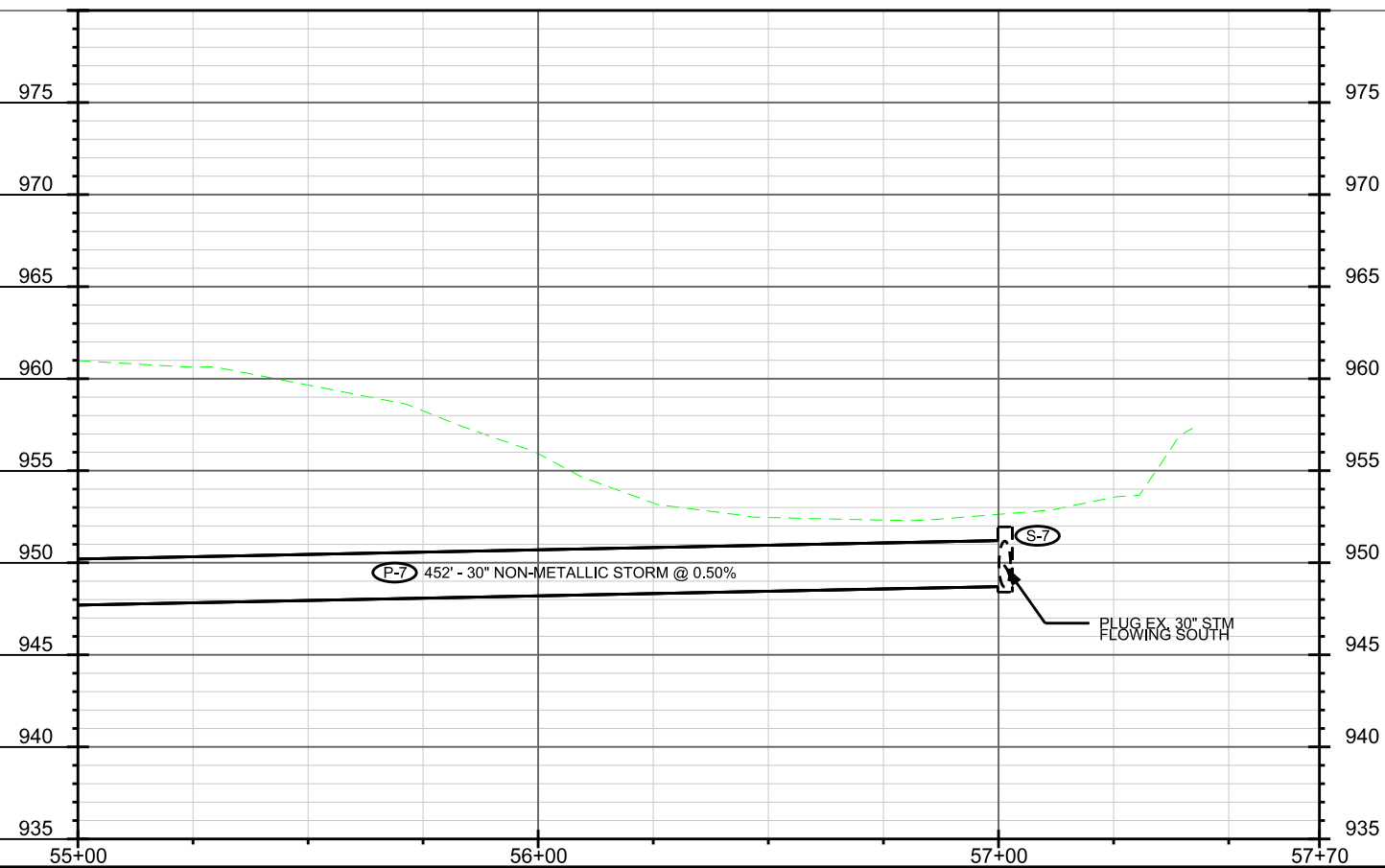
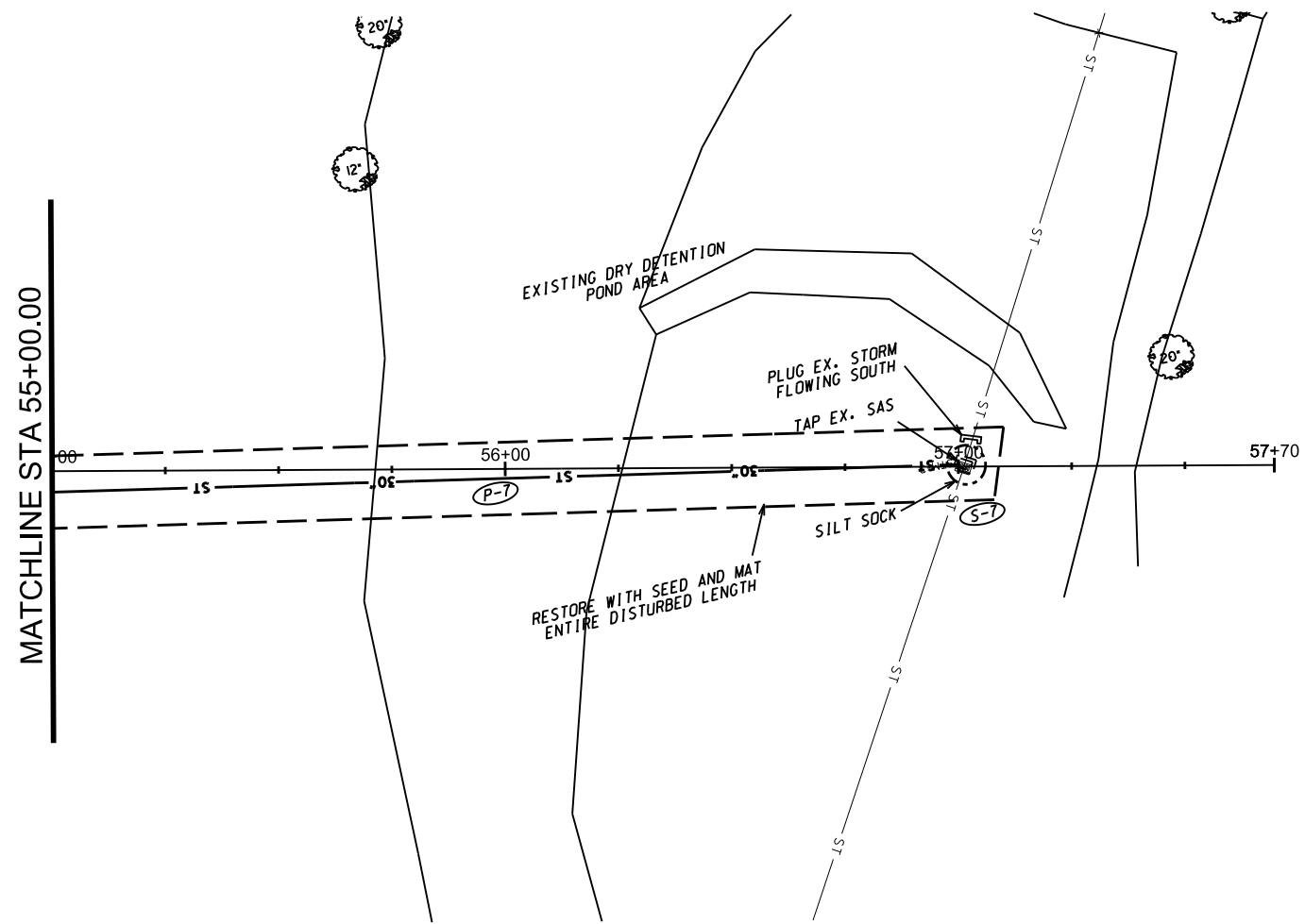

STORM SEWER SCHEDULE

ALIGNMENT CODES:

'R' = RETANA DR
'CH' = COACH HOUSE DR
'K' = KENNEDY SCHOOL PARK

KENNEDY STORM BYPASS PIPE - 2012

PROJECT NO. 53W1377

SHEET NO.

U-5

STORM SEWER SCHEDULE

CITY OF MADISON

STRUCTURES

STRUC. NO.	STATION	LOCATION (OFFSET)	TYPE	TOP OF CASTING	E.I.	DEPTH	NOTES
* S-0	11'R'+11.05	LT-11.25	6X6 SAS	943.66	937.87	5.79	FP, W/ R-1916-F (2)
* S-1	12'R'+93.45	LT-3.75	4X4 SAS	945.79	940.67	5.12	W/ R-1550-0054
* S-2	31'CH'+25.74	LT-14.66	4X4 SAS	946.08	940.94	5.14	W/ R-3067-7004
* S-3	31'CH'+25.74	RT-15.92	H INLET	945.36	942.35	3.01	FP, W/ R-3067-7004
* S-4	31'CH'+35.74	RT-15.92	H INLET	945.54	942.65	2.89	FP, W/ R-3067-7004
* S-5	31'CH'+35.74	LT-14.66	H INLET	946.15	942.49	3.66	W/ R-3067-7004
* S-6	52'K'+49.12	RT-11.06	3X3 SAS	955.42	945.95	9.47	FP, W/ R-1550-0054
S-7	57'K'+01.49	CL	EX. INLET	951.95	948.70	3.25	PLUG PIPE FLOWING SOUTH

PIPES

PIPE NO.	FROM (DNSTM)	TO (UPSTM)	LGTH (FT)	DISCH. E.I.	INLET E.I.	SLOPE (%)	PIPE SIZE	TYPE	*REVISED MKC 7/26/12 NOTES
* P-1	S-0	S-1	183	937.87	940.67	1.53%	30"	RCP	
* P-2	S-1	S-2	55	940.67	940.94	0.49%	30"	RCP	
* P-3	S-2	S-3	31	942.19	942.35	0.52%	15"	RCP	
* P-4	S-3	S-4	10	942.60	942.65	0.50%	12"	RCP	
* P-5	S-2	S-5	10	942.44	942.49	0.50%	12"	RCP	
* P-6	S-2	S-6	176	940.94	945.95	2.85%	30"	STORM	(1)
P-7	S-6	S-7	452	946.45	948.70	0.50%	30"	STORM	(1)

ULO

ULO NO.	STATION	LOCATION (OFFSET)	TYPE
ULO #1	11'R'+14.24	LT-11.05	ELEC, TELE
ULO #2	12'R'+56.86	LT-5.27	GAS
ULO #3	12'R'+68.77	LT-4.76	WATER

STANDARD NOTES:

- ABBREVIATIONS: AE = APRON ENDWALL; RCP = REINFORCED CONCRETE PIPE; HERCP = HORIZONTAL ELLIPTICAL REINFORCED CONCRETE PIPE; DNA = DOES NOT APPLY; SAS = SEWER ACCESS STRUCTURE; LP = LOW POINT INLET STRUCTURE; FP = FIELD POURED STRUCTURE; TR = TOP OF CONCRETE ROOF; NCM = NO CROWN MATCH FOR PIPES
- APPROXIMATE DISCHARGE E.I. GIVEN, ADJUST E.I. AND PIPE SLOPE IN THE FIELD.
- TOP OF CASTING GRADE GIVEN IS THE TOP OF CURB FOR INLET STRUCTURES AND THE FLOWLINE OF THE CLOSED CASTING FOR SAS's.
- TOP OF CONCRETE ROOF (TR) IS 1.25' BELOW TOP OF CASTING UNLESS OTHERWISE NOTED.
- ALL REINFORCED CONCRETE PIPES TO BE CLASS III UNLESS OTHERWISE NOTED.
- SURVEYOR TO CONFIRM THAT ALL INLET STATION / OFFSETS LINE UP WITH PROPOSED CURB AND GUTTER.
- ALL STRUCTURES CALLED OUT AS FIELD POURED SHALL BE FIELD POURED. ALL OTHER STRUCTURES (NOT INDICATED AS FIELD POURED) SHALL BE SUBMITTED TO CITY ENGINEERING FOR APPROVAL IF PRECAST STRUCTURES ARE PREFERRED. CONTACT MAX CONWAY OF CITY ENGINEERING AT (608) 261-9127 FOR PRECAST APPROVALS, OR FAX SHOP DRAWINGS TO (608)264-9275.

SPECIFIC NOTES

- (1) SEE SECTION 504.2(b) OF THE CITY OF MADISON'S STANDARD SPECIFICATIONS FOR PUBLIC WORKS CONSTRUCTION (2012 ED.) FOR NON-METALLIC STORM SPECIFICATIONS
- * (2) LOCKING LIDCOVER BOLTED TO STRUCTURE