

Madison, Wisconsin

CITY OF MADISON

CITY ENGINEERING DIVISION

DEPARTMENT OF PUBLIC WORKS

PLAN OF PROPOSED IMPROVEMENT

INDEX OF SHEETS

SHEET NO.	TITLE
1	EROSION CONTROL PLAN AND CONTROL POINTS
EC-1	BARRIER DETAIL
D-1	ACCESS PATH DETAIL
D-2	PLAN SHEET INDEX
D-3	POND A/PATH A
P1-P5	POND B/PATH B
P6-P8	STORM SEWER SCHEDULE
P9	TYPICAL CROSS SECTIONS
X1-X6	

CHEROKEE MARSH STORMWATER MANAGEMENT PONDS

CITY PROJECT NO. 53W1101
CONTRACT NO. 6900

PUBLIC IMPROVEMENT DESIGN
APPROVED BY:

Michael P. Oakley 7/3/2012
City Engineer Date

DESIGNED BY:

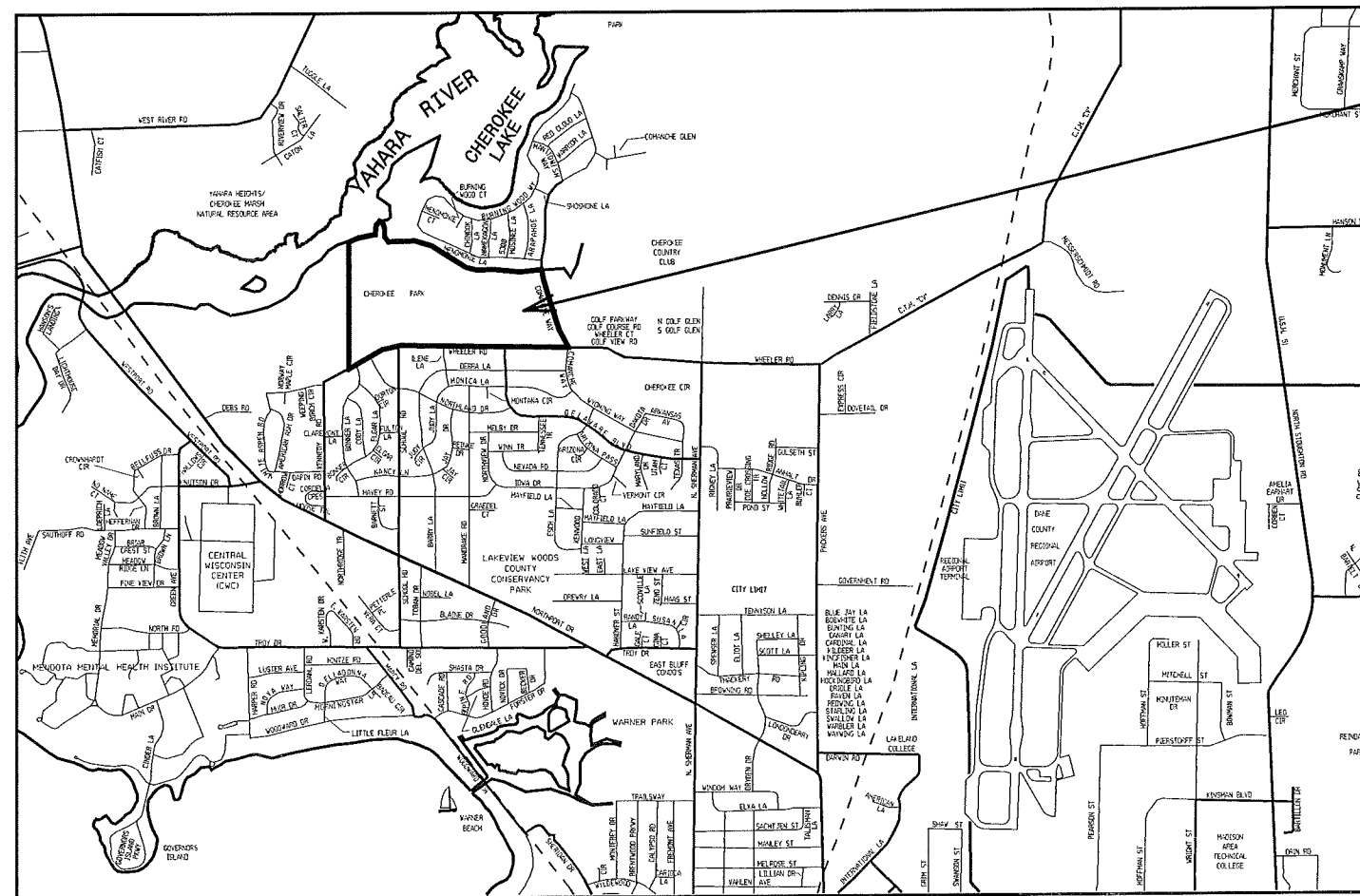
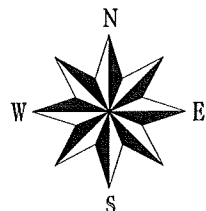
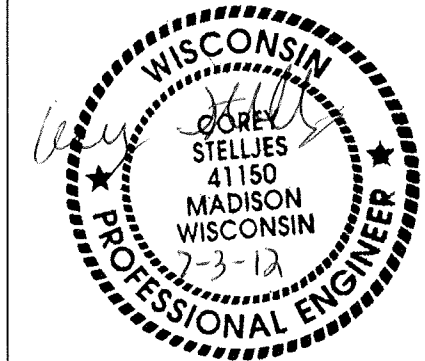

PROJECT LOCATION

- CONVENTIONAL SIGNS**
FIELD VERIFY ALL UTILITY LOCATIONS
- GAS — G —
 - STORM SEWER — ST —
 - SANITARY SEWER — SAN —
 - WATER — W —
 - OVERHEAD ELECTRIC — OH —
 - POWER POLE
 - HANDICAP RAMP
 - COMBUSTIBLE FLUIDS



ALL DISTURBED AREAS SHALL BE SEEDED AND MATTED. POND SIDESLOPES FROM WATER SURFACE ELEVATION 851.0 TO TOP OF BANK SHALL BE SEEDED WITH DETENTION BASIN MIX BID ITEM 20707. UPLAND AREAS, ACCESS ROADS, AND ACCESS ROAD SIDE SLOPES SHALL BE SEEDED WITH MIX PRAIRIE BID ITEM 20706.

ALL DISTURBED AREAS SHALL BE MATTED WITH EROSION MATTING CLASS 1 URBAN TYPE A PER THE STANDARD SPECIFICATIONS.

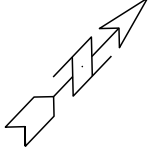

REV. DATE: PLOT NAME: PLOT SCALE:

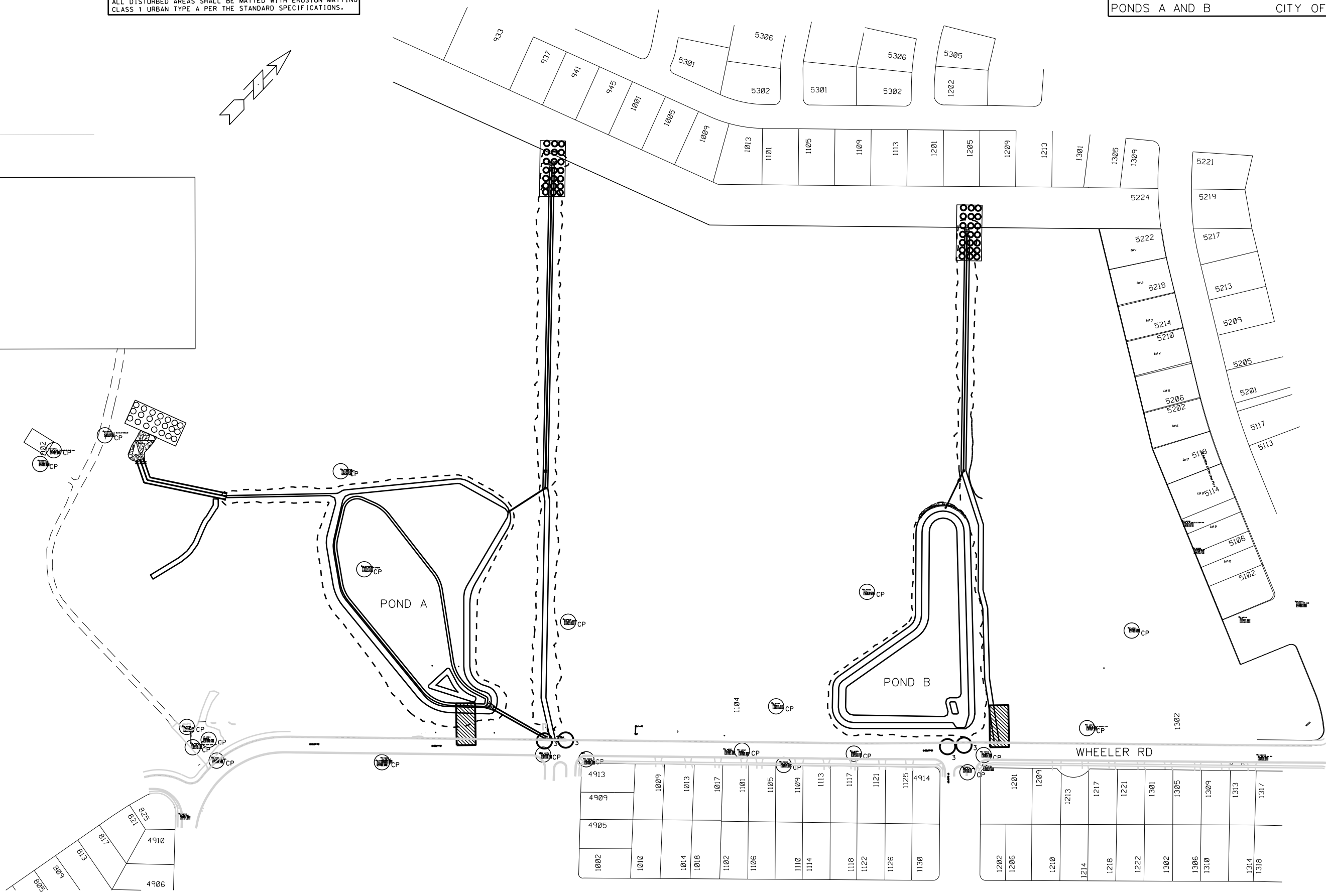
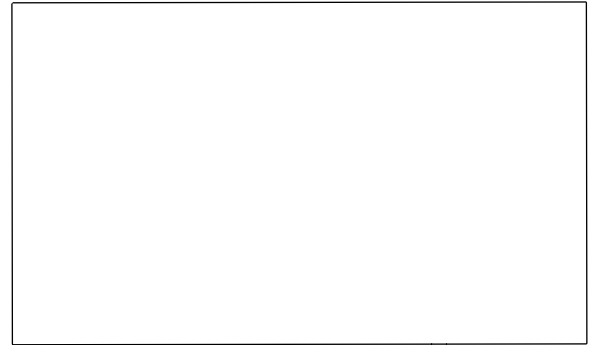

TYPICAL SECTION WITH
SHORELINE BARRIER - TYPE 1

POND A

POND B

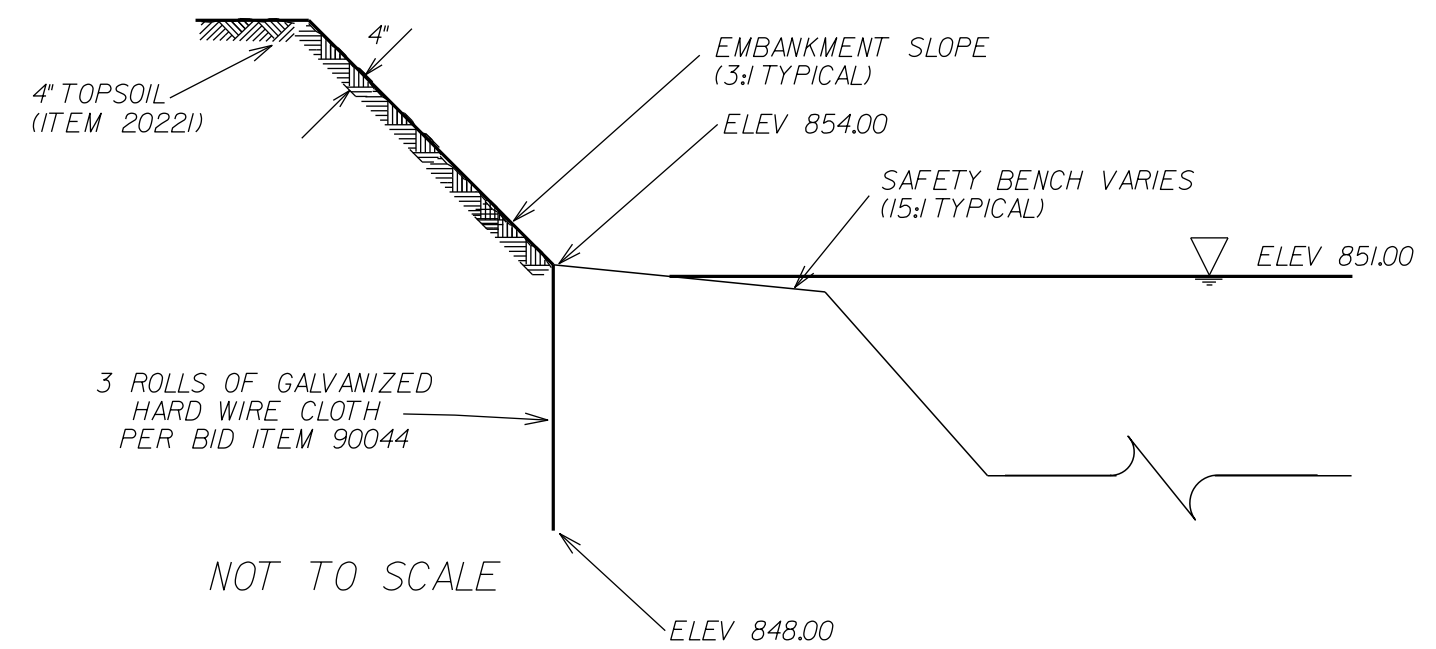
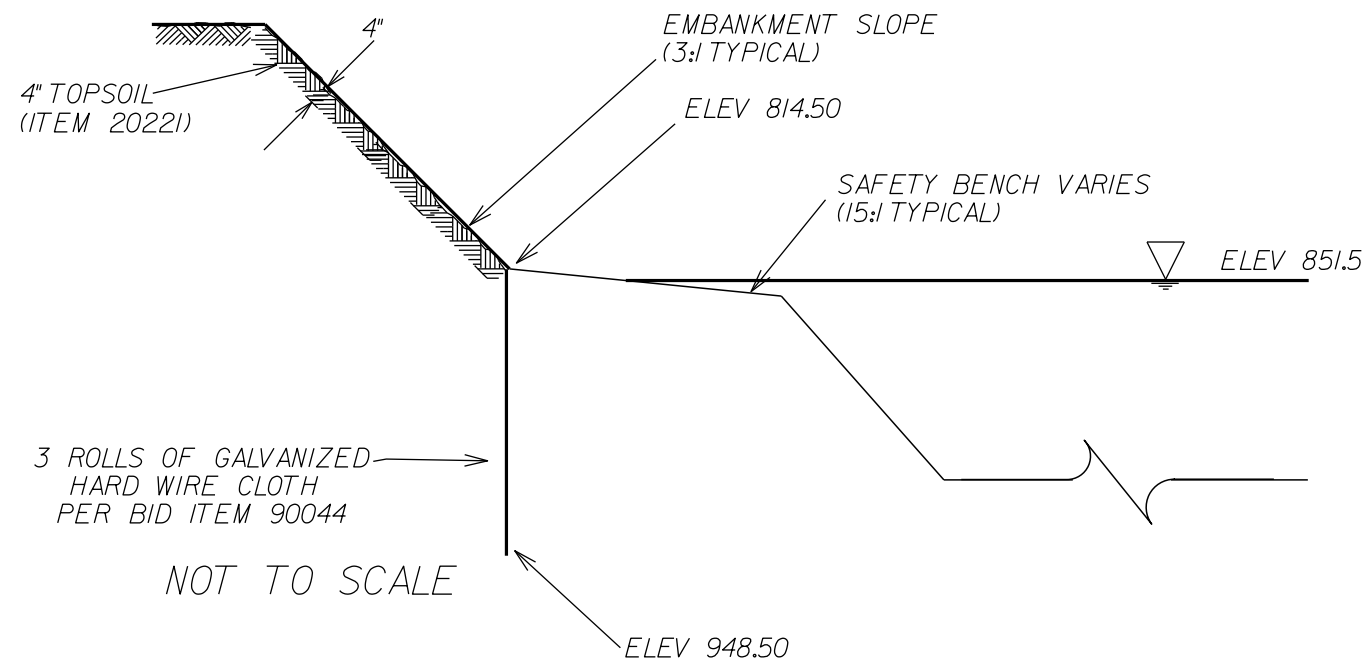

PLOT SCALE: _____

PLOT NAME: _____

REV. DATE: _____

GENERAL NOTES:

PATH SHALL BE SEEDDED WITH MIXED PRAIRIE SEED (ITEM #20706)

IMPROVE ACCESS ROAD

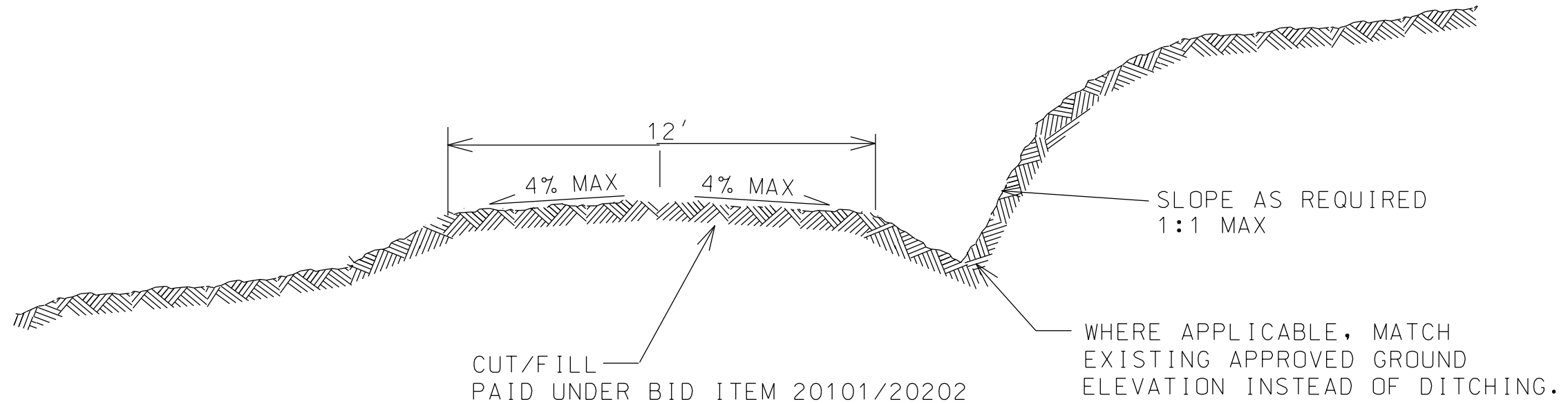

GENERAL NOTES:

PATH SHALL BE SEEDDED WITH MIXED PRAIRIE SEED (ITEM #20706)
TOPSOIL SHALL BE PAID FOR UNDER ITEM 20221

SEWER ACCESS ROAD GRADING ONLY

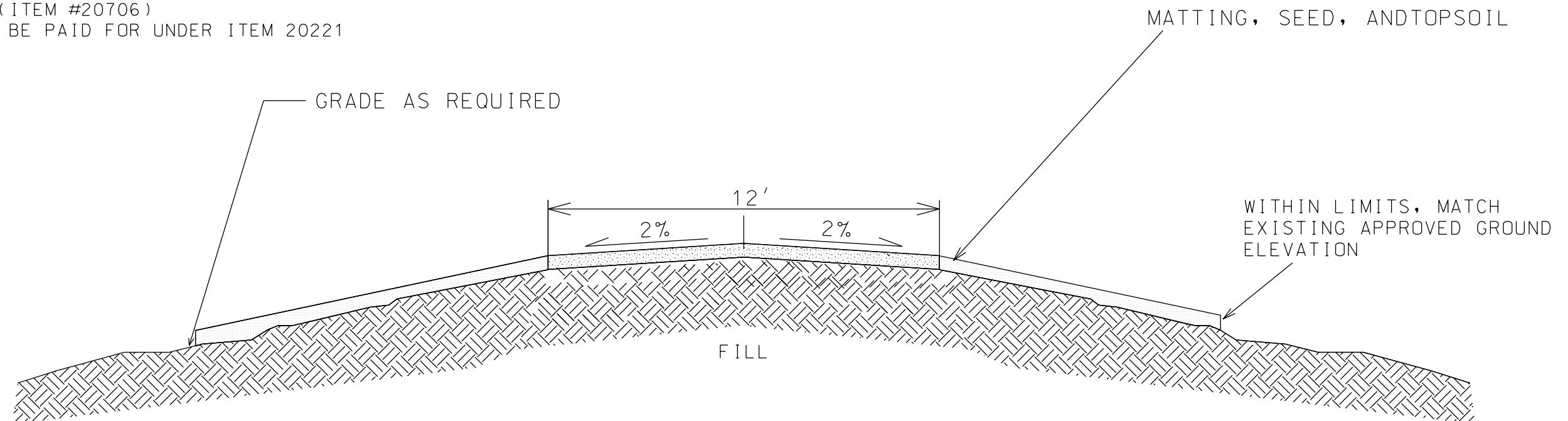

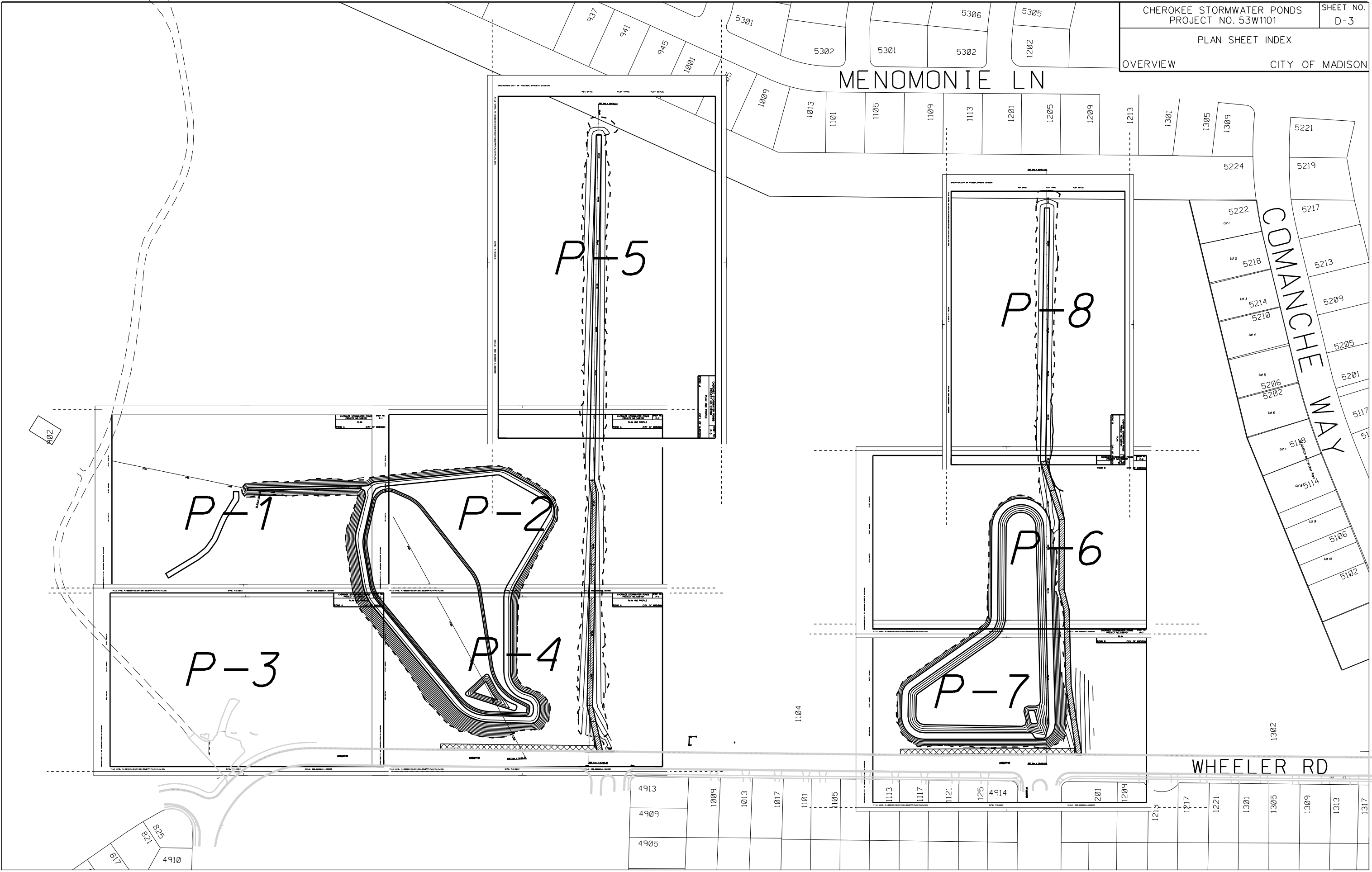

REV. DATE: PLOT NAME: PLOT SCALE:

ORIGINATOR: CITY OF MADISON, STREETS DIVISION

ALL SEWER ACCESS STRUCTURES AND APRON ENDWALLS SHALL HAVE MIN 12" CLEAR STONE BEDDING. STONE PAID UNDER ITEM 20218 CLEAR STONE

NOTIFY JOHN PODEBRADSKY AT MMSD MIN 48 HOURS PRIOR TO WORK WITHIN 20' OF SANITARY SEWER FORCEMAIN AT (608) 516-5862 OR JOHNPO@MADSEWER.ORG

RESTORE DISTURBED AREA FROM PIPE INSTALLATION WITH MIX PRAIRIE SEED MIX

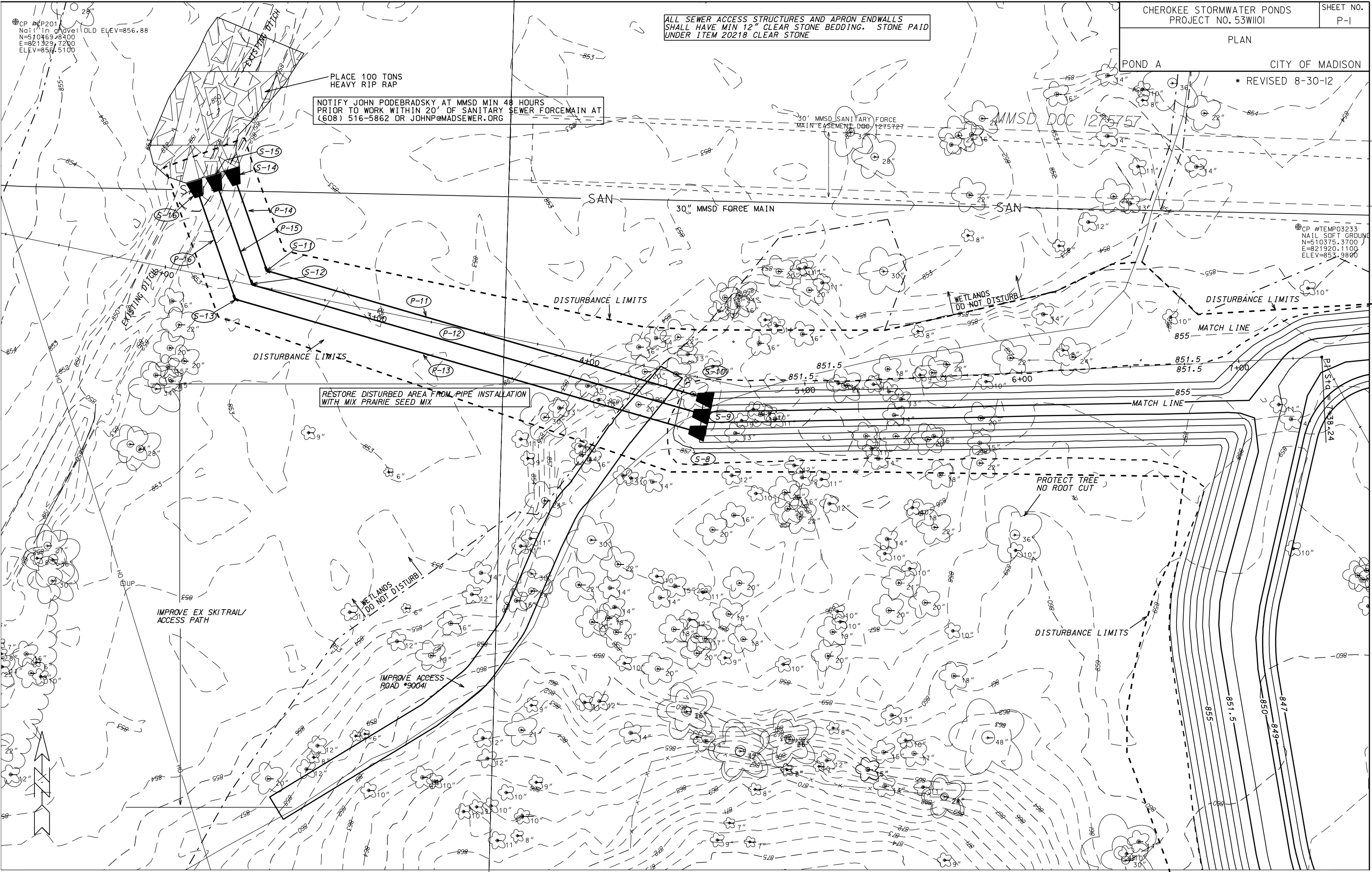

CP #P201
N=510469.8400
E=821329.7200
ELEV=856.5100

CP #TEMP03233
NAIL SOFT GROUND
N=510375.3700
E=821920.1100
ELEV=853.9800

MMSD DOC 1275757

PL STC = 738.24

ALL SEWER ACCESS STRUCTURES AND APRON ENDWALLS SHALL HAVE MIN 12" CLEAR STONE BEDDING. STONE PAID UNDER ITEM 20218 CLEAR STONE

NOTIFY JOHN PODEBRADSKY AT MMSD MIN 48 HOURS PRIOR TO WORK WITHIN 20' OF SANITARY SEWER FORCEMAIN AT (608) 546-5862 OR JOHNPM@MADSEWER.ORG

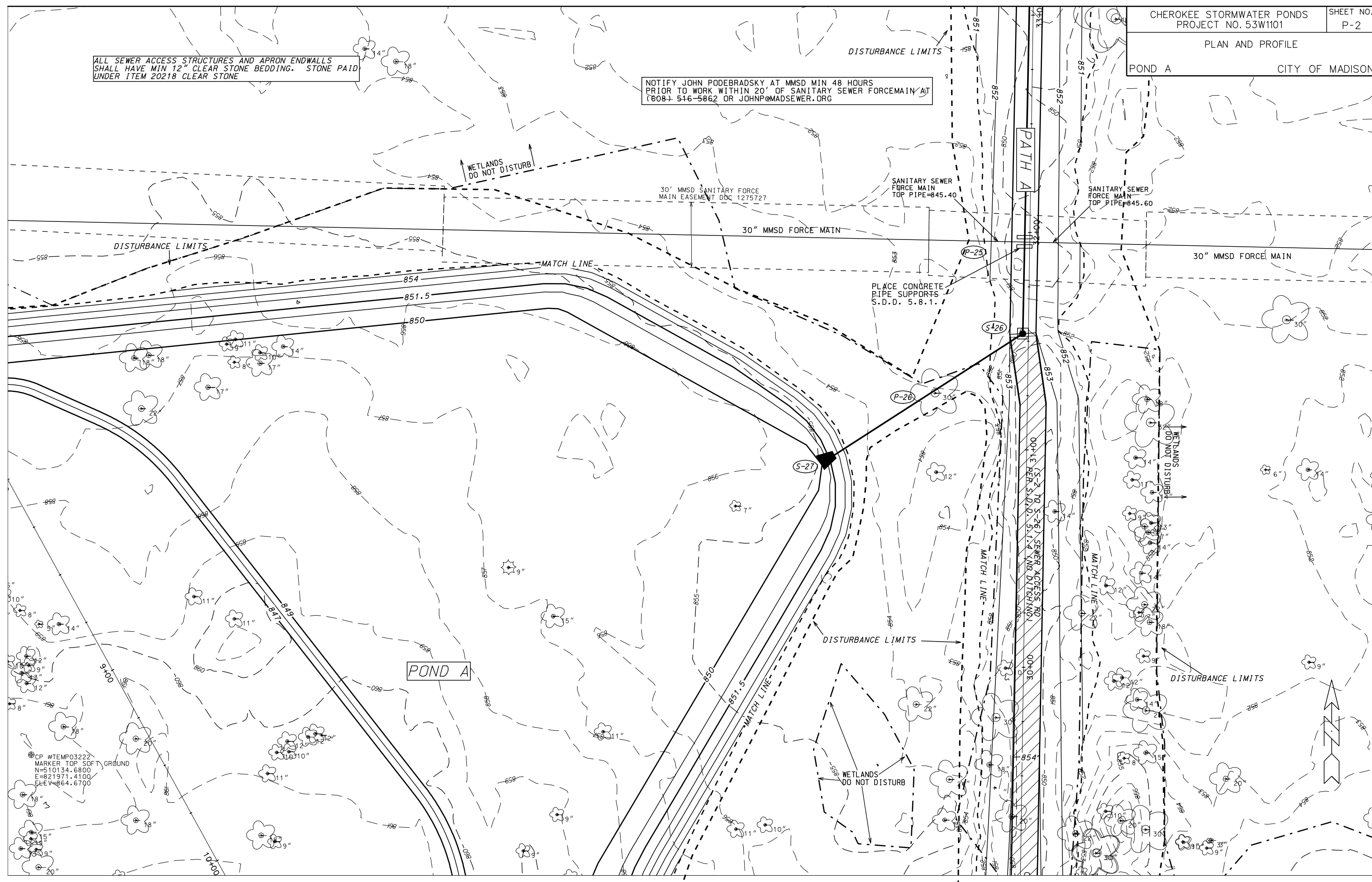

CP #TEMP03222
MARKER TOP SOFT GROUND
N=510134.6800
E=821971.4100
ELEV=864.6700

POND A

S-27 TO S-28 SEWER ACCESS RD
DO NOT PER S.D.D. 5.1.4 INR DITCHING

ALL SEWER ACCESS STRUCTURES AND APRON ENDWALLS SHALL HAVE MIN 12" CLEAR STONE BEDDING. STONE PAID UNDER ITEM 20218 CLEAR STONE

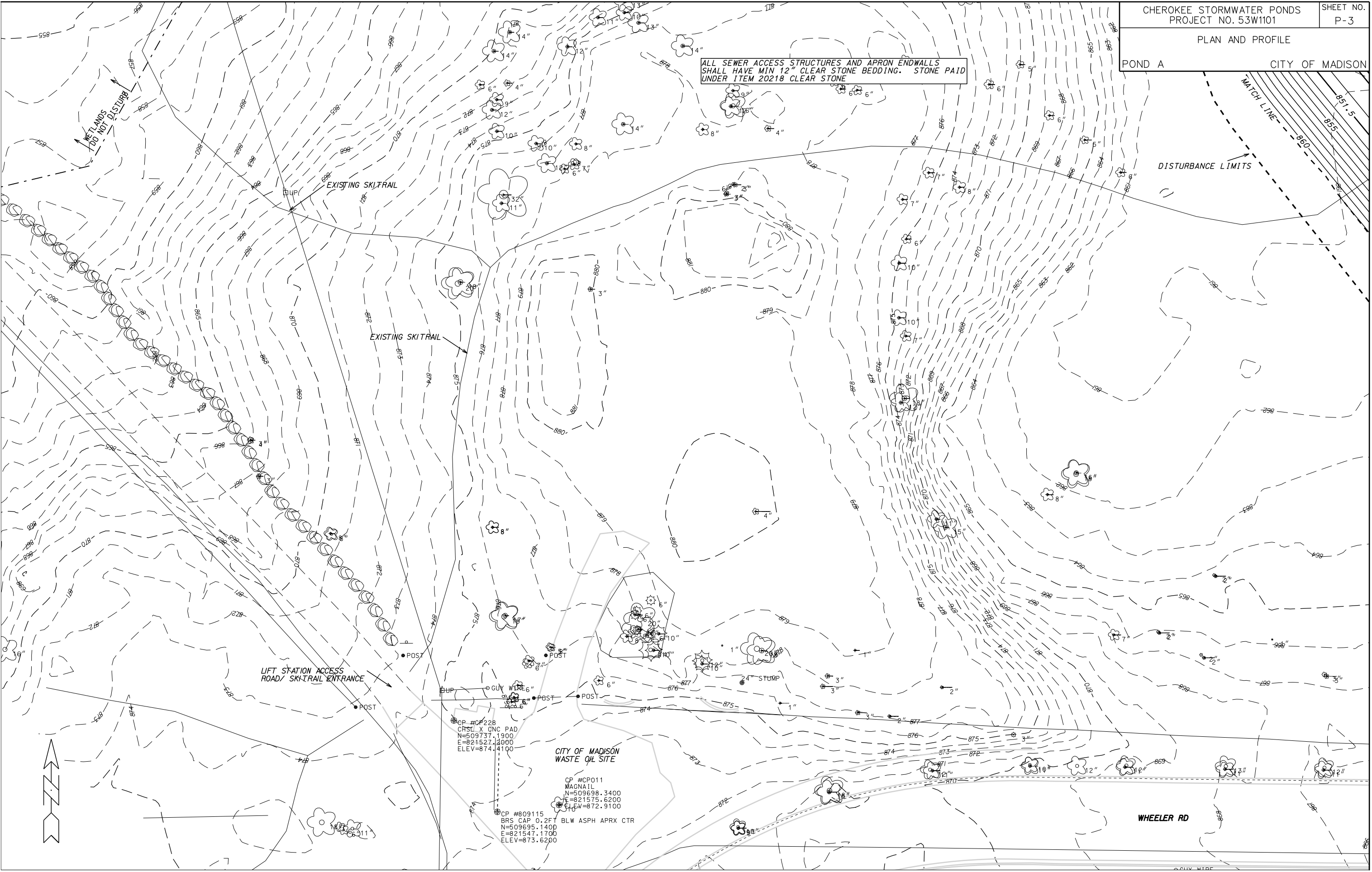

LIFT STATION ACCESS ROAD/ SKITRAIL ENTRANCE

CP #CP228
CHSL X ONC PAD
N=509737.1900
E=821527.2000
ELEV=874.4100

CITY OF MADISON
WASTE OIL SITE

CP #CP011
MAGNAIL
N=509698.3400
E=821575.6200
ELEV=872.9100

CP #809115
BRS CAP 0.2FT BLW ASPH APRX CTR
N=509695.1400
E=821547.1700
ELEV=873.6200

WHEELER RD

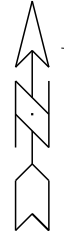

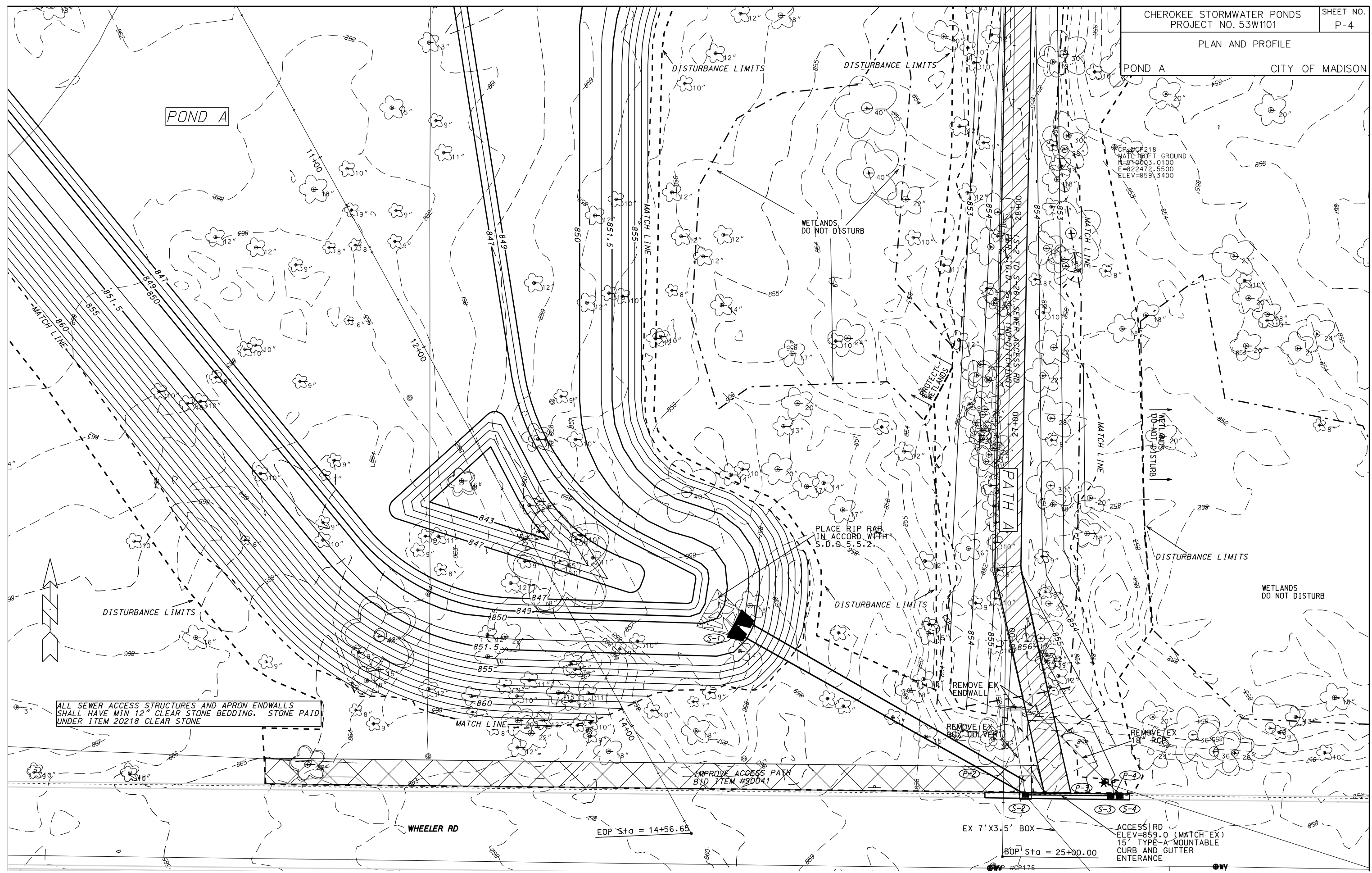

ALL SEWER ACCESS STRUCTURES AND APRON ENDWALLS SHALL HAVE MIN 12" CLEAR STONE BEDDING. STONE PAID UNDER ITEM 20218 CLEAR STONE

PLACE RIP RAP IN ACCORD WITH S.D.B. 5.5.2.

ACCESS RD ELEV=859.0 (MATCH EX) 15' TYPE-A MOUNTABLE CURB AND GUTTER ENTERANCE

EOP Sta = 14+56.65

BOP Sta = 25+00.00

CP#175

OW

PLAN AND PROFILE

POND A CITY OF MADISON

ALL SEWER ACCESS STRUCTURES AND APRON ENDWALLS
SHALL HAVE MIN 12" CLEAR STONE BEDDING. STONE PAID
UNDER ITEM 20218 CLEAR STONE

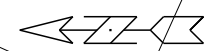

EDP STA = 40+18.57

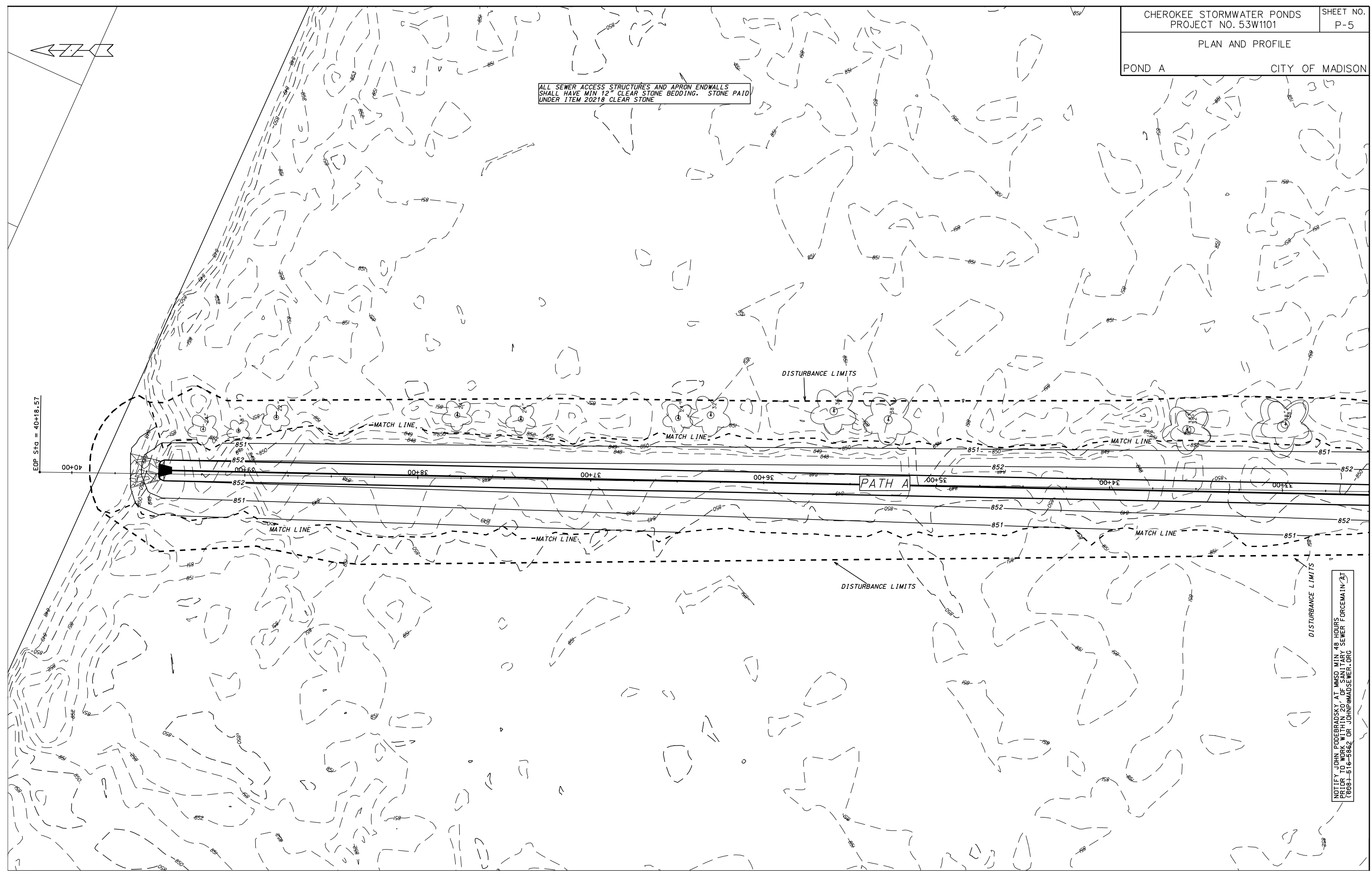

NOTIFY JOHN PODEBRADSKY, AT MMSO MIN 48 HOURS
ADVANCE AT: (608) 261-5161 OR (608) 261-5162
(608) 261-5163 OR JOHNPO@MADSEWER.ORG

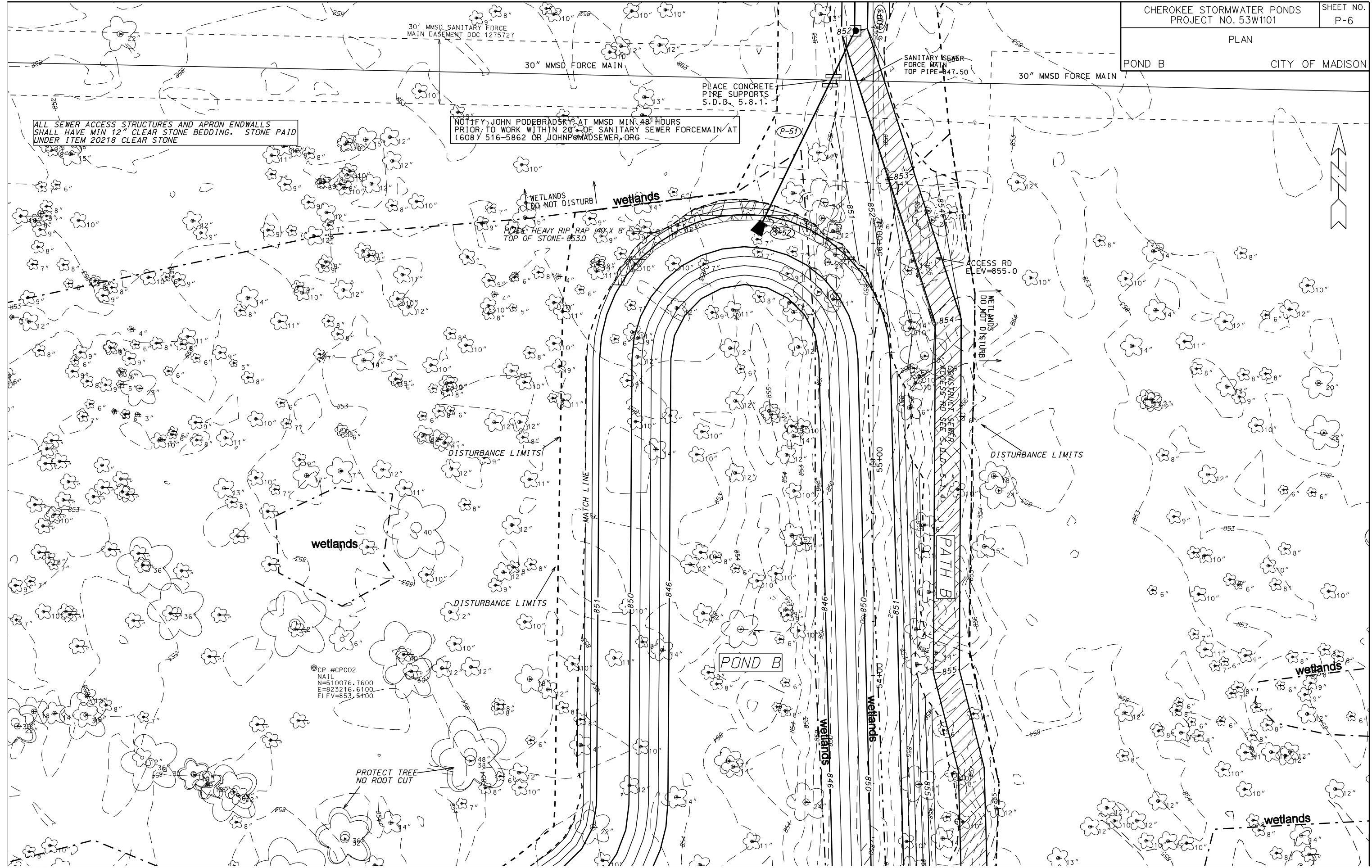

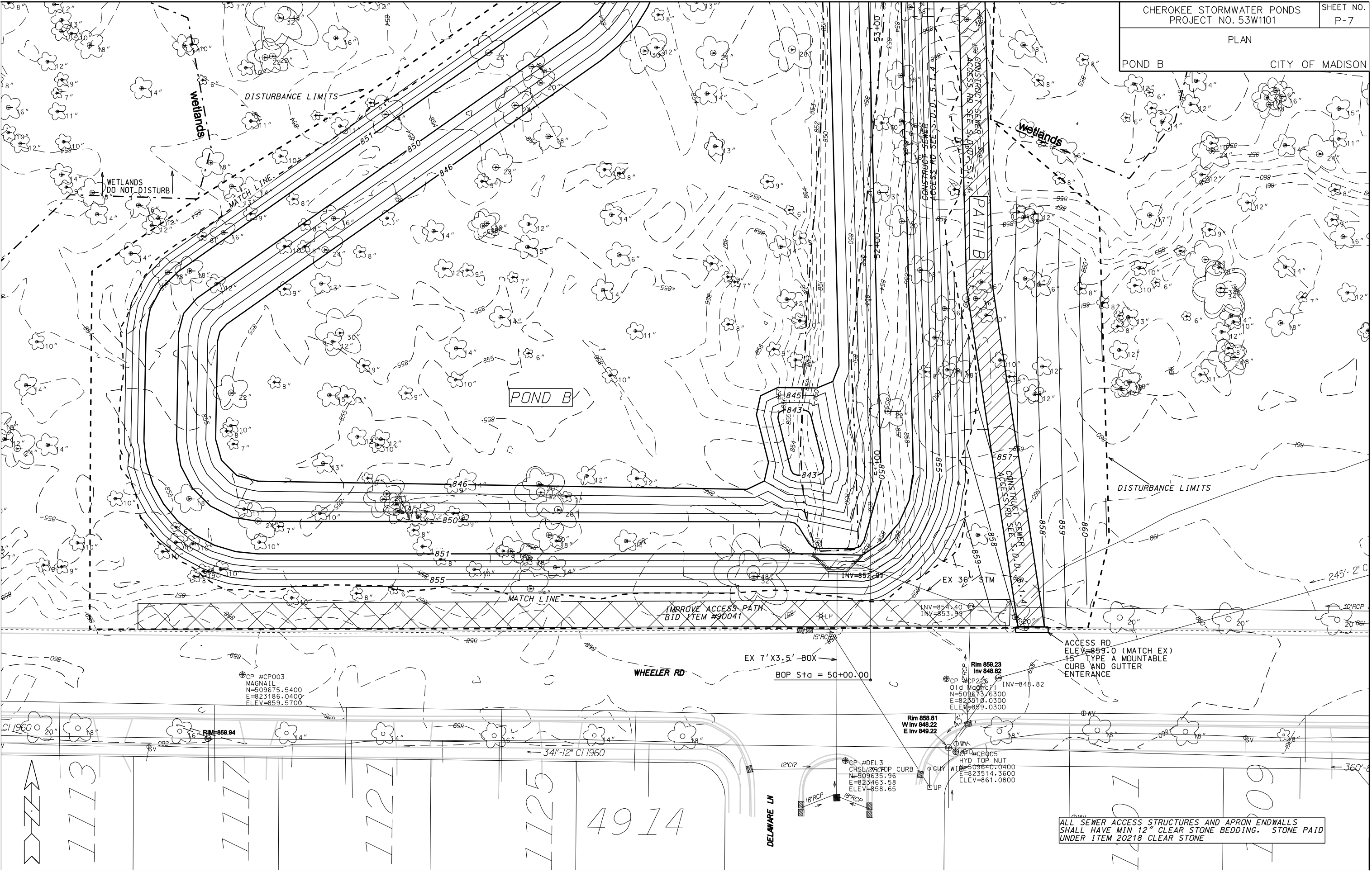

CP #CP003
MAGNAIL
N=509675.5400
E=823186.0400
ELEV=859.5700

Rim 859.23
Inv 848.82
CP #CP206
Old Magnail
N=509675.6300
E=823510.0300
ELEV=859.0300

Rim 858.81
W Inv 848.22
E Inv 849.22
CP #DEL3
CHSL/2"RCP CURB
N=509635.96
E=823463.58
ELEV=858.65

ACCESS RD
ELEV=859.0 (MATCH EX)
15" TYPE A MOUNTABLE
CURB AND GUTTER
ENTRANCE

ALL SEWER ACCESS STRUCTURES AND APRON ENDWALLS
SHALL HAVE MIN 12" CLEAR STONE BEDDING. STONE PAID
UNDER ITEM 20218 CLEAR STONE

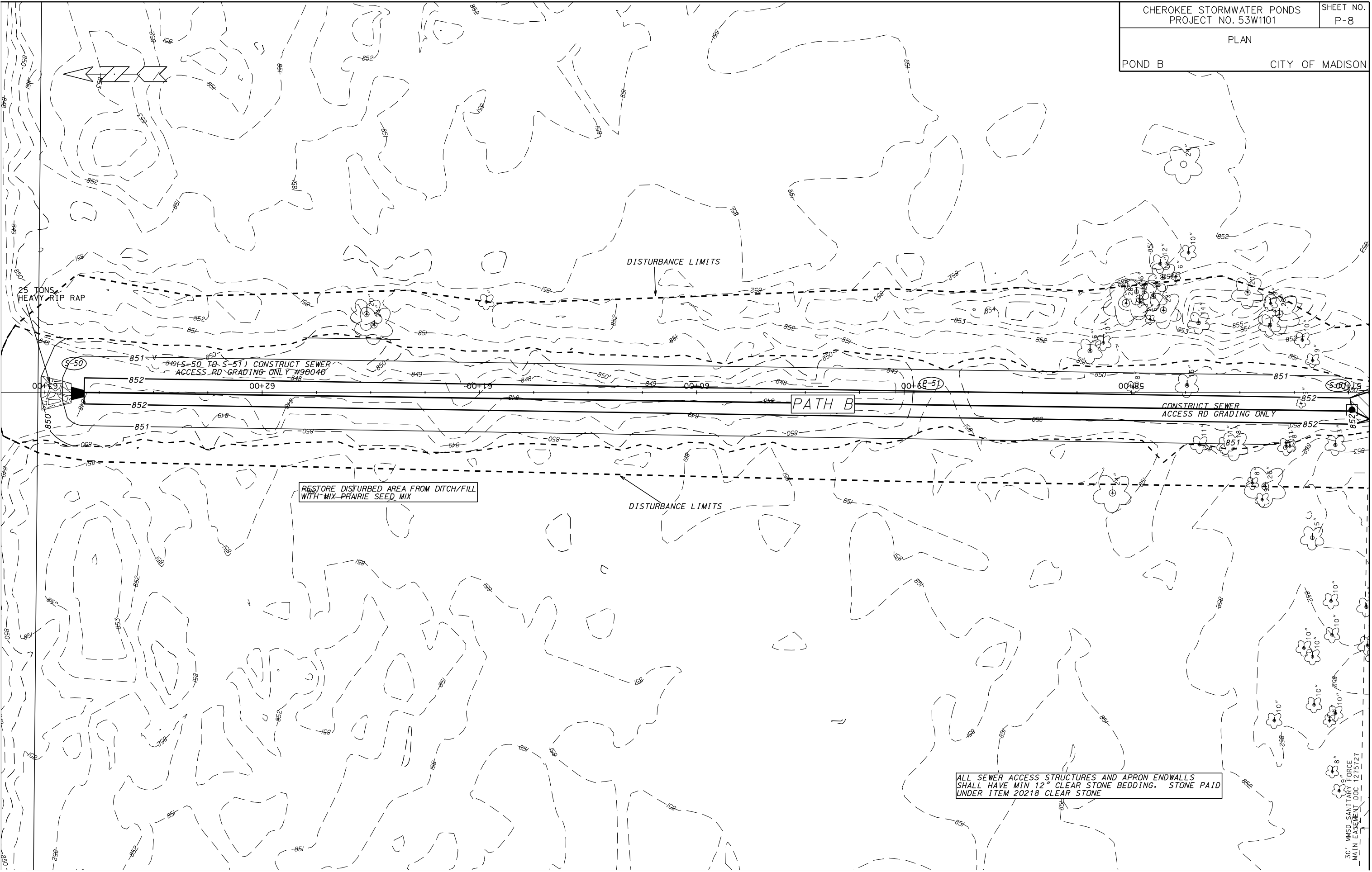

25 TONS
HEAVY RIP RAP

DISTURBANCE LIMITS

CONSTRUCT SEWER
ACCESS RD GRADING ONLY #90040

PATH B

CONSTRUCT SEWER
ACCESS RD GRADING ONLY

RESTORE DISTURBED AREA FROM DITCH/FILL
WITH MIX PRAIRIE SEED MIX

DISTURBANCE LIMITS

ALL SEWER ACCESS STRUCTURES AND APRON ENDWALLS
SHALL HAVE MIN 12" CLEAR STONE BEDDING. STONE PAID
UNDER ITEM 20218 CLEAR STONE

30' MMSD SANITARY FORCE
MAIN EASEMENT DOC 1275127

STORM SEWER SCHEDULE

ALIGNMENT CODES:

"PA"= POND A
 "PB"= POND B
 "WA"= PATH A

CHEROKEE STORMWATER PONDS PROJECT NO. 53W1101		SHEET NO. P-9
STORM SEWER SCHEDULE		CITY OF MADISON

STRUCTURES

STRUC. NO.	STATION	LOCATION (OFFSET)	TYPE	TOP OF CASTING	E.I.	DEPTH	NOTES
S-1	13'B'+82.00	LT-63.00	48" STM AE	---	850.50	---	TWO ENDWALLS
S-2	25'B'+28.00	LT-10.20	12'X5' SAS	858.06	852.31	5.75	FP; (1)
S-3	25'B'+29.00	RT-49.80	H INLET	857.76	854.25	3.51	W/R-3067-004
S-4	25'B'+29.00	RT-53.40	H INLET	857.76	854.30	3.46	W/R-3067-004
* S-8	4'B'+59.00	RT-24.75	36" RCP AE	---	851.50	---	END OF APRON STATIONED; W/GATE
* S-9	4'B'+59.00	RT-16.50	36" RCP AE	---	851.50	---	END OF APRON STATIONED; W/GATE
* S-10	4'B'+59.00	RT-9.00	36" RCP AE	---	851.50	---	END OF APRON STATIONED; W/GATE
S-11	2'B'+45.50	LT-8.00	36" STM 45DEG BEND	---	849.56	---	PLACE MARKER BALL
S-12	2'B'+40.00	RT-0	36" STM 45DEG BEND	---	849.56	---	PLACE MARKER BALL
S-13	2'B'+34.00	RT-8.00	36" STM 45DEG BEND	---	849.56	---	PLACE MARKER BALL
S-14	2'B'+20.00	LT-50.40	36" RCP AE	---	849.00	---	END OF APRON STATIONED; W/GATE
S-15	2'B'+13.00	LT-46.00	36" RCP AE	---	849.00	---	END OF APRON STATIONED; W/GATE
S-16	2'B'+04.00	LT-41.00	36" RCP AE	---	849.00	---	END OF APRON STATIONED; W/GATE
S-25	39'B'+40.00	RT-2.00	36" RCP AE	---	848.00	---	END OF APRON STATIONED; W/GATE
S-26	31'B'+52.00	LT-2.50	5X5 SAS	853.00	849.00	4.00	FP; (1)
S-27	9'B'+74.00	LT-331.00	36" RCP AE	---	851.50	---	END OF APRON STATIONED; W/GATE
S-50	62'B'+88.00	RT-0	36" RCP AE	---	848.00	---	END OF APRON STATIONED; W/GATE
S-51	56'U'+98.00	LT-8.50	5X5 SAS	853.00	849.00	4.00	FP; (1)
S-52	56'U'+05.00	LT-54.00	36" RCP AE	---	850.00	---	END OF APRON STATIONED; W/GATE

PIPES

PIPE NO.	FROM (DNSTM)	TO (UPSTM)	LGTH (FT)	DISCH. E.I.	INLET E.I.	SLOPE (%)	PIPE SIZE	TYPE	NOTES
P-2	S-1	S-2	131	850.50	852.31	1.38%	48"	STM PIPE	TWIN PIPES
P-3	S-2	S-3	40	853.31	854.25	2.35%	18"	RCP	NCM
P-4	S-3	S-4	3	854.25	854.30	1.67%	12"	RCP	NCM
* P-11	S-11	S-10	213	849.56	851.50	0.91%	36"	STM PIPE	
* P-12	S-12	S-9	218	849.56	851.50	0.89%	36"	STM PIPE	
* P-13	S-13	S-8	225	849.56	851.50	0.86%	36"	STM PIPE	
P-14	S-14	S-11	54	849.00	849.56	1.04%	36"	STM PIPE	
P-15	S-15	S-12	54	849.00	849.56	1.04%	36"	STM PIPE	
P-16	S-16	S-13	54	849.00	849.56	1.04%	36"	STM PIPE	
P-25	S-25	S-26	795	848.00	849.00	0.13%	36"	STM PIPE	
P-26	S-26	S-27	111	849.00	851.50	2.25%	36"	STM PIPE	
P-50	S-50	S-51	589	848.00	849.00	0.17%	36"	STM PIPE	
P-51	S-51	S-52	93	849.00	850.00	1.08%	36"	STM PIPE	

* REVISED 8-30-12

SPECIFIC NOTES

(1) STRUCTURE DEPTH REQUIRES PIPE WALLS MUST BE POURED INTO STRUCTURE ROOF

STANDARD NOTES:

- ABBREVIATIONS: AE = APRON ENDWALL; RCP = REINFORCED CONCRETE PIPE; HERCP = HORIZONTAL ELLIPTICAL REINFORCED CONCRETE PIPE; DNA = DOES NOT APPLY; SAS = SEWER ACCESS STRUCTURE; LP = LOW POINT INLET STRUCTURE; FP = FIELD POURED STRUCTURE; TR = TOP OF CONCRETE ROOF; NCM = NO CROWN MATCH FOR PIPES
- APPROXIMATE DISCHARGE E.I. GIVEN, ADJUST E.I. AND PIPE SLOPE IN THE FIELD.
- TOP OF CASTING GRADE GIVEN IS THE TOP OF CURB FOR INLET STRUCTURES AND THE FLOWLINE OF THE CLOSED CASTING FOR SAS's.
- TOP OF CONCRETE ROOF (TR) IS 1.25' BELOW TOP OF CASTING UNLESS OTHERWISE NOTED.
- ALL REINFORCED CONCRETE PIPES TO BE CLASS III UNLESS OTHERWISE NOTED.
- SURVEYOR TO CONFIRM THAT ALL INLET STATION / OFFSETS LINE UP WITH PROPOSED CURB AND GUTTER.
- ALL STRUCTURES CALLED OUT AS FIELD POURED SHALL BE FIELD POURED. ALL OTHER STRUCTURES (NOT INDICATED AS FIELD POURED) SHALL BE SUBMITTED TO CITY ENGINEERING FOR APPROVAL IF PRECAST STRUCTURES ARE PREFERRED. CONTACT COREY STELLJES OF CITY ENGINEERING AT (608) 266-9721 FOR PRECAST APPROVALS, OR FAX SHOP DRAWINGS TO (608)264-9275.

460 440 420 400 380 360 340 320 300 280 260 240 220 200 180 160 140 120 100 80 60 40 20 0 20 40 60 80 100 120 140 160 180 200 220 240 260 280 300

CHEROKEE STORMWATER
MANAGEMENT PONDS

SHEET NO.
X-1

TYPICAL SECTION
OUTLET PIPES CITY OF MADISON

320 340 360 380 400 430 450 470

PLOT SCALE: _____

PLOT NAME: _____

REV. DATE: _____

866
864
862
860
858
856
854
852
850

866
864
862
860
858
856
854
852
850

MOUND DIRT OVER PIPES
MIN 1.0' COVER
3:1 SIDE SLOPES

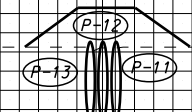

STA = 3+00

ORIGINATOR: CITY OF MADISON, STREETS DIVISION

460 440 420 400 380 360 340 320 300 280 260 240 220 200 180 160 140 120 100 80 60 40 20 0 20 40 60 80 100 120 140 160 180 200 220 240 260 280 300

TYPICAL SECTION
POND A OUTLET CITY OF MADISON

320 340 360 380 400 430 450 470

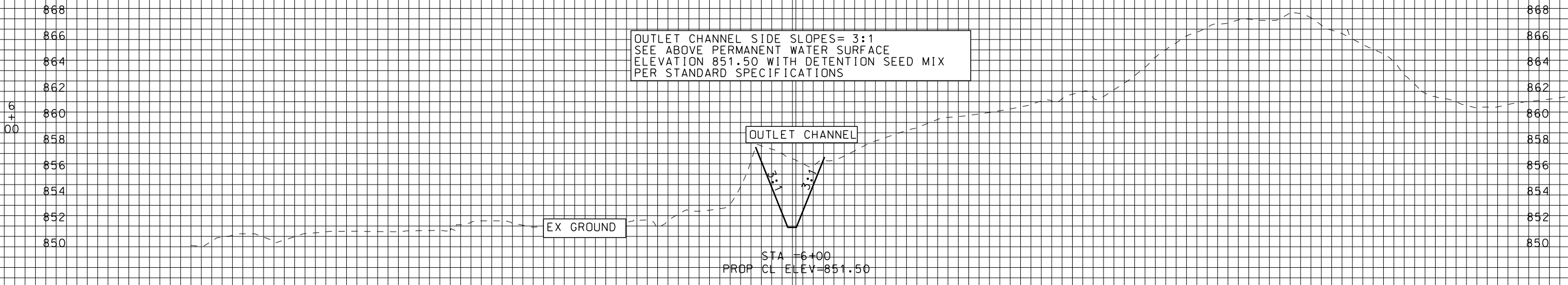

PLOT SCALE: _____
PLOT NAME: _____
REV. DATE: _____

ORIGINATOR: CITY OF MADISON, SIBBES DIVISION

460 440 420 400 380 360 340 320 300 280 260 240 220 200 180 160 140 120 100 80 60 40 20 0 20 40 60 80 100 120 140 160 180 200 220 240 260 280 300

CHEROKEE STORMWATER
MANAGEMENT PONDS
TYPICAL SECTION
POND A CITY OF MADISON
320 340 360 380 400 430 450 470

SHEET NO.
X-3

PLOT SCALE: _____

PLOT NAME: _____

REV. DATE: _____

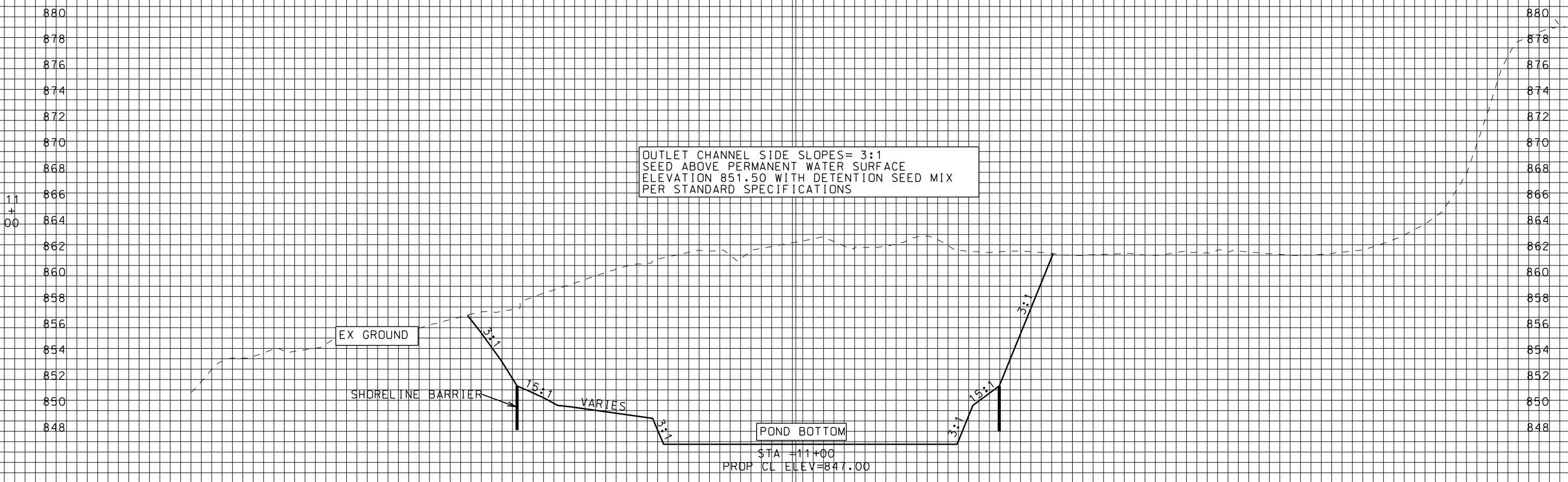

OUTLET CHANNEL SIDE SLOPES= 3:1
SEED ABOVE PERMANENT WATER SURFACE
ELEVATION 851.50 WITH DETENTION SEED MIX
PER STANDARD SPECIFICATIONS

EX GROUND

SHORELINE BARRIER

VARTES

POND BOTTOM

STA +11+00
PROP CL ELEV=847.00

ORIGINATOR: CITY OF MADISON, STREETS DIVISION

70 80 70 60 50 40 30 20 10 0 10 20 30 40 50 60 70

TYPICAL SECTION

PATH A

CITY OF MADISON

PLOT SCALE: _____

PLOT NAME: _____

REV. DATE: _____

RESTORE ALL DISTURBED AREA WITH
MIX PRAIRIE SEED MIX PER BID ITEM
20706

FILL FILL PILES FROM ORIGINAL DITCH.
TO BE USED AS TOPSOIL AS APPROVED
BY FIELD ENGINEER

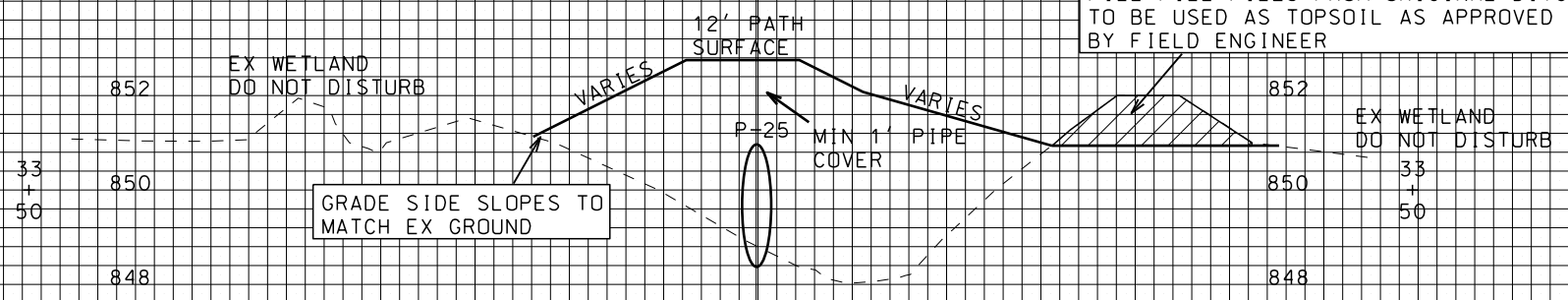

70 80 70 60 50 40 30 20 10 0 10 20 30 40 50 60 70

PLOT SCALE: _____
PLOT NAME: _____
REV. DATE: _____

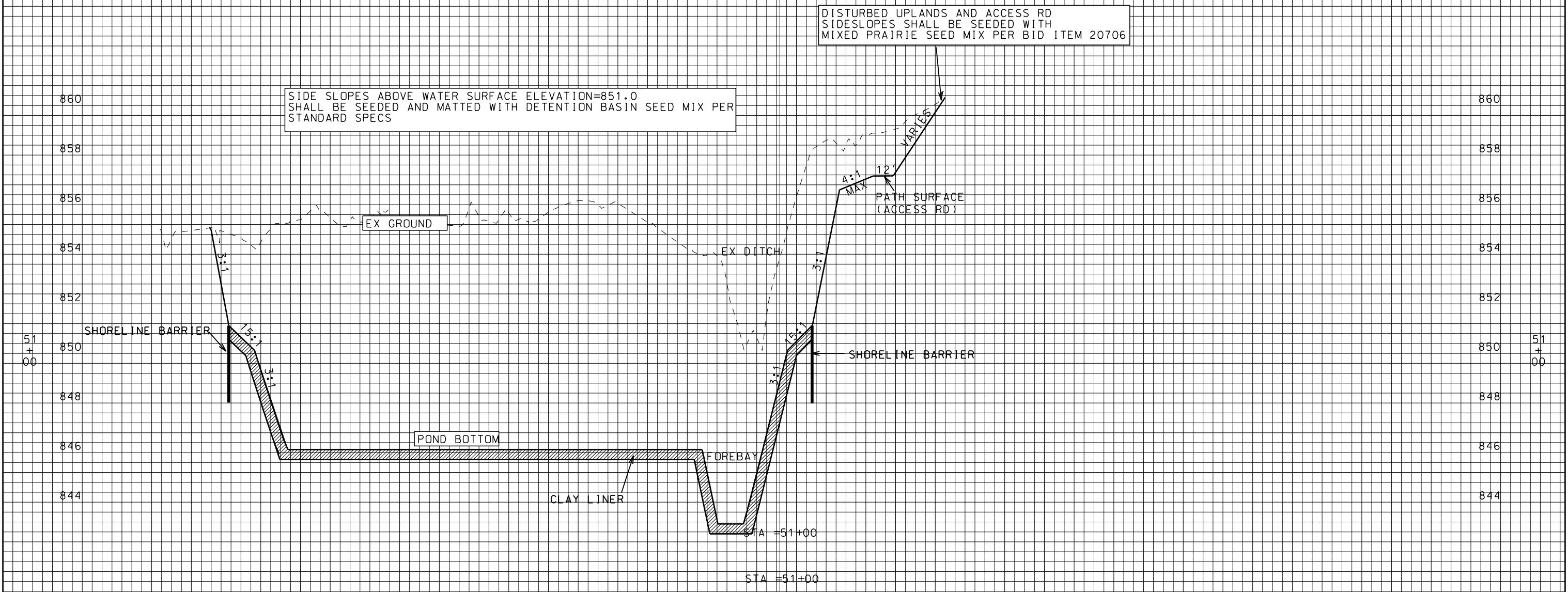

150 140 130 120 110 100 90 80 70 60 50 40 30 20 10 0 10 20 30 40 50 60 70 80 90

REV. DATE: _____ PLOT NAME: _____ PLOT SCALE: _____

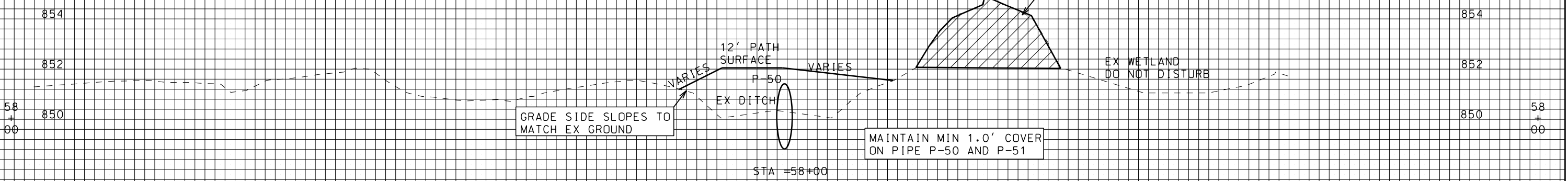

DISTURBED UPLANDS AND ACCESS RD SIDESLOPES SHALL BE SEEDDED WITH MIXED PRAIRIE SEED MIX PER BID ITEM 20706

FILL PILES FROM ORIGINAL DITCH. TO BE USED AS TOPSOIL AS APPROVED BY FIELD ENGINEER

GRADE SIDE SLOPES TO MATCH EX GROUND

MAINTAIN MIN 1.0' COVER ON PIPE P-50 AND P-51

150 140 130 120 110 100 90 80 70 60 50 40 30 20 10 0 10 20 30 40 50 60 70 80 90 100 110 120 130 140 150