



Department of Public Works  
**City Engineering Division**

Robert F. Phillips, P.E.  
**City Engineer**

City-County Building, Room 115  
210 Martin Luther King, Jr. Boulevard  
Madison, Wisconsin 53703  
FAX 608 264 9275  
www.cityofmadison.com

**608 266 4751**

**Assistant City Engineer**  
Michael R. Dailey, P.E.

**Principal Engineers**  
Christina M. Bachmann, P.E.  
John S. Fahrney, P.E.  
Gregory T. Fries, P.E.  
Christopher J. Petykowski, P.E.

**Facilities & Sustainability**  
Jeanne E. Hoffman, Manager  
James C. Whitney, A.I.A.

**Operations Supervisor**  
Kathleen M. Cryan

**GIS Manager**  
David A. Davis, R.L.S.

**Financial Officer**  
Steven B. Danner-Rivers

**Hydrogeologist**  
Brynn Bemis

**NOTICE OF ADDENDUM**  
**ADDENDUM NO. 2**  
**CONTRACT NO. 6994**

**LIVINGSTON STREET RESURFACING WITH UTILITIES**  
**ASSESSMENT DISTRICT – 2013**

Revise and amend the contract document(s) for the above project as stated in this addendum, otherwise, the original document shall remain in effect.

**BIDS PLANS:**

**REMOVE**

Remove pages U-4, E-1 and E-2

**INSERT**

Insert pages U-4, E-1 and E-2 (revised 1/4/13)

**BID SPECIFICATIONS:**

**REMOVE**

Remove BID ITEM 90030 – STORM CONTROL AND IMPLEMENTATION PLAN

**INSERT**

**BID ITEM 90030 – STORM CONTROL AND IMPLEMENTATION PLAN**

**DESCRIPTION**

Work under this item shall include all labor, materials, and incidentals required to prepare a storm control plan and to implement the approved plan. This plan shall include dry weather, wet weather and backwater flow control contingencies. The Contractor shall submit to the project engineer a plan that details how storm flows will be managed and/or diverted during placement of the new 54” storm sewer pipe and connection and abandonment/removal of storm sewer on North Livingston Street. The approved methodology shall be installed prior to any storm sewer work. Any work, materials, and incidentals necessary to repair and restore the site due to the Storm Control Implementation shall be considered incidental to this bid item. The plan shall specifically include measures to address the removal of existing storm pipe for installation of water main and sanitary sewer, connection at E Mifflin Street, E Dayton Street, and E Johnson Street. Also at the beginning of the new 54” storm sewer main in regards to the existing 29” x 45” storm pipe.

If phasing will be required to properly control the storm flows on site during the storm sewer main replacement, this shall be defined and detailed in the Storm Control Plan. The Contractor shall provide appropriate storm control measures during the entire duration of the storm sewer placement. Removal of all equipment and materials used for storm control shall be considered incidental to this bid item.

**METHOD OF MEASUREMENT**

Storm Control and Implementation Plan shall be measured as a lump sum bid item.

**BASIS OF PAYMENT**

Storm Control and Implementation Plan, as measured above, shall be considered full compensation for all work, materials, and incidentals required to complete the work as described above.

**PROPOSAL:**

**REMOVE**

Remove pages E-5 thru E-11

**INSERT**

Insert pages E-5 thru E-12 (revised 1/4/13)

**Summary of Addendum 2:**

- Revised electrical plans and item quantities.
- Revised U-4 Storm Sewer Schedule and storm structure quantities, specifically revising bid item 50725 quantity and adding bid item 50726 – 6'x6' STORM SAS.
- Revised description of bid item 90030 – STORM CONTROL AND IMPLEMENTATION PLAN. Revised key existing storm sewer connections.

Please acknowledge this addendum on page E1 of the contract documents.

Electronic version of these documents can be found on the City of Madison web site at:

<http://www.cityofmadison.com/business/PW/contracts/openforBid.cfm>

If you are unable to download plan revisions associated with the addendum, please contact the Engineering office at 608-266-4751 receive the material by another route.



**PROPOSAL**

NAME OF BIDDER

**LIVINGSTON STREET RESURFACING WITH UTILITIES ASSESSMENT DISTRICT - 2013**

REVISED 1/4/13

Contract No. 6994

ITEM	TYPE OF WORK	ESTIMATED QUANTITIES	UNIT PRICE BID	TOTAL BID
<b>STREET ACCOUNT NO. CS53-58260-810358-00-53W1462</b>				
10701	TRAFFIC CONTROL	1.0	LUMP SUM	
10721	TRAFFIC CONTROL SIGN - PORTABLE CHANGEABLE MESSAGE	20.0	DAYS	
10801	ROOT CUTTING - CURB AND GUTTER(UNDISTRIBUTED)	100.0	L.F.	
10802	ROOT CUTTING - SIDEWALK(UNDISTRIBUTED)	100.0	L.F.	
10911	MOBILIZATION	1.0	LUMP SUM	
20221	TOPSOIL	1300.0	S.Y.	
20303	SAWCUT BITUMINOUS PAVEMENT	225.0	L.F.	
20321	REMOVED CONCRETE PAVEMENT	100.0	S.Y.	
20323	REMOVE CONCRETE SIDEWALK & DRIVE	550.0	S.F.	
20401	CLEARING (UNDISTRIBUTED)	25.0	I.D.	
20403	GRUBBING (UNDISTRIBUTED)	25.0	I.D.	
20701	TERRACE SEEDING	1000.0	S.Y.	
21062	EROSION MATTING, CLASS I, URBAN TYPE A	1000.0	S.Y.	
30301	5 INCH CONCRETE SIDEWALK	150.0	S.F.	
30340	CURB RAMP DETECTABLE WARNING FIELD	112.0	S.F.	
40341	ASPHALT DRIVE AND TERRACE - RESURFACING	100.0	S.Y.	
40367	ADJUST VALVE CASTING METHOD #1	4.0	EACH	
40381	REMOVE AND REPLACE CURB AND GUTTER, MACHINE PLACED MORE THAN 100 CONTINUOUS FEET - RESURFACING	1450.0	L.F.	
40382	REMOVE AND REPLACE CURB AND GUTTER, HAND PLACED - RESURFACING	500.0	L.F.	

**PROPOSAL**

NAME OF BIDDER

**LIVINGSTON STREET RESURFACING WITH UTILITIES ASSESSMENT DISTRICT - 2013**

REVISED 1/4/13

Contract No. 6994

ITEM	TYPE OF WORK	ESTIMATED QUANTITIES		UNIT PRICE BID	TOTAL BID
40391	REMOVE AND REPLACE 5" THICK CONCRETE SIDEWALK - RESURFACING	1810.0	S.F.		
40392	REMOVE & REPLACE 7" THICK SIDEWALK AND DRIVEWAY - RESURFACING	2165.0	S.F.		
60840	PAVEMENT MARKING PAINT, LINE, 4-INCH	300.0	L.F.		
60852	PAVEMENT MARKING PAINT, CROSSWALK, 6-INCH	380.0	L.F.		
60858	PAVEMENT MARKING PAINT, STOP LINE, 24-INCH	40.0	L.F.		
60863	PAVEMENT MARKING PAINT, SYMBOL, BIKE LANE	1.0	EACH		
60880	PAVEMENT MARKING REMOVAL, 4-INCH	400.0	L.F.		
60887	PAVEMENT MARKING REMOVAL, SYMBOL, ARROW	1.0	EACH		
60888	PAVEMENT MARKING REMOVAL, SYMBOL, WORD	1.0	EACH		
60940	TEMPORARY PAVEMENT MARKING TAPE, REMOVABLE, REFLECTIVE, LINE, 4-INCH	1300.0	L.F.		
60947	TEMPORARY PAVEMENT MARKING TAPE, REMOVABLE, REFLECTIVE, SYMBOL, BIKE LANE	1.0	EACH		
90001	EXCAVATION, HAULING AND DISPOSAL OF CONTAMINATED SOIL	100.0	TON		
90601	TEMPORARY PRECAST BARRIER CONTRACTOR FURNISHED, CONTRACTOR DELIVERED, CONTRACTOR INSTALLED, CONTRACTOR REMOVED	60.0	L.F.		
<b>STORM ACCOUNT NO. ESTM-58270-810381-00-53W1462</b>					
<b>STORM ACCOUNT NO. CS53-58270-810358-00-53W1462</b>					
20101	EXCAVATION CUT	2301.0	C.Y.		
20219	BREAKER RUN	1000.0	TON		
20217	CLEAR STONE	350.0	TON		
21001	EROSION CONTROL PLAN & IMPLEMENTATION	1.0	LUMP SUM		
21002	EROSION CONTROL INSPECTION	15.0	EACH		
21011	CONSTRUCTION ENTRANCE	4.0	EACH		

**PROPOSAL**

NAME OF BIDDER

**LIVINGSTON STREET RESURFACING WITH UTILITIES ASSESSMENT DISTRICT - 2013**

REVISED 1/4/13

Contract No. 6994

ITEM	TYPE OF WORK	ESTIMATED QUANTITIES		UNIT PRICE BID	TOTAL BID
21012	STREET CONSTRUCTION ENTRANCE BERM	1.0	EACH		
21013	STREET SWEEPING	1.0	LUMP SUM		
21031	INLET PROTECTION TYPE C - COMPLETE (UNDISTRIBUTED)	10.0	EACH		
21042	INLET PROTECTION TYPE D HYBRID - PROVIDE & INSTALL	33.0	EACH		
21043	INLET PROTECTION TYPE D- MAINTAIN	66.0	EACH		
21044	INLET PROTECTION TYPE D - REMOVE	33.0	EACH		
40101	CRUSHED AGGREGATE BASE COURSE, GRADATION 1	1315.0	TON		
40102	CRUSHED AGGREGATE BASE COURSE, GRADATION 2 OR 3	1980.0	TON		
40202	HMA PAVEMENT, TYPE E-1	1200.0	TON		
40211	TACK COAT	230.0	GAL		
40362	ADJUST SEWER ACCESS STRUCTURE CASTING - RESURFACING	2.0	EACH		
40364	ADJUST INLET - RESURFACING TYPE H	4.0	EACH		
50401	12 INCH STORM SEWER PIPE	16.0	L.F.		
50411	12 INCH RCP STORM SEWER PIPE	231.0	L.F.		
50741	TYPE H INLET	13.0	EACH		
50761	SADDLED INLET TYPE I	1.0	EACH		
<b>STORM ACCOUNT NO. ESTM-58270-810381-00-53W1462</b>					
10702	TRAFFIC CONTROL FOR STORM SEWER INSTALLATION	1.0	LUMP SUM		
10912	MOBILIZATION FOR STORM SEWER INSTALLATION	1.0	LUMP SUM		
20233	RIPRAP FILTER FABRIC, TYPE HR	1000.0	S.Y.		
20311	REMOVE SEWER ACCESS STRUCTURE	3.0	EACH		

**PROPOSAL**

NAME OF BIDDER

**LIVINGSTON STREET RESURFACING WITH UTILITIES ASSESSMENT DISTRICT - 2013**

REVISED 1/4/13

Contract No. 6994

ITEM	TYPE OF WORK	ESTIMATED QUANTITIES		UNIT PRICE BID	TOTAL BID
20312	REMOVE CATCHBASIN	6.0	EACH		
20313	REMOVE INLET	6.0	EACH		
20314	REMOVE PIPE	1058.0	L.F.		
20337	PIPE PLUG STORM	16.0	EACH		
50211	SELECT BACKFILL FOR STORM SEWER	1607.0	T.F.		
50413	18 INCH RCP STORM SEWER PIPE	139.0	L.F.		
50415	24 INCH RCP STORM SEWER PIPE	56.0	L.F.		
50421	54 INCH RCP STORM SEWER PIPE	1106.0	L.F.		
50431	14 INCH X 23 INCH HERCP STORM SEWER PIPE	59.0	L.F.		
50499	CONCRETE COLLAR	4.0	EACH		
50723	3'X3' STORM SAS	2.0	EACH		
50725	5'X5' STORM SAS	2.0	EACH		
50726	6'X6' STORM SAS	1.0	EACH		
50792	STORM SEWER TAP	19.0	EACH		
50802	CONCRETE SUPPORTS	10.0	EACH		
90030	STORM CONTROL PLAN & IMPLEMENTATION	1.0	LUMP SUM		
90031	PRIVATE STORM CONNECT, TYPE 1	3.0	EACH		
<b>SANITARY ACCOUNT NO. ES01-58275-810332-00-53W1462</b>					
10704	TRAFFIC CONTROL FOR SANITARY SEWER CONSTRUCTION	1.0	LUMP SUM		
10914	MOBILIZATION FOR SANITARY SEWER CONSTRUCTION	1.0	LUMP SUM		
20311	REMOVE SEWER ACCESS STRUCTURE	5.0	EACH		

**PROPOSAL**

NAME OF BIDDER

**LIVINGSTON STREET RESURFACING WITH UTILITIES ASSESSMENT DISTRICT - 2013**

REVISED 1/4/13

Contract No. 6994

ITEM	TYPE OF WORK	ESTIMATED QUANTITIES		UNIT PRICE BID	TOTAL BID
20315	REMOVE PIPE (SANITARY)	50.0	L.F.		
20336	PIPE PLUG SANITARY	30.0	EACH		
20501	ADJUST SEWER ACCESS STRUCTURE	1.0	EACH		
50103	RECONSTRUCT BENCH & FLOWLINES	1.0	EACH		
50212	SELECT FILL FOR SANITARY SEWER MAIN	1162.0	T.F.		
50301	8" PVC SANITARY LATERAL SDR-35	48.0	L.F.		
50302	10" PVC SANITARY SEWER PIPE SDR-35	56.0	L.F.		
50304	15" PVC SANITARY SEWER PIPE SDR-35	651.0	L.F.		
50353	SANITARY SEWER LATERAL SDR-35	407.0	L.F.		
50354	RECONNECT SANITARY LATERAL	14.0	EACH		
50357	COMPRESSION COUPLING	1.0	EACH		
50361	WASTEWATER CONTROL	1.0	LUMP SUM		
50390	SEWER ELECTRONIC MARKERS	29.0	EACH		
50701	FOUR FOOT DIAMETER SAS	3.0	EACH		
50702	FIVE FOOT DIAMETER SAS	2.0	EACH		
50771	INTERNAL CHIMNEY SEALS	4.0	EACH		
50780	CLEANOUT (UNDISTRIBUTED)	1.0	EACH		
50783	INSIDE DROP	6.9	V.F.		
50791	SANITARY SEWER TAP	7.0	EACH		
50801	UTILITY LINE OPENING	5.0	EACH		
90032	WASTEWATER CONTROL - HEAVY FLOW	1.0	LUMP SUM		

**PROPOSAL**

NAME OF BIDDER

**LIVINGSTON STREET RESURFACING WITH UTILITIES ASSESSMENT DISTRICT - 2013**

REVISED 1/4/13

Contract No. 6994

ITEM	TYPE OF WORK	ESTIMATED QUANTITIES	UNIT PRICE BID	TOTAL BID
<b>WATER ACCOUNT NO. EW01-58273-810455-00-53W1462</b>				
10703	TRAFFIC CONTROL FOR WATER MAIN INSTALLATION	1.0	LUMP SUM	
10913	MOBILIZATION FOR WATER MAIN INSTALLATION	1.0	LUMP SUM	
20217	CLEAR STONE	15.0	TON	
70001	FURNISH AND INSTALL 4 INCH PIPE & FITTINGS	30.0	L.F.	
70002	FURNISH AND INSTALL 6 INCH PIPE & FITTINGS	40.0	L.F.	
70003	FURNISH AND INSTALL 8 INCH PIPE & FITTINGS	90.0	L.F.	
70004	FURNISH AND INSTALL 10 INCH PIPE & FITTINGS	600.0	L.F.	
70007	FURNISH AND INSTALL 20 INCH PIPE & FITTINGS	30.0	L.F.	
70405	CUT-IN CONNECTION	4.0	EACH	
70407	FURNISH AND INSTALL HYDRANT	2.0	EACH	
70408	SELECT FILL - SAND FOR WATER	790.0	L.F.	
70409	UNDERCUT	5.0	C.Y.	
70413	FURNISH AND INSTALL STYROFOAM	72.0	L.F.	
70414	CUT OFF EXISTING WATER MAIN	2.0	EACH	
70415	ABANDON WATER VALVE BOX	3.0	EACH	
70416	ABANDON HYDRANT	1.0	EACH	
70417	ABANDON WATER VALVE ACCESS STRUCTURE	1.0	EACH	
70418	ADJUST WATER VALVE BOX	6.0	EACH	
70427	FURNISH AND INSTALL 4 INCH VALVE	2.0	EACH	



**PROPOSAL**

NAME OF BIDDER

**LIVINGSTON STREET RESURFACING WITH UTILITIES ASSESSMENT DISTRICT - 2013**

REVISED 1/4/13

Contract No. 6994

ITEM	TYPE OF WORK	ESTIMATED QUANTITIES		UNIT PRICE BID	TOTAL BID
70428	FURNISH AND INSTALL 6 INCH VALVE	2.0	EACH		
70430	FURNISH AND INSTALL 10 INCH VALVE	1.0	EACH		
70433	FURNISH AND INSTALL 20 INCH VALVE	1.0	EACH		
70440	EXTEND AND RECONNECT SERVICE LATERAL - 1 INCH	140.0	L.F.		
70443	RECONNECT / DISCONNECT SERVICE LATERAL - 1 INCH	4.0	EACH		
70454	REPLACE COPPER SERVICE LATERAL	100.0	L.F.		
70455	PIPE PLUG FOR WATER MAIN INSTALLATION	2.0	EACH		
70456	FURNISH EXCAVATION AND DITCH FOR LIVE TAP	1.0	EACH		
90160	SPECIAL TREATMENT FOR SERVICES PLACED BELOW STORM PIPE	6.0	EACH		
90161	24" RCP STANDPIPE WITH OPEN IN BELL GRATE	1.0	LUMP SUM		
<b>STORM ACCOUNT NO. CS53-58270-810381-00-53W1462 (34%)</b> <b>SANITARY ACCOUNT NO. ES01-58275-810332-00-53W1462 (33%)</b> <b>WATER ACCOUNT NO. EW01-58273-810455-00-53W1462 (33%)</b>					
50202	TYPE II DEWATERING	1.0	LUMP SUM		
<b>STORM ACCOUNT NO. CS53-58270-810381-00-53W1462 (45%)</b> <b>SANITARY ACCOUNT NO. ES01-58275-810332-00-53W1462 (45%)</b> <b>WATER ACCOUNT NO. EW01-58273-810455-00-53W1462 (10%)</b>					
50226	UTILITY TRENCH PATCH TYPE III	110.0	S.Y.		
<b>STREET LIGHTS ACCOUNT NO. CS53-58545-810358-00-53W1462</b>					
60222	FURNISH & INSTALL 3 INCH PVC (SCHEDULE 80) CONDUIT	200.0	L.F.		
60224	FURNISH & INSTALL 3 INCH PVC (SCHEDULE 40) CONDUIT	900.0	L.F.		
60230	FURNISH & INSTALL 2 INCH PVC (SCHEDULE 80) CONDUIT	400.0	L.F.		
60232	FURNISH & INSTALL 2 INCH PVC (SCHEDULE 40) CONDUIT	1520.0	L.F.		
60241	GOPHER RACEWAY FOR ELECTRICAL CONDUIT OR CABLE-IN-DUCT	100.0	L.F.		

PROPOSAL

NAME OF BIDDER

LIVINGSTON STREET RESURFACING WITH UTILITIES ASSESSMENT DISTRICT - 2013

REVISED 1/4/13

Contract No. 6994

ITEM	TYPE OF WORK	ESTIMATED QUANTITIES		UNIT PRICE BID	TOTAL BID
60261	ELECTRICAL TRENCH	1820.0	L.F.		
60702	CONSTRUCT ELECTRICAL HANDHOLE TYPE 1	8.0	EACH		
<b>GRAND TOTAL</b>					

# STORM SEWER SCHEDULE

## ALIGNMENT CODES:

'L' = LIVINGSTON

REVISED 1/4/2013

LIVINGSTON ST RESURFACING W/ UTILITIES	SHEET NO.
PROJECT NO. 53W1462	U-4
UTILITIES	
STORM SEWER SCHEDULE	CITY OF MADISON

### STRUCTURES

STRUC. NO.	STATION	LOCATION (OFFSET)	TYPE	TOP OF CASTING	E.I.	DEPTH	NOTES
S-1	14'L'+61.00	LT-19.50	H INLET	848.17	845.27	2.90	LP; W/ R-3067-7004-VB
S-1A	14'L'+60.50	LT-3.80	TAP		844.33		(1)
S-2	14'L'+61.00	RT-19.50	H INLET	848.26	845.05	3.21	SADDLE INLET; LP; W/ R-3067-7004-VB
S-3	14'L'+98.88	LT-.58	5x5 SAS	848.66	841.87	6.79	FP, W/ R-1550-0054
S-4	15'L'+96.94	RT-19.50	H INLET	848.97	845.73	3.24	FP; W/ R-3067-7004-V; (2)
S-5	16'L'+39.11	LT-16.67	3x3 SAS	848.92	845.00	3.92	FP, W/ R-1550-0054; (2)
S-5A	16'L'+39.11	LT-1.67	TAP		844.50		(1)
S-6	17'L'+15.00	LT-19.50	H INLET	849.00	845.49	3.51	LP; W/ R-3067-7004-VB
S-6A	17'L'+15.00	LT-.55	TAP		844.58		(1)
S-7	17'L'+15.00	RT-19.50	H INLET	849.02	845.47	3.55	LP; W/ R-3067-7004-VB
S-7A	17'L'+15.00	RT-3.75	TAP		844.58		(1)
S-8	18'L'+26.44	RT-2.58	5x5 SAS	850.12	842.20	7.92	FP, W/ R-1550-0054
S-9	18'L'+26.87	LT-38.18	H INLET	849.20	844.97	4.23	LP; W/ R-3067-7004-VB
S-10	18'L'+65.85	LT-38.20	H INLET	849.00	845.84	3.16	LP; W/ R-3067-7004-VB
S-11	18'L'+26.70	RT-41.65	3x3 SAS	849.00	844.38	4.62	W/ R-3067-7004
S-12	18'L'+88.00	LT-19.50	H INLET	849.57	845.75	3.82	LP; W/ R-3067-7004-VB
S-12A	18'L'+88.00	CL	TAP		844.75		(1)
S-13	18'L'+88.00	RT-19.50	H INLET	849.57	845.70	3.87	LP; W/ R-3067-7004-VB
S-13A	18'L'+88.00	RT-4.50	TAP		844.75		(1)
S-14	20'L'+07.00	LT-19.50	H INLET	849.94	845.87	4.07	LP; W/ R-3067-7004-VB
S-14A	20'L'+07.00	LT-.50	TAP		844.85		(1)
S-15	20'L'+07.00	RT-19.50	H INLET	849.94	845.82	4.12	LP; W/ R-3067-7004-VB
S-15A	20'L'+07.00	RT-4.00	TAP		844.85		(1)
S-16	20'L'+77.50	LT-19.50	H INLET	850.12	845.94	4.18	W/ R-3067-7004-V; (2)
S-16A	20'L'+77.50	LT-.50	TAP		844.93		(1)
S-17	21'L'+39.58	LT-19.50	H INLET	849.98	845.44	4.54	LP; W/ R-3067-7004-VB
S-17A	21'L'+39.00	LT-.50	TAP		845.00		(1)
S-18	21'L'+39.12	RT-19.50	H INLET	849.98	845.50	4.48	LP; W/ R-3067-7004-VB
S-18A	21'L'+38.62	RT-4.00	TAP		845.00		(1)
S-19	21'L'+61.92	RT-2.82	6x6 SAS	850.34	842.51	7.83	W/ R-1550-0054
S-20	11'L'+81.84	LT-6.00	TAP		844.05		(1)
S-20A	13'L'+51.65	RT-4.30	TAP		844.22		(1)
S-21	15'L'+53.00	RT-2.45	TAP		844.47		(1)
S-21A	15'L'+54.50	LT-2.96	TAP		844.47		(1)
S-22	18'L'+10.36	RT-37.30	24" STANDPIPE	849.10	845.00	4.10	SPECIAL ITEM 90161
S-23	15'L'+54.50	LT-20.50	TAP(2)		845.53		(1)
S-24	11'L'+81.84	LT-18.00	TAP		844.70		(1)
S-25	13'L'+52.60	LT-18.00	TAP		845.46		(1)

### PIPES

PIPE NO.	FROM (DNSTM)	TO (UPSTM)	LGTH (FT)	DISCH. E.I.	INLET E.I.	SLOPE (%)	PIPE SIZE	TYPE	NOTES
P-1	EX. 54"	S-3	441	841.42	841.87	0.10%	54"	RCP	
P-2	S-20	ADJ-1	14	844.05	844.70	4.64%	12"	RCP	
P-3	S-20A	ADJ-2	15	844.22	845.46	8.27%	12"	RCP	
P-4	S-1A	S-1	17	844.33	845.27	5.54%	12"	RCP	
P-5	S-3	ADJ-3	37	841.87	845.70	10.34%	14"x23"	HERCP	COLLAR
P-6	S-3	CC-1	22	841.87	845.20	15.13%	14"x23"	HERCP	COLLAR
P-7	S-21A	IN 5247-163	14	844.47	845.65	8.43%	12"	RCP	
P-8	S-21	IN 5247-180	17	844.47	845.55	6.35%	18"	RCP	
P-9	S-3	S-8	328	841.87	842.20	0.10%	54"	RCP	
P-10	IN 5247-180	S-4	43	845.53	845.73	0.47%	18"	RCP	
P-11	S-5A	S-5	16	844.50	845.00	3.13%	15"	RCP	
P-12	S-6A	S-6	19	844.58	845.49	4.79%	12"	RCP	
P-13	S-7A	S-7	16	844.58	845.47	5.56%	12"	RCP	
P-14	S-8	S-9	41	844.60	844.97	0.90%	18"	RCP	
P-15	S-9	S-10	40	845.47	845.84	0.93%	12"	RCP	
P-16	S-8	S-11	40	844.20	844.38	0.45%	24"	RCP	
P-17	S-8	S-19	337	842.20	842.51	0.09%	54"	RCP	
P-18	S-12A	S-12	20	844.75	845.75	5.00%	12"	RCP	
P-19	S-13A	S-13	16	844.75	845.70	5.94%	12"	RCP	
P-20	S-14A	S-14	20	844.85	845.87	5.10%	12"	RCP	
P-21	S-15A	S-15	20	844.85	845.82	4.85%	12"	RCP	
P-22	S-16A	S-16	20	844.93	845.94	5.05%	12"	RCP	
P-23	S-17A	S-17	22	845.00	845.44	2.00%	18"	RCP	
P-24	S-17	EX. PIPE	8				12"	PVC	COLLAR
P-25	S-18A	S-18	16	845.25	845.50	1.56%	18"	RCP	
P-26	S-18	EX. PIPE	8				12"	PVC	COLLAR
P-27	S-11	S-22	16	844.38	845.00	3.88%	24"	RCP	

### STANDARD NOTES:

- ABBREVIATIONS: AE = APRON ENDWALL; RCP = REINFORCED CONCRETE PIPE; HERCP = HORIZONTAL ELLIPTICAL REINFORCED CONCRETE PIPE; DNA = DOES NOT APPLY; SAS = SEWER ACCESS STRUCTURE; LP = LOW POINT INLET STRUCTURE; FP = FIELD Poured STRUCTURE; TR = TOP OF CONCRETE ROOF; NCM = NO CROWN MATCH FOR PIPES
- APPROXIMATE DISCHARGE E.I. GIVEN, ADJUST E.I. AND PIPE SLOPE IN THE FIELD.
- TOP OF CASTING GRADE GIVEN IS THE TOP OF CURB FOR INLET STRUCTURES AND THE FLOWLINE OF THE CLOSED CASTING FOR SAS's.
- TOP OF CONCRETE ROOF (TR) IS 1.25' BELOW TOP OF CASTING UNLESS OTHERWISE NOTED.
- ALL REINFORCED CONCRETE PIPES TO BE CLASS III UNLESS OTHERWISE NOTED.
- SURVEYOR TO CONFIRM THAT ALL INLET STATION / OFFSETS LINE UP WITH PROPOSED CURB AND GUTTER.
- ALL STRUCTURES CALLED OUT AS FIELD Poured SHALL BE FIELD Poured. ALL OTHER STRUCTURES (NOT INDICATED AS FIELD Poured) SHALL BE SUBMITTED TO CITY ENGINEERING FOR APPROVAL IF PRECAST STRUCTURES ARE PREFERRED. CONTACT ERIC DUNDEE OF CITY ENGINEERING AT (608) 266-4913 FOR PRECAST APPROVALS, OR FAX SHOP DRAWINGS TO (608)264-9275.

### SPECIFIC NOTES

- (1) EI OF TAP AT 54" RCP TO BE 3" ABOVE 54" RCP SPRINGLINE
- (2) CONNECT PRIVATE DRAIN - BID ITEM 90031

GENERAL ELECTRIC NOTES:

1. ALL LOCATIONS ARE APPROXIMATE. THE TRAFFIC ENGINEER SHALL APPROVE FINAL LOCATIONS, INCLUDING SETBACK, IN THE FIELD AFTER NEW CURB AND SIDEWALK HAS BEEN LOCATED. THE CONTRACTOR SHALL NOTIFY DAN DETTMANN (266-) CITY TRAFFIC ENGINEERING, AT LEAST 24-HOURS IN ADVANCE OF NEEDING CONDUIT OR HANDHOLE LOCATIONS MARKED.
2. THE CONTRACTOR SHALL DO ALL WORK IN ACCORDANCE WITH "CITY OF MADISON STANDARD SPECIFICATIONS FOR PUBLIC WORKS CONSTRUCTION, 2013 EDITION" AND ALL ADDENDUMS THERETO. ALL CONDUIT SHALL BE PVC, SCHEDULE 80 UNDER ROADWAY PAVEMENT AND DRIVEWAYS OR SCHEDULE 40 OTHERWISE. PULL WIRE REQUIRED AS PER STANDARD SPECIFICATIONS.
3. THE CONTRACTOR SHALL CALL MIKE CHRISTOPH (266-9031) AT THE TRAFFIC ENGINEERING SHOP AT LEAST 24-HOURS IN ADVANCE OF BURYING CONDUIT TO ARRANGE FOR INSPECTION. ANY WORK COMPLETED WITHOUT INSPECTION IS SUBJECT TO REJECTION.
4. CONDUIT IN THE 10 N LIVINGSTON BLOCK MAY NEED TO BE TURNED OUT TOWARD SIDEWALK AT THREE LOCATIONS.
5. CONDUIT LOCATIONS WILL BE DETERMINED BY T.E. ELECTRICAL INSPECTOR FOR ROADWAY SEGMENTS WHERE CURB & GUTTER IS NOT BEING REPLACED.

LEGEND	
---	INSTALL PVC (SIZE NOTED)
■	ELECTRICAL HANDHOLE TYPE I
—E—	EXISTING CONDUIT
—FO—	EXISTING FIBER OPTIC
□	EXISTING HANDHOLE

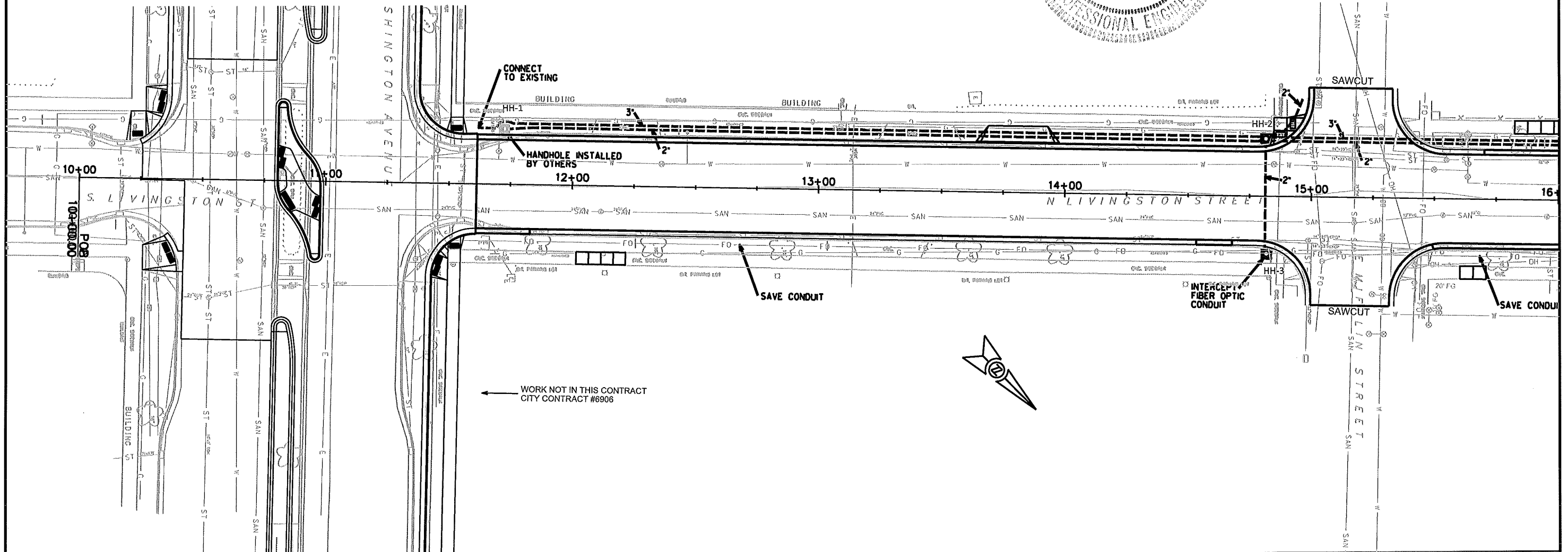
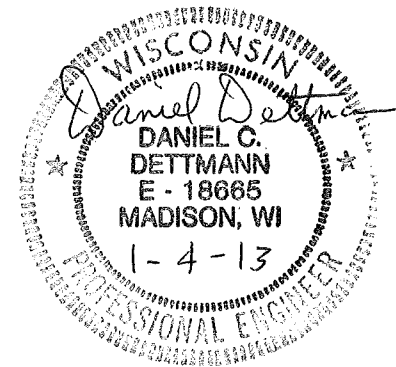

PLOT SCALE:

PLOT NAME:

REV. DATE:

ORIGINATOR: CITY OF MADISON, TRAFFIC ENG. DIV.

SL1225  
12/26/2012 SAL  
1/3/2013 KJF

PROJECT NO. 53W1462

SHEET NO.  
E-2

Livingston Street Construction  
Electrical Plan

CITY OF MADISON

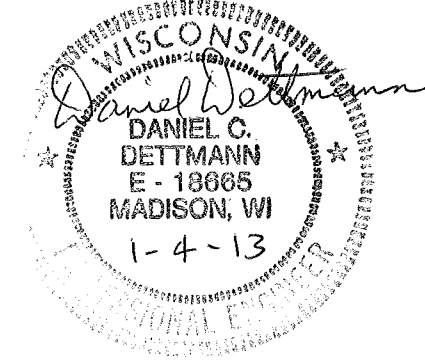

PLOT SCALE:

PLOT NAME:

REV. DATE:

ORIGINATOR: CITY OF MADISON, TRAFFIC ENG. DIV.

