



Madison, Wisconsin

CITY OF MADISON

CITY ENGINEERING DIVISION

DEPARTMENT OF PUBLIC WORKS

PLAN OF PROPOSED IMPROVEMENT

CONVENTIONAL SIGNS

COMBUSTIBLE FLUIDS



UNDERGROUND UTILITIES

NOTE: FIELD VERIFY UTILITIES

STORM SEWER	—ST—
SANITARY SEWER	—SAN—
WATER	—W—
POWER POLE	⊥
RAILROAD	▬▬▬▬▬▬

INDEX OF SHEETS

SHEET NO. D1	CURB DETAIL
SHEET NO. D2	WALK DETAIL
SHEET NO. D3	BIKE PATH DETAIL
SHEET NO. E1	ELECTRICAL PLAN
SHEET NO. M-1	PAVEMENT MARKING PLAN
SHEET NO. TCI-TC3	TRAFFIC CONTROL/PHASING PLAN

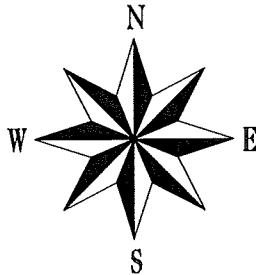

ATWOOD AVENUE/DUNNING STREET

BIKE CROSSING

PROJECT NO. 53W1551
CONTRACT NO. 7010

PROJECT LOCATION

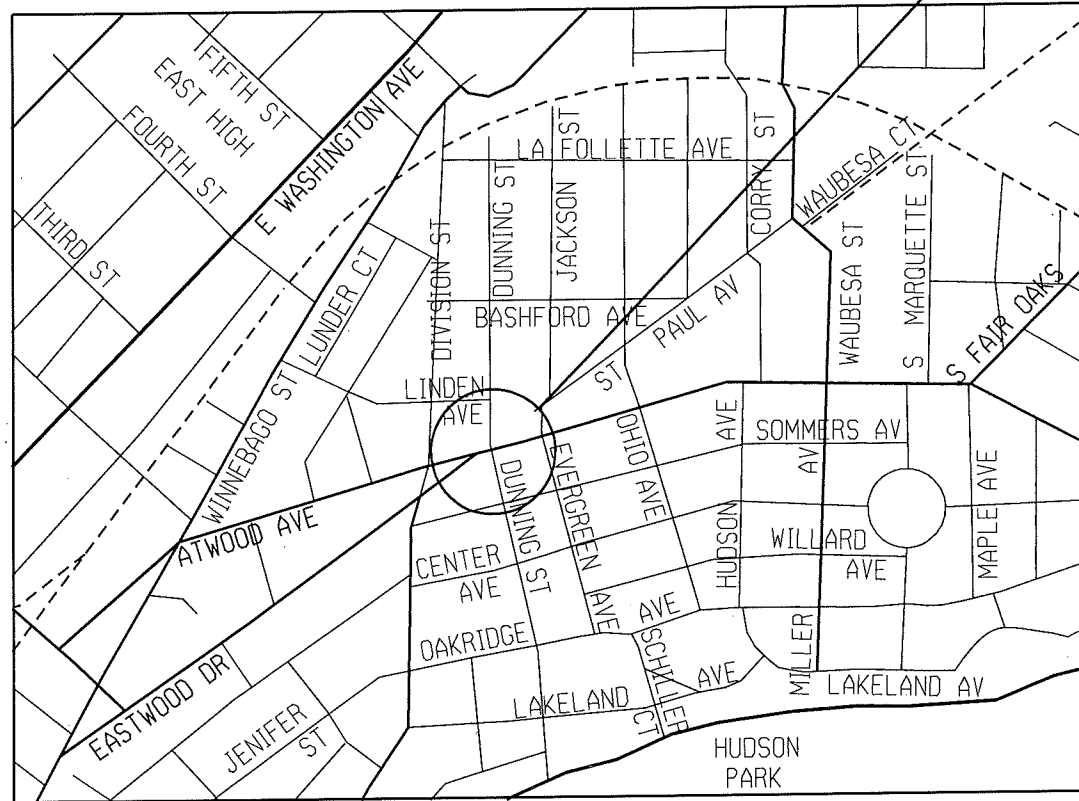

NOTES:
THE CROSS SLOPE OF SIDEWALK AND BARRIER FREE WALK RAMP SHALL NOT EXCEED 2%. THE LONGITUDINAL GRADE OF BARRIER FREE WALK RAMP SHALL NOT EXCEED 8.33%.

STREET PROJECT APPROVED
Oct. 16, 2012
BY THE COMMON COUNCIL
OF MADISON, WISCONSIN

DESIGN APPROVED BY:

[Signature] 11/16/12
City Engineer Date

STREET DESIGNED BY:

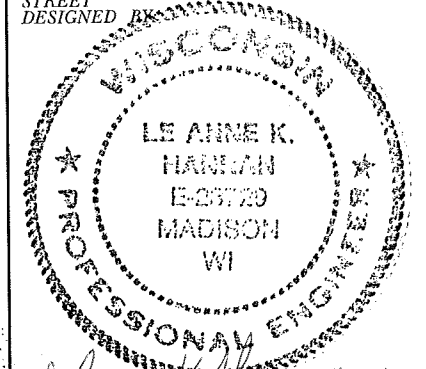

[Signature]
11/15/12

ELECTRIC DESIGNED BY:



11-15-12

PAVEMENT MARKING DESIGNED BY:

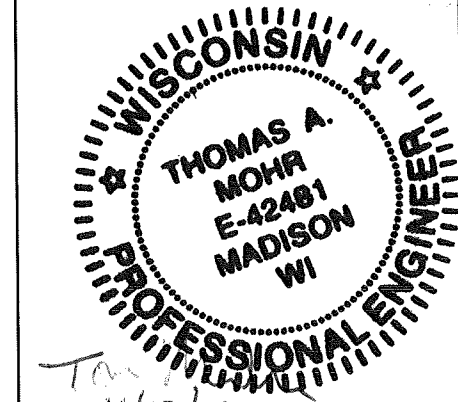

[Signature]
11/15/12

CURB DETAILS

ATWOOD AVE/DUNNING
ST BIKE CROSSING CITY OF MADISON

LEVELS ON - 1,2,3,4,5,6,7,8,9,10,11,12,13,14,15,16,17,18,19,20,21,22,23,24,25,26,27,28,29,30,31,32,33,34,35,36,37,38,39,40,41,42,43,44,45,46,47,48,49,50,51,52,53,54,55,56,57,58,59,60,61,62,63

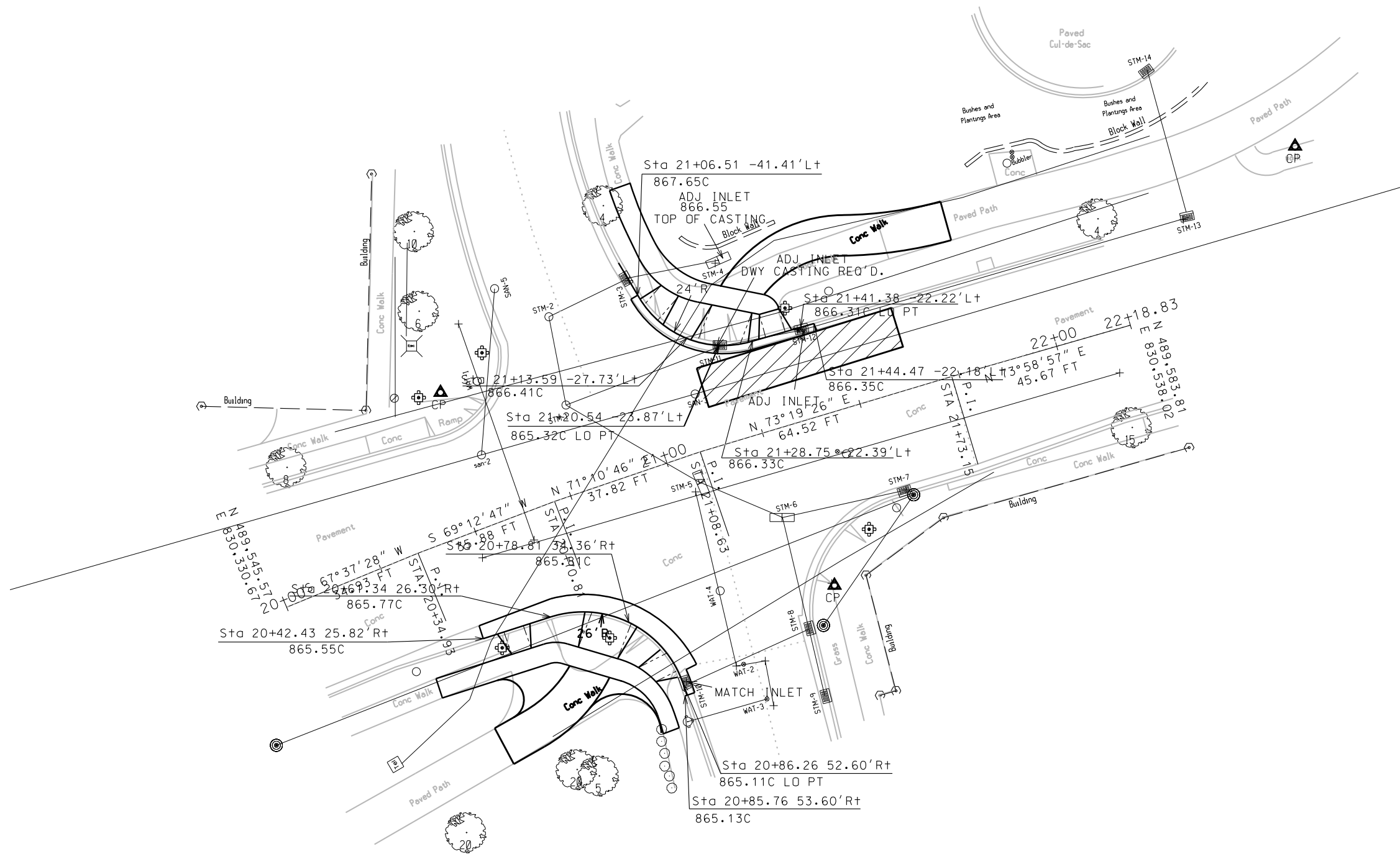

LEVELS ON - 1,2,3,4,5,6,7,8,9,10,11,12,13,14,15,16,17,18,19,20,21,22,23,24,25,26,27,28,29,30,31,32,33,34,35,36,37,38,39,40,41,42,43,44,45,46,47,48,49,50,51,52,53,54,55,56,57,58,59,60,61,62,63

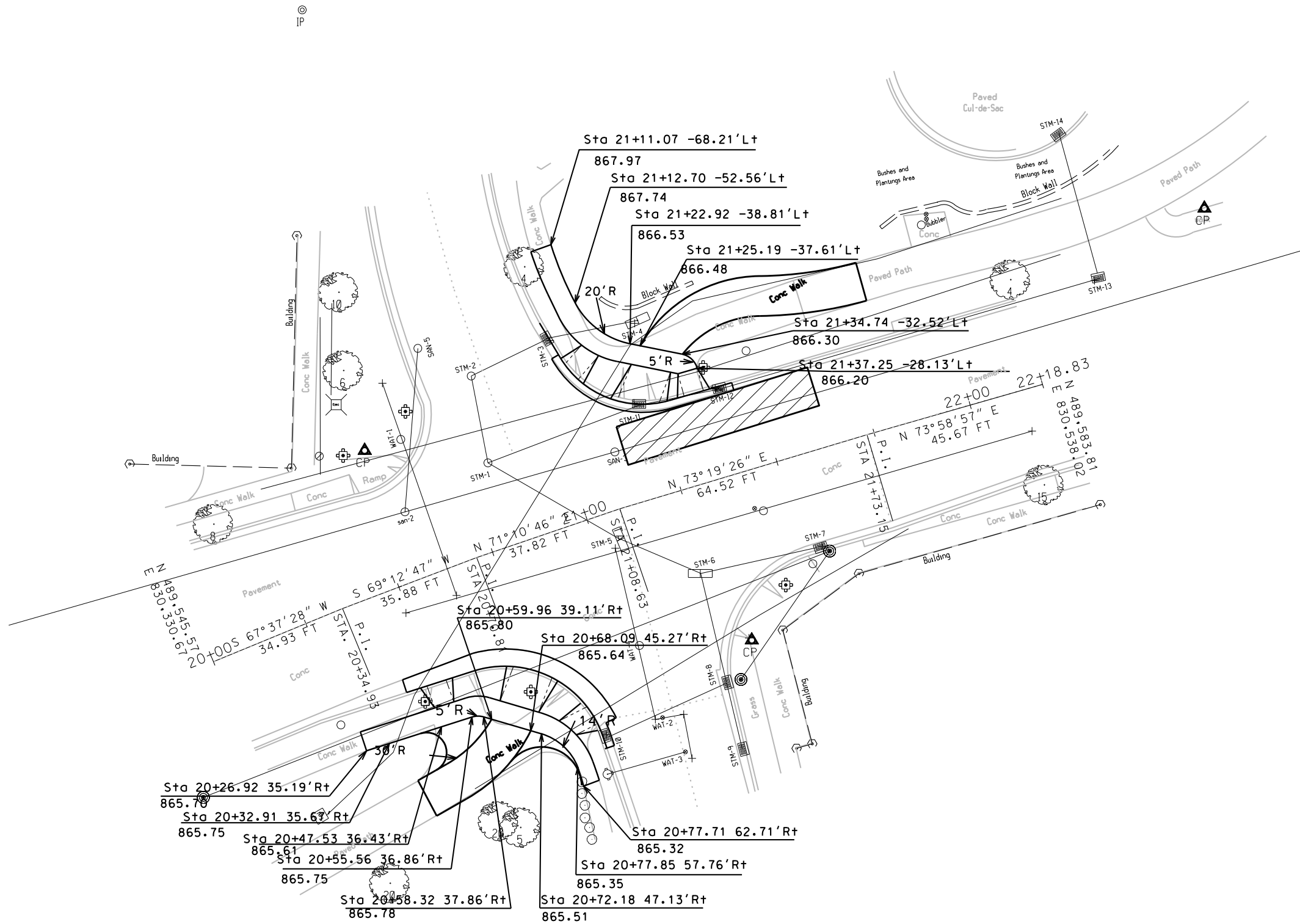

BIKE PATH DETAILS

ATWOOD AVE/DUNNING
ST BIKE CROSSING CITY OF MADISON

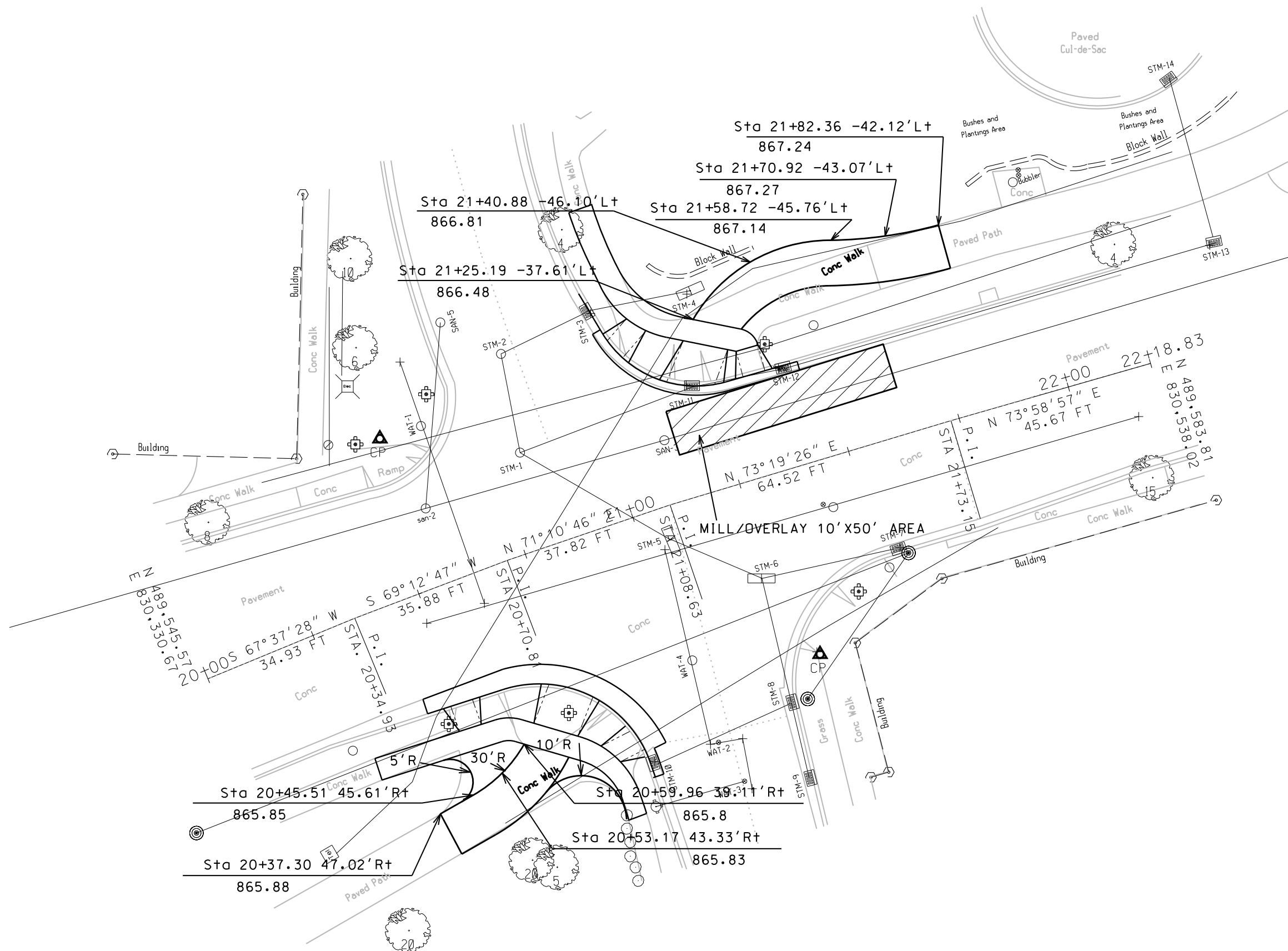

LEVELS ON - 1,2,3,4,5,6,7,8,9,10,11,12,13,14,15,16,17,18,19,20,21,22,23,24,25,26,27,28,29,30,31,32,33,34,35,36,37,38,39,40,41,42,43,44,45,46,47,48,49,50,51,52,53,54,55,56,57,58,59,60,61,62,63

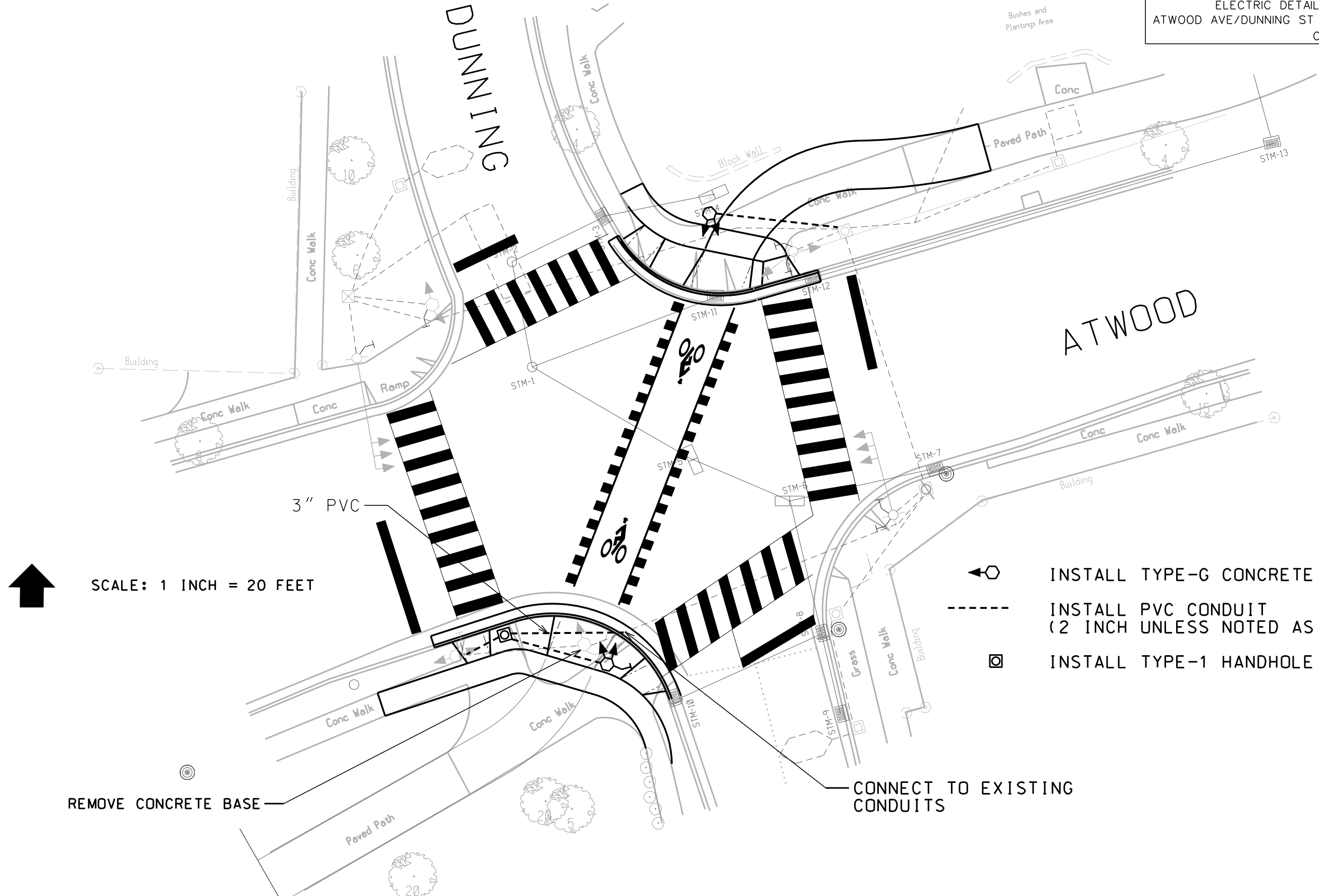

ELECTRIC DETAILS
ATWOOD AVE/DUNNING ST BIKE CROSSING
CITY OF MADISON

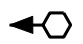
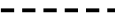

SCALE: 1 INCH = 20 FEET

-  INSTALL TYPE-G CONCRETE BASES
-  INSTALL PVC CONDUIT (2 INCH UNLESS NOTED AS OTHER)
-  INSTALL TYPE-1 HANDHOLE

REMOVE CONCRETE BASE

CONNECT TO EXISTING CONDUITS

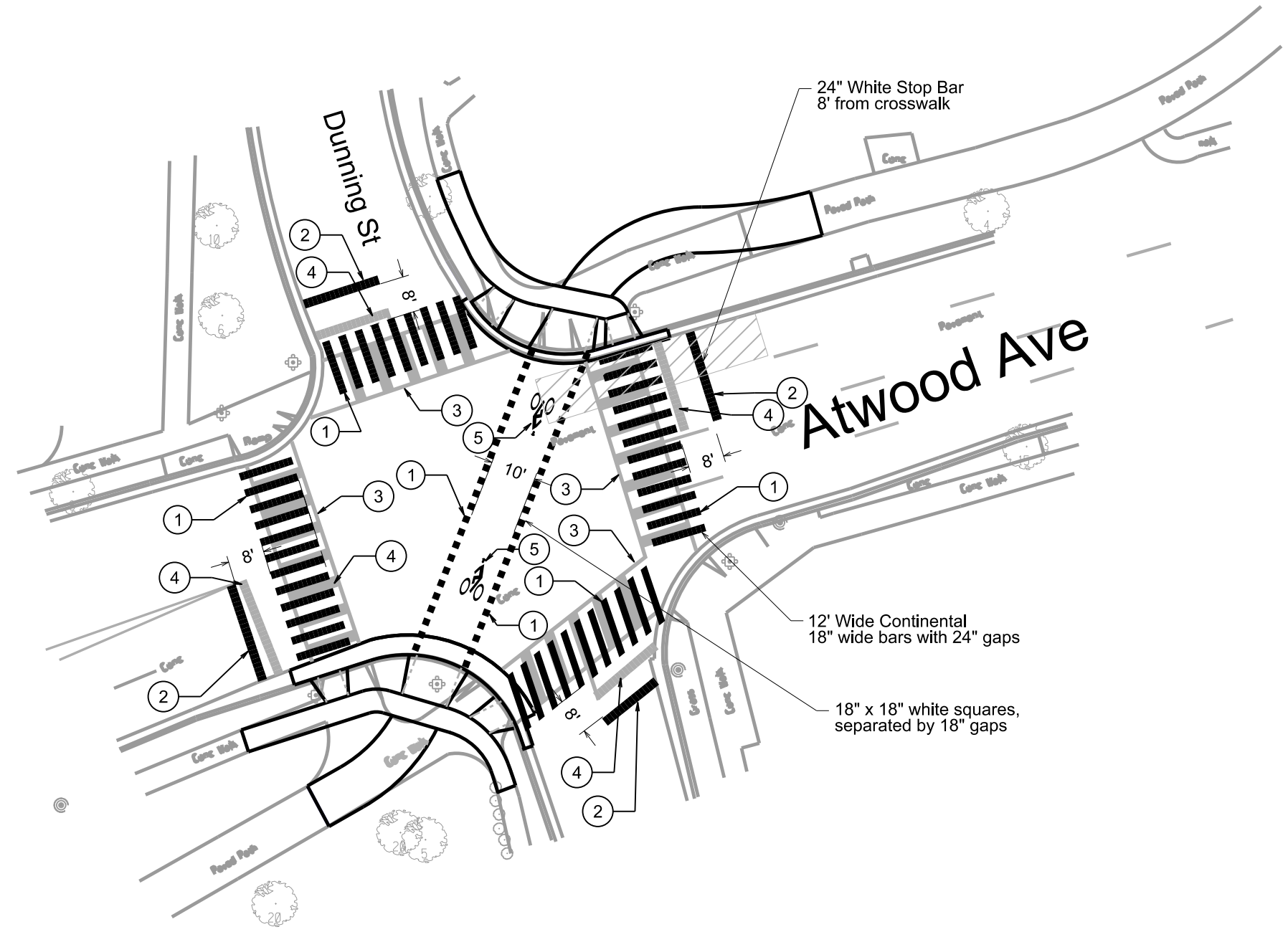

Bid Item	Callout	Description
60816	1	Pavement Marking Epoxy, Continental Crosswalk, 18-Inch
60818	2	Pavement Marking Epoxy, Stop Line, 24-Inch
60883	3	Pavement Marking Removal, 12-Inch
60885	4	Pavement Marking Removal, 24-Inch
60823	5	Pavement Marking Epoxy, Symbol, Bike Lane

PLOT SCALE:
 PLOT NAME:
 REV. DATE:
 ORIGINATOR: CITY OF MADISON, TRAFFIC ENG. DIV.

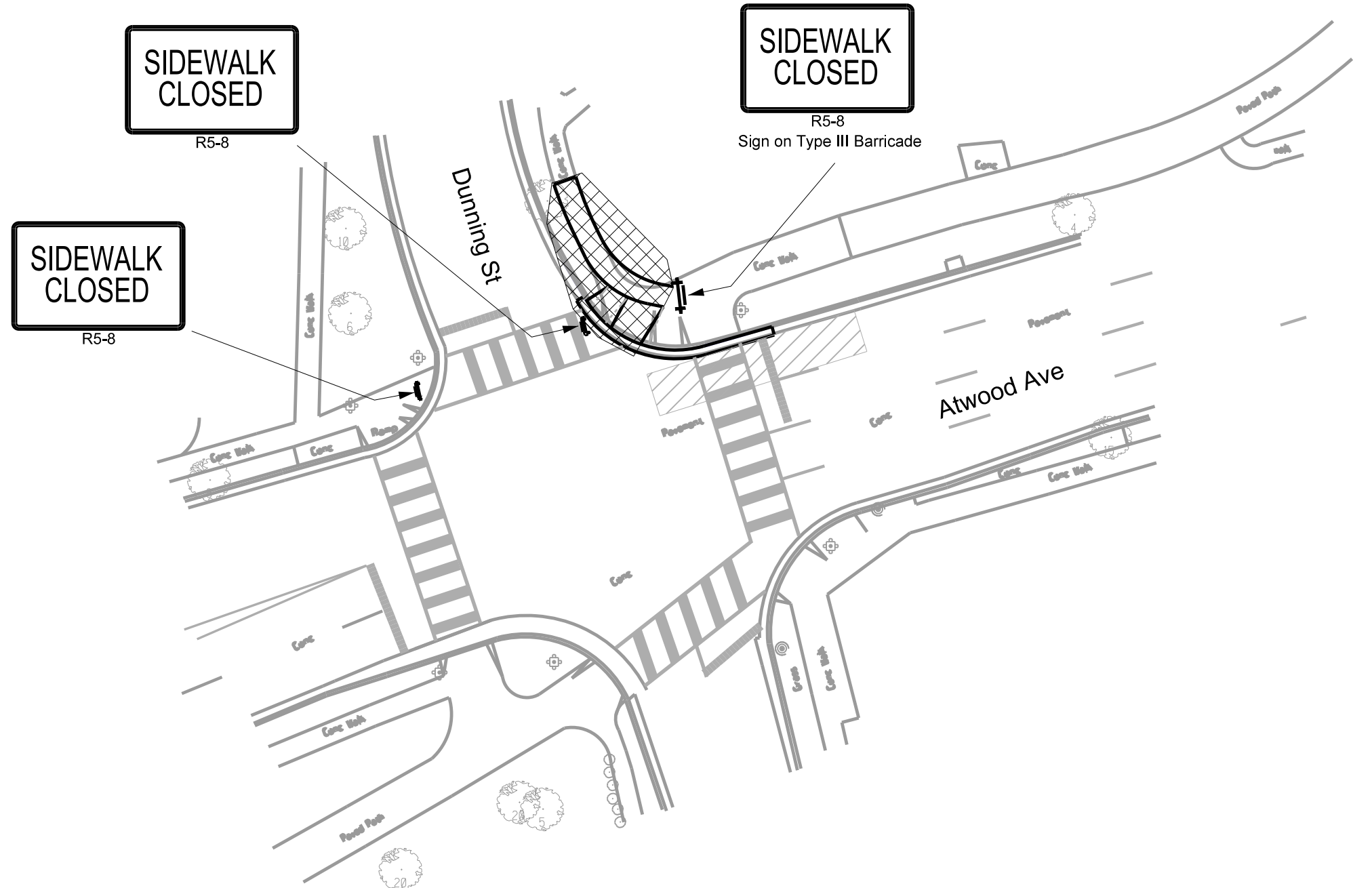

Sign on Type II Barricade
200' from work zone

PLOT SCALE:
 PLOT NAME:
 REV. DATE:
 ORIGINATOR: CITY OF MADISON, TRAFFIC ENG. DIV.

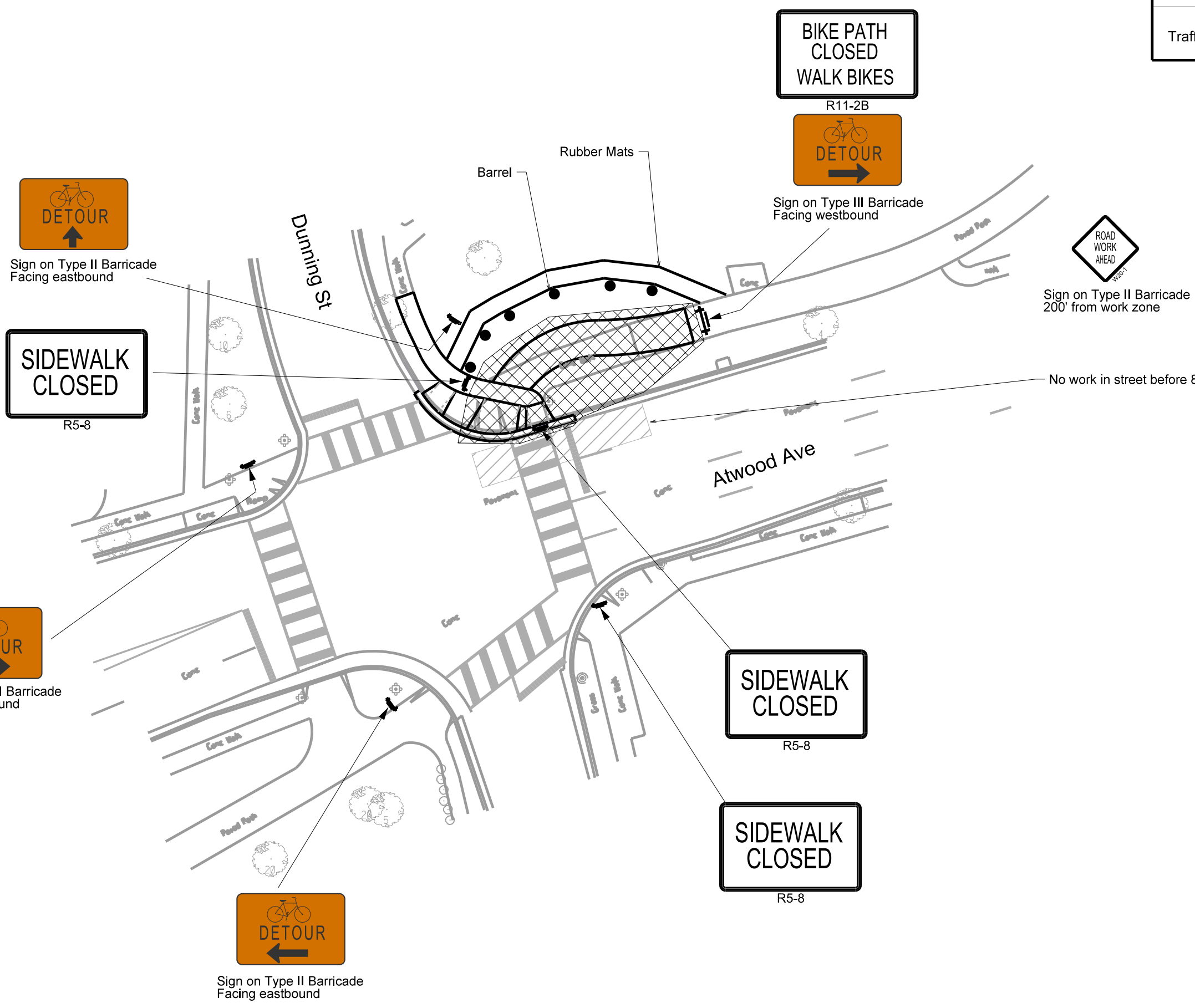

PLOT SCALE:
 PLOT NAME:
 REV. DATE:
 ORIGINATOR: CITY OF MADISON, TRAFFIC ENG. DIV.

PLOT SCALE:
 PLOT NAME:
 REV. DATE:
 ORIGINATOR: CITY OF MADISON, TRAFFIC ENG. DIV.

