

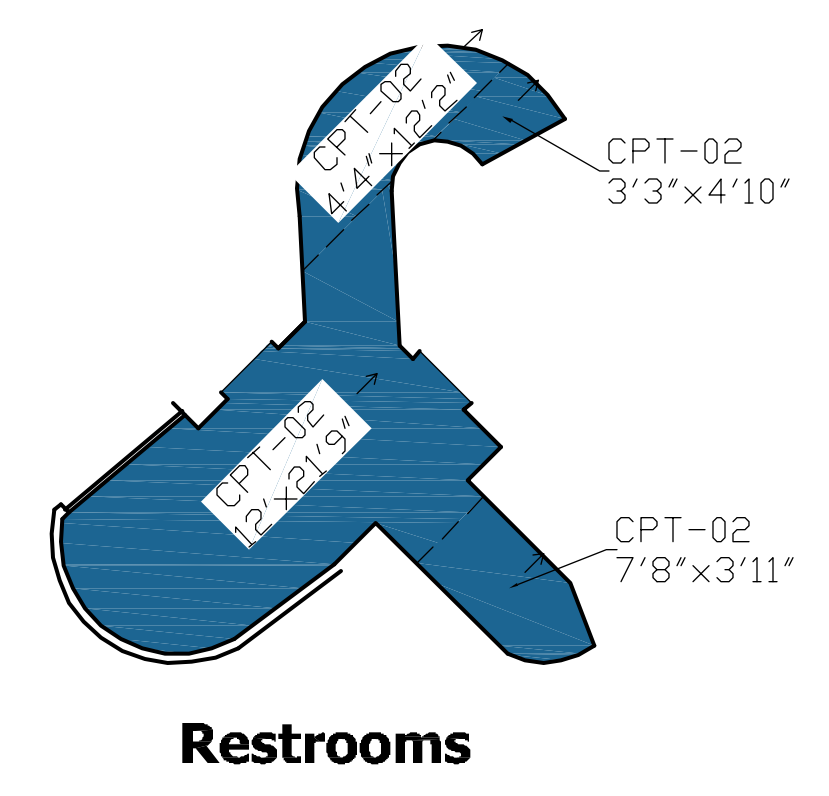

CARPET SCHEDULE				
CODE	DESIGN #	WIDTH	SIZE	DESCRIPTION
CPT-01	LX03850-15	12'	6'x2'7"	FIELD CARPET
CPT-02	BX04463-1	12'	N/A	BORDER CARPET
CPT-03	LX03850-20	4M	EJ	GRAND TERRACE FIELD
CPT-04	LX03850-21	4M	EJ	PROMENADE FIELD
CPT-05	FIELD LX03850-15 + BORDER BX04463-1	4M	EJ	PREFUNCTION FIELD
CPT-06	FIELD LX03850-15 + BORDER BX04463-1	4M	EJ	4TH FLOOR ENTRANCE FIELD
CPT-07	FIELD LX03850-15 + BORDER BX04463-1	4M	EJ	4TH FLOOR ENTRANCE FIELD
CPT-08	LX03850-22	4M	EJ	4TH FLOOR LECTURE HALL PREFUNCTION FIELD
CPT-09	FIELD LX03850-15 + BORDER BX04463-1	12'	EJ	HILTON SKYLINK CORRIDOR

Notes:
 Arrow → indicates carpet running direction.
 The seaming diagram is to illustrate our recommendation on the installation of Tai Ping carpet based on the architectural plans provided by the customer which have been converted to an AutoCAD file to determine the best possible layout for your project. Dashed lines shown on the seaming diagram are used to indicate the known seam locations and are not intended to be installed. It is the customer's responsibility to verify that the actual dimensions of the room are as shown on the architectural plans. Additional seams may be required during the installation of the carpet. Please note that by accepting this seaming diagram you are confirming your approval on the known seam locations presented and understood that, due to the custom manufacturing process, Tai Ping Carpets America, Inc. is unable to guarantee that additional seams which are currently not shown may be required to complete the installation.
 Adjustment seaming may be necessary. The fabrication will be done on job site. In order to prevent damage to seams and prevent the hazard of tripping, thresholds should be used in doorways to cover seams between carpets or other flooring with different pile heights. Measurements obtained during the site verification will be incorporated into a revised seaming diagram that will be provided to you. If the installation method chosen for this project is considered either full or partial electronic joint (EJ) the need for the site verification is heightened, as we will use the dimensions which are provided from the site verification to allow us to manufacture the carpet with the intent to have the material installed in a precise location within the property. The EJ production method allows us to produce full or partial electronic joints as one piece and allows for minimal seams while achieving the desired design concept.
 Carpet layout can vary due to unforeseen circumstances and a site verification may be necessary. Therefore, we recommend that you have your installer review this seaming diagram and provide you with the specific site verification details or we can provide the service to you for a fee. Please note that Tai Ping does not guarantee the information provided on the seaming diagram if an on-site verification has not been completed by a representative of Tai Ping Carpets.
 Carpet is a textile fabric subject to inevitable processing variations in the four pattern conditions: bow, skew, shrink, elongation/shrinkage and fraying of edges. There are no industry standards for carpet pattern variations. It is highly recommended that installation is performed by an experienced installer familiar with pattern carpet installation.
 Prior to the production of the actual material the following approvals must be provided in addition to the seaming diagram: signed design renderings for all designs which will be used as your approval on scale, design intent, design repeat details, and color placement only, signed design layout, and signed lobby completion including all colors used which will be used as your approval on color only and will be sent to our factory for reference for color matching purposes.
 Measurements shown on plan are not. However, pattern match is included in quantities on takeoffs to allow for shifting of the carpet to ensure side match.
 Design borders, if applicable on this project, were not designed to make. Where such notes occur, Tai Ping cannot guarantee pattern match.
EJ INSTALLATIONS
 Before installing, all panels should be displayed to mix and acclimate to the climate conditions. Due to possible shrinking and stretching of panels during the manufacturing process, stretching may be necessary to make a proper match. The longest panel should be installed first, then the short panels can be stretched to make a proper match.
 EJ situations require Tai Ping to add additional amounts of carpet to the ends of each panel in order to ensure adequate finishing lengths and allow for any shifting to ensure side matching between panels.
 Measurements on plans noted by text will indicate the width of the area first and then the length of the area last.
 Example: Width x Length: 12'0" x 12' is the width and 16' is the length.
 Due to manufacturer roll lengths, possible head seams may be needed to complete installation for some areas.
 All PDF prints are not to scale.

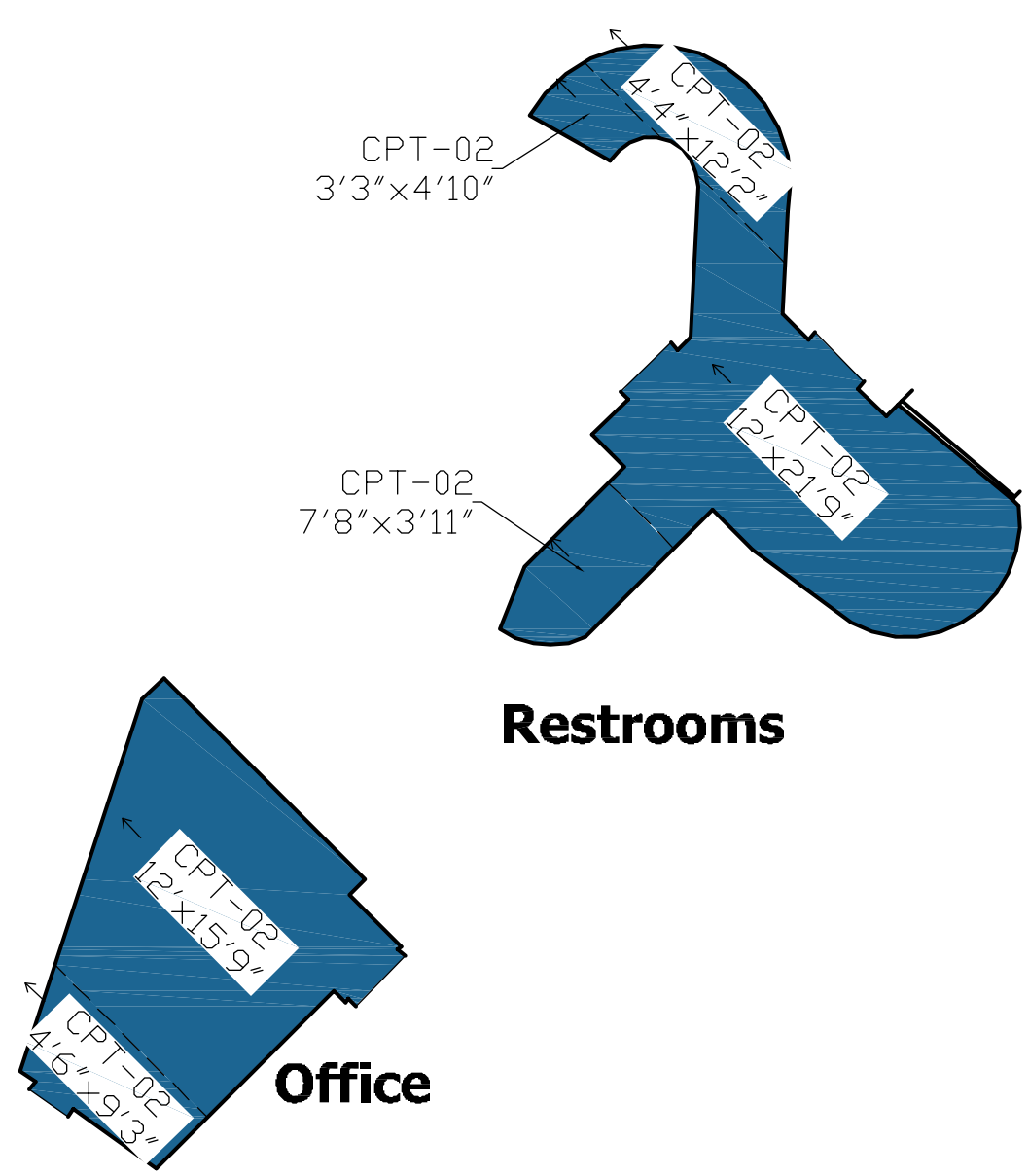
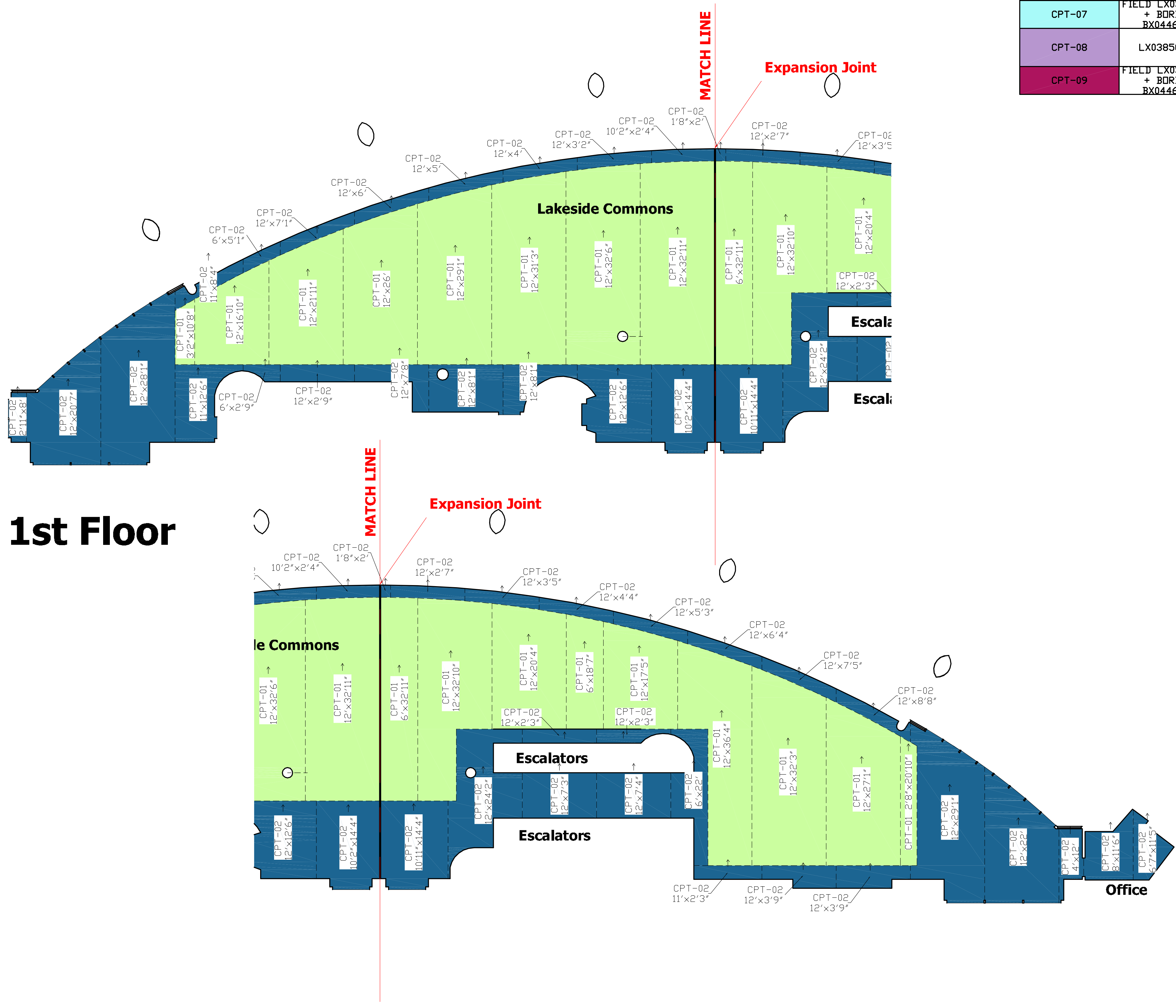
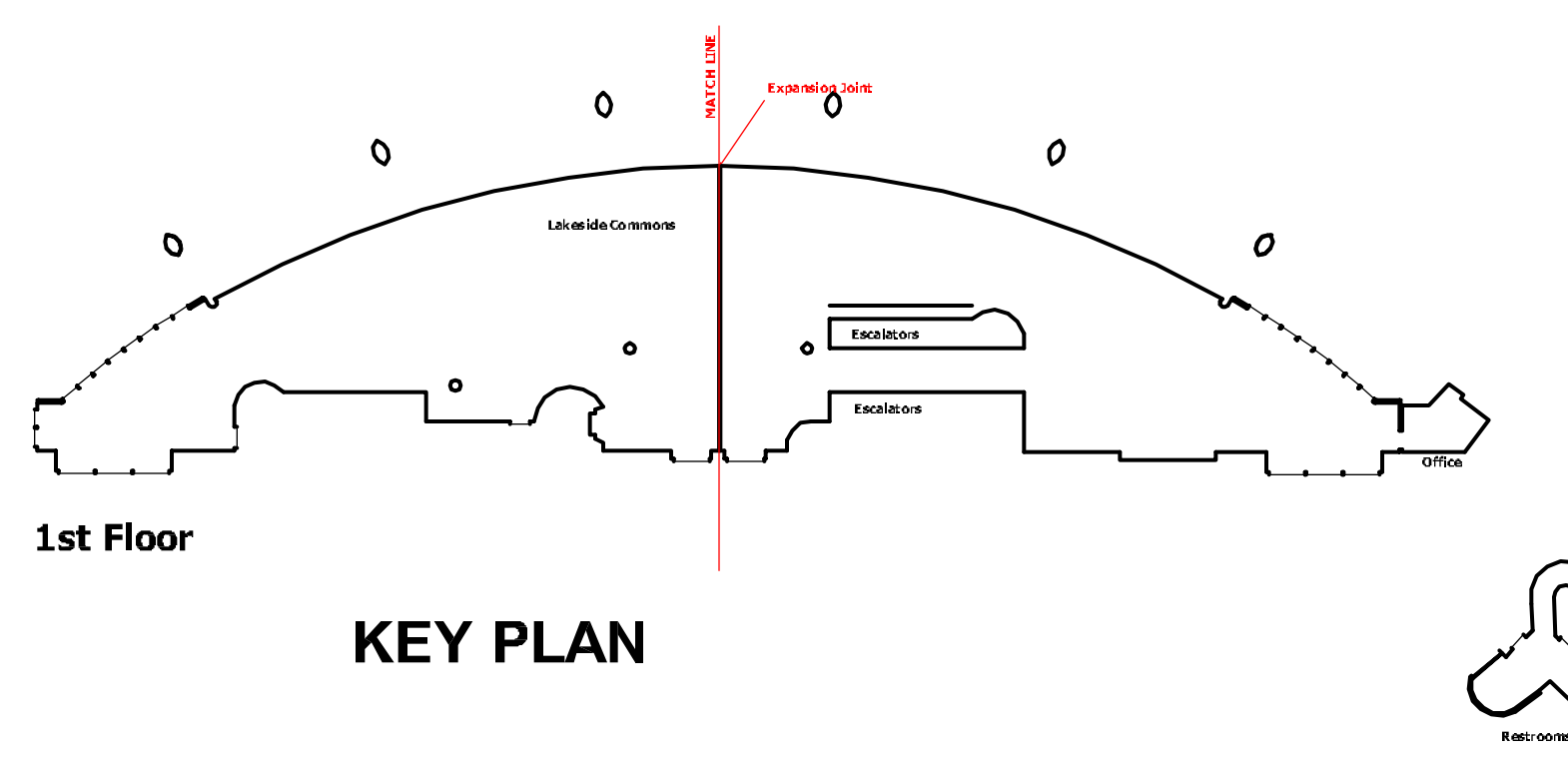

This drawing is the property of Tai Ping Carpets Americas.
Tai Ping Carpets Americas
 715 Curtis Parkway, SE
 Calhoun, GA 30701
 Tel +1 706 625 8905
 Tel +1 800 433 2440

PLANS APPROVED BY			
COMPANY			
DATE			
PROJECT NAME MONONA TERRACE CONVENTION CENTER			
PROJECT NO. 114939			
DATE 5/28/13	DRAWN BY BG		
SCALE 1/8"=1'	SHEET 1/5		
CPE NO. 12364			
NO.	REVISED	DATE	BY
30	FIELD & BORDER	5/31/13	BG
40	1ST FLOOR	6/5/13	BG
50	DESIGNS	6/7/13	BG

CARPET SCHEDULE				
CODE	DESIGN #	WIDTH	SIZE	DESCRIPTION
CPT-01	LX03850-15	12'	6'x2'7"	FIELD CARPET
CPT-02	BX04463-1	12'	N/A	BORDER CARPET
CPT-03	LX03850-20	4M	EJ	GRAND TERRACE
CPT-04	LX03850-21	4M	EJ	CAPITOL PROMENADE FIELD
CPT-05	FIELD LX03850-15 + BORDER BX04463-1	4M	EJ	PREFUNCTION FIELD
CPT-06	FIELD LX03850-15 + BORDER BX04463-1	4M	EJ	4TH FLOOR ENTRANCE FIELD
CPT-07	FIELD LX03850-15 + BORDER BX04463-1	4M	EJ	4TH FLOOR ENTRANCE FIELD
CPT-08	LX03850-22	4M	EJ	LECTURE HALL PREFUNCTION FIELD
CPT-09	FIELD LX03850-15 + BORDER BX04463-1	12'	EJ	HILTON SKYLINK CORRIDOR

Notes:
 Arrow → indicates carpet running direction.
 The seaming diagram is to illustrate our recommendation on the installation of Tai Ping carpet based on the architectural plans provided by the customer which have been converted to an Auto Cad file to determine the best possible layout for your project. Dashed lines shown on the seaming diagram are used to indicate the known seam locations only; however, additional seams may be required during the installation of the carpet. Please note that by accepting this seaming diagram you are confirming your approval on the known seam locations referenced and understood that, due to the custom manufacturing process, Tai Ping Carpets America, Inc. is unable to guarantee that additional seams which are currently not shown may be required to complete the installation.
 Adjustment seaming may be necessary. The fabrication will be done on job site. In order to prevent damage to seams and prevent the hazard of tripping, thresholds should be used in doorways to cover seams between carpets or other floorings with different pile heights. Measurements obtained during the site verification will be incorporated into a revised seaming diagram that will be provided to you. If the installation method chosen for this project is considered either full or partial electronic (EJ) the need for the site verification is heightened, as we will use the dimensions which are provided from the site verification to allow us to manufacture the carpet with the intent to have the material installed in a precise location within the property. The EJ production method allows us to produce flat or rose designs as one piece and allows for minimal seams while achieving the desired design concept.
 Carpet layouts can vary due to unforeseen circumstances and a site verification may be necessary. Therefore, we recommend that you have your installer review this seaming diagram and provide you with the specific site verification details or we can provide the service to you for a fee. Please note that Tai Ping does not guarantee the information provided on the seaming diagram if an official site verification has not been completed by a representative of Tai Ping Carpets.
 Carpet is a textile fabric subject to inevitable processing variations in the four pattern conditions: bow, skew/bite, elongation/shrinkage and looseness of edges. There are no industry standards for carpet pattern variations. It is highly recommended that installation is performed by an experienced familiar pattern carpet installer.
 Prior to the production of the actual material the following approvals must be provided in addition to the seaming diagram: signed design renderings for all designs which will be used; your approval on scale design intent, design repeat details, and color placement only; signed design layout and signed lobby samples including all colors used which will be used as your approval on color only and will be sent to our factory for reference for color matching purposes.
 Measurements shown on plan are not. However, pattern match is included in quantities on takeoffs to allow for shifting of the carpet to ensure side match.
 Design borders, if applicable on this project, were not designed to make. Where such notes occur, Tai Ping cannot guarantee pattern match.
EJ INSTALLATIONS:
 Before installing, all panels should be drylaid to mix and acclimate to the climate conditions. Due to possible shrinking and stretching of panels during the manufacturing process, stretching may be necessary to make a proper match. The longest panel should be installed first, then the short panels can be stretched to make a proper match.
 EJ situations require Tai Ping to add additional amounts of carpet to the ends of each panel in order to ensure adequate finishing lengths and allow for any shifting to ensure side matching between panels.
 Measurements on plans noted by text will indicate the width of the area first and then the length of the area last.
 Example: Width x Length: 12'x19' 12' is the width and 19' is the length.
 Due to manufacturer roll lengths, possible head seams may be needed to complete installation for some areas.
 All PDF prints are not to scale.

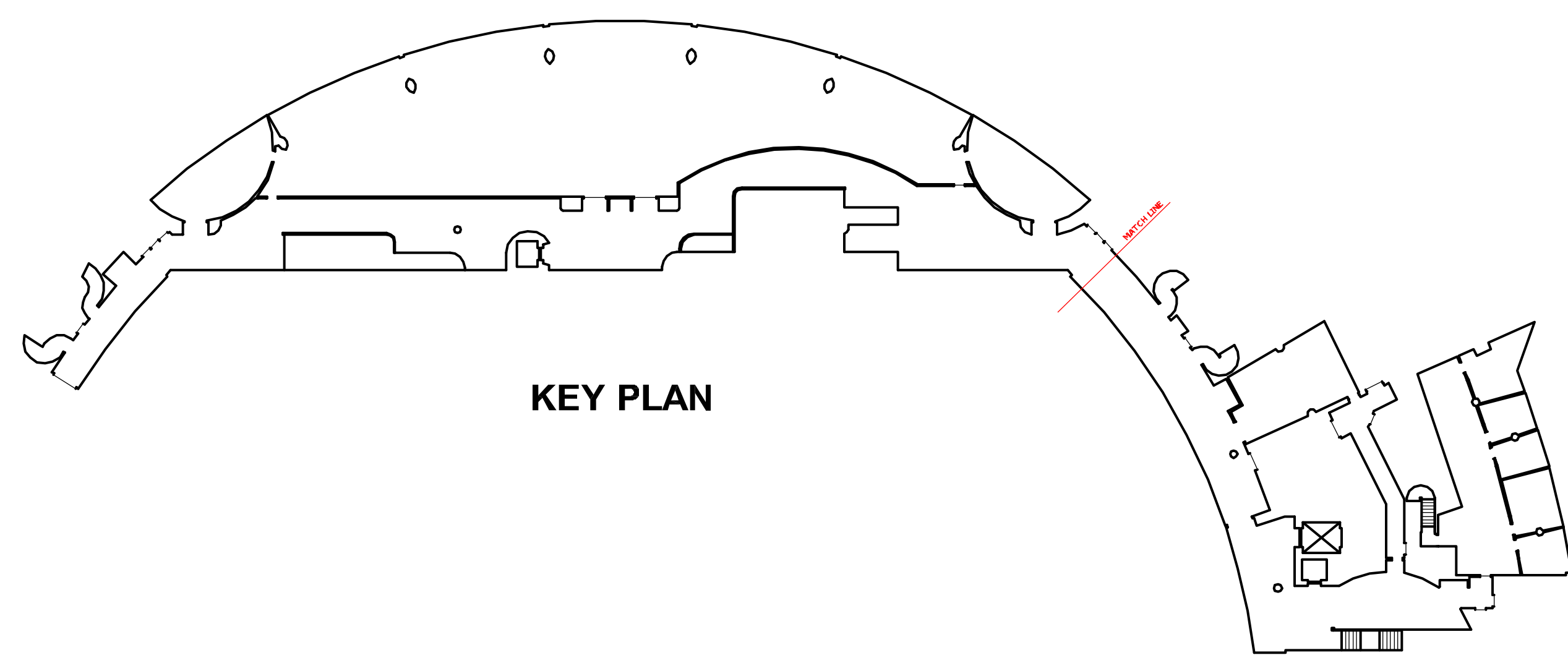

2nd Floor

NOTE:
 CARPET DIRECTION TURNS AT THIS POINT (*), SLIGHT CHANGE IN NAP.

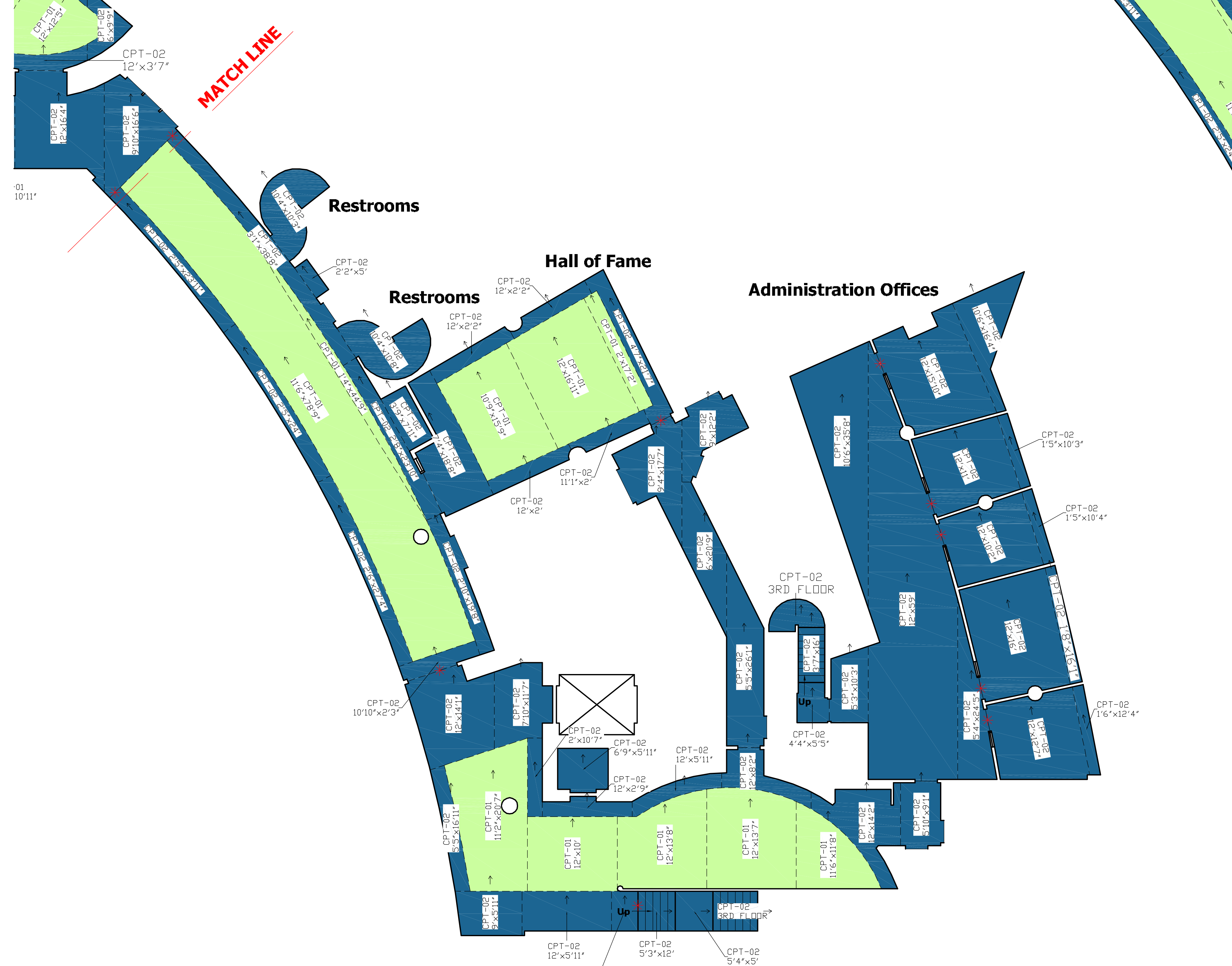

Match Line

This drawing is the property of Tai Ping Carpets America.
Tai Ping Carpets America
 715 Curtis Parkway, SE
 Calhoun, GA 30701
 Tel +1 706 625 8905
 Tel +1 800 433 2440

PLANS APPROVED BY			
COMPANY			
DATE			
PROJECT NAME			
MONONA TERRACE CONVENTION CENTER			
PROJECT NO.			
114939			
DATE	DRAWN BY		
5/28/13	BG		
SCALE	SHEET		
1/8"=1'	2/5		
CPE NO.			
12364			
NO.	REVISED	DATE	BY
30	FIELD & BORDER	5/31/13	BG
40	1ST FLOOR	6/5/13	BG
50	DESIGNS	6/7/13	BG

CARPET SCHEDULE				
CODE	DESIGN #	WIDTH	SIZE	DESCRIPTION
CPT-01	LX03850-15	12'	6'x2'7"	FIELD CARPET
CPT-02	BX04463-1	12'	N/A	BORDER CARPET
CPT-03	LX03850-20	4M	EJ	GRAND TERRACE FIELD
CPT-04	LX03850-21	4M	EJ	CAPITOL PROMENADE FIELD
CPT-05	FIELD LX03850-15 + BORDER BX04463-1	4M	EJ	PREFUNCTION FIELD
CPT-06	FIELD LX03850-15 + BORDER BX04463-1	4M	EJ	4TH FLOOR ENTRANCE FIELD
CPT-07	FIELD LX03850-15 + BORDER BX04463-1	4M	EJ	4TH FLOOR ENTRANCE FIELD
CPT-08	LX03850-22	4M	EJ	LECTURE HALL PREFUNCTION FIELD
CPT-09	FIELD LX03850-15 + BORDER BX04463-1	12'	EJ	HILTON SKYLINK CORRIDOR

Notes:
 Arrow → indicates carpet running direction.
 The seaming diagram is to illustrate our recommendation on the installation of Tai Ping carpet based on the architectural plans provided by the customer which have been converted to an Auto Cad file to determine the best possible layout for your project. Dashed lines shown on the seaming diagram are used to indicate the known seam locations only. However, additional seams may be required during the installation of the carpet. Please note that by accepting this seaming diagram you are confirming your approval on the known seam locations presented and understood that, due to the custom manufacturing process, Tai Ping Carpets Americas, Inc. is unable to guarantee that additional seams which are currently not shown may be required to complete the installation.
 Adjustment seaming may be necessary. The substitution will be done on job site. In order to prevent damage to seams and prevent the hazard of tripping, thresholds should be used in doorways to cover seams between carpets or other floorings with different pile heights. Measurements obtained during the site verification will be incorporated into a revised seaming diagram that will be provided to you. If the installation method chosen for this project is considered either full or partial electronic (e-joint) the need for the site verification is heightened, as we will use the dimensions which are provided from the site verification to allow us to manufacture the carpet with the intent to have the material installed in a precise location within the property. The E-J production method allows us to produce full or e-joint designs as one piece and allows for minimal seams while achieving the desired design concept.
 Carpet layouts can vary due to unforeseen circumstances and a site verification may be necessary. Therefore, we recommend that you have your installer review this seaming diagram and provide you with the specific site verification details or we can provide the service to you for a fee. Please note that Tai Ping does not guarantee the information provided on the seaming diagram if an official site verification has not been completed by a representative of Tai Ping Carpets.
 Carpet is a textile fabric subject to inevitable processing variations in the four pattern conditions: bow, skew/bite, elongation/shrinkage and looseness of edges. There are industry standards for carpet pattern variations. It is highly recommended that installation is performed by an experienced installer pattern carpet installer.
 Prior to the production of the actual material the following approvals must be provided in addition to the seaming diagram: signed design rendering for all designs which will be used in your approval on scale, design intent, design repeat details, and color placement only, signed design layout, and signed fabric samples including all colors used which will be used as your approval on color only and will be sent to our factory for reference for color matching purposes.
 Measurements shown on plan are not. However, pattern match is included in quantities on takeoffs to allow for shifting of the carpet to ensure side match.
 Design borders, if applicable on this project, were not designed to make. Where such notes occur, Tai Ping cannot guarantee pattern match.
E-J INSTALLATIONS
 Before installing, all panels should be displayed to mix and acclimate to the climate conditions. Due to possible shrinking and stretching of panels during the manufacturing process, stretching may be necessary to make a proper match. The longest panel should be installed first, then the short panels can be stretched to make a proper match.
 E-J situations require Tai Ping to add additional amounts of carpet to the ends of each panel in order to ensure adequate finishing lengths and allow for any shifting to ensure side matching between panels.
 Measurements on plans noted by text will indicate the width of the area first and then the length of the area last.
 Example: Width x Length: 12'0" x 12'0" is the width and 12'0" is the length.
 Due to manufacturer roll lengths, possible head seams may be needed to complete installation for some areas.
 All PDF prints are not to scale.

Administration Offices

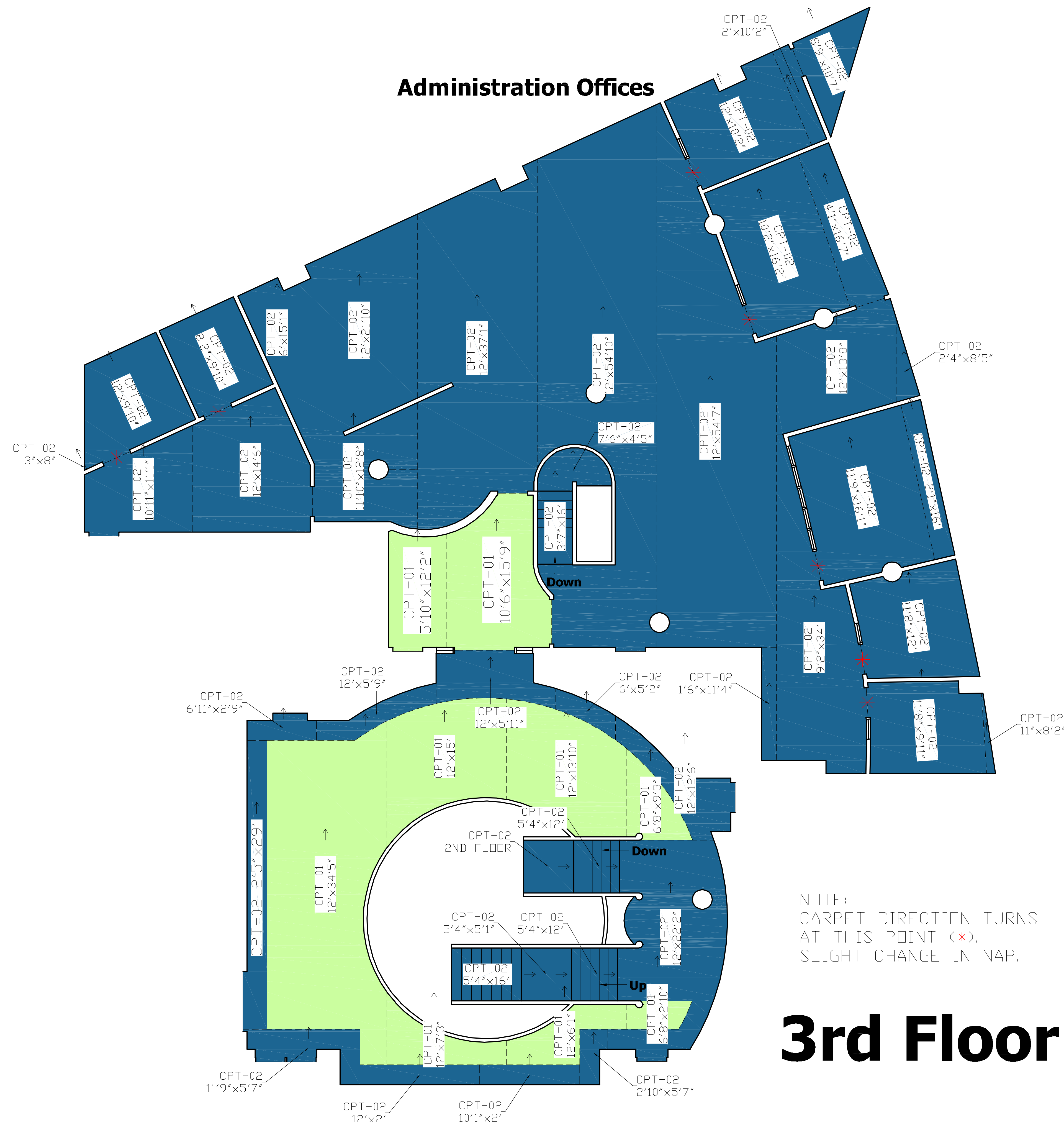

Expansion Joint

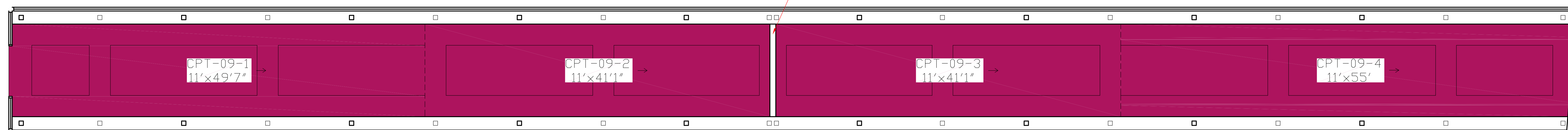

NOTE:
 INSTALL FROM EXPANSION JOINT. EXTRA BLEEDOUT WAS ADDED FOR INSTALLER TO TRIM TO FIT AND ADJUST TO CENTER.

This drawing is the property of Tai Ping Carpets Americas.
Tai Ping Carpets Americas
 715 Curtis Parkway, SE
 Calhoun, GA 30701
 Tel +1 706 625 8905
 Tel +1 800 433 2440

PLANS APPROVED BY	
COMPANY	
DATE	

PROJECT NAME	
MONONA TERRACE CONVENTION CENTER	

PROJECT NO.	
114939	
DATE	DRAWN BY
5/28/13	BG
SCALE	SHEET
3/16"=1'	3/5
CPE NO.	
12364	

NO.	REVISED	DATE	BY
30	FIELD & BORDER	5/31/13	BG
40	1ST FLOOR	6/5/13	BG
50	DESIGNS	6/7/13	BG

ORDER OF INSTALL:
CAPITOL PROMENADE, GRAND
TERRACE AND PRE-FUNCTION
AREAS TO BE INSTALLED BEFORE
BALL ROOM AND MEETING ROOMS.

NOTE:
PANELS 7,8 AND 9 OF CPT-04
WERE MADE LONG TO BE BE
ADJUSTED ON SITE.

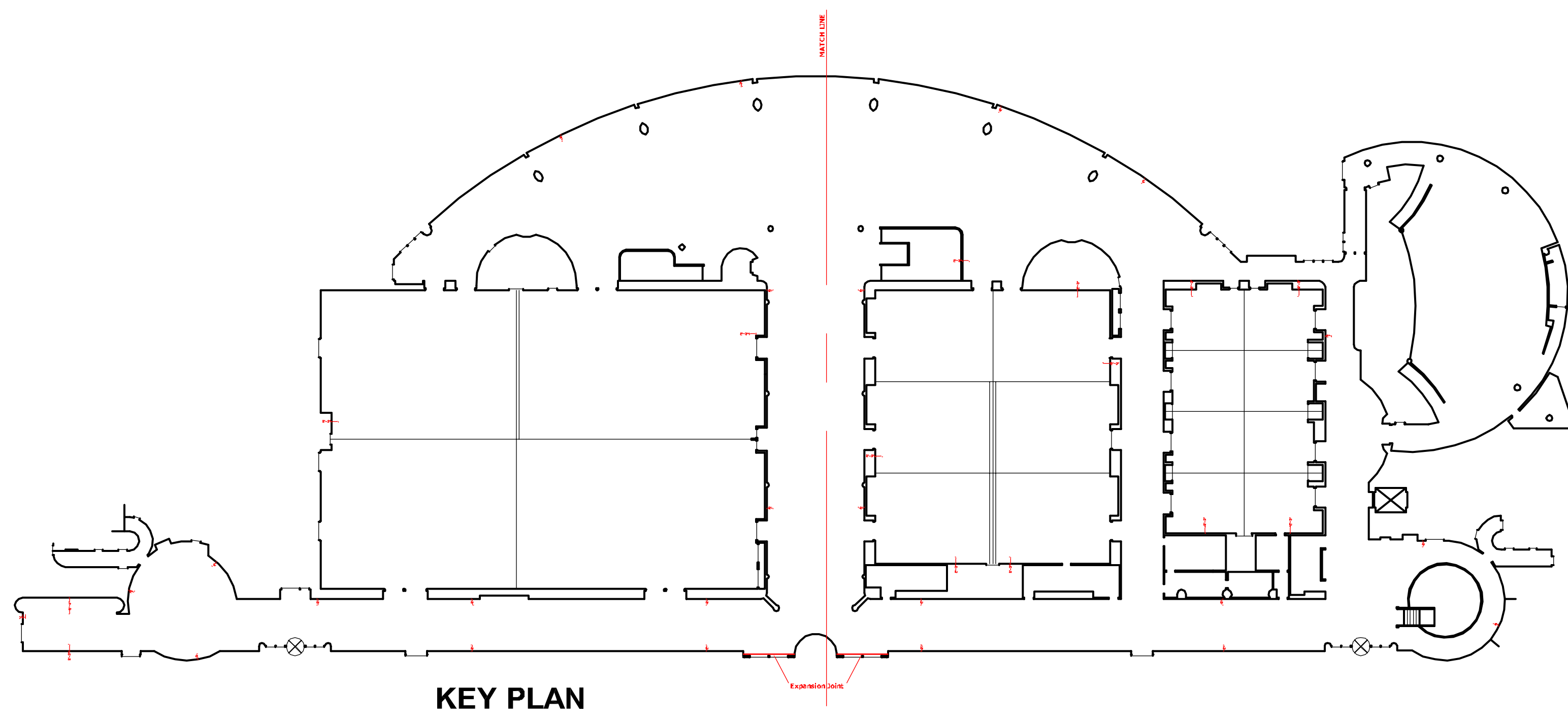

KEY PLAN

CARPET SCHEDULE				
CODE	DESIGN #	WIDTH	SIZE	DESCRIPTION
CPT-01	LX03850-15	12'	6'x2'7"	FIELD CARPET
CPT-02	BX04463-1	12'	N/A	BORDER CARPET
CPT-03	LX03850-20	4M	EJ	GRAND TERRACE FIELD
CPT-04	LX03850-21	4M	EJ	CAPITOL PROMENADE FIELD
CPT-05	FIELD LX03850-15 + BORDER BX04463-1	4M	EJ	PRE-FUNCTION FIELD
CPT-06	FIELD LX03850-15 + BORDER BX04463-1	4M	EJ	4TH FLOOR ENTRANCE FIELD
CPT-07	FIELD LX03850-15 + BORDER BX04463-1	4M	EJ	4TH FLOOR ENTRANCE FIELD
CPT-08	LX03850-22	4M	EJ	LECTURE HALL PREFUNCTION FIELD
CPT-09	FIELD LX03850-15 + BORDER BX04463-1	12'	EJ	HILTON SKYLINK CORRIDOR

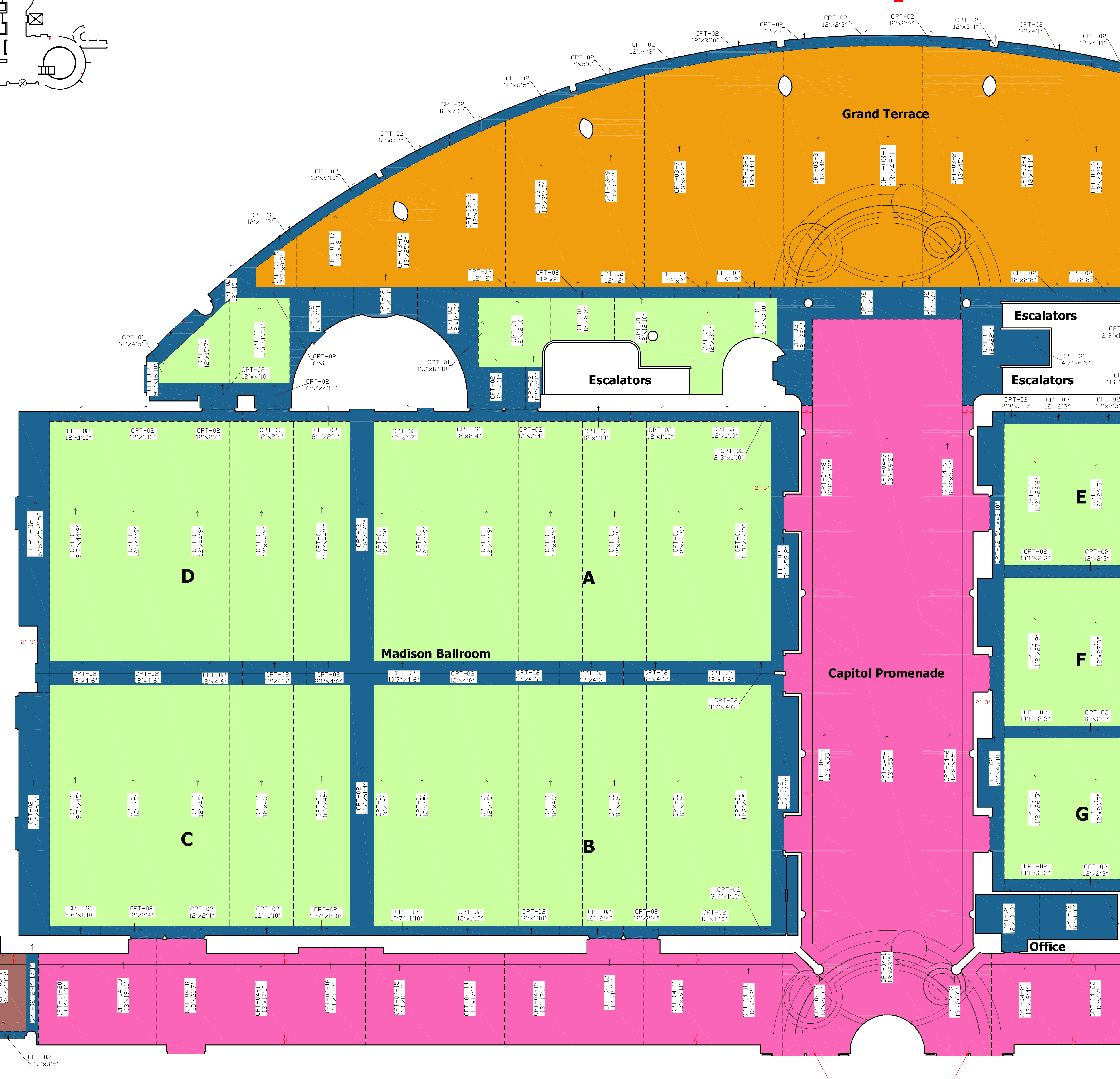

MATCH LINE

Notes:
Arrow → indicates carpet running direction.
This seaming diagram is to illustrate our recommendation on the installation of Tai Ping carpet based on the architectural plans provided by the customer which have been converted to an AutoCAD file to determine the best possible layout for your project. Dashed lines shown on the seaming diagram are used to indicate the known seam locations only; however, additional seams may be required during the installation of the carpet. Please note that by accepting this seaming diagram you are certifying your approval on the known seam locations and understand that, due to the custom manufacturing process, Tai Ping Carpets Americas, Inc. is unable to guarantee that additional seams which are currently not shown may be required to complete the installation.
Adjustment seaming may be necessary. The fabrication will date on job site. In order to prevent damage to seams and prevent the hazard of tripping, thresholds should be used in doorways to cover seams between carpets or other flooring with different heights. Measurements obtained during the site verification will be incorporated into a revised seaming diagram that will be provided to you. If the installation method chosen for this project is considered either full or partial electronic jacquard (EJ) the need for the site verification is heightened, as we will use the dimensions which are provided from the site verification to allow us to manufacture the carpet with the intent to have the material installed in a precise location within the property. The EJ production method allows us to produce flat or rose designs as one piece and allow for internal seams while achieving the desired design concept.
Carpet layout can vary due to unforeseen circumstances and a site verification may be necessary. Therefore, we recommend that you have your installer review the seaming diagram and provide you with the specific site verification details or we can provide the service to you for a fee. Please note that Tai Ping does not guarantee the information provided on the seaming diagram if an official site verification has not been completed by a representative of Tai Ping Carpets.
Carpet is a textile fabric subject to inevitable processing variations in the four pattern conditions: low skew/tilt, elongation/shrinkage and loss of edges. There are no industry standards for carpet pattern variations. It is highly recommended that installation is performed by an experienced familiar pattern carpet installer.
Prior to the production of the actual material the following approvals must be provided in addition to the seaming diagram: signed design renderings for all designs which will be used in your approval on scale, design intent, design repeat details, and color placement only; signed design layout, and signed fabric samples including all colors used which will be used as your approval on color only and will be sent to our factory for reference for color matching purposes.
Measurements shown on plan are not. However, pattern match is included in quantities on takeoffs to allow for shifting of the carpet to ensure side match.
Design borders, if applicable on this project, were not designed to make. Where such notes occur, Tai Ping cannot guarantee pattern match.
EJ INSTALLATIONS:
Before installing, all panels should be dry-laid to mix and accurate to the climate conditions. Due to possible shrinking and stretching of panels during the manufacturing process, stretching may be necessary to make a proper match. The longest panel should be installed first, then the short panels can be stretched to make a proper match.
EJ situations require Tai Ping to add additional amounts of carpet to the ends of each panel order to ensure adequate finishing lengths and allow for any shifting to ensure side matching between panels.
Measurements on plans noted by text will indicate the width of the area first and then the length of the area last.
Example: Width x Length: 12'0" is the width and 16' is the length.
Due to manufacturer roll lengths, possible head seams may be needed to complete installation for some areas.
All PDF prints are not to scale.

This drawing is the property of Tai Ping Carpets Americas.
Tai Ping Carpets Americas
715 Curtis Parkway, SE
Calhoun, GA 30701
Tel +1 706 625 8905
Tel +1 800 433 2440

PLANS APPROVED BY	
COMPANY	
DATE	
PROJECT NAME	
MONONA TERRACE CONVENTION CENTER	

PROJECT NO.	114939
DATE	5/28/13
DRAWN BY	BG
SCALE	1/8"=1'
SHEET	4/5
CPE NO.	12364

NO.	REVISED	DATE	BY
30	FIELD & BORDER	5/31/13	BG
40	1ST FLOOR	6/5/13	BG
50	DESIGNS	6/7/13	BG

4th Floor

Expansion Joint

ORDER OF INSTALL:
CAPITOL PROMENADE, GRAND
TERRACE AND PRE-FUNCTION
AREAS TO BE INSTALLED BEFORE
BALL ROOM AND MEETING ROOMS.

NOTE:
PANELS 7,8 AND 9 OF CPT-04
WERE MADE LONG TO BE BE
ADJUSTED ON SITE.

CARPET SCHEDULE				
CODE	DESIGN #	WIDTH	SIZE	DESCRIPTION
CPT-01	LX03850-15	12'	6'x2'7"	FIELD CARPET
CPT-02	BX04463-1	12'	N/A	BORDER CARPET
CPT-03	LX03850-20	4M	EJ	GRAND TERRACE FIELD
CPT-04	LX03850-21	4M	EJ	CAPITOL PROMENADE FIELD
CPT-05	FIELD LX03850-15 + BORDER BX04463-1	4M	EJ	PREFUNCTION FIELD
CPT-06	FIELD LX03850-15 + BORDER BX04463-1	4M	EJ	4TH FLOOR ENTRANCE FIELD
CPT-07	FIELD LX03850-15 + BORDER BX04463-1	4M	EJ	4TH FLOOR ENTRANCE FIELD
CPT-08	LX03850-22	4M	EJ	LECTURE HALL PREFUNCTION FIELD
CPT-09	FIELD LX03850-15 + BORDER BX04463-1	12'	EJ	HILTON SKYLINK CORRIDOR

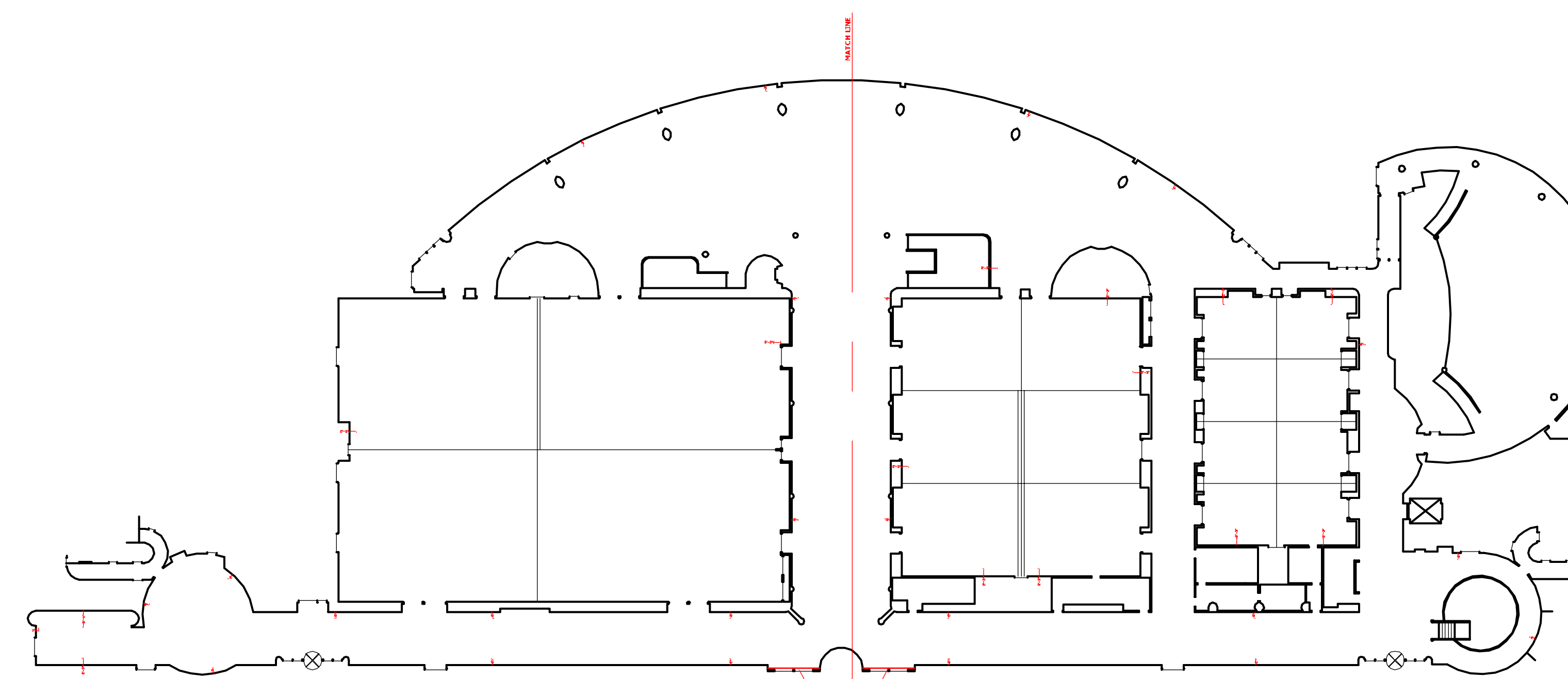

KEY PLAN

Notes:
Arrow → indicates carpet running direction.

The seaming diagram is to illustrate our recommendation on the installation of Tai Ping carpet based on the architectural plans provided by the customer which have been converted to an Auto Cad file to determine the best possible layout for your project. Dashed lines shown on the seaming diagram are used to indicate the known seaming locations only. However, additional seams may be required during the installation of the carpet. Please note that by accepting the seaming diagram you are certifying your approval on the known seaming locations indicated and understood that, due to the custom manufacturing process Tai Ping Carpets Americas, Inc. is unable to guarantee that additional seams which are currently not shown may be required to complete the installation. Adjustment seaming may be necessary. The installation will take place on job site. In order to prevent damage to seams and prevent the hazard of tripping, thresholds should be used in downways to cover seams between carpets or other floorings with different heights. Measurements obtained during the site verification will be incorporated into a revised seaming diagram that will be provided to you. If the installation method chosen for this project is considered either full or partial electronic (jagged EJ) the need for the site verification is heightened, as we will use the dimensions which are provided from the site verification to allow us to manufacture the carpet with the intent to have the material installed in a precise location within the property. The EJ production method allows us to produce full or close designs as one piece and allow for minimal seams while achieving the desired design concept. Carpet layouts can vary due to unforeseen circumstances and a site verification may be necessary. Therefore, we recommend that you have your installer review the seaming diagram and provide you with the specific site verification details or we can provide the service to you for a fee. Please note that Tai Ping does not guarantee the information provided on the seaming diagram if an official site verification has not been completed by a representative of Tai Ping Carpets.

NOTE:
CARPET DIRECTION TURNS
AT THIS POINT (*),
SLIGHT CHANGE IN NAP.

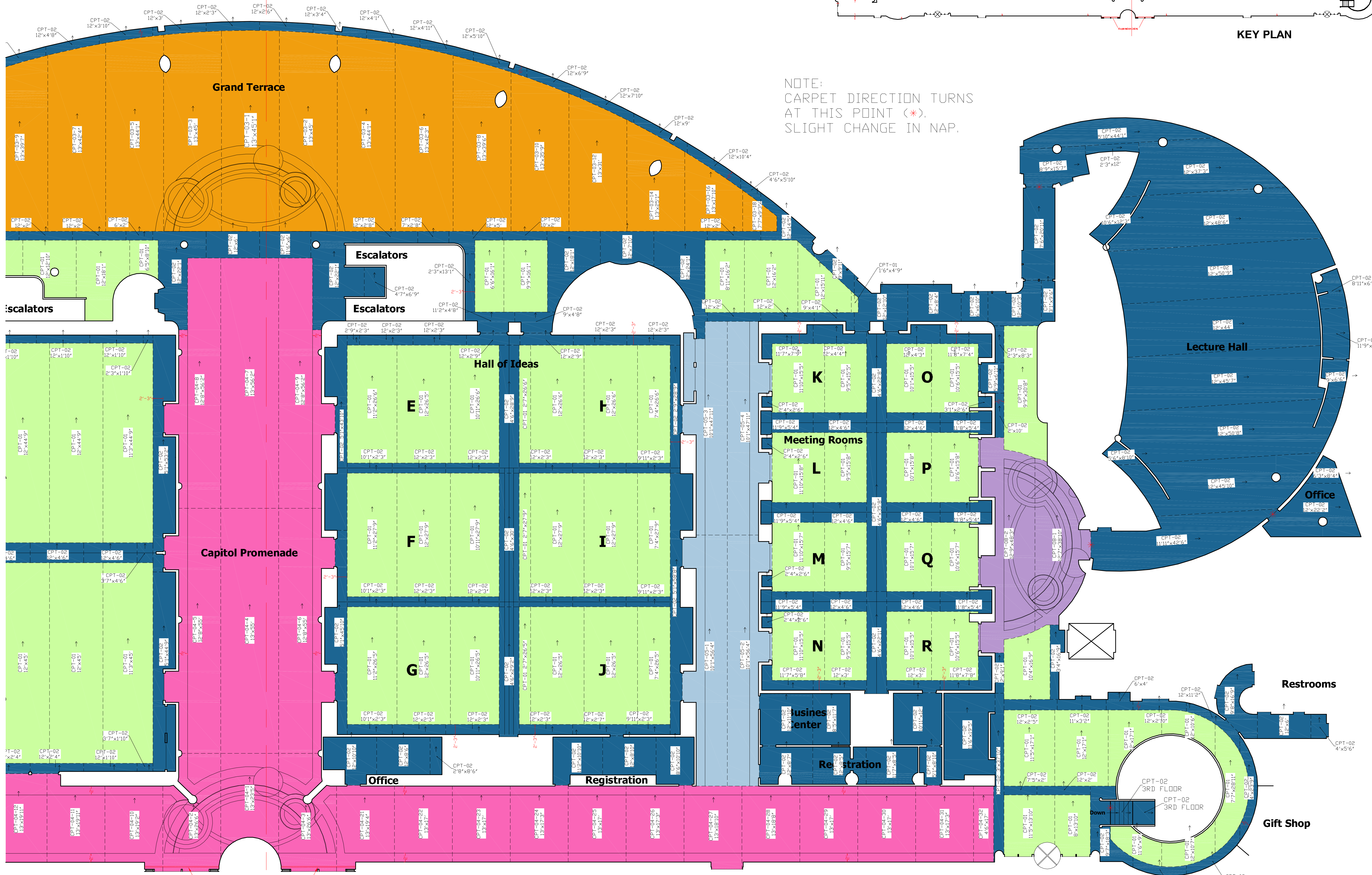

Carpet is a textile fabric subject to inevitable processing variations in the four pattern conditions: low skew/tilt, elongation/shrinkage and openness of edges. There are no industry standards for carpet pattern variations. It is highly recommended that installation is performed by an experienced familiar pattern carpet installer. Prior to the production of the actual material the following approvals must be provided in addition to the seaming diagram: signed design renderings for all designs which will be used as your approval on scale, design intent, design repeat details, and color placement only, signed design layout, and signed lobby completion including all colors used which will be used as your approval on color only and will be sent to our factory for reference for color matching including all colors used. Measurements shown on plan are not. However, pattern match is included in quantities on takeoffs to allow for shirring of the carpet to ensure side match. Design borders, if applicable on this project, were not designed to make. When such notes occur, Tai Ping cannot guarantee pattern match.

EJ INSTALLATIONS
Before installing, all panels should be displayed to mix and acclimate to the climate conditions. Due to possible shrinking and stretching of panels during the manufacturing process, stretching may be necessary to make a proper match. The longest panel should be installed first, then the short panels can be stretched to make a proper match. EJ situations require Tai Ping to add additional amounts of carpet to the ends of each panel in order to ensure adequate finishing lengths and allow for any shifting to ensure side matching between panels. Measurements on plans noted by text will indicate the width of the area first and then the length of the area last. Example: Width x Length: 12'x9' is the width and 16' is the length. Due to manufactured roll lengths, possible head seams may be needed to complete installation for some areas. All PDF prints are not to scale.

This drawing is the property of Tai Ping Carpets Americas.

Tai Ping Carpets Americas
715 Curtis Parkway, SE
Calhoun, GA 30701

Tel +1 706 625 8905
Tel +1 800 433 2440

PLANS APPROVED BY	
COMPANY	
DATE	

PROJECT NAME	MONONA TERRACE CONVENTION CENTER
--------------	---

PROJECT NO.	114939
DATE	5/28/13
DRAWN BY	BG
SCALE	1/8"=1'
SHEET	5/5
CPE NO.	12364

NO.	REVISED	DATE	BY
30	FIELD & BORDER	5/31/13	BG
40	1ST FLOOR	6/5/13	BG
50	DESIGNS	6/7/13	BG