

Madison, Wisconsin

# CITY OF MADISON

## CITY ENGINEERING DIVISION

### DEPARTMENT OF PUBLIC WORKS

# PLAN OF PROPOSED IMPROVEMENT

PUBLIC IMPROVEMENT PROJECT APPROVED

APRIL 4, 2014

BY THE COMMON COUNCIL OF MADISON, WISCONSIN

PUBLIC IMPROVEMENT DESIGN APPROVED BY:

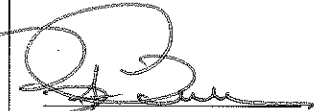
  
City Engineer  
5/27/14  
Date

#### INDEX OF SHEETS

SHEET NO.	TITLE
1	PROJECT LOCATION MAP
LM1	CHAMBERLAIN AVE
C1	CHAPEL HILL RD
CH1-CH2	JANA LN
J1-J4	NORTH ST
N1-N2	MILWAUKEE ST
M1	TODD DR
T1	WILLIAMSON ST
WI1-WI2	WRIGHT ST
WR1-WR4	

## LOCAL ROAD TRAFFIC CALMING & ARTERIAL PEDESTRIAN ENHANCEMENTS - 2014

CITY PROJECT NO. 53WI718

CITY CONTRACT NO. 7252

DESIGNED BY:

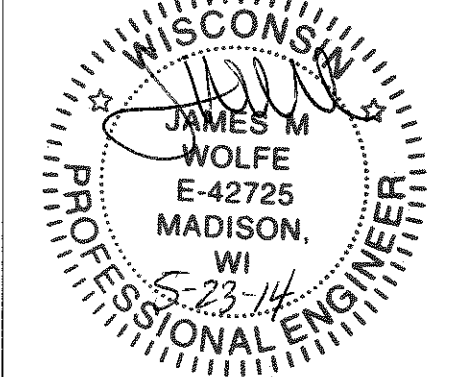

CONVENTIONAL SIGNS	
FIELD VERIFY ALL UTILITY LOCATIONS	
GAS	— G —
STORM SEWER	— ST —
SANITARY SEWER	— SAN —
WATER	— W —
OVERHEAD ELECTRIC	— OH —
POWER POLE	⊕
ADA COMPLIANT RAMP W/ DETECTABLE WARNING FIELD	
COMBUSTIBLE FLUIDS	

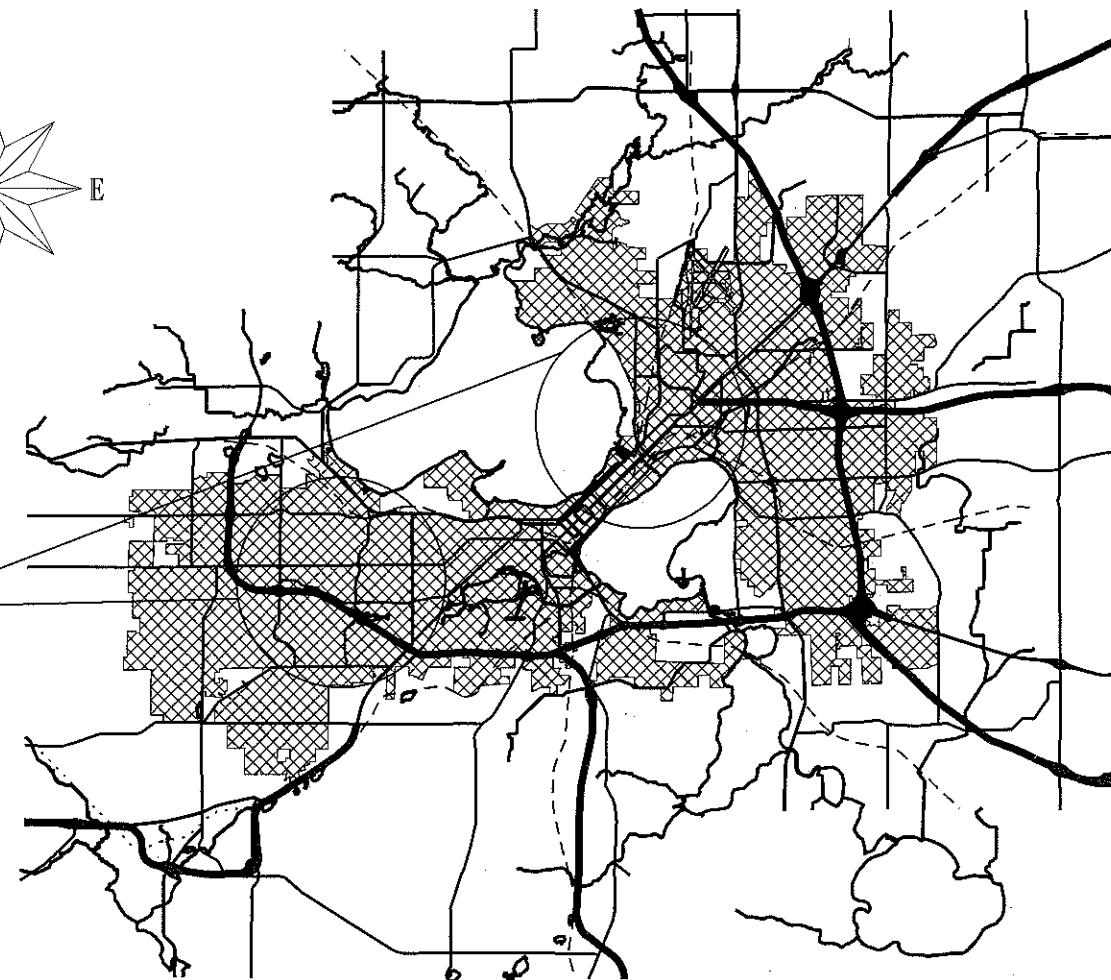
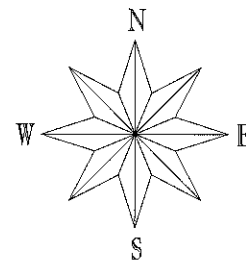

### CITY-WIDE PROJECT LOCATIONS

#### NOTES:

ALL GUTTERS SHALL DRAIN WITH A MINIMUM GRADE OF 0.50% TOWARD STORM SEWER INLETS.

SIDEWALK RAMPS AND CURB THRU SIDEWALK RAMPS SHALL HAVE A MAXIMUM SLOPE OF 1" PER 12". SIDEWALK AND CURB RAMPS SHALL BE CONSTRUCTED WITH A SIDE SLOPE OF 2.00%. SIDEWALK SHALL HAVE A MINIMUM LONGITUDINAL SLOPE OF 0.50% AND A MAXIMUM LONGITUDINAL SLOPE OF 5.00% EXCEPT WHERE STREET GRADES EXCEED 5.00%.

EARTH WORK SUMMARY:

EXCAVATION CUT (MEASURED PLAN QUANTITY).....	255 C.Y.
ESTIMATED UNDISTRIBUTED UNDERCUT.....	0 C.Y.
TOTAL UNCLASSIFIED EXCAVATION CUT.....	255 C.Y.

PLOT SCALE:

REV. DATE:

ORIGINATOR: CITY OF MADISON - STREETS DIVISION

PROJECT LOCATION MAP CITY OF MADISON

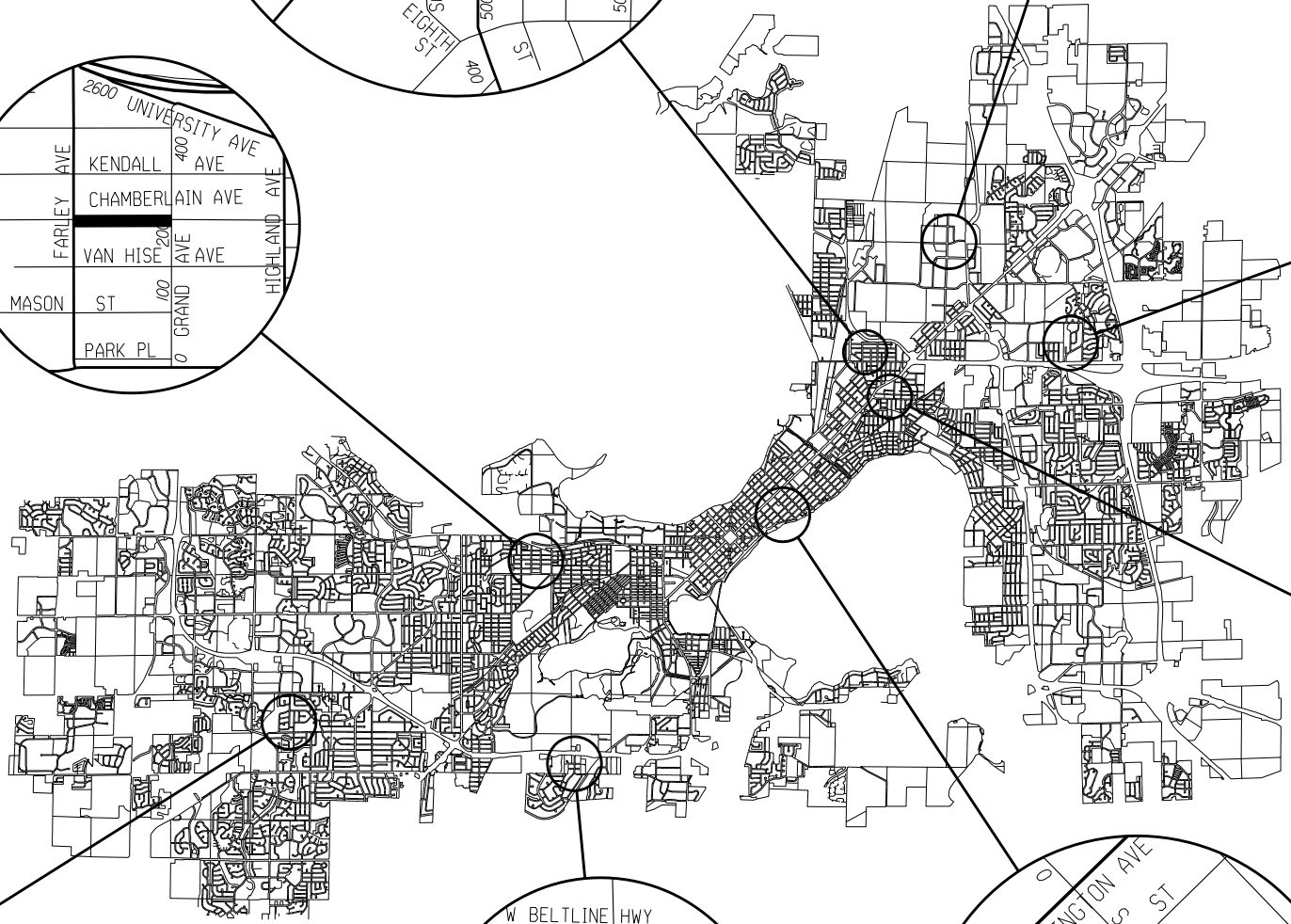
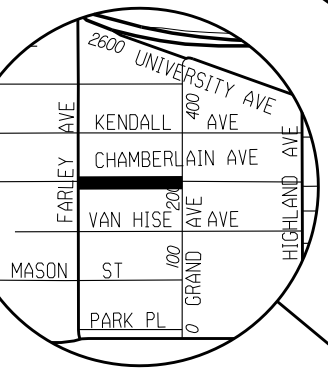
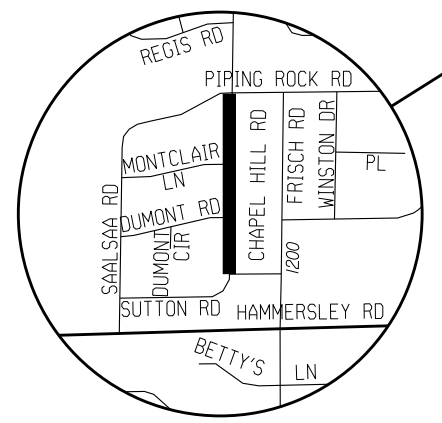
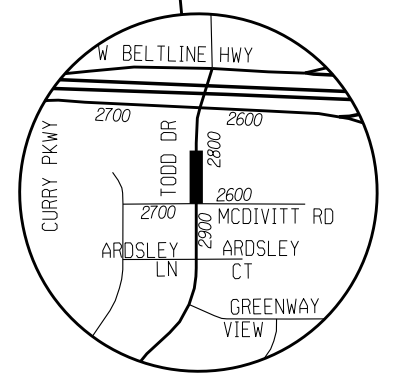
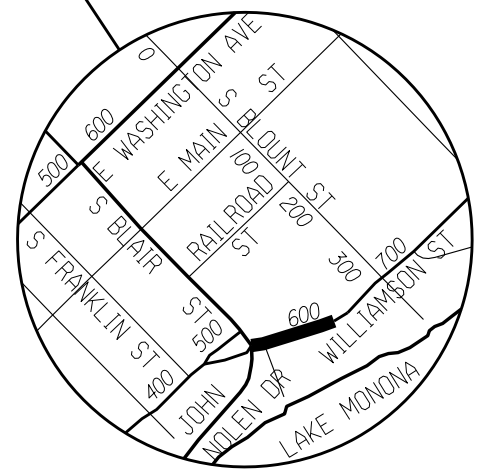
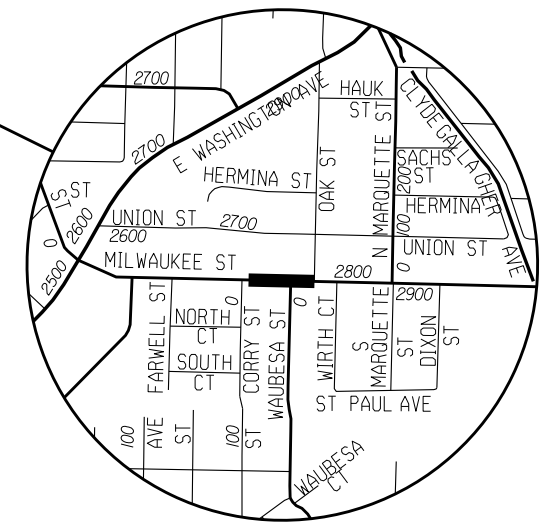
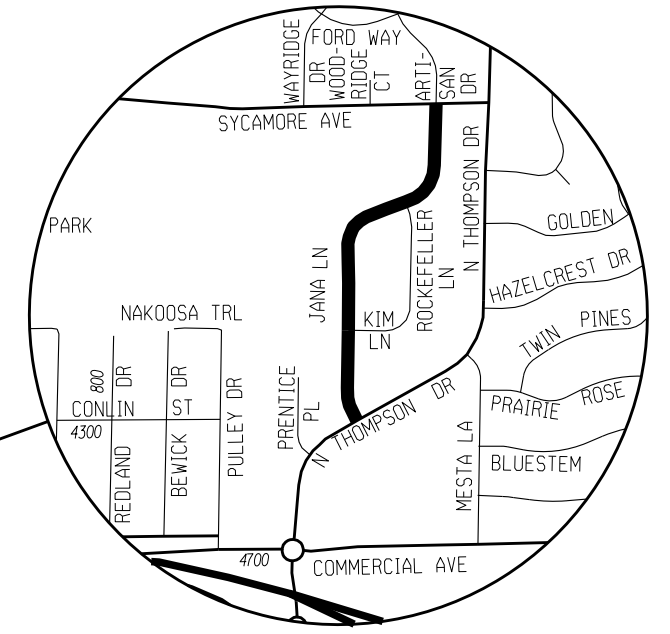
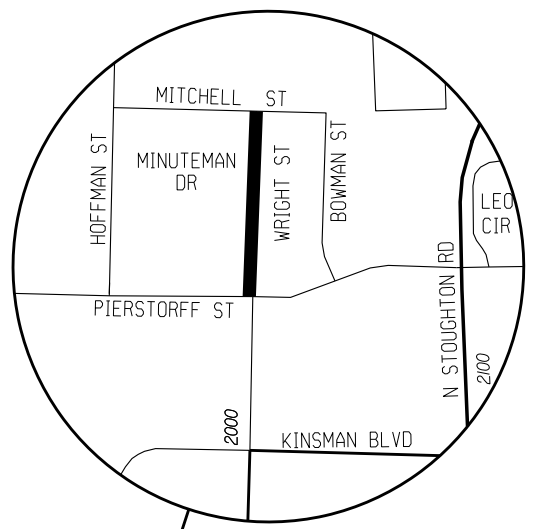
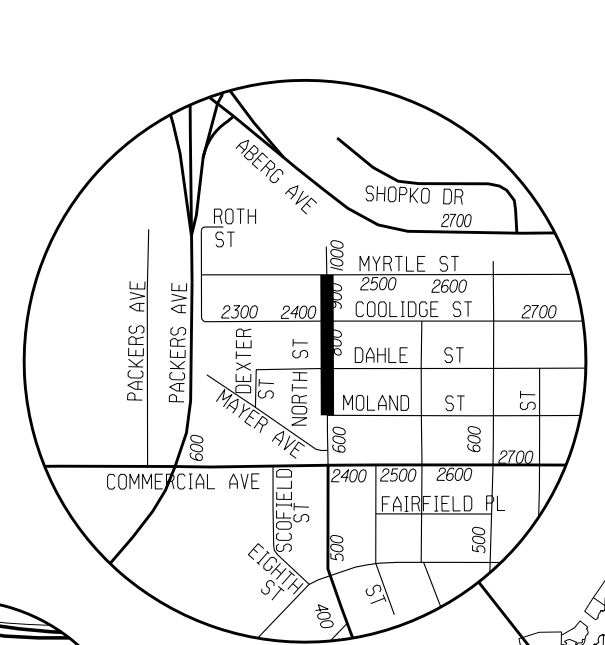
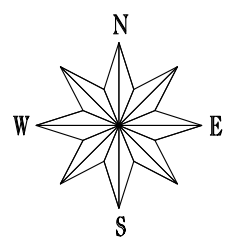

PLOT SCALE: \_\_\_\_\_  
PLOT NAME: \_\_\_\_\_  
REV. DATE: \_\_\_\_\_

ORIGINATOR: CITY OF MADISON, STREETS DIVISION

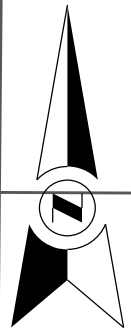

CENTER BETWEEN  
DRIVEWAYS

SPEED HUMP

NOTES:

- 1. SAWCUT EXISTING PAVEMENT AT EDGE OF PROPOSED SPEED HUMP
- 2. FINAL SPEED HUMP LOCATIONS TO BE MARKED IN THE FIELD BY TRAFFIC ENGINEERING
- 3. INSTALL SPEED HUMPS PER S.D.D. 4.10

2650

2646

2644

2640

2632

2630

2626

2622

2620

2610

2606

2602

2653

2641

2635

2633

2631

2629

2627

2623

2617

2615

2611

220

22'



FARLEY AVE

CHAMBERLAIN AVE

GRAND AVE

PLOT SCALE:

PLOT NAME:

REV. DATE:

ORIGINATOR: CITY OF MADISON, STREETS DIVISION

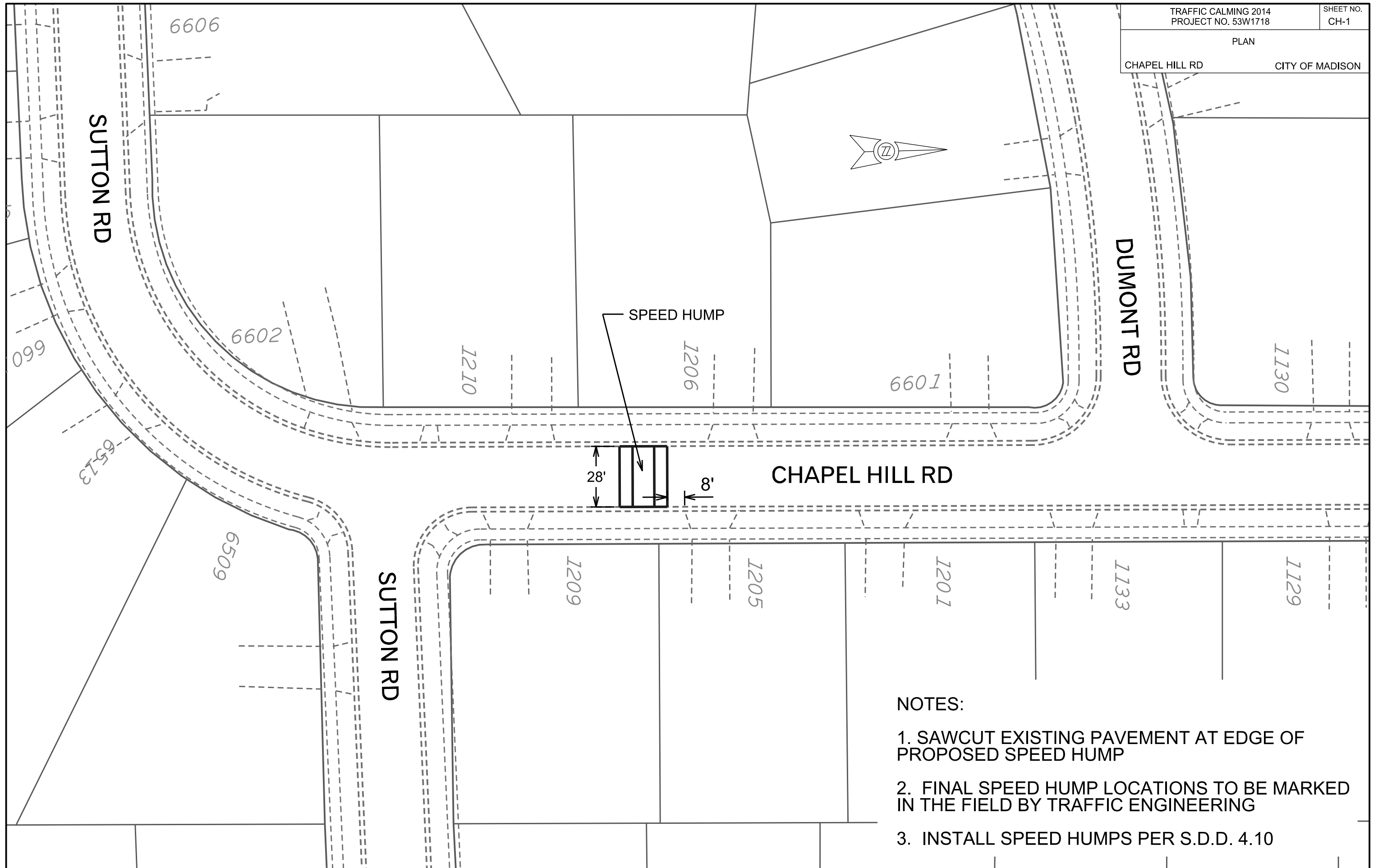

SPEED HUMPS

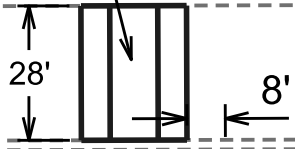

CHAPEL HILL RD

NOTES:

1. SAWCUT EXISTING PAVEMENT AT EDGE OF PROPOSED SPEED HUMPS
2. FINAL SPEED HUMPS LOCATIONS TO BE MARKED IN THE FIELD BY TRAFFIC ENGINEERING
3. INSTALL SPEED HUMPS PER S.D.D. 4.10

PLOT SCALE: \_\_\_\_\_

PLOT NAME: \_\_\_\_\_

REV. DATE: \_\_\_\_\_

ORIGINATOR: CITY OF MADISON, STREETS DIVISION

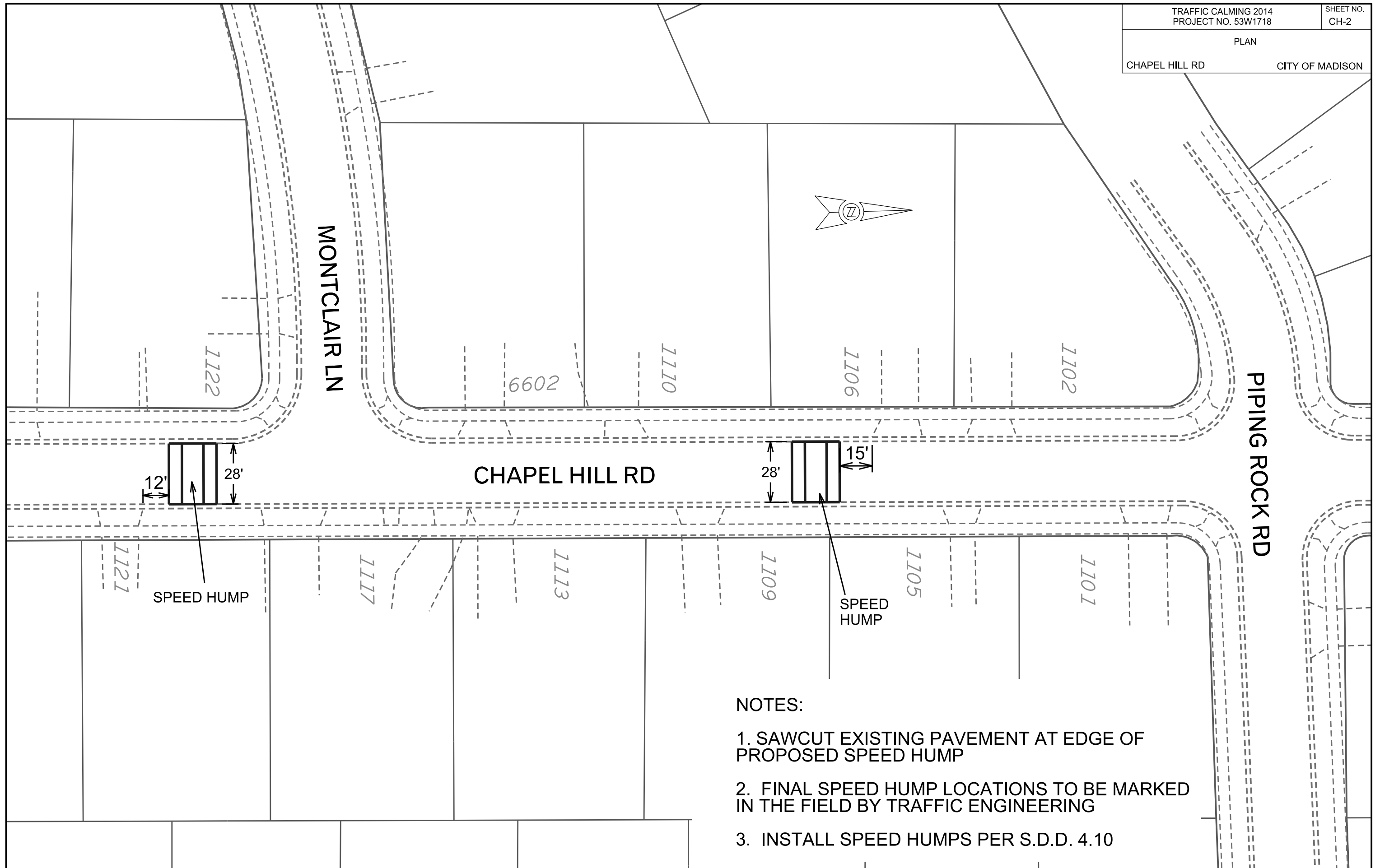

NOTES:

1. SAWCUT EXISTING PAVEMENT AT EDGE OF PROPOSED SPEED HUMPS
2. FINAL SPEED HUMP LOCATIONS TO BE MARKED IN THE FIELD BY TRAFFIC ENGINEERING
3. INSTALL SPEED HUMPS PER S.D.D. 4.10

PLOT SCALE: \_\_\_\_\_

PLOT NAME: \_\_\_\_\_

REV. DATE: \_\_\_\_\_

ORIGINATOR: CITY OF MADISON, STREETS DIVISION

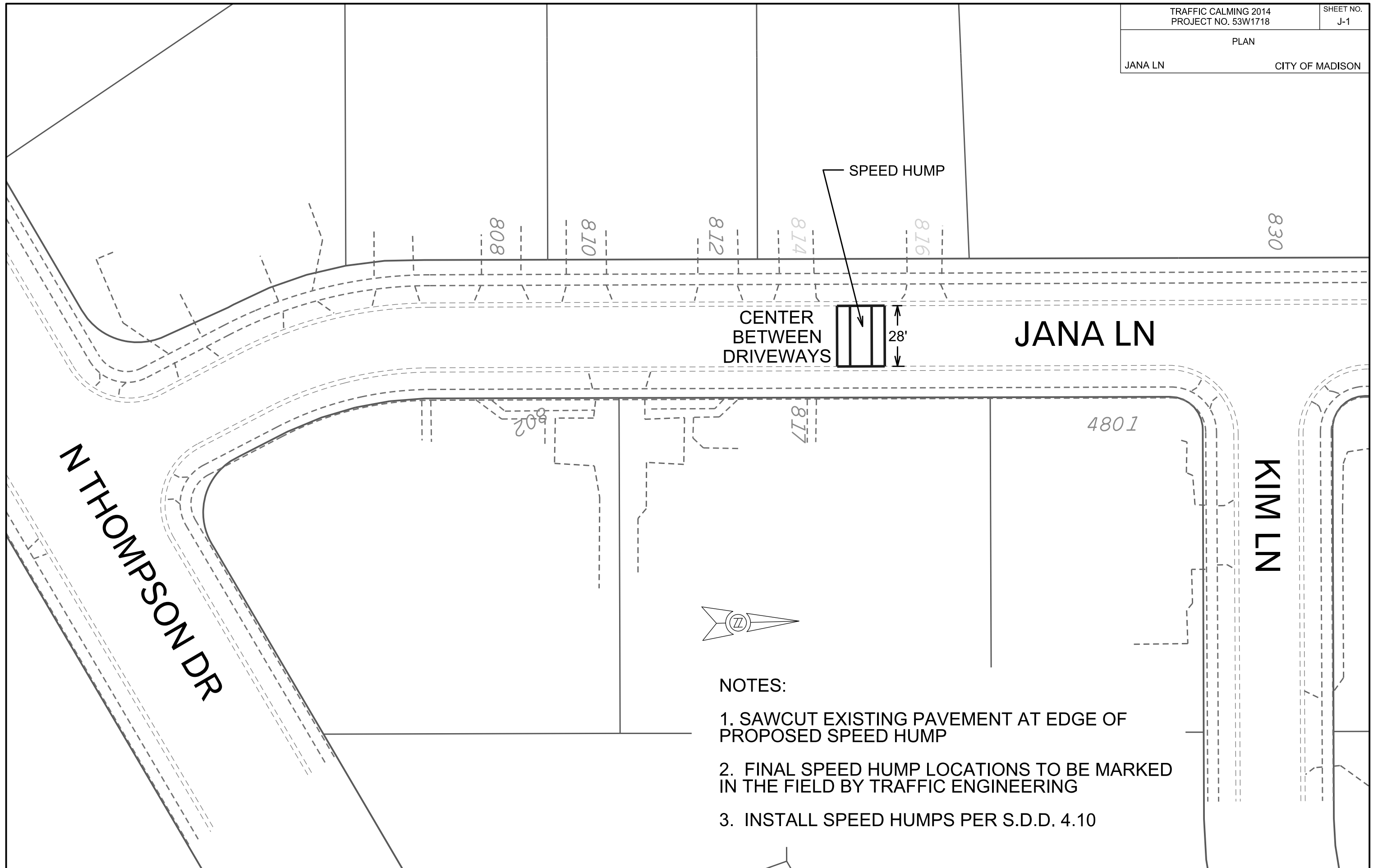

NOTES:

1. SAWCUT EXISTING PAVEMENT AT EDGE OF PROPOSED SPEED HUMPS
2. FINAL SPEED HUMP LOCATIONS TO BE MARKED IN THE FIELD BY TRAFFIC ENGINEERING
3. INSTALL SPEED HUMPS PER S.D.D. 4.10

PLOT SCALE: \_\_\_\_\_

PLOT NAME: \_\_\_\_\_

REV. DATE: \_\_\_\_\_

ORIGINATOR: CITY OF MADISON, STREETS DIVISION

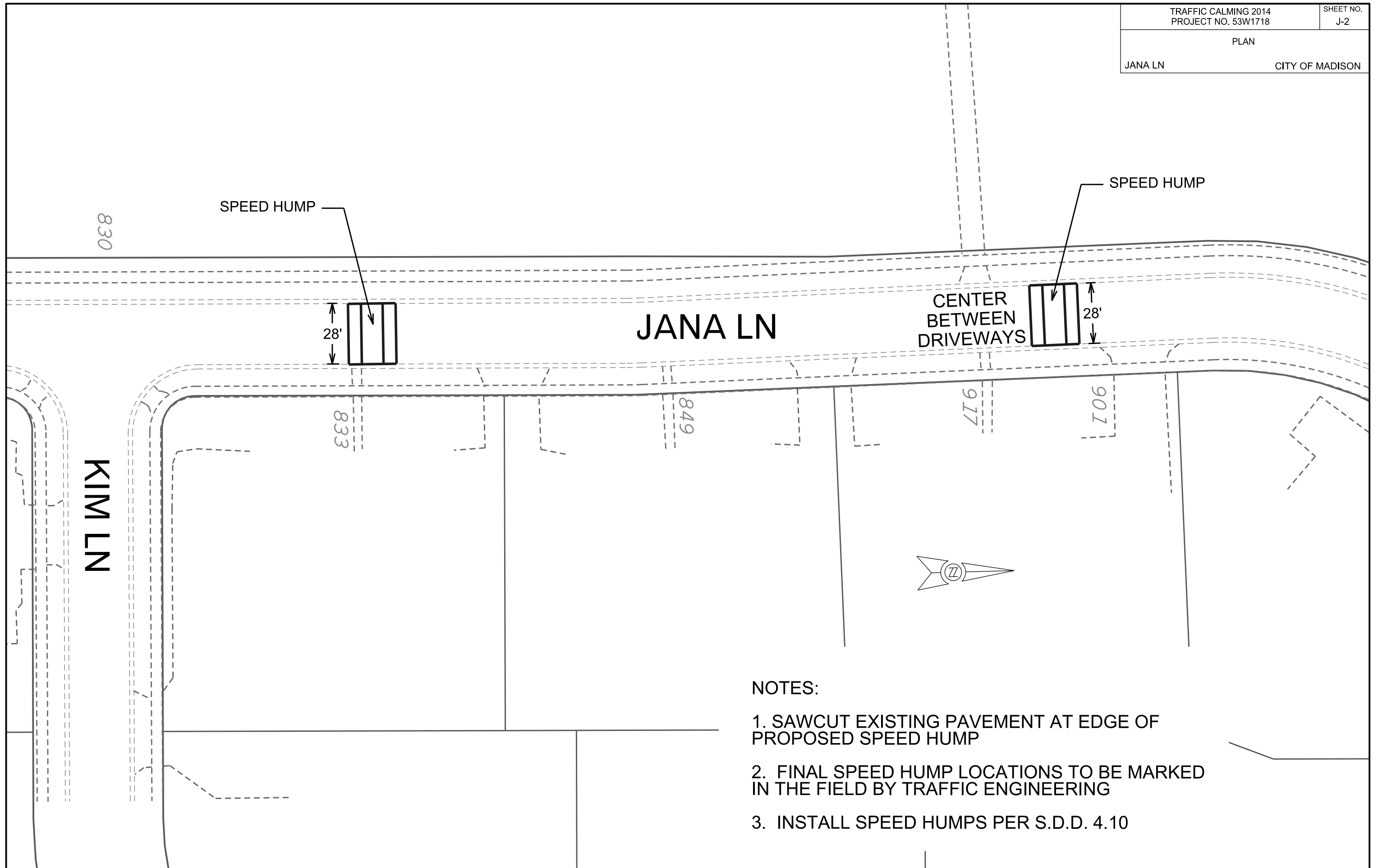

NOTES:

1. SAWCUT EXISTING PAVEMENT AT EDGE OF PROPOSED SPEED HUMP
2. FINAL SPEED HUMP LOCATIONS TO BE MARKED IN THE FIELD BY TRAFFIC ENGINEERING
3. INSTALL SPEED HUMPS PER S.D.D. 4.10

PLOT SCALE:

PLOT NAME:

REV. DATE:

ORIGINATOR: CITY OF MADISON, STREETS DIVISION

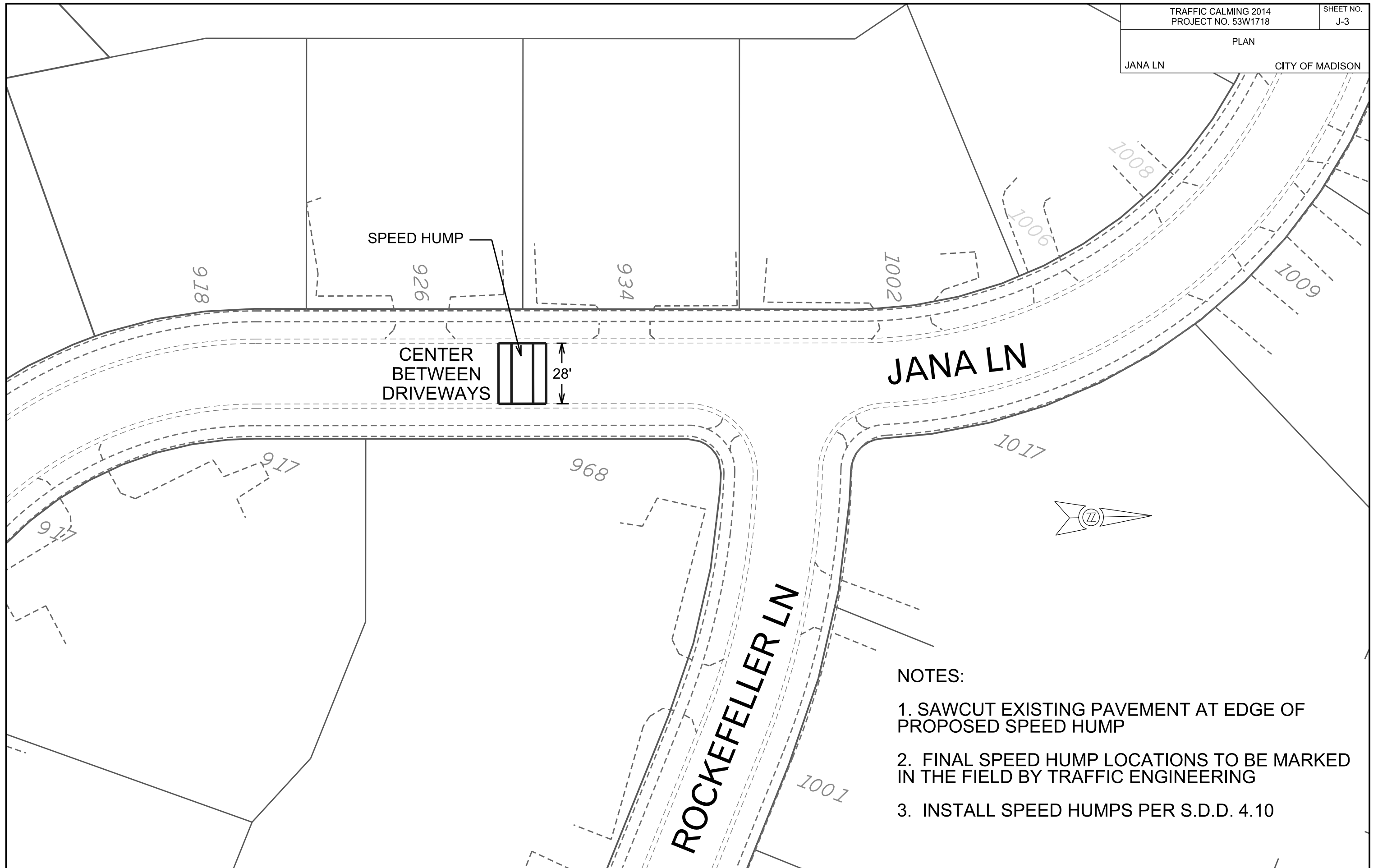

NOTES:

1. SAWCUT EXISTING PAVEMENT AT EDGE OF PROPOSED SPEED HUMP
2. FINAL SPEED HUMP LOCATIONS TO BE MARKED IN THE FIELD BY TRAFFIC ENGINEERING
3. INSTALL SPEED HUMPS PER S.D.D. 4.10

PLOT SCALE: \_\_\_\_\_

PLOT NAME: \_\_\_\_\_

REV. DATE: \_\_\_\_\_

ORIGINATOR: CITY OF MADISON, STREETS DIVISION



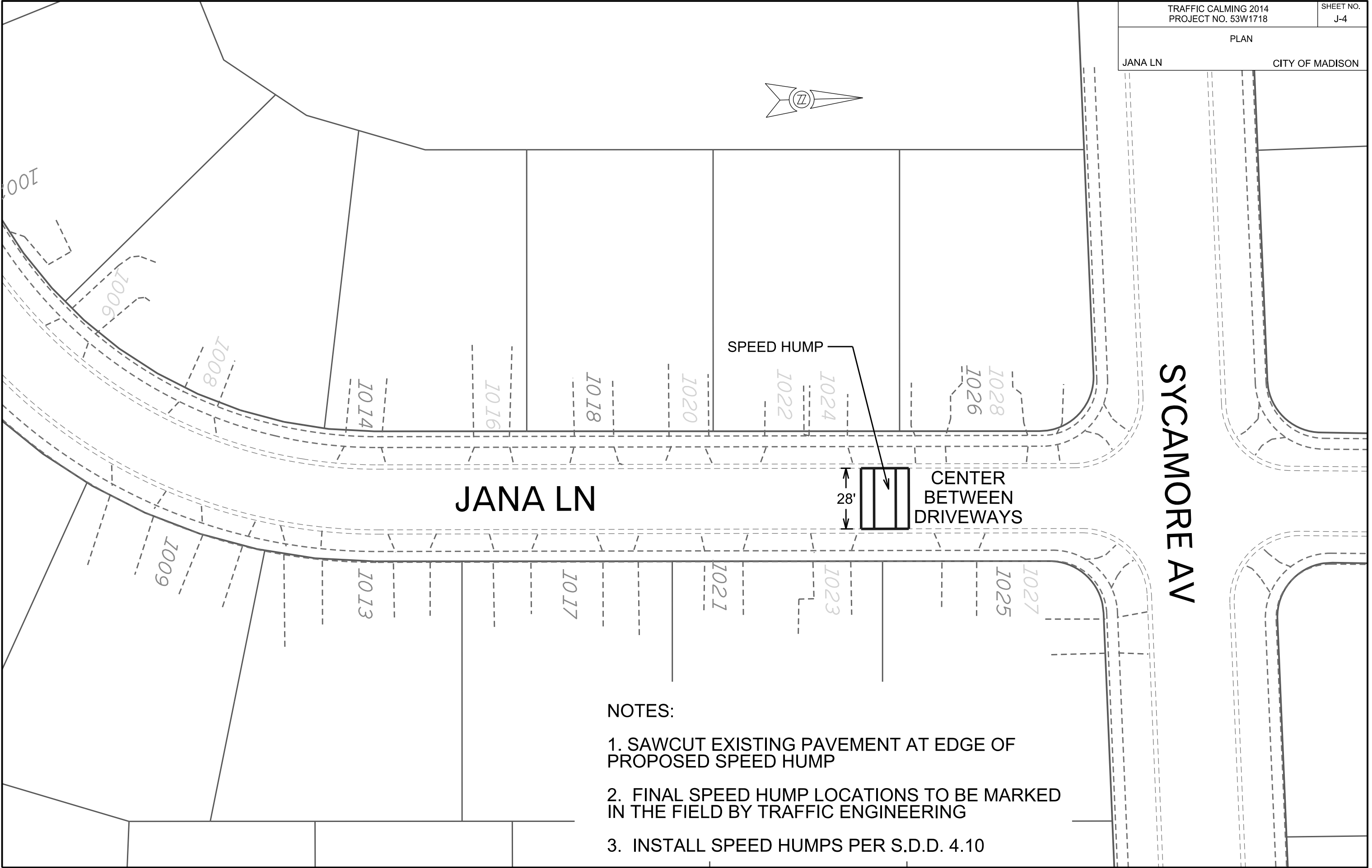
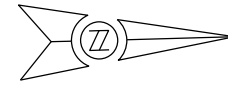

JANA LN

SYCAMORE AV

SPEED HUMP

28'

CENTER  
BETWEEN  
DRIVEWAYS

NOTES:

1. SAWCUT EXISTING PAVEMENT AT EDGE OF PROPOSED SPEED HUMP
2. FINAL SPEED HUMP LOCATIONS TO BE MARKED IN THE FIELD BY TRAFFIC ENGINEERING
3. INSTALL SPEED HUMPS PER S.D.D. 4.10

PLOT SCALE: \_\_\_\_\_

PLOT NAME: \_\_\_\_\_

REV. DATE: \_\_\_\_\_

ORIGINATOR: CITY OF MADISON, STREETS DIVISION

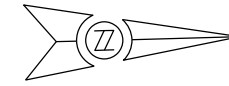

DAHLE ST

COOLIDGE ST

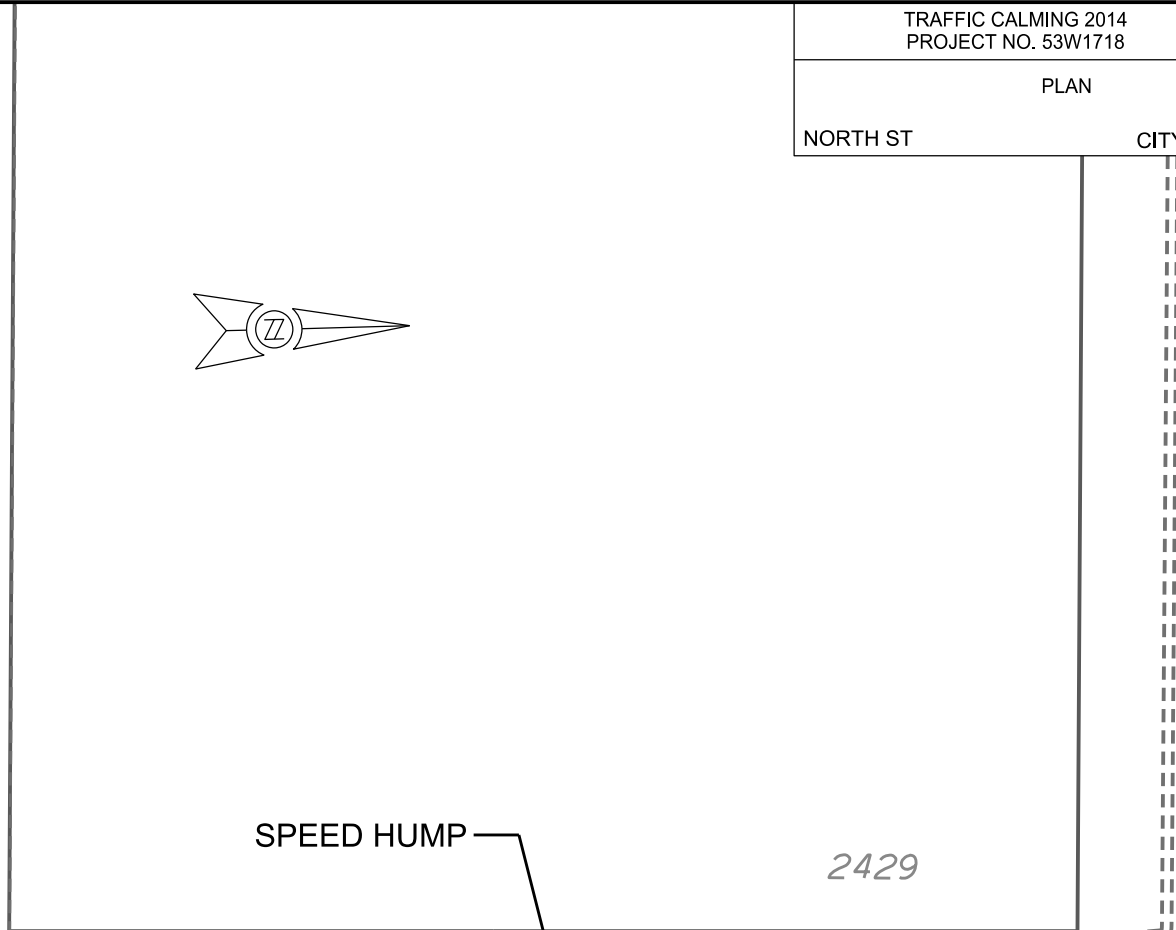
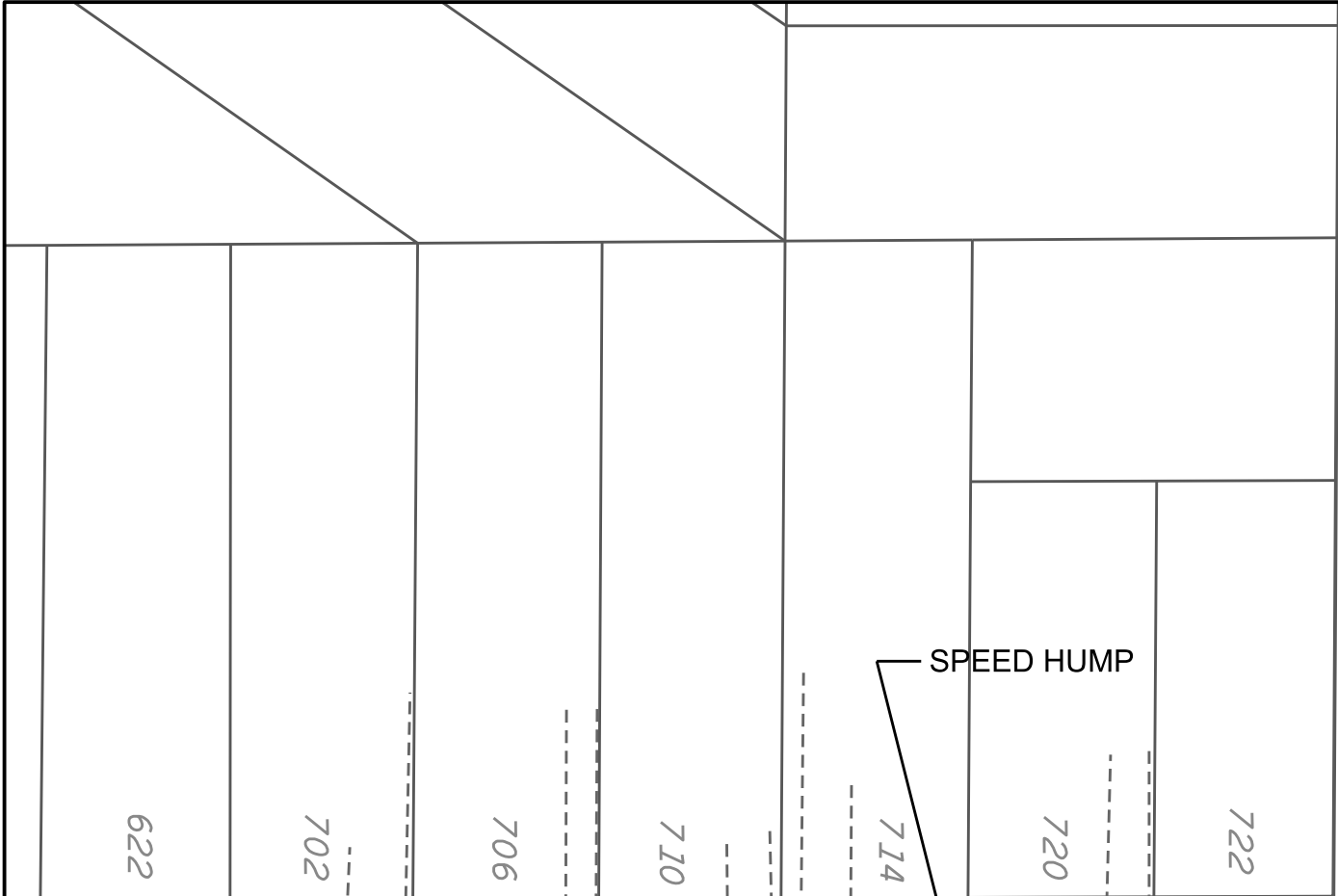

NORTH ST

NORTH ST

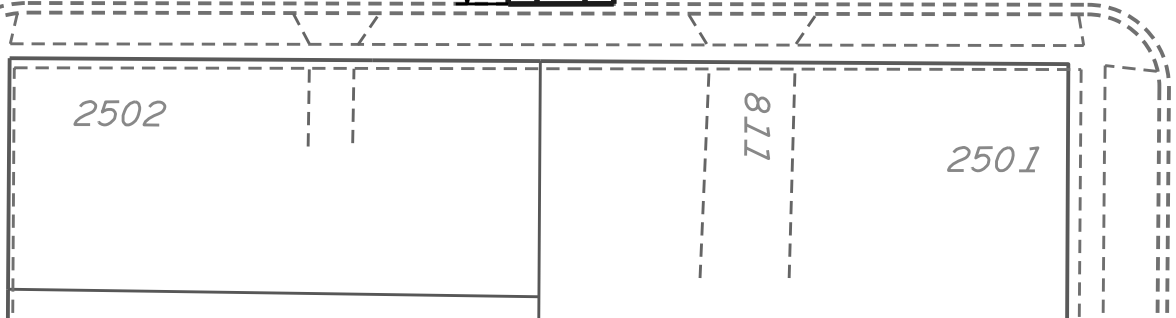
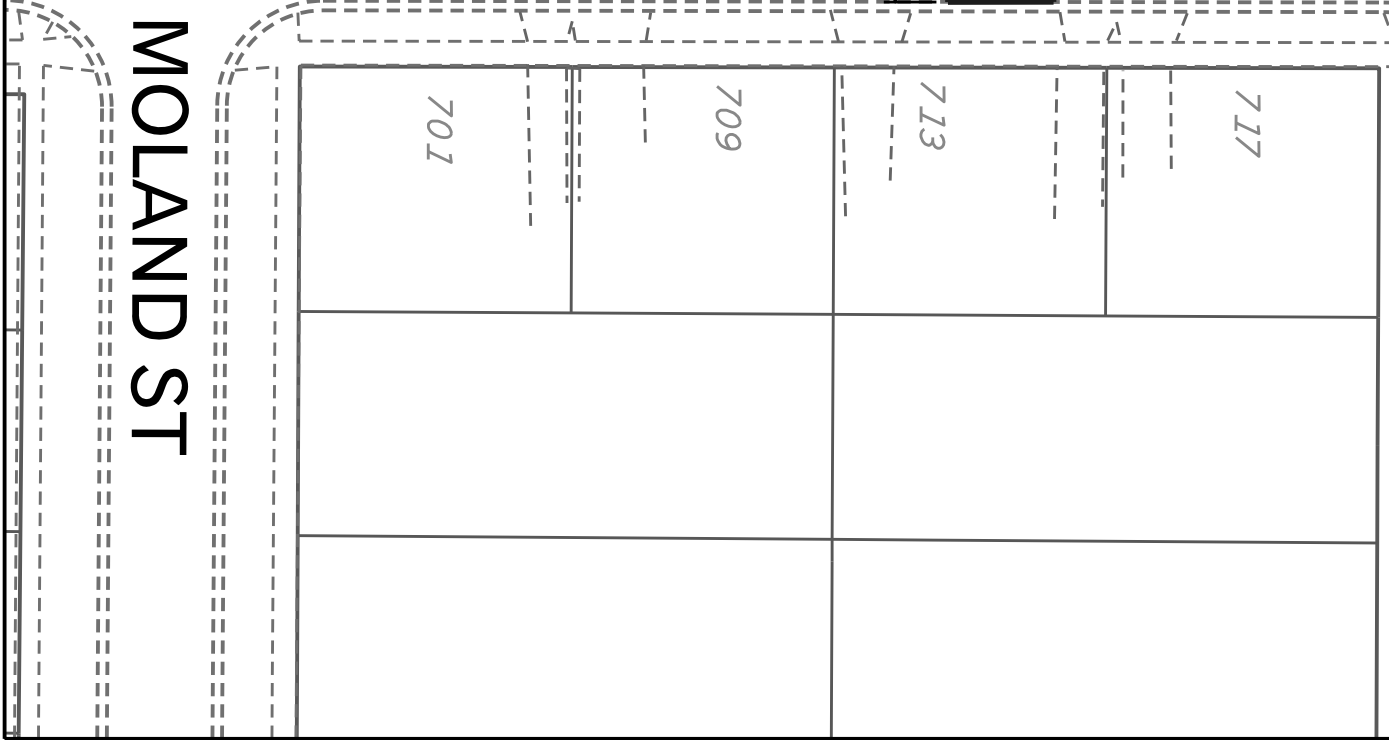
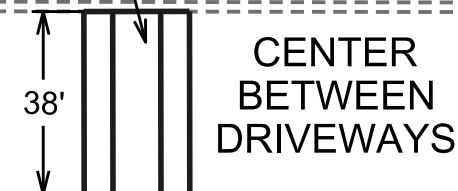
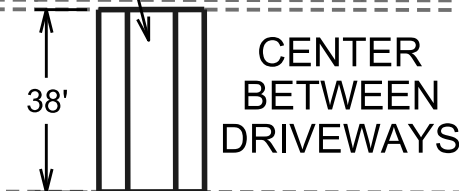

- NOTES:
1. SAWCUT EXISTING PAVEMENT AT EDGE OF PROPOSED SPEED HUMP
  2. FINAL SPEED HUMP LOCATIONS TO BE MARKED IN THE FIELD BY TRAFFIC ENGINEERING
  3. INSTALL SPEED HUMPS PER S.D.D. 4.10

PLOT SCALE: \_\_\_\_\_  
PLOT NAME: \_\_\_\_\_  
REV. DATE: \_\_\_\_\_  
ORIGINATOR: CITY OF MADISON, STREETS DIVISION

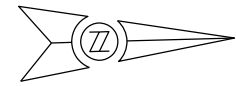

COOLIDGE ST

MYRTLE ST

NORTH ST

2417

2418

2421

2422

2425

2426

902

912

1002

SPEED HUMP

CENTER  
BETWEEN  
DRIVEWAYS

38'

2501

2502

913

1001

NOTES:

1. SAWCUT EXISTING PAVEMENT AT EDGE OF PROPOSED SPEED HUMP
2. FINAL SPEED HUMP LOCATIONS TO BE MARKED IN THE FIELD BY TRAFFIC ENGINEERING
3. INSTALL SPEED HUMPS PER S.D.D. 4.10

PLOT SCALE: \_\_\_\_\_

PLOT NAME: \_\_\_\_\_

REV. DATE: \_\_\_\_\_

ORIGINATOR: CITY OF MADISON, STREETS DIVISION

OAK ST

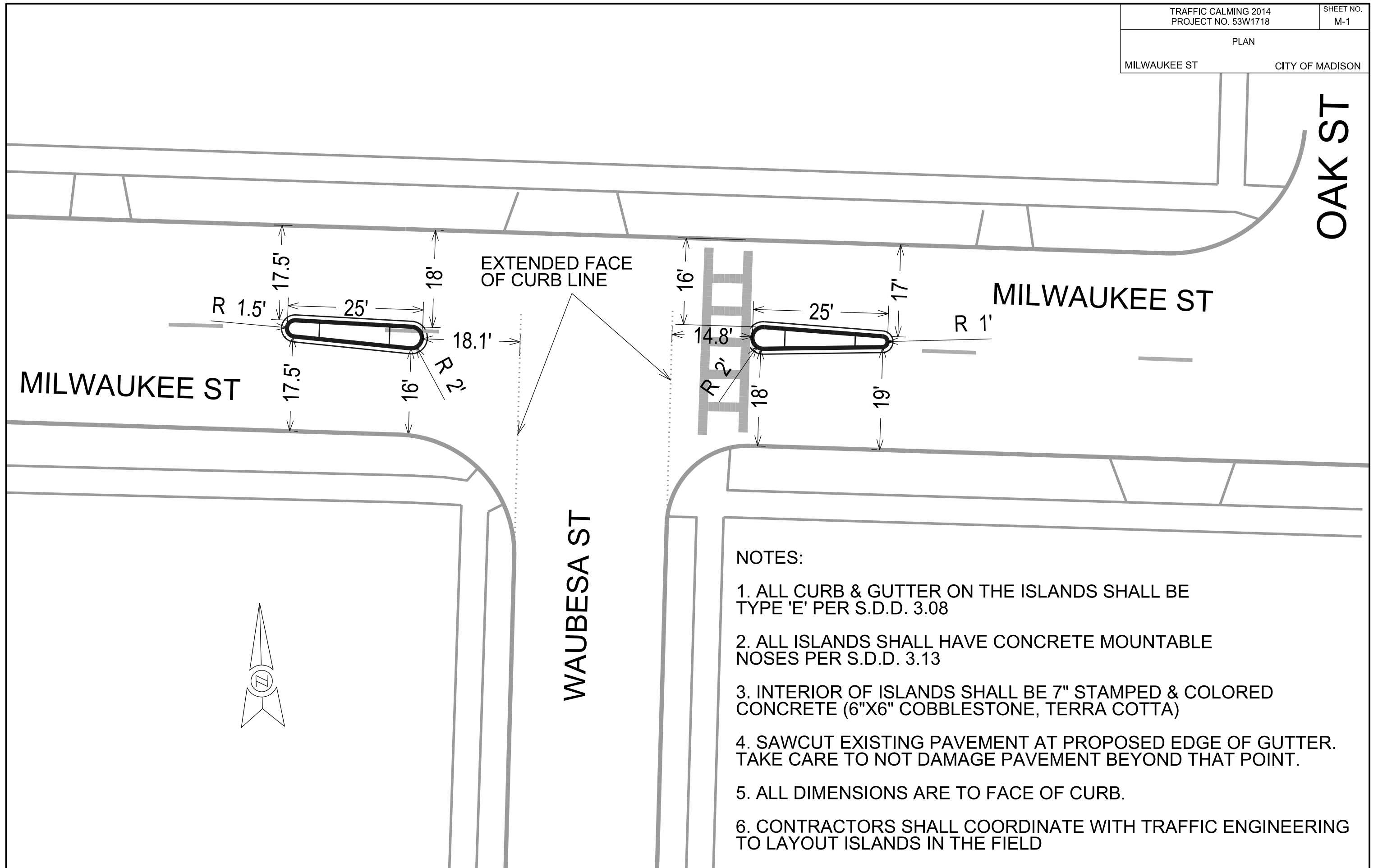

NOTES:

1. ALL CURB & GUTTER ON THE ISLANDS SHALL BE TYPE 'E' PER S.D.D. 3.08
2. ALL ISLANDS SHALL HAVE CONCRETE MOUNTABLE NOSES PER S.D.D. 3.13
3. INTERIOR OF ISLANDS SHALL BE 7" STAMPED & COLORED CONCRETE (6"X6" COBBLESTONE, TERRA COTTA)
4. SAWCUT EXISTING PAVEMENT AT PROPOSED EDGE OF GUTTER. TAKE CARE TO NOT DAMAGE PAVEMENT BEYOND THAT POINT.
5. ALL DIMENSIONS ARE TO FACE OF CURB.
6. CONTRACTORS SHALL COORDINATE WITH TRAFFIC ENGINEERING TO LAYOUT ISLANDS IN THE FIELD



PLOT SCALE: \_\_\_\_\_

PLOT NAME: \_\_\_\_\_

REV. DATE: \_\_\_\_\_

ORIGINATOR: CITY OF MADISON, STREETS DIVISION

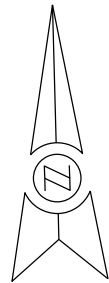

TODD DR

NOTES:

1. ALL CURB & GUTTER ON THE ISLANDS SHALL BE TYPE 'E' PER S.D.D. 3.08
2. ALL ISLANDS SHALL HAVE CONCRETE MOUNTABLE NOSES PER S.D.D. 3.13
3. INTERIOR OF ISLANDS SHALL BE 7" STAMPED & COLORED CONCRETE (6"X6" COBBLESTONE, TERRA COTTA)
4. SAWCUT EXISTING PAVEMENT AT PROPOSED EDGE OF GUTTER. TAKE CARE TO NOT DAMAGE PAVEMENT BEYOND THAT POINT.
5. ALL DIMENSIONS ARE TO FACE OF CURB.
6. CONTRACTORS SHALL COORDINATE WITH TRAFFIC ENGINEERING TO LAYOUT ISLANDS IN THE FIELD

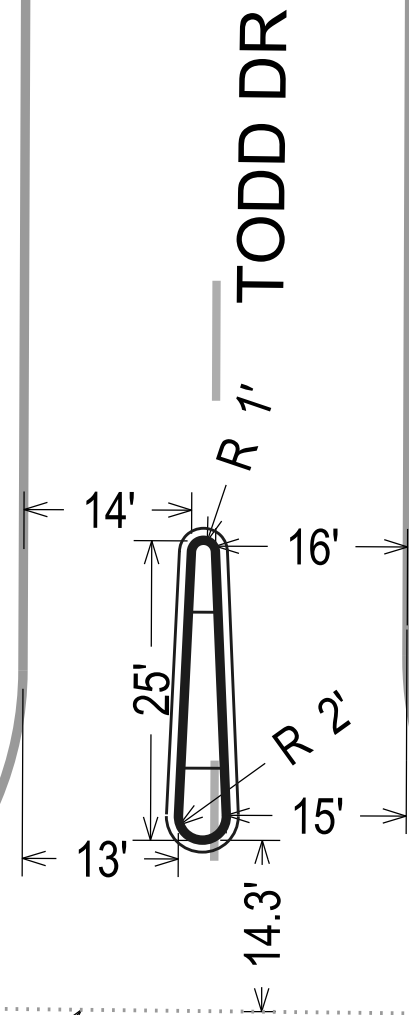

EXTENDED FACE OF CURB LINE

MCDIVITT RD

PLOT SCALE: \_\_\_\_\_

PLOT NAME: \_\_\_\_\_

REV. DATE: \_\_\_\_\_

ORIGINATOR: CITY OF MADISON, STREETS DIVISION

NOTES:

- 1) ALL DIMENSIONS ARE TO FACE OF CURB OR FRONT FACE OF WALL
- 2) COORDINATE ALL WORK WITH MG&E
- 3) FOUNDATION & SCULPTURE CONSTRUCTED BY OTHERS
- 4) FORMLINER AND CONCRETE STAIN COLOR TO MATCH BASE STONE OF MACHINERY ROW BUILDING (601-627 WILLIAMSON ST)

PLOT SCALE:

PLOT NAME:

REV. DATE:

ORIGINATOR: CITY OF MADISON, STREETS DIVISION

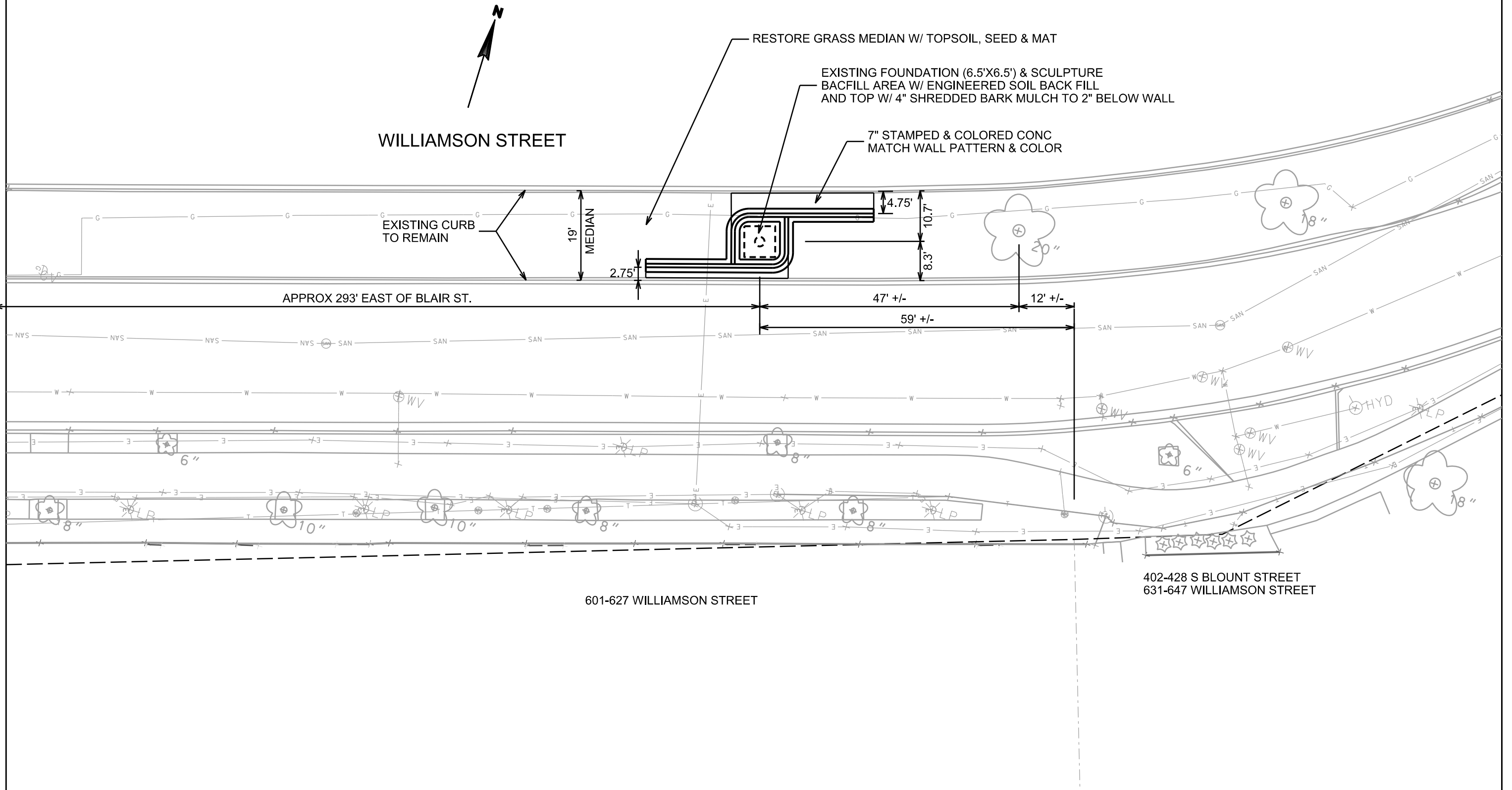

**WALL PLAN**  
NOT TO SCALE

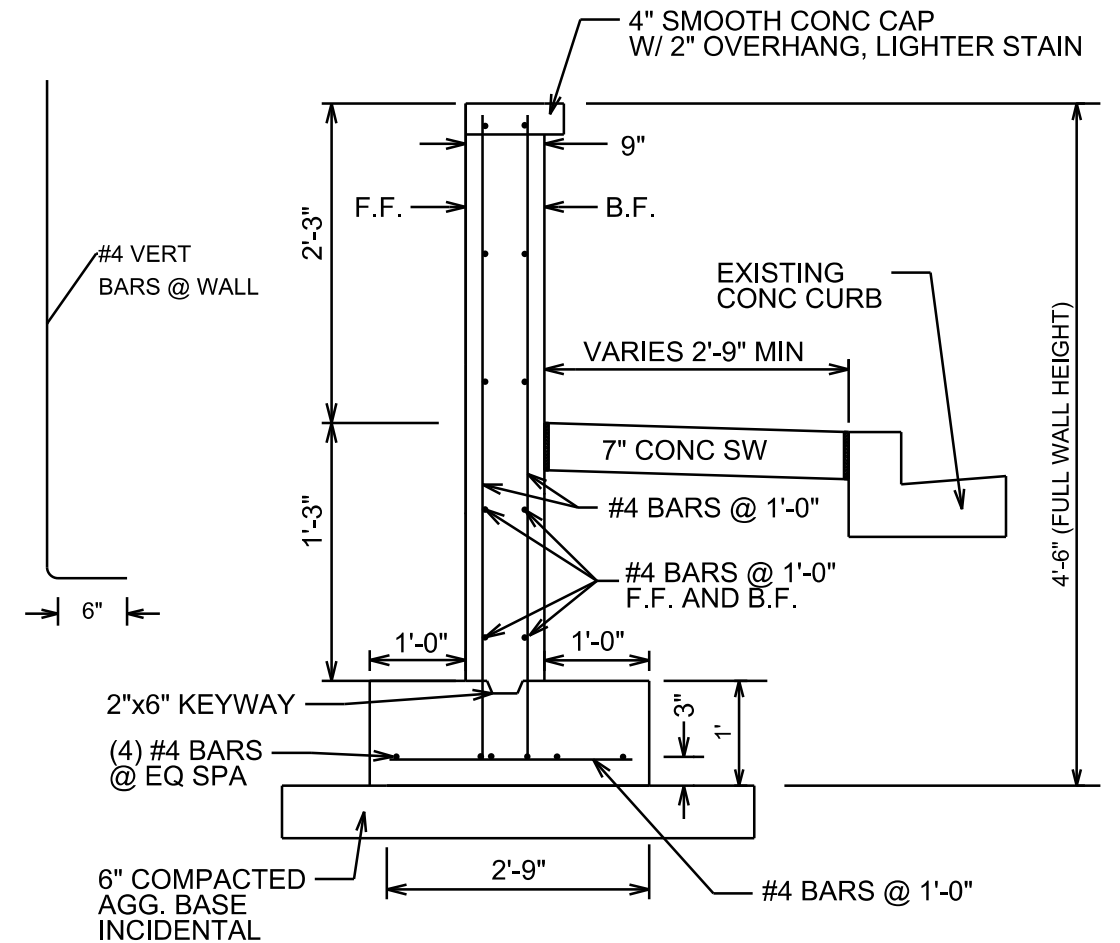
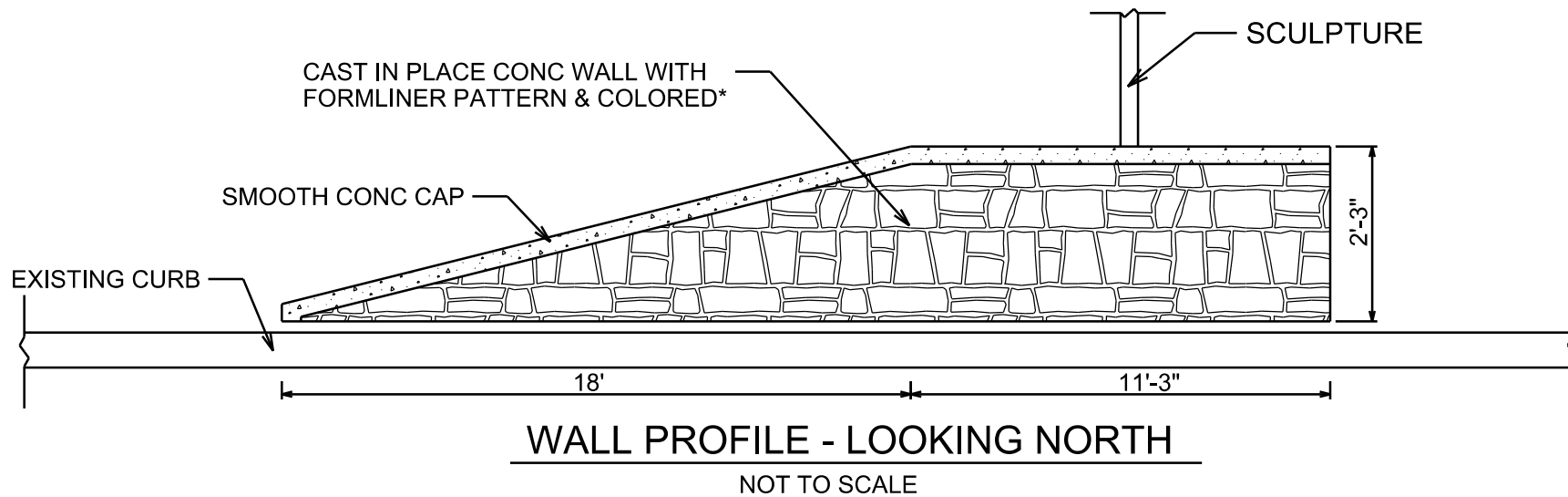
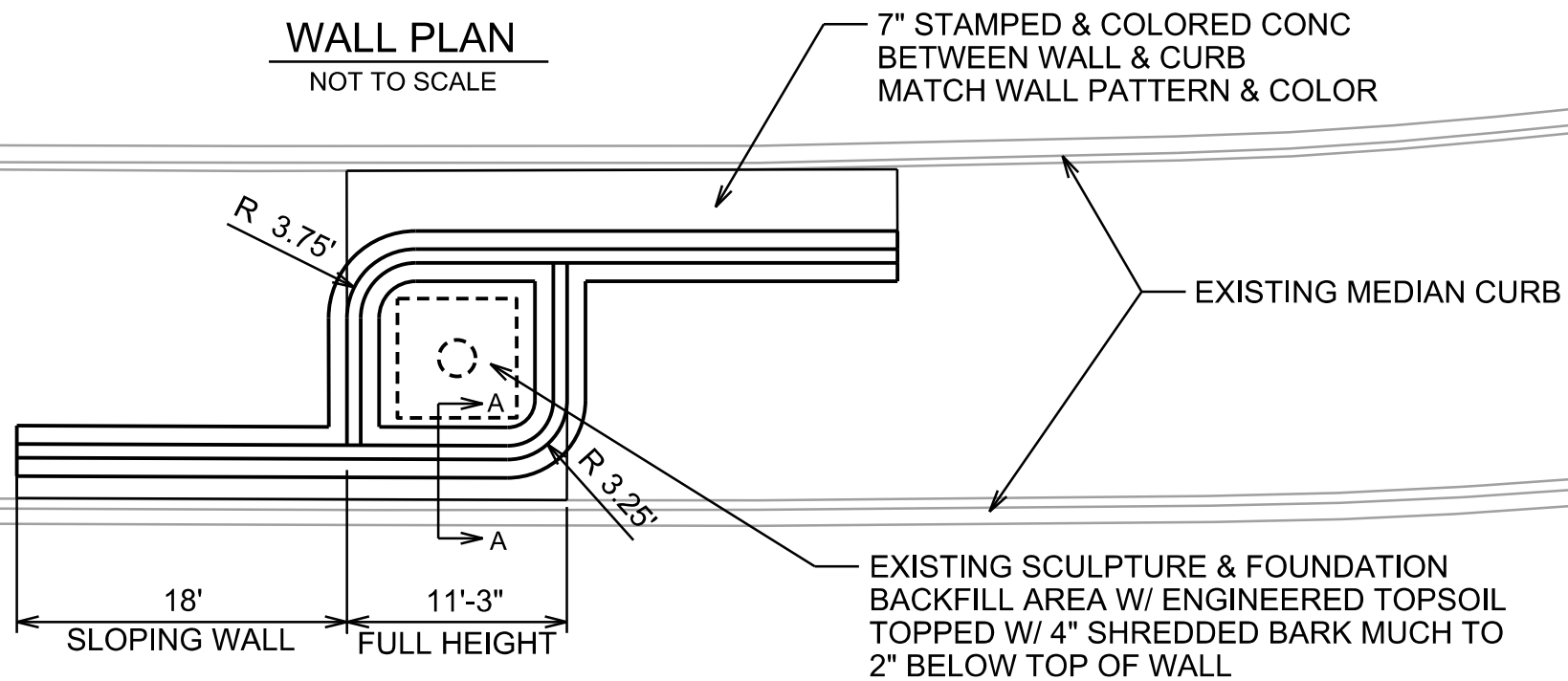

**SECTION A-A**

\* PATTERN SHOWN ON THIS SHEET IS NOT REPRESENTATIVE OF PATTERN THAT IS TO BE INSTALLED. REFER TO SPECIFICATIONS FOR PATTERN DETAILS

NOTES:

1. CONCRETE COMPRESSIVE STRENGTH = 3500 PSI  
REINFORCING STEEL YIELD STRENGTH = 60,000 PSI
2. MAINTAIN 3" CLEAR, MINIMUM
3. ALL STEEL BARS SHALL BE EPOXY COATED
4. INSTALL 1" WEEP HOLES IN FULL HEIGHT PORTION, SPACED APPROXIMATELY 3'-6"
5. INSTALL GEOTEXTILE FABRIC ON INTERIOR PORTION OF WALL (BY SCULPTURE) TO WITHIN 6" OF THE TOP OF WALL.
6. PROVIDE EXPANSION JOINTS BETWEEN CONC SIDEWALK & WALL AND SIDEWALK & CURB

PLOT SCALE: \_\_\_\_\_

PLOT NAME: \_\_\_\_\_

REV. DATE: \_\_\_\_\_

ORIGINATOR: CITY OF MADISON, STREETS DIVISION

PLAN AND PROFILE  
WRIGHT ST SIDEWALK CITY OF MADISON

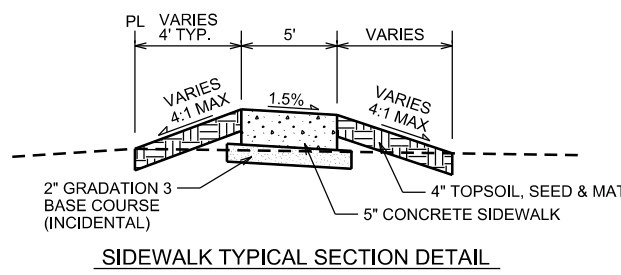
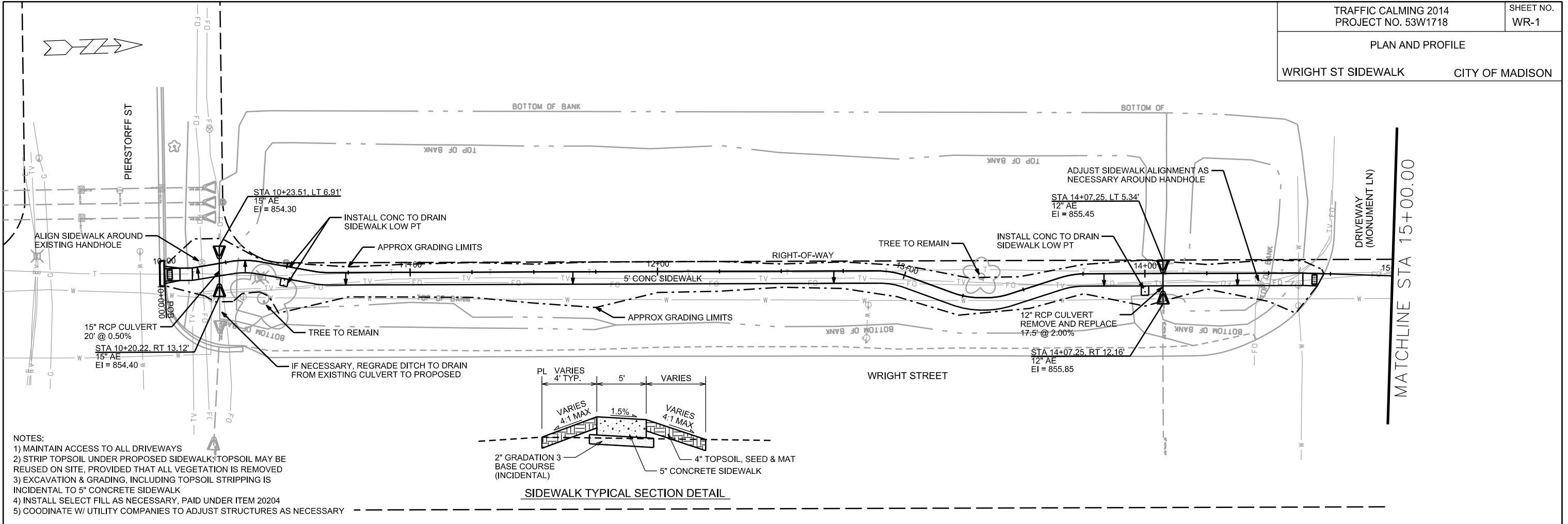

- NOTES:
- 1) MAINTAIN ACCESS TO ALL DRIVEWAYS
  - 2) STRIP TOPSOIL UNDER PROPOSED SIDEWALK; TOPSOIL MAY BE REUSED ON SITE, PROVIDED THAT ALL VEGETATION IS REMOVED
  - 3) EXCAVATION & GRADING, INCLUDING TOPSOIL STRIPPING IS INCIDENTAL TO 5" CONCRETE SIDEWALK
  - 4) INSTALL SELECT FILL AS NECESSARY, PAID UNDER ITEM 20204
  - 5) COORDINATE W/ UTILITY COMPANIES TO ADJUST STRUCTURES AS NECESSARY

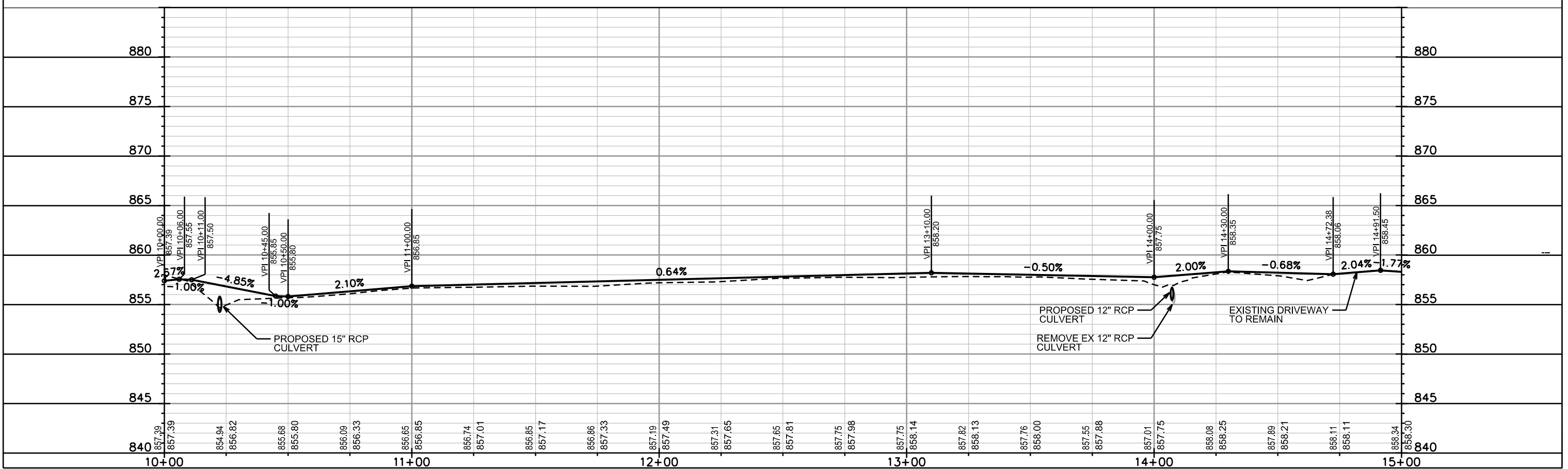

PLOT SCALE: \_\_\_\_\_

PLOT NAME: \_\_\_\_\_

REV. DATE: \_\_\_\_\_

ORIGINATOR: CITY OF MADISON, STREETS DIVISION



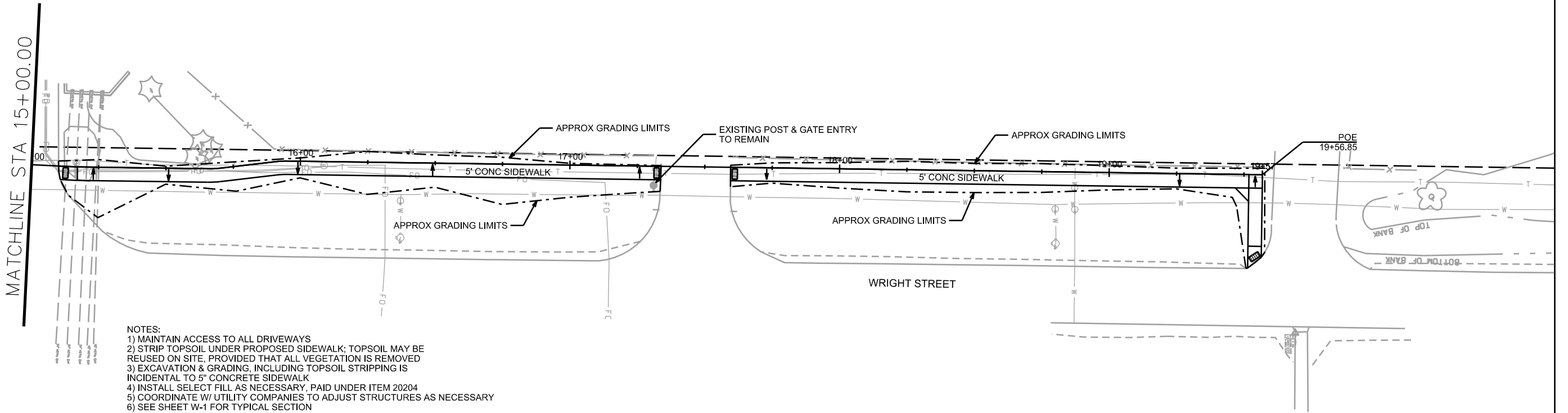

- NOTES:  
 1) MAINTAIN ACCESS TO ALL DRIVEWAYS  
 2) STRIP TOPSOIL UNDER PROPOSED SIDEWALK; TOPSOIL MAY BE REUSED ON SITE, PROVIDED THAT ALL VEGETATION IS REMOVED  
 3) EXCAVATION & GRADING, INCLUDING TOPSOIL STRIPPING IS INCIDENTAL TO 5" CONCRETE SIDEWALK  
 4) INSTALL SELECT FILL AS NECESSARY, PAID UNDER ITEM 20204  
 5) COORDINATE W/ UTILITY COMPANIES TO ADJUST STRUCTURES AS NECESSARY  
 6) SEE SHEET W-1 FOR TYPICAL SECTION

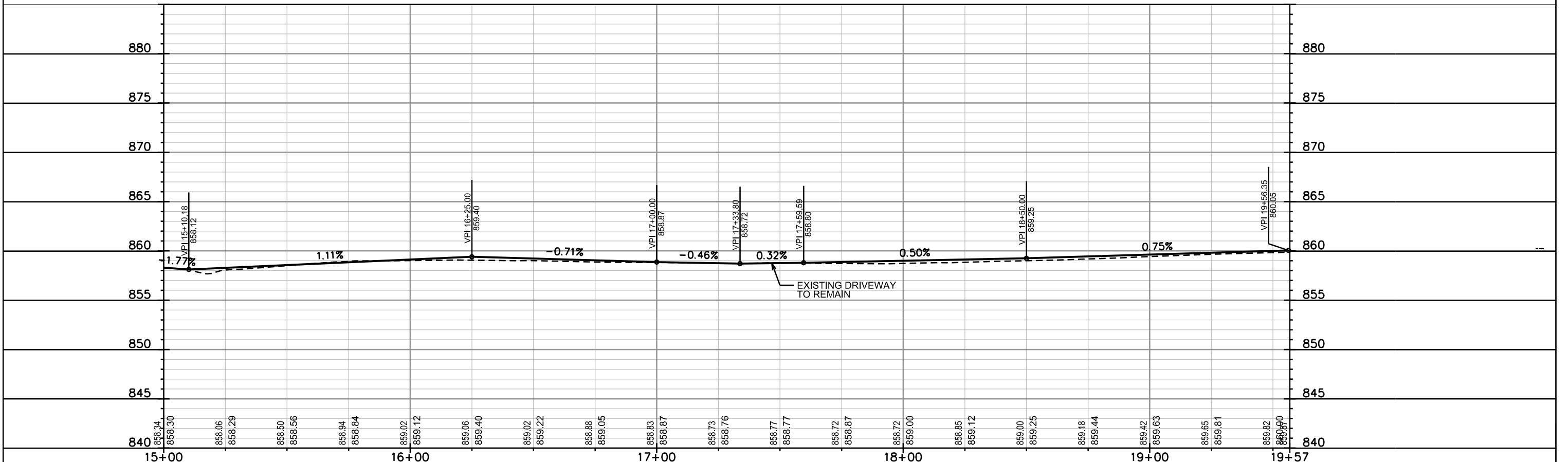

PLOT SCALE: \_\_\_\_\_

PLOT NAME: \_\_\_\_\_

REV. DATE: \_\_\_\_\_

ORIGINATOR: CITY OF MADISON, STREETS DIVISION

CROSS SECTIONS  
WRIGHT ST SIDEWALK CITY OF MADISON

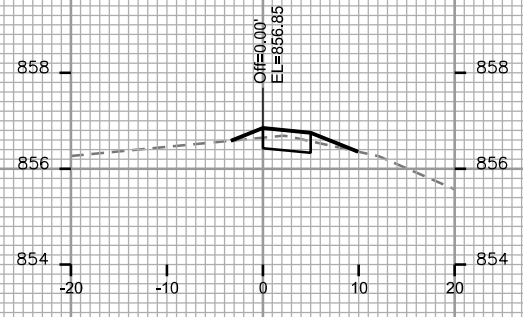

STA. 11+00

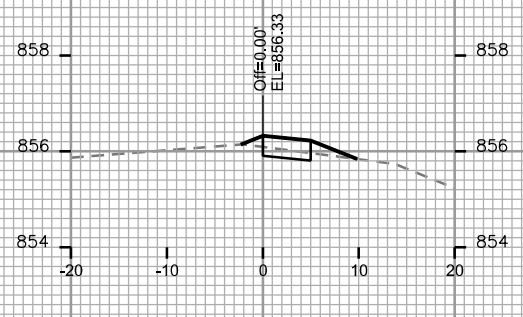

STA. 10+75

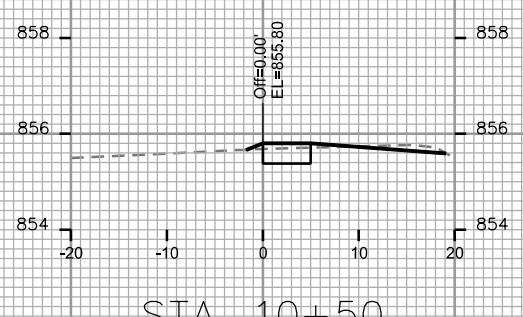

STA. 10+50

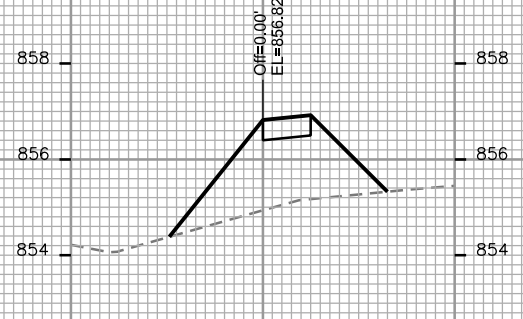

STA. 10+25

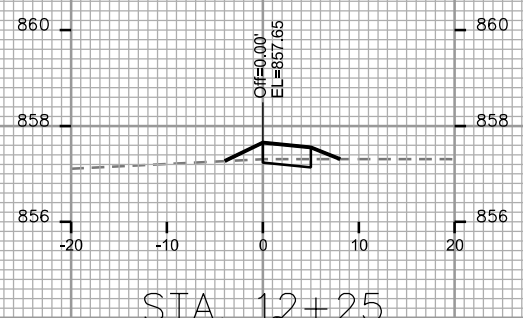

STA. 12+25

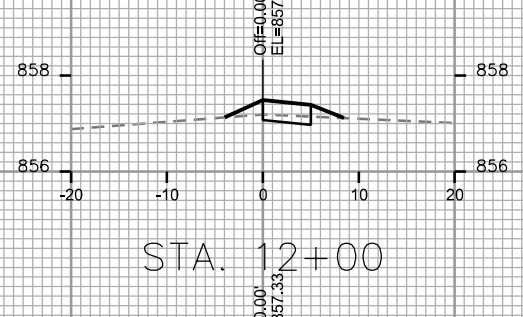

STA. 12+00

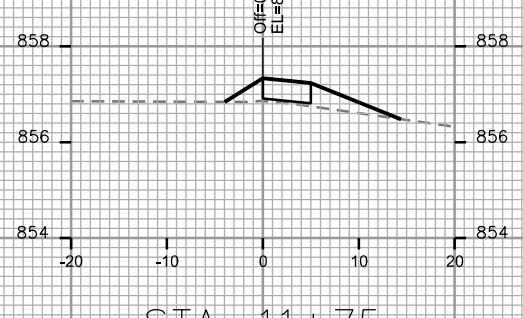

STA. 11+75

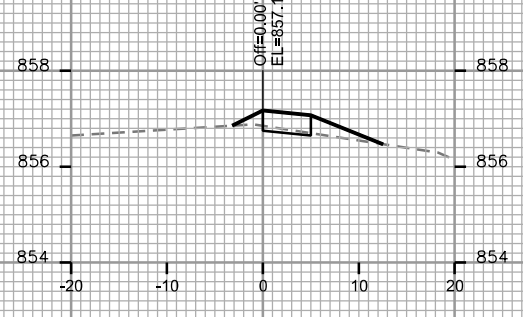

STA. 11+50

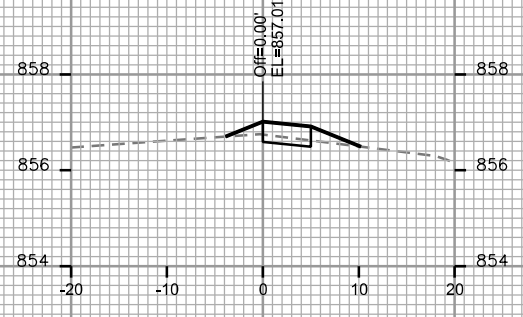

STA. 11+25

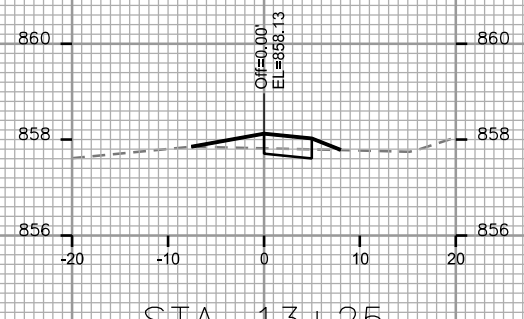

STA. 13+25

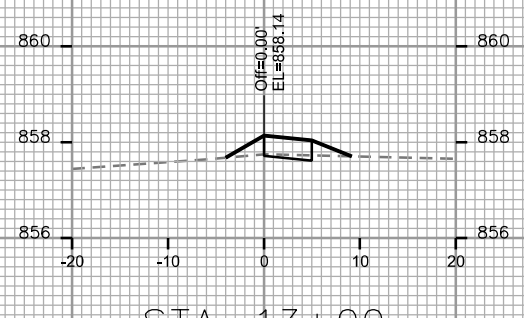

STA. 13+00

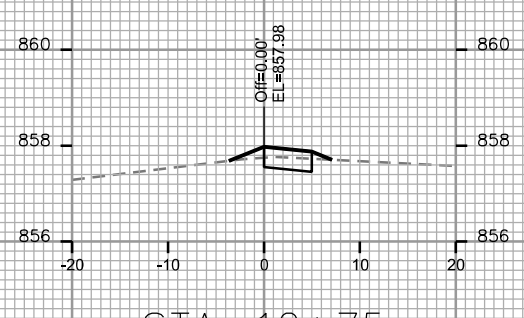

STA. 12+75

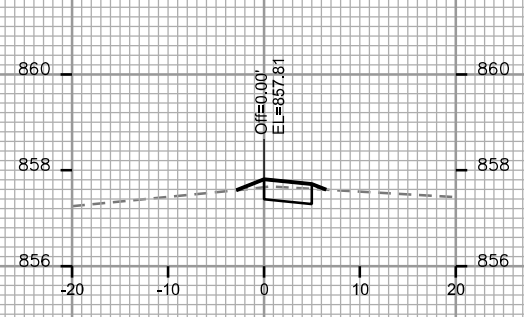

STA. 12+50

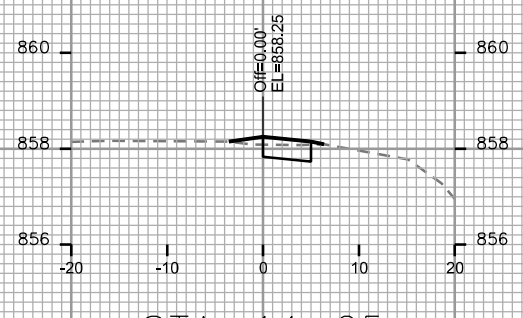

STA. 14+25



STA. 14+00

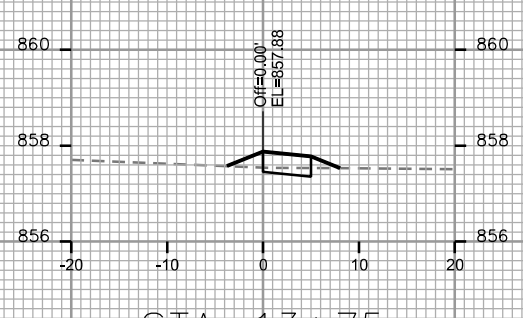

STA. 13+75

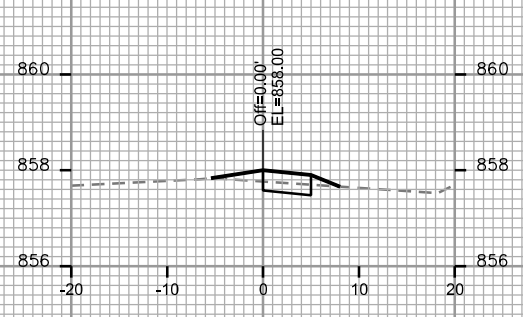

STA. 13+50

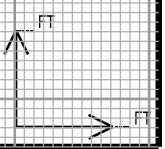

PLOT SCALE: \_\_\_\_\_

PLOT NAME: \_\_\_\_\_

REV. DATE: \_\_\_\_\_

ORIGINATOR: CITY OF MADISON - STREETS DIVISION

CROSS SECTIONS

WRIGHT ST SIDEWALK

CITY OF MADISON

PLOT SCALE: \_\_\_\_\_

PLOT NAME: \_\_\_\_\_

REV. DATE: \_\_\_\_\_

ORIGINATOR: CITY OF MADISON, STREETS DIVISION

