

Madison, Wisconsin

CITY OF MADISON

CITY ENGINEERING DIVISION

DEPARTMENT OF PUBLIC WORKS

PLAN OF PROPOSED IMPROVEMENT

PUBLIC IMPROVEMENT PROJECT APPROVED

MAY 5, 2015

BY THE COMMON COUNCIL
OF MADISON, WISCONSIN

PUBLIC IMPROVEMENT DESIGN
APPROVED BY:

 5/7/15
City Engineer Date

STREET
DESIGNED BY:

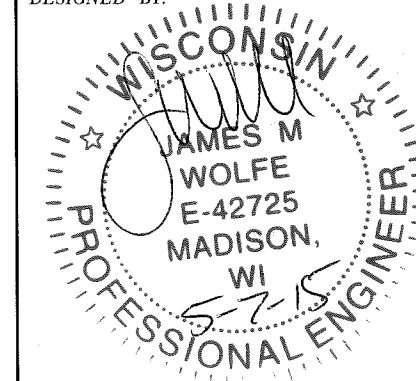

INDEX OF SHEETS

SHEET NO.	TITLE
1	NOTES & DETAILS
DI-D2	NOTES & DETAILS
PI-P3	STATE ST PLANS

STATE STREET SIDEWALK REPAIRS

CITY PROJECT NO. 53W1753 (MUNIS #10161)

CONTRACT NO. 7433

PROJECT
LOCATION

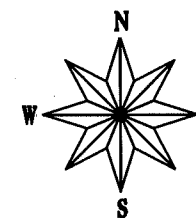
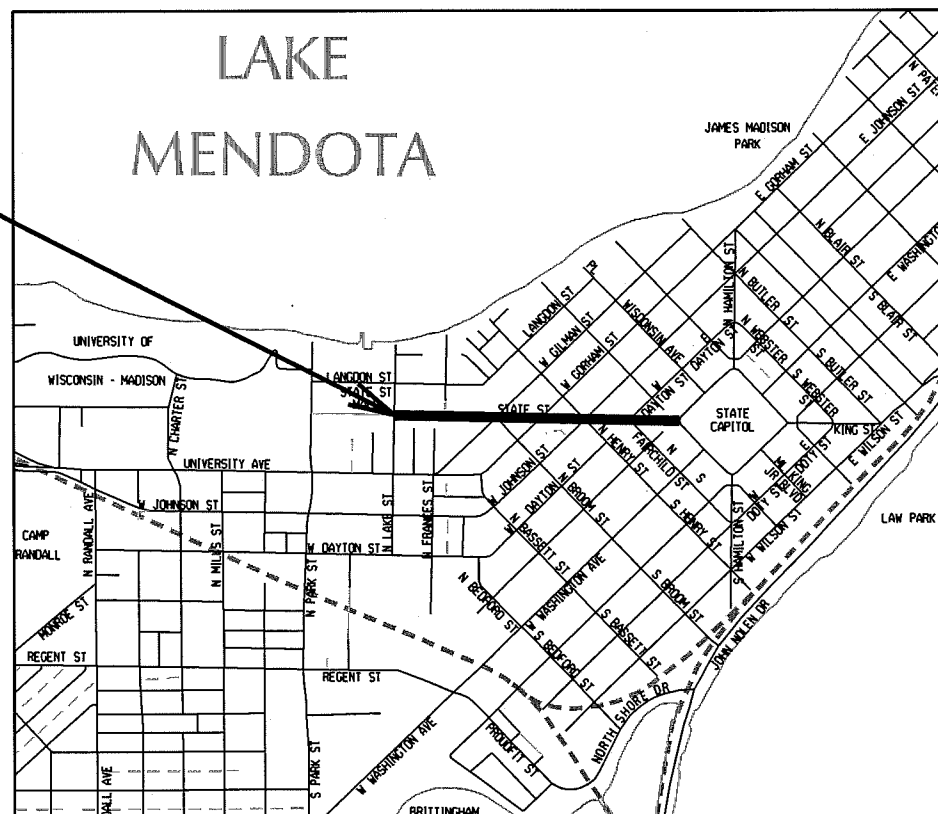

CONVENTIONAL SIGNS	
FIELD VERIFY ALL UTILITY LOCATIONS	
GAS	— G —
STORM SEWER	— ST —
SANITARY SEWER	— SAN —
WATER	— W —
OVERHEAD ELECTRIC	— OH —
POWER POLE	□

NOTES:

ALL GUTTERS SHALL DRAIN WITH A MINIMUM GRADE OF 0.50% TOWARD STORM SEWER INLETS.

SIDEWALK RAMPS AND CURB THRU SIDEWALK RAMPS SHALL HAVE A MAXIMUM SLOPE OF 1" PER 12". SIDEWALK AND CURB RAMPS SHALL BE CONSTRUCTED WITH A SIDE SLOPE OF 2.00%. SIDEWALK SHALL HAVE A MINIMUM LONGITUDINAL SLOPE OF 0.50% AND A MAXIMUM LONGITUDINAL SLOPE OF 5.00%

PLOT SCALE:

PLOT NAME:

REV. DATE:

ORIGINATOR: CITY OF MADISON, STREETS DIVISION

GENERAL NOTES:

1. ALL WORK IS TO BE COORDINATED WITH ADJACENT BUSINESSES. PROVIDE MINIMUM OF 48 HRS. PRIOR TO WORKING IN FRONT OF A BUSINESS.
2. MAINTAIN PEDESTRIAN ACCESS ALONG THE MAINLINE SIDEWALK AND ACCESS TO ALL BUSINESSES AT ALL TIMES.
3. INSTALL TEMPORARY RAMPS FOR USE BY PEDESTRIANS WHEN REPLACING EXISTING RAMPS. TEMPORARY RAMPS SHALL BE CONSIDERED INCIDENTAL TO TRAFFIC CONTROL BID ITEM.
4. CAULK THE ENTIRE LENGTH OF THE 2 LONGITUDINAL EXPANSION JOINTS ALONG THE TERRACE (BETWEEN TERRACE & MAINLINE SIDEWALK AND BETWEEN TERRACE & CONCRETE BAND BEHIND CURB). ALSO CAULK ADDITIONAL JOINTS NOTED ON PLAN. WIDTH OF JOINTS TO BE CAULKED WILL VARY UP TO AS WIDE AS 2 INCHES.
5. IT IS RECOMMENDED THAT JOINT CAULKING BE DONE IN THE MORNING, BEFORE 11 AM. CLOSURE OF SIDEWALK CAFES TO PERFORM JOINT CAULKING WORK WILL NOT BE PERMITTED, AND MOST CAFES ARE SET UP FOR LUNCH SERVICE.
6. REMOVE TEMPORARY ASPHALT REPAIRS FROM JOINTS TO BE CAULKED, WHICH WILL BE PAID UNDER REMOVE ASPHALT JOINT BID ITEM. REMOVAL OF ASPHALT IN JOINTS THAT WILL BE REPAIRED OR FROM PARTIAL DEPTH REPAIR AREAS SHALL BE CONSIDERED INCIDENTAL TO THOSE BID ITEMS.
7. CURB AND GUTTER THAT IS TO BE REMOVED AND REPLACED IS EITHER ADJACENT TO CONCRETE PAVEMENT, OR INTEGRAL WITH THE CONCRETE PAVEMENT. THE PAVEMENT WILL NEED TO BE SAWCUT PRIOR TO REMOVAL AND THE NEW CURB IS TO BE TIED TO THE EXISTING PAVEMENT PER S.D.D. 3.10. SAW CUTTING AND TIE BARS ARE INCIDENTAL TO REMOVE & REPLACE CONCRETE CURB & GUTTER ITEM.
8. AREAS OF CONCRETE REMOVAL ARE TO BE PROTECTED WITH BARRICADES, BARRELS, ETC. OR COVERED UNTIL THE CONCRETE CAN BE POURED THE FOLLOWING DAY. IF CONCRETE WON'T BE POURED THE FOLLOWING DAY, THE CONTRACTOR SHALL FILL OR COVER REMOVED AREAS SO THAT THEY CAN BE SAFELY USED BY PEDESTRIANS OR AS SIDEWALK CAFE SPACE UNTIL THE CONCRETE IS POURED.
9. NO CONCRETE POURS ARE TO TAKE PLACE ON A FRIDAY IN AREAS THAT ARE USED FOR SIDEWALK CAFES OR VENDOR SPACE.

**C1 LONGITUDINAL JOINT REPAIR DETAIL
NOT TO SCALE**

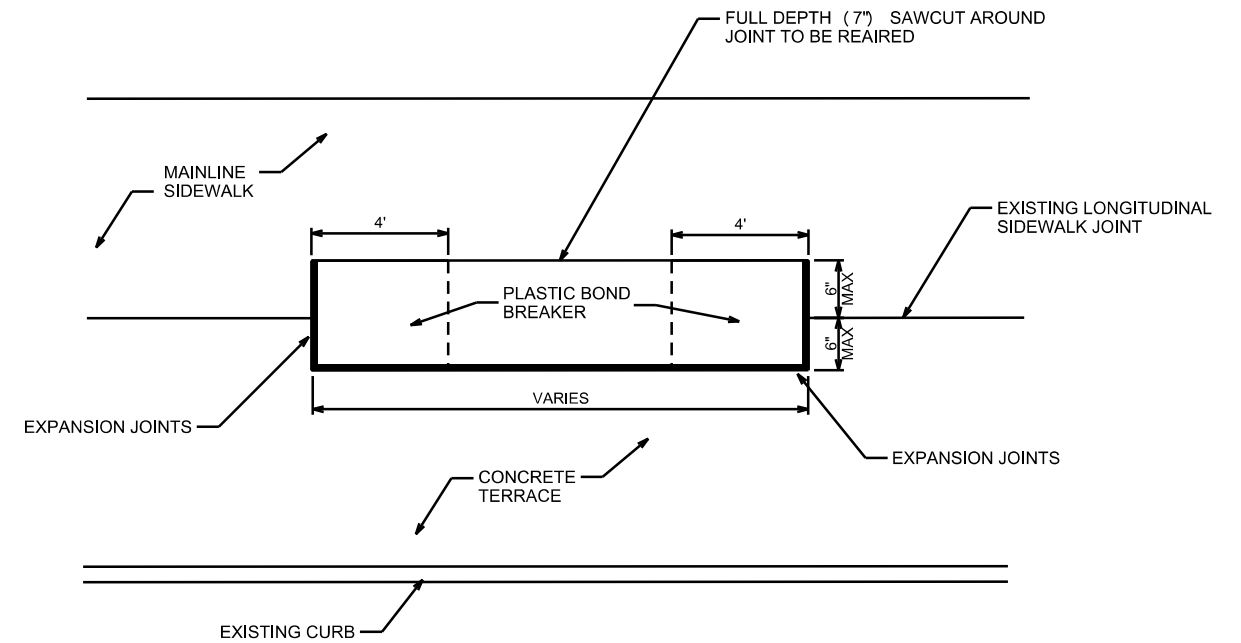

DETAIL NOTES:

1. ALL ASPECTS OF THE TRANSVERSE JOINT REPAIR ARE THE SAME AS LONGITUDINAL EXCEPT THE BOND BREAKERS IS NOT USED AND THE EXPANSION JOINT SHALL ONLY BE INSTALLED ADJACENT TO THE TERRACE CONCRETE
2. INSTALL BOND BREAKER FOR FULL LENGTH IF JOINT IF THE REPAIR IS LESS THAN 4' IN LENGTH.
3. JOINT REPAIR WIDTH IS A MAXIMUM OF 6" ON EITHER SIDE OF THE EXISING EXPANSION JOINT. MOST REPAIRS WILL BE ON ONE SIDE OR THE OTHER OF THE EXISTING JOINT. IF ONLY ONE SIDE IS REPAIRED, MAINTAIN EXPANSION JOINT IN ITS CURRENT LOCATION.
4. JOINT REPAIRS TO BE PAID PER L.F. ASSUMING 6" WIDTH FOR REPAIR. IF BOTH SIDES OF A JOINT ARE TO BE REPAIRED, JOINT REPAIR WILL BE PAID AT 2 TIMES LENGTH.

PLOT SCALE: _____

PLOT NAME: _____

REV. DATE: _____

ORIGINATOR: CITY OF MADISON, STREETS DIVISION

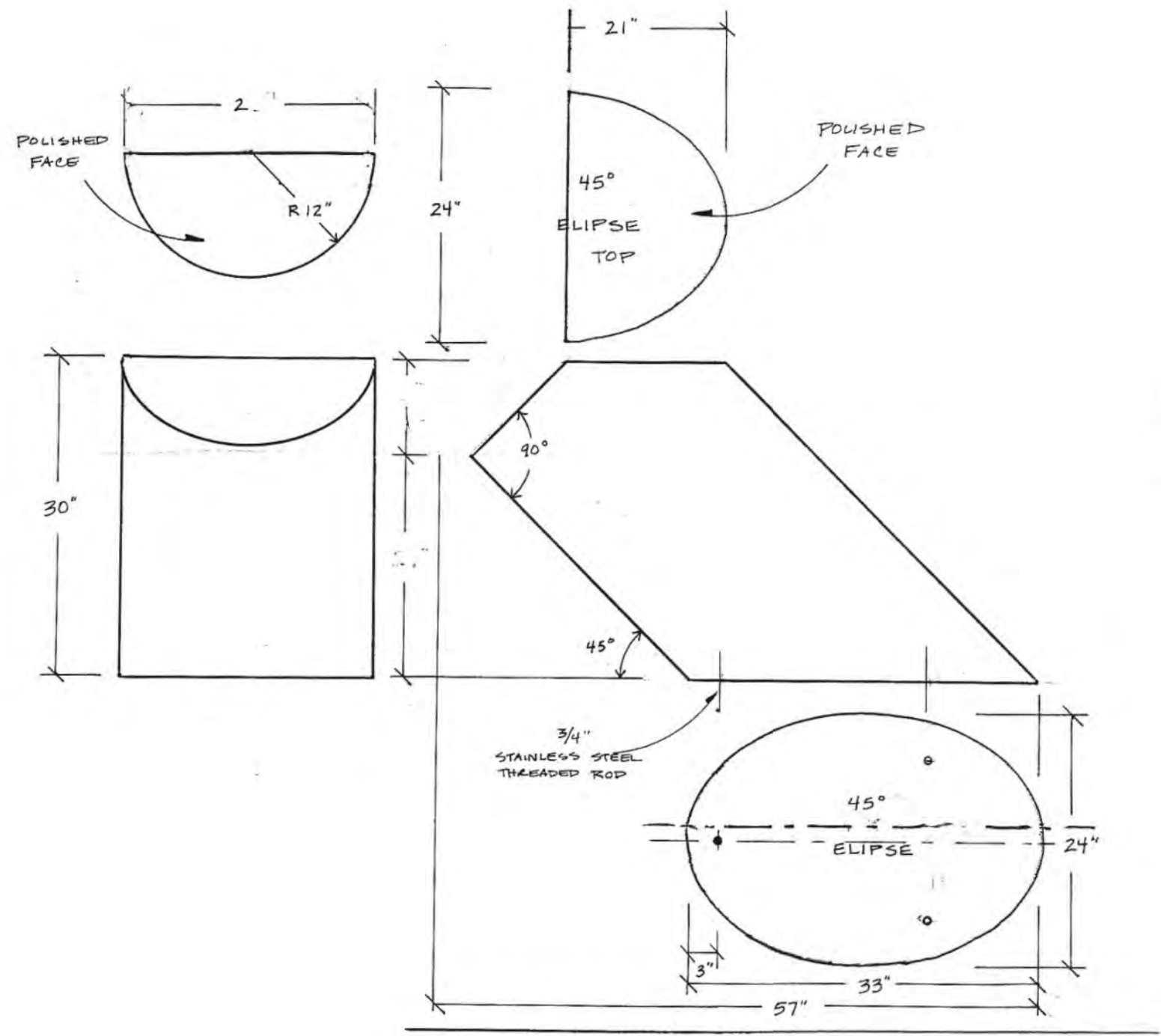

GRANITE STREET FORM TYPE G
SCALE: NONE

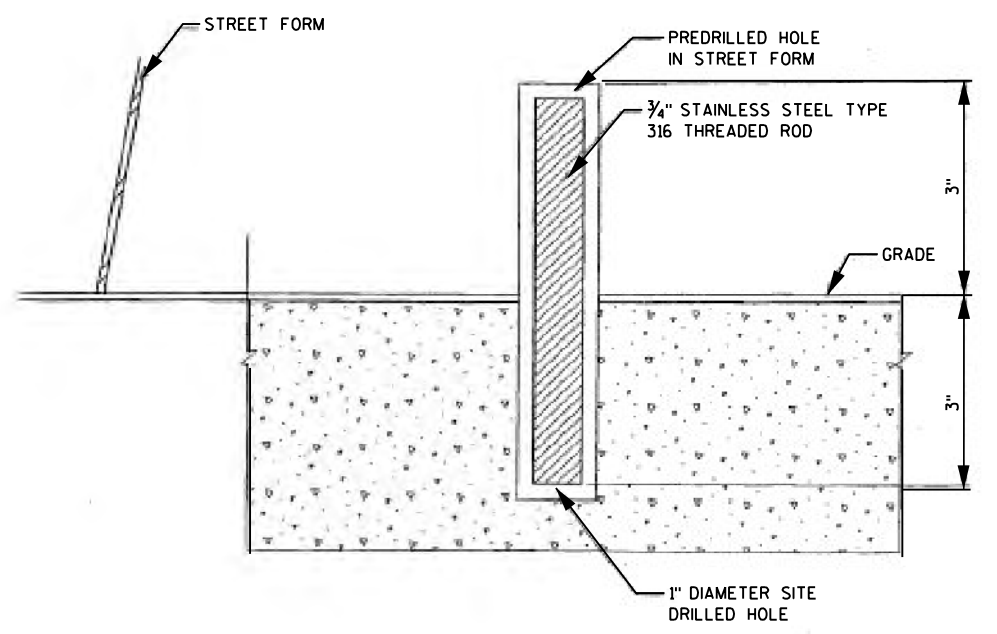
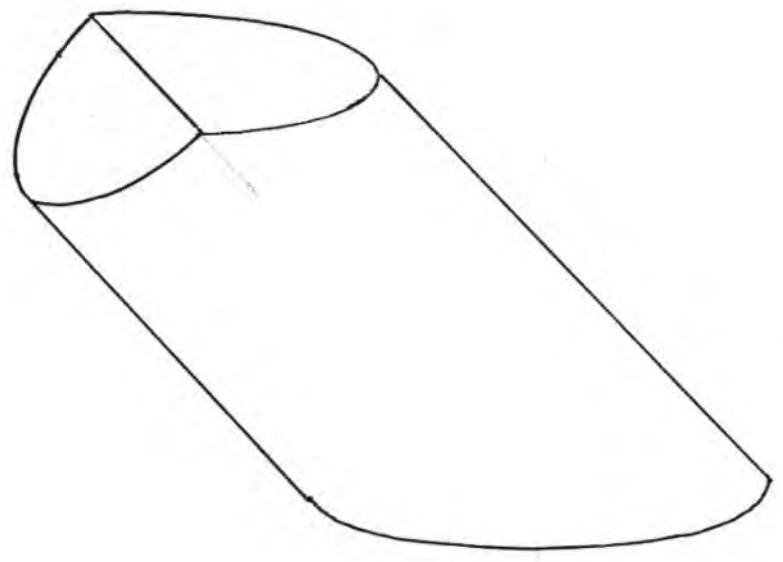

STREET FORM ANCHOR DETAIL
SCALE: NONE

PLOT SCALE:
 PLOT NAME:
 REV. DATE:
 ORIGINATOR: CITY OF MADISON, STREETS DIVISION

LEGEND

- = ASPHALT JOINT REMOVAL
- = ADD'L CAULK JOINT
- = EXISTING MANHOLE
- ▬▬▬ = INSTALL DETECTABLE WARNING FIELDS
- ▬▬▬ = C1 JOINT REPAIR
- ▣ = 7" C1 AREA REPLACEMENT
- ▣ = 7" CONC. SIDEWALK
- ▣ = CONC. CURB & GUTTER

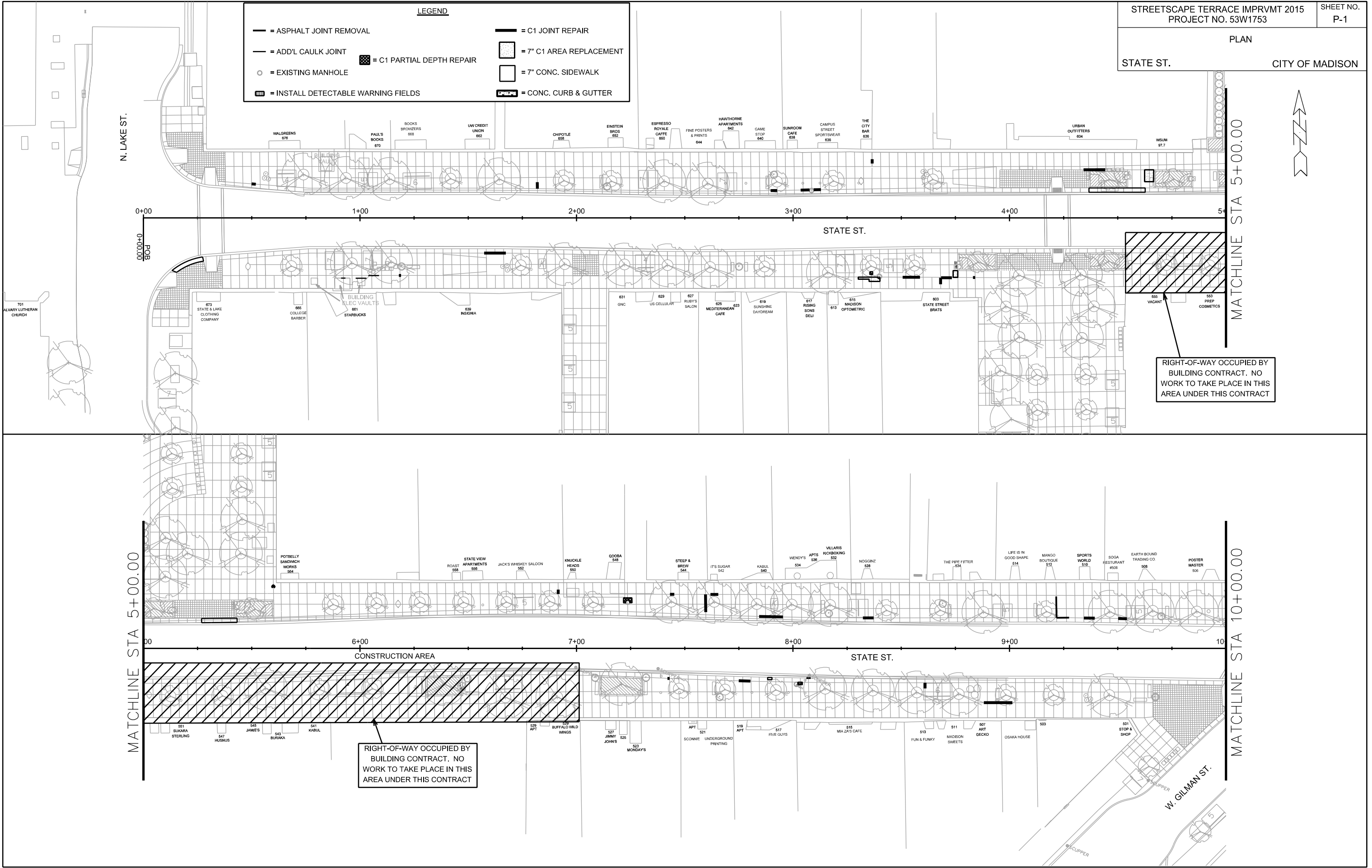

RIGHT-OF-WAY OCCUPIED BY BUILDING CONTRACT. NO WORK TO TAKE PLACE IN THIS AREA UNDER THIS CONTRACT

RIGHT-OF-WAY OCCUPIED BY BUILDING CONTRACT. NO WORK TO TAKE PLACE IN THIS AREA UNDER THIS CONTRACT

PLOT SCALE: _____

PLOT NAME: _____

REV. DATE: _____

ORIGINATOR: CITY OF MADISON, STREETS DIVISION

PLAN

STATE ST. CITY OF MADISON

LEGEND

- = ASPHALT JOINT REMOVAL
- = ADD'L CAULK JOINT
- = EXISTING MANHOLE
- = INSTALL DETECTABLE WARNING FIELDS
- = C1 JOINT REPAIR
- = 7" C1 AREA REPLACEMENT
- = 7" CONC. SIDEWALK
- = CONC. CURB & GUTTER
- = C1 PARTIAL DEPTH REPAIR

MATCHLINE STA 10+00.00

MATCHLINE STA 15+00.00

MATCHLINE STA 15+00.00

MATCHLINE STA 20+00.00

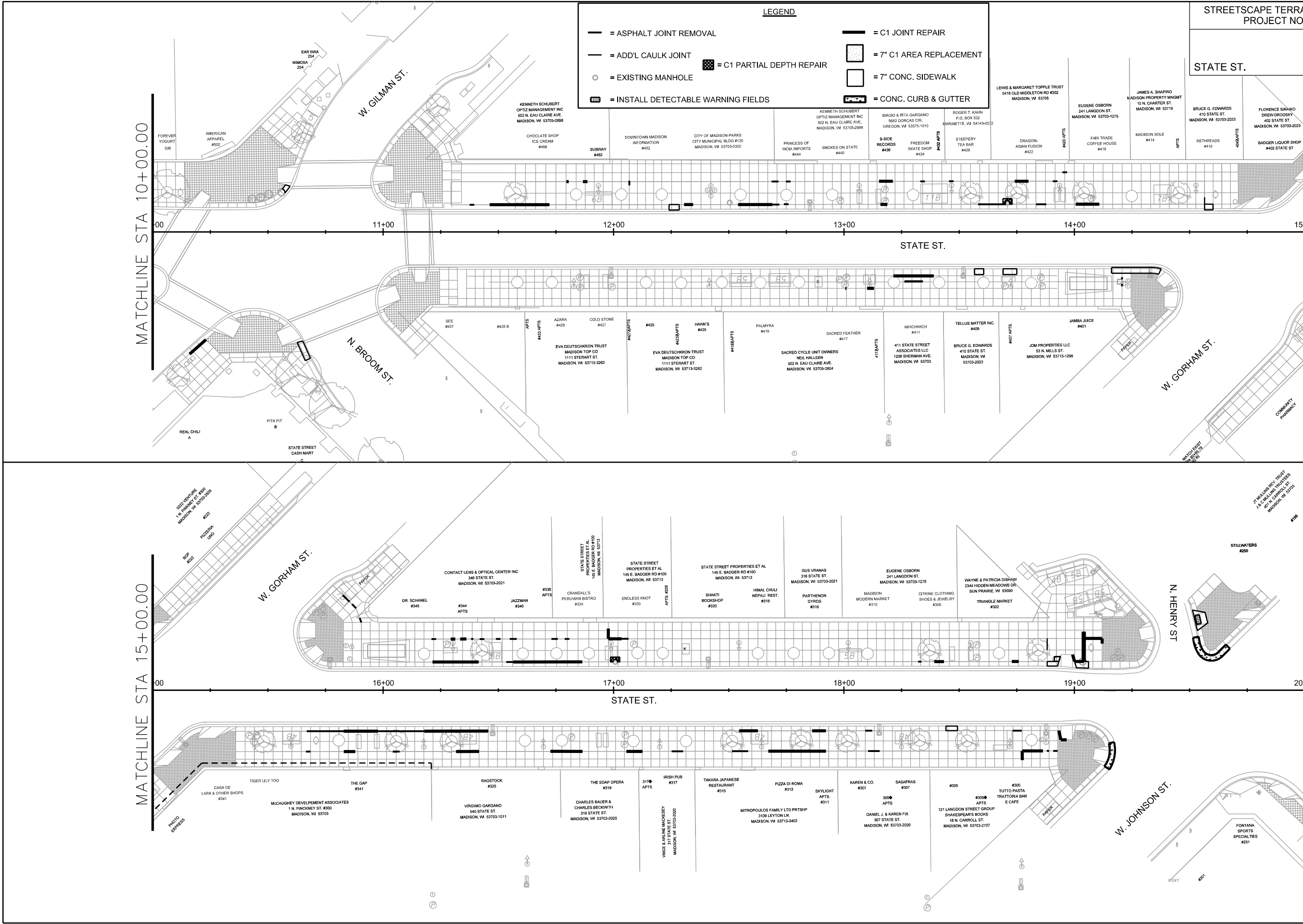

PLOT SCALE: _____

PLOT NAME: _____

REV. DATE: _____

ORIGINATOR: CITY OF MADISON, STREETS DIVISION

LEGEND

- = ASPHALT JOINT REMOVAL
- = ADD'L CAULK JOINT
- = EXISTING MANHOLE
- = C1 PARTIAL DEPTH REPAIR
- = 7" C1 AREA REPLACEMENT
- = 7" CONC. SIDEWALK
- ▨ = CONC. CURB & GUTTER
- = C1 JOINT REPAIR
- = 7" C1 AREA REPLACEMENT
- = 7" CONC. SIDEWALK
- ▨ = CONC. CURB & GUTTER

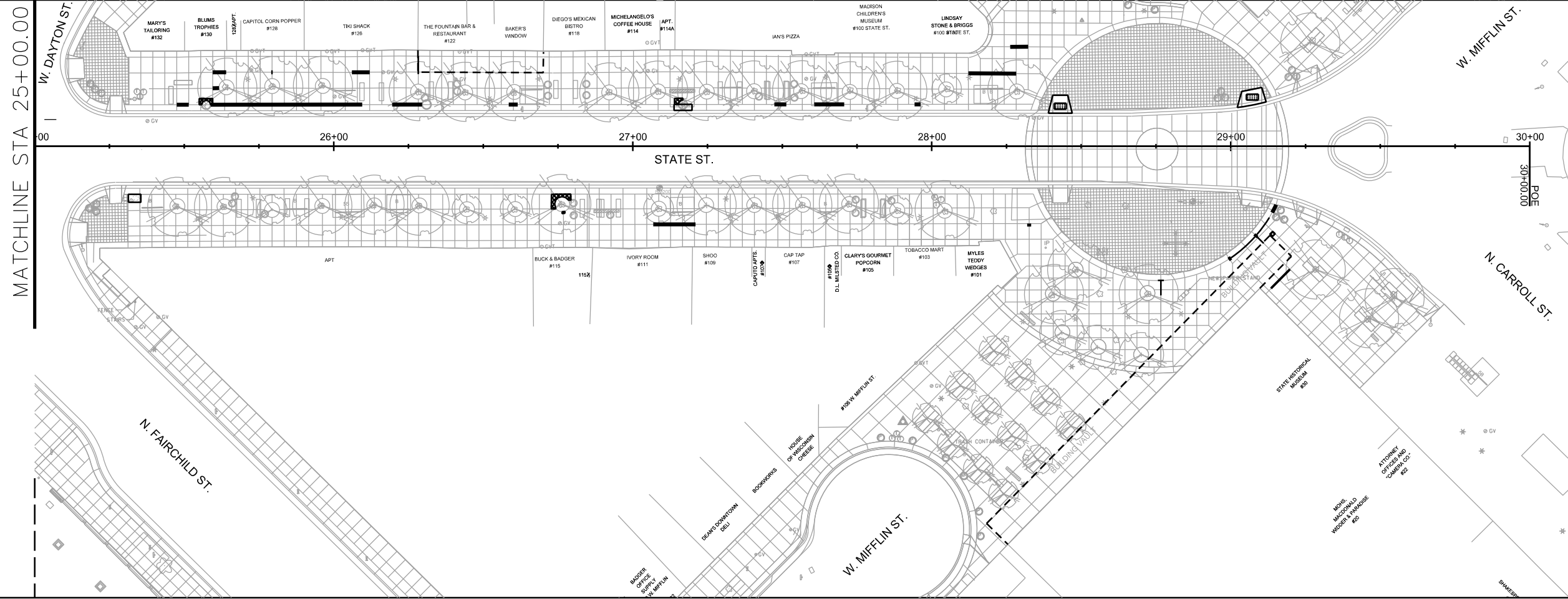
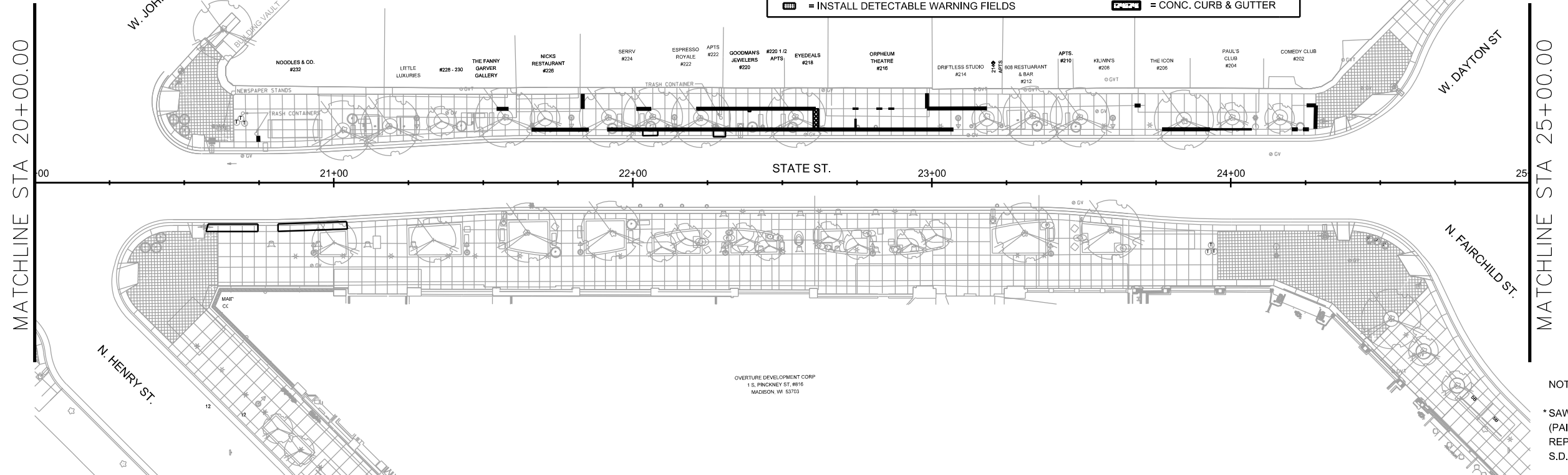

NOTES:
*SAWCUT CONCRETE PAVEMENT (PAID UNDER BID ITEM 20301).
REPLACE CURB W/TIE BARS PER S.D.D. 3.10 (INCIDENTAL TO CURB).

PLOT SCALE: _____

REV. DATE: _____

ORIGINATOR: CITY OF MADISON, STREETS DIVISION