

Madison, Wisconsin

CITY OF MADISON

MADISON WATER UTILITY

DEPARTMENT OF PUBLIC WORKS

PLAN OF PROPOSED IMPROVEMENT

E. BROADWAY SERVICE RD WATER MAIN REPLACEMENT

CITY PROJECT NO. 11212
CONTRACT NO. 7673

INDEX OF SHEETS

SHEET NO.	1	TITLE SHEET
SHEET NO.	W-1 TO W-2	WATER PLAN & PROFILE (LOCATION 1)
SHEET NO.	W-3	WATER PLAN & PROFILE (LOCATION 2)
SHEET NO.	W-4 TO W-5	WATER IMPACT PLAN
SHEET NO.	W-6	WATER PLAN OVERVIEW
SHEET NO.	W-7	WATER ESTIMATE OF MATERIALS
SHEET NO.	E-1 TO E-2	EROSION CONTROL PLAN (LOCATION 1)
SHEET NO.	E-3	EROSION CONTROL PLAN (LOCATION 2)

PUBLIC IMPROVEMENT PROJECT
APPROVED

MARCH 1, 2016

BY THE COMMON COUNCIL
OF MADISON, WISCONSIN

PUBLIC IMPROVEMENT DESIGN
APPROVED BY:

[Signature] 4/20/16
Principal Engineer Date
Madison Water Utility



PLOT SCALE: _____
PLOT NAME: _____
REV. DATE: _____

CONVENTIONAL SIGNS	
FIELD VERIFY ALL UTILITY LOCATIONS	
GAS	— G —
STORM SEWER	— ST —
SANITARY SEWER	— SAN —
WATER	— W —
BURIED ELECTRIC	— E —
OVERHEAD ELECTRIC	— OH —
POWER POLE	□
ADA COMPLIANT RAMP W/ DETECTABLE WARNING FIELD	▤
COMBUSTIBLE FLUIDS	☠

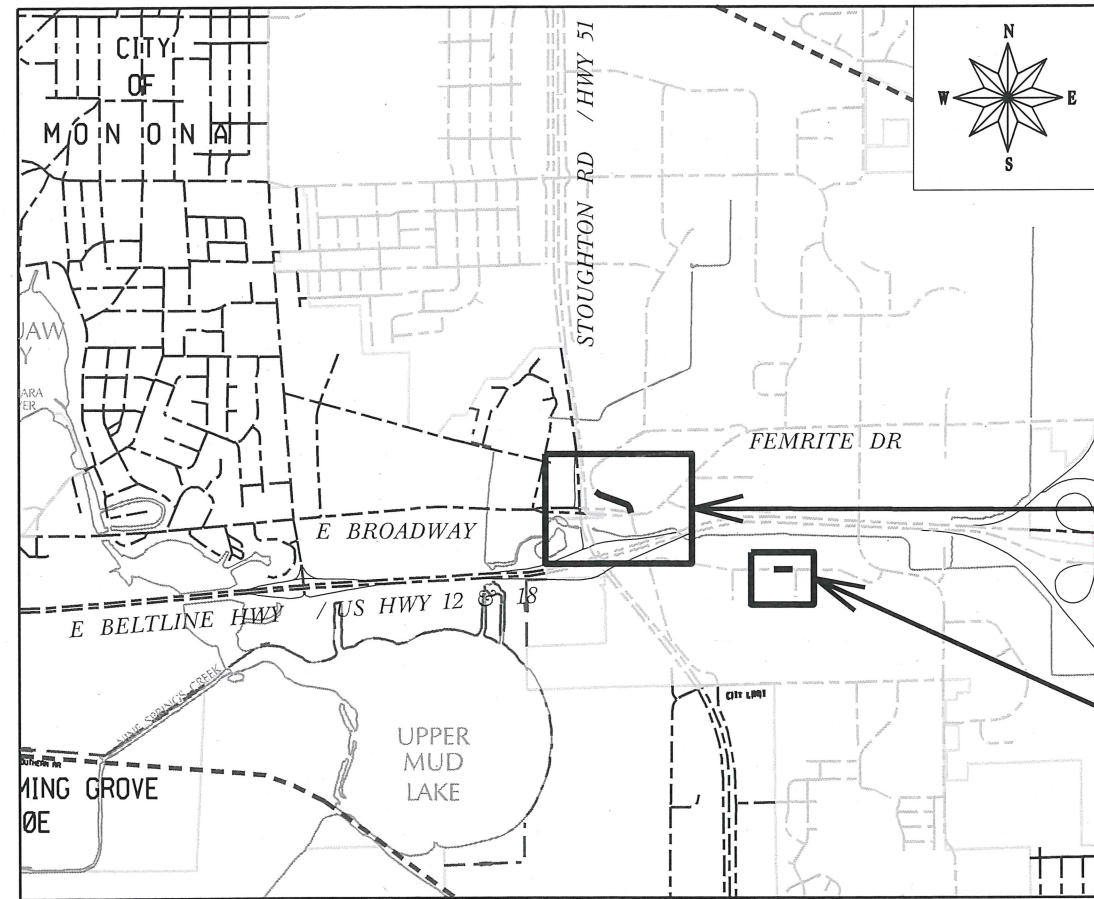

CONSTRUCTION PROJECT
LOCATION 1
(E. BROADWAY SERVICE RD)

CONSTRUCTION PROJECT
LOCATION 2
(4901 TRADEWINDS PKWY)

ORIGINATOR: CITY OF MADISON, STREETS DIVISION

0710-223-0272-4
 BARTSCH PROPERTIES LLC
 C/O BARTSCH PROPERTIES
 4302 E Broadway Service Rd

0710-223-0287-3
 INDIGO HOSPITALITY LLC
 4402 E Broadway Service Rd

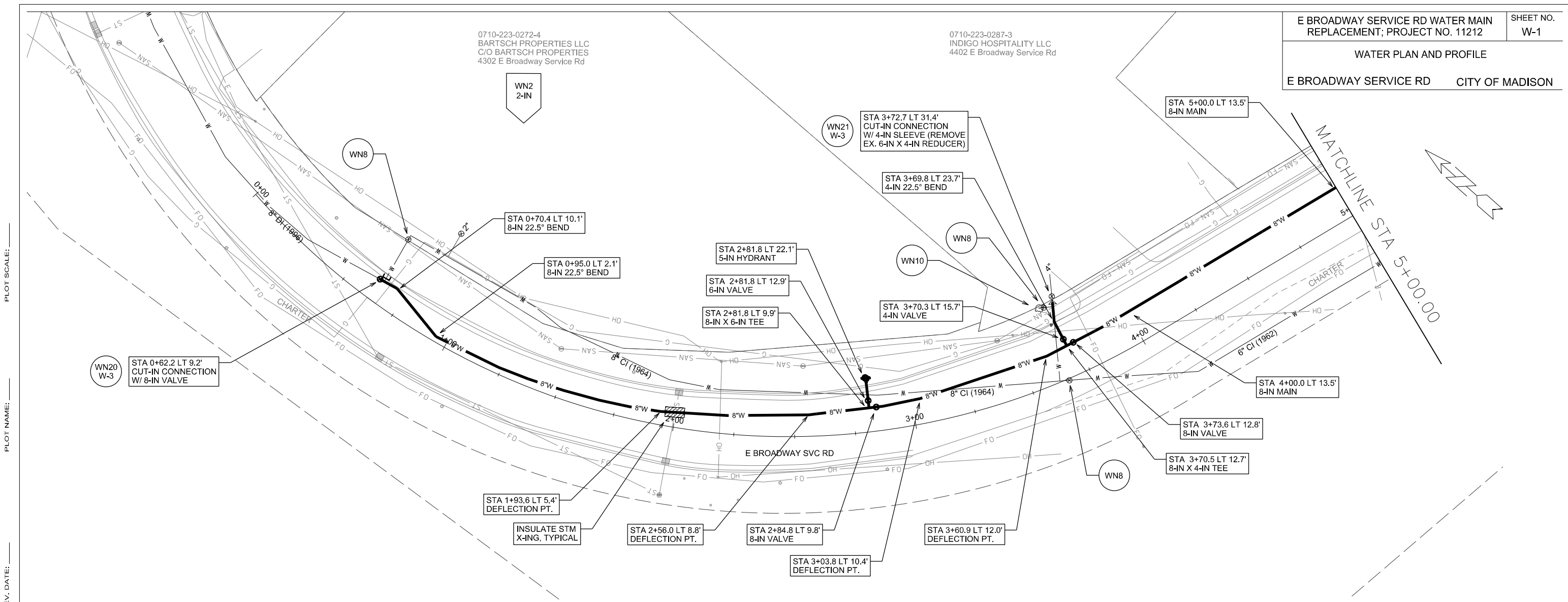

PLOT SCALE: _____

PLOT NAME: _____

REV. DATE: _____

ORIGINATOR: CITY OF MADISON, STREETS DIVISION

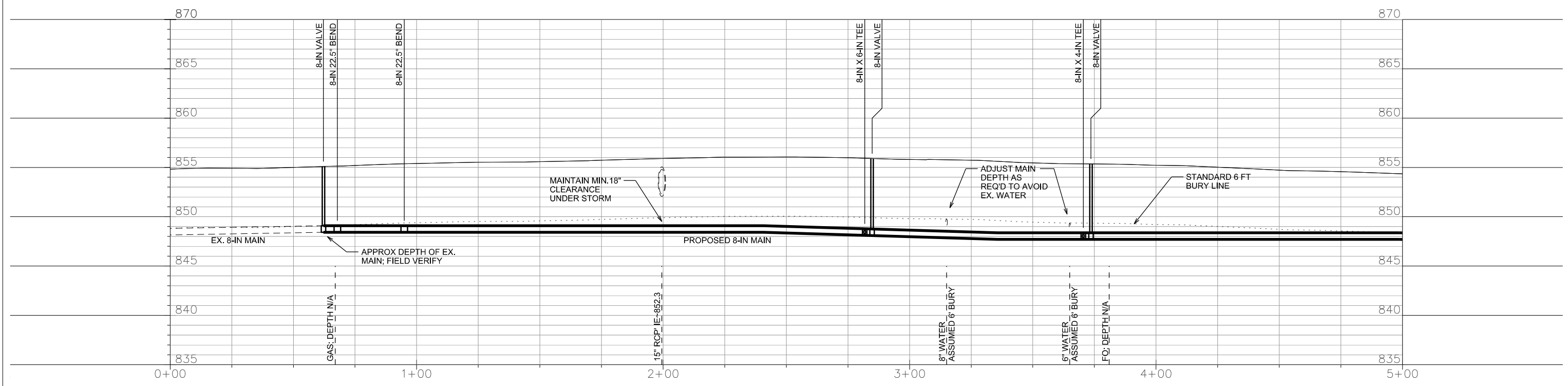

0710-223-0279-0
 ENGBRING LLC, PAT & JERRY
 4506 E Broadway Service Rd

0710-223-0286-5
 PAINTER PROPERTIES LLC
 4516 E Broadway Service Rd

0710-223-0275-8
 SUMMIT CREDIT UNION
 4538 E Broadway Service Rd

MATCHLINE STA 5+00.00

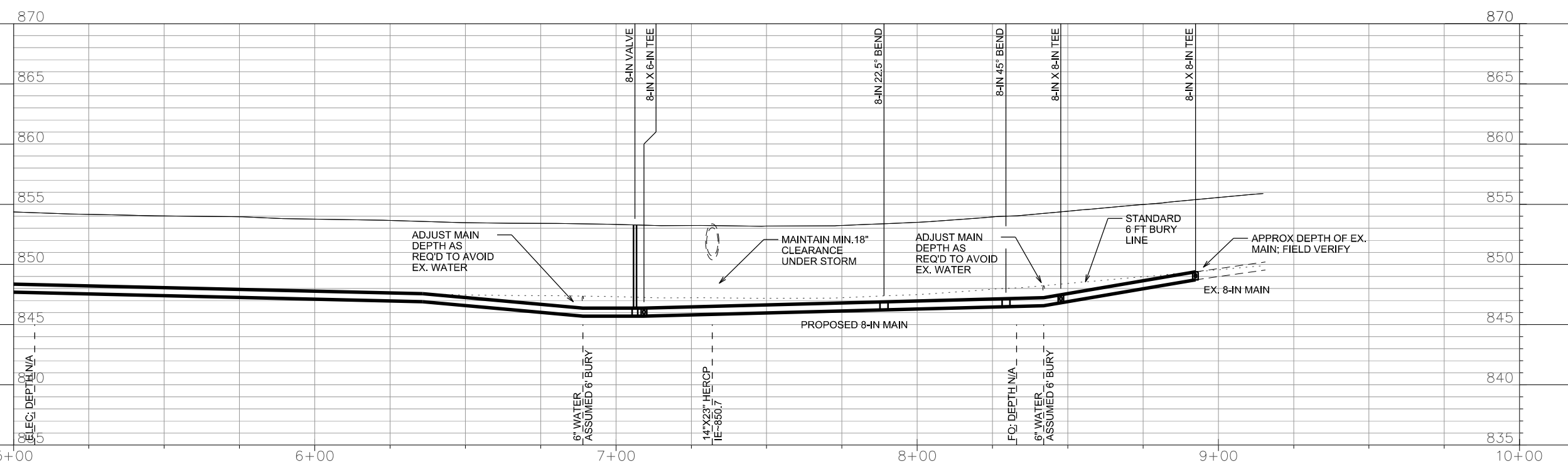
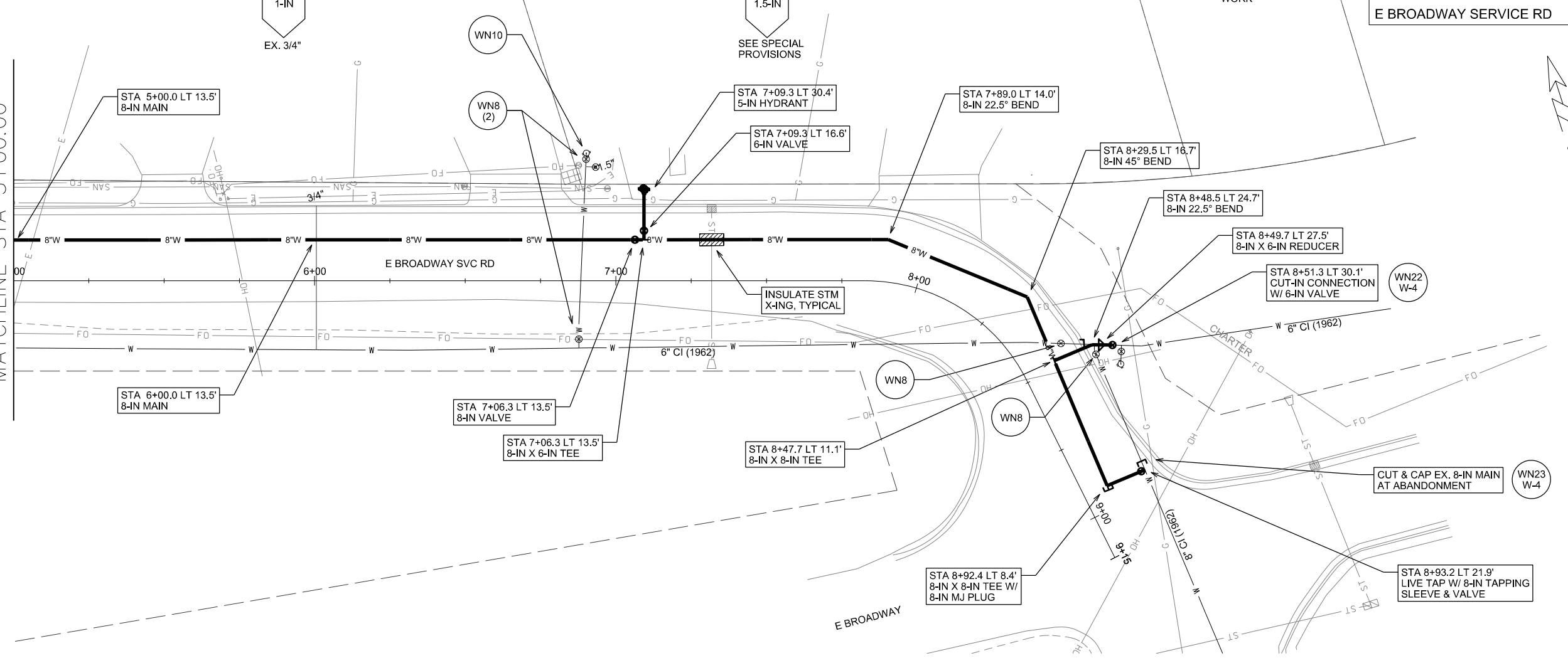

PLOT SCALE: _____
 PLOT NAME: _____
 REV. DATE: _____
 ORIGINATOR: CITY OF MADISON, STREETS DIVISION

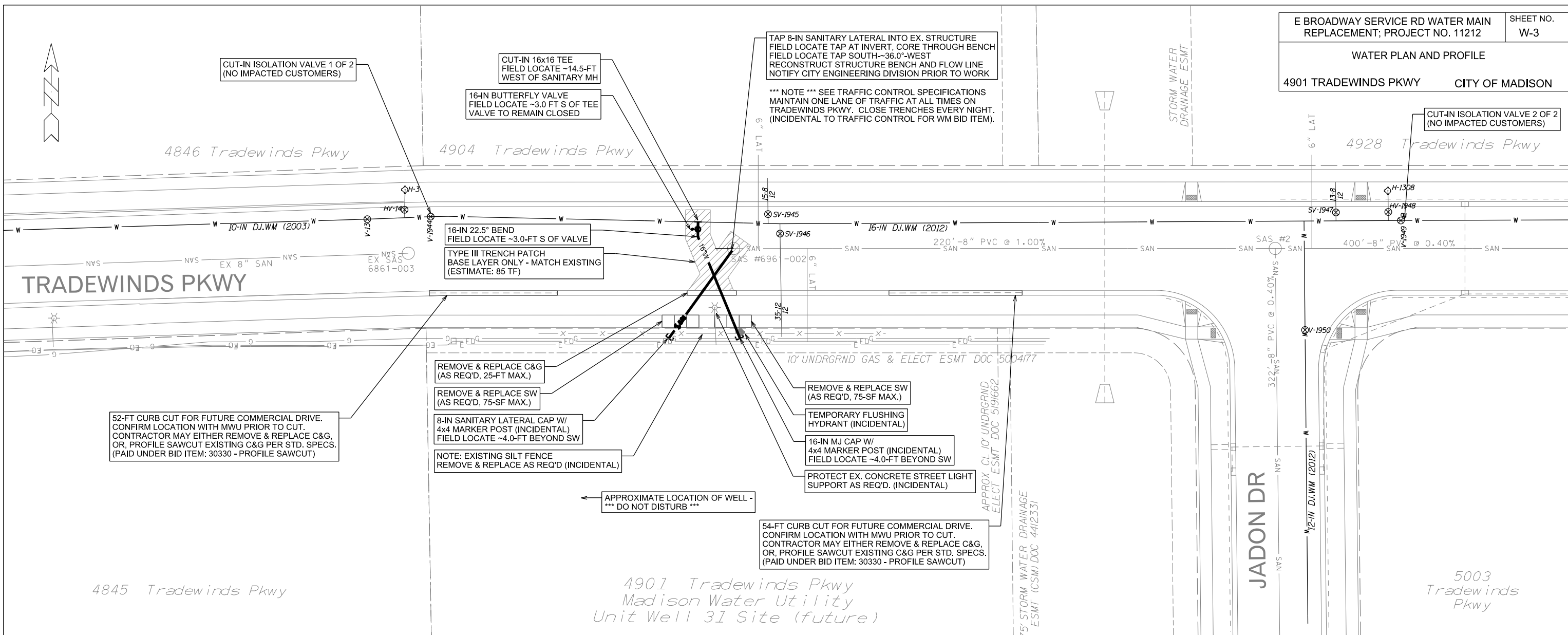

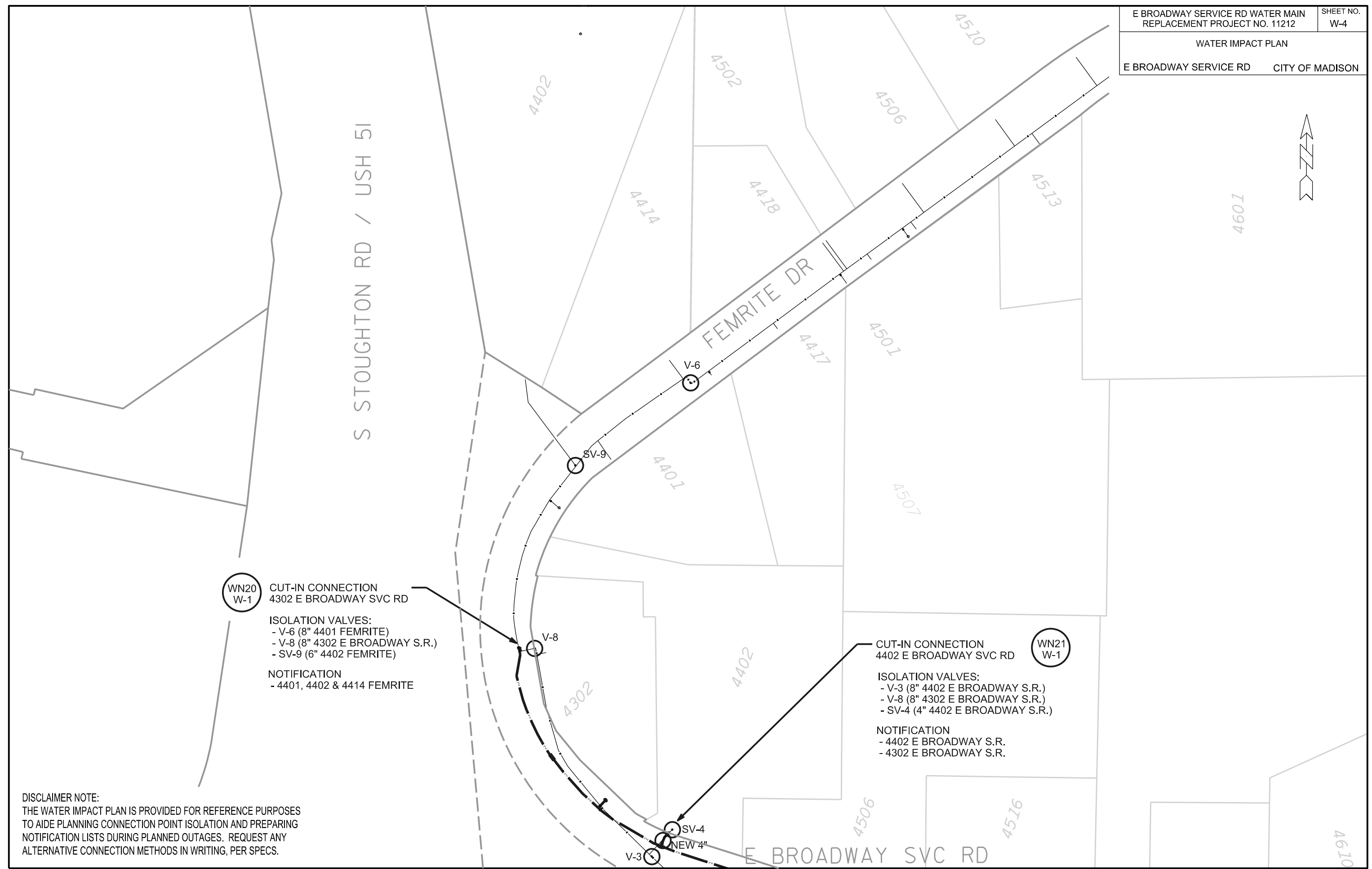

**WN20
W-1** CUT-IN CONNECTION
4302 E BROADWAY SVC RD

ISOLATION VALVES:
 - V-6 (8" 4401 FEMRITE)
 - V-8 (8" 4302 E BROADWAY S.R.)
 - SV-9 (6" 4402 FEMRITE)

NOTIFICATION
 - 4401, 4402 & 4414 FEMRITE

**WN21
W-1** CUT-IN CONNECTION
4402 E BROADWAY SVC RD

ISOLATION VALVES:
 - V-3 (8" 4402 E BROADWAY S.R.)
 - V-8 (8" 4302 E BROADWAY S.R.)
 - SV-4 (4" 4402 E BROADWAY S.R.)

NOTIFICATION
 - 4402 E BROADWAY S.R.
 - 4302 E BROADWAY S.R.

DISCLAIMER NOTE:
 THE WATER IMPACT PLAN IS PROVIDED FOR REFERENCE PURPOSES
 TO AIDE PLANNING CONNECTION POINT ISOLATION AND PREPARING
 NOTIFICATION LISTS DURING PLANNED OUTAGES. REQUEST ANY
 ALTERNATIVE CONNECTION METHODS IN WRITING, PER SPECS.

PLOT SCALE: _____
 PLOT NAME: _____
 REV. DATE: _____
 ORIGINATOR: CITY OF MADISON, STREETS DIVISION

CUT-IN CONNECTION
 E BROADWAY SVC RD AT E BROADWAY **WN22 W-2**

ISOLATION VALVES:

- V-1 (6" E BROADWAY SR AT E BROADWAY)
- V-2 (8" E BROADWAY SR AT E BROADWAY)
- V-4 (6" 4610 E BROADWAY)

NOTIFICATION

- 4602 & 4610 E BROADWAY

WN23 W-2

CUT & CAP EXISTING MAIN
 E BROADWAY SVC RD AT E BROADWAY

ISOLATION VALVES:

- V-2 (8" E BROADWAY SR AT E BROADWAY)
- V-2 (8" COLLINS AT PARK & RIDE LOT)
- 8" TAPPING VALVE (E BROADWAY SR AT E BROADWAY)

NOTIFICATION

- 2, 4 & 6 COLLINS CT
- PARK & RIDE LOT

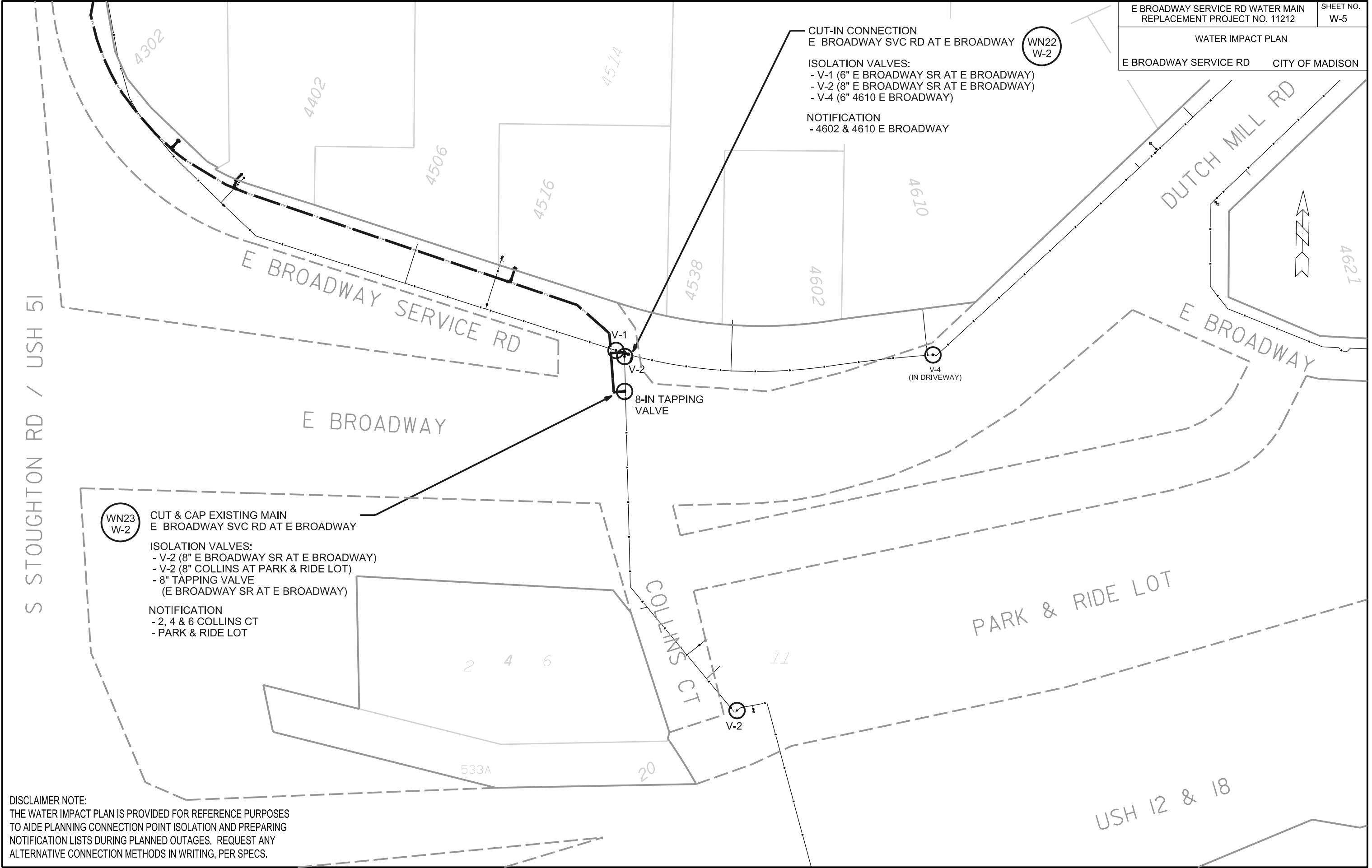

DISCLAIMER NOTE:
 THE WATER IMPACT PLAN IS PROVIDED FOR REFERENCE PURPOSES TO AIDE PLANNING CONNECTION POINT ISOLATION AND PREPARING NOTIFICATION LISTS DURING PLANNED OUTAGES. REQUEST ANY ALTERNATIVE CONNECTION METHODS IN WRITING, PER SPECS.

PLOT SCALE: _____
 PLOT NAME: _____
 REV. DATE: _____
 ORIGINATOR: CITY OF MADISON, STREETS DIVISION

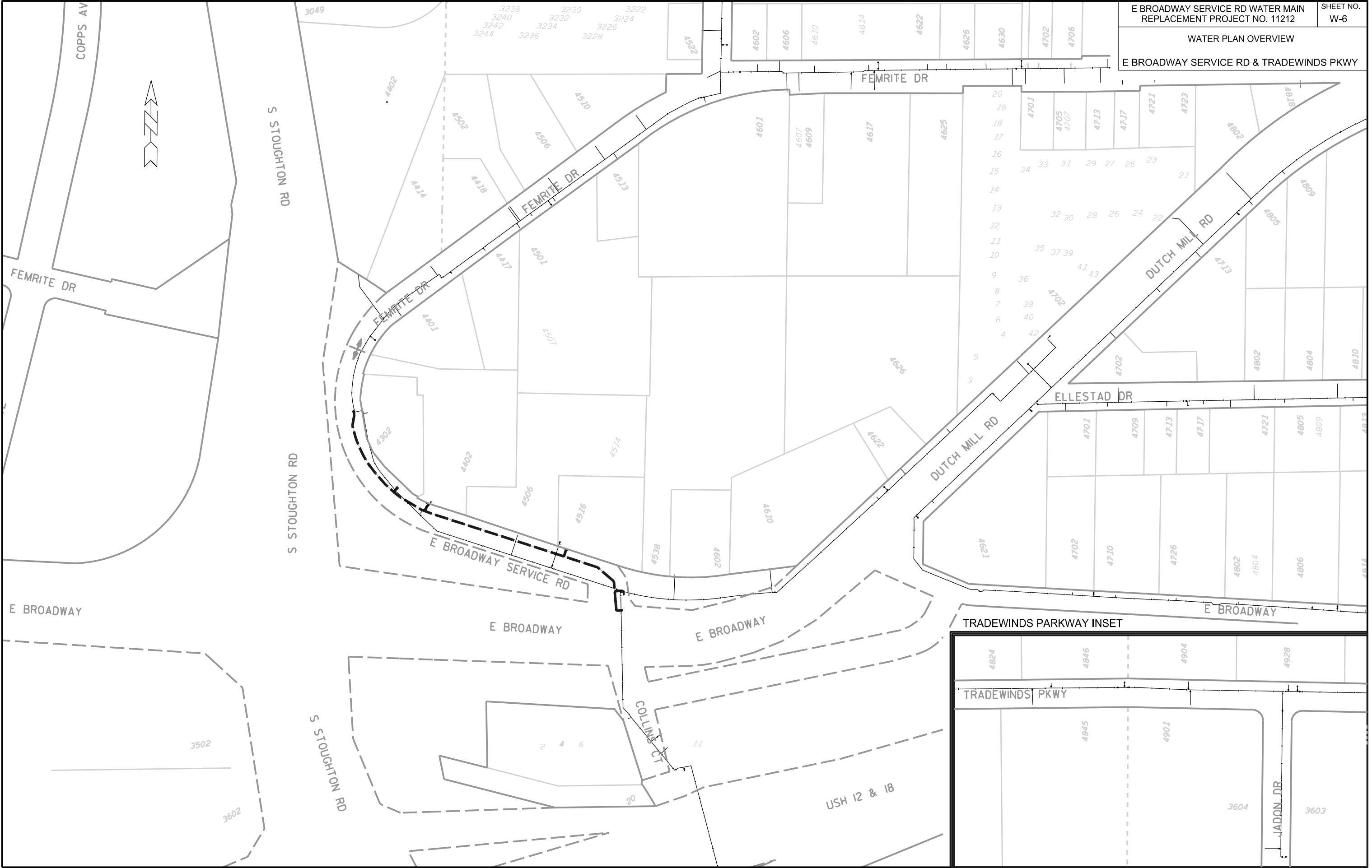

PLOT SCALE: _____

PLOT NAME: _____

REV. DATE: _____

ORIGINATOR: CITY OF MADISON, STREETS DIVISION

WATER ESTIMATE OF MATERIALS
E BROADWAY SERVICE RD / TRADEWINDS PKWY

DISCLAIMER NOTE:
UTILITY LOCATIONS SHOWN ARE APPROXIMATE ONLY. IT SHALL BE THE CONTRACTOR'S RESPONSIBILITY TO DETERMINE THE EXACT HORIZONTAL AND VERTICAL LOCATION OF ALL EXISTING UNDERGROUND AND OVERHEAD UTILITIES PRIOR TO COMMENCING WORK.

CONSTRUCTION NOTES:

1. CONSTRUCT NEW WATER MAIN 6.0' BELOW FINISHED GRADE, UNLESS OTHERWISE NOTED. INSULATE MAIN WITH POLYSTYRENE BOARD AT UTILITY CROSSINGS OR OTHER AREAS IDENTIFIED BY ENGINEER AS HAVING INADEQUATE COVER.
2. VERIFY SIZE OF EXISTING WATER SERVICES AND RECONNECT SERVICES AS INDICATED.
3. MINIMIZE DISRUPTION OF SERVICE TO EXISTING CUSTOMERS. NOTIFY PER CONTRACT REQUIREMENTS OF ANY PLANNED WATER OUTAGE.
4. THE EXISTING UTILITIES SHOWN ON THIS PLAN REPRESENT THE BEST INFORMATION AVAILABLE TO THE WATER UTILITY AT THE TIME OF PLAN PREPARATION. CONTRACTOR IS RESPONSIBLE FOR HAVING EACH UTILITY LOCATED PRIOR TO COMMENCING WORK.

- WN1 REPLACE THE EXISTING LEAD SERVICE WITH A NEW COPPER SERVICE.
- WN2 EXTEND AND RECONNECT THE EXISTING COPPER SERVICE TO THE NEW WATER MAIN.
- WN3 EXISTING SERVICE TO BE ABANDONED WHEN THE WATER MAIN IS CUT OFF.
- WN4 DISCONNECT FROM THE OLD WATER MAIN AND RECONNECT THE EXISTING COPPER WATER SERVICE LATERAL TO THE NEW WATER MAIN.
- WN5 RELOCATE THE EXISTING FIRE HYDRANT.
- WN6 ABANDON WATER VALVE ACCESS STRUCTURE.
- WN7 FURNISH AND INSTALL THE NEW TOP SECTION FOR THE WATER ACCESS STRUCTURE.
- WN8 ABANDON THE VALVE BOX.
- WN9 FURNISH THE DITCH, COMPACTION, AND ALL MATERIALS AND LABOR FOR THE INSTALLATION OF NEW SERVICE LATERAL.
- WN10 REMOVE AND SALVAGE EXISTING HYDRANT
- WN11 REPLACE THE EXISTING COPPER SERVICE WITH A COPPER SERVICE
- WN20+ SEE WATER IMPACT PLAN FOR CONNECTION POINT ISOLATION AND WATER SHUT-OFF NOTIFICATION INFORMATION

TO OBTAIN LOCATION OF PARTICIPANTS' UNDERGROUND FACILITIES BEFORE YOU DIG IN WISCONSIN
CALL DIGGERS HOTLINE TOLL FREE
811 OR 1-800-242-8511
FAX-A-LOCATE 1-800-338-3860
TDD (FOR HEARING IMPAIRED) 1-800-542-2289

WIS. STATUTE 182.0175 (1974) REQUIRES MIN. OF 3 WORK DAYS NOTICE BEFORE YOU EXCAVATE.

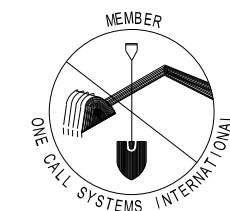

ESTIMATE OF MATERIALS SUPPLIED BY CONTRACTOR:

* ESTIMATE OF MATERIALS IS FOR INFORMATION ONLY. ENGINEER DOES NOT GUARANTEE ACCURACY OF MATERIAL TAKE-OFF.

- | | |
|-----------------------|---|
| 20-FT - 4-IN PIPE | 1 - 8-IN 45° BEND |
| 40-FT - 6-IN PIPE | 1 - 4-IN 22.5° BEND |
| 900-FT - 8-IN PIPE | 4 - 8-IN 22.5° BEND |
| 50-FT - 16-IN PIPE | 1 - 16-IN 22.5° BEND |
| 1160-FT - POLYWRAP | 1 - 8-IN X 6-IN REDUCER |
| 1 - 4-IN VALVE & BOX | 1 - 6-IN MJ CAP |
| 3 - 6-IN VALVE & BOX | 2 - 8-IN MJ CAP |
| 4 - 8-IN VALVE & BOX | 1 - 16-IN MJ CAP |
| 1 - 16-IN VALVE & BOX | 1 - 8-IN MJ PLUG |
| 1 - 8-IN X 4-IN TEE | 2 - 5-IN HYDRANT |
| 2 - 8-IN X 6-IN TEE | 16 - LF 2-IN FOAM INSULATION |
| 2 - 8-IN X 8-IN TEE | COPPER SERVICE TUBING & COUPLINGS (AS REQ'D) |
| 1 - 16-IN X 16-IN TEE | HYDRANT OR VALVE BOX RISERS/EXTENSIONS (AS REQ'D) |

ESTIMATE OF MATERIALS SUPPLIED BY CITY:

* ESTIMATE OF MATERIALS IS FOR INFORMATION ONLY. ENGINEER DOES NOT GUARANTEE ACCURACY OF MATERIAL TAKE-OFF.

- 1 - 8-IN TAPPING SLEEVE
- 1 - 8-IN TAPPING VALVE

ESTIMATE OF MATERIALS SALVAGED:

* ESTIMATE OF MATERIALS IS FOR INFORMATION ONLY. ENGINEER DOES NOT GUARANTEE ACCURACY OF MATERIAL TAKE-OFF.

NONE

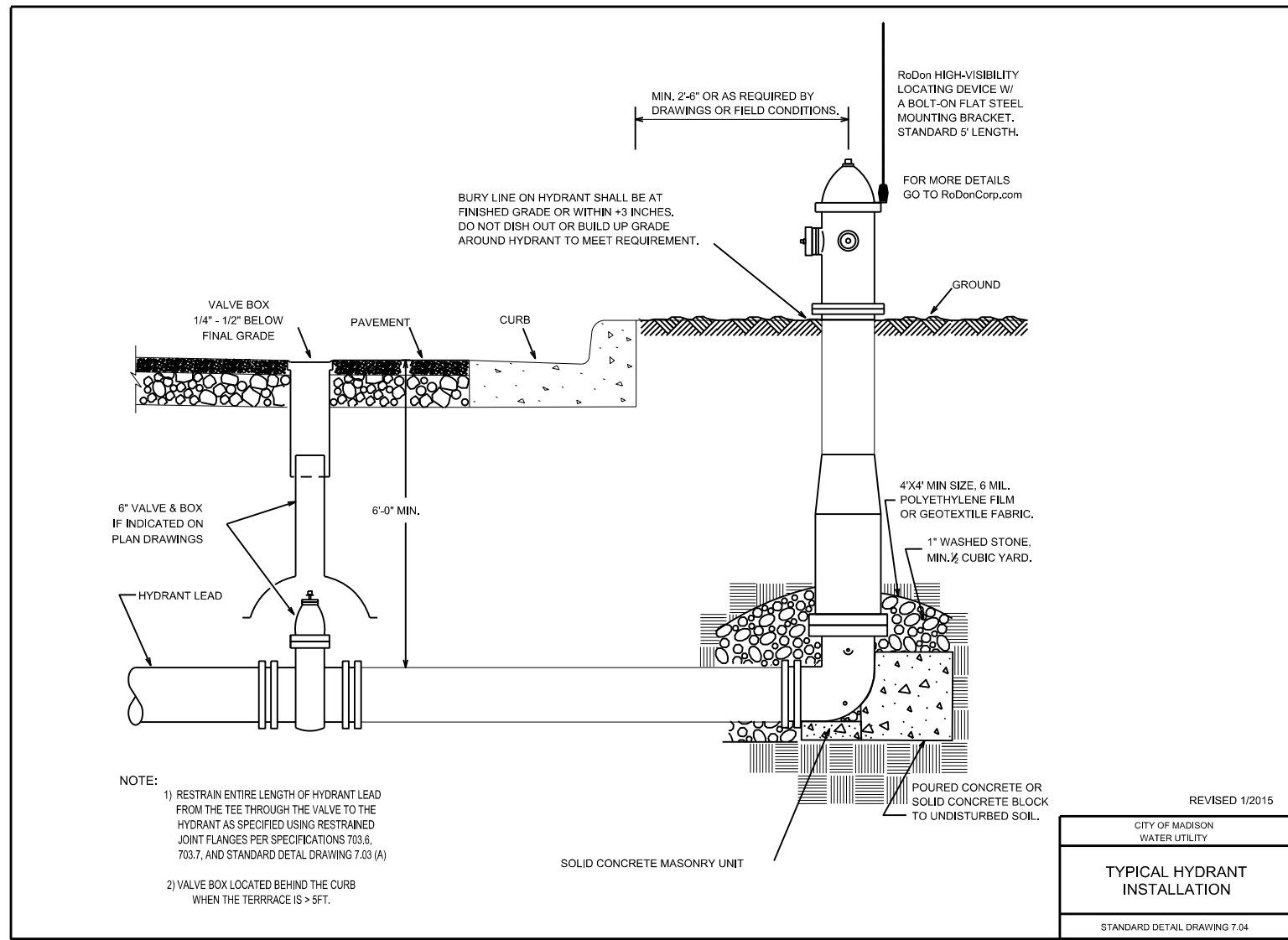

- NOTE:
- 1) RESTRAIN ENTIRE LENGTH OF HYDRANT LEAD FROM THE TEE THROUGH THE VALVE TO THE HYDRANT AS SPECIFIED USING RESTRAINED JOINT FLANGES PER SPECIFICATIONS 703.6, 703.7, AND STANDARD DETAIL DRAWING 7.03 (A)
 - 2) VALVE BOX LOCATED BEHIND THE CURB WHEN THE TERRACE IS > 5FT.

REVISED 1/2015

CITY OF MADISON WATER UTILITY
TYPICAL HYDRANT INSTALLATION
STANDARD DETAIL DRAWING 7.04

PLOT SCALE: _____ REV. DATE: _____ ORIGINATOR: CITY OF MADISON, STREETS DIVISION

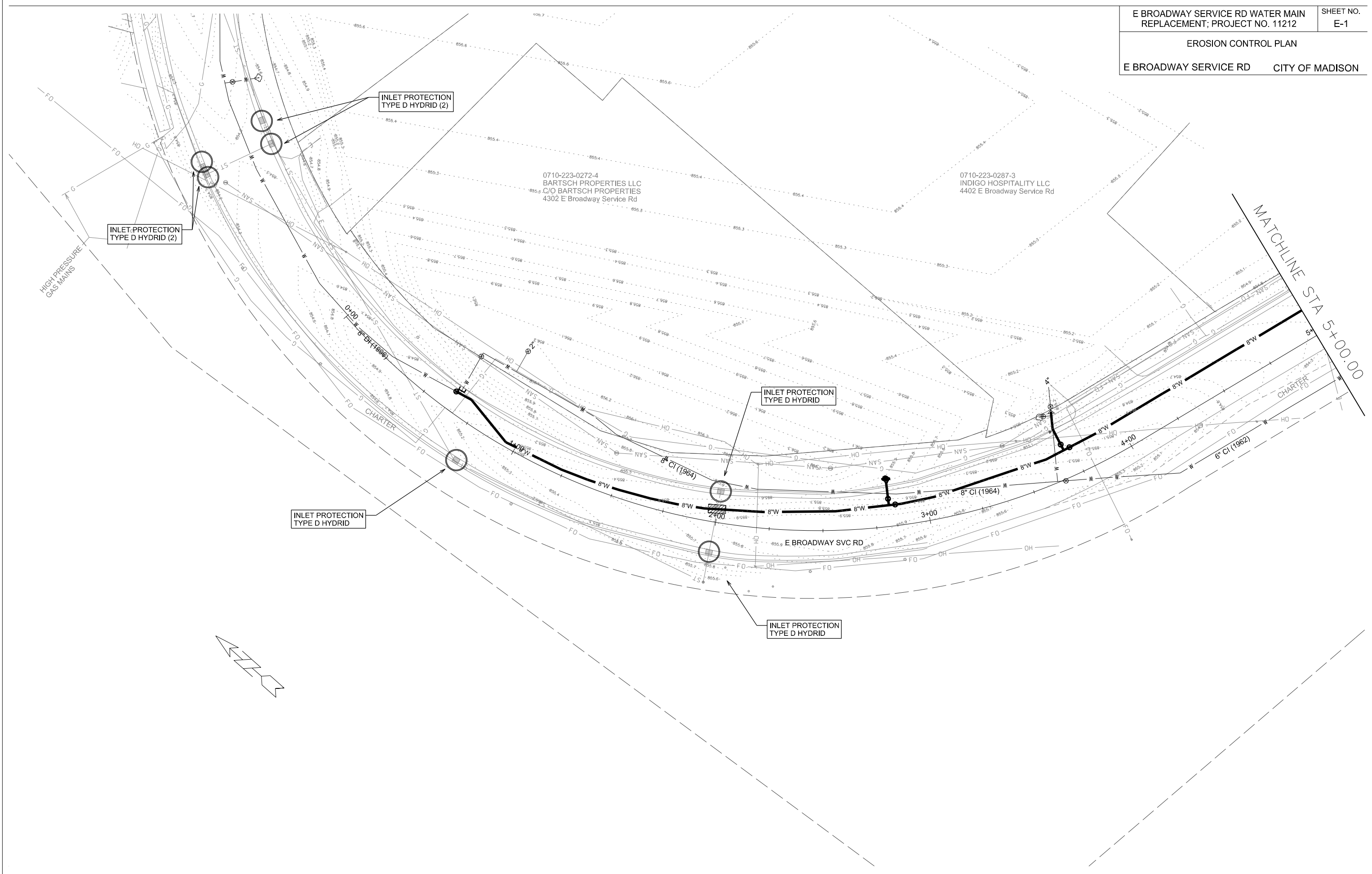

PLOT SCALE: _____

PLOT NAME: _____

REV. DATE: _____

ORIGINATOR: CITY OF MADISON, STREETS DIVISION

0710-223-0279-0
ENGBRING LLC, PAT & JERRY
4506 E Broadway Service Rd

0710-223-0286-5
PAINTER PROPERTIES LLC
4516 E Broadway Service Rd

0710-223-0275-8
SUMMIT CREDIT UNION
4538 E Broadway Service Rd



MATCHLINE STA 5+00.00

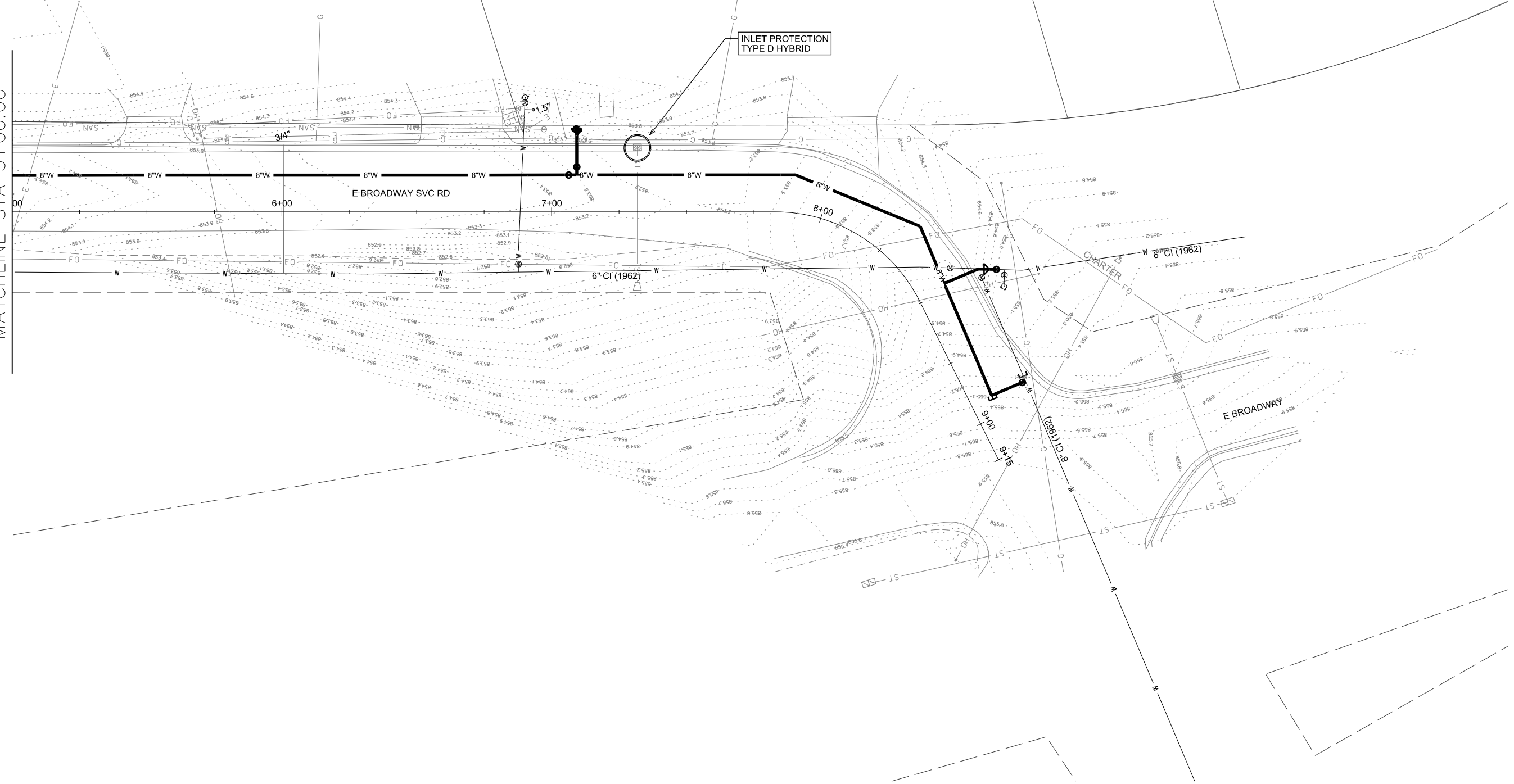

PLOT SCALE: _____

PLOT NAME: _____

REV. DATE: _____

ORIGINATOR: CITY OF MADISON, STREETS DIVISION

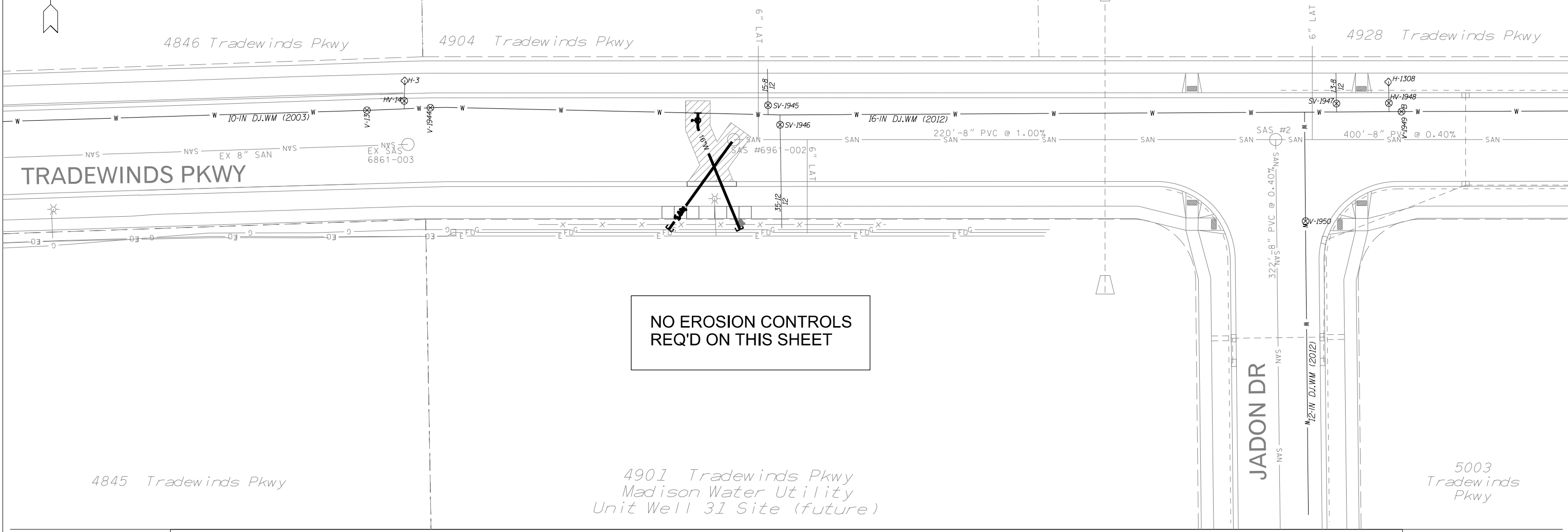
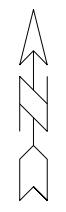

**NO EROSION CONTROLS
 REQ'D ON THIS SHEET**

4901 Tradewinds Pkwy
 Madison Water Utility
 Unit Well 31 Site (future)

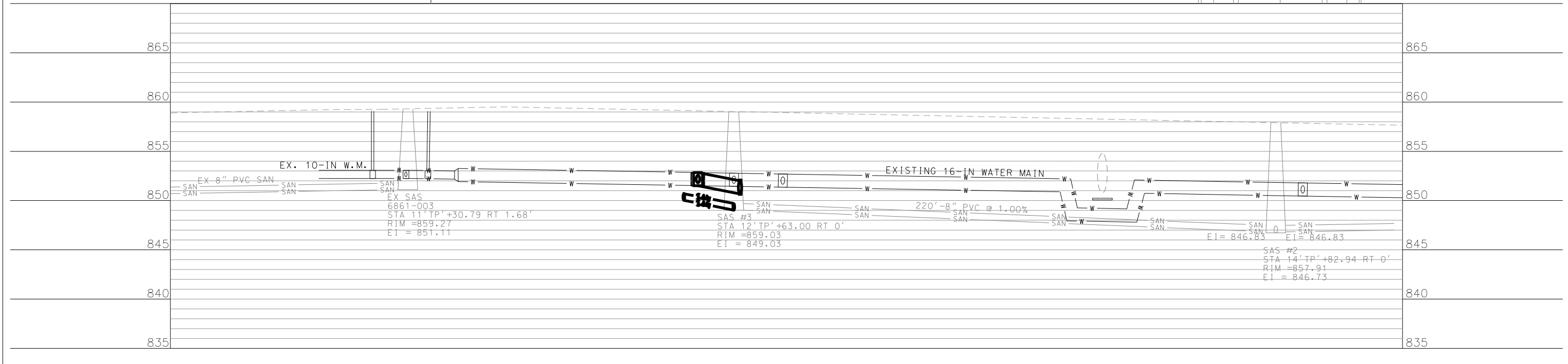

ORIGINATOR: CITY OF MADISON, STREETS DIVISION