

Madison, Wisconsin

# CITY OF MADISON

## CITY ENGINEERING DIVISION

### DEPARTMENT OF PUBLIC WORKS

## PLAN OF PROPOSED IMPROVEMENTS

### CORPORATE DRIVE GREENWAY

CITY PROJECT NO. 10986  
CONTRACT NO. 7980

PUBLIC IMPROVEMENT PROJECT APPROVED  
MAY 16, 2017  
BY THE COMMON COUNCIL  
OF MADISON, WISCONSIN

PUBLIC IMPROVEMENT DESIGN  
APPROVED BY:  
  
City Engineer Date 6/6/17

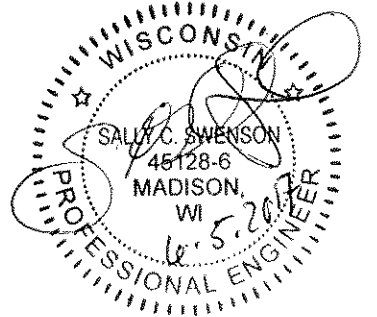
STORM SEWER DESIGNED BY:  

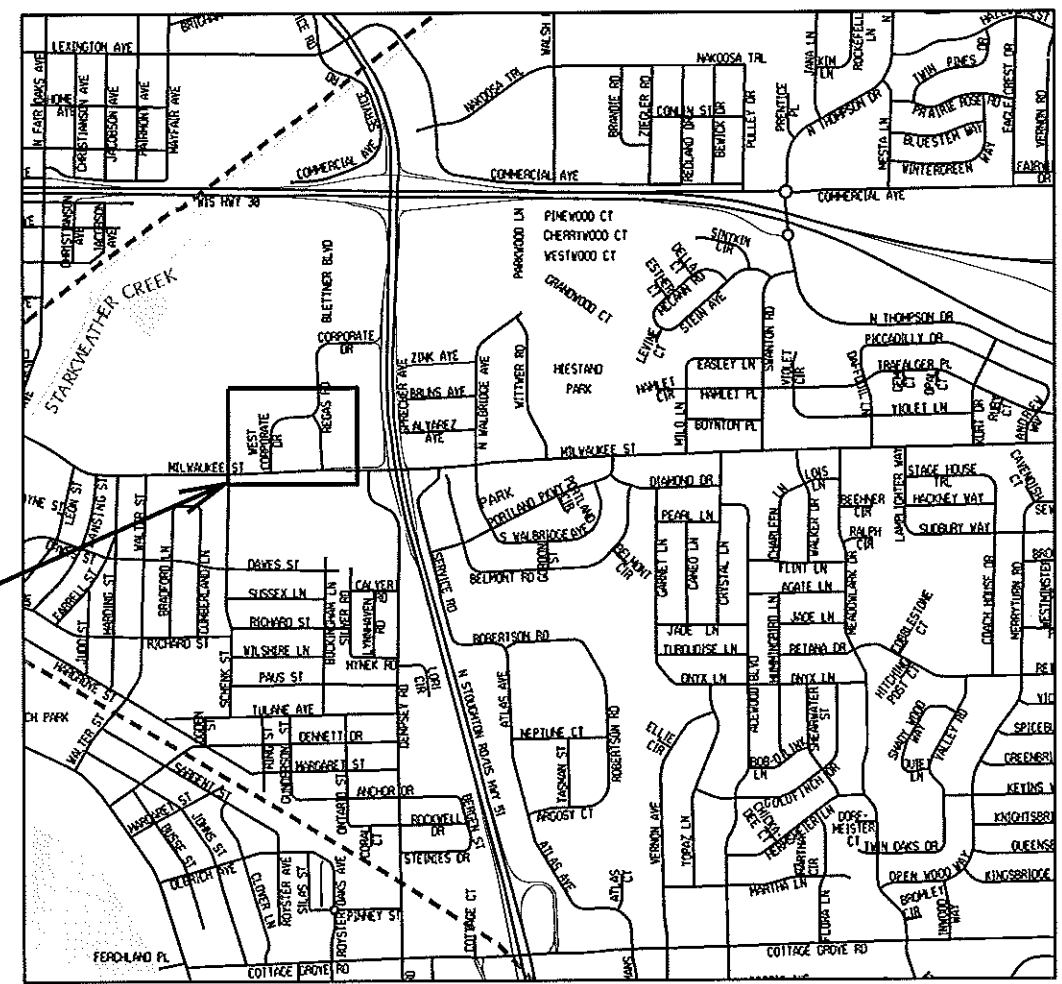
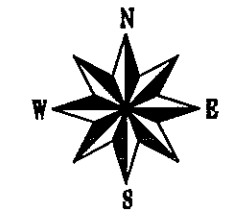

PROJECT  
LOCATION

INDEX OF SHEETS

SHEET NO.	NA	TITLE SHEET
SHEET NO. 1	EXISTING CONDITIONS & LAYDOWN AREA	
SHEET NO. 2	EROSION CONTROL PLAN	
SHEET NO. 3-4	DETAILS	
SHEET NO. 5	GRADING PLAN	
SHEET NO. 6	STORM SCHEDULE	
SHEET NO. XI-XIX	CROSS-SECTIONS	

CONVENTIONAL SIGNS

FIELD VERIFY ALL UTILITY LOCATIONS

GAS	— G —
STORM SEWER	— ST —
SANITARY SEWER	— SAN —
WATER	— W —
OVERHEAD ELECTRIC	— OH —
POWER POLE	⊕

EARTH WORK SUMMARY:  
EXCAVATION CUT - CHANNEL (MEASURED PLAN QUANTITY).....2,150 C.Y.

PLOT SCALE: \_\_\_\_\_  
PLOT NAME: \_\_\_\_\_  
REV. DATE: \_\_\_\_\_  
ORIGINATOR: CITY OF MADISON, STREETS DIVISION



PLOT SCALE: \_\_\_\_\_

PLOT NAME: \_\_\_\_\_

REV. DATE: \_\_\_\_\_

ORIGINATOR: CITY OF MADISON, STREETS DIVISION

EROSION CONTROL PLAN

CITY OF MADISON

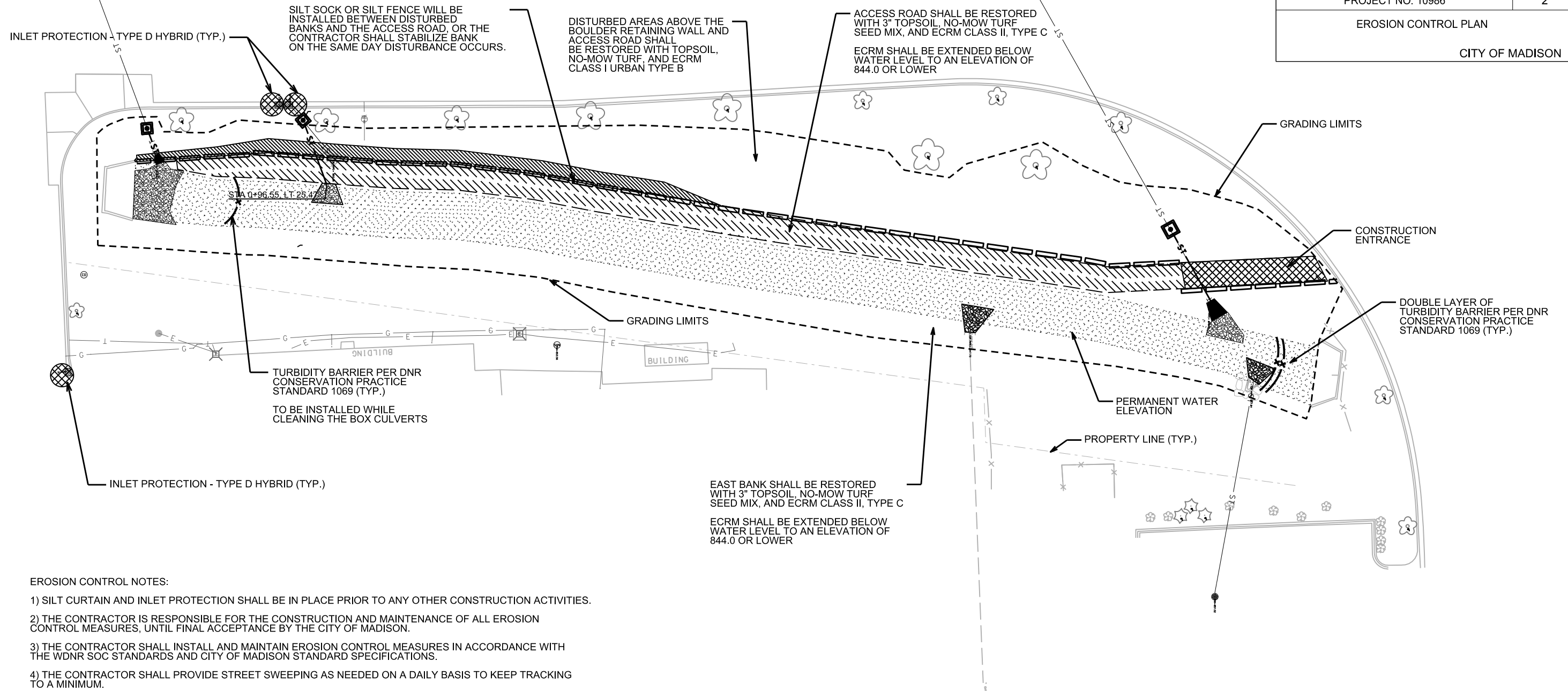

EROSION CONTROL NOTES:

- 1) SILT CURTAIN AND INLET PROTECTION SHALL BE IN PLACE PRIOR TO ANY OTHER CONSTRUCTION ACTIVITIES.
- 2) THE CONTRACTOR IS RESPONSIBLE FOR THE CONSTRUCTION AND MAINTENANCE OF ALL EROSION CONTROL MEASURES, UNTIL FINAL ACCEPTANCE BY THE CITY OF MADISON.
- 3) THE CONTRACTOR SHALL INSTALL AND MAINTAIN EROSION CONTROL MEASURES IN ACCORDANCE WITH THE WDNR SOC STANDARDS AND CITY OF MADISON STANDARD SPECIFICATIONS.
- 4) THE CONTRACTOR SHALL PROVIDE STREET SWEEPING AS NEEDED ON A DAILY BASIS TO KEEP TRACKING TO A MINIMUM.
- 5) THE CONTRACTOR SHALL BE RESPONSIBLE FOR ALL STORM WATER CONTROL MEASURES NECESSARY WITHIN THE CHANNEL AND ASSOCIATED DRAINAGES.
- 6) POLYMER SHALL BE APPLIED TO THE AREAS AS DIRECTED BY THE CONSTRUCTION ENGINEER.
- 7) THE CONTRACTOR SHALL NOT STOCKPILE MATERIAL OR STORE EQUIPMENT WITHIN THE CHANNEL.
- 8) SILT CURTAIN SHALL BE INSTALLED AS SHOWN IN THE PLAN SET, OR AS DIRECTED BY THE CONSTRUCTION ENGINEER.
- 9) THE CONTRACTOR SHALL EITHER INSTALL SILT SOCK OR SILT FENCE BETWEEN DISTURBED SLOPES AND THE CHANNEL, OR SHALL STABILIZED CHANNEL BANKS ON THE SAME DAY THAT DISTURBANCE OCCURS.
- 10) THE CONTRACTOR SHALL INSTALL SILT SOCK OR SILT FENCE AT THE DIRECTION OF THE CONSTRUCTION ENGINEER.
- 11) ALL EROSION CONTROL MATTING SHALL BE OVERLAPPED IN A MANNER THAT CORRESPONDS WITH THE FLOW DIRECTION IN THE CHANNEL.
- 12) ADDITIONAL INLET PROTECTION MAY BE REQUIRED OUTSIDE THE LIMITS OF THIS SHEET.
- 13) THE CONTRACTOR SHALL CLEAN THE MILWAUKEE STREET BOX CULVERTS PRIOR TO DREDGING THE CHANNEL.
- 14) WITH THE EXCEPTION OF DREDGING AS NECESSARY TO CLEAN THE MILWAUKEE STREET CULVERTS, THE CONTRACTOR SHALL START AT THE DOWNSTREAM END OF THE CHANNEL AND WORK THEIR WAY UPSTREAM.

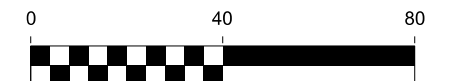
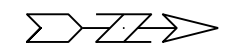

PLOT SCALE: \_\_\_\_\_

PLOT NAME: \_\_\_\_\_

REV. DATE: \_\_\_\_\_

ORIGINATOR: CITY OF MADISON, STREETS DIVISION

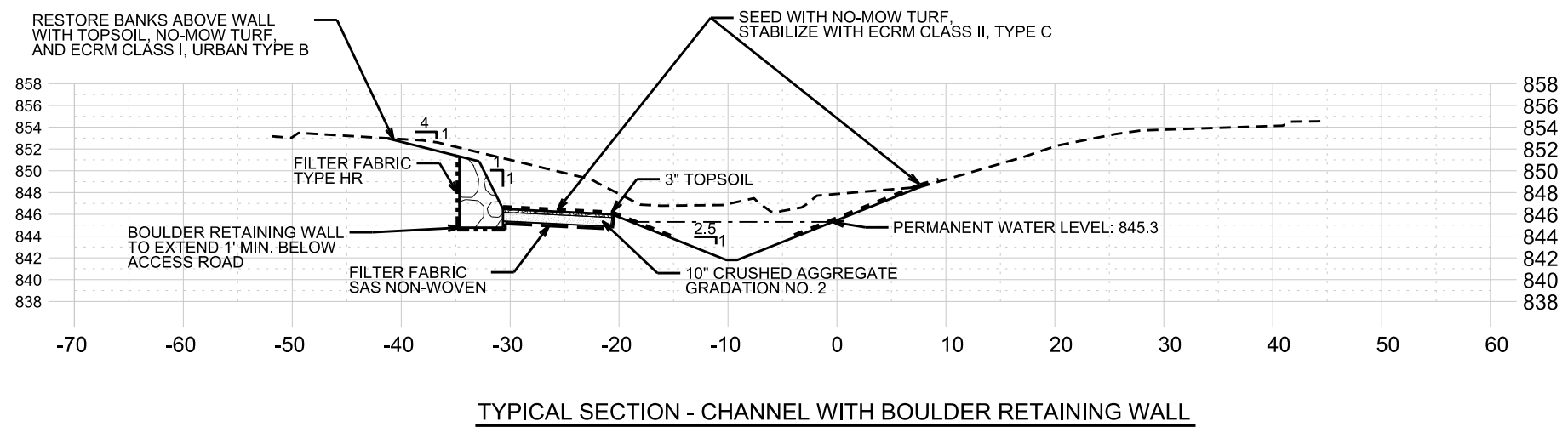
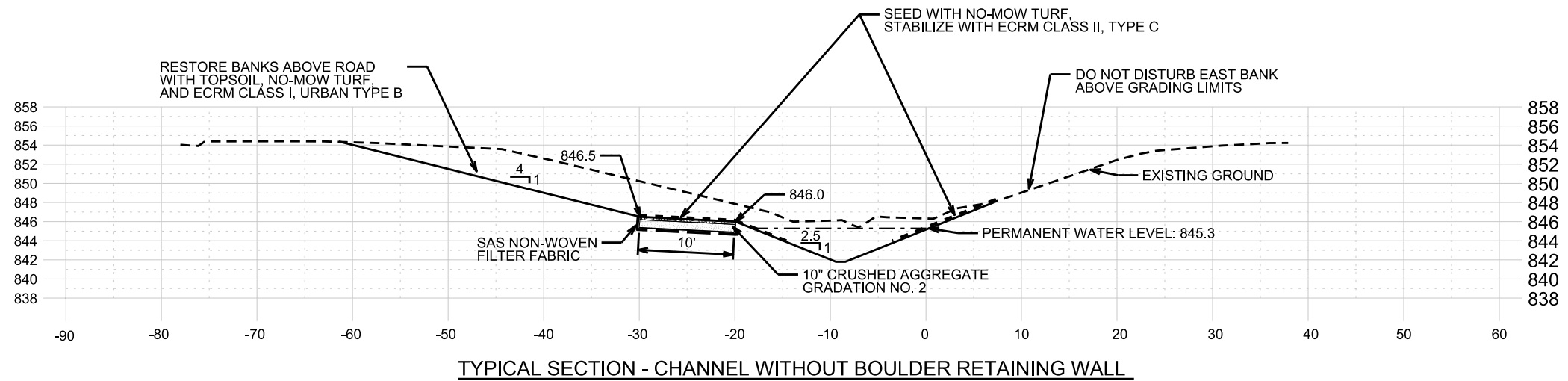
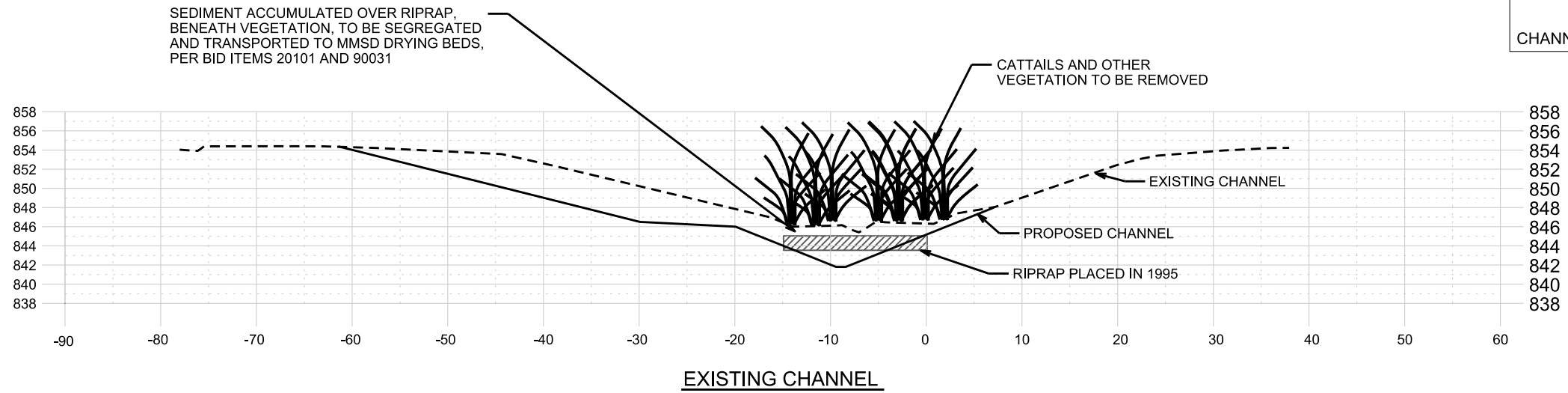

PLOT SCALE: \_\_\_\_\_

PLOT NAME: \_\_\_\_\_

REV. DATE: \_\_\_\_\_

ORIGINATOR: CITY OF MADISON, STREETS DIVISION

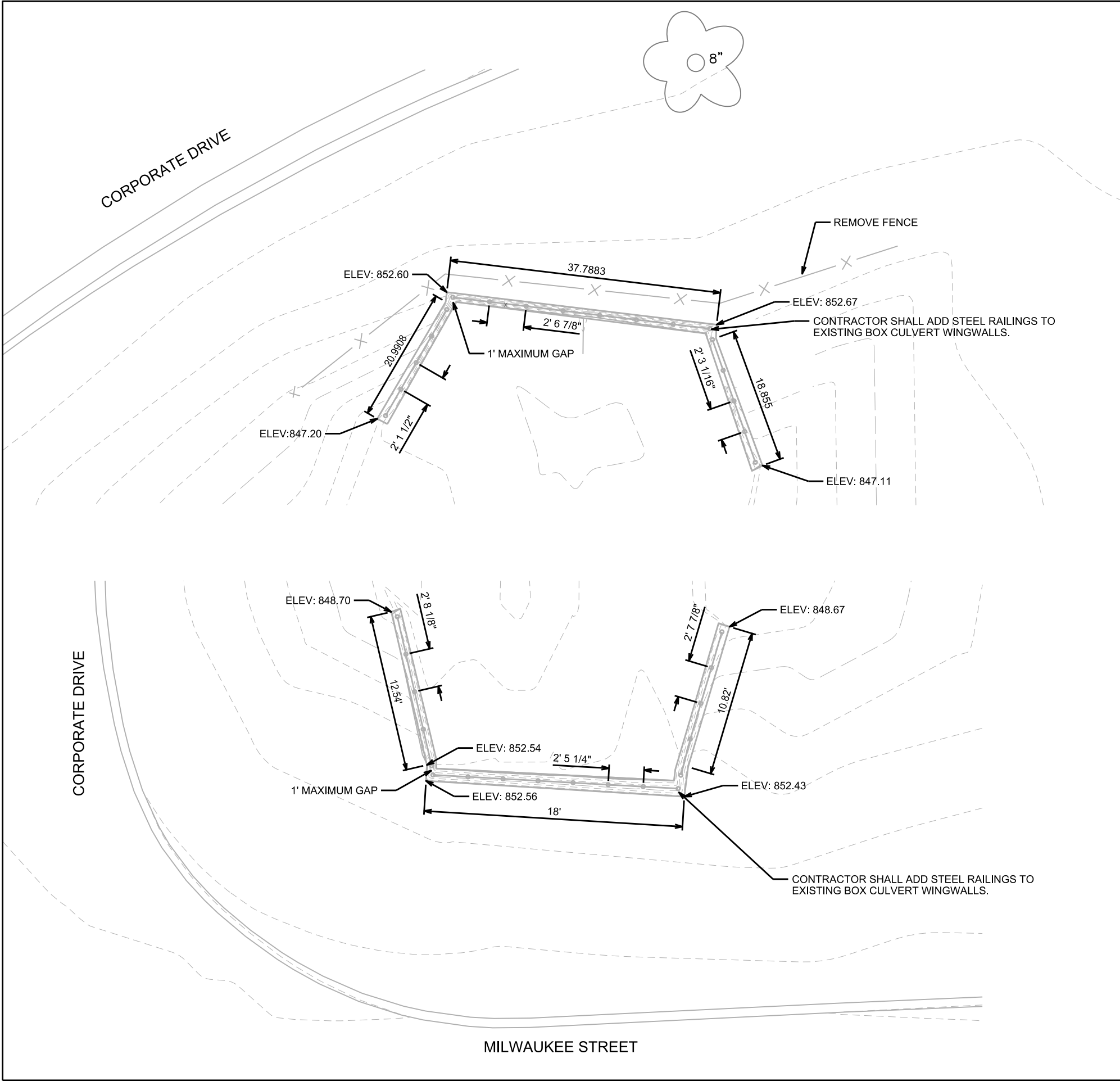

**GUARD RAIL DETAILS**

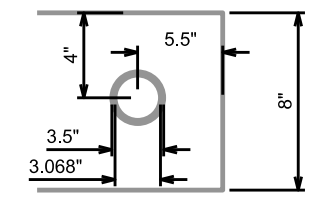

**STRUCTURAL STEEL SLEEVE - TOP VIEW**

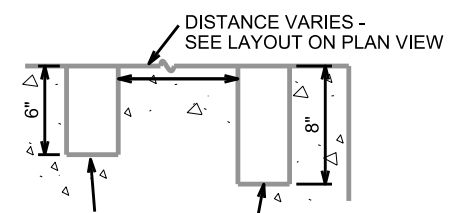

**STRUCTURAL STEEL SLEEVE - SIDE VIEW**

**STRUCTURAL STEEL TUBING - SIDE VIEW**

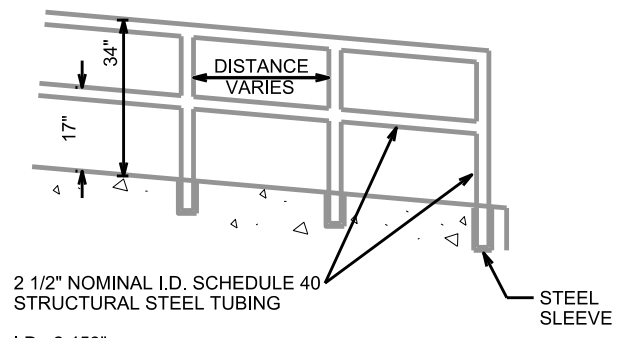

2 1/2" NOMINAL I.D. SCHEDULE 40 STRUCTURAL STEEL TUBING  
 I.D.: 2.459"  
 O.D.: 2.875"  
 NOTE:  
 ON SLOPED WINGWALLS, THE POSTS SHOULD REMAIN VERTICAL. SLOPE RAILS TO MATCH WINGWALLS.

**GENERAL RAILING NOTES:**  
 GUARD RAIL SHALL BE CONSTRUCTED OF SCHEDULE 40, GALVANIZED STEEL  
 ALL PIPES SHALL BE CUT TO FIT AND JOINTS SHALL BE WELDED CONTINUOUSLY AROUND THE PERIMETER WITH A TYPE 3 WELD, TO ASSURE A BURR FREE AND STRUCTURALLY SOUND CONNECTION.  
 THE GUARD RAIL SHALL NOT BE FABRICATED UNTIL THE STEEL SLEEVES ARE IN PLACE. THE ACTUAL DIMENSIONS, AS MEASURED IN THE FIELD, SHALL BE UTILIZED TO CONSTRUCT THE GUARD RAILS.

PLOT SCALE: \_\_\_\_\_  
 PLOT NAME: \_\_\_\_\_  
 REV. DATE: \_\_\_\_\_  
 ORIGINATOR: CITY OF MADISON, STREETS DIVISION

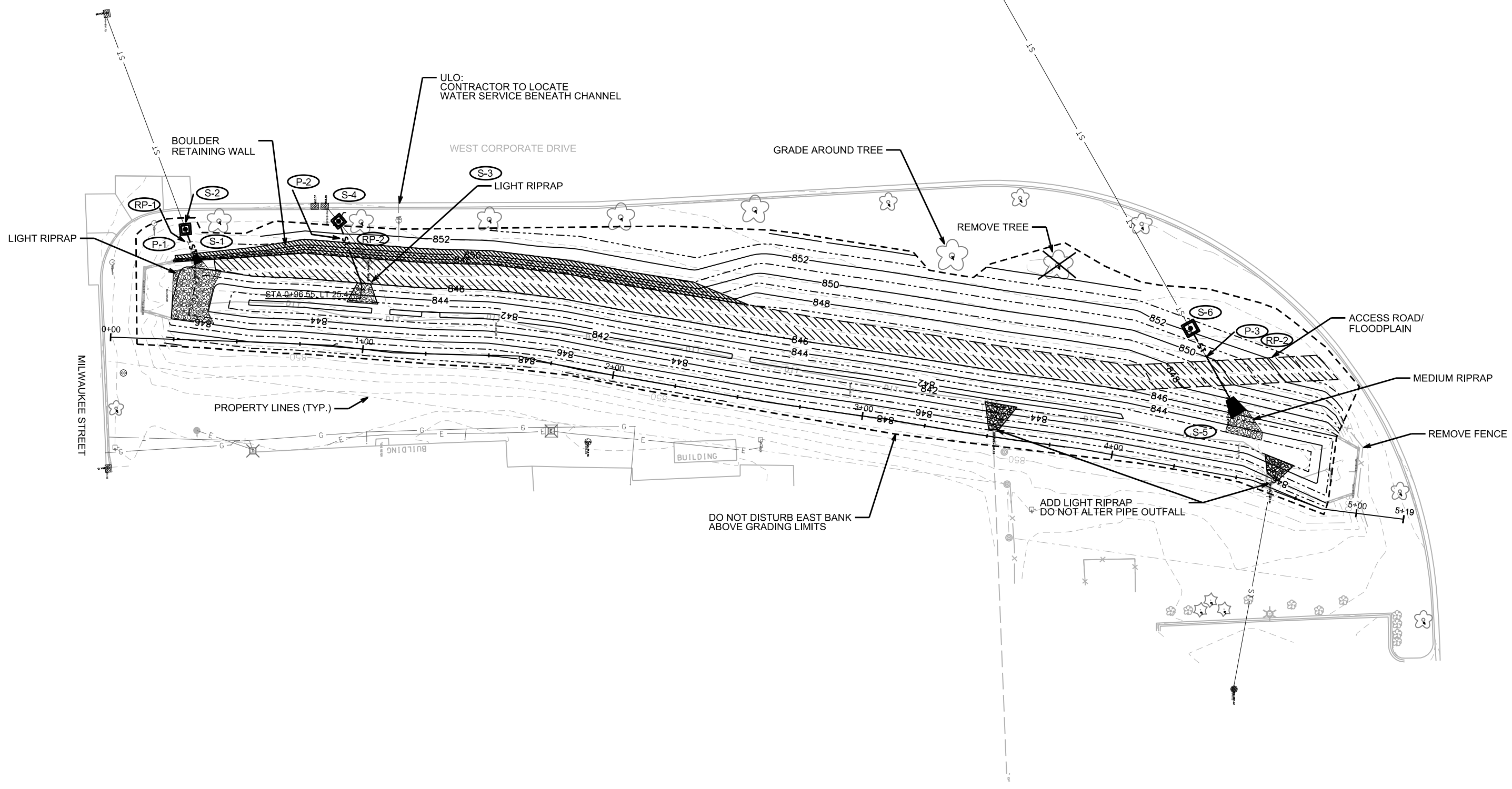

PLOT SCALE: \_\_\_\_\_  
 PLOT NAME: \_\_\_\_\_  
 REV. DATE: \_\_\_\_\_

ORIGINATOR: CITY OF MADISON, STREETS DIVISION

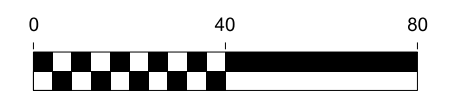
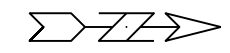

# STORM SEWER SCHEDULE

## STRUCTURES

STRUC. NO.	STATION	LOCATION (OFFSET)	TYPE	TOP OF CASTING	E.I.	DEPTH	NOTES
S-1	0+33.76	LT-30.40	15" APRON ENDWALL	--	846.00	--	(1)
S-2	0+28.14	LT-43.73	3X3 SAS	852.25	846.00	6.25	W/ R-1878-A10G, FP
S-3	0+96.55	LT-25.47	NO STRUCTURE	--	843.60	--	(2)
S-4	0+88.15	LT-49.29	3X3 SAS	853.05	843.60	9.45	W/ R-1878-A10G, FP, (3), (4)
S-5	4+46.53	LT-24.70	36" APRON ENDWALL	--	844.50	--	(1)
S-6	4+21.65	LT-54.78	4X4 SAS	852.10	844.50	--	W/ R-1878-A10G, FP

## PIPES

PIPE NO.	FROM (DNSTM)	TO (UPSTM)	DISCH. E.I.	INLET E.I.	PLAN LGTH FT	PIPE LGTH FT	SLOPE (%)	PIPE SIZE	TYPE	NOTES
P-1	S-1	S-2	846.00	846.00	14.50	12.9	0.00%	15"	RCP	
P-2	S-3	S-4	843.60	843.60	26.60	25	0.00%	18"	RCP	
P-3	S-5	S-6	844.50	844.50	39.00	37	0.00%	36"	RCP	

## STORM PIPE REMOVALS

PIPE NO.	REMOVE FROM	REMOVE TO	LENGTH (FT)	PAID (Y/N)	PIPE SIZE	TYPE	NOTES
RP-1	S-2	S-1	14	N	15"	RCP	
RP-2	S-4	AE 6339-002	21	Y	18"	RCP	
RP-3	S-6	S-5	39	N	36"	RCP	

## SPECIFIC NOTES

- (1) STATION AND OFFSET ARE TO DOWNSTREAM EDGE, CL OF APRON ENDWALL
- (2) PIPE DISCHARGES BELOW STANDING WATER LEVEL. RIPRAP TO BE PLACED AT OUTLET BELOW WATER LEVEL.
- (3) PIPE WALLS TO BE POURED INTO STRUCTURE WALLS
- (4) 3' SUMP TO BE INSTALLED BELOW INVERT OF STRUCTURE

## STANDARD NOTES:

- APPROXIMATE DISCHARGE E.I. GIVEN, ADJUST E.I. AND PIPE SLOPE IN THE FIELD.
- ALL REINFORCED CONCRETE PIPES TO BE CLASS III UNLESS OTHERWISE NOTED.
- SURVEYOR TO CONFIRM ALL STRUCTURE LOCATIONS
- ALL STRUCTURES CALLED OUT AS FIELD POURED SHALL BE FIELD POURED.
- ALL QUESTIONS CAN BE DIRECTED TO SALLY SWENSON AT SSWENSON@CITYOFMADISON.COM OR 608-266-4862

PLOT SCALE: \_\_\_\_\_

PLOT NAME: \_\_\_\_\_

REV. DATE: \_\_\_\_\_

ORIGINATOR: CITY OF MADISON, STREETS DIVISION

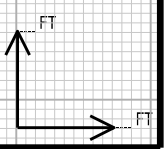
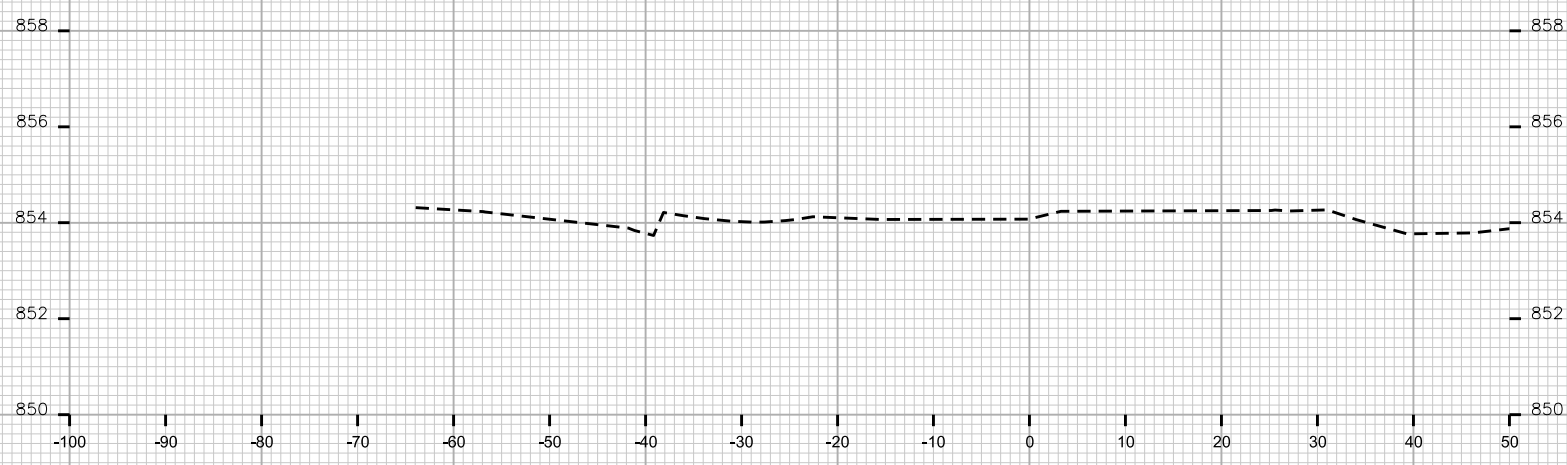
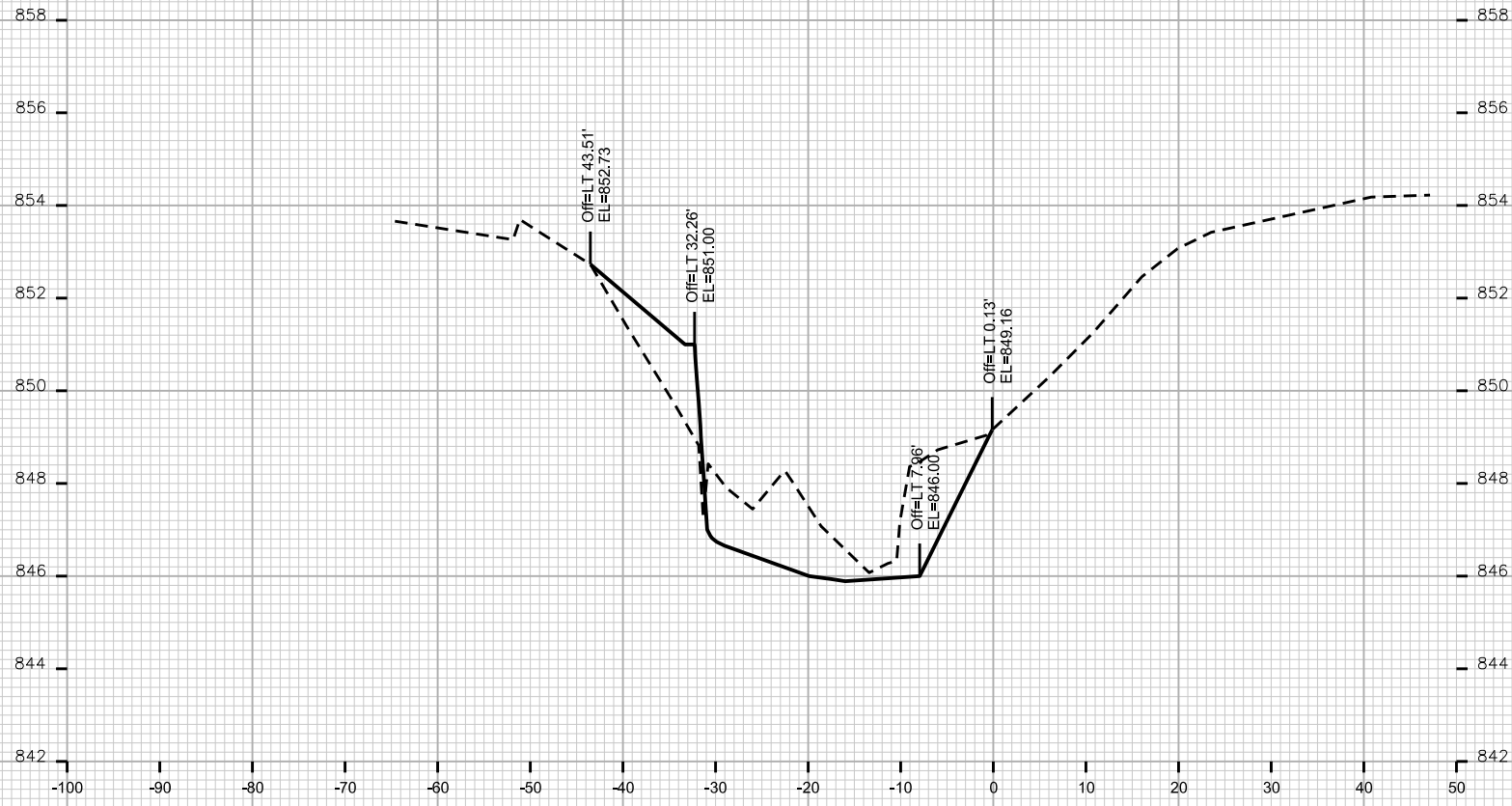



PLOT SCALE: \_\_\_\_\_

PLOT NAME: \_\_\_\_\_

REV. DATE: \_\_\_\_\_

ORIGINATOR: CITY OF MADISON, STREETS DIVISION

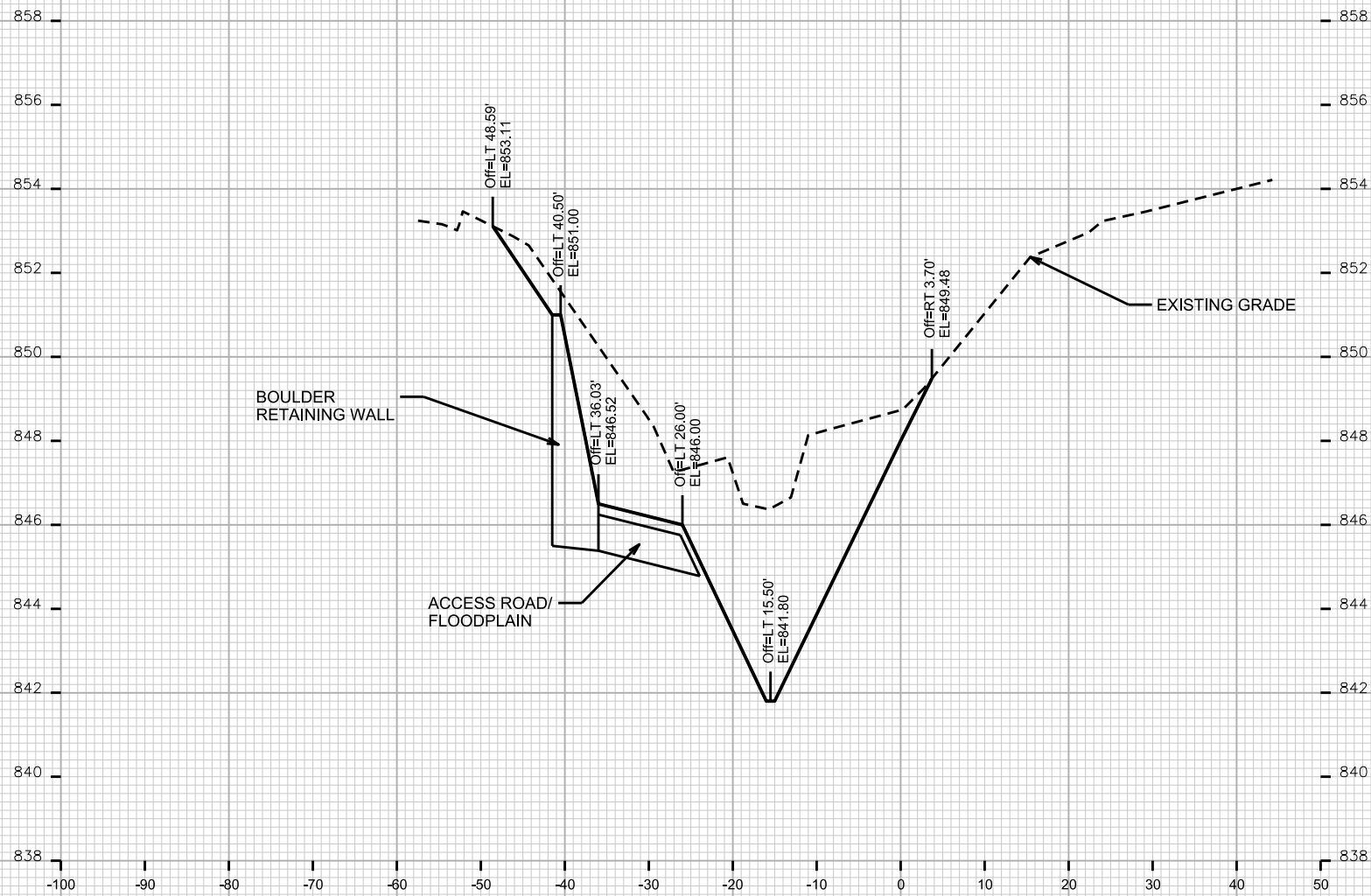

STA. 0+50

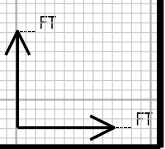

PLOT SCALE: \_\_\_\_\_

PLOT NAME: \_\_\_\_\_

REV. DATE: \_\_\_\_\_

ORIGINATOR: CITY OF MADISON, STREETS DIVISION

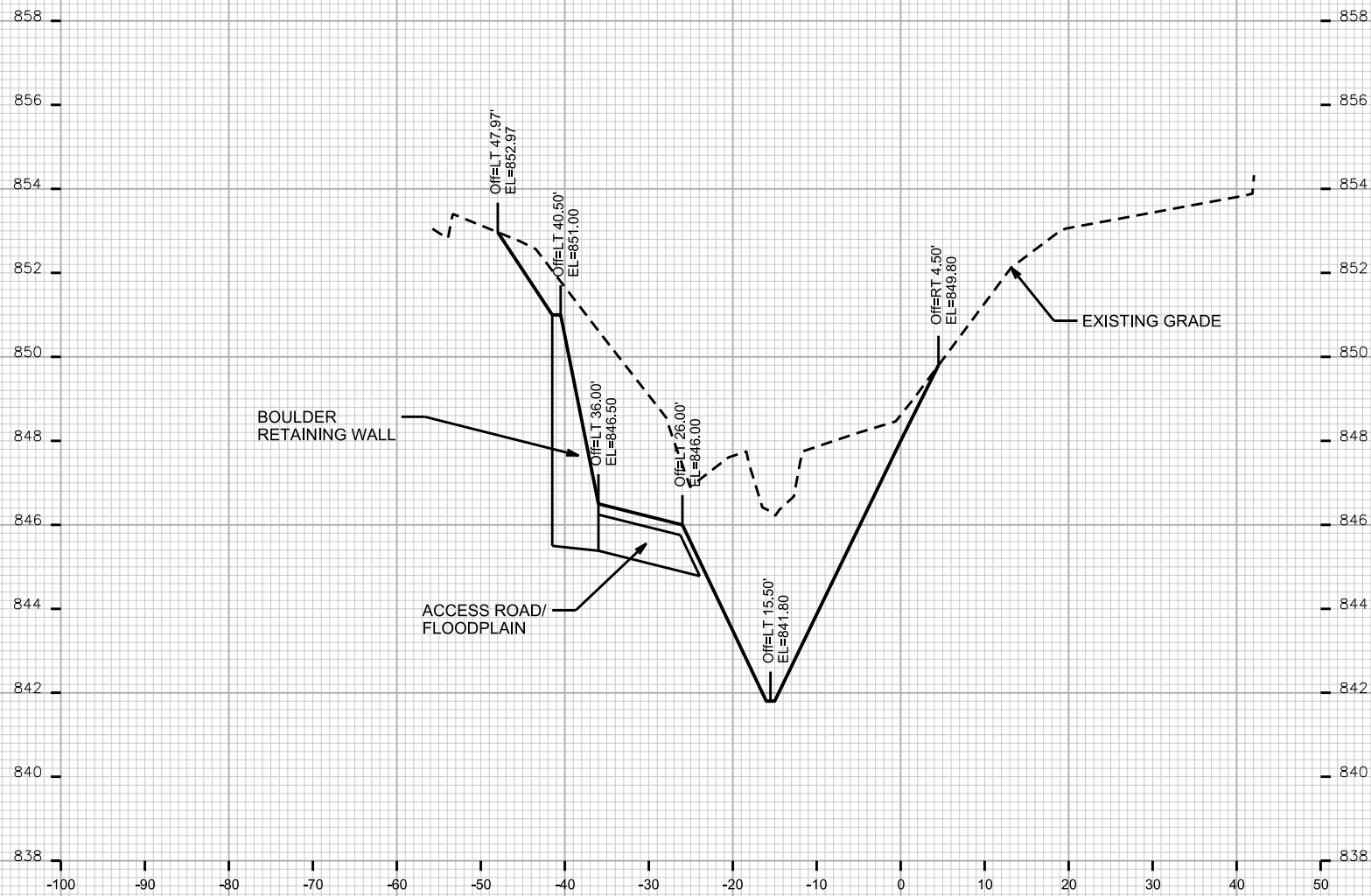

STA. 0+75

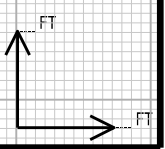

PLOT SCALE: \_\_\_\_\_

PLOT NAME: \_\_\_\_\_

REV. DATE: \_\_\_\_\_

ORIGINATOR: CITY OF MADISON, STREETS DIVISION

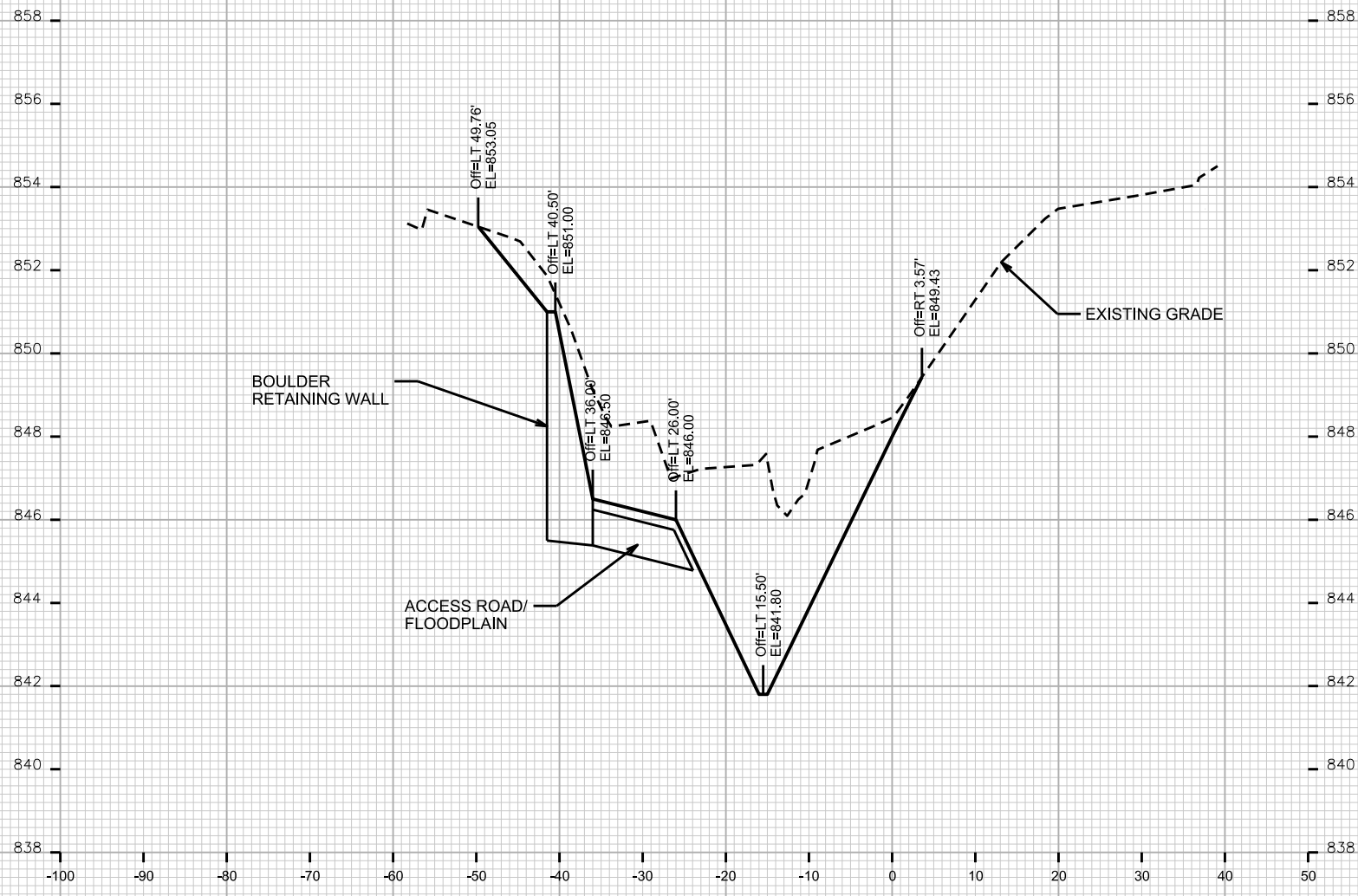

PLOT SCALE: \_\_\_\_\_

PLOT NAME: \_\_\_\_\_

REV. DATE: \_\_\_\_\_

ORIGINATOR: CITY OF MADISON, STREETS DIVISION

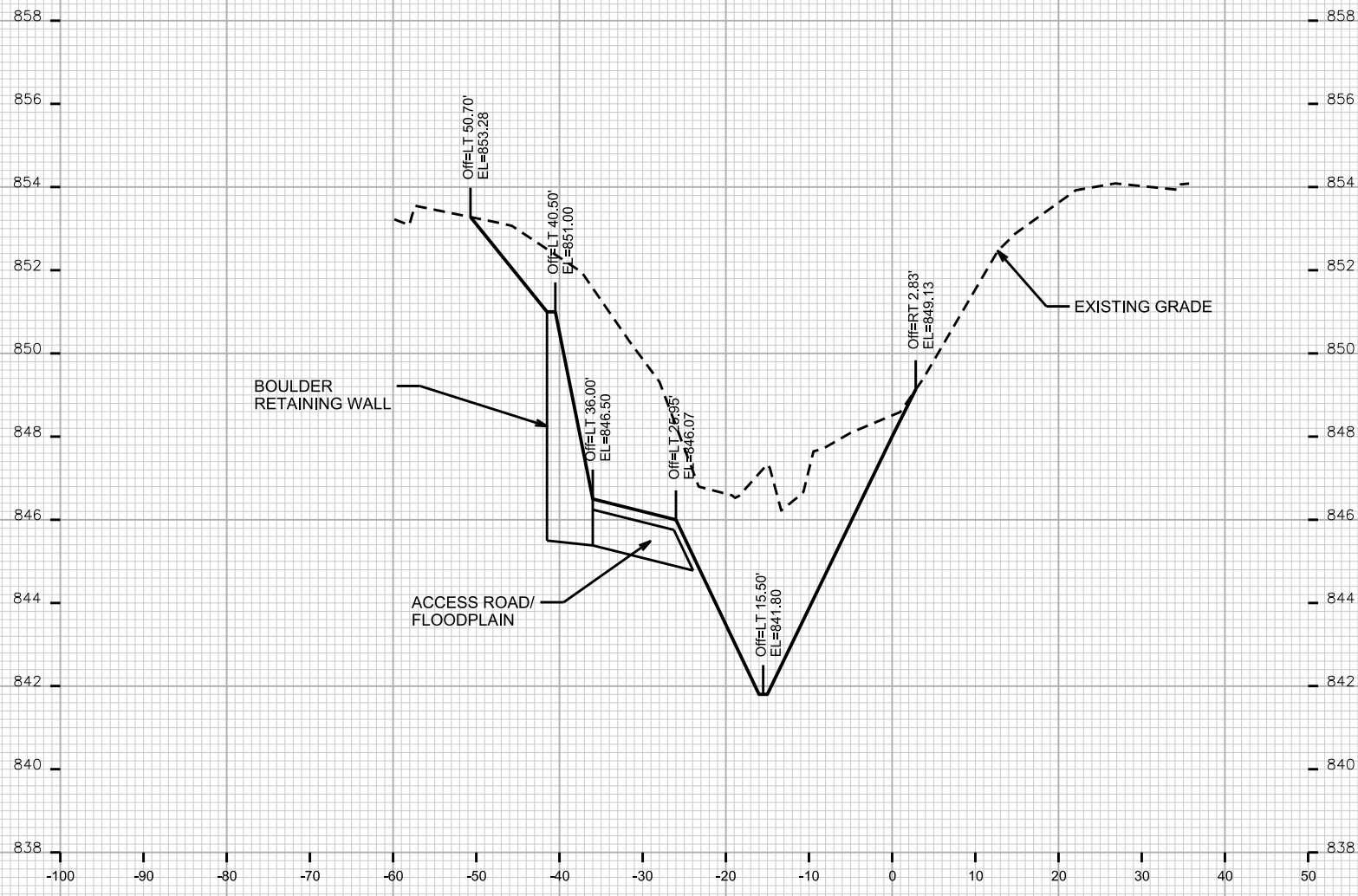

STA. 1+25

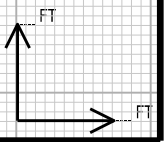

PLOT SCALE: \_\_\_\_\_

PLOT NAME: \_\_\_\_\_

REV. DATE: \_\_\_\_\_

ORIGINATOR: CITY OF MADISON, STREETS DIVISION

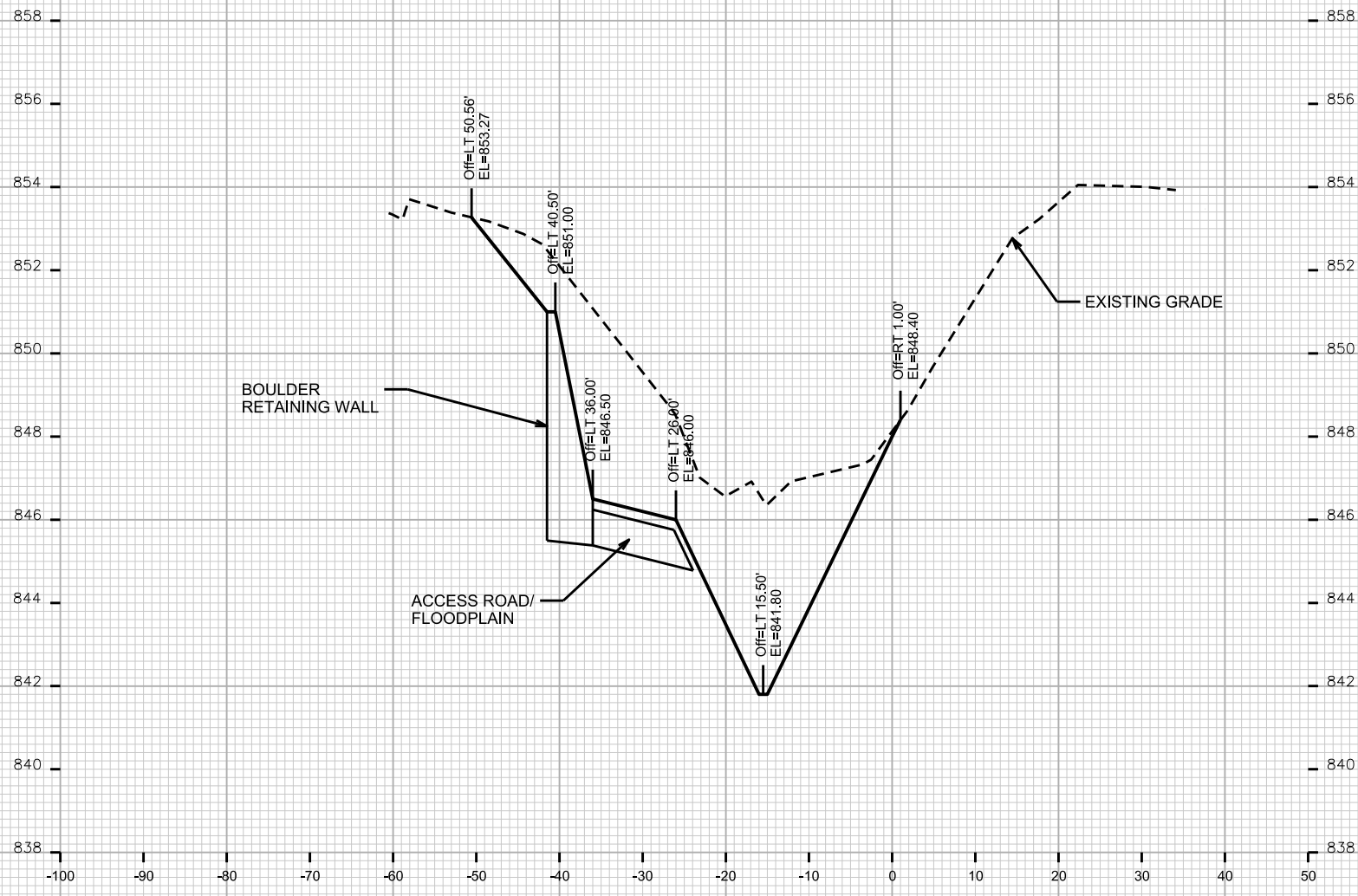

STA. 1+50

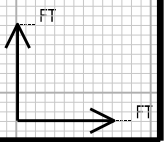

PLOT SCALE: \_\_\_\_\_

PLOT NAME: \_\_\_\_\_

REV. DATE: \_\_\_\_\_

ORIGINATOR: CITY OF MADISON, STREETS DIVISION

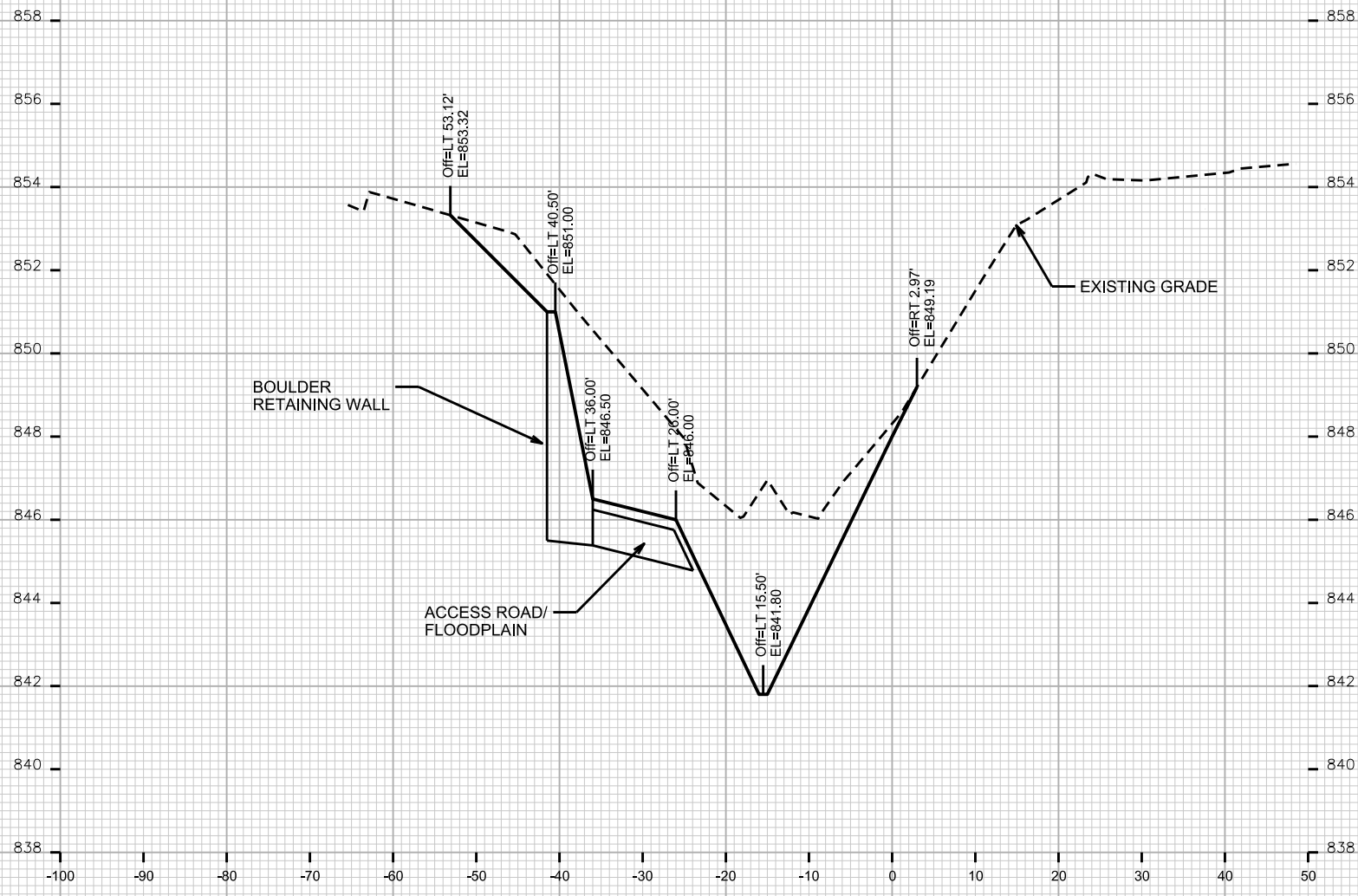

STA. 1+75

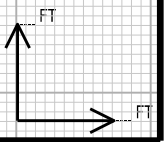

PLOT SCALE: \_\_\_\_\_

PLOT NAME: \_\_\_\_\_

REV. DATE: \_\_\_\_\_

ORIGINATOR: CITY OF MADISON, STREETS DIVISION

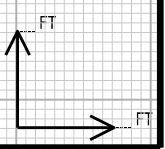
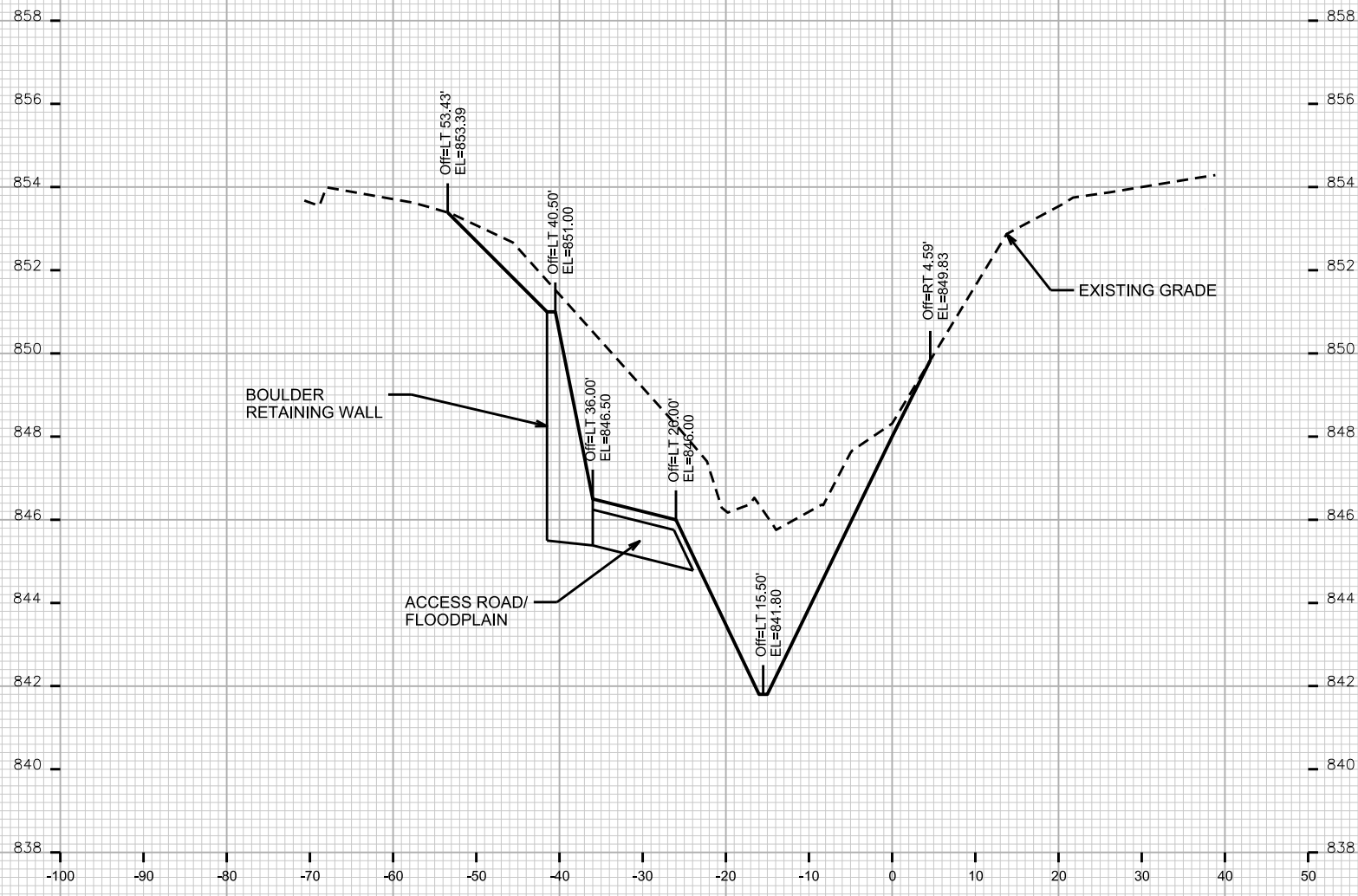

PLOT SCALE: \_\_\_\_\_

PLOT NAME: \_\_\_\_\_

REV. DATE: \_\_\_\_\_

ORIGINATOR: CITY OF MADISON, STREETS DIVISION

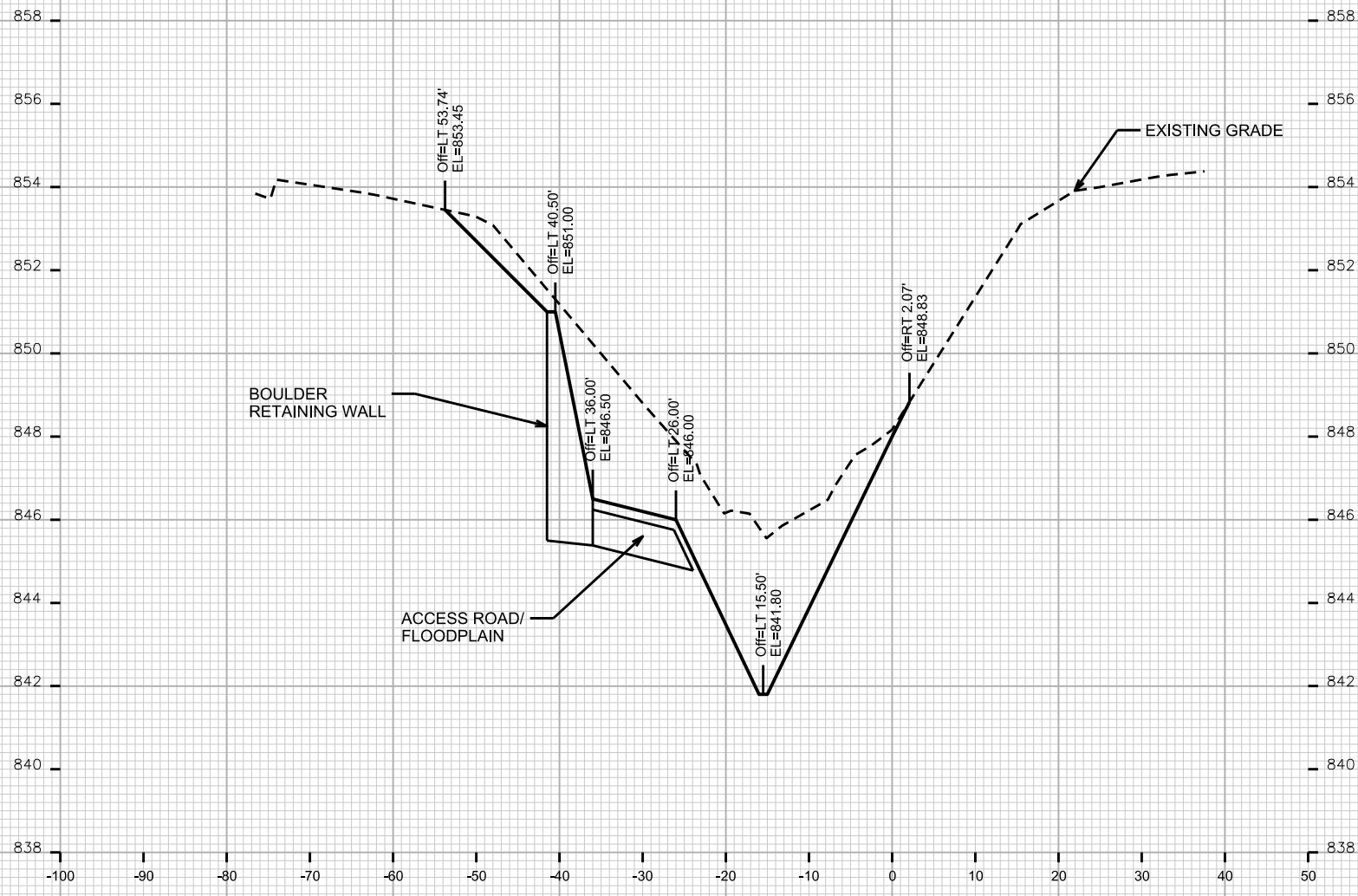

STA. 2+25

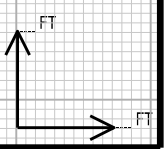



PLOT SCALE: \_\_\_\_\_

PLOT NAME: \_\_\_\_\_

REV. DATE: \_\_\_\_\_

ORIGINATOR: CITY OF MADISON, STREETS DIVISION

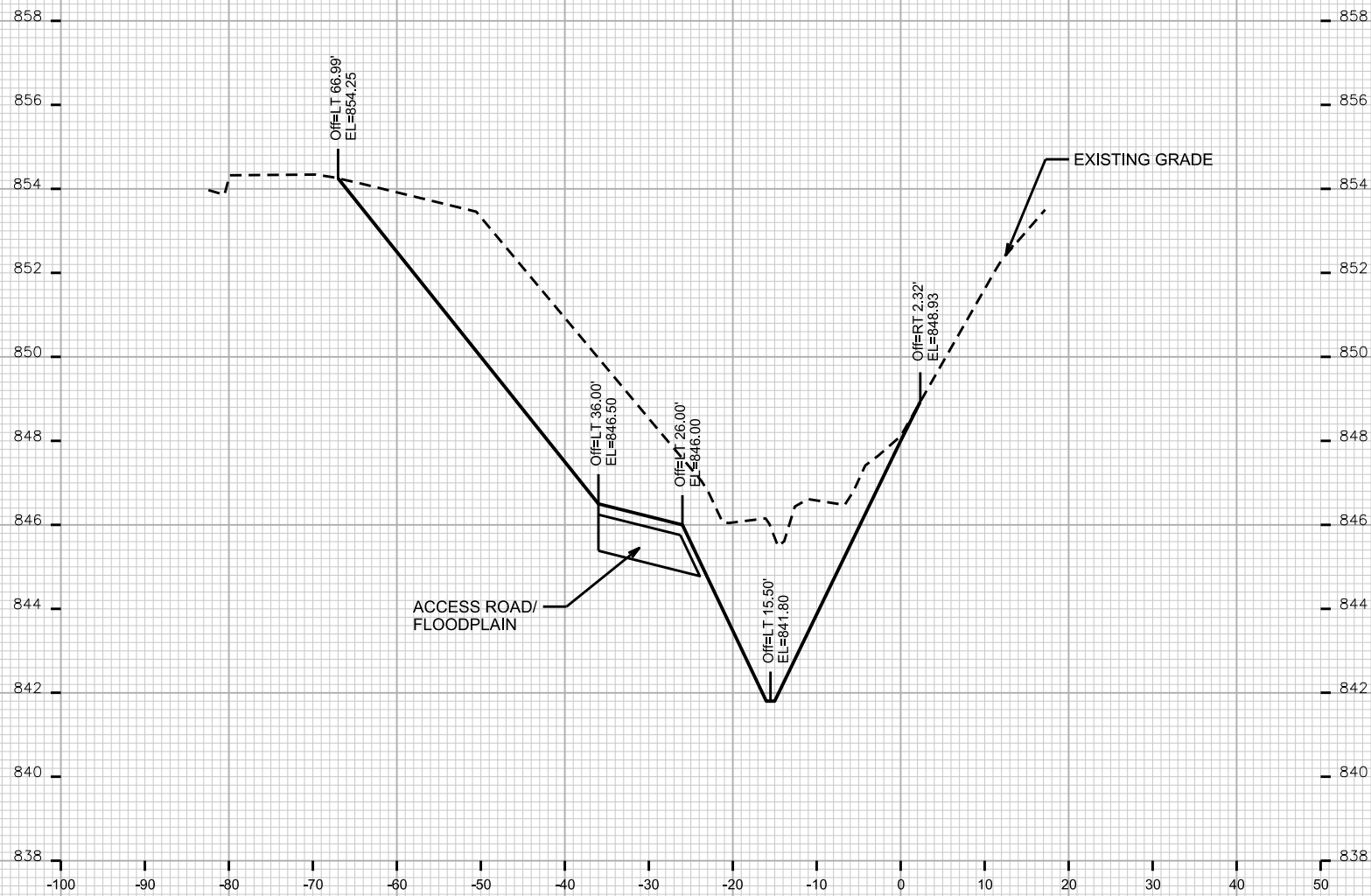

STA. 2+50

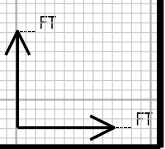

PLOT SCALE: \_\_\_\_\_

PLOT NAME: \_\_\_\_\_

REV. DATE: \_\_\_\_\_

ORIGINATOR: CITY OF MADISON, STREETS DIVISION

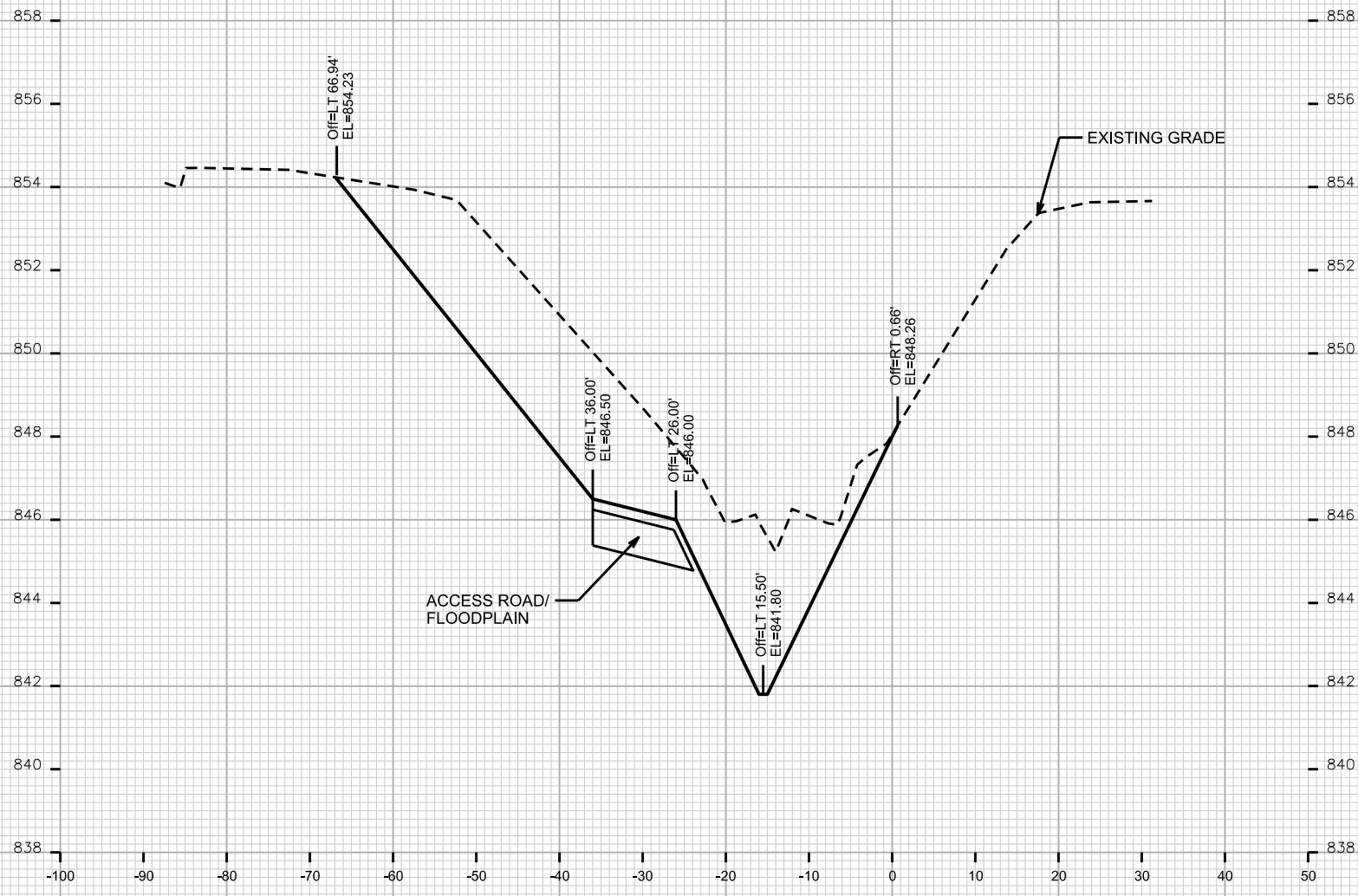

STA. 2+75

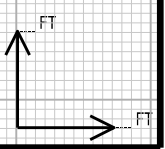

PLOT SCALE: \_\_\_\_\_

PLOT NAME: \_\_\_\_\_

REV. DATE: \_\_\_\_\_

ORIGINATOR: CITY OF MADISON, STREETS DIVISION

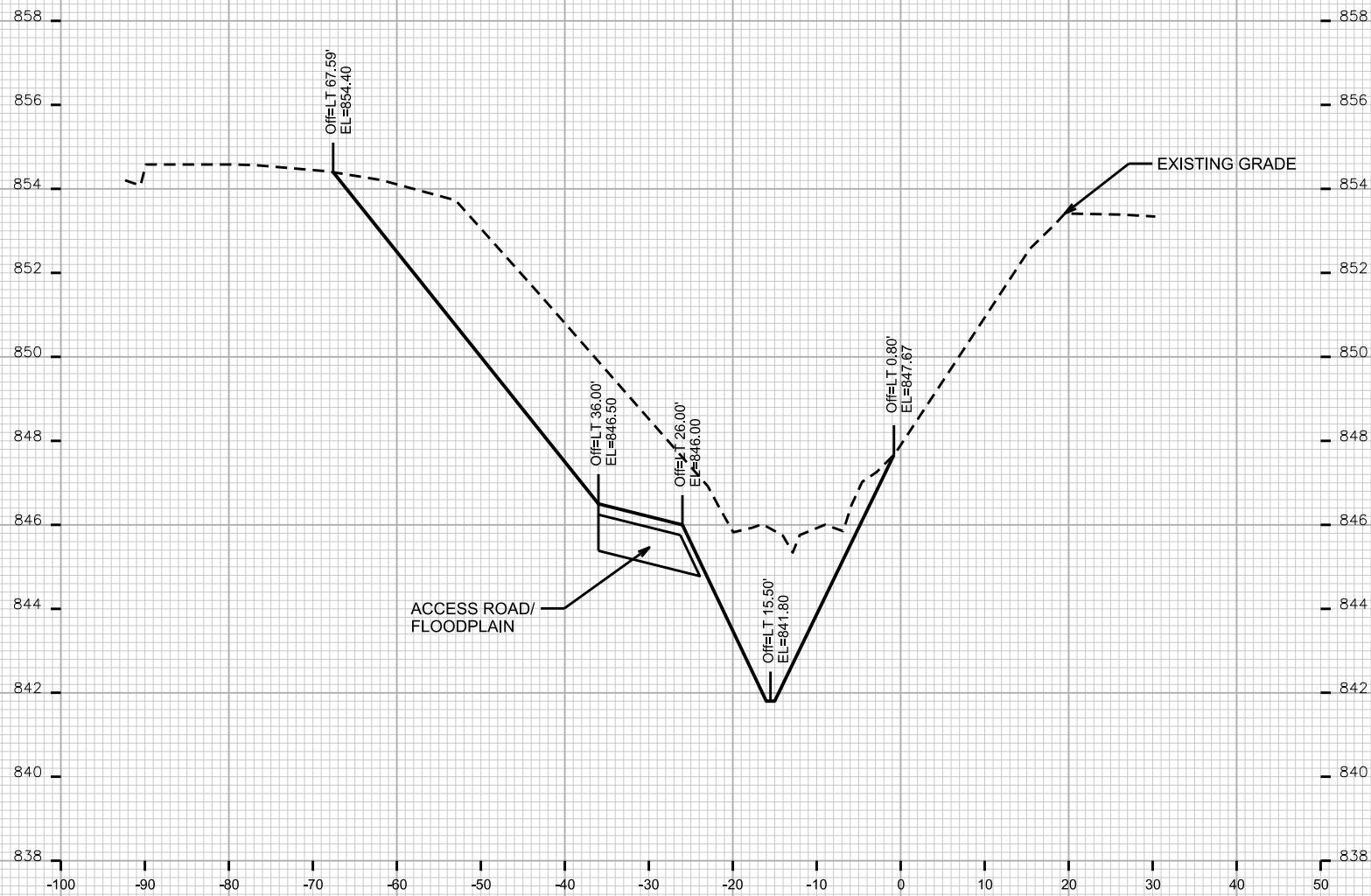

STA. 3+00

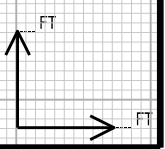

PLOT SCALE: \_\_\_\_\_

PLOT NAME: \_\_\_\_\_

REV. DATE: \_\_\_\_\_

ORIGINATOR: CITY OF MADISON, STREETS DIVISION

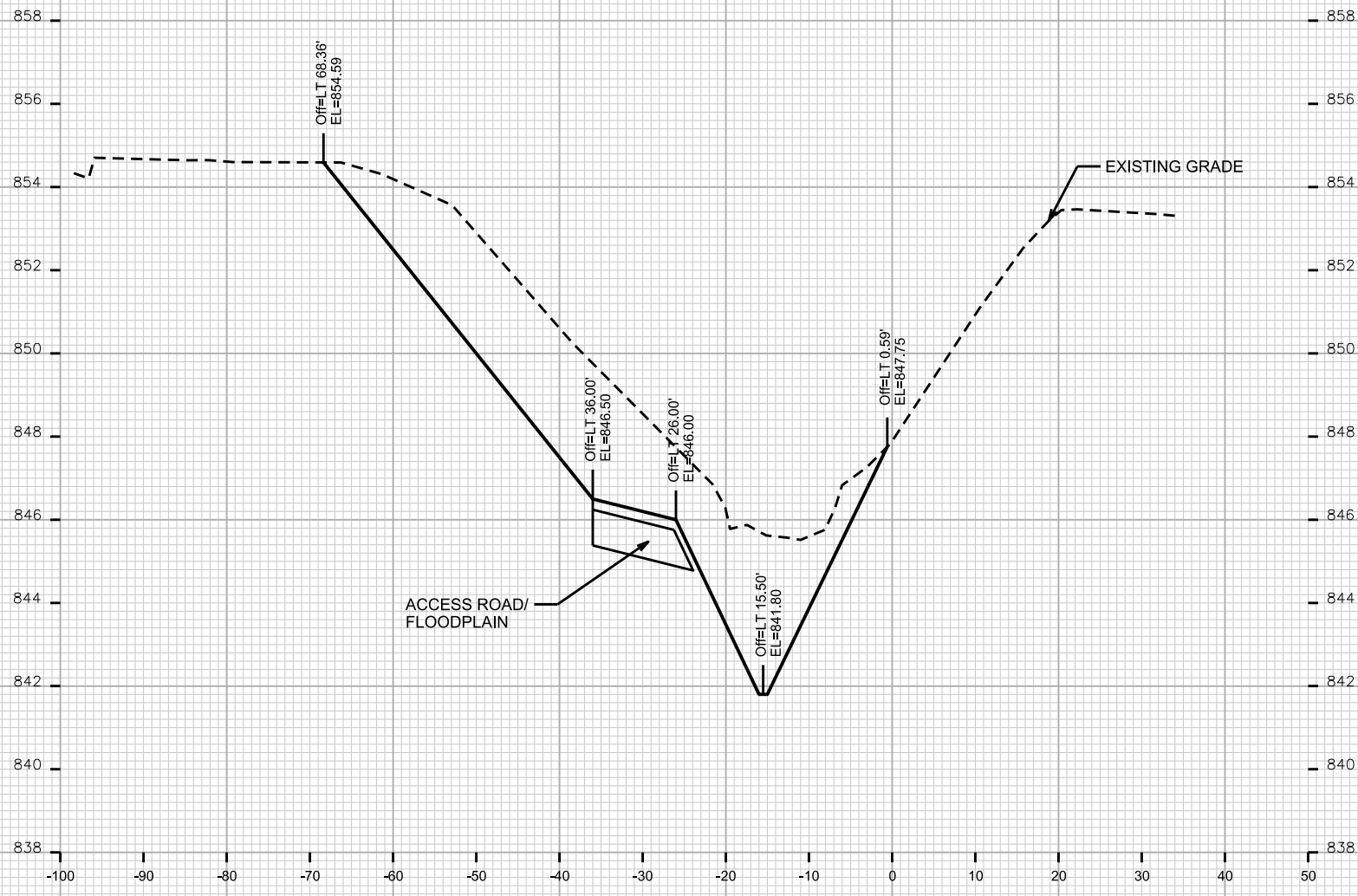

STA. 3+25

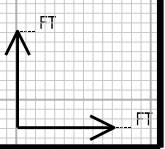

PLOT SCALE: \_\_\_\_\_

PLOT NAME: \_\_\_\_\_

REV. DATE: \_\_\_\_\_

ORIGINATOR: CITY OF MADISON, STREETS DIVISION

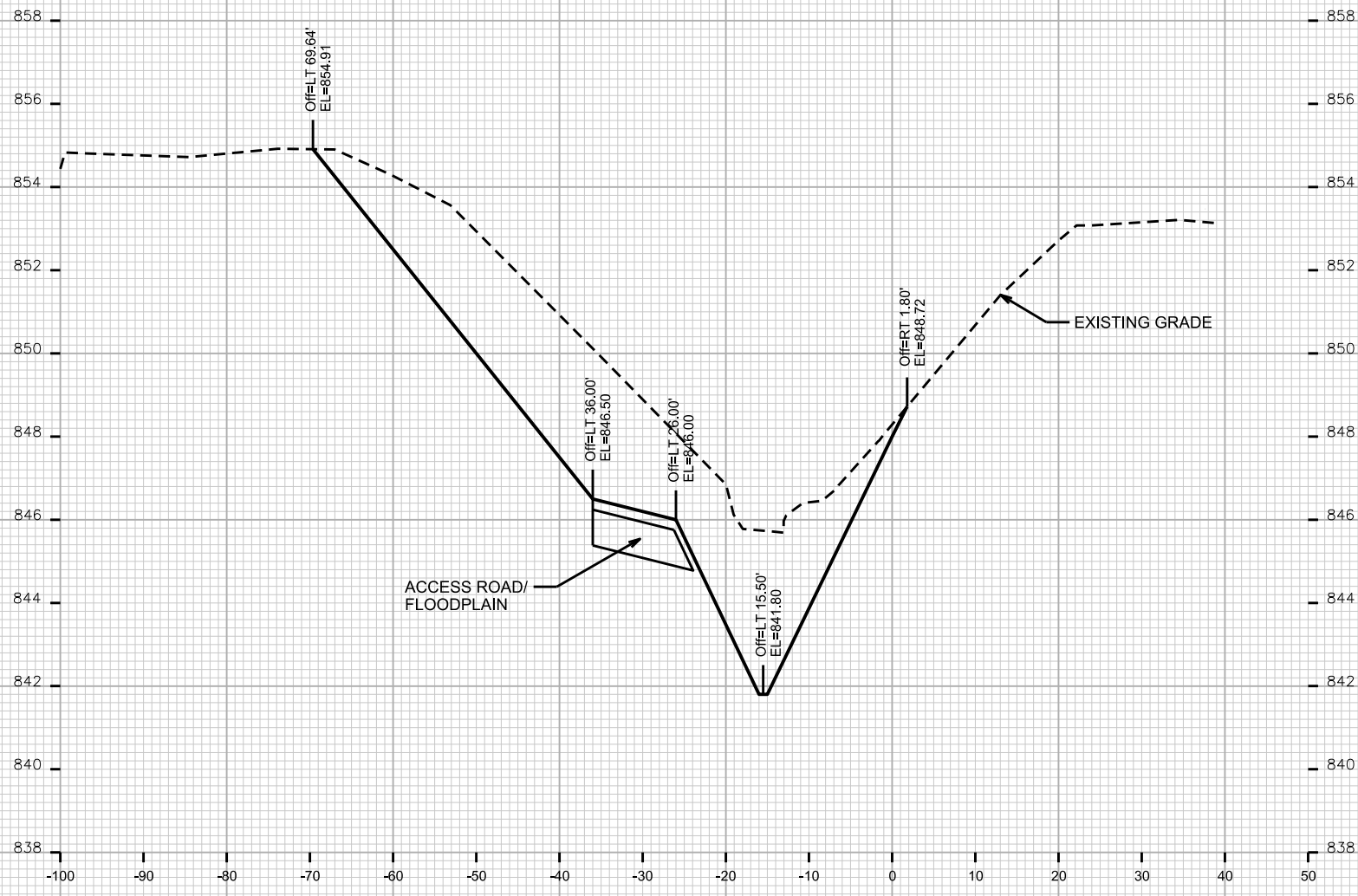

STA. 3+50



PLOT SCALE: \_\_\_\_\_

PLOT NAME: \_\_\_\_\_

REV. DATE: \_\_\_\_\_

ORIGINATOR: CITY OF MADISON, STREETS DIVISION

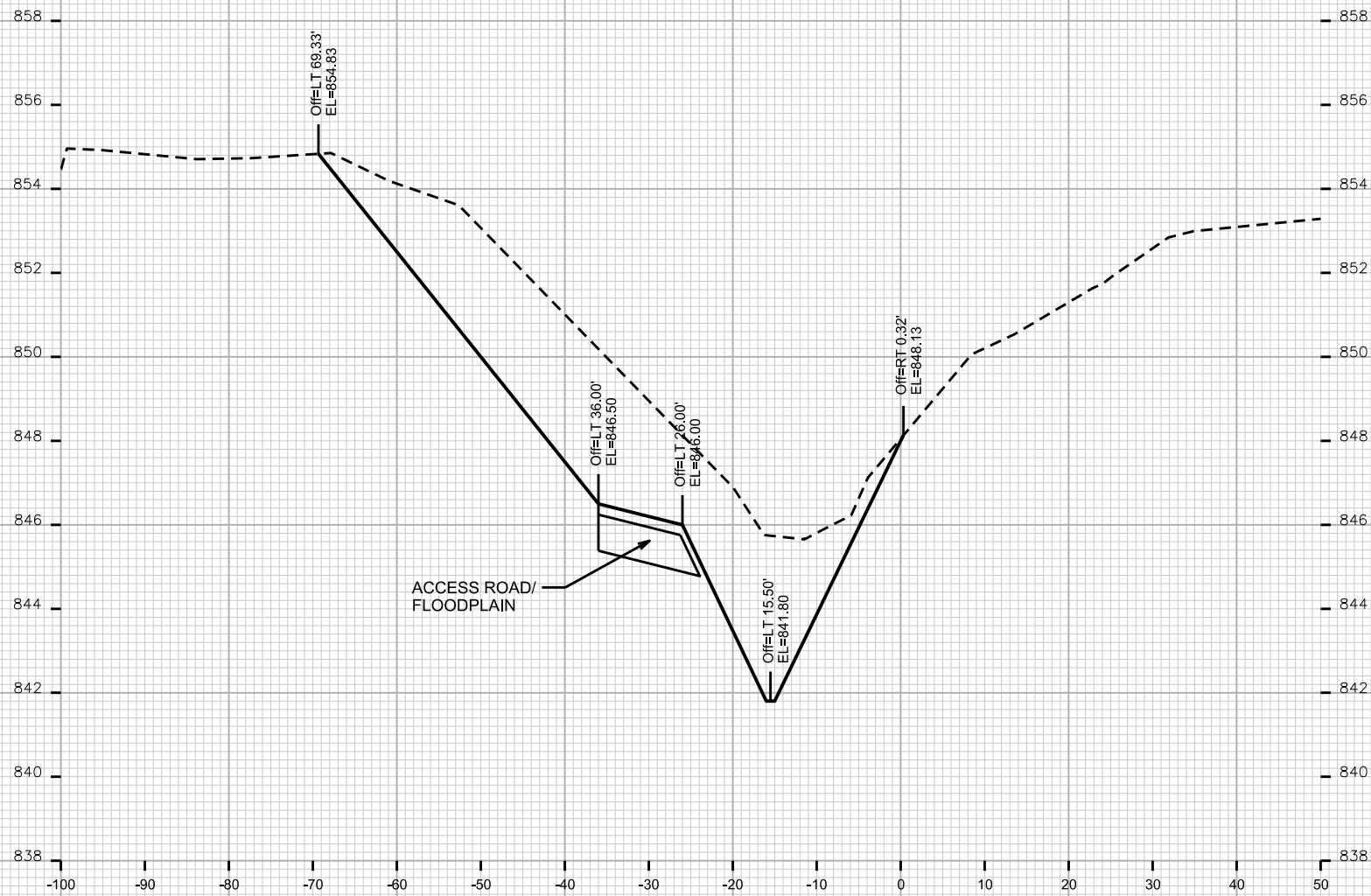

STA. 3+75



PLOT SCALE: \_\_\_\_\_

PLOT NAME: \_\_\_\_\_

REV. DATE: \_\_\_\_\_

ORIGINATOR: CITY OF MADISON, STREETS DIVISION

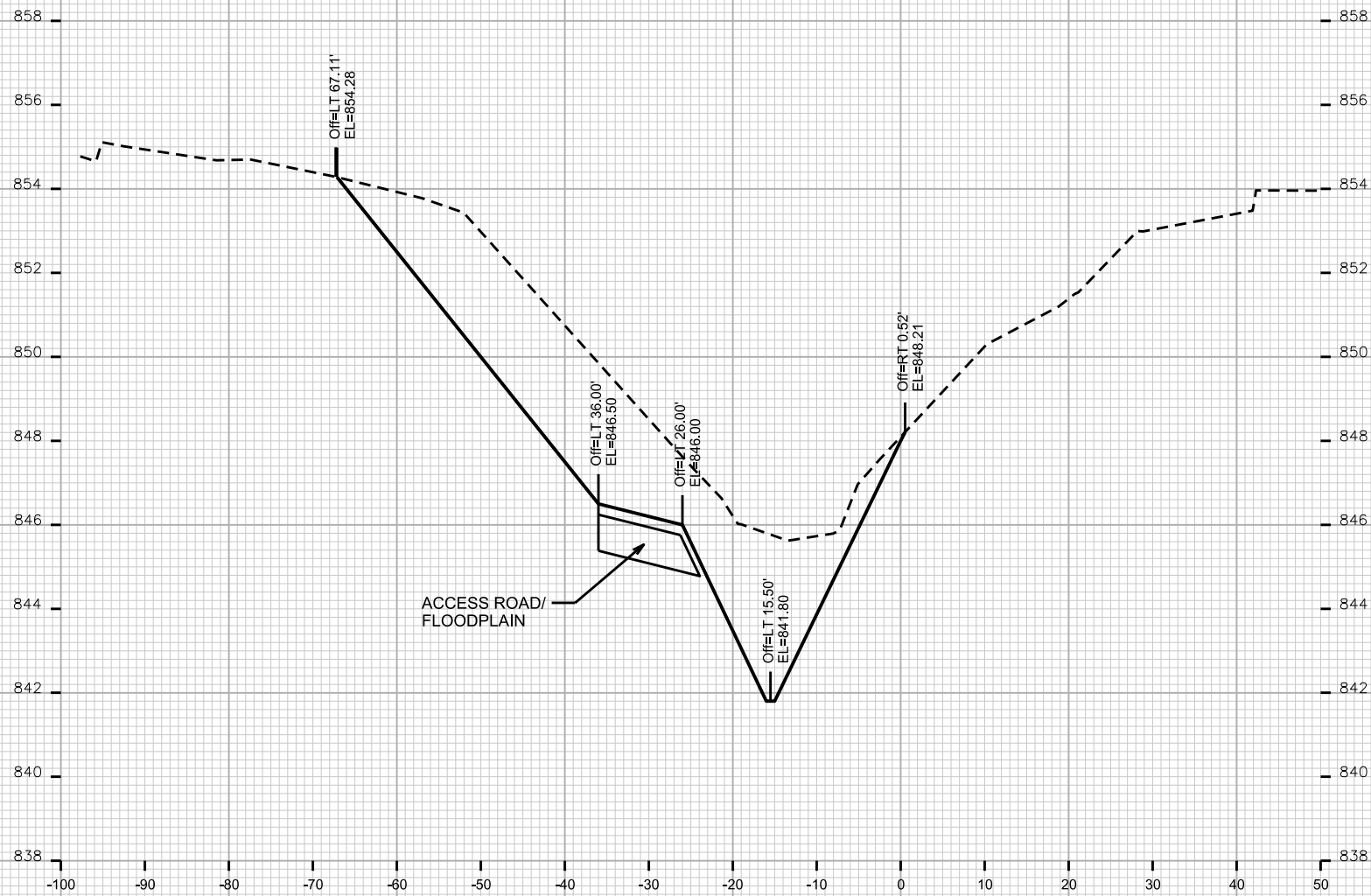

STA. 4+00

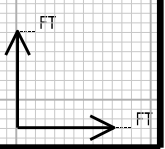

PLOT SCALE: \_\_\_\_\_

PLOT NAME: \_\_\_\_\_

REV. DATE: \_\_\_\_\_

ORIGINATOR: CITY OF MADISON, STREETS DIVISION

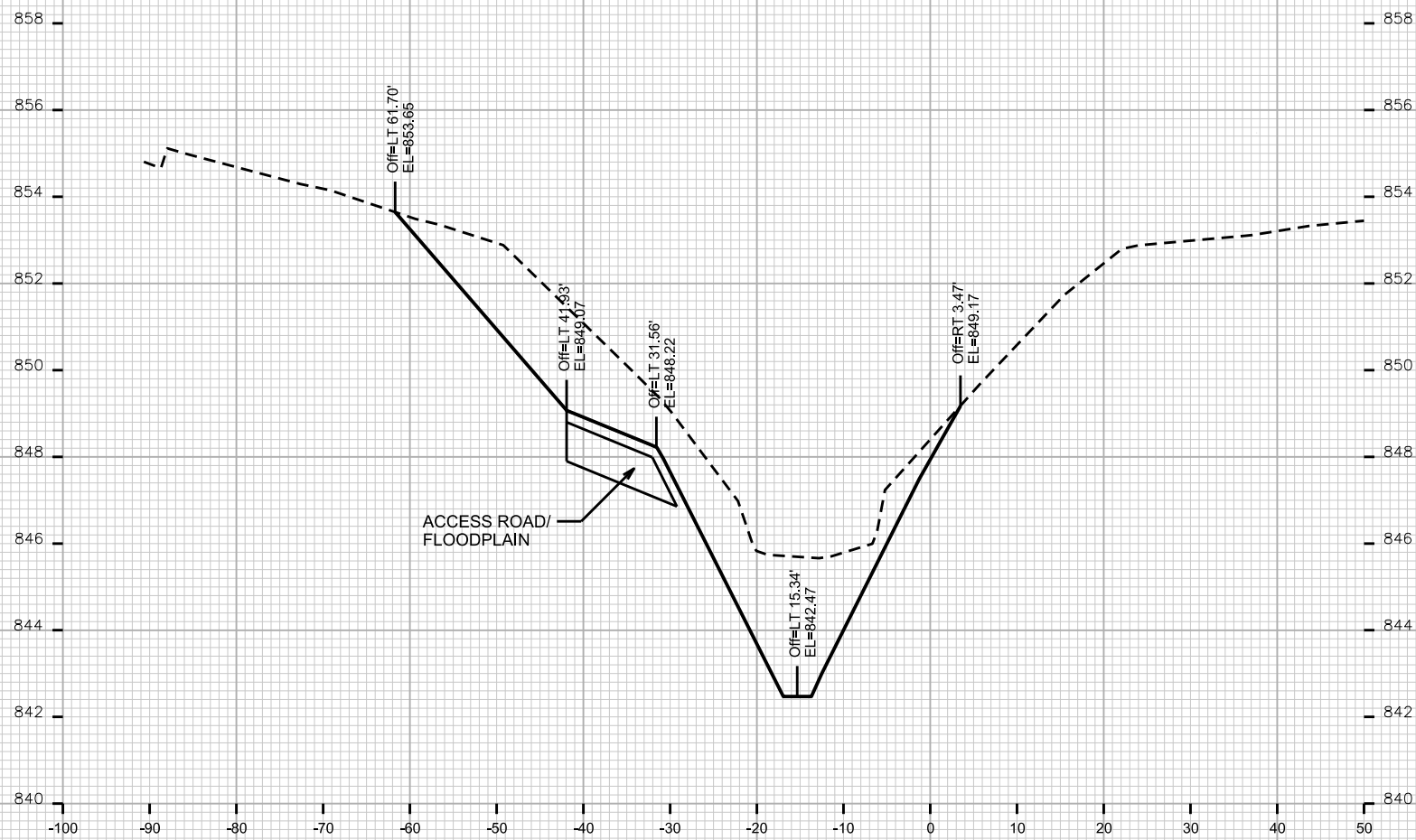

ACCESS ROAD/  
FLOODPLAIN

STA. 4+25

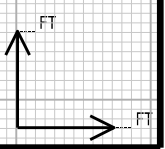



PLOT SCALE: \_\_\_\_\_

PLOT NAME: \_\_\_\_\_

REV. DATE: \_\_\_\_\_

ORIGINATOR: CITY OF MADISON, STREETS DIVISION

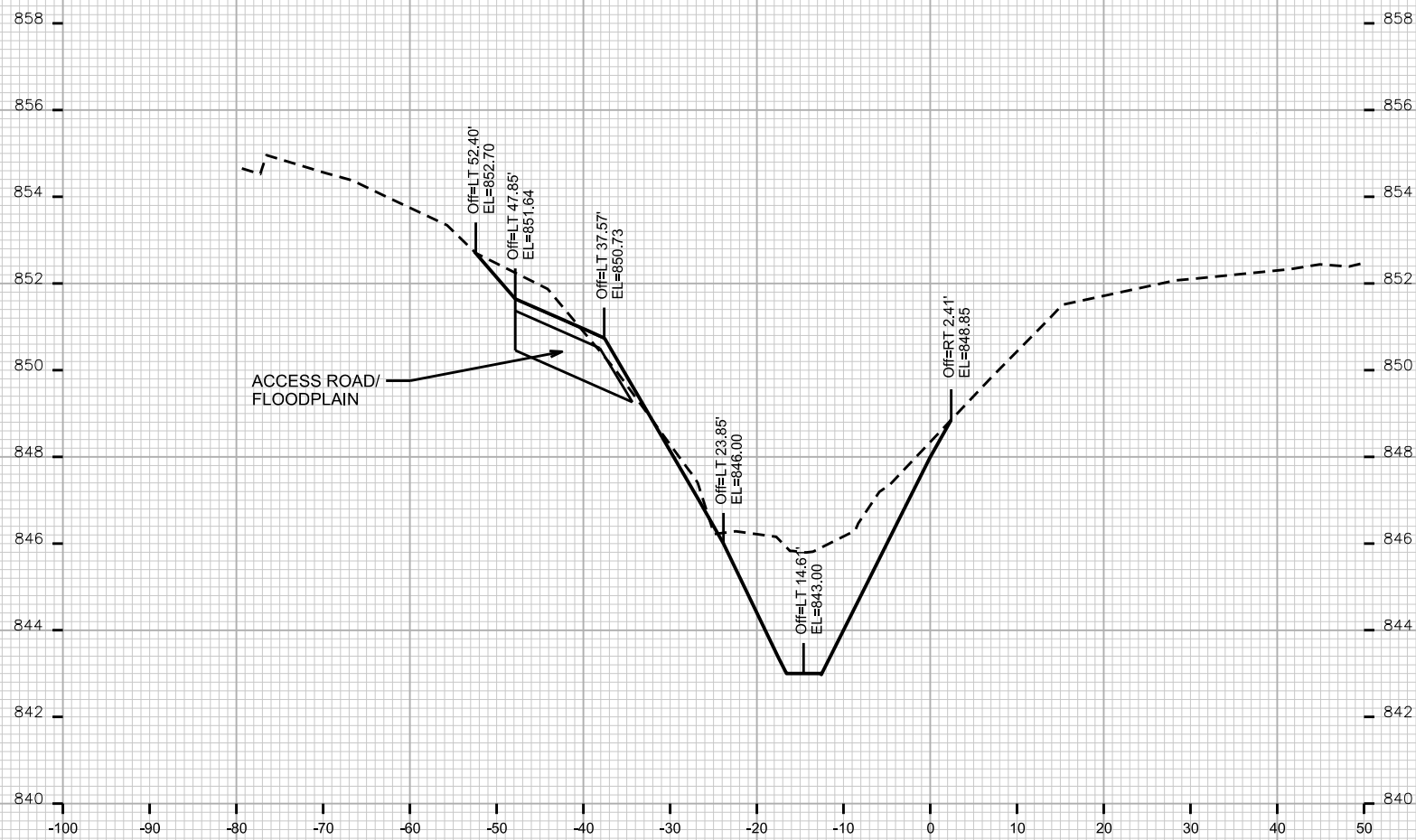

STA. 4+50

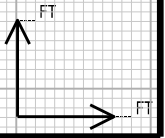

PLOT SCALE: \_\_\_\_\_

PLOT NAME: \_\_\_\_\_

REV. DATE: \_\_\_\_\_

ORIGINATOR: CITY OF MADISON, STREETS DIVISION

