



Department of Public Works
City Engineering Division

Robert F. Phillips, P.E.
City Engineer

City-County Building, Room 115
210 Martin Luther King, Jr. Boulevard
Madison, Wisconsin 53703
FAX 608 264 9275
www.cityofmadison.com

608 266 4751

Assistant City Engineer
Michael R. Dailey, P.E.

Principal Engineers
Christina M. Bachmann, P.E.
John S. Fahrney, P.E.
Gregory T. Fries, P.E.
Christopher J. Petykowski, P.E.

Facilities & Sustainability
Jeanne E. Hoffman, Manager
James C. Whitney, A.I.A.

Operations Supervisor
Kathleen M. Cryan

GIS Manager
David A. Davis, R.L.S.

Financial Officer
Steven B. Danner-Rivers

Hydrogeologist
Brynn Bemis

NOTICE OF ADDENDUM

ADDENDUM NO. 1

CONTRACT NO. 6994

Revise and amend the contract document(s) for the above project as stated in this addendum, otherwise, the original document shall remain in effect.

Soil boring pages were omitted from original specs. Please include the attached eight (8) pages after page D19 in the specification book.

Please acknowledge this addendum on page E1 of the contract documents.

Electronic version of these documents can be found on the City of Madison web site at:

<http://www.cityofmadison.com/business/PW/contracts/openforBid.cfm>

If you are unable to download plan revisions associated with the addendum, please contact the Engineering office at 608-266-4751 receive the material by another route.

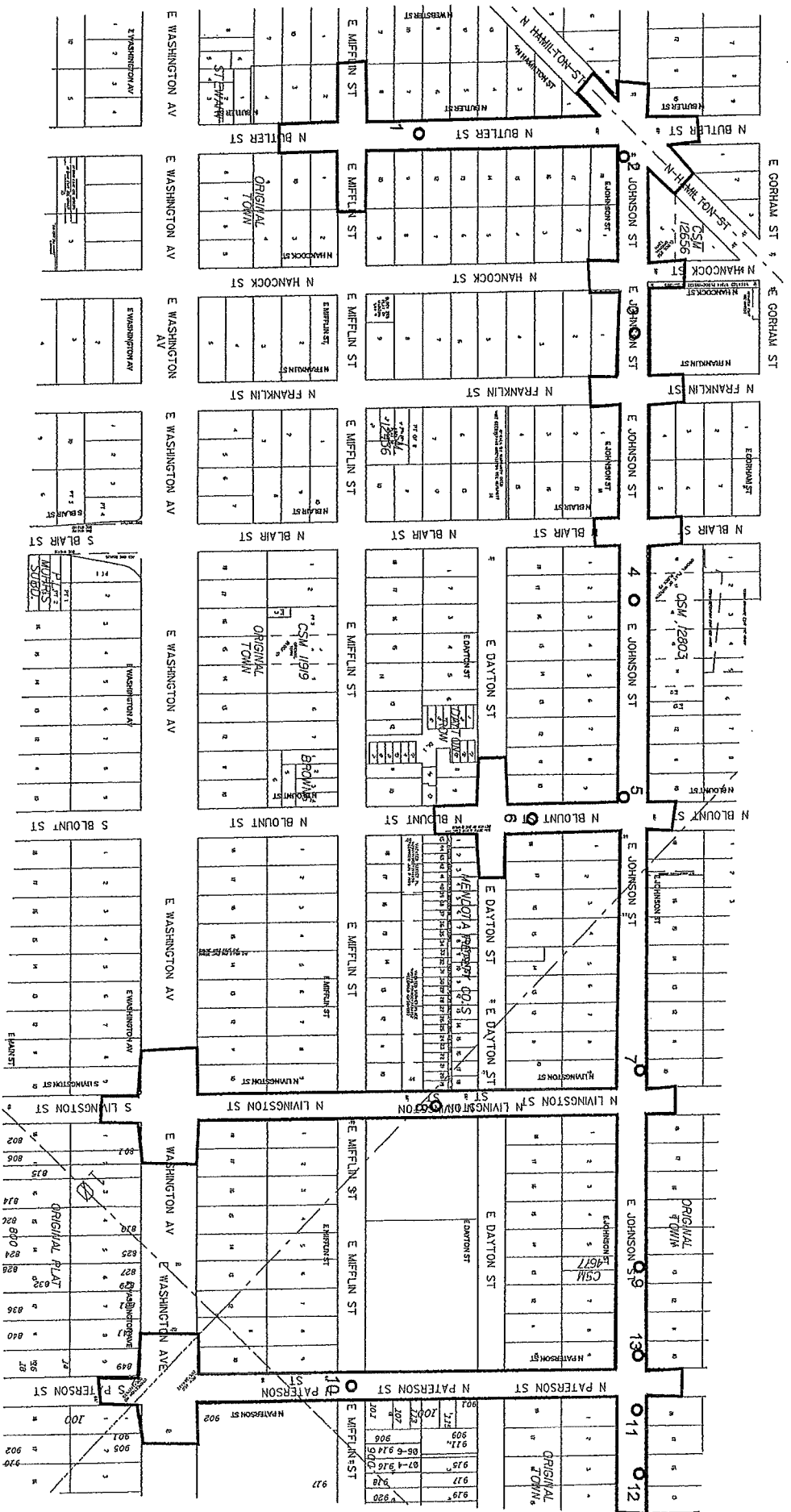

Legend

- Denotes Boring Location (approximate)



Notes

1. Soil borings performed by Badger State Drilling in November 2011
2. Boring 6 not drilled

DWN: -	APP'D: MNS	Date: 12/11	C11054-30
SOIL BORING LOCATION PLAN East Johnson Street Area Madison, Wisconsin			
Page 1 of 2			



LOG OF TEST BORING

Project East Johnson Street Area
Johnson: 50'SW of Livingston, 15'SE of Centerline
 Location Madison, Wisconsin

Boring No. 7
 Surface Elevation (ft) 88.9*
 Job No. C11054-30
 Sheet 1 of 1

2921 Perry Street, Madison, WI 53713 (608) 288-4100, FAX (608) 288-7887

SAMPLE					VISUAL CLASSIFICATION and Remarks	SOIL PROPERTIES				
No.	TYPE	Rec (in.)	Moist	N		Depth (ft)	qu (qa) (tsf)	W	LL	PL
1		0		8	2 in. Asphalt Pavement/6 in. Concrete Pavement/8 in. Base Course					
					FILL: Brown Sand with Silt, Gravel and Clay	(0.75)				
2		12	M	4	Medium-Stiff, Black Organic Lean CLAY (CL) (Probable Buried Topsoil)	(0.75)				
					Stiff to Very Stiff, Gray Lean CLAY, Trace Sand (CL)	(1.5)				
3		18	M	5		(3.0)				
4		18	W	6	Medium Stiff near 9 ft	(0.75)				
					Loose, Brown Fine to Medium SAND, Some Silt and Gravel, Scattered Cobbles and Boulders (SM)					
5		18	W	6						
					End Boring at 15 ft					
					Borehole backfilled with bentonite chips					
					*Elevation determined using an assumed datum of 100.0 ft referencing the top nut of a hydrant situated along Johnson between Butler and Hancock.					
					** Note Boring 7 was initially attempted twice before extending to the requested depth. The initial attempts (7A, 7B) terminated 3.5' to 3.7' below ground surface due to spoon/auger refusal on unknown, unmarked obstructions.					

WATER LEVEL OBSERVATIONS					GENERAL NOTES				
While Drilling	∇	13.0'	Upon Completion of Drilling	10.0'	Start	11/7/11	End	11/7/11	
Time After Drilling					Driller	Badger	Chief	RM	Rig CME-55
Depth to Water					Logger	KD	Editor	ESF	
Depth to Cave in					Drill Method	2 1/4" HSA			
<small>The stratification lines represent the approximate boundary between soil types and the transition may be gradual.</small>									



LOG OF TEST BORING

Project East Johnson Street Area
Johnson: 75'SW of Livingston, 5'SE of Centerline
 Location Madison, Wisconsin

Boring No. 7A
 Surface Elevation (ft) 89.0*
 Job No. C11054-30
 Sheet 1 of 1

2921 Perry Street, Madison, WI 53713 (608) 288-4100, FAX (608) 288-7887

SAMPLE					VISUAL CLASSIFICATION and Remarks	SOIL PROPERTIES				
No.	Rec (in.)	Moist	N	Depth (ft)		qu (qa) (tsf)	W	LL	PL	LI
1	0	M	17	17	<div style="border: 1px solid black; padding: 2px; margin-bottom: 5px;"> X 1.5 in. Asphalt Pavement/10 in. Concrete Pavement/6 in. Base Course </div> <div style="border: 1px solid black; padding: 2px;"> F FILL: Brown to Black Sand with Silt, Gravel and Clay </div>					
2	0	M	50/2"	3.7	<div style="border: 1px solid black; padding: 2px; margin-bottom: 5px;"> E End Boring at 3.7 ft due to spoon refusal on unknown obstruction </div> <div style="border: 1px solid black; padding: 2px; margin-bottom: 5px;"> B Borehole backfilled with soil cuttings. </div> <div style="border: 1px solid black; padding: 2px; margin-bottom: 5px;"> M Moved 5' northeast and attempted Boring 7B </div> <div style="border: 1px solid black; padding: 2px;"> E *Elevation determined using an assumed datum of 100.0 ft referencing the top nut of a hydrant situated along Johnson between Butler and Hancock. </div>					

WATER LEVEL OBSERVATIONS	GENERAL NOTES
While Drilling <input checked="" type="checkbox"/> NW Upon Completion of Drilling <input type="checkbox"/> NW Time After Drilling _____ Depth to Water _____ Depth to Cave in _____	Start <u>11/7/11</u> End <u>11/7/11</u> Driller <u>Badger</u> Chief <u>RM</u> Rig <u>CME-55</u> Logger <u>KD</u> Editor <u>ESF</u> Drill Method <u>2 1/4" HSA</u>

The stratification lines represent the approximate boundary between soil types and the transition may be gradual.



LOG OF TEST BORING

Project East Johnson Street Area
Johnson: 70'SW of Livingston, 5'SE of Centerline
 Location Madison, Wisconsin

Boring No. 7B
 Surface Elevation (ft) 89.0*
 Job No. C11054-30
 Sheet 1 of 1

2921 Perry Street, Madison, WI 53713 (608) 288-4100, FAX (608) 288-7887

SAMPLE					VISUAL CLASSIFICATION and Remarks	SOIL PROPERTIES				
No.	Rec (in.)	Moist	N	Depth (ft)		qu (qa) (tsf)	W	LL	PL	LI
				0	X	1.5 in. Asphalt Pavement/10" Concrete Pavement/6 in. Base Course				
				3.5	X	Blind Drill through Sandy to Clayey Fill to 3.5 ft				
1	0	M		10/0"	X	End Boring at 3.5 ft due to spoon refusal on unknown obstruction				
				5		Borehole backfilled with soil cuttings Moved 20' northeast and 10' southeast to perform Boring 7. *Elevation determined using an assumed datum of 100.0 ft referencing the top nut of a hydrant situated along Johnson between Butler and Hancock.				
				10						
				15						
				20						
				25						
				30						

WATER LEVEL OBSERVATIONS	GENERAL NOTES
While Drilling <u>∇</u> <u>NW</u> Upon Completion of Drilling <u> </u> <u>NW</u> Time After Drilling _____ Depth to Water _____ Depth to Cave in _____	Start <u>11/7/11</u> End <u>11/7/11</u> Driller <u>Badger</u> Chief <u>RM</u> Rig <u>CME-55</u> Logger <u>KD</u> Editor <u>ESF</u> Drill Method <u>2 1/4" HSA</u>
The stratification lines represent the approximate boundary between soil types and the transition may be gradual.	



LOG OF TEST BORING

Project East Johnson Street Area
Livingston: 145' SE of Dayton, near Centerline
 Location Madison, Wisconsin

Boring No. 8
 Surface Elevation (ft) 97.3*
 Job No. C11054-30
 Sheet 1 of 1

2921 Perry Street, Madison, WI 53713 (608) 288-4100, FAX (608) 288-7887

SAMPLE					VISUAL CLASSIFICATION and Remarks	SOIL PROPERTIES				
No.	TYPE	Rec (in.)	Moist	N		Depth (ft)	q _u (qa) (tsf)	W	LL	PL
					X	3 in. Asphalt Pavement/7 in. Base Course				
1		3	M	6		FILL: Brown Sand with Silt, Gravel and Clay to 3'				
2		8	M	3		Black Clay with Sand and Gravel to 5'				
3		16	M/W	3		Soft to Very Soft, Gray Lean CLAY, Trace Plant Fibers (CL)				
4		14	W	3		Very Loose, Gray Silty SAND, Some Clay (SM)				
5		24	W	3		Very Soft, Dark Gray Lean CLAY, Trace Sand (CL)				
End Boring at 15 ft										
Borehole backfilled with bentonite chips										
*Elevation determined using an assumed datum of 100.0 ft referencing the top nut of a hydrant situated along Johnson between Butler and Hancock.										

WATER LEVEL OBSERVATIONS	GENERAL NOTES
While Drilling ∇ <u>8.5'</u> Upon Completion of Drilling <u>7.0'</u> Time After Drilling _____ Depth to Water _____ Depth to Cave in _____	Start <u>11/11/11</u> End <u>11/11/11</u> Driller <u>Badger</u> Chief <u>RM</u> Rig <u>CME-55</u> Logger <u>KD</u> Editor <u>ESF</u> Drill Method <u>2 1/4" HSA</u>
The stratification lines represent the approximate boundary between soil types and the transition may be gradual.	

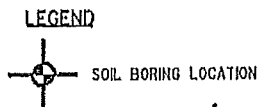
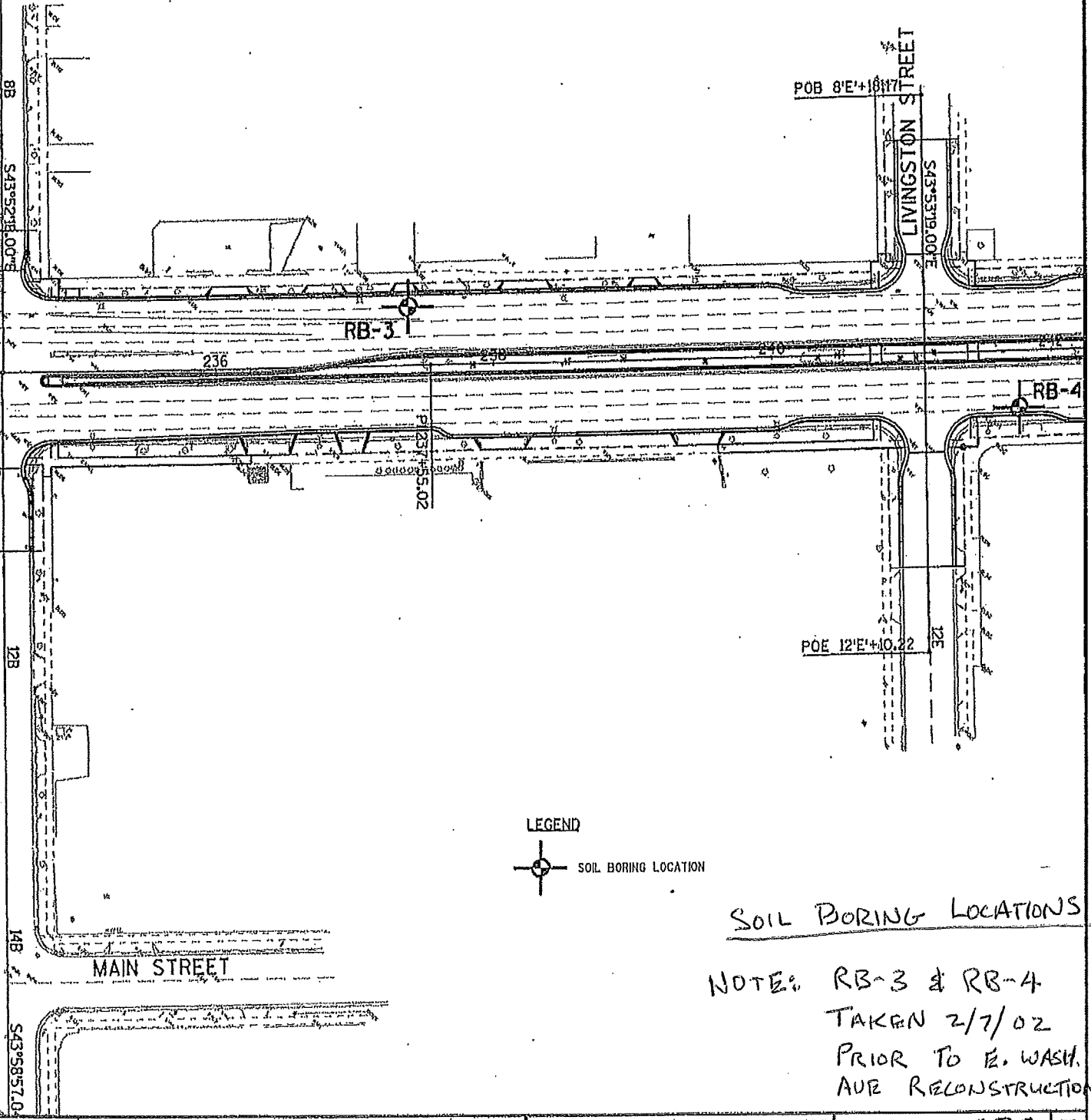

SOIL BORING LOCATIONS

NOTE: RB-3 & RB-4
 TAKEN 2/7/02
 PRIOR TO E. WASH.
 AVE RECONSTRUCTION

SOIL BORINGS

SCALE, FEET 100

SHEET NO: 273 E

ORG DATE :

Originator : Dist

PLOT SCALE : 100.463812:1.000000

WISDOT/CADD5 SHEET 42



**WISCONSIN
SOIL
TESTING**

A DIVISION OF
D. HIGHITE INVESTMENTS, INC.

LOG OF BORING

Project: Proposed Roadway Reconstruction
Location: East Washington Avenue
Madison, Wisconsin
Client: HNTB Corporation

Boring # RB-3

Surface Elev: SEE TABLE
WST Job No: 02-4675
Sheet: 1 of 1

Date Boring Started: 2/7/02
Total Boring Depth: 17.5'
Borehole Cave-in at: 14.0'

Completed: 2/7/02
Hour(s) after Drilling

Depth to Ground Water During Drilling: 7.0'
Depth to Ground Water Upon Completion of Drilling: Trace
Depth to Groundwater Hour(s) After Drilling:

Laboratory Results						Sample No.	Blows / Foot N ₆₀ Value	Pocket Pen (PSF)	Depth (Feet)	Sample Type	Visual Soil Classification	Drilling Notes: Bit Size, Type, Loss or Gain of Water, Casing Size, Etc.
M (%)	LL	PL	PI	LOI	PID							
										6" Asphalt		
32				8	0	1	13			SAND with organic silt, trace fine gravel, fine to coarse grained, black, medium dense to loose. (Fill) (SM - OL)	Borings Advanced with 2 1/4" Hollow- Stem Augers	
					0	2	4			No sample recovered from 3.5' to 5.0'		
								5		Organic clayey SILT, slightly fibrous, dark brownish-black, moist to wet, very loose (OL) —Decreasing fiber content to 10.0%		
140				17	598	3	2					
					736	4	2	10		Clayey SILT, trace fine sand, greenish-gray to grayish-brown, moist to wet, loose to very loose. (ML - CL) (A-4)		
					100	5	7					
					177	6	3	15		Silty CLAY, trace fine sand and gravel, light brown, moist, stiff. (CL)		
					200	7	9	2.0		End of Boring at 17.5'		
								20				

Boring Logged By: A. C. Guenther
Checked By: J. Heinz, E.I.T.

Drilling and Sampling Information

Classification System: USCS, AASHTO
Machine Model Used: Mobile B-59

Penetration Test

2" OD x 1 3/4" ID split-barrel sampler driven 18" by a 140 lb. guided weight free-falling 30". Number of blows required to advance the test 12" is shown as the "N" value.

Sample Type

Split-Barrel Shelby Tube Auger Wash



**WISCONSIN
SOIL
TESTING**

DIVISION OF
D. HIGHITE INVESTMENTS, INC.

LOG OF BORING

Project: Proposed Roadway Reconstruction
Location: East Washington Avenue
Madison, Wisconsin
Client: HNTB Corporation

Boring # RB-4

Surface Elev: SEE TABLE
WST Job No: 02-4575
Sheet: 1 of 1

Date Boring Started: 2/4/02
Total Boring Depth: 12.5'
Borehole Cave-In at: 10.0'

Completed: 2/4/02
Hour(s) after Drilling

Depth to Ground Water During Drilling: 8.5'
Depth to Ground Water Upon Completion of Drilling: None
Depth to Groundwater Hour(s) After Drilling:

Laboratory Results						Sample No.	Blows / Foot N ₆₀ Value	Pocket Pen (TSF)	Depth (Feet)	Sample Type	Visual Soil Classification	Drilling Notes: Bit Size, Type, Loss or Gain of Water, Casing Size, Etc.
M (%)	LL	PL	PI	LOI	PID							
										4" Asphalt 8" Concrete 6" Basecourse	Borings Advanced with 2 1/2" Hollow- Stem Augers	
					4	1	23			SAND, little fine to coarse stone, fine to coarse grained, light brown, moist, medium dense. (Fill) (SW) (A-3)		
12.5				35	3	2	4			PEAT, fibrous, brownish-black. (PT)		
										Lean CLAY with silt, trace fine to medium sand, light brown, wet to moist, soft to medium stiff. (CL) (A-6)		
23	27	18	9		7	3	9	1.5				
					2	4	6					
					3	5	50			Clayey SAND, trace fine gravel, fine to medium grained, reddish-brown, moist, very dense. (SC) (A-2-6)		
End of Boring at 12.5'												
								15-				
								20-				

Drilling and Sampling Information

Boring Logged By: A. C. Guenther
Checked By: J. Heinz, E.I.T.

Classification System: USCS, AASHTO
Machine Model Used: Mobile B-59

Penetration Test

2" OD x 1 3/8" ID split-barrel sampler driven 18" by a 140 lb. guided weight free-falling 30". Number of blows required to advance the test 12" is shown as the "N" value.

Sample Type

- Split-Barrel
 Shelby Tube
 Auger
 Wash