



Madison, Wisconsin

CONVENTIONAL SIGNS

COMBUSTIBLE FLUIDS



UNDERGROUND UTILITIES

NOTE: FIELD VERIFY UTILITIES

- STORM SEWER — ST —
- SANITARY SEWER — SAN —
- WATER — W —
- POWER POLE — □ —
- RAILROAD — [Symbol] —

INDEX OF SHEETS

SHEET NO. D1	TYPICAL SECTIONS
SHEET NO. D2	ASPHALT FLUME DETAIL
SHEET NO. D3	CURB & GUTTER DETAIL
SHEET NO. M1-M2	PAVEMENT MARKING PLAN
SHEET NO. P1-P2	PLAN/PROFILE
SHEET NO. U1-U2	STORM SEWER
SHEET NO. X1-X3	CROSS-SECTIONS

EARTHWORK SUMMARY

EXCAVATION CUT (PAID AS PLAN QUANTITY)	268 CY
UNDERCUT (EST.)	48 CY
TOTAL	<u>316 CY</u>

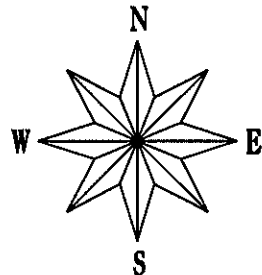

CITY OF MADISON

CITY ENGINEERING DIVISION

DEPARTMENT OF PUBLIC WORKS

PLAN OF PROPOSED IMPROVEMENT

STOUGHTON RD/VOGES RD INTERSECTION IMPROVEMENT ASSESSMENT DISTRICT-2014

PROJECT NO. 53W1332
CONTRACT NO. 7002

PROJECT LOCATION

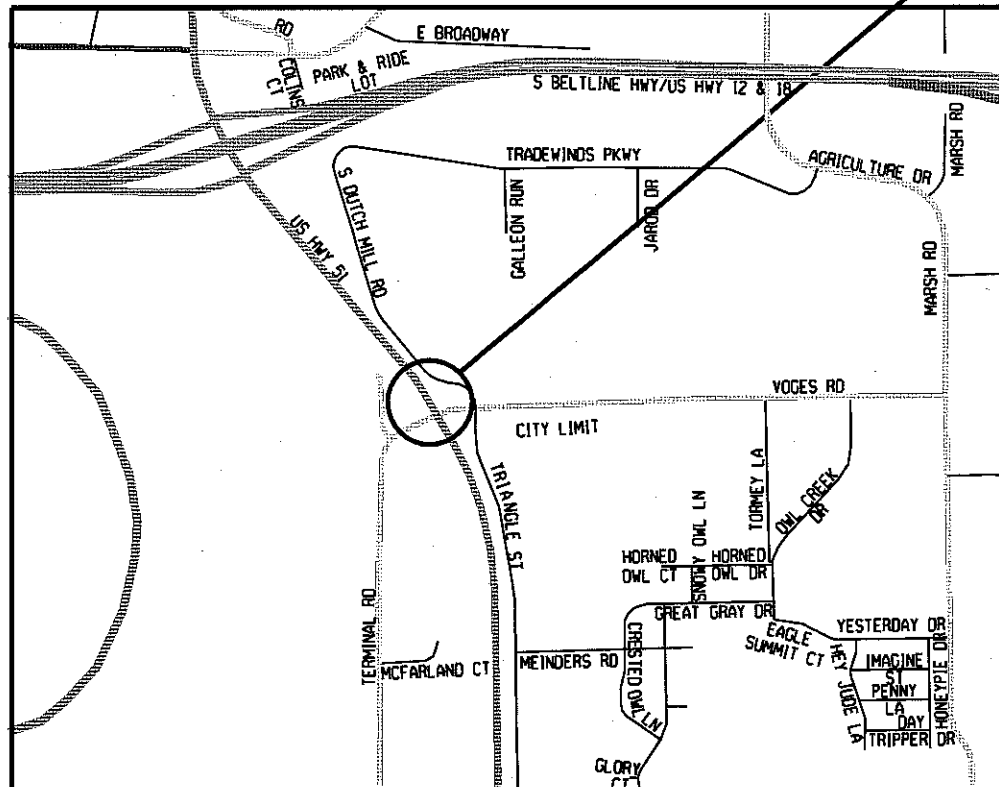

STREET PROJECT APPROVED
MAR. 4, 2014
BY THE COMMON COUNCIL
OF MADISON, WISCONSIN

DESIGN
APPROVED BY:

Michael R. Dwyer 4/25/14
for City Engineer Date

STREET
DESIGNED BY:

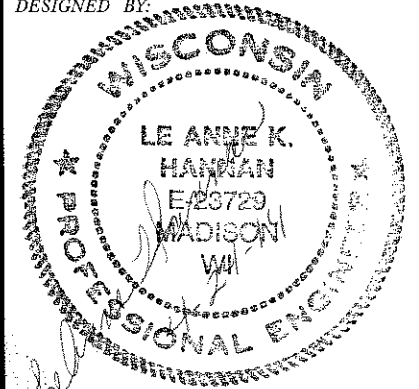

STORM SEWER
DESIGNED BY:



PAVEMENT MARKINGS
DESIGNED BY:

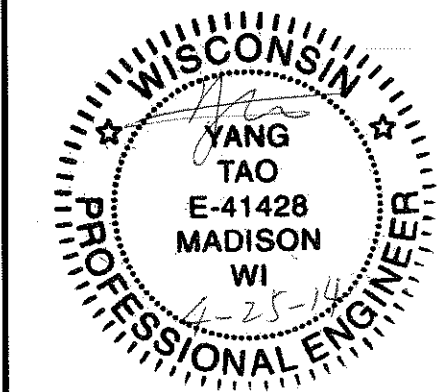

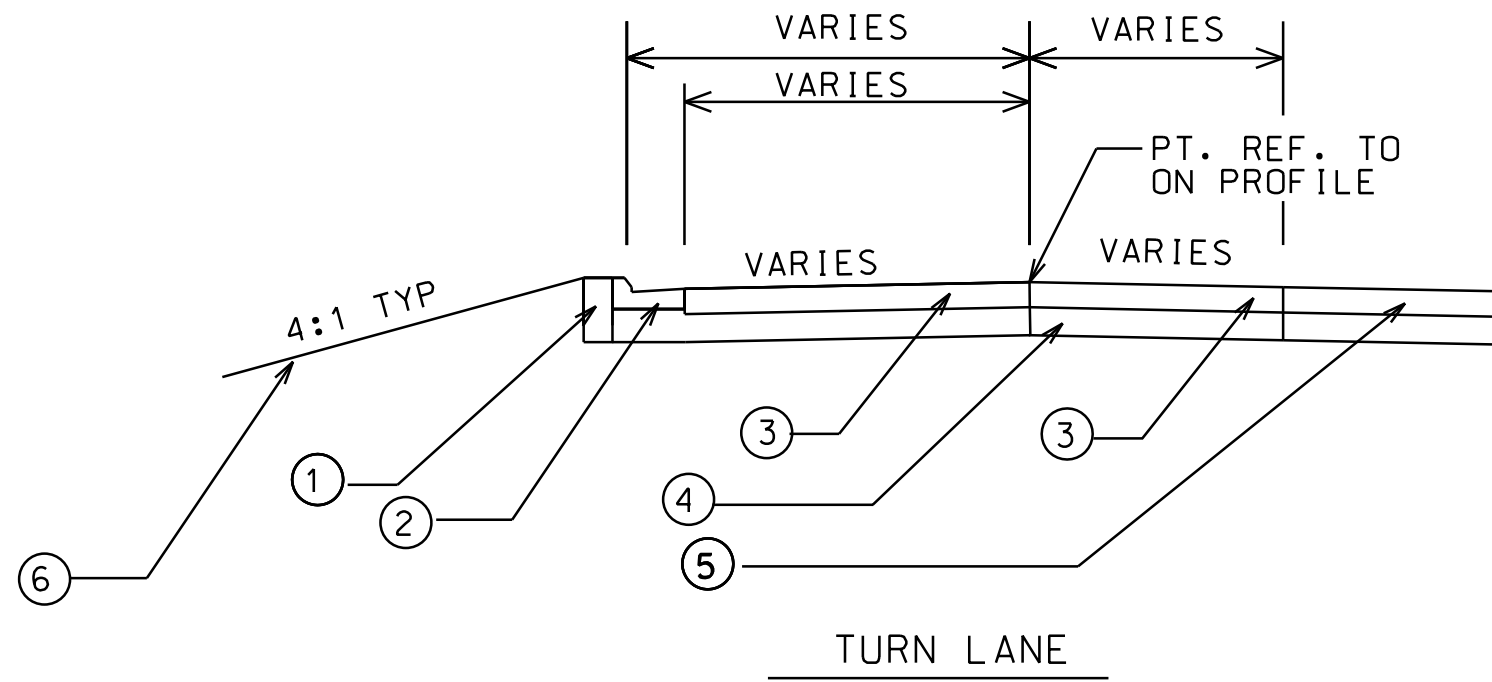

- ① FILL
- ② TYPE "G" 30" SLOPED, CONC. C&G-HES
- ③ 9-INCH CONCRETE PAVEMENT
- ④ 4" C.A.B.C.GR. 2
6" C.A.B.C.GR. 1
- ⑤ EXIST. CONC. PAV'T
- ⑥ 4" TOPSOIL, SEED & MATTING

LEVELS ON - 1, 2, 3, 4, 5, 6, 7, 8, 9, 10, 11, 12, 13, 14, 15, 16, 17, 18, 19, 20, 21, 22, 23, 24, 25, 26, 27, 28, 29, 30, 31, 32, 33, 34, 35, 36, 37, 38, 39, 40, 41, 42, 43, 44, 45, 46, 47, 48, 49, 50, 51, 52, 53, 54, 55, 56, 57, 58, 59, 60, 61, 62, 63

PLOT SCALE: _____
PLOT NAME: _____
REV. DATE: _____

ORIGINATOR: _____



8D4: Concrete Surface Drains & Asphaltic Flumes

ASPHALTIC FLUME

NOTE: TAPER CURB ENDS TO GUTTER IN 1'-0"

INCREASE ϕ FROM RIGHT ANGLE TO BEST FIT FIELD CONDITIONS

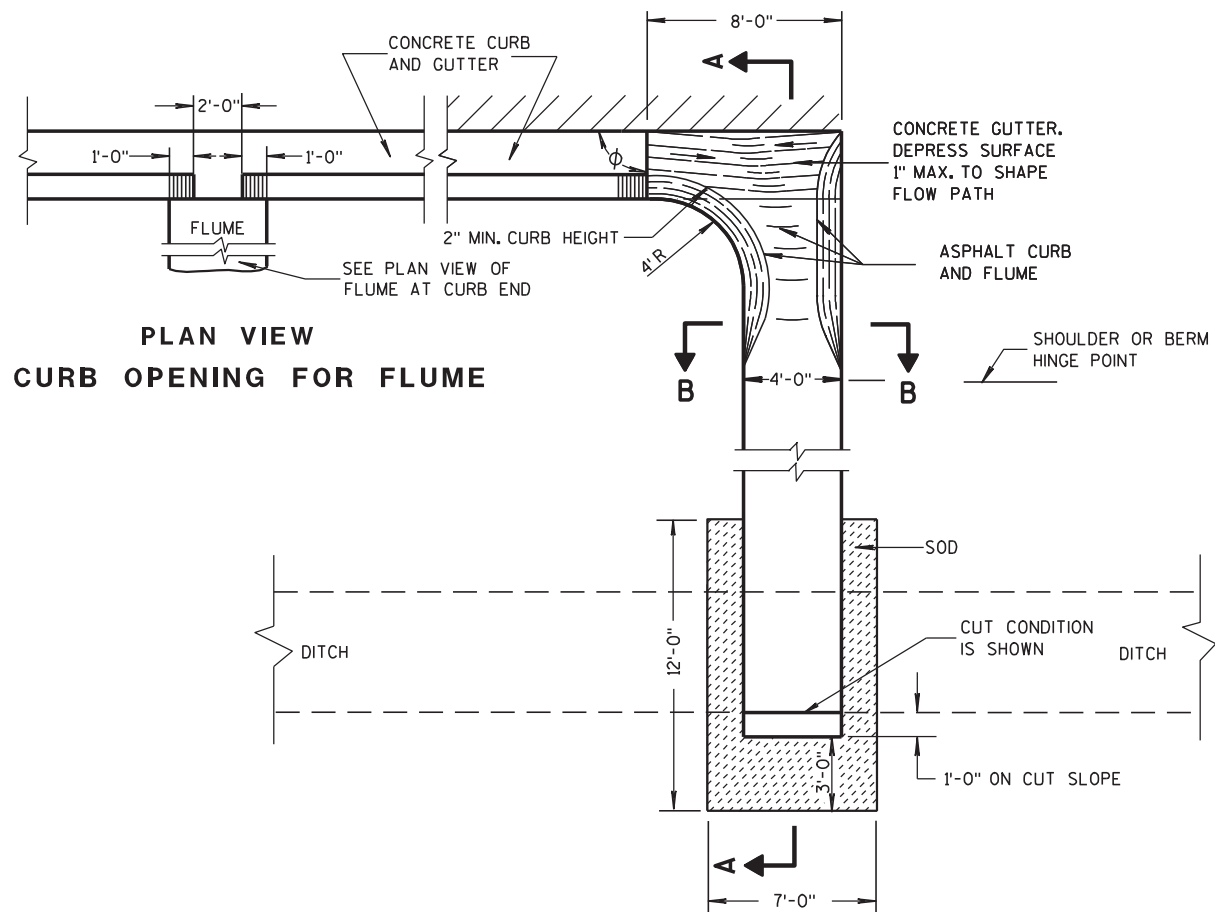

PLAN VIEW FLUME AT CURB END

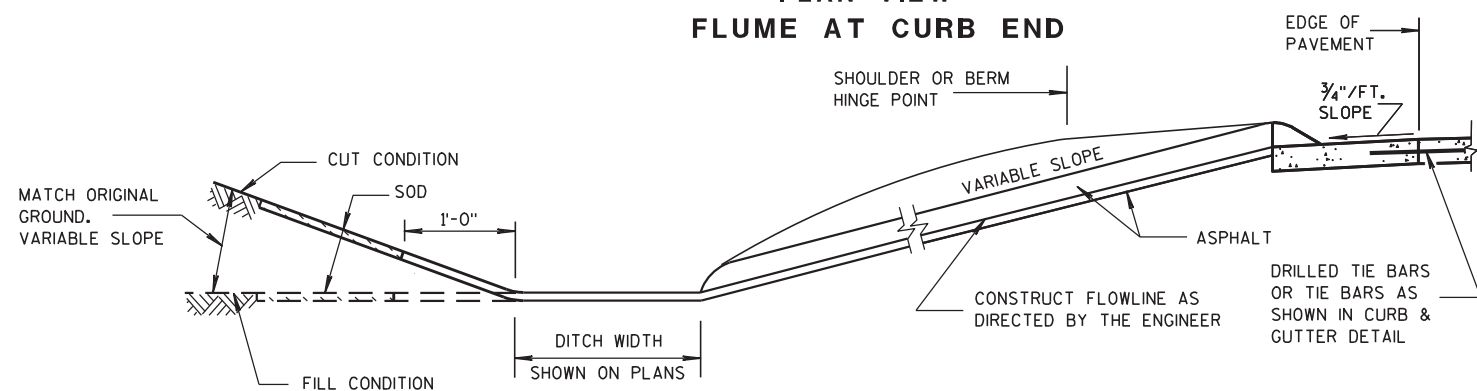

SECTION B-B

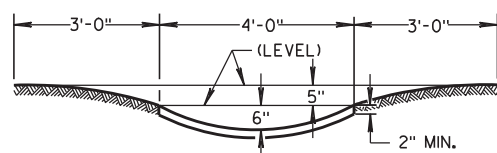

GENERAL NOTES

DETAILS OF CONSTRUCTION, MATERIALS AND WORKMANSHIP NOT SHOWN ON THIS DRAWING SHALL CONFORM TO PERTINENT REQUIREMENTS OF THE STANDARD SPECIFICATIONS AND APPLICABLE SPECIAL PROVISIONS.

WELDED STEEL WIRE FABRIC SHALL BE IN ACCORDANCE WITH AASHTO SPECIFICATION M55.

- JOINTS SHALL BE 1/8 TO 1/4 INCH WIDE BY 1/2 INCHES DEEP AND SPACED AT UNIFORM INTERVALS OF APPROXIMATELY 4 FEET.
- GEOTEXTILE FABRIC TYPE "R" SHALL UNDERLAY THE FULL LENGTH AND WIDTH OF THE CONCRETE SURFACE DRAIN AND RIPRAP.
- CONCRETE SURFACE DRAIN WITHOUT CURB AND GUTTER MAY BE USED ON BACKSLOPES WHEN SPECIFIED

CONCRETE SURFACE DRAIN

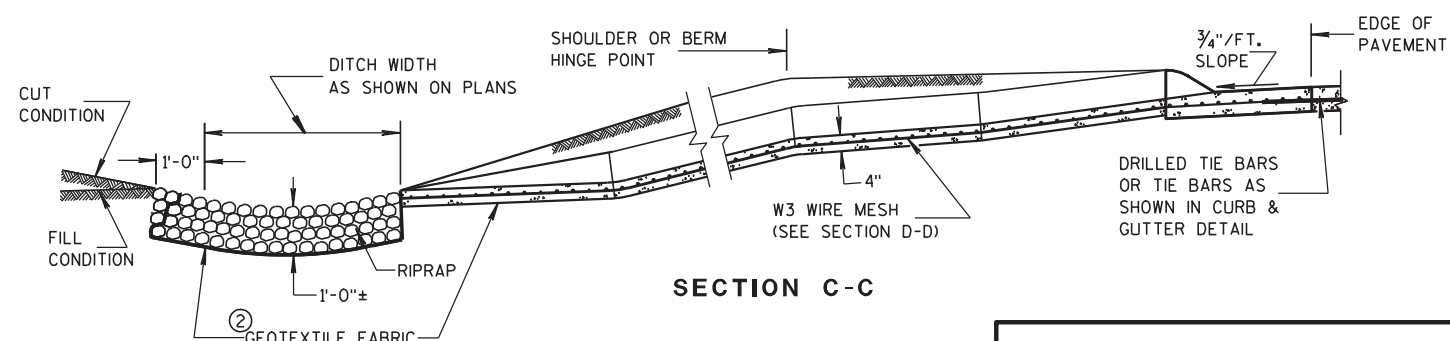
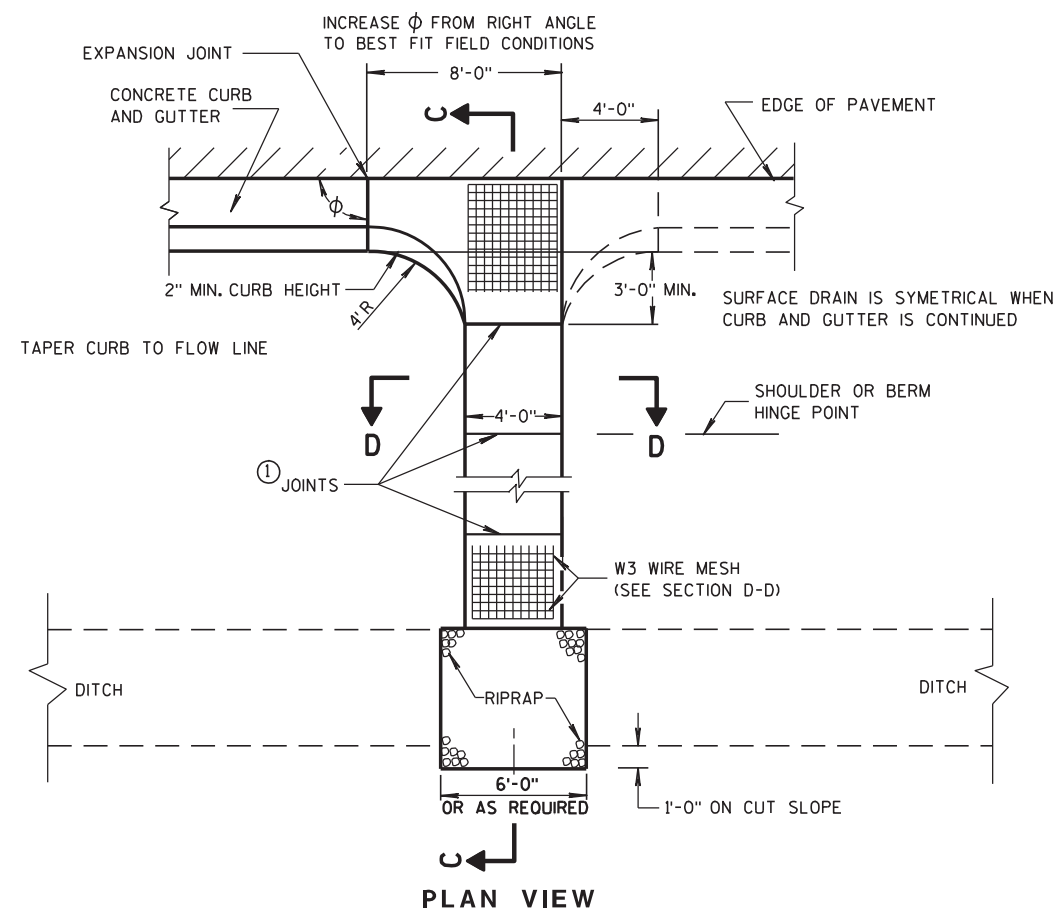

SECTION D-D

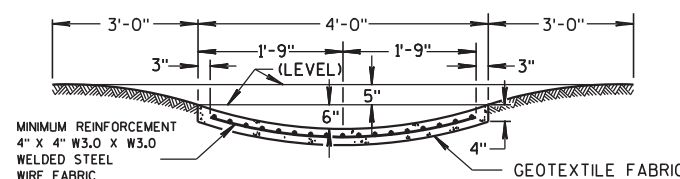

CONCRETE SURFACE DRAINS & ASPHALTIC FLUMES

STATE OF WISCONSIN
DEPARTMENT OF TRANSPORTATION

APPROVED
9-4-08 /S/ Jerry H. Zogg
DATE ROADWAY STANDARDS DEVELOPMENT ENGINEER
FHWA

8D1: Concrete Curb, Concrete Curb & Gutter and Ties

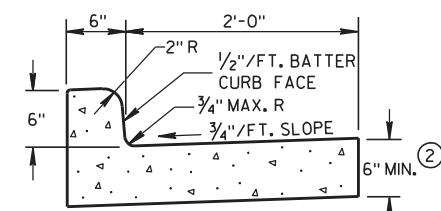

TYPES A & D ①

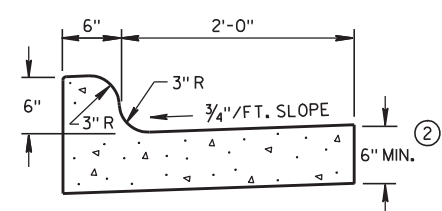

TYPES K & L ①

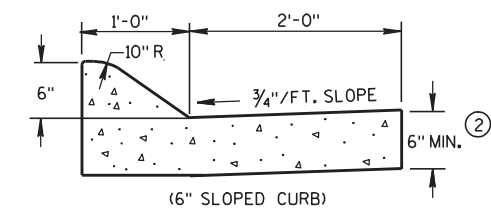

(6" SLOPED CURB) ②

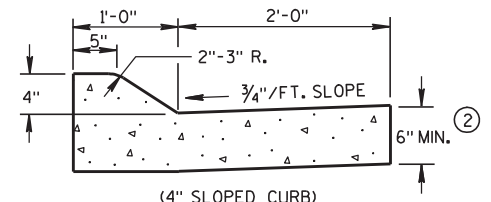

(4" SLOPED CURB) ②

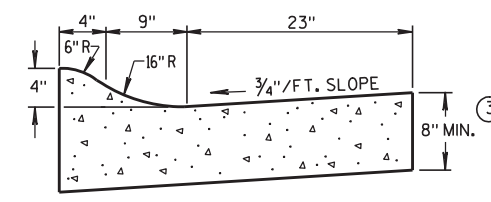

4" SLOPED CURB TYPES R & T ① ④

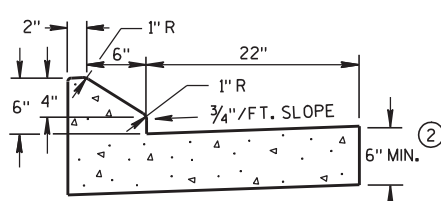

6" SLOPED CURB TYPES G & J ①

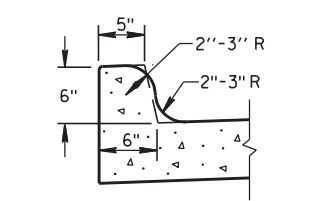

OPTIONAL CURB SHAPE FOR TYPES K & L ①

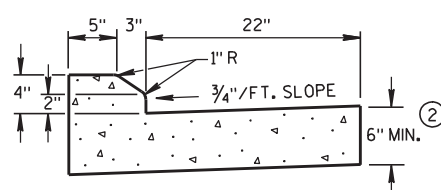

4" SLOPED CURB TYPES G & J ①

CONCRETE CURB & GUTTER 30"

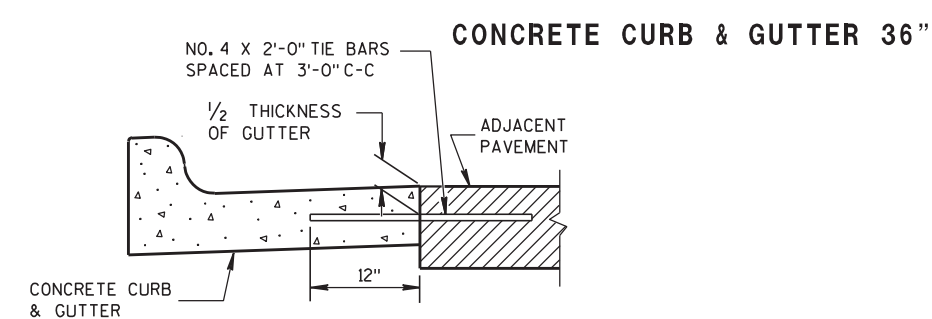

TYPICAL TIE BAR LOCATION ①

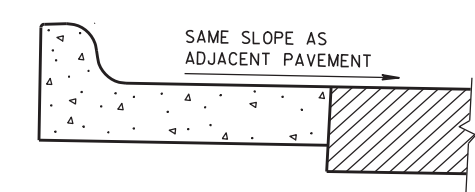

REVERSE SLOPE GUTTER ⑤

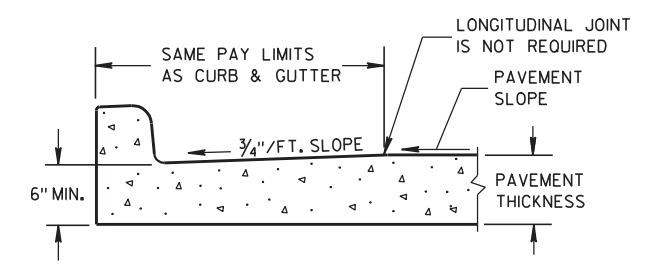

PARTIAL SECTION OF PAVEMENT WITH INTEGRAL CURB & GUTTER

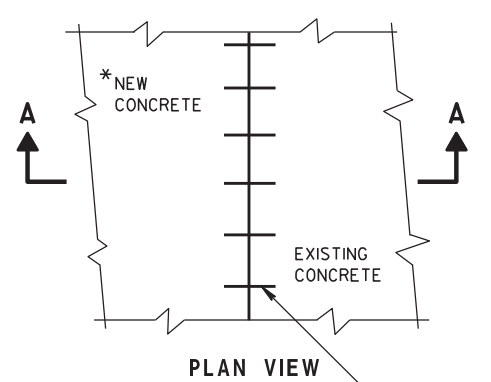

PLAN VIEW

* NEW CURB & GUTTER, SURFACE DRAINS, CONCRETE PAVEMENT OR OTHER NEW CONCRETE.

NO. 6 TIE BARS SPACED 2'-6" C-C, INSTALLED PERPENDICULAR TO THE LONGITUDINAL JOINT.

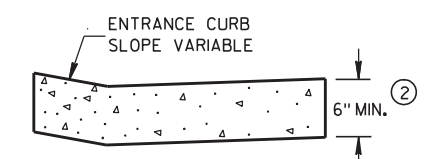

DRIVEWAY ENTRANCE CURB (WHEN DIRECTED BY THE ENGINEER) ②

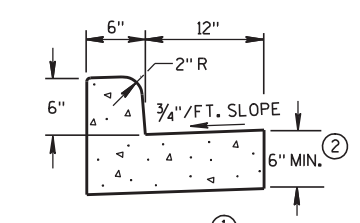

TYPES A & D CONCRETE CURB & GUTTER 18" ②

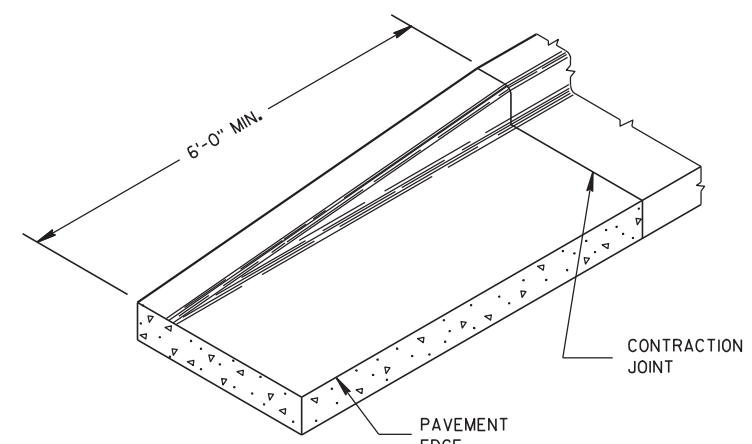

END SECTION CURB & GUTTER

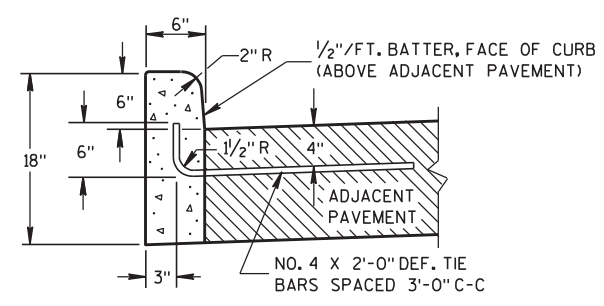

TYPES A & D ①

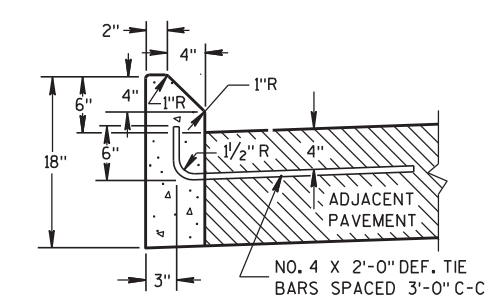

TYPES G & J ①

CONCRETE CURB

GENERAL NOTES

DETAILS OF CONSTRUCTION, MATERIALS AND WORKMANSHIP NOT SHOWN ON THIS DRAWING SHALL CONFORM TO THE PERTINENT REQUIREMENTS OF THE CONTRACT.
PAVEMENT TIES AND TIE BARS SHALL BE EPOXY COATED IN CONFORMANCE WITH SUBSECTION 505.2.6.2 OF THE STANDARD SPECIFICATIONS.

INTEGRAL CURB & GUTTER SHALL CONFORM TO THE DETAILS SHOWN FOR CONCRETE CURB & GUTTER INCLUDING THE TRANSVERSE GUTTER SLOPE. A LONGITUDINAL CONSTRUCTION JOINT IS NOT REQUIRED WITH INTEGRAL CURB AND GUTTER.

WHERE THE TRANSVERSE JOINTS IN THE PAVEMENT ARE REQUIRED TO BE SEALED, THE JOINTS IN THE INTEGRAL CURB AND GUTTER SHALL BE SEALED TO THE FACE OF CURB WITH THE SAME TYPE OF SEALANT. THE COST OF FURNISHING AND INSTALLING THIS SEALANT SHALL BE INCIDENTAL TO THE ITEM CONCRETE CURB AND GUTTER.

UNLESS OTHERWISE SHOWN ON THE TYPICAL CROSS SECTIONS, THE BASE AGGREGATE AND COMMON EXCAVATION LIMITS ARE 2'-0" BEHIND THE BACK OF CURBS.

- ① TIE BARS ARE REQUIRED FOR CURB AND GUTTER TYPES A, G, K AND R.
- ② THE BOTTOM OF CURB AND GUTTER MAY BE CONSTRUCTED EITHER LEVEL OR PARALLEL TO THE SLOPE OF THE SUBGRADE OR BASE AGGREGATE PROVIDED A 6" MINIMUM GUTTER THICKNESS IS MAINTAINED.
- ③ THE BOTTOM OF CURB AND GUTTER MAY BE CONSTRUCTED EITHER LEVEL OR PARALLEL TO THE SLOPE OF THE SUBGRADE OR BASE AGGREGATE PROVIDED A 8" MINIMUM GUTTER THICKNESS IS MAINTAINED.
- ④ THE FACE OF CURB IS 6" FROM THE BACK OF CURB.
- ⑤ WHEN REVERSE SLOPE GUTTER IS REQUIRED, THE LOCATION(S) WILL BE SHOWN ELSEWHERE IN THE PLAN.

6

6

S.D.D. 8 D 1-17

S.D.D. 8 D 1-17

SECTION A-A
TIE BARS DRILLED INTO EXISTING PAVEMENT

MAXIMUM DRILL HOLE SIZE IS 1/8" GREATER THAN TIE BAR DIAMETER

CONCRETE CURB, CONCRETE CURB & GUTTER AND TIES

STATE OF WISCONSIN
DEPARTMENT OF TRANSPORTATION

APPROVED
9/4/08 /S/ Jerry H. Zogg
DATE ROADWAY STANDARDS DEVELOPMENT ENGINEER
FHWA

4-23-14 YT

CALLOUT NUMBER	DESCRIPTION
1	PAVEMENT MARKING EPOXY, 4-INCH, YELLOW
2	PAVEMENT MARKING EPOXY, 2' LINE X 6' GAP, 8-INCH, WHITE
3	PAVEMENT MARKING EPOXY, 8-INCH, WHITE
4	PAVEMENT MARKING PAINT, MEDIAN NOSE, YELLOW
5	PAVEMENT MARKING EXISTING, 4-INCH, YELLOW
6	PAVEMENT MARKING EXISTING, 4-INCH, WHITE
7	PAVEMENT MARKING EXISTING, 10' LINE X 30' GAP, 6-INCH, WHITE

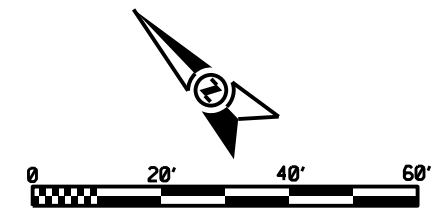

PLOT SCALE:
PLOT NAME:
REV. DATE:
ORIGINATOR: CITY OF MADISON, TRAFFIC ENG. DIV.

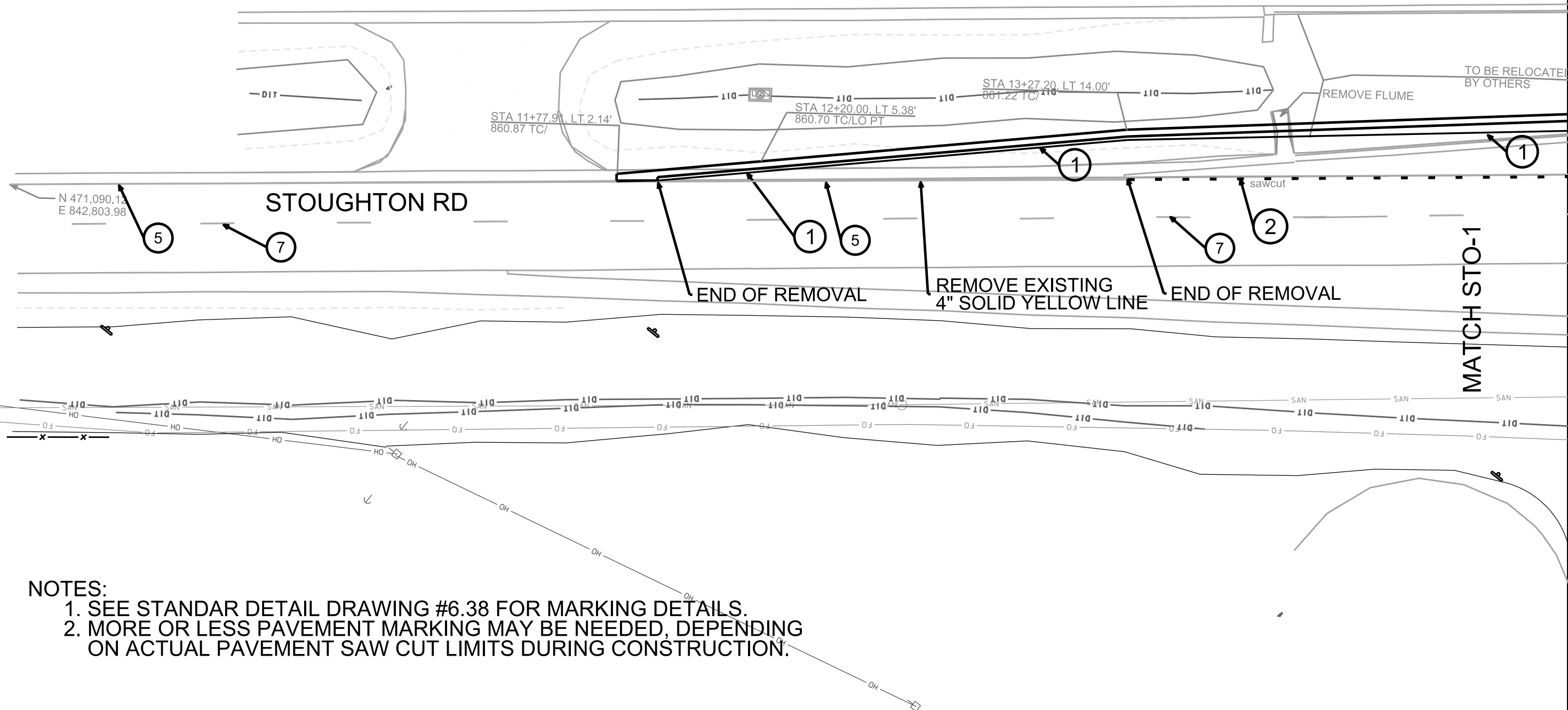

- NOTES:**
1. SEE STANDAR DETAIL DRAWING #6.38 FOR MARKING DETAILS.
 2. MORE OR LESS PAVEMENT MARKING MAY BE NEEDED, DEPENDING ON ACTUAL PAVEMENT SAW CUT LIMITS DURING CONSTRUCTION.

PAVEMENT MARKING PLAN

STOUGHTON RD CITY OF MADISON

4-23-14 YT

CALLOUT NUMBER	DESCRIPTION
1	PAVEMENT MARKING EPOXY, 4-INCH, YELLOW
2	PAVEMENT MARKING EPOXY, 2' LINE X 6' GAP, 8-INCH, WHITE
3	PAVEMENT MARKING EPOXY, 8-INCH, WHITE
4	PAVEMENT MARKING PAINT, MEDIAN NOSE, YELLOW
5	PAVEMENT MARKING EXISTING, 4-INCH, YELLOW
6	PAVEMENT MARKING EXISTING, 4-INCH, WHITE
7	PAVEMENT MARKING EXISTING, 10' LINE X 30' GAP, 6-INCH, WHITE

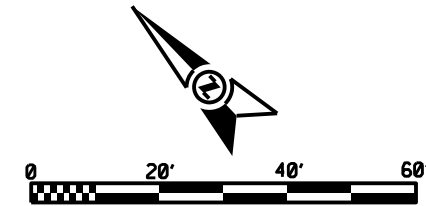

PLOT SCALE:

PLOT NAME:

REV. DATE:

ORIGINATOR: CITY OF MADISON, TRAFFIC ENG. DIV.

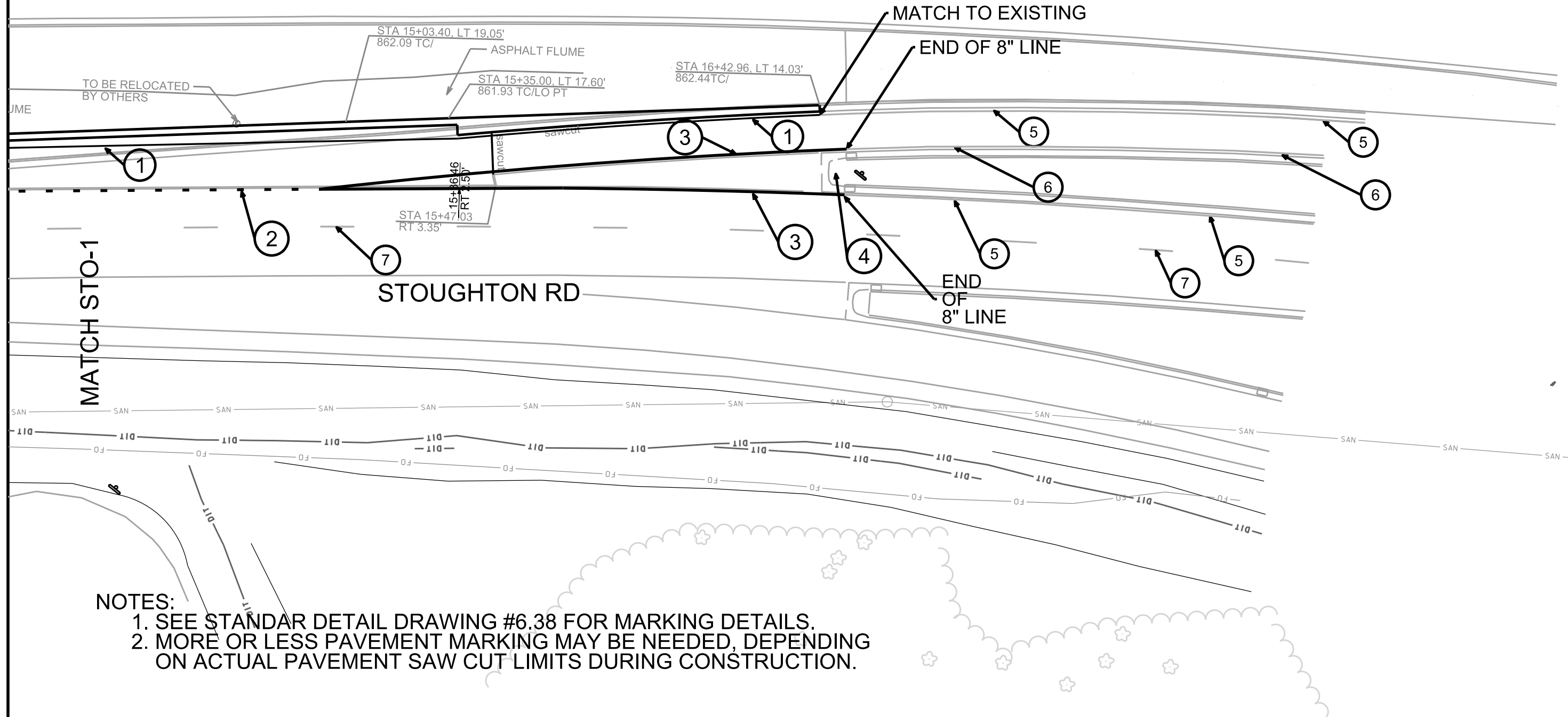

NOTES:

1. SEE STANDAR DETAIL DRAWING #6.38 FOR MARKING DETAILS.
2. MORE OR LESS PAVEMENT MARKING MAY BE NEEDED, DEPENDING ON ACTUAL PAVEMENT SAW CUT LIMITS DURING CONSTRUCTION.

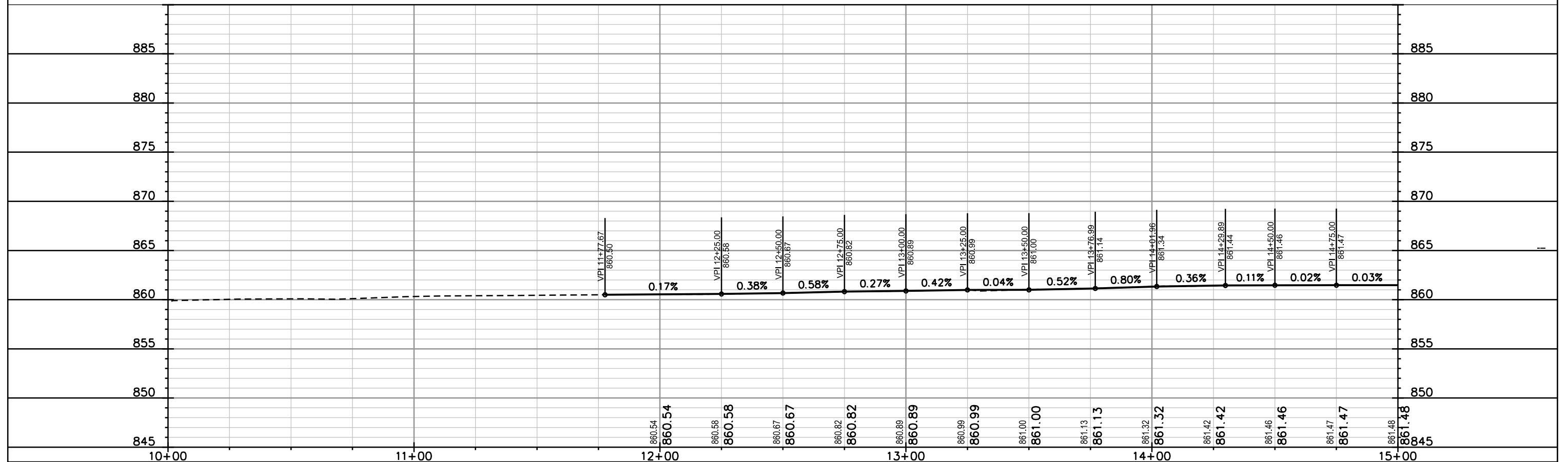
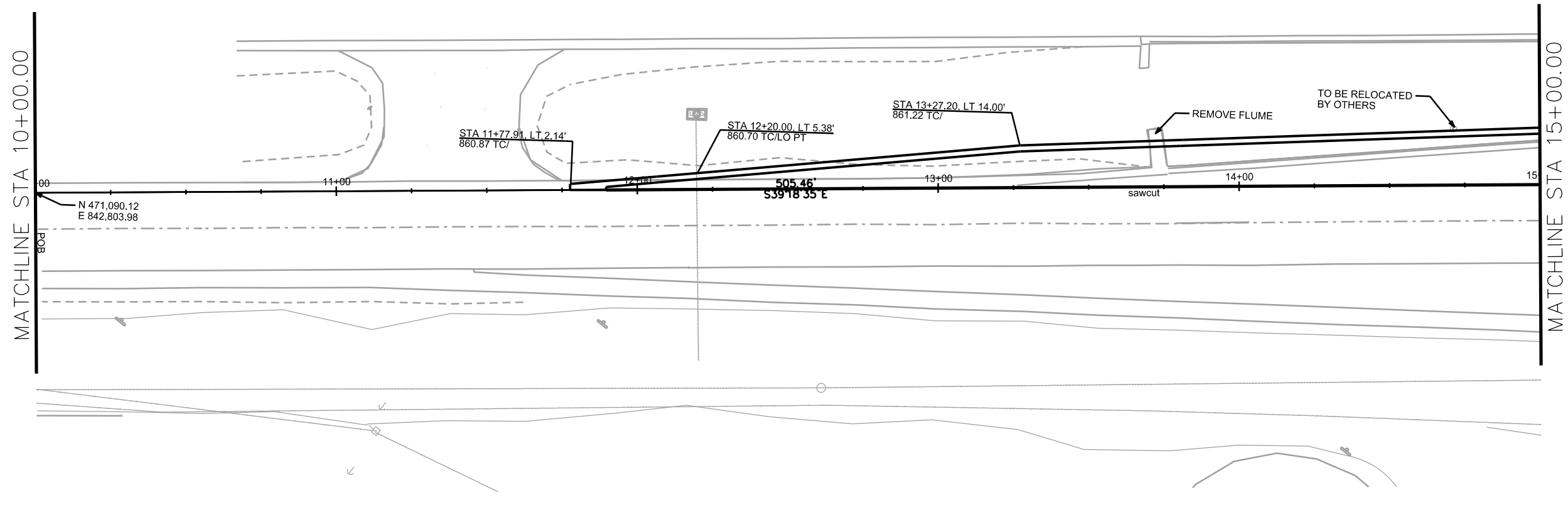
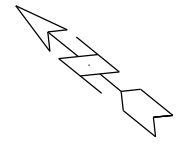

PLOT SCALE: _____

PLOT NAME: _____

REV. DATE: _____

ORIGINATOR: CITY OF MADISON, STREETS DIVISION

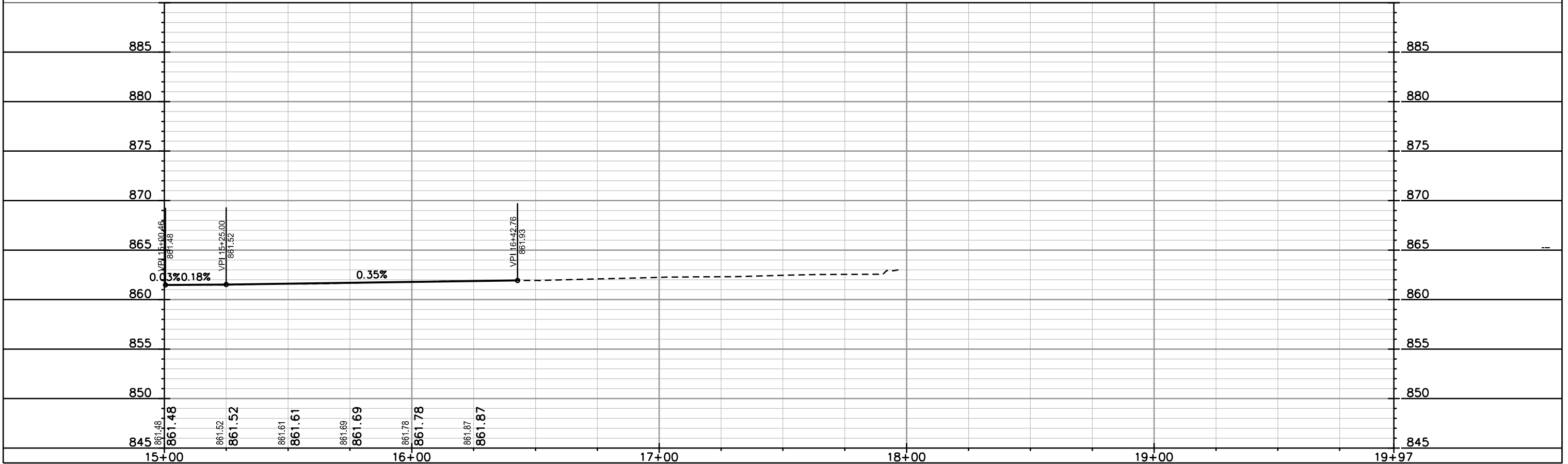
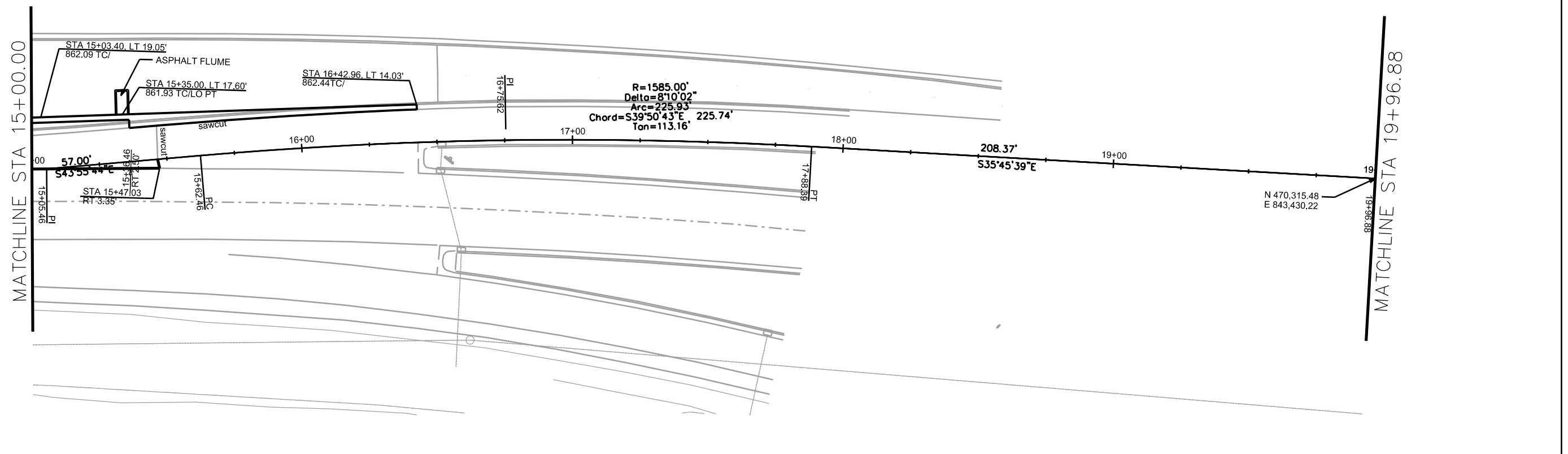
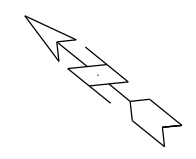

PLOT SCALE: _____

PLOT NAME: _____

REV. DATE: _____

ORIGINATOR: CITY OF MADISON, STREETS DIVISION

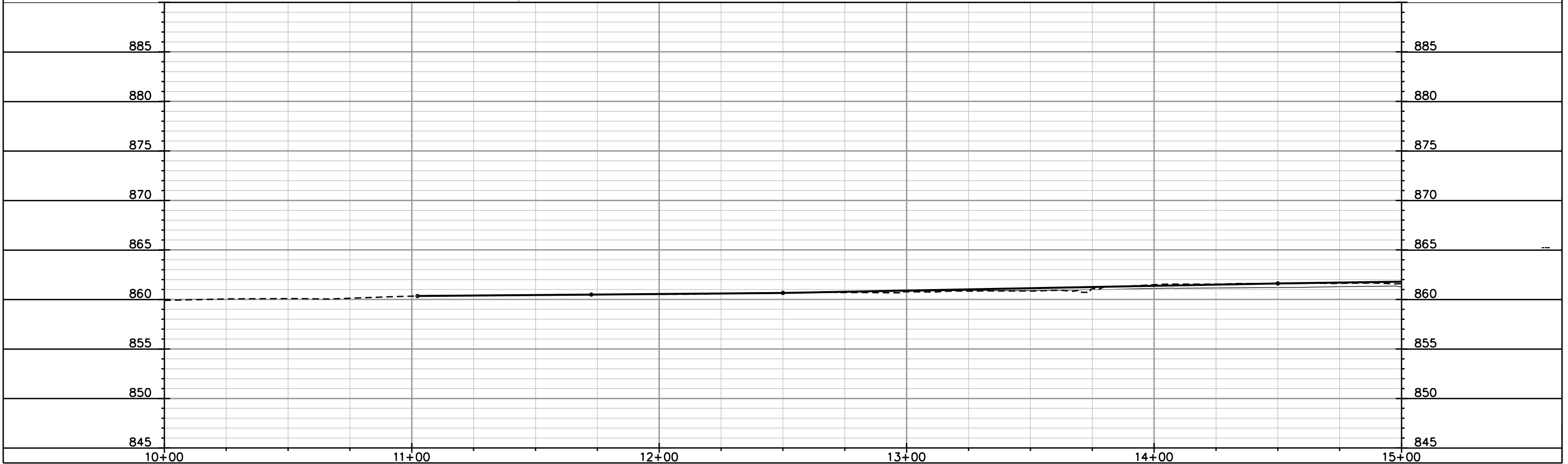
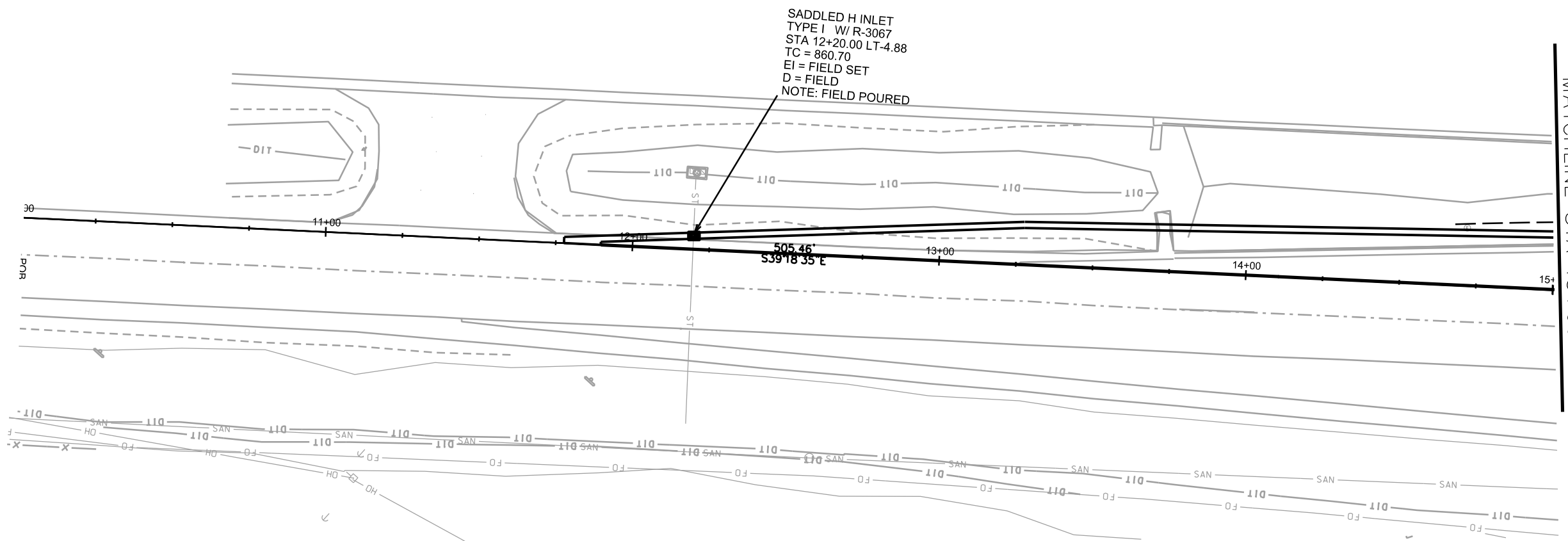
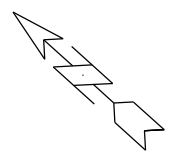

PLOT SCALE: _____

PLOT NAME: _____

REV. DATE: _____

ORIGINATOR: CITY OF MADISON, STREETS DIVISION

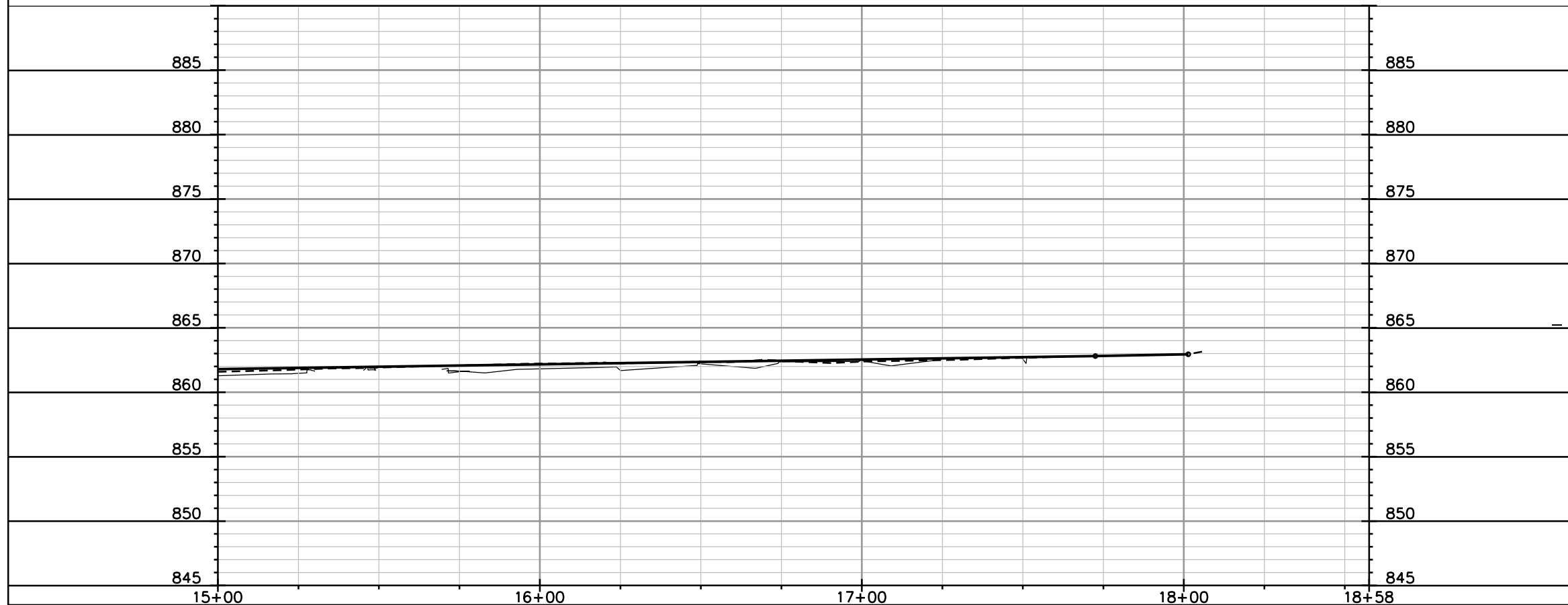
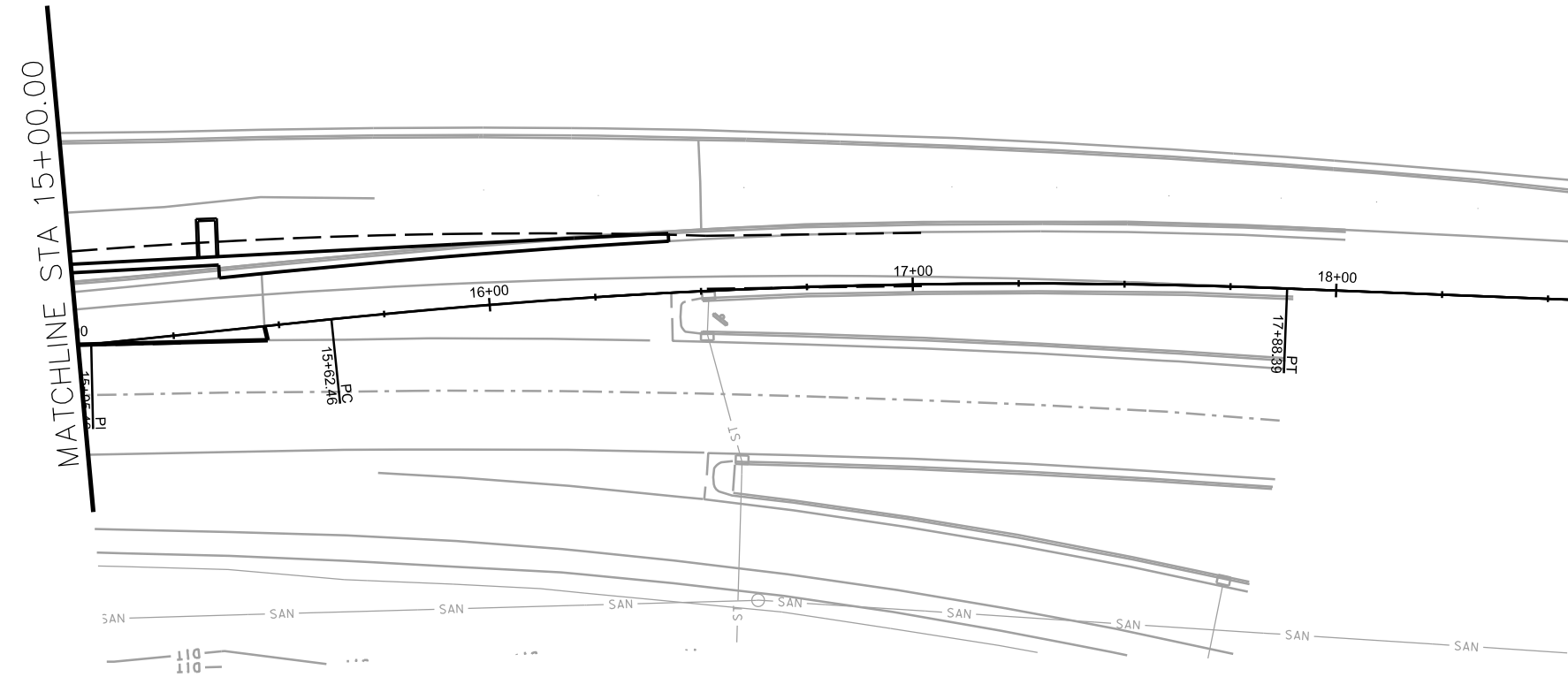
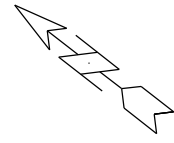

PLOT SCALE: _____

PLOT NAME: _____

REV. DATE: _____

ORIGINATOR: CITY OF MADISON, STREETS DIVISION

CROSS SECTIONS
STOUGHTON RD CITY OF MADISON

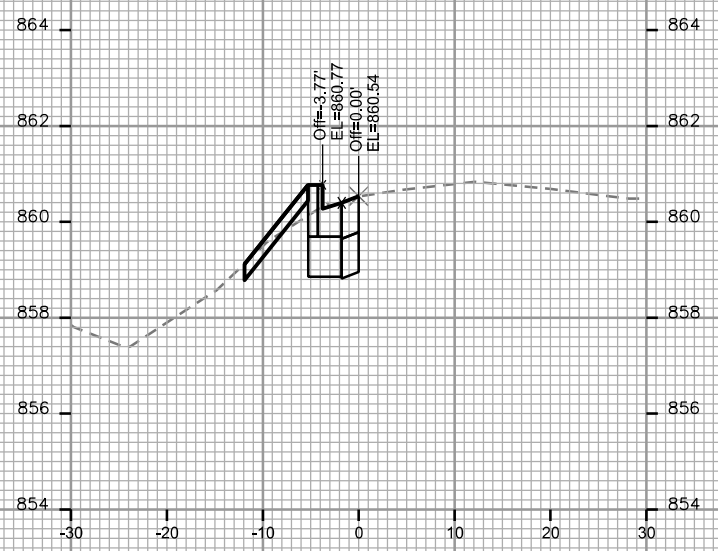

STA. 12+00

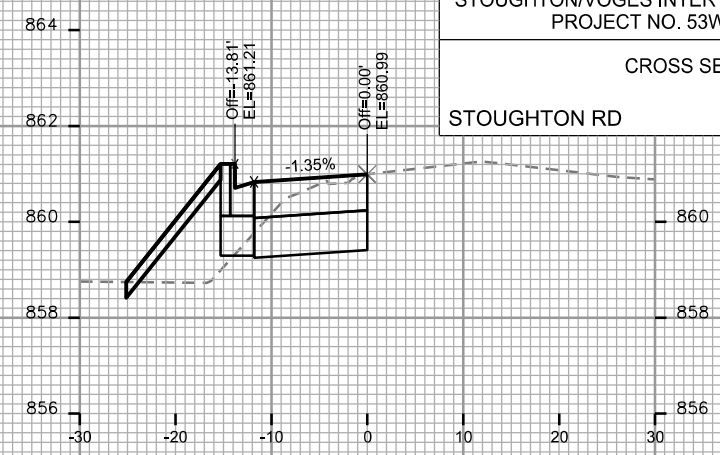

STA. 13+25

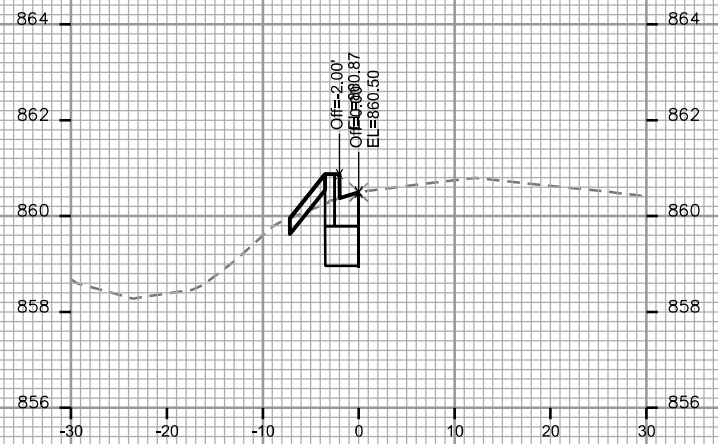

STA. 11+78

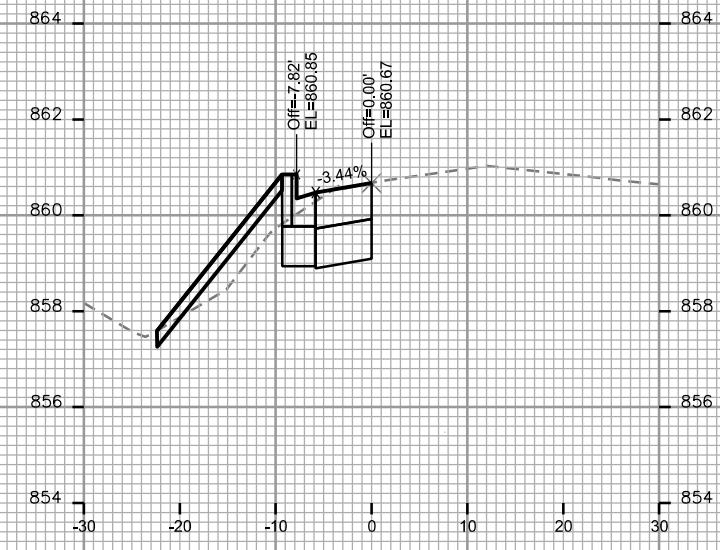

STA. 12+50

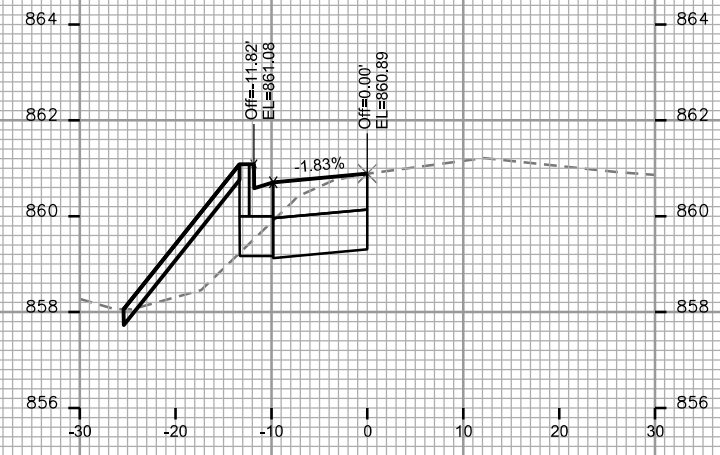

STA. 13+00

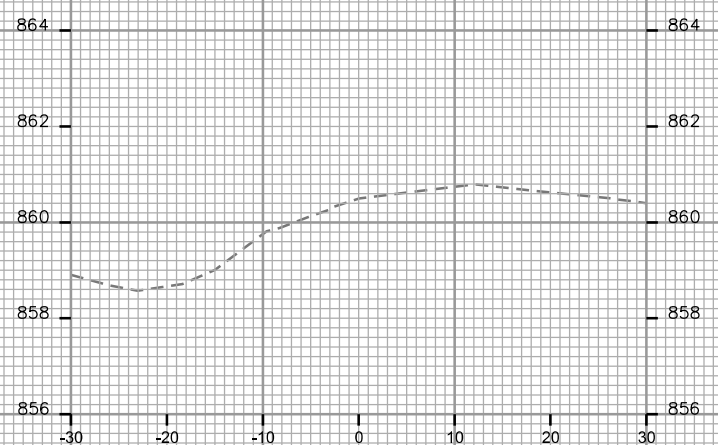

STA. 11+75

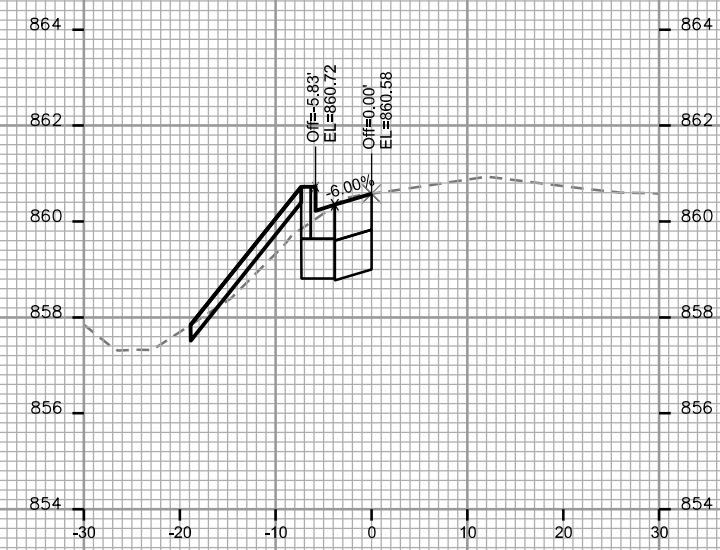

STA. 12+25

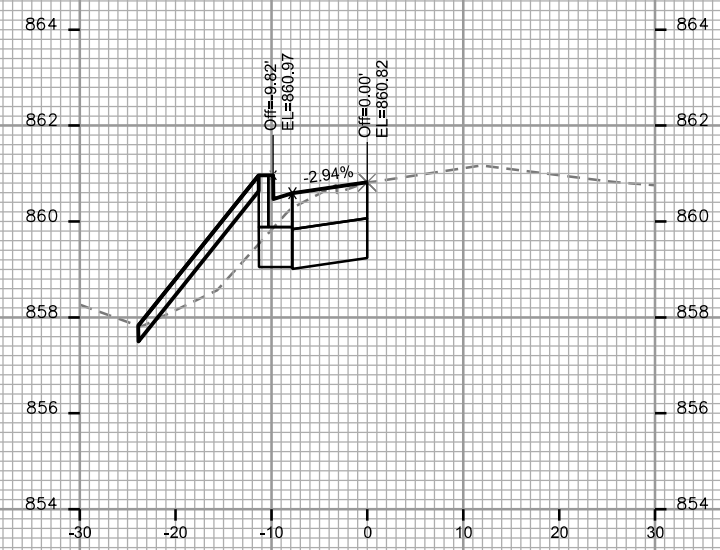

STA. 12+75

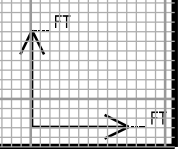

PLOT SCALE: _____

PLOT NAME: _____

REV. DATE: _____

ORIGINATOR: CITY OF MADISON, STREETS DIVISION

CROSS SECTIONS

STOUGHTON RD

CITY OF MADISON

PLOT SCALE: _____

PLOT NAME: _____

REV. DATE: _____

ORIGINATOR: CITY OF MADISON, STREETS DIVISION

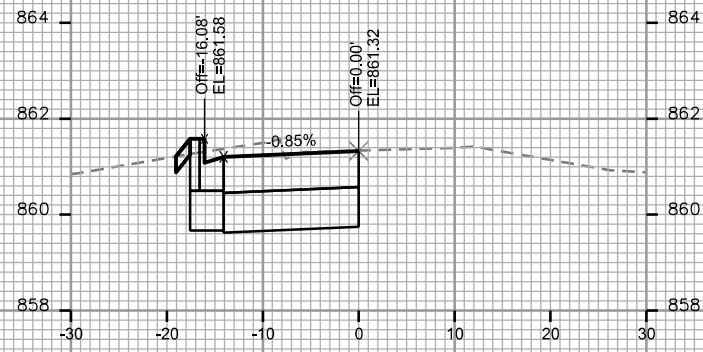

STA. 14+00

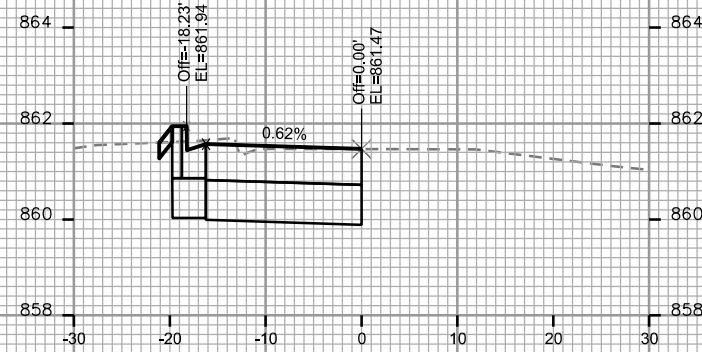

STA. 14+75

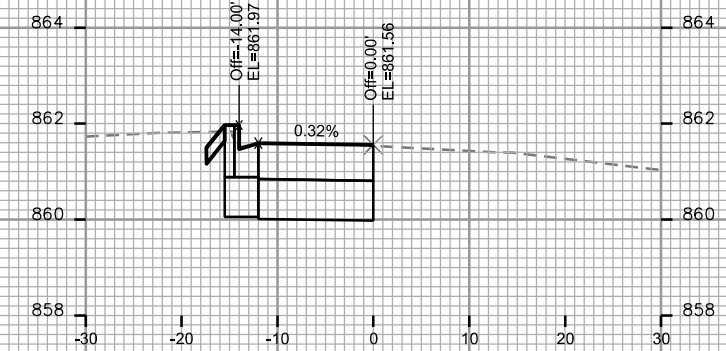

STA. 15+35

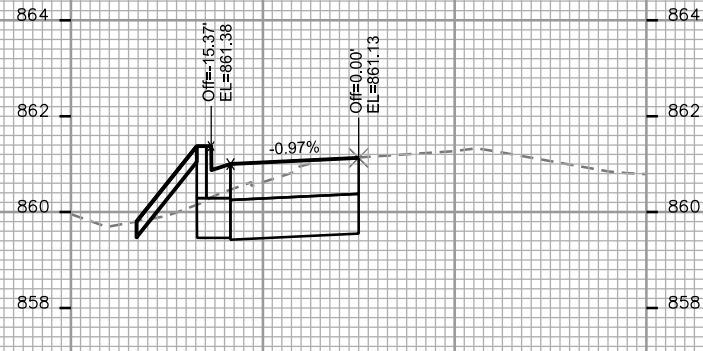

STA. 13+75

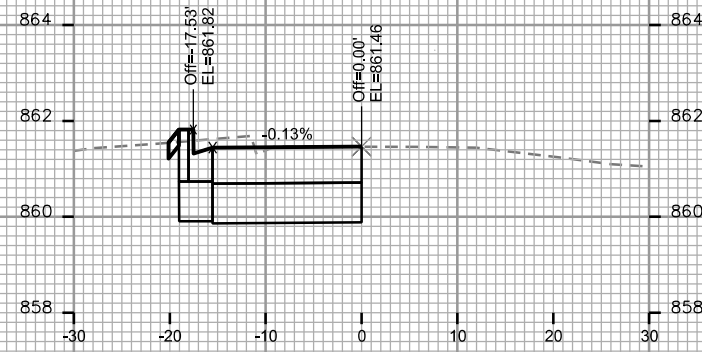

STA. 14+50

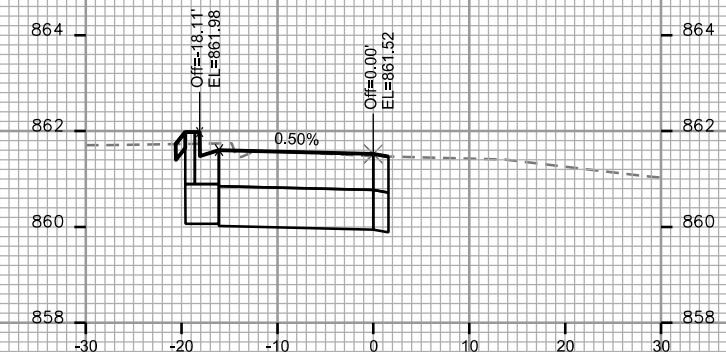

STA. 15+25

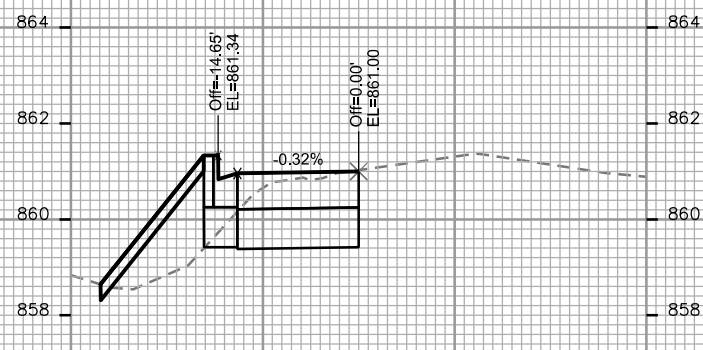

STA. 13+50

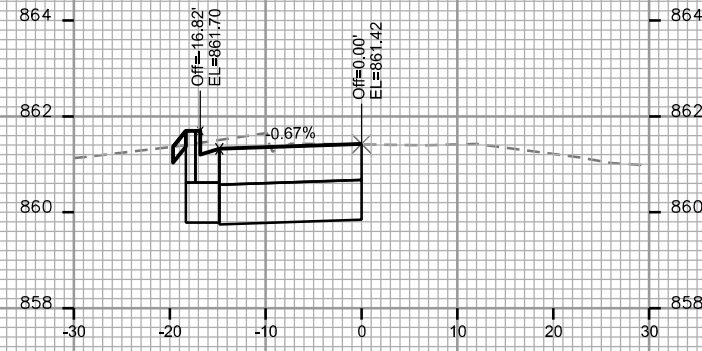

STA. 14+25

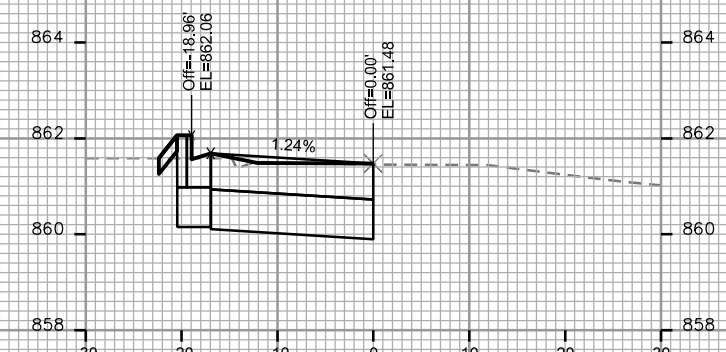

STA. 15+00

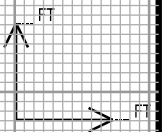

CROSS SECTIONS

STOUGHTON RD

CITY OF MADISON

PLOT SCALE: _____

PLOT NAME: _____

REV. DATE: _____

ORIGINATOR: CITY OF MADISON, STREETS DIVISION

