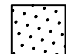



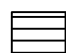

EXHIBIT "A"



GENERAL NOTES:

- VINYL COVE BASE TO BE JOHNSONITE, 4" HIGH X 1/2" THICK; COLOR 167 FUDGE
- BASE BID FLOORING TYPES KEY:

-  EXISTING FLOOR - NO CHANGE
-  CARPET TILES:
TANDUS DIVIDE 03863 24"x24"
COLOR: 79008 BURGESS
QUARTER TURN PATTERN
-  WALKOFF TILE:
MOHAWK 24"x24"
STEP UP II/GT311; 859 WALNUT
QUARTER TURN PATTERN
-  BASE BID:
TANDUS DIVIDE 03863 24"x24"
COLOR: 79008 BURGESS
QUARTER TURN PATTERN
- ALTERNATE 1:
WALKOFF TILE: MOHAWK 24"x24"
STEP UP II/GT311, 859 WALNUT
QUARTER TURN PATTERN
-  RUBBER FLOOR TILES
NORA SYSTEMS 39.53" x 39.53"
NORAMENT GRANO
COLOR: TO BE DETERMINED FROM
STANDARD COLORS
-  BASE BID: NO FLOORING
REPLACEMENT IN CONFERENCE RM 104
- ALTERNATE 2:
TANDUS DIVIDE 03863 24"x24"
COLOR: 79008 BURGESS
QUARTER TURN PATTERN

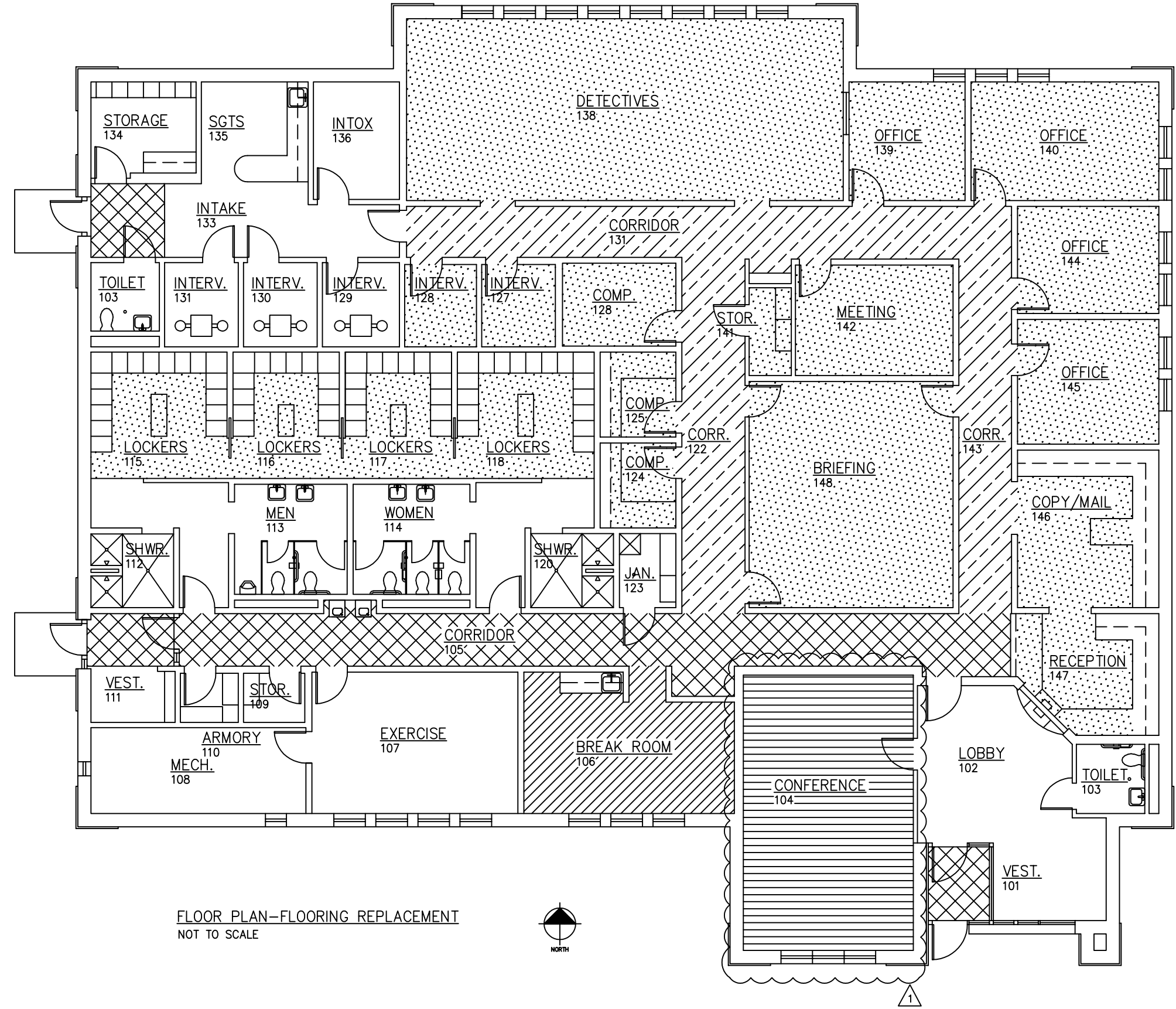

FLOOR PLAN-FLOORING REPLACEMENT
NOT TO SCALE



DRAWN BY:
ENLKA
DATE: 08/16/2018
REVISED: 08/30/18

CITY OF MADISON POLICE-NORTH DISTRICT
FLOORING REPLACEMENT - CONTRACT #8245
2033 LONDONDERRY DR., MADISON, WI