



Madison, Wisconsin

# CITY OF MADISON

## CITY ENGINEERING DIVISION

### DEPARTMENT OF PUBLIC WORKS

# PLAN OF PROPOSED IMPROVEMENT

PUBLIC IMPROVEMENT PROJECT APPROVED

BY THE COMMON COUNCIL  
OF MADISON, WISCONSIN

PUBLIC IMPROVEMENT DESIGN  
APPROVED BY:

*[Signature]* 7/13/12  
City Engineer Date

SANITARY SEWER  
DESIGNED BY:

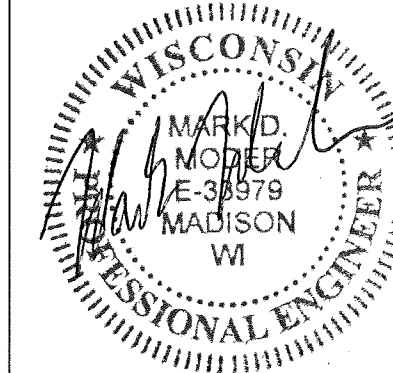

7/12/12

INDEX OF SHEETS

SHEET NO.	TITLE
1	UTILITY PLAN & PROFILE
U1	

## CENTRAL LIBRARY SANITARY SEWER LATERAL

CITY PROJECT NO. 53W1520  
CONTRACT NO. 6939

CONVENTIONAL SIGNS	
FIELD VERIFY ALL UTILITY LOCATIONS	
GAS	— G —
STORM SEWER	— ST —
SANITARY SEWER	— SAN —
WATER	— W —
OVERHEAD ELECTRIC	— OH —
POWER POLE	□
ADA COMPLIANT RAMP W/ DETECTABLE WARNING FIELD	◻
COMBUSTIBLE FLUIDS	<i>[Starburst symbol]</i>

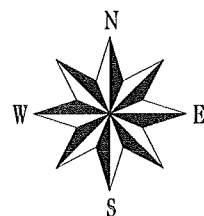

### PROJECT LOCATION

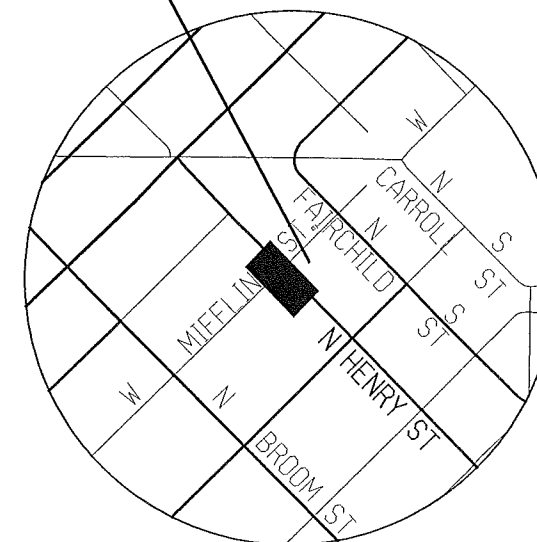
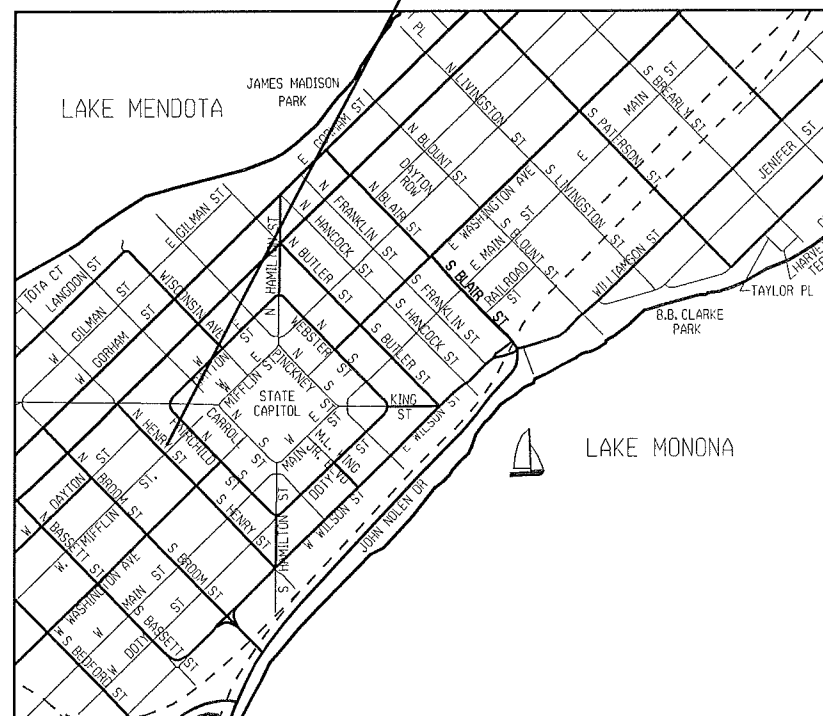

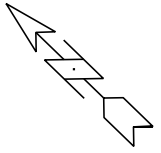

0709-231-0207-7  
OVERTURE DEVELOPMENT CORP  
1 S PINCKNEY ST # 816

WORK TO BE DONE  
BY OTHERS  
(MONONA PLUMBING)  
ULD TO CONFIRM LAT.  
ELEV. PRIOR TO  
COMMENCING  
CONSTRUCTION

Sta 17+07.39 -48.01' L+  
LATERAL SURVEYED  
LOCATION/ELEVATION  
ELEV.=861.29

0709-231-0803-3  
CITY OF MADISON LIBRARY  
CENTRAL LIBRARY  
201 W MIFFLIN ST

0709-231-0801-7  
FIORE COAL & OIL & 20TH  
CENT MKTS & W WASH ASC LLC  
244 W WASHINGTON AVE

EXISTING SAS  
5050-023 TO  
REMAIN  
RIM=869.33  
EI=860.05(NW)15"  
EI=861.13(NE)8"  
EI=861.08(NE)12"  
EI=860.28(E)4"(LAT LIBRARY)  
EI=860.63(S)8"  
EI=860.30(S)8" TAP  
REM.&REP. BENCH&FLOW LINES

REMOVE & RE-INSTALL  
SALVAGED SAS  
#5050-050 LOWER  
RIM=869.16  
EI=860.34(N)  
EI=860.37(S)

\*NOTE: FINDORFF  
TO ADJUST  
ENTRANCE  
LOCATION  
ON MIFFLIN  
WHILE SEWER  
CONSTRUCTION  
UNDERWAY

PROVIDE ELECTRONIC  
MARKER BALL ABOVE  
LATERAL

REMSW & CONCRETE DRIVE AS NEEDED (NO REPLACE)

REM&REP.  
12" INLET  
FO=869.63  
EI=866.80

REM&REP.  
12" STM SEWER  
& C&G  
AS NEEDED

PROJECT LIMITS  
UTILITY TRENCH  
PATCH TYPE 191

0709-231-1226-6  
WISCONSIN TELEPHONE CO  
ONE BELL CENTER  
308 W WASHINGTON AVE

0709-231-1201-8  
WASHINGTON AVE CDM UNIT  
OWNERS ASSOC ANN GAYLORD  
304 W WASHINGTON AVE

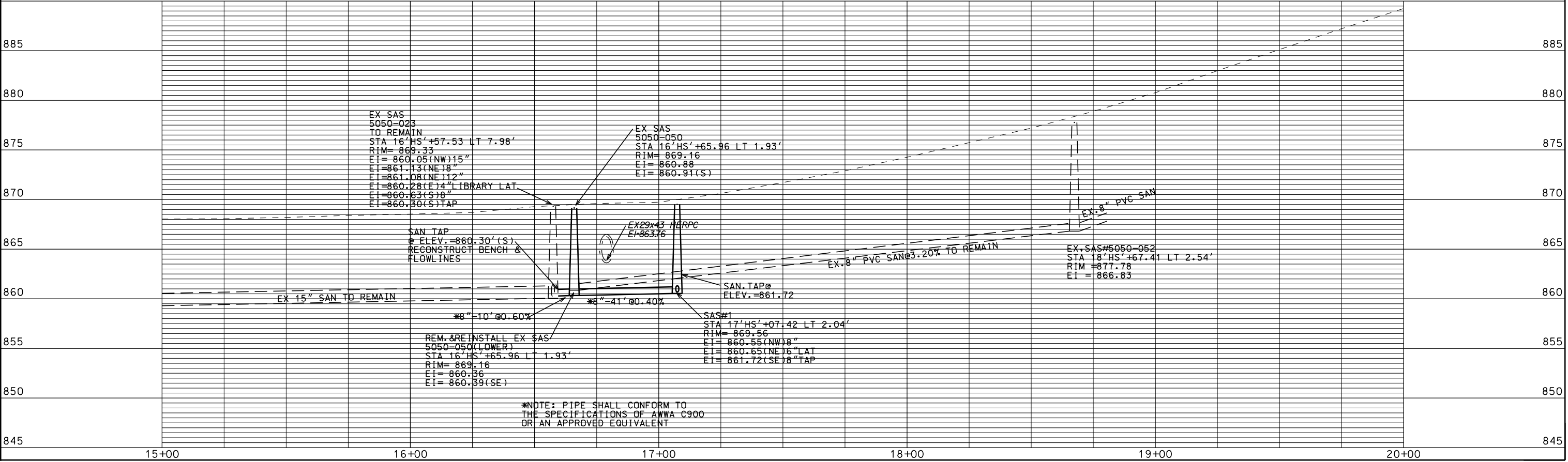
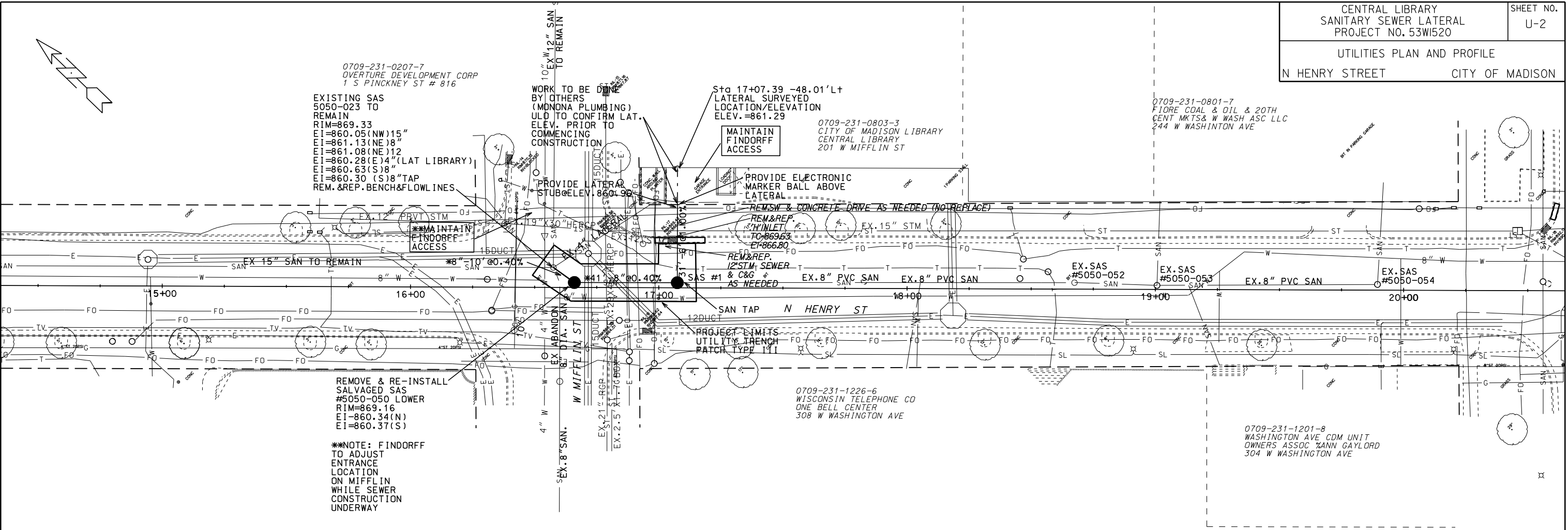

\*NOTE: PIPE SHALL CONFORM TO  
THE SPECIFICATIONS OF AWWA C900  
OR AN APPROVED EQUIVALENT

PLOT SCALE: .....

PLOT NAME: .....

REV. DATE: .....

ORIGINATOR: CITY OF MADISON, STREETS DIVISION