

Madison, Wisconsin

# CITY OF MADISON

## CITY ENGINEERING DIVISION DEPARTMENT OF PUBLIC WORKS

### PLAN OF PROPOSED IMPROVEMENT

# BOULEVARD/ROW

# LANDSCAPING - 2012

PUBLIC IMPROVEMENT PROJECT APPROVED:

SEPTEMBER 9, 2012

BY THE COMMON COUNCIL  
OF MADISON, WISCONSIN

PROJECT DESIGN  
APPROVED BY:

  
City Engineer

  
Date

#### CONVENTIONAL SIGNS

#### COMBUSTIBLE FLUIDS

#### UNDERGROUND UTILITIES

- GAS — G —
- ELECTRIC — E —
- TELEPHONE OR TELEGRAPH — T —
- STORM SEWER — st —
- SANITARY SEWER — SAN —
- WATER — W —
- FIBER OPTICS TELEPHONE — FO —
- POWER POLE — □ —
- RAILROAD — [hatched] —



PROJECT NO. 53W1473

### INDEX OF SHEETS

- SHEET NO. 1 TITLE
- SHEET NO. 2 TREE AND SHRUB TABLE
- SHEET NO. 3 TREE AND SHRUB TABLE
- SHEET NO. 4 TABLE AND SHRUB TABLE
- SHEET NO. 5 TREES AND SHRUBS SCHEDULE
- SHEET NO. 6 TREES AND SHRUBS SCHEDULE
- SHEET NO. 7 TREES AND SHRUBS SCHEDULE
- SHEET NO. 8 MINERAL POINT ROAD LANDSCAPE PLAN
- SHEET NO. 9 MINERAL POINT ROAD LANDSCAPE PLAN
- SHEET NO. 10 MINERAL POINT ROAD LANDSCAPE PLAN
- SHEET NO. 11 MINERAL POINT ROAD LANDSCAPE PLAN
- SHEET NO. 12 MINERAL POINT ROAD LANDSCAPE PLAN
- SHEET NO. 13 FISH HATCHERY ROAD LANDSCAPE PLAN
- SHEET NO. 14 E. WASHINGTON AVENUE AND  
YAHARA RIVER PARKWAY LANDSCAPE PLAN

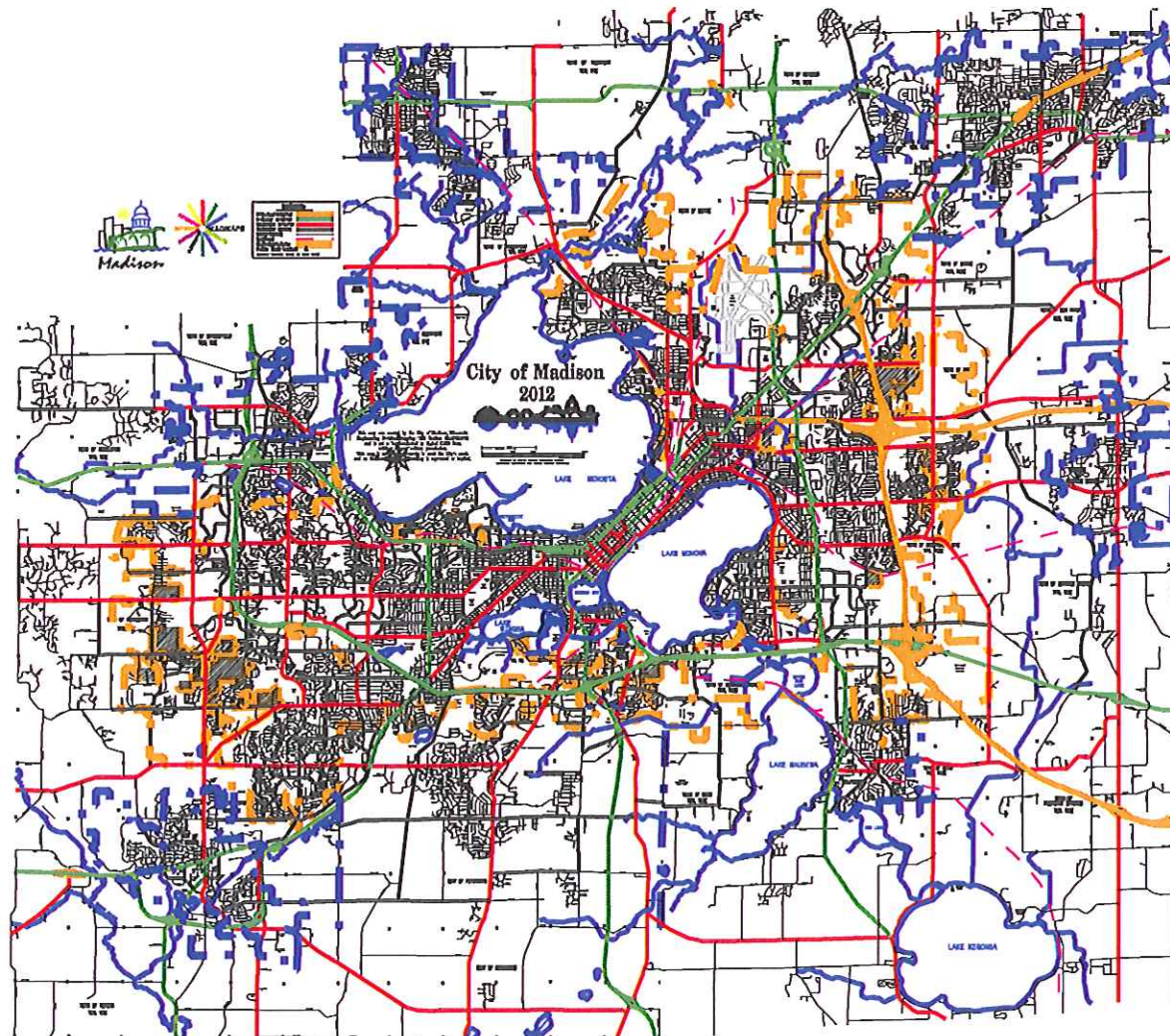

### NOTES

ALL TREES AND SCHRUBS  
INSTALLATIONS ARE WITHIN  
THE CITY LIMITS OF MADISON

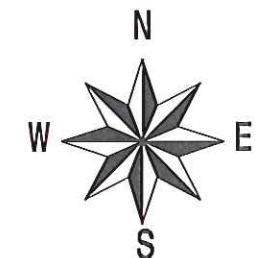

PLOT SCALE: 1" = 100'

PLOT NAME: 53W1473

REV. DATE: 9/12/12

ORIGINATOR: TRUAX



Boulevard /ROW Landscaping 2012 (Tree and Shrub Table)																							SHT. 3
	Ft. McNair Red Horsechestnut	Skycolor Skyline Honeylocust	Red Jewel Crabapple	Royal Raindrops Crabapple	Donald Wyman Crabapple	Cleveland Select Pear	Kectucky Coffeetree 'Expresso'	Thornless Cockspur Hawthorn	Chicagoland Common Hackberry	Japanese Ivory Silk Lilac	EasternWhite Pine	Frontier Elm	London Plane Tree	Ginkgo	Danada Charm* Smoothleaf Elm	Korean Sun Pear	Sargent Cherry "Pink Flair"	Turkist Filbert	"Jefferson" American Elm	River Birch	Norway Spruce	New Horizon Elm	Total by Location
W. Broadway between WPS Drive and Bridge Road			1																				1
Cottage Grove Rd. between Ellen Ave. and Inwood Way				1																			1
Cottage Grove Rd. between Flora Ln. and Meadowlark Dr.			1		1				1														3
Diamond Dr. between Crystal Lane and Garnet lane			1				1																2
Gammon Road between Mineral Point Road and Tree Lane		2																					2
Portland Pkwy. Between Portland cir. To Walbridge Ave.					1																		1
Portland Pkwy. Between Walbridge Ave. to Belmont Rd.				1																			1
Kinsman Blvd. between Stoughton Rd. and Wright St.		1																					1
E. Washington Ave. between Pinecrest Drive and Melvin Ct.		1																					1
E. Washington Ave. between Paterson St. and Livingston St.		1																					1
E. Washington Ave. between Livingston St. and Blount St.						1																	1
S. Park St. between Wingra Dr. and Plaenert Dr.									1														1
S. Park St. between Plaenert Dr. and North Avenue								1	1														2
S. Park St. between Wingra Drive and Cedar Place	1							1	1														3
S. Park St. between Cedar Place and Spruce Street			2																				2
S. Park St. between Spruce Street and Olin Avenue			1																				1
S. Park St. between Fish Hatchery and Haywood Drive			2																				2
S. Park St. between W. Dayton Street and Regent Street				1																			1
Aberg Avenue at Packers Avenue Bridge Abutment											1												1
Fish Hatchery Road between Badger Road and Catalpa Road		1		1	2			2	1			1											8
Pennsylvania Avenue and Johnson Street in Median																	2						2
Mineral Point Rd. between Grand Canyon Dr. Yellowstone Dr.	2		4				1	2		2			1	1	1								14
Mineral Point Rd. between Yellowstone Dr. and Nautilus Drive			1	1			1		1								2						6
Mineral Point Rd. between Nautilus Drive and Island Drive				2											1		2						5
Mineral Point Rd. between Island Drive and Rosa Road	1		2	2	2									1					3		1		12
Mineral Point Rd. between Rosa Road and Whitney Way	3																						3
East Washington Avenue at Yahara River Bridge (North and South side of river, on the west side of the bridge (East Washington Ave. - Sparkle Auto Body side of Yahara)								3															3
East Washington Avenue at Yahara River Bridge (North side of river, on the west side of the bridge)																						1	1
Planting Bed at the Intersection of John Nolen Drive and Olin Avenue				1							1		1							1	1		5
E. Washington Avenue between Marquette St. and Oak St.			1																				1
<b>Grand Total Trees</b>	<b>11</b>	<b>13</b>	<b>31</b>	<b>17</b>	<b>14</b>	<b>4</b>	<b>6</b>	<b>13</b>	<b>10</b>	<b>7</b>	<b>2</b>	<b>4</b>	<b>2</b>	<b>2</b>	<b>2</b>	<b>2</b>	<b>4</b>	<b>3</b>	<b>1</b>	<b>1</b>	<b>1</b>	<b>1</b>	<b>151</b>



<b>CONTRACT # 6950</b>		<b>TREES AND SHRUBS SCHEDULE</b>				<b>TABLE I</b>										<b>SHT. 5</b>
<b>S Y M B L</b>	<b>PLANT NAME</b>	<b>SCIENTIFIC NAME</b>	<b>MATURE HEIGHT</b>	<b>MATURE SPREAD</b>	<b>CALIPER, HGT., SPREAD, SIZE</b>	<b>B &amp; B</b>	<b>P O T T D</b>	<b>B R</b>	<b>S T A K E</b>	<b>W R A P</b>	<b>B U L B S</b>	<b>P R O T E C T I O</b>	<b>S P R I N G</b>	<b>F A L L</b>	<b>Q t y</b>	
<b>TREES</b>																
DW	Donald Wyman Crabapple	Malus 'Donald Wyman'	20'	25'	2.5"	X				X		X		X	14	
RR	Royal Raindrops Crabapple	Malus 'Royal Raindrops'	20'	15'	2.5"	X				X		X		X	17	
RJ	Red Jewel Crabapple	Malus 'Red Jewel'	18'	15'	2.5"	X				X		X		X	31	
HC	Ft Mc Nair Horsechestnut	Aesculus x carnea 'Fort McNair'	40'	40'	2.5"	X				X		X		X	11	
RB	River Birch	Betula nigra	40'	35'	2.5"	X				X		X		X	1	
TF	Turkist Filbert	Corylus colurna	40'	30'	2.5"	X				X		X		X	3	
CH	Chicagoland Hackberry	Celtic occidentalis 'Chicagoland'	60'	45'	2.5"	X				X		X		X	10	
TCH	Thornless Cockspur Hawthorn	Crataegus crusgalli (Crusgalli inermis)	25'	25'	2.5"	X				X		X		X	13	
HL	Skycole Skyline Honeylocust	Gleditsia tricanthos 'Skycole'	55'	35'	2.5"	X				X		X		X	13	
KC	Espresso Kentucky Coffeetree	Gymnocladus dioica 'Espresso'	80'	50'	2.5"	X				X		X		X	6	
GB	Ginkgo	Ginkgo biloba	60'	45'	2.5"	X				X		X		X	2	
LP	London Planetree 'Exclamation'	Platanus x acerifolia 'Morton Circle'	100'	80'	2.5"	X				X		X		X	2	
NS	Norway Spruce	Picea abies	50	40	2.5"	X				X		X		X	1	
WP	Eastern White Pine	Pinus strobus	60'	40'	8' Hgt.	X				X		X		X	2	
CP	Cleveland Select Pear	Pyrus calleryana 'Cleveland Select'	35'	25'	2.5"	X				X		X		X	4	
SCL	Sargent Cherry 'Pink Flair'	Prunus sarenti 'Pink Flair'	15'	15'	2.5"	X				X		X		X	4	
<b>PAGE SUBTOTAL</b>															134	



<b>CONTRACT # 6950</b>		<b>TREES AND SHRUBS SCHEDULE</b>				<b>TABLE I</b>										<b>SHT. 7</b>
<b>S Y M B O L</b>	<b>PLANT NAME</b>	<b>SCIENTIFIC NAME</b>	<b>MATURE HEIGHT</b>	<b>MATURE SPREAD</b>	<b>CALIPER, HGT., SPREAD, SIZE</b>	<b>B &amp; B</b>	<b>P O T T D</b>	<b>B R</b>	<b>S T A K E</b>	<b>W R A P</b>	<b>B U L B S</b>	<b>P R O T E C T I O N</b>	<b>S P R I N G</b>	<b>F A L L</b>	<b>Q t y</b>	
<b>SHRUBS</b>																
LGS	Fragrant Sumac	Rhus aromatica	108"	120"	3 GAL		X						X		8	
GLS	Fragrant Gro-Low Sumac	Rhus aromatica 'Gro-Low'	24"	84"	3 GAL		X						X		109	
KR	Knock Out™ Rose	Rosa 'Radrazz' PP#11836	24"-36"	36"	3 GAL		X						X		2	
RTD	Red Twig Dogwood	Cornus sericea	96"	72"	3 GAL		X						X		17	
YTD	Yellow Twig Dogwood	Cornus sericea 'Flaviramea'	72"	60"	3 GAL		X						X		10	
ID	Isanti Dogwood	Cornus sericea 'Isanti'	72"	72"	3 GAL		X						X		14	
BC	Black Chokeberry	Aronia melanocarpa	60'	60"	3 GAL		X						X		9	
NWA	Alert New York Aster	Aster novi-belgi 'Alert'	15"	18"	3 GAL		X						X		25	
CPB	Crimson Pygmy Barberry	Berberis thunbergii 'Crimson Pygmy'	36"	48"	3 GAL		X						X		1	
AW	Anthony Waterer Spirea	Spiraea x bumalda 'Anthony Waterer'	24"-36"	24"-36"	3 GAL		X						X		33	
<b>GRASSES</b>																
LB	Little Bluestem "The Blues"	Schizachyrium scoparium 'The Blues'	24"-36"	24"	4.5"		X						X		25	
<b>PERENNIALS /GROUNDCOVERS</b>																
SHD	Stella de Ore Daylily	Hemerocallis 'Stella de ore'	12"	12"	1 Gal		X						X		10	
<b>BULBS</b>																
T	Tulips	Tulipa gesneriana	15"	12'							X			X	2500	
D	Daffodils	Narcissus sp.	15"	12'							X			X	2500	
<b>PAGE SUBTOTAL</b>															5263	

GRAND CANYON DRIVE

STATE PROJECT NUMBER	SHEET NO.
	8
PLAN FOR	
MINERAL POINT ROAD	DANE COUNTY

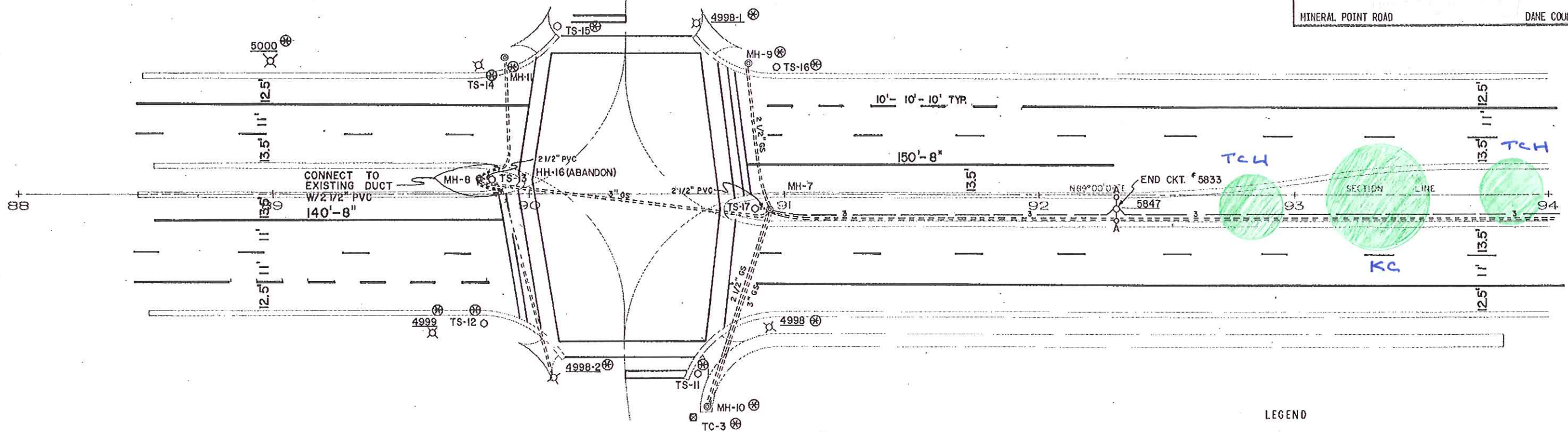

CORONADO COURT

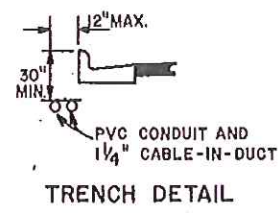

- LEGEND
- Existing Street Light
  - Street Light (Single Arm)
  - Street Light (Twin Arm)
  - Pole Number
  - Traffic Signal
  - Traffic Signal Controller
  - Electrical Manhole
  - Electrical Pull Box
  - PVC Conduit (3" Unless Otherwise Noted)
  - 1 1/4" Cable-in-duct (With Number of Wires Noted)
  - 3" (Size) Galvanized Steel
  - Existing

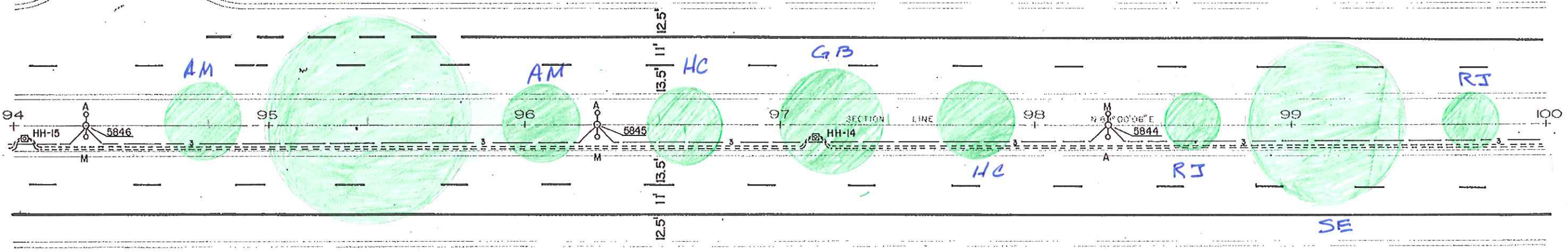



STATE PROJECT NUMBER	SHEET NO.
	9
PLAN FOR	
MINERAL POINT ROAD	DANE COUNTY

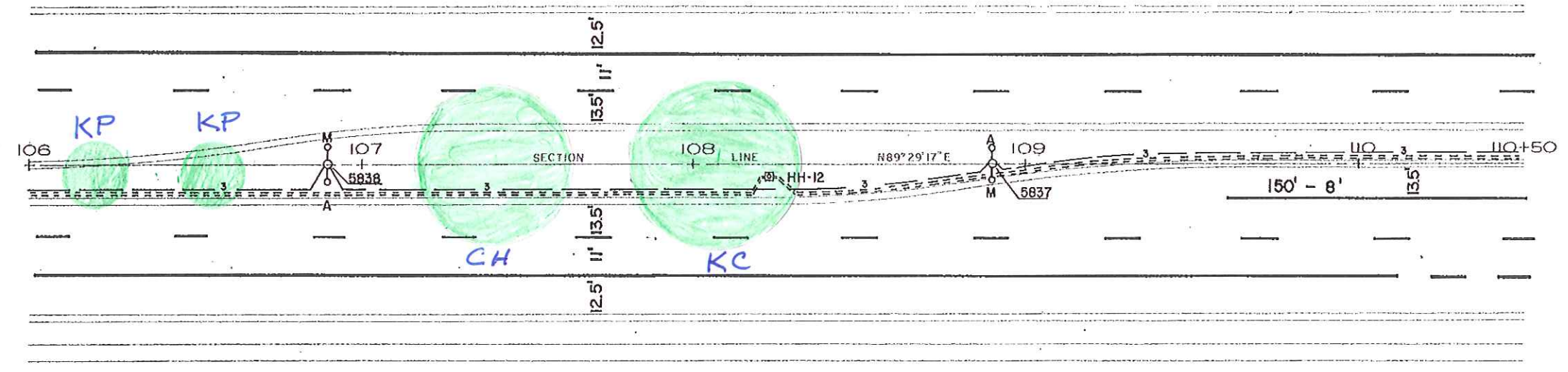
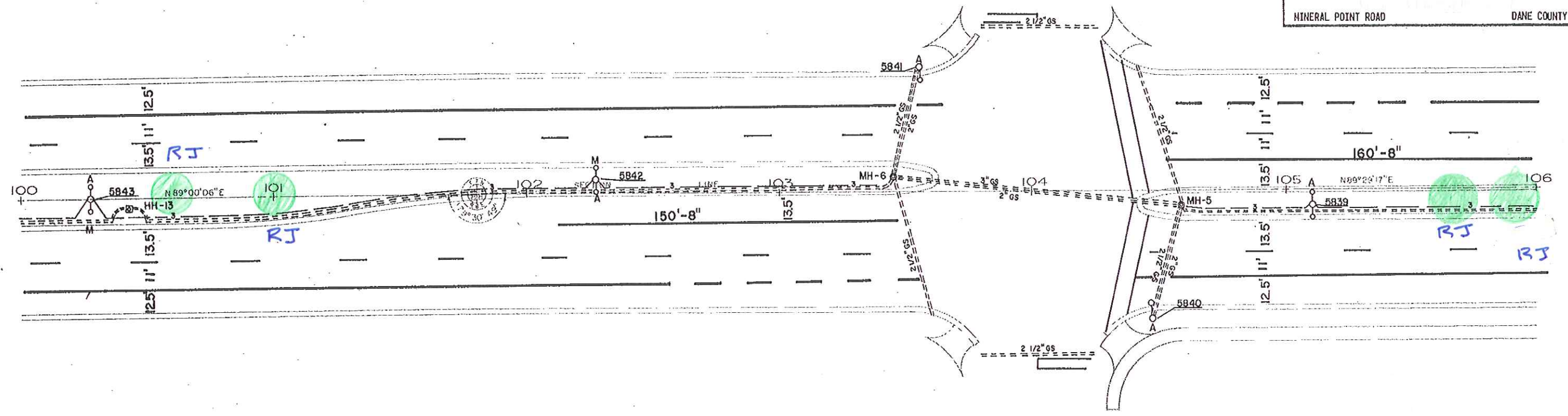

NAUTILUS DRIVE

STATE PROJECT NUMBER	SHEET NO.
	10
PLAN FOR	
MINERAL PUNI ROAD	DANE COUNTY

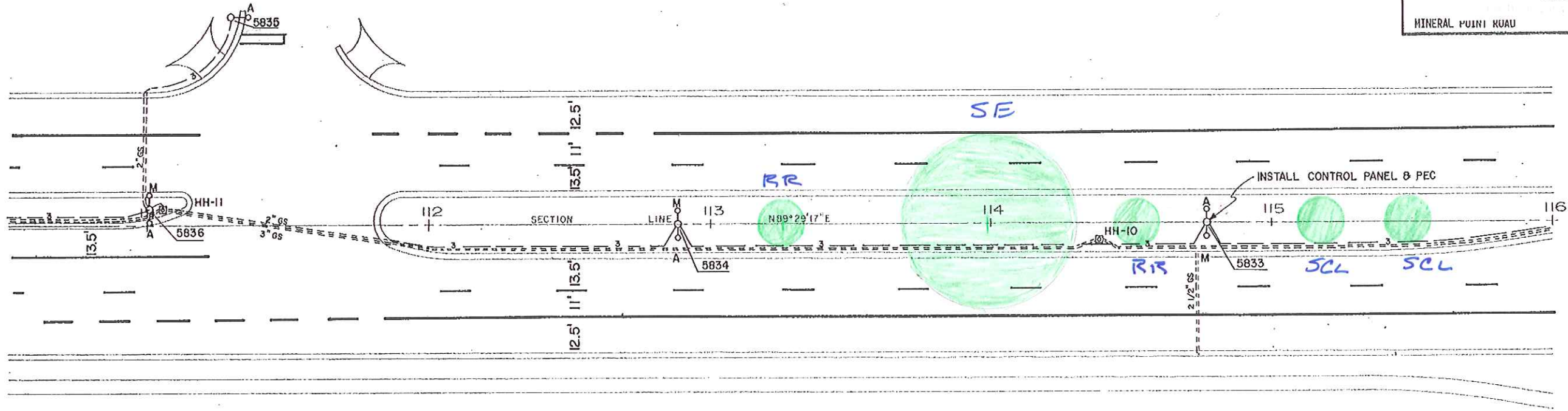

ISLAND DRIVE

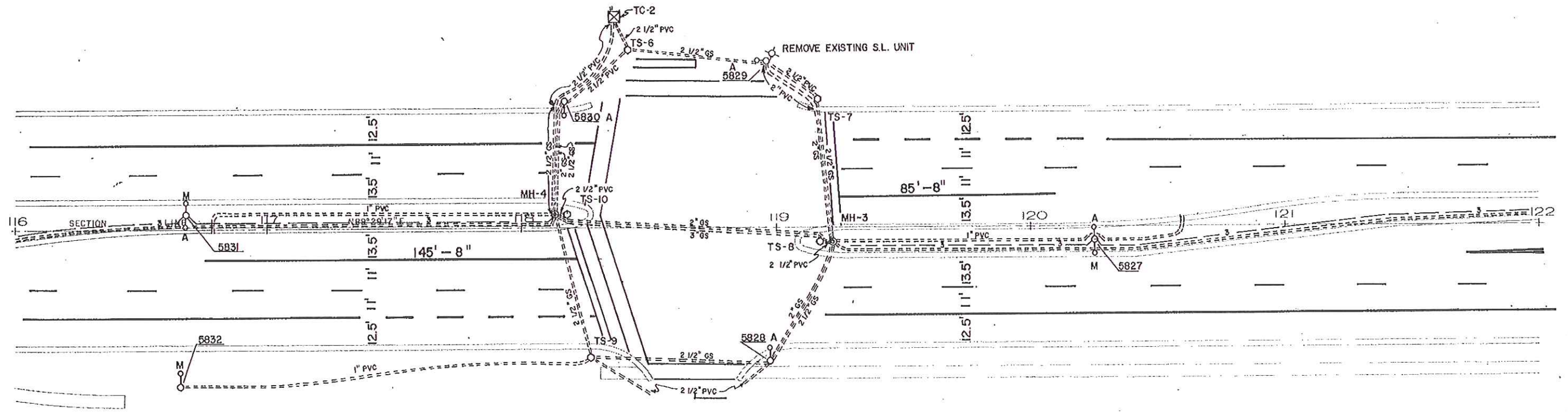

STATE PROJECT NUMBER	SHEET NO.
	//
PLAN FOR	
MINERAL POINT ROAD	DANE COUNTY

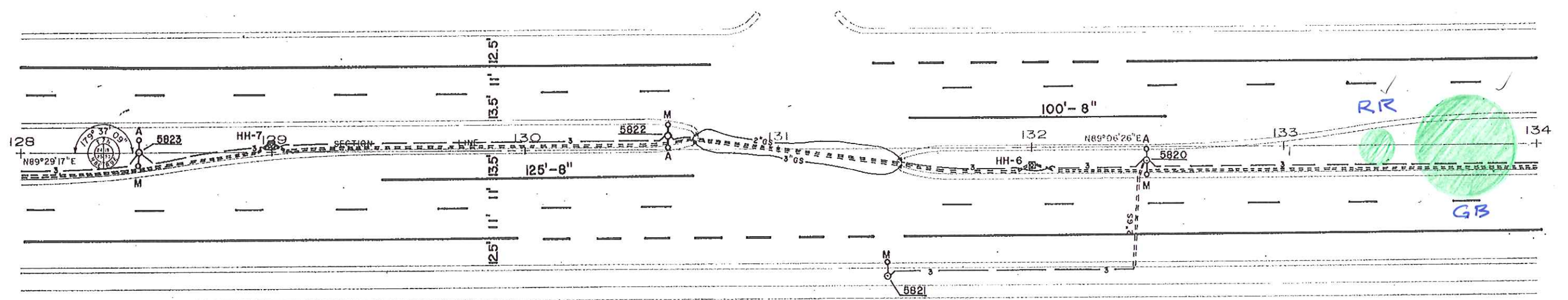
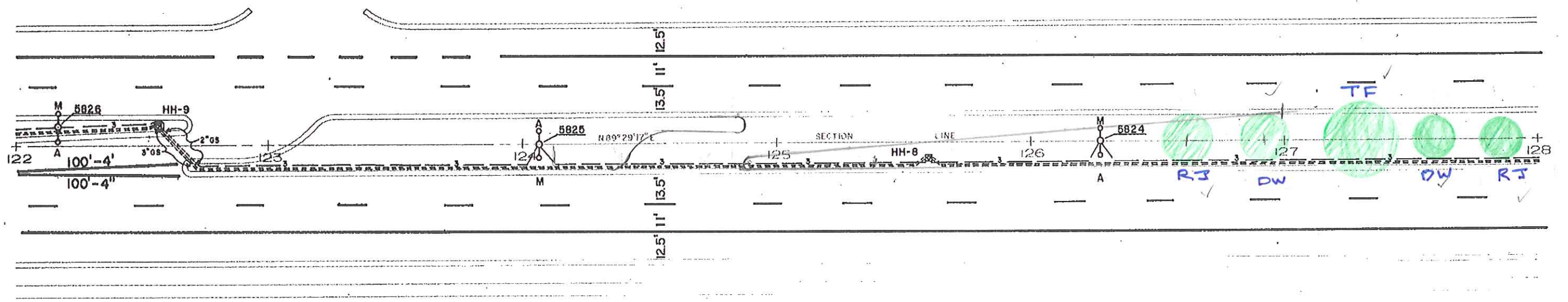

STATE PROJECT NUMBER	SHEET NO.
	12
PLAN FOR	
MINERAL POINT ROAD	DANE COUNTY

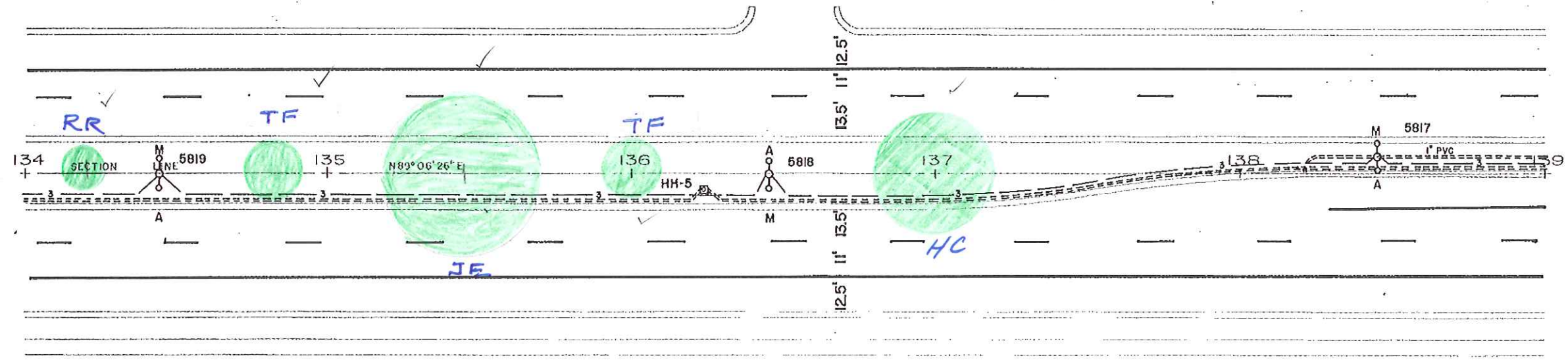

ROSA ROAD

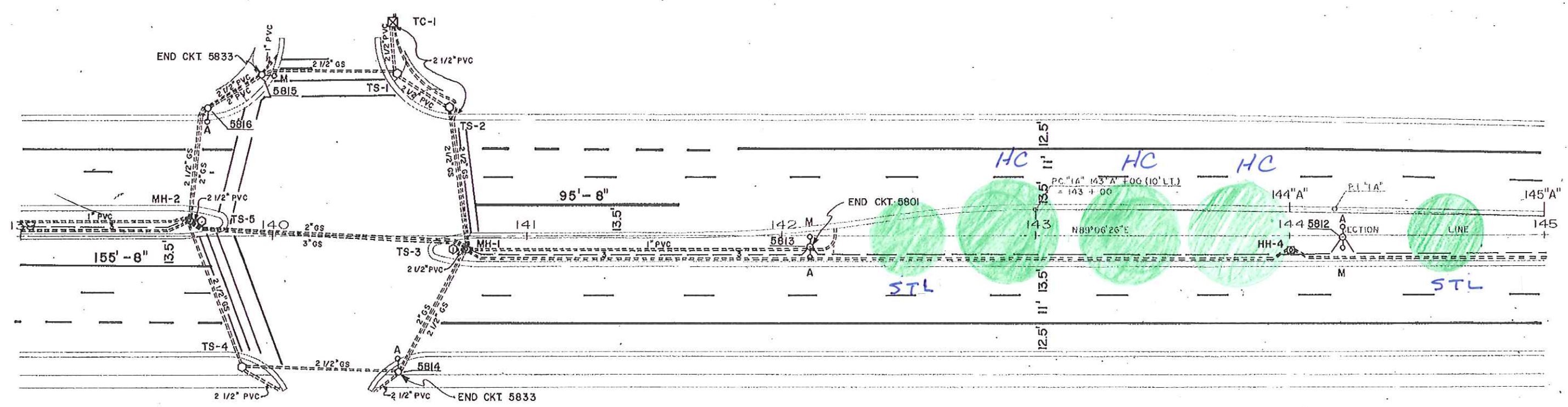

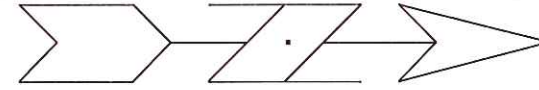

SCALE 1' = 80'

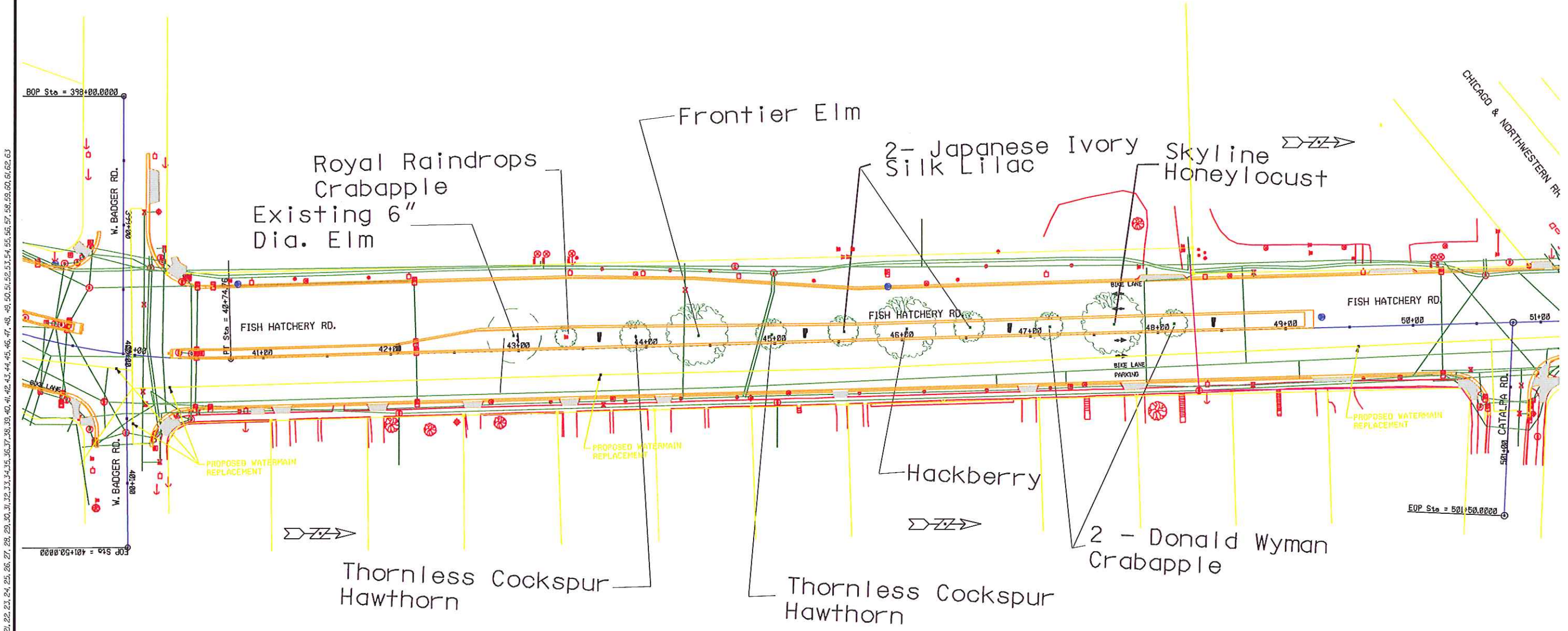

LEVELS ON = 1, 2, 3, 4, 5, 7, 8, 9, 10, 11, 12, 13, 14, 15, 16, 17, 18, 19, 20, 21, 22, 23, 24, 25, 26, 27, 28, 29, 30, 31, 32, 33, 34, 35, 36, 37, 38, 39, 40, 41, 42, 43, 44, 45, 46, 47, 48, 49, 50, 51, 52, 53, 54, 55, 56, 57, 58, 59, 60, 61, 62, 63

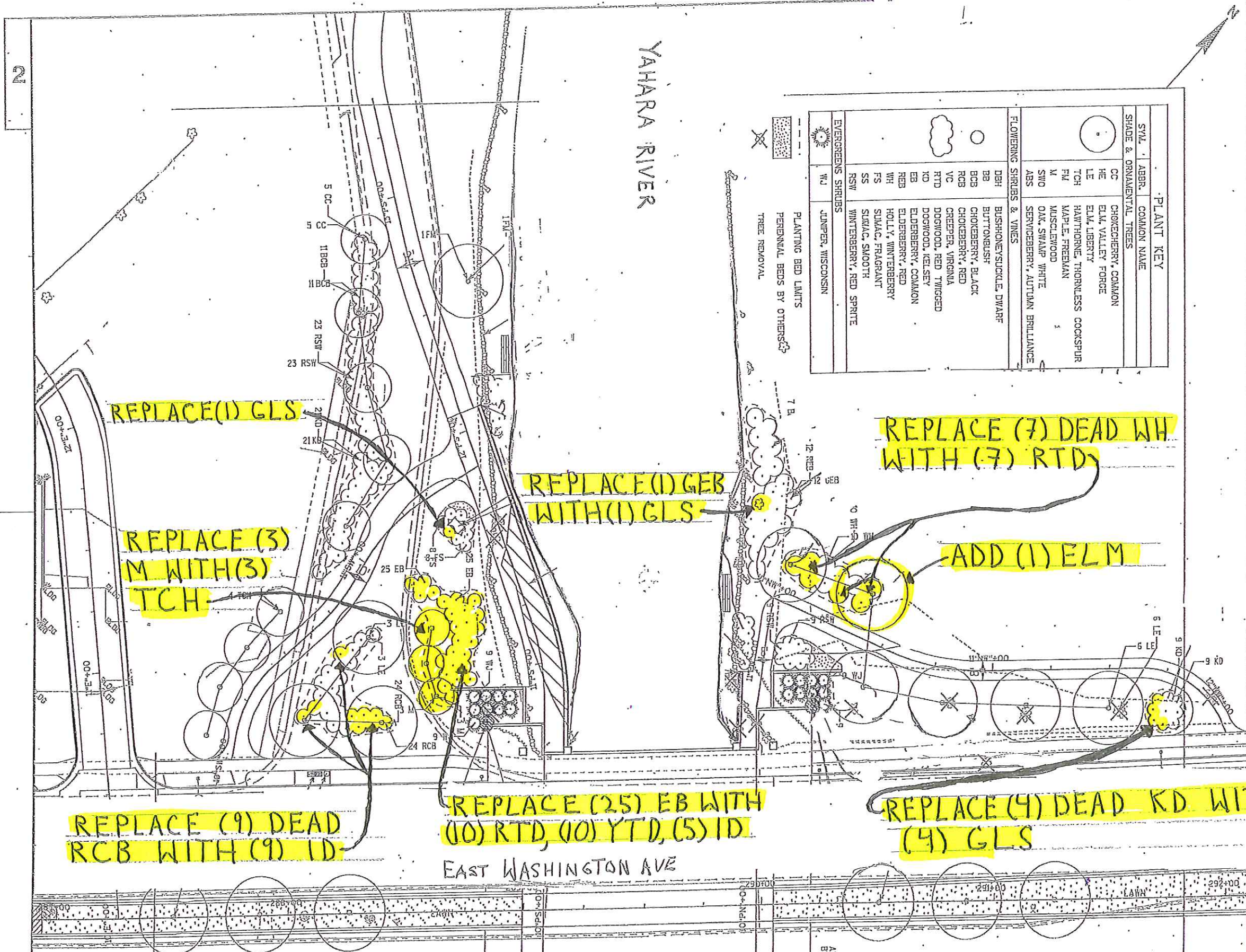

PLANT KEY	
SYL.	COMMON NAME
SHADE & ORNAMENTAL TREES	
CC	CHOKECHERRY, COMMON
NHE	ELM, NEW HORIZON
LE	ELM, LIBERTY
HE	ELM, HOMESTEAD
TCH	HAWTHORNE, THORNLESS COCKSPUR
HL	HONEYLOCUST, SKYLINE
FM	MAPLE, FREEMAN 'ARMSTRONG'
M	MUSCLEWOOD
SWO	OAK, SWAMP WHITE
ABS	SERVICEBERRY, AUTUMN BRILLIANCE
FLOWERING SHRUBS & VINES	
DBH	BUSHHONEYSUCCULE, DWARF
BB	BUTTONBUSH
BCB	CHOKEBERRY, BLACK
RCB	CHOKEBERRY, RED
VC	CREEPER, VIRGINIA
RTD	DOGWOOD, RED TWIGGED
KD	DOGWOOD, KELSEY
EB	ELDERBERRY, COMMON
WH	HOLLY, WINTERBERRY
FS	SUMAC, FRAGRANT
SS	SUMAC, SMOOTH
RSW	WINTERBERRY, RED SPRITE
EVERGREENS SHRUBS	
WJ	JUNPER, WISCONSIN

PLANT KEY		
SYM.	ABBR.	COMMON NAME
SHADE & ORNAMENTAL TREES		
CC		CHOKECHERRY, COMMON
NHE		ELM, NEW HORIZON
LE		ELM, LIBERTY
HE		ELM, HOMESTEAD
TCH		HAWTHORNE, THORNLESS COCKSPUR
HL		HONEYLOCUST, SKYLINE
FM		MAPLE, FREEMAN 'ARMSTRONG'
M		MUSCLEWOOD
SWO		OAK, SWAMP WHITE
ABS		SERVICEBERRY, AUTUMN BRILLIANCE
FLOWERING SHRUBS & VINES		
BB		BUTTONBUSH
BCB		CHOKEBERRY, BLACK
RCB		CHOKEBERRY, RED
KD		DOGWOOD, KELSEY
RTD		DOGWOOD, RED TWIGGED
EB		ELDERBERRY, COMMON
GEB		ELDERBERRY, GOLDEN
WH		HOLLY, WINTERBERRY
RSW		HOLLY, 'RED SPRITE' WINTERBERRY
FS		SUMAC, FRAGRANT
SS		SUMAC, SMOOTH
VC		VIRGINIA CREEPER
EVERGREENS SHRUBS		
WJ		JUNPER, WISCONSIN

LEGEND	
	ARCHITECTURAL CONCRETE PAVEMENT
	COLORLED CONCRETE CROSSWALK
	LAWN
	TRASH RECEPTACLE
	REMOVE EXISTING TREE/BUSH
	PLANTING BED LIMITS
	PERENNIAL BEDS BY OTHERS
	PROPOSED STREETLIGHT

2

2

YAHARA RIVER

EAST WASHINGTON AVE