

Madison, Wisconsin

INDEX OF SHEETS

SHEET NO.	TITLE
1	
DI	DETAILS - TYPICAL SECTION
PI-P4	PLAN & PROFILE
PM1-PM3	PAVEMENT MARKING PLANS

# CITY OF MADISON

## CITY ENGINEERING DIVISION

### DEPARTMENT OF PUBLIC WORKS

# PLAN OF PROPOSED IMPROVEMENT

PUBLIC IMPROVEMENT PROJECT APPROVED

March 5, 2015

BY THE COMMON COUNCIL OF MADISON, WISCONSIN

PUBLIC IMPROVEMENT DESIGN APPROVED BY:

*[Signature]* 3/11/15  
City Engineer Date

STREET DESIGNED BY:

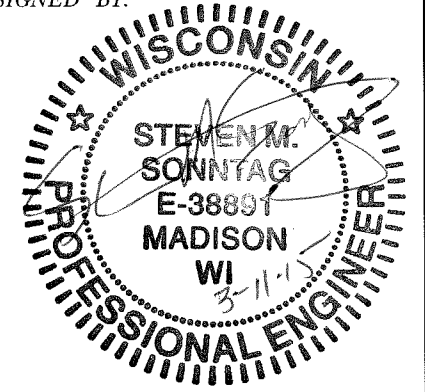

## HANSON ROAD RESURFACING - 2015

CITY PROJECT NO. 53W1843(MUNIS #10260)

CONTRACT NO. 7434

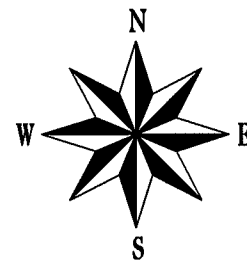

CONSTRUCTION PROJECT LOCATION

CONVENTIONAL SIGNS	
FIELD VERIFY ALL UTILITY LOCATIONS	
GAS	— G —
STORM SEWER	— ST —
SANITARY SEWER	— SAN —
WATER	— W —
OVERHEAD ELECTRIC	— OH —
POWER POLE	□
ADA COMPLIANT RAMP W/ DETECTABLE WARNING FIELD	□
COMBUSTIBLE FLUIDS	CAUTION

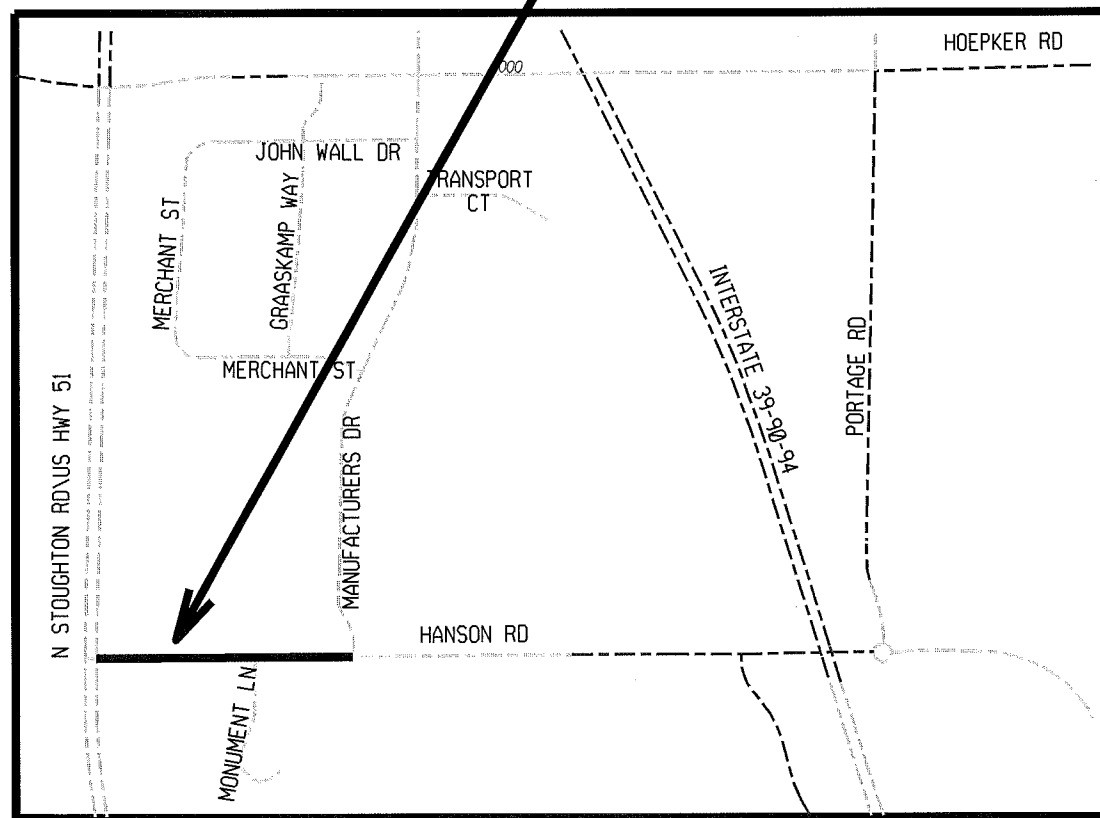

PLOT SCALE:

PLOT NAME:

REV. DATE:

ORIGINATOR: CITY OF MADISON, STREETS DIVISION

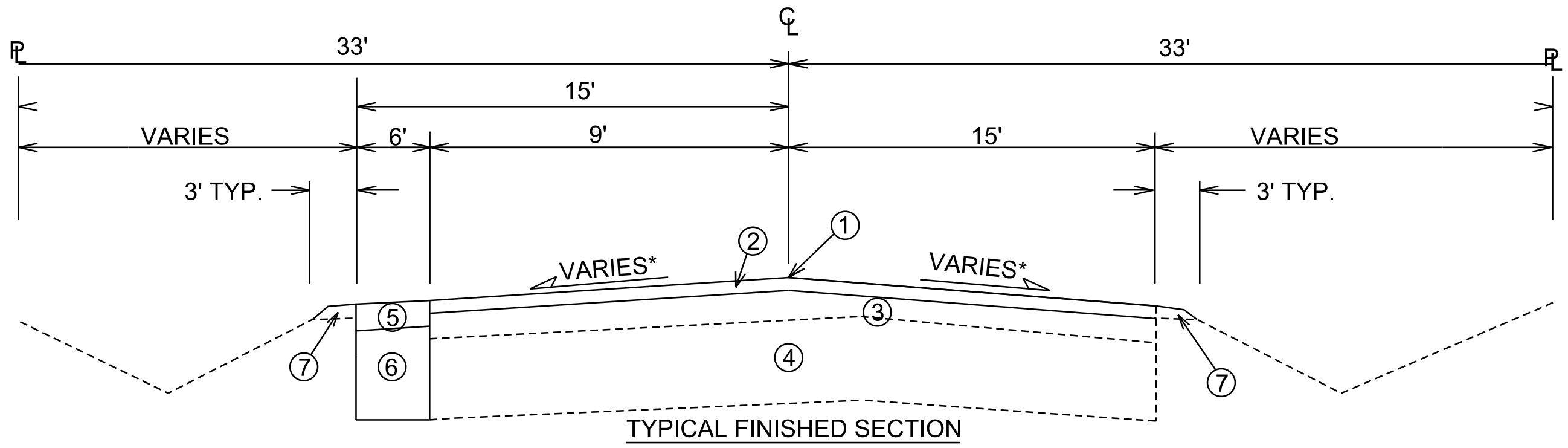

TYPICAL FINISHED SECTION

HANSON ROAD

- ① POINT REFERRED TO ON PROFILE
- ② 3" E-1 ASPHALT OVERLAY
- ③ EXISTING ASPHALT PAVEMENT
- ④ EXISTING BASE
- ⑤ 6" E-1 ASPHALT
- ⑥ 10" GRADATION 2 OR 3 CRUSHED AGGREGATE
- ⑦ GRAVEL SHOULDERING

PLOT SCALE: \_\_\_\_\_

PLOT NAME: \_\_\_\_\_

REV. DATE: \_\_\_\_\_

ORIGINATOR: CITY OF MADISON, STREETS DIVISION

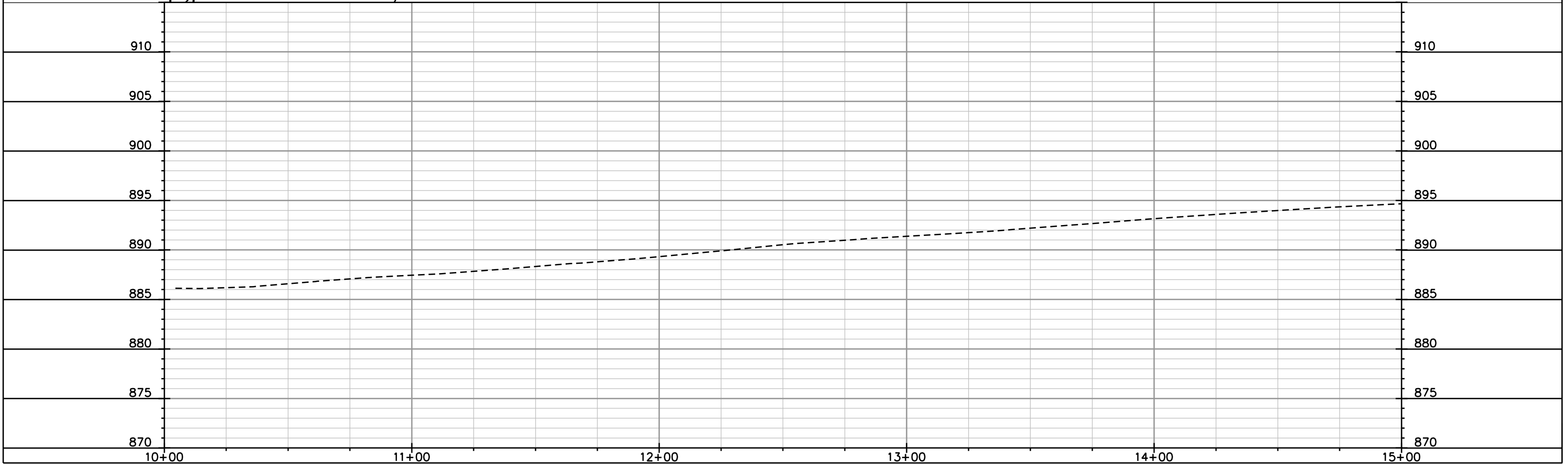
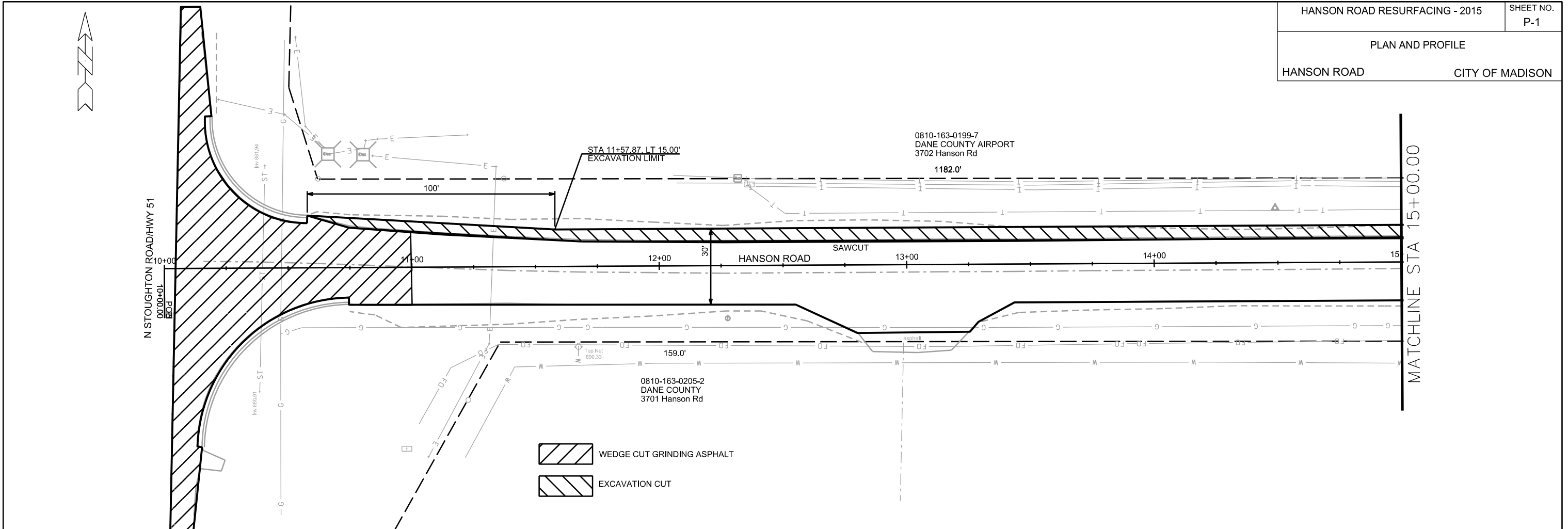

PLOT SCALE: \_\_\_\_\_  
 PLOT NAME: \_\_\_\_\_  
 REV. DATE: \_\_\_\_\_  
 ORIGINATOR: CITY OF MADISON, STREETS DIVISION

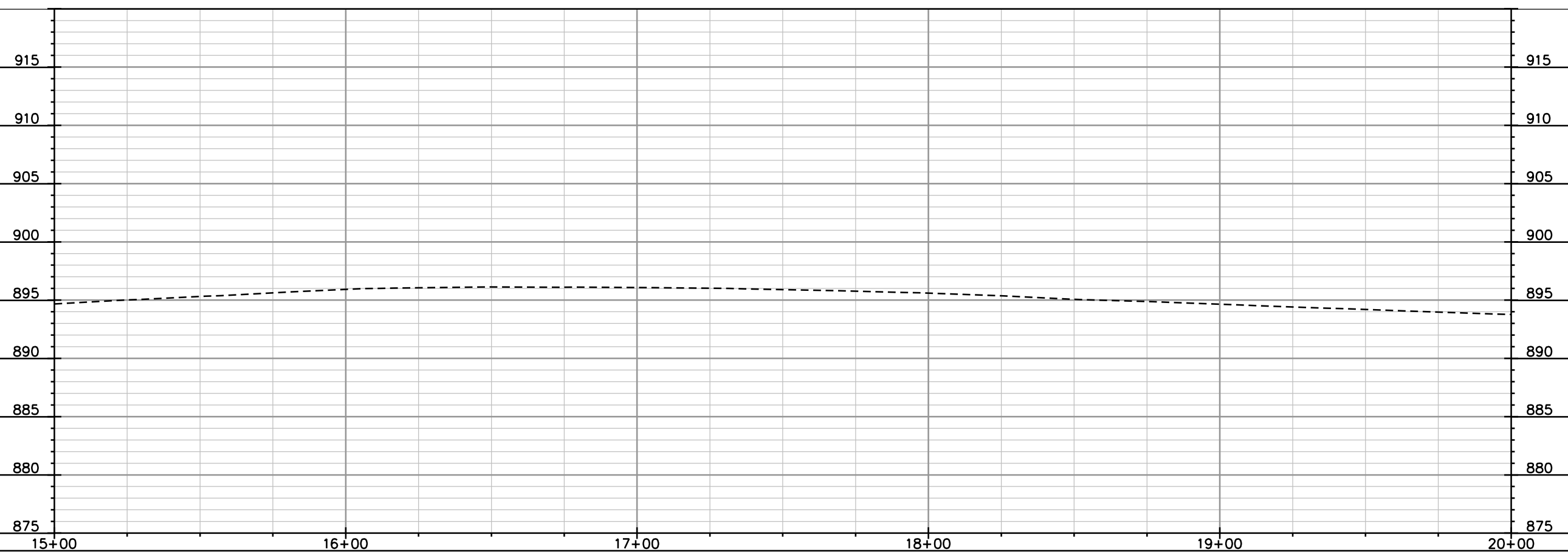
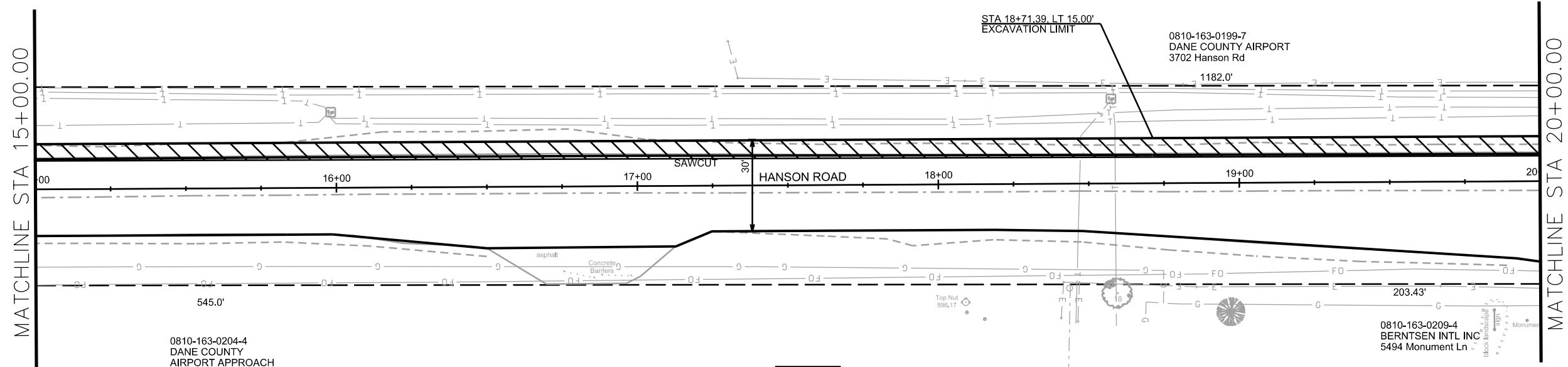

PLOT SCALE: \_\_\_\_\_

PLOT NAME: \_\_\_\_\_

REV. DATE: \_\_\_\_\_

ORIGINATOR: CITY OF MADISON, STREETS DIVISION

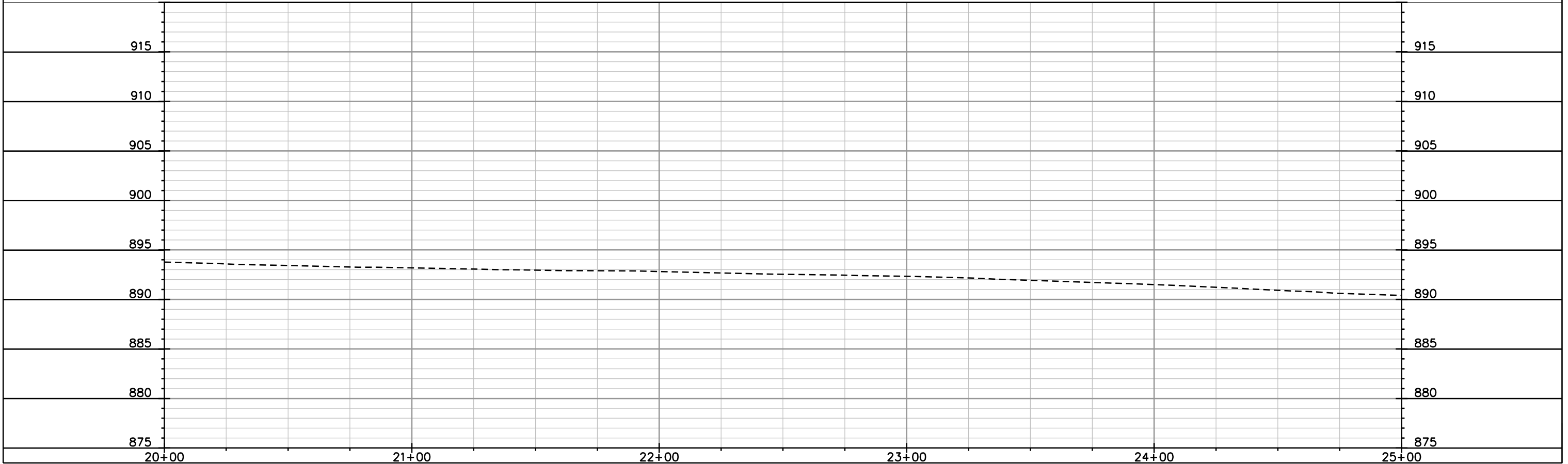
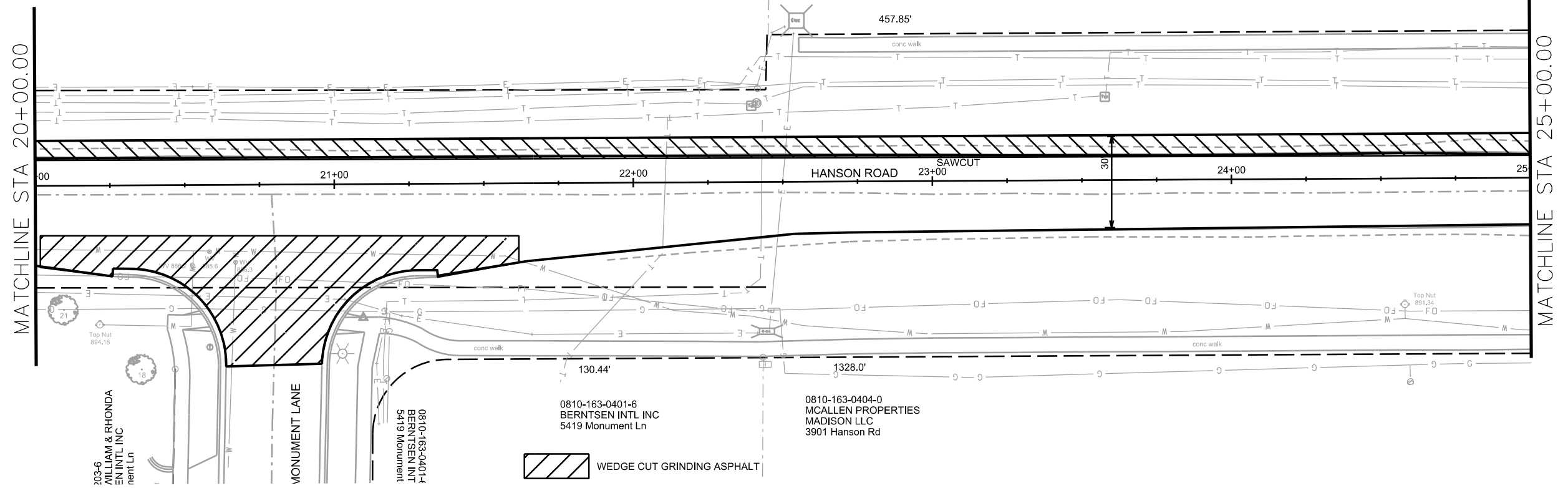

PLOT SCALE: \_\_\_\_\_

PLOT NAME: \_\_\_\_\_

REV. DATE: \_\_\_\_\_

ORIGINATOR: CITY OF MADISON, STREETS DIVISION

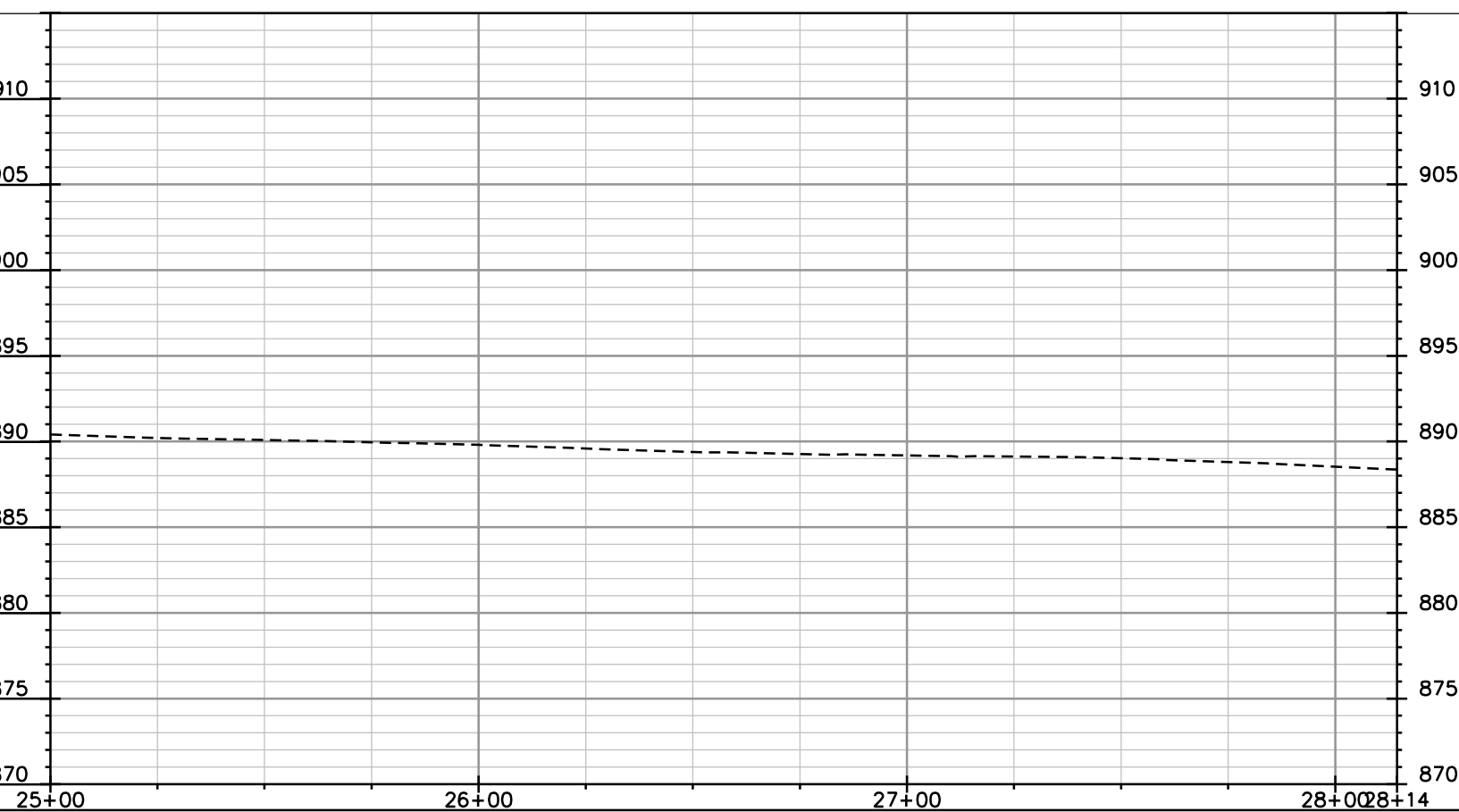
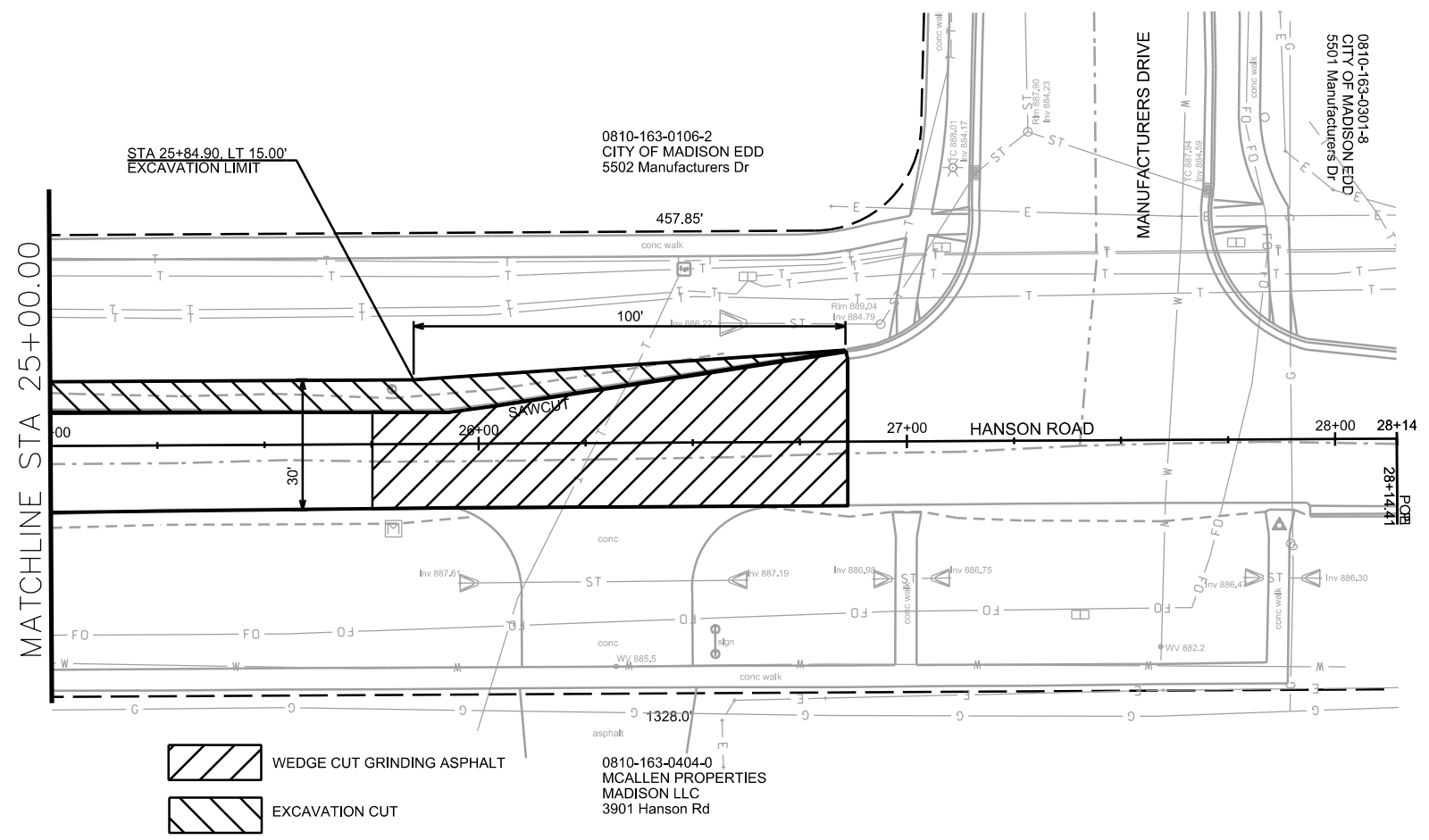

PLOT SCALE:

PLOT NAME:

REV. DATE:

ORIGINATOR: CITY OF MADISON, STREETS DIVISION

Callout	Bid Item	Description
1	60802	Pavement Marking Epoxy, 6-Inch, Solid White
2	60818	Pavement Marking Epoxy, 24-Inch, White, Stop Line
3	60812	Pavement Marking Epoxy, 6-Inch, White, Crosswalk
4	60802	Pavement Marking Epoxy, 6-Inch, Yellow Skips (10' Line, 30' Gap)
5	60823	Pavement Marking Epoxy, Symbol, Bike Lane
6	60801	Pavement Marking Epoxy, 4-Inch, Double Yellow
7	60802	Pavement Marking Epoxy, 6-Inch, White Skips (2' Line, 6' Gap)

Contact Tom Mohr, tmohr@cityofmadison.com, (608) 267-8725  
with marking layout questions

PLOT SCALE:

PLOT NAME:

REV. DATE:

ORIGINATOR: CITY OF MADISON, TRAFFIC ENG. DIV.

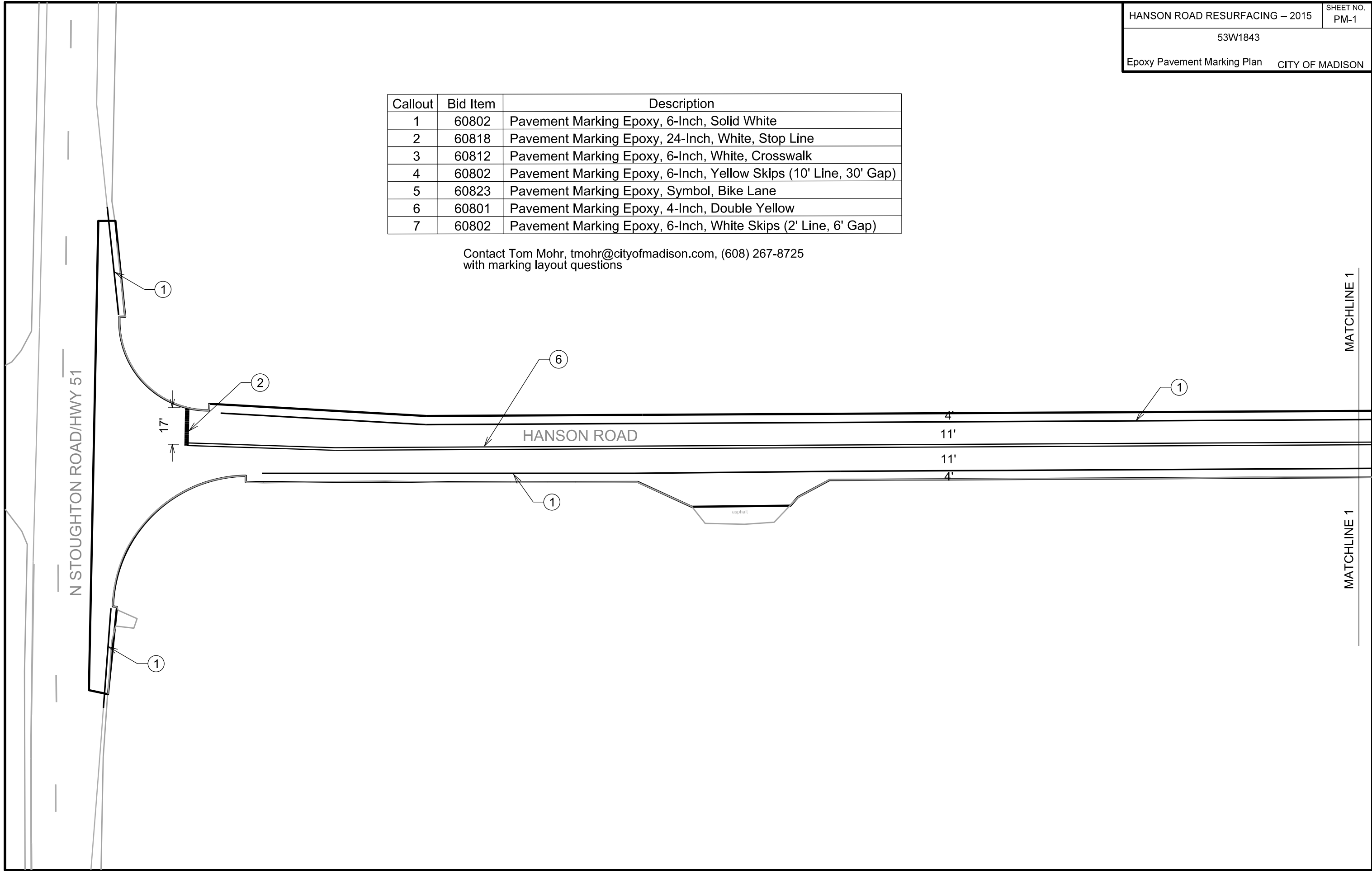

Callout	Bid Item	Description
1	60802	Pavement Marking Epoxy, 6-Inch, Solid White
2	60818	Pavement Marking Epoxy, 24-Inch, White, Stop Line
3	60812	Pavement Marking Epoxy, 6-Inch, White, Crosswalk
4	60802	Pavement Marking Epoxy, 6-Inch, Yellow Skips (10' Line, 30' Gap)
5	60823	Pavement Marking Epoxy, Symbol, Bike Lane
6	60801	Pavement Marking Epoxy, 4-Inch, Double Yellow
7	60802	Pavement Marking Epoxy, 6-Inch, White Skips (2' Line, 6' Gap)

Contact Tom Mohr, tmohr@cityofmadison.com, (608) 267-8725  
 with marking layout questions

PLOT SCALE:

PLOT NAME:

REV. DATE:

ORIGINATOR: CITY OF MADISON, TRAFFIC ENG. DIV.

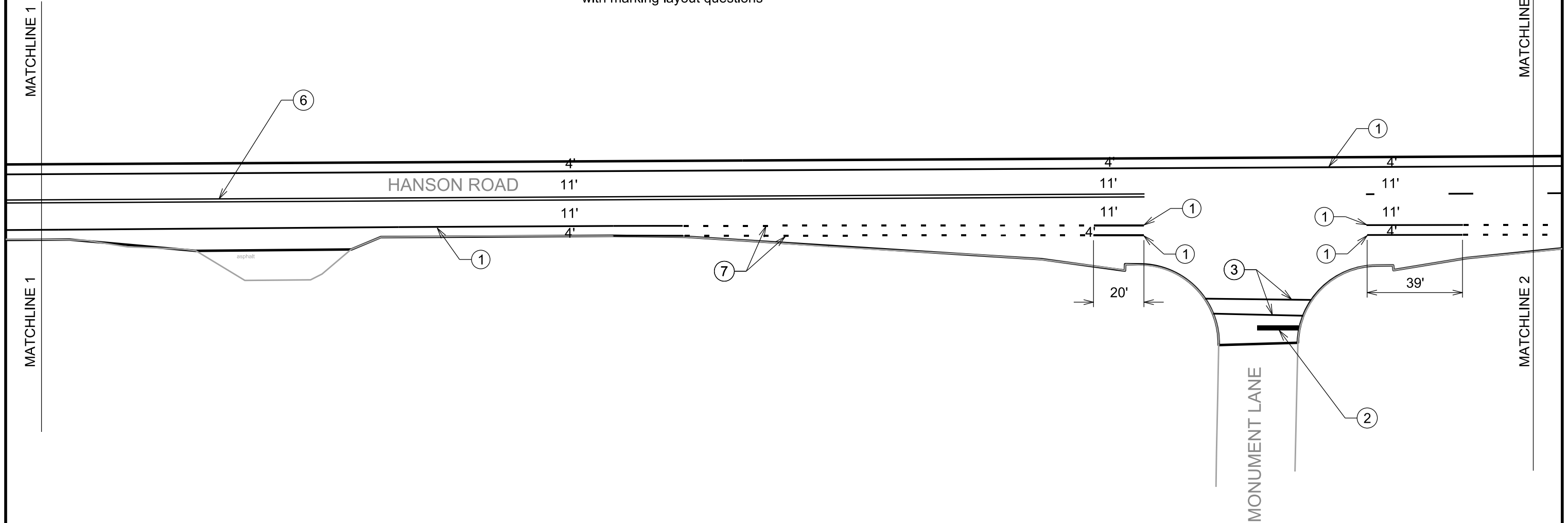



Callout	Bid Item	Description
1	60802	Pavement Marking Epoxy, 6-Inch, Solid White
2	60818	Pavement Marking Epoxy, 24-Inch, White, Stop Line
3	60812	Pavement Marking Epoxy, 6-Inch, White, Crosswalk
4	60802	Pavement Marking Epoxy, 6-Inch, Yellow Skips (10' Line, 30' Gap)
5	60823	Pavement Marking Epoxy, Symbol, Bike Lane
6	60801	Pavement Marking Epoxy, 4-Inch, Double Yellow
7	60802	Pavement Marking Epoxy, 6-Inch, White Skips (2' Line, 6' Gap)

Contact Tom Mohr, tmohr@cityofmadison.com, (608) 267-8725  
with marking layout questions

PLOT SCALE:

PLOT NAME:

REV. DATE:

ORIGINATOR: CITY OF MADISON, TRAFFIC ENG. DIV.

MATCHLINE 2

MATCHLINE 2

MANUFACTURERS  
DRIVE

