

Madison, Wisconsin

CITY OF MADISON

CITY ENGINEERING DIVISION DEPARTMENT OF PUBLIC WORKS

PLAN OF PROPOSED IMPROVEMENT

PLEASANT VIEW ROAD AND BLACKHAWK ROAD INTERSECTION IMPROVEMENT-2016

CITY PROJECT NO. 11301
CONTRACT NO. 7670

PUBLIC IMPROVEMENT PROJECT APPROVED

MAY 3, 2016

BY THE COMMON COUNCIL
OF MADISON, WISCONSIN

PUBLIC IMPROVEMENT DESIGN
APPROVED BY:

[Signature] 5/27/16
City Engineer Date

STREET
DESIGNED BY:

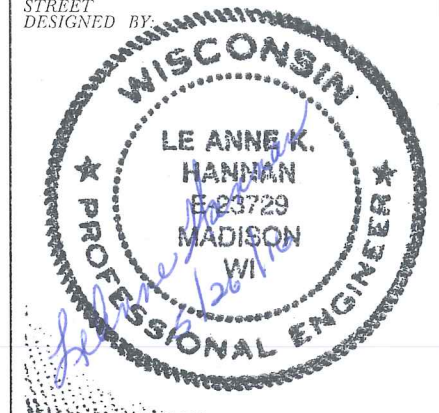

ELECTRIC
DESIGNED BY:

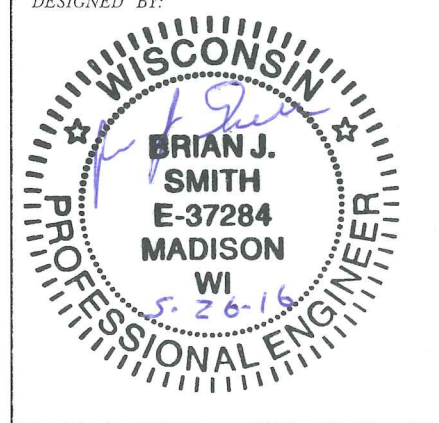

STORM SEWER
DESIGNED BY:

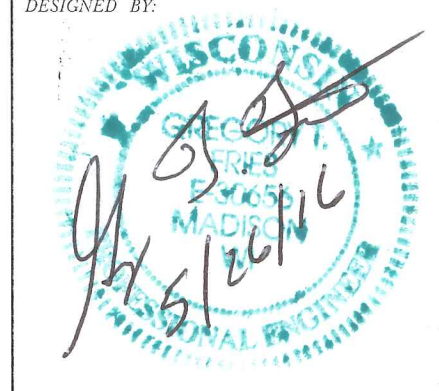

INDEX OF SHEETS

SHEET NO.	TITLE
1	TYPICAL SECTIONS AND DETAILS
D1	ELECTRIC PLAN
E1	PAVEMENT MARKING PLAN
M1-M2	STREET PLAN & PROFILES
P1-P2	UTILITY PLAN & PROFILES & EROSION CONTROL
U1-U2	CROSS SECTIONS
X1-X8	

PROJECT
LOCATION

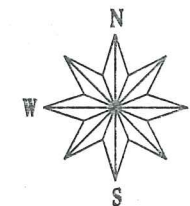
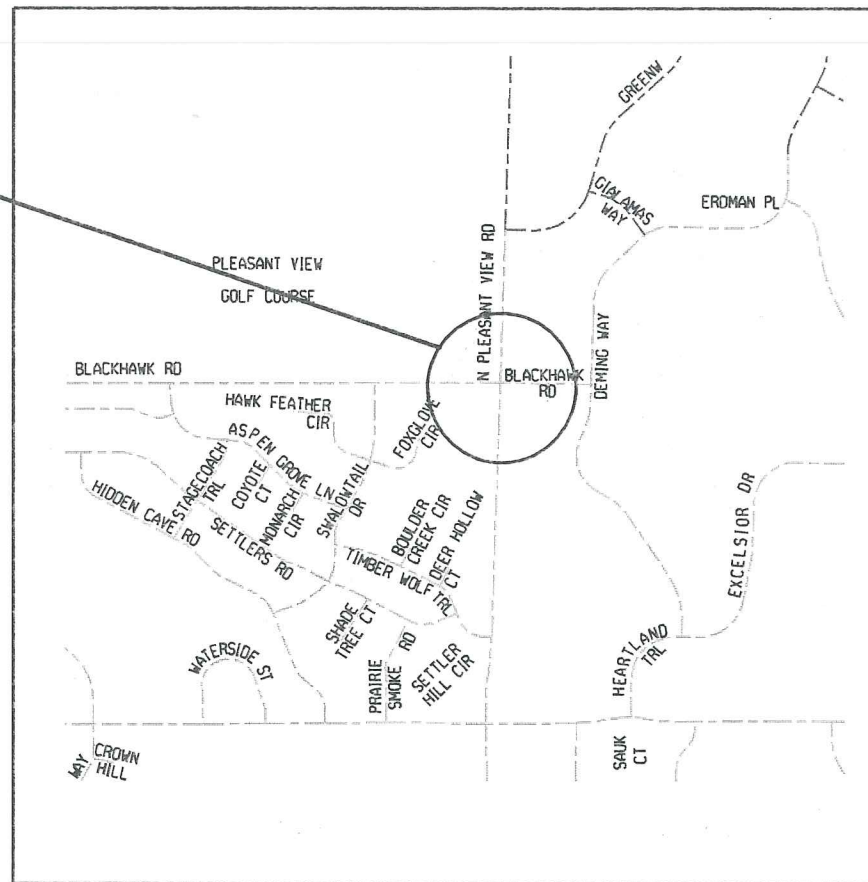

CONVENTIONAL SIGNS	
FIELD VERIFY ALL UTILITY LOCATIONS	
GAS	G
STORM SEWER	ST
SANITARY SEWER	SAN
WATER	W
OVERHEAD ELECTRIC	OH
POWER POLE	□

NOTES:

ALL GUTTERS SHALL DRAIN WITH A MINIMUM GRADE OF 0.50% TOWARD STORM SEWER INLETS.

SIDEWALK RAMPS AND CURB THRU SIDEWALK RAMPS SHALL HAVE A MAXIMUM SLOPE OF 1" PER 12". SIDEWALK AND CURB RAMPS SHALL BE CONSTRUCTED WITH A SIDE SLOPE OF 2.00%.

SIDEWALK SHALL HAVE A MINIMUM LONGITUDINAL SLOPE OF 0.50% AND A MAXIMUM LONGITUDINAL SLOPE OF 5.00%.

EARTH WORK SUMMARY:

EXCAVATION CUT (MEASURED PLAN QUANTITY).....	528 C.Y.
ESTIMATED UNDISTRIBUTED UNDERCUT.....	489 C.Y.
TOTAL UNCLASSIFIED EXCAVATION CUT.....	1017 C.Y.

PLOT SCALE:

PLOT NAME:

REV. DATE:

ORIGINATOR: CITY OF MADISON - STREETS DIVISION

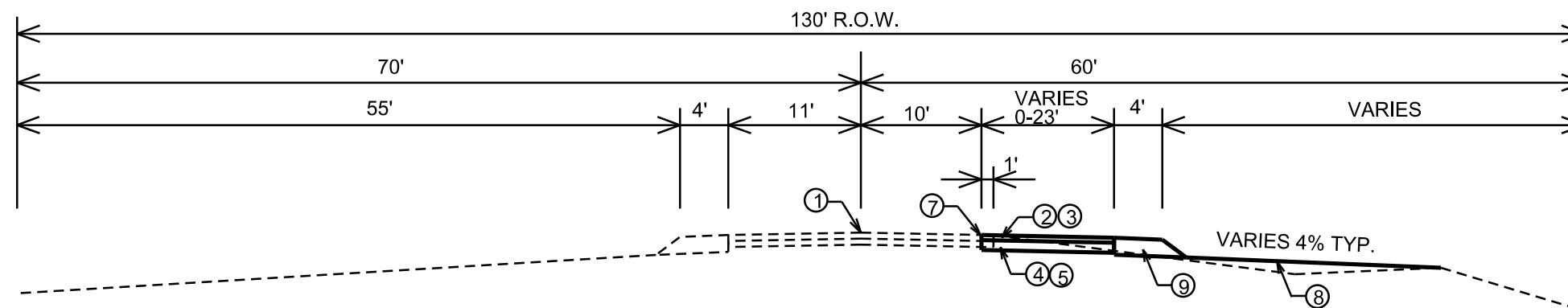

TYPICAL SECTION

STA 100+75 - STA 104+02.02
STA 105+29.96 - STA 107+70.02

- ① POINT REFERRED TO ON PROFILE
- ② 2" BITUMINOUS UPPER LAYER
- ③ 3.25" BITUMINOUS LOWER LAYER
- ④ 4" GRADATION 2 CRUSHED STONE
- ⑤ 6" GRADATION 1 CRUSHED STONE
- ⑥ TYPE 'A' CONCRETE CURB & GUTTER
- ⑦ SAWCUT, 1' FROM EX. PAV'T EDGE
- ⑧ 4" TOPSOIL, SEED & MAT
- ⑨ UNPAVED SHOULDER

SEE CROSS SECTION SHEETS FOR CROSS SLOPES, TOP OF CURB AND BACK OF WALK ELEVATIONS.

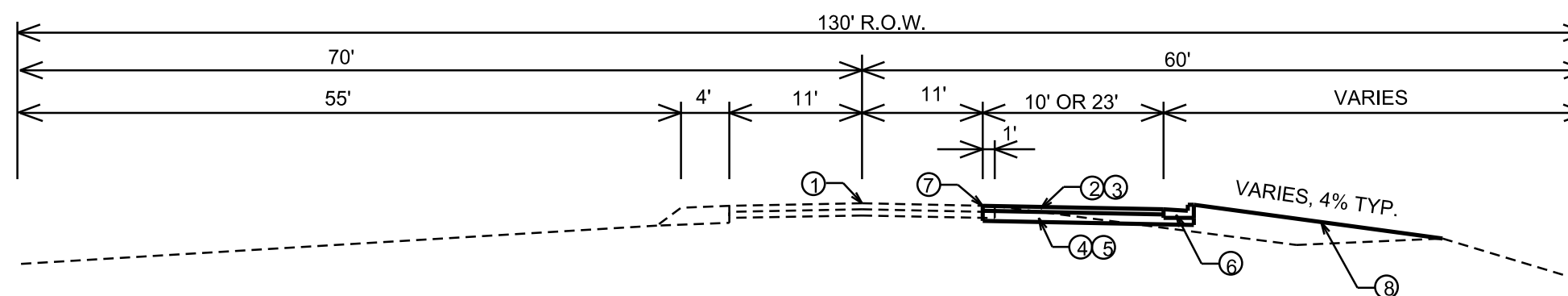

TYPICAL SECTION

STA 104+02.02 - STA 105+29.96

LEVELS ON - 1, 2, 3, 4, 5, 6, 7, 8, 9, 10, 11, 12, 13, 14, 15, 16, 17, 18, 19, 20, 21, 22, 23, 24, 25, 26, 27, 28, 29, 30, 31, 32, 33, 34, 35, 36, 37, 38, 39, 40, 41, 42, 43, 44, 45, 46, 47, 48, 49, 50, 51, 52, 53, 54, 55, 56, 57, 58, 59, 60, 61, 62, 63

BLACKHAWK RD

N PLEASANT VIEW RD

INSTALL 2 (TWO) 3" PVC CONDUITS
STUB UP AT WOOD POLE TO BE INSTALLED
BY CITY CREWS

CONSTRUCT TYPE-P BASE
STA 104+12.9, 31.6 LT

INSTALL 2 (TWO) 3" CONDUITS
ONE TO ENTER NEW LB-8 BASE,
THE OTHER IS TO BE STUBBED UP
AND CAPPED NEXT TO THE LB-8 BASE

CONSTRUCT LB-8 BASE
STA 104+87.0, 55.4 LT

CONSTRUCT LB-8 BASE
STA 104+19.7, 24.0 LT

WOOD POLE TO BE INSTALLED
BY CITY TE CREWS
(TYPICAL)

GENERAL ELECTRICAL NOTES:

1. ALL LOCATIONS ARE APPROXIMATE. THE TRAFFIC ENGINEER SHALL APPROVE FINAL LOCATIONS INCLUDING SETBACK IN THE FIELD. AFTER CONTRACTOR SURVEYS STAKING, THE CONTRACTOR SHALL NOTIFY BRIAN SMITH (261-9625) CITY TRAFFIC ENGINEERING, AT LEAST 24-HOURS IN ADVANCE OF NEEDING BASE LOCATIONS MARKED.
2. THE CONTRACTOR SHALL DO ALL WORK IN ACCORDANCE WITH CITY OF MADISON STANDARD SPECIFICATIONS FOR PUBLIC WORKS CONSTRUCTION 2016 EDITION AND ALL ADDENDUMS THERETO. ALL CONDUIT SHALL BE PVC SCHEDULE 80 UNDER PAVEMENT OR SCHEDULE 40 OTHERWISE. PULL WIRE REQUIRED AS PER STANDARD SPECIFICATIONS.
3. THE CONTRACTOR SHALL CALL MIKE CHRISTOPH (266-4767) AT THE TRAFFIC ENGINEERING SHOP AT LEAST 24-HOURS IN ADVANCE OF POURING BASES OR BURYING CONDUIT TO ARRANGE FOR INSPECTION.
4. THE FOLLOWING CITY FURNISHED MATERIALS ARE TO BE PICKED UP AT THE TRAFFIC OPERATION SHOP, 1120 SAYLE STREET. NOTIFY DENNIS ROWE AT 266-9034 TWENTY FOUR (24) HOURS PRIOR TO PICKING UP THE MATERIAL.

1.25" X 48" ANCHOR BOLTS: 20

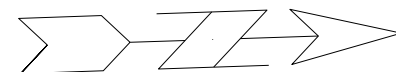

SCALE: 1" = 20'

CONSTRUCT LB-8 BASE
STA 104+38.2, 71.6 RT

INSTALL 3" PVC

CONSTRUCT TYPE-1 HANDHOLE
STA 104+40.7, 81.1 RT

INSTALL 2 (TWO)
3" PVC CONDUITS

INSTALL 3" PVC

INSTALL 3" PVC

CONSTRUCT LB-8 BASE
STA 105+30.1, 28.7 RT

REMOVE STREET
LIGHT BASE

CONSTRUCT LB-8 BASE
STA 104+93.8, 72.5 RT

INSTALL 3" PVC

CONSTRUCT TYPE-1
HANDHOLE
STA 104+91.6, 81.0 RT

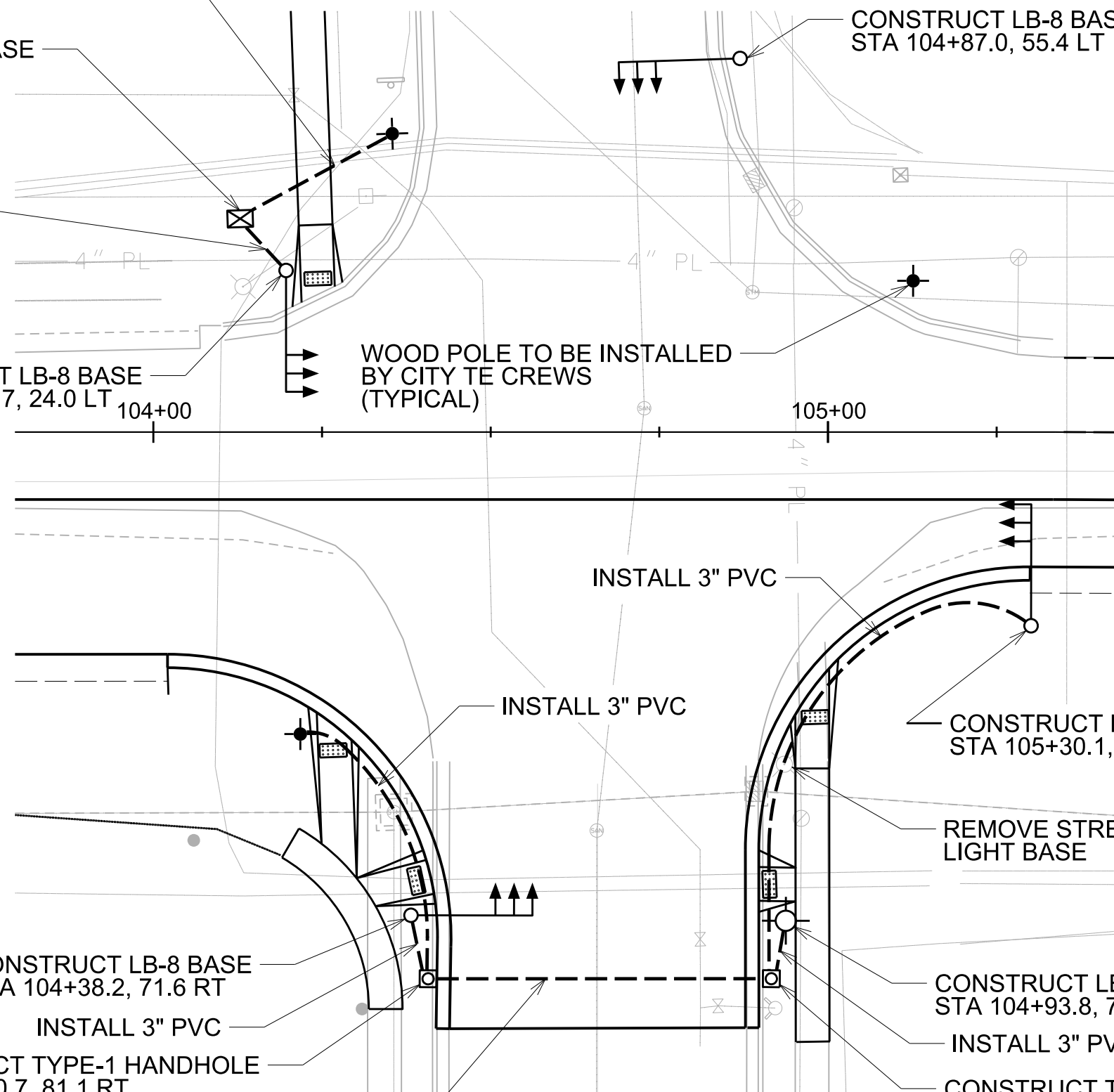

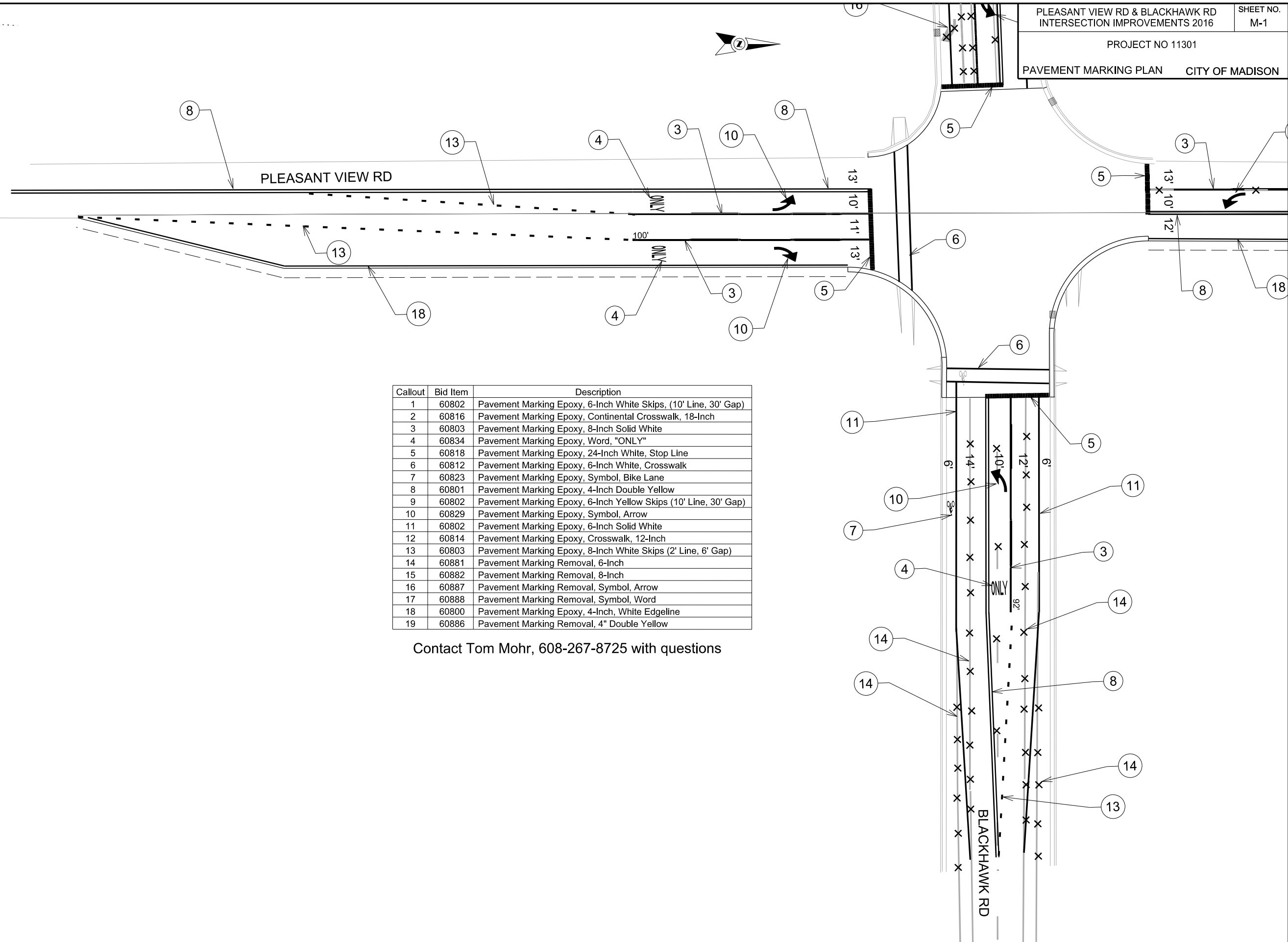

Callout	Bid Item	Description
1	60802	Pavement Marking Epoxy, 6-Inch White Skips, (10' Line, 30' Gap)
2	60816	Pavement Marking Epoxy, Continental Crosswalk, 18-Inch
3	60803	Pavement Marking Epoxy, 8-Inch Solid White
4	60834	Pavement Marking Epoxy, Word, "ONLY"
5	60818	Pavement Marking Epoxy, 24-Inch White, Stop Line
6	60812	Pavement Marking Epoxy, 6-Inch White, Crosswalk
7	60823	Pavement Marking Epoxy, Symbol, Bike Lane
8	60801	Pavement Marking Epoxy, 4-Inch Double Yellow
9	60802	Pavement Marking Epoxy, 6-Inch Yellow Skips (10' Line, 30' Gap)
10	60829	Pavement Marking Epoxy, Symbol, Arrow
11	60802	Pavement Marking Epoxy, 6-Inch Solid White
12	60814	Pavement Marking Epoxy, Crosswalk, 12-Inch
13	60803	Pavement Marking Epoxy, 8-Inch White Skips (2' Line, 6' Gap)
14	60881	Pavement Marking Removal, 6-Inch
15	60882	Pavement Marking Removal, 8-Inch
16	60887	Pavement Marking Removal, Symbol, Arrow
17	60888	Pavement Marking Removal, Symbol, Word
18	60800	Pavement Marking Epoxy, 4-Inch, White Edgeline
19	60886	Pavement Marking Removal, 4" Double Yellow

Contact Tom Mohr, 608-267-8725 with questions

PLOT SCALE:
PLOT NAME:
REV. DATE:
ORIGINATOR: CITY OF MADISON, TRAFFIC ENG. DIV.



PLOT SCALE:

 PLOT NAME:

 REV. DATE:

 ORIGINATOR: CITY OF MADISON, TRAFFIC ENG. DIV.

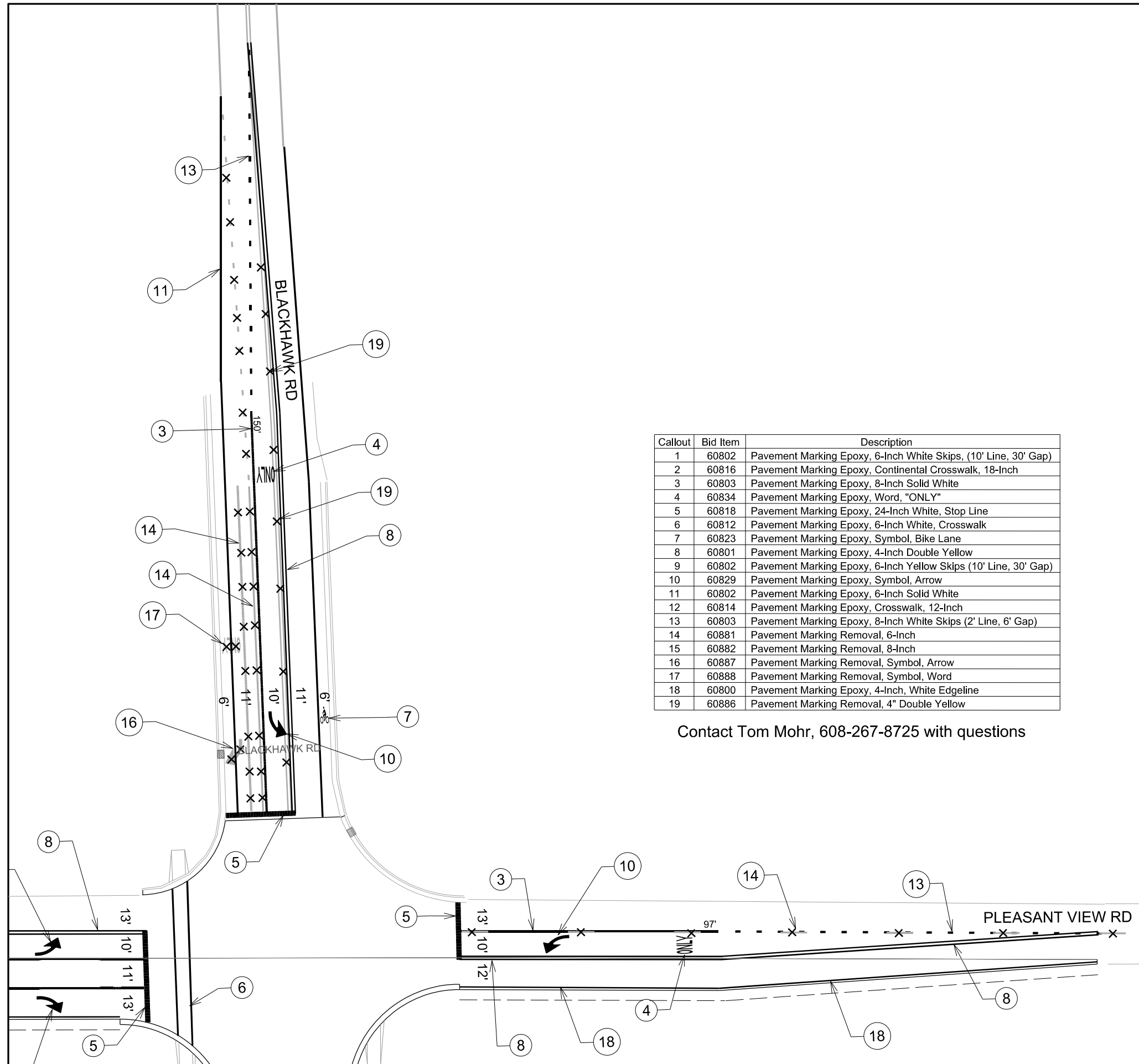

Callout	Bid Item	Description
1	60802	Pavement Marking Epoxy, 6-Inch White Skips, (10' Line, 30' Gap)
2	60816	Pavement Marking Epoxy, Continental Crosswalk, 18-Inch
3	60803	Pavement Marking Epoxy, 8-Inch Solid White
4	60834	Pavement Marking Epoxy, Word, "ONLY"
5	60818	Pavement Marking Epoxy, 24-Inch White, Stop Line
6	60812	Pavement Marking Epoxy, 6-Inch White, Crosswalk
7	60823	Pavement Marking Epoxy, Symbol, Bike Lane
8	60801	Pavement Marking Epoxy, 4-Inch Double Yellow
9	60802	Pavement Marking Epoxy, 6-Inch Yellow Skips (10' Line, 30' Gap)
10	60829	Pavement Marking Epoxy, Symbol, Arrow
11	60802	Pavement Marking Epoxy, 6-Inch Solid White
12	60814	Pavement Marking Epoxy, Crosswalk, 12-Inch
13	60803	Pavement Marking Epoxy, 8-Inch White Skips (2' Line, 6' Gap)
14	60881	Pavement Marking Removal, 6-Inch
15	60882	Pavement Marking Removal, 8-Inch
16	60887	Pavement Marking Removal, Symbol, Arrow
17	60888	Pavement Marking Removal, Symbol, Word
18	60800	Pavement Marking Epoxy, 4-Inch, White Edgeline
19	60886	Pavement Marking Removal, 4" Double Yellow

Contact Tom Mohr, 608-267-8725 with questions

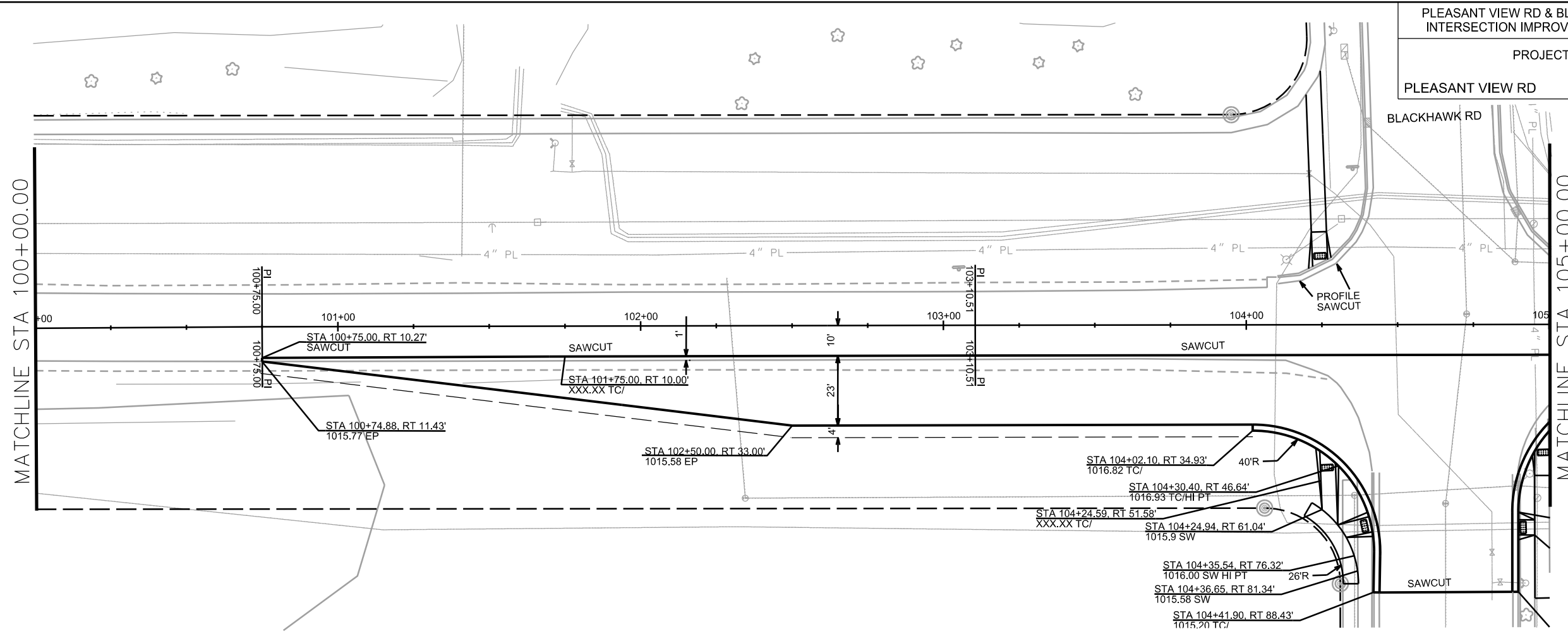
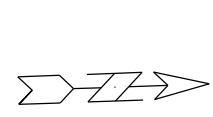

MATCHLINE STA 100+00.00

MATCHLINE STA 105+00.00

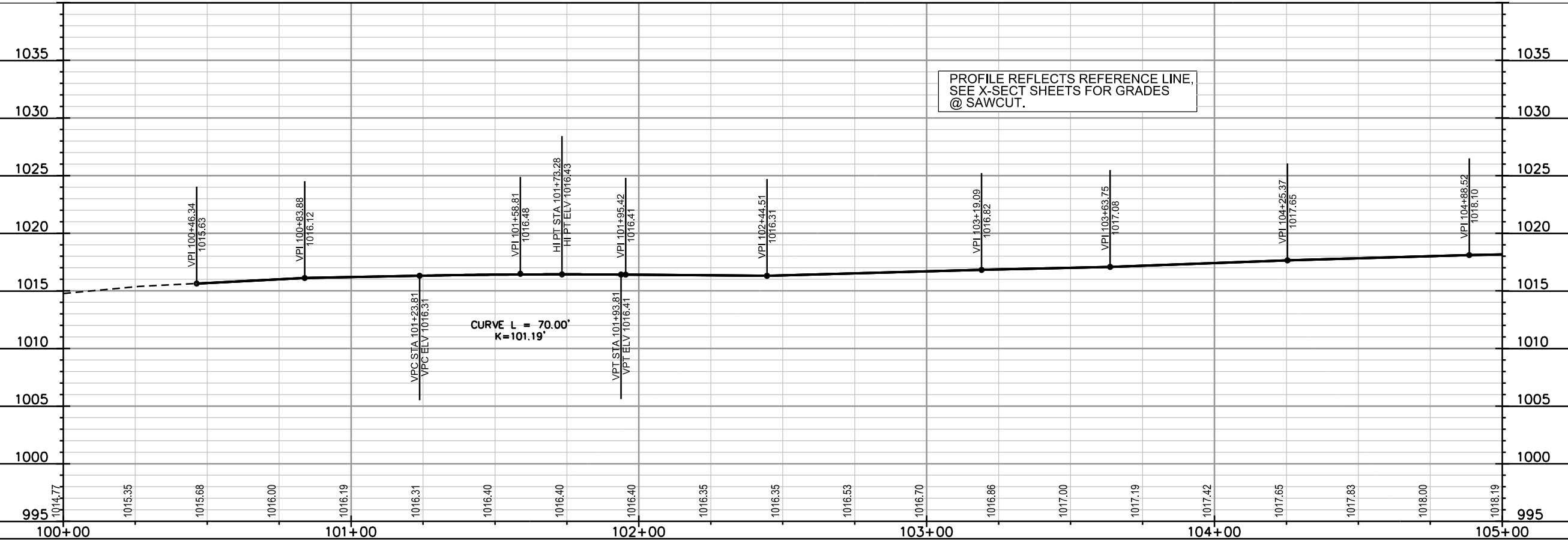

PROFILE REFLECTS REFERENCE LINE,
SEE X-SECT SHEETS FOR GRADES
@ SAWCUT.

PLOT SCALE: _____

PLOT NAME: _____

REV. DATE: _____

ORIGINATOR: CITY OF MADISON, STREETS DIVISION

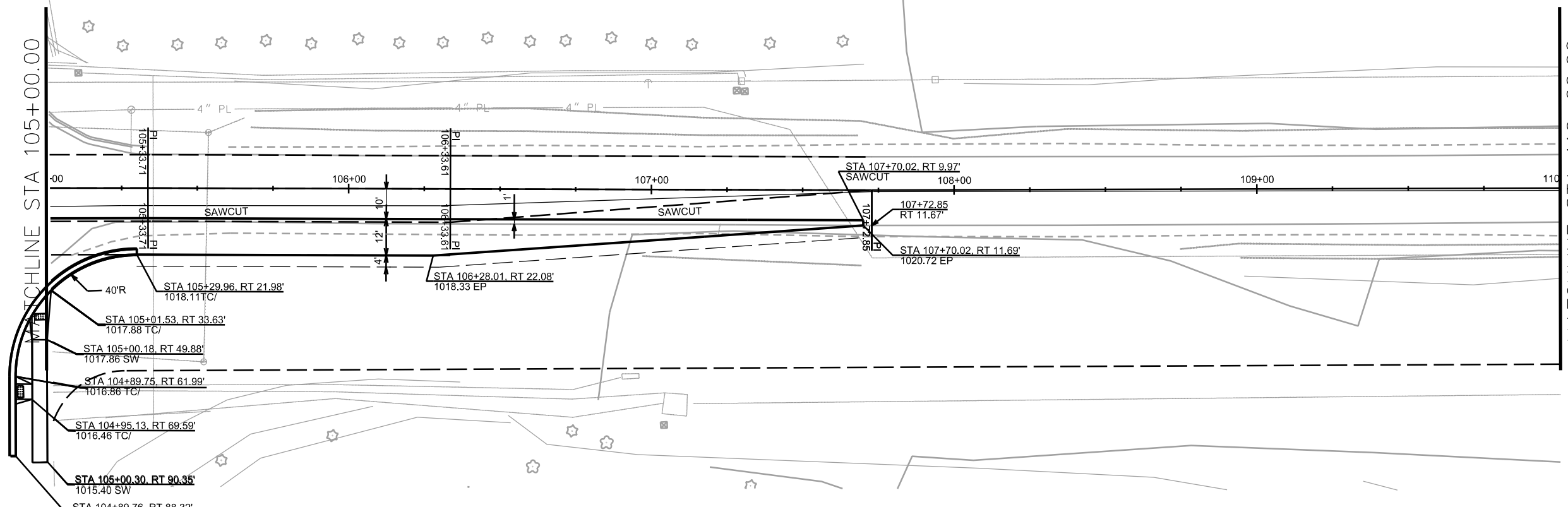

PLOT SCALE: _____

PLOT NAME: _____

REV. DATE: _____

ORIGINATOR: CITY OF MADISON, STREETS DIVISION



MATCHLINE STA 105+00.00

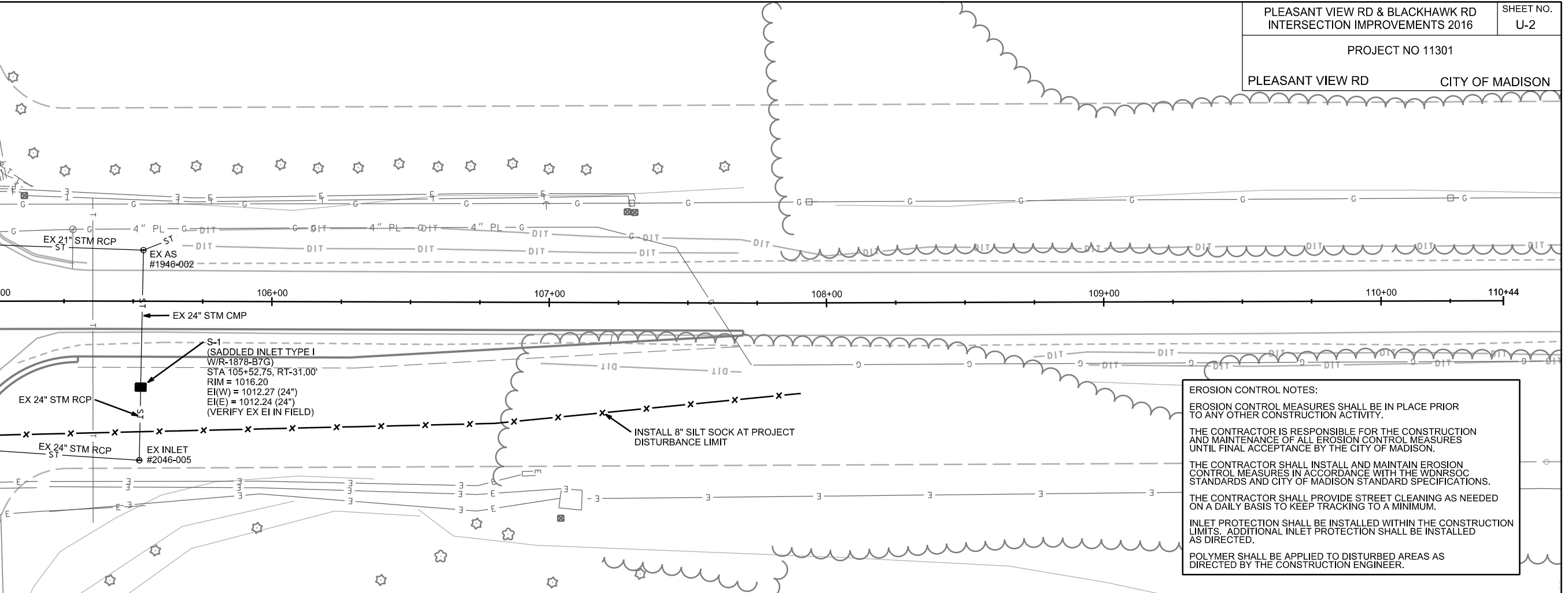

EROSION CONTROL NOTES:

EROSION CONTROL MEASURES SHALL BE IN PLACE PRIOR TO ANY OTHER CONSTRUCTION ACTIVITY.

THE CONTRACTOR IS RESPONSIBLE FOR THE CONSTRUCTION AND MAINTENANCE OF ALL EROSION CONTROL MEASURES UNTIL FINAL ACCEPTANCE BY THE CITY OF MADISON.

THE CONTRACTOR SHALL INSTALL AND MAINTAIN EROSION CONTROL MEASURES IN ACCORDANCE WITH THE WDNR SOC STANDARDS AND CITY OF MADISON STANDARD SPECIFICATIONS.

THE CONTRACTOR SHALL PROVIDE STREET CLEANING AS NEEDED ON A DAILY BASIS TO KEEP TRACKING TO A MINIMUM.

INLET PROTECTION SHALL BE INSTALLED WITHIN THE CONSTRUCTION LIMITS. ADDITIONAL INLET PROTECTION SHALL BE INSTALLED AS DIRECTED.

POLYMER SHALL BE APPLIED TO DISTURBED AREAS AS DIRECTED BY THE CONSTRUCTION ENGINEER.

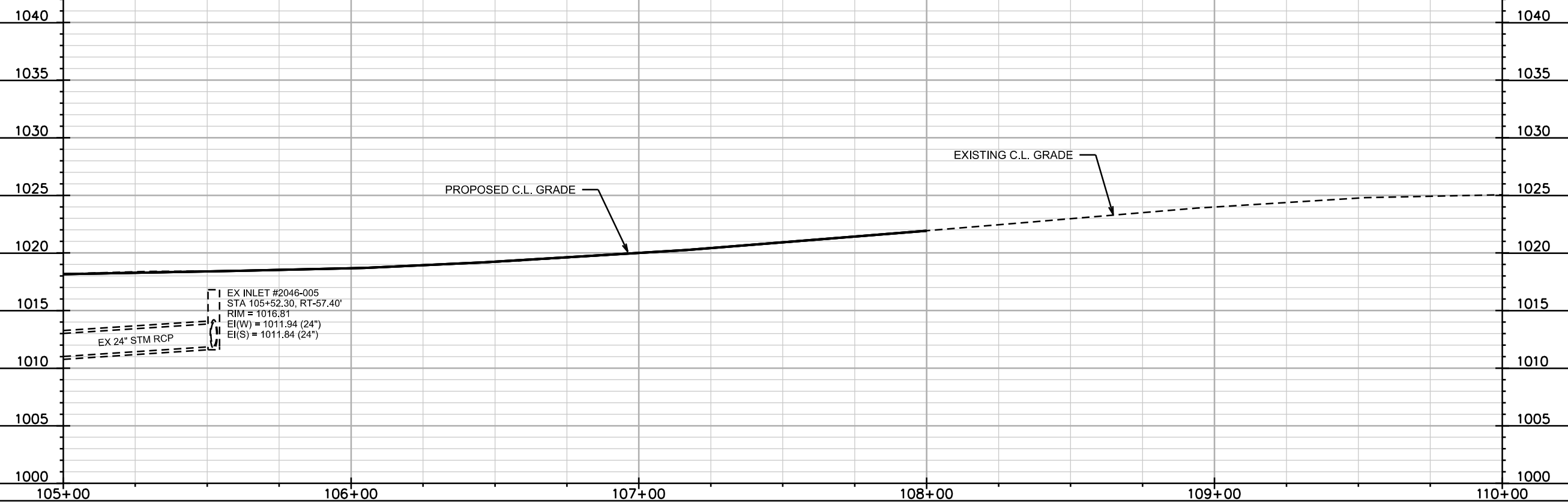

PLOT SCALE: _____

PLOT NAME: _____

REV. DATE: _____

ORIGINATOR: CITY OF MADISON, STREETS DIVISION

CROSS SECTIONS

PLEASANT VIEW RD

CITY OF MADISON

PLOT SCALE: _____

PLOT NAME: _____

REV. DATE: _____

ORIGINATOR: CITY OF MADISON - STREETS DIVISION

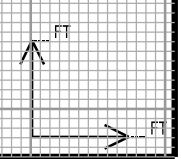
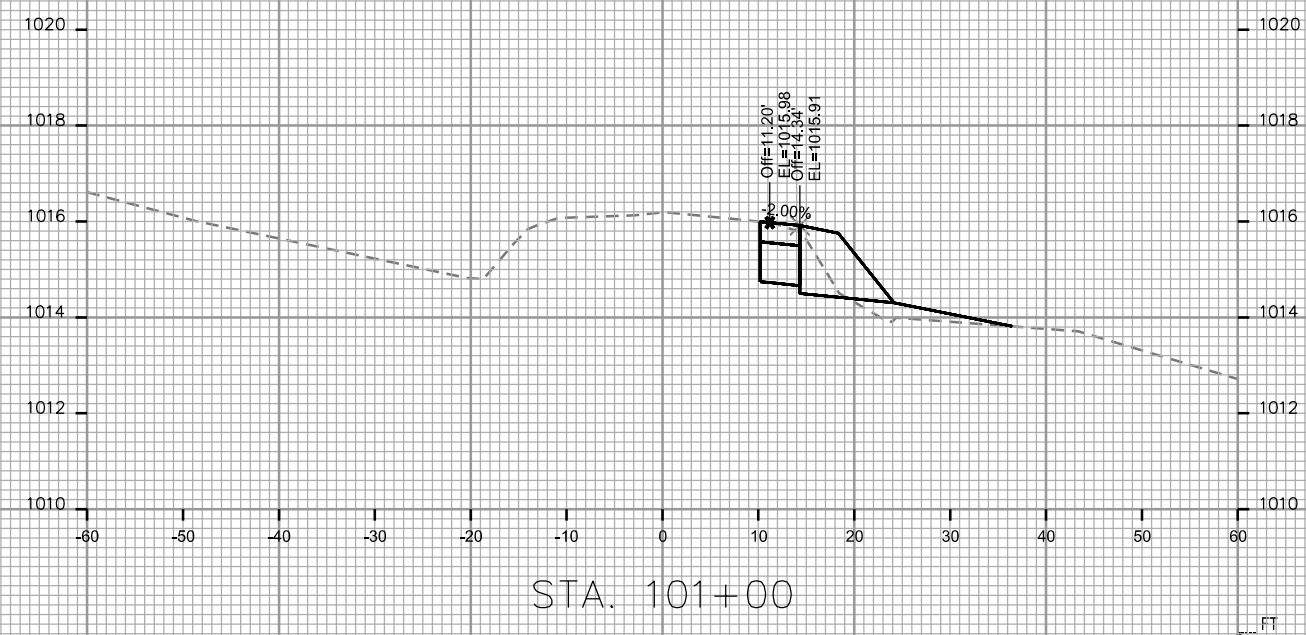
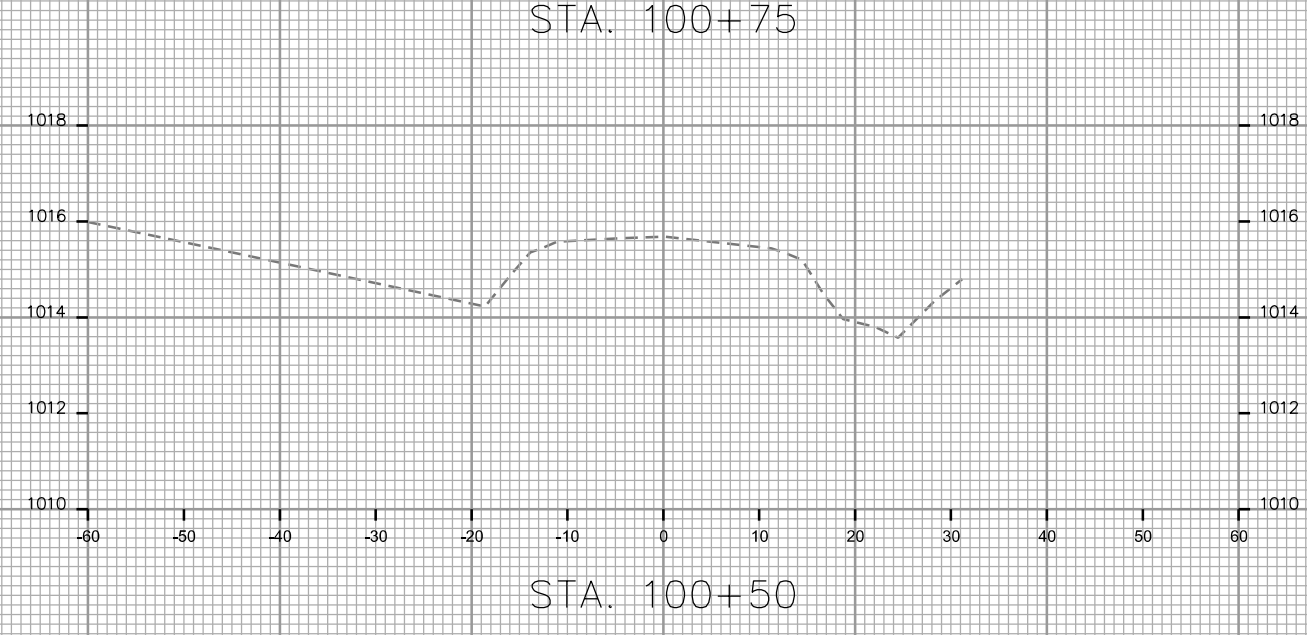
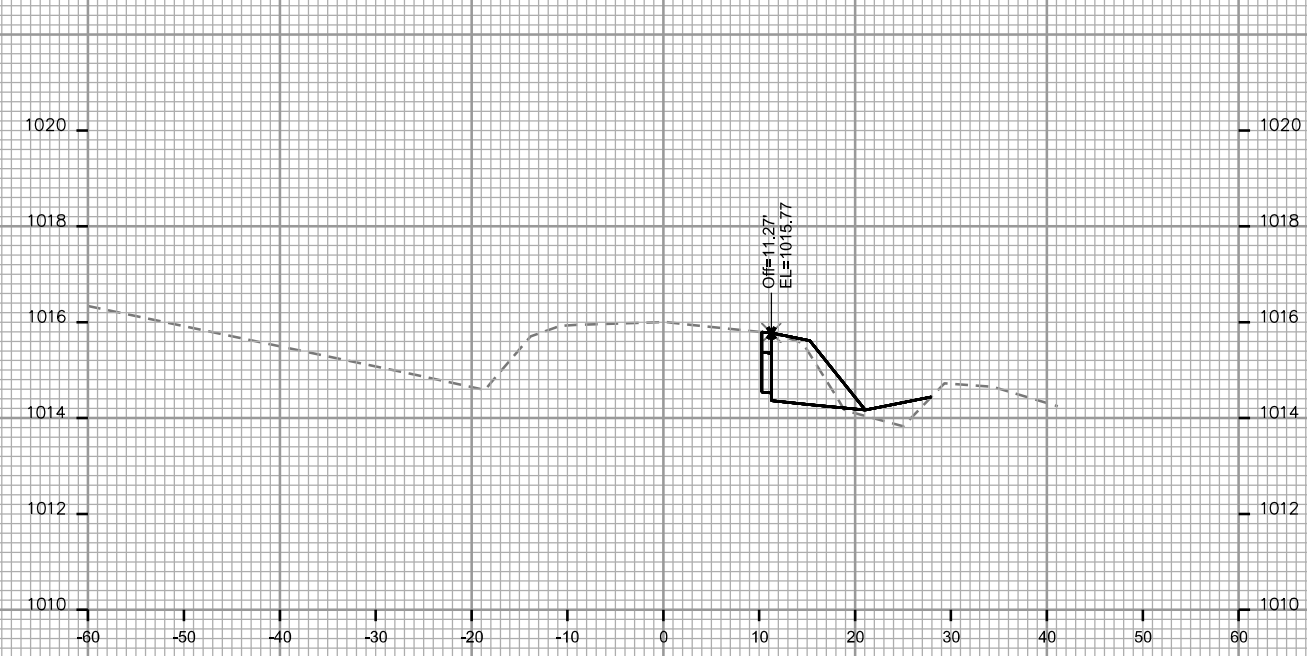

PLOT SCALE: _____
PLOT NAME: _____

REV. DATE: _____

ORIGINATOR: CITY OF MADISON - STREETS DIVISION

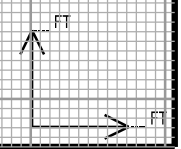
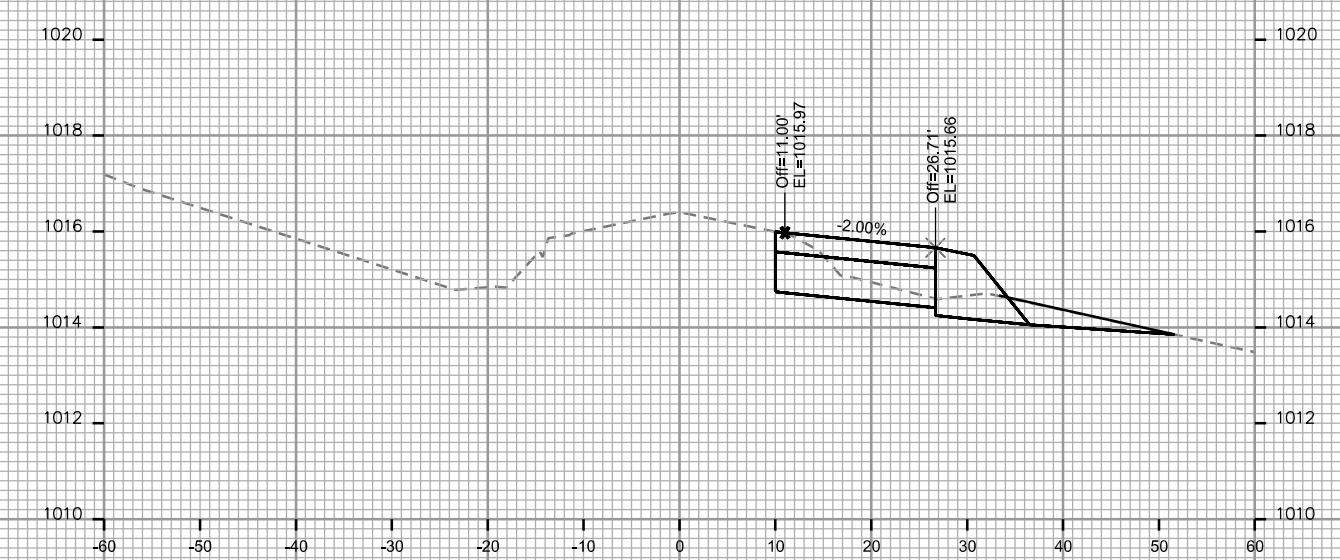
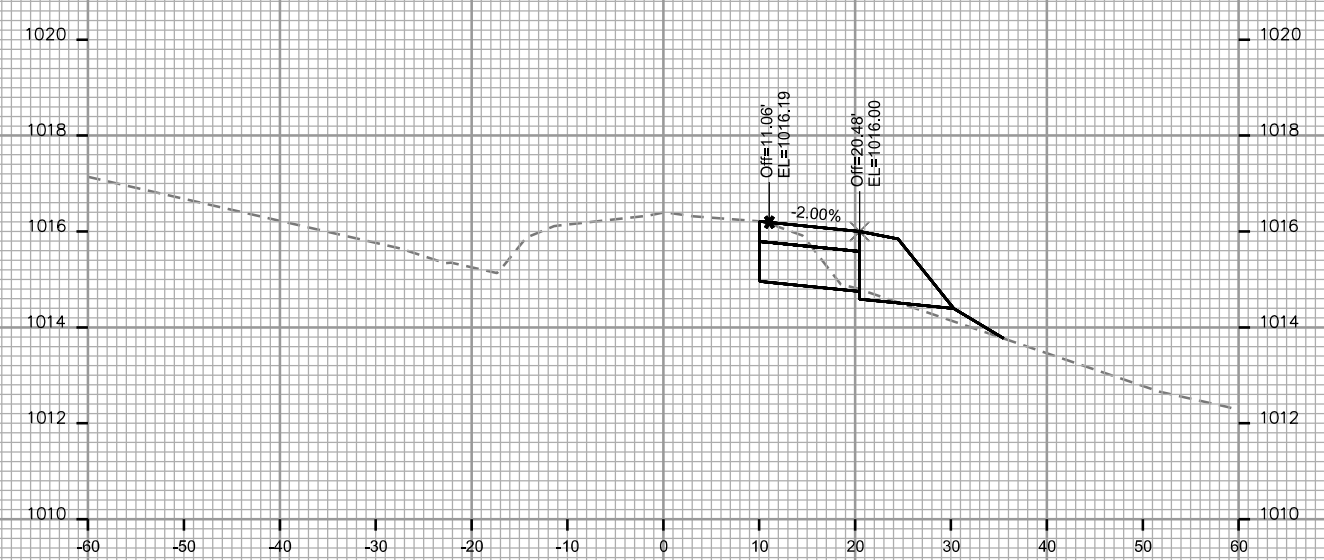
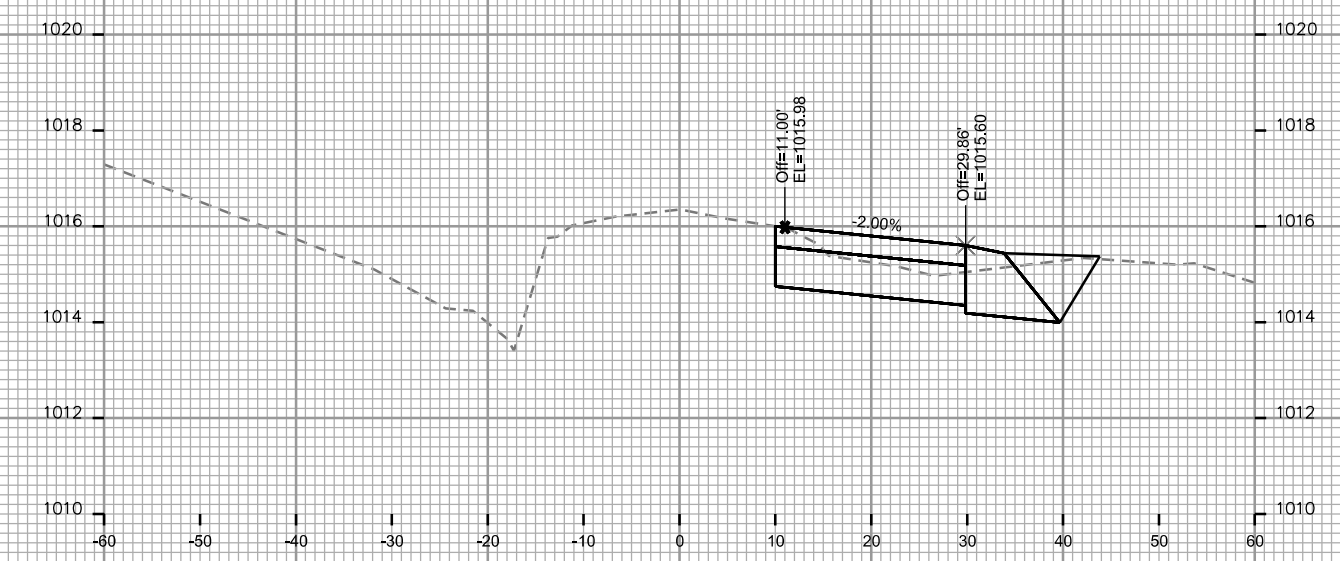
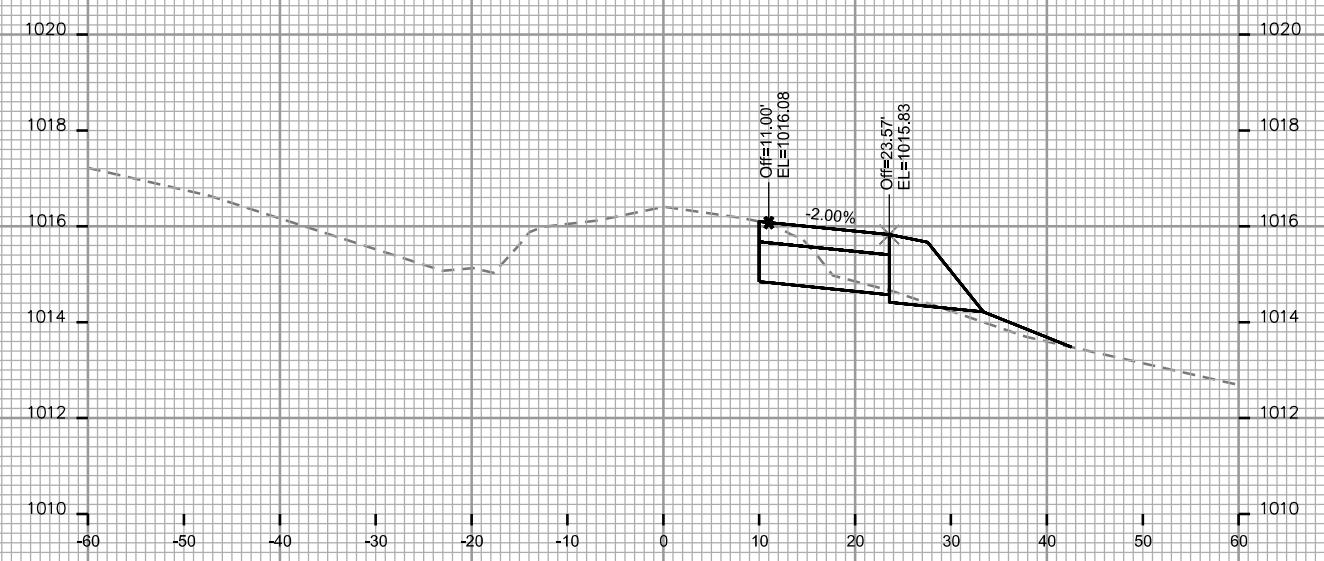

PLOT SCALE: _____

PLOT NAME: _____

REV. DATE: _____

ORIGINATOR: CITY OF MADISON - STREETS DIVISION

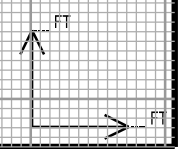
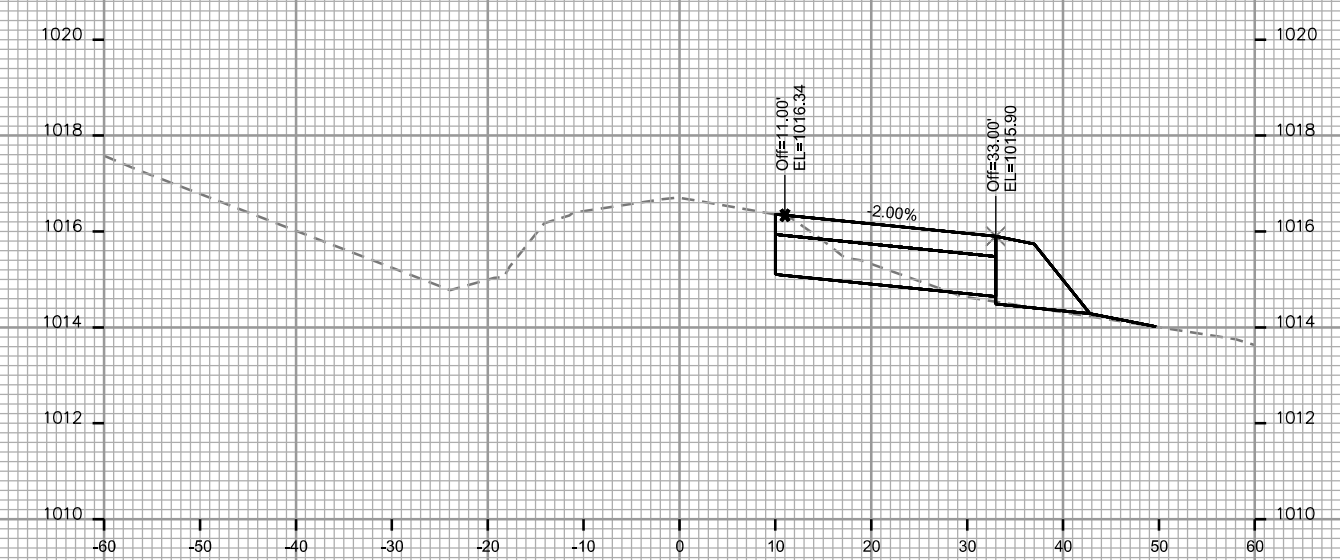
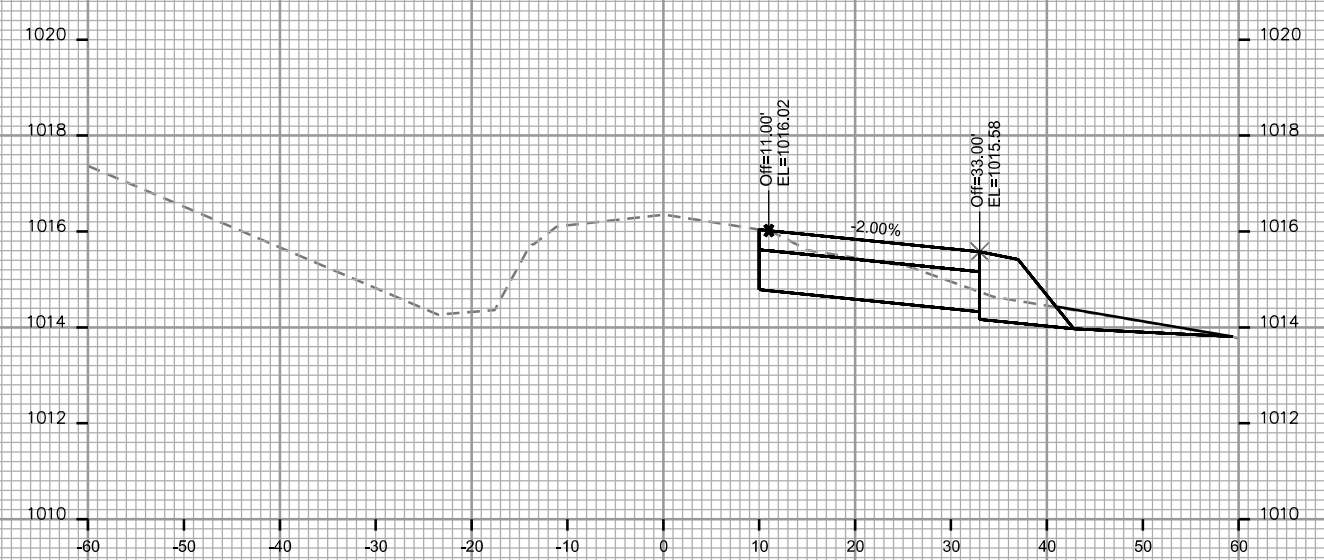
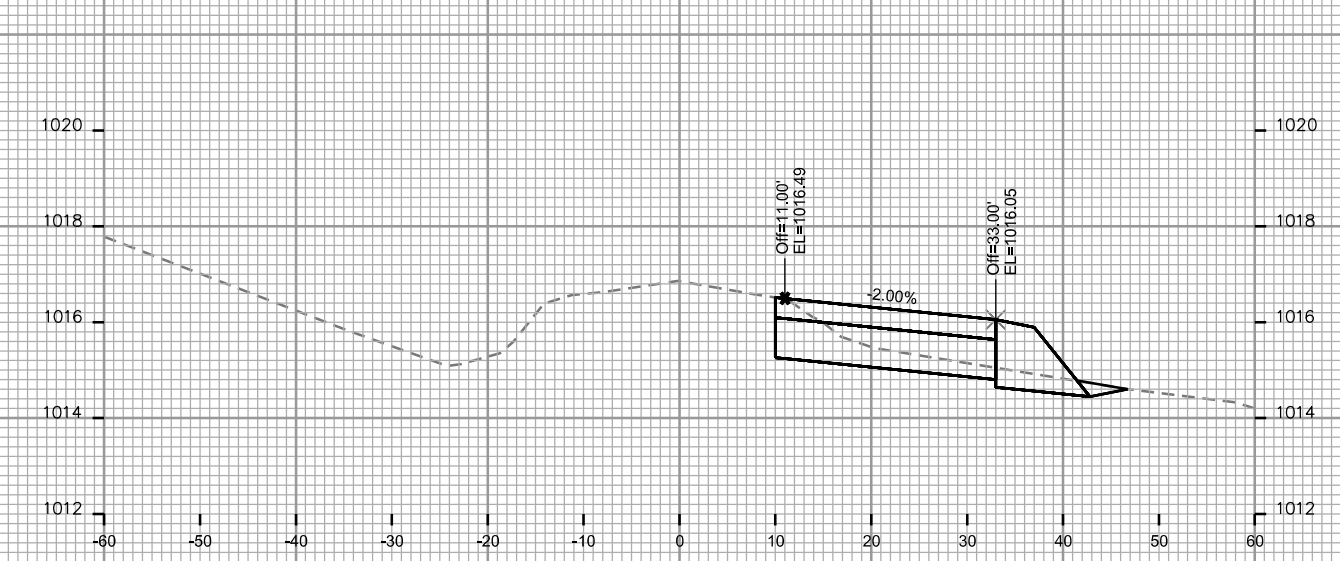
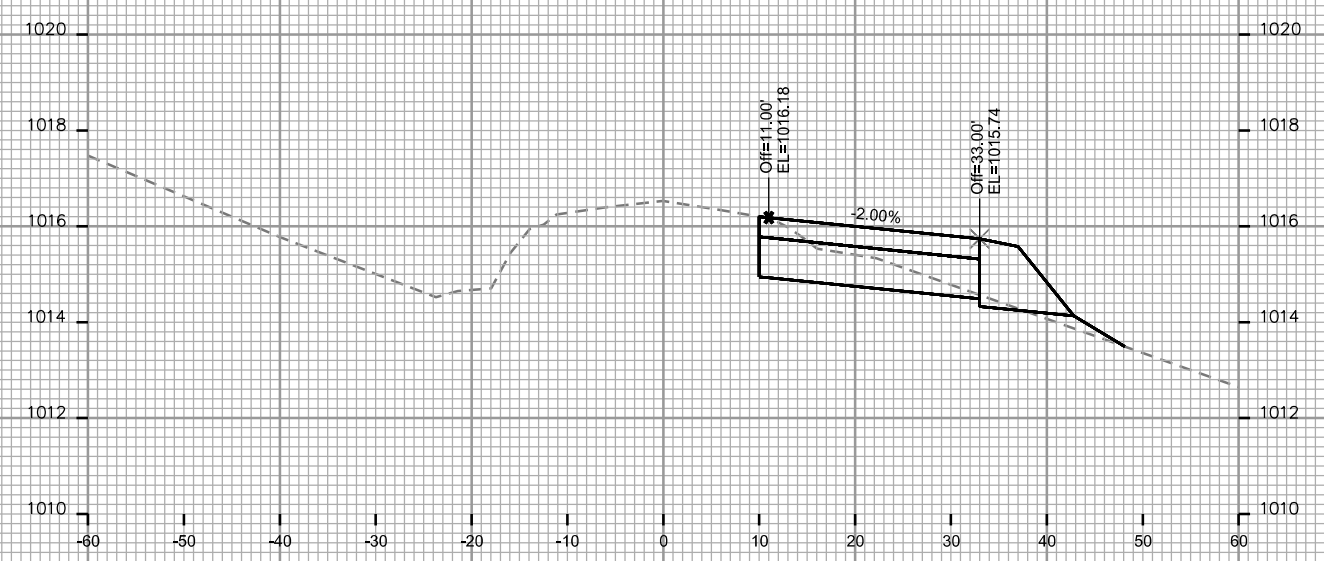

PLOT SCALE: _____

PLOT NAME: _____

REV. DATE: _____

ORIGINATOR: CITY OF MADISON - STREETS DIVISION

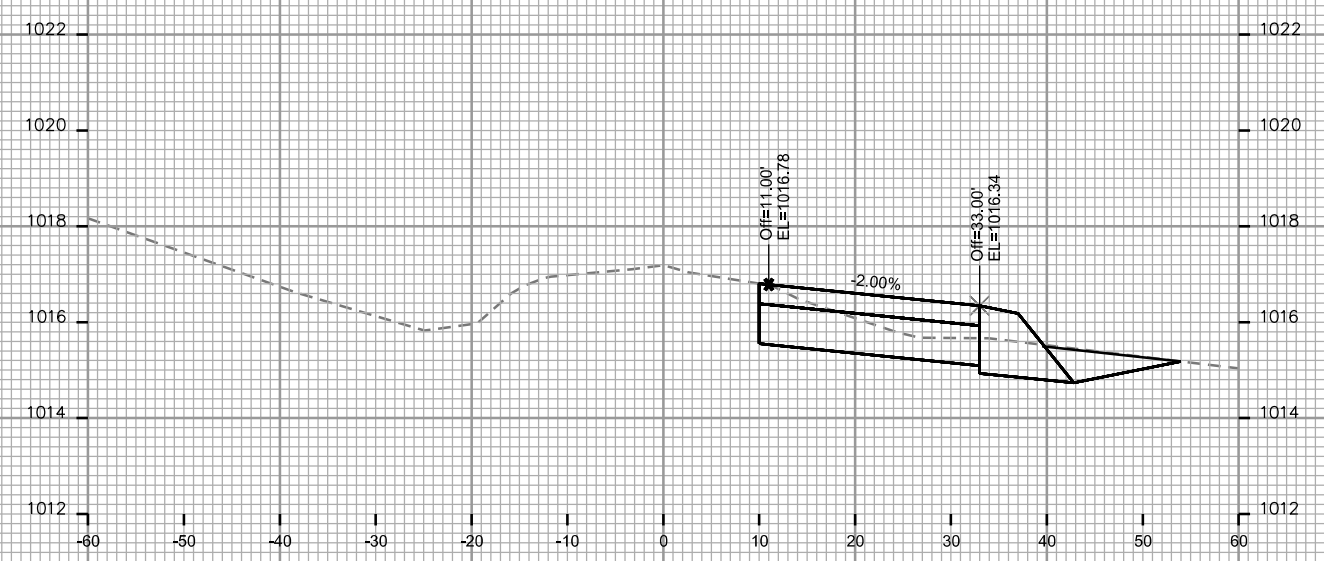

STA. 103+75

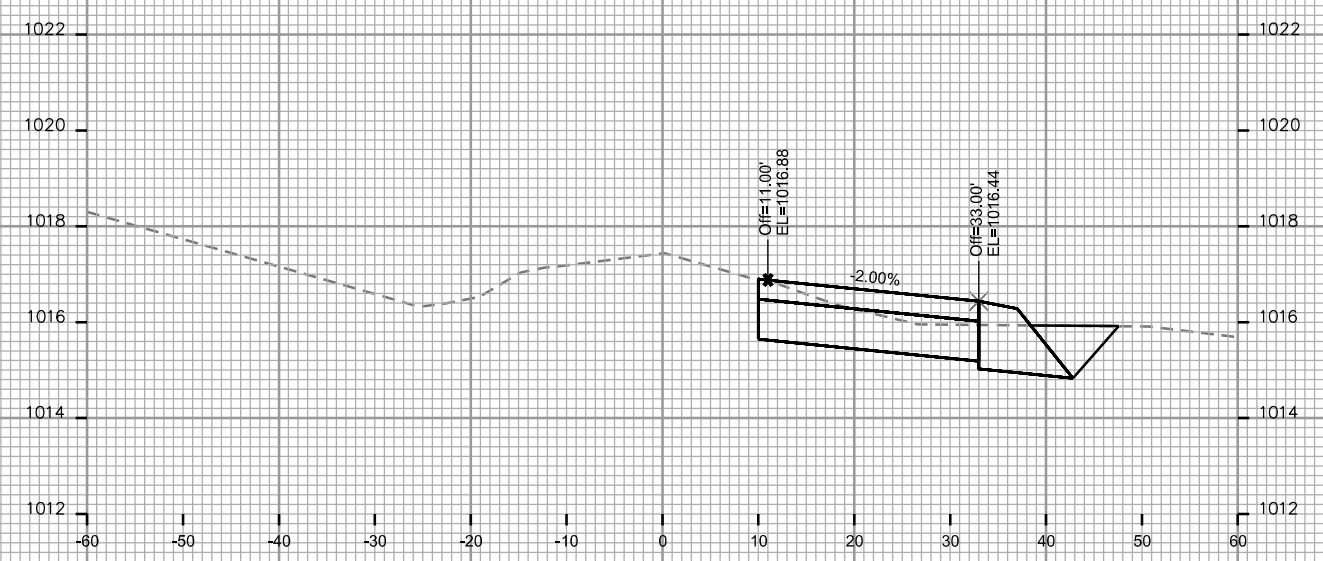

STA. 104+02

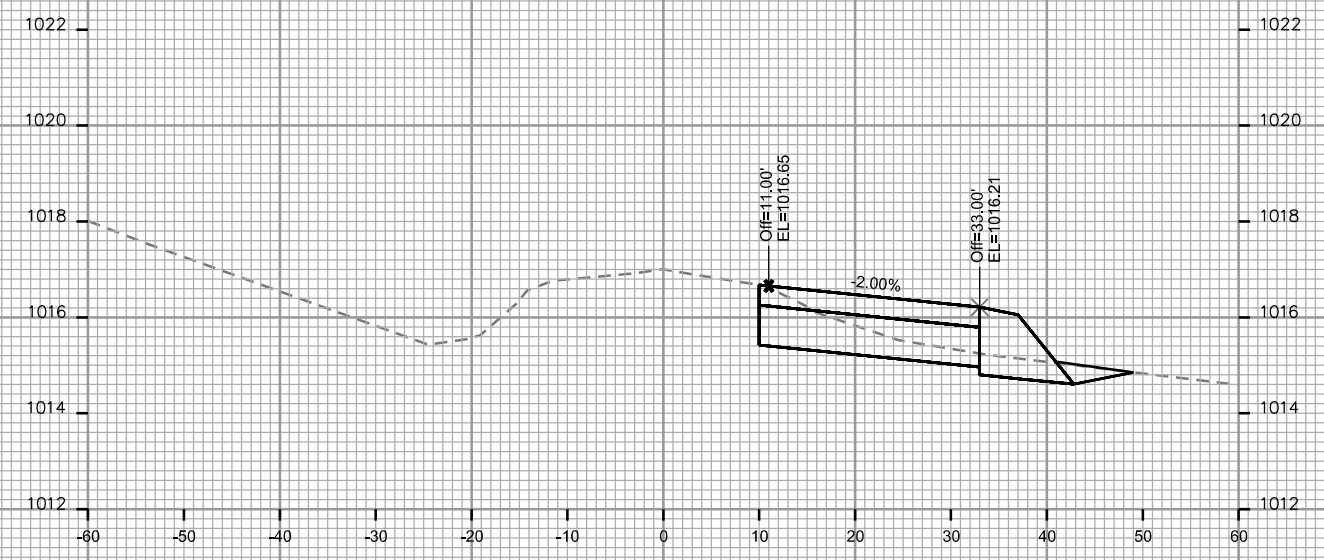

STA. 103+50

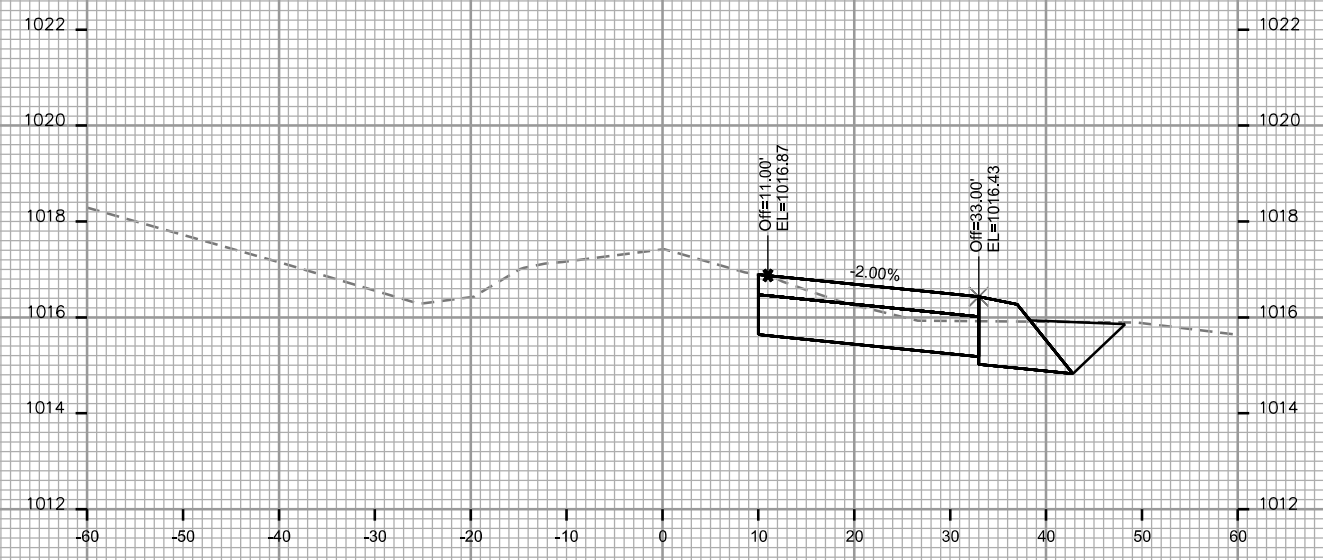

STA. 104+00

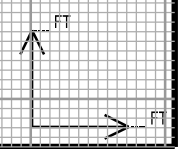

CROSS SECTIONS

PLEASANT VIEW RD

CITY OF MADISON

PLOT SCALE: _____

PLOT NAME: _____

REV. DATE: _____

ORIGINATOR: CITY OF MADISON, STREETS DIVISION

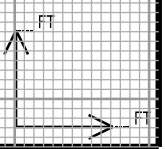
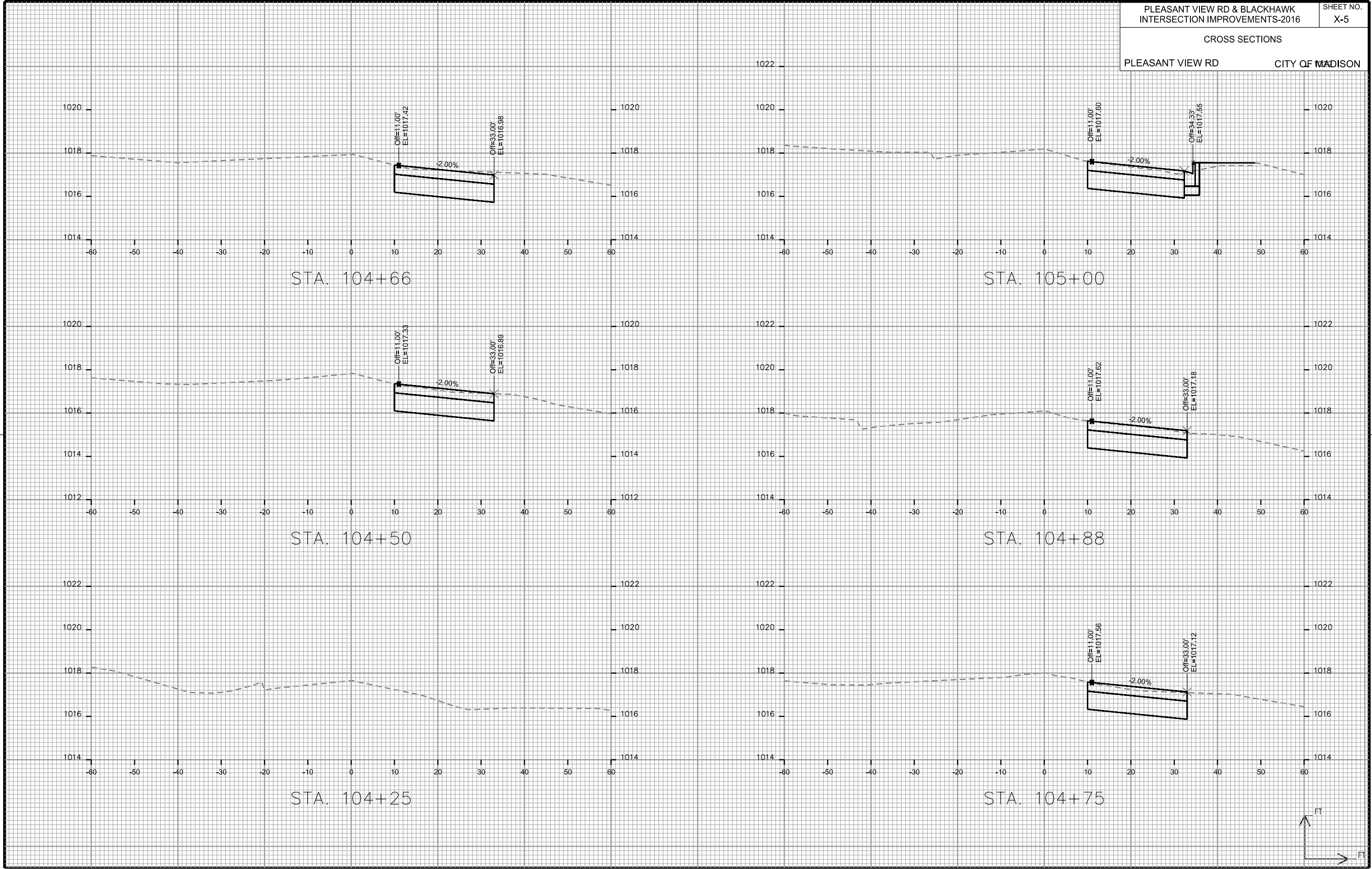

PLOT SCALE: _____

PLOT NAME: _____

REV. DATE: _____

ORIGINATOR: CITY OF MADISON - STREETS DIVISION

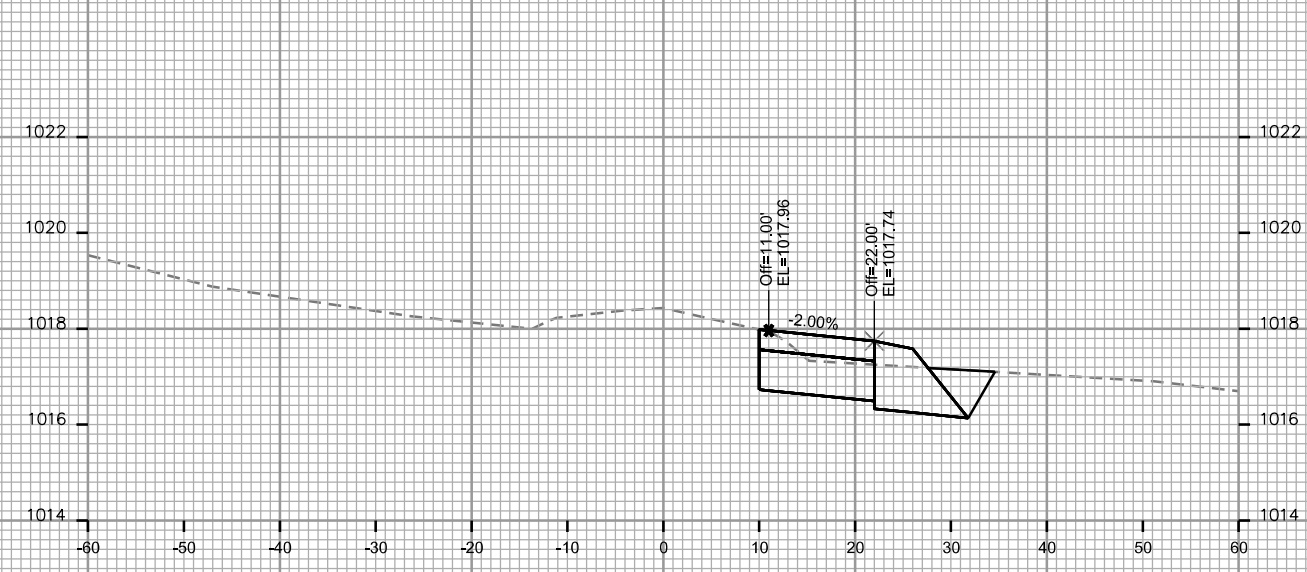

STA. 105+50

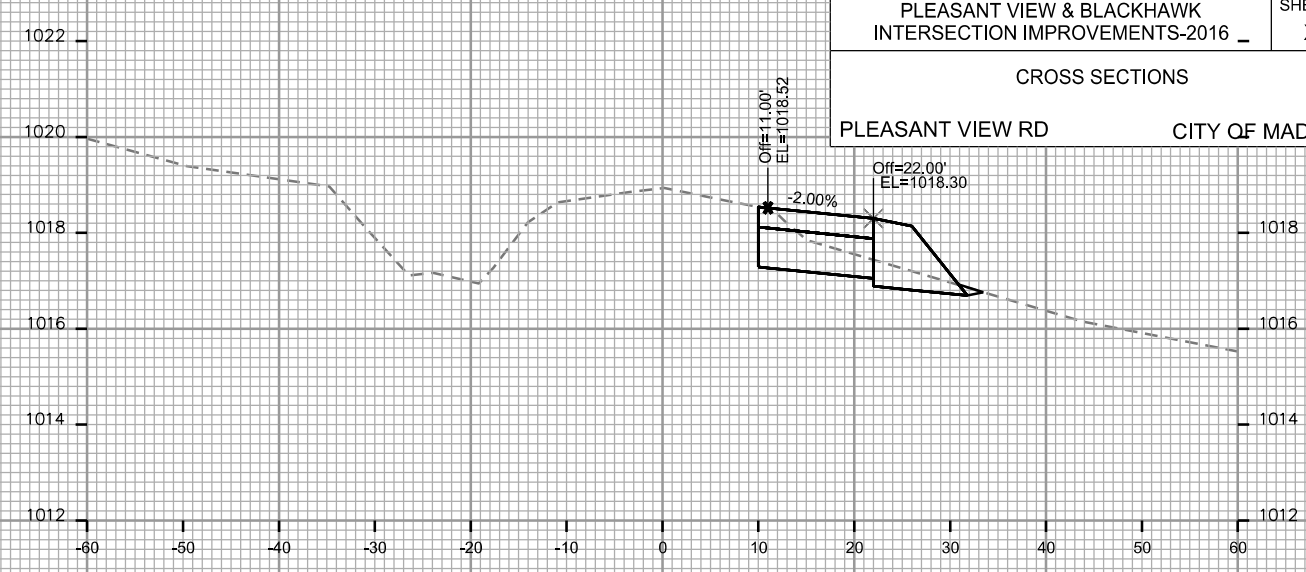

STA. 106+25

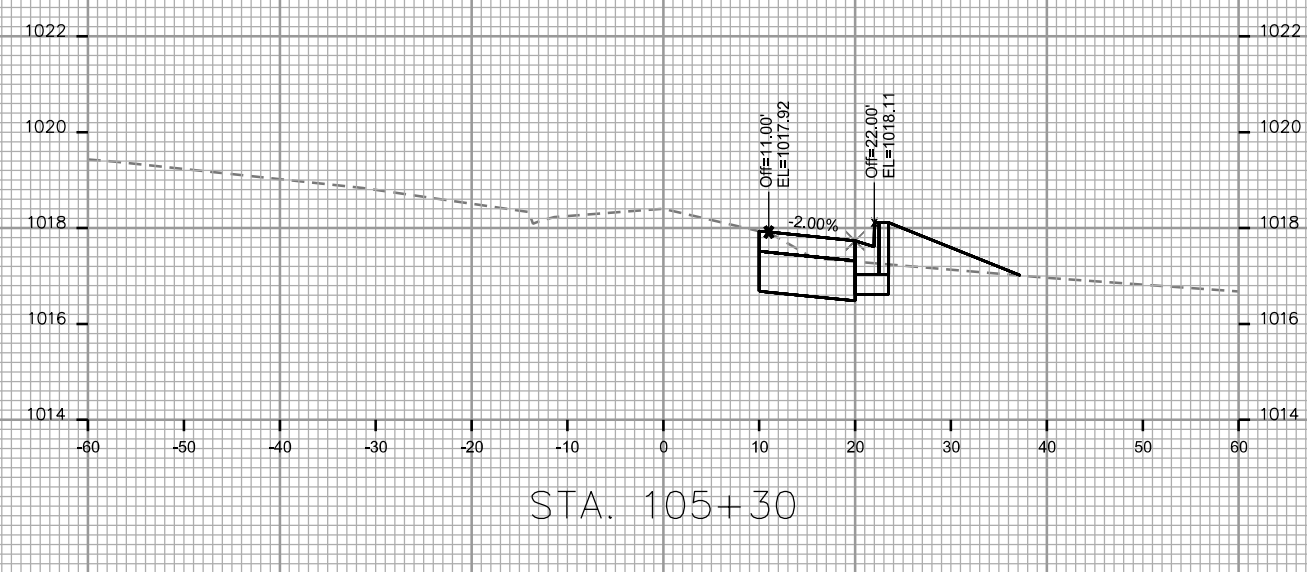

STA. 105+30

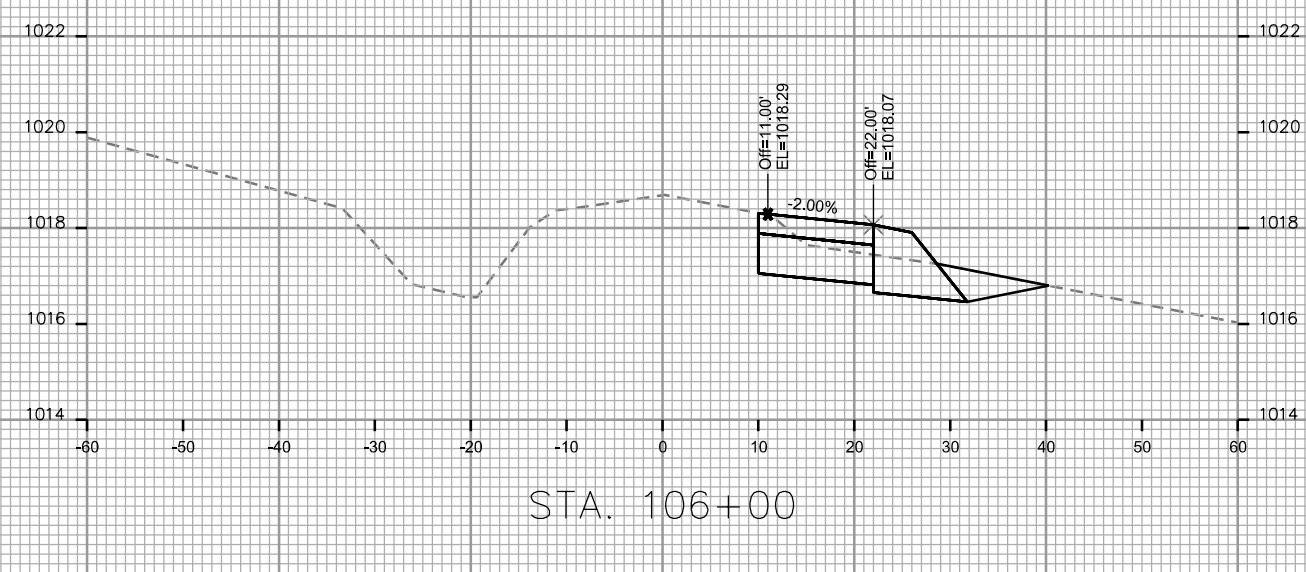

STA. 106+00

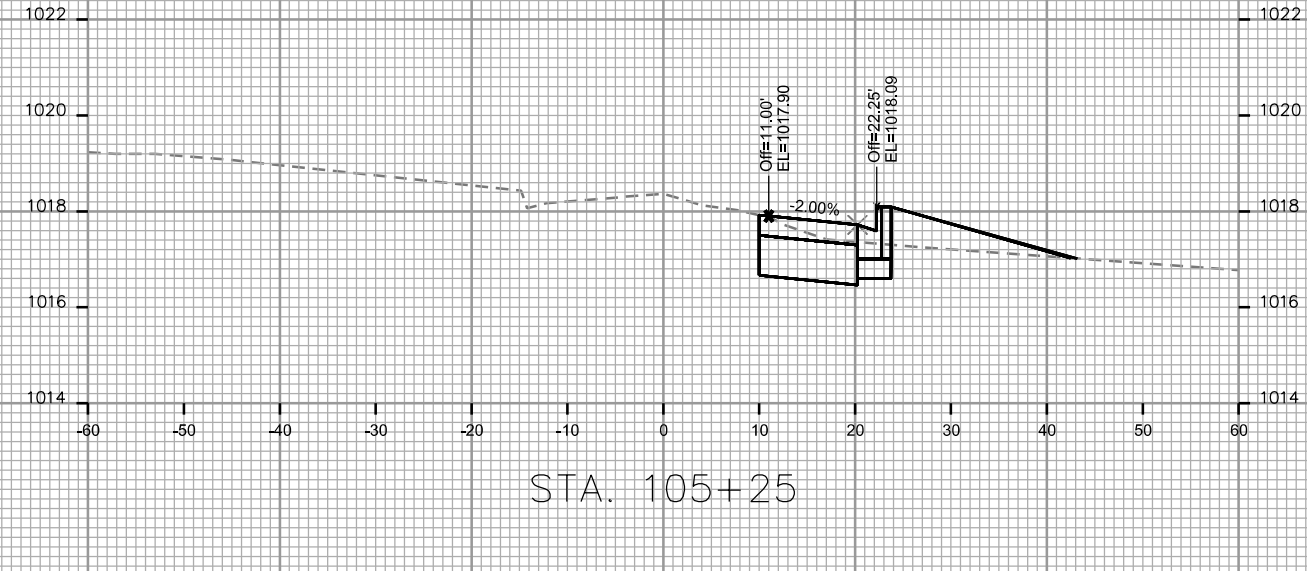

STA. 105+25

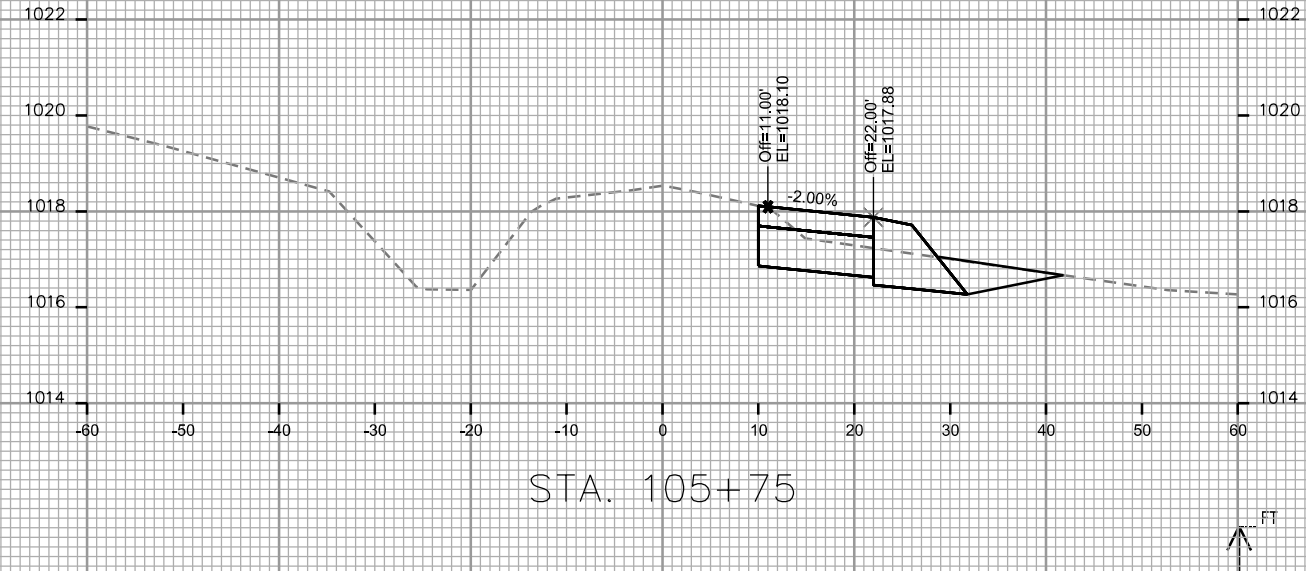

STA. 105+75

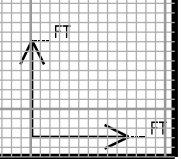

CROSS SECTIONS

PLEASANT VIEW RD

CITY OF MADISON

PLOT SCALE: _____

PLOT NAME: _____

REV. DATE: _____

ORIGINATOR: CITY OF MADISON - STREETS DIVISION

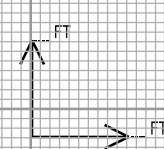
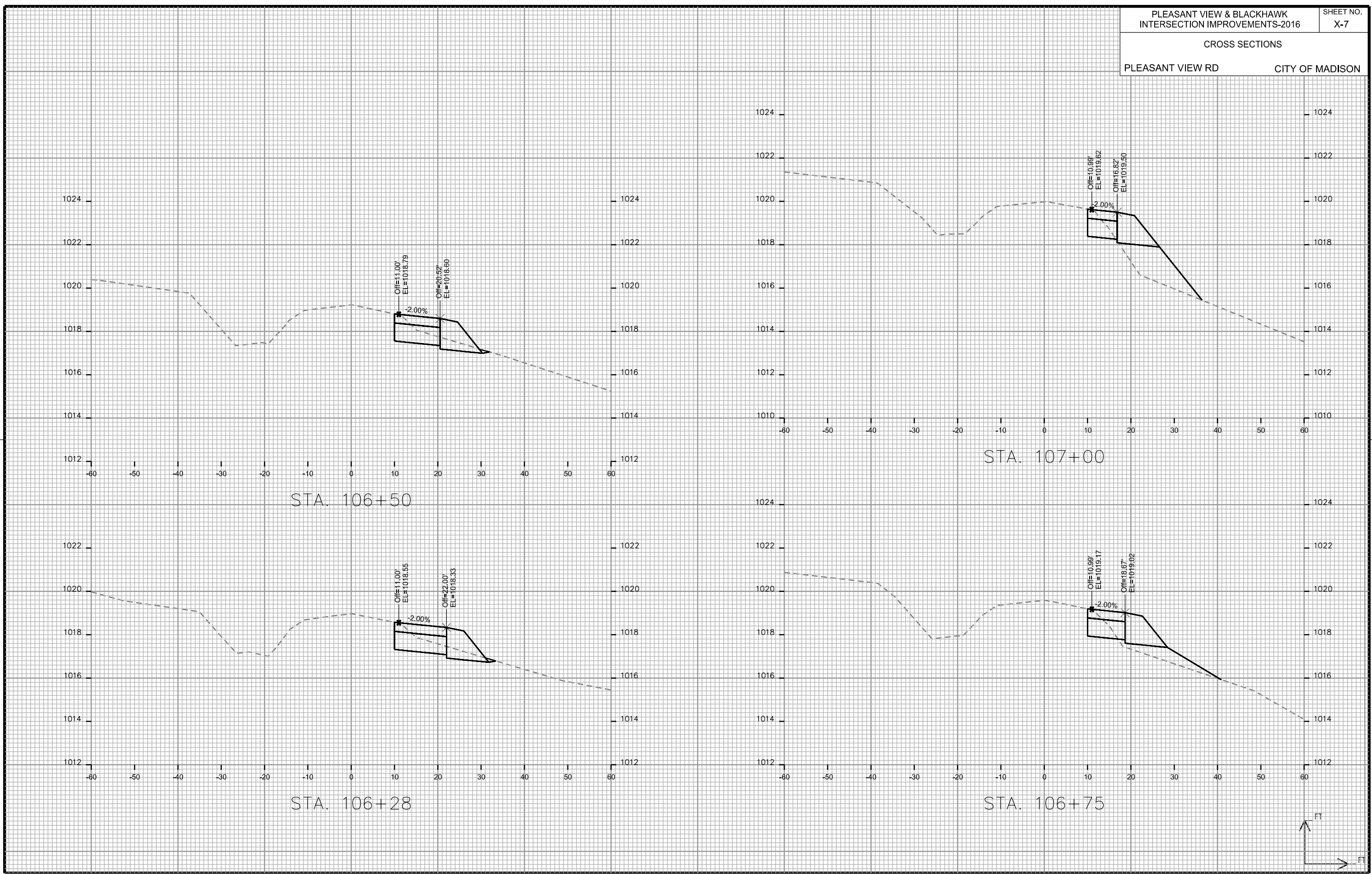

PLOT SCALE: _____
PLOT NAME: _____

REV. DATE: _____

ORIGINATOR: CITY OF MADISON - STREETS DIVISION

