

THE LOCATION AND INFORMATION FOR PROPOSED NEW TREES, IN THE PUBLIC RIGHT OF WAY OR ON PUBLIC LANDS ARE APPROXIMATE AND ARE SHOWN FOR REFERENCE ONLY. THE LOCATIONS, SPECIFICATIONS AND PLANTING METHODS OF ALL PROPOSED NEW OR REPLACEMENT TREES IN THE PUBLIC RIGHT OF WAY OR ON PUBLIC LANDS SHALL BE APPROVED BY THE CITY FORESTER PRIOR TO INSTALLATION.

NO TREES IN THE RIGHT OF WAY OR ON PUBLIC LANDS SHALL BE TRIMMED, PRUNED, REMOVED OR ADVERSELY AFFECTED IN ANY WAY UNTIL THE DEVELOPER HAS RECEIVED WRITTEN PERMISSION FROM THE CITY ENGINEER OR CITY FORESTER. SAID WRITTEN PERMISSION SHALL INCLUDE LANGUAGE INDICATING THAT SECTION 10.101 OF THE MADISON GENERAL ORDINANCES AND ADMINISTRATIVE PROCEDURE MEMORANDUM NO. 6-2, REFERRING TO NOTIFICATION OF PROPERTY OCCUPANTS AND/OR OWNERS, HAS BEEN COMPLIED WITH.

DEVELOPER MUST SUBMIT A TRAFFIC CONTROL PLAN TO CITY TRAFFIC ENGINEERING AT LEAST 14 DAYS PRIOR TO THE START OF WORK. WORK SHALL NOT PROCEED UNTIL AN APPROVED TRAFFIC CONTROL PLAN IS IN PLACE

ALL PAVEMENT IN THE HARVEY & RIDGE RIGHTS-OF-WAY SHALL BE TYPE A PAVEMENT PER STANDARD DETAIL DRAWING 4.02.

UNDERDRAINS SHALL BE INSTALLED, PER STANDARD DETAIL DRAWING 4.05 FOR 75' ON EACH SIDE OF THE LOW POINT, OR TO THE NEAREST CURB HIGH POINT. ALL UNDERDRAIN SHALL BE WRAPPED.

ALL GUTTERS SHALL DRAIN WITH A MINIMUM GRADES OF 0.5% TOWARD STORM SEWER INLETS.

ALL DITCHES SHALL DRAIN WITH A MINIMUM GRADES OF 0.5%

THE CROSS SLOPE OF SIDEWALKS AND BARRIER FREE SIDEWALK CURB RAMPS SHALL TYPICALLY BE 1.5%. THE LONGITUDINAL GRADE OF BARRIER FREE SIDEWALK CURB RAMPS SHALL NOT EXCEED 8.33%. ALL SIDEWALK RAMPS SHALL BE CONSTRUCTED ACCORDING TO S.D.D. 3.03. AT ALL OTHER LOCATIONS THE LONGITUDINAL GRADE OF SIDEWALKS SHALL NOT EXCEED 5.0 % OR THE ADJACENT STREET GRADE WHICHEVER IS GREATER NOR BE LESS THAN 0.5% AND SHALL DRAIN TOWARD STORM SEWER INLETS. SIDE SLOPES WITHIN TEN FEET OF A PUBLIC SIDEWALK SHALL NOT EXCEED 4:00:1. ALL SIDEWALK AND SIDEWALK RAMP ELEVATIONS AND GRADES SHALL BE FIELD VERIFIED AND SET TO COMPLY WITH THE CITY OF MADISON STANDARD SPECIFICATIONS AND THE A.D.A. GUIDELINES.

OBTAIN A PRINT OUT OF THE ALIGNMENT FROM THE CITY ENGINEER PRIOR TO STAKING THIS PROJECT.

CURB STATION AND OFFSETS SHALL BE TO THE FACE OF CURB UNLESS OTHERWISE INDICATED. CURB ELEVATIONS SHALL BE TO THE TOP OF CURB (OR EXTENDED TOP OF CURB FOR DRIVEWAYS OR RAMPS) UNLESS OTHERWISE INDICATED.

POWER POLES AND OTHER OBSTRUCTIONS SHALL BE MOVED TO PROVIDE 2 FEET MINIMUM OF CLEAR DISTANCE FROM ANY FACE OF CURB OR EDGE OF SIDEWALK.

ANY INFORMATION SHOWN ON THIS PLAN, WHICH IS NOT PART OF THIS PROJECT, IS PRELIMINARY AND NOT FOR CONSTRUCTION.

THERE MAY BE EXISTING UTILITIES OR OTHER FEATURES WHICH ARE EITHER NOT SHOWN OR SHOWN INCORRECTLY ON THIS PLAN. IT IS THE RESPONSIBILITY OF THE DEVELOPER TO LOCATE AND IDENTIFY ALL UTILITIES AND TOPOGRAPHY WHICH MAY AFFECT THE CONSTRUCTION OF THESE IMPROVEMENTS.

ALL PERMANENT SIGNING AND POSTING WILL BE DETERMINED AND PROVIDED BY THE TRAFFIC ENGINEERING DIVISION, FOLLOWING CONSTRUCTION OF THESE IMPROVEMENTS.

THE DEVELOPER SHALL PROVIDE, INSTALL AND MAINTAIN ALL STREET END BARRICADES, SIGNING AND TRAFFIC CONTROL, AS REQUIRED BY THE CITY TRAFFIC ENGINEER.



PAVEMENT SAWCUTS SHALL BE AS DIRECTED BY THE CITY CONSTRUCTION ENGINEER. SAWCUTS SHOWN ON THE PLAN ARE APPROXIMATE.

CURB ON CUL DE SACS SHALL BE INSTALLED ACCORDING TO SDD 3.05.

ALL WORK IN THE RIGHT OF WAY AND PUBLIC EASEMENTS SHALL BE IN ACCORDANCE WITH THE CITY OF MADISON STANDARD SPECIFICATIONS FOR PUBLIC WORKS CONSTRUCTION

CONVENTIONAL SIGNS

FIELD VERIFY ALL UTILITY LOCATIONS

GAS	—— G ——
STORM SEWER	—— ST ——
SANITARY SEWER	—— SAN ——
WATER	—— W ——
OVERHEAD ELECTRIC	—— OH ——
POWER POLE	⊕
ADA COMPLIANT RAMP W/ DETECTABLE WARNING FIELD	
COMBUSTIBLE FLUIDS	

PLOT SCALE: _____

PLOT NAME: _____

REV. DATE: _____

ORIGINATOR: CITY OF MADISON, STREETS DIVISION

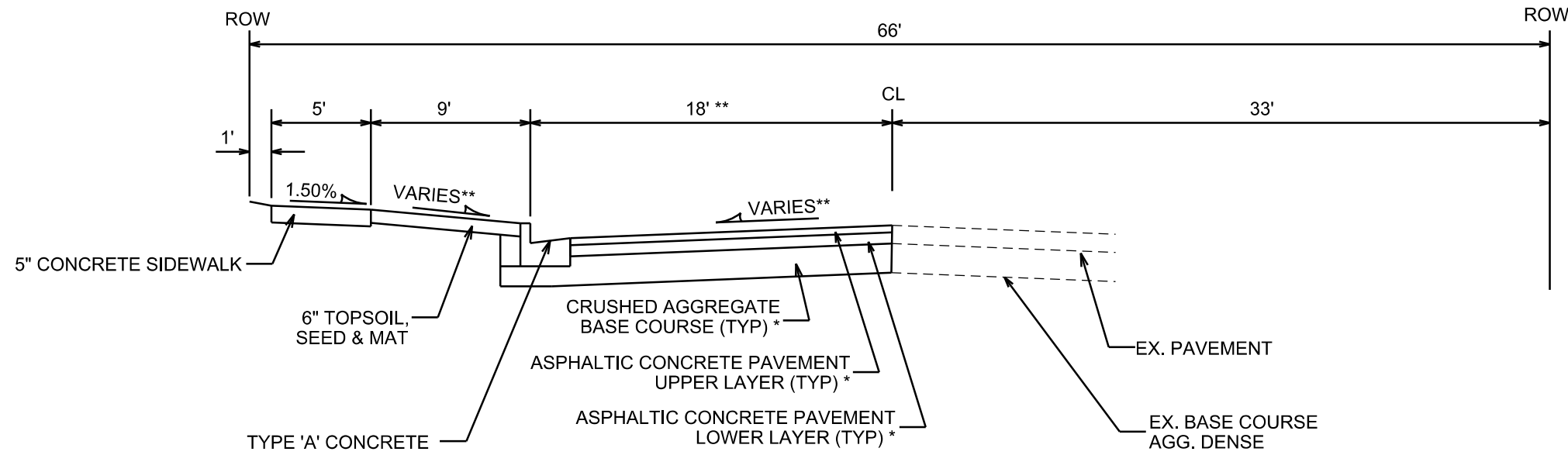

TYPICAL SECTION

RIDGE ST
STA 102+78 TO STA 104+78
NOT TO SCALE

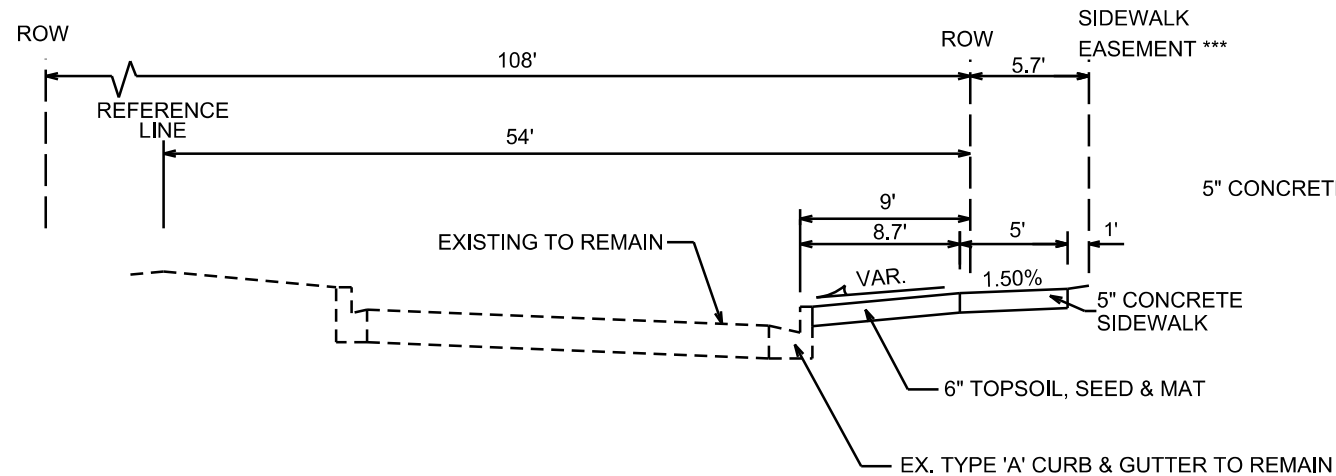

TYPICAL SECTION

UNIVERSITY AVE
STA 11+78 TO 13+61
NOT TO SCALE

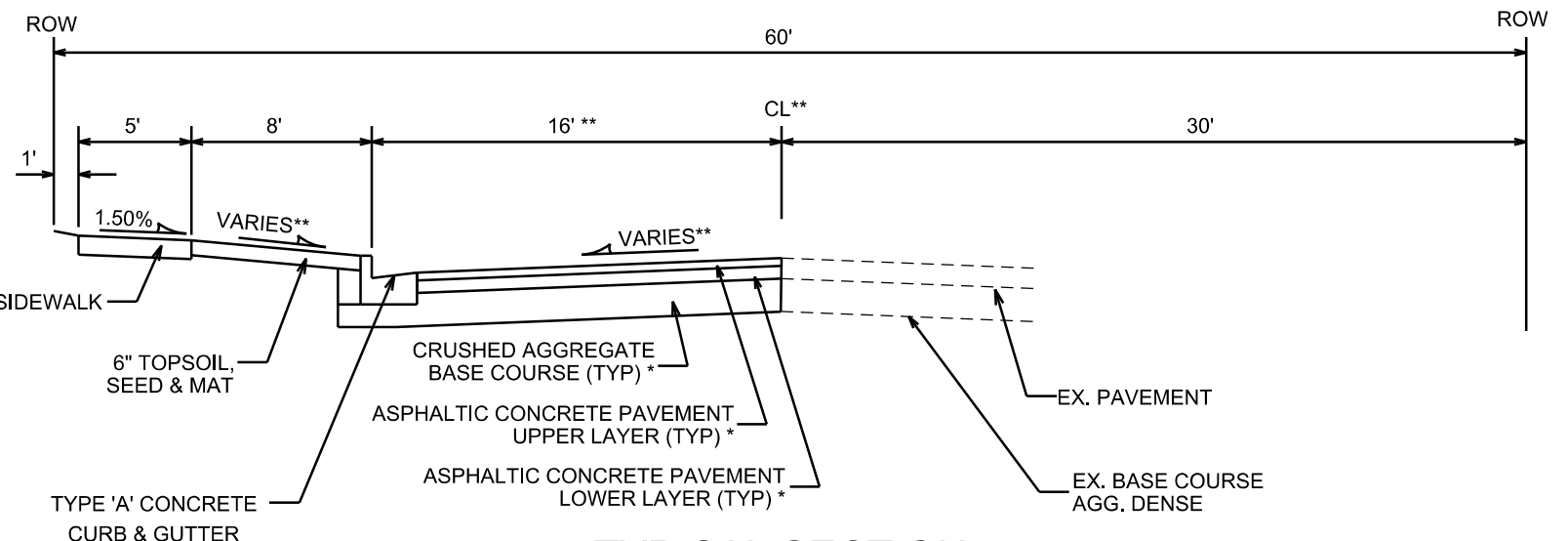

TYPICAL SECTION

HARVEY ST
STA 200+93 TO STA 202+74
NOT TO SCALE

CITY OF MADISON MINIMUM PAVEMENT DESIGN

TYPE	CRUSHED AGG. BASE COURSE		ASPHALTIC CONCRETE PAVEMENT			
	LOWER LAYER GRADATION 1	UPPER LAYER GRADATION 2	LOWER LAYER		UPPER LAYER	
			TYPE	THICKNESS	TYPE	THICKNESS
A	6"	6"	4 LT 58-28 S	1.75"	4 LT 58-28 S	1.75"
B	6"	6"	4 LT 58-28 S	2.50"	4 LT 58-28 S	2.00"
C	6"	6"	3 MT 58-28 S/H 3 HT 58-28 H	3.50"	4 MT 58-28 S/H 4 HT 58-28 H	2.00"

NOTES:

TYPICAL SECTIONS NOT TO SCALE

* HARVEY AND RIDGE ST TO BE CONSTRUCTED AS TYPE 'A' PAVEMENT PER CITY OF MADISON MINIMUM PAVEMENT DESIGN

** SEE CROSS SECTIONS FOR ELEVATIONS, SLOPES AND OFFSETS.

*** 5.7' SIDEWALK EASEMENT. SEE RECORDED DOCUMENT NO. 5404546

STREET PLAN AND PROFILE

HARVEY ST CITY OF MADISON

NOTES:
1" = 30'

1. FINAL PAVEMENT REPAIR LIMITS TO BE DETERMINED BY THE CONSTRUCTION ENGINEER.
2. DEVELOPER SHALL BE RESPONSIBLE FOR COORDINATING AND SCHEDULING ANY REQUIRED RELOCATION OR ADJUSTING OF PRIVATE UTILITY FACILITIES, SUCH AS POLES, PEDESTALS, BOXES, STRUCTURES, CASTINGS OR MANHOLES, WITH PRIVATE UTILITY COMPANIES
3. SEE PRIVATE PLANS FOR WORK ON PRIVATE PROPERTY

LEGEND:

X = REMOVE TREE

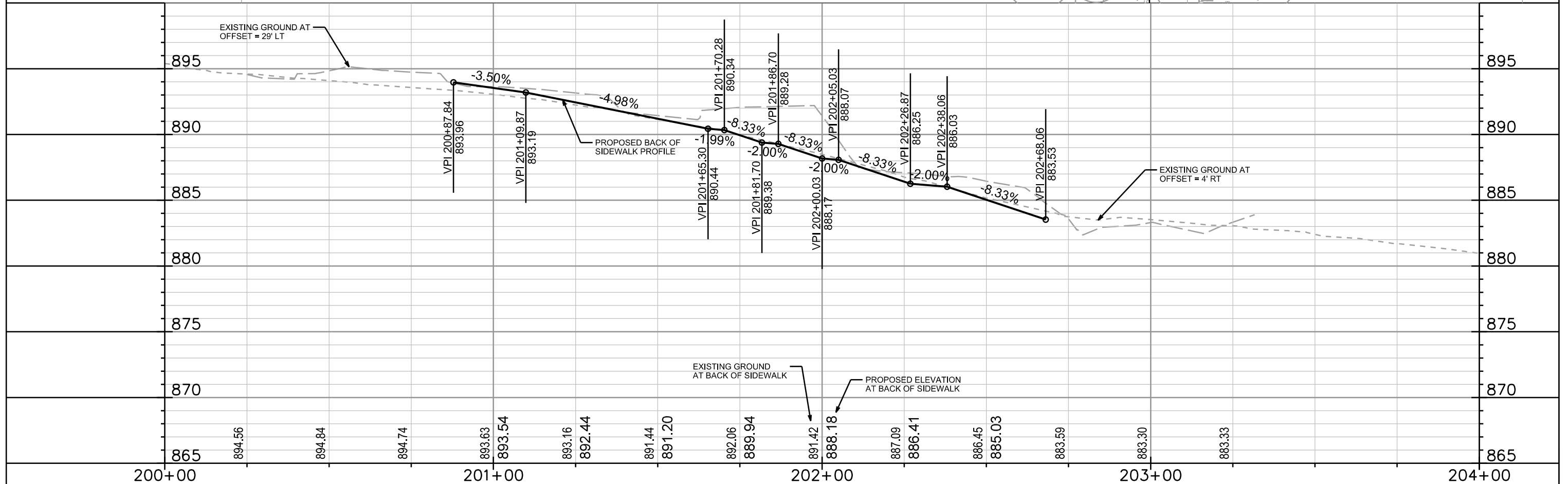
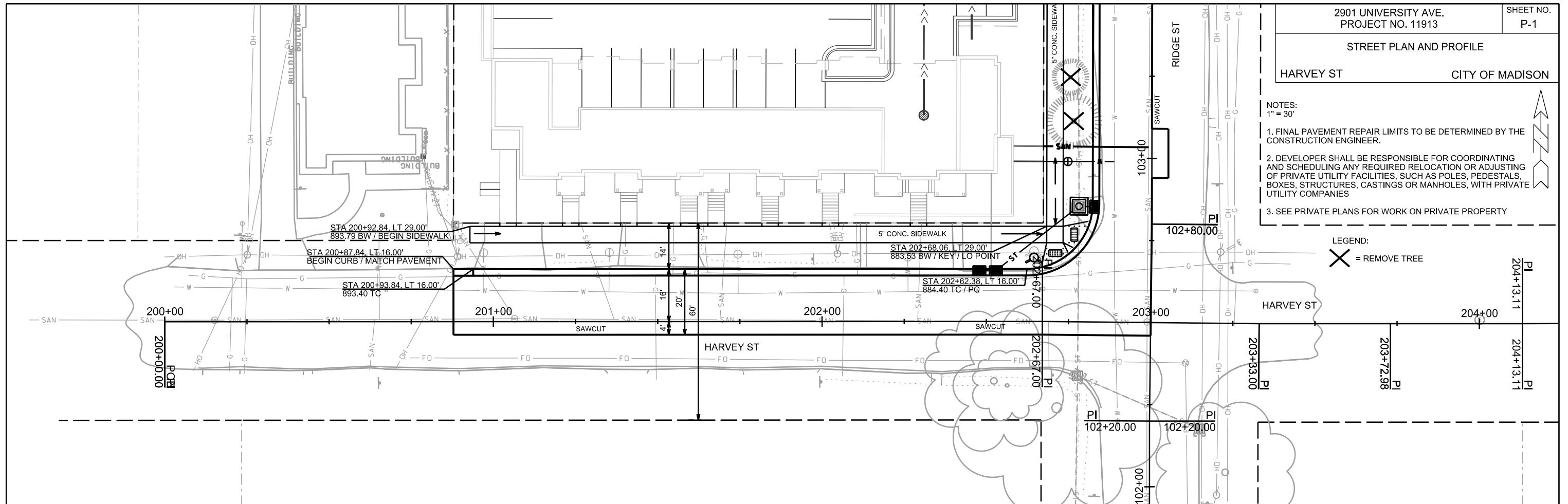

PLOT SCALE: _____

PLOT NAME: _____

REV. DATE: _____

ORIGINATOR: CITY OF MADISON, STREETS DIVISION

SIDEWALK PLAN AND PROFILE

RIDGE ST CITY OF MADISON

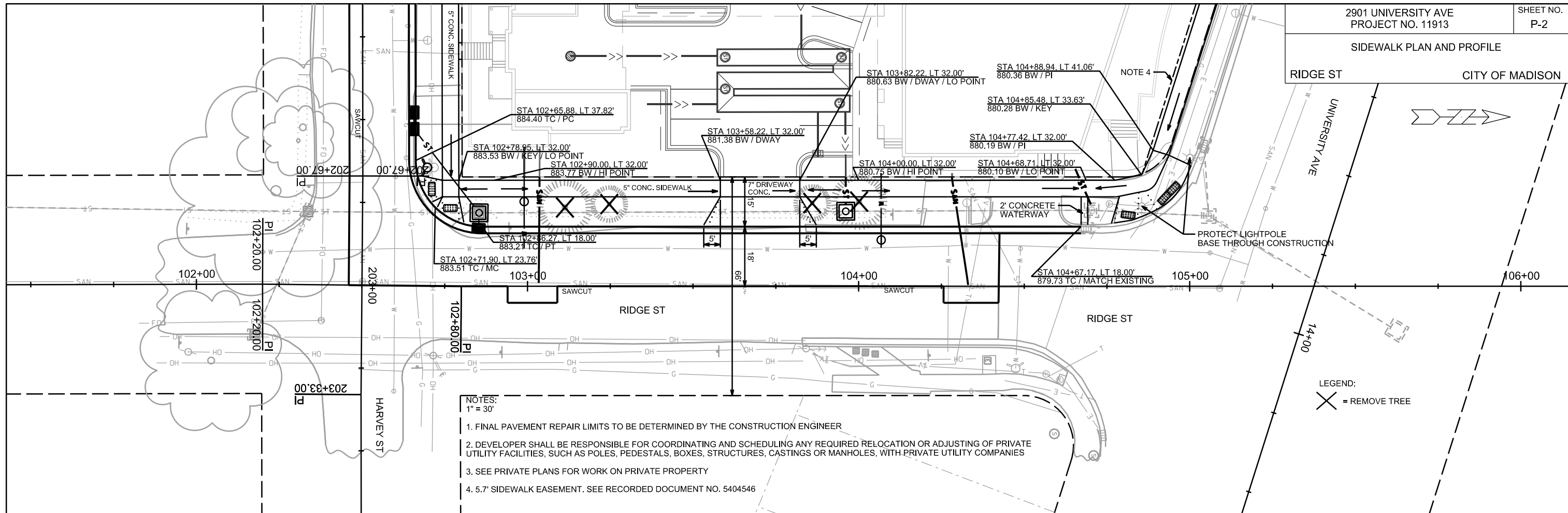

- NOTES:
1" = 30'
1. FINAL PAVEMENT REPAIR LIMITS TO BE DETERMINED BY THE CONSTRUCTION ENGINEER
 2. DEVELOPER SHALL BE RESPONSIBLE FOR COORDINATING AND SCHEDULING ANY REQUIRED RELOCATION OR ADJUSTING OF PRIVATE UTILITY FACILITIES, SUCH AS POLES, PEDESTALS, BOXES, STRUCTURES, CASTINGS OR MANHOLES, WITH PRIVATE UTILITY COMPANIES
 3. SEE PRIVATE PLANS FOR WORK ON PRIVATE PROPERTY
 4. 5.7' SIDEWALK EASEMENT. SEE RECORDED DOCUMENT NO. 5404546

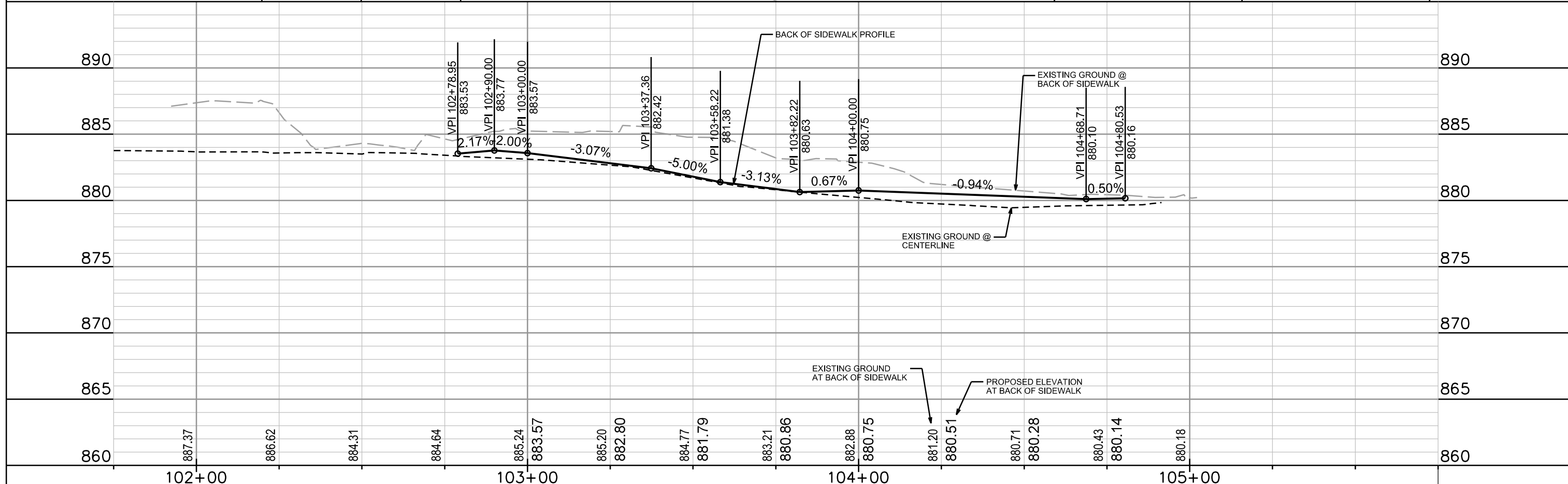

PLOT SCALE:

PLOT NAME:

REV. DATE:

ORIGINATOR: CITY OF MADISON, STREETS DIVISION

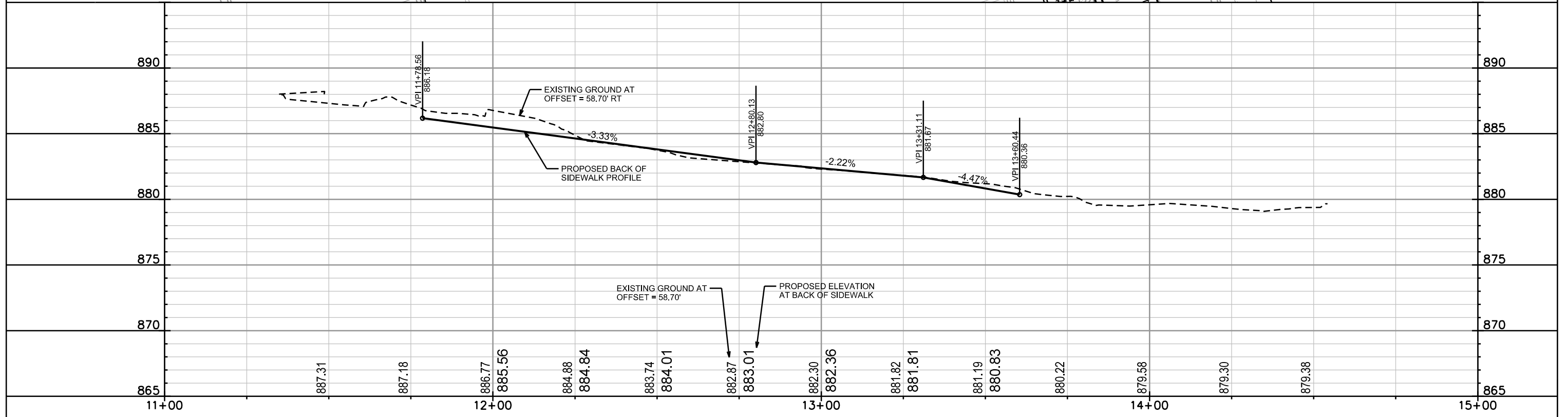
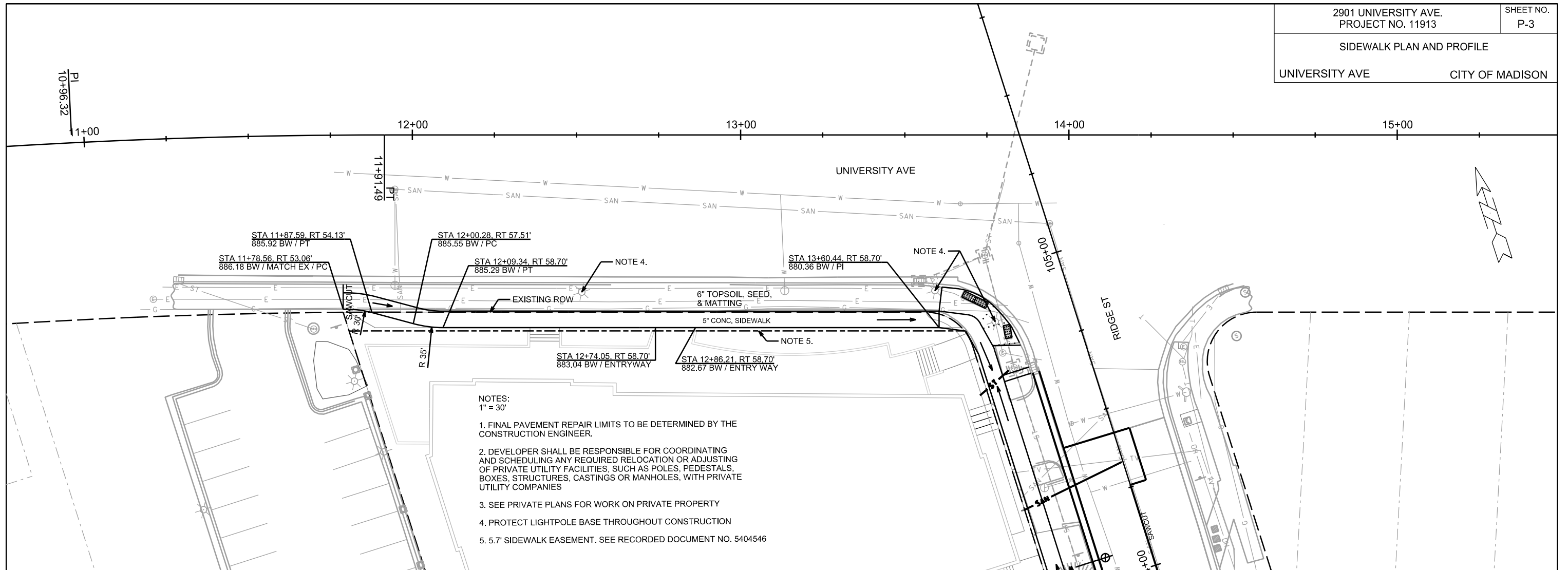

PLOT SCALE: _____

PLOT NAME: _____

REV. DATE: _____

ORIGINATOR: CITY OF MADISON, STREETS DIVISION

UTILITY PLAN AND PROFILE

HARVEY ST CITY OF MADISON

- NOTES:
1"=30'
- SANITARY PLUG BY CITY. PERMIT REQUIRED.
 - PLUG AND CAP EX. LATERAL (AT PROPERTY LINE) BY APPLICANT. PERMIT REQUIRED.

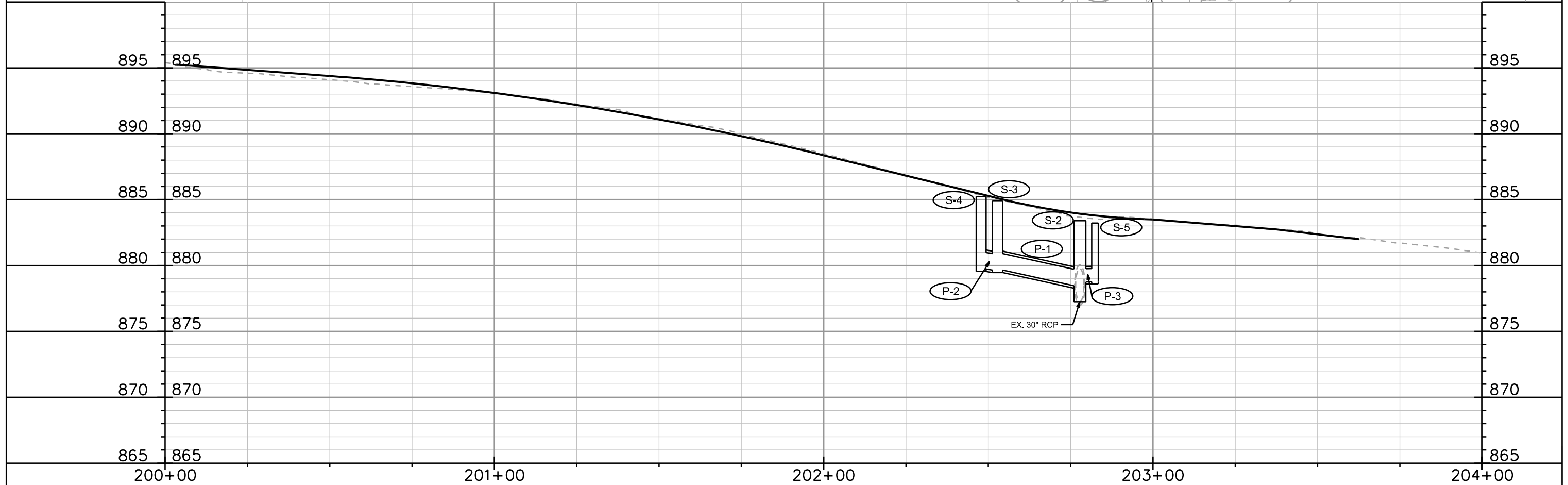
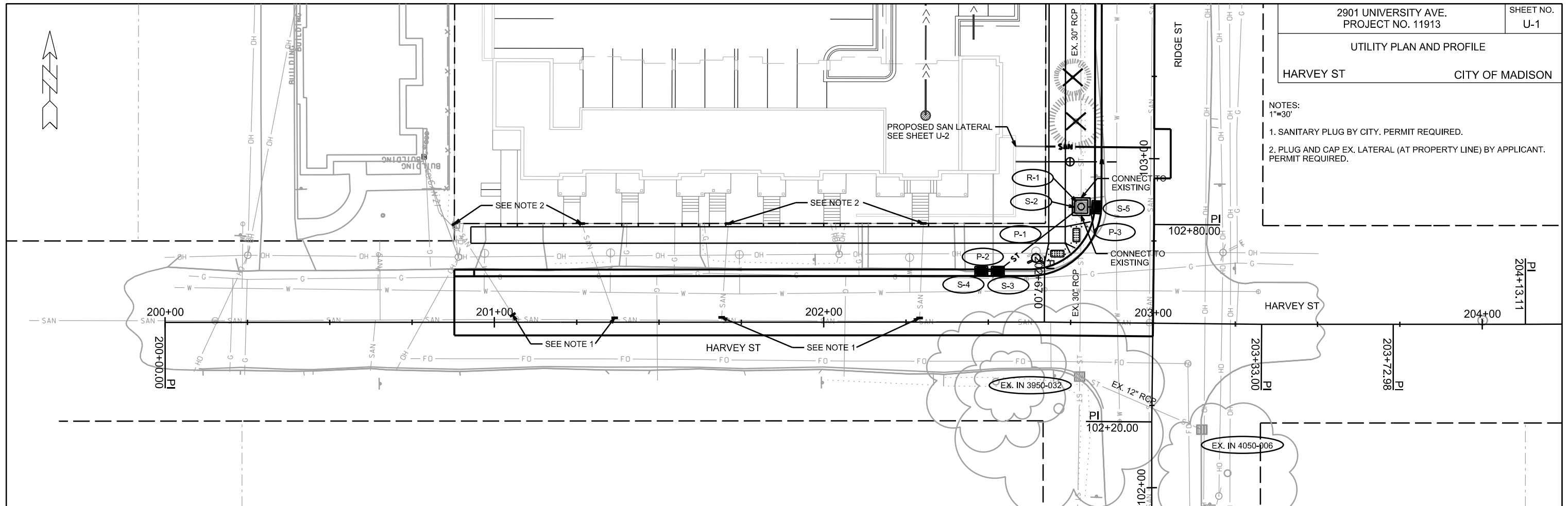

PLOT SCALE: _____

PLOT NAME: _____

REV. DATE: _____

ORIGINATOR: CITY OF MADISON, STREETS DIVISION

UTILITY PLAN AND PROFILE

RIDGE ST CITY OF MADISON

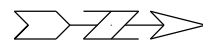

- NOTES:
1"=30'
- SANITARY PLUG BY CITY. PERMIT REQUIRED.
 - PLUG AND CAP EX. LATERAL (AT PROPERTY LINE) BY APPLICANT. PERMIT REQUIRED.
 - CONTRACTOR TO VERIFY EX. 30" RCP STORM SEWER DEPTH BETWEEN STA 104+00 AND 104+75.

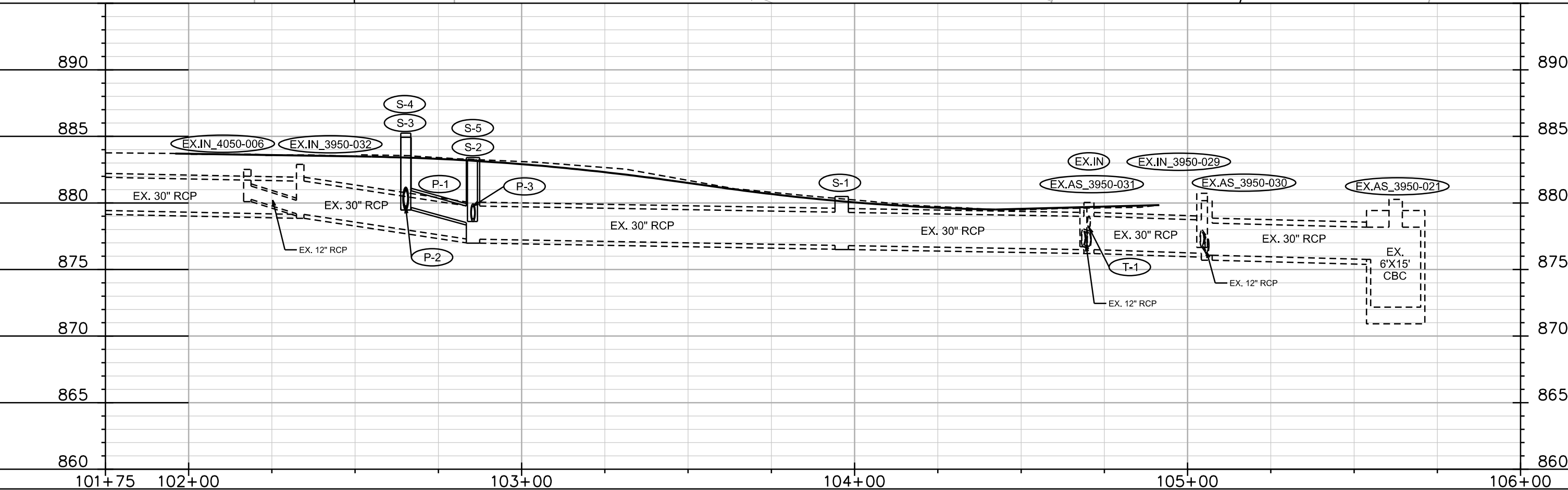
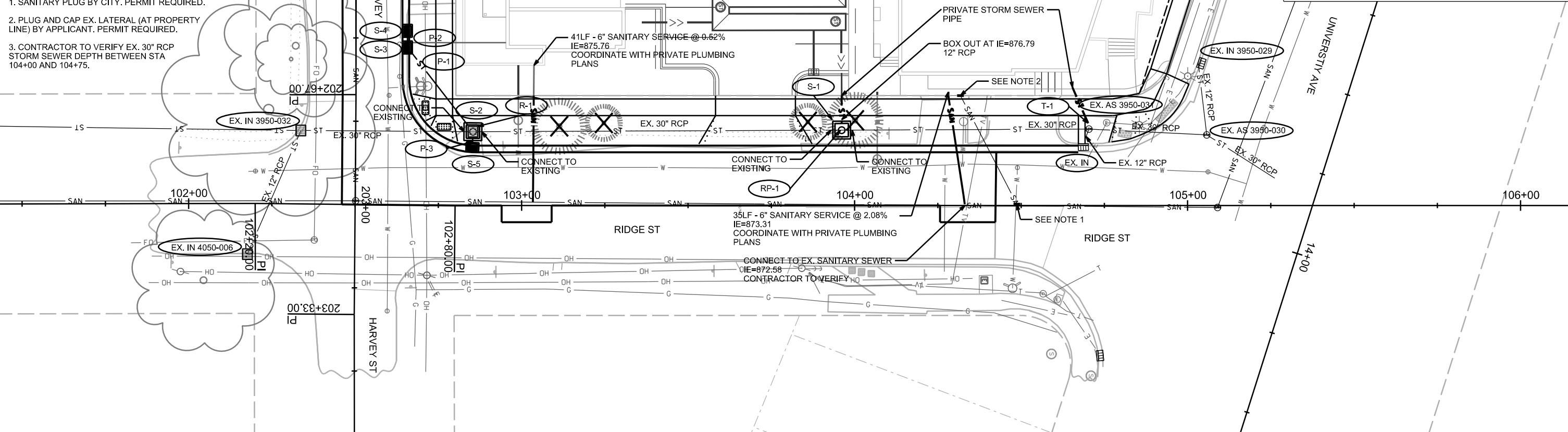

PLOT SCALE:

PLOT NAME:

REV. DATE:

ORIGINATOR: CITY OF MADISON, STREETS DIVISION

STORM SEWER SCHEDULE

2901 UNIVERSITY AVE PROJECT NO. 11913	SHEET NO. U-3
STORM SEWER SCHEDULE CITY OF MADISON	

PROPOSED STORM STRUCTURES

STRUC NO.	STATION	LOCATION (OFFSET)	TYPE	TOP OF CASTING	E.I.	DEPTH	NOTES
S-1	103+96.13	LT-22.63	4X4 SAS	880.49	876.79	3.70	W/ R-1689-0054; FP
S-2	102+85.40	LT-22.16	4X4 SAS	883.41	877.27	6.14	W/ R-1550-0054; FP
S-3	202+52.88	LT-15.50	H INLET	884.93	879.66	5.27	W/ R-3067-7004-V
S-4	202+47.88	LT-15.50	H INLET	885.24	879.75	5.49	W/ R-3067-7004-V
S-5	102+85.22	LT-17.53	H INLET	883.23	878.78	4.45	W/ R-3067-7004-V

PROPOSED STORM PIPES

PIPE NO.	FROM SAS (DWNSTRM)	TO SAS (UPSTREAM)	EI # (DWNSTRM)	EI # (UPSTRM)	PIPE LENGTH (FT)	PLAN LENGTH (FT)	SLOPE (%)	SIZE (DIA)	TYPE	NOTES
P-1	S-2	S-3	878.52	879.66	28	32	4.09%	15"	RCP	
P-2	S-3	S-4	879.66	879.75	2	5	4.50%	15"	RCP	
P-3	S-2	S-5	878.77	878.78	2	5	0.61%	12"	RCP	

STORM STRUCTURE TAP

STRUC NO.	ID NO.	STATION	LOCATION (OFFSET)	TYPE	E.I.	NOTES
T-1	AS 3950-031	104+70.26	LT-24.45	4X4 SAS	878.16	SEE SPEC. NOTE 1

STORM PIPE REMOVAL

PIPE REMOV/	REMOVE FROM	REMOVE TO	LENGTH (FT)	PAID (Y/N)	SIZE	TYPE	NOTES
RP-1	STA 103+93.63	STA 103+98.63	5	N	30"	RCP	

STORM STRUCTURE REMOVAL

STRUC NO.	ID NO.	STATION	LOCATION (OFFSET)	TYPE	DEPTH
R-1	AS 3950-034	102+85.40	LT-22.16	H INLET FLAT	5.80

NOTE: PLAN LENGTH (PAY LENGTH) IS FROM CENTER OF STRUCTURE TO CENTER OF STRUCTURE. PIPE LENGTH IS ACTUAL

SPECIAL NOTES:

1) PLACE SEWER ELECTRONIC MARKER ABOVE STORM SEWER TAP AND BEND LOCATIONS

STANDARD NOTES:

- ABBREVIATIONS: AE = APRON ENDWALL; RCP = REINFORCED CONCRETE PIPE; HERCP = HORIZONTAL ELLIPTICAL REINFORCED CONCRETE PIPE; DNA = DOES NOT APPLY; SAS = SEWER ACCESS STRUCTURE; LP = LOW POINT INLET STRUCTURE; FP = FIELD POURED STRUCTURE; TR = TOP OF CONCRETE ROOF; NCM = NO CROWN MATCH FOR PIPES; UD = UNDERDRAIN
 - APPROXIMATE DISCHARGE E.I. GIVEN, ADJUST E.I. AND PIPE SLOPE IN THE FIELD.
 - TOP OF CASTING GRADE GIVEN IS THE TOP OF CURB FOR INLET STRUCTURES AND THE FLOWLINE OF THE CLOSED CASTING FOR SAS'S.
 - TOP OF CONCRETE ROOF (TR) IS 1.25' BELOW TOP OF CASTING UNLESS OTHERWISE NOTED.
 - ALL REINFORCED CONCRETE PIPES TO BE CLASS III UNLESS OTHERWISE NOTED.
 - SURVEYOR TO CONFIRM THAT ALL INLET STATION / OFFSETS LINE UP WITH PROPOSED CURB AND GUTTER.
 - ALL STRUCTURES CALLED OUT AS FIELD POURED SHALL BE FIELD POURED. ALL OTHER STRUCTURES (NOT INDICATED AS FIELD POURED) SHALL BE SUBMITTED TO CITY ENGINEERING FOR APPROVAL IF PRECAST STRUCTURES ARE PREFERRED. CONTACT LAUREN STRIEGL OF CITY ENGINEERING AT (608) 266-4094. LSTRIEGL@CITYOFMADISON.COM. FOR PRECAST APPROVALS. OR FAX SHOP DRAWINGS TO (608) 264-9275.
 - INLETS LOCATED IN TYPE "H" CURB SHALL BE INSTALLED PER S.D.D. 5.7.27

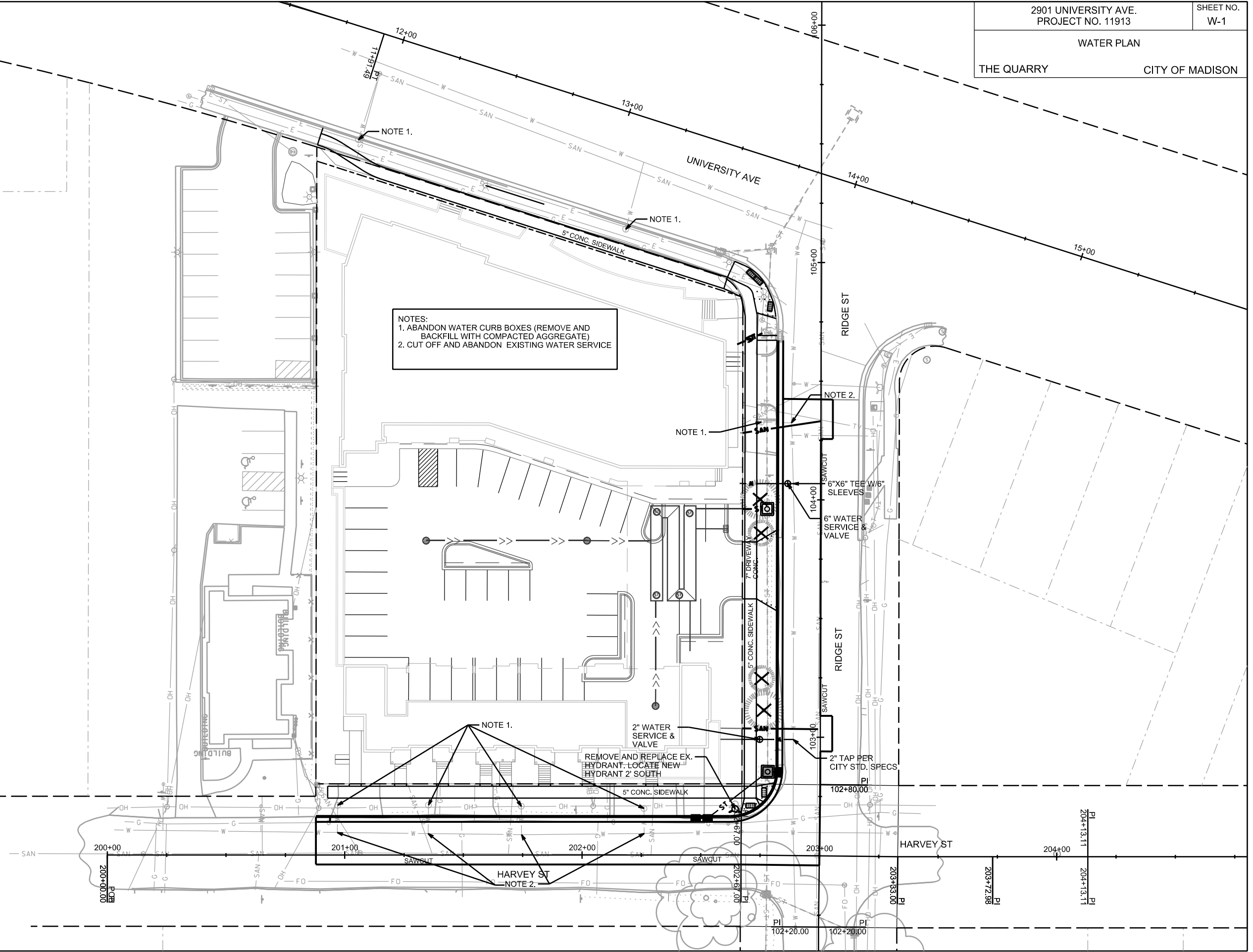

PLOT SCALE: _____

PLOT NAME: _____

REV. DATE: _____

ORIGINATOR: CITY OF MADISON, STREETS DIVISION

NOTES:

1. CONTRACTOR SHALL CONTACT CITY FORESTRY BRAD HOFMANN BHOFFMANN@CITYOFMADISON.COM OR 262-4816 AT LEAST ONE WEEK PRIOR TO PLANTING TO SCHEDULE INSPECTING THE NURSERY STOCK AND REVIEW PLANTING SPECIFICATIONS WITH THE LANDSCAPER.
2. WATER VALVE TO BE ABANDONED
3. CONTRACTOR TO CORDINATE WITH CITY FORESTRY BRAD HOFFMAN AND CONSTRUCTION STAFF TO VERIFY THAT THE TREE'S ROOTBALL WILL SURVIVE WITHOUT DAMAGING THE EXISTING 30" STORM PIPE. (NEW HORIZON ELM TREE TO BE CONSIDERED).

TREE KEY:

- (ABST) = AUTUMN BRILL SERVICEBERRY
- (GGCT) = GOLDEN GLORY CORN CHERRY
- (PSG) = PRINCETON SENTRY GINKGO
- (SKH) = STREET KEEPER HONEYLOCUST
- (SHL) = SKYLINE THNLS HONEYLOCUST
- (RJC) = RED JEWEL CRABAPPLE
- (ASL) = AMER SENTRY LINDEN
- (X) = TREE REMOVAL

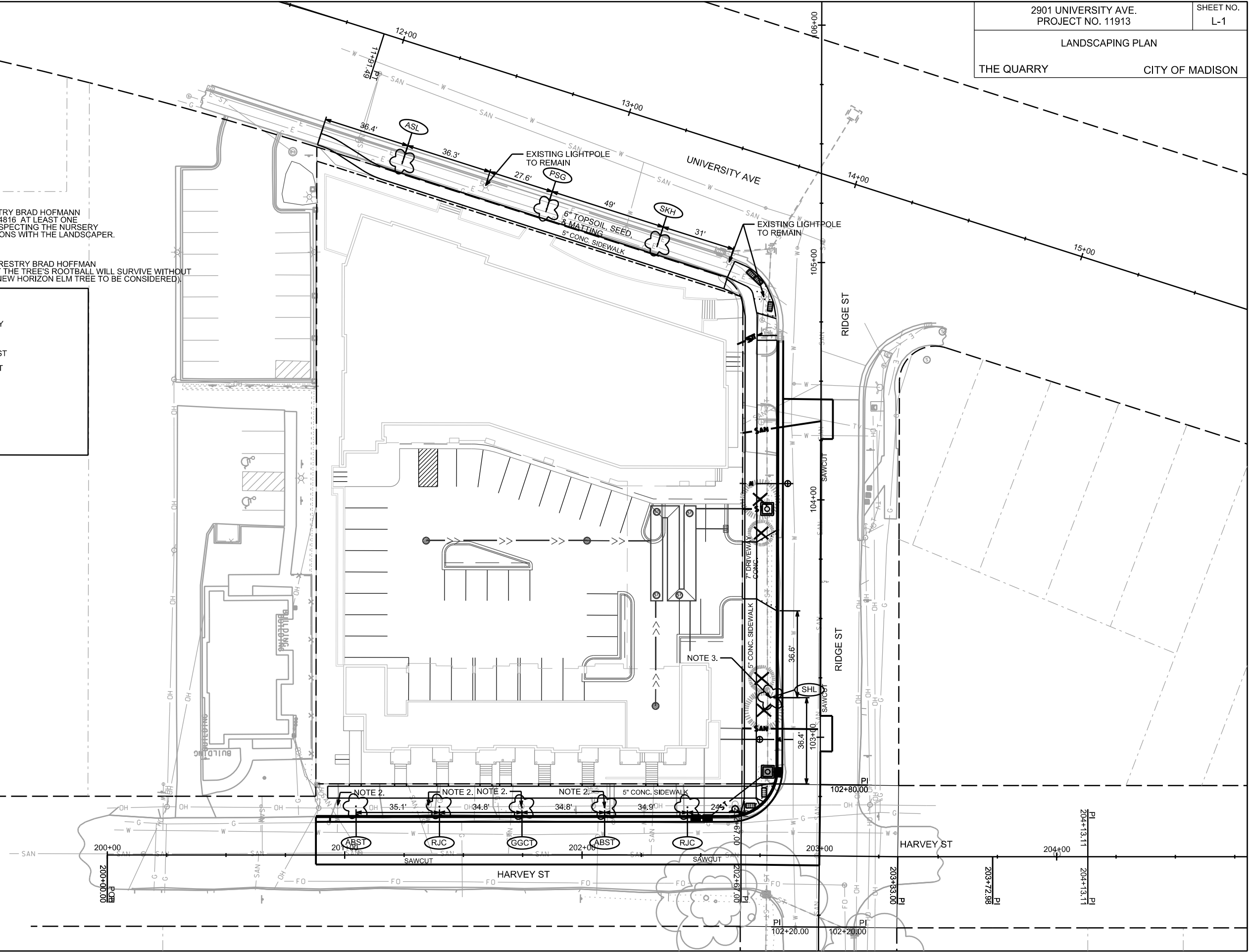

PLOT SCALE: _____

PLOT NAME: _____

REV. DATE: _____

ORIGINATOR: CITY OF MADISON, STREETS DIVISION

CROSS SECTIONS

HARVEY ST

CITY OF MADISON

PLOT SCALE: _____

PLOT NAME: _____

REV. DATE: _____

ORIGINATOR: CITY OF MADISON - STREETS DIVISION

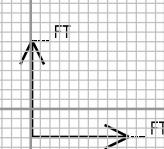
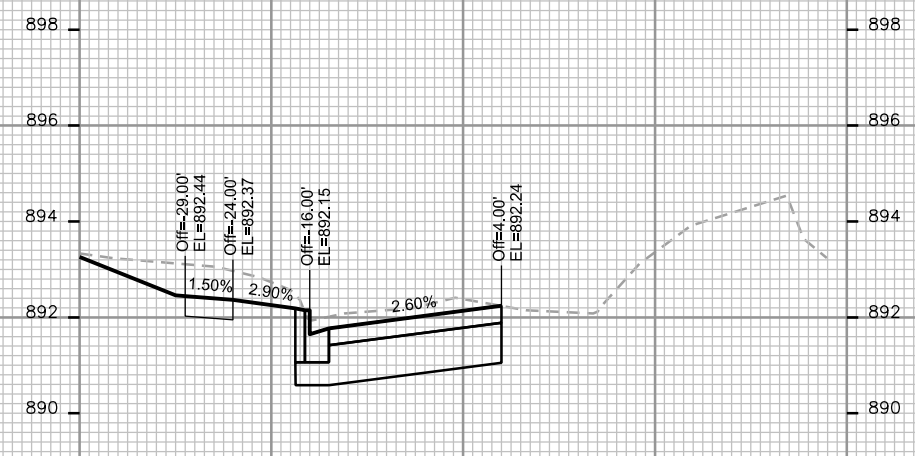
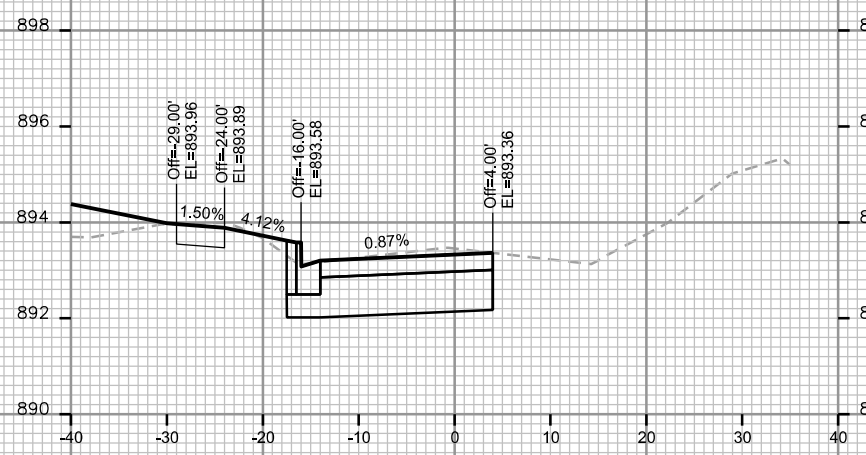
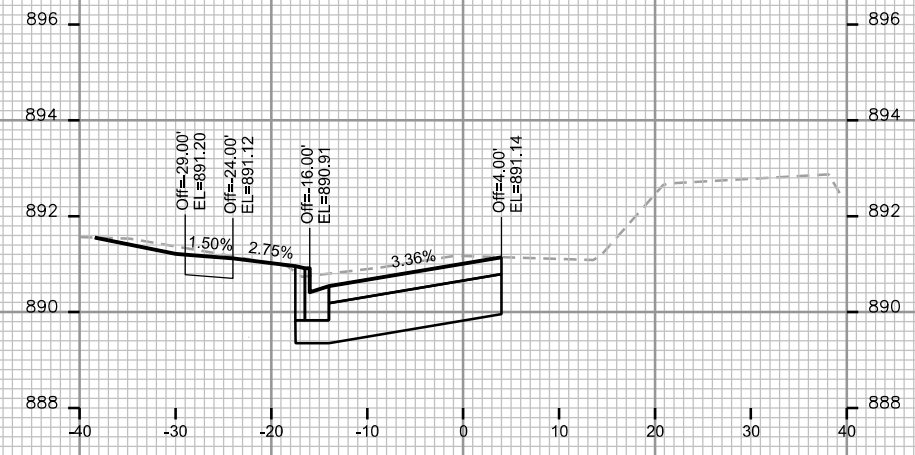
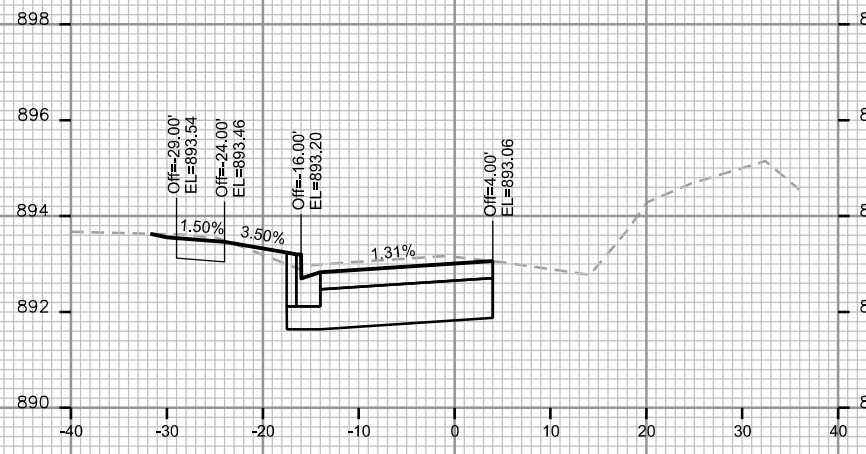
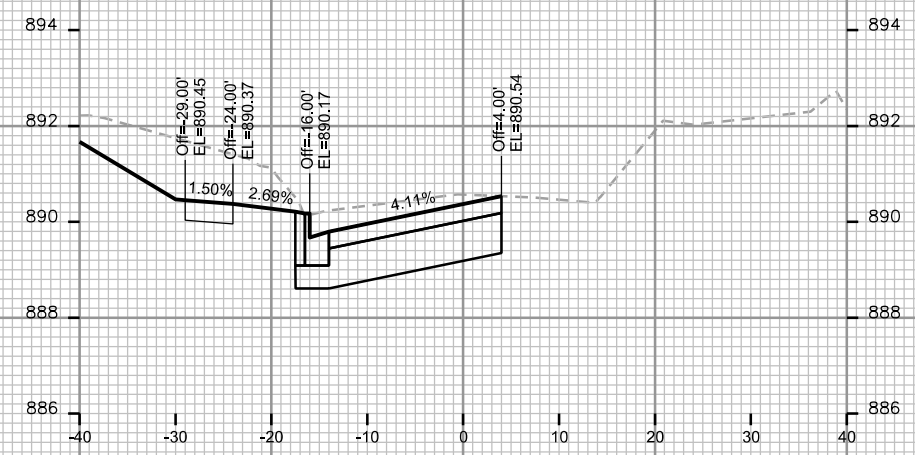
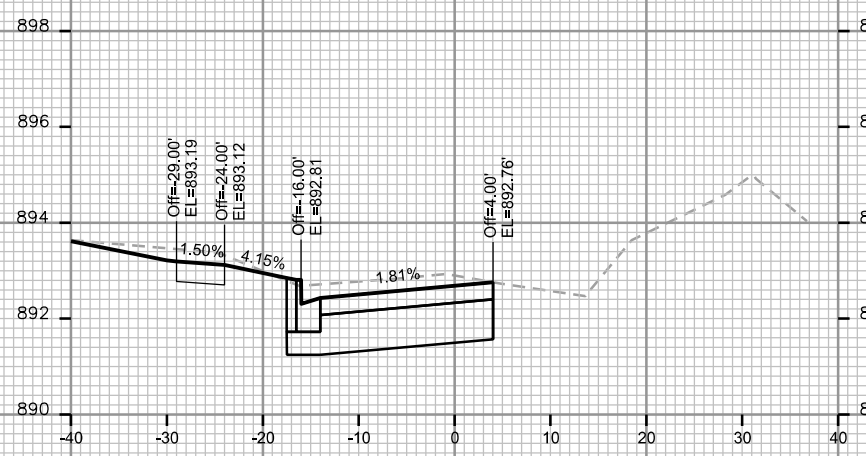

CROSS SECTIONS

HARVEY ST

CITY OF MADISON

PLOT SCALE: _____

PLOT NAME: _____

REV. DATE: _____

ORIGINATOR: CITY OF MADISON - STREETS DIVISION

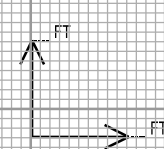
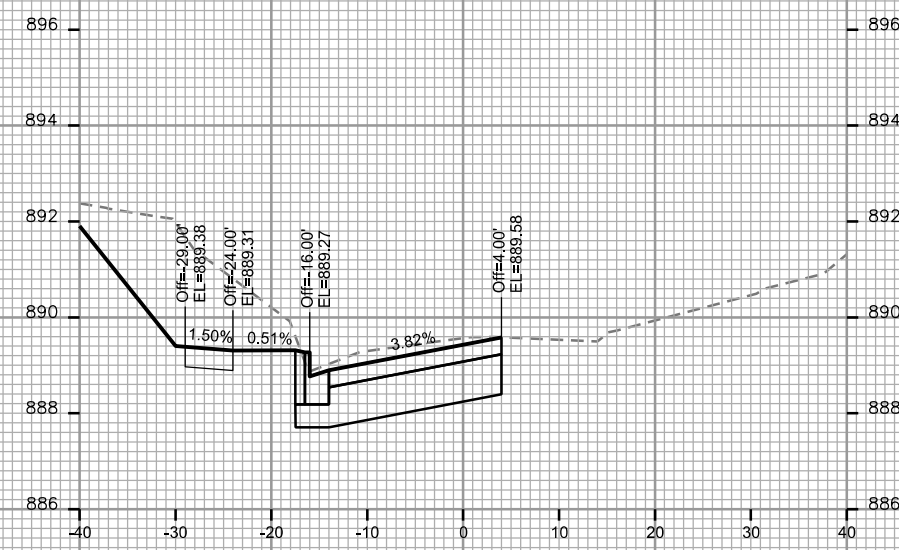
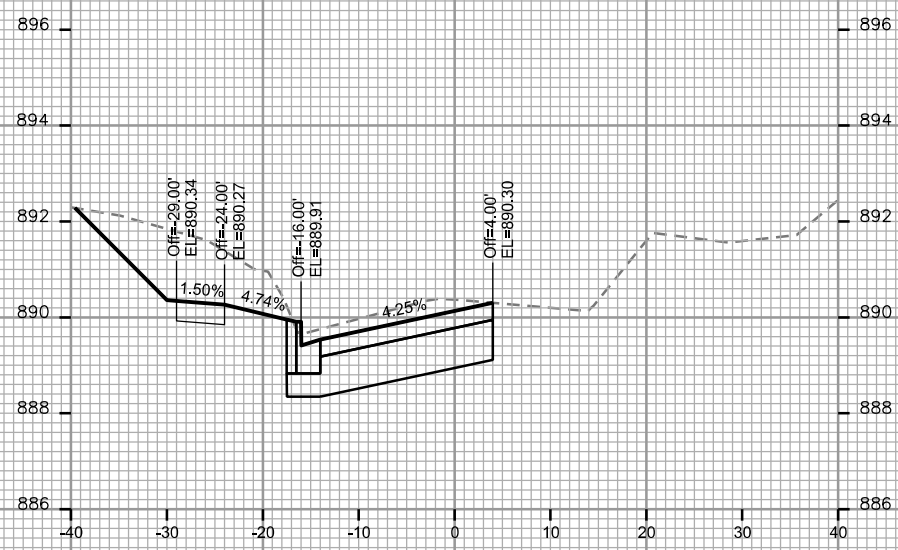
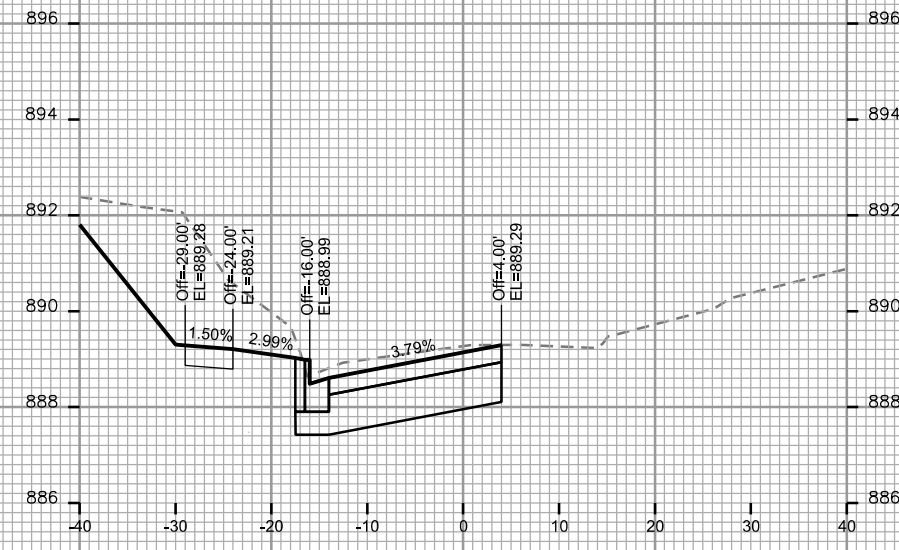
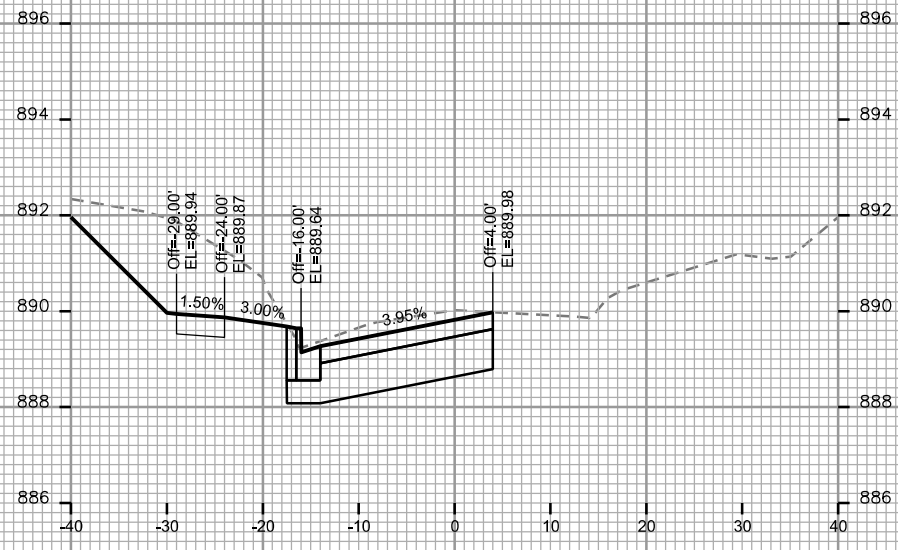

CROSS SECTIONS

HARVEY ST

CITY OF MADISON

PLOT SCALE: _____

PLOT NAME: _____

REV. DATE: _____

ORIGINATOR: CITY OF MADISON, STREETS DIVISION

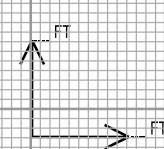
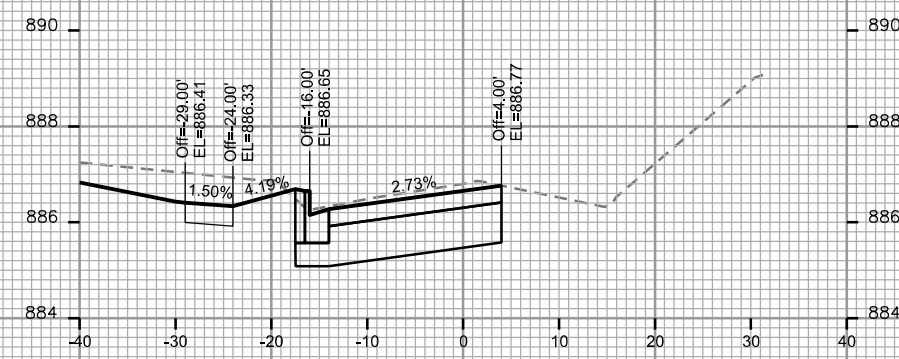
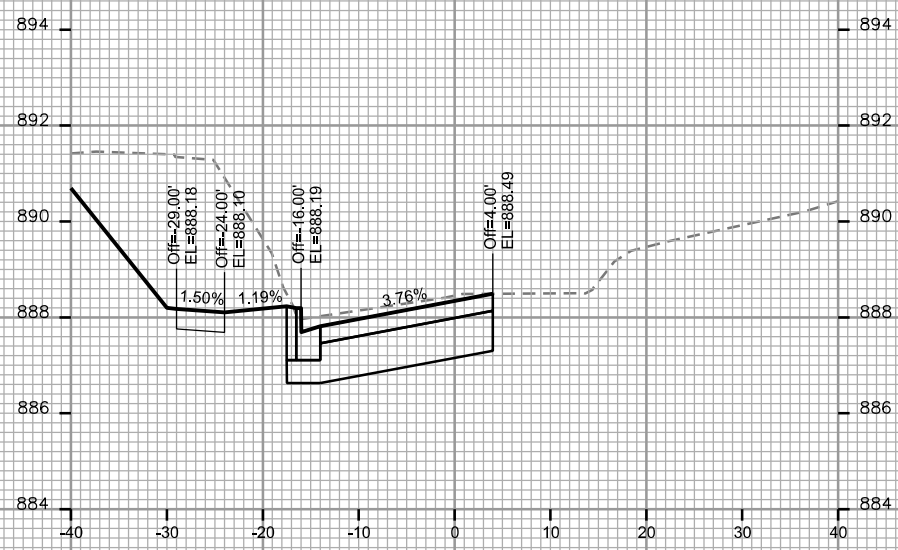
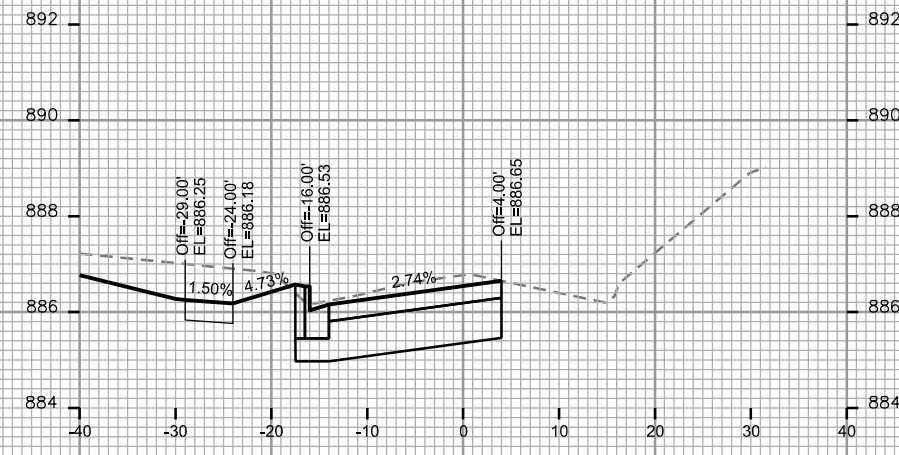
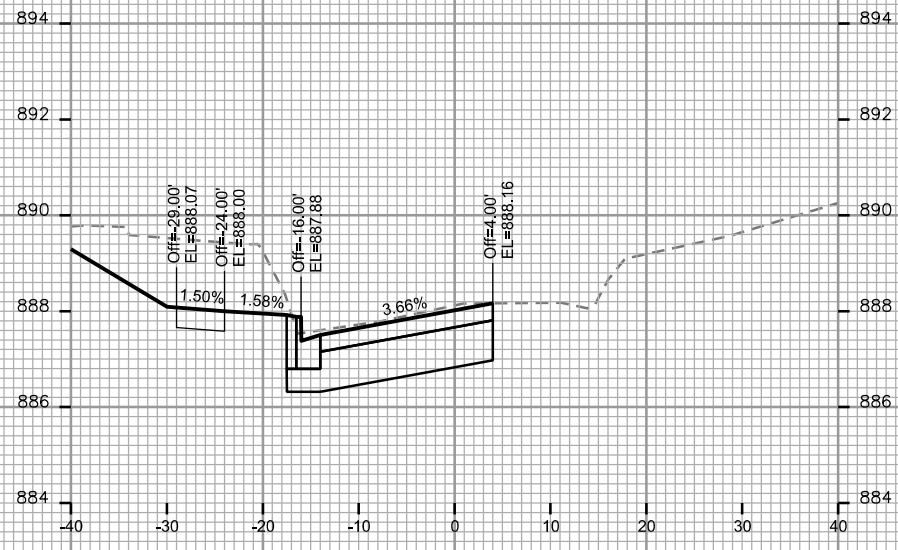

CROSS SECTIONS

HARVEY ST

CITY OF MADISON

PLOT SCALE: _____

PLOT NAME: _____

REV. DATE: _____

ORIGINATOR: CITY OF MADISON, STREETS DIVISION

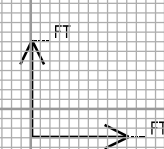
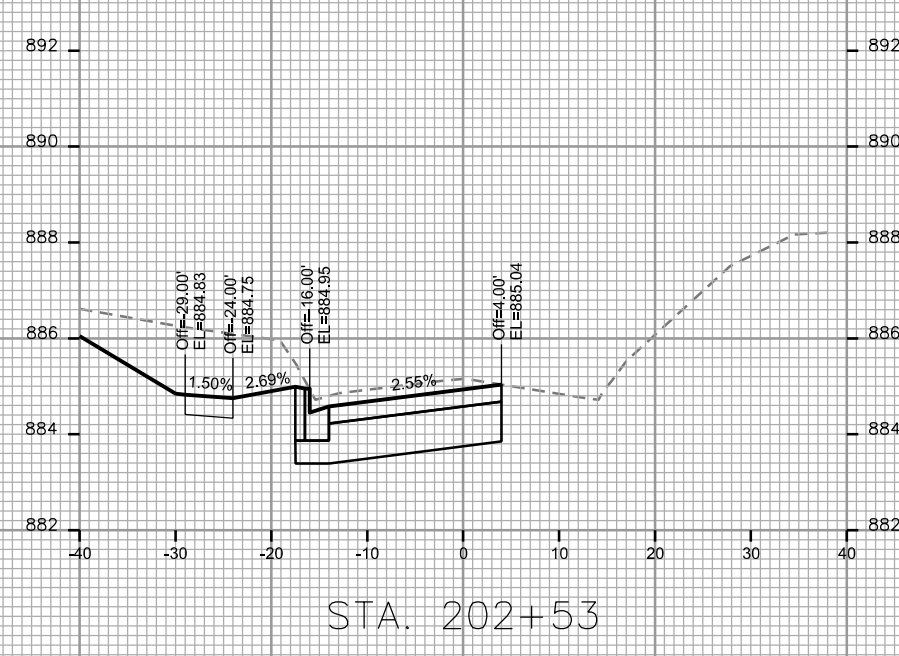
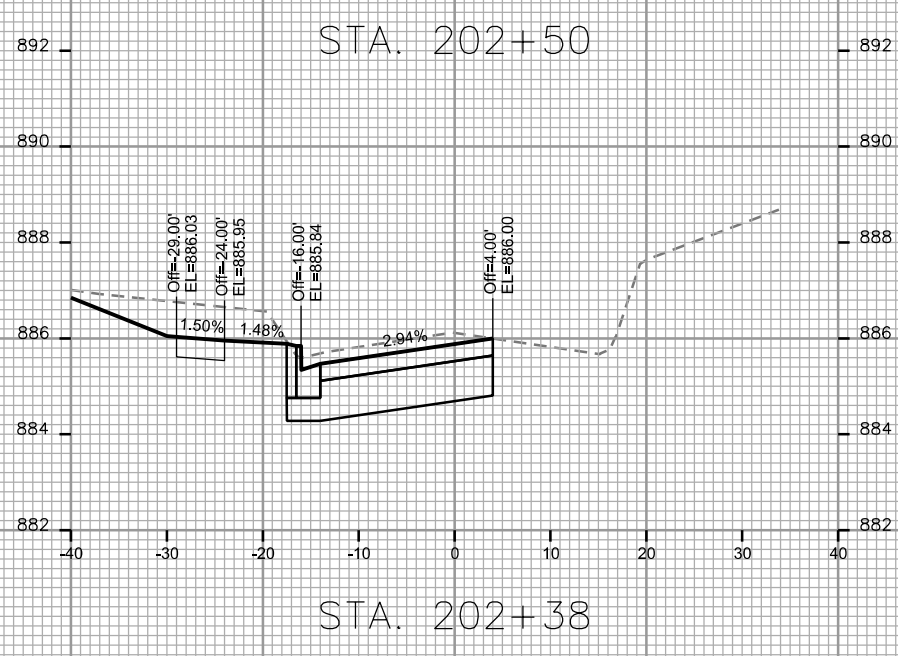
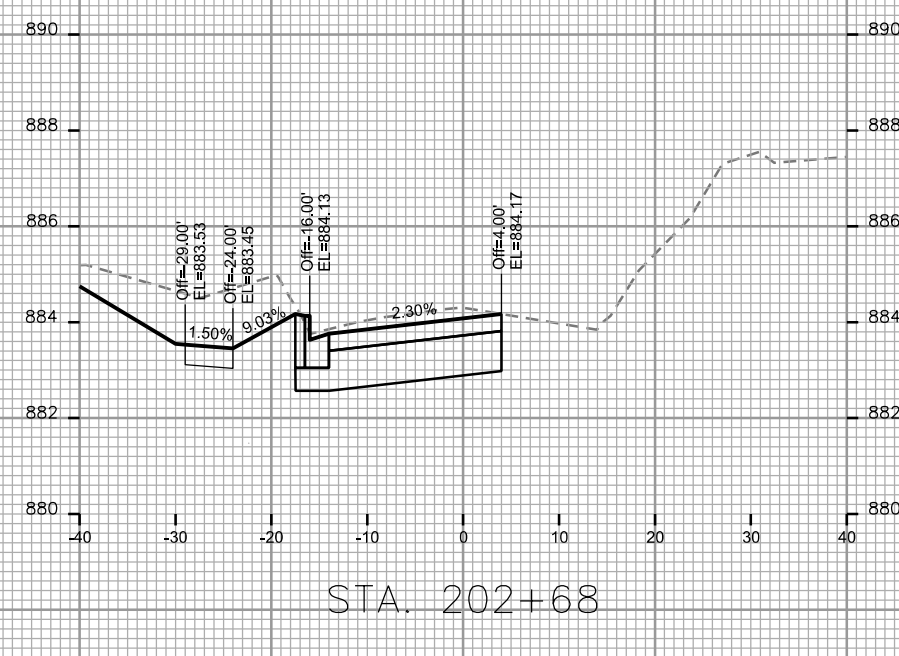
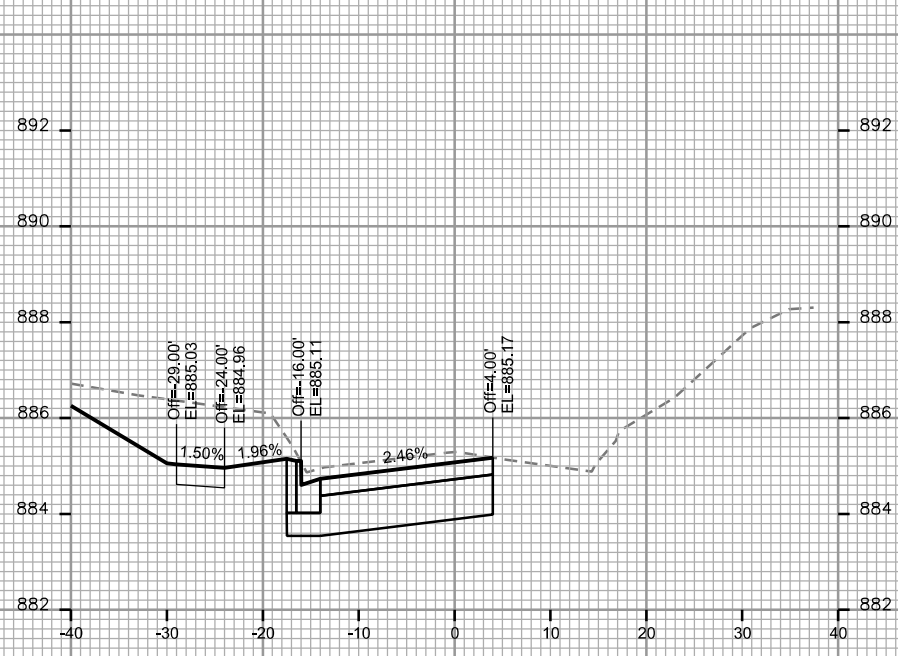

CROSS SECTIONS

RIDGE ST

CITY OF MADISON

PLOT SCALE: _____

PLOT NAME: _____

REV. DATE: _____

ORIGINATOR: CITY OF MADISON, STREETS DIVISION

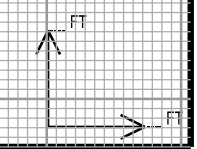
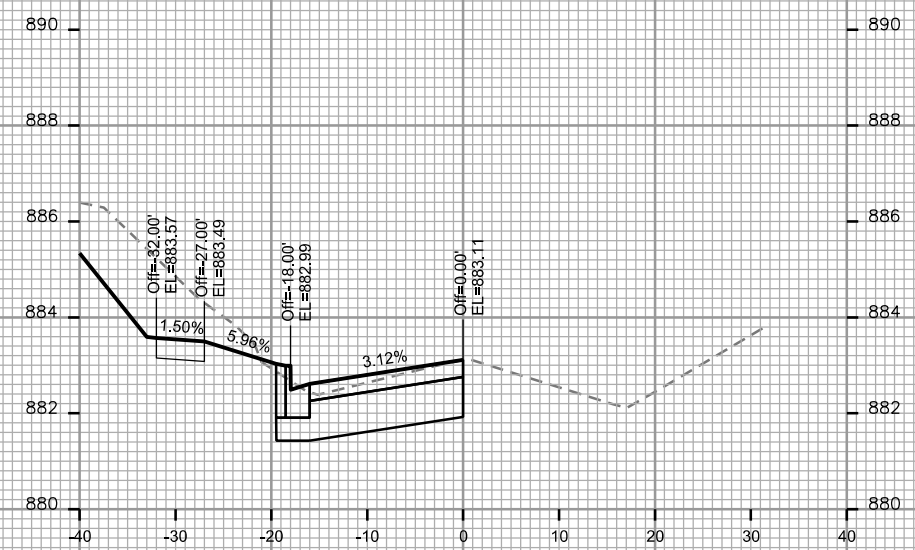
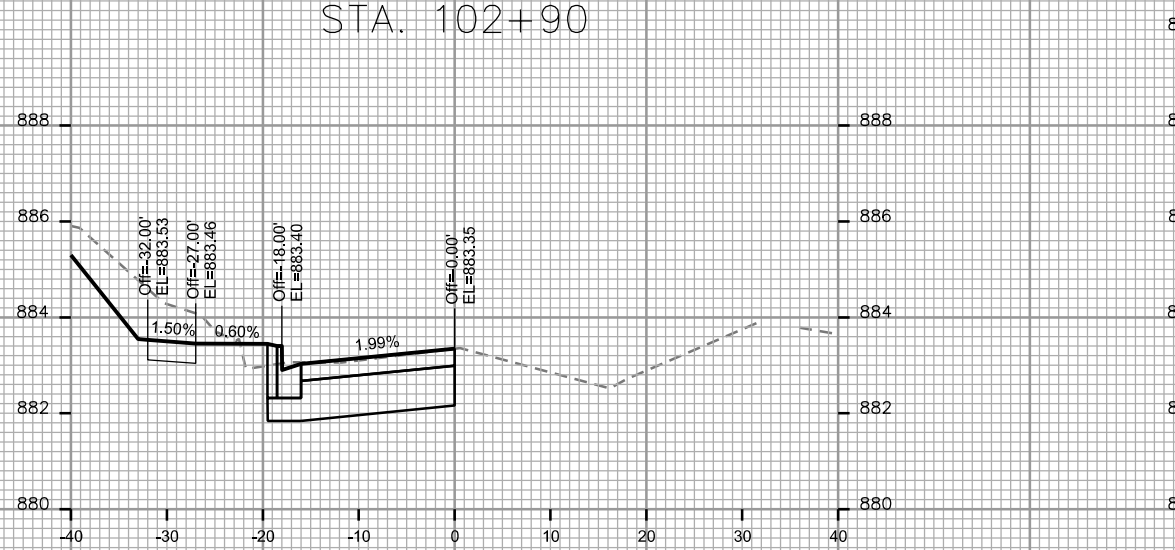
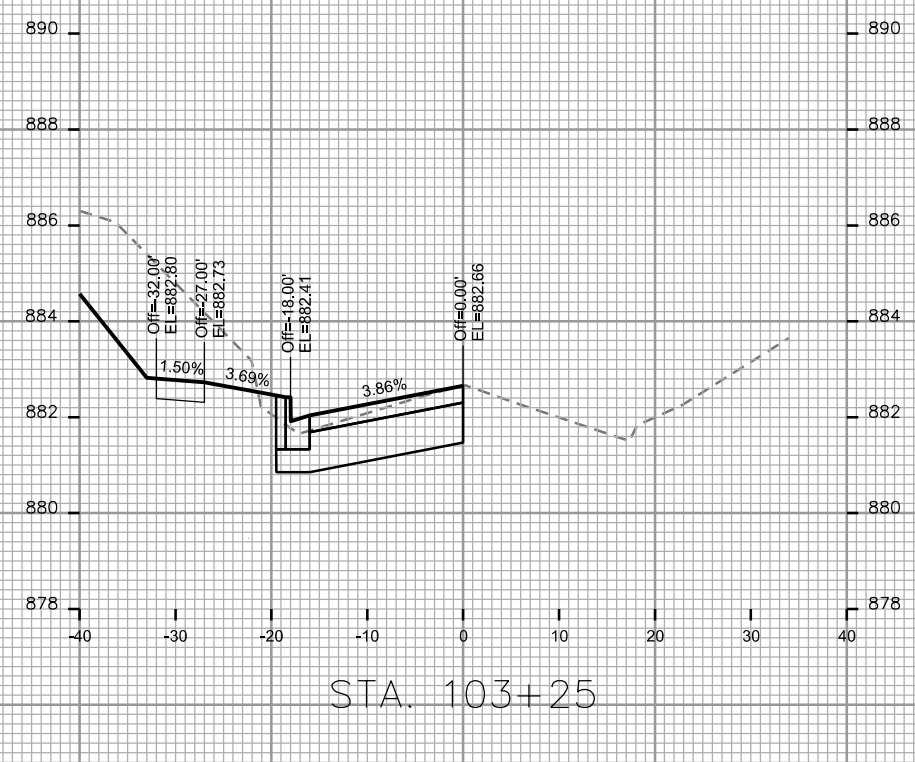
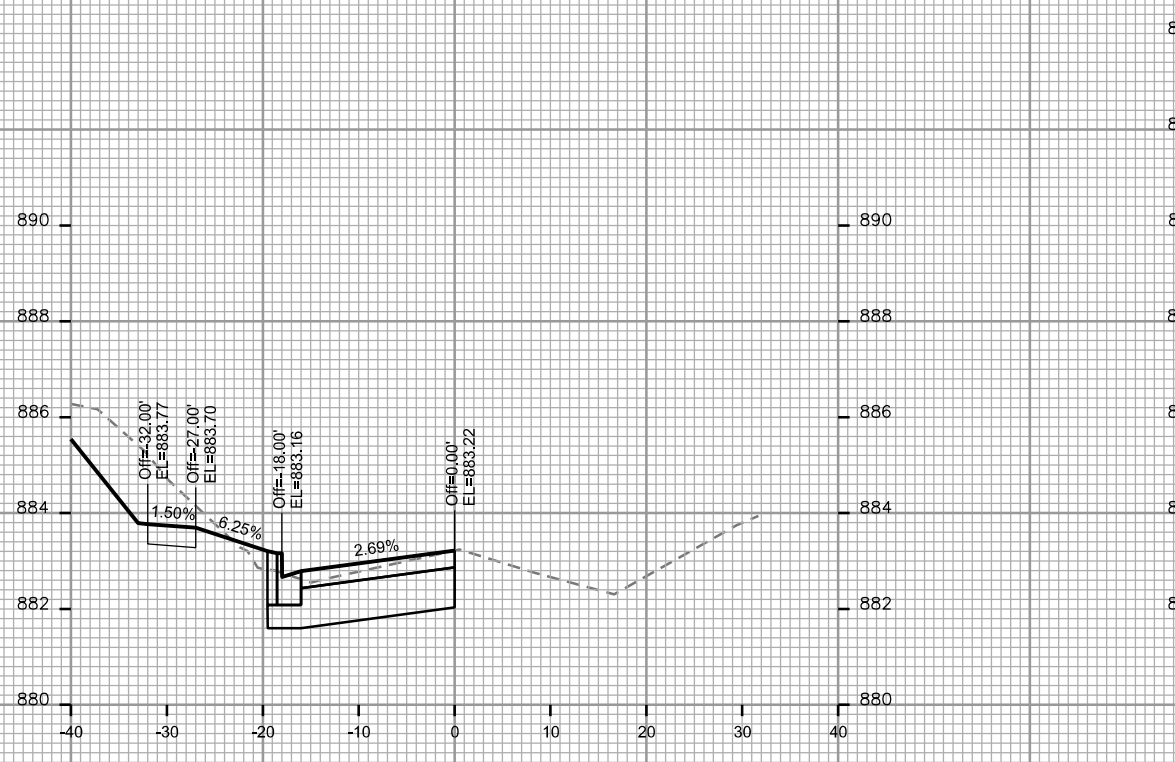

CROSS SECTIONS

RIDGE ST

CITY OF MADISON

PLOT SCALE: _____

PLOT NAME: _____

REV. DATE: _____

ORIGINATOR: CITY OF MADISON - STREETS DIVISION

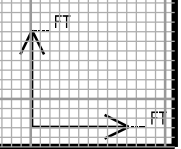
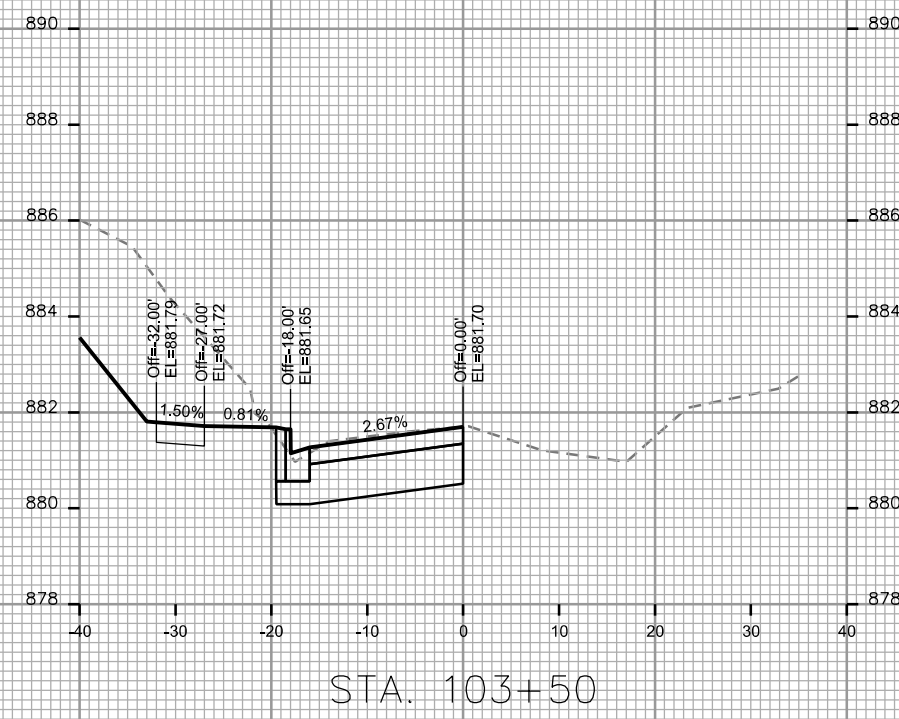
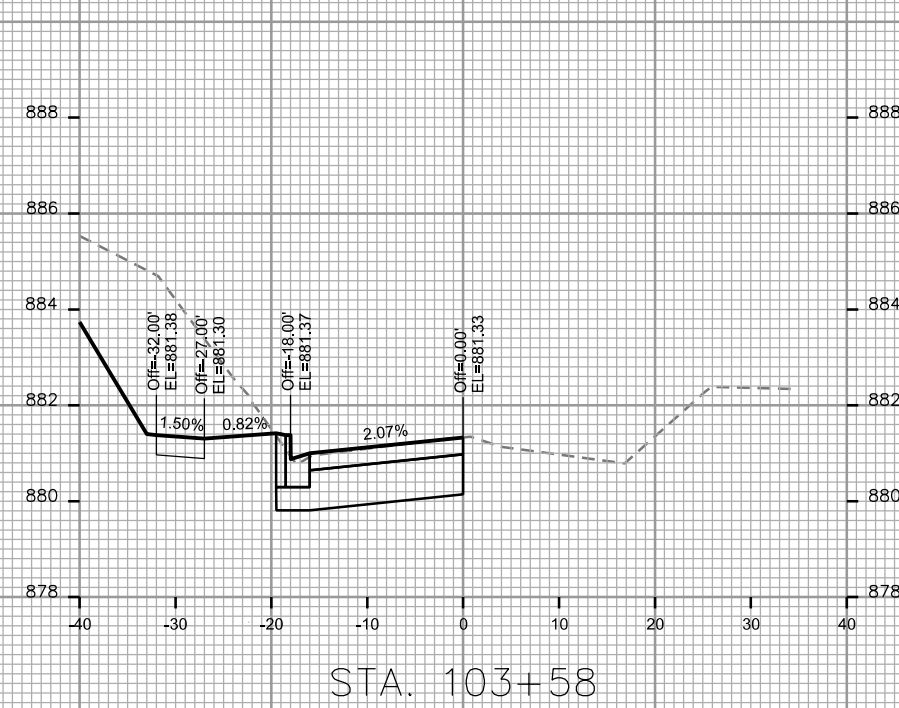
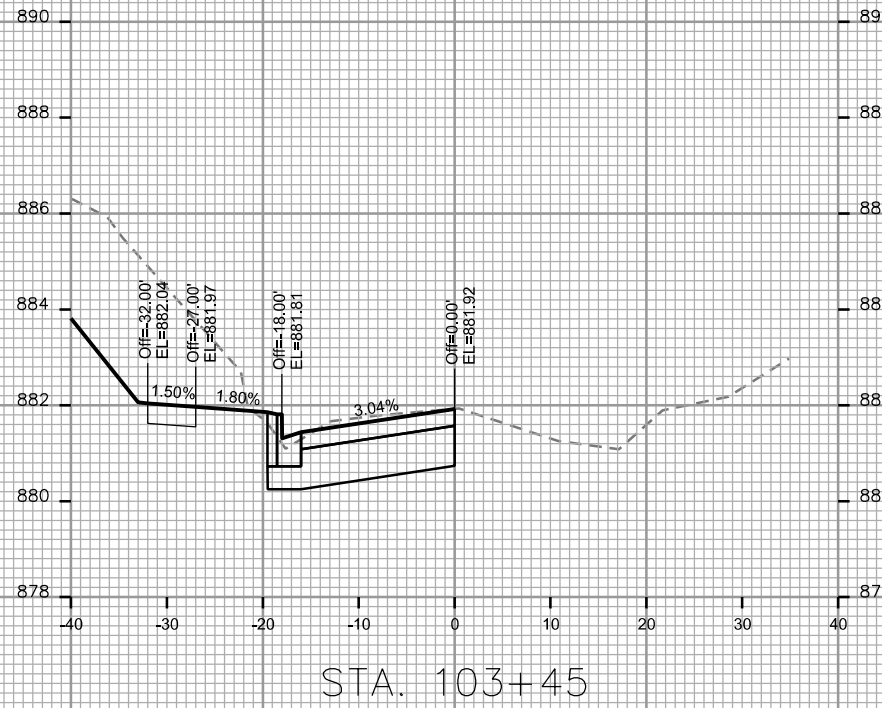

CROSS SECTIONS

RIDGE ST

CITY OF MADISON

PLOT SCALE: _____

PLOT NAME: _____

REV. DATE: _____

ORIGINATOR: CITY OF MADISON - STREETS DIVISION

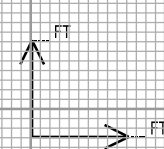
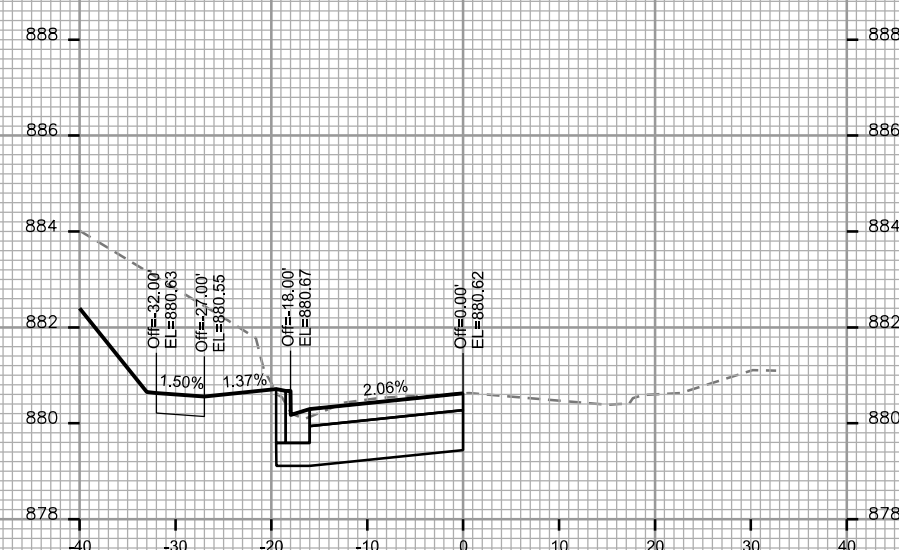
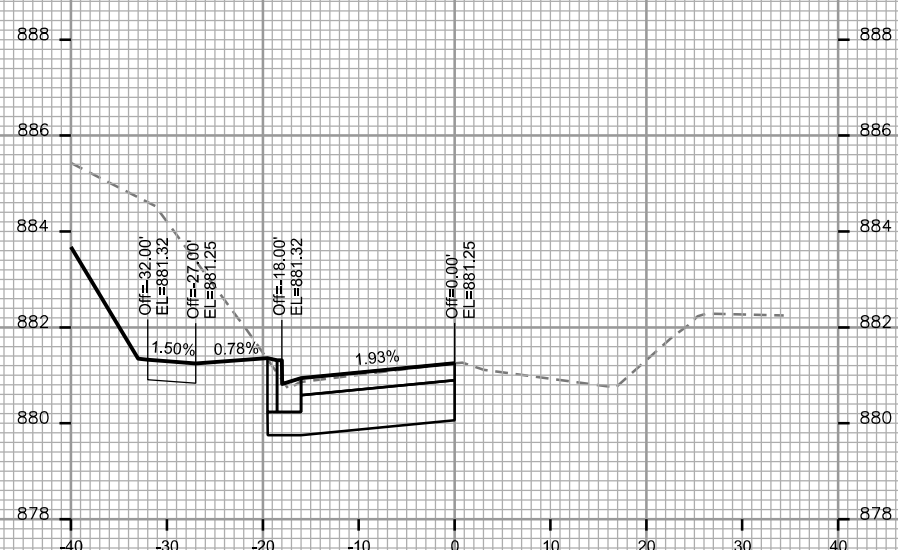
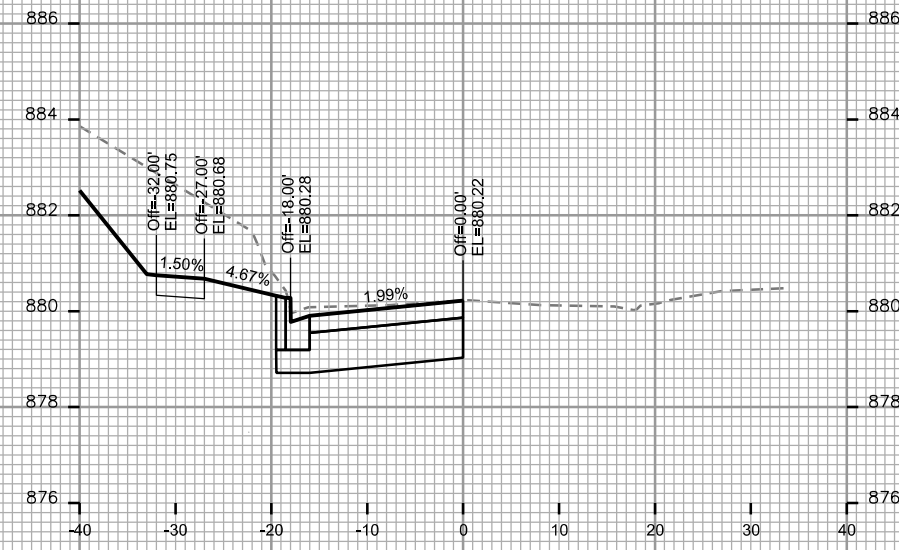
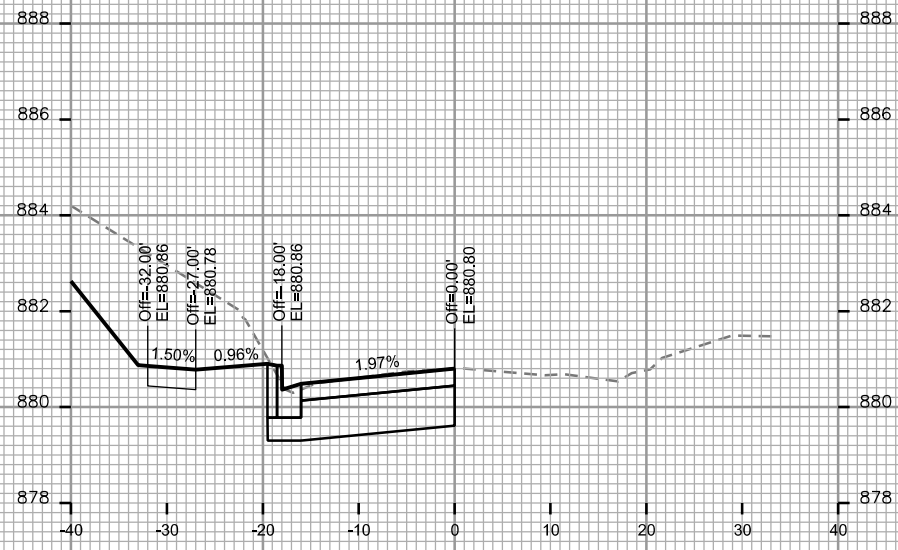

CROSS SECTIONS

RIDGE ST

CITY OF MADISON

PLOT SCALE: _____

PLOT NAME: _____

REV. DATE: _____

ORIGINATOR: CITY OF MADISON STREETS DIVISION

