

Madison, Wisconsin

CITY OF MADISON

CITY ENGINEERING DIVISION DEPARTMENT OF PUBLIC WORKS

PLAN OF PROPOSED IMPROVEMENT

601 WEST DAYTON STREET – UW HOCKEY/SWIM

CITY PROJECT NO. 53B2269
CONTRACT NO. 2269

PUBLIC IMPROVEMENT PROJECT APPROVED
FEBRUARY 22, 2011

BY THE COMMON COUNCIL
OF MADISON, WISCONSIN

PUBLIC IMPROVEMENT DESIGN
APPROVED BY:

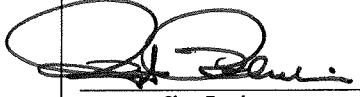
 5/31/11
City Engineer Date

STREET
DESIGNED BY:

SEE EACH
SHEET

INDEX OF SHEETS (CITY NOS.)

SHEET NO. 1	TITLE
SHEET NO. D1	NOTES
SHEET NO. D2	DETAILS
SHEET NO. P1-P2	STREET PLANS
SHEET NO. P3-P4	EAST CAMPUS PAVING PLANS

CONVENTIONAL SIGNS

FIELD VERIFY ALL UTILITY LOCATIONS

GAS — G —

STORM SEWER — ST —

SANITARY SEWER — SAN —

WATER — W —

OVERHEAD ELECTRIC — OH —

POWER POLE 

ADA COMPLIANT RAMP W/
DETECTABLE WARNING FIELD 

COMBUSTIBLE FLUIDS 

NOTES:

ALL GUTTERS SHALL DRAIN WITH A MINIMUM GRADE OF 0.50% TOWARD STORM SEWER INLETS.

SIDEWALK RAMPS AND CURB THRU SIDEWALK RAMPS SHALL HAVE A MAXIMUM SLOPE OF 1" PER 12". SIDEWALK AND CURB RAMPS SHALL BE CONSTRUCTED WITH A SIDE SLOPE OF 2.00%. SIDEWALK SHALL HAVE A MINIMUM LONGITUDINAL SLOPE OF 0.50% AND A MAXIMUM LONGITUDINAL SLOPE OF 5.00% EXCEPT WHERE STREET GRADES EXCEED 5.00%.

STREETS ONLY

PROJECT LOCATION

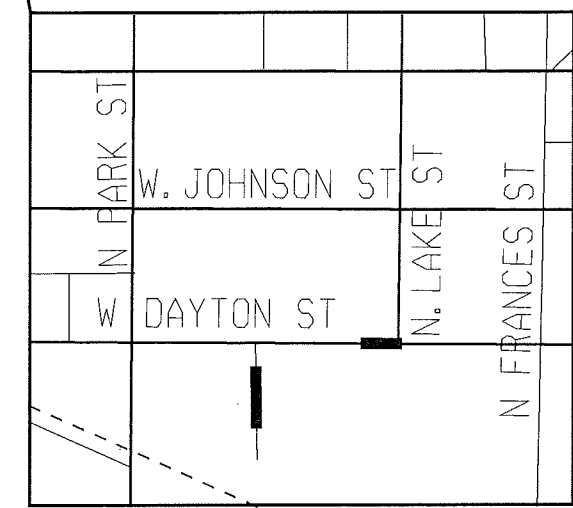
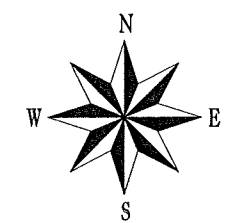
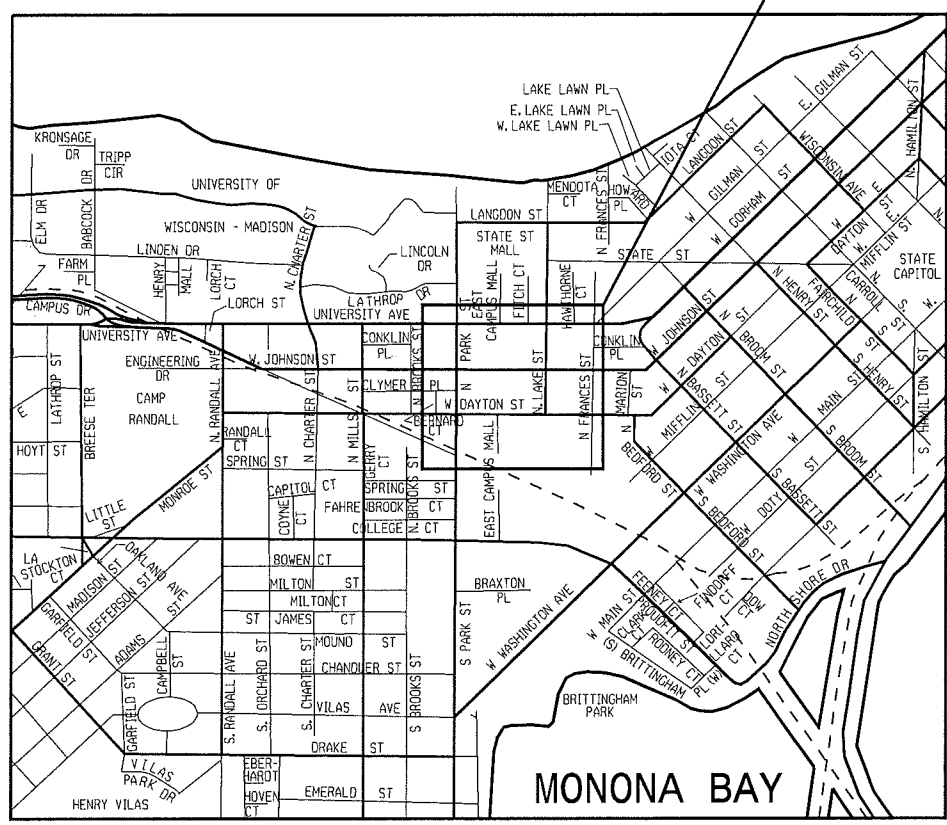

MONONA BAY

THE LOCATION AND INFORMATION FOR PROPOSED NEW TREES, IN THE PUBLIC RIGHT OF WAY OR ON PUBLIC LANDS ARE APPROXIMATE AND ARE SHOWN FOR REFERENCE ONLY. THE LOCATIONS, SPECIFICATIONS AND PLANTING METHODS OF ALL PROPOSED NEW OR REPLACEMENT TREES IN THE PUBLIC RIGHT OF WAY OR ON PUBLIC LANDS SHALL BE APPROVED BY THE CITY FORESTER PRIOR TO INSTALLATION.

NO TREES IN THE RIGHT OF WAY OR ON PUBLIC LANDS SHALL BE TRIMMED, PRUNED, REMOVED OR ADVERSELY AFFECTED IN ANY WAY UNTIL THE DEVELOPER HAS RECEIVED WRITTEN PERMISSION FROM THE CITY ENGINEER OR CITY FORESTER. SAID WRITTEN PERMISSION SHALL INCLUDE LANGUAGE INDICATING THAT SECTION 10.101 OF THE MADISON GENERAL ORDINANCES AND ADMINISTRATIVE PROCEDURE MEMORANDUM NO. 6-2, REFERRING TO NOTIFICATION OF PROPERTY OCCUPANTS AND/OR OWNERS, HAS BEEN COMPLIED WITH.

ANY PORTIONS OF THE CONCRETE RETAINING WALLS THAT ARE ADJACENT TO THE BIKE PATH UNDERPASS THAT ARE REMOVED SHALL BE REPLACED IN KIND. THE WALLS SHALL BE RESTORED SUCH THAT THEY MEET ALL CODE REQUIREMENTS FOR A GUARD RAIL, INCLUDING HEIGHT (42"). THE HEIGHT REQUIREMENT MAY BE MET BY EITHER RESTORING THE CONCRETE WALL TO THE PROPER HEIGHT OR BY EXTENDING THE GUARD RAIL BY ATTACHING AN ACCEPTABLE TYPE OF RAILING TO THE TOP OF THE WALL. THE DEVELOPER SHALL SUBMIT THEIR DESIRED MEANS TO THE CITY FOR APPROVAL PRIOR TO INSTALLATION. THE WALL RESTORATION SHALL BE DONE UNDER A STREET OCCUPANCY PERMIT

THE CONTRACTOR SHALL CONTACT CITY FORESTRY TO REVIEW THE TREES PRIOR TO ANY PRUNING OR REMOVALS. A TREE REMOVAL PERMIT SHALL BE ISSUED BY CITY FORESTRY PRIOR TO REMOVAL OF ANY CITY OWNED TREES. CONTACT DEAN KAHL AT 266-4891 TO OBTAIN THIS PERMIT. PRIOR TO CLOSURE OF THIS CONTRACT, CITY FORESTRY SHALL DO A FINAL INSPECTION OF THE TREES. DAMAGES TO TREES SHALL BE SUBJECT TO PROVISIONS IN SECTION 23.24 OF THE MADISON GENERAL ORDINANCE.

ALL PAVEMENT IN THE EAST CAMPUS MALL RIGHT OF WAY SHALL BE TYPE "B", AND ALL PAVEMENT IN THE DAYTON ST RIGHT OF WAY SHALL BE TYPE "C" PER STANDARD DETAIL DRAWING 4.02.

ALL ISLANDS SHALL HAVE TYPE "E" C & G PER S.D.D. 3.08 AND MOUNTABLE NOSES PER S.D.D. 3.13. ALL OTHER C & G SHALL BE TYPE "A" PER S.D.D. 3.06 UNLESS OTHERWISE NOTED.

ISLAND INTERIORS SHALL BE OF SOD WHERE THE BACK TO BACK OF CURB DIMENSION IS GREATER THAN 6'.

UNDERDRAINS SHALL BE INSTALLED, PER STANDARD DETAIL DRAWING 4.05 FOR 75' ON EACH SIDE OF THE LOW POINT, OR TO THE NEAREST CURB HIGH POINT. ALL UNDERDRAIN SHALL BE WRAPPED.

ALL GUTTERS SHALL DRAIN WITH A MINIMUM GRADES OF 0.5% TOWARD STORM SEWER INLETS.

PAVEMENT CROSS SLOPES SHALL BE 2%, TERRACES SHALL SLOPE AT A 4% GRADE TOWARD THE GUTTER, SHOULDERS SHALL HAVE A 4% CROSS SLOPE AND CROSS SLOPES FORMING DITCHES SHALL NOT EXCEED 4.00:1 UNLESS OTHERWISE INDICATED.

THE CROSS SLOPE OF SIDEWALKS AND BARRIER FREE SIDEWALK CURB RAMPS SHALL BE 2%. THE LONGITUDINAL GRADE OF BARRIER FREE SIDEWALK CURB RAMPS SHALL NOT EXCEED 8.33%. ALL SIDEWALK RAMPS SHALL BE CONSTRUCTED ACCORDING TO S.D.D. 3.03. AT ALL OTHER LOCATIONS THE LONGITUDINAL GRADE OF SIDEWALKS SHALL NOT EXCEED 5.0 % OR THE ADJACENT STREET GRADE WHICHEVER IS GREATER NOR BE LESS THAN 0.5% AND SHALL DRAIN TOWARD STORM SEWER INLETS. A 2 FOOT WIDE CONCRETE FLUME SHALL BE INSTALLED BETWEEN THE SIDEWALK AND THE BACK OF CURB AT SIDEWALK LOW POINTS WHICH CANNOT OTHERWISE BE DRAINED DIRECTLY TO THE GUTTER. SIDE SLOPES WITHIN TEN FEET OF A PUBLIC SIDEWALK SHALL NOT EXCEED 4.00:1. THE DESIGN OF SIDEWALK ELEVATIONS AND GRADES IS NOT INCLUDED IN THIS PLAN. ALL SIDEWALK AND SIDEWALK RAMP ELEVATIONS AND GRADES SHALL BE FIELD VERIFIED AND SET TO COMPLY WITH THE CITY OF MADISON STANDARD SPECIFICATIONS AND THE A.D.A. GUIDELINES.

OBTAIN A PRINT OUT OF THE ALIGNMENT FROM THE CITY ENGINEER PRIOR TO STAKING THIS PROJECT.

CURB STATION AND OFFSETS SHALL BE TO THE FACE OF CURB UNLESS OTHERWISE INDICATED. CURB ELEVATIONS SHALL BE TO THE TOP OF CURB (OR EXTENDED TOP OF CURB FOR DRIVEWAYS OR RAMPS) UNLESS OTHERWISE INDICATED.

POWER POLES AND OTHER OBSTRUCTIONS SHALL BE MOVED TO PROVIDE 2 FEET MINIMUM OF CLEAR DISTANCE FROM ANY FACE OF CURB OR EDGE OF SIDEWALK.

ANY INFORMATION SHOWN ON THIS PLAN, WHICH IS NOT PART OF THIS PROJECT, IS PRELIMINARY AND NOT FOR CONSTRUCTION.

THERE MAY BE EXISTING UTILITIES OR OTHER FEATURES WHICH ARE EITHER NOT SHOWN OR SHOWN INCORRECTLY ON THIS PLAN. IT IS THE RESPONSIBILITY OF THE DEVELOPER TO LOCATE AND IDENTIFY ALL UTILITIES AND TOPOGRAPHY WHICH MAY AFFECT THE CONSTRUCTION OF THESE IMPROVEMENTS.

ALL PERMANENT SIGNING AND POSTING WILL BE DETERMINED AND PROVIDED BY THE TRAFFIC ENGINEERING DIVISION, FOLLOWING CONSTRUCTION OF THESE IMPROVEMENTS.

THE DEVELOPER SHALL PROVIDE, INSTALL AND MAINTAIN ALL STREET END BARRICADES, SIGNING AND TRAFFIC CONTROL, AS REQUIRED BY THE CITY TRAFFIC ENGINEER.

PAVEMENT SAWCUTS SHALL BE AS DIRECTED BY THE CITY CONSTRUCTION ENGINEER. SAWCUTS SHOWN ON THE PLAN ARE APPROXIMATE.

CURB ON CUL DE SACS SHALL BE INSTALLED ACCORDING TO SDD 3.05.

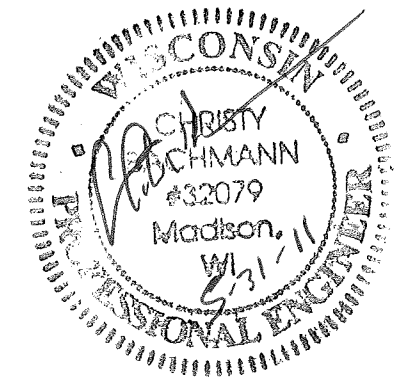

PLOT SCALE:

PLOT NAME:

REV. DATE:

ORIGINATOR: CITY OF MADISON, STREETS DIVISION



*OPEN
5-25-2011*

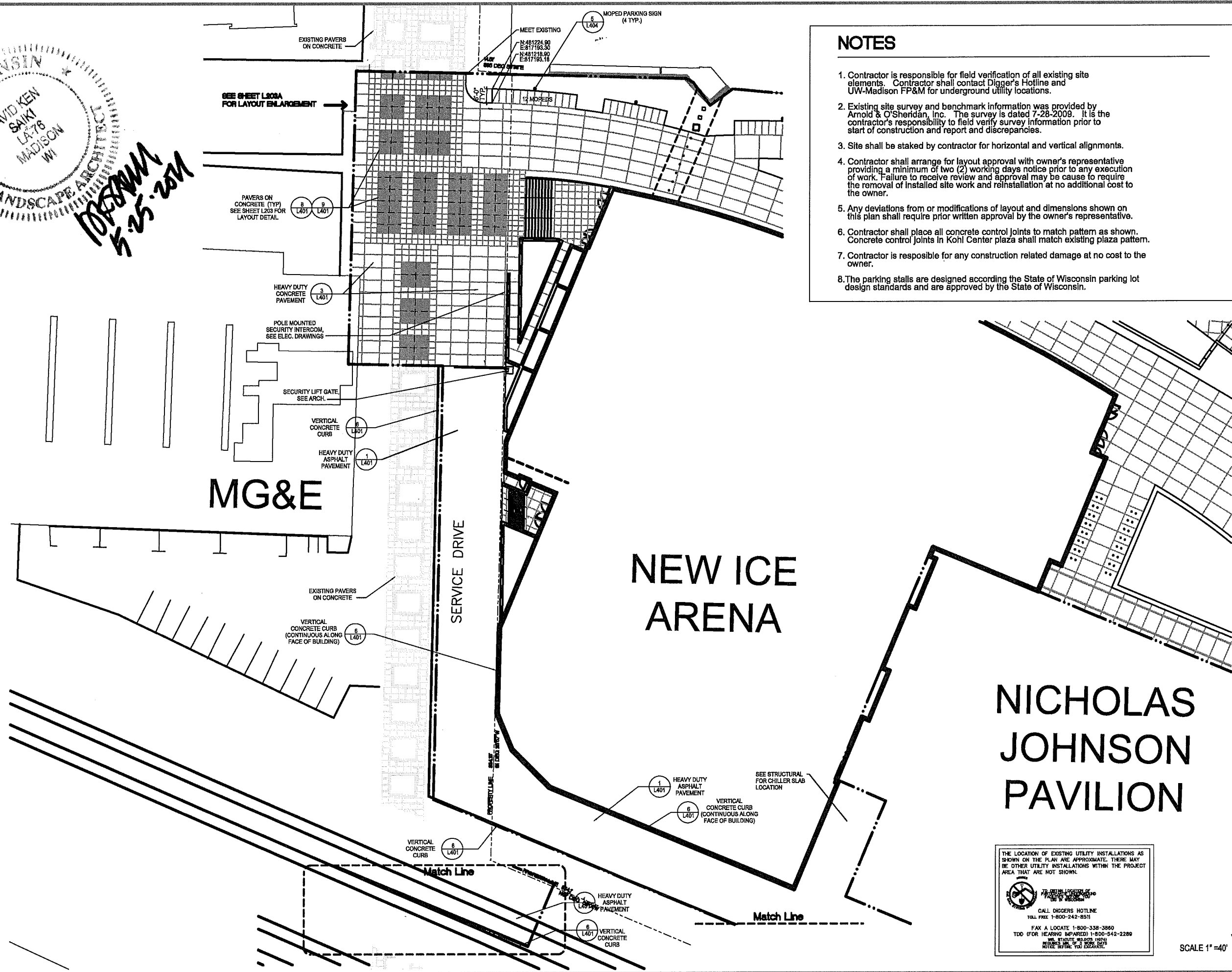

NOTES

1. Contractor is responsible for field verification of all existing site elements. Contractor shall contact Digger's Hotline and UW-Madison FP&M for underground utility locations.
2. Existing site survey and benchmark information was provided by Arnold & O'Sheridan, Inc. The survey is dated 7-28-2009. It is the contractor's responsibility to field verify survey information prior to start of construction and report any discrepancies.
3. Site shall be staked by contractor for horizontal and vertical alignments.
4. Contractor shall arrange for layout approval with owner's representative providing a minimum of two (2) working days notice prior to any execution of work. Failure to receive review and approval may be cause to require the removal of installed site work and reinstallation at no additional cost to the owner.
5. Any deviations from or modifications of layout and dimensions shown on this plan shall require prior written approval by the owner's representative.
6. Contractor shall place all concrete control joints to match pattern as shown. Concrete control joints in Kohl Center plaza shall match existing plaza pattern.
7. Contractor is responsible for any construction related damage at no cost to the owner.
8. The parking stalls are designed according to the State of Wisconsin parking lot design standards and are approved by the State of Wisconsin.

THE LOCATION OF EXISTING UTILITY INSTALLATIONS AS SHOWN ON THE PLAN ARE APPROXIMATE. THERE MAY BE OTHER UTILITY INSTALLATIONS WITHIN THE PROJECT AREA THAT ARE NOT SHOWN.

CALL DIGGERS HOTLINE
TOLL FREE 1-800-242-8511
FAX A LOCATE 1-800-338-3860
TDD (FOR HEARING IMPAIRED) 1-800-542-2289
NEEDS: WIS. STATUTE 90.0275 (10/01)
EXCAVATE: WIS. STATUTE 90.0275 (10/01)
NOTICE BEFORE YOU EXCAVATE.

SCALE 1"=40'



Revisions:

No.	Date	Description

Graphic Scale	
DSF Number	0681U
Issued With	City Submittal
Date Issued	05/23/11
Sheet Number	L201A



PLOT SCALE:

PLOT NAME:

REV. DATE:

ORIGINATOR: CITY OF MADISON, STREETS DIVISION

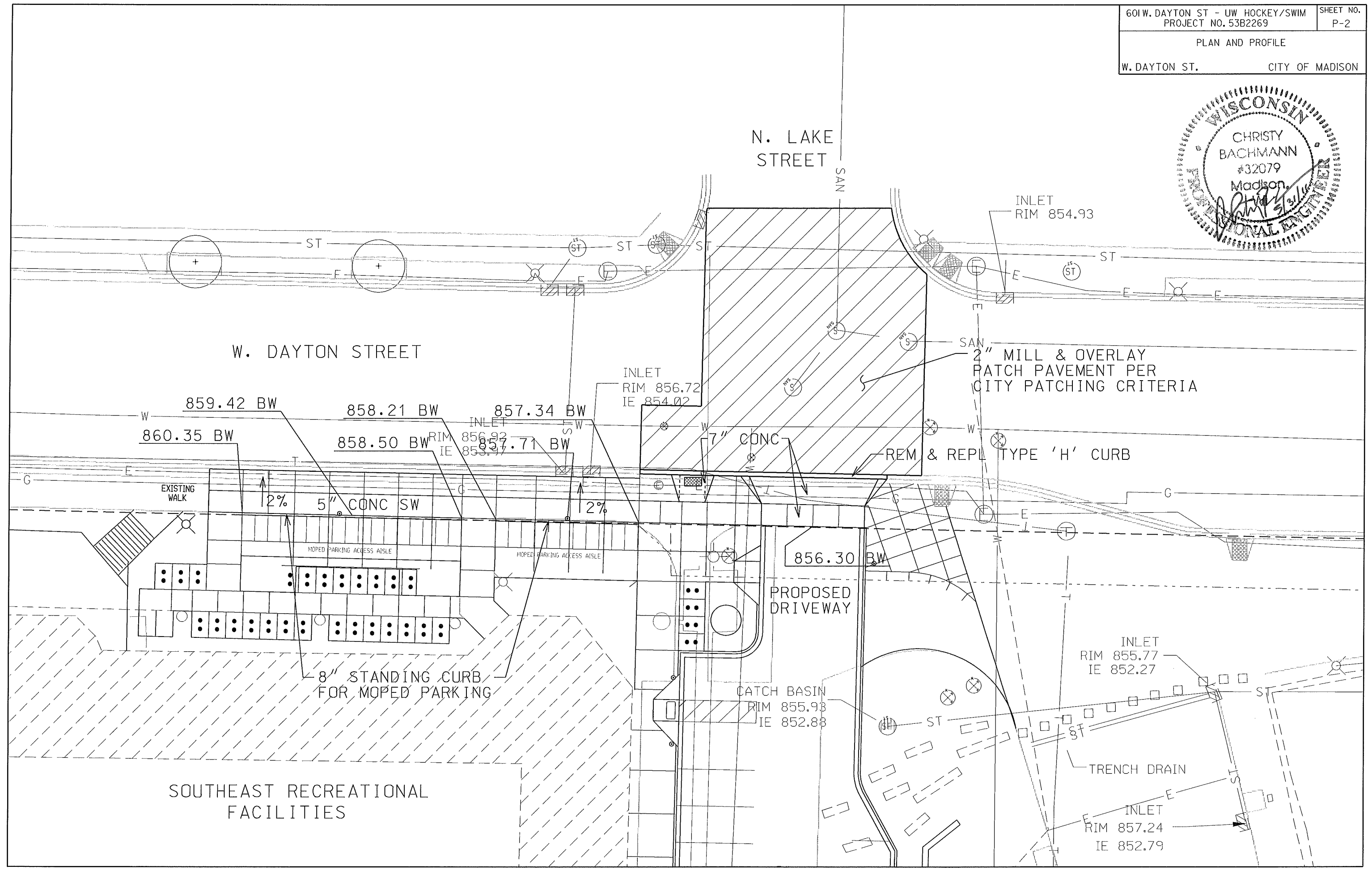

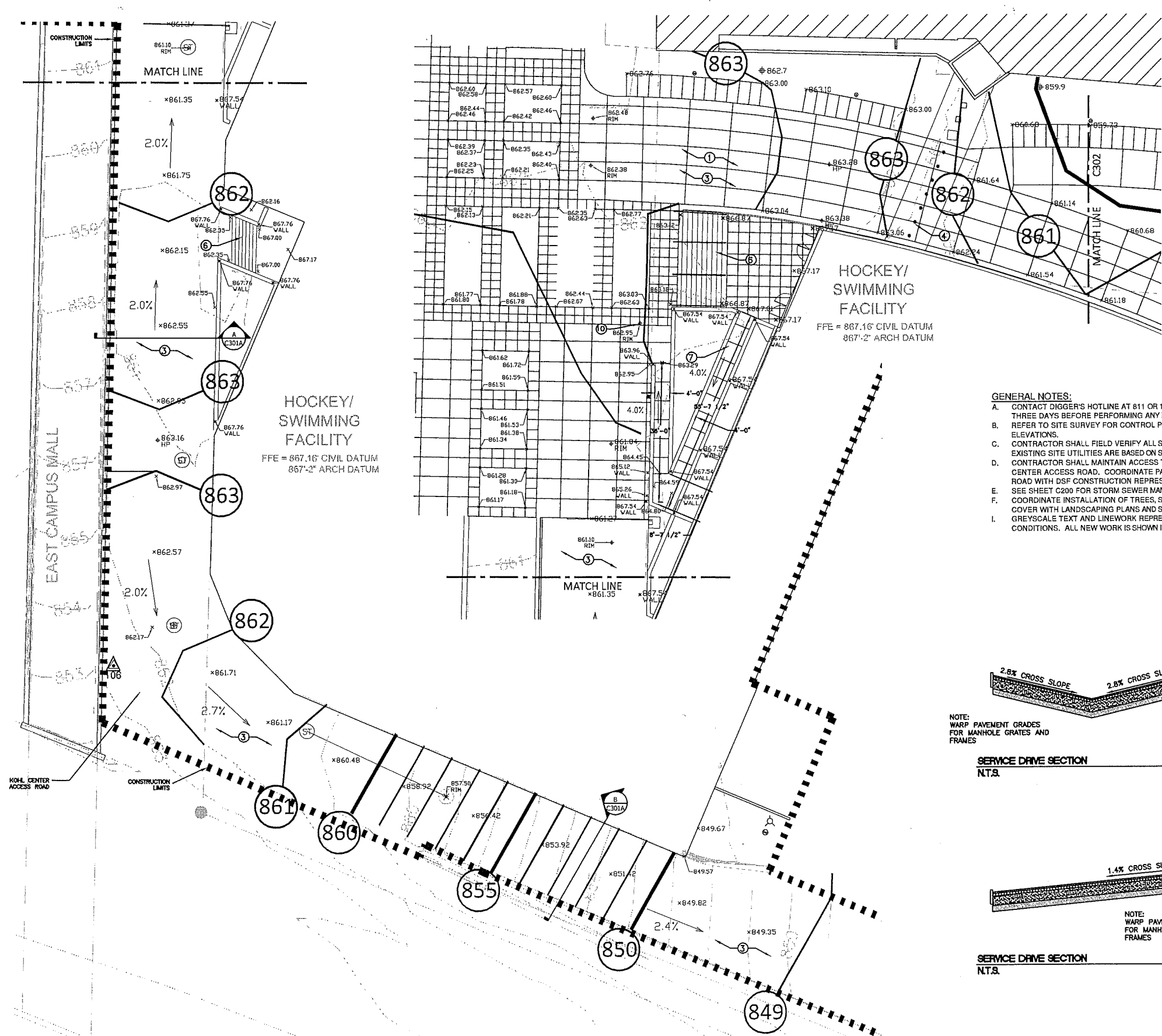

- LEGEND**
- PROPOSED CONTOUR
 - - - EXISTING CONTOUR
 - - - CONSTRUCTION LIMIT
 - - - PROPERTY LINE
 - ▲ CONTROL POINT
 - x PAVEMENT SPOT ELEVATION
 - ◆ LANDSCAPE SPOT ELEVATION
 - x TOP OF WALL SPOT ELEVATION

- GENERAL NOTES:**
- A. CONTACT DIGGER'S HOTLINE AT 811 OR 1-800-242-8511 AT LEAST THREE DAYS BEFORE PERFORMING ANY EXCAVATION WORK.
 - B. REFER TO SITE SURVEY FOR CONTROL POINT COORDINATES AND ELEVATIONS.
 - C. CONTRACTOR SHALL FIELD VERIFY ALL SITE INFORMATION. THE EXISTING SITE UTILITIES ARE BASED ON SURVEY DATA.
 - D. CONTRACTOR SHALL MAINTAIN ACCESS TO KOHL CENTER VIA KOHL CENTER ACCESS ROAD. COORDINATE PAVING WORK ON ACCESS ROAD WITH DSF CONSTRUCTION REPRESENTATIVE AND OWNER.
 - E. SEE SHEET C200 FOR STORM SEWER MANHOLES AND INLETS.
 - F. COORDINATE INSTALLATION OF TREES, SHRUBS, AND GROUND COVER WITH LANDSCAPING PLANS AND SPECIFICATIONS.
 - G. GREYSCALE TEXT AND LINEWORK REPRESENTS EXISTING CONDITIONS. ALL NEW WORK IS SHOWN IN BLACK.

- KEYED NOTES:**
1. CONCRETE FIRE LANE. SEE SHEET L202 FOR DETAIL.
 2. CONCRETE CURB AND GUTTER. SEE SHEET L401 FOR DETAIL.
 3. CONCRETE PARKING LOT AND DRIVE. SEE SHEET L401 FOR DETAIL.
 4. SEE SHEET L401 AND L404 FOR BOLLARD DETAIL.
 5. NOT USED.
 6. SEE SHEET L402 FOR STAIR SECTIONS AND DETAILS.
 7. SEE SHEET L403 FOR RAMP DETAILS.
 8. SEE SHEET L201, L401, AND L402 FOR RETAINING WALL DETAILS.
 9. SEE SHEET C400 FOR ADA RAMP DETAILS.
 10. ADJUST RIM ELEVATION.

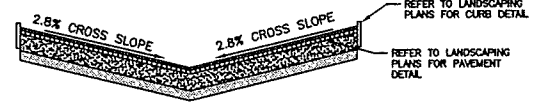

NOTE: WARP PAVEMENT GRADES FOR MANHOLE GRATES AND FRAMES

SERVICE DRIVE SECTION A
N.T.S. C301A

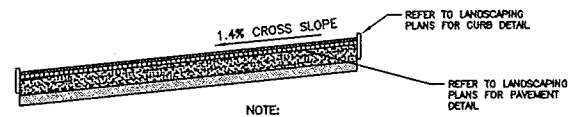

NOTE: WARP PAVEMENT GRADES FOR MANHOLE GRATES AND FRAMES

SERVICE DRIVE SECTION B
N.T.S. C301A

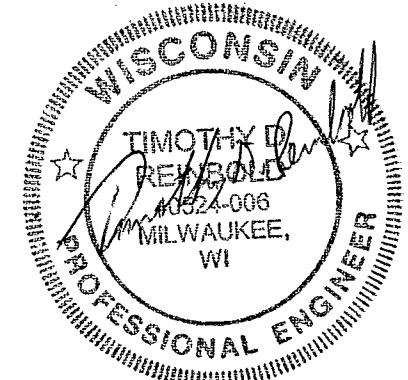

ATHLETICS HOCKEY / SWIMMING FACILITY - KOHL CENTER UNIVERSITY OF WISCONSIN-MADISON MADISON, WISCONSIN

Revisions:		
No.	Date	Description

Graphic Scale	0' 15'
DSF Number	09B1U
Issued With	City Submittal
Date Issued	05/23/11
Sheet Number	C301A

CITY No. P-3

State of Wisconsin
 Department of Administration
 Division of State Facilities



UNIVERSITY OF WISCONSIN - MADISON
 601 WEST DAYTON, MADISON, WI 53715

Kahler Slater
 experience design
 Copyright © 2011 Kahler Slater, Inc. All rights reserved.

