

Madison, Wisconsin

# CITY OF MADISON

## CITY ENGINEERING DIVISION

### DEPARTMENT OF PUBLIC WORKS

# PLAN OF PROPOSED IMPROVEMENT

# MADISON COLLEGE ALLIED HEALTH BUILDING

CITY PROJECT NO. 53B2280  
CONTRACT NO. 2280

**SANITARY SEWER ONLY**

PUBLIC IMPROVEMENT PROJECT APPROVED

JUNE 21, 2011

BY THE COMMON COUNCIL  
OF MADISON, WISCONSIN

PUBLIC IMPROVEMENT DESIGN  
APPROVED BY:

 7/19/11  
City Engineer Date



SANITARY SEWER  
DESIGNED BY:

SEE INDIVIDUAL  
SHEETS

OK MRO 7/19/2011

#### INDEX OF SHEETS

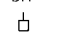
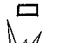
SHEET NO.	TITLE
1	EROSION CONTROL & UTIL SCHEDULE
C1.0	UTILITY PLAN AND PROFILE
C2.0-2.1	

CONVENTIONAL SIGNS	
FIELD VERIFY ALL UTILITY LOCATIONS	
GAS	— G —
STORM SEWER	— ST —
SANITARY SEWER	— SAN —
WATER	— W —
OVERHEAD ELECTRIC	— OH —
POWER POLE	
ADA COMPLIANT RAMP W/ DETECTABLE WARNING FIELD	
COMBUSTIBLE FLUIDS	

#### NOTES:

ALL GUTTERS SHALL DRAIN WITH A MINIMUM GRADE OF 0.50% TOWARD STORM SEWER INLETS.

SIDEWALK RAMPS AND CURB THRU SIDEWALK RAMPS SHALL HAVE A MAXIMUM SLOPE OF 1" PER 12". SIDEWALK AND CURB RAMPS SHALL BE CONSTRUCTED WITH A SIDE SLOPE OF 2.00%. SIDEWALK SHALL HAVE A MINIMUM LONGITUDINAL SLOPE OF 0.50% AND A MAXIMUM LONGITUDINAL SLOPE OF 5.00% EXCEPT WHERE STREET GRADES EXCEED 5.00%.

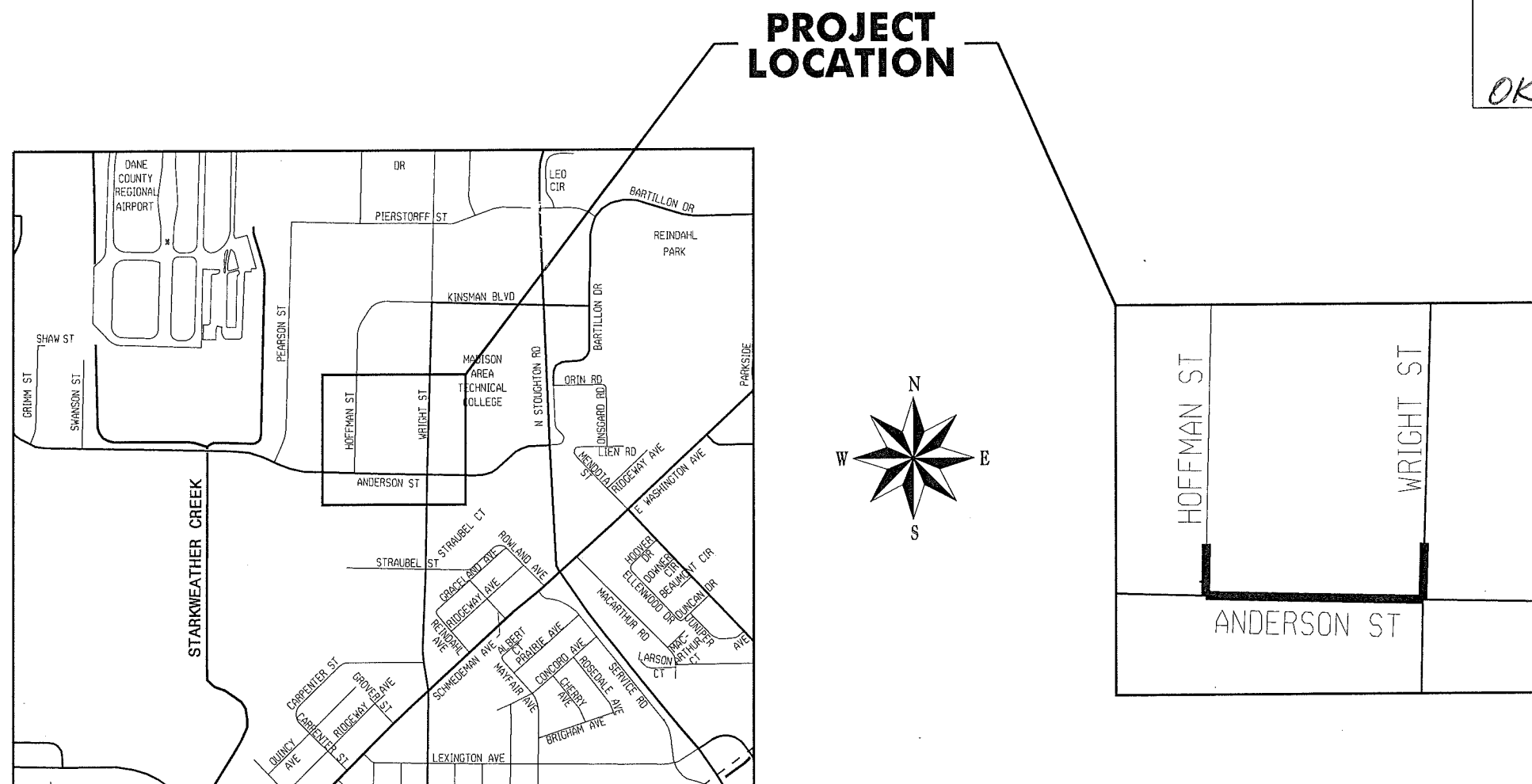

**LEGEND (PROPOSED)**

- PROPERTY LINE
- PUBLIC SANITARY SEWER
- FUTURE BUILDING LOCATION
- UTILITY REMOVAL / ABANDONMENT
- WATERS EDGE AT TIME OF SURVEY
- WETLAND DELINEATION

**GENERAL NOTES**

- REFER TO THE EXISTING CONDITIONS SURVEY FOR EXISTING CONDITIONS NOTES AND LEGENDS. FIELD WORK FOR THE EXISTING CONDITIONS SURVEY PERFORMED BY JSD PROFESSIONAL SERVICES, INC. IN DECEMBER 2010 AND JANUARY 2011.
- CONTRACT DOES NOT INCLUDE ANY WORK OUTSIDE OF THE PUBLIC EASEMENTS UNLESS REQUIRED TO FIX DAMAGE CAUSED BY CONSTRUCTION OF PUBLIC IMPROVEMENTS.
- ALL WORK SHALL BE IN ACCORDANCE WITH THE CITY OF MADISON STANDARD SPECIFICATIONS FOR PUBLIC WORKS CONSTRUCTION.
- ALL RESTORATION SHALL BE IN ACCORDANCE WITH THE CITY OF MADISON STANDARD SPECIFICATIONS FOR PUBLIC WORKS CONSTRUCTION EXCEPT AS NOTED.
- NO SITE GRADING OUTSIDE OF THE CONSTRUCTION LIMIT LINE.
- THIS PROJECT HAS BEEN DESIGNED AND WILL BE CONSTRUCTED IN COMPLIANCE WITH ALL OF THE WDNR INDIVIDUAL PERMIT APPLICATION ELIGIBILITY STANDARDS.
- JSD SHALL BE HELD HARMLESS AND DOES NOT WARRANT ANY DEVIATIONS BY THE OWNER/CONTRACTOR FROM THE APPROVED CONSTRUCTION PLANS THAT MAY RESULT IN DISCIPLINARY ACTIONS BY ANY OR ALL REGULATORY AGENCIES.
- DRAWING FOR REVIEW - NOT FOR CONSTRUCTION UNLESS OTHERWISE NOTED IN THE TITLE BLOCK.
- REFER TO GEOTECHNICAL REPORT DATED JANUARY 18, 2011 AS PREPARED BY CGC, INC FOR SITE SOILS INFORMATION.

**EROSION CONTROL NOTES**

- EROSION CONTROL MEASURES SHALL BE IN PLACE PRIOR TO ANY OTHER CONSTRUCTION ACTIVITY.
- INLET PROTECTION SHALL BE PLACED IN ALL INLETS WITHIN THE PROJECT BOUNDARIES AND ALL INLETS RECEIVING RUNOFF FROM THE PROJECT.
- TYPE D MODIFIED INLET PROTECTION SHALL BE PLACED IN ALL TYPE H INLETS, EXCEPT AT LOW POINTS WHERE TYPE D SHALL BE USED.
- TYPE C MODIFIED INLET PROTECTION SHALL BE PLACED IN ALL TUB STYLE INLETS, EXCEPT AT LOW POINTS WHERE TYPE C SHALL BE USED.
- THE CONSTRUCTION ENGINEER SHALL HAVE FINAL DETERMINATION OF TYPE, LOCATION, AND / EXEMPTIONS FOR INLET PROTECTION.
- THE CONTRACTOR IS RESPONSIBLE FOR THE CONSTRUCTION AND MAINTENANCE OF ALL EROSION CONTROL MEASURES UNTIL FINAL ACCEPTANCE BY THE CITY OF MADISON.
- ALL EROSION CONTROL MEASURES SHALL BE INSTALLED AND MAINTAINED IN ACCORDANCE WITH WDNR SOC STANDARDS, THE CITY OF MADISON STANDARD SPECIFICATIONS AND AS DIRECTED BY THE CONSTRUCTION ENGINEER.
- THE CONTRACTOR SHALL PROVIDE STREET CLEANING AS NEEDED AND / OR AS DIRECTED BY THE CONSTRUCTION ENGINEER.
- THE CONTRACTOR SHALL PROVIDE POLYMER STABILIZATION AS NEEDED AND / OR AS DIRECTED BY THE CONSTRUCTION ENGINEER.
- STOCKPILED MATERIALS SHALL BE PROTECTED FROM EROSION.
- CONSTRUCTION ENTRANCES SHALL BE INSTALLED AS REQUIRED / DETERMINED BY THE CONSTRUCTION ENGINEER.
- DITCH CHECKS SHALL BE INSTALLED AS REQUIRED / DETERMINED BY THE CONSTRUCTION ENGINEER.
- SILT FENCE SHALL BE INSTALLED AS REQUIRED / DETERMINED BY THE CONSTRUCTION ENGINEER.
- DE-WATERING SHALL BE INSTALLED AS REQUIRED / DETERMINED BY THE CONSTRUCTION ENGINEER.

**UTILITY NOTES**

- ABBREVIATIONS: PVC = POLYVINYL CHLORIDE PIPE (SDR-35), SAS = SEWER ACCESS STRUCTURE
- PRECAST STRUCTURE SHOP DRAWINGS SHALL BE SUBMITTED TO CITY ENGINEERING FOR APPROVAL. CONTACT ELIA E. ACOSTA OF CITY ENGINEERING AT (608) 266-4096 FOR APPROVALS, OR FAX SHOP DRAWINGS TO (608) 264-9275.
- DIMENSIONS TAKE PRECEDENCE OVER SCALE. CONTRACTOR TO VERIFY ALL DIMENSIONS IN FIELD.
- IF ANY ERRORS, DISCREPANCIES, OR OMISSIONS WITHIN THE PLAN BECOME APPARENT, IT SHALL BE BROUGHT TO THE ATTENTION OF THE ENGINEER PRIOR TO CONSTRUCTION SO THAT CLARIFICATION OR REDESIGN MAY OCCUR.
- LENGTHS OF ALL UTILITIES ARE TO CENTER OF STRUCTURES OR FITTINGS AND MAY VARY SLIGHTLY FROM PLAN. LENGTHS SHALL BE VERIFIED IN THE FIELD DURING CONSTRUCTION.
- ALL CONSTRUCTION SIGNING TO BE IN ACCORDANCE WITH THE CITY OF MADISON AND WISCONSIN DEPARTMENT OF TRANSPORTATION REQUIREMENTS.
- THE CONTRACTOR SHALL INSTALL A PEDESTRIAN FENCE AROUND ALL EXCAVATIONS TO BE LEFT OPEN OVER NIGHT AS REQUIRED.
- THE PROPOSED IMPROVEMENTS MUST BE CONSTRUCTED IN ACCORDANCE WITH CITY OF MADISON STANDARD SPECIFICATIONS.
- PRIOR TO CONSTRUCTION, THE CONTRACTOR IS RESPONSIBLE FOR:
  - EXAMINING ALL SITE CONDITIONS RELATIVE TO THE CONDITIONS INDICATED ON THE ENGINEERING DRAWINGS. ANY DISCREPANCIES ARE TO BE REPORTED TO THE ENGINEER AND RESOLVED PRIOR TO THE START OF CONSTRUCTION.
  - OBTAINING ALL PERMITS INCLUDING PERMIT COSTS, TAP FEES, METER DEPOSITS, BONDS, AND ALL OTHER FEES REQUIRED FOR PROPOSED WORK TO BEGIN OCCUPANCY.
  - VERIFYING UTILITY ELEVATIONS AND NOTIFYING ENGINEER OF ANY DISCREPANCY. NO WORK SHALL BE PERFORMED UNTIL THE DISCREPANCY IS RESOLVED.
  - NOTIFYING ALL UTILITIES PRIOR TO THE INSTALLATION OF ANY UNDERGROUND IMPROVEMENTS.
  - NOTIFYING THE DESIGN ENGINEER AND MUNICIPALITY 48 HOURS PRIOR TO THE START OF CONSTRUCTION TO ARRANGE FOR APPROPRIATE CONSTRUCTION OBSERVATION.
- THE CONTRACTOR IS RESPONSIBLE FOR PROVIDING THE CITY OF MADISON WITH AS-BUILT CONDITIONS OF THE DESIGNATED IMPROVEMENTS IN ORDER THAT THE APPROPRIATE DRAWINGS CAN BE PREPARED, IF REQUIRED. ANY CHANGES TO THE DRAWINGS OR ADDITIONAL ITEMS MUST BE REPORTED TO THE CONSTRUCTION ENGINEER AS WORK PROGRESSES.
- THE PRIME CONTRACTOR IS RESPONSIBLE FOR COORDINATING ALL CONSTRUCTION WITH OTHER CONTRACTORS INVOLVED WITH CONSTRUCTION OF THE PROPOSED DEVELOPMENT AND FOR REPORTING ANY ERRORS OR DISCREPANCIES BETWEEN THESE PLANS AND PLANS PREPARED BY OTHERS.
- ANY SANITARY SEWER, SANITARY SEWER SERVICES, WATER MAIN, WATER SERVICES, STORM SEWER, OR OTHER UTILITIES, WHICH ARE DAMAGED BY THE CONTRACTORS, SHALL BE REPAIRED TO THE OWNER'S SATISFACTION AT THE CONTRACTOR'S EXPENSE.
- CONTRACTOR IS RESPONSIBLE FOR SITE SAFETY DURING THE CONSTRUCTION OF IMPROVEMENTS.

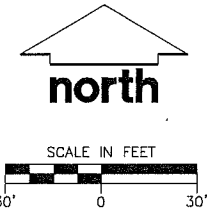

**PROPOSED PIPE SCHEDULE**

FROM SAS (DOWNSTREAM)	TO SAS (UPSTREAM)	ELEVATION (DOWNSTREAM)	ELEVATION (UPSTREAM)	LENGTH (FT)	SLOPE (S)	SIZE (DIA)	PVC (TYPE)
SAS NO. 1	SAS NO. 2	841.00	841.18	105	0.15	18	SDR-35
SAS NO. 2	SAS NO. 3	841.18	841.75	378	0.15	18	SDR-35
SAS NO. 3	SAS NO. 4	841.75	842.29	364	0.15	18	SDR-35
SAS NO. 4	EX. SAN-5	842.31	842.50	114	0.15	18	SDR-35

**ABANDON PIPE SCHEDULE**

ABANDON (FROM)	ABANDON (TO)	LENGTH (FT)	SIZE (DIA)	PIPE (TYPE)
EX. SAN-9	EX. SAN-5	698	18	VP

**REMOVE PIPE SCHEDULE**

REMOVE (FROM)	REMOVE (TO)	LENGTH (FT)	SIZE (DIA)	PIPE (TYPE)
EX. SAN-5	SAS MH NO. 4	114	8	VP

**PROPOSED STRUCTURE SCHEDULE**

SAS NO.	STATION	TOP OF CASTING	INVERT	DEPTH	DIAMETER
SAS NO. 1	1+00.0	853.70	840.90	12.80	5 FT
SAS NO. 2	2+05.4	853.70	841.16	12.54	5 FT
SAS NO. 3	5+83.6	853.70	841.75	11.95	5 FT
SAS NO. 4	9+47.1	853.70	842.29	11.41	5 FT

**REMOVE STRUCTURE SCHEDULE**

STRUCTURE	STATION	LOCATION
EX. SAN-8	8+20.9	LT 114.4
EX. SAN-7	7+09.1	LT 114.3

**EXISTING STRUCTURE CASTING ADJUSTMENT**

STRUCTURE	EX. CASTING	PROP. CASTING	RAISE	NOTES
EX. SAN-9	851.06	853.70	2.64	SWAP BARREL SECTIONS FOR SAS ADJUSTMENT - MAXIMUM ADJUSTING RING HEIGHT NOT TO EXCEED 9 INCHES.
EX. SAN-5	853.62	853.70	0.08	MAXIMUM ADJUSTING RING HEIGHT NOT TO EXCEED 9 INCHES.

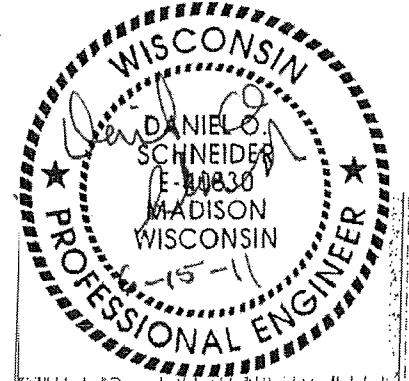
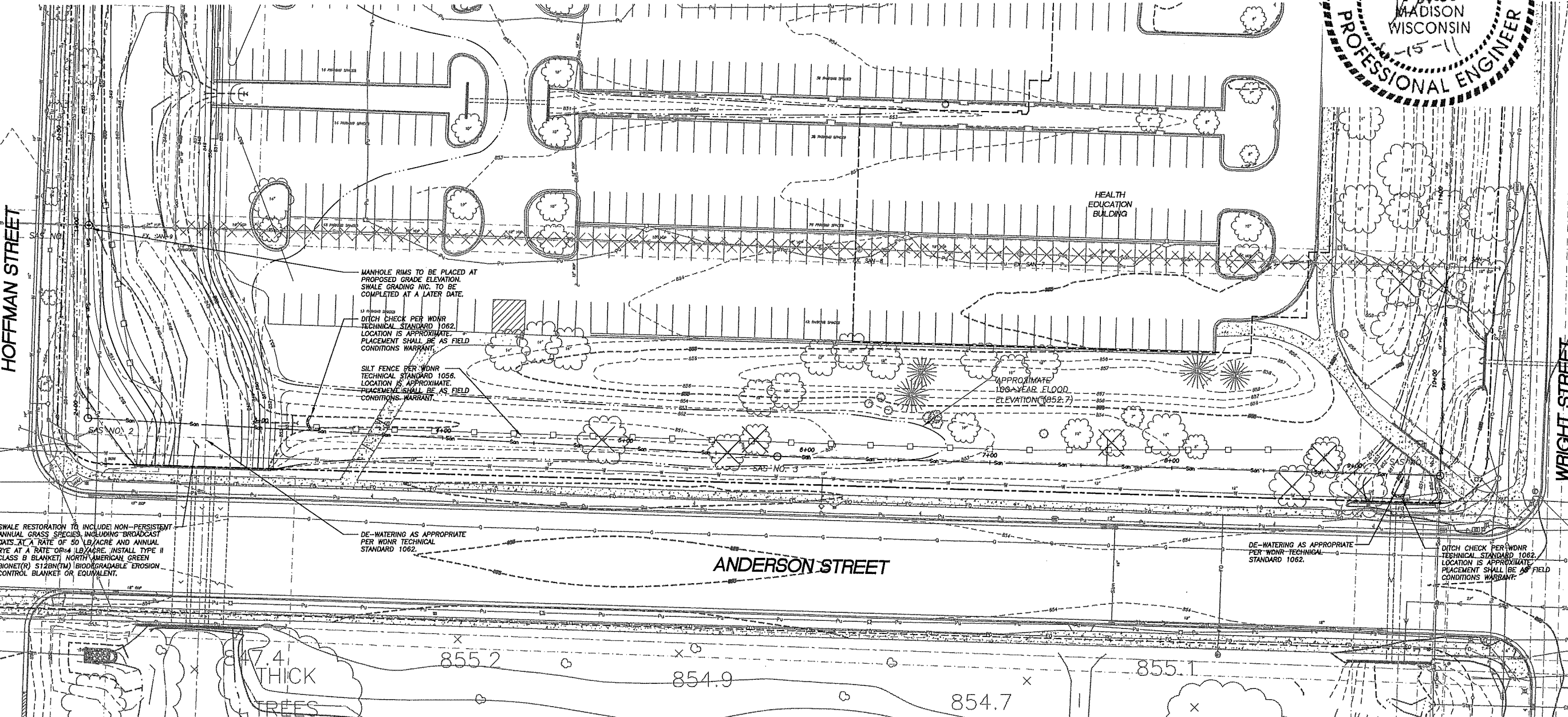

**JSD Professional Services, Inc.**  
 Engineers • Surveyors • Planners

"BUILDING RELATIONSHIPS WITH A COMMITMENT TO CLIENT SATISFACTION THROUGH TRUST, QUALITY AND EXPERIENCE"

- CIVIL ENGINEERING
- SURVEYING & MAPPING
- CONSTRUCTION SERVICES
- WATER RESOURCES
- PLANNING & DEVELOPMENT
- TRANSPORTATION ENGINEERING
- STRUCTURAL ENGINEERING
- LANDSCAPE ARCHITECTURE

MADISON REGIONAL OFFICE  
 161 HORIZON DRIVE, SUITE 101  
 VERONA, WISCONSIN 53593  
 608.848.5060 PHONE | 608.848.2255 FAX

MADISON | MILWAUKEE  
 KENOSHA | APPLETON  
 www.jsdinc.com

SERVICES PROVIDED TO:  
**MADISON COLLEGE**

3550 ANDERSON ST.  
 MADISON, WI 53704

PROJECT:  
**MADISON COLLEGE  
 UTILITY  
 IMPROVEMENTS**

PROJECT LOCATION:  
 CITY OF MADISON  
 DANE COUNTY, WI

JSD PROJECT NO.: 10-4154

SEAL/SIGNATURE:

ALTHOUGH EVERY EFFORT HAS BEEN MADE IN PREPARING THESE PLANS AND CHECKING THEM FOR ACCURACY, THE CONTRACTOR AND SUBCONTRACTORS MUST CHECK ALL DETAIL AND DIMENSIONS OF THEIR TRADE AND BE RESPONSIBLE FOR THE SAME.

DESIGN: DOS 2-25-11  
 DRAWN: DOS 2-25-11  
 APPROVED: WPW

PLAN MODIFICATIONS: DATE:  
 CITY OF MADISON 06-15-2011

**DIGGERS HOTLINE**

Toll Free (800) 242-8511  
 Milwaukee Area (414) 259-1181  
 Hearing Impaired TDD (800) 542-2289  
 www.DiggersHotline.com

SHEET TITLE:  
**OVERALL UTILITY  
 AND EROSION  
 CONTROL PLAN  
 AND SCHEDULE**

SHEET NUMBER:  
**C1.0**

THESE PLANS AND DESIGNS ARE COPYRIGHT PROTECTED AND MAY NOT BE USED IN WHOLE OR IN PART WITHOUT THE WRITTEN CONSENT OF JSD PROFESSIONAL SERVICES, INC.

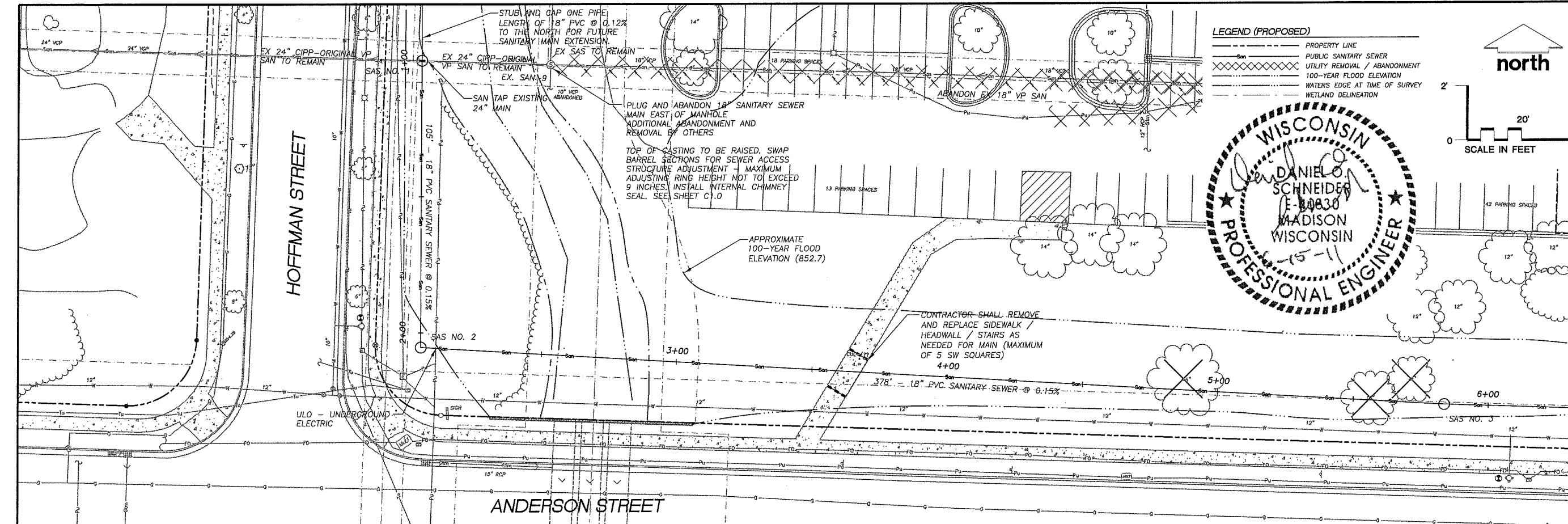

**LEGEND (PROPOSED)**

- PROPERTY LINE
- PUBLIC SANITARY SEWER
- UTILITY REMOVAL / ABANDONMENT
- 100-YEAR FLOOD ELEVATION
- WATERS EDGE AT TIME OF SURVEY
- WETLAND DELINEATION

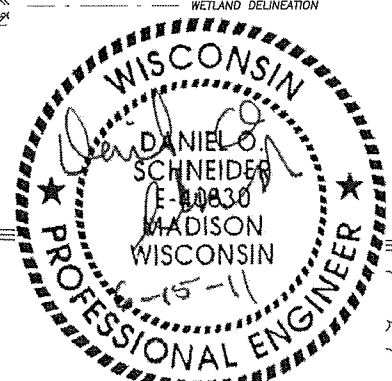
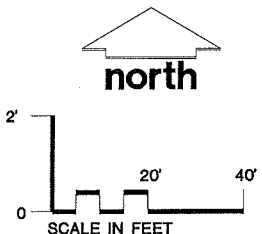

**JSD Professional Services, Inc.**  
 Engineers • Surveyors • Planners

"BUILDING RELATIONSHIPS WITH A COMMITMENT TO CLIENT SATISFACTION THROUGH TRUST, QUALITY AND EXPERIENCE"

- CIVIL ENGINEERING
- SURVEYING & MAPPING
- CONSTRUCTION SERVICES
- WATER RESOURCES
- PLANNING & DEVELOPMENT
- TRANSPORTATION ENGINEERING
- LANDSCAPE ARCHITECTURE

MADISON REGIONAL OFFICE  
 161 HORIZON DRIVE, SUITE 101  
 VERONA, WISCONSIN 53593  
 608.848.5060 PHONE | 608.848.2255 FAX  
 MADISON | MILWAUKEE | KENOSHA

www.jsdinc.com

SERVICES PROVIDED TO:  
**CITY OF MADISON**

210 MLK, Jr. Blvd., Room 115  
 Madison, WI 53703

**ANDERSON STREET  
 SANITARY SEWER**

PROJECT LOCATION:  
 CITY OF MADISON  
 DANE COUNTY, WI

JSD PROJECT NO.: 10-4154

SEAL/SIGNATURE:

ALTHOUGH EVERY EFFORT HAS BEEN MADE IN PREPARING THESE PLANS AND CHECKING THEM FOR ACCURACY, THE CONTRACTOR AND SUBCONTRACTORS MUST CHECK ALL DETAIL AND DIMENSIONS OF THEIR TRADE AND BE RESPONSIBLE FOR THE SAME.

DESIGN:	DOS	06-01-2011
DRAWN:	DOS	06-01-2011
APPROVED:		
PLAN MODIFICATIONS:		DATE:
DRAFT		06-01-2011
CITY OF MADISON		06-15-2011

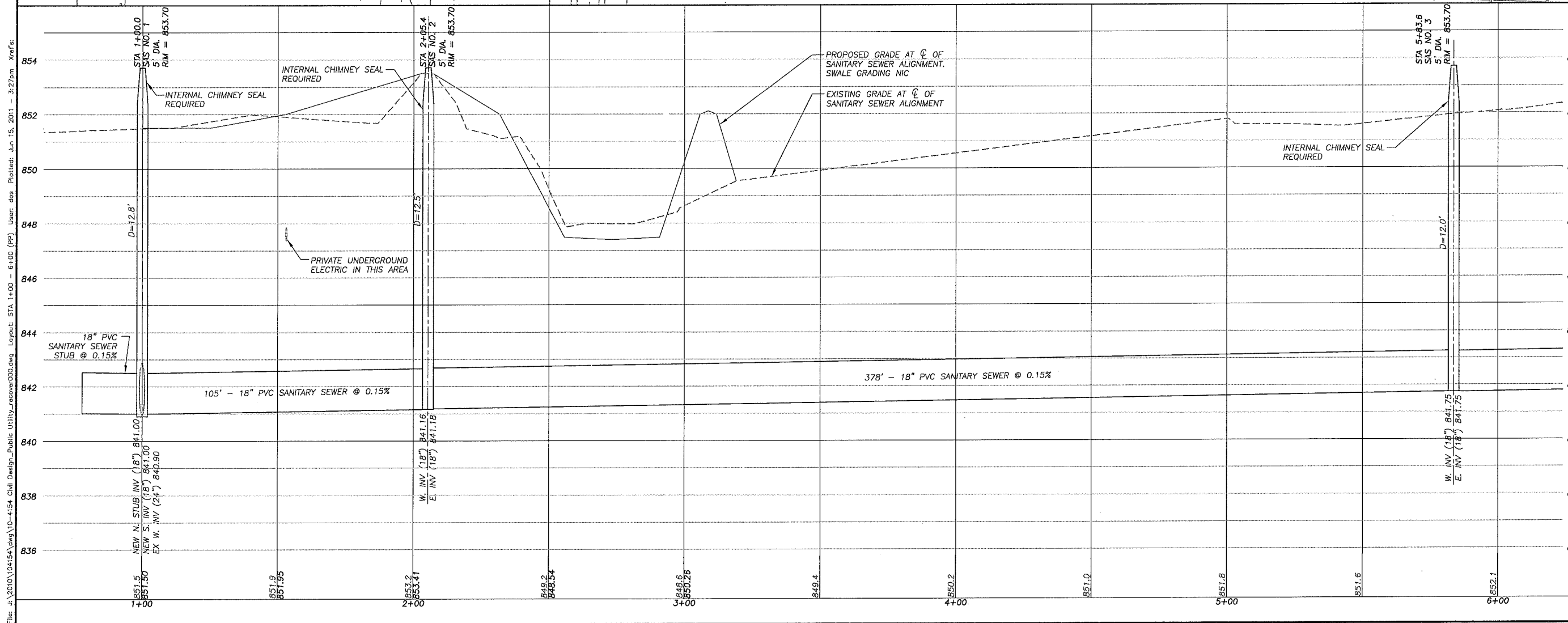

**DIGGERS HOTLINE**

Toll Free (800) 242-8511  
 Milwaukee Area (414) 259-1181  
 Hearing Impaired TDD (800) 542-2289  
 www.DiggersHotline.com

SHEET TITLE:  
**SANITARY SEWER  
 PLAN & PROFILE  
 STA 1+00 - 6+00**

SHEET NUMBER  
**C-2.0**

File: s:\2010\104154\10-4154\_Civil Design\_Public Utility\_recover000.dwg Layout: STA 1+00 - 6+00 (PP) User: dos Plotted: Jun 15, 2011 - 3:27pm Xref's:

THESE PLANS AND DESIGNS ARE COPYRIGHT PROTECTED AND MAY NOT BE USED IN WHOLE OR IN PART WITHOUT THE WRITTEN CONSENT OF JSD PROFESSIONAL SERVICES, INC.

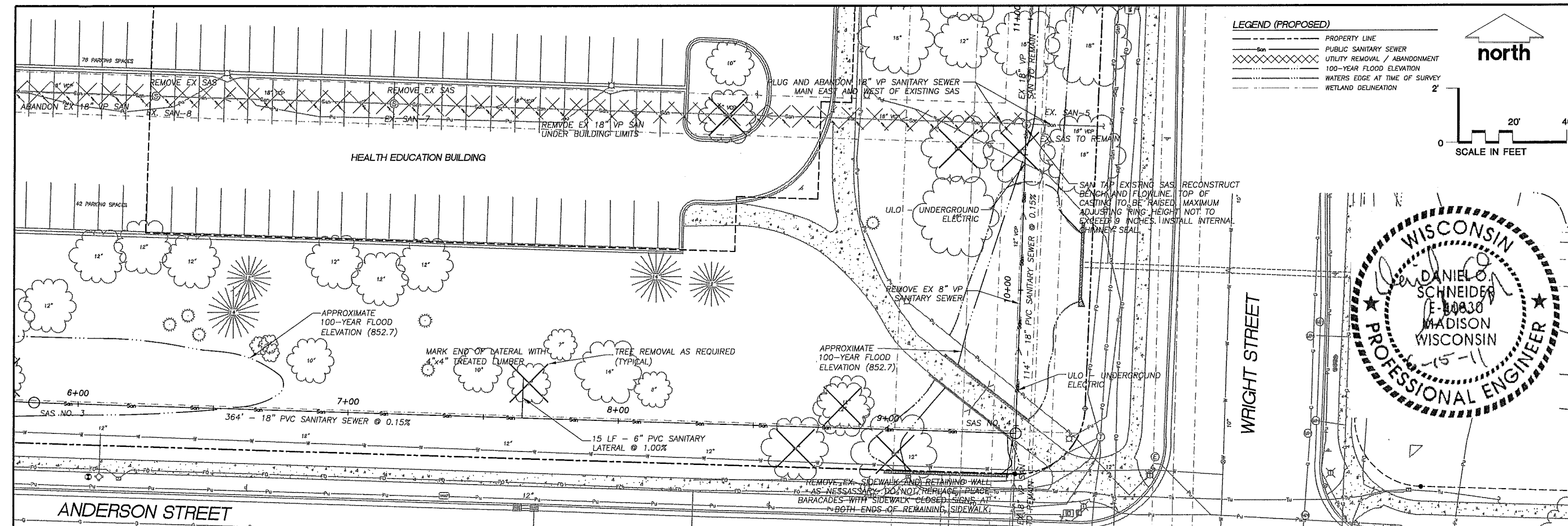

- LEGEND (PROPOSED)**
- PROPERTY LINE
  - PUBLIC SANITARY SEWER
  - XXXXXX UTILITY REMOVAL / ABANDONMENT
  - 100-YEAR FLOOD ELEVATION
  - WATERS EDGE AT TIME OF SURVEY
  - WETLAND DELINEATION

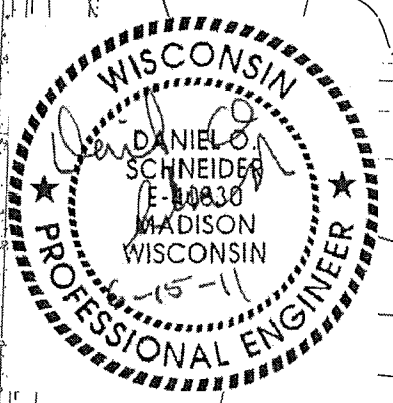
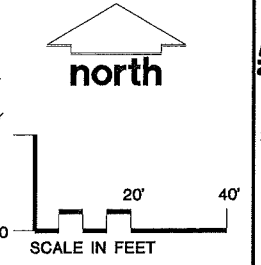

**JSD Professional Services, Inc.**  
 Engineers • Surveyors • Planners

"BUILDING RELATIONSHIPS WITH A COMMITMENT TO CLIENT SATISFACTION THROUGH TRUST, QUALITY AND EXPERIENCE"

- CIVIL ENGINEERING
- SURVEYING & MAPPING
- CONSTRUCTION SERVICES
- WATER RESOURCES
- PLANNING & DEVELOPMENT
- TRANSPORTATION ENGINEERING
- LANDSCAPE ARCHITECTURE

MADISON REGIONAL OFFICE  
 161 HORIZON DRIVE, SUITE 101  
 VERONA, WISCONSIN 53593  
 608.848.5060 PHONE | 608.848.2255 FAX

MADISON | MILWAUKEE | KENOSHA

www.jsdinc.com

SERVICES PROVIDED TO:  
**CITY OF MADISON**

210 MLK, Jr. Blvd., Room 115  
 Madison, WI 53703

**ANDERSON STREET SANITARY SEWER**

PROJECT LOCATION:  
 CITY OF MADISON  
 DANE COUNTY, WI

JSD PROJECT NO.: 10-4154

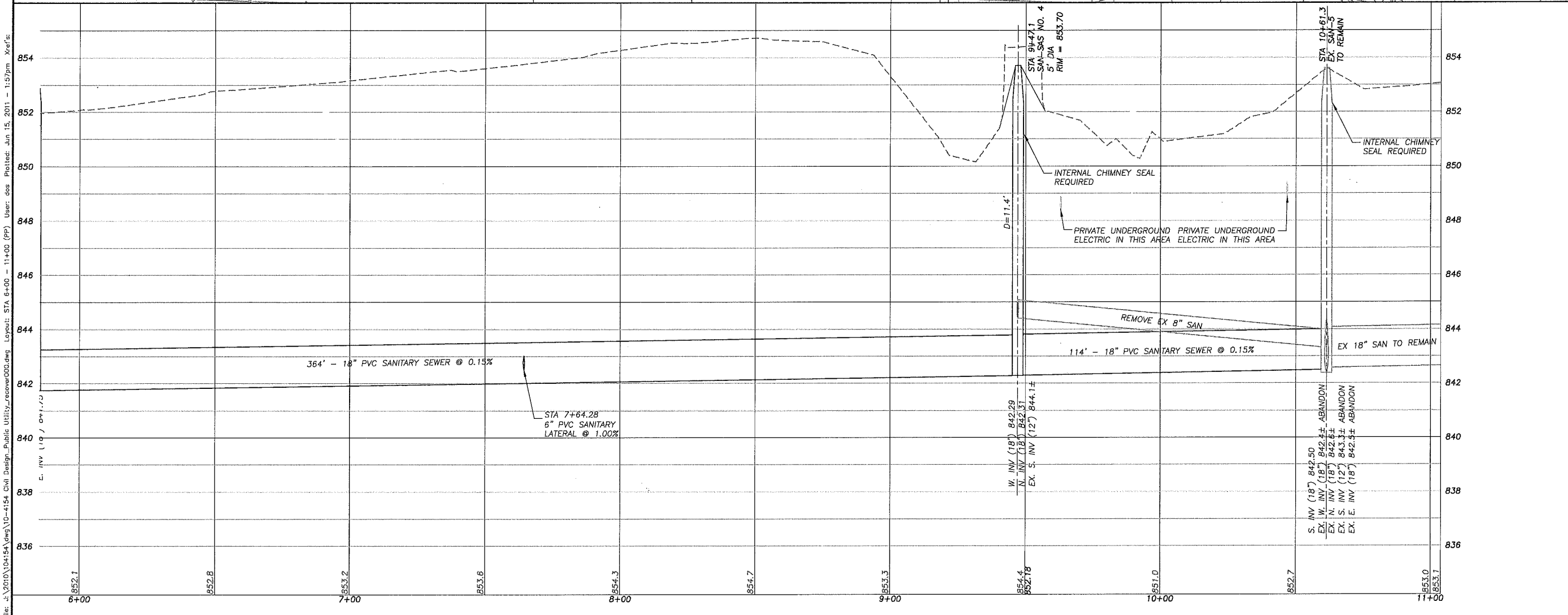

SEAL SIGNATURE:

ALTHOUGH EVERY EFFORT HAS BEEN MADE IN PREPARING THESE PLANS AND CHECKING THEM FOR ACCURACY, THE CONTRACTOR AND SUBCONTRACTORS MUST CHECK ALL DETAIL AND DIMENSIONS OF THEIR TRADE AND BE RESPONSIBLE FOR THE SAME.

DESIGN:	DOS	08-01-2011
DRAWN:	DOS	08-01-2011
APPROVED:		
PLAN MODIFICATIONS:		DATE:
DRAFT		08-01-2011
CITY OF MADISON		08-15-2011

**DIGGERS HOTLINE**

Toll Free (800) 242-8511  
 Milwaukee Area (414) 259-1181  
 Hearing Impaired TDD (800) 542-2289  
 www.DiggersHotline.com

SHEET TITLE:  
**NOVATION PARKWAY  
 PLAN & PROFILE  
 STA 113+00 - 118+50**

SHEET NUMBER:  
**C-2.1**

File: J:\2010\104154\dwg\10-4154\_Civil\_Design\_Public\_Utility\_recover000.dwg Layout: STA 6+00 - 11+00 (PP) User: dos Plotted: Jun 15, 2011 - 1:57pm Xref(s):

THESE PLANS AND DESIGNS ARE COPYRIGHT PROTECTED AND MAY NOT BE USED IN WHOLE OR IN PART WITHOUT THE WRITTEN CONSENT OF JSD PROFESSIONAL SERVICES, INC.