



# Madison Metro Transit System

1101 East Washington Avenue  
Madison, Wisconsin, 53703  
Administrative Office: 608 266 4904  
Fax: 608 267 8778



May 8, 2006

TO: Plan Commission  
FROM: Timothy Sobota, Transit Planner, Metro Transit  
SUBJECT: **1701 Thierer Road – East Pointe Plaza**

Metro Transit has reviewed the subject development and has the following comments.

**MAJOR OR NON-STANDARD REVIEW COMMENTS** (Comments which are special to the project and/or may require additional work beyond a standard, more routine project.)

1. The applicant shall install a concrete passenger boarding pad on the north side of Lien Road, approximately eight feet east of bus stop sign pole #9537. This bus stop is located about 180 feet west of the parcel's Lien Road driveway access, and 200 feet east of the Lien Road intersection with Thierer Road. The concrete pad shall occupy the full distance of the terrace, measure 6 feet in width parallel to the street, and lie flush between the sidewalk and the top of curb.
2. The developer shall include the location of these passenger amenities on the final documents filed with their permit application so that Metro Transit may review and approve the design.

## GENERAL OR STANDARD REVIEW COMMENTS

In addition, we offer the following General or Standard Review Comments:

3. Metro Transit operates bus service seven days a week along Lien and Thierer roads.
4. Metro Transit requests to sign and review final documents submitted for this project.

Please contact Tim Sobota, Metro Transit at 261-4289  
or by email at <[tsobota@cityodmadison.com](mailto:tsobota@cityodmadison.com)>  
if you have questions regarding the above items.

CC: Project contact person, John Bienen: [jjbienen@tjkdesignbuild.com](mailto:jjbienen@tjkdesignbuild.com) (email)

Atch. Exhibit page "L1 Landscape Plan" [4/5/2006], notated with approximate amenity location



634 West Main Street  
 Madison, WI 53103  
 608-251-1090  
 FAX 608-251-1092

UNLIMITED DRAWING  
 THIS DOCUMENT OR THE INFORMATION  
 HEREIN IS NOT TO BE REPRODUCED,  
 COPIED, STORED IN A RETRIEVAL SYSTEM,  
 TRANSMITTED, OR IN ANY MANNER  
 DISSEMINATED BY THE DESIGN FIRM.

PROPOSED FACILITY FOR:  
**EAST POINTE PLAZA**  
 RETAIL  
 MADISON, WISCONSIN

4-5-06

**GENERAL NOTES**

- A) All new trees and shrubs groups (and other specimens of property) to be planted from a nursery or grower who has been approved by a majority of the local landscape board.
- B) All trees to be planted in a minimum 2' depth (1' wide hole for other groups).
- C) "Edging" to be Vicks Vinyl Base Diamond Edging or equivalent.
- D) Areas labeled "Remove Stone" to receive 1.5" washed gravel under 2" extra over above noted stones.
- E) Areas labeled "Soil" shall receive any No. 1 grade horticulture fertilizer.

Head of Division	Quantity	Code Name	Common Name	Planting Size
Plant Material List	1	ASH	American Purple Winter Jun	2" BALL
	6	GC	Green and Golden Linden	2" BALL
	2	TRH	Three Cornered Plant	2" BALL
Container Evergreen	Quantity	Code Name	Common Name	Planting Size
	27	SP	Spotted Garden	4" CONT.
	1	FAS	Fax Albert Blue Spruce	4" x 6"
	5	TY	Taunton Yew	18" BALL
	4	TA	Teddy Bear Hamamelis	4" BALL
Perennials	Quantity	Code Name	Common Name	Planting Size
	18	SP	Spotted Garden	4" CONT.
	5	DAW	Delaware Aster (white)	4" CONT.
	6	FD	French Daylily	4" CONT.
	11	SD	Star's Do One Daylily (8" Repeat)	4" CONT.
Shrub	Quantity	Code Name	Common Name	Planting Size
	4	SHAW	Blue Multiflora Arrowwood	4" CONT.
	30	GS	Golden Spice	4" CONT.
	39	GS	Golden Spice	4" CONT.
	2	NT	Native	4" CONT.
	3	A	Amelanchier	24" BALL
	10	TSF	Texas Scarlet Flowering Quince	4" CONT.
	1	TVE	Texas Wildflower	4" CONT.

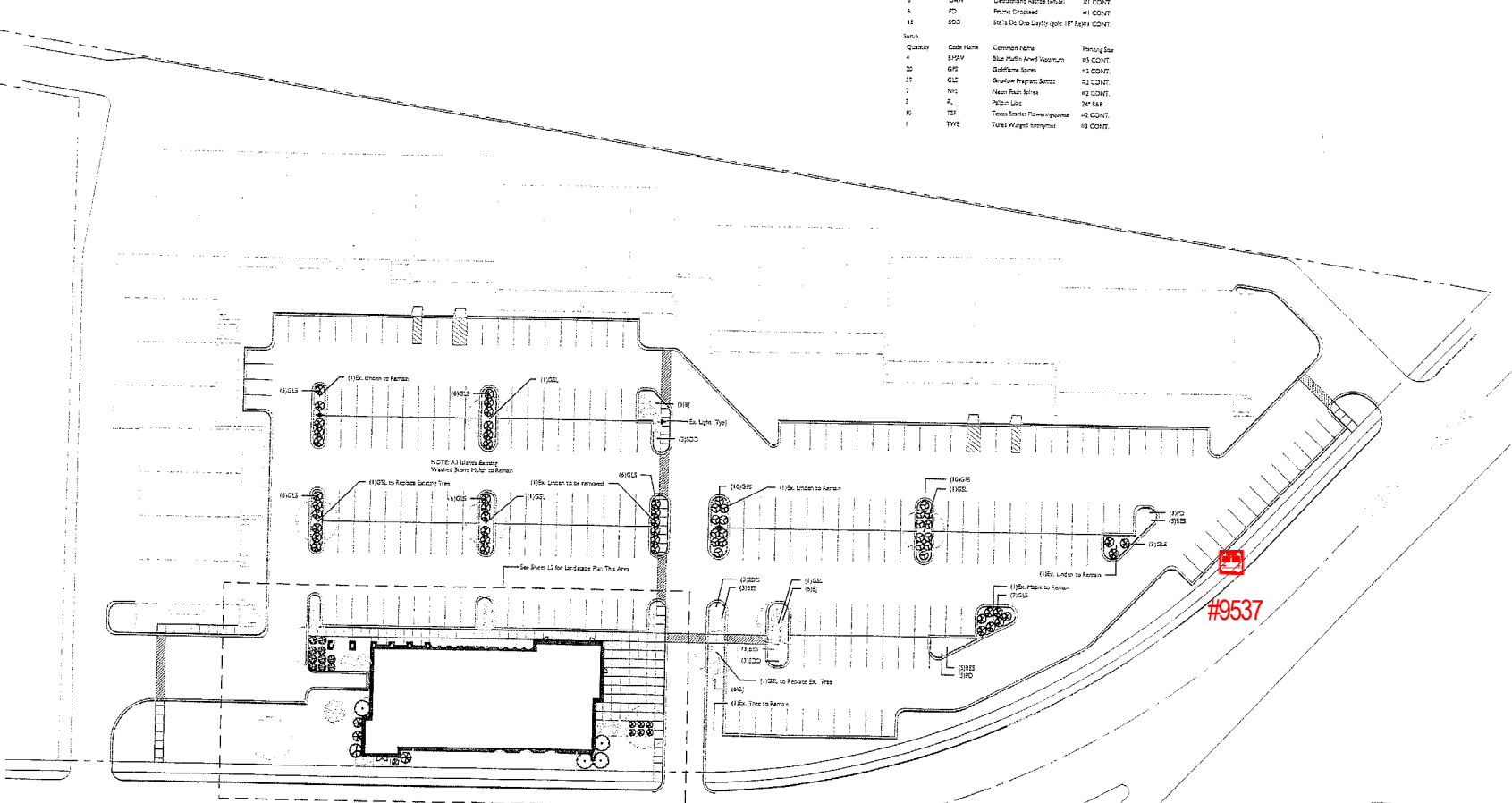

THIERER ROAD

**The Group Company**  
 LANDSCAPE ARCHITECTS  
 LANDSCAPE CONTRACTORS  
 2220 W. BERTHOUD AVENUE  
 MADISON, WI 53705-0200  
 TEL: (608) 816-7944  
 FAX: (608) 814-4265

