

**1 FLOOR PLAN**  
 Scale: 1/8" = 1'-0"



Thomas List, AIA - Architect  
 4370 Citation Ct.  
 Cottage Grove, WI  
 Ph. 608-839-1107  
 Cell 608-445-3191  
 tlist1964@charter.net

**CAFE BELLAITALIA**

DECK ADDITION  
 1026 N. SHERMAN AVE.  
 MADISON, WI 53704

DRAWN BY: TELAIA  
 PROJECT NO.: 10002  
 DATE: 12/15/2010  
 SHEET NO.: 1 OF 3  
 REVISION:

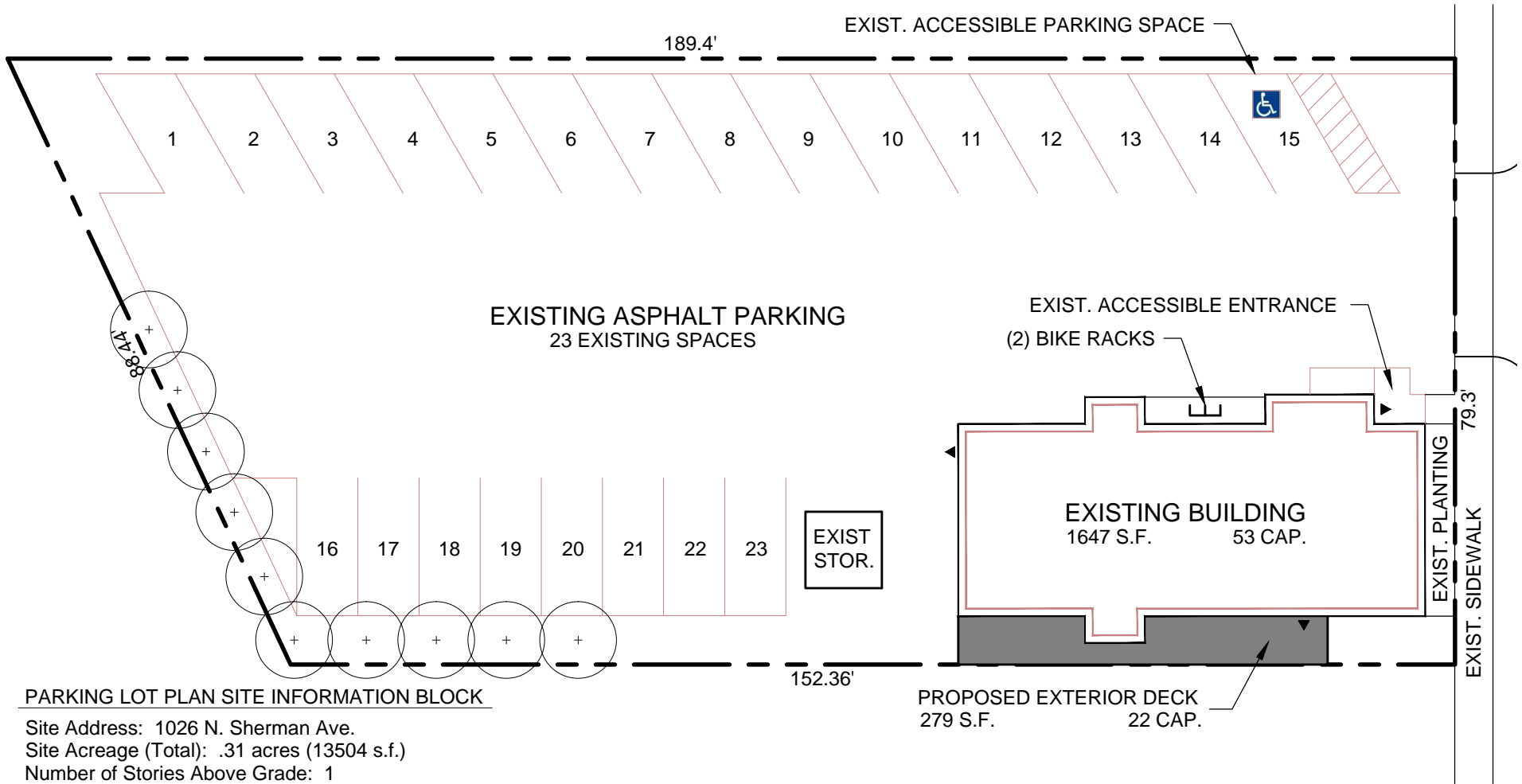

**PARKING LOT PLAN SITE INFORMATION BLOCK**

Site Address: 1026 N. Sherman Ave.  
 Site Acreage (Total): .31 acres (13504 s.f.)  
 Number of Stories Above Grade: 1  
 Building Height: 20' +/-  
 Construction Type: III-B  
 Building Area: 1647 s.f.  
 Bicycle Rack Quantity: 2  
 Parking Stalls: 23  
 Accessible Parking Stalls: 1  
 Number of Trees Shown: 10  
 Accessible Parking Stalls: 1

**2 SITE PLAN**  
 Scale: 1" = 20'-0"



Thomas List, AIA - Architect  
 4370 Citation Ct.  
 Cottage Grove, WI  
 Ph. 608-839-1107  
 Cell 608-445-3191  
 tlist1964@charter.net

**CAFE BELLAITALIA**

DECK ADDITION  
 1026 N. SHERMAN AVE.  
 MADISON, WI 53704

DRAWN BY: TELAIA  
 PROJECT NO.: 10002  
 DATE: 12/15/2010  
 SHEET NO.: 2 OF 3  
 REVISION:

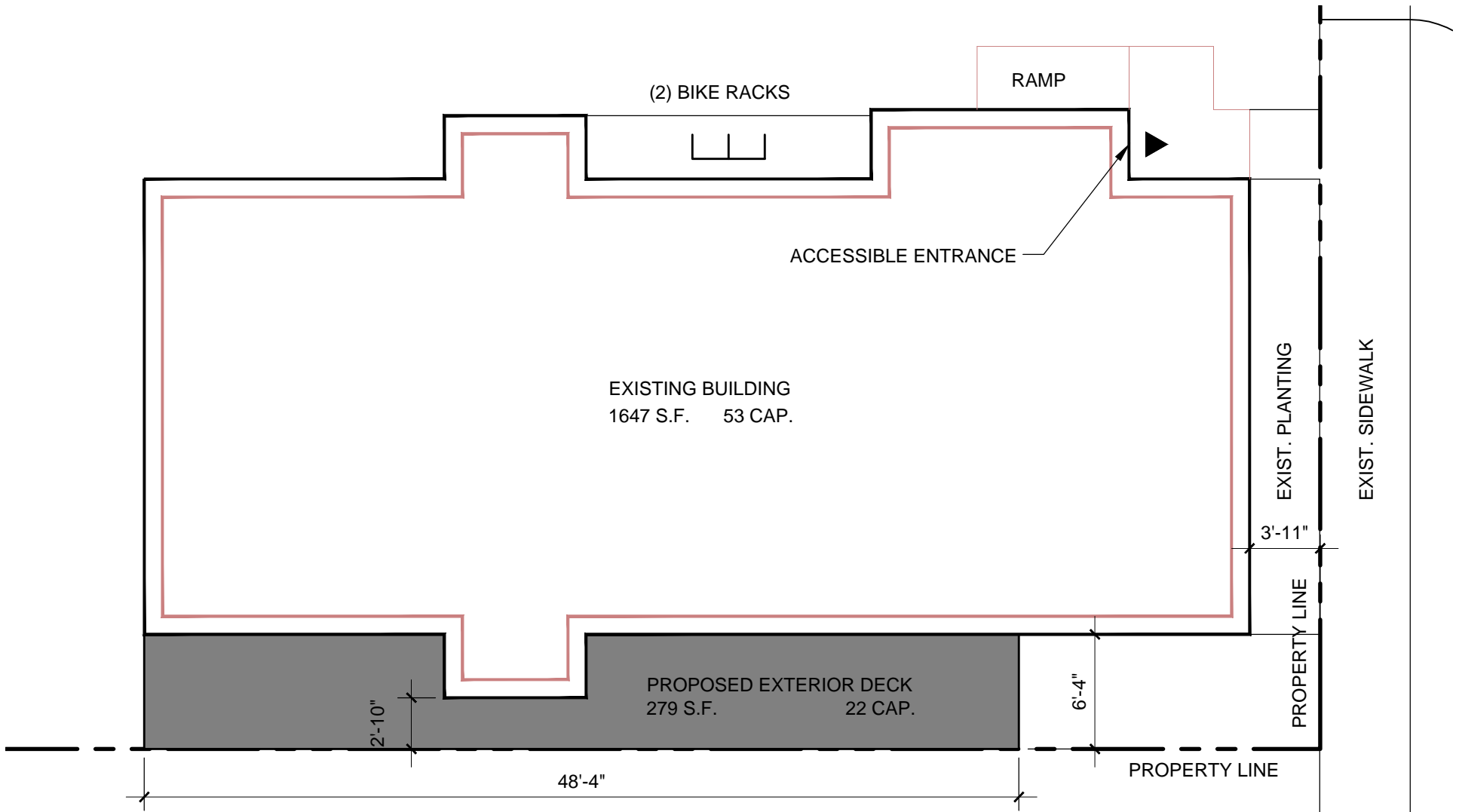

**3** SITE PLAN  
Scale: 1/8" = 1'-0"



Thomas List, AIA - Architect  
4370 Citation Ct.  
Cottage Grove, WI  
Ph. 608-839-1107  
Cell 608-445-3191  
tlist1964@charter.net

# CAFE BELLAITALIA

DECK ADDITION  
1026 N. SHERMAN AVE.  
MADISON, WI 53704

DRAWN BY: TELAIA  
PROJECT NO.: 10002  
DATE: 12/15/2010  
SHEET NO.: 3 OF 3  
REVISION: