

FOURTH FLOOR ADDITION
 &
 FACADE RENOVATION
 TO
 202 STATE STREET
 MADISON, WISCONSIN

architecture
 network, inc.

116 East Dayton Street
 Madison, WI 53703
 608-251-7515 Phone
 608-251-7566 Fax
 www.architecture-network.net

DRAWING INDEX

- T-1.0 COVER SHEET & PROJECT DATA
- SP-1.0 SITE PLAN
- A-1.0 BASEMENT PLAN
- A-1.1 FIRST FLOOR PLAN
- A-1.2 SECOND FLOOR PLAN
- A-1.3 THIRD FLOOR PLAN
- A-1.4 FOURTH FLOOR PLAN
- A-2.0 ELEVATIONS

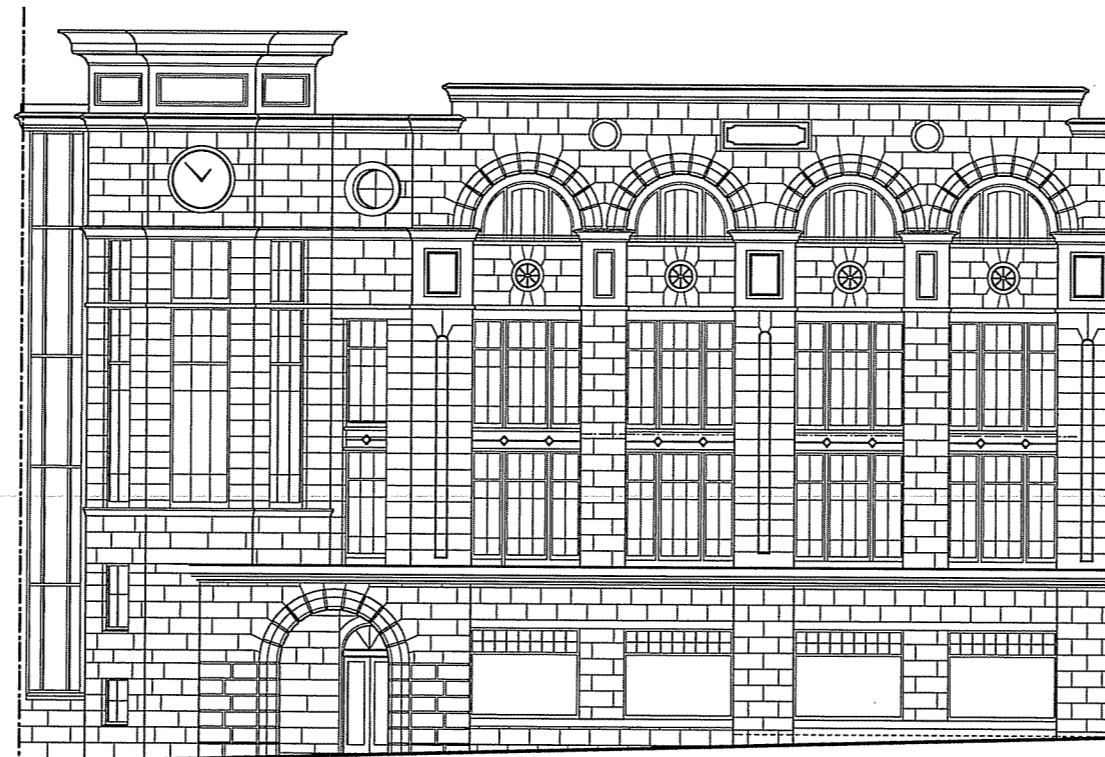

PROJECT:
 FOURTH FLOOR ADDITION
 &
 FACADE
 RENOVATION
 TO:
 202
 STATE
 STREET

MADISON, WISCONSIN

REVISIONS:

DATE: 1 MARCH 2006

SCALE: AS NOTED
 50% @ 11x17

PROJECT: K0522

DRAWN BY: J.P. EKSTROM EJE

DRAWING NAME:

TITLE SHEET

DRAWING NUMBER:

T-1.0

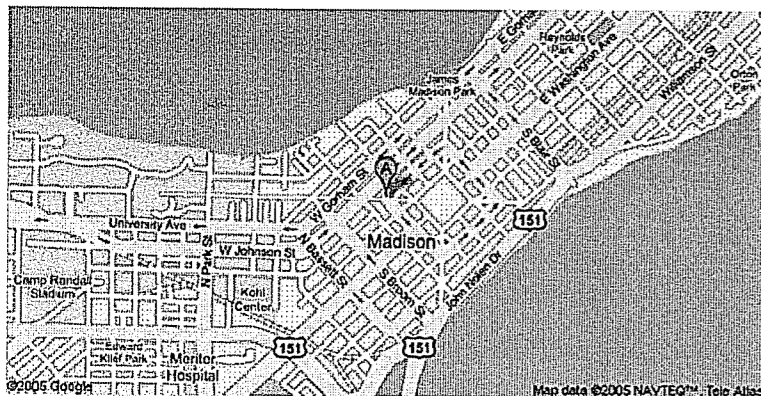

SITE LOCATION MAP

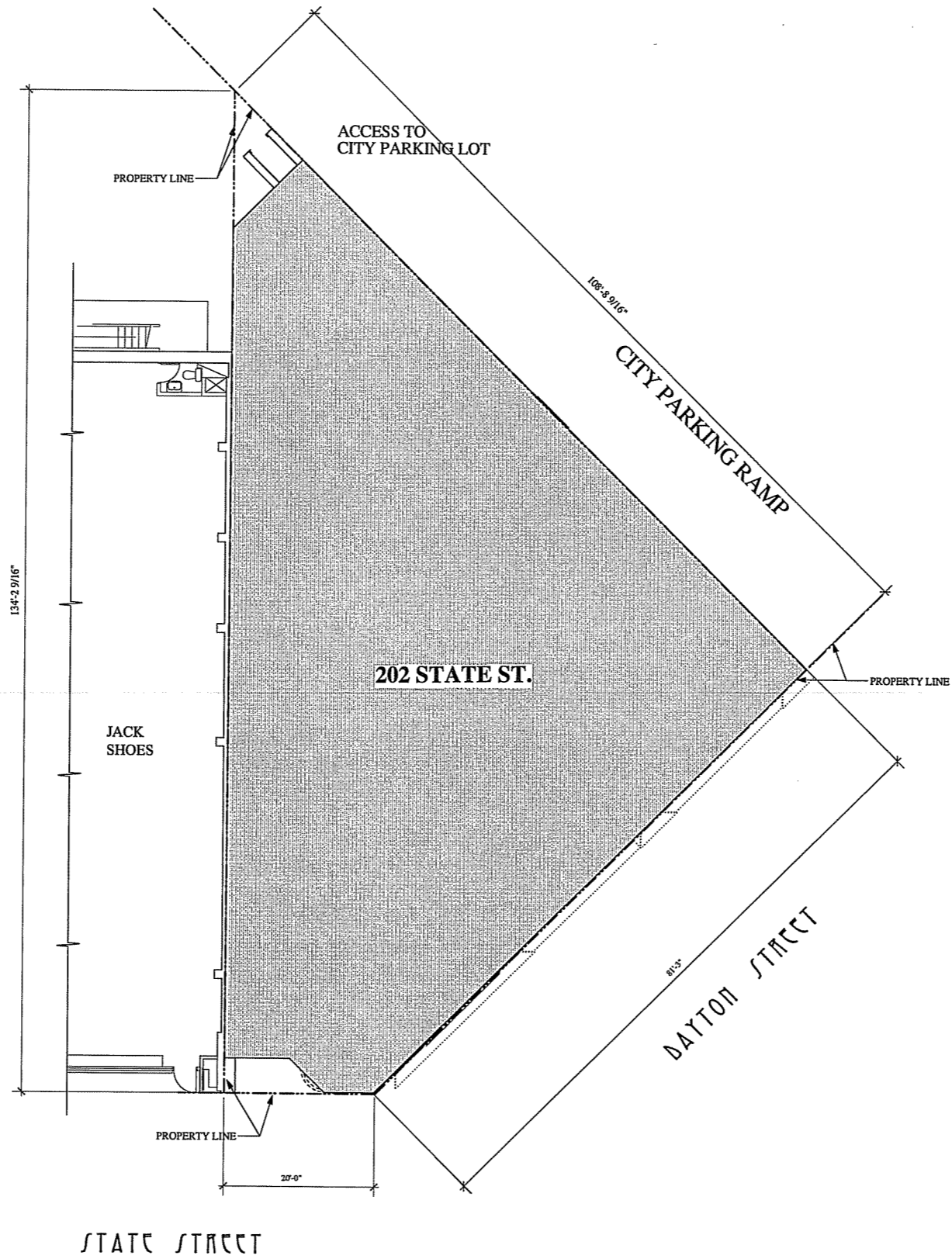

PROJECT:
FOURTH FLOOR ADDITION
&
FACADE
RENOVATION
TR:
**202
STATE
STREET**

MADISON, WISCONSIN

REVISIONS:

DATE: 1 MARCH 2006
SCALE: AS NOTED
50% @ 11x17
PROJECT: K0522
DRAWN BY: J.P. EKSTROM EJE

DRAWING NAME:





SITE PLAN

1 SITE PLAN
SP-1 Scale: 1" = 20 ft

DRAWING NUMBER:

SP-1.0

LEGEND

	EXISTING WALL TO REMAIN
	NEW EXTERIOR WALL
	NEW INTERIOR WALL
	EXISTING DOOR TO REMAIN
	NEW DOOR

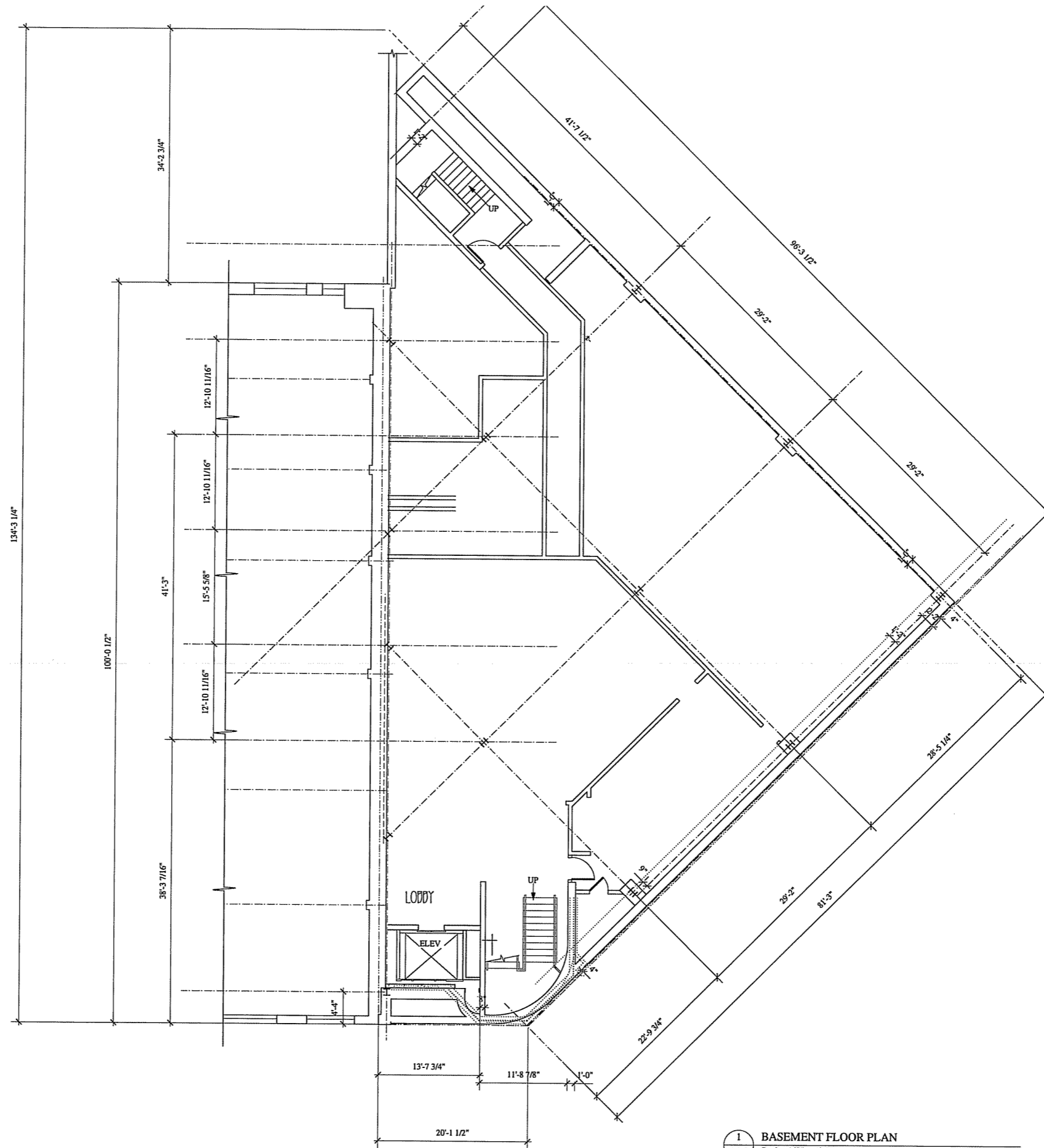

1 BASEMENT FLOOR PLAN
A1.0 Scale: 1/8" = 1'-0"

PROJECT:
FURTHER FLOOR ADDITION
&
FACADE
RENOVATION
TO:
**202
STATE
STREET**
MADISON, WISCONSIN





REVISIONS:

DATE: 1 MARCH 2006
SCALE: AS NOTED
50% @ 11x17
PROJECT: K0522
DRAWN BY: J.P. EKSTROM EJE
DRAWING NAME:

BASEMENT PLAN

DRAWING NUMBER:
A-1.0

LEGEND

	EXISTING WALL TO REMAIN
	NEW EXTERIOR WALL
	NEW INTERIOR WALL
	EXISTING DOOR TO REMAIN
	NEW DOOR

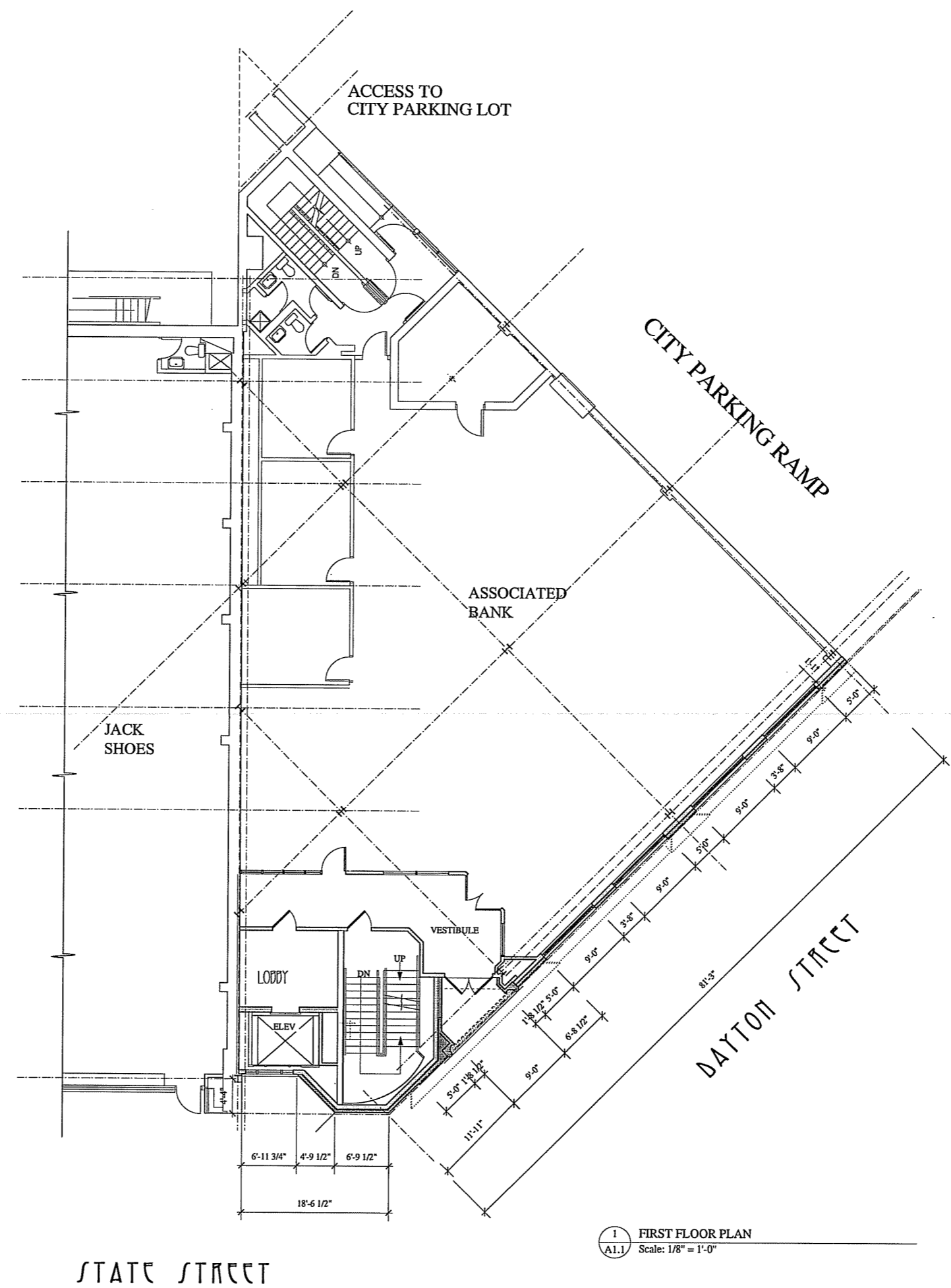

PROJECT:
FOURTH FLOOR ADDITION
&
FACADE
RENOVATION
TO:
**202
STATE
STREET**

MADISON, WISCONSIN

REVISIONS:

DATE: 1 MARCH 2006
SCALE: AS NOTED
50% @ 11/17
PROJECT: K0522
DRAWN BY: J.P. EKSTROM EJE
DRAWING NAME:





FIRST FLOOR
PLAN

1 FIRST FLOOR PLAN
A1.1 Scale: 1/8" = 1'-0"

DRAWING NUMBER:

A-1.1

LEGEND

	EXISTING WALL TO REMAIN
	NEW EXTERIOR WALL
	NEW INTERIOR WALL
	EXISTING DOOR TO REMAIN
	NEW DOOR

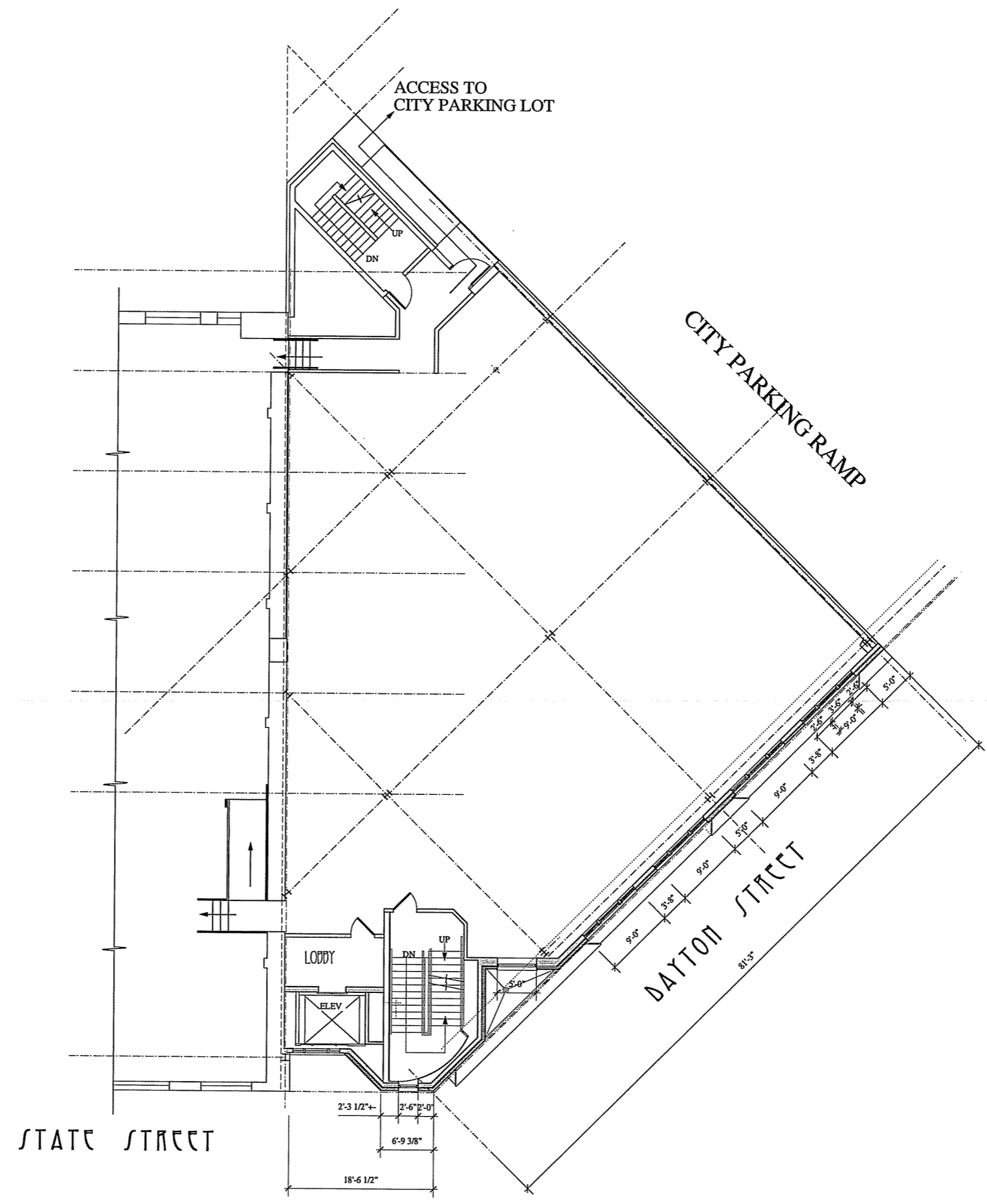

PROJECT:
 FOURTH FLOOR ADDITION
 &
 FACADE
 RENOVATION
 TO:
**202
 STATE
 STREET**
 MADISON, WISCONSIN

REVISIONS:

DATE: 1 MARCH 2006
 SCALE: AS NOTED
 50% @ 11x17
 PROJECT: K0522
 DRAWN BY: J.P. EKSTROM EJE
 DRAWING NAME:





SECOND FLOOR PLAN

DRAWING NUMBER:

A-1.2

1 SECOND FLOOR PLAN
 A1.2 Scale: 1/8" = 1'-0"

LEGEND

-  EXISTING WALL TO REMAIN
-  NEW EXTERIOR WALL
-  NEW INTERIOR WALL
-  EXISTING DOOR TO REMAIN
-  NEW DOOR

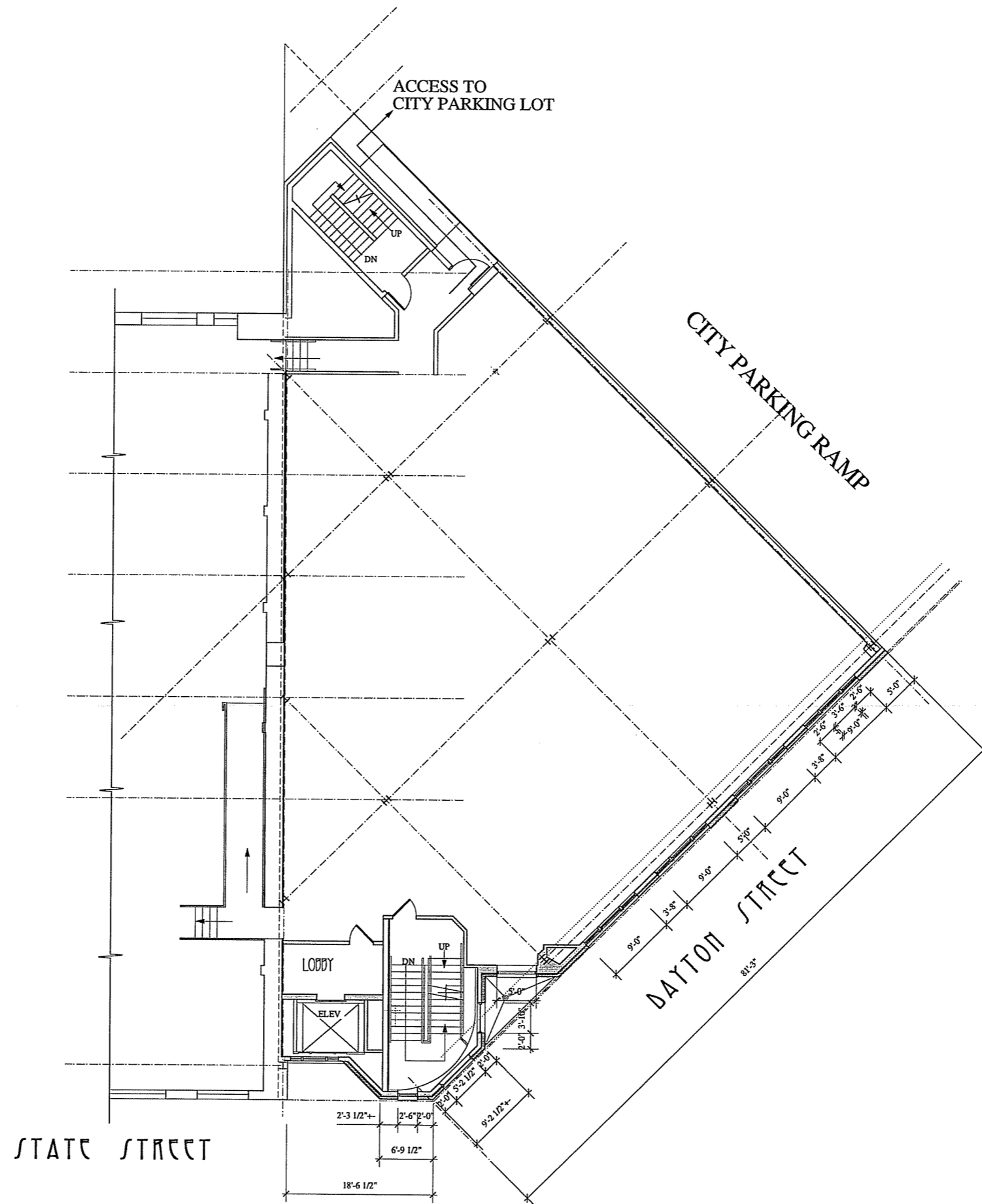

PROJECT:
FOURTH FLOOR ADDITION
&
FACADE
RENOVATION
TO
202
STATE
STREET
MADISON, WISCONSIN

REVISIONS:

DATE: 1 MARCH 2006
SCALE: AS NOTED
50% @ 11x17
PROJECT: K0522
DRAWN BY: J.P. EKSTROM EJE





DRAWING NAME:
**THIRD FLOOR
PLAN**

DRAWING NUMBER:

A-1.3

1 THIRD FLOOR PLAN
Scale: 1/8" = 1'-0"

LEGEND

	EXISTING WALL TO REMAIN
	NEW EXTERIOR WALL
	NEW INTERIOR WALL
	EXISTING DOOR TO REMAIN
	NEW DOOR

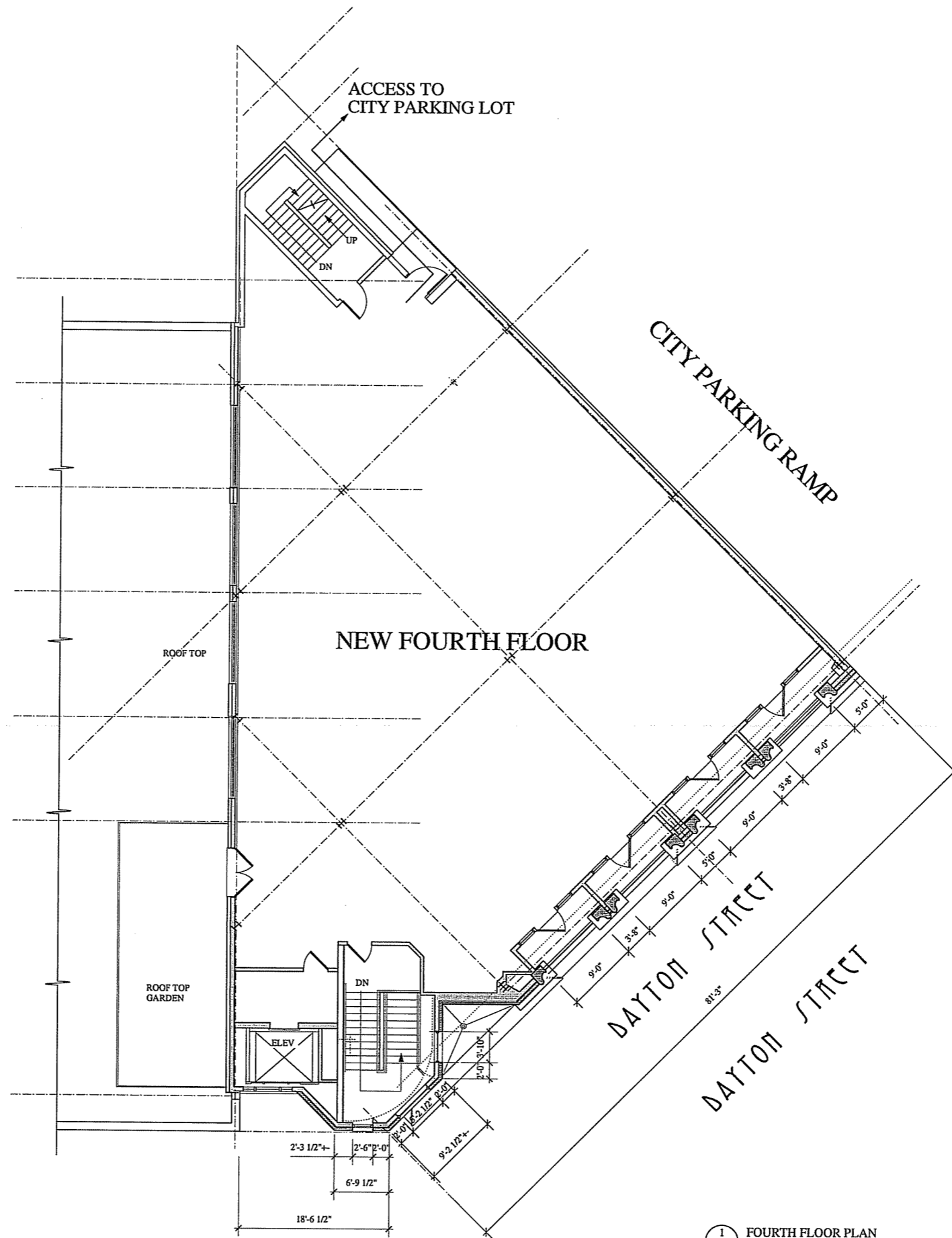

PROJECT:
FOURTH FLOOR ADDITION
&
FACADE
RENOVATION
TO:
**202
STATE
STREET**

MADISON, WISCONSIN

REVISIONS:

DATE: 1 MARCH 2006
SCALE: AS NOTED
50% @ 11x17
PROJECT: K0522
DRAWN BY: J.P. EKSTROM EJE
DRAWING NAME:

FOURTH FLOOR
PLAN

DRAWING NUMBER:

A-1.4

1 FOURTH FLOOR PLAN
A1.4 Scale: 1/8" = 1'-0"

STATE STREET

204 STATE ST. X 202 STATE ST.

202 STATE ST. X CITY RAMP

**architecture
network, inc.**

116 East Dayton Street
Madison, WI 53703
608-251-7515 Phone
608-251-7566 Fax
www.architecture-network.net

GENERAL EXTERIOR NOTES:

- 2x4 BRONZE STOREFRONT W/
SIMULATED DIVIDED LIGHT
- SALVAGED INDIANA LIMESTONE
- SALVAGED LIMESTONE PANELS
- BRONZE SPANDREL PANELS
- SALVAGED EXTERIOR LIGHTS

PROJECT:
FOURTH FLOOR ADDITION
&
FACADE
RENOVATION
TO:
**202
STATE
STREET**

MADISON, WISCONSIN

REVISIONS:

DATE: 1 MARCH 2006

SCALE: AS NOTED
50% @ 11x17

PROJECT: K0522

DRAWN BY: J.P. EKSTROM

DRAWING NAME:

EXTERIOR
ELEVATIONS

DRAWING NUMBER:

A-2.0

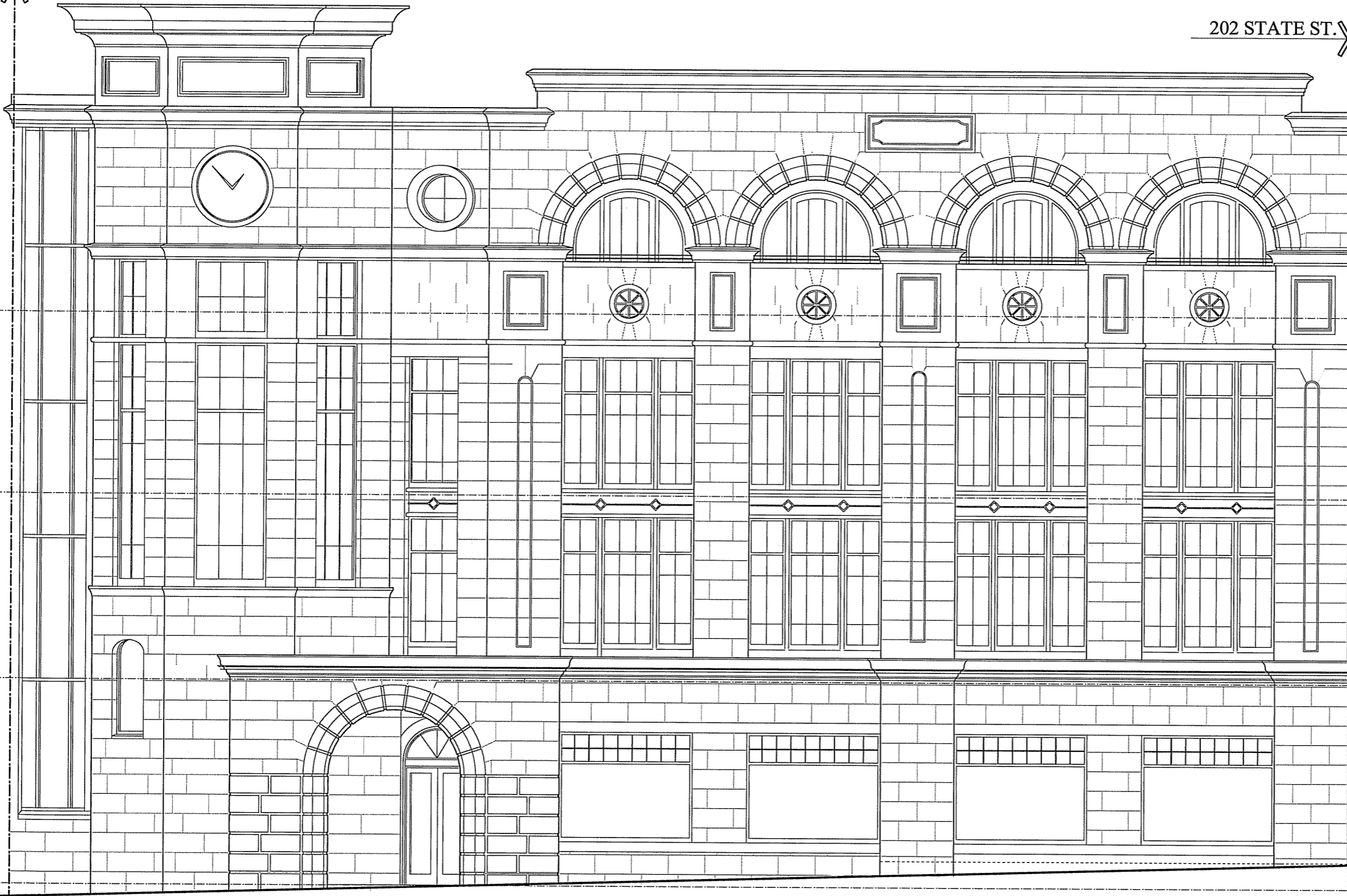

FOURTH FLOOR LINE
FINISHED ELEV 77'-1"

THIRD FLOOR LINE
FINISHED ELEV 64'-8"

SECOND FLOOR LINE
FINISHED ELEV 52'-0"

FIRST FLOOR LINE
FINISHED ELEV 38'-0"

BASEMENT FLOOR LINE
FINISHED ELEV 26'-0"

1 ELEVATION
A2.0 Scale: 1/4" = 1'-0"

GENERAL EXTERIOR NOTES:

2x4 BRONZE STOREFRONT W/
SIMULATED DIVIDED LIGHT

ALUMINUM STOREFRONT

SALVAGED INDIANA LIMESTONE

SALVAGED LIMESTONE PANELS

BRONZE SPANDREL PANELS



PROJECT: FOURTH FLOOR ADDITION
&
FACADE
RENOVATION

TO:
**202
STATE
STREET**

MADISON, WISCONSIN

REVISIONS:

DATE: 1 MARCH 2006

SCALE: AS NOTED
50% @ 11/17

PROJECT: K0522

DRAWN BY: J.P. EKSTROM

DRAWING NAME:

**EXTERIOR
ELEVATIONS**

DRAWING NUMBER:

A-2.1

PHASE TWO
204 STATE STREET
FUTURE RENOVATION

PHASE ONE
202 STATE STREET EXTERIOR RENOVATION
W/ NEW FOURTH FLOOR

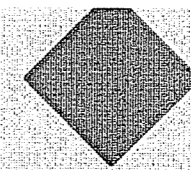

architecture
network, inc.



202 STATE STREET

MADISON - WISCONSIN

THE
RIFKEN
GROUP LTD

DEVELOPMENT
BROKERAGE