

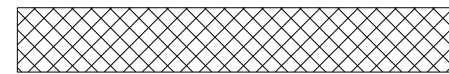

4018 MINERAL POINT ROAD
PREVIOUSLY APPROVED CHURCH DEMOLITION
LEGISTAR ID 35100
PLANNING COMMISSION 08/25/2014



4016 MINERAL POINT ROAD
ADJACENT PROPERTY PURCHASED FOR
ADDITIONAL DEVELOPMENT POTENTIAL
OF THE FUTURE MIDTOWN DISTRICT STATION
REQUESTING DEMOLITION APPROVAL OF THE
RESIDENTIAL STRUCTURE ON THIS PROPERTY

WESTMORLAND BLVD.

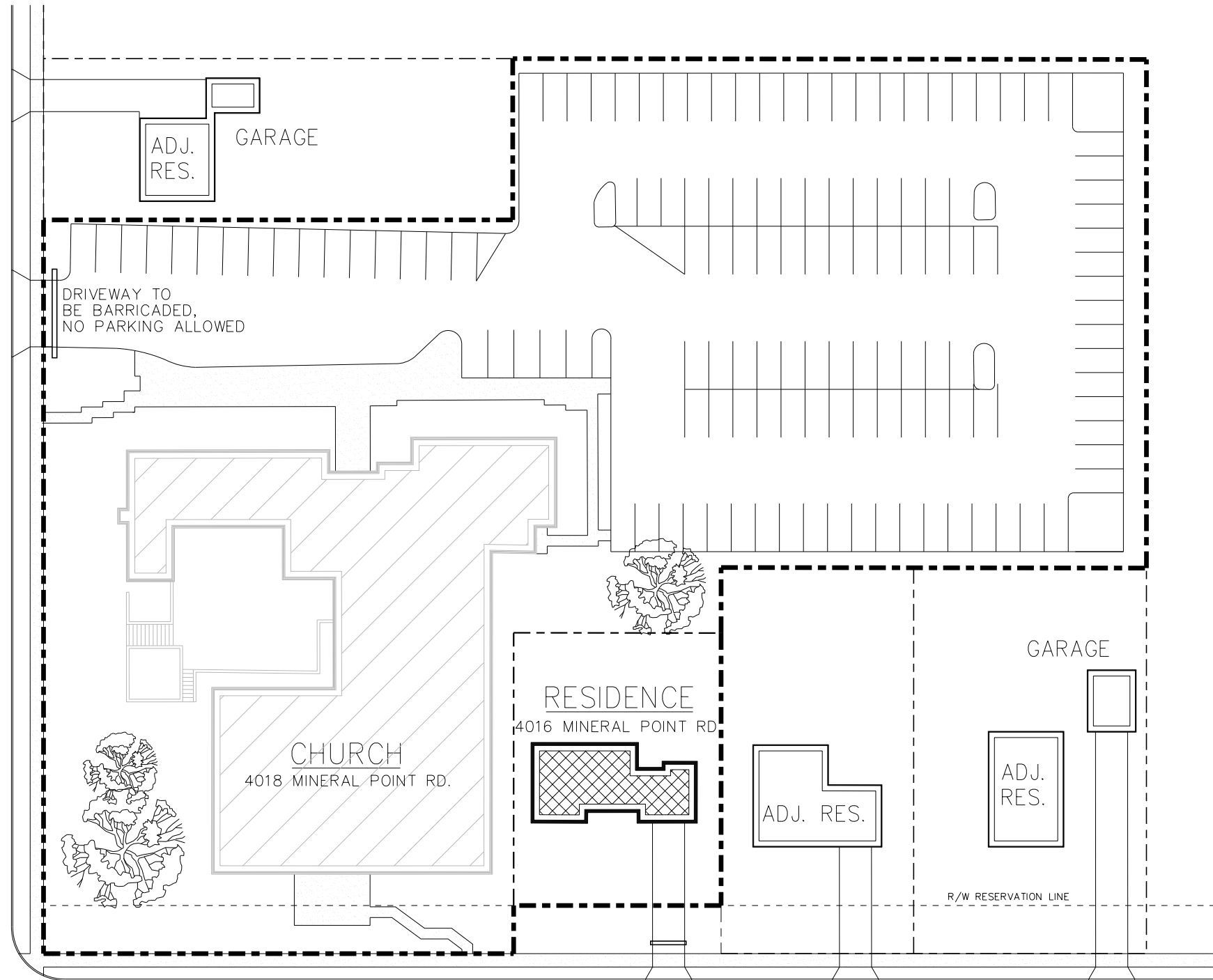

MINERAL POINT RD.

DRIVEWAY TO
BE BARRICADED,
NO PARKING ALLOWED

DEMOLITION SITE PLAN
MINERAL POINT ROAD
1" :: 50'-0" FEBRUARY 5, 2015

