

THE PLAN AND DESIGN ARE COPYRIGHT PROTECTED AND MAY NOT BE REPRODUCED OR TRANSMITTED IN ANY FORM OR BY ANY MEANS WITHOUT THE WRITTEN CONSENT OF JSD PROFESSIONAL SERVICES, INC.

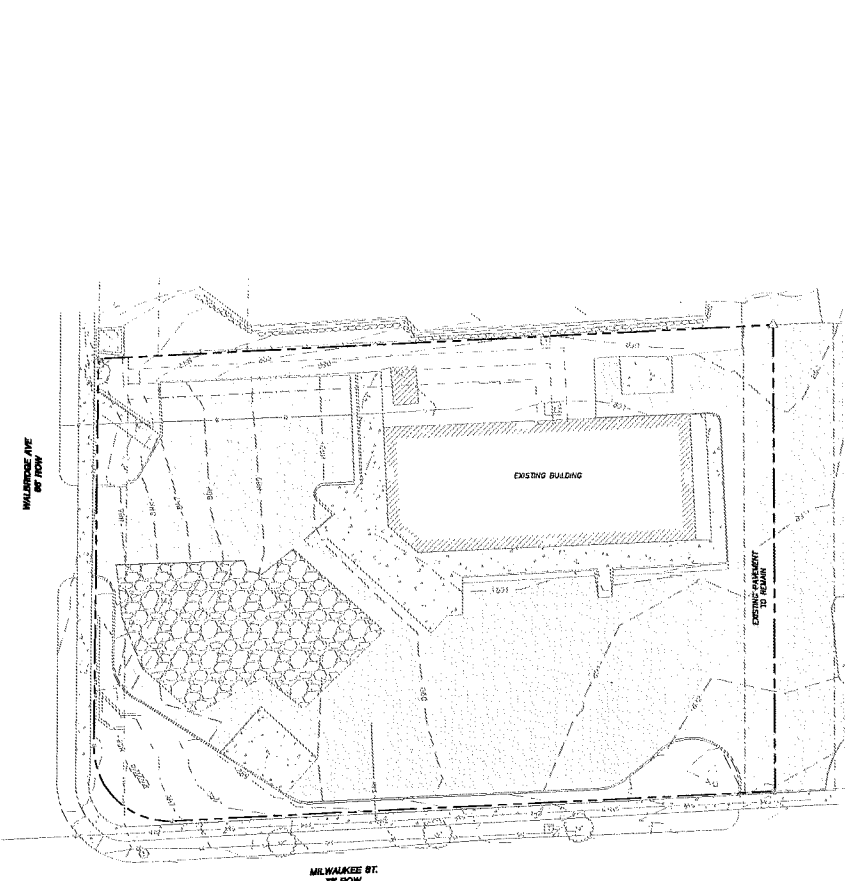

LEGEND (EXISTING)

- GOVERNMENT CORNER
- REAR FOUND (SIZE NOTED)
- SIGN
- SANITARY MANHOLE
- HYDRANT
- STORM MANHOLE
- CURB INLET
- WATER OR GAS VALVE
- MANHOLE
- ELECTRIC MANHOLE
- FENCE LINE
- EDGE OF PAVEMENT
- CONCRETE CURB & GUTTER
- EDGE OF GRAVEL
- WATER LINE
- SANITARY SEWER
- STORM SEWER
- NATURAL GAS
- INDEX CONTOUR
- BITUMINOUS PAVEMENT
- CONCRETE PAVEMENT
- UNDESIGNED GRAVEL OR ROCK

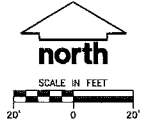

GENERAL NOTES

1. ALL WORK IN THE ROW SHALL BE IN ACCORDANCE WITH THE CITY OF MADISON STANDARD SPECIFICATIONS FOR PUBLIC WORKS CONSTRUCTION.
2. JSD SHALL BE HELD HARMLESS AND DOES NOT WARRANT ANY DEVIATIONS BY THE CONTRACTOR FROM THE APPROVED CONSTRUCTION PLANS THAT MAY RESULT IN DISPLEASANT ACTIONS BY ANY OF ALL REGULATORY AGENCIES.
3. DRAWING FOR REVIEW - NOT FOR CONSTRUCTION UNLESS OTHERWISE NOTED IN THE TITLE BLOCK.

DEMOLITION NOTES

1. ALL EXISTING BUILDINGS SHALL BE REMOVED INCLUDING UNDERGROUND CONCRETE AND UTILITIES.
2. ALL EXISTING PAVEMENT SHALL BE REMOVED.
3. THIS PLAN INDICATES ITEMS ON THE PROPERTY INTENDED FOR DEMOLITION BASED ON THE CURRENT SITE DESIGN THAT HAVE BEEN IDENTIFIED BY A REASONABLE OBSERVATION OF THE EXISTING CONDITIONS THROUGH FIELD SURVEY RECONNOISSANCE, "DIGGER'S HOTLINE" LOCATION, AND GENERAL "STANDARD OF CARE." THERE MAY BE ADDITIONAL ITEMS THAT CAN NOT BE IDENTIFIED BY A REASONABLE OBSERVATION OF WHICH THE ENGINEER WOULD HAVE NO KNOWLEDGE OR MAY BE A PART OF ANOTHER DESIGN DISCIPLINE. IT IS THE CONTRACTOR'S RESPONSIBILITY TO REVIEW THE PLANS, INSPECT THE SITE AND PROVIDE HIS OWN JUDGEMENT TO INCLUDE IN HIS BID WHAT ADDITIONAL ITEMS IN HIS OPINION, MAY BE NECESSARY FOR DEMOLITION. ADDITIONAL ITEMS IDENTIFIED BY THE CONTRACTOR/OWNER SHALL BE IDENTIFIED IN THE BID AND REPORTED TO THE ENGINEER OF RECORD. JSD TAKES NO RESPONSIBILITY FOR ITEMS ON THE PROPERTY THAT COULD NOT BE LOCATED BY A REASONABLE OBSERVATION OF THE PROPERTY OR OF WHICH THEY WOULD HAVE NO KNOWLEDGE.
4. ALL PERMITS OR SONIC CONTROL DEVICES SHALL BE INSTALLED PRIOR TO THE START OF DEMOLITION ACTIVITIES. CONTRACTOR SHALL KEEP ALL STREETS FREE AND CLEAR OF ALL CONSTRUCTION RELATED DIRT, DEBRIS, AND OBSTACLES.
5. PERFORM TREE PRUNING IN ALL LOCATIONS WHERE PROPOSED PAVEMENT AND/OR UTILITY INSTALLATION SUFFICIENTLY WITHIN THE EXISTING DUMP LINE OF THE TREES TO REMAIN. ALL PRUNING WITHIN THE EXISTING DUMP LINE OF THE TREES TO REMAIN SHALL BE DONE RADICALLY AWAY FROM THE TRUNK OR ROOTS IN EXCESS OF 1" DIAMETER ARE EXPOSED. ROOTS MUST BE CUT BY SURVIVABLE TREE PRUNING SERVICES FROM TO ANY TRANSDUCING TREES.
6. CONTRACTOR SHALL INSTALL TREE PROTECTION FENCING IN THE AREA BETWEEN THE CURB AND SIDEWALK AND EXTEND IT AT LEAST 5 FEET FROM BOTH SIDES OF THE TREE ALONG THE LENGTH OF THE TRENCH. NO EXCAVATION IS PERMITTED WITHIN 5 FEET OF THE OUTSIDE EDGE OF A TREE TRUNK. IF EXCAVATION WITHIN 5 FEET OF ANY TREE IS NECESSARY, CONTRACTOR SHALL CONTACT CITY FORESTRY PRIOR TO EXCAVATION TO ASSESS THE IMPACT TO THE TREE AND ROOT SYSTEM. TREE PRUNING SHALL BE COORDINATED WITH THE CITY FORESTRY TREE PROTECTION SPECIFICATIONS CAN BE FOUND IN THE CITY OF MADISON CONSTRUCTION SPECIFICATIONS.
7. ALL LIGHT POLES TO BE REMOVED SHALL BE REMOVED IN THEIR ENTIRETY, INCLUDING BASE AND ALL APPURTENANCES, COORDINATE RELOCATION AND/OR ABANDONMENT OF ALL ELECTRIC LINES WITH ELECTRICAL ENGINEER AND OWNER PRIOR TO DEMOLITION.
8. BUILDING REMOVALS SHALL BE BY A QUALIFIED CONTRACTOR. CONTRACTOR TO FOLLOW ALL DEMOLITION REGULATIONS, OBTAIN ALL UTILITIES, OBTAIN ALL APPLICABLE PERMITS AND DISPOSE OF ALL BUILDING MATERIALS IN APPROPRIATE LANDFILLS. NO PORTIONS OF THE BUILDING SHALL NOT BE BURIED ON SITE. ANY CONTAMINATED SOILS SHALL BE REMOVED TO A LANDFILL IN ACCORDANCE WITH APPROPRIATE STATE AND FEDERAL REGULATIONS. THE OWNER WILL PROVIDE ENVIRONMENTAL DOCUMENTATION AVAILABLE. THIS CONTRACTOR SHALL SUBMIT REQUIRED DEMOLITION PERMITS FROM THE CITY OF MADISON AND COMPLY WITH ALL LOCAL, STATE AND FEDERAL REGULATIONS.
9. ABANDONED/REMOVED ITEMS SHALL BE DISPOSED OF OFF SITE UNLESS OTHERWISE NOTED.
10. THE CONTRACTOR SHALL INSTALL A CONSTRUCTION FENCE AROUND ALL EXCAVATIONS TO BE LEFT OPEN OVERNIGHT AS REQUIRED.
11. CONTRACTOR TO REMOVE EXISTING UTILITY PIPE OR PROVIDE PIPE BACK-FILLING AFTER REMOVAL OF EXISTING UTILITIES WITHIN BUILDING FOOTPRINT USING LOW DENSITY CONCRETE/FLOWABLE FILL.
12. RESTORATION OF THE EXISTING ROADWAY RIGHT-OF-WAYS ARE CONSIDERED INCIDENTAL AND SHOULD BE PART OF THE COST OF THE UNDERGROUND IMPROVEMENTS, DEMOLITION AND REMOVAL. THIS INCLUDES CURB & GUTTER, SIDEWALK, TOPSOIL, SEEDING AND MULCHING.
13. GRANULAR BACKFILL MATERIALS ARE REQUIRED IN ALL UTILITY TRENCHES UNDER SIDEWALKS AND PROPOSED PARKED AREAS. ALL UTILITY TRENCH BACKFILL SHALL BE COMPACTED PER SPECIFICATIONS.
14. PRIOR TO CONSTRUCTION, THE CONTRACTOR IS RESPONSIBLE FOR:
 - EXAMINING ALL SITE CONDITIONS RELATIVE TO THE CONDITIONS INDICATED ON THE ENGINEERING DRAWINGS. ANY DISCREPANCIES ARE TO BE REPORTED TO THE ENGINEER AND RESOLVED PRIOR TO THE START OF CONSTRUCTION.
 - VERIFYING UTILITY ELEVATIONS AND NOTIFYING ENGINEER OF ANY DISCREPANCIES. NO WORK SHALL BE PERFORMED UNTIL THE DISCREPANCIES ARE RESOLVED.
 - NOTIFYING ALL UTILITIES PRIOR TO THE REMOVAL OF ANY UNDERGROUND UTILITIES.
 - NOTIFYING THE DESIGN ENGINEER AND LOCAL CONTROLLING MUNICIPALITY 48 HOURS PRIOR TO THE START OF CONSTRUCTION TO ARRANGE FOR APPROPRIATE CONSTRUCTION INSPECTION.
9. ANY SANITARY SEWER, SANITARY SEWER SERVICES, WATER MAIN, WATER SERVICES, STORM SEWER, OR OTHER UTILITIES WHICH ARE DAMAGED BY THE CONTRACTORS, SHALL BE REPAIRED TO THE OWNER'S SATISFACTION AT THE CONTRACTOR'S EXPENSE.
10. CONTRACTOR IS RESPONSIBLE FOR SITE SAFETY DURING THE CONSTRUCTION OF THESE IMPROVEMENTS.
11. WATER ABANDONMENT SHALL BE IN ACCORDANCE WITH SECTION 4.14.0 OF THE STANDARD SPECIFICATIONS FOR WATER AND SEWER CONSTRUCTION IN WISCONSIN, LATEST EDITION AND CITY OF MADISON STANDARDS.
12. SEWER ABANDONMENT SHALL BE IN ACCORDANCE WITH SECTION 3.2.24 OF THE STANDARD SPECIFICATIONS FOR WATER AND SEWER CONSTRUCTION IN WISCONSIN, LATEST EDITION AND CITY OF MADISON STANDARDS.
13. CONTRACTOR TO COORDINATE PRIVATE UTILITY REMOVAL / ABANDONMENT AND NECESSARY RELOCATION WITH RESPECTIVE UTILITY COMPANY. COORDINATION REQUIRED PRIOR TO CONSTRUCTION. ALL INCLUDES WATER AND SEWER SERVICES SHALL BE FIELD MARKED FOR LOCAL SIZE AND INVERT PRIOR TO CONSTRUCTION. THESE SHOULD BE REMOVED IF LOCATED WITHIN THE BUILDING FOOTPRINT AND REMOVED OR ABANDONED IF LOCATED OUTSIDE OF THE BUILDING FOOTPRINT. THE CONTRACTOR SHALL SHUT THE CORPORATION VALVE AT THE MAIN AS PART OF THE ABANDONMENT/RECONNECTION.
14. THE CONTRACTOR SHALL PREPARE AND SUBMIT FOR APPROVAL A CITY OF MADISON RECYCLING PLAN PRIOR TO CONSTRUCTION.

JSD Professional Services, Inc.
 • Engineers • Surveyors • Planners

"BUILDING RELATIONSHIPS WITH A COMMITMENT TO EXCELLENCE THROUGH TECHNICAL TRUST, QUALITY AND EXPERIENCE"

- CIVIL ENGINEERING
- SURVEYING & MAPPING
- CONSTRUCTION SERVICES
- WATER RESOURCES
- PLANNING & DEVELOPMENT
- TRANSPORTATION ENGINEERING
- STRUCTURAL ENGINEERING
- LANDSCAPE ARCHITECTURE

MADISON REGIONAL OFFICE
 701 HERSHORN DRIVE, SUITE 101
 VERONA, WISCONSIN 53593
 608.948.5500 / PHONE 608.948.2255 FAX
 MADISON | MILWAUKEE
 KENOSHA | APPLETON
 www.jsdinc.com

SERVICES PROVIDED TO:
KRUPP CONSTRUCTION

PROJECT:
PDQ DEMOLITION

PROJECT LOCATION:
 DANE COUNTY, WI
 JSD PROJECT NO.: 14-0321

SEAL/GUARANTEE:

ALTHOUGH EVERY EFFORT HAS BEEN MADE IN PREPARING THESE PLANS AND CHECKING THEM FOR ACCURACY, THE CONTRACTOR AND SUBCONTRACTORS MUST CHECK ALL DETAILS AND DIMENSIONS OF THEIR TRADE AND BE RESPONSIBLE FOR THE SAME.

DESIGN	USG	08-11-14
DRAWING	USG	09-11-14
APPROVED:		
PLAN MODIFICATIONS:		DATE:

DIGGERS HOTLINE

Toll Free (800) 242-8811
 Madison: 608.948.2255
 Hearing Impaired TDD (800) 542-8269
 www.DiggersHotline.com

SHEET TITLE:
**SITE PLAN
 EXISTING CONTOURS**

SHEET NUMBER:
C100

FILE: J:\Projects\140612\140612.dwg - 140612.dwg - 140612.dwg - 140612.dwg - 140612.dwg

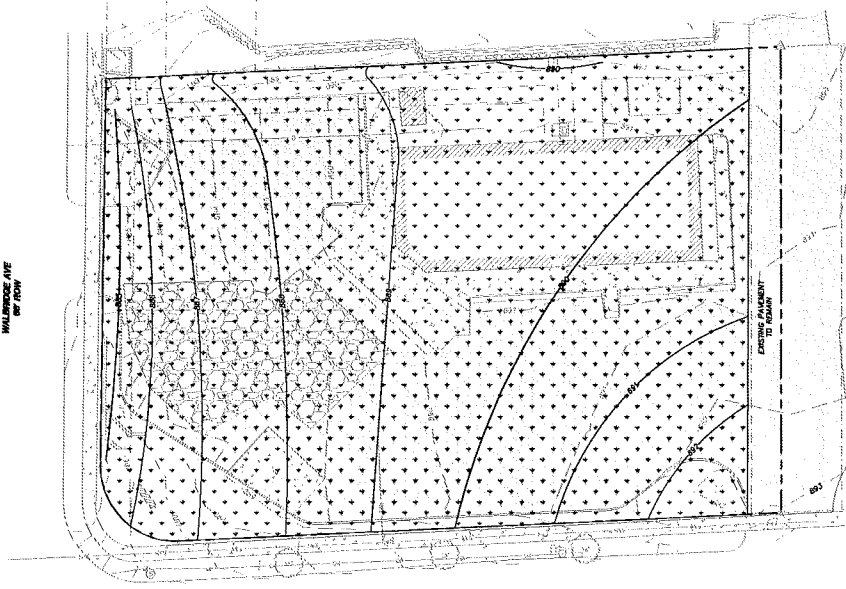

MILWAUKEE ST.
75' ROW

LEGEND (EXISTING)

- GOVERNMENT CORNER
- REAR FOUND (SIZE NOTED)
- SIGN
- SANITARY MANHOLE
- HYDRANT
- STORM MANHOLE
- CURB INLET
- WATER OR GAS VALVE
- MANHOLE
- ELECTRIC MANHOLE
- FENCE LINE
- EDGE OF PAVEMENT
- CONCRETE CURB & GUTTER
- EDGE OF GRAVEL
- SANITARY SEWER
- WATER LINE
- STORM SEWER
- NATURAL GAS
- INDEX CONTOUR
- BITUMINOUS PAVEMENT
- CONCRETE PAVEMENT
- GRAVEL OR ROCK

LEGEND (PROPOSED)

- PROPERTY LINE
- PROPOSED 1 FOOT CONTOUR
- PROPOSED 3 FOOT CONTOUR
- GRASS

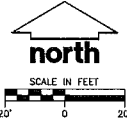

GENERAL NOTES

1. ALL WORK IN THE ROW SHALL BE IN ACCORDANCE WITH THE CITY OF MADISON STANDARD SPECIFICATIONS FOR PUBLIC WORKS CONSTRUCTION.
2. JSD SHALL BE HELD HARMLESS AND DOES NOT WARRANT ANY DEVIATIONS BY THE DRAFTER/CONTRACTOR FROM THE APPROVED CONSTRUCTION PLANS THAT MAY RESULT IN DISCREPANCY ACTIONS BY ANY OF ALL REGULATORY AGENCIES.
3. DRAWING FOR REFERENCE - NOT FOR CONSTRUCTION UNLESS OTHERWISE NOTED IN THE TITLE BLOCK.

GRADING/LANDSCAPING NOTES

1. THE CONTRACTOR SHALL PROVIDE A MINIMUM OF 4" TOPSOIL PRIOR TO SEEDING. SELECT FILL SHALL BE USED IF FILL IS REQUIRED TO MEET PROPOSED GRADE AND COMPACTED TO 95% OF STANDARD PROCTOR DENSITY.
2. ALL DISTURBED AREAS SHALL BE SEEDED AND MULCHED AFTER DEMOLITION AND GRADING ACTIVITIES HAVE BEEN COMPLETED.

JSD Professional Services, Inc.
 Engineers • Surveyors • Planners

AN EQUAL OPPORTUNITY FIRM WITH A COMMITMENT TO CLIENTS' SATISFACTION THROUGH TRUST, INTEGRITY AND EXPERIENCE™

- CIVIL ENGINEERING
- SURVEYING & MAPPING
- CONSTRUCTION SERVICES
- WATER RESOURCES
- PLANNING & DEVELOPMENT
- TRANSPORTATION ENGINEERING
- STRUCTURAL ENGINEERING
- LANDSCAPE ARCHITECTURE

MADISON REGIONAL OFFICE
 761 HORIZON DRIVE, SUITE 101
 VERONA, WISCONSIN 53593
 608.848.5500 PHONE | 608.848.2258 FAX
 MADISON | MILWAUKEE
 KENOSHA | APPLETON
 www.jsdinc.com

SERVICES PROVIDED TO:
KRUPP CONSTRUCTION

PROJECT:
PDQ DEMOLITION

PROJECT LOCATION:
 DANE COUNTY WI
 JSD PROJECT NO.: 14-6321

SEAL/SIGNATURE:

ALTHOUGH EVERY EFFORT HAS BEEN MADE IN PREPARING THESE PLANS AND CHECKING THEM FOR ACCURACY, THE CONTRACTOR AND SUBCONTRACTORS MUST CHECK ALL DETAILS AND DIMENSIONS OF THEIR TRADE AND BE RESPONSIBLE FOR THE SAME.

DESIGN	USD	08-11-14
DRAWN	USG	08-11-14
APPROVED:		

PLAN MODIFICATIONS:	DATE:

DIGGERS & HOTLINE
 Toll Free (800) 242-8511
 Madison Area (608) 251-1151
 Heating/Insulation TDD (563) 542-2299
 www.DiggersandHotline.com

SHEET TITLE:
LANDSCAPING PLAN

SHEET NUMBER:
C100

THESE PLANS AND DESIGN ARE COPYRIGHT PROTECTED AND ANY NOT BE USED IN WHOLE OR IN PART WITHOUT THE WRITTEN CONSENT OF JSD PROFESSIONAL SERVICES, INC.