

PHOTO SIMULATION NOTES:

- THESE PHOTO SIMULATIONS ARE AN INTERPRETATION OF THE GENERAL APPEARANCE OF THE PROPOSED INSTALLATION. EACH PHOTO SIMULATION IS BASED ON THE SCALING CRITERIA OR ASSUMPTIONS IDENTIFIED
- THE FINAL TOWER DESIGN AND DIMENSIONS WERE NOT AVAILABLE AT THE TIME THE PHOTO SIMULATION WAS PREPARED. THEREFORE, A TYPICAL TOWER/ANTENNA OF SIMILAR SIZE WAS UTILIZED FOR SIMULATION PURPOSES
- AN OBJECT OF KNOWN HEIGHT WAS NOT AVAILABLE FOR REFERENCE IN THE DIRECT VICINITY OF THE TOWER LOCATION, LIMITING RELIABILITY OF THE HEIGHT INTERPRETATION
- THE HORIZON LINE AT THE PROPOSED TOWER BASE IS NOT VISIBLE; A HORIZON LINE HAS BEEN ESTIMATED AT THE TOWER BASE FOR THE PHOTO SIMULATIONS
- ARTISTIC INTERPRETATIONS UTILIZED TO ESTIMATE THE APPROXIMATE TOWER SIZE AND APPEARANCE
- PHOTO SIMULATIONS GENERATED USING A SIMILAR TOWER OF SIMILAR HEIGHT AT A SIMILAR DISTANCE; ARTISTIC INTERPRETATIONS UTILIZED TO ESTIMATE THE APPROXIMATE TOWER SIZE AND APPEARANCE

PHOTO LOCATION DESCRIPTION:

- PHOTO SIM 1**
- TAKEN FROM PARKING LOT NEAR U.W. HEALTH BUILDING
- APPROXIMATE ELEVATION OF PHOTOGRAPH LOCATION
- GROUND ELEVATION: 1074', TOWER ELEVATION: 1073'
- PHOTO SIM 2**
- TAKEN FROM PARKING LOT NEAR BEST BUY BUILDING
- APPROXIMATE ELEVATION OF PHOTOGRAPH LOCATION
- GROUND ELEVATION: 1070', TOWER ELEVATION: 1073'
- PHOTO SIM 3**
- TAKEN FROM THE TURN AROUND OF THE ZOR SHRINE PL
- APPROXIMATE ELEVATION OF PHOTOGRAPH LOCATION
- GROUND ELEVATION: 1078', TOWER ELEVATION: 1073'
- PHOTO SIM 4**
- TAKEN FROM ZOR SHRINE ST. & POINT ST.
- APPROXIMATE ELEVATION OF PHOTOGRAPH LOCATION
- GROUND ELEVATION: 1081', TOWER ELEVATION: 1073'
- PHOTO SIM 5**
- TAKEN FROM ZOR SHRINE PL AND BUILDING
- APPROXIMATE ELEVATION OF PHOTOGRAPH LOCATION
- GROUND ELEVATION: 1081', TOWER ELEVATION: 1073'
- PHOTO SIM 6**
- TAKEN FROM WEST BELTLINE HWY 12 / 14
- APPROXIMATE ELEVATION OF PHOTOGRAPH LOCATION
- GROUND ELEVATION: 1092', TOWER ELEVATION: 1073'



PHOTO SIMULATION ZOR (#782483) MADISON, WISCONSIN

SHEET TITLE	BLUE DATE
	PHOTO SIMS - 5/27/09
	PHOTO SIMS - 8/22/09
REVISIONS	
DESIGNED BY	JAH
CHECKED BY	ASH
PLotted DATE	10/27/2009
PROJECT NUMBER	3293
FILE NAME	AS1.dgn
SHEET NUMBER	AS-1



PHOTO SIMULATION DESCRIPTION:
 FOLLOWING UTILIZED FOR PHOTO SIMULATION
 -PHOTOGRAPH OF EXISTING LIGHT POLE UTILIZED
 FOR PHOTO SIMULATION
 -PHOTOGRAPH ESTIMATED AT APPROX. 225'
 AWAY FROM TOWER LOCATION
 -EXISTING LIGHT POLE IN PHOTO UTILIZED
 AND ESTIMATED AT 25' IN HEIGHT



ACTUAL PHOTO DESCRIPTION:
 FOLLOWING UTILIZED FOR PHOTO SIMULATION
 -EXISTING PHOTOGRAPH FOR PHOTO SIMULATION
 -PHOTOGRAPH ESTIMATED AT APPROX. 225'
 AWAY FROM TOWER LOCATION

Edge
 Consulting Engineers, Inc.
 600 N. Loc. St. #100
 Madison, WI 53703
 608.261.1494 voice
 608.261.1000 fax
 www.edgeconsult.com

PHOTO SIMULATION

ZOR [#782483]

MADISON, WISCONSIN

SHEET TITLE

ISSUE DATE

PHOTO SIM - 5/27/09

PHOTO SIM - 12/25/09

REVISIONS

DESIGNED BY

JAS

CHECKED BY

ASB

PLT DATE

10/27/2009

PROJECT NUMBER

3013

FILE NAME

PS-021

SHEET NUMBER

PS-2

PHOTO SIMULATION DESCRIPTION:

FOLLOWING UTILIZED FOR PHOTO SIMULATION
-PHOTOGRAPH OF EXISTING LIGHT POLE UTILIZED
FOR PHOTO SIMULATION
-PHOTOGRAPH ESTIMATED AT APPROX. 575'
AWAY FROM TOWER LOCATION

TOP OF PROPOSED 70' LIGHT POLE NOT VISIBLE

APPROXIMATE
HORIZON LINE



ACTUAL PHOTO DESCRIPTION:

FOLLOWING UTILIZED FOR PHOTO SIMULATION
-EXISTING PHOTOGRAPH FOR PHOTO SIMULATION
-PHOTOGRAPH ESTIMATED AT APPROX. 575'
AWAY FROM TOWER LOCATION

© 1994 CORALINE BAKERS INC.

புது-ய

[illegible]

SHEET TITLE:

PHOTO SIMULATION
ZOR [#782483]
MADISON, WISCONSIN





PHOTO SIMULATION DESCRIPTION:

FOLLOWING UTILIZED FOR PHOTO SIMULATION
 -PHOTOGRAPH OF EXISTING LIGHT POLE UTILIZED FOR PHOTO SIMULATION
 -PHOTOGRAPH ESTIMATED AT APPROX. 1125' AWAY FROM TOWER LOCATION
 -EXISTING REI BUILDING IN PHOTO UTILIZED AND ESTIMATED AT 25' IN HEIGHT

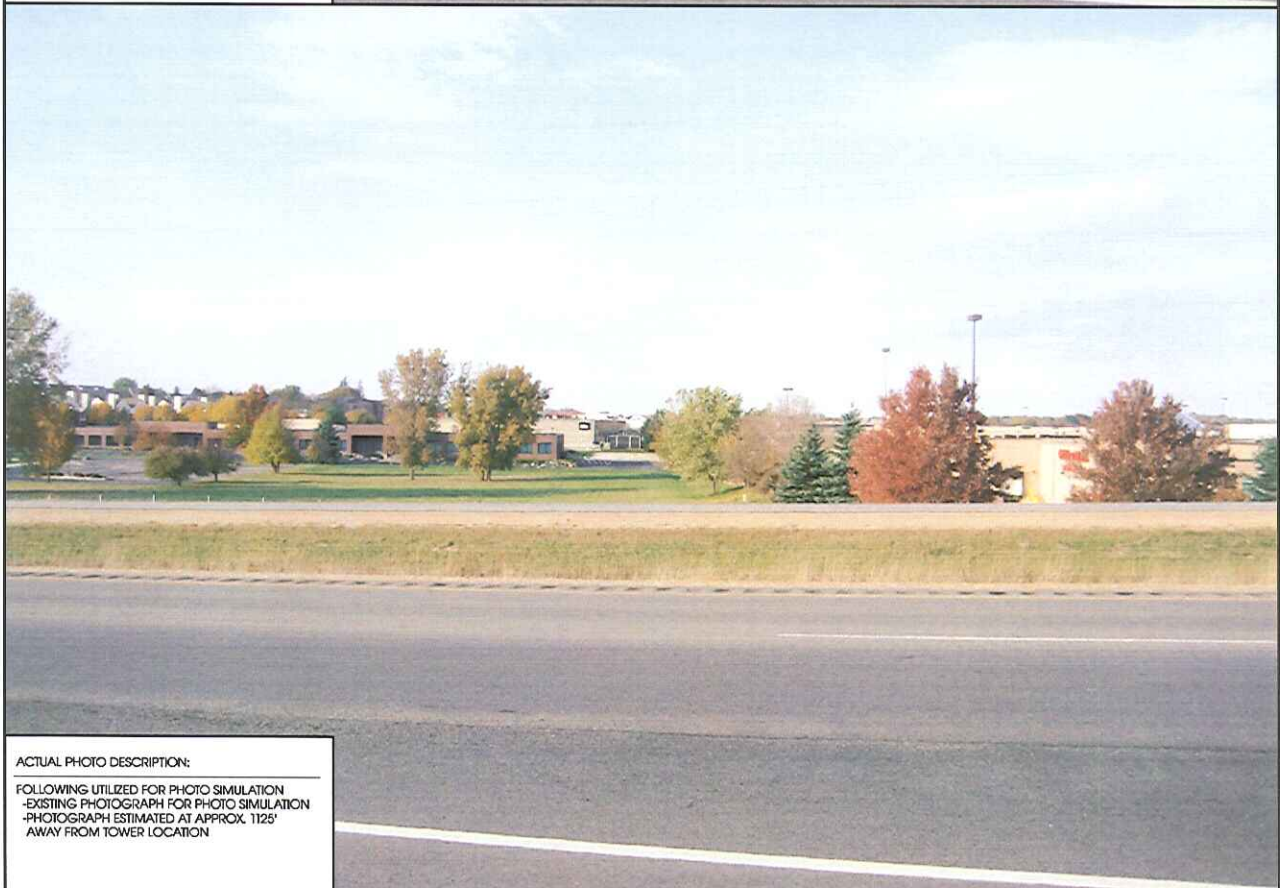

ACTUAL PHOTO DESCRIPTION:

FOLLOWING UTILIZED FOR PHOTO SIMULATION
 -EXISTING PHOTOGRAPH FOR PHOTO SIMULATION
 -PHOTOGRAPH ESTIMATED AT APPROX. 1125' AWAY FROM TOWER LOCATION

PHOTO SIMULATION
ZOR [#782483]
MADISON, WISCONSIN