

Madison, Wisconsin

CITY OF MADISON

CITY ENGINEERING DIVISION DEPARTMENT OF PUBLIC WORKS

PLAN OF PROPOSED IMPROVEMENT

PUBLIC IMPROVEMENT PROJECT APPROVED
MAY 15, 2012
BY THE COMMON COUNCIL
OF MADISON, WISCONSIN

PUBLIC IMPROVEMENT DESIGN
APPROVED BY:

City Engineer 6/1/12
Date

LAKE EDGE BASIN REPAIR

CITY OF MONONA

INDEX OF SHEETS

SHEET NO.	TITLE
1	GRADING PLAN & BERM DETAIL

CITY PROJECT NO. 53W1094
CONTRACT NO. 6744

DESIGNED BY:

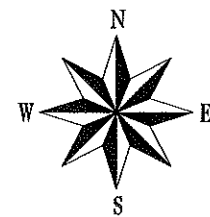
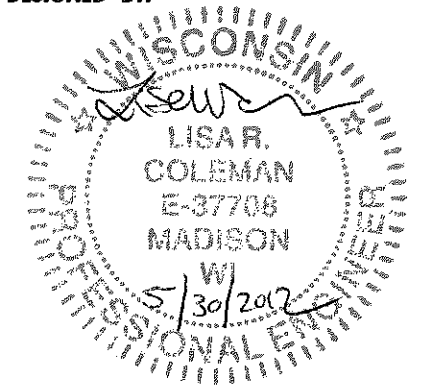

**PROJECT
LOCATION**
4115 MONONA DRIVE

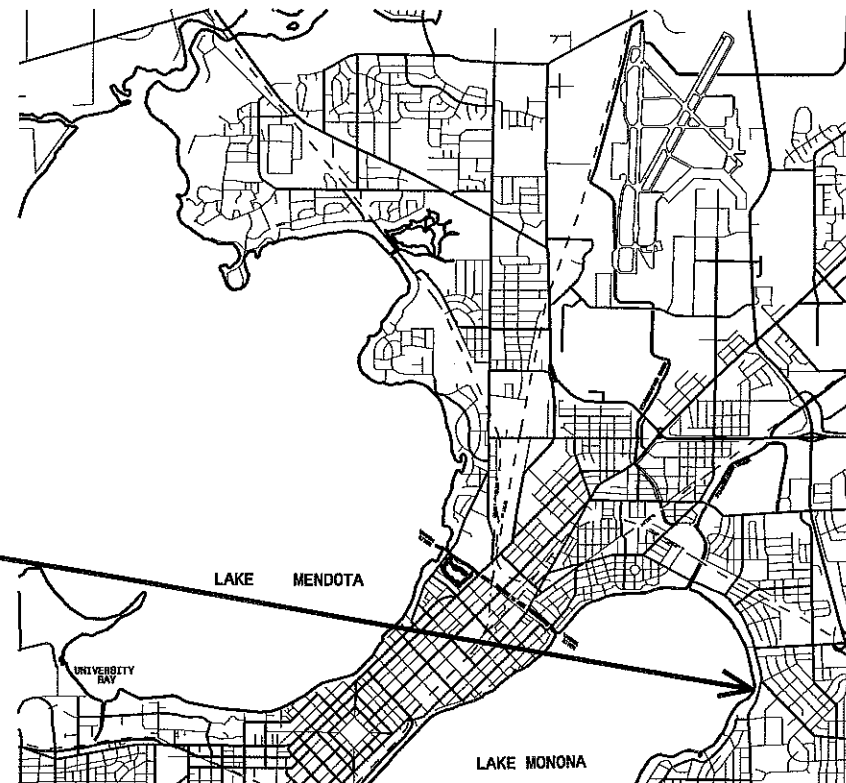

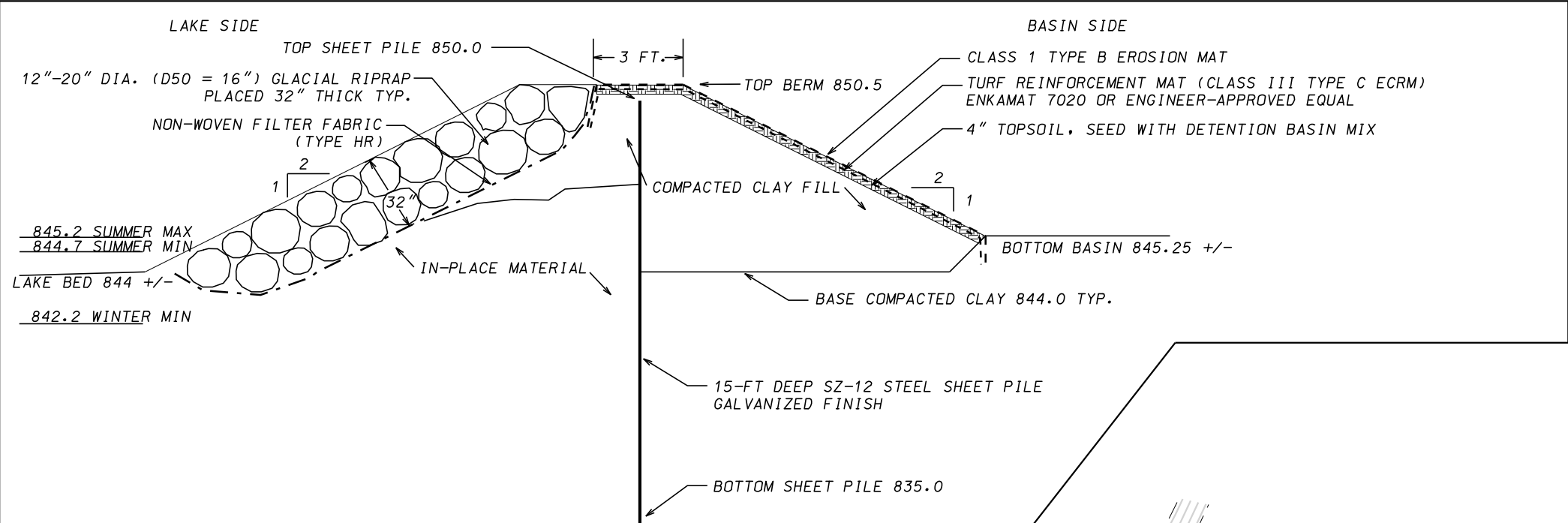

- EROSION CONTROL NOTES:**
1. ALL DISTURBED AREAS SHALL BE RESTORED WITH TOPSOIL, SEED, AND ECRM.
 2. RIPRAP TO BE INSTALLED AT THE LOCATIONS SHOWN ON THE PLAN.
 3. TURF REINFORCEMENT MAT (CLASS III TYPE C) TO BE INSTALLED IN THE LOCATIONS SHOWN. TRM SHALL BE FILLED WITH TOPSOIL AND COVERED WITH CLASS 1 TYPE B ECRM.
 4. TEMPORARY POLYMER STABILIZATION SHALL BE INCLUDED AS DIRECTED BY THE CONSTRUCTION ENGINEER.
 5. THE PROJECT SITE SHALL BE INSPECTED FOR EROSION CONTROL WEEKLY AND WITHIN 24 HOURS OF A RAINFALL GREATER THAN 0.5 INCHES.

4113 MONONA DR.
STELLHORN & MILLER

CP COORDINATES (CUT X)
837063.18, 484335.16, 853.97

CHISELED X
837063.05, 484334.75

BERM REPAIR SECTION A-A'
NOT TO SCALE

LEGEND

- RIPRAP
- TURF REINFORCEMENT MAT (ECRM CLASS III TYPE C) COVERED WITH CLASS 1 TYPE B ECRM AND SEEDED WITH DETENTION BASIN MIX
- APPROX ZONE FOR REMOVAL OF ARTICULATED CONCRETE

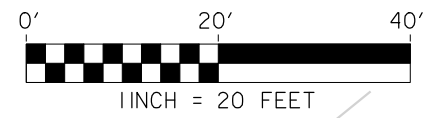

Edge of Water
Water Elev. = 845.63
Oct. 14, 2010

LAKE MONONA

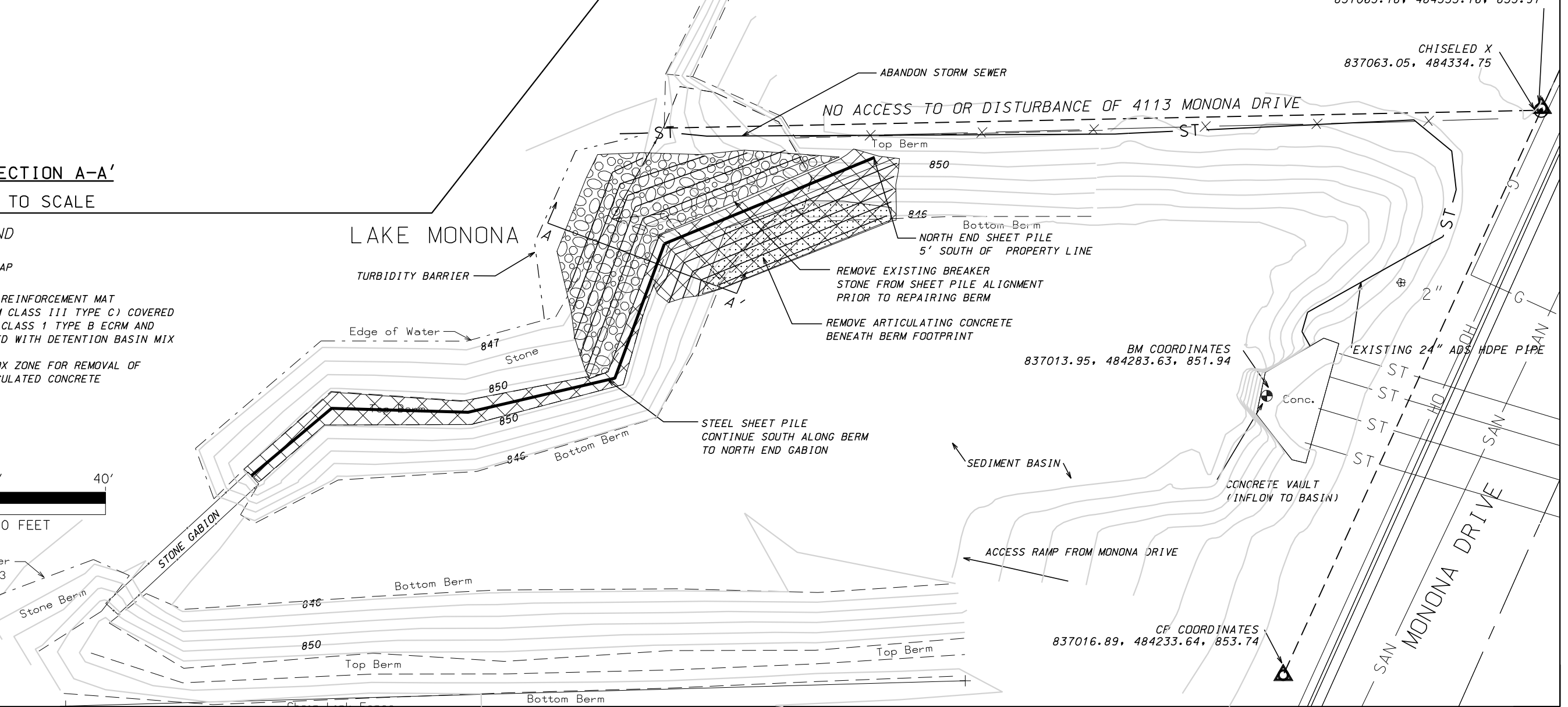

BM COORDINATES
837013.95, 484283.63, 851.94

CP COORDINATES
837016.89, 484233.64, 853.74

PLOT SCALE:

PLOT NAME:

REV. DATE:

ORIGINATOR: CITY OF MADISON, STREETS DIVISION