

BID OF _____

2012

PROPOSAL, CONTRACT, BOND AND SPECIFICATIONS

FOR

**WEST GORHAM STREET, N. HENRY STREET & N. FRANCES STREET
ASSESSMENT DISTRICT - 2012**

CONTRACT NO. 6785

IN

MADISON, DANE COUNTY, WISCONSIN

AWARDED BY THE COMMON COUNCIL
MADISON, WISCONSIN ON _____

PLEASE RETURN PLANS AND SPECIFICATIONS TO:

**CITY ENGINEERING DIVISION
1600 EMIL STREET
MADISON, WISCONSIN 53713**

www.cityofmadison.com/business/pw

**WEST GORHAM STREET, N. HENRY STREET & N. FRANCES STREET
ASSESSMENT DISTRICT - 2012
CONTRACT NO. 6785**

INDEX

SECTION A: ADVERTISEMENT FOR BIDS A-1
SECTION B: INSTRUCTIONS TO BIDDERSB-1
SECTION C: SBEC-1
SECTION D: SPECIAL PROVISIONS..... D-1
SECTION E: PROPOSALE-1
SECTION F: BID BOND..... F-1
SECTION G: AGREEMENT..... G-1
SECTION H: PAYMENT AND PERFORMANCE BOND H-1
SECTION I: PREVAILING WAGE RATEI-1

This Proposal, and Agreement have
been prepared by:

**CITY ENGINEERING DIVISION
CITY OF MADISON
MADISON, DANE COUNTY, WISCONSIN**



Robert F. Phillips, P.E., City Engineer

SECTION A: ADVERTISEMENT FOR BIDS

**REQUEST FOR BID FOR PUBLIC WORKS CONSTRUCTION
CITY OF MADISON, WISCONSIN**

A BEST VALUE CONTRACTING MUNICIPALITY

CONTRACT NO.	PROJECT NAME:
6785	WEST GORHAM STREET, N. HENRY STREET & n. FRANCES STREET ASSESSMENT DISTRICT - 2012
SBE GOAL	6%

Plans and Specifications are available at 1600 Emil Street, Madison, WI 53713; 608-267-1197 or on our website at www.cityofmadison.com/business/pw/contracts/openforBid.cfm.

PREQUALIFICATIONS

Bidders who have not been prequalified by the City Engineer and Affirmative Action Director for the period of **February 1, 2012 to January 31, 2013** must submit their application on or before 1:00 p.m., MARCH 23, 2012, Room 115, City-County Building, Madison, WI 53703. Postmark is not applicable. Contractors be prequalified by the City Engineer including an affirmative action plan approved by the Affirmative Action Director prior to the bid opening or the bid will be rejected. Forms are available at the same location or on our website at www.cityofmadison.com/business/pw/forms.cfm.

PRE-BID MEETING

Representatives of the Affirmative Action Department will be present to discuss the Small Business Enterprise requirements on MARCH 16, 2012 at 1:00 PM at 1600 Emil Street, Madison Wisconsin.

OTHER REQUIREMENTS

Sealed bids must be accompanied with a Bid Bond equal to at least 5% of the bid or a Certificate of Annual/Biennial Bid Bond or certified check, payable to the City Treasurer.

Prevailing Wage Rates may be required and are attached in Section I of the contract. See Special Provisions to determine applicability.

Deadline for the Submittal of Bid is MARCH 23, 2012 by 1:00 PM, at 1600 Emil Street, Madison, WI 53713.

Bid Opening will be on MARCH 30, 2012 at 1:30 PM at 1600 Emil Street, Madison, WI 53713.

<p>REQUEST FOR BIDS FOR PUBLIC WORKS CONSTRUCTION FOR THE CITY OF MADISON, WISCONSIN</p> <p>A BEST VALUE CONTRACTING MUNICIPALITY</p> <p>Plans and Specifications for Public Works Projects that are open for bid are available on the City of Madison website at http://www.cityofmadison.com/business/PW/contracts/openforBid.cfm or by calling City Engineering at 608-266-4751.</p> <p>Sealed bids must be accompanied with a Bid Bond equal to at least 5% of the bid or a Certificate of Annual/Biennial Bid Bond or certified check, payable to the City Treasurer.</p> <p>Prevailing Wage Rates may be required and are attached in Section I of the contract. See Special Provisions to determine applicability.</p> <p>Bidders must be prequalified with the City Engineer and the Affirmative Action Director. Deadline date for submittal of application is noticed on our website. Forms are available on the web at http://www.cityofmadison.com/business/pw/forms.cfm or by contacting City Engineering at 608-266-4620</p> <p>Publ. WSJ MARCH 9 & 16, 2012</p>

SECTION B: INSTRUCTIONS TO BIDDERS

The City of Madison Standard Specifications for Public Works Construction - 2012 Edition, as supplemented and amended from time to time, forms a part of these contract documents as if attached hereto.

These standard specifications are available on the City of Madison Public Works website at www.cityofmadison.com/Business/PW/specs.cfm or by contacting City Engineering Division, Room 115, City-County Building, 210 Martin Luther King Jr. Blvd., Madison, WI 53703.

The Contractor shall review these Specifications prior to preparation of proposals for the work to be done under this contract, with specific attention to Article 102 **“BIDDING REQUIREMENTS AND CONDITIONS”** and Article 103 **“AWARD AND EXECUTION OF THE CONTRACT.”** For the convenience of the bidder, below are highlights of three subsections of the specifications.

Section 102.1: Pre-Qualification of Bidders

In accordance with Wisconsin State Statutes 66.0901 (2) and (3), all bidders must submit to the Board of Public Works proof of responsibility on forms furnished by the City. The City requires that all bidders be qualified on a biennial basis.

Bidders must present satisfactory evidence that they have been regularly engaged in the type of work specified herein and they are fully prepared with necessary capital, materials, machinery and supervisory personnel to conduct the work to be contracted for to the satisfaction of the City. All bidders must be pre-qualified by the Board of Public Works for the type of construction on which they are bidding prior to the opening of the bid.

In accordance with Section 39.02(9)(a)l. of the Madison General Ordinances, all bidders shall submit in writing to the Affirmative Action Division Manager of the City of Madison, a Certificate of Compliance or an Affirmative Action Plan at the same time or prior to the submission of the proof of responsibility forms. The bidder shall be disqualified if the bidder fails to or refuses to, prior to opening of the bid, submit a Certificate of compliance, Affirmative Action Plan or Affirmative Action Data Update, as applicable, as defined by Section 39.02 of the Madison General Ordinances (entitled Affirmative Action) and as required by Section 102.11 of the Standard Specifications.

Section 102.4: Proposals

No bid will be accepted that does not contain an adequate or reasonable price for each and every item named in the Schedule of Unit Prices.

A lump sum bid for the work in accordance with the plans and specifications is required. The lump sum bid must be the same as the total amounts bid for the various items and it shall be inserted in the space provided.

All papers bound with or attached to the proposal form are considered a part thereof and must not be detached or altered when the proposal is submitted. The plans, specifications and other documents designated in the proposal form will be considered a part of the proposal whether attached or not.

A proposal submitted by an individual shall be signed by the bidder or by a duly authorized agent. A proposal submitted by a partnership shall be signed by a member/partner or by a duly authorized agent thereof. A proposal submitted by a corporation shall be signed by an authorized officer or duly authorized registered agent of such corporation, and the proposal shall show the name of the State under the laws of

which such corporation was chartered. The required signatures shall in all cases appear in the space provided therefore on the proposal.

Each proposal shall be placed, together with the proposal guaranty, in a sealed envelope, so marked as to indicate name of project, the contract number or option to which it applies, and the name and address of the Contractor. Proposals will be received at the place and until the hour on the date designated in the advertisement. When sent by mail, the sealed proposal marked as indicated above shall be enclosed in an additional envelope. Proposals sent by mail, submitted in person or otherwise delivered must be in the hands of the official conducting the letting by the hour on the date designated in the advertisement. Proposals received after the date designated will be returned to the bidder unopened.

The Bidder shall execute form ERD-7777 (R.9/03), a part of these proposal pages and submit same with the bidder's proposal, if applicable. REFER TO PROPOSAL SECTION.

Section 102.5: Bid Deposit (Proposal Guaranty)

No proposal shall be considered unless either (i) it is accompanied by a bid deposit of the character and amount described in the Advertisement for Bids or (ii) a biennial bid bond in an amount and form acceptable to the City of Madison has been previously submitted.

Bid deposits of unsuccessful bidders shall be returned following the award of the contract by the Common Council. Bid deposit of the successful bidders shall be returned within forty-eight (48) hours following execution of the contract and bond as required.

Bidders for this Contract(s) must be Pre-Qualified for at least one of the following type(s) of construction denoted by an

Building Demolition

- 101 Asbestos Removal
- 120 House Mover

- 110 Building Demolition

Street, Utility and Site Construction

- 201 Asphalt Paving
- 205 Blasting
- 210 Boring/Pipe Jacking
- 215 Concrete Paving
- 220 Con. Sidewalk/Curb & Gutter/Misc. Concrete Work
- 221 Concrete Bases and Other Concrete Work
- 225 Dredging
- 230 Fencing
- 235 Fiber Optic Cable/Conduit Installation
- 240 Grading and Earthwork
- 242 Infrared Seamless Patching
- 245 Landscaping, Maintenance
- 250 Landscaping, Site and Street
- 251 Parking Ramp Maintenance
- 255 Pavement Sealcoating and Crack Sealing
- 260 Petroleum Above/Below Ground Storage Tank Removal/Installation

- 265 Retaining Walls, Precast Modular Units
- 270 Retaining Walls, Reinforced concrete
- 275 Sanitary, Storm Sewer & Water Main Const.
- 280 Sewer Lateral Drain Cleaning/Internal TV Insp.
- 285 Sewer Lining
- 290 Sewer Pipe Bursting
- 295 Soil Borings
- 300 Soil Nailing
- 305 Storm & Sanitary Sewer Laterals & Water Svc.
- 310 Street Construction
- 315 Street Lighting
- 318 Tennis Court Resurfacing
- 330 Traffic Control During Construction
- 320 Traffic Signals
- 325 Traffic Signing & Marking
- 335 Trucking
- 399 Other _____

Bridge Construction

- 501 Bridge Construction and/or Repair

Building Construction

- 401 Floor Covering (including carpet, ceramic tile installation, rubber, VCT)
- 402 Building Automation Systems
- 403 Concrete
- 404 Doors and Windows
- 405 Electrical - Power, Lighting & Communications
- 410 Elevator - Lifts
- 412 Fire Suppression
- 413 Furnishings - Furniture and Window Treatments
- 415 General Building Construction, Equal or Less than \$250,000
- 420 General Building Construction, \$250,000 to \$1,500,000
- 425 General Building Construction, Over \$1,500,000
- 428 Glass and/or Glazing
- 429 Hazardous Material Removal
- 430 Heating, Ventilating and Air Conditioning (HVAC)
- 433 Insulation - Thermal

- 435 Masonry
- 437 Metals
- 440 Painting and Wallcovering
- 445 Plumbing
- 450 Pump Repair
- 455 Pump Systems
- 460 Roofing and Moisture Protection
- 461 Solar Photovoltaic/Hot Water Systems
- 465 Soil/Groundwater Remediation
- 466 Warning Sirens
- 470 Water Supply Elevated Tanks
- 475 Water Supply Wells
- 480 Wood, Plastics & Composites-Structural & Architectural
- 499 Other _____

State of Wisconsin Certifications

- 1 Class 5 Blaster - Blasting Operations and Activities 2500 feet and closer to inhabited buildings for quarries, open pits and road cuts.
- 2 Class 6 Blaster - Blasting Operations and Activities 2500 feet and closer to inhabited buildings for trenches, site excavations, basements, underwater demolition, underground excavations, or structures 15 feet or less in height.
- 3 Class 7 Blaster - Blasting Operations and Activities for structures greater than 15' in height, bridges, towers, and any of the objects or purposes listed as "Class 5 Blaster or Class 6 Blaster".
- 4 Petroleum Above/Below Ground Storage Tank Removal and Installation (Attach copies of State Certifications.)
- 5 Hazardous Material Removal (Contractor to be certified for asbestos and lead abatement per the Wisconsin Department of Health Services, Asbestos and Lead Section (A&LS).) See the following link for application: <http://www.dhs.wisconsin.gov/Asbestos/Cert/Index.htm>. State of Wisconsin Performance of Asbestos Abatement Certificate must be attached.
- 6 Other _____

SECTION C: SBE

Instructions to Bidders City of Madison SBE Program Information

2 Small Business Enterprise (SBE) Program Information

2.1 Policy and Goal

The City of Madison reaffirms its policy of nondiscrimination in the conduct of City business by maintaining a procurement process which remains open to all who have the potential and ability to sell goods and services to the City. It is the policy of the City of Madison to allow Small Business Enterprises (SBE) maximum feasible opportunity to participate in City of Madison contracting. The bidder acknowledges that its bid has been submitted in accordance with the SBE program and is for the public's protection and welfare.

Please refer to the "ADVERTISEMENT FOR BIDS" for the goal for the utilization of SBEs on this project. SBEs may participate as subcontractors, vendors and/or suppliers, which provide a commercially useful function. The dollar value for SBE suppliers or 'materials only' vendors shall be discounted to 60% for purposes of meeting SBE goals.

A bidder which achieves or exceeds the SBE goal will be in compliance with the SBE requirements of this project. In the event that the bidder is unable to achieve the SBE goal, the bidder must demonstrate that a good faith effort to do so was made. Failure to either achieve the goal or demonstrate a good faith effort to do so will be grounds for the bidder being deemed a non-responsible contractor ineligible for award of this contract.

A bidder may count towards its attainment of the SBE goal only those expenditures to SBEs that perform a commercially useful function. For purposes of evaluating a bidder's responsiveness to the attainment of the SBE goal, the contract participation by an SBE is based on the percentage of the total base bid proposed by the Contractor. The total base bid price is inclusive of all addenda.

Work performed by an SBE firm in a particular transaction can be counted toward the goal only if it involves a commercially useful function. That is, in light of industry practices and other relevant considerations, does the SBE firm have a necessary and useful role in the transaction, of a kind for which there is a market outside the context of the SBE Program, or is the firm's role a superfluous step added in an attempt to obtain credit towards goals? If, in the judgment of the Affirmative Action Division, the SBE firm will not perform a commercially useful function in the transaction, no credit towards goals will be awarded.

The question of whether a firm is performing a commercially useful function is completely separate from the question of whether the firm is an eligible SBE. A firm is eligible if it meets the definitional criteria and ownership and control requirements, as set forth in the City of Madison's SBE Program.

If the City of Madison determines that the SBE firm is performing a commercially useful function, then the City of Madison must then decide what that function is. If the

commercially useful function is that of an SBE vendor / supplier that regularly transacts business with the respective product, then the City of Madison will count 60% of the value of the product supplied toward SBE goals.

To be counted, the SBE vendor / supplier must be engaged in selling the product in question to the public. This is important in distinguishing an SBE vendor / supplier, which has a regular trade with a variety of customers, from a firm which performs supplier-like functions on an ad hoc basis or for only one or two contractors with whom it has a special relationship.

A supplier of bulk goods may qualify as an eligible SBE vendor / supplier if it either maintains an inventory or owns or operates distribution equipment. With respect to the distribution equipment; e.g., a fleet of trucks, the term "operates" is intended to cover a situation in which the supplier leases the equipment on a regular basis for its entire business. It is not intended to cover a situation in which the firm simply provides drivers for trucks owned or leased by another party; e.g., a prime contractor, or leases such a party's trucks on an ad hoc basis for a specific job.

If the commercially useful function being performed is not that of a qualified SBE vendor / supplier, but rather that of delivery of products, obtaining bonding or insurance, procurement of personnel, acting as a broker or manufacturer's representative in the procurement of supplies, facilities, or materials, etc., only the fees or commissions will apply towards the goal.

For example, a business that simply transfers title of a product from manufacturer to ultimate purchaser; e. g., a sales representative who re-invoices a steel product from the steel company to the Contractor, or a firm that puts a product into a container for delivery would not be considered a qualified SBE vendor / supplier. The Contractor would not receive credit based on a percentage of the cost of the product for working with such firms.

Concerning the use of services that help the Contractor obtain needed supplies, personnel, materials or equipment to perform a contract: only the fee received by the service provider will be counted toward the goal. For example, use of a SBE sales representative or distributor for a steel company, if performing a commercially useful function at all, would entitle the Contractor receiving the steel to count only the fee paid to the representative or distributor toward the goal. This provision would also govern fees for professional and other services obtained expressly and solely to perform work relating to a specific contract.

Concerning transportation or delivery services: if an SBE trucking company picks up a product from a manufacturer or a qualified vendor / supplier and delivers the product to the Contractor, the commercially useful function it is performing is not that of a supplier, but simply that of a transporter of goods. Unless the trucking company is itself the manufacturer or a qualified vendor / supplier in the product, credit cannot be given based on a percentage of the cost of the product. Rather, credit would be allowed for the cost of the transportation service.

The City is aware that the rule's language does not explicitly mention every kind of business that may contribute work on this project. In administering these programs, the City would, on a case-by-case basis, determine the appropriate counting formula to apply in a particular situation.

2.2 Contract Compliance

Questions concerning the SBE Program shall be directed to the Contract Compliance Officer of the City of Madison Department of Civil Rights, Affirmative Action Division, 210 Martin Luther King, Jr. Blvd., Room 523, Madison, WI 53703; telephone (608) 266-4910.

2.3 Certification of SBE by City of Madison

The Affirmative Action Division maintains a directory of SBEs which are currently certified as such by the City of Madison. Contact the Contract Compliance Officer as indicated in Section 2.2 to receive a copy of the SBE Directory or you may access the SBE Directory online at www.cityofmadison.com/dcr/aaTBDDir.cfm.

All contractors, subcontractors, vendors and suppliers seeking SBE status must complete and submit the **Targeted Business Certification Application** to the City of Madison Affirmative Action Division by the time and date established for receipt of bids. A copy of the Targeted Business Certification Application is available by contacting the Contract Compliance Officer at the address and telephone indicated in Section 2.2 or you may access the Targeted Business Certification Application online at www.cityofmadison.com/dcr/aaTBDDir.cfm. Submittal of the Targeted Business Certification Application by the time specified does not guarantee that the applicant will be certified as a SBE eligible to be utilized towards meeting the SBE goal for this project.

2.4 Small Business Enterprise Compliance Report

2.4.1 Good Faith Efforts

Bidders shall take all necessary affirmative steps to assure that SBEs are utilized when possible and that the established SBE goal for this project is achieved. A contractor who self performs a portion of the work, and is pre-qualified to perform that category of work, may subcontract that portion of the work, but shall not be required to do so. When a bidder is unable to achieve the established SBE goal, the bidder must demonstrate that a good faith effort to do so was made. Such a good faith effort should include the following:

- 2.4.1.1 Attendance at the pre-bid meeting.
- 2.4.1.2 Using the City of Madison's directory of certified SBEs to identify SBEs from which to solicit bids.
- 2.4.1.3 Assuring that SBEs are solicited whenever they are potential sources.
- 2.4.1.4 Referring prospective SBEs to the City of Madison Affirmative Action Division for certification.
- 2.4.1.5 Dividing total project requirements into smaller tasks and/or quantities, where economically feasible, to permit maximum feasible SBE participation.
- 2.4.1.6 Establishing delivery schedules, where requirements permit, which will encourage participation by SBEs.
- 2.4.1.7 Providing SBEs with specific information regarding the work to be performed.
- 2.4.1.8 Contacting SBEs in advance of the deadline to allow such businesses sufficient time to prepare a bid.

- 2.4.1.9 Utilizing the bid of a qualified and competent SBE when the bid of such a business is deemed reasonable (i.e. 5% above the lowest bidder), although not necessarily low.
- 2.4.1.10 Contacting SBEs which submit a bid, to inquire about the details of the bid and confirm that the scope of the work was interpreted as intended.

2.4.2 Reporting SBE Utilization and Good Faith Efforts

The Small Business Enterprise Compliance Report is to be submitted by the bidder in a separate sealed envelope marked: **“ENVELOPE 2 - SBE COMPLIANCE REPORT.”** This report is due by the specified bid closing time and date. Bids submitted without a completed SBE Compliance Report as outlined below shall be deemed non-responsible and the bidder ineligible for award of this contract.

- 2.4.2.1 If the Bidder meets or exceeds the goal established for SBE utilization, the Small Business Enterprise Compliance Report shall consist of the following:

- 2.4.2.1.1 **Cover Page**, Page C-7; and
- 2.4.2.1.2 **Summary Sheet**, C-8.

- 2.4.2.2 If the bidder does not meet the goal established for SBE utilization, the Small Business Enterprise Compliance Report shall consist of the following:

- 2.4.2.2.1 **Cover Page**, Page C-7;
- 2.4.2.2.2 **Summary Sheet**, C-8; and
- 2.4.2.2.3 **SBE Contact Report**, C-9 and C-10. (A separate Contact Report must be completed for each applicable SBE which is not utilized.)

2.5 Appeal Procedure

A bidder which does not achieve the established goal and is deemed non-responsible for failure to demonstrate a good faith effort to achieve such goal and subsequently denied eligibility for award of contract may, within 72 hours of receiving such notification, appeal that decision to a special appeals committee composed of three (3) members of the Affirmative Action Commission, three (3) members of the Board of Public Works and a seventh member appointed by the Mayor. All appeals must be made in writing to the City Engineer and received within 72 hours of City of Madison’s notice. Postmark not applicable.

2.6 SBE Requirements After Award of the Contract

The successful bidder shall identify SBE subcontractors, suppliers and vendors on the subcontractor list in accordance with the specifications. The Contractor shall submit a detailed explanation of any variances between the listing of SBE subcontractors, vendors and/or suppliers on the subcontractor list and the Contractor’s SBE Compliance Report for SBE participation.

No change in SBE subcontractors, vendors and/or suppliers from those SBEs indicated in the SBE Compliance Report will be allowed without prior approval from the Engineer and the Affirmative Action Division. The contractor shall submit in writing to the City of Madison Affirmative Action Division a request to change any SBE citing specific reasons which necessitate such a change. The Affirmative Action Division will use a general test of reasonableness in approving or rejecting the contractor's request for change. If the request is approved, the Contractor will make every effort to utilize another SBE if available.

The City will monitor the project to ensure that the actual percentage commitment to SBE firms is carried out.

2.7 SBE Definition and Eligibility Guidelines

A Small Business Enterprise is a business concern awarded certification by the City of Madison. For the purposes of this program a Small Business Enterprise is defined as:

- A. An independent business operated under a single management. The business may not be a subsidiary of any other business and the stock or ownership may not be held by any individual or any business operating in the same or a similar field. In determining whether an entity qualifies as a SBE, the City shall consider all factors relevant to being an independent business including, but not limited to, the date the business was established, adequacy of its resources for the work in which it proposes to involve itself, the degree to which financial, equipment leasing and other relationships exist with other ineligible firms in the same or similar lines of work. SBE owner(s) shall enjoy the customary incidents of ownership and shall share in the risks and profits commensurate with their enjoyment interests, as demonstrated by an examination of the substance rather than form or arrangements that may be reflected in its ownership documents.
- B. A business with annual gross receipts of less than \$750,000 when averaged over the past three year period;

Firm and/or individuals that submit fraudulent documents/testimony may be barred from doing business with the City and/or forfeit existing contracts.

SBE certification is valid for one (1) year unless revoked.

WEST GORHAM STREET, N. HENRY STREET & N. FRANCES STREET
ASSESSMENT DISTRICT - 2012
CONTRACT NO. 6785

Small Business Enterprise Compliance Report

Cover Sheet

This information MUST be submitted in a separate sealed envelope marked
"ENVELOPE NO. 2 - SBE COMPLIANCE REPORT."

Prime Bidder Information:

Company: _____

Address: _____

Telephone Number: _____ Fax Number: _____

Contact Person/Title: _____

Prime Bidder Certification:

I, _____, _____ of
Name Title

_____ certify that the information
Company

contained in this SBE Compliance Report is true and correct to the best of my knowledge and belief.

Witness' Signature

Bidder's Signature

Date

**WEST GORHAM STREET, N. HENRY STREET & N. FRANCES STREET
ASSESSMENT DISTRICT - 2012
CONTRACT NO. 6785**

Small Business Enterprise Compliance Report

Summary Sheet

**This information MUST be submitted in a separate sealed envelope marked
"ENVELOPE NO. 2 - SBE COMPLIANCE REPORT."**

SBE SUBCONTRACTORS WHO ARE NOT SUPPLIERS

Name(s) of SBEs Utilized	Type of Work	% of Total Bid Amount

Subtotal SBE who are not suppliers: _____ %

SBE SUBCONTRACTORS WHO ARE NOT SUPPLIERS

Name(s) of SBEs Utilized	Type of Work	% of Total Bid Amount

Subtotal Contractors who are not suppliers: _____ % x 0.6 = _____ % (discounted to 60%)

Total Percentage of SBE Utilization: _____%

**WEST GORHAM STREET, N. HENRY STREET & N. FRANCES STREET
ASSESSMENT DISTRICT - 2012
CONTRACT NO. 6785**

Small Business Enterprise Compliance Report

SBE Contact Report

**This information MUST be submitted in a separate sealed envelope marked
"ENVELOPE NO. 2 - SBE COMPLIANCE REPORT."**

Submit separate copy of this form for each SBE which you are not able to utilize towards meeting the SBE goal for this project. Attach separate sheets if necessary.

SBE Information:

Company: _____

Address: _____

Telephone Number: _____

Contact Person/Title: _____

1. Outline below all efforts to solicit a bid from the above SBE. Include date, means of contact, who from your company made this contact and the result.

2. Describe the information provided to the aforementioned SBE regarding the scope of work for which he/she was to provide a bid.

Is this the same scope of work on which the subcontractor you intend to utilize based his/her bid?

Yes No

3. Did this SBE submit a bid? Yes No

4. Is the General Contractor pre-qualified to self-perform this category of work?

Yes No

5. If you responded "Yes" to Question 3, please check the items below which apply and provide the requested detail. If you responded "No" to Question 3, please skip ahead to item 6 below.

The SBE listed above is unavailable for work on this project for the following reasons. Provide specific detail for this conclusion.

The SBE listed above is unqualified for work on this project. Provide specific details for this conclusion.

The SBE listed above provided a price that was unreasonable (i.e. more than 5% above the lowest bidder). Provide specific detail for this conclusion including the SBE's price and the price of the subcontractor you intend to utilize.

A contract with the SBE listed above may constitute a breach of the bidder's collective bargaining agreements. Provide specific detail for this conclusion including, but not limited to, correspondence from the SBE indicating it will not sign a project labor agreement and/or correspondence from the applicable trade union indicating a project labor agreement will not be allowed at the time of project bidding.

Other; please specify reason(s) other than listed above which made it impossible for you to utilize this SBE on this project.

6. Describe any other good faith efforts:

SECTION D: SPECIAL PROVISIONS

**WEST GORHAM STREET, N. HENRY STREET & N. FRANCES STREET
ASSESSMENT DISTRICT - 2012
CONTRACT NO. 6785**

It is the intent of these Special Provisions to set forth the final contractual intent as to the matter involved and shall prevail over the Standard Specifications and plans whenever in conflict therewith. In order that comparisons between the Special Provisions can be readily made, the numbering system for the Special Provisions is equivalent to that of the Specifications.

Whenever in these Specifications the term "Standard Specifications" appears, it shall be taken to refer to the City of Madison Standard Specifications for Public Works Construction and Supplements thereto.

SECTION 102.10: MINIMUM RATE OF WAGE SCALE

For this project, payment of prevailing wages (white sheet) is not required if either: a single trade accounts for 85% or more of the total labor costs of the project and the bid is less than \$48,000; or no single trade accounts for 85% or more of the total labor costs of the project and the bid is less than \$100,000. For bids not meeting either of these conditions, prevailing wages shall be required.

If required, the wages and benefits paid on the contract shall not be less than those specified in the Prevailing Wage Determination included with these contract documents for the following types of work:

- Building and Heavy Construction
- Sewer, Water, and Tunnel Construction
- Local Street and Miscellaneous Paving Operations
- Residential and Agricultural Construction

All bidders are notified that all labor employed on City contracts must be paid in accordance with the minimum rate of wage scale included in the Contract Documents.

For the information of the employees working on the project, a copy of the wage scale included in the contract documents and the provisions of Section 66.0903(8) of the Wisconsin Statutes shall be kept posted by the employer and in at least one conspicuous and easily accessible place at the site of the project.

The Contractor shall keep weekly payroll records setting forth the name, address, telephone number, classification, wage rate and fringe benefit package of each employee who worked on such City project and all other projects the employee worked in the same period, and the Contractor must keep records of the individual time each employee worked on the project and for each day of the project. Such records shall also set forth the total number of hours of overtime credited to each such employee for each day and week and the amount of overtime pay received in that week. Such records shall, in addition, set forth the full weekly wages earned by each such employee and the actual hourly wage paid to that employee. The Contractor shall submit payroll records to the Engineer every week for those periods when work is being done on the project. Said submittal shall be within twenty-one (21) calendar days of the end of the Contractor's weekly pay period.

The Contractor shall ensure that employees shall be paid unconditionally and shall receive the full amounts accrued at the time of payment, computed at rates not less than those stated in the City of Madison "Minimum Rate of Wage Scale" and that each employee's rate shall be determined by the work that is done within the trade or occupation classification which should be properly assigned to such

employee. Questions regarding an employee's classification or rate of pay within that classification, shall be resolved by the practice that predominates in the industry and on which the trade or occupation rate/classification is based. Therefore, rate of pay, classification and work jurisdiction disputes shall be resolved by relying upon practices established by collective bargaining agreements and guidelines used in such determinations by appropriate recognized trade unions operating within the City of Madison.

The Contractor shall agree that the normal rate of wage paid to the Contractor's employees on other projects shall not be reduced or otherwise diminished as a result of the requirement to pay no less than the minimum rate of wage scale on a City project. Mulcting of employees on City projects by Contractors, such as by kickbacks or other such devices, is prohibited.

These contract provisions shall apply to all work performed on the contract by the Contractor with its own organization and with assistance of laborers under its immediate superintendency and to all work performed by piecework or by subcontract. No laborer, worker, or mechanic shall be employed directly upon the site of the work except on a wage basis, but this shall not be construed to prohibit the rental of equipment from individuals.

In the event of a refusal by the Contractor to submit payroll records as required by the contract, the City of Madison shall have the option to cancel this contract and request the Surety to perform or to relet the balance of the work for bids, and in that event, to charge the Contractor for any loss which the City may incur thereby.

SECTION 102.12 BEST VALUE CONTRACTING

This Contract shall be considered a Best Value Contract if the Contractor's bid is equal to or greater than \$51,500 for a single trade contract; or equal to or greater than \$251,000 for a multi-trade contract pursuant to MGO 33.07(7).

ARTICLE 104 SCOPE OF WORK

The work under this contract shall include installation of storm and sanitary sewer systems, water main, curb and gutter, concrete terrace, base preparation, asphalt pavement, drive aprons, sidewalk and street lighting.

The project includes the reconstruction of approximately 450 ft of roadway including underground utilities and 1,800 ft of sidewalk and terrace improvements including tree grates and pedestrian lighting.

The project limits for the work are:

W Gorham Street: from State Street to N Henry Street (sidewalk and terrace)

N Henry Street: from State Street to W Gorham Street (reconstruction)

N Frances St: from University Avenue to State Street cul-de-sac (sidewalk and terrace)

N Frances St: from Langdon Street to State Street cul-de-sac (reconstruction)

Also included is the spot replacement of specialty sidewalk on the 400 block of North Lake Street and 500 block of State Street.

The Contractor shall view the site prior to bidding to become familiar with the existing conditions. It will be the responsibility of the Contractor to work with the utilities located in the right of way to resolve conflicts during the construction process.

SECTION 104.6 DECREASED AND DELETED ITEMS

The electrical quantities include estimates for work that may or may not be required. If actual quantities are less than estimated, or if items are deleted from the contractor's work, the decreased quantities or deleted items shall not constitute the basis for a claim for damages for anticipated profits for the work dispensed with.

SECTION 105.1 AUTHORITY OF THE ENGINEER

The Engineer shall resolve all questions which arise as to the quality and acceptability of materials furnished, work performed, manner of performance, rate of progress of the work, interpretation of the plans and Specifications, acceptable fulfillment of the contract, compensation, and disputes and mutual rights between Contractors under the Specifications. The Engineer shall determine the amount and quantity of work performed and materials furnished.

All decisions of the Engineer shall, when so requested, be rendered in writing. They shall be final and conclusive in all matters unless within ten (10) days after such decision the Contractor applies in writing to the Board of Public Works for a review of such decision.

Any change proposed by a Contractor in SBE subcontractors, vendors or suppliers from those SBEs indicated on the SBE Compliance Report must be approved by the Engineer and the City's Manager of the Affirmative Action Division (hereafter, AAD). When requested, such decision shall be rendered in writing. Such decisions shall be final and conclusive in all matters unless within ten (10) days after such decision the Contractor or the affected SBE applies in writing to the Board of Public Works for a review of such decision.

In the event the Engineer and the AAD disagree over the proper decision to be made regarding an SBE, the Mayor shall appoint a third person to resolve the disagreement, within 30 days of appointment. The decision thus rendered may be reviewed by the Board of Public Works upon request of the Contractor or the affected SBE as set forth in Sections 105.1 and 105.2 of the City's standard specifications.

SECTION 105.12 COOPERATION BY THE CONTRACTOR

The City of Madison has contracted work that will be undertaken by others in the same time frame and the same area as the proposed project, specifically City of Madison contract #6577, on North Frances Street (Langdon Street to Lake Mendota). It shall be the Contractor's responsibility to verify this information and any subsequent changes in the scheduling of the work by others and to make corrections in his/her construction timetable as required.

As part of this contract, repair of "C1 Structural Concrete" shall be completed on the 500 block of State Street and "C1 Concrete" shall be installed on the 400 block of Lake Street. Work on the 500 block of State Street will be in coordination with MG&E gas service replacement. MG&E gas contact, Don McClain, at (608) 252-5618 shall be contacted with any questions on the schedule of MG&E's work. The contractor shall replace the structural concrete removed by MG&E during their service replacement. Details of structural concrete section replacement can be seen in the construction detail drawings. Work on the 400 block of Lake Street will be the removal of a concrete patch in the sidewalk terrace and replacement with "C1 concrete". For both locations, concrete waste management practices shall apply.

MG&E Electric – Mark Bohm (608-252-4730)

MG&E electric work shall be completed with this project. The Contractor shall coordinate their work to allow access to the utility company to install new facilities and resolve any conflicts that may arise. Known work will take place at electrical vault locations to adjust manhole and hatch elevations.

Overhead to Underground Utility Conversion

MG&E – Mark Bohm (608) 252-4730

Charter Communications - Jon Marschke (608) 274-3822 ext. 6734

MG&E and Charter Communications will be burying overhead utility service lines on N Frances St (University Ave to State St cul-de-sac). This work includes one utility pole removal and street trenching near 408 N Frances Street. The Contractor shall review the extents of the utility work with the utility companies and schedule the utility work into their construction schedule. Any additional time shall be agreed upon between the Contractor and the Engineer before work begins.

The Contractor shall use care around existing trees, plantings, fences, walls, steps and driveways that are indicated on the plans to remain. Damage to these items during construction shall be repaired or replaced at the Contractor's expense. No trees, other than those shown on the plan to be removed, shall be cut without the approval of the Engineer and the City Forester; the abutting property owners shall be notified in accordance with the City's Administrative Procedure Memorandum No. 6-2.

The Contractor shall maintain access for mail delivery and garbage/recycling pickup for all properties in the project area.

No utility work, utility disruption or sidewalk construction can commence in front of an entrance without notifying the business a minimum of 48 hours in advance. Utilities or entrances shall not be shut down during the business open times unless approved by the business and the Engineer. For any replacement of the main line sidewalk directly in front of a business, bridges shall be provided to enter all building entryways. Sidewalk closures with five feet of a businesses' entrance providing lunch service shall be prohibited between the hours of 11:00am and 1:00pm. Contractor shall coordinate utility lateral work with Businesses to provide access at all times, and perform work in businesses' desired time frames as much as possible. Specifically, water lateral reconnections shall be coordinated with all business to minimize interruption.

Contractor shall install and maintain up to 4 "Business Open" signs on the project. Signage will be provided to contractor. Contractor may need to support with plywood, post, etc. Along with the business open signs, businesses shall be allowed to place business signs within the project limits. Sign placement shall be coordinated to place signs in a location of visibility.

As part of the North Frances Street (Langdon Street to south cul-de-sac) project, the contractor shall obtain and bag parking meters on Langdon Street per the maintenance of traffic specifications to provide a drop off and pick up location for the Campus Inn hotel at 601 Langdon Street during construction. Access to the two parking lots shall be maintained at all times.

Bus stops shall be maintained at all times as directed by the Engineer. When work is being performed adjacent to existing bus stops, a bus stop loading area shall be provided next to the adjacent travel lane. The contractor shall provide an accessible area for bus riders to board the bus. Madison Metro contact: Tim Sobota (608) 261-4289.

All staging and construction equipment must be stored within project limits

The Contractor shall hold weekly progress meetings with the Engineer, affected utilities, contractor on adjacent project and interested area businesses and residents. The progress meetings are intended to give updates regarding the progression of work and timing of various traffic control stages.

Maxwell Street Days are from 6:00 AM July 20, 2012 to 9:00 PM July 22, 2012. The Contractor shall not work on these days and shall remove all equipment; barricades and other items that will impede the

When 300 block of N Henry St is closed, a 50-foot loading zone shall be maintained on south side of 200 block of W Gorham St at all times. The zone shall be signed as TRUCK LOADING ZONE.

When parking on 300 block of N Henry St is removed, the following alternate parking signs shall be provided to direct traffic to State Street Capitol Parking Garage:

- North side of eastbound Johnson St before State St: "HENRY ST ALTERNATE PARKING" sign with straight arrow
- South side of eastbound Johnson St before Henry St: "HENRY ST ALTERNATE PARKING" sign with straight arrow
- South end of 300 block of N Henry St, on type III barricade: "HENRY ST ALTERNATE PARKING" sign with right arrow

500 block of N Frances St may be closed to through traffic within the project limits for the duration of the project. Local and emergency vehicle access to all properties shall be maintained at all times. Pedestrian traffic to all properties shall be maintained at all times.

Langdon St shall remain open to two lanes of traffic, one lane for each direction, at all times during construction. The sidewalk shall remain open at all times on both sides of Langdon St. When necessary for construction at the Frances-Langdon intersection, Langdon St may be reduced to one lane of traffic during off peak hours (peak hours are defined as 7:00 AM – 9:00 AM and 3:00 PM – 6:00 PM, weekdays) provided that properly equipped and trained flag persons are present and proper signage is in place in accordance with MUTCD.

When 500 block of N Frances St is closed, a 50-foot loading zone shall be maintained on north side of 200 block of Langdon St (near Frances St) at all times. The zone shall be signed as PASSENGER LOADING ZONE.

400 block of N Frances St shall remain open to two lanes of traffic, one lane for each direction, at all times during construction. Local and emergency vehicle access to all properties shall be maintained at all times. The sidewalk shall remain open at all times on both sides of the street. The total parking lane closure time shall be limited to a maximum of three (3) weeks.

No work shall encroach into or impact traffic lanes on University Ave during peak traffic hours (7:00 AM – 9:00 AM and 3:00 PM – 6:00 PM, weekdays) and on days with special events.

When parking lanes on 400 block of N Frances St are closed, a 50-foot loading zone shall be maintained at south end of the block and another 50-foot loading zone at the north end of the block at all times. The zones shall be signed as FREIGHT LOADING ZONE.

At least two lanes of traffic shall be maintained on W Gorham St during peak traffic hours (7:00 AM – 9:00 AM and 3:00 PM – 6:00 PM, weekdays) and for days with special events. At least one lane of traffic shall be maintained on W Gorham St during non-peak traffic hours. Local and emergency vehicle access to all properties shall be maintained at all times. The sidewalk shall remain open at all times on both sides of the street. The total lane closure time shall be limited to a maximum of three (3) weeks.

When the south parking lane on 200 block of W Gorham St is closed, a 50-foot loading zone shall be maintained at south side of the street at all times. The zones shall be signed as TRUCK LOADING ZONE.

The contractor shall post and maintain business open signs as required.

The contractor shall call Parking Utility Maintenance Supervisor (Dan Valenza, 266-4744), a minimum of seven (7) days in advance of when any existing parking facilities need to be removed.

The contractor shall call Parking Utility (John Villarreal, 267-8756), a minimum of three (3) days in advance of when any parking meter hoods are needed.

The work areas shall be backfilled, plated, or protected by traffic control devices during non-working hours. If steel plates are used, the Contractor shall notify the City of Madison Streets Division, 266-4681, 1 working day prior to placement of the plates.

The Contractor shall provide ADA/Handicap Accessible pedestrian access at all intersections within the construction area at all times. Sidewalks shall be maintained on at least one side of the street at all times unless otherwise required.

The Contractor may remove parking within the project limits as indicated on the Traffic Control Plan. The Contractor shall be responsible for posting and maintaining NO PARKING signs in accordance with City of Madison Police Department's "Guidelines for Temporary No Parking Restrictions for Construction or Special Events".

No construction equipment or materials shall be stored in the roadway or street right-of-way that is open to traffic during non-working hours. Construction equipment and materials are not to be stored within the street right-of-way that is outside the project limits as shown on the approved plan.

Contact Yang Tao, Traffic Engineering Division, 266-4815, with any questions concerning these traffic control specifications.

SECTION 107.8 NOTIFICATION WHEN STREET CLOSING

The Contractor shall not remove traffic signs. For removal or replacement of traffic and parking signs, contact the City of Madison Traffic Engineering Field Operations, 1120 Sayle Street, 266-4767, 8:00 a.m. to 4:00 p.m., a minimum of twenty-four (24) hours in advance of when any existing signs need to be removed. This service is provided free of charge. If the Contractor removes the signs, the Contractor will be billed for the reinstallation of, and any damage to, the signing equipment.

SECTION 107.10 OPENING OF SECTION OF HIGHWAY TO TRAFFIC

Upon completion of all concrete work, final surface course of pavement, landscaping, topsoil, seed or sod, the City Construction Engineer shall certify that it is complete and shall contact the City of Madison Traffic Operations Section, 266-4767. The City of Madison Traffic Engineer shall have seven (7) working days to complete the signing and marking so that the street is ready to open to traffic. The Contractor shall leave all barricades in place until such time that the permanent pavement marking and signing has been installed by the City. The City shall notify the Contractor when the final pavement marking and signing is complete and the Contractor shall remove all temporary construction signs and barricades within 24 hours of the notification.

SECTION 109.2 PROSECUTION OF WORK

The Contractor shall begin work on or before MAY 21, 2012. The total time of completion of the contract shall be SEVENTY-FIVE (75) CALENDAR DAYS.

Work on North Henry Street shall be completed by JUNE 15, 2012.

Work on West Gorham Street and North Frances Street (University Avenue to State Street cul-de-sac) shall be limited to TWENTY-ONE (21) CONSECUTIVE CALENDAR DAYS for each separate block of work following Section 107.7 Maintenance of Traffic herein these specifications unless approved by the Engineer.

Work on North Frances Street (Langdon Street to State Street cul-de-sac) shall start on or after JUNE 4, 2012 and shall be completed within THIRTY-FIVE (35) CALENDAR DAYS.

Daily work hours on North Frances Street (Langdon Street to State Street cul-de-sac) and North Frances Street (University Avenue to State Street cul-de-sac) shall begin no earlier than **8:00 A.M.**

Work shall begin only after the start work letter is received.

SECTION 203.2 DISPOSING OF MATERIALS

The Contractor shall comply with Section 203.2 of the City of Madison Standard Specifications for Public Works Construction with regard to salvaging castings.

BID ITEM 20323 - REMOVE CONCRETE SIDEWALK AND DRIVE

Removal of brick pavers in areas where they will not be reset, specifically on N Frances Street (University Ave to State Street cul-de-sac) and in areas of new tree grates and pedestrian lighting in front of 601 Langdon Street shall be paid under this item. All work associated with removal, salvaging and replacement of brick pavers will be paid under a separate bid item.

BID ITEM 20336 - PIPE PLUGS

Structures and pipes called out for removal and/or abandonment shall have the existing pipes plugged at the structure or at the pipe ends, as noted in the plans, and shall be paid for under this bid item. This includes plugs necessary to abandon sanitary sewer laterals. All work under this item shall comply with Article 203 of the Standard Specifications.

ARTICLE 301 CONCRETE AND CONCRETE MATERIALS

HIGH EARLY STRENGTH CONCRETE

This special provision describes the use of high early strength concrete in accordance with the requirements of the standard specifications and as hereinafter provided.

High early strength concrete (on curb, driveway & sidewalks) shall be used to meet the established contract schedule and maintain access to commercial drives within the project limits. All use of high early strength concrete shall be incidental to the specific bid item.

All concrete used on City of Madison Public Works projects shall comply with the following subsections of Article 501, "Concrete" of the latest edition of the Standard Specifications for Highway and Structure Construction of the State of Wisconsin, Department of Transportation, Division of Highways:

501.2 Materials

501.3 Construction

ARTICLE 501 STORM SEWER STRUCTURES

501.1 Description

STORM SEWER GENERAL

The storm sewer designer for this project is Corey Stelljes. He may be contacted by phone at (608) 266-9721 or by email at cstelljes@cityofmadison.com.

Reconnection of existing pipes at new structures, or new pipes at new structures, shall be considered to be part of the work required to construct the new structure or to construct the new sewer pipe and shall not be rewarded with additional compensation. However, if the structure being removed is larger than the new structure, thus requiring additional pipe, the new pipe shall be paid under the appropriate bid item and the connection of the old pipe to the new pipe shall be accomplished with a concrete collar.

Where a new structure is to be constructed at an existing pipe, it is expected that the contractor shall saw cut the existing pipe in the required location to accommodate the placement of the new structure. If the contractor for his/her convenience deems it more suitable to remove the existing pipe to a full joint, the additional pipe and concrete collar required to reconnect to the new structure shall be the contractor's responsibility and shall not be compensated.

Connection of new pipes to existing structures shall be accommodated with a Storm Sewer Tap – Bid Item 50792.

If there are structures where the pipe walls are to be poured into the structure roof or both the pipe walls and the structure casting are to be poured in the structure roof, the Contractor shall not be provided additional compensation for complying with the structure requirements detailed on the storm sewer chart and plans.

Precast structures are only allowed where field poured structures are not specifically called for, and no precast structures are allowed until ULO's are completed and approval of the design engineer has been received.

SANITARY SEWER GENERAL

THE SANITARY SEWER DESIGNER FOR THIS PROJECT IS COREY STELLJES (608) 266-9721.

Sanitary sewer pipe work shall include installing approximately 161 feet of new 10" PVC and 9 sanitary laterals.

All new sanitary sewer access structures shall include Neenah R-1550 castings with the new City of Madison casting detail (see S.D.D. 5.7.16) of the City of Madison Standard Specifications for Public Works Construction 2012 ed. All new sewer main connections may be factory cored and shall be included in the structure. All existing main connections shall be field cored to

accommodate existing conditions and shall be compensated under BID ITEM 50791 SANITARY SEWER TAP. All sewer main and/or laterals not slated for replacement that are damaged during the installation of a structure shall be replaced by the Contractor and shall be considered incidental to the project. All benches and flowlines shall have a smooth trowel finish.

It is advised that the Contractor visit the site prior to bidding to determine the type of trench protection that will be necessary for the sanitary sewer main installation.

BID ITEM 50353 - SANITARY SEWER LATERAL

All work associated with this bid item shall comply with Article 503 of the Standard Specifications. Any terrace restoration (topsoil, seed and mulch) required to restore the grassy areas where disturbed for lateral construction, shall be considered incidental to SANITARY SEWER LATERAL.

The sewer lateral at 201 W Gorham St has been located and surveyed prior to design. Laterals that were located are marked on the plan set as "LAT LOCATED". All other laterals were located from City records. Per the City of Madison Standard Specifications for sanitary sewer lateral construction on street reconstruction projects, Contractors are encouraged to begin installation of sanitary lateral pipe at the proposed sewer main. If the Contractor starts excavation for the lateral at the property line, it shall be at the Contractor's risk. No Utility Line Openings (ULOs) will be granted for the inability to locate the sanitary lateral at the property line. Any extra sidewalk removal caused by looking for an existing sanitary lateral at the property line will not be compensated to the Contractor. Contractors are encouraged to have a locator device on-site if they intend to start laying lateral pipe at the property line to minimize the amount of extra sidewalk removal. Each sanitary lateral shall have a maximum of 4 sidewalk squares and 20' of curb and gutter removed and replaced. No additional compensation shall be awarded beyond this amount for the replacement of a sewer lateral.

BID ITEM 50390 SEWER ELECTRONIC MARKERS

With regard to the City of Madison Standard Specifications for Public Works Construction 2012 Edition Section 503.3(c), each sanitary lateral shall have a minimum of two (2) electronic markers with the City providing the Contractor with the required number of electronic markers. For sanitary laterals, which only include the installation of a wye, a marker ball shall be installed directly above the wye connection to the main.

BID ITEM 50903 – FURNISH AND INSTALL CIPP TO REHABILITATE 10" VP SAN

Work under this item shall include lining existing 10" VP sanitary sewer on N Henry St from Ex SAS #4950-032 to SAS#2 with Cured-in-Place Pipe (CIPP). Work shall be in accordance with Article 509 of the Standard Specifications. Files (mpg) of the CCTV inspection of the existing storm sewer are available for review by the Contractor at <ftp://ftp.cityofmadison.com/>, in the folder called Henry Sanitary. To access the ftp site, use Username "cityftp" and password "2upload!".

In order to access the videos online, enter the following on your Microsoft Internet Explorer address bar:

<ftp://ftp.cityofmadison.com>

Click "page"

Select "open FTP side in Windows Explorer"

Enter the following at the prompt:

Username: cityftp

Password: 2upload!

If you are not prompted, go to the File menu and select "login as" and use the username and password above.

After you have accessed the site, find the directory called "Henry Sanitary." Copy the video files onto your hard drive, and you may view the videos. If you have problems, the videos will be available on DVD's or CD's upon request.

Any additional spot repairs of damaged sections of pipe (either shown on the TV report above, or incurred prior to or during construction) required to successfully line the pipe shall be considered incidental to this bid item. Cleaning of the pipe as needed to complete the lining shall be considered incidental to this bid item. Contractor is encouraged to complete pipe lining at the start of the project to avoid damage to the existing VPs during construction activities.

METHOD OF MEASUREMENT

Furnish and Install CIPP to rehabilitate 10" VP San shall be measured as complete when each completed unit is installed in the field.

BASIS OF PAYMENT

Furnish and Install CIPP to rehabilitate 10" VP san shall be measured as described above and shall be paid for at the contract price which shall be full compensation for all work, materials, labor, and incidentals required to complete the work as set forth in the description.

SECTION 601 ELECTRICAL, GENERAL REQUIREMENTS

The existing signal and lighting poles, conduits, handholes, and manholes not scheduled for removal or abandonment shall be protected during construction. If the contractor believes that damage to such facilities is unavoidable, the contractor shall not damage or remove any facilities until the City Traffic Engineering electrical inspector has reviewed and approved such actions. Any damage or removal of City electrical conduit, wire, fiber, or structures, without the specific approval by the City Traffic Engineering electrical inspector shall be promptly repaired or replaced by and at the expense of the contractor. The City may elect to do repair work with City crews. The cost for any repair work done by the City will be billed to the contractor.

Any damage or removal of City street lighting facilities shall be repaired or replaced within 24 hours, but any resulting street light outage resulting from such damage or removal shall be confined to as few numbers of street lights as possible. The streetlight circuits shall remain operational each and every night. If any street light outage continues beyond 24 hours, the City shall have the right to make temporary or permanent repairs, with the full cost of such work, including engineering time, billed to the general contractor.

The City of Madison Traffic Engineering Division will remove existing and install new lighting poles as necessary and install wire for new street light operation. The contractor shall fully cooperate with the City in staging the work so that existing lights remain operational until the new lights on the opposite side of the road are operational.

Unless a manhole (utility access structure) or handhole is specifically designated for removal, it shall be saved. Not all fiberoptic, signal and lighting structures and conduit are being removed or abandoned in the project area. The contractor shall consult with the Traffic Engineering Electrical Inspector before removing or damaging any existing facilities.

SECTION 601.10 MATERIALS FURNISHED BY THE CITY OF MADISON

The following electrical materials will be furnished to the Contractor at the Traffic Operations Shop, 1120 Sayle Street. The Contractor shall notify the Traffic Operations Shop (Dennis Rowe at 266-9034) twenty four (24) hours prior to picking up any materials. Complete quantities of an item shall be picked up on one appointment unless Dennis Rowe agrees to a partial quantity disbursement.

3/4" x 24" Anchor Bolts: 76
1" x 40" anchor bolts: 16
Steel Base for Multi-Space Parking Meters: 4

SECTION 602.4(b) ELECTRICAL CONDUIT

Item 60241, Gopher Raceway, shall include any and all work associated with determining locations of existing utilities, such as underground locates. Item 60241 shall include raceways created by pushing, gophering or boring. The measured quantity will only include distances installed directly underneath curb and gutter, roadway, and sidewalk sections that are not removed or constructed with this project. Minor alterations in conduit location may be made by the City Traffic Engineering Electrical Inspector to avoid gopher installation.

Where curb and gutter is being replaced, the new conduit to be installed parallel to the curb and gutter shall be placed according to the Typical Conduit Installation detail shown on the plan sheet. When existing utilities preclude placing conduit as shown in the detail, the conduit shall be placed under the curb or as close to the curb as possible.

When curb and gutter is not being replaced, the new conduit to be installed parallel to the curb and gutter shall be placed in the roadway, three feet from the edge of gutter, and as approved by the City Traffic Engineering Electrical Inspector.

Conduit depth within five feet of entering or leaving any handhole shall be 40 inches.

SECTION 604 BASES FOR STREET LIGHTING UNITS

The bid items for LB-3 and LB-3 Modified bases shall include cutting existing conduit and wire, pulling back and saving existing wire, and extending existing conduit and wire into each new base where streetlight conduit and/or wire already exists. Existing street light conductors shall be saved and reused. Any existing wire that is damaged or removed by the contractor when it could have been reused shall be replaced by the contractor at no expense to the City. All work associated with installing conduit connection between existing conduit and new base, saving and reusing existing wire or removing existing wire from conduit is incidental to the bid items for LB-3 and LB-3 Modified bases.

ARTICLE 607 ELECTRICAL HANDHOLES

The contractor shall furnish Type I and V handholes conforming to this section and the Standard Detail Drawings. Electrical Handhole, Type I shall be gray colored polymer concrete construction. Box dimensions for Type I shall be 19" wide X 32" long X 24" deep and come with a cover rated to withstand 15,000 lbs over a 10" square with a minimum test load of 22,568 lbs. Electrical Handhole, Type V, shall be gray colored polymer concrete construction. Box dimensions shall be 26" wide by 38" long by 24" deep. The box and cover shall be rated at 15,000 lbs over a 10" square with a minimum test load of 22,568 lbs.

SECTION 701 PROVISIONS FOR WATER INSTALLATION AND ABANDONMENT

The project consists of work in two locations. The first location is North Frances Street between State and Langdon Streets. This portion of the project consists of furnishing and installing 8-inch ductile iron water main on North Frances Street from the cul de sac just north of State Street to the intersection with Langdon Street. The second location is North Henry Street between State and Gorham Streets. This portion of the work consists of abandoning the existing 4-inch cast iron water main and re-connecting all service laterals off the 4-in main onto the existing 12-in ductile iron main. Both locations will include the abandonment of old main including water valves and hydrants.

Once the new systems have passed the pressure and water quality tests, cut off, extend as necessary, and reconnect the existing water service laterals to the new water mains unless the service is to be abandoned. All services that may require relocation due to conflicts with trees or any other issue must be authorized and the new location approved in advance by the Water Utility inspector. Any broken curb stops, buried curb boxes or otherwise dysfunctional service components must be approved for adjustment, removal and/or replacement by the Water Utility inspector in advance of any work being performed.

Water Shut-Off Notification

Notify all affected users of water shut-offs per the Standard Specifications. Coordinate planned outages with all building representatives and businesses and ensure all owners and tenants of affected properties are properly noticed. Work with businesses to find mutually agreeable timeframes for water shut offs. The contractor is responsible for ensuring ALL affected customers are properly noticed. No premium or extra compensation shall be paid for work performed outside of normal working hours to make such accommodations.

Coordinate all outages affecting the Campus Inn at 601 Langdon Street with General Manager Bill Wellman at (608) 257-4391.

Coordinate all outages affecting The Towers at 502 North Frances Street with Area Manager Peter Feltman at (608) 257-0701.

Coordinate all outages affecting Vientiane Palace at 151 West Gorham Street with owner Lee Madden at (608) 345-3998.

Special Service Notes

156 West Johnson: The 1-inch service to 156 West Johnson Street shall be abandoned and the curb stop removed per section 704.31 of the Standard Specifications. A new 1-inch copper service shall be installed to replace the abandoned service. The new service shall be tapped off the existing 12-in water main as shown on the plans. Place the curb stop 8 feet off the property line and lay the service such that there is a minimum 5 feet clearance from proposed tree grates.

151 West Gorham: The existing 2-inch lateral serving 151 West Gorham Street shall be abandoned from the 4-inch main to and including the curb stop. Replace the lateral with a new 6-inch service. Cap the 6-inch service 8 feet off the property line with a MJ cap tapped with a 2-inch corporation stop. Re-connect the existing service to the new 2-inch corporation stop. The existing curb stop shall be removed and incidental to the installation of the 6-inch service. The 6-inch service shall be paid per Bid Item 70002: Furnish and Install 6-inch Pipe & Fittings. The tapped cap, stop, 2-inch copper, all other required fittings and the reconnection to the existing 2-inch service shall be paid per Bid Item 90160.

302 State Street: The existing ¾" lateral to 302 State Street is not in service. DO NOT re-connect the service. DO NOT abandon the curb stop due to its location in the recently hardscaped State Street Mall Area.

265 Langdon Street: The proposed 4-inch lateral serving 265 Langdon Street must be installed and in service before the storm sewer work between Stations 10+00 and 10+90 on Frances Street may occur.

Protection of Existing Water Utility System

Take all necessary precautions to protect the existing Madison Water Utility system and ensure its proper functioning during construction. Note that some of the existing water main dates back to the 1800's.

Special Bid Items

Bid Item # 90160: Furnish & Install 6" MJ Cap W/ 2" Corp & Reconnect To Ex. Service. The work under this bid item includes the following items regarding the service at 151 West Gorham Street

- Installing a 6-inch MJ cap tapped with a 2-inch corporation stop on the proposed 6-inch service.
- Reconnecting the existing service to the new corporation stop.
- Furnishing the tapped cap, corporation stop, 2-inch copper and all other fittings required to make a proper connection to the existing service.

View the sites prior to bidding and become familiar with existing conditions and utilities.

SECTION 702 MATERIALS

Furnish all materials, labor and equipment necessary to complete this project except the tapping sleeves, tapping valves and tapping valve boxes. Water Utility will furnish the tapping sleeves, tapping valves, tapping valve boxes, and the crew to perform the taps.

Section 702.2 Valves and Valve Boxes

The AFC Series 2500 is an acceptable gate valve model for this project.

SECTION 703 CONSTRUCTION METHODS

Perform all work in accordance with these provisions and the City of Madison Standard Specifications. Keep all valves accessible and functioning throughout the duration of the work or directed otherwise by the Water Utility representative.

All water main and ductile iron service pipe that cannot be disinfected per Standard Specification section 704.14(c) shall be hand disinfected by a method acceptable to the Water Utility inspector.

WATER UTILITY GENERAL NOTES FOR SPECIFIC WORK:

- | | |
|-----|---|
| WN1 | Replace the existing lead service with a new copper service. |
| WN2 | Extend and reconnect the existing copper service to the new water main. |
| WN3 | Existing service to be abandoned when water main is cut-off. |
| WN4 | Disconnect service from the old water main and reconnect the existing copper water service lateral to the new water main. |
| WN5 | Relocate the existing fire hydrant. |
| WN6 | Abandon water valve access structure. |

- WN7 Furnish and install the new top section for the water access structure.
- WN8 Abandon the valve box.
- WN9 Furnish the ditch, compaction and all materials and labor for the installation of new service lateral.
- WN10 Remove and salvage existing hydrant.
- WN11 Replace the existing copper service with a new copper service.
- WN20+ See Water Impact Plan sheet(s) for connection point isolation and water shut-off notification information.

BID ITEM 90001 – TEMPORARY SIDEWALK ACCESS

DESCRIPTION

This special provision describes maintaining accessible sidewalk within the construction zone. Maintaining accessible sidewalks consists of maintaining a sidewalk and/or crosswalk on existing pavement, new pavement, or temporary surface material.

MATERIALS

Furnish a hard temporary surface material consisting of asphaltic surface, any grade of concrete, skid resistant steel plating, or alternative material as approved by the Engineer. Gravel or base course material is not acceptable.

CONSTRUCTION

Install, maintain, move, and remove temporary surface material at Temporary Sidewalk Access locations as shown on the plans and as directed by the Engineer. Level and compact the surface prior to placing temporary surface material. The temporary crosswalk shall have a minimum clear width of 4 feet; be located outside the immediate work area, as approved by the Engineer; and meet the requirements of the current Americans with Disabilities Act Accessibility Guidelines (ADAAG). Reconstruct or relay Temporary Sidewalk Access when disturbed by construction operations or utility trenches.

MEASUREMENT

The department will measure Temporary Sidewalk Access by the lump sum completed and accepted by the Engineer.

PAYMENT

This item, measured as provided above, will be paid for at the contract unit price lump sum which is full compensation for furnishing, loading, hauling material; for preparing the foundation; for furnishing, placing, maintaining, and removing temporary surface material; for reconstructing or relaying the temporary surface material; and for furnishing all labor, tools, equipment, and incidentals necessary to complete the work.

BID ITEM 90002 – FENCE SAFETY

DESCRIPTION

This special provision describes constructing a plastic fence between the construction zone and all sidewalk, or as directed by the Engineer and as hereinafter provided. Fence shall extend to the ground to be detectable by cane for the blind.

MATERIALS

Provide notched conventional metal "T" or "U" shaped fence posts.
Provide fence fabric meeting the following requirements.

Color:	International orange (UV stabilized)
Roll Height:	4 feet
Mesh opening:	1 inch min to 3-inch max
Resin/construction:	High density polyethylene diamond mesh
Service temperature:	-60° F to 200° F (ASTM D648)
Tensile Yield:	Avg. 2000 lb per 4 ft. width (ASTM D638)
Ultimate tensile strength:	Avg. 3000 lb per 4 ft. width (ASTM D638)
Elongation at break (%):	Greater than 100% (ASTM D638)
Chemical resistance:	Inert to most chemicals and acids

CONSTRUCTION

Drive posts into the ground 12 to 18 inches or use other Engineer approved method to secure posts. Space posts at 7 feet.

Use a minimum of three wire ties to secure the fence at each post. Weave tension wire through the top row of strands to provide a top stringer that prevents sagging.
Overlap two rolls at a post and secure with wire ties.

METHOD OF MEASUREMENT

City Engineering will measure Fence Safety by the linear foot along the base of the fence, center to center of posts. Fence moved or removed and replaced for construction activities will not be measured and paid again.

BASIS OF PAYMENT

Payment is full compensation for furnishing and installing fence and posts; maintaining the fence and posts in satisfactory condition; removing and disposing of fence and posts at project completion; and for furnishing all labor, tools, equipment and incidentals necessary to complete the work.

BID ITEM 90003 – C1 CONCRETE SIDEWALK 7-INCH

DESCRIPTION

This work shall be in accordance with the requirements of Part 3 of the Standard Specifications, except as herein after amended.

MATERIALS

The concrete mix design shall be as follows per cubic yard:

Cement: 575 lbs

Fine Aggregate: 950 lbs

Upper Canadian Black Granite (1/2 x 1/4) **or** Starlite Black Granite (9/16 x 3/16): 752.5 lbs

Colonial Red Granite (9/16 x 3/16): 1397.5 lbs

Sieve Analysis

Upper Canadian Black Granite

Sieve Size	% Passing
9/16"	100%
0.53"	98.5%
7/16"	84.7%
5/8"	65.8%
1/4"	14.2%
#4	1.0%

Starlite Black Granite

Sieve Size	% Passing
9/16"	98%
3/8"	66%
3/16"	12%
#8	0%

Colonial Red Granite

Sieve Size	% Passing
9/16"	98.0%
3/8"	67.0%
#4	13.0%
#8	3.0%
#16	<1.0%

CONSTRUCTION

Placing and Finishing Concrete. Conform to Part 3 of the Standard Specifications for the concrete. The Engineer will check and approve the foundation, forms and reinforcement if required, before placing the concrete. Place the concrete on a moist foundation, deposit it to the required depth, and consolidate sufficiently to bring the mortar to the surface, then strike-off and finish to a true and even surface. Before mortar sets, spray the surface with water and brush or lightly broom the surface to expose the aggregate. Before performing the final surface finish, check the sidewalk surface with a 10-foot straightedge, and correct all areas that vary 1/4-inch from the testing edge by adding or removing concrete while the concrete is still plastic.

C1 Concrete Sidewalk 7-Inch shall be doweled into all existing and new concrete with #6 epoxy coated tie bars. All tie bars shall be in accordance with Standard Details 3.10 and 3.11 of the City of Madison Standard Specifications

All C1 Concrete Sidewalk 7-Inch shall include 2 inches crushed stone base foundation incidental if needed.

The Contractor shall follow concrete waste management specifications herein these specifications.

Interface between C1 Concrete Sidewalk 7-Inch and 7" Concrete Sidewalk & Drive shall have foam expansion joint and caulk seal incidental.

METHOD OF MEASUREMENT

C1 Concrete Sidewalk 7-Inch shall be measured by the square foot installed and accepted.

BASIS OF PAYMENT

C1 Concrete Sidewalk 7-Inch, measured as stated above, is full compensation for providing all materials, including concrete, bar steel reinforcement HS, joint fillers, joint sealers, and expansion joints; for excavating and preparing the foundation; backfilling and disposing of surplus material; for placing, finishing, protecting, and curing; and restoring the work site. However, if the contract provides a bid item for excavation, then the department will pay for work required and performed in construction concrete sidewalks as specified in the contract.

BID ITEM 90004 – C1 CONCRETE STRUCTURAL SLAB 7-INCH

DESCRIPTION

This work shall be in accordance with the requirements of Part 3 of the Standard Specifications, except as herein after amended.

MATERIALS

The concrete mix design shall be the same as the bid item “C1 Concrete Sidewalk 7-Inch”.

CONSTRUCTION

Placing and Finishing Concrete. The Placing and Finishing Concrete shall be the same as the bid item “C1 Concrete Sidewalk 7-Inch”.

Reinforcement. Epoxy Coated Bar Steel Reinforcement is required and shall be placed as specified in the plans.

METHOD OF MEASUREMENT

C1 Structural Slab 7-Inch shall be measured by the square foot installed and accepted.

BASIS OF PAYMENT

C1 Structural Slab 7-Inch, measured as stated above, is full compensation for providing all materials, including concrete, bar steel reinforcement HS, joint fillers, joint sealers, and expansion joints; for excavating and preparing the foundation; backfilling and disposing of surplus material; for placing, finishing, protecting, and curing; and restoring the work site. However, if the contract provides a bid item for excavation, then the department will pay for work required and performed in construction concrete sidewalks as specified in the contract.

BID ITEM 90005 - CONCRETE SIDEWALK TEST POUR

Description

This work shall be in accordance with the requirements of Part 3 of the Standard Specifications, except as hereinafter amended. The test pours shall be completed by the Contractor to demonstrate the techniques and quality of workmanship required to produce the desired finished product. The test pour area shall be 10-foot by 10-foot.

Materials

The concrete mix design shall be the same as the bid item "C1 Concrete Sidewalk 7-Inch".

Construction

The test pour shall be done at a location within the City of Madison Metropolitan area. Location shall be verified with the Engineer. The Contractor will give the Engineer a minimum 48-hour notice prior to the test pour. The test pours shall be completed on separate days. The construction of the test pour area shall follow the techniques as described in the bid item "C1 Concrete Sidewalk 7-Inch," including different tooling techniques as directed by the Engineer.

Method of Measurement

Concrete Sidewalk Test Pour shall be measured by the unit each.

Basis of Payment

Concrete Sidewalk Test Pour, measure as provided above, shall be paid at the contact unit price for work as described above.

BID ITEM 90006 – CARDBOARD VOID FORMS

DESCRIPTION

The work shall consist of furnishing and installing cardboard void forms to create a temporary support for the placement of structural concrete slabs over expansive soils in accordance with Section 602 of the State of Wisconsin Standard Specifications, the plan details, and as herein provided.

MATERIALS

Cardboard Void Form shall be four inches thick with a minimum work load strength of 1000 psf. The composition of the material shall be corrugated paper material with a moisture resistant exterior, and having an interior fabrication of a uniform, cellular configuration, composed of non-wax impregnated components. Cardboard Void Form shall be Sure Void Products, Inc, Void Forms International, LTD, or approved equal.

CONSTRUCTION

Prepare ground surface on an even plane. Install Cardboard Void Form in accordance with manufacturer's recommendations. Protect forms from moisture before concrete placement. Tape joints to prevent water absorption. Protect forms from puncture and other damage during concrete placement.

METHOD OF MEASUREMENT

The department will measure Cardboard Void Forms in square feet of surface area acceptably completed.

BASIS OF PAYMENT

Cardboard Void Forms, measured as provided above, will be paid for at the contract unit, which price shall be payment in full for furnishing all materials, labor, tools, equipment and incidentals necessary to complete this item of work.

BID ITEM 90007 – REMOVE BENCH

DESCRIPTION

This special provision describes removing benches in accordance with the pertinent provisions of Article 203 of the standard specifications and as hereinafter provided.

The existing bench on North Frances Street (University Avenue to State Street cul-de-sac) shall be carefully removed and delivered to the City of Madison Parks Division. The Contractor shall notify Laura Bauer, City of Madison, (608) 266-6031 to schedule delivery.

All other material shall be removed from the right-of-way and disposed of by the Contractor.

METHOD OF MEASUREMENT

Remove Bench shall be measured by the unit each removed.

BASIS OF PAYMENT

Remove Bench, measured as provided above, shall be paid at the contract unit price for work as described above.

BID ITEM 90008 – INSTALL BENCH

DESCRIPTION

This work shall consist of installing City of Madison furnished benches in locations as shown on the plans and as herein provided.

The City of Madison Parks Division shall deliver benches for installation. The Contractor shall notify Laura Bauer, City of Madison, (608) 266-6031 or Tom Skaife, City of Madison, (608) 225-4849 to schedule delivery.

All material to securely attach the benches shall be provided by the Contractor. Contact the above contacts for questions on securing the benches.

METHOD OF MEASUREMENT

Install Bench shall be measured by the unit each removed.

BASIS OF PAYMENT

Install Bench, measured as provided above, shall be paid at the contract unit price for work as described above.

BID ITEM 90009 - DECOMPOSED GRANITE

DESCRIPTION

This bid item is to provide decomposed granite for the tree openings where the trees are too large for tree grates. Provide uniform 4” depth to surface of tree opening. Full 4” depth may not be possible at all locations due to tree roots. Do not damage tree roots for installation of Decomposed Granite.

MATERIALS

Decomposed Granite to be orange/red in color. Contractor shall submit sample to Engineer prior to ordering or installing.

METHOD OF MEASUREMENT

Decomposed Granite shall be measured by square foot of installed material.

BASIS OF PAYMENT

This item, measured as provided above, will be paid for at the contract unit price per square foot, which price shall be payment in full for furnishing, installing stone, and for furnishing all labor, tools, equipment, and incidentals necessary to complete this item of work.

BID ITEM 900010 – REMOVE AND SALVAGE BRICK PAVERS

DESCRIPTION

The Contractor shall remove and salvage the terrace pavers as needed at the locations shown on the plans, specifically in the North Frances Street terrace of the Campus Inn, 601 Langdon Street. The limits of this work shall be as necessary to replace the adjacent curb and gutter, sidewalk, driveway apron, underground utilities and terrace improvements. The approximate limits of this work are shown on the plans, but additional work may be necessary as directed by the Engineer. The Contractor will be required to salvage and palletize pavers. The bid item will be full compensation for all work necessary including any incidental items to remove and salvage the pavers for future use. Excess pavers at the completion of the project shall be delivered to the Campus Inn. For delivery coordination, contact Bill Wellman or Tom Gail (608) 257-4391.

MEASUREMENT

Remove and Salvage Brick Pavers shall be measured by the square foot.

BASIS OF PAYMENT

Payment for this work, as measured above, shall be full compensation at the contract unit price for all work, materials, equipment, and incidentals required to complete the work.

BID ITEM 900011 – RESET BRICK PAVERS

DESCRIPTION

The Contractor shall reset the terrace pavers as needed at the locations shown on the plans, specifically in the North Frances Street terrace of the Campus Inn, 601 Langdon Street. The limits of this work shall be

as necessary to reinstall pavers within the terrace around the terrace improvements (lighting and tree grates). The limits of the work shall be such that there will not be any tripping hazards within the area of the pavers and such that there are not any low spots within this area that prevent the terrace from draining properly. The approximate limits of this work are shown on the plans, but additional work may be necessary as directed by the Engineer. The Contractor will be required to saw the pavers to match into the curb, sidewalk, driveway apron and around improvements. The bid item will be full compensation for all work necessary including any incidental items to reset the pavers to match the existing pattern around the terrace improvements.

MEASUREMENT

Reset Brick Pavers shall be measured by the square foot.

BASIS OF PAYMENT

Payment for this work, as measured above, shall be full compensation at the contract unit price for all work, materials, equipment, and incidentals required to complete the work.

BID ITEM 90012 - UNDISTRIBUTED SHEET MEMBRANE WATERPROOFING

DESCRIPTION

This special provision describes preparing the surface, furnishing and installing a primer, waterproofing membrane, and hot rubberized sealer or mastic, or both, on the vault roof to be overlaid with a minimum of one-inch granular material and concrete.

MATERIALS

Provide a material in the waterproofing system that is specifically designed for use with vault roofs. The membrane shall consist of a cold-applied, self-adhering membrane incorporating a heat resistant woven or non-woven fabric or fiberglass reinforcing laminated in between layers of polymer modified bitumen or SBS modified rubberized asphalt. The membrane shall have a release film, polyester or polyethylene on the down side and may have a thin spun bonded open weave polyester fabric on the up side. Provide a composite sheet membrane with the following properties:

Property	Test Method	Specific Value
Width		36 inch min.
Tensile Strength	ASTM D 412	50 lb/in or 700 psi min.
Thickness		60 mils to 80 mils
Puncture Resistance	ASTM E 154	40 lb. min.
Permeance	ASTM E 96, Method B	0.05 US Perms max.
Low Temperature Pliability	ASTM D 146, 1-inch Mandrel @ -25° F	No cracks or splits at 180° bend
Water Absorption	ASTM D 570, 72 hr.	0.25% max.
Peel Adhesion	ASTM D 903	5 lb/in width min.
Crack Cycling @ -15° F, 100	ASTM C 836	No cracks or splits

cycles		
Compound Softening Point	ASTM D 36	210° F ± 20° F
Viscosity of Membrane	ASTM D 4402	3500 centipoise
Rubberized Asphalt, @ 329° F		

Provide rubberized asphalt compound containing not more than 15% inorganic residue or filler material.

Provide primer, mastic and/or hot rubberized asphalt sealer conforming to the specified properties required by the manufacturer of the waterproofing membrane.

MATERIALS CERTIFICATION

Prior to membrane approval for initial submittals and/or upon reformulation of membrane material compounds, submit to the Engineer a notarized certification by an independent test laboratory stating that the materials conform to the requirements of these specifications. The certification shall include or have attached specific results of tests performed on the material supplied. The Engineer may at his option require samples of any material for testing. Prior approval membranes will be provisionally accepted by manufacturer's certification on their company letterhead, but may be subject to control and/or approval by subsequent testing.

CONSTRUCTION

Application Methods

Apply materials in strict accordance with the manufacturer's instructions. In order to install the waterproofing membrane, the vault roof temperature shall be a minimum of 45° F and rising. Before applying the system, become acquainted with the materials specified and their handling characteristics and become thoroughly familiar with the construction procedures recommended by the manufacturer. Furnish a copy of the recommended procedures to the Engineer. To establish procedures for maintaining optimum working conditions and to coordinate work related to adjacent construction, a pre-installation conference with a manufacturer's representative shall be held prior to starting construction. To provide quality assurance that the membrane has been properly installed, a manufacturer's representative familiar with membrane installation procedures shall be present during placement of the membrane.

After sidewalk removal operations, remove by sweeping, compressed air blasting, or by other satisfactory means any foreign material remaining on the vault roof. The roof shall be clean, dry and free from mud, dirt, sand, oil or grease and any other contaminants prior to application of the primer. No vehicles or equipment will be permitted on the roof after surface preparation except those necessary for the installation of the waterproofing membrane. The Engineer will inspect the roof prior to the application of the primer. Do not begin application of either the primer or membrane until after the Engineer grants approval.

To coat all surfaces of the roof and walls that will be covered with the membrane, apply primer uniformly as recommended by the manufacturer. Use roller, brush or spray to apply primer to the surfaces. If spraying is used, an approved method of protecting the environment is required.

Allow the primer to dry until tack free (approximately forty-five minutes) before applying the membrane. Apply primer only to an area that will be covered with the membrane within the same calendar day. If the surface of the roof becomes contaminated, clean and reprime the area.

Apply primer on the walls and expansion joints to the limits of the adjacent concrete pours. Take care to ensure that all corners are coated with primer.

After the primer has dried to a tack free condition, apply one layer of membrane to the roof starting on the low side edge.

To form a bond with the primed roof, remove the release film from the membrane on the tacky side while the membrane is rolled face down. Apply the membrane by hand methods or by using mechanical applicators. Overlap a minimum of 2.5 inches at the edges of each strip and overlap the membrane in such a manner to provide a shingling effect toward the low side of the roof cross section. Overlap a minimum of 5 inches at the ends of each strip of membrane and overlap the membrane in such a manner to provide a shingling effect toward the lower side of the roof profile. Roll the entire membrane surface with a rubber tire roller to ensure firm and uniform contact with the primed surface. Use special care to ensure that the membrane is uniformly adhered to the concrete. The entire membrane shall be free of wrinkles, air bubbles, and other placement defects. In the event bubbles or blisters do form under the membrane, puncture the bubbles or blisters with a sharp pointed instrument such as an awl and press the membrane firmly into contact with the roof. Repair any membrane punctures, tears, holes, and misaligned or inadequate seams with a patch of waterproofing membrane sized as required to ensure water tightness. Apply membrane flashing to expansion joints and cut, fit and seal the membrane flashing with mastic or by heat sealing.

Cover the corners of walls and all other perimeter edges with narrow strips (flashing strips of approximately 12 inches), hot rubberized sealer, or mastic in accordance with manufacturer guidelines. As an additional method of ensuring a watertight bond, all terminating edges, transverse overlaps and longitudinal overlaps may be heated with a propane torch to soften the top mat and fuse the surfaces together.

The applicator foreman or lead worker shall be certified by the manufacturer of the waterproofing membrane as approved applicators, and shall be present during all applications.

OVERLAYING THE MEMBRANE WITH CONCRETE

Construct the concrete according to scheduling requirements elsewhere in the contract. Cover all exposed membrane with the specified granular material and concrete mix within five (5) days after installation. Chemical solvents, gasoline, diesel fuel, mineral spirits, etc. shall not be spilled or leaked onto the membrane. Prior to covering the membrane with granular material and concrete, clean and dry the membrane of mud, dirt, oil, grease, or any other contaminants, and dry the membrane. Patch contaminated areas as required by the Engineer.

METHOD OF MEASUREMENT

Sheet Membrane Waterproofing, installed in accordance with the contract and accepted will be measured, in area by the square feet.

BASIS OF PAYMENT

Sheet membrane waterproofing, measured as provided above, shall be paid at the contract unit price. Payment is full compensation for furnishing and placing the primer, membrane, mastic, and hot rubberized

asphalt sealer; preparing the surface; and for furnishing all labor, tools, materials, equipment, and incidentals necessary to complete the contract work.

BID ITEM 90013 - UNDISTRIBUTED ABANDON VAULT

DESCRIPTION

The work shall consist of removing the vault roof, removing part of the outer walls and cracking the existing vault floor.

MATERIALS

Granular Backfill shall meet the requirements of Article 202 of the standard specifications.

METHOD OF MEASUREMENT

The department will measure Undistributed Abandon Vault in square feet of roof.

BASIS OF PAYMENT

Undistributed Abandon Vault measured as provided above, will be paid for at the contract price square feet, which price shall be payment in full for excavation of vault roof and vault walls, disposal of material and other debris, granular backfill, labor, material, equipment, and incidentals necessary to complete this item of work.

BID ITEM 90014 - UNDISTRIBUTED VAULT WALL

DESCRIPTION

The work shall consist of drilling in dowel bars and constructing a masonry wall.

MATERIALS

Clay brick, concrete brick, or concrete block masonry shall meet the requirements of Section 519 of the State of Wisconsin Standard Specifications. The new material shall match the existing foundation material. If the existing foundation is cast-in-place concrete, use concrete block or brick.

CONSTRUCTION

See construction details.

METHOD OF MEASUREMENT

The department will measure Undistributed Vault Wall in square feet of wall face.

BASIS OF PAYMENT

Undistributed Vault Wall shall be measured as provided above, will be paid for at the contract unit price square feet, which price shall be payment in full for construction of masonry wall, including ties to existing walls, waterproofing, labor, material, equipment, and incidentals necessary to complete this item of work.

BID ITEM 90030 – STORM CONTROL

DESCRIPTION

Work under this item shall include all work, materials, equipment, and incidentals required to control dry and wet weather flow in the storm sewer system during the reconstruction project. The Contractor shall take all necessary steps to protect the new and existing storm mains from damage during construction and to accommodate the existing flows during construction.

This item includes all storm control necessary for all aspects of the Construction. This item is not for control of groundwater.

METHOD OF MEASUREMENT

Storm Control shall be measured by the lump sum for all dewatering necessary throughout construction.

BASIS OF PAYMENT

Storm Control shall be paid for at the contract price, which shall be full compensation for all work as outlined in the description.

BID ITEM 90031 - PRIVATE STORM RECONNECT

DESCRIPTION

Work under this item shall include all work, materials, labor and incidentals necessary to connect existing private storm sewers to the new storm sewer main. Specifically, this item includes (at a minimum) the following: up to twenty five (25) feet of six (6) inch, ten (10) inch, or twelve (12) inch PVC pipe or RCP pipe (concrete pipe must be used under the roadway), compression couplings, or concrete collar to connect to the existing private system, and up to four (4) precast bends. The Contractor shall complete the following as part of this item:

- 1) Find the end of the existing system.
- 2) Remove the pipe to a point where it is covered by at least 6 inches of topsoil.
- 3) Connect to the pipe with a bend directing the pipe underground to a depth where a second or third bend can be installed directing the lateral toward the new storm sewer structure/pipe.
- 4) The lateral shall then be connected to the new storm sewer structure
 - All storm lateral pipe under the roadway must be RCP

METHOD OF MEASUREMENT

Private Storm Sewer Lateral Reconnect shall be measured as complete when each completed unit is installed in the field.

BASIS OF PAYMENT

Private Storm Sewer Lateral Reconnect shall be measured as described above which shall be full compensation for all work, materials and incidentals to complete the work as described above.

BID ITEM 90032 - PRIVATE STORM RECONNECT AND PIPE REPAIR

DESCRIPTION

This item is intended for the work needed to remove structure RS-3, repair the existing storm pipe, reconnect the private storm sewer, and remove and replace the existing private storm sewer under the roadway.

Work under this item shall include all work, materials, labor and incidentals necessary to:

- Remove inlet casting and chimney from RS-3 (saddled inlet)
- Saw cut out section of existing 14"x23" HERCP storm sewer over which RS-3 is saddled or remove pipe to next joint
- Replace section of 14"x23" HERCP with new pipe
- Remove and replace private PVC storm sewer pipe under roadway with 8" AWWA C900 DR18 PVC pipe
 - Includes approx 60' of pipe, backfill, bend, marker ball and all labor and incidentals necessary to complete the work
- Reconnect new private storm pipe to HERCP pipe
 - Contractor shall field core the existing pipe and provide a Core-n-T, Core-n-Seal boot, or approved equal to connect the new pipe to the existing pipe as detailed in Standard Detail Drawing 5.7.31.

METHOD OF MEASUREMENT

Private Storm Reconnect and Pipe Repair shall be measured as complete when each completed unit is installed in the field.

BASIS OF PAYMENT

Private Storm Reconnect and Pipe Repair shall be measured as described above which shall be full compensation for all work, materials and incidentals to complete the work as described above.

BID ITEM 90120 - CONCRETE BASES LB-3 MODIFIED

DESCRIPTION

This work shall consist of constructing concrete foundations as shown on the plans, in accordance with the pertinent provisions of Section 604 of the Standard Specifications and as hereinafter provided.

CONSTRUCTION

The bases shall be placed with one side of the bolt square parallel to the centerline of the street.

The top of the concrete base must be 2-inch +/- 0.5 inch above the adjacent sidewalk/terrace and the bolt circle pattern must be centered to be within a tolerance of +/- 0.25 inch. If the base is not within this tolerance the base will be required to be removed and reinstalled at the Contractors expense.

The bid item for LB-3 Modified base shall include cutting existing conduit and wire, pulling back and saving existing wire, and extending existing conduit and wire into each new base where streetlight conduit and/or wire already exists. Existing street light conductors shall be saved and reused. Any

existing wire that is damaged or removed by the contractor when it could have been reused shall be replaced by the contractor at no expense to the City. All work associated with installing conduit connection between existing conduit and new base, saving and reusing existing wire or removing existing wire from conduit is incidental to the bid item for LB-3 Modified base

METHOD OF MEASUREMENT

Concrete Base LB-3 Modified will be measured as a unit complete in place.

BASIS OF PAYMENT

Concrete Base LB-3 Modified, measured as provided above, will be paid for at the contract unit price each, which price shall be payment in full for picking up City-furnished anchor bolts; for furnishing and installing all materials including conduit, bushings, caps and/or plugs, ground rod, copper grounding wire, bar steel reinforcement, and concrete masonry; for excavation, including hand-digging as required, backfill, and disposal of surplus materials; and for all labor, tools, equipment, and incidentals necessary to complete this item of work.

BID ITEM 90121 - TEMPORARY WOOD POLE

DESCRIPTION

Work under this item consists of installing City-furnished temporary wood poles for overhead lighting as required, and for the locations determined by the Traffic Engineering (TE) Inspector. The quantity to be installed will be determined as the project progresses.

CONSTRUCTION

Wood poles will be sized to provide a minimum thirty (30) foot above grade height and be of the size and weight normally used for power poles. The poles shall be set in dug or bored holes, and set with compacted backfill. The location of each pole will be determined by the TE Inspector. The depth of the hole shall be approximately five feet, but fully subject to the review and revision by the TE Inspector. The poles shall be installed within one week after notification, or as directed by the TE Inspector. When they are no longer needed, they shall be removed and returned to the City of Madison Traffic Engineering Shop, 1120 Sayle Street. The City will install and subsequently remove any temporary facilities from these poles.

METHOD OF MEASUREMENT

Temporary Wood Pole will be measured as a unit complete in place, and removed after their use is no longer needed.

BASIS OF PAYMENT

Temporary Wood Pole, measured as provided above, will be paid for at the contract unit price each, which price shall be payment in full for picking up City-furnished wood poles, installing poles, furnishing backfill as needed, disposal of surplus materials; and for all labor, tools, equipment, and incidentals necessary to complete this item of work.

BID ITEM 90122 - BASE FOR MULTI SPACE PARKING METERS

General.

This item consists of picking up and installing city provided steel bases for multi space parking meters in accordance with the standard specifications, these Special Provisions, and the detail shown on the plans.

Materials.

All requirements specified in Article 301 - Concrete and Concrete Materials, regarding mix design, high-early strength concrete, testing, materials, mixing, placing, curing, and protecting the concrete, shall apply to the concrete used in the construction of said concrete slab around said bases.

Construction Methods.

Where bases are to be installed within existing sidewalks or improved terraces, the Contractor shall remove and replace the entire stone of sidewalk or improved terrace affected by the installation unless otherwise specified or directed by the Engineer.

The general locations of the bases are shown on the plans. The exact locations and elevations shall be established in the field by the Parking Utility Maintenance Supervisor (Dan Valenza, 266-4744). Unless otherwise specified, bases shall be placed with one side parallel to the center line of the adjacent sidewalk and the center of the base shall be four (4) feet from the face of the curb. The elevations of the bases shall be as shown on the detail unless otherwise specified.

The city-furnished steel base shall be cast into the concrete sidewalk slab. The top of the steel base shall be level, with a minimum depth of two inches below the finished slab grade.

The contractor shall install conduit as shown in the plan. Conduit shall extend three inches above the top of the steel base plate.

Unless otherwise specified, all backfill shall be in accordance with the requirements of Section 503.2 of these Specifications.

Measurement and Payment.

This item shall be measured as units, complete in place and accepted in accordance with the contract.

This item, measured as provided above, will be paid for at the contract unit price for each base, which price shall be payment in full for picking up and installing the city provided steel plate in the concrete slab and placing the concrete slab; for excavation, backfill, and disposal of surplus materials; and for all labor, tools, equipment and incidentals necessary to complete these items of work.

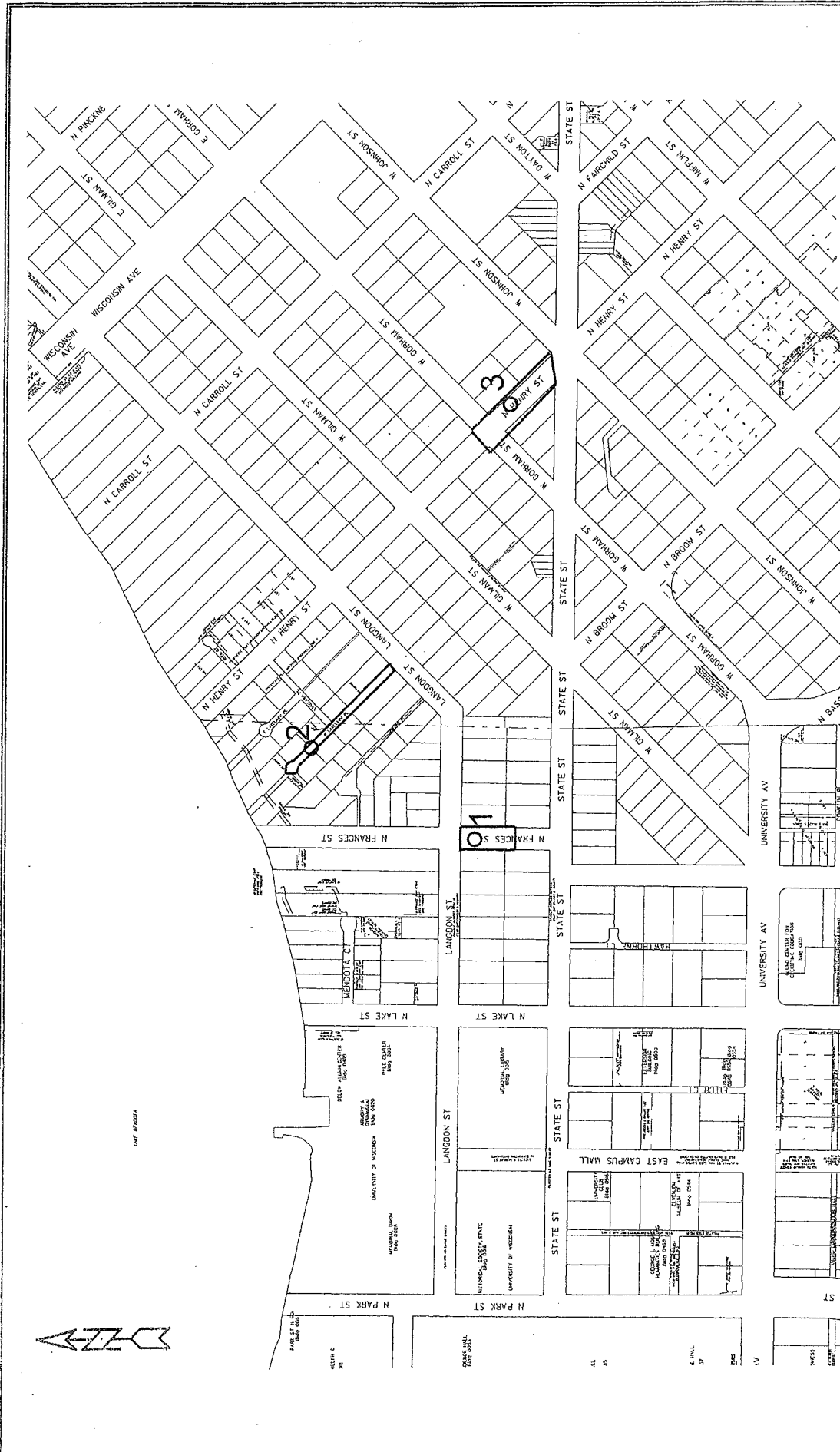

Legend

○ Denotes Boring Location (approximate)

Notes

1. Soil borings performed by Badger State Drilling in November 2011

SOIL BORING LOCATION PLAN
North Frances Street, West Lakelawn Place and North Henry Street
Madison, Wisconsin

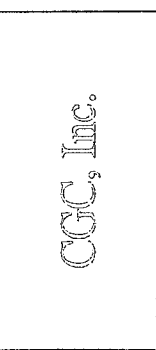

DWN: -	APP'D: MNS	Date: 12/11	C11054-19
--------	------------	-------------	-----------



LOG OF TEST BORING

Project Frances St., Lakelawn Pl. & Henry St.
Frances: 75'S of Langdon, 7'E of CL
 Location Madison, Wisconsin

Boring No. 1
 Surface Elevation (ft) 98.3*
 Job No. C11054-19
 Sheet 1 of 1

2921 Perry Street, Madison, WI 53713 (608) 288-4100, FAX (608) 288-7887

SAMPLE					VISUAL CLASSIFICATION and Remarks	SOIL PROPERTIES				
No.	REMARKS	Rec (in.)	Moist	N		Depth (ft)	qu (qa) (tsf)	W	LL	PL
					5	6 in. Asphalt Pavement/10" Base Course				
1		6	M	50	5	Dense, Brown Fine to Medium SAND, Some Silt and Gravel, Scattered Cobbles & Boulders (SM) (Possible Fill to 3 ft)				
2		18	M	34	5					
3		8	M	42	5					
4		18	M	45	5					
5		15	M	44	5					
					15	End Boring at 15 ft				
					15	Borehole backfilled with bentonite chips				
					20	*Elevation determined using an assumed datum of 100.0 ft referencing the top nut of a hydrant situated along Langdon at the intersection with Frances				

WATER LEVEL OBSERVATIONS	GENERAL NOTES
While Drilling <input checked="" type="checkbox"/> NW Upon Completion of Drilling <input type="checkbox"/> NW Time After Drilling _____ Depth to Water _____ Depth to Cave in _____	Start <u>8/10/11</u> End <u>8/10/11</u> Driller <u>Badger Chief</u> BM <u>BM</u> Rig <u>CME-55</u> Logger <u>MC</u> Editor <u>ESF</u> Drill Method <u>2 1/4" HSA</u>
The stratification lines represent the approximate boundary between soil types and the transition may be gradual.	



LOG OF TEST BORING

Project Frances St., Lakelawn Pl. & Henry St.
Henry: 65'SE of Gorham, 10'NE of CL
 Location Madison, Wisconsin

Boring No. 3
 Surface Elevation (ft) 95.5
 Job No. C11054-19
 Sheet 1 of 1

2921 Perry Street, Madison, WI 53713 (608) 286-4100, FAX (608) 288-7887

SAMPLE					VISUAL CLASSIFICATION and Remarks	SOIL PROPERTIES				
No.	Rec (in.)	Moist	N	Depth (ft)		qu (qa) (tsf)	W	LL	PL	LI
					7" Asphalt Pavement/10" Base Course					
1	15	M	10		Stiff to Very Stiff, Brown Lean CLAY (CL) (Probable Fill to 2.5 ft)	(3.25)				
2	18	M	8			(1.75)				
3	18	M	5			(2.0)				
					Soft to Medium Stiff, Brown Mottled Lean CLAY (CL)	(0.3)				
4	6	M	21			(0.75)				
5	12	M	27		Medium Dense, Brown Fine to Medium SAND, Some Silt and Gravel, Scattered Cobbles & Boulders (SM)					
6	18	M	19							
					End Boring at 15 ft					
					Borehole backfilled with bentonite chips					
					*Elevation determined using an assumed datum of 100.0 ft referencing the top nut of a hydrant situated along Gorham at the intersection with Henry					

WATER LEVEL OBSERVATIONS

GENERAL NOTES

While Drilling NW Upon Completion of Drilling NW
 Time After Drilling _____
 Depth to Water _____
 Depth to Cave in _____

Start 8/10/11 End 8/10/11
 Driller Badger Chief BM Rig CME-55
 Logger MC Editor ESF
 Drill Method 2 1/4" HSA

The stratification lines represent the approximate boundary between soil types and the transition may be gradual.

SECTION E: PROPOSAL

**WEST GORHAM STREET, N. HENRY STREET & N. FRANCES STREET
ASSESSMENT DISTRICT - 2012
CONTRACT NO. 6785**

Bidder must state a Unit Price and Total Bid for each item. The Total Bid for each item must be the product of quantity, by Unit Price. The Grand Total must be the sum of the Total Bids for the various items. In case of multiplication errors or addition errors, the Grand Total with corrected multiplication and/or addition shall determine the Grand Total bid for each contract. The Unit Price and Total Bid must be entered numerically in the spaces provided. All words and numbers shall be written in ink.

1. The undersigned having familiarized himself/herself with the Contract documents, including Advertisement for Bids, Instructions to Bidders, Form of Proposal, City of Madison Standard Specifications for Public Works Construction - 2012 Edition thereto, Form of Agreement, Form of Bond, and Addenda issued and attached to the plans and specifications on file in the office of the City Engineer, hereby proposes to provide and furnish all the labor, materials, tools, and expendable equipment necessary to perform and complete in a workmanlike manner the specified construction on this project for the City of Madison; all in accordance with the plans and specifications as prepared by the City Engineer, including Addenda to the Contract Nos. _____ through _____ issued thereto, at the prices for said work as contained in this proposal.
2. If awarded the Contract, we will initiate action within seven (7) days after notification or in accordance with the date specified in the contract to begin work and will proceed with diligence to bring the project to full completion within the number of work days allowed in the Contract or by the calendar date stated in the Contract.
3. The undersigned Bidder or Contractor certifies that he/she is not a party to any contract, combination in form of trust or otherwise, or conspiracy in restraint of trade or commerce or any other violation of the anti-trust laws of the State of Wisconsin or of the United States, with respect to this bid or contract or otherwise.
4. Accompanying this Proposal is Bid Bond or Certified Check in the amount of _____ Dollars (\$ _____) or a Certificate of Biennial Bid Bond as required by the Advertisement for Bids.
(IF BID BOND IS USED, IT SHALL BE SUBMITTED ON THE FORMS PROVIDED BY THE CITY. FAILURE TO DO SO MAY RESULT IN REJECTION OF THE BID).
5. I hereby certify that all statements herein are made on behalf of _____
(name of corporation, partnership, or person submitting bid)
a corporation organized and existing under the laws of the State of _____ a
partnership consisting of _____; an individual trading as _____; of
the City of _____; State of _____; that I have examined and carefully prepared this
Proposal, from the plans and specifications and have checked the same in detail before submitting
this Proposal; that I have fully authority to make such statements and submit this Proposal in (its,
their) behalf; and that the said statements are true and correct.

SIGNATURE

TITLE, IF ANY

Sworn and subscribed to before me this
_____ day of _____, 20_____

(Notary Public or other officer authorized to administer oaths)
My Commission Expires _____

Bidders shall not add any conditions or qualifying statements to this Proposal.

**WEST GORHAM STREET, N. HENRY STREET & N. FRANCES STREET ASSESSMENT
DISTRICT - 2012
CONTRACT NO. 6785**

State of Wisconsin
Department of Workforce Development
Equal Rights Division
Labor Standards Bureau

Disclosure of Ownership

Notice required under Section 15.04(1)(m), Wisconsin Statutes. The statutory authority for the use of this form is prescribed in Sections 66.0903(12)(d) and 103.49(7)(d), Wisconsin Statutes. The use of this form is mandatory. The penalty for failing to complete this form is prescribed in Section 103.005(12), Wisconsin Statutes. Personal information you provide may be used for secondary purposes.

- (1) On the date a contractor submits a bid to or completes negotiations with a state agency or local governmental unit, on a project subject to Section 66.0903 or 103.49, Wisconsin Statutes, the contractor shall disclose to such state agency or local governmental unit the name of any "other construction business", which the contractor, or a shareholder, officer or partner of the contractor, owns or has owned within the preceding three (3) years.
- (2) The term "other construction business" means any business engaged in the erection, construction, remodeling, repairing, demolition, altering or painting and decorating of buildings, structures or facilities. It also means any business engaged in supplying mineral aggregate, or hauling excavated material or spoil as provided by Sections 66.0903(3), 103.49(2) and 103.50(2), Wisconsin Statutes.
- (3) This form must **ONLY** be filed, with the state agency or local governmental unit that will be awarding the contract, if **both (A) and (B) are met.**
 - (A) The contractor, or a shareholder, officer or partner of the contractor:
 - (1) Owns at least a 25% interest in the "other construction business", indicated below, on the date the contractor submits a bid or completes negotiations.
 - (2) Or has owned at least a 25% interest in the "other construction business" at any time within the preceding three (3) years.
 - (B) The Wisconsin Department of Workforce Development (DWD) has determined that the "other construction business" has failed to pay the prevailing wage rate or time and one-half the required hourly basic rate of pay, for hours worked in excess of the prevailing hours of labor, to any employee at any time within the preceding three (3) years.

Other Construction Business

Name of Business			
Street Address or P O Box	City	State	Zip Code
Name of Business			
Street Address or P O Box	City	State	Zip Code
Name of Business			
Street Address or P O Box	City	State	Zip Code

I hereby state under penalty of perjury that the information, contained in this document, is true and accurate according to my knowledge and belief.

Print the Name of Authorized Officer			
Signature of Authorized Officer	Date Signed		
Name of Corporation, Partnership or Sole Proprietorship			
Street Address or P O Box	City	State	Zip Code

If you have any questions call (608) 266-0028

**WEST GORHAM STREET, N. HENRY STREET & N. FRANCES STREET
ASSESSMENT DISTRICT - 2012
CONTRACT NO. 6785**

Best Value Contracting

1. The Contractor shall indicate the non-apprenticeable trades used on this contract.

2. Some Contractors are exempt due to the size of the work force. Apprenticeable trades are those trades considered apprenticeable by the State of Wisconsin.

Check Here if the Contractor has a total skilled work force of four or less individuals in all apprenticeable trades combined. This contractor is exempt from Best Value Contracting.

3. The Contractor shall indicate on page E-4 which apprenticeable trades are to be used on this Contract and shall indicate by checking the appropriate box for the trades used, how the contractor will comply with Madison General Ordinance 33.07(7).

Legend

Number of Journeyworkers	The Contractor shall indicated for trades to be used on this Contract only, the number of journeyworkers that the Contractor has employed company wide.
W-ATT	The Contractor is an active trade trainer in the State of Wisconsin for the trade indicated.
US-ATT	The Contractor is an active trade trainer in an apprenticeship program approved by the U.S. Department of Labor or another state apprenticeship agency in the trade indicated.
SB-ATT	The Contractor shall become an active trade trainer prior to beginning work on the Contract in the trade indicated.

The Contractor has reviewed the list on page E-4 and shall not use any apprenticeable trades on this project.

The Contractor has reviewed this list on E-4 and has checked the appropriate box by each apprenticeable trade to be used on the project.

**WEST GORHAM STREET, N. HENRY STREET & N. FRANCES STREET
ASSESSMENT DISTRICT - 2012
CONTRACT NO. 6785**

Apprenticeable Trades

Check the box in the column "Trade Used on This Project" for each apprenticeable trades used on this project. For those trades used on the project indicated the number of journeyworkers that are employed company wide and check a box to the right of the trade as to how the Contractor will comply MGO 33.07(7). Refer to the legend on page E-3 for the meaning associated with each heading. The Contractor must check one of the boxes on the right for each apprenticeable trade used and checked on the left.

Trade Used on Contract	Apprenticeable Trades	Number of Journeyworkers	W-ATT	US-ATT	SB-ATT
<input type="checkbox"/>	Bricklayer		<input type="checkbox"/>	<input type="checkbox"/>	<input type="checkbox"/>
<input type="checkbox"/>	Carpenter		<input type="checkbox"/>	<input type="checkbox"/>	<input type="checkbox"/>
<input type="checkbox"/>	Cement Mason / Concrete Finisher		<input type="checkbox"/>	<input type="checkbox"/>	<input type="checkbox"/>
<input type="checkbox"/>	Cement Mason (Heavy Highway)		<input type="checkbox"/>	<input type="checkbox"/>	<input type="checkbox"/>
<input type="checkbox"/>	Construction Craft Laborer		<input type="checkbox"/>	<input type="checkbox"/>	<input type="checkbox"/>
<input type="checkbox"/>	Data Communication Installer		<input type="checkbox"/>	<input type="checkbox"/>	<input type="checkbox"/>
<input type="checkbox"/>	Electrician		<input type="checkbox"/>	<input type="checkbox"/>	<input type="checkbox"/>
<input type="checkbox"/>	Environmental Systems Technician / HVAC Service Tech/HVAC Install / Service		<input type="checkbox"/>	<input type="checkbox"/>	<input type="checkbox"/>
<input type="checkbox"/>	Glazier		<input type="checkbox"/>	<input type="checkbox"/>	<input type="checkbox"/>
<input type="checkbox"/>	Heavy Equipment Operator / Operating Engineer		<input type="checkbox"/>	<input type="checkbox"/>	<input type="checkbox"/>
<input type="checkbox"/>	Insulation Worker (Heat & Frost)		<input type="checkbox"/>	<input type="checkbox"/>	<input type="checkbox"/>
<input type="checkbox"/>	Iron Worker		<input type="checkbox"/>	<input type="checkbox"/>	<input type="checkbox"/>
<input type="checkbox"/>	Iron Worker (Assembler, Metal Bldgs)		<input type="checkbox"/>	<input type="checkbox"/>	<input type="checkbox"/>
<input type="checkbox"/>	Painter & Decorator		<input type="checkbox"/>	<input type="checkbox"/>	<input type="checkbox"/>
<input type="checkbox"/>	Plasterer		<input type="checkbox"/>	<input type="checkbox"/>	<input type="checkbox"/>
<input type="checkbox"/>	Plumber		<input type="checkbox"/>	<input type="checkbox"/>	<input type="checkbox"/>
<input type="checkbox"/>	Residential Electrician		<input type="checkbox"/>	<input type="checkbox"/>	<input type="checkbox"/>
<input type="checkbox"/>	Roofer & Waterproofer		<input type="checkbox"/>	<input type="checkbox"/>	<input type="checkbox"/>
<input type="checkbox"/>	Sheet Metal Worker		<input type="checkbox"/>	<input type="checkbox"/>	<input type="checkbox"/>
<input type="checkbox"/>	Sprinklerfitter		<input type="checkbox"/>	<input type="checkbox"/>	<input type="checkbox"/>
<input type="checkbox"/>	Steamfitter		<input type="checkbox"/>	<input type="checkbox"/>	<input type="checkbox"/>
<input type="checkbox"/>	Steamfitter (Refrigeration)		<input type="checkbox"/>	<input type="checkbox"/>	<input type="checkbox"/>
<input type="checkbox"/>	Steamfitter (Service)		<input type="checkbox"/>	<input type="checkbox"/>	<input type="checkbox"/>
<input type="checkbox"/>	Taper & Finisher		<input type="checkbox"/>	<input type="checkbox"/>	<input type="checkbox"/>
<input type="checkbox"/>	Telecommunications (Voice, Data & Video) Installer-Technician		<input type="checkbox"/>	<input type="checkbox"/>	<input type="checkbox"/>
<input type="checkbox"/>	Tile Setter		<input type="checkbox"/>	<input type="checkbox"/>	<input type="checkbox"/>

PROPOSAL

NAME OF BIDDER

**WEST GORHAM STREET, NORTH HENRY STREET & NORTH FRANCES STREET
ASSESSMENT DISTRICT - 2012 (STATE STREET SIDE STREETS)**

CONTRACT NO. 6785

ITEM	TYPE OF WORK	ESTIMATED QUANTITIES	UNIT PRICE BID	TOTAL BID
STREET ACCOUNT NO. CS53-58250-810571-00-53W1192-53TIF032				
10701	TRAFFIC CONTROL	1	LUMP SUM	
10801	ROOT CUTTING - CURB & GUTTER	120	L.F.	
10802	ROOT CUTTING - SIDEWALK	120	L.F.	
10911	MOBILIZATION	1	LUMP SUM	
20101	EXCAVATION CUT	1160	C.Y.	
20140	GEOTEXTILE FABRIC TYPE SAS (NON-WOVEN)	100	S.Y.	
20219	BREAKER RUN	400	TON	
20301	SAWCUT CONCRETE PAVEMENT, FULL DEPTH	80	L.F.	
20303	SAWCUT BITUMINOUS PAVEMENT, FULL DEPTH	80	L.F.	
20321	REMOVE CONCRETE PAVEMENT	1500	S.Y.	
20322	REMOVE CONCRETE CURB & GUTTER	520	L.F.	
20323	REMOVE CONCRETE SIDEWALK & DRIVE	10950	S.F.	
20327	REMOVE TREE GRATE	19	EACH	
20401	CLEARING	16	I.D.	
20403	GRUBBING	24	I.D.	
30122	EPOXY COATED BAR STEEL REINFORCING	2200	L.F.	
30201	TYPE "A" CONCRETE CURB & GUTTER	530	L.F.	

**WEST GORHAM STREET, NORTH HENRY STREET & NORTH FRANCES STREET
ASSESSMENT DISTRICT - 2012 (STATE STREET SIDE STREETS)**

CONTRACT NO. 6785

ITEM	TYPE OF WORK	ESTIMATED QUANTITIES		UNIT PRICE BID	TOTAL BID
30203	TYPE "X" CONCRETE CURB & GUTTER	35	L.F.		
30301	5" CONCRETE SIDEWALK	6100	S.F.		
30302	7" CONCRETE SIDEWALK AND DRIVE	1300	S.F.		
30340	CURB RAMP DETECTABLE WARNING FIELD	64	S.F.		
30341	TREE GRATE 4'X6' (INCLUDING FRAME)	2	EACH		
30342	TREE GRATE 4'X8' (INCLUDING FRAME)	16	EACH		
40101	CRUSHED AGGREGATE BASE COURSE, GRADATION 1	460	TON		
40102	CRUSHED AGGREGATE BASE COURSE , GRADATION 2	1050	TON		
40202	HMA PAVEMENT TYPE E-1	500	TON		
40211	BITUMINOUS TACK COAT	100	GAL		
40231	ASPHALT DRIVE & TERRACE (UNDISTRIBUTED)	50	S.Y.		
40301	FULL WIDTH GRINDING	350	S.Y.		
90001	TEMPORARY SIDEWALK ACCESS	1	LUMP SUM		
90002	FENCE SAFETY	900	L.F.		
90003	C1 CONCRETE SIDEWALK 7-INCH	3075	S.F.		
90004	C1 CONCRETE STRUCTURAL SLAB 7-INCH	110	S.F.		
90005	CONCRETE SIDEWALK TEST POUR	1	EACH		
90006	CARDBOARD VOID FORMS	110	S.F.		
90007	REMOVE BENCH	1	EACH		

**WEST GORHAM STREET, NORTH HENRY STREET & NORTH FRANCES STREET
ASSESSMENT DISTRICT - 2012 (STATE STREET SIDE STREETS)**

CONTRACT NO. 6785

ITEM	TYPE OF WORK	ESTIMATED QUANTITIES		UNIT PRICE BID	TOTAL BID
90008	INSTALL BENCH	3	EACH		
90009	DECOMPOSED GRANITE	970	S.F.		
90010	REMOVE & SALVAGE BRICK PAVERS	700	S.F.		
90011	RESET BRICK PAVERS	450	S.F.		
90012	UNDISTRIBUTED SHEET MEMBRANE WATERPROOFING	500	S.F.		
90013	UNDISTRIBUTED ABANDON VAULT	400	S.F.		
90014	UNDISTRIBUTED VAULT WALL	100	S.F.		
STREET ACCOUNT NO. CS53-58270-810571-00-53W1192-53TIF032					
20217	CLEAR STONE	200	TON		
21001	EROSION CONTROL PLAN & IMPLEMENTATION	1	LUMP SUM		
21002	EROSION CONTROL INSPECTION	5	EACH		
21011	CONSTRUCTION ENTRANCE	5	EACH		
21013	STREET SWEEPING	1	LUMP SUM		
21042	INLET PROTECTION, TYPE D - PROVIDE & INSTALL	1	EACH		
21043	INLET PROTECTION, TYPE D - MAINTAIN	1	EACH		
21044	INLET PROTECTION, TYPE D - REMOVE	1	EACH		
21046	INLET PROTECTION, TYPE D MODIFIED - PROVIDE & INSTALL	15	EACH		
21047	INLET PROTECTION MODIFIED, TYPE D - MAINTAIN	15	EACH		
21048	INLET PROTECTION MODIFIED, TYPE D - REMOVE	15	EACH		
50411	12 INCH RCP STORM SEWER PIPE	79	L.F.		

**WEST GORHAM STREET, NORTH HENRY STREET & NORTH FRANCES STREET
ASSESSMENT DISTRICT - 2012 (STATE STREET SIDE STREETS)**

CONTRACT NO. 6785

ITEM	TYPE OF WORK	ESTIMATED QUANTITIES		UNIT PRICE BID	TOTAL BID
50741	TYPE H INLET	3	EACH		
50801	UTILITY LINE OPENING (ULO)	2	EACH		

STORM ACCOUNT NO. ESTM-58270-810381-00-53W1192

10912	MOBILIZATION FOR STORM SEWER INSTALLATION	1	LUMP SUM		
20313	REMOVE INLET	3	EACH		
20502	ADJUST CATCHBASIN	1	EACH		
20503	ADJUST INLET	1	EACH		
50211	SELECT BACKFILL FOR STORM	79	T.F.		
50792	STORM SEWER TAP	1	EACH		
90030	STORM CONTROL	1	LUMP SUM		
90031	PRIVATE STORM RECONNECT	3	EACH		
90032	PRIVATE STORM RECONNECT AND PIPE REPAIR	1	EACH		

SANITARY ACCOUNT NO. ES01-58275-810332-00-53W1192

10914	MOBILIZATION FOR SANITARY SEWER INSTALLATION	1	LUMP SUM		
20311	REMOVE SEWER ACCESS STRUCTURE	1	EACH		
20336	PIPE PLUG	4	EACH		
20501	ADJUST SEWER ACCESS STRUCTURE	1	EACH		
50212	SELECT BACKFILL FOR SANITARY SEWER	301	T.F.		
50302	10 INCH PVC SANITARY SEWER PIPE	161	L.F.		
50353	SANITARY SEWER LATERAL SDR 26 AND 35	140	L.F.		

**WEST GORHAM STREET, NORTH HENRY STREET & NORTH FRANCES STREET
ASSESSMENT DISTRICT - 2012 (STATE STREET SIDE STREETS)**

CONTRACT NO. 6785

ITEM	TYPE OF WORK	ESTIMATED QUANTITIES		UNIT PRICE BID	TOTAL BID
50354	RECONNECT	9	EACH		
50361	WASTEWATER CONTROL	1	LUMP SUM		
50390	SEWER ELECTRONIC MARKERS	18	EACH		
50701	4' DIA. SANITARY SAS	2	EACH		
50771	INTERNAL CHIMNEY SEAL	1	EACH		
50903	FURNISH AND INSTALL CIPP TO REHABILITATE 10-INCH DIAMETER SANITARY SEWER MAINS	67	L.F.		
50909	REINSTATE AND RECONNECT SERVICE OPENINGS	1	EACH		

WATER ACCOUNT NO. EW01-58273-810455-00-53W1192

10703	TRAFFIC CONTROL FOR WATER MAIN INSTALLATION	1	LUMP SUM		
10913	MOBILIZATION FOR WATER MAIN INSTALLATION	1	LUMP SUM		
50225	UTILITY TRENCH PATCH TYPE III	36	T.F.		
70001	FURNISH AND INSTALL 4 INCH PIPE & FITTINGS	40	L.F.		
70002	FURNISH AND INSTALL 6 INCH PIPE & FITTINGS	80	L.F.		
70003	FURNISH AND INSTALL 8 INCH PIPE & FITTINGS	180	L.F.		
70407	FURNISH AND INSTALL HYDRANT	1	EACH		
70408	SELECT FILL - SAND FOR WATER	300	L.F.		
70413	FURNISH AND INSTALL STYROFOAM	8	L.F.		
70414	CUT OFF EXISTING WATER MAIN	4	EACH		
70415	ABANDON WATER VALVE BOX	4	EACH		

**WEST GORHAM STREET, NORTH HENRY STREET & NORTH FRANCES STREET
ASSESSMENT DISTRICT - 2012 (STATE STREET SIDE STREETS)**

CONTRACT NO. 6785

ITEM	TYPE OF WORK	ESTIMATED QUANTITIES		UNIT PRICE BID	TOTAL BID
70418	ADJUST WATER VALVE BOX	6	EACH		
70427	FURNISH AND INSTALL 4 INCH VALVE	1	EACH		
70428	FURNISH AND INSTALL 6 INCH VALVE	2	EACH		
70440	EXTEND AND RECONNECT SERVICE LATERAL - 1 INCH	15	L.F.		
70443	RECONNECT / DISCONNECT SERVICE LATERAL - 1 INCH	1	EACH		
70444	RECONNECT / DISCONNECT SERVICE LATERAL - 1.5 INCHES OR 2 INCHES	2	EACH		
70450	FURNISH AND INSTALL CURB BOX	1	EACH		
70451	FURNISH AND INSTALL CURB STOP	1	EACH		
70452	ADJUST WATER SERVICE BOX	4	EACH		
70453	ABANDON EXISTING CURB BOX	3	EACH		
70454	REPLACE COPPER SERVICE LATERAL	40	L.F.		
70455	PIPE PLUG FOR WATER MAIN INSTALLATION	2	EACH		
70456	FURNISH EXCAVATION AND DITCH FOR LIVE TAP	2	EA		
90160	FURNISH & INSTALL 6" MJ CAP W/ 2" CORP & RECONNECT TO EX. SERVICE	1	EA		

STREET LIGHTS ACCOUNT NO. CS53-58545-810571-00-53W1192

60222	FURNISH & INSTALL 3 INCH PVC (SCHEDULE 80) CONDUIT	400	L.F.		
60224	FURNISH & INSTALL 3 INCH PVC (SCHEDULE 40) CONDUIT	210	L.F.		
60230	FURNISH & INSTALL 2 INCH PVC (SCHEDULE 80) CONDUIT	400	L.F.		
60232	FURNISH & INSTALL 2 INCH PVC (SCHEDULE 40) CONDUIT	1400	L.F.		

**WEST GORHAM STREET, NORTH HENRY STREET & NORTH FRANCES STREET
ASSESSMENT DISTRICT - 2012 (STATE STREET SIDE STREETS)**

CONTRACT NO. 6785

ITEM	TYPE OF WORK	ESTIMATED QUANTITIES		UNIT PRICE / BID	TOTAL BID
60234	FURNISH & INSTALL 1 1/4 INCH PVC (SCHEDULE 40) CONDUIT	200	L.F.		
60241	GOPHER RACEWAY FOR ELECTRICAL CONDUIT OR CABLE-IN-DUCT	270	L.F.		
60403	CONSTRUCT LB-3 BASE	4	EACH		
60421	REMOVE STREET LIGHT BASE	4	EACH		
60427	REMOVE ELECTRICAL HANDHOLE	6	EACH		
60261	ELECTRICAL TRENCH	1650	L.F.		
60702	CONSTRUCT ELECTRICAL HANDHOLE TYPE I	7	EACH		
60706	CONSTRUCT ELECTRICAL HANDHOLE TYPE V	1	EACH		
90120	CONCRETE BASES LB-3 MODIFIED	19	EACH		
90121	TEMPORARY WOOD POLE	4	EACH		
90122	BASE FOR MULTISPACE PARKING METER	4	EACH		
				GRAND TOTAL	

SECTION F: BID BOND

KNOW ALL MEN BY THESE PRESENT, THAT _____
(a corporation of the State of _____) (individual), (partnership), hereinafter referred to as
the "Principal") and _____, a corporation of the State of _____ (hereinafter referred
to as the "Surety") and licensed to do business in the State of Wisconsin, are held and firmly bound unto
the City of Madison, (hereinafter referred to as the "Obligee"), in the sum of five per cent (5%) of the
amount of the total bid or bids of the Principal herein accepted by the Obligee, for the payment of which
the Principal and the Surety bind themselves, their heirs, executors, administrators, successors and
assigns, jointly and severally, firmly by these presents.

The conditions of this obligation are such that, whereas the Principal has submitted, to the City of
Madison a certain bid, including the related alternate, and substitute bids attached hereto and hereby made
a part hereof, to enter into a contract in writing for the construction of:

WEST GORHAM STREET, N. HENRY STREET & N. FRANCES STREET ASSESSMENT DISTRICT - 2012 CONTRACT NO. 6785

1. If said bid is rejected by the Obligee, then this obligation shall be void.
2. If said bid is accepted by the Obligee and the Principal shall execute and deliver a contract in the
form specified by the Obligee (properly completed in accordance with said bid) and shall furnish
a bond for his/her faithful performance of said contract, and for the payment of all persons
performing labor or furnishing materials in connection therewith, and shall in all other respects
perform the agreement created by the acceptance of said bid, then this obligation shall be void.

If said bid is accepted by the Obligee and the Principal shall fail to execute and deliver the
contract and the performance and payment bond noted in 2. above executed by this Surety, or
other Surety approved by the City of Madison, all within the time specified or any extension
thereof, the Principal and Surety agree jointly and severally to forfeit to the Obligee as liquidated
damages the sum mentioned above, it being understood that the liability of the Surety for any and
all claims hereunder shall in no event exceed the sum of this obligation as stated, and it is further
understood that the Principal and Surety reserve the right to recover from the Obligee that portion
of the forfeited sum which exceed the actual liquidated damages incurred by the Obligee.

The Surety, for value received, hereby stipulates and agrees that the obligations of said Surety
and its bond shall be in no way impaired or affected by an extension of the time within which the
Obligee may accept such bid, and said Surety does hereby waive notice of any such extension.

IN WITNESS WHEREOF, the Principal and the Surety have hereunto set their hands and seals, and such of them as are corporations have caused their corporate seals to be hereto affixed and these presents to be signed by their proper officers, on the day and year set forth below.

Seal

Principal

Date

By:

Name of Surety

By:

Date

This certifies that I have been duly licensed as an agent for the above company in Wisconsin under License No. _____ for the year _____, and appointed as attorney in fact with authority to execute this bid bond and the payment and performance bond referred to above, which power of attorney has not been revoked.

Date

Agent

Address

City, State and Zip Code

Telephone Number

NOTE TO SURETY & PRINCIPAL

The bid submitted which this bond guarantees may be rejected if the following instrument is not attached to this bond:

Power of Attorney showing that the agent of Surety is currently authorized to execute bonds on behalf of the Surety, and in the amounts referenced above.

Certificate of Biennial Bid Bond

TIME PERIOD - VALID (FROM/TO)
NAME OF SURETY
NAME OF CONTRACTOR
CERTIFICATE HOLDER <p style="text-align: center;">City of Madison, Wisconsin</p>

This is to certify that a biennial bid bond issued by the above-named Surety is currently on file with the City of Madison.

This certificate is issued as a matter of information and conveys no rights upon the certificate holder and does not amend, extend or alter the coverage of the biennial bid bond.

Cancellation: Should the above policy be cancelled before the expiration date, the issuing Surety will give thirty (30) days written notice to the certificate holder indicated above.

Signature of Authorized Contractor Representative

Date

SECTION G: AGREEMENT

THIS AGREEMENT made this _____ day of _____ in the year Two Thousand and Twelve between _____ hereinafter called the Contractor, and the City of Madison, Wisconsin, hereinafter called the City.

WHEREAS, the Common Council of the said City of Madison under the provisions of a resolution adopted _____, and by virtue of authority vested in the said Council, has awarded to the Contractor the work of performing certain construction.

NOW, THEREFORE, the Contractor and the City, for the consideration hereinafter named, agree as follows:

1. **Scope of Work.** The Contractor shall, perform the construction, execution and completion of the following listed complete work or improvement in full compliance with the Plans, Specifications, Standard Specifications, Supplemental Specifications, Special Provisions and contract; perform all items of work covered or stipulated in the proposal; perform all altered or extra work; and shall furnish, unless otherwise provided in the contract, all materials, implements, machinery, equipment, tools, supplies, transportation, and labor necessary to the prosecution and completion of the work or improvements:

WEST GORHAM STREET, N. HENRY STREET & N. FRANCES STREET ASSESSMENT DISTRICT - 2012 CONTRACT NO. 6785

2. **Completion Date/Contract Time.** Construction work must begin within seven (7) calendar days after the date appearing on mailed written notice to do so shall have been sent to the Contractor and shall be carried on at a rate so as to secure full completion SEE SPECIAL PROVISIONS, the rate of progress and the time of completion being essential conditions of this Agreement.
3. **Contract Price.** The City shall pay to the Contractor at the times, in the manner and on the conditions set forth in said specifications, the sum of _____ (\$ _____) Dollars being the amount bid by such Contractor and which was awarded to him/her as provided by law.
4. **Wage Rates for Employees of Public Works Contractors**

General and Authorization. The Contractor shall compensate its employees at the prevailing wage rate in accordance with section 66.0903, Wis. Stats., DWD 290 of the Wisconsin Administrative Code and as hereinafter provided.

“Public Works” shall include building or work involving the erection, construction, remodeling, repairing or demolition of buildings, parking lots, highways, streets, bridges, sidewalks, street lighting, traffic signals, sanitary sewers, water mains and appurtenances, storm sewers, and the grading and landscaping of public lands.

“Building or work” includes construction activity as distinguished from manufacturing, furnishing of materials, or servicing and maintenance work, except for the delivery of mineral aggregate such as sand, gravel, bituminous asphaltic concrete or stone which is incorporated into the work under contract with the City by depositing the material directly in final place from transporting vehicle.

“Erection, construction, remodeling, repairing” means all types of work done on a particular building or work at the site thereof in the construction or development of the project, including without limitation, erecting, construction, remodeling, repairing, altering, painting, and decorating, the transporting of materials and supplies to or from the building or work done by the employees of the Contractor, Subcontractor, or Agent thereof, and the manufacturing or furnishing of materials, articles, supplies or equipment on the site of the building or work, by persons employed by the Contractor, Subcontractor, or Agent thereof.

“Employees working on the project” means laborers, workers, and mechanics employed directly upon the site of work.

“Laborers, Workers, and Mechanics” include preapprentices, helpers, trainees, learners and properly registered and indentured apprentices but exclude clerical, supervisory, and other personnel not performing manual labor.

Establishment of Wage Rates. The Department of Public Works shall periodically obtain a current schedule of prevailing wage rates from DWD. The schedule shall be used to establish the City of Madison Prevailing Wage Rate Schedule for Public Works Construction (prevailing wage rate). The Department of Public Works may include known increases to the prevailing wage rate which can be documented and are to occur on a future specific date. The prevailing wage rate shall be included in public works contracts subsequently negotiated or solicited by the City. Except for known increases contained within the schedule, the prevailing wage rate shall not change during the contract. The approved wage rate is attached hereto.

Workforce Profile. The Contractor shall, at the time of signature of the contract, notify the City Engineer in writing of the names and classifications of all the employees of the Contractor, Subcontractors, and Agents proposed for the work. In the alternative, the Contractor shall submit in writing the classifications of all the employees of the Contractor, Subcontractors and Agents and the total number of hours estimated in each classification for the work. This workforce profile(s) shall be reviewed by the City Engineer who may, within ten (10) days, object to the workforce profile(s) as not being reflective of that which would be required for the work. The Contractor may request that the workforce profile, or a portion of the workforce profile, be submitted after the signature of the contract but at least ten (10) days prior to the work commencing. Any costs or time loss resulting from modifications to the workforce profile as a result of the City Engineer’s objections shall be the responsibility of the Contractor.

Payrolls and Records. The Contractor shall keep weekly payroll records setting forth the name, address, telephone number, classification, wage rate and fringe benefit package of all the employees who work on the contract, including the employees of the Contractor’s subcontractors and agents. Such weekly payroll records must include the required information for all City contracts and all other contracts on which the employee worked during the week in which the employee worked on the contract. The Contractor shall also keep records of the individual time each employee worked on the project and for each day of the project. Such records shall also set forth the total number of hours of overtime credited to each such employee for each day and week and the amount of overtime pay received in that week. The records shall set forth the full weekly wages earned by each employee and the actual hourly wage paid to the employee.

The Contractor shall submit the weekly payroll records, including the records of the Contractor’s subcontractors and agents, to the City Engineer for every week that work is being done on the contract. The submittal shall be within twenty-one (21) calendar days of the end of the Contractor’s weekly pay period.

Employees shall receive the full amounts accrued at the time of the payment, computed at rates not less than those stated in the prevailing wage rate and each employee's rate shall be determined by the work that is done within the trade or occupation classification which should be properly assigned to the employee.

An employee's classification shall not be changed to a classification of a lesser rate during the contract. If, during the term of the contract, an employee works in a higher pay classification than the one which was previously properly assigned to the employee, then that employee shall be considered to be in the higher pay classification for the balance of the contract, receive the appropriate higher rate of pay, and she/he shall not receive a lesser rate during the balance of the contract. For purposes of clarification, it is noted that there is a distinct difference between working in a different classification with higher pay and doing work within a classification that has varying rates of pay which are determined by the type of work that is done within the classification. For example, the classification "Operating Engineer" provides for different rates of pay for various classes of work and the Employer shall compensate an employee classified as an "Operating Engineer" based on the highest class of work that is done in one day. Therefore, an "Operating Engineer's" rate may vary on a day to day basis depending on the type of work that is done, but it will never be less than the base rate of an "Operating Engineer". Also, as a matter of clarification, it is recognized that an employee may work in a higher paying classification merely by chance and without prior intention, calculation or design. If such is the case and the performance of the work is truly incidental and the occurrence is infrequent, inconsequential and does not serve to undermine the single classification principle herein, then it may not be required that the employee be considered to be in the higher pay classification and receive the higher rate of pay for the duration of the contract. However, the Contractor is not precluded or prevented from paying the higher rate for the limited time that an employee performs work that is outside of the employee's proper classification.

Questions regarding an employee's classification, rate of pay or rate of pay within a classification, shall be resolved by reference to the established practice that predominates in the industry and on which the trade or occupation rate/classification is based. Rate of pay and classification disputes shall be resolved by relying upon practices established by collective bargaining agreements and guidelines used in such determination by appropriate recognized trade unions operating within the City of Madison.

The Contractor, its Subcontractors and Agents shall submit to interrogation regarding compliance with the provisions of this ordinance.

Mulcting of the employees by the Contractor, Subcontractor, and Agents on Public Works contracts, such as by kickbacks or other devices, is prohibited. The normal rate of wage of the employees of the Contractor, Subcontractor, and Agents shall not be reduced or otherwise diminished as a result of payment of the prevailing wage rate on a public works contract.

Hourly contributions. Hourly contributions shall be determined in accordance with the prevailing wage rate and with DWD. 290.01(10), Wis. Admin. Code.

Apprentices and Subjourneypersons. Apprentices and subjourneypersons performing work on the project shall be compensated in accordance with the prevailing wage rate and with DWD 290.02, and 290.025, respectively, Wis. Admin. Code.

Straight Time Wages. The Contractor may pay straight time wages as determined by the prevailing wage rate and DWD 290.04, Wis. Admin. Code.

Overtime Wages. The Contractor shall pay overtime wages as required by the prevailing wage rate and DWD 290.05, Wis. Admin. Code.

Posting of Wage Rates and Hours. A clearly legible copy of the prevailing wage rate, together with the provisions of Sec. 66.0903(10)(a) and (11)(a), Wis. Stats., shall be kept posted in at least one conspicuous and easily accessible place at the project site by the Contractor and such notice shall remain posted during the full time any laborers, workers or mechanics are employed on the contract.

Evidence of Compliance by Contractor. Upon completion of the contract, the Contractor shall file with the Department of Public Works an affidavit stating:

- a. That the Contractor has complied fully with the provisions and requirements of Sec. 66.0903(3), Wis. Stats., and Chapter DWD 290, Wis. Admin. Code; the Contractor has received evidence of compliance from each of the agents and subcontractors; and the names and addresses of all of the subcontractors and agents who worked on the contract.
- b. That full and accurate records have been kept, which clearly indicate the name and trade or occupation of every laborer, worker or mechanic employed by the Contractor in connection with work on the project. The records shall show the number of hours worked by each employee and the actual wages paid therefor; where these records will be kept and the name, address and telephone number of the person who will be responsible for keeping them. The records shall be retained and made available for a period of at least three (3) years following the completion of the project of public works and shall not be removed without prior notification to the municipality.

Evidence of Compliance by Agent and Subcontractor. Each agent and subcontractor shall file with the Contractor, upon completion of their portion of the work on the contract an affidavit stating that all the provisions of Sec. 66.0903(3), Wis. Stats., have been fully complied with and that full and accurate records have been kept, which clearly indicate the name and trade or occupation of every laborer, worker or mechanic employed by the Contractor in connection with work on the project. The records shall show the number of hours worked by each employee and the actual wages paid therefor; where these records shall be kept and the name, address and telephone number of the person who shall be responsible for keeping them. The records shall be retained and made available for a period of at least three (3) years following the completion of the project of public works and shall not be removed without prior notification to the municipality.

Failure to Comply with the Prevailing Wage Rate. If the Contractor fails to comply with the prevailing wage rate, she/he shall be in default on the contract.

5. **Affirmative Action.** In the performance of the services under this Agreement the Contractor agrees not to discriminate against any employee or applicant because of race, religion, marital status, age, color, sex, disability, national origin or ancestry, income level or source of income, arrest record or conviction record, less than honorable discharge, physical appearance, sexual orientation, political beliefs, or student status. The Contractor further agrees not to discriminate against any subcontractor or person who offers to subcontract on this contract because of race, religion, color, age, disability, sex or national origin.

The Contractor agrees that within thirty (30) days after the effective date of this agreement, the Contractor will provide to the City Affirmative Action Division certain workforce utilization statistics, using a form to be furnished by the City.

If the contract is still in effect, or if the City enters into a new agreement with the Contractor, within one year after the date on which the form was required to be provided, the Contractor will provide updated workforce information using a second form, also to be furnished by the City. The second form will be submitted to the City Affirmative Action Division no later than one year after the date on which the first form was required to be provided.

The Contractor further agrees that, for at least twelve (12) months after the effective date of this contract, it will notify the City Affirmative Action Division of each of its job openings at facilities in Dane County for which applicants not already employees of the Contractor are to be considered. The notice will include a job description, classification, qualifications and application procedures and deadlines. The Contractor agrees to interview and consider candidates referred by the Affirmative Action Division if the candidate meets the minimum qualification standards established by the Contractor, and if the referral is timely. A referral is timely if it is received by the Contractor on or before the date started in the notice.

Articles of Agreement Article I

The Contractor shall take affirmative action in accordance with the provisions of this contract to insure that applicants are employed, and that employees are treated during employment without regard to race, religion, color, age, marital status, disability, sex or national origin and that the employer shall provide harassment free work environment for the realization of the potential of each employee. Such action shall include, but not be limited to, the following: employment, upgrading, demotion or transfer, recruitment or recruitment advertising, layoff or termination, rates of pay or other forms of compensation and selection for training including apprenticeship insofar as it is within the control of the Contractor. The Contractor agrees to post in conspicuous places available to employees and applicants notices to be provided by the City setting out the provisions of the nondiscrimination clauses in this contract.

Article II

The Contractor shall in all solicitations or advertisements for employees placed by or on behalf of the Contractor state that all qualified or qualifiable applicants will be employed without regard to race, religion, color, age, marital status, disability, sex or national origin.

Article III

The Contractor shall send to each labor union or representative of workers with which it has a collective bargaining agreement or other contract or understanding a notice to be provided by the City advising the labor union or worker's representative of the Contractor's equal employment opportunity and affirmative action commitments. Such notices shall be posted in conspicuous places available to employees and applicants for employment.

Article V

The Contractor agrees that it will comply with all provisions of the Affirmative Action Ordinance of the City of Madison, including the contract compliance requirements. The Contractor agrees to submit the model affirmative action plan for public works contractors in a form approved by the Director of Affirmative Action.

Article VI

The Contractor will maintain records as required by Section 39.02(9)(f) of the Madison General Ordinances and will provide the City Affirmative Action Division with access to such records and to persons who have relevant and necessary information, as provided in Section 39.02(9)(f). The City agrees to keep all such records confidential, except to the extent that public inspection is required by law.

Article VII

In the event of the Contractor's or subcontractor's failure to comply with the Equal Employment Opportunity and Affirmative Action Provisions of this contract or Section 39.03 and 39.02 of the Madison General Ordinances, it is agreed that the City at its option may do any or all of the following:

1. Cancel, terminate or suspend this Contract in whole or in part.
2. Declare the Contractor ineligible for further City contracts until the Affirmative Action requirements are met.
3. Recover on behalf of the City from the prime Contractor 0.5 percent of the contract award price for each week that such party fails or refuses to comply, in the nature of liquidated damages, but not to exceed a total of five percent (5%) of the contract price, or five thousand dollars (\$5,000), whichever is less. Under public works contracts, if a subcontractor is in noncompliance, the City may recover liquidated damages from the prime Contractor in the manner described above. The preceding sentence shall not be construed to prohibit a prime Contractor from recovering the amount of such damage from the non-complying subcontractor.

Article VIII

The Contractor shall include the above provisions of this contract in every subcontract so that such provisions will be binding upon each subcontractor. The Contractor shall take such action with respect to any subcontractor as necessary to enforce such provisions, including sanctions provided for noncompliance.

Article IX

The Contractor shall allow the maximum feasible opportunity to small business enterprises to compete for any subcontracts entered into pursuant to this contract.

**WEST GORHAM STREET, N. HENRY STREET & N. FRANCES STREET
ASSESSMENT DISTRICT - 2012
CONTRACT NO. 6785**

IN WITNESS WHEREOF, the Contractor has hereunto set his/her hand and seal and the City has caused these presents to be sealed with its corporate seal and to be subscribed by its Mayor and City Clerk the day and year first above written.

Countersigned:

Company Name

Witness Date

President Date

Witness Date

Secretary Date

CITY OF MADISON, WISCONSIN

Provisions have been made to pay the liability that will accrue under this contract.

Approved as to form:

Finance Director

City Attorney

Signed this _____ day of _____, 20_____

Witness

Mayor Date

Witness

City Clerk Date

SECTION H: PAYMENT AND PERFORMANCE BOND

KNOW ALL MEN BY THESE PRESENTS, that we _____
as principal, and _____
Company of _____ as surety, are held and firmly bound unto the City of
Madison, Wisconsin, in the sum of _____ (\$ _____) Dollars, lawful money of the
United States, for the payment of which sum to the City of Madison, we hereby bind ourselves and our
respective executors and administrators firmly by these presents.

The condition of this Bond is such that if the above bounden shall on his/her part fully and faithfully
perform all of the terms of the Contract entered into between him/herself and the City of Madison for the
construction of:

**WEST GORHAM STREET, N. HENRY STREET & N. FRANCES STREET
ASSESSMENT DISTRICT - 2012
CONTRACT NO. 6785**

in Madison, Wisconsin, and shall pay all claims for labor performed and material furnished in the
prosecution of said work, and save the City harmless from all claims for damages because of negligence
in the prosecution of said work, and shall save harmless the said City from all claims for compensation
(under Chapter 102, Wisconsin Statutes) of employees and employees of subcontractor, then this Bond is
to be void, otherwise of full force, virtue and effect.

Signed and sealed this _____ day of _____,

Countersigned:

Company Name (Principal)

Witness

President Seal

Secretary

Approved as to form:

Surety Seal

Salary Employee Commission

City Attorney

By _____
Attorney-in-Fact

This certifies that I have been duly licensed as an agent for the above company in Wisconsin under
License No. _____ for the year 20_____, and appointed as attorney-in-fact with
authority to execute this payment and performance bond which power of attorney has not been revoked.

Date

Agent

MINIMUM WAGE SCALE

FOR

PUBLIC WORKS IMPROVEMENTS

APPROVED BY: BOARD OF PUBLIC WORKS

MADISON, WISCONSIN

February 7, 2012

The attached "Prevailing Wage Rate Determination: (Pages 1 through 30), issued February 7, 2012, is hereby approved as the Minimum Wage Scale of the City of Madison.

State of Wisconsin Department of Workforce Development Equal Rights Division	DEPARTMENTAL ORDER
ISSUE DATE: 1/13/2012	
PROJECT: ALL PUBLIC WORKS PROJECTS UNDER SEC 66.0903, STATS.-CITY OF MADISON MADISON CITY, DANE COUNTY, WI Determination No. 201200105	
PROJECT OWNER:	REQUESTER:
ROBERT F. PHILLIPS, CITY ENGINEER CITY OF MADISON-ENGINEERING 210 MARTIN L KING JR BLVD, RM 115 MADISON, WI 53703	ROBERT F. PHILLIPS, CITY ENGINEER CITY OF MADISON-ENGINEERING 210 MARTIN L KING JR BLVD, RM 115 MADISON, WI 53703
ADDITIONAL CONTACT:	
NORMAN DAVIS, CONTRACT COMPLIANCE CITY OF MADISON-DEPT OF CIVIL RTS-AA DIV 210 MARTIN L KING JR BLVD, RM 523 MADISON, WI 537033342	
<p>The department received an application for prevailing wage rate determination for the above-captioned project. The department conducted a survey to determine the prevailing wage rate for the trade(s) or occupation(s) needed to complete the project. The survey's findings appear in the attached project determination.</p> <p>If you believe that the wage rate for any trade or occupation does not accurately reflect the prevailing wage rate in the city, village or town where the project is located, you may ask the department to conduct an administrative review of such wage rate. You must submit this request in writing within 30 days from the date indicated above. Additionally, your request must include wage rate information from at least three similar projects in the city, village or town where the proposed project is located and on which some work has been performed by the contested trade(s) during the current survey period and was previously considered by the department in issuing the attached determination. See DWD 290.10 of the Wisconsin Administrative Code and either s. 66.0903(3)(br), s. 66.0904(4)(e), or s. 103.49(3)(c), Stats., for a complete explanation of the administrative review process.</p> <p>Enclosures</p>	
<p>It is hereby ordered that the prevailing wage rates set forth in the attached project determination shall only be applicable to the above referenced project. This order is a FINAL ORDER of the department unless a timely request for an administrative review is filed with the department.</p> <p>ISSUED BY:</p> <p style="text-align: center;"> Equal Rights Division Labor Standards Bureau Construction Wage Standards Section PO Box 8928 Madison, WI 53708-8928 (608)266-6861 </p> <p style="text-align: center;"> Web Site: http://dwd.wisconsin.gov/er/ </p>	

PREVAILING WAGE RATE DETERMINATION

Issued by the State of Wisconsin
Department of Workforce Development
Pursuant to s. 66.0903, Wis. Stats.
Issued On: 1/13/2012

DETERMINATION NUMBER: 201200105

EXPIRATION DATE: Prime Contracts MUST Be Awarded or Negotiated On Or Before 12/31/2012. If NOT, You MUST Reapply.

PROJECT NAME: ALL PUBLIC WORKS PROJECTS UNDER SEC 66.0903, STATS.-CITY OF MADISON

PROJECT LOCATION: MADISON CITY, DANE COUNTY, WI

CONTRACTING AGENCY: CITY OF MADISON-ENGINEERING

CLASSIFICATION:	Contractors are responsible for correctly classifying their workers. Either call the Department of Workforce Development (DWD) with trade or classification questions or consult DWD's Dictionary of Occupational Classifications & Work Descriptions on the DWD website at: dwd.wisconsin.gov/er/prevailing_wage_rate/Dictionary/dictionary_main.htm .
OVERTIME:	Time and one-half must be paid for all hours worked: <ul style="list-style-type: none">- over 10 hours per day on prevailing wage projects- over 40 hours per calendar week- Saturday and Sunday- on all of the following holidays: January 1; the last Monday in May; July 4; the 1st Monday in September; the 4th Thursday in November; December 25;- The day before if January 1, July 4 or December 25 falls on a Saturday;- The day following if January 1, July 4 or December 25 falls on a Sunday. Apply the time and one-half overtime calculation to whichever is higher between the Hourly Basic Rate listed on this project determination or the employee's regular hourly rate of pay. Add any applicable Premium or DOT Premium to the Hourly Basic Rate before calculating overtime. A DOT Premium (discussed below) may supersede this time and one-half requirement.
FUTURE INCREASE:	When a specific trade or occupation requires a future increase, you MUST add the full hourly increase to the "TOTAL" on the effective date(s) indicated for the specific trade or occupation.
PREMIUM PAY:	If indicated for a specific trade or occupation, the full amount of such pay MUST be added to the "HOURLY BASIC RATE OF PAY" indicated for such trade or occupation, whenever such pay is applicable.
DOT PREMIUM:	This premium only applies to highway and bridge projects owned by the Wisconsin Department of Transportation and to the project type heading "Airport Pavement or State Highway Construction." DO NOT apply the premium calculation under any other project type on this determination.
APPRENTICES:	Pay apprentices a percentage of the applicable journey person's hourly basic rate of pay and hourly fringe benefit contributions specified in this determination. Obtain the appropriate percentage from each apprentice's contract or indenture.
SUBJOURNEY:	Subjourney wage rates may be available for some of the trades or occupations indicated below with the exception of laborers, truck drivers and heavy equipment operators. Any employer interested in using a subjourney classification on this project MUST complete Form ERD-10880 and request the applicable wage rate from the Department of Workforce Development PRIOR to using the subjourney worker on this project.

This document **MUST BE POSTED** by the **CONTRACTING AGENCY** in at least one conspicuous and easily accessible place on **the site of the project**. A local governmental unit may post this document at the place normally used to post public notices if there is no common site on the project. This document **MUST** remain posted during the entire time any worker is employed on the project and **MUST** be physically incorporated into the specifications and all contracts and subcontracts. If you have any questions, please write to the Equal Rights Division, Labor Standards Bureau, P.O. Box 8928, Madison, Wisconsin 53708 or call (608) 266-6861.

The following statutory provisions apply to local governmental unit projects of public works and are set forth below pursuant to the requirements of s. 66.0903(8), Stats.

s. 66.0903 (1) (f) & s. 103.49 (1) (c) "PREVAILING HOURS OF LABOR" for any trade or occupation in any area means 10 hours per day and 40 hours per week and may not include any hours worked on a Saturday or Sunday or on any of the following holidays:

1. January 1.
2. The last Monday in May.
3. July 4.
4. The first Monday in September.
5. The 4th Thursday in November.
6. December 25.
7. The day before if January 1, July 4 or December 25 falls on a Saturday.
8. The day following if January 1, July 4 or December 25 falls on a Sunday.

s. 66.0903 (10) RECORDS; INSPECTION; ENFORCEMENT.

(a) Each contractor, subcontractor, or contractor's or subcontractor's agent performing work on a project of public works that is subject to this section shall keep full and accurate records clearly indicating the name and trade or occupation of every person performing the work described in sub. (4) and an accurate record of the number of hours worked by each of those persons and the actual wages paid for the hours worked.

s. 66.0903 (11) LIABILITY AND PENALTIES.

(a) 1. Any contractor, subcontractor, or contractor's or subcontractor's agent who fails to pay the prevailing wage rate determined by the department under sub. (3) or who pays less than 1.5 times the hourly basic rate of pay for all hours worked in excess of the prevailing hours of labor is liable to any affected employee in the amount of his or her unpaid wages or his or her unpaid overtime compensation and in an additional amount as liquidated damages as provided under subd. 2., 3., whichever is applicable.

2. If the department determines upon inspection under sub. (10) (b) or (c) that a contractor, subcontractor, or contractor's or subcontractor's agent has failed to pay the prevailing wage rate determined by the department under sub. (3) or has paid less than 1.5 times the hourly basic rate of pay for all hours worked in excess of the prevailing hours of labor, the department shall order the contractor to pay to any affected employee the amount of his or her unpaid wages or his or her unpaid overtime compensation and an additional amount equal to 100 percent of the amount of those unpaid wages or that unpaid overtime compensation as liquidated damages within a period specified by the department in the order.

3. In addition to or in lieu of recovering the liability specified in subd. 1. as provided in subd. 2., any employee for and in behalf of that employee and other employees similarly situated may commence an action to recover that liability in any court of competent jurisdiction. If the court finds that a contractor, subcontractor, or contractor's or subcontractor's agent has failed to pay the prevailing wage rate determined by the department under sub. (3) or has paid less than 1.5 times the hourly basic rate of pay for all hours worked in excess of the prevailing hours of labor, the court shall order the contractor, subcontractor, or agent to pay to any affected employee the amount of his or her unpaid wages or his or her unpaid overtime compensation and an additional amount equal to 100 percent of the amount of those unpaid wages or that unpaid overtime compensation as liquidated damages.

5. No employee may be a party plaintiff to an action under subd. 3. unless the employee consents in writing to become a party and the consent is filed in the court in which the action is brought. Notwithstanding s. 814.04 (1), the court shall, in addition to any judgment awarded to the plaintiff, allow reasonable attorney fees and costs to be paid by the defendant.

BUILDING OR HEAVY CONSTRUCTION

Includes sheltered enclosures with walk-in access for the purpose of housing persons, employees, machinery, equipment or supplies and non-sheltered work such as canals, dams, dikes, reservoirs, storage tanks, etc. A sheltered enclosure need not be "habitable" in order to be considered a building. The installation of machinery and/or equipment, both above and below grade level, does not change a project's character as a building. On-site grading, utility work and landscaping are included within this definition. Residential buildings of four (4) stories or less, agricultural buildings, parking lots and driveways are NOT included within this definition.

SKILLED TRADES

Fringe Benefits Must Be Paid On <u>All</u> Hours Worked		HOURLY BASIC RATE OF PAY	HOURLY FRINGE BENEFITS	TOTAL
CODE	TRADE OR OCCUPATION	\$	\$	\$
101	Acoustic Ceiling Tile Installer	29.06	15.16	44.22
102	Boilermaker	31.09	23.75	54.84
103	Bricklayer, Blocklayer or Stonemason Future Increase(s): Add \$.50/hr on 6/1/2012; Add \$.80 on 6/1/2013 Premium Increase(s): DOT PREMIUM: Pay two times the hourly basic rate on Sunday, New Year's Day, Memorial Day, Independence Day, Labor Day, Thanksgiving Day & Christmas Day.	32.26	16.60	48.86
104	Cabinet Installer	29.06	15.16	44.22
105	Carpenter	29.06	15.16	44.22
106	Carpet Layer or Soft Floor Coverer	29.06	15.16	44.22
107	Cement Finisher	32.03	15.13	47.16
108	Drywall Taper or Finisher	26.10	13.65	39.75
109	Electrician Future Increase(s): Add \$.50/hr on 6/1/2012. Premium Increase(s): DOT PREMIUM: Pay two times the hourly basic rate on Sunday, New Year's Day, Memorial Day, Independence Day, Labor Day, Thanksgiving Day & Christmas Day.	32.55	18.68	51.23
110	Elevator Constructor	43.79	25.48	69.27
111	Fence Erector	25.50	0.26	25.76
112	Fire Sprinkler Fitter	36.39	16.75	53.14
113	Glazier	36.23	11.22	47.45
114	Heat or Frost Insulator	33.28	22.51	55.79
115	Insulator (Batt or Blown)	23.62	11.55	35.17
116	Ironworker	30.90	19.11	50.01
117	Lather	29.06	15.16	44.22

Fringe Benefits Must Be Paid On <u>All</u> Hours Worked		HOURLY BASIC RATE OF PAY	HOURLY FRINGE BENEFITS	TOTAL
CODE	TRADE OR OCCUPATION	\$	\$	\$
118	Line Constructor (Electrical)	35.97	18.08	54.05
119	Marble Finisher	31.16	16.27	47.43
120	Marble Mason	32.66	16.20	48.86
121	Metal Building Erector	22.00	4.11	26.11
122	Millwright	30.66	15.21	45.87
123	Overhead Door Installer	18.00	4.86	22.86
124	Painter	25.65	14.11	39.76
125	Pavement Marking Operator	26.00	0.00	26.00
126	Piledriver	29.56	15.16	44.72
127	Pipeline Fuser or Welder (Gas or Utility)	29.54	18.84	48.38
129	Plasterer	29.03	15.16	44.19
130	Plumber	36.20	15.02	51.22
132	Refrigeration Mechanic Future Increase(s): Add \$.85/hr on 12/1/11; Add \$.90/hr on 6/1/12; Add \$.85/hr on 12/1/12.	40.35	16.21	56.56
133	Roofer or Waterproofer	28.06	0.00	28.06
134	Sheet Metal Worker	34.23	20.19	54.42
135	Steamfitter Future Increase(s): Add \$.85/hr on 12/1/11; Add \$.90/hr on 6/1/12; Add \$.85/hr on 12/1/12.	40.35	16.21	56.56
137	Teledata Technician or Installer	21.26	6.99	28.25
138	Temperature Control Installer	32.55	18.68	51.23
139	Terrazzo Finisher	18.00	5.35	23.35
140	Terrazzo Mechanic	31.16	16.27	47.43
141	Tile Finisher Future Increase(s): Add \$.50/hr on 6/1/2012; Add \$.80/hr on 6/1/2013.	23.77	16.00	39.77
142	Tile Setter Future Increase(s): Add \$.50/hr on 6/1/2012; Add \$.80/hr on 6/1/2013.	29.71	16.00	45.71
143	Tuckpointer, Caulker or Cleaner	22.00	9.75	31.75
144	Underwater Diver (Except on Great Lakes)	36.20	18.81	55.01
146	Well Driller or Pump Installer	25.32	15.30	40.62

Fringe Benefits Must Be Paid On <u>All</u> Hours Worked				
CODE	TRADE OR OCCUPATION	HOURLY BASIC RATE OF PAY	HOURLY FRINGE BENEFITS	TOTAL
		\$	\$	\$
147	Siding Installer	16.74	2.58	19.32
150	Heavy Equipment Operator - ELECTRICAL LINE CONSTRUCTION ONLY	32.37	16.48	48.85
151	Light Equipment Operator -ELECTRICAL LINE CONSTRUCTION ONLY	28.78	15.16	43.94
152	Heavy Truck Driver - ELECTRICAL LINE CONSTRUCTION ONLY	17.80	9.00	26.80
153	Light Truck Driver - ELECTRICAL LINE CONSTRUCTION ONLY	23.38	12.48	35.86
154	Groundman - ELECTRICAL LINE CONSTRUCTION ONLY	21.30	10.97	32.27

TRUCK DRIVERS

Fringe Benefits Must Be Paid On <u>All</u> Hours Worked				
CODE	TRADE OR OCCUPATION	HOURLY BASIC RATE OF PAY	HOURLY FRINGE BENEFITS	TOTAL
		\$	\$	\$
201	Single Axle or Two Axle	18.00	6.98	24.98
203	Three or More Axle Future Increase(s): Add \$1.57/hr on 6/1/2012.	18.00	13.83	31.83
204	Articulated, Euclid, Dumptor, Off Road Material Hauler Future Increase(s): Add \$1/hr on 6/3/2012; Add \$1/hr on 6/2/2013.	31.89	17.98	49.87
205	Pavement Marking Vehicle	19.25	10.84	30.09
207	Truck Mechanic	18.00	13.68	31.68

LABORERS

Fringe Benefits Must Be Paid On <u>All</u> Hours Worked				
CODE	TRADE OR OCCUPATION	HOURLY BASIC RATE OF PAY	HOURLY FRINGE BENEFITS	TOTAL
		\$	\$	\$
301	General Laborer Future Increase(s): Add \$.50/hr. on 06/04/2012; Add \$.75/hr. on 06/03/2013 Premium Increase(s): Add \$1.00/hr for certified welder; Add \$.25/hr for mason tender	24.14	13.45	37.59
302	Asbestos Abatement Worker	23.96	12.88	36.84
303	Landscaper	17.00	6.36	23.36
310	Gas or Utility Pipeline Laborer (Other Than Sewer and Water)	20.39	12.20	32.59
311	Fiber Optic Laborer (Outside, Other Than Concrete Encased)	16.51	0.00	16.51
314	Railroad Track Laborer	14.00	4.77	18.77

**HEAVY EQUIPMENT OPERATORS
SITE PREPARATION, UTILITY OR LANDSCAPING WORK ONLY**

Fringe Benefits Must Be Paid On <u>All</u> Hours Worked		HOURLY BASIC RATE OF PAY	HOURLY FRINGE BENEFITS	TOTAL
CODE	TRADE OR OCCUPATION	\$	\$	\$
501	Air Track, Rotary or Percussion Drilling Machine &/or Hammers, Blaster; Asphalt Milling Machine; Boring Machine (Directional, Horizontal or Vertical); Backhoe (Track Type) Having a Mfg's Rated Capacity of 130,000 Lbs. or Over; Backhoe (Track Type) Having a Mfg's Rated Capacity of Under 130,000 Lbs., Backhoe (Mini, 15,000 Lbs. & Under); Bulldozer or Endloader (Over 40 hp); Compactor (Self-Propelled 85 Ft Total Drum Width & Over, or Tractor Mounted, Towed & Light Equipment); Concrete Batch Plant, Batch Hopper; Concrete Breaker (Large, Auto, Vibratory/Sonic, Manual or Remote); Crane, Shovel, Dragline, Clamshells; Forklift (Machinery Moving or Steel Erection, 25 Ft & Over); Gradall (Cruz-Aire Type); Grader or Motor Patrol; Master Mechanic; Mechanic or Welder; Robotic Tool Carrier (With or Without Attachments); Scraper (Self Propelled or Tractor Drawn) 5 cu yds or More Capacity; Tractor or Truck Mounted Hydraulic Backhoe; Tractor or Truck Mounted Hydraulic Crane (10 Tons or Under); Tractor (Scraper, Dozer, Pusher, Loader); Trencher (Wheel Type or Chain Type Having Over 8 Inch Bucket). Future Increase(s): Add \$1/hr on 6/3/2012; Add \$1/hr on 6/2/2013.	32.42	17.98	50.40
502	Backfiller; Broom or Sweeper; Bulldozer or Endloader (Under 40 hp); Environmental Burner; Forestry Equipment, Timbco, Tree Shear, Tub Grinder, Processor; Jeep Digger; Screed (Milling Machine); Skid Rig; Straddle Carrier or Travel Lift; Stump Chipper; Trencher (Wheel Type or Chain Type Having 8 Inch Bucket & Under).	31.89	14.44	46.33
503	Air Compressor (&/or 400 CFM or Over); Augers (Vertical & Horizontal); Compactor (Self-Propelled 84 Ft Total Drum Width & Under, or Tractor Mounted, Towed & Light Equipment); Crusher, Screening or Wash Plant; Farm or Industrial Type Tractor; Forklift; Generator (&/or 150 KW or Over); Greaser; High Pressure Utility Locating Machine (Daylighting Machine); Mulcher; Oiler; Post Hole Digger or Driver; Pump (3 Inch or Over) or Well Points; Refrigeration Plant or Freeze Machine; Rock, Stone Breaker; Skid Steer Loader (With or Without Attachments); Vibratory Hammer or Extractor, Power Pack. Future Increase(s): Add \$1/hr on 6/3/2012; Add \$1/hr on 6/2/2013.	31.89	17.98	49.87
504	Work Performed on the Great Lakes Including Diver; Wet Tender or Hydraulic Dredge Engineer.	36.20	18.81	55.01
505	Work Performed on the Great Lakes Including Crane or Backhoe Operator; Assistant Hydraulic Dredge Engineer; Hydraulic Dredge Leverman or Diver's Tender; Mechanic or Welder; 70 Ton & Over Tug Operator. Premium Increase(s): Add \$.50/hr for friction crane, lattice boom or crane certification (CCO).	37.45	19.45	56.90

Fringe Benefits Must Be Paid On <u>All</u> Hours Worked				
<u>CODE</u>	<u>TRADE OR OCCUPATION</u>	<u>HOURLY BASIC RATE OF PAY</u> \$	<u>HOURLY FRINGE BENEFITS</u> \$	<u>TOTAL</u> \$
506	Work Performed on the Great Lakes Including Deck Equipment Operator or Machineryman (Maintains Cranes Over 50 Tons or Backhoes 115,000 Lbs. or More); Tug, Launch or Loader, Dozer or Like Equipment When Operated on a Barge, Breakwater Wall, Slip, Dock or Scow, Deck Machinery.	26.80	18.52	45.32
507	Work Performed on the Great Lakes Including Deck Equipment Operator, Machineryman or Fireman (Operates 4 Units or More or Maintains Cranes 50 Tons or Under or Backhoes 115,000 Lbs. or Under); Deck Hand, Deck Engineer or Assistant Tug Operator; Off Road Trucks - Great Lakes ONLY.	27.75	19.15	46.90

**HEAVY EQUIPMENT OPERATORS
EXCLUDING SITE PREPARATION, UTILITY, PAVING LANDSCAPING WORK**

Fringe Benefits Must Be Paid On <u>All</u> Hours Worked				
<u>CODE</u>	<u>TRADE OR OCCUPATION</u>	<u>HOURLY BASIC RATE OF PAY</u> \$	<u>HOURLY FRINGE BENEFITS</u> \$	<u>TOTAL</u> \$
508	Boring Machine (Directional); Crane, Tower Crane, Pedestal Tower or Derrick, With or Without Attachments, With a Lifting Capacity of Over 100 Tons, Self-Erecting Tower Crane With a Lifting Capacity of Over 4,000 Lbs., Crane With Boom Dollies; Crane, Tower Crane, Pedestal Tower or Derrick, With Boom, Leads &/or Jib Lengths Measuring 176 Ft or Over; Master Mechanic. Future Increase(s): Add \$1/hr on 6/3/2012; Add \$1/hr on 6/2/2013. Premium Increase(s): Add \$.50/hr at 200 ton; Add \$1.00/hr. at 300 ton; Add \$1.50/hr at 400 ton; Add \$2.00/hr at 500 ton.	34.62	17.98	52.60
509	Backhoe (Track Type) Having a Mfgr's Rated Capacity of 130,000 Lbs. or Over; Boring Machine (Horizontal or Vertical); Caisson Rig; Crane, Tower Crane, Portable Tower, Pedestal Tower or Derrick, With or Without Attachments, With a Lifting Capacity of 100 Tons or Under, Self-Erecting Tower Crane With A Lifting Capacity Of 4,000 Lbs. & Under; Crane, Tower Crane, Portable Tower, Pedestal Tower or Derrick, With Boom, Leads &/or Jib Lengths Measuring 175 Ft or Under; Pile Driver; Versl Lifts, Tri-Lifts & Gantrys (20,000 Lbs. & Over). Future Increase(s): Add \$1/hr on 6/3/2012; Add \$1/hr on 6/2/2013. Premium Increase(s): Add \$.25/hr for cranes with lifting capacity of 45 ton or over.	33.62	17.98	51.60
510	Backhoe (Track Type) Having a Mfgr.'s Rated Capacity of Under 130,000 Lbs., Backhoe (Mini, 15,000 Lbs. & Under); Concrete Bump Cutter, Grinder, Planing or Grooving Machine; Concrete Laser/Screened; Concrete Paver (Slipform); Concrete Pump (Over 46 Meter), Concrete Conveyor (Rotec or Bidwell Type); Concrete Slipform Placer Curb & Gutter Machine; Concrete Spreader & Distributor; Dredge (NOT Performing Work on the Great Lakes); Forklift (Machinery Moving or Steel Erection, 25 Ft & Over); Gradall (Cruz-Aire Type); Hydro-Blaster (10,000 PSI or Over); Milling Machine; Skid Rig; Traveling Crane (Bridge Type). Future Increase(s): Add \$1/hr on 6/3/2012; Add \$1/hr on 6/2/2013.	32.42	17.98	50.40

Fringe Benefits Must Be Paid On <u>All</u> Hours Worked		HOURLY BASIC RATE OF PAY	HOURLY FRINGE BENEFITS	TOTAL
CODE	TRADE OR OCCUPATION	\$	\$	\$
511	Air, Track, Rotary or Percussion Drilling Machine &/or Hammers, Blaster; Bulldozer or Endloader (Over 40 hp); Compactor (Self-Propelled 85 Ft Total Drum Width & Over, or Tractor Mounted, Towed & Light Equipment); Concrete Pump (46 Meter & Under), Concrete Conveyor (Rotec or Bidwell Type); Crane (Carry Deck, Mini) or Truck Mounted Hydraulic Crane (10 Tons or Under); Environmental Burner; Gantrys (Under 20,000 Lbs.); Grader or Motor Patrol; High Pressure Utility Locating Machine (Daylighting Machine); Manhoist; Material or Stack Hoist; Mechanic or Welder; Railroad Track Rail Leveling Machine, Tie Placer, Extractor, Tamper, Stone Leveler or Rehabilitation Equipment; Roller (Over 5 Ton); Scraper (Self Propelled or Tractor Drawn) 5 cu yd or More Capacity; Screed (Milling Machine); Sideboom; Straddle Carrier or Travel Lift; Tining or Curing Machine; Tractor (Scraper, Dozer, Pusher, Loader); Tractor or Truck Mounted Hydraulic Backhoe; Tractor or Truck Mounted Hydraulic Crane (10 Tons or Under); Trencher (Wheel Type or Chain Type Having Over 8-Inch Bucket). Future Increase(s): Add \$1/hr on 6/3/2012; Add \$1/hr on 6/2/2013.	31.89	17.98	49.87
512	Backfiller; Broom or Sweeper; Bulldozer or Endloader (Under 40 hp); Compactor (Self-Propelled 84 Ft Total Drum Width & Under, or Tractor Mounted, Towed & Light Equipment); Concrete Batch Plant, Batch Hopper; Concrete Breaker (Large, Auto, Vibratory/Sonic, Manual or Remote); Concrete Conveyor System; Concrete Finishing Machine (Road Type); Fireman (Pile Driver & Derrick NOT Performing Work on the Great Lakes); Grout Pump; Hoist (Tugger, Automatic); Industrial Locomotives; Jeep Digger; Lift Slab Machine; Mulcher; Robotic Tool Carrier (With or Without Attachments); Roller (Rubber Tire, 5 Ton or Under); Screw or Gypsum Pumps; Stabilizing or Concrete Mixer (Self-Propelled or 14S or Over); Stump Chipper; Trencher (Wheel Type or Chain Type Having 8-Inch Bucket & Under); Winches & A-Frames.	35.59	19.10	54.69
513	Air Compressor (&/or 400 CFM or Over); Air, Electric or Hydraulic Jacking System; Augers (Vertical & Horizontal); Boatmen (NOT Performing Work on the Great Lakes); Boiler (Temporary Heat); Crusher, Screening or Wash Plant; Elevator; Farm or Industrial Type Tractor; Fireman (Asphalt Plant NOT Performing Work on the Great Lakes); Forklift; Generator (&/or 150 KW or Over); Greaser; Heaters (Mechanical); Loading Machine (Conveyor); Oiler; Post Hole Digger or Driver; Prestress Machine; Pump (3 Inch or Over) or Well Points; Refrigeration Plant or Freeze Machine; Rock, Stone Breaker; Skid Steer Loader (With or Without Attachments); Vibratory Hammer or Extractor, Power Pack. Future Increase(s): Add \$1/hr on 6/3/2012; Add \$1/hr on 6/2/2013.	29.19	17.98	47.17
514	Gas or Utility Pipeline, Except Sewer & Water (Primary Equipment). Future Increase(s): Add \$2/hr. on 1/1/2013.	34.89	19.68	54.57
515	Gas or Utility Pipeline, Except Sewer & Water (Secondary Equipment).	30.32	17.40	47.72
516	Fiber Optic Cable Equipment	22.00	7.27	29.27

SEWER, WATER OR TUNNEL CONSTRUCTION

Includes those projects that primarily involve public sewer or water distribution, transmission or collection systems and related tunnel work (excluding buildings).

SKILLED TRADES

Fringe Benefits Must Be Paid On <u>All</u> Hours Worked		HOURLY BASIC RATE OF PAY	HOURLY FRINGE BENEFITS	TOTAL
CODE	TRADE OR OCCUPATION	\$	\$	\$
103	Bricklayer, Blocklayer or Stonemason	32.66	16.20	48.86
105	Carpenter Premium Increase(s): DOT PREMIUM: Pay two times the hourly basic rate on Sunday, New Year's Day, Memorial Day, Independence Day, Labor Day, Thanksgiving Day & Christmas Day.	33.43	19.31	52.74
107	Cement Finisher Future Increase(s): Add \$1.86 on 6/1/12; Add \$1.87 on 6/1/13; Add \$1.87 on 6/1/14; Add \$1.87 on 6/1/15; Add \$1.75 on 6/1/16. Premium Increase(s): DOT PREMIUMS: 1) Pay two times the hourly basic rate on Sunday, New Year's Day, Memorial Day, Independence Day, Labor Day, Thanksgiving Day & Christmas Day. 2) Add \$1.40/hr when the Wisconsin Department of Transportation or responsible governing agency requires that work be performed at night under artificial illumination with traffic control and the work is completed after sunset and before sunrise.	30.68	15.68	46.36
109	Electrician Future Increase(s): Add \$1.40/hr on 6/1/2012. Add \$1.60/hr on 6/1/2013. Premium Increase(s): DOT PREMIUM: Pay two times the hourly basic rate on Sunday, New Year's Day, Memorial Day, Independence Day, Labor Day, Thanksgiving Day & Christmas Day.	31.54	20.95	52.49
111	Fence Erector	25.50	0.26	25.76
116	Ironworker Premium Increase(s): DOT PREMIUM: Pay two times the hourly basic rate on Sunday, New Year's Day, Memorial Day, Independence Day, Labor Day, Thanksgiving Day & Christmas Day.	31.31	22.22	53.53
118	Line Constructor (Electrical)	35.97	18.08	54.05
125	Pavement Marking Operator	26.00	0.00	26.00
126	Piledriver	29.56	15.16	44.72
130	Plumber	36.20	15.02	51.22
135	Steamfitter	39.90	15.76	55.66
137	Teledata Technician or Installer	21.26	6.99	28.25

Fringe Benefits Must Be Paid On <u>All</u> Hours Worked		HOURLY BASIC RATE OF PAY	HOURLY FRINGE BENEFITS	TOTAL
CODE	TRADE OR OCCUPATION	\$	\$	\$
143	Tuckpointer, Caulker or Cleaner	22.00	9.75	31.75
144	Underwater Diver (Except on Great Lakes)	36.20	18.81	55.01
146	Well Driller or Pump Installer	24.22	14.80	39.02
150	Heavy Equipment Operator - ELECTRICAL LINE CONSTRUCTION ONLY	32.37	16.48	48.85
151	Light Equipment Operator -ELECTRICAL LINE CONSTRUCTION ONLY	28.78	15.16	43.94
152	Heavy Truck Driver - ELECTRICAL LINE CONSTRUCTION ONLY	17.80	9.00	26.80
153	Light Truck Driver - ELECTRICAL LINE CONSTRUCTION ONLY	23.38	12.48	35.86
154	Groundman - ELECTRICAL LINE CONSTRUCTION ONLY	21.30	10.97	32.27

TRUCK DRIVERS

Fringe Benefits Must Be Paid On <u>All</u> Hours Worked		HOURLY BASIC RATE OF PAY	HOURLY FRINGE BENEFITS	TOTAL
CODE	TRADE OR OCCUPATION	\$	\$	\$
201	Single Axle or Two Axle	23.00	8.64	31.64
203	Three or More Axle	21.17	9.51	30.68
204	Articulated, Euclid, Dumptor, Off Road Material Hauler Future Increase(s): Add \$1.75/hr on 6/1/2012; Add \$1.85/hr on 6/1/2013. Premium Increase(s): DOT PREMIUM: Pay two times the hourly basic rate on Sunday, New Year's Day, Memorial Day, Independence Day, Labor Day, Thanksgiving Day & Christmas Day.	22.50	16.19	38.69
205	Pavement Marking Vehicle	19.25	10.84	30.09
207	Truck Mechanic	21.17	9.51	30.68

LABORERS

Fringe Benefits Must Be Paid On <u>All</u> Hours Worked		HOURLY BASIC RATE OF PAY	HOURLY FRINGE BENEFITS	TOTAL
CODE	TRADE OR OCCUPATION	\$	\$	\$
301	General Laborer Future Increase(s): Add \$.70/hr. on 06/04/2012; Add \$.80/hr. on 06/03/2013 Premium Increase(s): Add \$.20 for blaster, bracer, manhole builder, caulker, bottomman and power tool; Add \$.55 for pipelayer; Add \$1.00 for tunnel work 0-15 lbs. compressed air; Add \$2.00 for over 15-30 lbs. compressed air; Add \$3.00 for over 30 lbs. compressed air.	25.28	13.44	38.72

Fringe Benefits Must Be Paid On All Hours Worked

<u>CODE</u>	<u>TRADE OR OCCUPATION</u>	<u>HOURLY BASIC RATE OF PAY</u> \$	<u>HOURLY FRINGE BENEFITS</u> \$	<u>TOTAL</u> \$
303	Landscaper	17.00	6.36	23.36
304	Flagperson or Traffic Control Person	12.00	17.89	29.89
311	Fiber Optic Laborer (Outside, Other Than Concrete Encased)	16.51	0.00	16.51
314	Railroad Track Laborer	14.00	4.77	18.77

**HEAVY EQUIPMENT OPERATORS
SEWER, WATER OR TUNNEL WORK**

Fringe Benefits Must Be Paid On All Hours Worked

<u>CODE</u>	<u>TRADE OR OCCUPATION</u>	<u>HOURLY BASIC RATE OF PAY</u> \$	<u>HOURLY FRINGE BENEFITS</u> \$	<u>TOTAL</u> \$
521	Backhoe (Track Type) Having a Mfgr.'s Rated Capacity of 130,000 Lbs. or Over; Calsson Rig; Crane, Tower Crane, Pedestal Tower or Derrick, With Boom, Leads &/or Jib Lengths Measuring 176 Ft or Over; Crane, Tower Crane, Pedestal Tower or Derrick, With or Without Attachments, With a Lifting Capacity of Over 100 Tons, Self-Erecting Tower Crane With a Lifting Capacity Of Over 4,000 Lbs., Crane With Boom Dollies; Master Mechanic; Pile Driver. Future Increase(s): Add \$1/hr on 6/3/2012; Add \$1/hr on 6/2/2013. Premium Increase(s): Add \$.25/hr for cranes with lifting capacity of 45 ton or over.	33.62	17.98	51.60
522	Backhoe (Track Type) Having a Mfgr.'s Rated Capacity of Under 130,000 Lbs., Backhoe (Mini, 15,000 Lbs. & Under); Boring Machine (Directional); Concrete Bump Cutter, Grinder, Planing or Grooving Machine; Concrete Laser/Screed; Concrete Paver (Slipform); Concrete Pump (Over 46 Meter), Concrete Conveyor (Rotec or Bidwell Type); Concrete Spreader & Distributor; Crane, Tower Crane, Portable Tower, Pedestal Tower or Derrick, With Boom, Leads &/or Jib Lengths Measuring 175 Ft or Under; Crane, Tower Crane, Portable Tower, Pedestal Tower or Derrick, With or Without Attachments, With a Lifting Capacity of 100 Tons or Under, Self-Erecting Tower Crane With a Lifting Capacity of 4,000 Lbs. & Under; Dredge (NOT Performing Work on the Great Lakes); Milling Machine; Skid Rig; Telehandler; Traveling Crane (Bridge Type). Future Increase(s): Add \$1/hr on 6/3/2012; Add \$1/hr on 6/2/2013.	32.42	17.98	50.40

Fringe Benefits Must Be Paid On <u>All</u> Hours Worked		HOURLY BASIC RATE OF PAY	HOURLY FRINGE BENEFITS	TOTAL
CODE	TRADE OR OCCUPATION	\$	\$	\$
523	Air Track, Rotary or Percussion Drilling Machine &/or Hammers, Blaster; Boring Machine (Horizontal or Vertical); Bulldozer or Endloader (Over 40 hp); Crane (Carry Deck, Mini) or Truck Mounted Hydraulic Crane (10 Tons or Under); Concrete Pump (46 Meter & Under), Concrete Conveyor (Rotec or Bidwell Type); Concrete Slipform Placer Curb & Gutter Machine; Gradall (Cruz-Aire Type); Grader or Motor Patrol; Hydro-Blaster (10,000 PSI or Over); Manhoist; Material or Stack Hoist; Mechanic or Welder; Roller (Over 5 Ton); Scraper (Self Propelled or Tractor Drawn) 5 cu yd or More Capacity; Screed (Milling Machine); Sideboom; Straddle Carrier or Travel Lift; Tractor (Scraper, Dozer, Pusher, Loader); Tractor or Truck Mounted Hydraulic Backhoe; Tractor or Truck Mounted Hydraulic Crane (10 Tons or Under); Trencher (Wheel Type or Chain Type Having Over 8-Inch Bucket). Future Increase(s): Add \$1/hr on 6/3/2012; Add \$1/hr on 6/2/2013.	31.89	17.98	49.87
524	Backfiller; Broom or Sweeper; Bulldozer or Endloader (Under 40 hp); Compactor (Self-Propelled 85 Ft Total Drum Width & Over, or Tractor Mounted, Towed & Light Equipment); Concrete Batch Plant, Batch Hopper; Concrete Breaker (Large, Auto, Vibratory/Sonic, Manual or Remote); Concrete Conveyor System; Concrete Finishing Machine (Road Type); Environmental Burner; Fireman (Pile Driver & Derrick NOT Performing Work on the Great Lakes); Forestry Equipment, Timbco, Tree Shear, Tub Grinder, Processor; Hoist (Tugger, Automatic); Grout Pump; Jeep Digger; Lift Slab Machine; Mulcher; Power Subgrader; Pump (3 Inch or Over) or Well Points; Robotic Tool Carrier (With or Without Attachments); Roller (Rubber Tire, 5 Ton or Under); Screw or Gypsum Pumps; Stabilizing or Concrete Mixer (Self-Propelled or 14S or Over); Stump Chipper; Tining or Curing Machine; Trencher (Wheel Type or Chain Type Having 8-Inch Bucket & Under); Winches & A-Frames.	30.89	17.16	48.05
525	Air Compressor (&/or 400 CFM or Over); Air, Electric or Hydraulic Jacking System; Augers (Vertical & Horizontal); Compactor (Self-Propelled 84 Ft Total Drum Width & Under, or Tractor Mounted, Towed & Light Equipment); Crusher, Screening or Wash Plant; Farm or Industrial Type Tractor; Fireman (Asphalt Plant NOT Performing Work on the Great Lakes); Generator (&/or 150 KW or Over); Heaters (Mechanical); High Pressure Utility Locating Machine (Daylighting Machine); Loading Machine (Conveyor); Post Hole Digger or Driver; Refrigeration Plant or Freeze Machine; Rock, Stone Breaker; Skid Steer Loader (With or Without Attachments); Vibratory Hammer or Extractor, Power Pack. Future Increase(s): Add \$1/hr on 6/3/2012; Add \$1/hr on 6/2/2013.	29.19	17.98	47.17
526	Boiler (Temporary Heat); Forklift; Greaser; Oiler.	29.19	17.96	47.15
527	Work Performed on the Great Lakes Including Diver; Wet Tender or Hydraulic Dredge Engineer.	36.20	18.81	55.01
528	Work Performed on the Great Lakes Including 70 Ton & Over Tug Operator; Assistant Hydraulic Dredge Engineer; Crane or Backhoe Operator; Hydraulic Dredge Leverman or Diver's Tender; Mechanic or Welder.	36.20	18.81	55.01

Fringe Benefits Must Be Paid On <u>All</u> Hours Worked				
<u>CODE</u>	<u>TRADE OR OCCUPATION</u>	<u>HOURLY BASIC RATE OF PAY</u> \$	<u>HOURLY FRINGE BENEFITS</u> \$	<u>TOTAL</u> \$
529	Work Performed on the Great Lakes Including Deck Equipment Operator or Machineryman (Maintains Cranes Over 50 Tons or Backhoes 115,000 Lbs. or More); Tug, Launch or Loader, Dozer or Like Equipment When Operated on a Barge, Breakwater Wall, Slip, Dock or Scow, Deck Machinery.	26.80	18.52	45.32
530	Work Performed on the Great Lakes Including Deck Equipment Operator; Machineryman or Fireman (Operates 4 Units or More or Maintains Cranes 50 Tons or Under or Backhoes 115,000 Lbs. or Under), Deck Hand, Deck Engineer or Assistant Tug Operator; Off Road Trucks - Great Lakes ONLY.	26.80	18.52	45.32

AIRPORT PAVEMENT OR STATE HIGHWAY CONSTRUCTION

Includes all airport projects (excluding buildings) and all projects awarded by the Wisconsin Department of Transportation (excluding buildings).

SKILLED TRADES

Fringe Benefits Must Be Paid On <u>All</u> Hours Worked		HOURLY BASIC RATE OF PAY	HOURLY FRINGE BENEFITS	TOTAL
CODE	TRADE OR OCCUPATION	\$	\$	\$
103	Bricklayer, Blocklayer or Stonemason	32.66	15.92	48.58
105	Carpenter	30.23	15.16	45.39
107	Cement Finisher Future Increase(s): Add \$1.86 on 6/1/12; Add \$1.87 on 6/1/13; Add \$1.87 on 6/1/14; Add \$1.87 on 6/1/15; Add \$1.75 on 6/1/16. Premium Increase(s): DOT PREMIUMS: 1) Pay two times the hourly basic rate on Sunday, New Year's Day, Memorial Day, Independence Day, Labor Day, Thanksgiving Day & Christmas Day. 2) Add \$1.40/hr when the Wisconsin Department of Transportation or responsible governing agency requires that work be performed at night under artificial illumination with traffic control and the work is completed after sunset and before sunrise.	30.68	15.68	46.36
109	Electrician	37.25	14.68	51.93
111	Fence Erector	35.62	0.00	35.62
116	Ironworker	30.90	19.11	50.01
118	Line Constructor (Electrical)	35.97	18.08	54.05
124	Painter	28.00	11.15	39.15
125	Pavement Marking Operator	26.65	14.92	41.57
126	Piledriver	29.56	15.16	44.72
133	Rofer or Waterproofer	28.06	0.00	28.06
137	Teledata Technician or Installer	21.26	6.99	28.25
143	Tuckpointer, Caulker or Cleaner	22.00	9.75	31.75
144	Underwater Diver (Except on Great Lakes)	36.20	18.81	55.01
150	Heavy Equipment Operator - ELECTRICAL LINE CONSTRUCTION ONLY	35.42	12.90	48.32
151	Light Equipment Operator -ELECTRICAL LINE CONSTRUCTION ONLY	35.50	14.27	49.77
152	Heavy Truck Driver - ELECTRICAL LINE CONSTRUCTION ONLY	25.18	14.07	39.25
153	Light Truck Driver - ELECTRICAL LINE CONSTRUCTION ONLY	23.38	12.48	35.86

154	Groundman - ELECTRICAL LINE CONSTRUCTION ONLY	21.30	10.97	32.27
-----	---	-------	-------	-------

TRUCK DRIVERS

Fringe Benefits Must Be Paid On All Hours Worked

<u>CODE</u>	<u>TRADE OR OCCUPATION</u>	<u>HOURLY BASIC RATE OF PAY</u> \$	<u>HOURLY FRINGE BENEFITS</u> \$	<u>TOTAL</u> \$
201	Single Axle or Two Axle Future Increase(s): Add \$1.75/hr on 6/1/2012; Add \$1.85/hr on 6/1/2013. Premium Increase(s): DOT PREMIUM: Pay two times the hourly basic rate on Sunday, New Year's Day, Memorial Day, Independence Day, Labor Day, Thanksgiving Day & Christmas Day.	22.35	16.19	38.54
203	Three or More Axle Future Increase(s): Add \$1.75/hr on 6/1/2012; Add \$1.85/hr on 6/1/2013. Premium Increase(s): DOT PREMIUM: Pay two times the hourly basic rate on Sunday, New Year's Day, Memorial Day, Independence Day, Labor Day, Thanksgiving Day & Christmas Day.	22.50	16.19	38.69
204	Articulated, Euclid, Dumptor, Off Road Material Hauler	24.91	15.63	40.54
205	Pavement Marking Vehicle	23.84	14.76	38.60
206	Shadow or Pilot Vehicle	24.76	15.35	40.11
207	Truck Mechanic	24.91	15.35	40.26

LABORERS

Fringe Benefits Must Be Paid On All Hours Worked

<u>CODE</u>	<u>TRADE OR OCCUPATION</u>	<u>HOURLY BASIC RATE OF PAY</u> \$	<u>HOURLY FRINGE BENEFITS</u> \$	<u>TOTAL</u> \$
301	General Laborer Future Increase(s): Add \$1.60/hr on 6/1/2012; Add \$1.70/hr on 6/1/2013; Add \$1.60/hr on 6/1/2014. Premium Increase(s): Add \$.10/hr for topman, air tool operator, vibrator or tamper operator (mechanical hand operated), chain saw operator and demolition burning torch laborer; Add \$.15/hr for bituminous worker (raker and luteman), formsetter (curb, sidewalk and pavement) and strike off man; Add \$.20/hr for blaster and powderman; Add \$.25/hr for bottomman; Add \$.35/hr for line and grade specialist; Add \$.45/hr for pipelayer. / DOT PREMIUMS: 1) Pay two times the hourly basic rate on Sunday, New Year's Day, Memorial Day, Independence Day, Labor Day, Thanksgiving Day & Christmas Day. 2) Add \$1.25/hr for work on projects involving temporary traffic control setup, for lane and shoulder closures, when work under artificial illumination conditions is necessary as required by the project provisions (including prep time prior to and/or cleanup after such time period).	27.20	13.45	40.65
302	Asbestos Abatement Worker	23.96	12.88	36.84
303	Landscaper Future Increase(s): Add \$1.60/hr on 6/1/12; Add \$1.70/hr on 6/1/13; Add \$1.60/hr on 6/1/14. Premium Increase(s): DOT PREMIUMS: 1) Pay two times the hourly basic rate on Sunday, New Year's Day, Memorial Day, Independence Day, Labor Day, Thanksgiving Day & Christmas Day. 2) Add \$1.25/hr for work on projects involving temporary traffic control setup, for lane and shoulder closures, when work under artificial illumination conditions is necessary as required by the project provisions (including prep time prior to and/or cleanup after such time period).	27.20	13.45	40.65
304	Flagperson or Traffic Control Person Future Increase(s): Add \$1.60/hr on 6/1/2012; Add \$1.70/hr on 6/1/2013; Add \$1.60/hr on 6/1/2014. Premium Increase(s): DOT PREMIUMS: 1) Pay two times the hourly basic rate on Sunday, New Year's Day, Memorial Day, Independence Day, Labor Day, Thanksgiving Day & Christmas Day. 2) Add \$1.25/hr when the Wisconsin Department of Transportation or responsible governing agency requires that work be performed at night under artificial illumination with traffic control and the work is completed after sunset and before sunrise.	23.55	13.45	37.00

Fringe Benefits Must Be Paid On All Hours Worked

<u>CODE</u>	<u>TRADE OR OCCUPATION</u>	<u>HOURLY BASIC RATE OF PAY</u> \$	<u>HOURLY FRINGE BENEFITS</u> \$	<u>TOTAL</u> \$
311	Fiber Optic Laborer (Outside, Other Than Concrete Encased)	16.51	0.00	16.51
314	Railroad Track Laborer	14.00	4.77	18.77

**HEAVY EQUIPMENT OPERATORS
AIRPORT PAVEMENT OR STATE HIGHWAY CONSTRUCTION**

Fringe Benefits Must Be Paid On All Hours Worked

<u>CODE</u>	<u>TRADE OR OCCUPATION</u>	<u>HOURLY BASIC RATE OF PAY</u> \$	<u>HOURLY FRINGE BENEFITS</u> \$	<u>TOTAL</u> \$
531	Crane, Tower Crane, Pedestal Tower or Derrick, With Boom, Leads &/or Jib Lengths Measuring 176 Ft or Over; Crane, Tower Crane, Pedestal Tower or Derrick, With or Without Attachments, With a Lifting Capacity of Over 100 Tons, Self-Erecting Tower Crane With a Lifting Capacity Of Over 4,000 Lbs., Crane With Boom Dollies; Traveling Crane (Bridge Type). Future Increase(s): Add \$2/hr on 6/1/12; Add \$2/hr on 6/1/13; Add \$1.75/hr on 6/1/14. Premium Increase(s): DOT PREMIUMS: 1) Pay two times the hourly basic rate on Sunday, New Year's Day, Memorial Day, Independence Day, Labor Day, Thanksgiving Day & Christmas Day. 2) Add \$1.25/hr for work on projects involving temporary traffic control setup, for lane and shoulder closures, when work under artificial illumination conditions is necessary as required by the project provisions (including prep time prior to and/or cleanup after such time period).	34.22	18.90	53.12
532	Backhoe (Track Type) Having a Mfgr.'s Rated Capacity of 130,000 Lbs. or Over; Caisson Rig; Crane, Tower Crane, Portable Tower, Pedestal Tower or Derrick, With Boom, Leads &/or Jib Lengths Measuring 175 Ft or Under; Crane, Tower Crane, Portable Tower, Pedestal Tower or Derrick, With or Without Attachments, With a Lifting Capacity of 100 Tons or Under, Self-Erecting Tower Crane With A Lifting Capacity Of 4,000 Lbs., & Under; Dredge (NOT Performing Work on the Great Lakes); Licensed Boat Pilot (NOT Performing Work on the Great Lakes); Pile Driver. Future Increase(s): Add \$2/hr on 6/1/12; Add \$2/hr on 6/1/13; Add \$1.75/hr on 6/1/14. Premium Increase(s): DOT PREMIUMS: 1) Pay two times the hourly basic rate on Sunday, New Year's Day, Memorial Day, Independence Day, Labor Day, Thanksgiving Day & Christmas Day. 2) Add \$1.25/hr for work on projects involving temporary traffic control setup, for lane and shoulder closures, when work under artificial illumination conditions is necessary as required by the project provisions (including prep time prior to and/or cleanup after such time period).	33.72	18.90	52.62

Fringe Benefits Must Be Paid On <u>All</u> Hours Worked		HOURLY BASIC RATE OF PAY	HOURLY FRINGE BENEFITS	TOTAL
CODE	TRADE OR OCCUPATION	\$	\$	\$
533	<p>Air Track, Rotary or Percussion Drilling Machine &/or Hammers, Blaster; Asphalt Heater, Planer & Scarifier; Asphalt Milling Machine; Asphalt Screed; Automatic Subgrader (Concrete); Backhoe (Track Type) Having a Mfgr.'s Rated Capacity of Under 130,000 Lbs., Backhoe (Mini, 15,000 Lbs. & Under); Bituminous (Asphalt) Plant & Paver, Screed; Boatmen (NOT Performing Work on the Great Lakes); Boring Machine (Directional, Horizontal or Vertical); Bridge (Bidwell) Paver; Bulldozer or Endloader; Concrete Batch Plant, Batch Hopper; Concrete Breaker (Large, Auto, Vibratory/Sonic, Manual or Remote); Concrete Bump Cutter, Grinder, Planing or Grooving Machine; Concrete Conveyor System; Concrete Laser/Screed; Concrete Paver (Slipform); Concrete Pump, Concrete Conveyor (Rotec or Bidwell Type); Concrete Slipform Placer Curb & Gutter Machine; Concrete Spreader & Distributor; Crane (Carry Deck, Mini) or Truck Mounted Hydraulic Crane (10 Tons or Under); Crane With a Lifting Capacity of 25 Tons or Under; Forestry Equipment, Timbco, Tree Shear, Tub Grinder, Processor; Gradall (Cruz-Aire Type); Grader or Motor Patrol; Grout Pump; Hydro-Blaster (10,000 PSI or Over); Loading Machine (Conveyor); Material or Stack Hoist; Mechanic or Welder; Milling Machine; Post Hole Digger or Driver; Roller (Over 5 Ton); Scraper (Self Propelled or Tractor Drawn) 5 cu yds or More Capacity; Shoulder Widener; Sideboom; Skid Rig; Stabilizing or Concrete Mixer (Self-Propelled or 14S or Over); Straddle Carrier or Travel Lift; Tractor (Scraper, Dozer, Pusher, Loader); Tractor or Truck Mounted Hydraulic Backhoe; Trencher (Wheel Type or Chain Type); Tube Finisher; Tugger (NOT Performing Work on the Great Lakes); Winches & A-Frames.</p> <p>Future Increase(s): Add \$2/hr on 6/1/12; Add \$2/hr on 6/1/13; Add \$1.75/hr on 6/1/14.</p> <p>Premium Increase(s): DOT PREMIUMS: 1) Pay two times the hourly basic rate on Sunday, New Year's Day, Memorial Day, Independence Day, Labor Day, Thanksgiving Day & Christmas Day. 2) Add \$1.25/hr for work on projects involving temporary traffic control setup, for lane and shoulder closures, when work under artificial illumination conditions is necessary as required by the project provisions (including prep time prior to and/or cleanup after such time period).</p>	33.22	18.90	52.12

Fringe Benefits Must Be Paid On <u>All</u> Hours Worked		HOURLY BASIC RATE OF PAY	HOURLY FRINGE BENEFITS	TOTAL
CODE	TRADE OR OCCUPATION	\$	\$	\$
534	Belting, Burlap, Texturing Machine; Broom or Sweeper; Compactor (Self-Propelled or Tractor Mounted, Towed & Light Equipment); Concrete Finishing Machine (Road Type); Environmental Burner; Farm or Industrial Type Tractor; Fireman (Asphalt Plant, Pile Driver & Derrick NOT Performing Work on the Great Lakes); Forklift; Greaser; Hoist (Tugger, Automatic); Jeep Digger; Joint Sawyer (Multiple Blade); Launch (NOT Performing Work on the Great Lakes); Lift Slab Machine; Mechanical Float; Mulcher; Power Subgrader; Robotic Tool Carrier (With or Without Attachments); Roller (Rubber Tire, 5 Ton or Under); Self Propelled Chip Spreader; Shouldering Machine; Skid Steer Loader (With or Without Attachments); Telehandler; Tining or Curing Machine. Future Increase(s): Add \$2/hr on 6/1/12; Add \$2/hr on 6/1/13; Add \$1.75/hr on 6/1/14. Premium Increase(s): DOT PREMIUMS: 1) Pay two times the hourly basic rate on Sunday, New Year's Day, Memorial Day, Independence Day, Labor Day, Thanksgiving Day & Christmas Day. 2) Add \$1.25/hr for work on projects involving temporary traffic control setup, for lane and shoulder closures, when work under artificial illumination conditions is necessary as required by the project provisions (including prep time prior to and/or cleanup after such time period).	32.96	18.90	51.86
535	Air Compressor (&/or 400 CFM or Over); Air, Electric or Hydraulic Jacking System; Augers (Vertical & Horizontal); Automatic Belt Conveyor & Surge Bin; Boiler (Temporary Heat); Concrete Proportioning Plant; Crusher, Screening or Wash Plant; Generator (&/or 150 KW or Over); Heaters (Mechanical); High Pressure Utility Locating Machine (Daylighting Machine); Mudjack; Oiler; Prestress Machine; Pug Mill; Pump (3 Inch or Over) or Well Points; Rock, Stone Breaker; Screed (Milling Machine); Stump Chipper; Tank Car Heaters; Vibratory Hammer or Extractor, Power Pack. Future Increase(s): Add \$2/hr on 6/1/12; Add \$2/hr on 6/1/13; Add \$1.75/hr on 6/1/14. Premium Increase(s): DOT PREMIUMS: 1) Pay two times the hourly basic rate on Sunday, New Year's Day, Memorial Day, Independence Day, Labor Day, Thanksgiving Day & Christmas Day. 2) Add \$1.25/hr for work on projects involving temporary traffic control setup, for lane and shoulder closures, when work under artificial illumination conditions is necessary as required by the project provisions (including prep time prior to and/or cleanup after such time period).	32.67	18.90	51.57
536	Fiber Optic Cable Equipment.	22.00	7.27	29.27
537	Work Performed on the Great Lakes Including Diver; Wet Tender or Hydraulic Dredge Engineer.	36.20	18.81	55.01

Fringe Benefits Must Be Paid On <u>All</u> Hours Worked		HOURLY BASIC RATE OF PAY	HOURLY FRINGE BENEFITS	TOTAL
CODE	TRADE OR OCCUPATION	\$	\$	\$
538	Work Performed on the Great Lakes Including 70 Ton & Over Tug Operator; Assistant Hydraulic Dredge Engineer; Crane or Backhoe Operator; Hydraulic Dredge Leverman or Diver's Tender; Mechanic or Welder.	36.20	18.81	55.01
539	Work Performed on the Great Lakes Including Deck Equipment Operator or Machineryman (Maintains Cranes Over 50 Tons or Backhoes 115,000 Lbs. or More); Tug, Launch or Loader, Dozer or Like Equipment When Operated on a Barge, Breakwater Wall, Slip, Dock or Scow, Deck Machinery.	26.80	18.52	45.32
540	Work Performed on the Great Lakes Including Deck Equipment Operator, Machineryman or Fireman (Operates 4 Units or More or Maintains Cranes 50 Tons or Under or Backhoes 115,000 Lbs. or Under); Deck Hand, Deck Engineer or Assistant Tug Operator; Off Road Trucks-Great Lakes ONLY.	26.80	18.52	45.32

LOCAL STREET OR MISCELLANEOUS PAVING CONSTRUCTION

Includes roads, streets, alleys, trails, bridges, paths, racetracks, parking lots and driveways (except residential or agricultural), public sidewalks or other similar projects (excluding projects awarded by the Wisconsin Department of Transportation).

SKILLED TRADES

Fringe Benefits Must Be Paid On <u>All</u> Hours Worked		HOURLY BASIC RATE OF PAY	HOURLY FRINGE BENEFITS	TOTAL
CODE	TRADE OR OCCUPATION	\$	\$	\$
103	Bricklayer, Blocklayer or Stonemason	32.66	16.20	48.86
105	Carpenter	29.06	15.16	44.22
107	Cement Finisher Future Increase(s): Add \$1.86 on 6/1/12; Add \$1.87 on 6/1/13; Add \$1.87 on 6/1/14; Add \$1.87 on 6/1/15; Add \$1.75 on 6/1/16. Premium Increase(s): DOT PREMIUMS: 1) Pay two times the hourly basic rate on Sunday, New Year's Day, Memorial Day, Independence Day, Labor Day, Thanksgiving Day & Christmas Day. 2) Add \$1.40/hr when the Wisconsin Department of Transportation or responsible governing agency requires that work be performed at night under artificial illumination with traffic control and the work is completed after sunset and before sunrise.	30.68	15.68	46.36
109	Electrician Future Increase(s): Add \$.50/hr. effective 06/04/2012. Premium Increase(s): DOT PREMIUM: Pay two times the hourly basic rate on Sunday, New Year's Day, Memorial Day, Independence Day, Labor Day, Thanksgiving Day & Christmas Day.	28.74	17.86	46.60
111	Fence Erector	25.50	0.26	25.76
116	Ironworker	30.90	19.11	50.01
118	Line Constructor (Electrical)	35.97	18.08	54.05
124	Painter	25.65	14.11	39.76
125	Pavement Marking Operator	26.00	0.00	26.00
126	Piledriver	29.56	15.16	44.72
133	Roofer or Waterproofer	28.06	0.00	28.06
137	Teledata Technician or Installer	21.26	6.99	28.25
143	Tuckpointer, Caulker or Cleaner	22.00	9.75	31.75
144	Underwater Diver (Except on Great Lakes)	36.20	18.81	55.01
150	Heavy Equipment Operator - ELECTRICAL LINE CONSTRUCTION ONLY	35.42	12.90	48.32

Fringe Benefits Must Be Paid On <u>All</u> Hours Worked				
<u>CODE</u>	<u>TRADE OR OCCUPATION</u>	<u>HOURLY BASIC RATE OF PAY</u>	<u>HOURLY FRINGE BENEFITS</u>	<u>TOTAL</u>
		\$	\$	\$
151	Light Equipment Operator -ELECTRICAL LINE CONSTRUCTION ONLY Premium Increase(s): DOT PREMIUM: Pay two times the hourly basic rate on Sunday, New Year's Day, Memorial Day, Independence Day, Labor Day, Thanksgiving Day & Christmas Day.	29.64	14.64	44.28
152	Heavy Truck Driver - ELECTRICAL LINE CONSTRUCTION ONLY	25.18	13.07	38.25
153	Light Truck Driver - ELECTRICAL LINE CONSTRUCTION ONLY	23.38	12.48	35.86
154	Groundman - ELECTRICAL LINE CONSTRUCTION ONLY	21.30	10.97	32.27
TRUCK DRIVERS				

Fringe Benefits Must Be Paid On <u>All</u> Hours Worked				
<u>CODE</u>	<u>TRADE OR OCCUPATION</u>	<u>HOURLY BASIC RATE OF PAY</u>	<u>HOURLY FRINGE BENEFITS</u>	<u>TOTAL</u>
		\$	\$	\$
201	Single Axle or Two Axle	15.00	0.00	15.00
203	Three or More Axle	19.50	4.97	24.47
204	Articulated, Euclid, Dumptor, Off Road Material Hauler Future Increase(s): Add \$1/hr on 6/3/2012; Add \$1/hr on 6/2/2013.	31.89	17.98	49.87
205	Pavement Marking Vehicle	19.25	10.84	30.09
206	Shadow or Pilot Vehicle	15.00	0.00	15.00
207	Truck Mechanic	19.50	4.97	24.47
LABORERS				

Fringe Benefits Must Be Paid On <u>All</u> Hours Worked				
<u>CODE</u>	<u>TRADE OR OCCUPATION</u>	<u>HOURLY BASIC RATE OF PAY</u>	<u>HOURLY FRINGE BENEFITS</u>	<u>TOTAL</u>
		\$	\$	\$
301	General Laborer	26.15	12.29	38.44
303	Landscaper	23.71	15.07	38.78
304	Flagperson or Traffic Control Person	12.00	17.89	29.89
311	Fiber Optic Laborer (Outside, Other Than Concrete Encased)	16.51	0.00	16.51
314	Railroad Track Laborer	14.00	4.77	18.77

**HEAVY EQUIPMENT OPERATORS
CONCRETE PAVEMENT OR BRIDGE WORK**

Fringe Benefits Must Be Paid On All Hours Worked

<u>CODE</u>	<u>TRADE OR OCCUPATION</u>	<u>HOURLY BASIC RATE OF PAY</u> \$	<u>HOURLY FRINGE BENEFITS</u> \$	<u>TOTAL</u> \$
541	Crane, Tower Crane, Pedestal Tower or Derrick, With or Without Attachments, With a Lifting Capacity of Over 100 Tons, Self-Erecting Tower Crane With a Lifting Capacity Of Over 4,000 Lbs., Crane With Boom Dollies; Crane, Tower Crane, Pedestal Tower or Derrick, With Boom, Leads &/or Jib Lengths Measuring 176 Ft or Over; Master Mechanic. Future Increase(s): Add \$2/hr on 6/1/12; Add \$2/hr on 6/1/13; Add \$1.75/hr on 6/1/14. Premium Increase(s): DOT PREMIUMS: 1) Pay two times the hourly basic rate on Sunday, New Year's Day, Memorial Day, Independence Day, Labor Day, Thanksgiving Day & Christmas Day. 2) Add \$1.25/hr for work on projects involving temporary traffic control setup, for lane and shoulder closures, when work under artificial illumination conditions is necessary as required by the project provisions (including prep time prior to and/or cleanup after such time period).	34.22	18.90	53.12
542	Backhoe (Track Type) Having a Mfgr.'s Rated Capacity of 130,000 Lbs. or Over; Caisson Rig; Crane, Tower Crane, Portable Tower, Pedestal Tower or Derrick, With or Without Attachments, With a Lifting Capacity of 100 Tons or Under, Self-Erecting Tower Crane With a Lifting Capacity of 4,000 Lbs. & Under; Crane, Tower Crane Portable Tower, Pedestal Tower or Derrick, With Boom, Leads &/or Jib Lengths Measuring 175 Ft or Under; Dredge (NOT Performing Work on the Great Lakes); Licensed Boat Pilot (NOT Performing Work on the Great Lakes); Pile Driver. Future Increase(s): Add \$2/hr on 6/1/12; Add \$2/hr on 6/1/13; Add \$1.75/hr on 6/1/14. Premium Increase(s): DOT PREMIUMS: 1) Pay two times the hourly basic rate on Sunday, New Year's Day, Memorial Day, Independence Day, Labor Day, Thanksgiving Day & Christmas Day. 2) Add \$1.25/hr for work on projects involving temporary traffic control setup, for lane and shoulder closures, when work under artificial illumination conditions is necessary as required by the project provisions (including prep time prior to and/or cleanup after such time period).	33.72	18.90	52.62

Fringe Benefits Must Be Paid On <u>All</u> Hours Worked		HOURLY BASIC RATE OF PAY	HOURLY FRINGE BENEFITS	TOTAL
CODE	TRADE OR OCCUPATION	\$	\$	\$
543	<p>Air Track, Rotary or Percussion Drilling Machine &/or Hammers, Blaster; Automatic Subgrader (Concrete); Backhoe (Track Type) Having a Mfgr.'s Rated Capacity of Under 130,000 Lbs., Backhoe (Mini, 15,000 Lbs. & Under); Boring Machine (Directional, Horizontal or Vertical); Bridge (Bidwell) Paver; Bulldozer or Endloader; Concrete Batch Plant, Batch Hopper; Concrete Breaker (Large, Auto, Vibratory/Sonic, Manual or Remote); Concrete Bump Cutter, Grinder, Planing or Grooving Machine; Concrete Conveyor System; Concrete Laser/Screed; Concrete Paver (Slipform); Concrete Pump, Concrete Conveyor (Rotec or Bidwell Type); Concrete Slipform Placer Curb & Gutter Machine; Concrete Spreader & Distributor; Crane (Carry Deck, Mini) or Truck Mounted Hydraulic Crane (10 Tons or Under); Crane With a Lifting Capacity of 25 Tons or Under; Forestry Equipment, Timbco, Tree Shear, Tub Grinder, Processor; Gradall (Cruz-Aire Type); Grader or Motor Patrol; Grout Pump; Hydro-Blaster (10,000 PSI or Over); Loading Machine (Conveyor); Manhoist; Material or Stack Hoist; Mechanic or Welder; Milling Machine; Post Hole Digger or Driver; Scraper (Self Propelled or Tractor Drawn) 5 cu yds or More Capacity; Shoulder Widener; Sideboom; Skid Rig; Stabilizing or Concrete Mixer (Self-Propelled or 14S or Over); Straddle Carrier or Travel Lift; Tractor (Scraper, Dozer, Pusher, Loader); Tractor or Truck Mounted Hydraulic Backhoe; Trencher (Wheel Type or Chain Type); Tube Finisher; Tugger (NOT Performing Work on the Great Lakes); Winches & A-Frames.</p> <p>Future Increase(s): Add \$2/hr on 6/1/12; Add \$2/hr on 6/1/13; Add \$1.75/hr on 6/1/14.</p> <p>Premium Increase(s): DOT PREMIUMS: 1) Pay two times the hourly basic rate on Sunday, New Year's Day, Memorial Day, Independence Day, Labor Day, Thanksgiving Day & Christmas Day. 2) Add \$1.25/hr for work on projects involving temporary traffic control setup, for lane and shoulder closures, when work under artificial illumination conditions is necessary as required by the project provisions (including prep time prior to and/or cleanup after such time period).</p>	33.22	18.90	52.12

Fringe Benefits Must Be Paid On <u>All</u> Hours Worked				
<u>CODE</u>	<u>TRADE OR OCCUPATION</u>	<u>HOURLY BASIC RATE OF PAY</u> \$	<u>HOURLY FRINGE BENEFITS</u> \$	<u>TOTAL</u> \$
544	Backfiller; Belting, Burlap, Texturing Machine; Broom or Sweeper; Compactor (Self-Propelled or Tractor Mounted, Towed & Light Equipment); Concrete Finishing Machine (Road Type); Environmental Burner; Farm or Industrial Type Tractor; Fireman (Pile Driver & Derrick NOT Performing Work on the Great Lakes); Forklift; Greaser; Jeep Digger; Joint Sawyer (Multiple Blade); Launch (NOT Performing Work on the Great Lakes); Lift Slab Machine; Mechanical Float; Mulcher; Power Subgrader; Robotic Tool Carrier (With or Without Attachments); Self Propelled Chip Spreader; Shouldering Machine; Skid Steer Loader (With or Without Attachments); Telehandler; Tining or Curing Machine. Future Increase(s): Add \$2/hr on 6/1/12; Add \$2/hr on 6/1/13; Add \$1.75/hr on 6/1/14. Premium Increase(s): DOT PREMIUMS: 1) Pay two times the hourly basic rate on Sunday, New Year's Day, Memorial Day, Independence Day, Labor Day, Thanksgiving Day & Christmas Day. 2) Add \$1.25/hr for work on projects involving temporary traffic control setup, for lane and shoulder closures, when work under artificial illumination conditions is necessary as required by the project provisions (including prep time prior to and/or cleanup after such time period).	33.22	18.90	52.12
545	Air Compressor (&/or 400 CFM or Over); Air, Electric or Hydraulic Jacking System; Automatic Belt Conveyor & Surge Bin; Boiler (Temporary Heat); Concrete Proportioning Plant; Crusher, Screening or Wash Plant; Generator (&/or 150 KW or Over); Heaters (Mechanical); High Pressure Utility Locating Machine (Daylighting Machine); Mudjack; Oiler; Prestress Machine; Pug Mill; Pump (3 Inch or Over) or Well Points; Rock, Stone Breaker; Screed (Milling Machine); Stump Chipper; Tank Car Heaters; Vibratory Hammer or Extractor, Power Pack.	30.42	17.58	48.00
546	Fiber Optic Cable Equipment.	22.00	7.27	29.27
547	Work Performed on the Great Lakes Including Diver; Wet Tender or Hydraulic Dredge Engineer.	36.20	18.81	55.01
548	Work Performed on the Great Lakes Including 70 Ton & Over Tug Operator; Assistant Hydraulic Dredge Engineer; Crane or Backhoe Operator; Hydraulic Dredge Leverman or Diver's Tender; Mechanic or Welder.	36.20	18.81	55.01
549	Work Performed on the Great Lakes Including Deck Equipment Operator or Machineryman (Maintains Cranes Over 50 Tons or Backhoes 115,000 Lbs. or more); Tug, Launch or Loader, Dozer or Like Equipment When Operated on a Barge, Breakwater Wall, Slip, Dock or Scow, Deck Machinery.	26.80	18.52	45.32
550	Work Performed on the Great Lakes Including Deck Equipment Operator; Machineryman or Fireman (Operates 4 Units or More or Maintains Cranes 50 Tons or Under or Backhoes 115,000 Lbs. or Under); Deck Hand, Deck Engineer or Assistant Tug Operator; Off Road Trucks - Great Lakes ONLY.	26.80	18.52	45.32

**HEAVY EQUIPMENT OPERATORS
ASPHALT PAVEMENT OR OTHER WORK**

Fringe Benefits Must Be Paid On All Hours Worked

<u>CODE</u>	<u>TRADE OR OCCUPATION</u>	<u>HOURLY BASIC RATE OF PAY</u> \$	<u>HOURLY FRINGE BENEFITS</u> \$	<u>TOTAL</u> \$
551	Crane, Tower Crane, Pedestal Tower or Derrick, With or Without Attachments, With a Lifting Capacity of Over 100 Tons, Self Erecting Tower Crane With a Lifting Capacity of Over 4,000 Lbs., Crane With Boom Dollies; Crane, Tower Crane, Pedestal Tower or Derrick, With Boom, Leads and/or Jlb Lengths Measuring 176 Ft or Over; Master Mechanic.	34.62	17.96	52.58
552	Backhoe (Track Type) Having a Mfgr.'s Rated Capacity of 130,000 Lbs. or Over; Caisson Rig; Crane, Tower Crane, Portable Tower, Pedestal Tower or Derrick, With or Without Attachments, With a Lifting Capacity of 100 Tons or Under, Self-Erecting Tower Crane With a Lifting Capacity Of 4,000 Lbs. & Under; Crane, Tower Crane, Portable Tower, Pedestal Tower or Derrick, With Boom, Leads &/or Jlb Lengths Measuring 175 Ft or Under; Dredge (NOT Performing Work on the Great Lakes); Licensed Boat Pilot (NOT Performing Work on the Great Lakes); Pile Driver. Future Increase(s): Add \$2/hr on 6/1/12; Add \$2/hr on 6/1/13; Add \$1.75/hr on 6/1/14. Premium Increase(s): DOT PREMIUMS: 1) Pay two times the hourly basic rate on Sunday, New Year's Day, Memorial Day, Independence Day, Labor Day, Thanksgiving Day & Christmas Day. 2) Add \$1.25/hr for work on projects involving temporary traffic control setup, for lane and shoulder closures, when work under artificial illumination conditions is necessary as required by the project provisions (including prep time prior to and/or cleanup after such time period).	33.72	18.90	52.62

Fringe Benefits Must Be Paid On <u>All</u> Hours Worked		HOURLY BASIC RATE OF PAY	HOURLY FRINGE BENEFITS	TOTAL
CODE	TRADE OR OCCUPATION	\$	\$	\$
553	Air, Track, Rotary or Percussion Drilling Machine &/or Hammers, Blaster; Asphalt Heater, Planer & Scarifier; Asphalt Milling Machine; Asphalt Screed; Backhoe (Track Type) Having a Mfgr.'s Rated Capacity of Under 130,000 Lbs., Backhoe (Mini, 15,000 Lbs. & Under); Bituminous (Asphalt) Plant & Paver, Screed; Boring Machine (Directional, Horizontal or Vertical); Bulldozer or Endloader; Concrete Breaker (Large, Auto, Vibratory/Sonic, Manual or Remote); Concrete Conveyor System; Concrete Laser/Screed; Concrete Slipform Placer Curb & Gutter Machine; Crane (Carry Deck, Mini) or Truck Mounted Hydraulic Crane (10 Tons or Under); Crane With a Lifting Capacity of 25 Tons or Under; Forestry Equipment, Timbco, Tree Shear, Tub Grinder, Processor; Gradall (Cruz-Aire Type); Grader or Motor Patrol; Hydro-Blaster (10,000 PSI or Over); Loading Machine (Conveyor); Manhoist; Material or Stack Hoist; Mechanic or Welder; Milling Machine; Post Hole Digger or Driver; Railroad Track Rail Leveling Machine, Tie Placer, Extractor, Tamper, Stone Leveler or Rehabilitation Equipment; Roller (Over 5 Ton); Scraper (Self Propelled or Tractor Drawn) 5 cu yds or More Capacity; Shoulder Widener; Sideboom; Skid Rig; Stabilizing or Concrete Mixer (Self-Propelled or 14S or Over); Tractor (Scraper, Dozer, Pusher, Loader); Tractor or Truck Mounted Hydraulic Backhoe; Trencher (Wheel Type or Chain Type); Tube Finisher; Tugger (NOT Performing Work on the Great Lakes); Winches & A-Frames. Future Increase(s): Add \$2/hr on 6/1/12; Add \$2/hr on 6/1/13; Add \$1.75/hr on 6/1/14.	32.67	18.55	51.22
554	Backfiller; Broom or Sweeper; Compactor (Self-Propelled or Tractor Mounted, Towed & Light Equipment); Concrete Finishing Machine (Road Type); Environmental Burner; Farm or Industrial Type Tractor; Fireman (Asphalt Plant, Pile Driver & Derrick NOT Performing Work on the Great Lakes); Forklift; Greaser; Hoist (Tugger, Automatic); Jeep Digger; Joint Sawyer (Multiple Blade); Launch (NOT Performing Work on the Great Lakes); Lift Slab Machine; Mechanical Float; Mulcher; Power Subgrader; Robotic Tool Carrier (With or Without Attachments); Roller (Rubber Tire, 5 Ton or Under); Self-Propelled Chip Spreader; Shouldering Machine; Skid Steer Loader (With or Without Attachments); Telehandler.	31.52	17.89	49.41
555	Air Compressor (&/or 400 CFM or Over); Air, Electric or Hydraulic Jacking System; Augers (Vertical & Horizontal); Automatic Belt Conveyor & Surge Bin; Boiler (Temporary Heat); Crusher, Screening or Wash Plant; Generator (&/or 150 KW or Over); Heaters (Mechanical); High Pressure Utility Locating Machine (Daylighting Machine); Mudjack; Oiler; Prestress Machine; Pug Mill; Pump (3 Inch or Over) or Well Points; Rock, Stone Breaker; Screed (Milling Machine); Stump Chipper; Tank Car Heaters; Vibratory Hammer or Extractor, Power Pack. Future Increase(s): Add \$2/hr on 6/1/12; Add \$2/hr on 6/1/13; Add \$1.75/hr on 6/1/14.	32.67	18.55	51.22
556	Fiber Optic Cable Equipment.	22.00	7.27	29.27

RESIDENTIAL OR AGRICULTURAL CONSTRUCTION

Includes single family houses or apartment buildings of no more than four (4) stories in height and all buildings, structures or facilities that are primarily used for agricultural or farming purposes, excluding commercial buildings. For classification purposes, the exterior height of a residential building, in terms of stories, is the primary consideration. All incidental items such as site work, driveways, parking lots, private sidewalks, private septic systems or sewer and water laterals connected to a public system and swimming pools are included within this definition. Residential buildings of five (5) stories and above are NOT included within this definition.

SKILLED TRADES

Fringe Benefits Must Be Paid On <u>All</u> Hours Worked		HOURLY BASIC RATE OF PAY	HOURLY FRINGE BENEFITS	TOTAL
CODE	TRADE OR OCCUPATION	\$	\$	\$
101	Acoustic Ceiling Tile Installer	27.00	2.47	29.47
102	Bollermaker	31.09	23.75	54.84
103	Bricklayer, Blocklayer or Stonemason	32.00	3.00	35.00
104	Cabinet Installer	22.00	2.74	24.74
105	Carpenter	27.00	3.46	30.46
106	Carpet Layer or Soft Floor Coverer	23.95	2.78	26.73
107	Cement Finisher	21.33	4.25	25.58
108	Drywall Taper or Finisher	23.80	1.55	25.35
109	Electrician	22.00	9.18	31.18
110	Elevator Constructor	43.79	25.48	69.27
111	Fence Erector	17.64	4.33	21.97
112	Fire Sprinkler Fitter	36.39	16.97	53.36
113	Glazier	36.23	11.22	47.45
114	Heat or Frost Insulator	29.04	19.73	48.77
115	Insulator (Batt or Blown)	18.95	1.70	20.65
116	Ironworker	30.90	19.11	50.01
117	Lather	28.15	15.14	43.29
119	Marble Finisher	31.16	16.27	47.43
120	Marble Mason	32.66	16.20	48.86
121	Metal Building Erector	17.50	2.80	20.30
123	Overhead Door Installer	17.00	0.00	17.00
124	Painter	25.65	6.33	31.98
125	Pavement Marking Operator	26.00	0.00	26.00

Fringe Benefits Must Be Paid On All Hours Worked

<u>CODE</u>	<u>TRADE OR OCCUPATION</u>	<u>HOURLY BASIC RATE OF PAY</u> \$	<u>HOURLY FRINGE BENEFITS</u> \$	<u>TOTAL</u> \$
129	Plasterer	19.00	0.29	19.29
130	Plumber	30.00	10.34	40.34
132	Refrigeration Mechanic	30.96	0.00	30.96
133	Rofer or Waterproofer	29.85	1.55	31.40
134	Sheet Metal Worker	21.03	3.40	24.43
135	Steamfitter	32.59	11.05	43.64
137	Teledata Technician or Installer	19.23	5.32	24.55
138	Temperature Control Installer	22.45	4.11	26.56
139	Terrazzo Finisher	18.00	5.35	23.35
140	Terrazzo Mechanic	31.16	16.27	47.43
141	Tile Finisher	23.96	13.36	37.32
142	Tile Setter	21.00	0.00	21.00
143	Tuckpointer, Caulker or Cleaner	23.96	12.88	36.84
146	Well Driller or Pump Installer	15.10	12.38	27.48
147	Siding Installer	18.80	1.42	20.22

TRUCK DRIVERS

Fringe Benefits Must Be Paid On All Hours Worked

<u>CODE</u>	<u>TRADE OR OCCUPATION</u>	<u>HOURLY BASIC RATE OF PAY</u> \$	<u>HOURLY FRINGE BENEFITS</u> \$	<u>TOTAL</u> \$
201	Single Axle or Two Axle	19.86	2.54	22.40
203	Three or More Axle	19.50	14.27	33.77
205	Pavement Marking Vehicle	19.25	10.84	30.09
207	Truck Mechanic	19.00	1.75	20.75

LABORERS

Fringe Benefits Must Be Paid On All Hours Worked

<u>CODE</u>	<u>TRADE OR OCCUPATION</u>	<u>HOURLY BASIC RATE OF PAY</u> \$	<u>HOURLY FRINGE BENEFITS</u> \$	<u>TOTAL</u> \$
301	General Laborer	16.09	7.18	23.27
302	Asbestos Abatement Worker	17.00	2.21	19.21
303	Landscaper	25.00	0.54	25.54

311	Fiber Optic Laborer (Outside, Other Than Concrete Encased)	16.51	0.00	16.51
-----	--	-------	------	-------

**HEAVY EQUIPMENT OPERATORS
RESIDENTIAL OR AGRICULTURAL CONSTRUCTION**

Fringe Benefits Must Be Paid On <u>All</u> Hours Worked		HOURLY BASIC RATE OF PAY	HOURLY FRINGE BENEFITS	TOTAL
<u>CODE</u>	<u>TRADE OR OCCUPATION</u>	\$	\$	\$
557	Asphalt Heater, Planer & Scarifier; Asphalt Milling Machine; Asphalt Screed; Backhoe (Track Type); Backhoe (Mini, 15,000 Lbs. & Under); Bituminous (Asphalt) Plant & Paver, Screed; Boring Machine (Directional, Horizontal or Vertical); Bulldozer or Endloader; Concrete Breaker (Large, Auto, Vibratory/Sonic, Manual or Remote); Concrete Bump Cutter, Grinder, Planing or Grooving Machine; Concrete Conveyor System; Concrete Laser/Screed; Concrete Paver (Slipform); Concrete Pump, Concrete Conveyor (Rotec or Bidwell Type); Concrete Slipform Placer Curb & Gutter Machine; Concrete Spreader & Distributor; Crane (Carry Deck, Mini) or Truck Mounted Hydraulic Crane (10 Tons or Under); Crane With a Lifting Capacity of 25 Tons or Under; Crane, Shovel, Dragline, Clamshells; Forestry Equipment, Tlmbco, Tree Shear, Tub Grinder, Processor; Grader or Motor Patrol; Grout Pump; Hydro-Blaster (10,000 PSI or Over); Loading Machine (Conveyor); Manhoist; Material or Stack Hoist; Mechanic or Welder; Milling Machine; Roller (Over 5 Ton); Scraper (Self Propelled or Tractor Drawn) 5 cu yds or More Capacity; Shoulder Widener; Skid Rig; Stabilizing or Concrete Mixer (Self-Propelled or 14S or Over); Tractor (Scraper, Dozer, Pusher, Loader); Tractor or Truck Mounted Hydraulic Backhoe; Tractor or Truck Mounted Hydraulic Crane (10 Tons or Under); Trencher (Wheel Type or Chain Type); Winches & A-Frames.	29.45	15.37	44.82
558	Air Compressor (&/or 400 CFM or Over); Air, Electric or Hydraulic Jacking System; Backfiller; Belting, Burlap, Texturing Machine; Boiler (Temporary Heat); Broom or Sweeper; Compactor (Self-Propelled or Tractor Mounted, Towed & Light Equipment); Concrete Finishing Machine (Road Type); Farm or Industrial Type Tractor; Forklift; Generator (&/or 150 KW or Over); Heaters (Mechanical); High Pressure Utility Locating Machine (Daylighting Machine); Jeep Digger; Lift Slab Machine; Mulcher; Oiler; Post Hole Digger or Driver; Power Subgrader; Pump (3 Inch or Over) or Well Points; Robotic Tool Carrier (With or Without Attachments); Rock, Stone Breaker; Roller (Rubber Tire, 5 Tons or Under); Screed (Milling Machine); Self Propelled Chip Spreader; Shouldering Machine; Skid Steer Loader (With or Without Attachments); Stump Chipper; Telehandler; Vibratory Hammer or Extractor, Power Pack.	26.45	14.35	40.80

***** END OF RATES *****