

Madison, Wisconsin

CITY OF MADISON

CITY ENGINEERING DIVISION DEPARTMENT OF PUBLIC WORKS

PLAN OF PROPOSED IMPROVEMENT

PUBLIC IMPROVEMENT PROJECT APPROVED
SEPTEMBER 4, 2012
BY THE COMMON COUNCIL
OF MADISON, WISCONSIN

PUBLIC IMPROVEMENT DESIGN
APPROVED BY:

City Engineer 9/26/12
Date

BURROWS PARK SHORELINE

LAKE MENDOTA SHORELINE ALONG BURROWS PARK

CITY PROJECT NO. 53W1374

CONTRACT NO. 6833

INDEX OF SHEETS

SHEET NO.	TITLE
1	TYPICAL CROSS SECTIONS
D1	PLAN
P1	EROSION CONTROL PLAN
EC1	CROSS SECTIONS

DESIGNED BY:

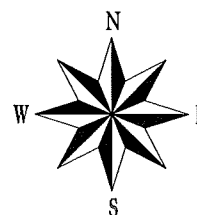
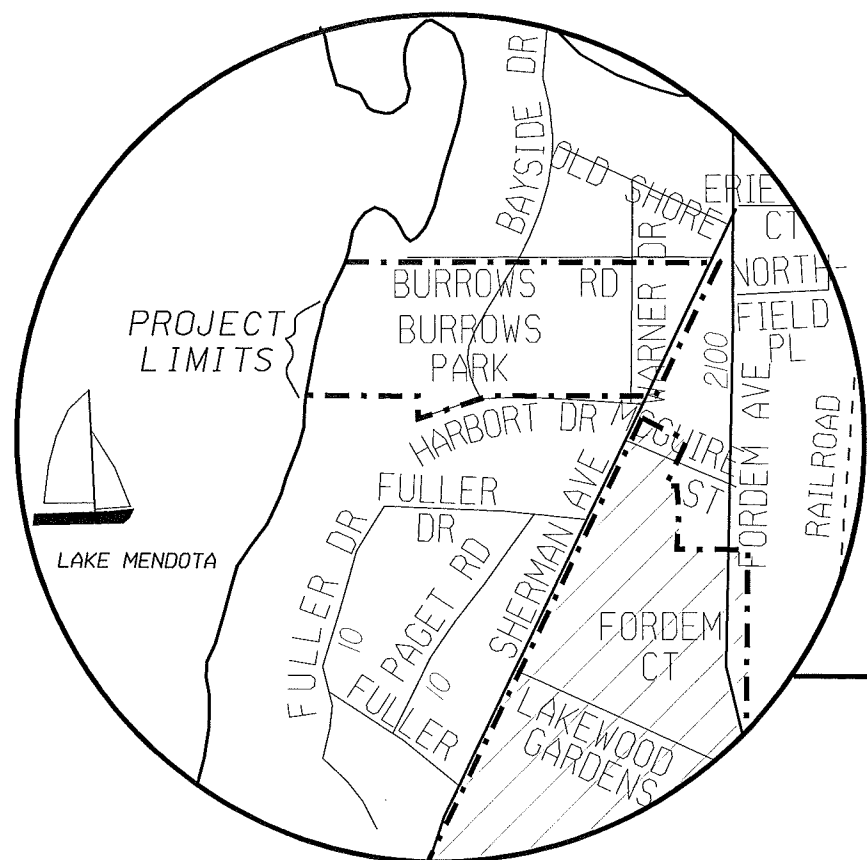
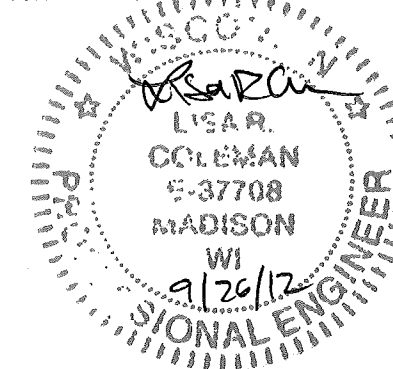

**PROJECT
LOCATION**

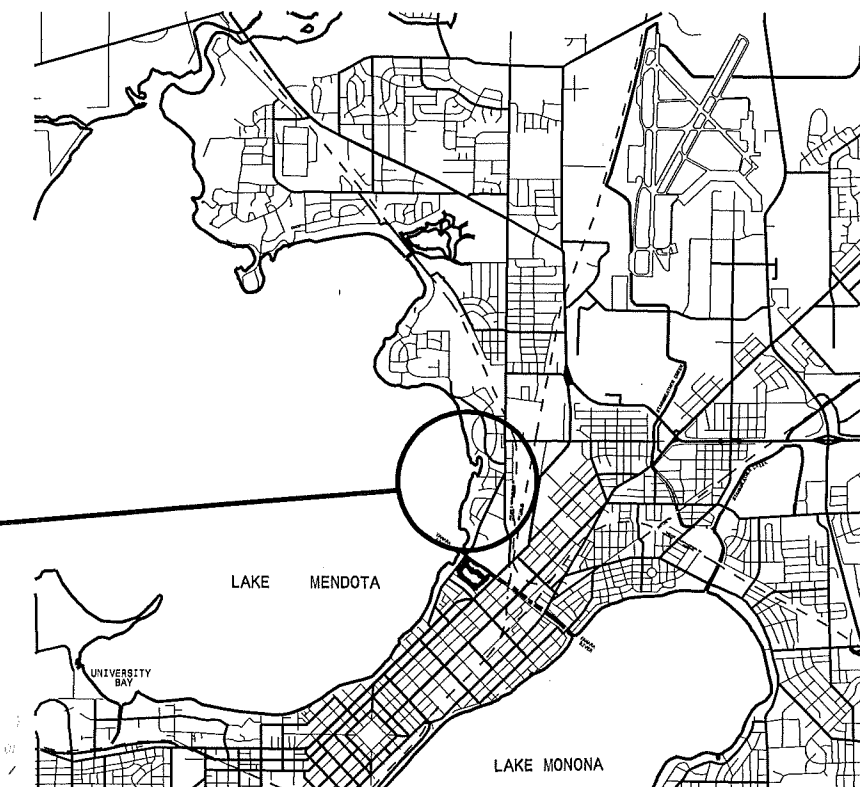

SECTION 1

RIPRAP REPAIR

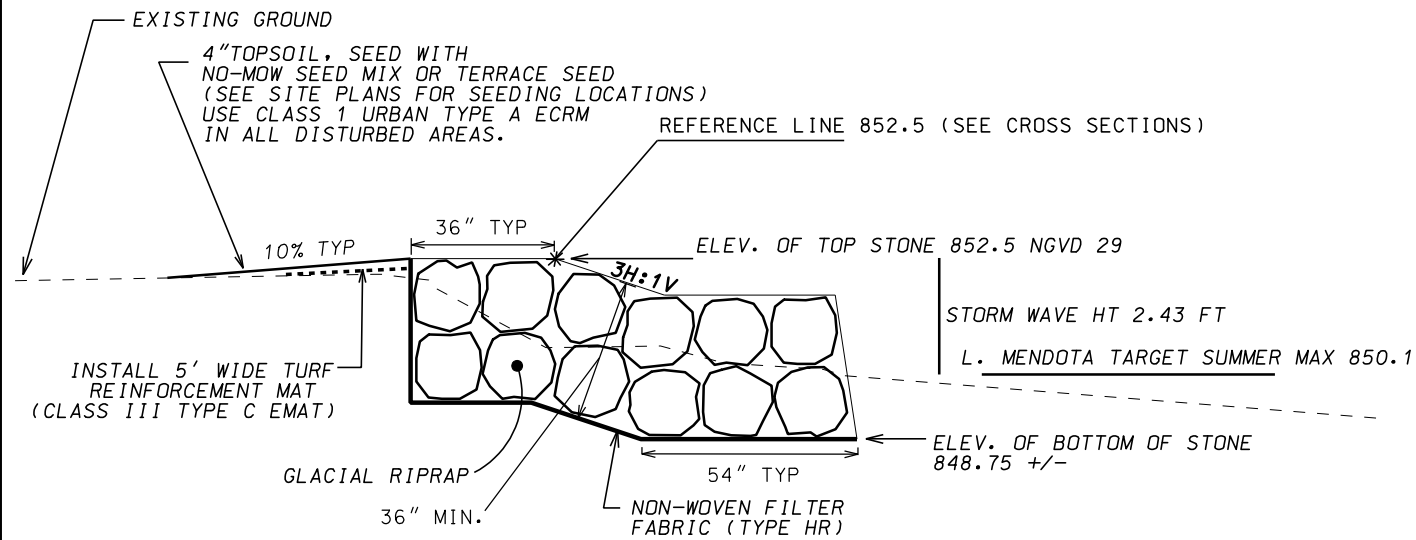

GLACIAL RIPRAP SHALL BE 15" TO 21" DIAMETER PLACED 36" DEEP AS MEASURED PERPENDICULAR TO THE SLOPE. USE EXISTING SALVAGED RIPRAP MEETING OR EXCEEDING SPEC. PRIOR TO TRUCKING IN NEW MATERIAL.

NOT TO SCALE

SECTION 2

TRANSITION RIPRAP AT BEACH

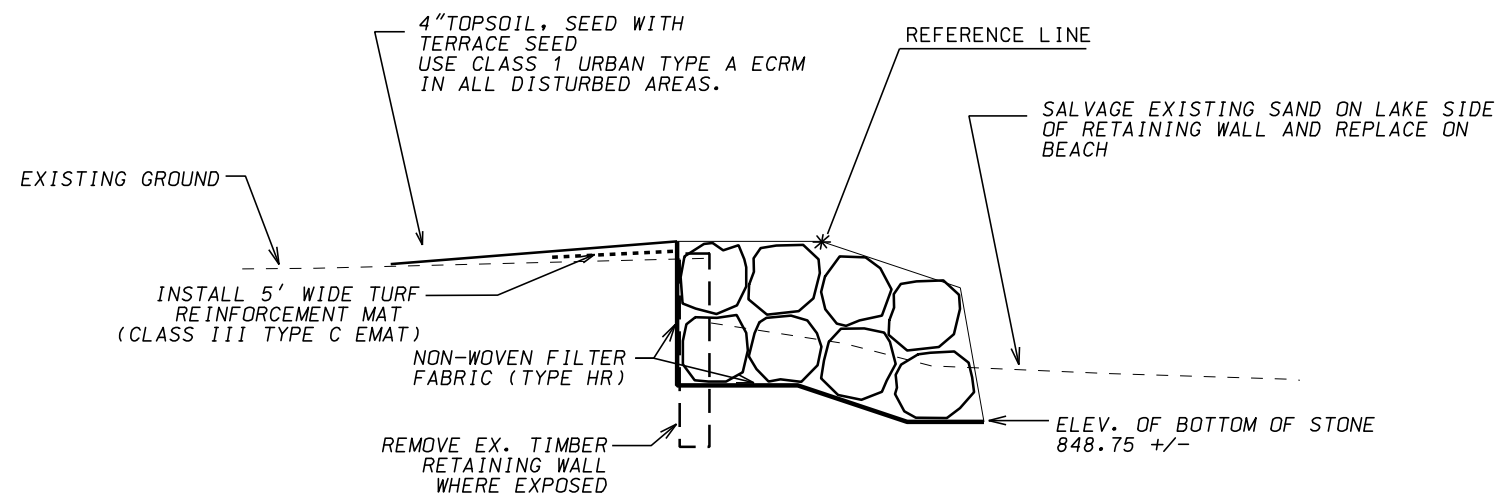

GLACIAL RIPRAP SHALL BE 15" TO 21" DIAMETER PLACED 36" DEEP AS MEASURED PERPENDICULAR TO THE SLOPE. USE EXISTING SALVAGED RIPRAP MEETING OR EXCEEDING SPEC. PRIOR TO TRUCKING IN NEW MATERIAL.

NOT TO SCALE

GENERAL NOTES

- FOR TREES TO BE SAVED, ALIGNMENT LOCATION MAY BE ADJUSTED IN THE FIELD. FOR SAVED TREES, PLACE RIPRAP AROUND TREES (SHORELINE PROTECTION MAY EXTEND FURTHER TOWARD LAKE THAN SHOWN ON CROSS SECTIONS IN THE VICINITY OF EXISTING TREES).

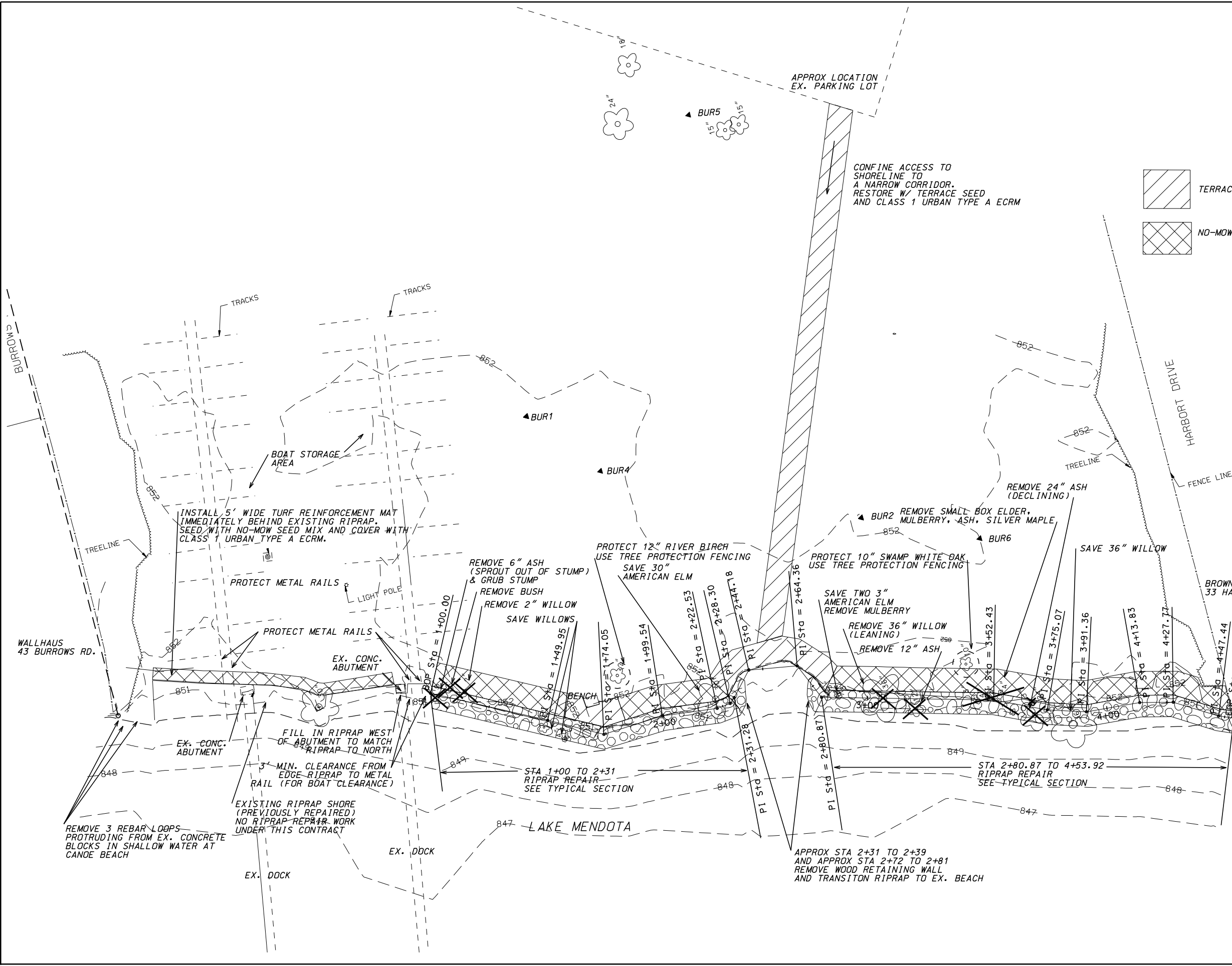
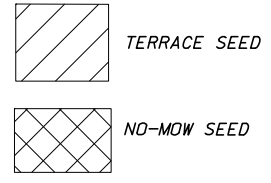
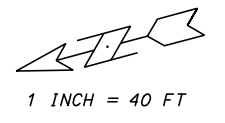

PLOT SCALE: PLOT NAME: REV. DATE:

ORIGINATOR: CITY OF MADISON, STREETS DIVISION

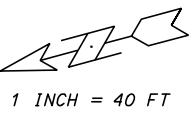
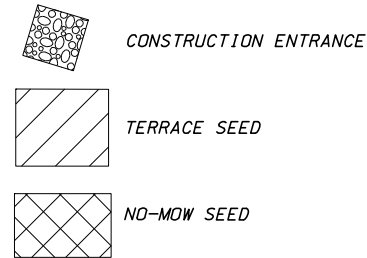

- EROSION CONTROL NOTES:**
1. CLASS 1 URBAN TYPE A EROSION MATTING SHALL BE INSTALLED OVER ALL DISTURBED AREAS OF PARK.
 2. ALL DISTURBED AREAS SHALL BE RESTORED WITH 4" TOPSOIL AND SEED, AND ECRM.
 3. SILT FENCE SHALL BE INSTALLED AS DIRECTED BY THE CONSTRUCTION ENGINEER.
 4. TEMPORARY POLYMER STABILIZATION SHALL BE INCLUDED AS DIRECTED BY THE CONSTRUCTION ENGINEER.
 5. SILT FENCE TO BE INSTALLED DOWNSTREAM OF STOCKPILE AREAS.
 6. THE PROJECT SITE SHALL BE INSPECTED FOR EROSION CONTROL COMPLIANCE WEEKLY AND WITHIN 24 HOURS OF A RAINFALL GREATER THAN 0.5 INCHES.



ALONG SHORELINE WORK, SEED, POLYMER, AND INSTALL EROSION MAT AS SHOWN ON THE TYPICAL SECTION

ALONG SHORELINE WORK, SEED, POLYMER, AND INSTALL EROSION MAT AS SHOWN ON THE TYPICAL SECTION

REV. DATE: PLOT NAME: PLOT SCALE:

ORIGINATOR: CITY_OF_MADISON_STREETS_DIVISION

ORIGINATOR: CITY OF MADISON - STREETS DIVISION

PLOT NAME:
REV. DATE:

PLOT SCALE:

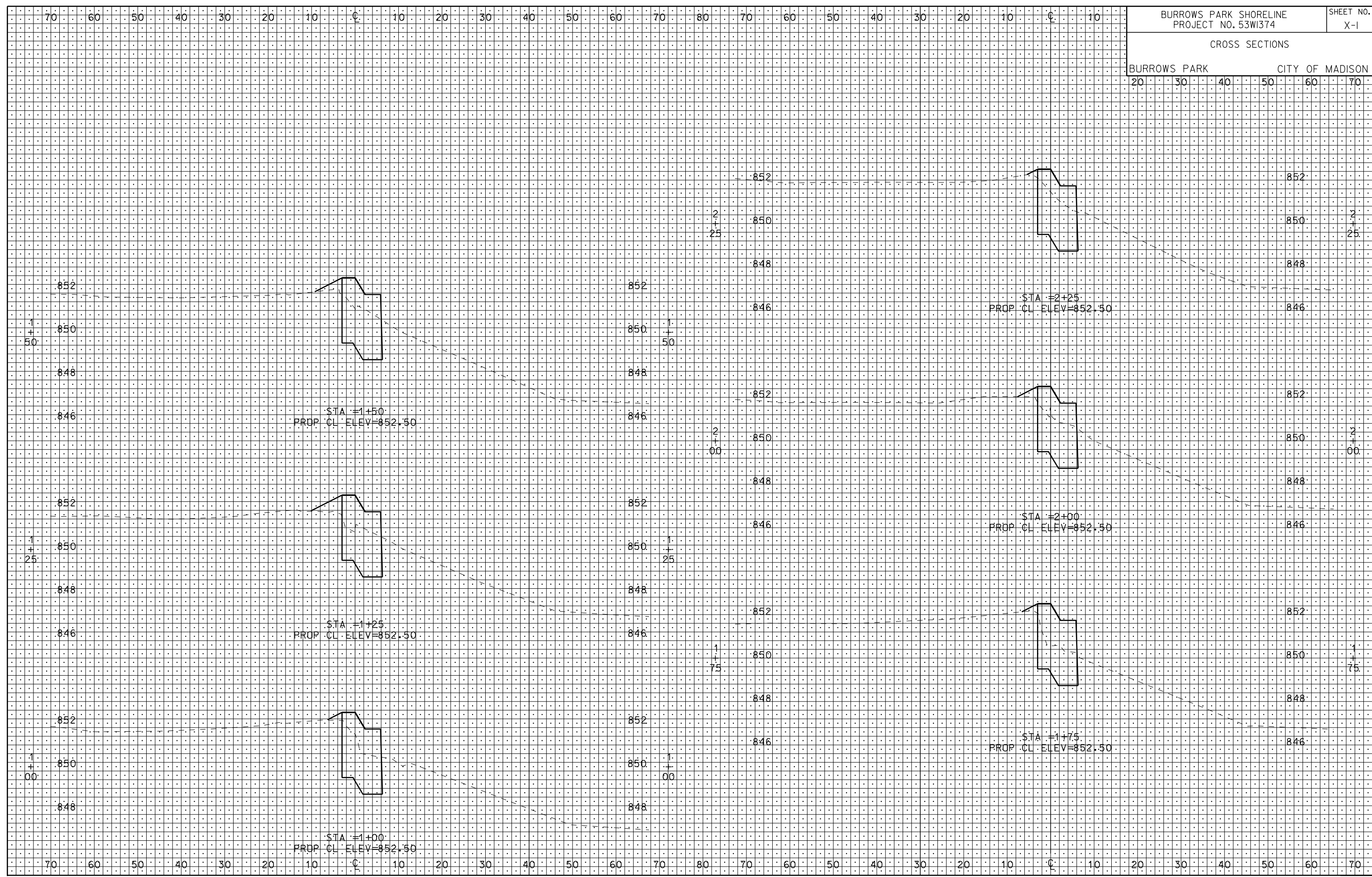

ORIGINATOR: CITY OF MADISON - STREETS DIVISION

PLOT NAME: PLOT SCALE: REV. DATE:

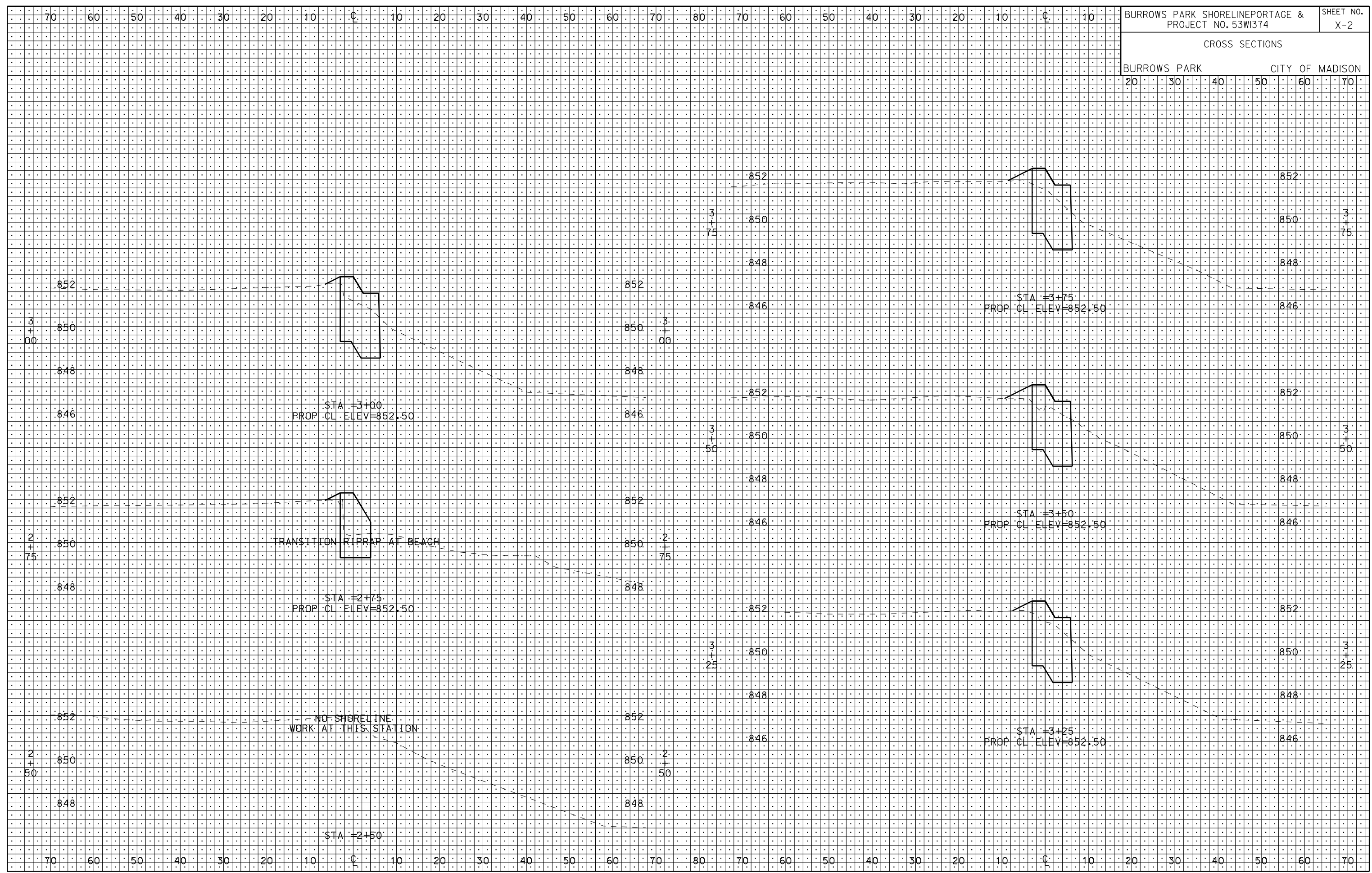

BURROWS PARK SHORELINEPORTAGE & PROJECT NO. 53WI374 SHEET NO. X-2
 CROSS SECTIONS
 BURROWS PARK CITY OF MADISON

ORIGINATOR: CITY OF MADISON - STREETS DIVISION

PLOT SCALE: 1" = 50'
PLOT NAME:
REV. DATE:

