

Madison, Wisconsin

CITY OF MADISON

CITY ENGINEERING DIVISION

DEPARTMENT OF PUBLIC WORKS

PLAN OF PROPOSED IMPROVEMENT

PUBLIC IMPROVEMENT PROJECT APPROVED

January 21, 2014

BY THE COMMON COUNCIL OF MADISON, WISCONSIN

PUBLIC IMPROVEMENT DESIGN APPROVED BY:

 5/20/14
City Engineer Date

INDEX OF SHEETS

SHEET NO.	TITLE
SHEET NO. 1	DETAILS
SHEET NO. D1	EROSION CONTROL PLAN
SHEET NO. EC1-EC2	SITE AND GRADING PLAN
SHEET NO. P1-P2	STORM SEWER PLAN AND PROFILE
SHEET NO. U1	STORM SEWER SCHEDULE
SHEET NO. U2	CROSS-SECTIONS
SHEET NO. XI-X8	



HIGHLAND MANOR STORM SHELTER

SITE GRADING COMPONENT

CITY PROJECT NO. 53W1625

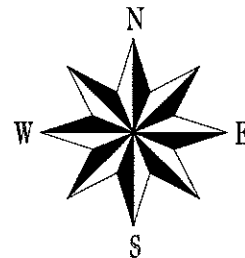
CONTRACT NO. 7319

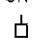

CONVENTIONAL SIGNS	
FIELD VERIFY ALL UTILITY LOCATIONS	
GAS	— G —
STORM SEWER	— ST —
SANITARY SEWER	— SAN —
WATER	— W —
OVERHEAD ELECTRIC	— OH —
POWER POLE	
ADA COMPLIANT RAMP W/ DETECTABLE WARNING FIELD	
COMBUSTIBLE FLUIDS	

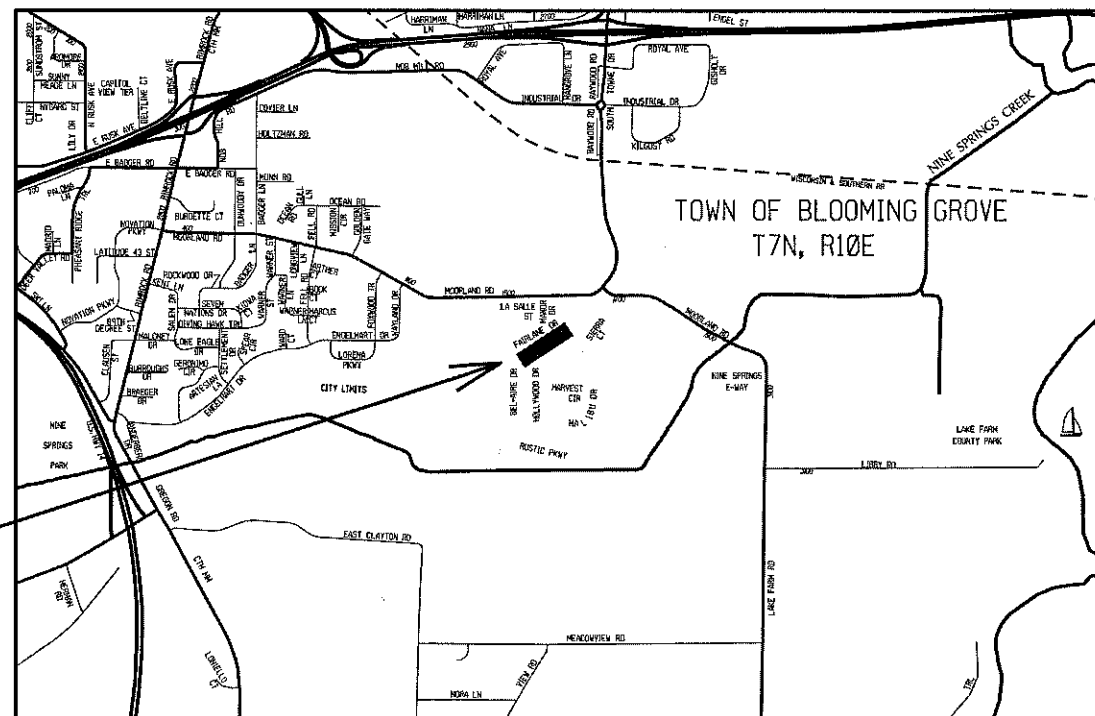

CONSTRUCTION PROJECT LOCATION

SITE & GRADING DESIGNED BY:

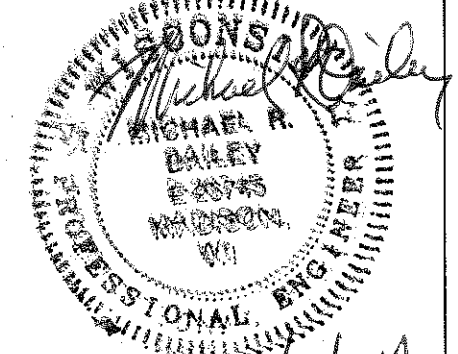

STORM SEWER DESIGNED BY:

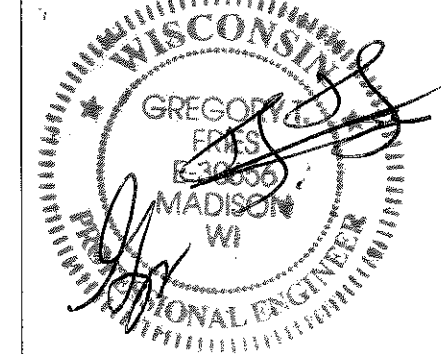

PLOT SCALE:

PLOT NAME:

REV. DATE:

ORIGINATOR: CITY OF MADISON, STREETS DIVISION

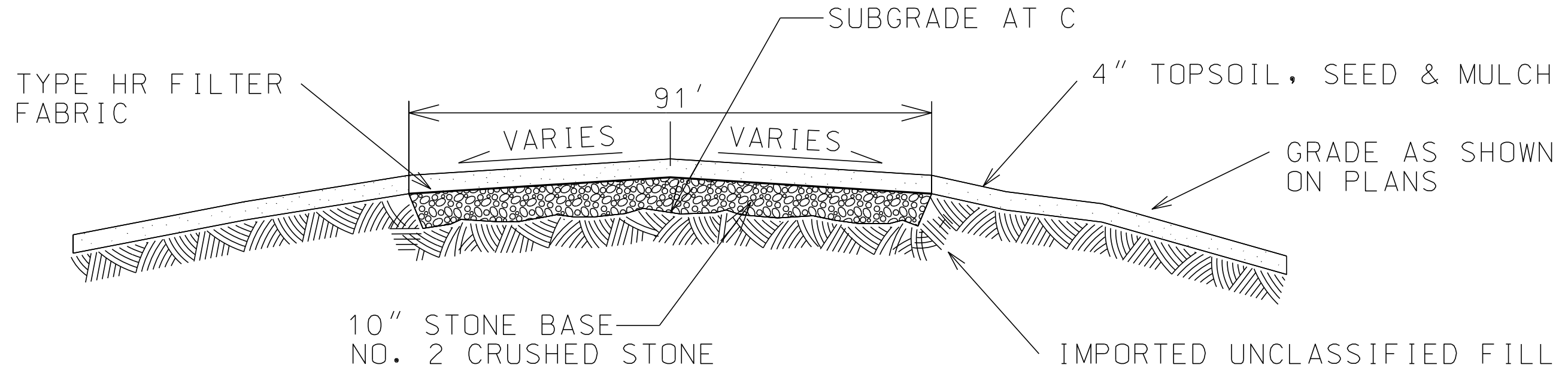

OVERFLOW PARKING

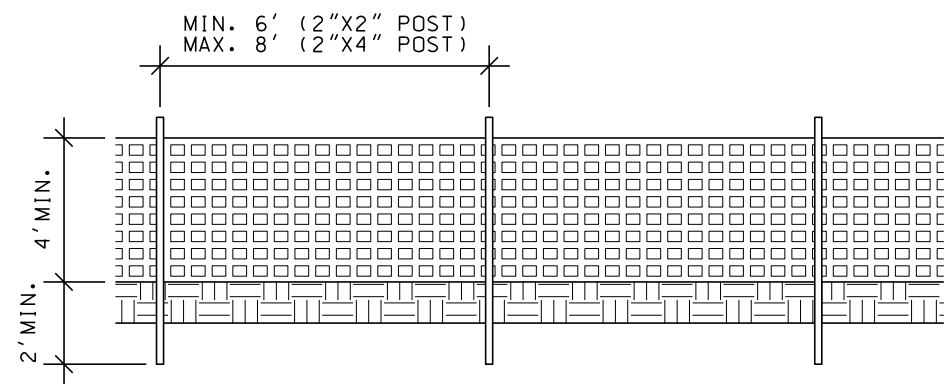

ANCHOR POST SHALL BE INSTALL TO A DEPTH OF AT LEAST 2'.
FENCING MATERIAL TO BE BLAZE ORANGE FENCE

CONSTRUCTION FENCE

BID ITEM 90006

PLOT SCALE:

PLOT NAME:

REV. DATE:

ORIGINATOR: CITY OF MADISON, STREETS DIVISION

CONSTRUCTION ENTRANCE (S.D.D. 1.07)

TYPE D HYBRID INLET PROTECTION

CONSTRUCTION FENCE (BID ITEM XXXXX)

SILT FENCE

EROSION CONTROL NOTES:

EROSION CONTROL MEASURES SHALL BE IN PLACE PRIOR TO ANY OTHER CONSTRUCTION ACTIVITY.

THE CONTRACTOR IS RESPONSIBLE FOR THE CONSTRUCTION AND MAINTENANCE OF ALL EROSION CONTROL MEASURES UNTIL FINAL ACCEPTANCE BY THE CITY OF MADISON.

THE CONTRACTOR SHALL INSTALL AND MAINTAIN EROSION CONTROL MEASURES IN ACCORDANCE WITH THE WDNRSOC STANDARDS AND CITY OF MADISON STANDARD SPECIFICATIONS.

THE CONTRACTOR SHALL PROVIDE STREET CLEANING AS NEEDED ON A DAILY BASIS TO KEEP TRACKING TO A MINIMUM.

PROVISION OF AN EROSION CONTROL IMPLEMENTATION PLAN BY THE CONTRACTOR AT THE PRE-CON IS REQUIRED.

THE CONTRACTOR SHALL PROVIDE A CONSTRUCTION DEWATERING PLAN AS PART OF THE EROSION CONTROL IMPLEMENTATION PLAN.

POLYMER SHALL BE APPLIED TO DISTURBED AREAS AS DIRECTED BY THE CONSTRUCTION ENGINEER.

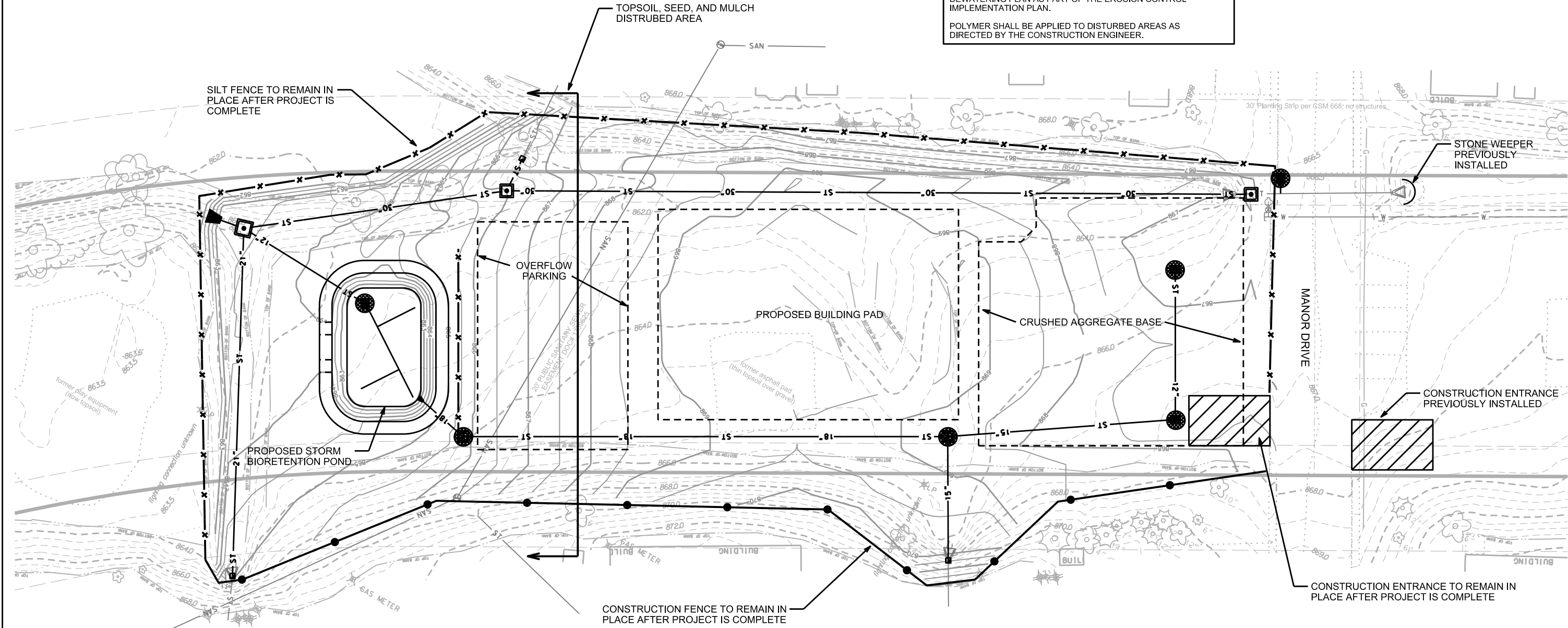
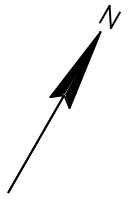

PLOT SCALE:
PLOT NAME:
REV. DATE:
ORIGINATOR: CITY OF MADISON, STREETS DIVISION

NOTE: ALL STORM SEWER CONSTRUCTION WILL BE PERFORMED BY CITY OF MADISON ENGINEERING, UNLESS NOTED OTHERWISE. CONTRACTOR TO COORDINATE WORK WITH THE CITY OF MADISON CONSTRUCTION CREWS.

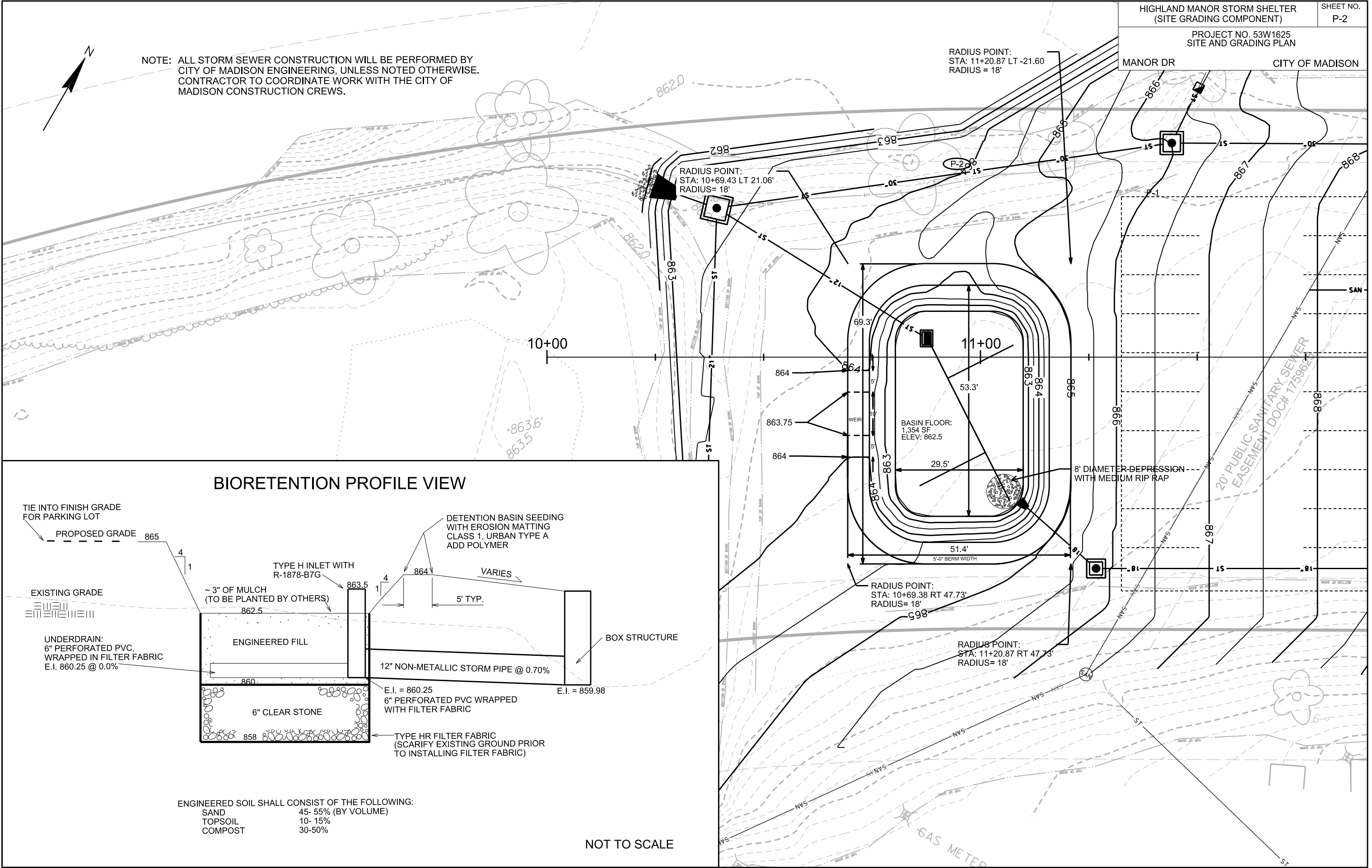

BIORETENTION PROFILE VIEW

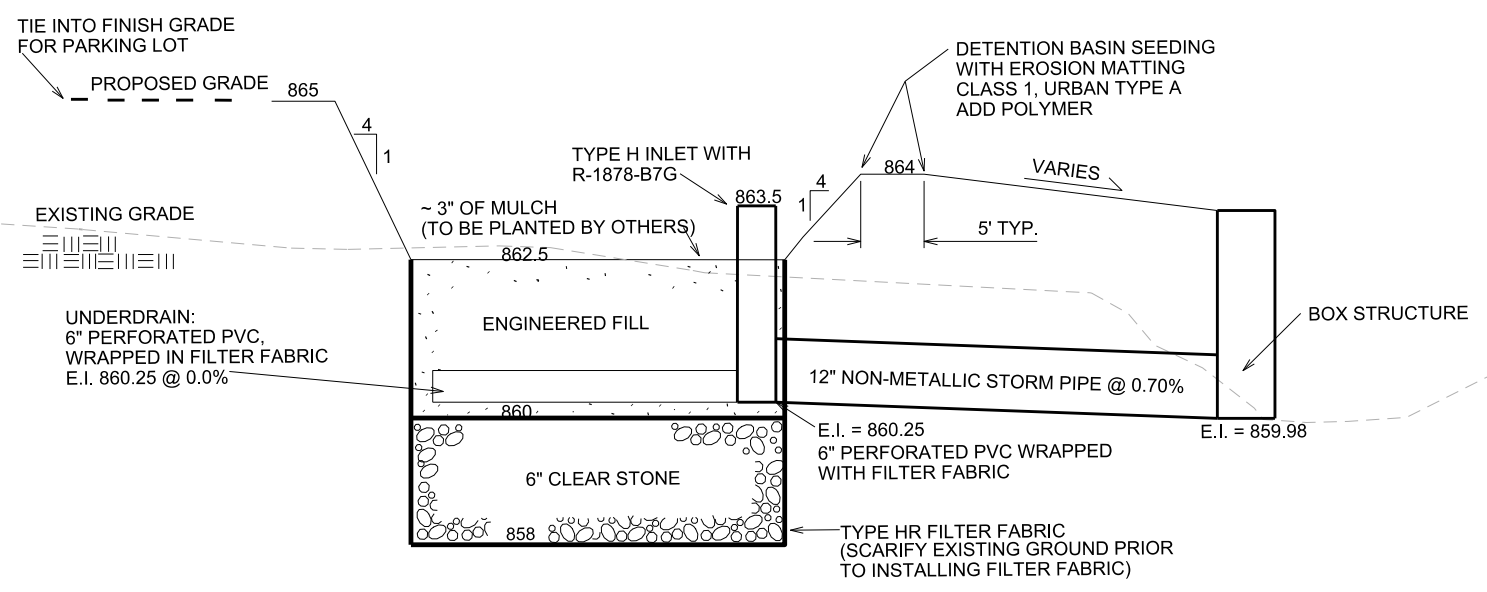

ENGINEERED SOIL SHALL CONSIST OF THE FOLLOWING:
 SAND 45- 55% (BY VOLUME)
 TOPSOIL 10- 15%
 COMPOST 30-50%

NOT TO SCALE

PLOT SCALE: _____ PLOT NAME: _____ REV. DATE: _____ ORIGINATOR: CITY OF MADISON, STREETS DIVISION

NOTE: ALL STORM AND SANITARY SEWER CONSTRUCTION WILL BE PERFORMED BY CITY OF MADISON ENGINEERING, UNLESS NOTED OTHERWISE. CONTRACTOR TO COORDINATE WORK WITH THE CITY OF MADISON CONSTRUCTION CREWS.

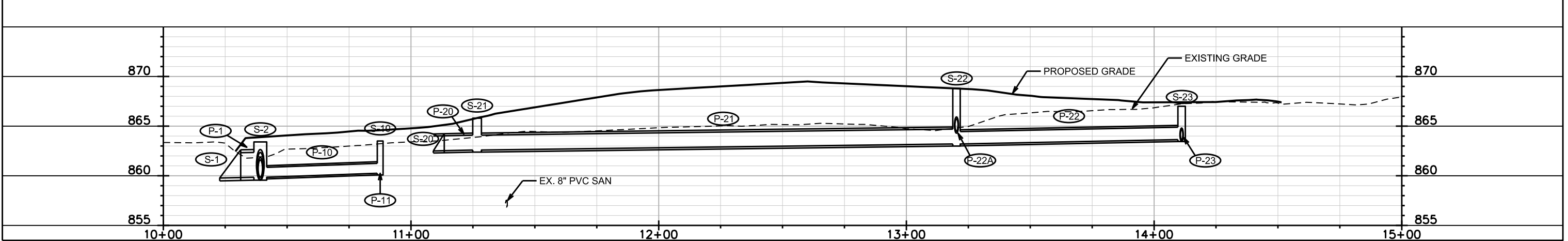
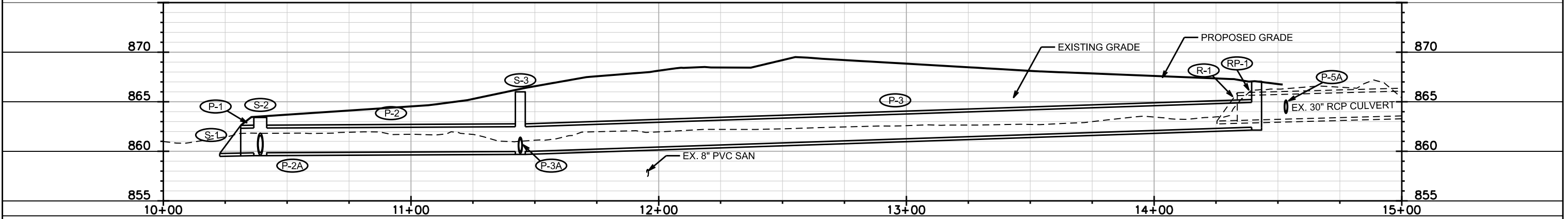
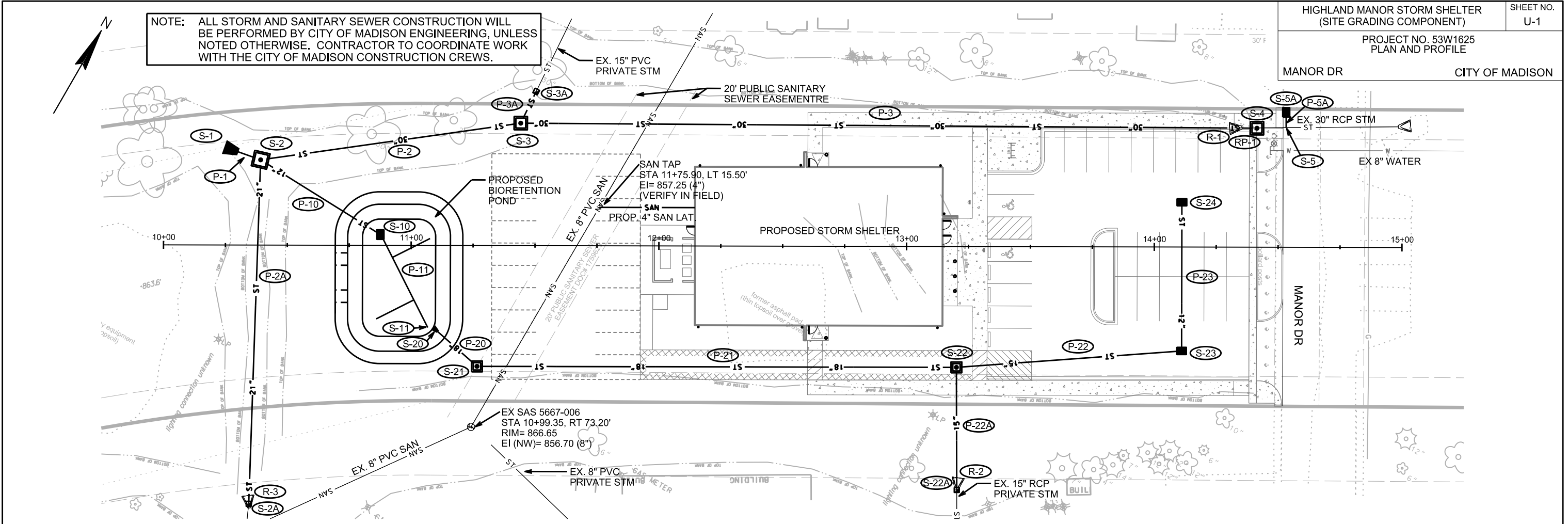

PLOT SCALE:

PLOT NAME:

REV. DATE:

ORIGINATOR: CITY OF MADISON, STREETS DIVISION

STORM SEWER SCHEDULE

ALIGNMENT CODES:

HIGHLAND MANOR STORM SHELTER (SITE GRADING COMPONENT)	SHEET NO. U-2
PROJECT NO. 53W1625 STORM SEWER SCHEDULE	
MANOR DR	CITY OF MADISON

PROPOSED STORM STRUCTURES

STRUC. NO.	STATION	LOCATION (OFFSET)	TYPE	TOP OF CASTING	E.I.	DEPTH	NOTES
S-1	10+24.50	LT-39.60	30" RCP AE	-	859.80	-	(1), W/AE GATE
S-2	10+39.15	LT-34.40	5X5 SAS	863.41	859.85	3.56	(FP), W/R-1689, LID 1550-0054
S-2A	10+34.65	RT-104.45	CONCRETE COLLAR	-	860.97	-	-
S-3	11+44.15	LT-49.45	4X4 SAS	866.00	859.98	6.02	W/R-1689, LID 1550-0054
S-3A	11+50.35	LT-62.20	CONCRETE COLLAR	-	860.01	-	-
S-4	14+41.39	LT-48.00	4X4 SAS	867.06	862.43	4.63	W/R-1550-0054
S-5	14+53.15	LT-48.30	STORM TAP	-	864.00	-	-
S-5A	14+53.15	LT-54.40	H INLET	866.31	864.02	2.29	(3), W/R-1878-B7G
S-10	10+87.55	LT-4.35	H INLET	863.50	860.25	3.25	(3), W/R-1878-B7G
S-11	11+06.75	RT-33.15	STUB	-	860.25	-	(3), W/R-1878-B7G
S-20	11+09.00	RT-33.20	18" RCP AE	-	862.50	-	W/AE GATE (1)
S-21	11+26.70	RT-48.75	3X3 SAS	865.80	862.59	3.21	(FP), W/R-1689, LID 1550-0054
S-22	13+20.25	RT-48.75	3X3 SAS	868.80	863.20	5.60	W/R-1550-0054
S-22A	13+20.45	RT-98.25	CONCRETE COLLAR	-	865.48	-	-
S-23	14+11.10	RT-41.95	H INLET	867.00	863.64	3.36	W/R-1878-B7G (3)
S-24	14+11.10	LT-18.05	H INLET	866.50	863.93	2.57	(FP), (3), W/R-1878-B7G

PROPOSED STORM PIPES

PIPE NO.	FROM (DNSTM)	TO (UPSTM)	LGTH (FT)	DISCH. E.I.	INLET E.I.	SLOPE (%)	PIPE SIZE	TYPE	NOTES
P-1	S-1	S-2	7	859.80	859.85	0.50%	30"	STORM	-
P-2	S-2	S-3	106	859.85	859.98	0.13%	30"	STORM	-
P-2A	S-2	S-2A	139	859.85	860.97	0.82%	21"	STORM	NCM
P-3	S-3	S-4	297.5	859.98	862.43	0.84%	30"	STORM	-
P-3A	S-3	S-3A	14.5	859.98	860.01	0.25%	15"	STORM	NCM
P-5A	S-5	S-5A	6.5	864.00	864.02	0.50%	12"	RCP	-
P-10	S-2	S-10	57	859.85	860.25	0.75%	12"	STORM	NCM
P-11	S-10	S-11	68	860.25	860.25	0.00%	6"	STORM	(2)
P-20	S-20	S-21	23.5	862.50	862.59	0.42%	18"	RCP	-
P-21	S-21	S-22	193.5	862.59	863.20	0.32%	18"	STORM	(4) C900 OR RCP
P-22	S-22	S-23	91	863.20	863.64	0.50%	15"	RCP	NCM
P-22A	S-22	S-22A	49.5	864.48	865.48	2.08%	15"	RCP	-
P-23	S-23	S-24	60	863.64	863.93	0.50%	12"	RCP	-

STORM STRUCTURE REMOVALS

REMOVAL NO.	STATION	LOCATION (OFFSET)	TYPE	NOTES
R-1	14+32.60	LT-48.00	30" RCP AE	-
R-2	13+20.45	RT-95.00	15" RCP AE	-
R-3	10+34.65	RT-104.44	21" RCP AE	-

STORM PIPE REMOVALS

REMOVAL NO.	FROM (DNSTM)	TO (UPSTM)	LGTH (FT)	NOTES
RP-1	R-1	S-5	15	30" RCP

SPECIFIC NOTES

ALL STORM AND SANITARY SEWER CONSTRUCTION WILL BE PERFORMED BY CITY OF MADISON ENGINEERING, UNLESS NOTED OTHERWISE ON THE SITE UTILITY PLAN. CONTRACTOR TO COORDINATE WORK WITH THE CITY OF MADISON CONSTRUCTION CREW.

(1) STATION AND OFFSET FROM END OF AE. SEE STANDARD DETAIL DRAWINGS 5.4.1 AND 5.4.4

(2) PIPE TO BE 6" PERFERATED PVC WRAPPED WITH FILTER FABRIC. SEE POND TYPICAL SECTION ON SHEET P-2. PIPE LENGTH INCLUDES TEE SECTIONS @ 10.5' AND 29.5' FROM CENTER OF S-10.

(3) STATIONING TO CENTER OF STRUCTURE

(4) PROVIDE 8" TAP AT 89' FROM CENTER OF S-21 AND 131' FROM CENTER OF S-21.

STANDARD NOTES:

- ABBREVIATIONS: AE = APRON ENDWALL; RCP = REINFORCED CONCRETE PIPE; HERCP = HORIZONTAL ELLIPTICAL REINFORCED CONCRETE PIPE; DNA = DOES NOT APPLY; SAS = SEWER ACCESS STRUCTURE; LP = LOW POINT INLET STRUCTURE; FP = FIELD POURED STRUCTURE; TR = TOP OF CONCRETE ROOF; NCM = NO CROWN MATCH FOR PIPES

- APPROXIMATE DISCHARGE E.I. GIVEN, ADJUST E.I. AND PIPE SLOPE IN THE FIELD.

- TOP OF CASTING

- TOP OF CONCRETE ROOF (TR) IS 1.25' BELOW TOP OF CASTING UNLESS OTHERWISE NOTED.

- ALL REINFORCED CONCRETE PIPES TO BE CLASS III UNLESS OTHERWISE NOTED.

- SURVEYOR TO CONFIRM THAT ALL INLET STATION / OFFSETS LINE UP WITH PROPOSED CURB AND GUTTER.

- ALL STRUCTURES CALLED OUT AS FIELD POURED SHALL BE FIELD POURED. ALL OTHER STRUCTURES (NOT INDICATED AS FIELD POURED) SHALL BE SUBMITTED TO CITY ENGINEERING FOR APPROVAL IF PRECAST STRUCTURES ARE PREFERRED. CONTACT KYLE FRANK OF CITY ENGINEERING AT (608) 266-4098 FOR PRECAST APPROVALS, FAX SHOP DRAWINGS TO (608)264-9275, OR EMAIL SHOP DRAWINGS TO kfrank@cityofmadison.com.

PLOT SCALE: _____

PLOT NAME: _____

REV. DATE: _____

ORIGINATOR: CITY OF MADISON - STREETS DIVISION

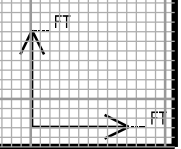
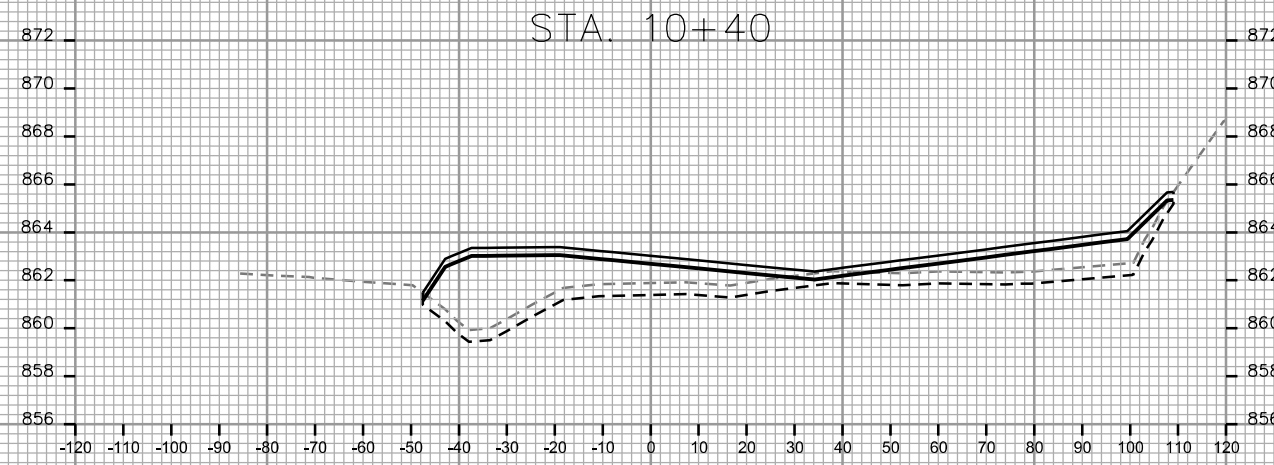
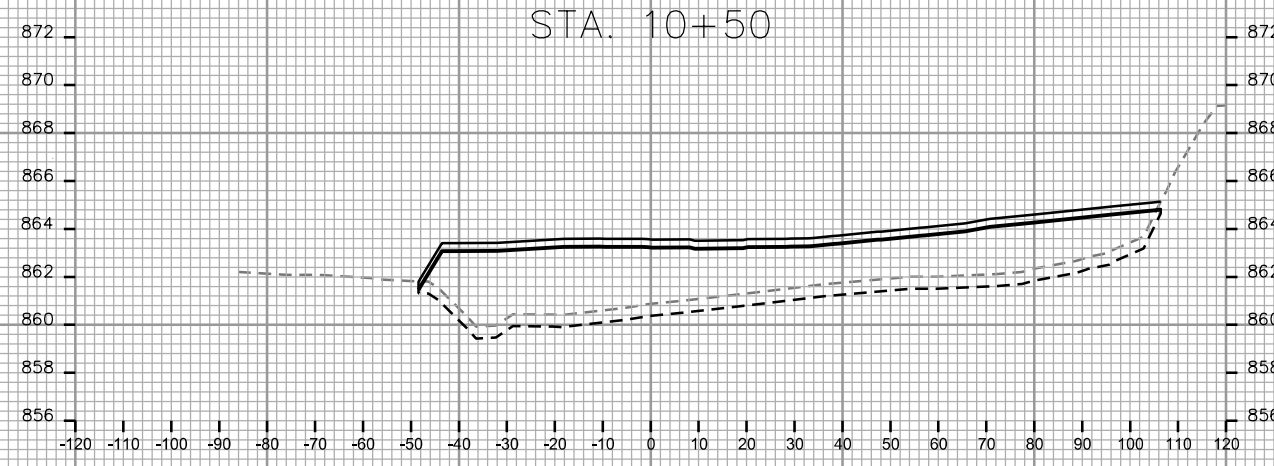
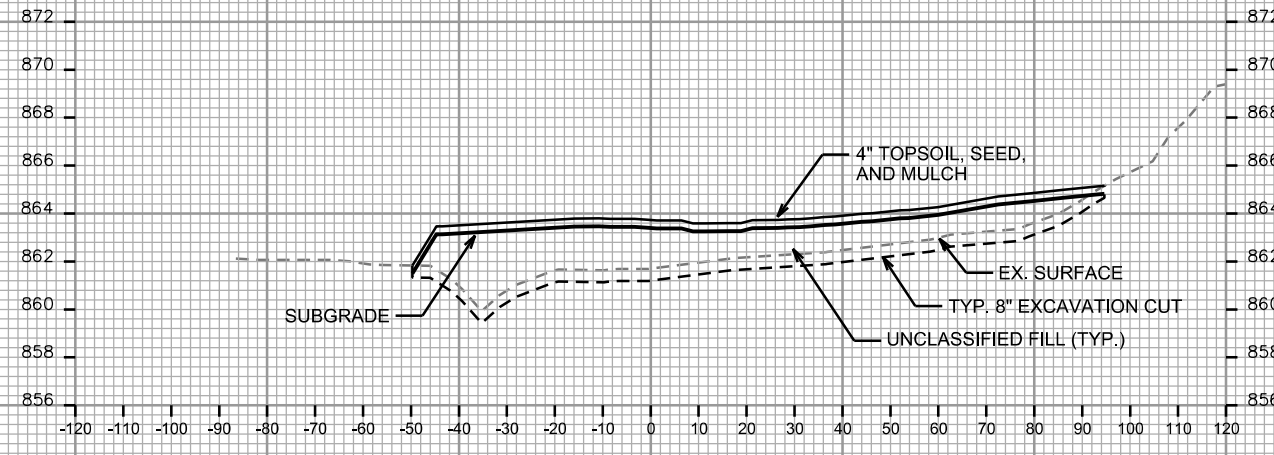
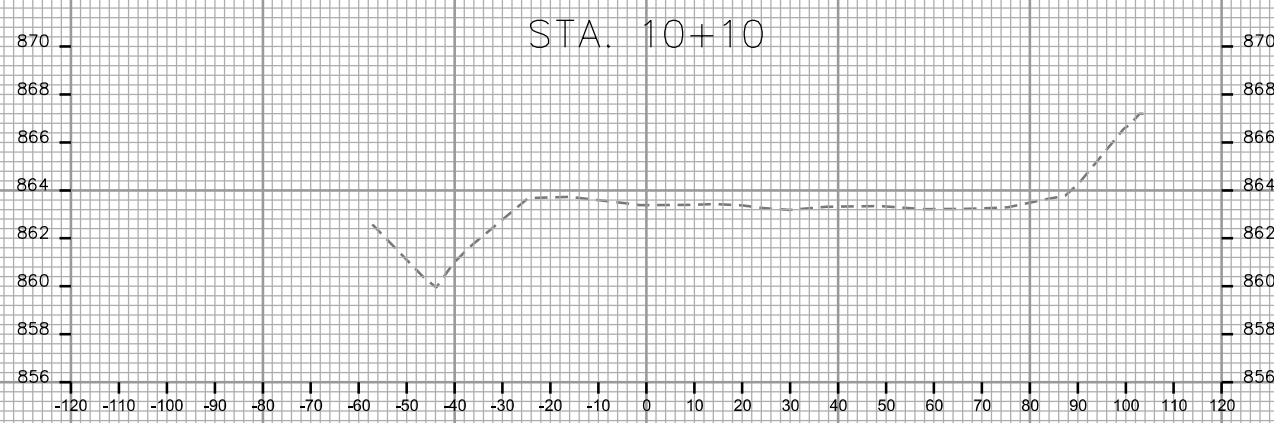
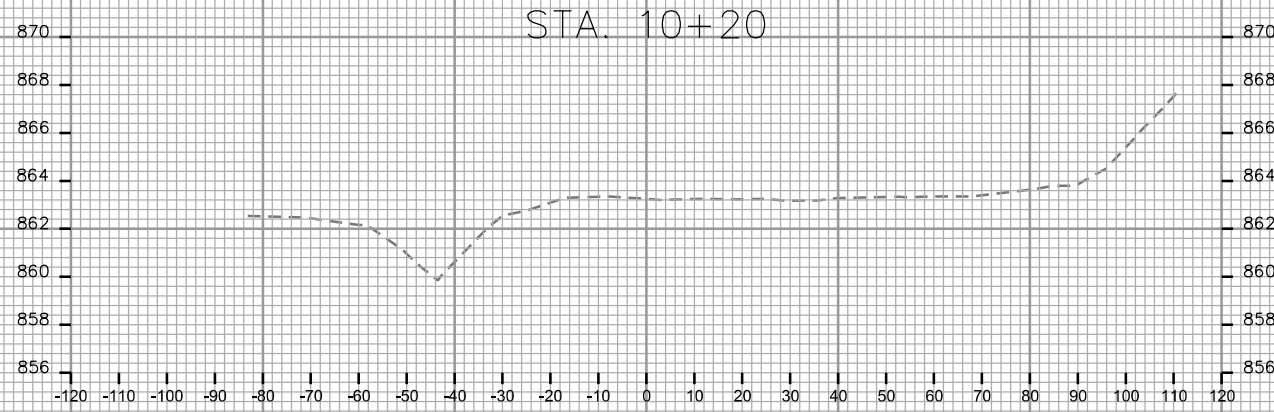
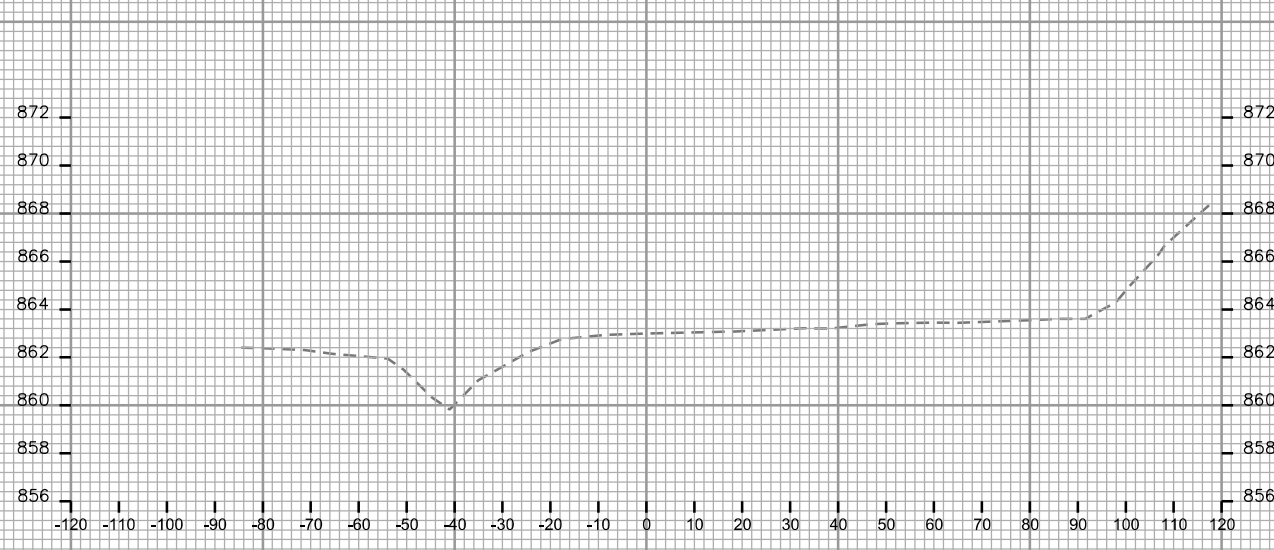



STA. 10+90

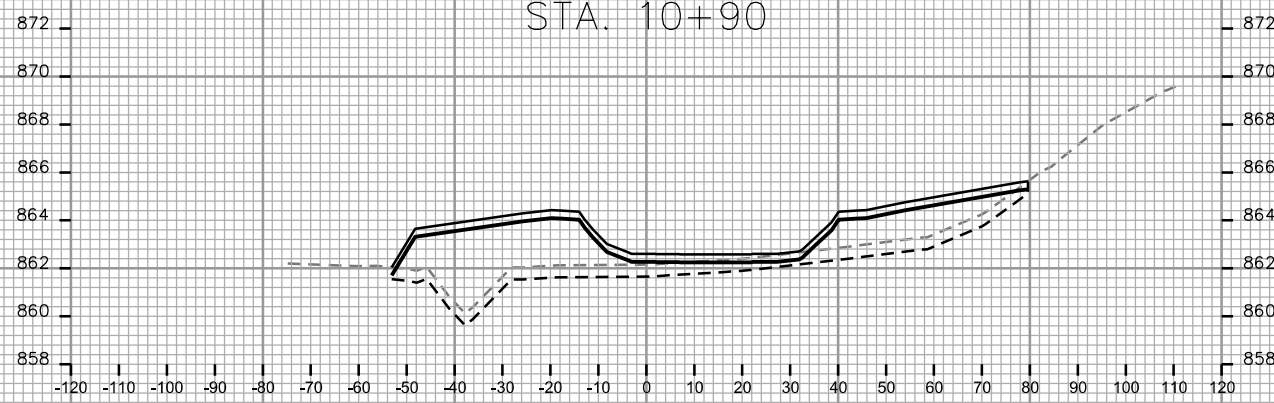

STA. 10+80

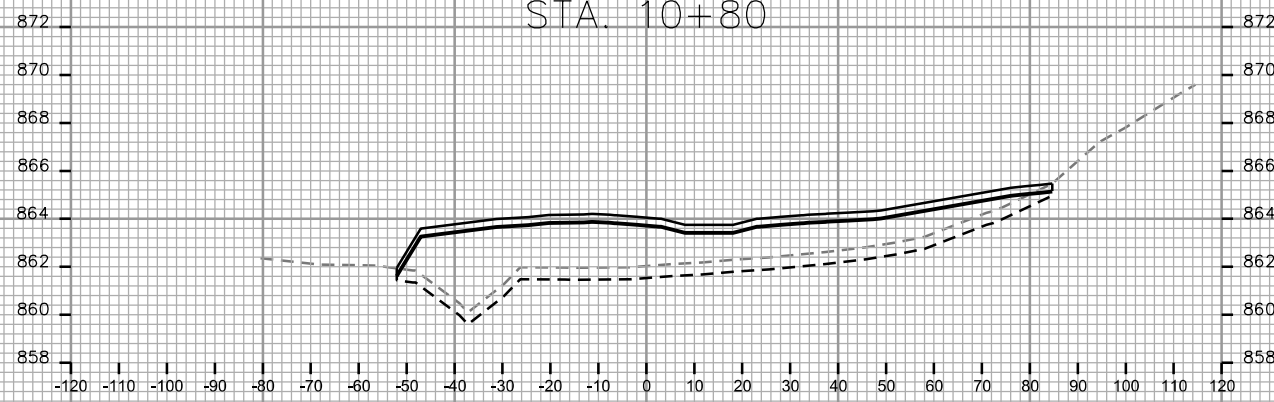

STA. 10+70

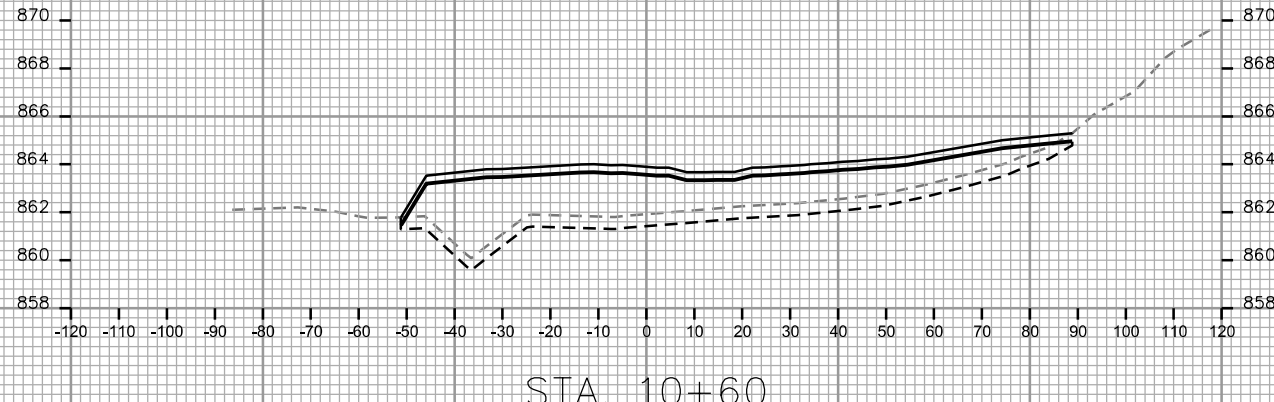

STA. 10+60

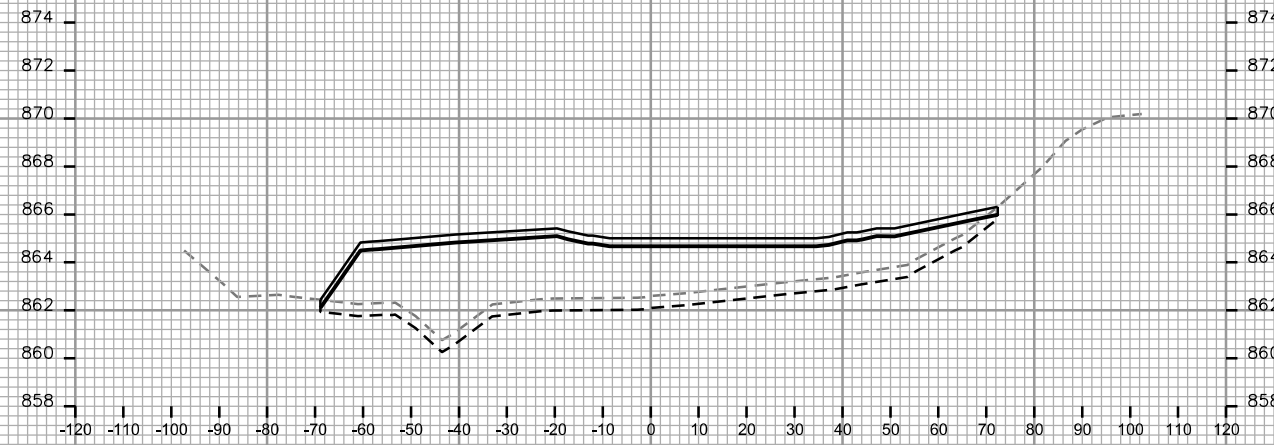

STA. 11+20

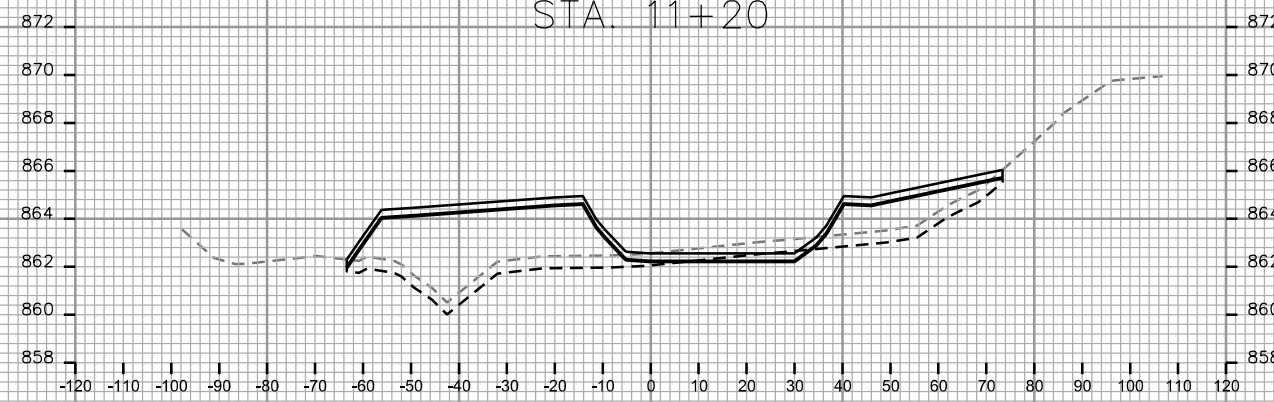

STA. 11+10

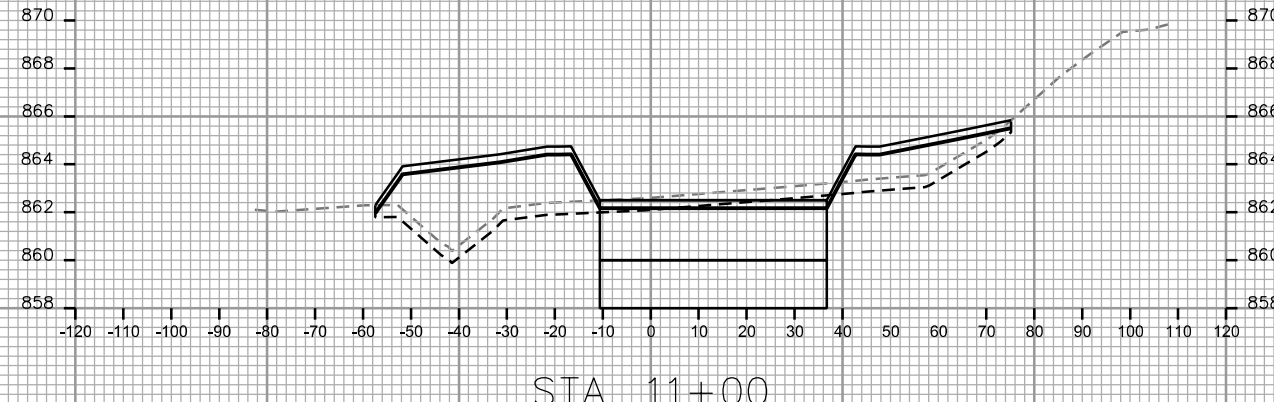

STA. 11+00

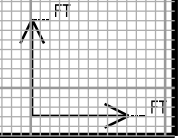

PLOT SCALE: _____

PLOT NAME: _____

REV. DATE: _____

ORIGINATOR: CITY OF MADISON - STREETS DIVISION

PLOT SCALE: _____

PLOT NAME: _____

REV. DATE: _____

ORIGINATOR: CITY OF MADISON - STREETS DIVISION

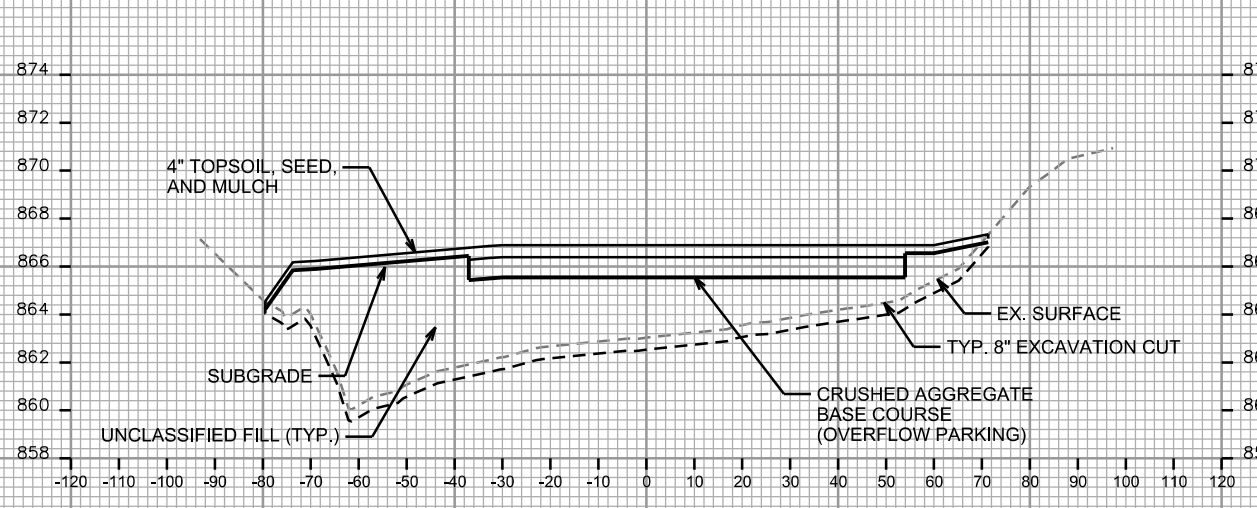

STA. 11+50

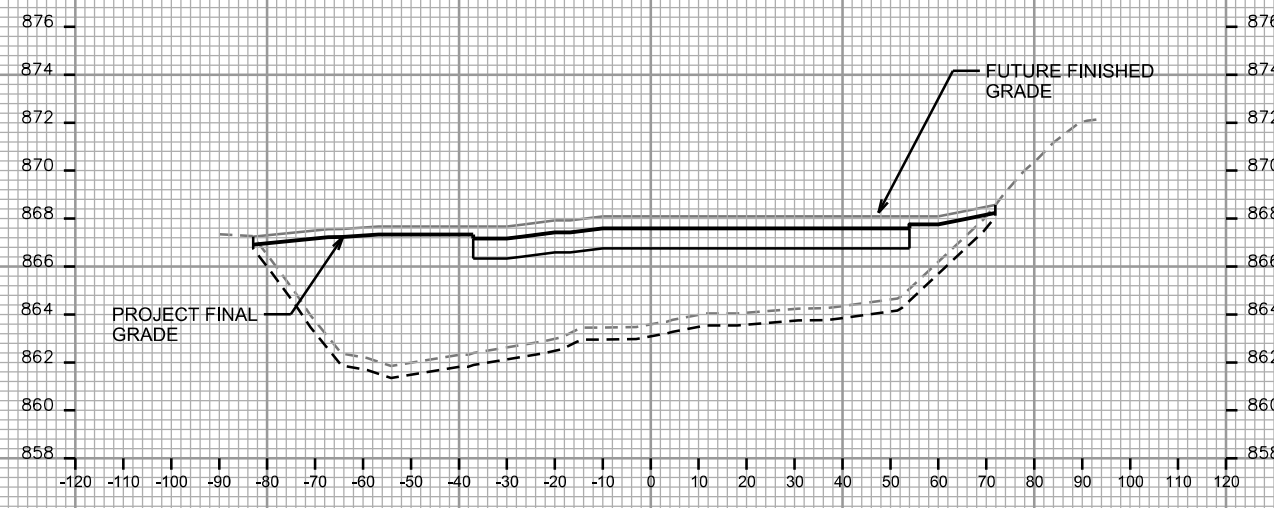

STA. 11+80

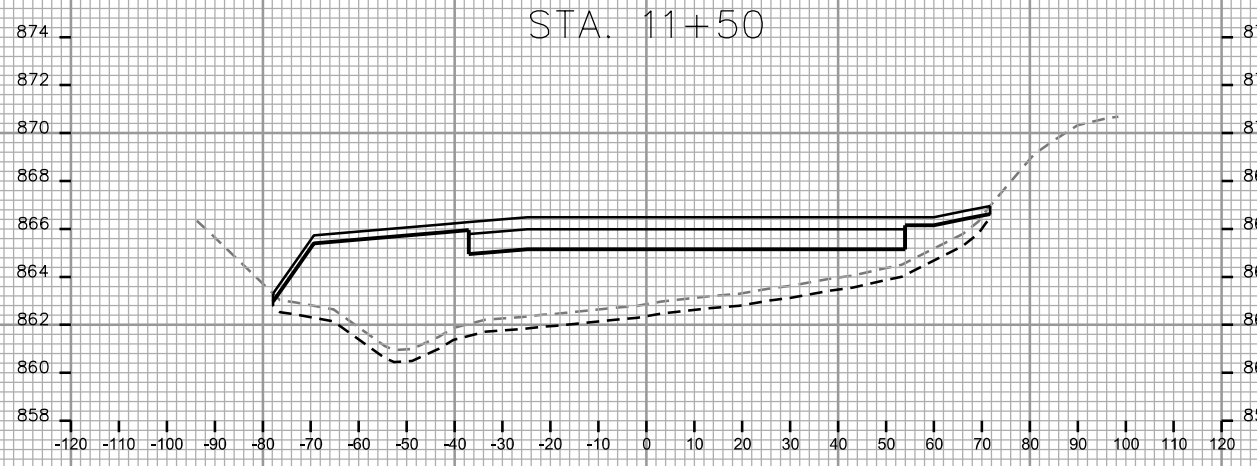

STA. 11+40

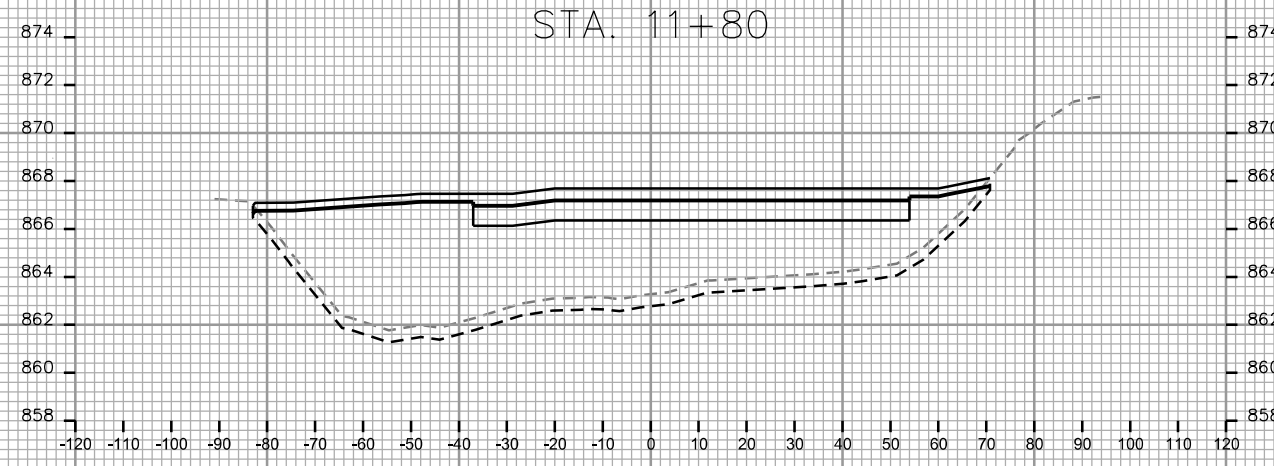

STA. 11+70

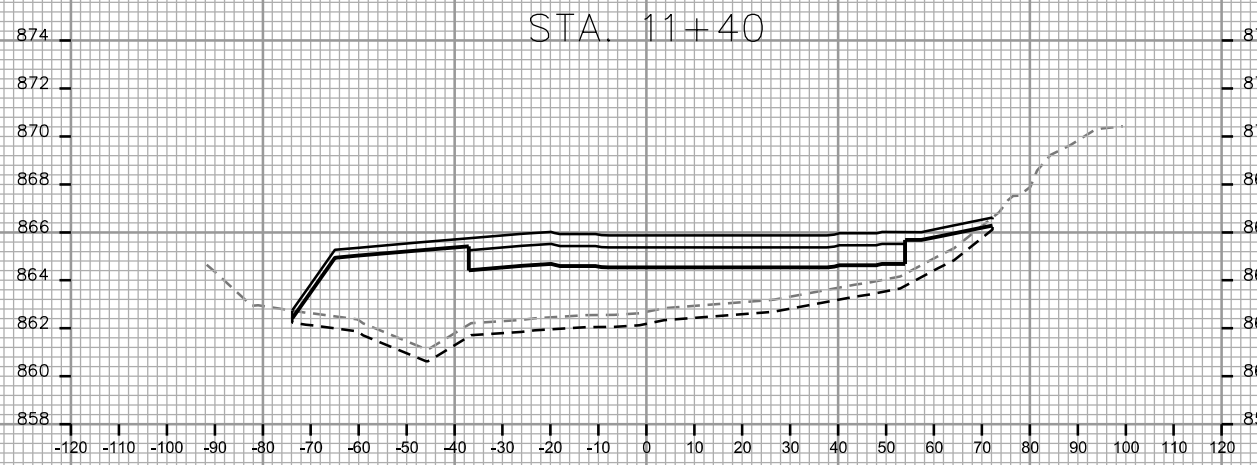

STA. 11+30

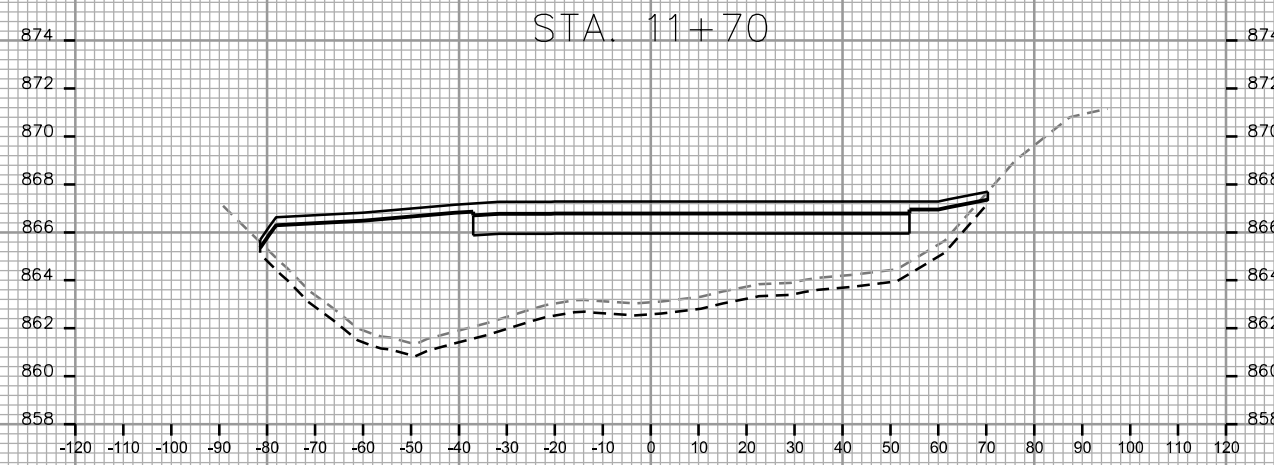

STA. 11+60

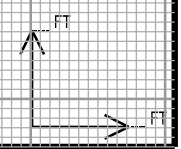

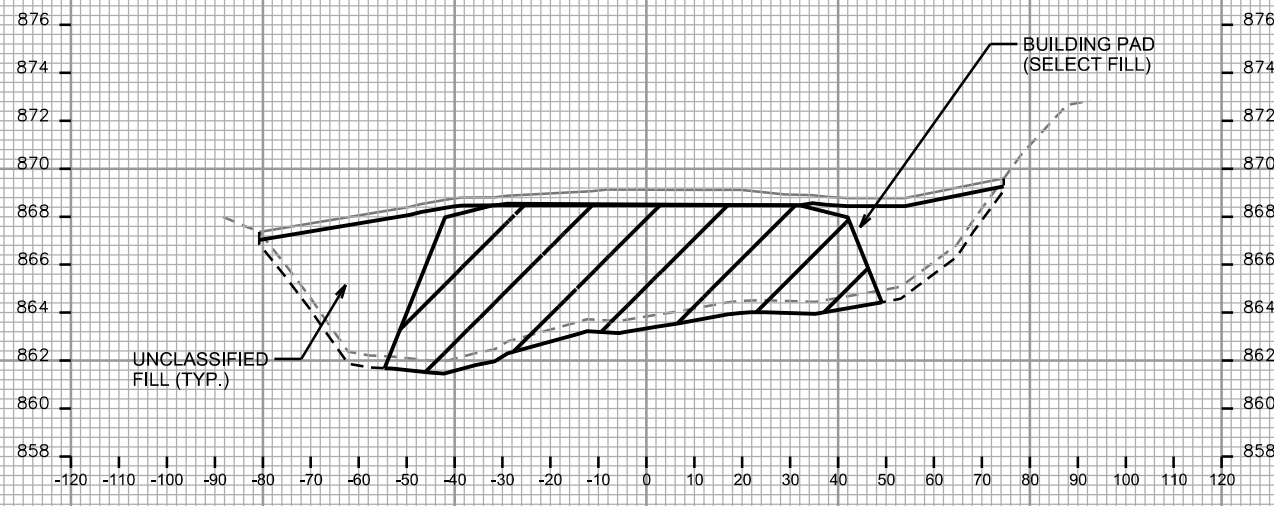

STA. 12+10

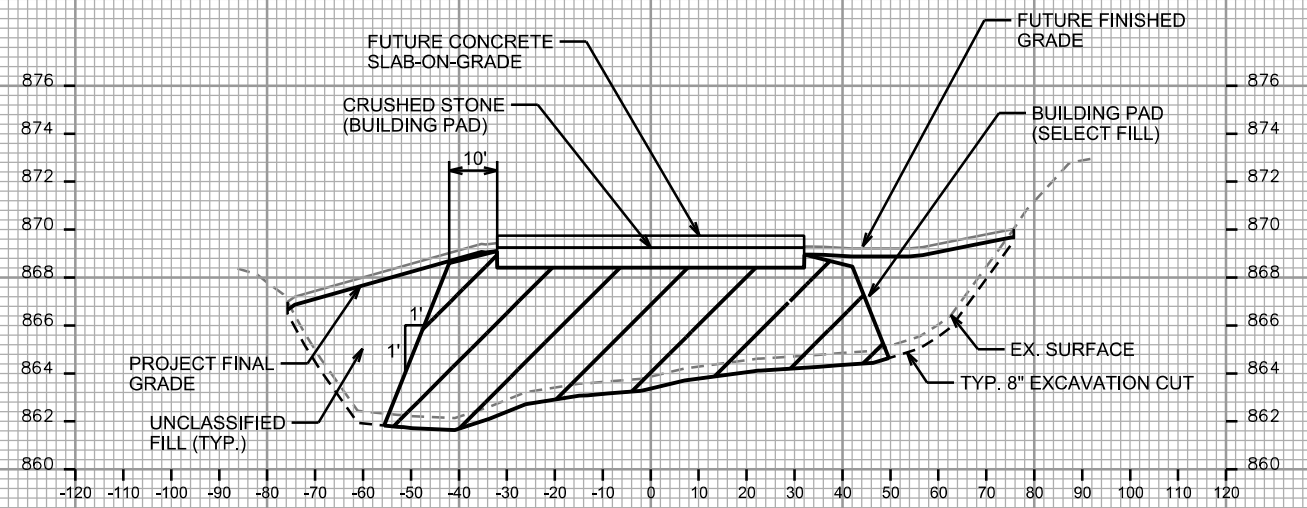

STA. 12+40

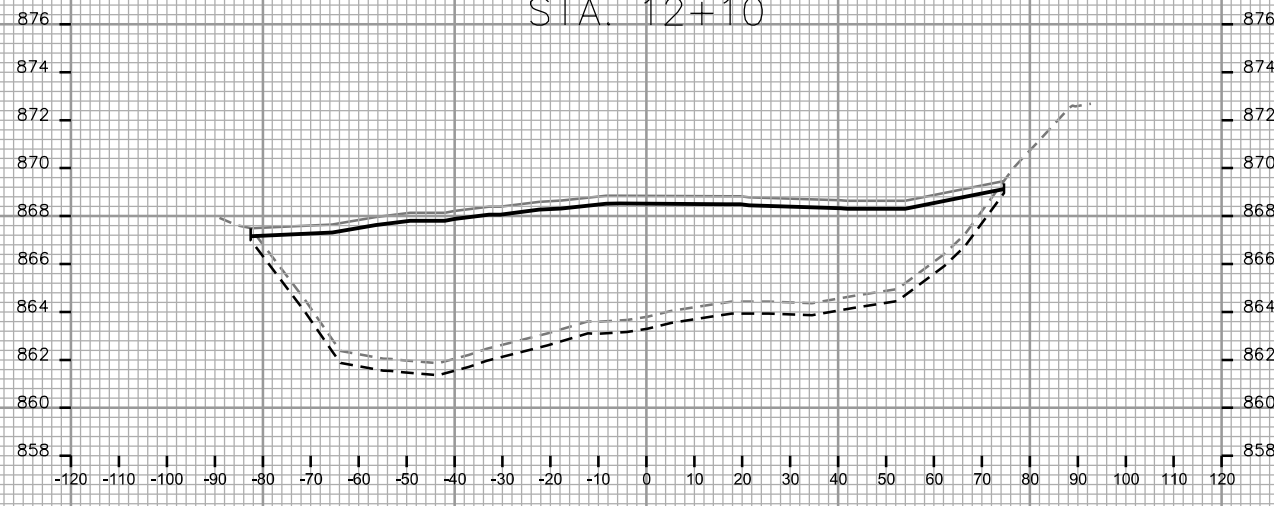

STA. 12+00

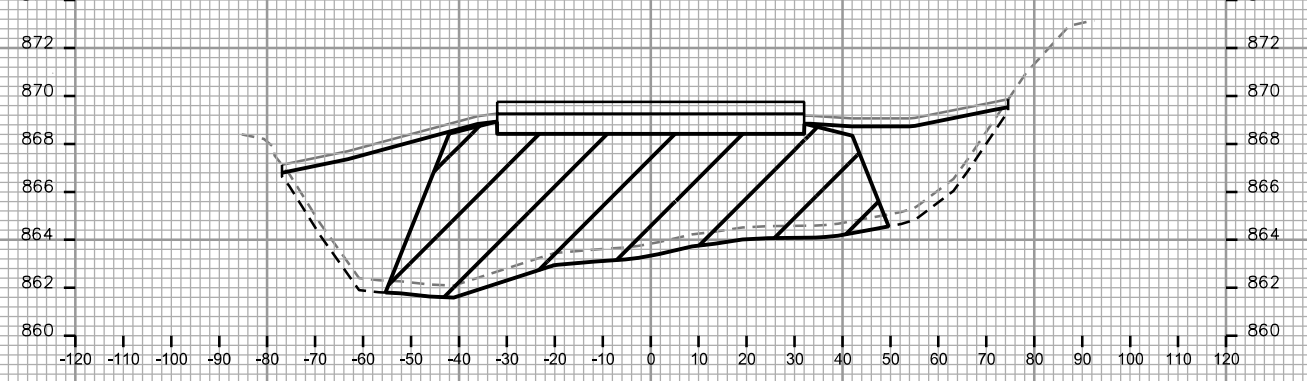

STA. 12+30

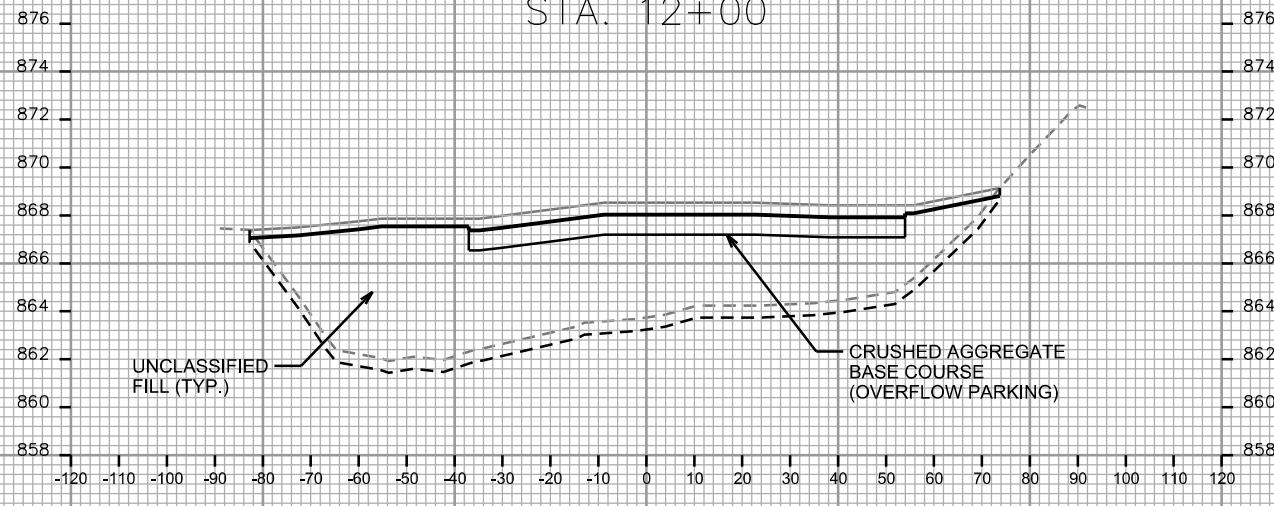

STA. 11+90

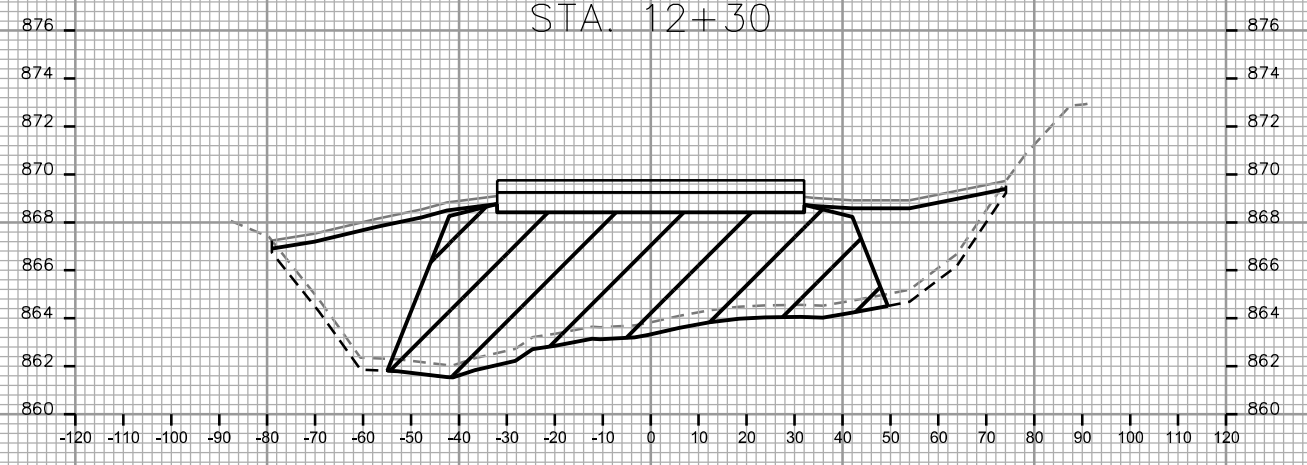

STA. 12+20

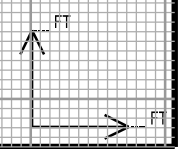

PLOT SCALE: _____

PLOT NAME: _____

REV. DATE: _____

ORIGINATOR: CITY OF MADISON - STREETS DIVISION

PLOT SCALE: _____

PLOT NAME: _____

REV. DATE: _____

ORIGINATOR: CITY OF MADISON - STREETS DIVISION

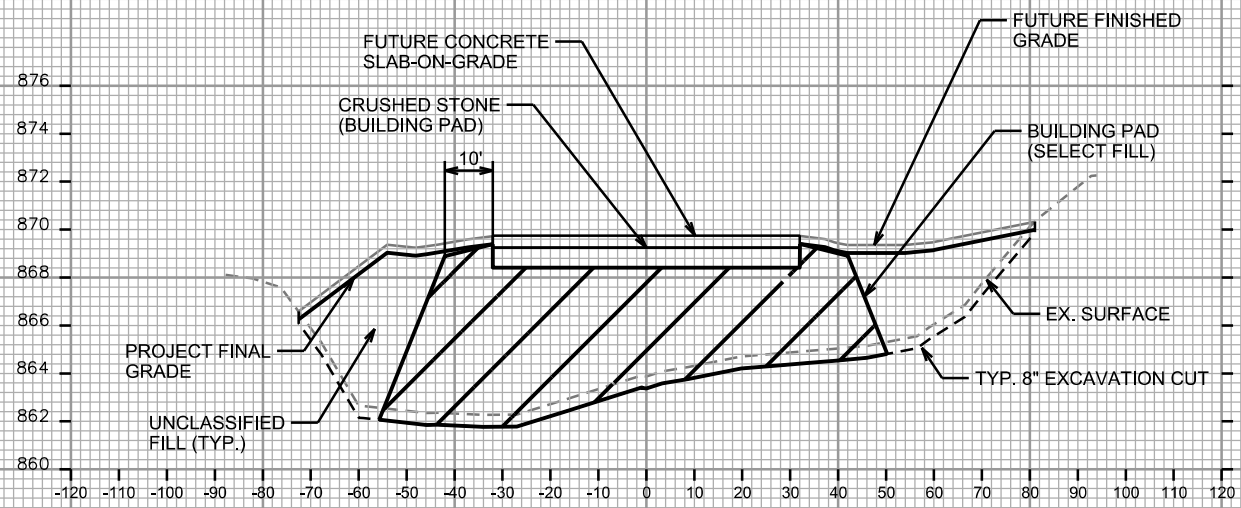

STA. 12+70

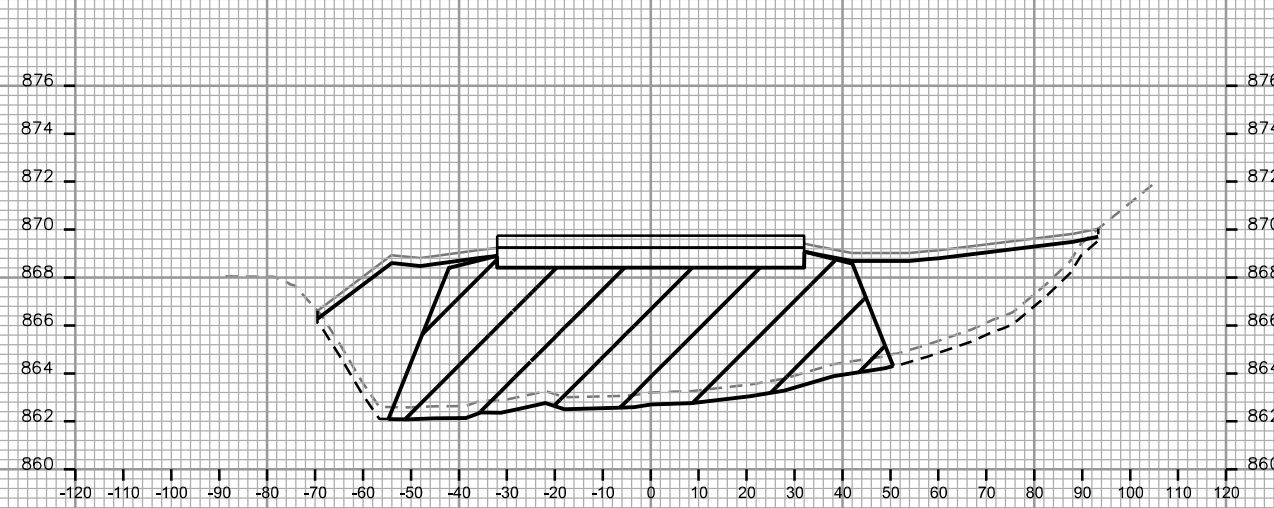

STA. 13+00

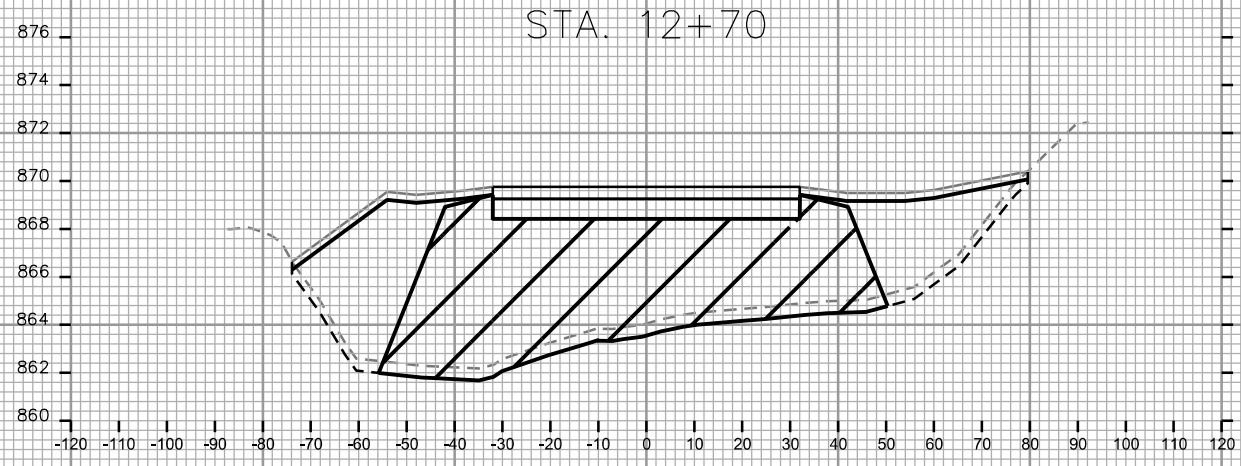

STA. 12+60

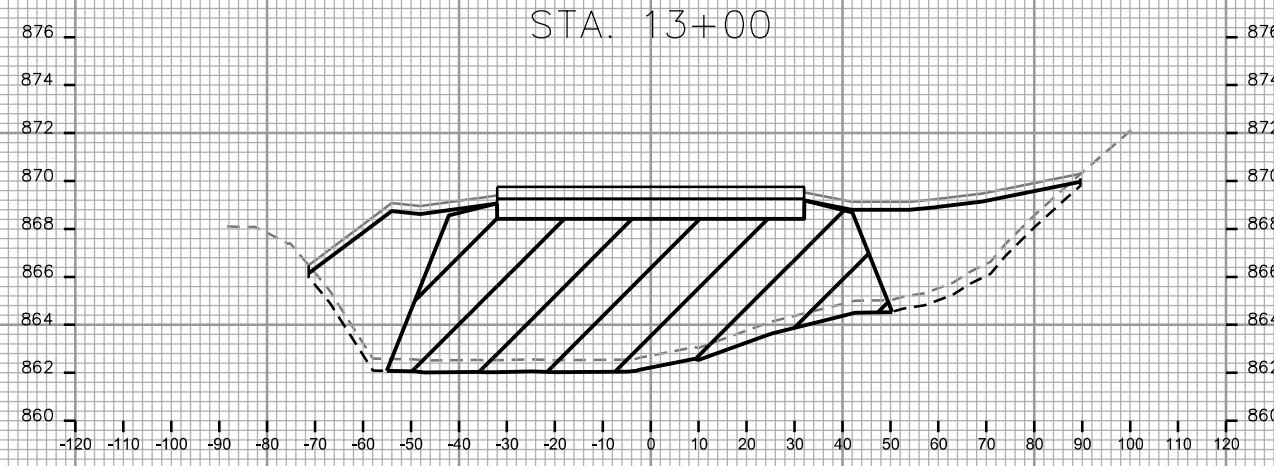

STA. 12+90

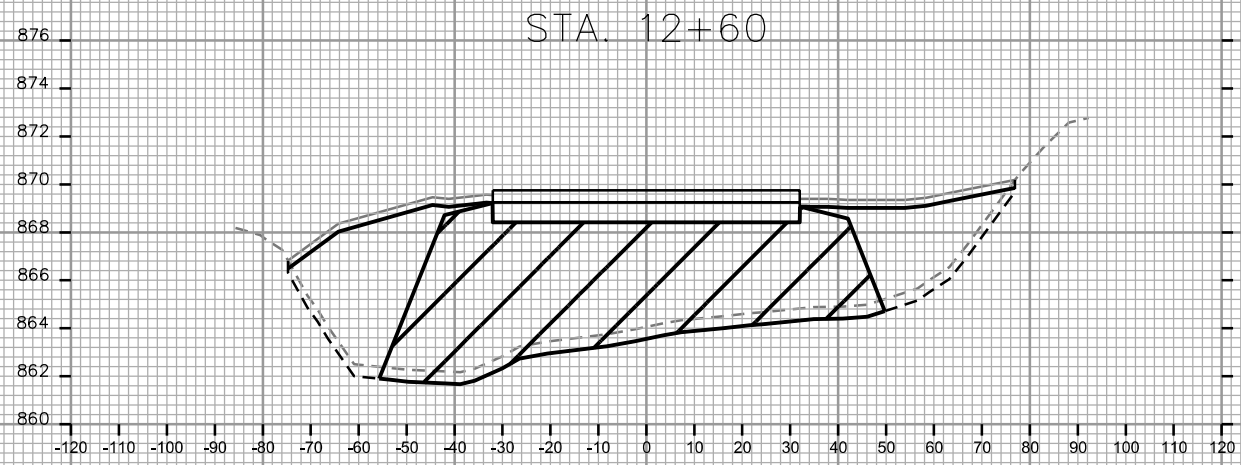

STA. 12+50

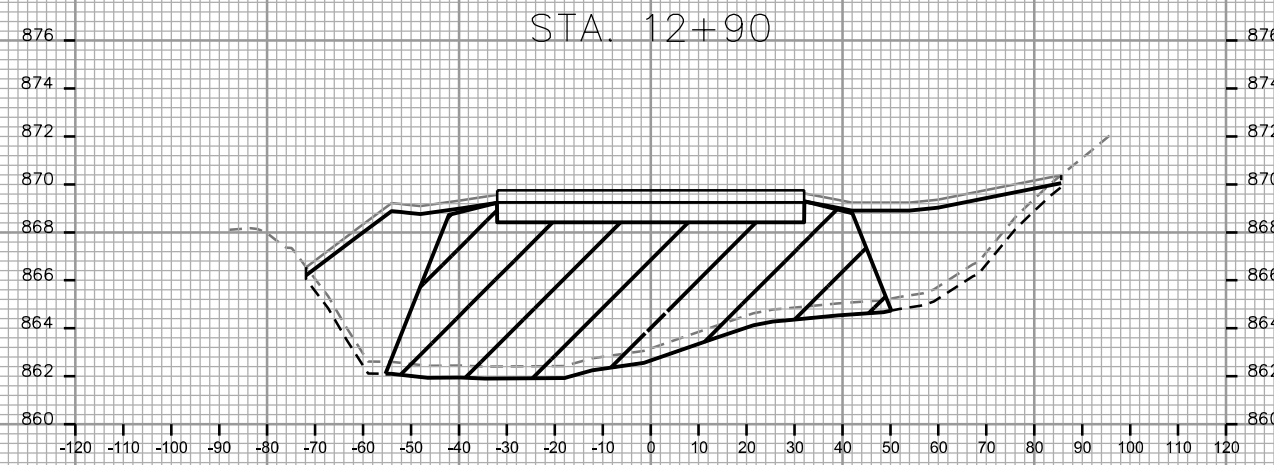

STA. 12+80

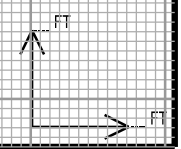

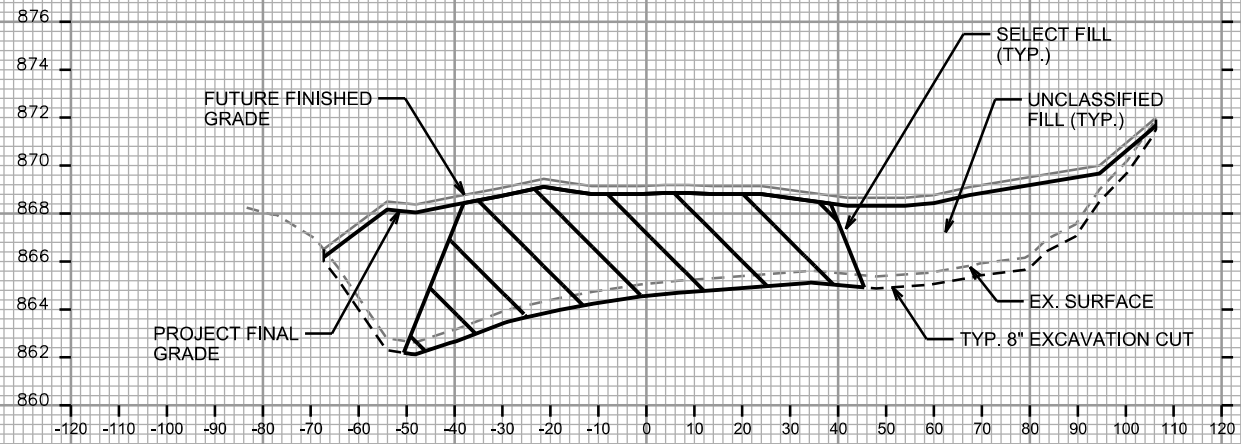

STA. 13+30

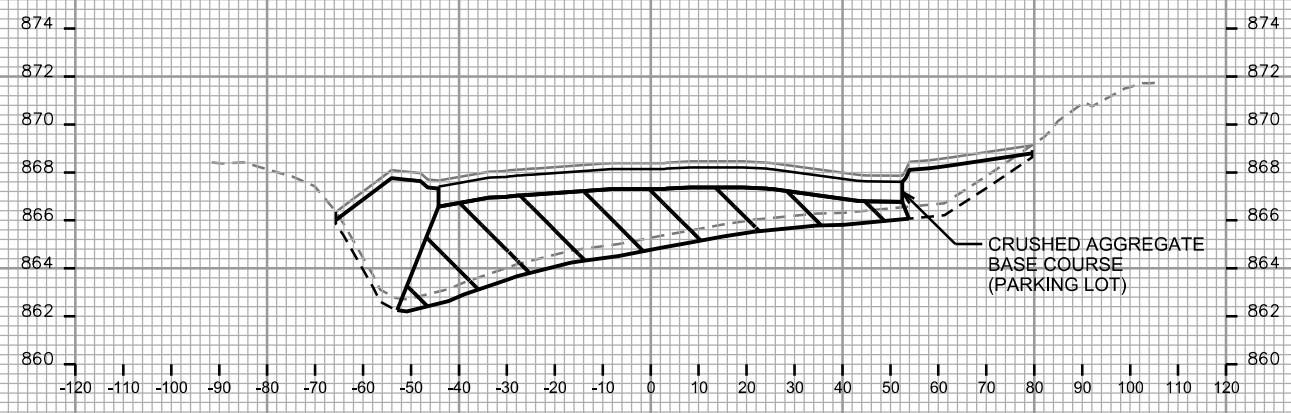

STA. 13+60

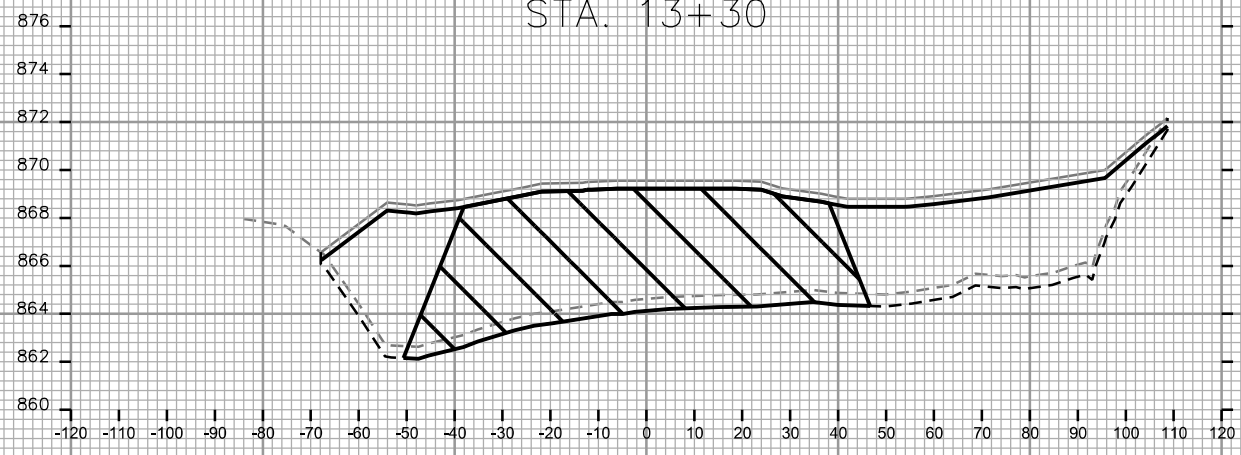

STA. 13+20

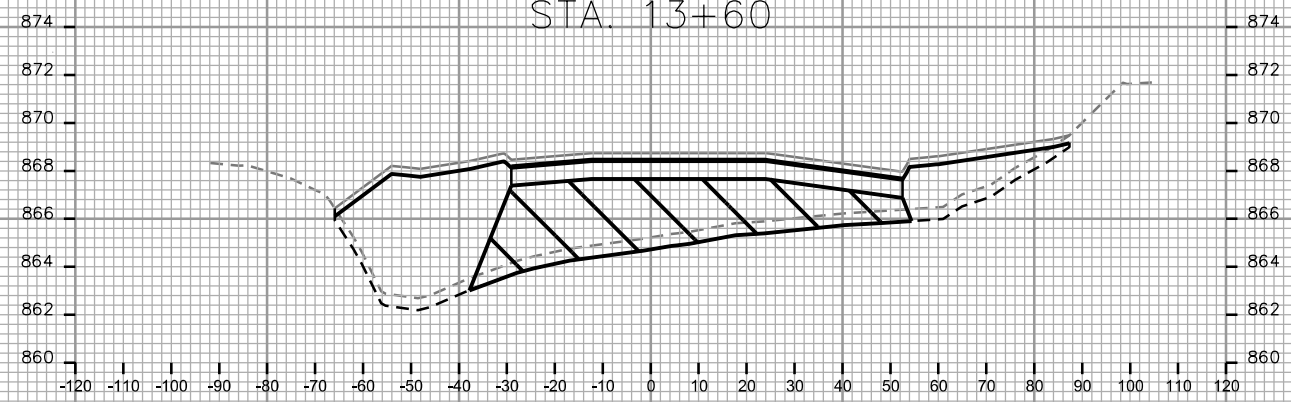

STA. 13+50

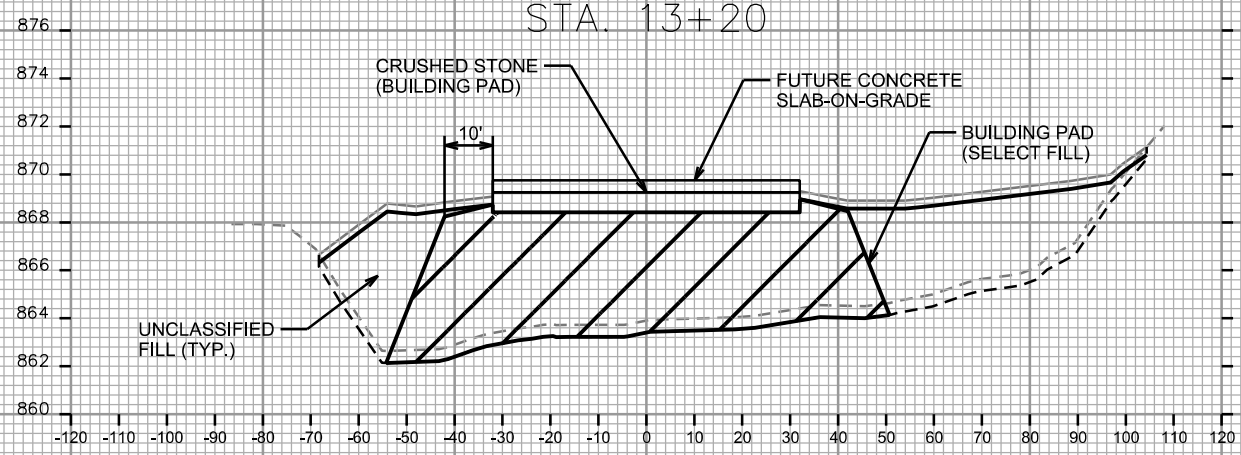

STA. 13+10

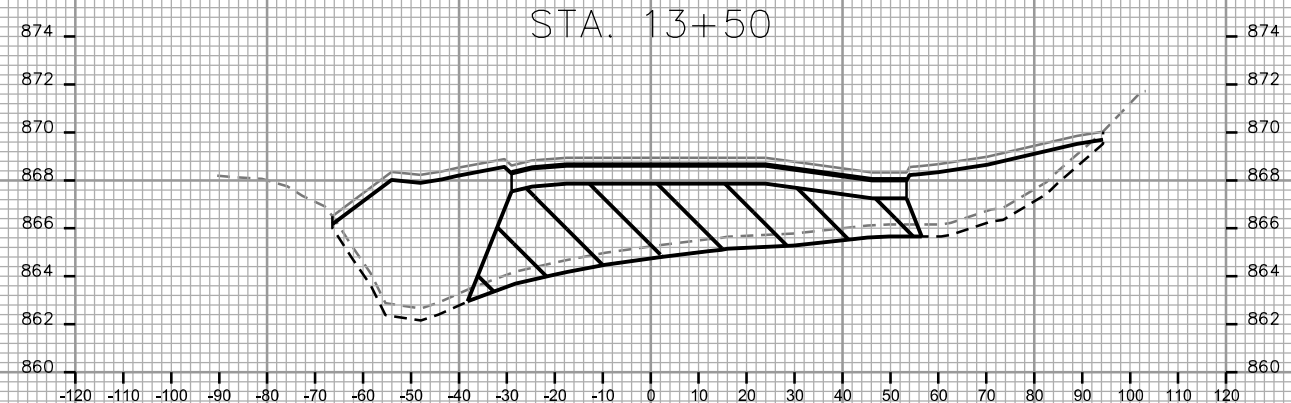

STA. 13+40

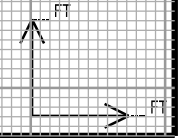

PLOT SCALE: _____

PLOT NAME: _____

REV. DATE: _____

ORIGINATOR: CITY OF MADISON - STREETS DIVISION

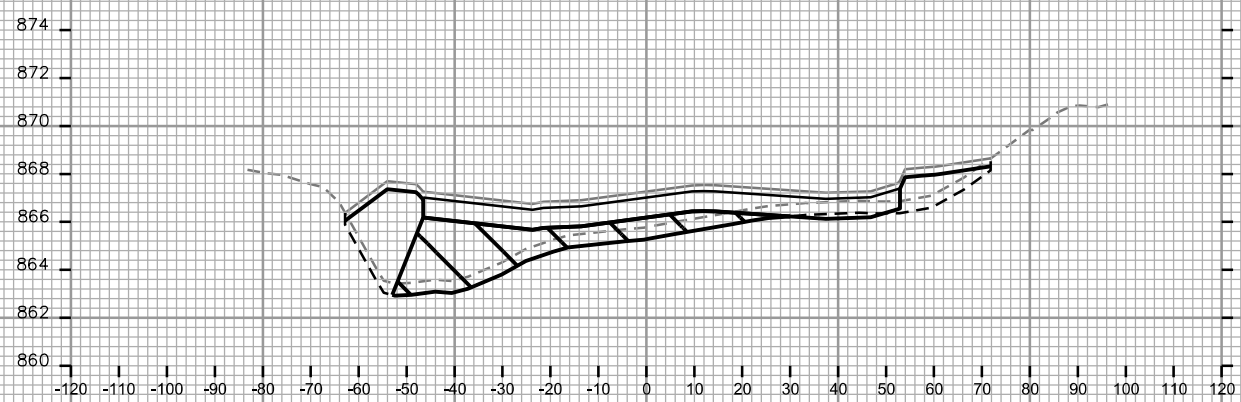

STA. 14+00

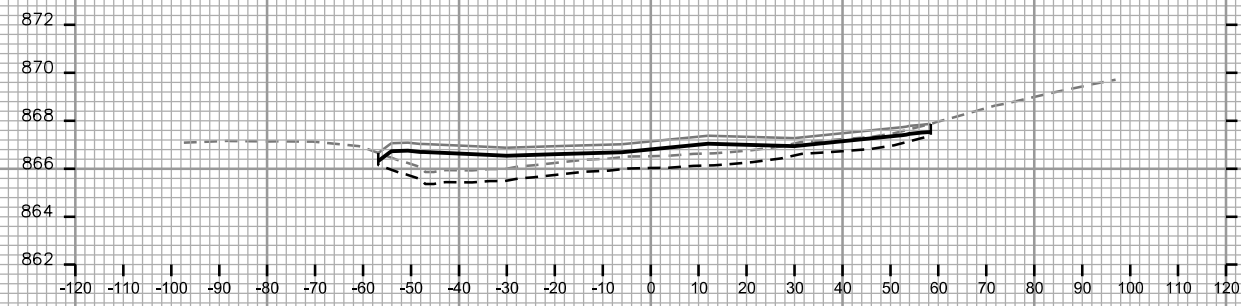

STA. 14+40

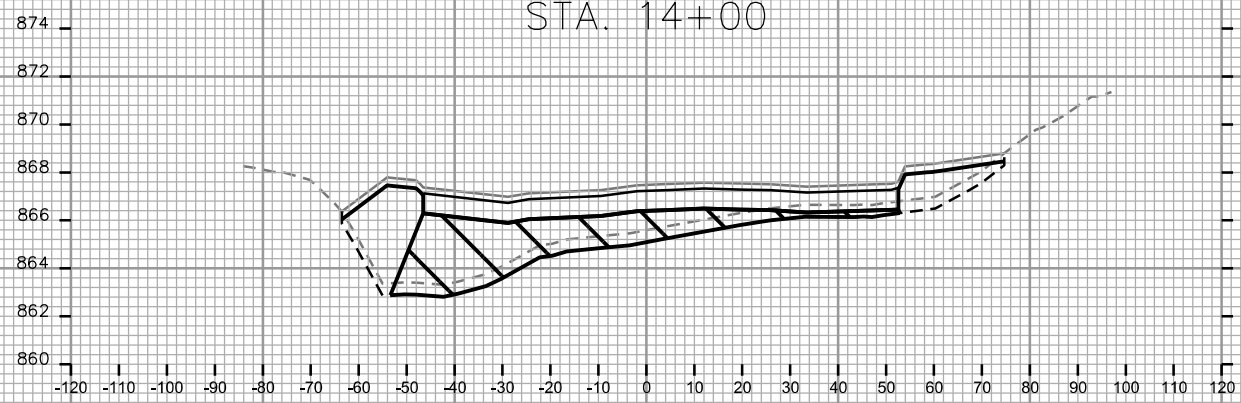

STA. 13+90

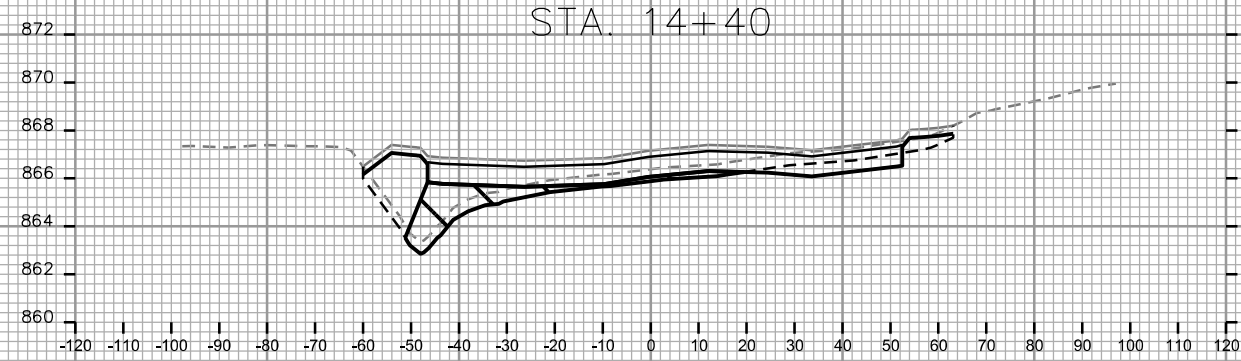

STA. 14+30

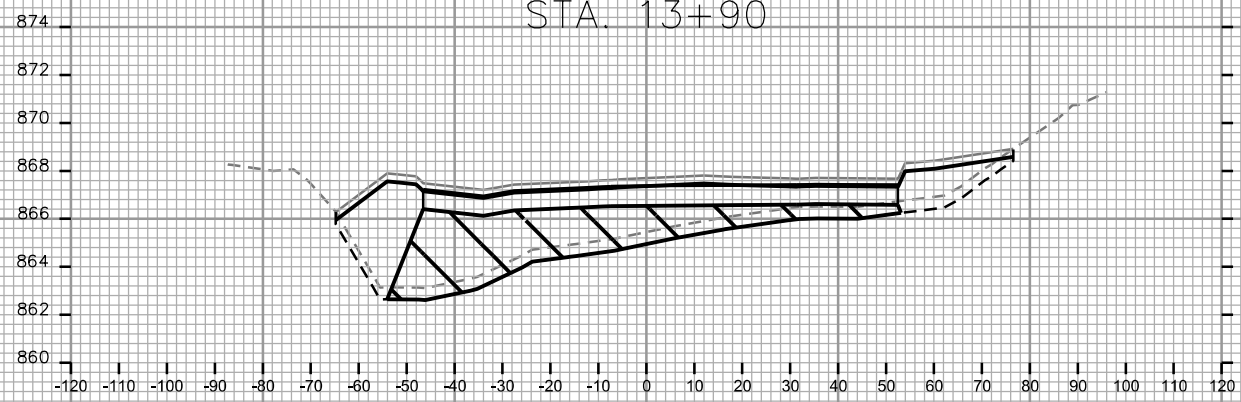

STA. 13+80

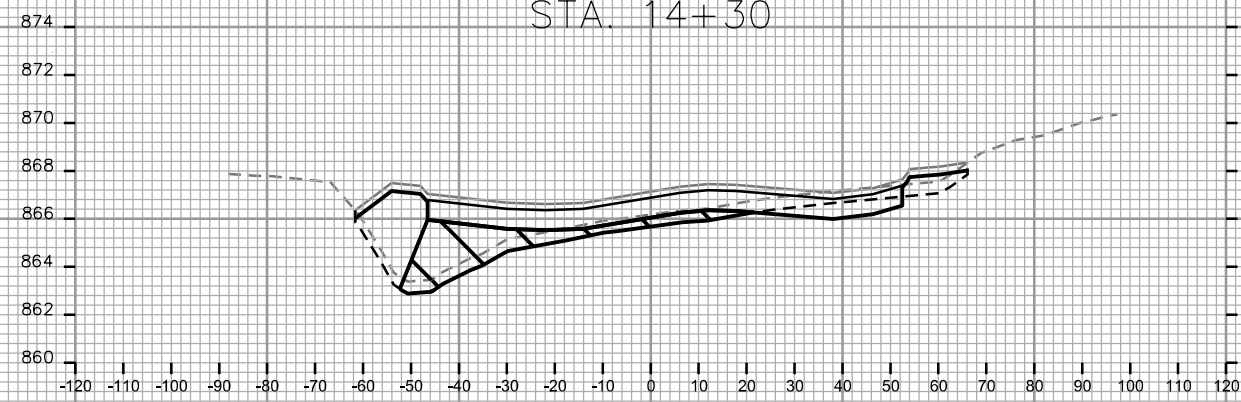

STA. 14+20

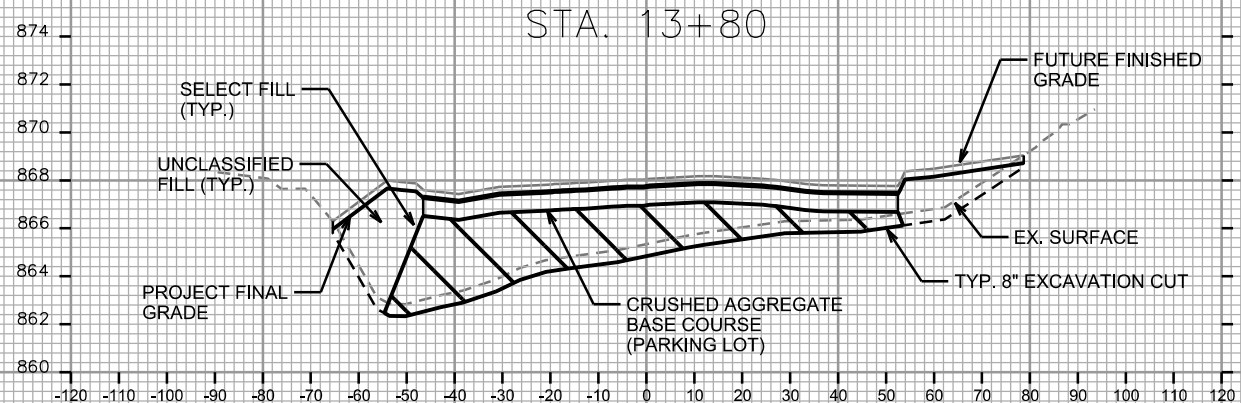

STA. 13+70

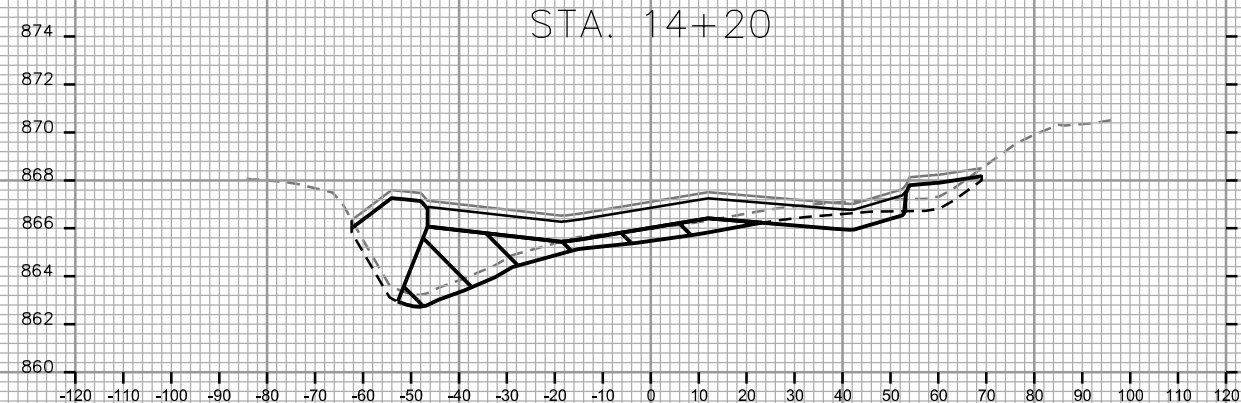

STA. 14+10

- SELECT FILL (TYP.)
- UNCLASSIFIED FILL (TYP.)
- PROJECT FINAL GRADE
- CRUSHED AGGREGATE BASE COURSE (PARKING LOT)
- FUTURE FINISHED GRADE
- EX. SURFACE
- TYP. 8" EXCAVATION CUT

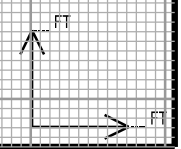

PLOT SCALE: _____
PLOT NAME: _____
REV. DATE: _____
ORIGINATOR: CITY OF MADISON - STREETS DIVISION

PLOT SCALE: _____

PLOT NAME: _____

REV. DATE: _____

ORIGINATOR: CITY OF MADISON - STREETS DIVISION

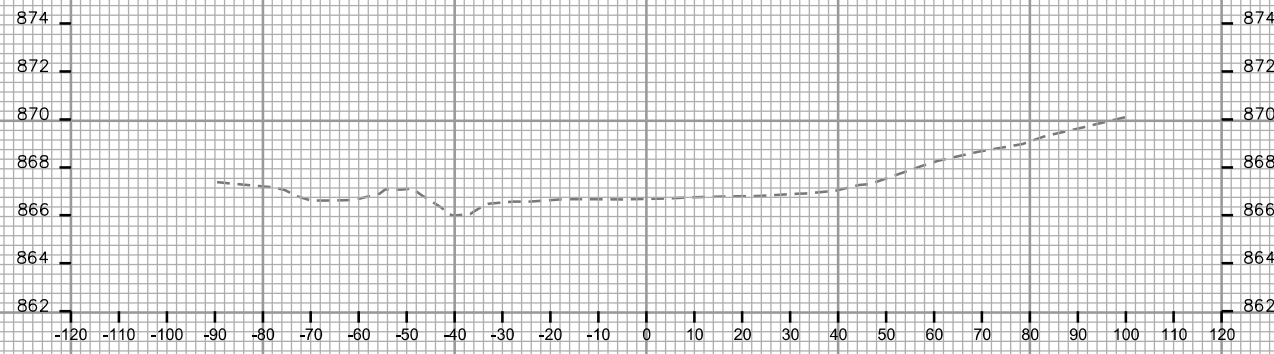

STA. 14+90

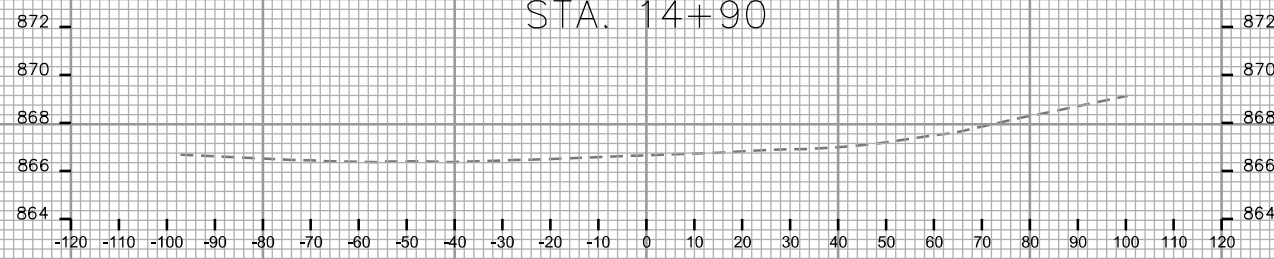

STA. 14+80

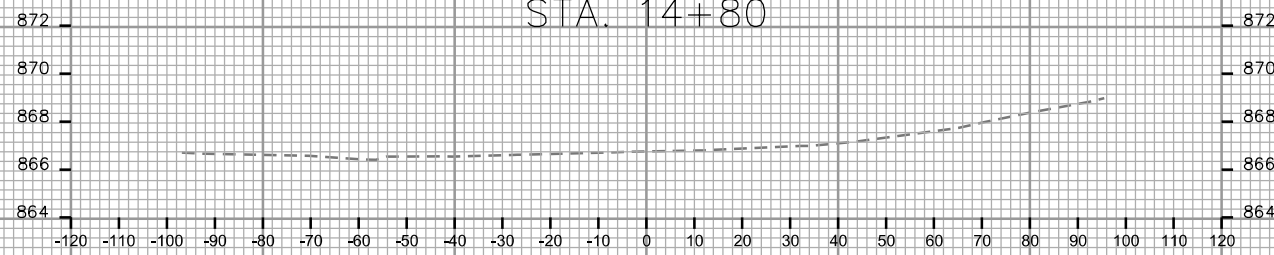

STA. 14+70

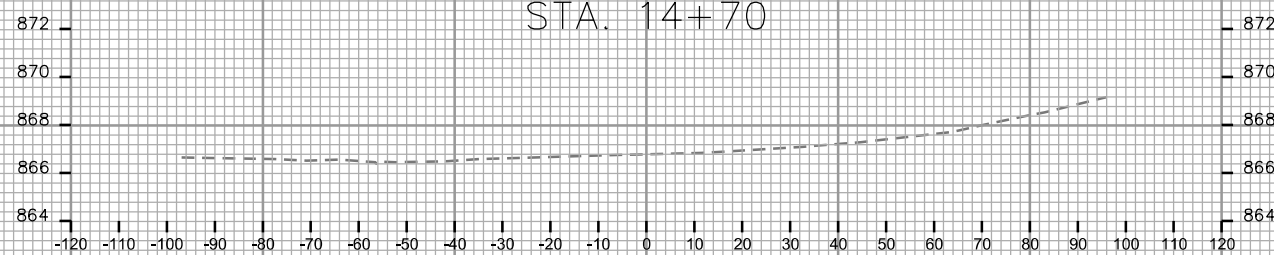

STA. 14+60

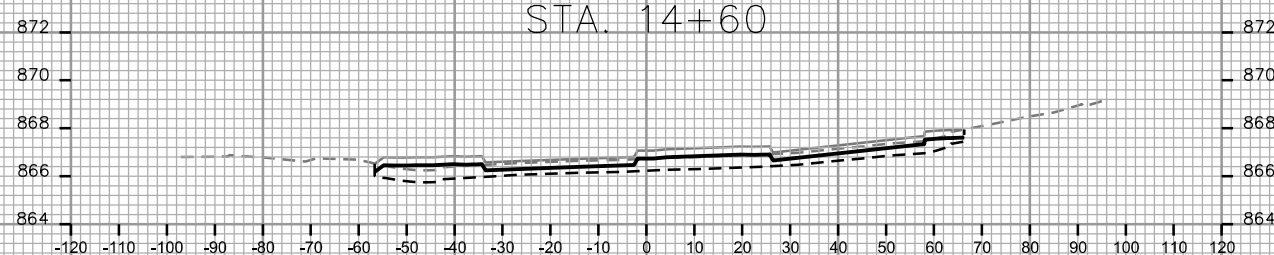

STA. 14+50

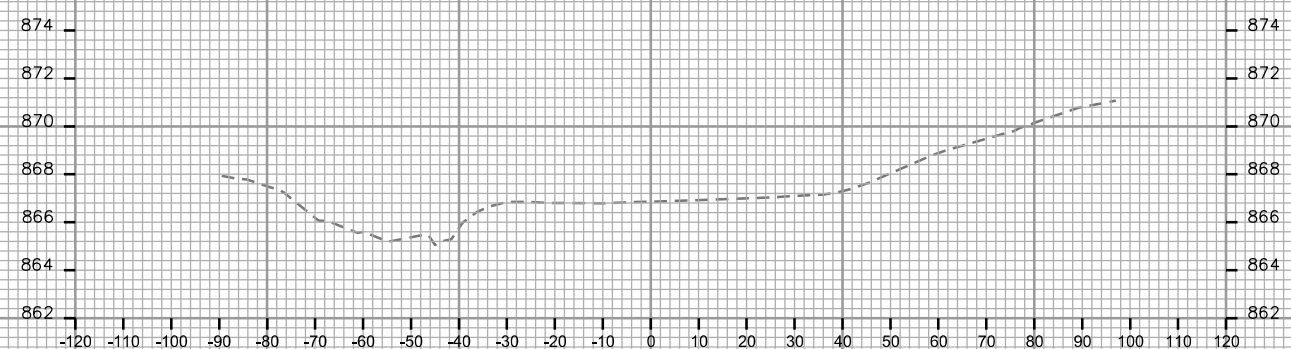

STA. 15+00

