

Madison, Wisconsin

CITY OF MADISON

CITY ENGINEERING DIVISION DEPARTMENT OF PUBLIC WORKS PLAN OF PROPOSED IMPROVEMENT

CONFLUENCE POND REGRADING & GREENWAY REPAIR

PROJECT NO. 10342
CONTRACT NO. 7539

INDEX OF SHEETS

SHEET NO.	PSG1-PSG3	PRAIRIE SCHOONER GRNWX REPAIR P&P
SHEET NO.	PSG4-PSG15	PRAIRIE SCHOONER GRNWX REPAIR X-SECTIONS
SHEET NO.	SHP1	S. HIGH POINT POND REGRADING PLAN

PROJECT APPROVED
JUNE 2, 2015
BY THE COMMON COUNCIL
OF MADISON, WISCONSIN

DESIGN APPROVED BY:

 6/2/15
City Engineer Date

STORM SEWER
APPROVED BY:

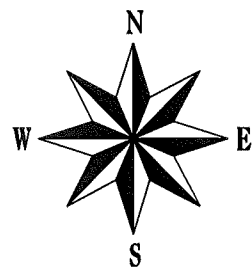
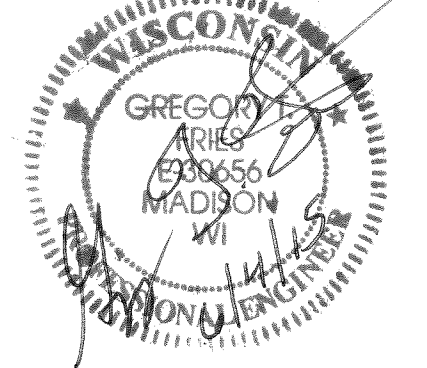

S. HIGH POINT POND REGRADING

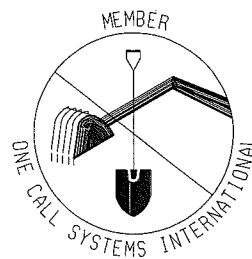

TO OBTAIN LOCATION OF
PARTICIPANTS' UNDERGROUND
FACILITIES BEFORE YOU
DIG IN WISCONSIN

CALL DIGGERS HOTLINE
811

or 1-800-242-8511
TOLL FREE

FAX-A-LOCATE 1-800-338-3860

TDD (FOR HEARING IMPAIRED) 1-800-542-2289

WIS. STATUTE 182.0175 (1974)
REQUIRES MIN. OF 3 WORK DAY
NOTICE BEFORE YOU EXCAVATE

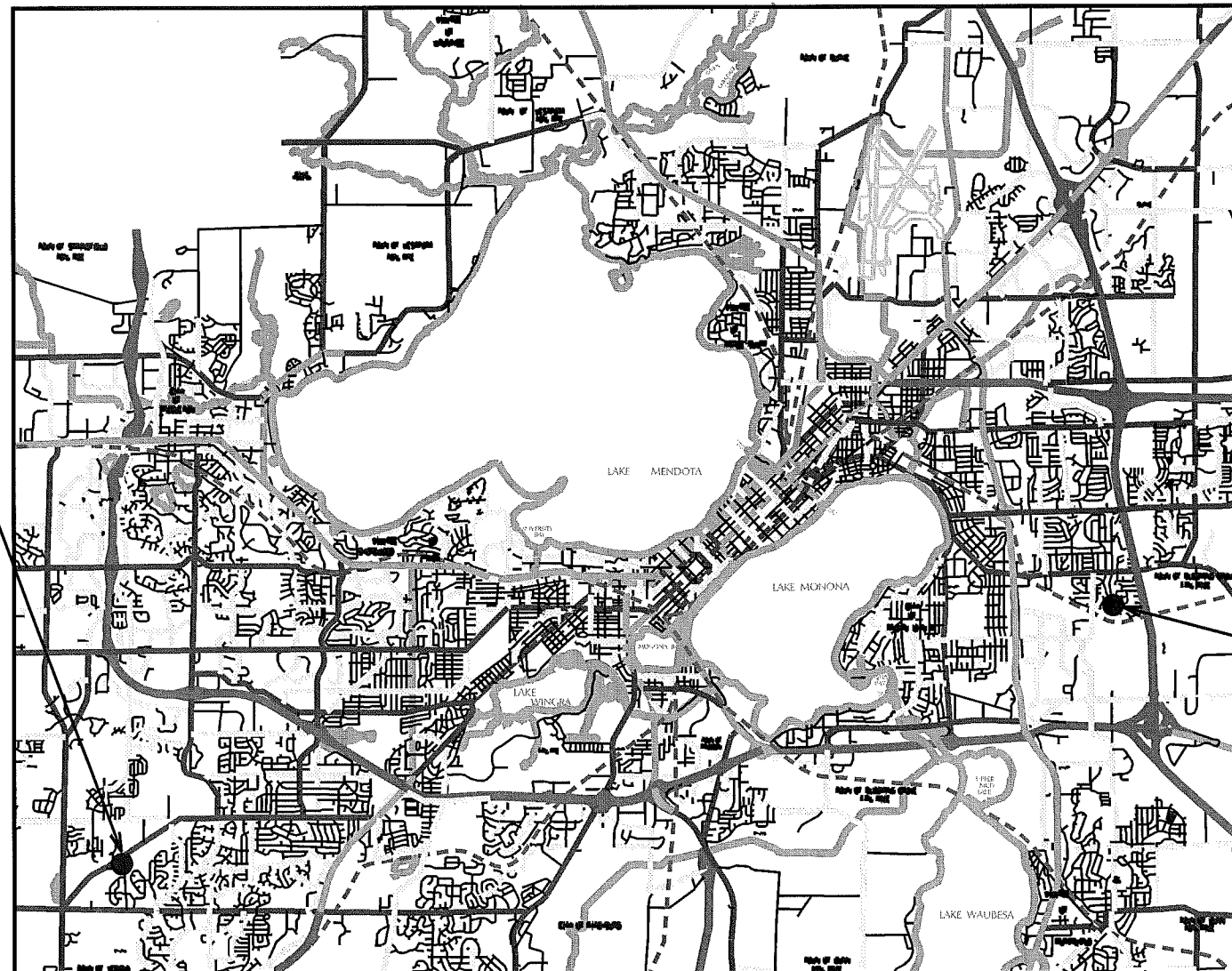

PRAIRIE SCHOONER GREENWAY REPAIR:

NOTE:
EXISTING UTILITIES SHOWN IN PLANS ARE INDICATED
IN ACCORDANCE WITH AVAILABLE RECORDS. OTHER UTILITIES MAY
ALSO BE PRESENT. THE CONTRACTOR SHALL BE RESPONSIBLE FOR
OBTAINING EXACT LOCATIONS AND ELEVATIONS OF ALL UTILITIES,
INCLUDING SEWER AND WATER FROM THE OWNERS OF THE
RESPECTIVE UTILITIES. ALL UTILITY OWNERS SHALL BE NOTIFIED
BY THE CONTRACTOR 72 HOURS PRIOR TO EXCAVATION.

PLOT SCALE:

PLOT NAME:

REV. DATE:

ORIGINATOR: CITY OF MADISON, STREETS DIVISION

PLAN AND PROFILE
PRAIRIE SCHOONER GRNWAY CITY OF MADISON

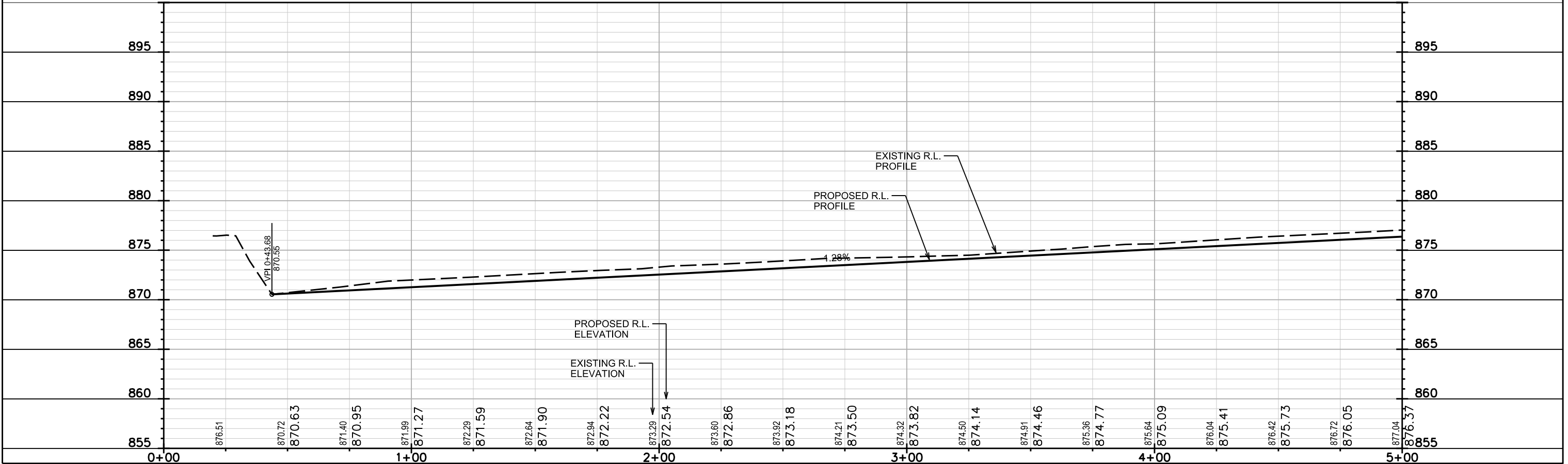
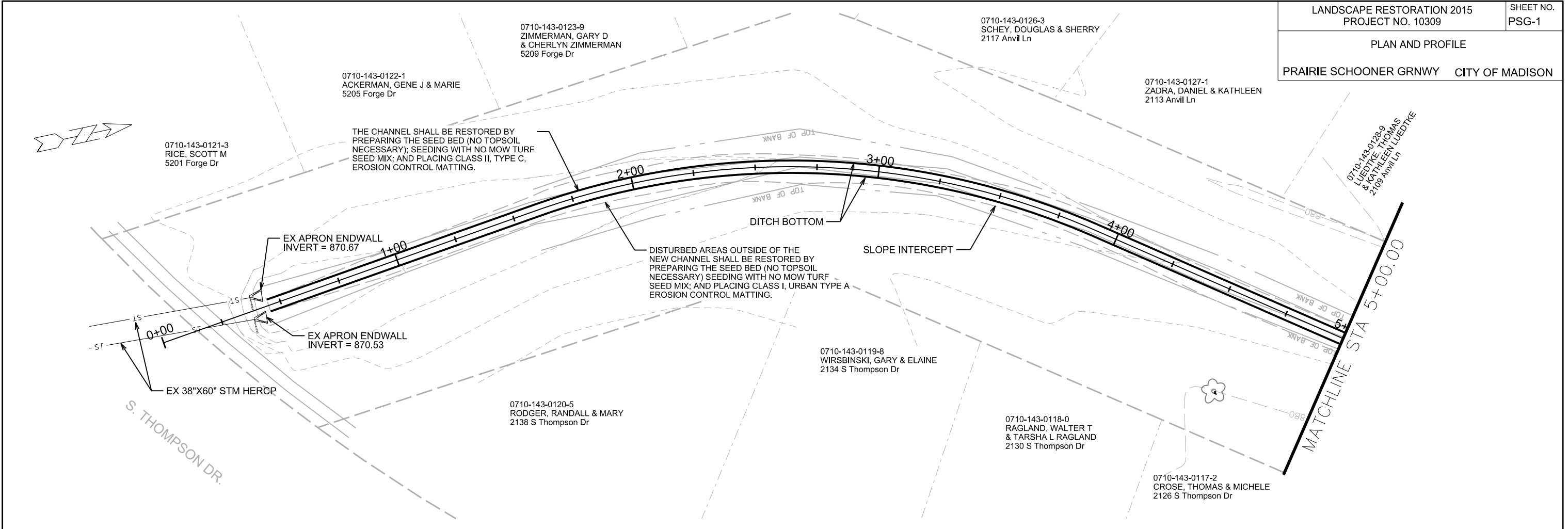

PLOT SCALE: _____
 PLOT NAME: _____
 REV. DATE: _____
 ORIGINATOR: CITY OF MADISON, STREETS DIVISION

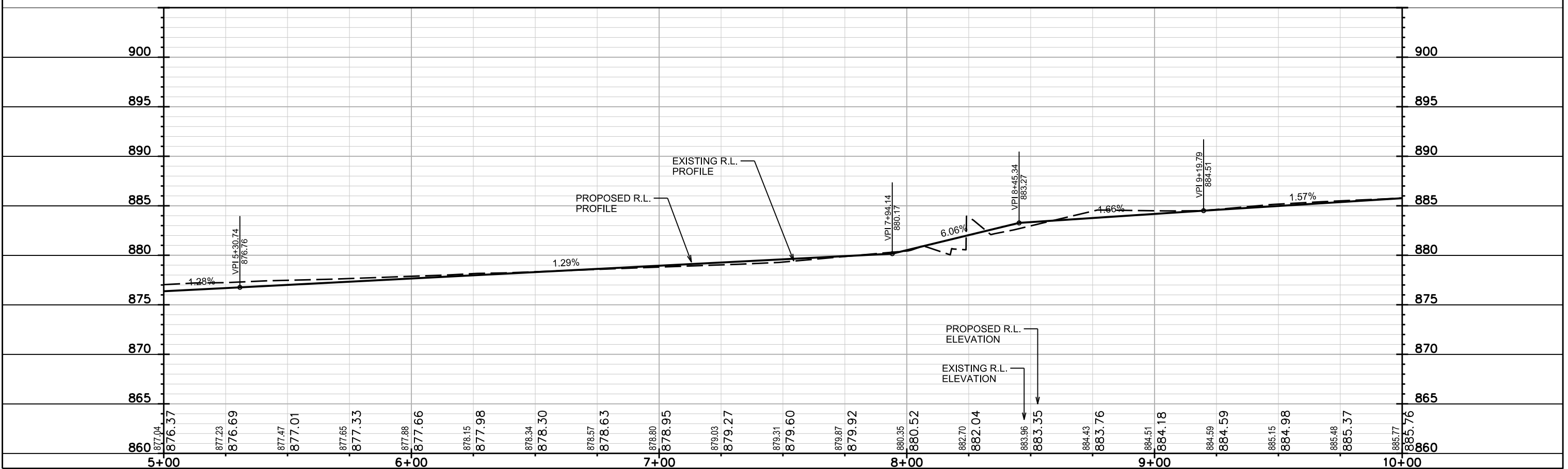
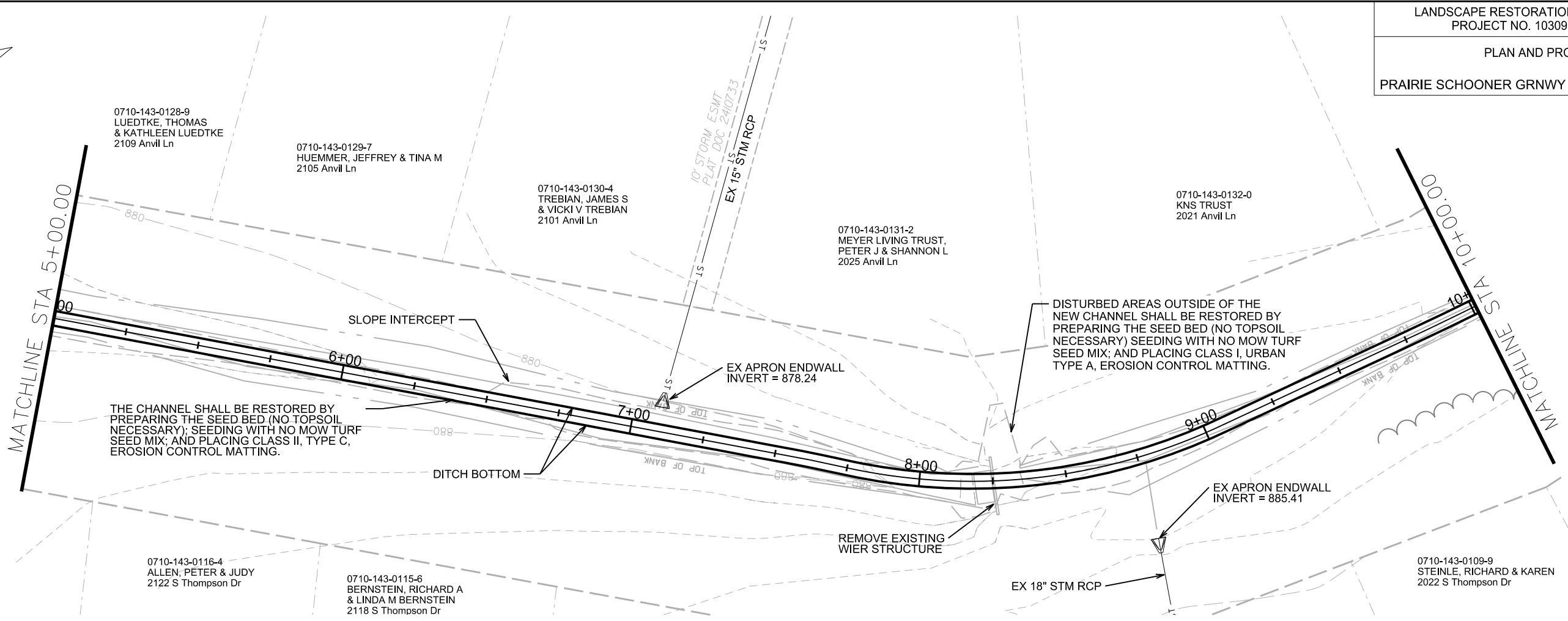
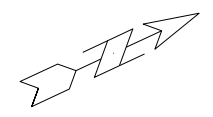

PLOT SCALE:
PLOT NAME:
REV. DATE:
ORIGINATOR: CITY OF MADISON, STREETS DIVISION

PLAN AND PROFILE
PRAIRIE SCHOONER GRNWAY CITY OF MADISON

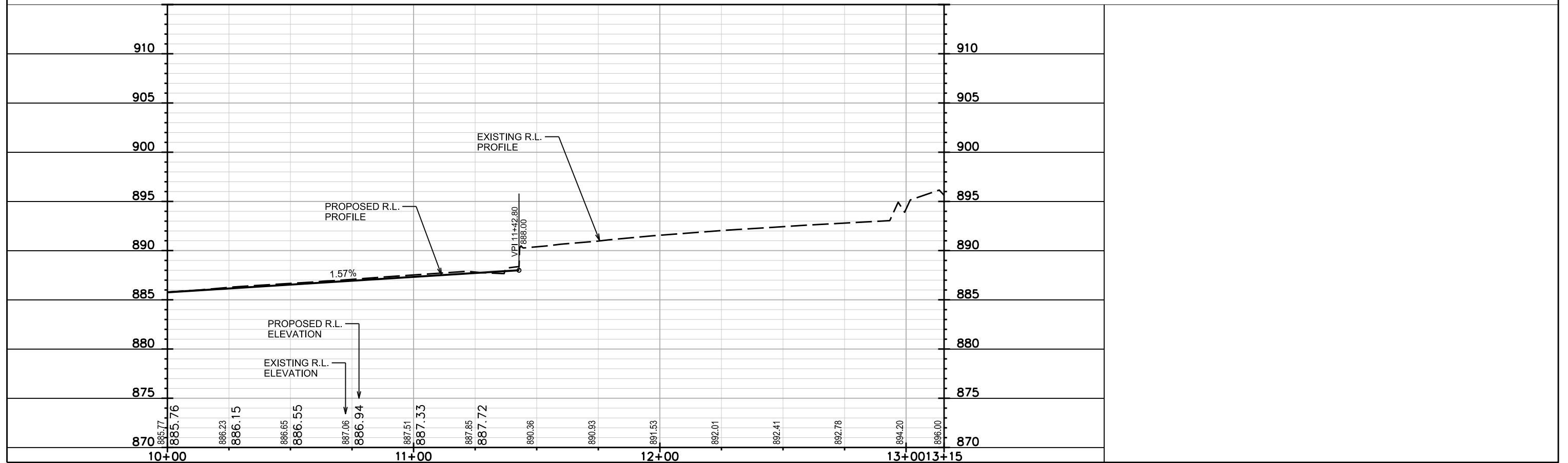
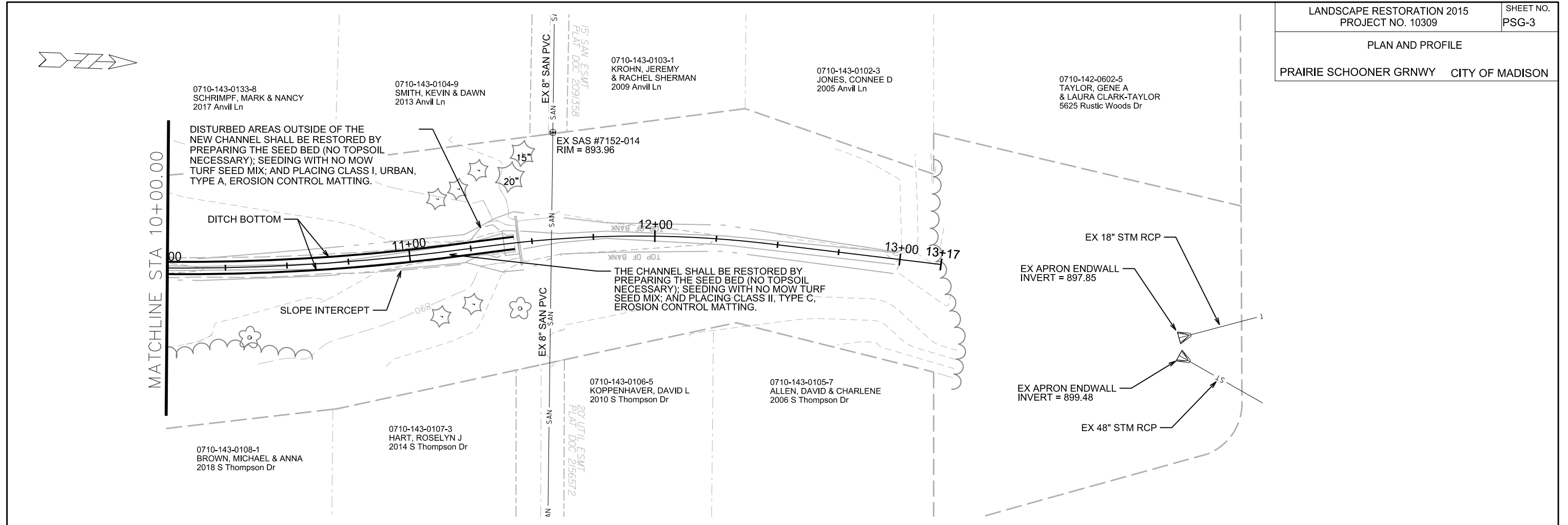

PLOT SCALE:

PLOT NAME:

REV. DATE:

ORIGINATOR: CITY OF MADISON, STREETS DIVISION

CROSS SECTIONS

PRAIRIE SCHOONER GRNWAY CITY OF MADISON

PLOT SCALE:

PLOT NAME:

REV. DATE:

ORIGINATOR: CITY OF MADISON, STREETS DIVISION

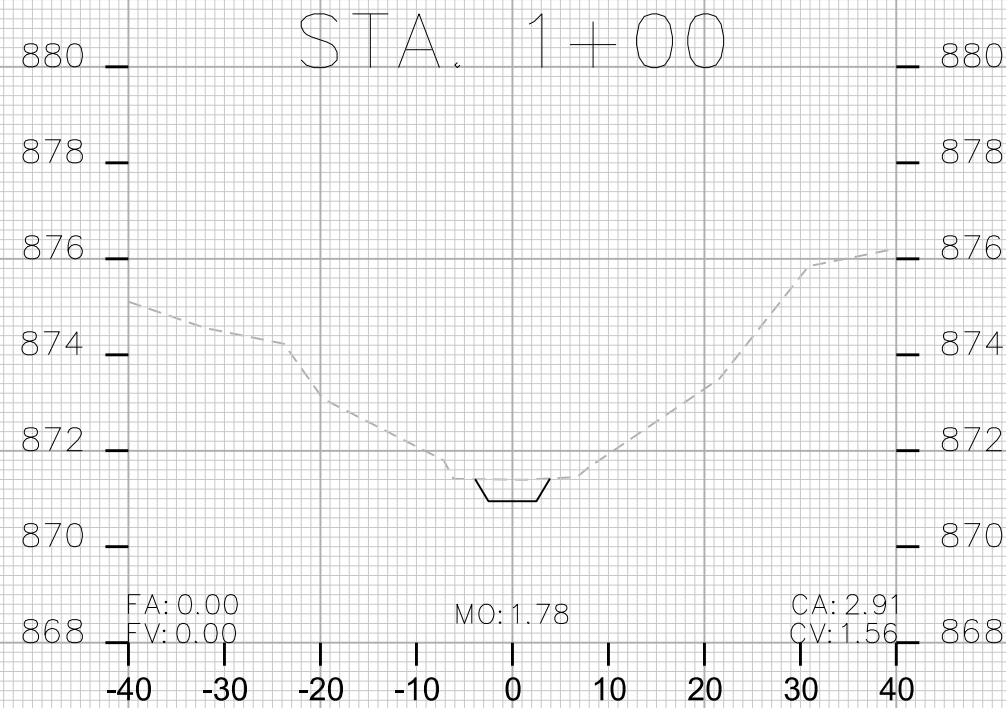
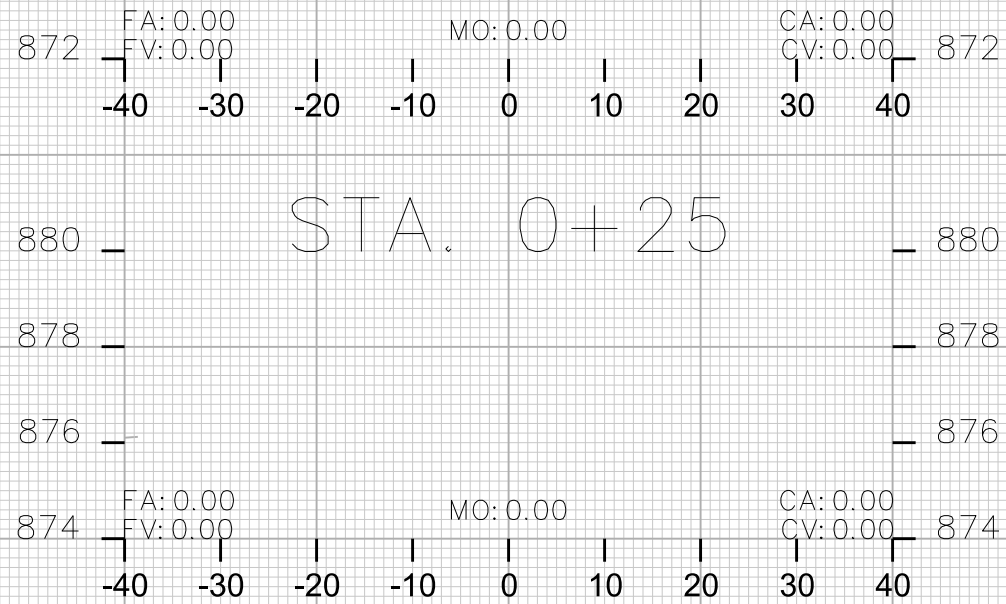
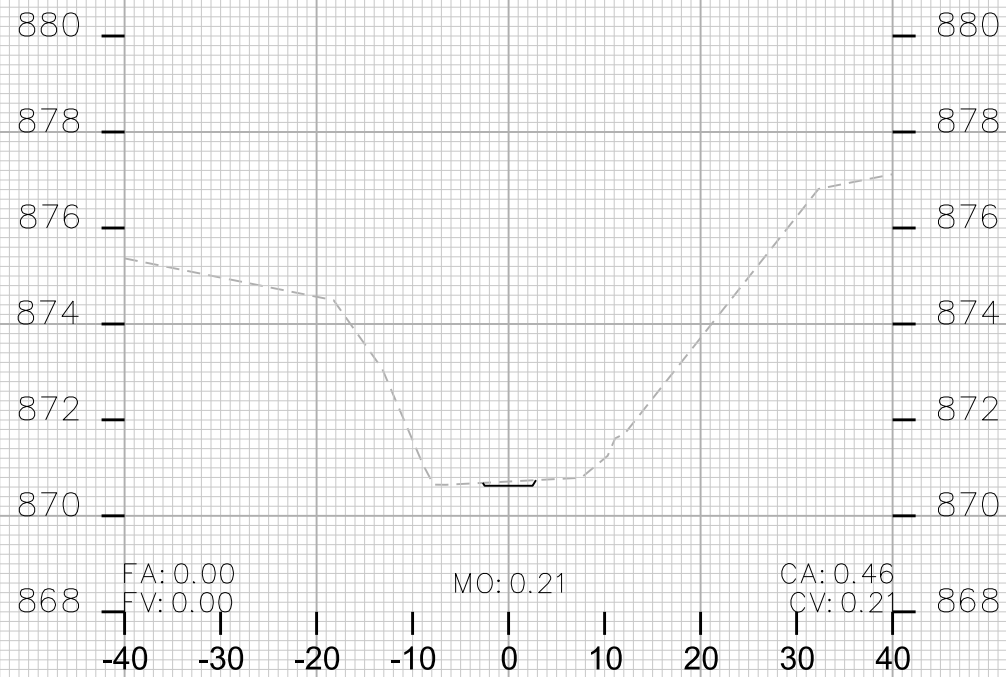

STA. 0+00

STA. 0+75

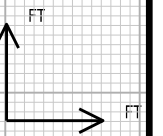

CROSS SECTIONS

PRAIRIE SCHOONER GRNWAY CITY OF MADISON

PLOT SCALE:

PLOT NAME:

REV. DATE:

ORIGINATOR: CITY OF MADISON, STREETS DIVISION

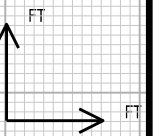
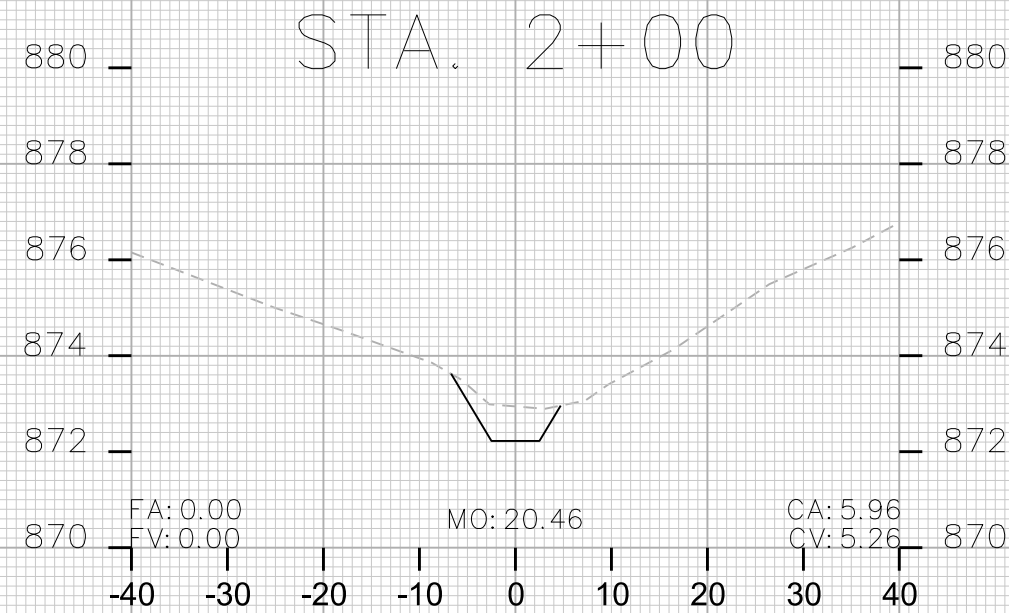
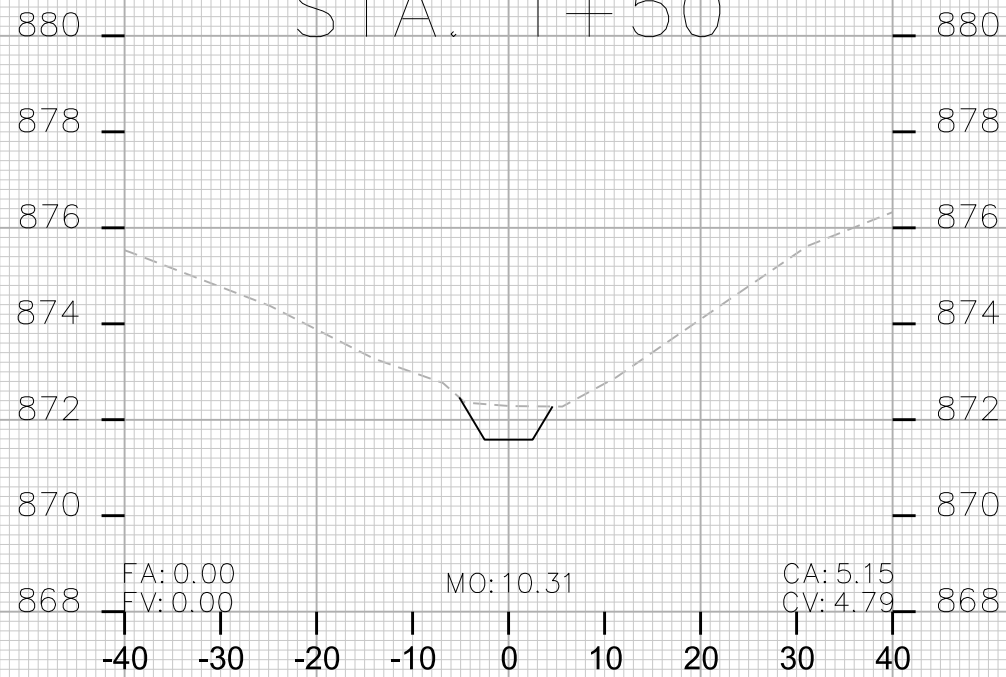
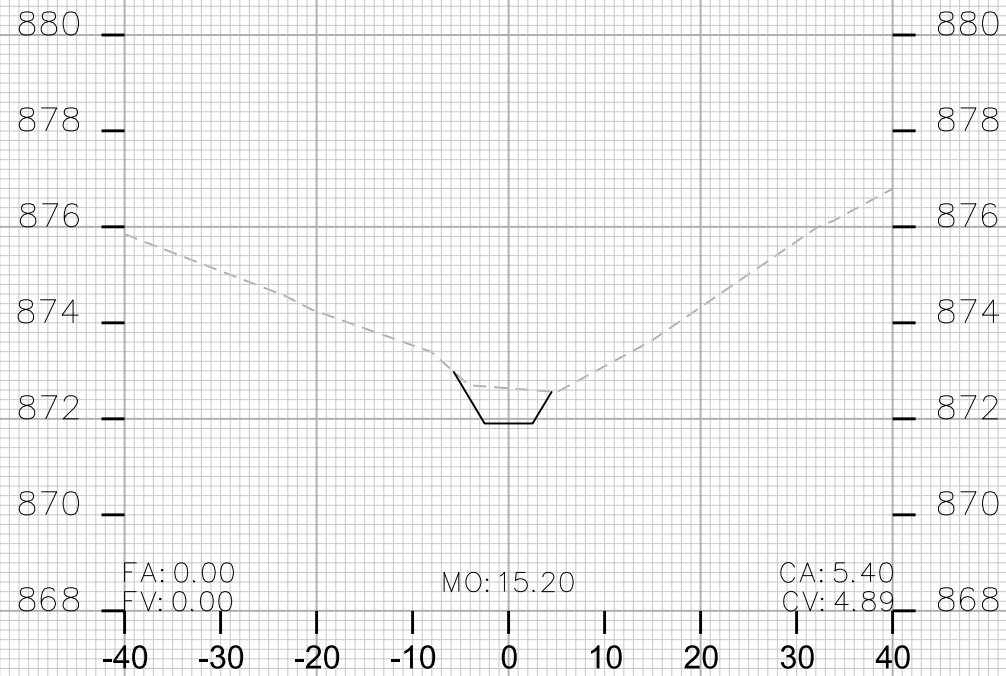

CROSS SECTIONS

PRAIRIE SCHOONER GRNWY CITY OF MADISON

PLOT SCALE:

PLOT NAME:

REV. DATE:

ORIGINATOR: CITY OF MADISON, STREETS DIVISION

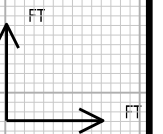
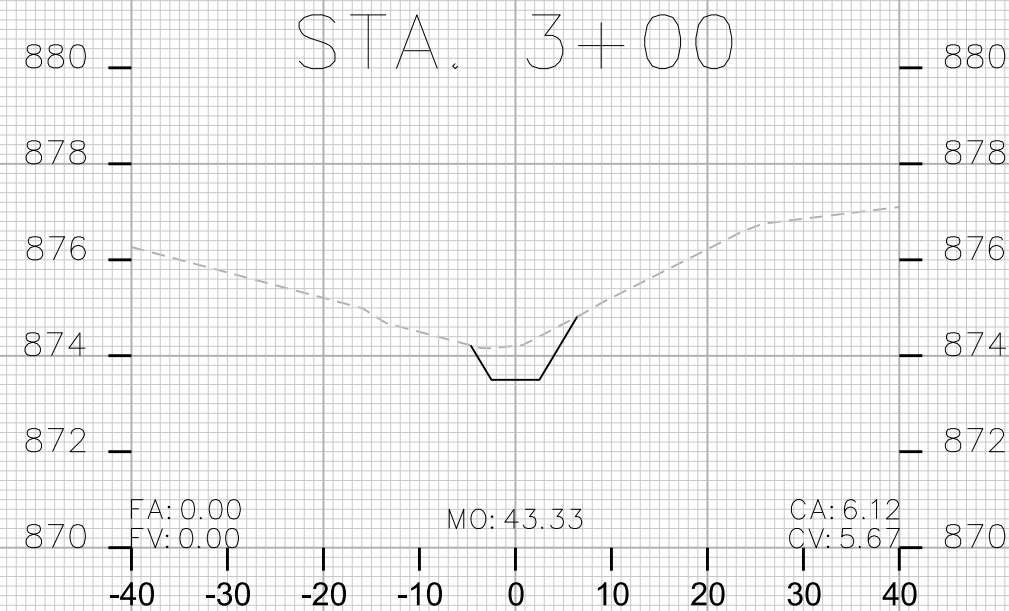
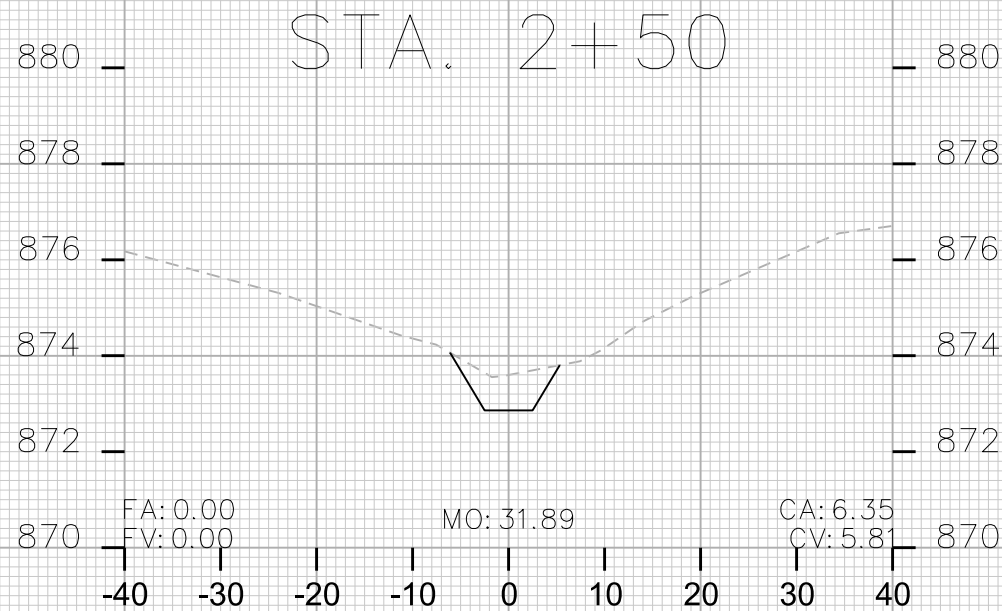
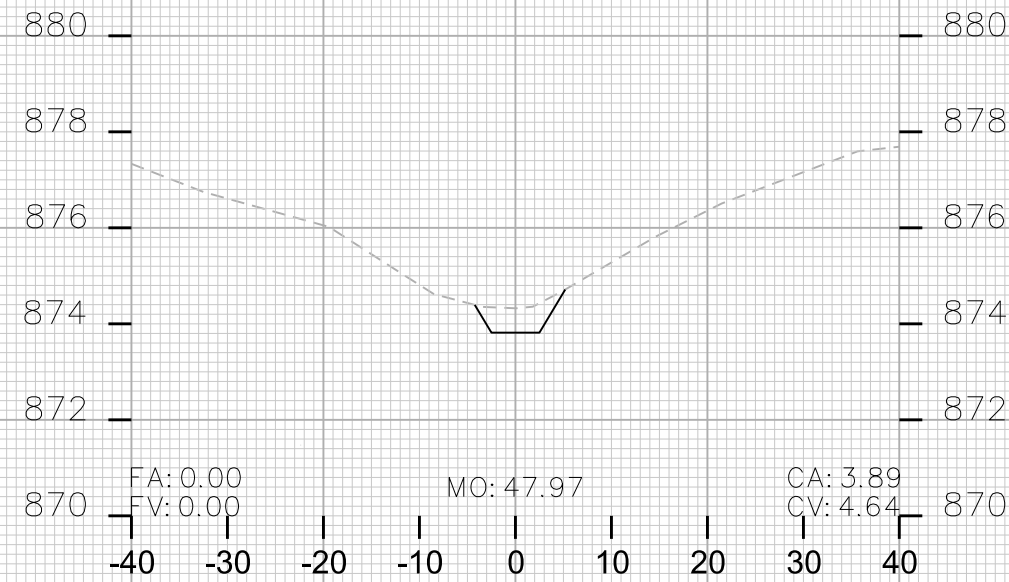

CROSS SECTIONS

PRAIRIE SCHOONER GRNWY CITY OF MADISON

PLOT SCALE:

PLOT NAME:

REV. DATE:

ORIGINATOR: CITY OF MADISON, STREETS DIVISION

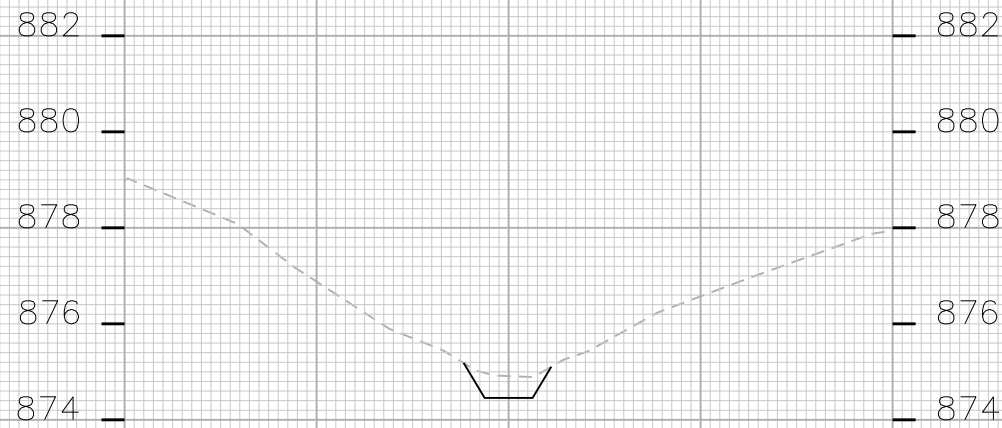

FA: 0.00
FV: 0.00
MO: 53.99
CA: 3.26
CV: 2.87

STA. 3+50

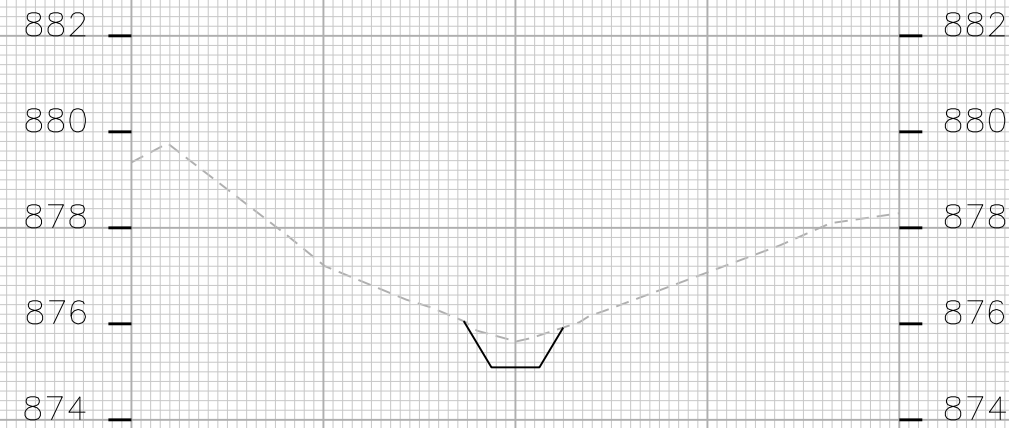

FA: 0.00
FV: 0.00
MO: 62.01
CA: 4.75
CV: 4.35

STA. 4+00

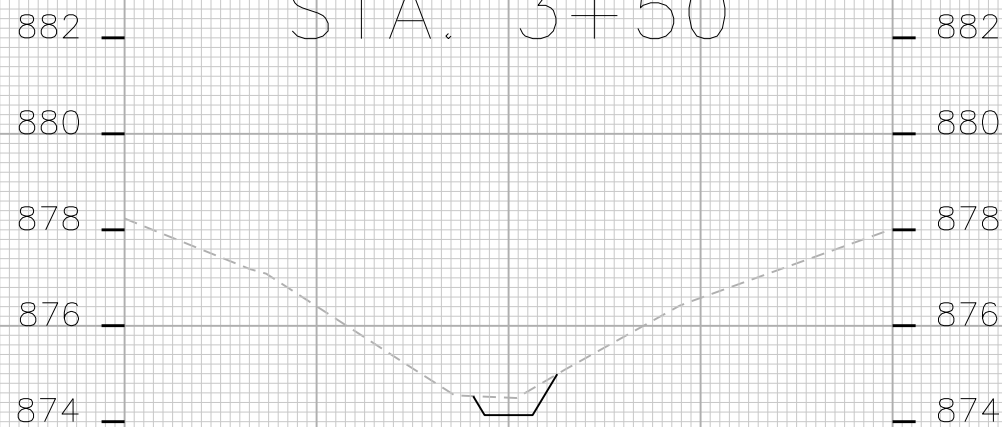

FA: 0.00
FV: 0.00
MO: 51.13
CA: 2.93
CV: 3.16

STA. 3+25

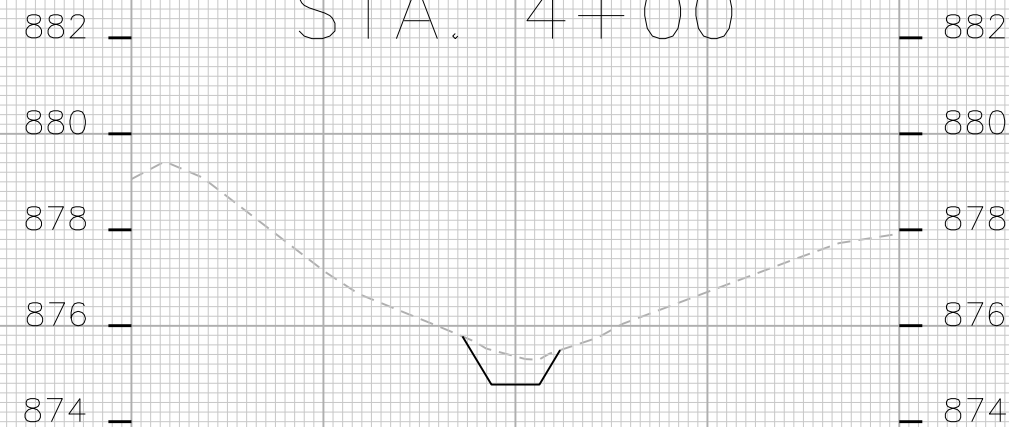

FA: 0.00
FV: 0.00
MO: 57.66
CA: 4.65
CV: 3.66

STA. 3+75

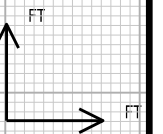

CROSS SECTIONS

PRAIRIE SCHOONER GRNWAY CITY OF MADISON

PLOT SCALE:

PLOT NAME:

REV. DATE:

ORIGINATOR: CITY OF MADISON, STREETS DIVISION



STA. 4+50



STA. 5+00

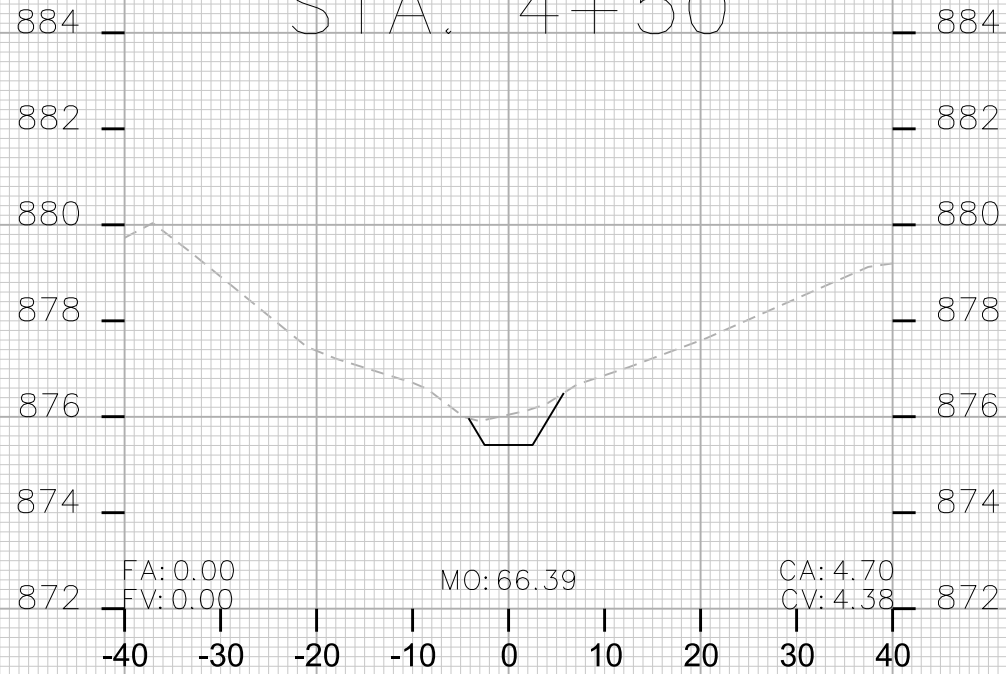

STA. 4+25

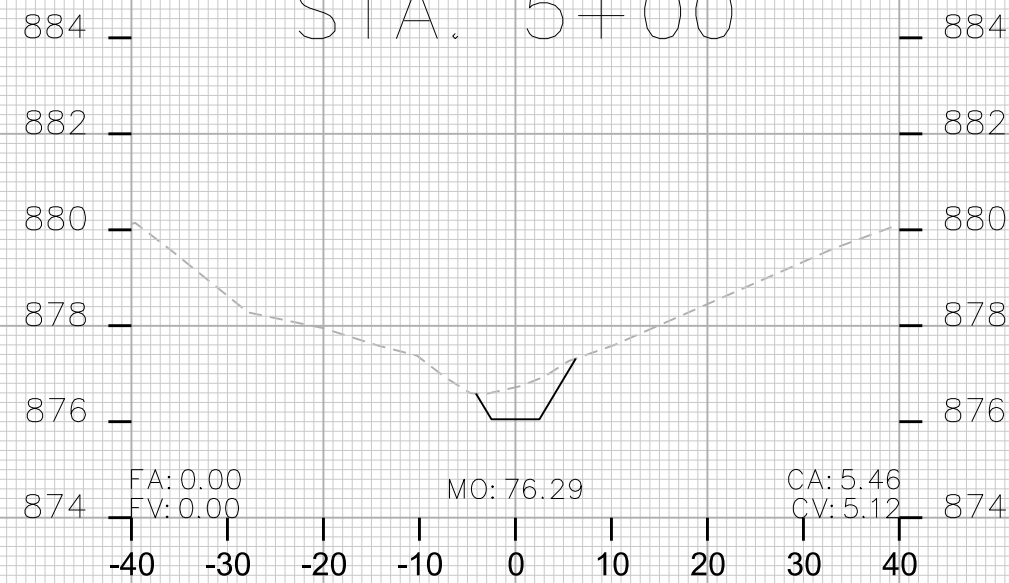

STA. 4+75

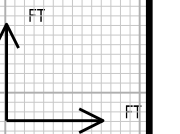

CROSS SECTIONS

PRAIRIE SCHOONER GRNWY CITY OF MADISON

PLOT SCALE:

PLOT NAME:

REV. DATE:

ORIGINATOR: CITY OF MADISON, STREETS DIVISION

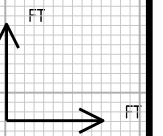
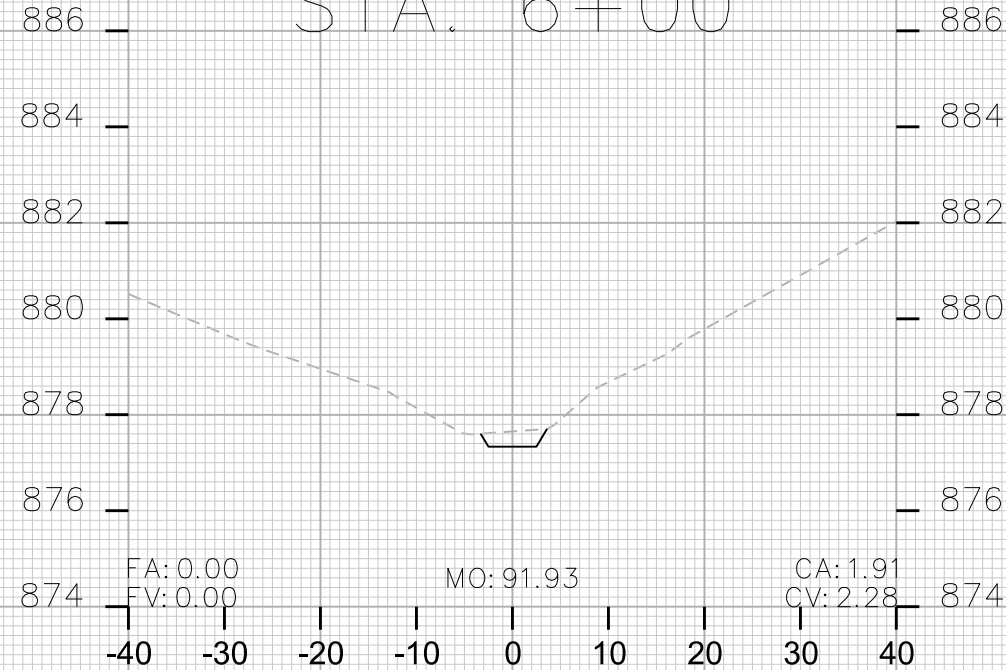
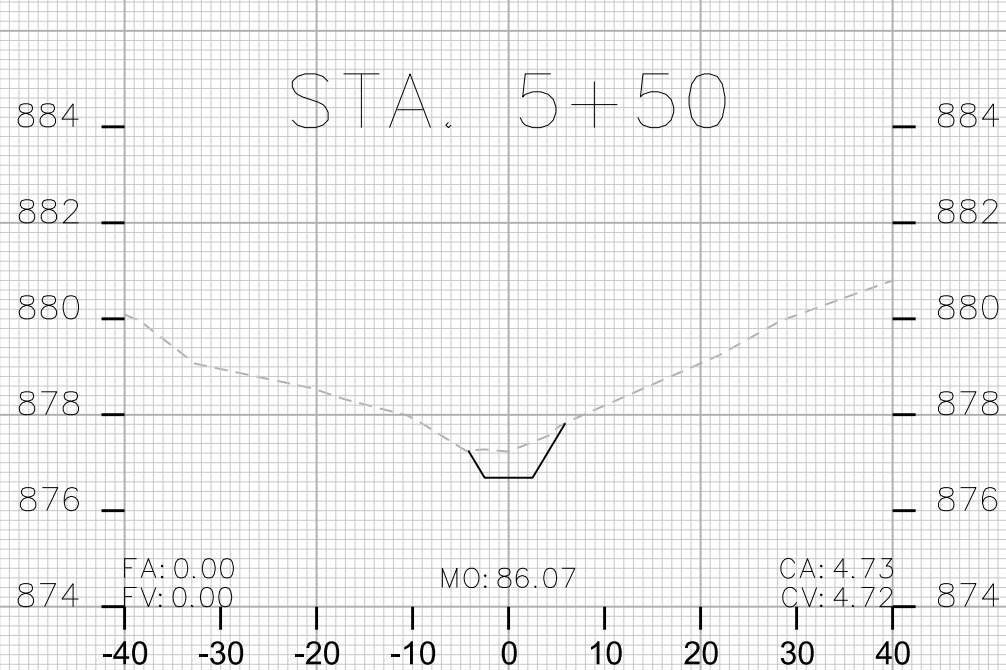
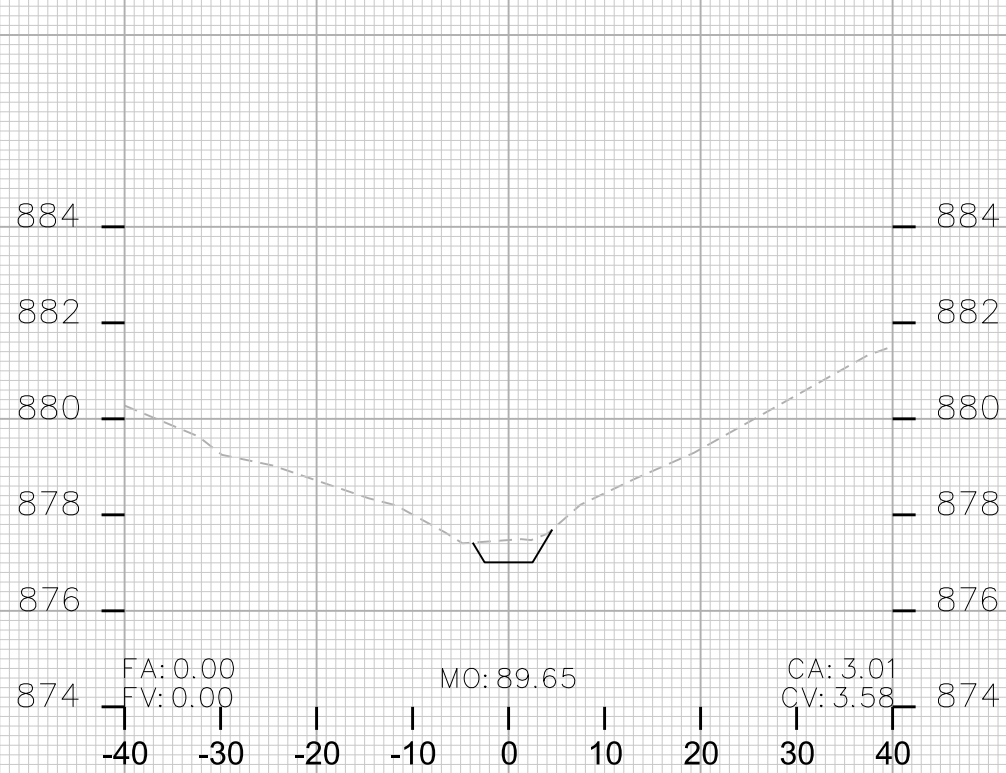

CROSS SECTIONS

PRAIRIE SCNOONER GRNWAY CITY OF MADISON

PLOT SCALE:

PLOT NAME:

REV. DATE:

ORIGINATOR: CITY OF MADISON, STREETS DIVISION

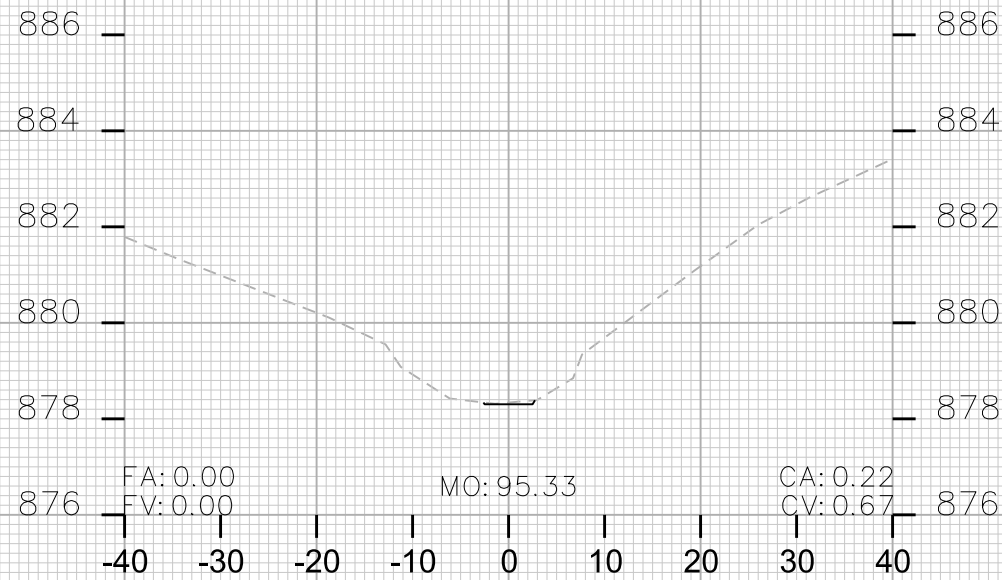

STA. 6+50



STA. 7+00

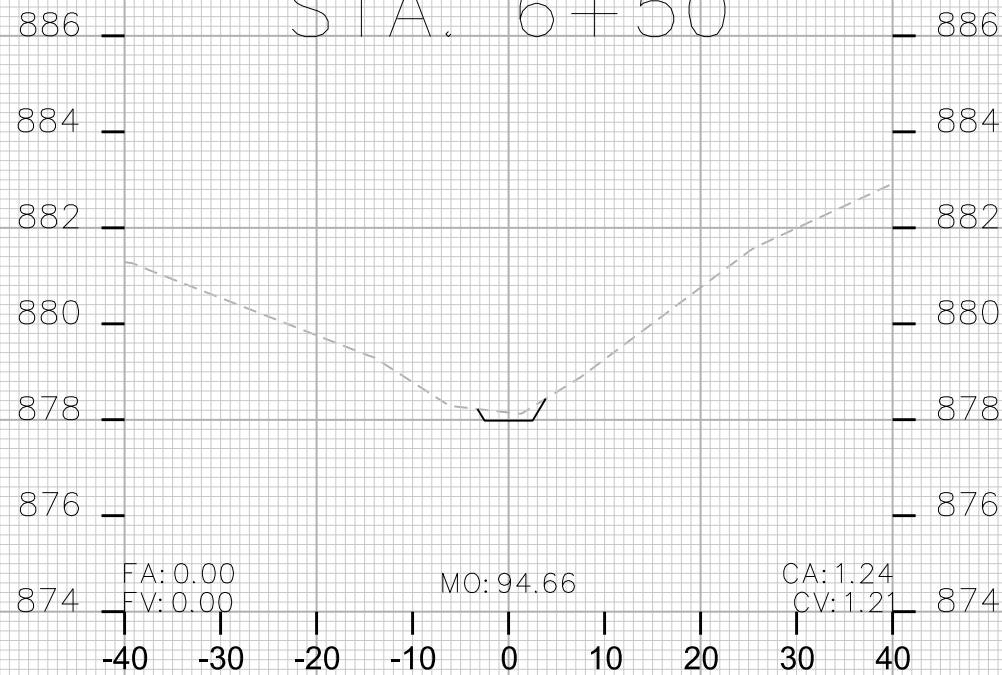

STA. 6+25

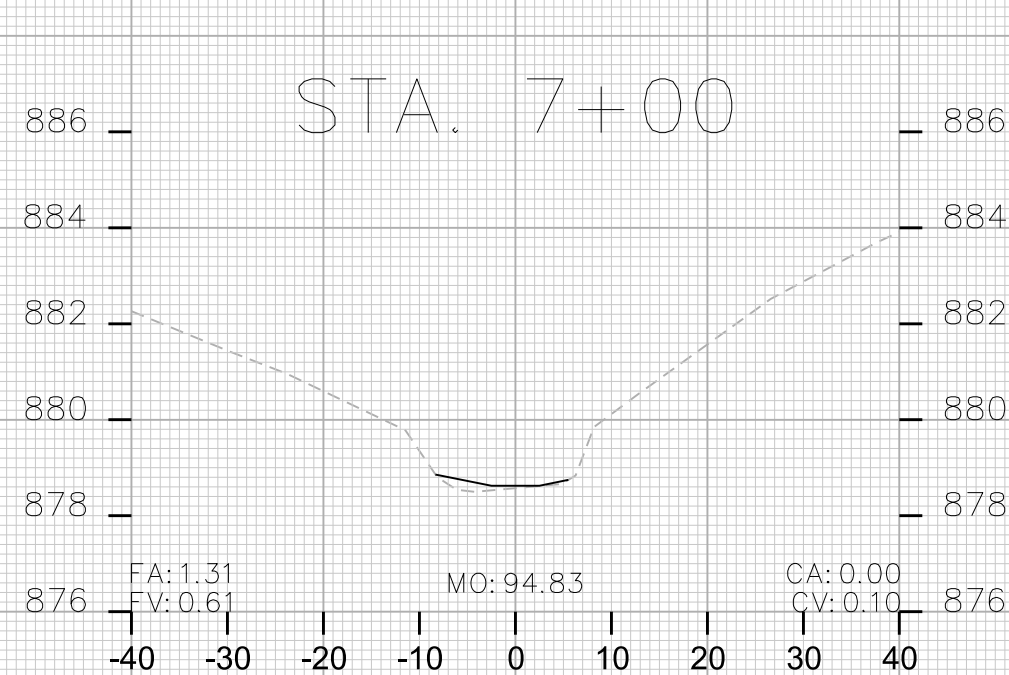

STA. 6+75

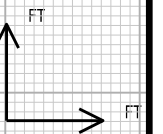

CROSS SECTIONS

PRAIRIE SCHOONER GRNWAY CITY OF MADISON

PLOT SCALE:

PLOT NAME:

REV. DATE:

ORIGINATOR: CITY OF MADISON, STREETS DIVISION

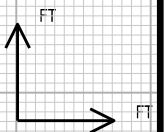
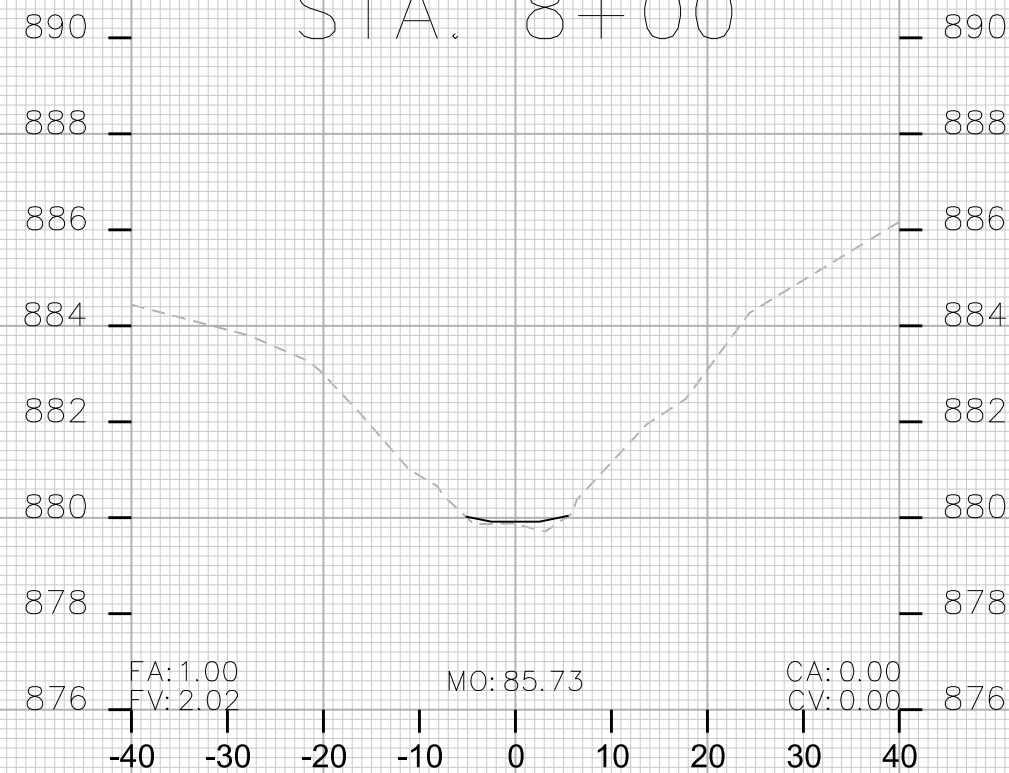
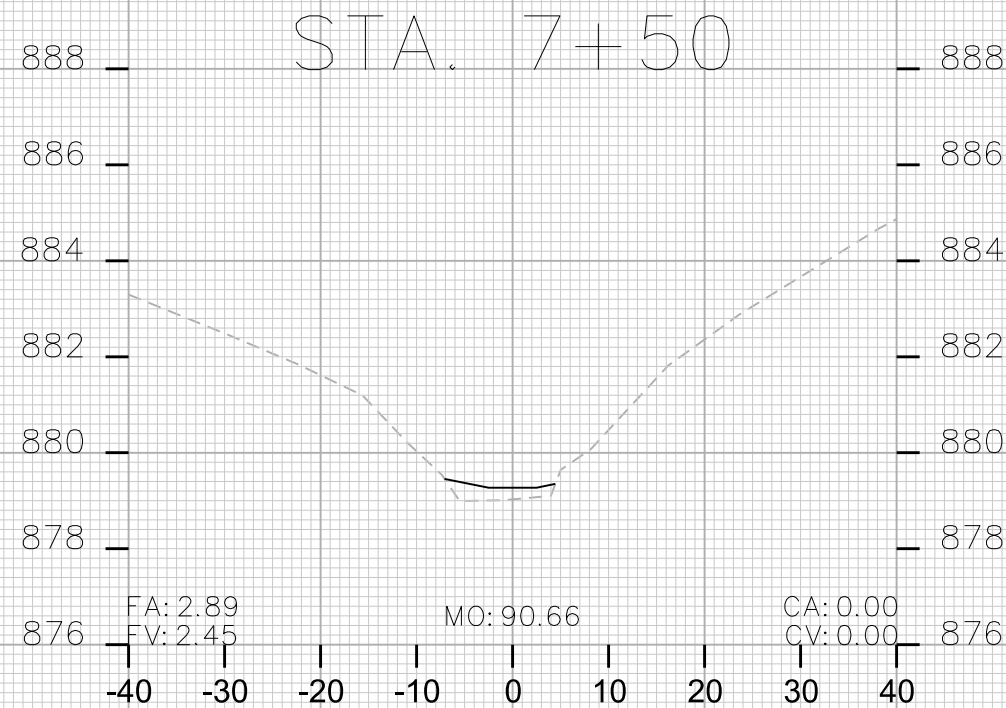
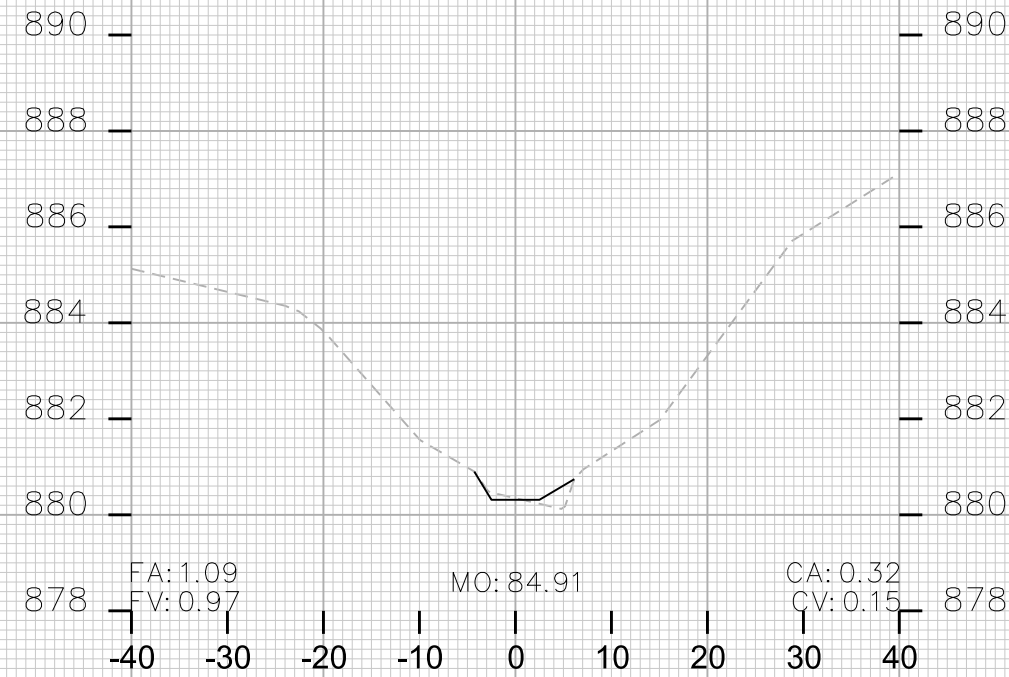
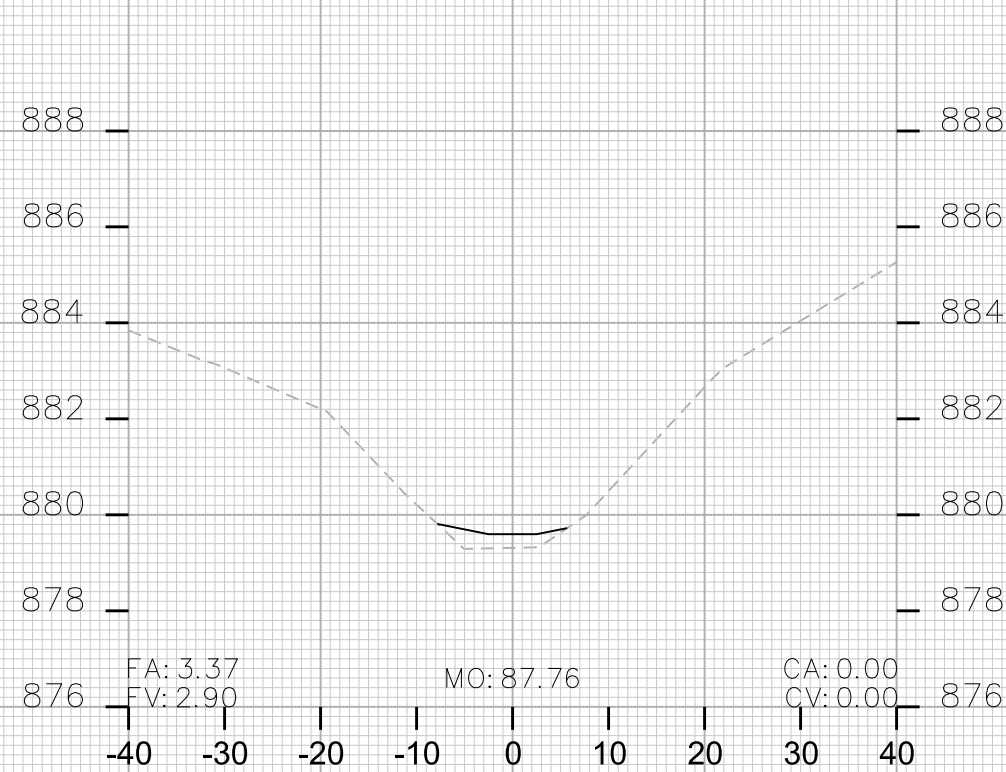

CROSS SECTIONS

PRAIRIE SCHOONER GRNWAY CITY OF MADISON

PLOT SCALE:

PLOT NAME:

REV. DATE:

ORIGINATOR: CITY OF MADISON, STREETS DIVISION

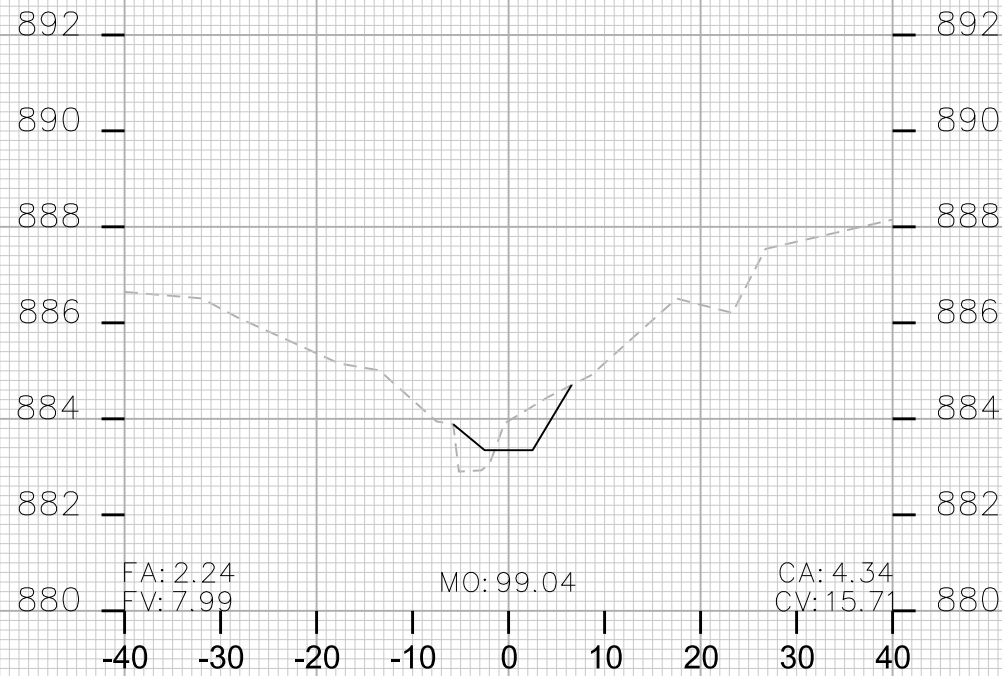

STA. 8+50

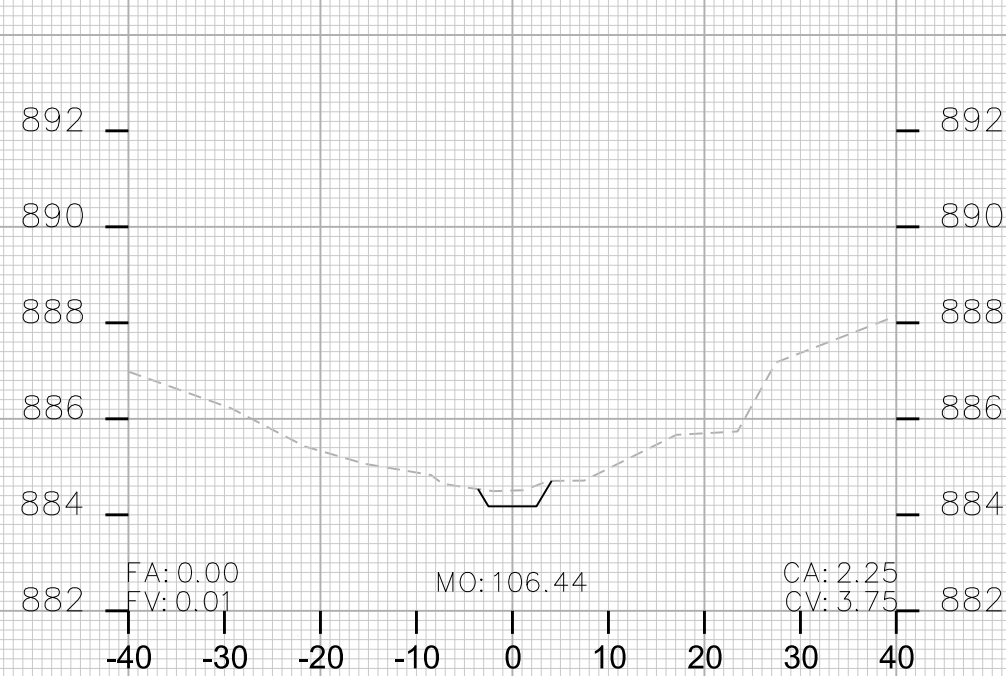

STA. 9+00



STA. 8+25

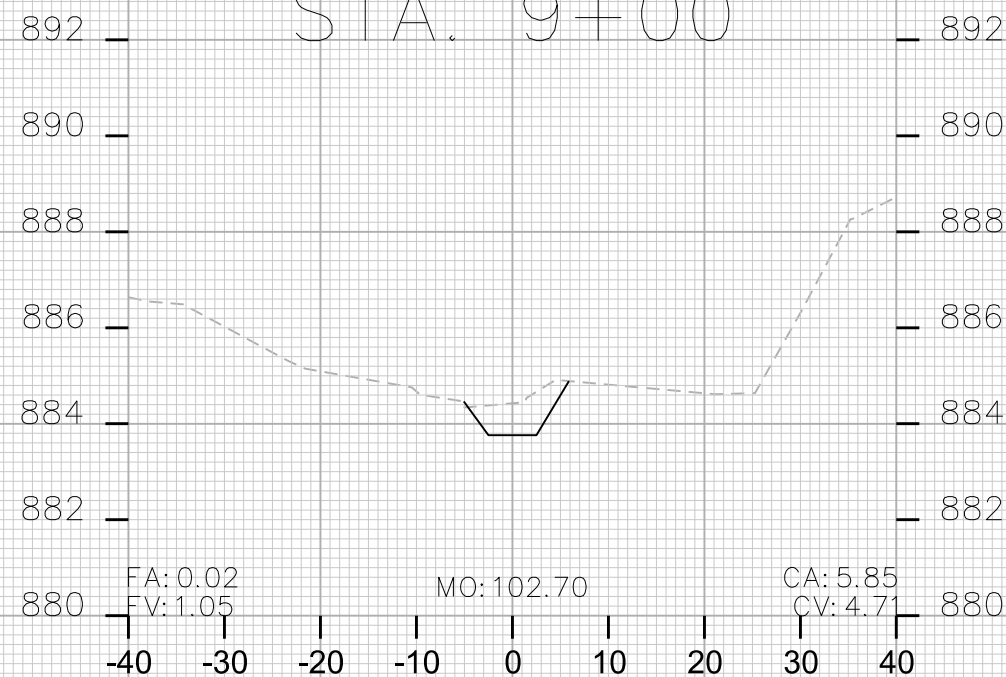

STA. 8+75

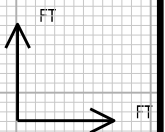

CROSS SECTIONS

PRAIRIE SCHOONER GRNWY CITY OF MADISON

PLOT SCALE:

PLOT NAME:

REV. DATE:

ORIGINATOR: CITY OF MADISON, STREETS DIVISION

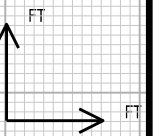
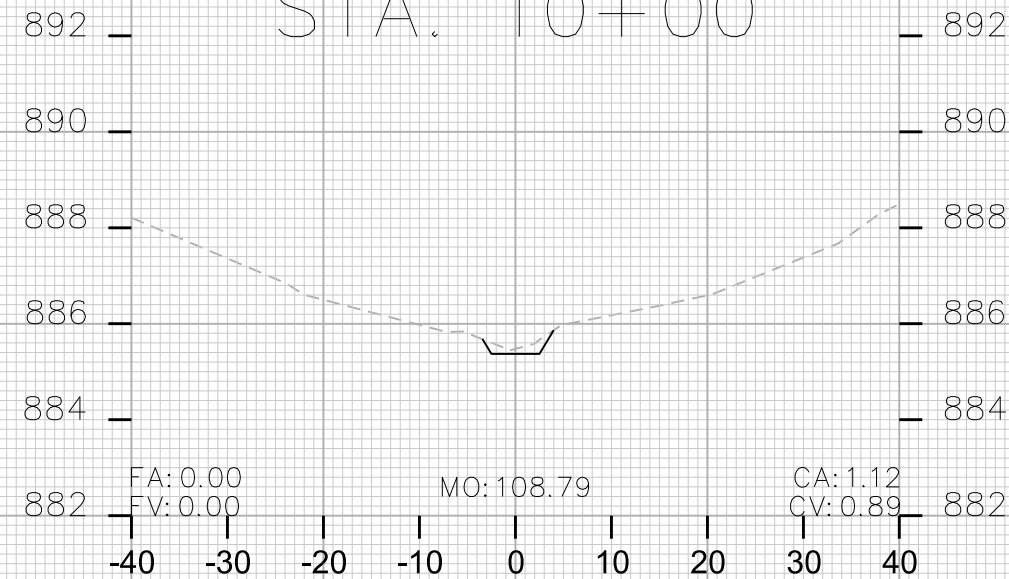
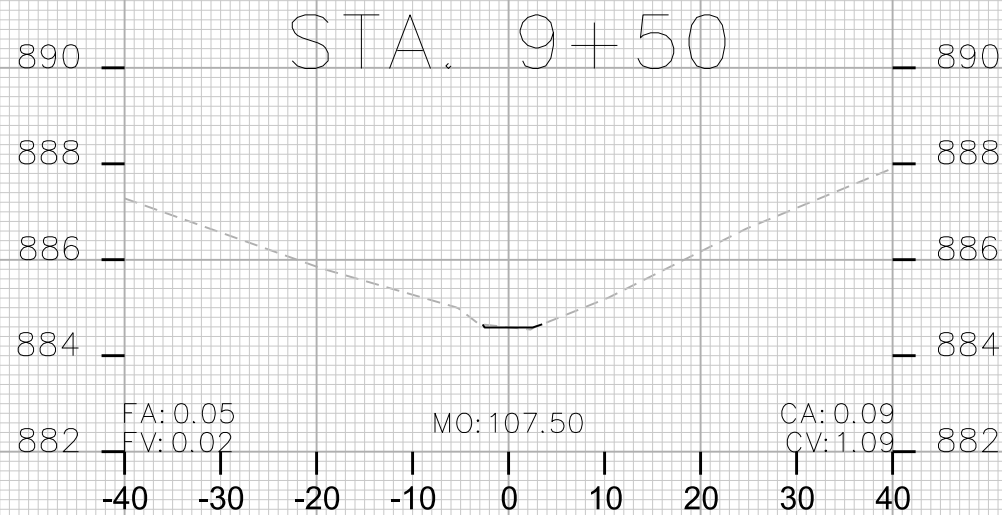
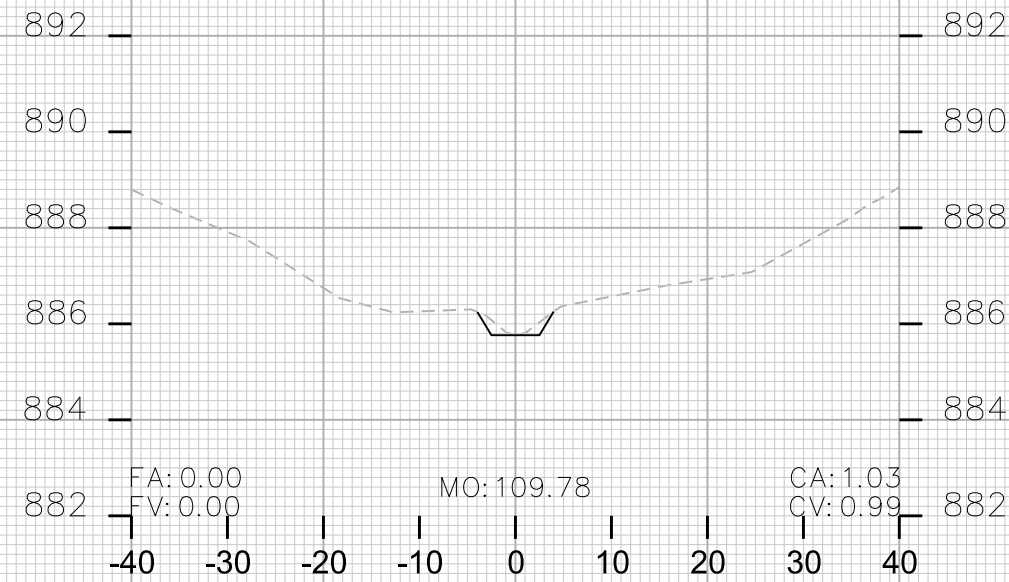
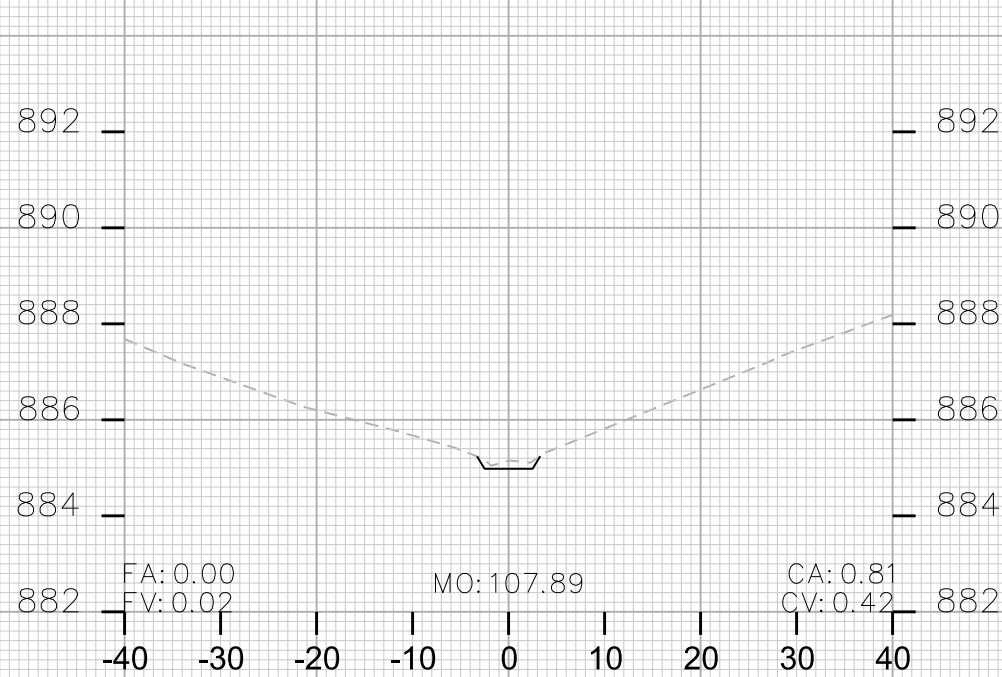

CROSS SECTIONS

PRAIRIE SCHOONER GRNWAY CITY OF MADISON

PLOT SCALE:

PLOT NAME:

REV. DATE:

ORIGINATOR: CITY OF MADISON, STREETS DIVISION

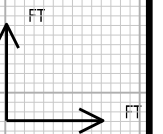
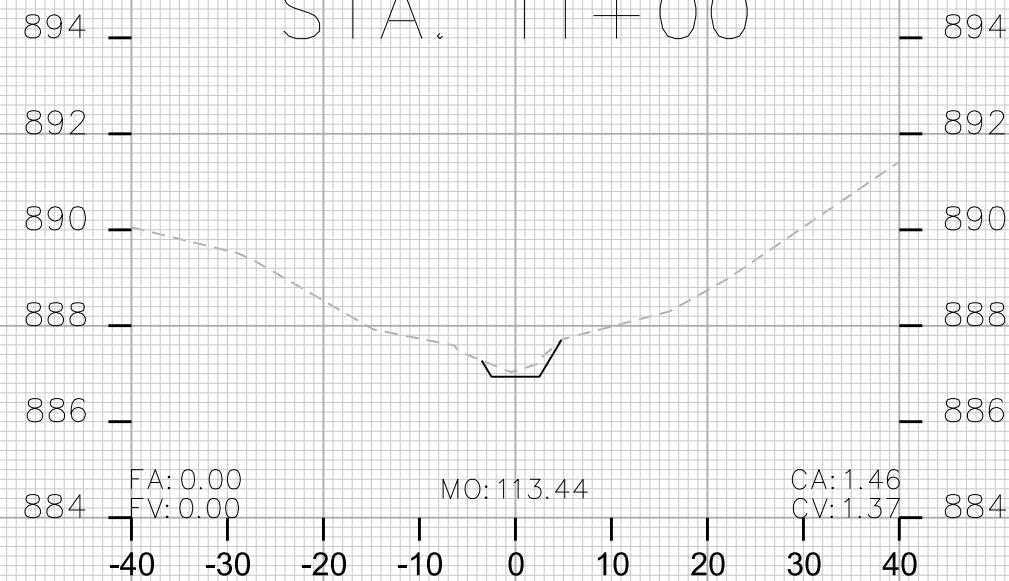
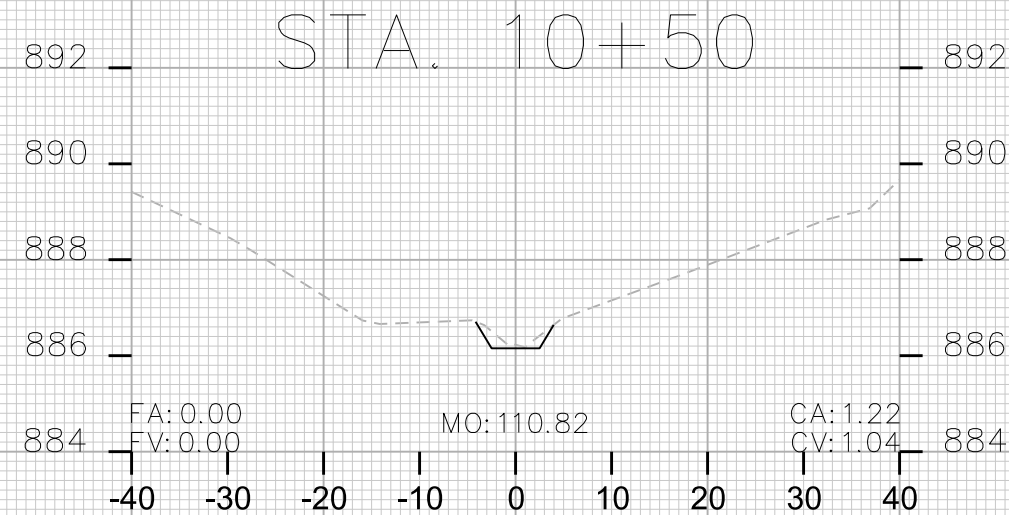
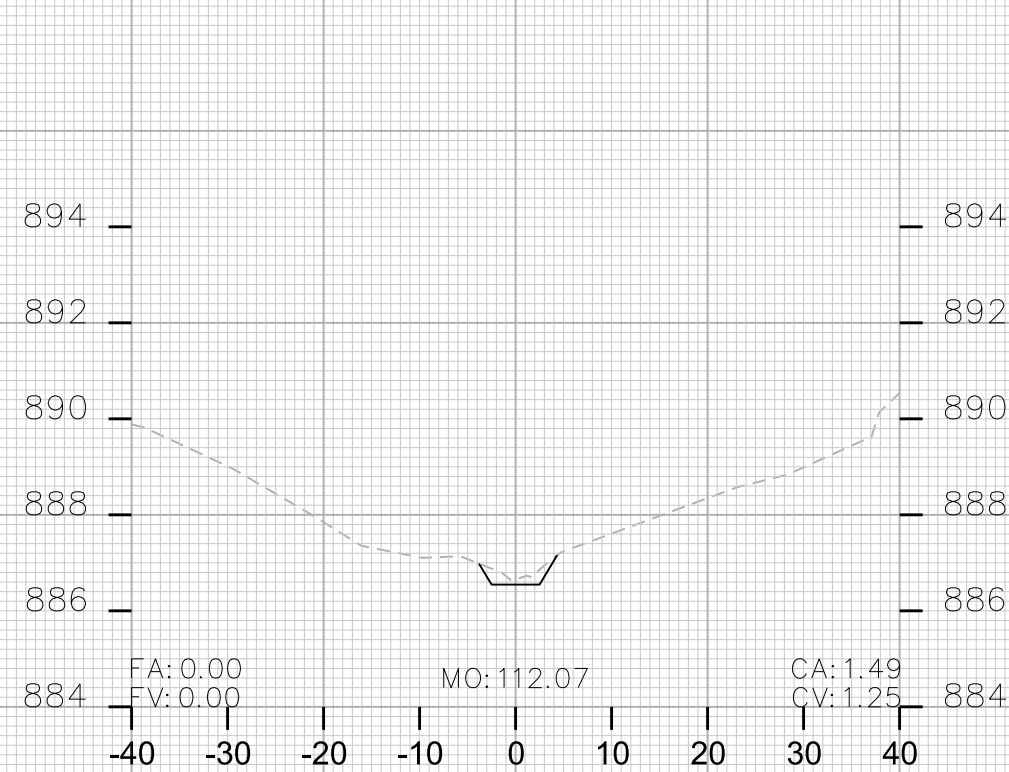

CROSS SECTIONS

PRAIRIE SCHOONER GRNWAY CITY OF MADISON

PLOT SCALE:

PLOT NAME:

REV. DATE:

ORIGINATOR: CITY OF MADISON, STREETS DIVISION

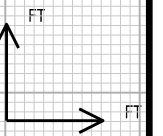
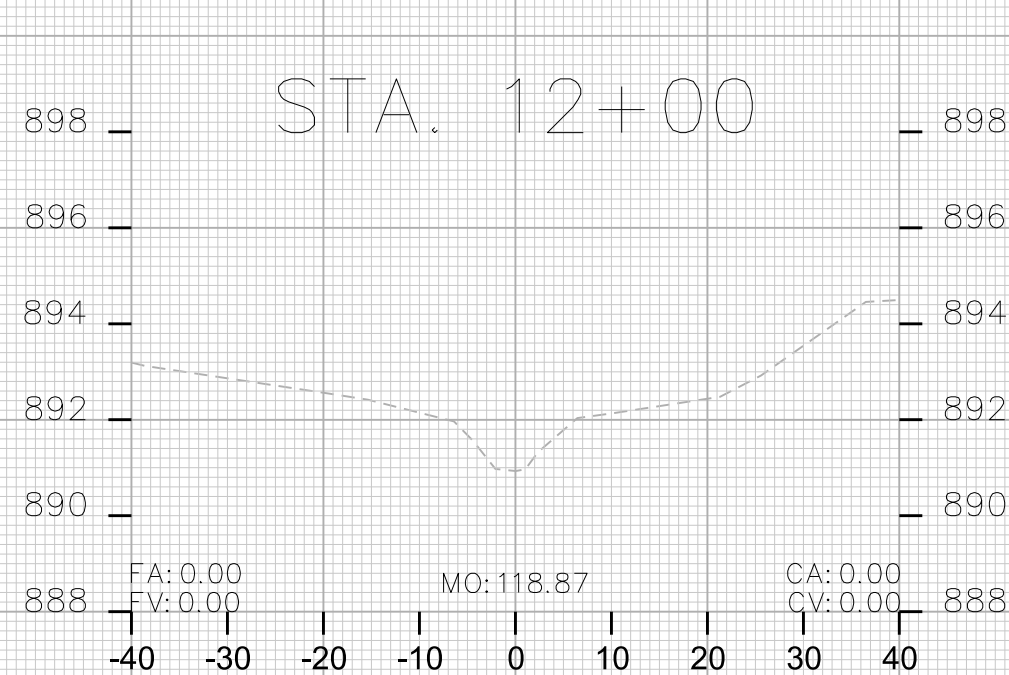
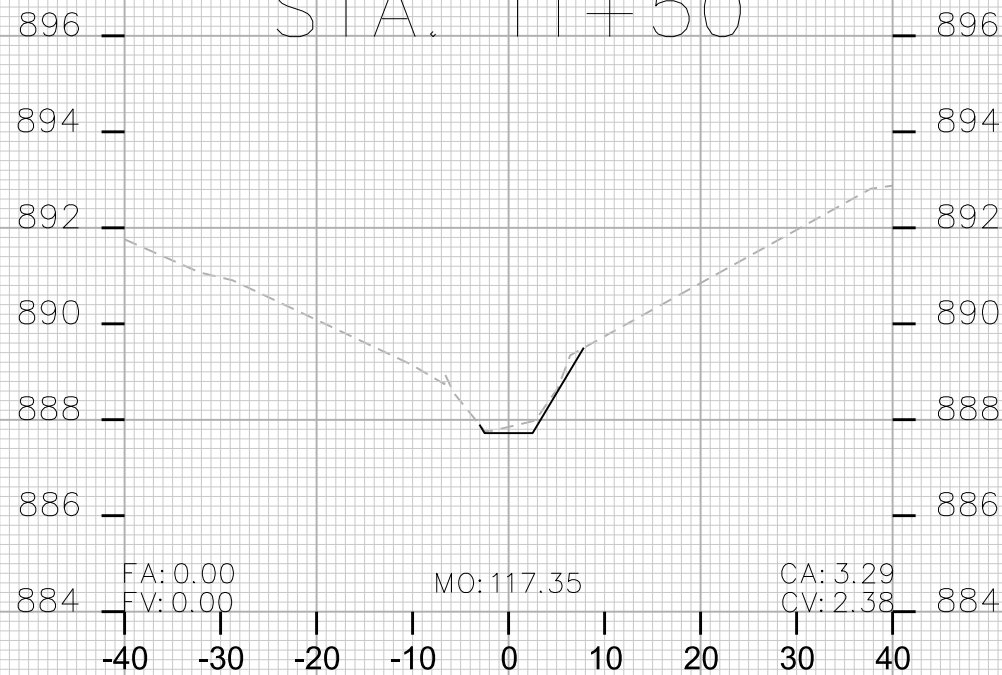
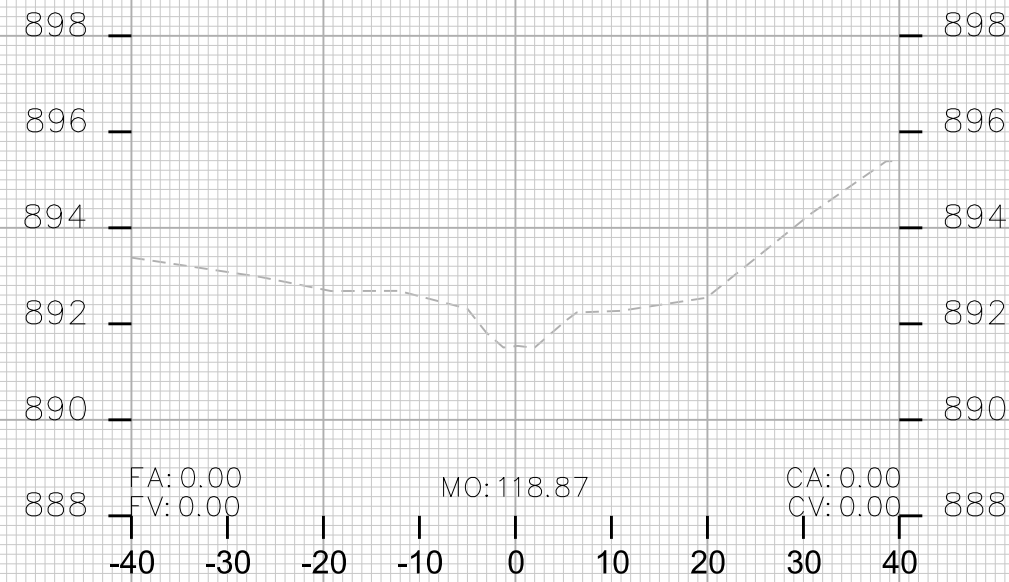
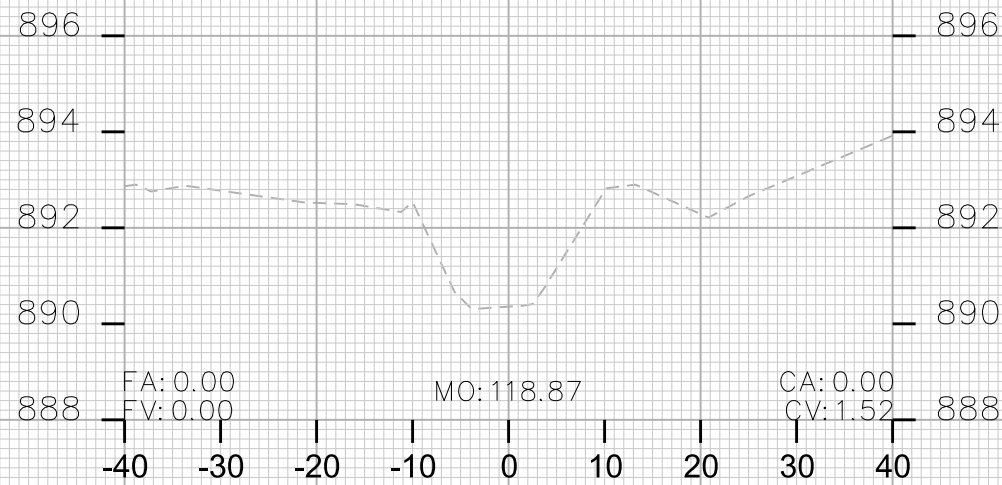

- NOTES:
- 1) IF THE CONTRACTOR ANTICIPATES HAULING MATERIAL TO THE SITE, A CONSTRUCTION ENTRANCE SHALL BE INSTALLED IN ACCORDANCE WITH THE STANDARD SPECIFICATIONS.
 - 2) THE CONTRACTOR SHALL STRIP AND STOCKPILE WHAT TOPSOIL IS AVAILABLE ON SITE. TOPSOIL SHALL BE STOCKPILED OUTSIDE OF THE POND LIMITS.
 - 3) THE CONTRACTOR SHALL ONLY USE MATERIAL GENERATED FROM THE SHELF TO REGRADE THE POND. NO FILL SHALL BE IMPORTED FOR THIS PROJECT.
ESTIMATED VOLUME: 7450 C.Y.
 - 4) AFTER FINAL GRADING IS COMPLETE, THE CONTRACTOR SHALL PLACE 4 INCHES OF TOPSOIL OVER ALL DISTURBED AREAS. IT IS ANTICIPATED THAT SALVAGED TOPSOIL WILL BE INSUFFICIENT AND IMPORTED TOPSOIL WILL BE NECESSARY.
ESTIMATED QUANTITY: 18,985 S.Y.
 - 5) THE CONTRACTOR SHALL SEED DISTURBED AREAS WITHIN THE POND WITH NO MOW TURF SEED MIX.
ESTIMATED QUANTITY: 18,985 S.Y.
 - 6) THE CONTRACTOR SHALL SEED DISTURBED AREAS OUTSIDE OF THE POND WITH NO MOW TURF SEED MIX.
QUANTITY DETERMINED BY CONTRACTOR METHODS
 - 7) THE CONTRACTOR SHALL PROVIDE EROSION CONTROL MEASURES FOR ALL DISTURBED AREAS AS FOLLOWS:
POND BOTTOM: MULCH 13,736 S.Y.
POND SLOPES: EROSION MATTING, CLASS I URBAN TYPE A 5243 S.Y.
OUTSIDE OF POND: EROSION MATTING, CLASS I URBAN TYPE A

DISTURBED AREAS WITHIN THE GRADING LIMITS SHALL BE RESTORED WITH 4 INCHES OF TOPSOIL AND NO MOW TURF SEED MIX. STRAW MULCH SHALL BE TRACKED IN ON THE BOTTOM OF THE POND. EROSION CONTROL MATTING, CLASS I URBAN TYPE A SHALL BE PLACED ON THE SIDE SLOPES WITHIN THE GRADING LIMITS.

THE EXISTING SAFETY BENCH IS APPROXIMATELY 20-FEET WIDE. THE SLOPES WILL BE REGRADED TO REDUCE THIS TO 10 FEET.

THE CONTRACTOR SHALL REMOVE, SALVAGE, AND REPLACE RIPRAP AS NECESSARY. THIS WORK SHALL INCLUDE THE REPLACEMENT OF GEOTEXTILE FILTER FABRIC, TYPE HR AS NECESSARY.

REGRADE S. HIGH POINT CONFLUENCE POND: CUT EXISTING SHELF AND USE MATERIAL AS FILL TO RAISE THE POND ELEVATION FROM 981 TO 984.8 FEET. APPROXIMATELY 7450 C.Y. OF MATERIAL WILL BE REDISTRIBUTED.

DISTURBED AREAS OUTSIDE OF THE GRADING LIMITS SHALL BE RESTORED WITH 4 INCHES OF TOPSOIL, NO MOW TURF SEED MIX, AND EROSION CONTROL MATTING, CLASS I URBAN TYPE A. THIS WORK SHALL BE INCIDENTAL TO MOBILIZATION.

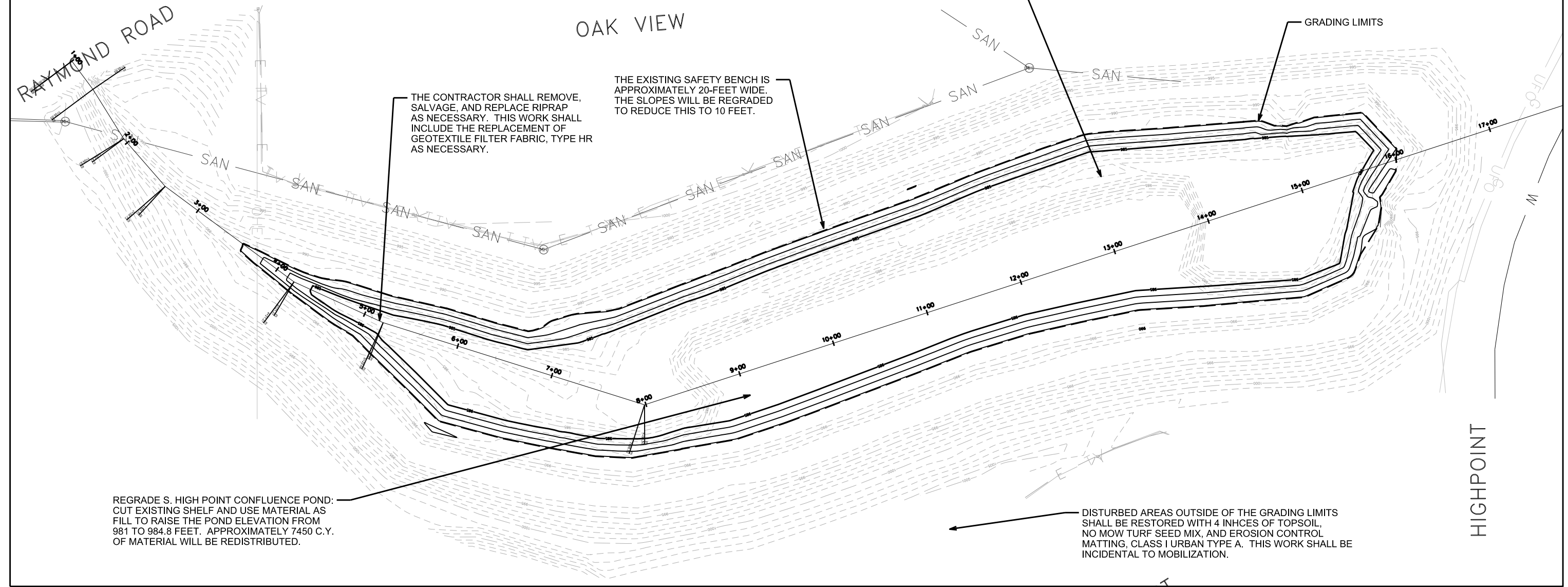

PLOT SCALE: _____
 PLOT NAME: _____
 REV. DATE: _____
 ORIGINATOR: CITY OF MADISON, STREETS DIVISION