

2016 GARNER PARK TENNIS TO PICKLEBALL-COURT CONVERSION
 CONTRACT 7740
 MUNIS NO. 17435-51-130

GARNER PARK
 333 S ROSA ROAD
 MADISON, WI 53705

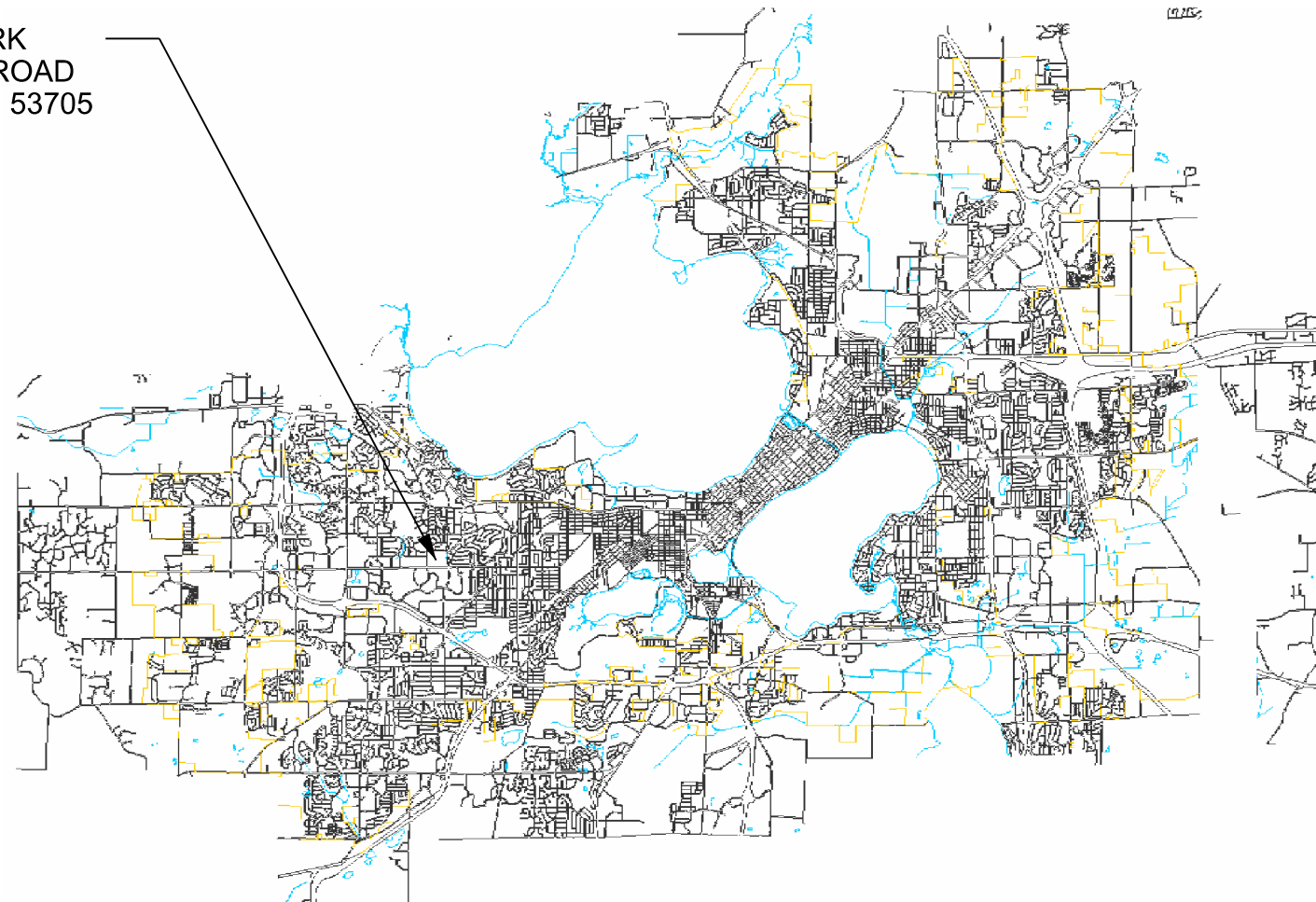

SHEET SCHEDULE

- 1.1 PROJECT LOCATION AND SITE ACCESS
- 1.2 DEMOLITION AND SITE PROTECTION PLAN
- 1.3 SITE PLAN
- 1.4 DETAILS

City of Madison
 Department of Public Works
PARKS DIVISION

City-County Building, Suite 104
 210 Martin Luther King, Jr. Blvd.
 PO Box 2987
 Madison, WI 53701-2987

play
**MADISON
 PARKS**



PROJECT: **2016 GARNER
 PARK TENNIS TO
 PICKLEBALL
 COURT
 CONVERSION**

Although every effort has been made in preparing these plans and checking them for accuracy, the contractor and subcontractors must check all details and dimensions of their trade and be responsible for the same.

ITEM	DATE
Rebid: KK	05-31-2016
Drawn by: KK	04-22-2016

PUBLIC WORKS PROJECT #:
7740

SHEET TITLE:

SHEET NUMBER:



City of Madison
 Department of Public Works
PARKS DIVISION

City-County Building, Suite 104
 210 Martin Luther King, Jr. Blvd.
 PO Box 2987
 Madison, WI 53701-2987

play
MADISON
PARKS

Graphical Scale

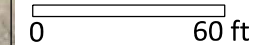

PROJECT:
2016 GARNER
PARK TENNIS TO
PICKLEBALL-COURT
CONVERSION

GARNER PARK
333 S ROSA ROAD
MADISON, WI 53705

Although every effort has been made in preparing these plans and checking them for accuracy, the contractor and subcontractors must check all details and dimensions of their trade and be responsible for the same.

ITEM	DATE
Rebid: KK	05-13-2016
For bid: KK	04-22-2016
Revised: KK	02-24-2016
Drawn by: KK	01-15-2016

PUBLIC WORKS PROJECT #:
7740

SHEET TITLE:
PROJECT LOCATION
AND SITE ACCESS

SHEET NUMBER:
1.1

City of Madison
 Department of Public Works
PARKS DIVISION

City-County Building, Suite 104
 210 Martin Luther King, Jr. Blvd.
 PO Box 2987
 Madison, WI 53701-2987



Graphical Scale

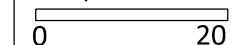

PROJECT:
**2016 GARNER
 PARK TENNIS TO
 PICKLEBALL-COURT
 CONVERSION**

**GARNER PARK
 333 S ROSA ROAD
 MADISON, WI 53705**

Although every effort has been made in preparing these plans and checking them for accuracy, the contractor and subcontractors must check all details and dimensions of their trade and be responsible for the same.

ITEM	DATE
Rebid: KK	05-13-2016
For bid: KK	04-22-2016
Revised: KK	02-24-2016
Drawn by: KK	01-15-2016

PUBLIC WORKS PROJECT #:
7740

SHEET TITLE:
**DEMOLITION AND
 SITE PROTECTION PLAN**

SHEET NUMBER:
1.2

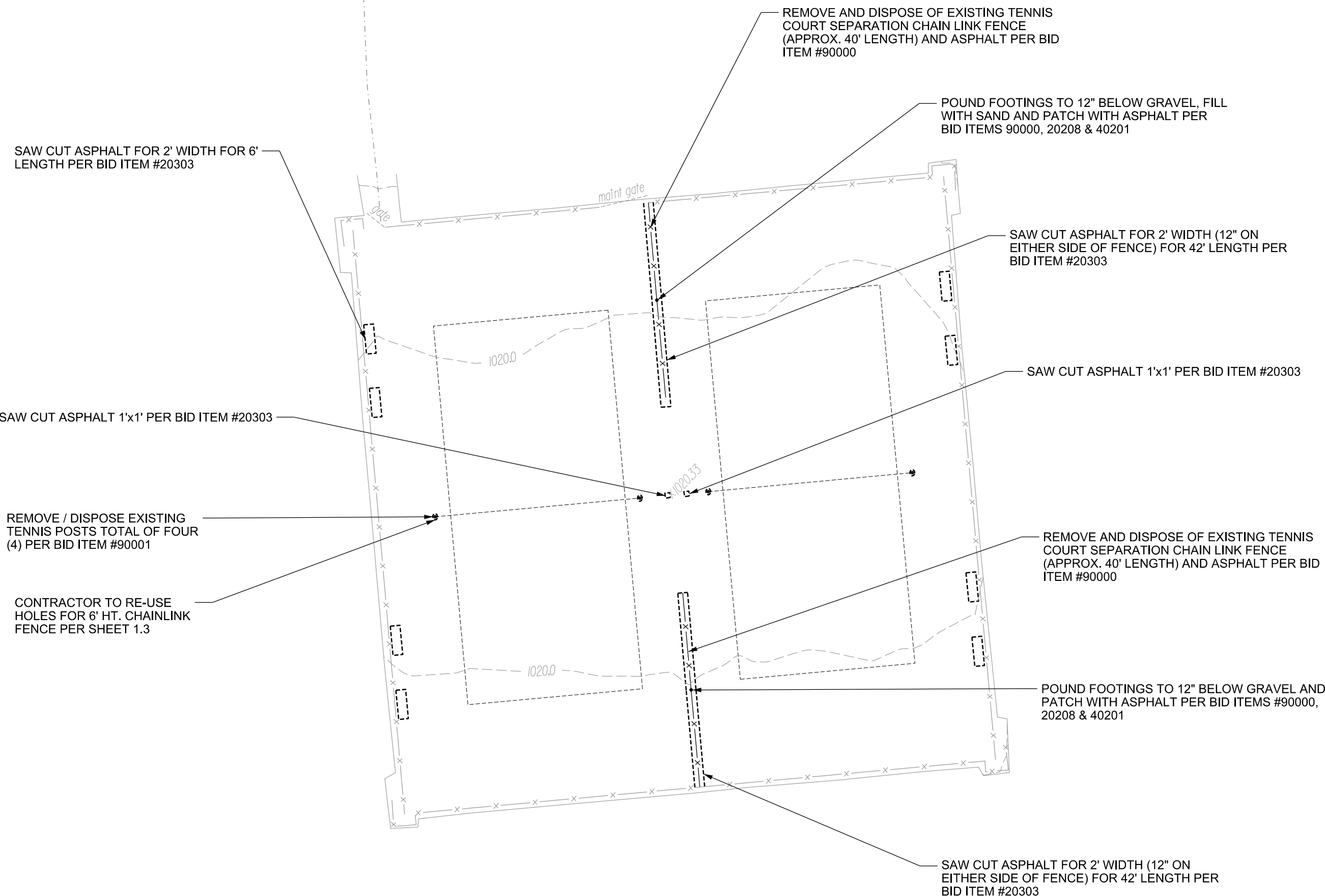

City of Madison
Department of Public Works
PARKS DIVISION

City-County Building, Suite 104
210 Martin Luther King, Jr. Blvd.
PO Box 2987
Madison, WI 53701-2987

play
**MADISON
PARKS**

Graphical Scale

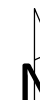
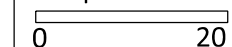

PROJECT:
**2016 GARNER
PARK TENNIS TO
PICKLEBALL-COURT
CONVERSION**

**GARNER PARK
333 S ROSA ROAD
MADISON, WI 53705**

Although every effort has been made in preparing these plans and checking them for accuracy, the contractor and subcontractors must check all details and dimensions of their trade and be responsible for the same.

ITEM	DATE
Rebid: KK	05-13-2016
For bid: KK	04-22-2016
Revised: KK	02-24-2016
Drawn by: KK	01-15-2016

PUBLIC WORKS PROJECT #:

7740

SHEET TITLE:

SITE PLAN

SHEET NUMBER:

1.3

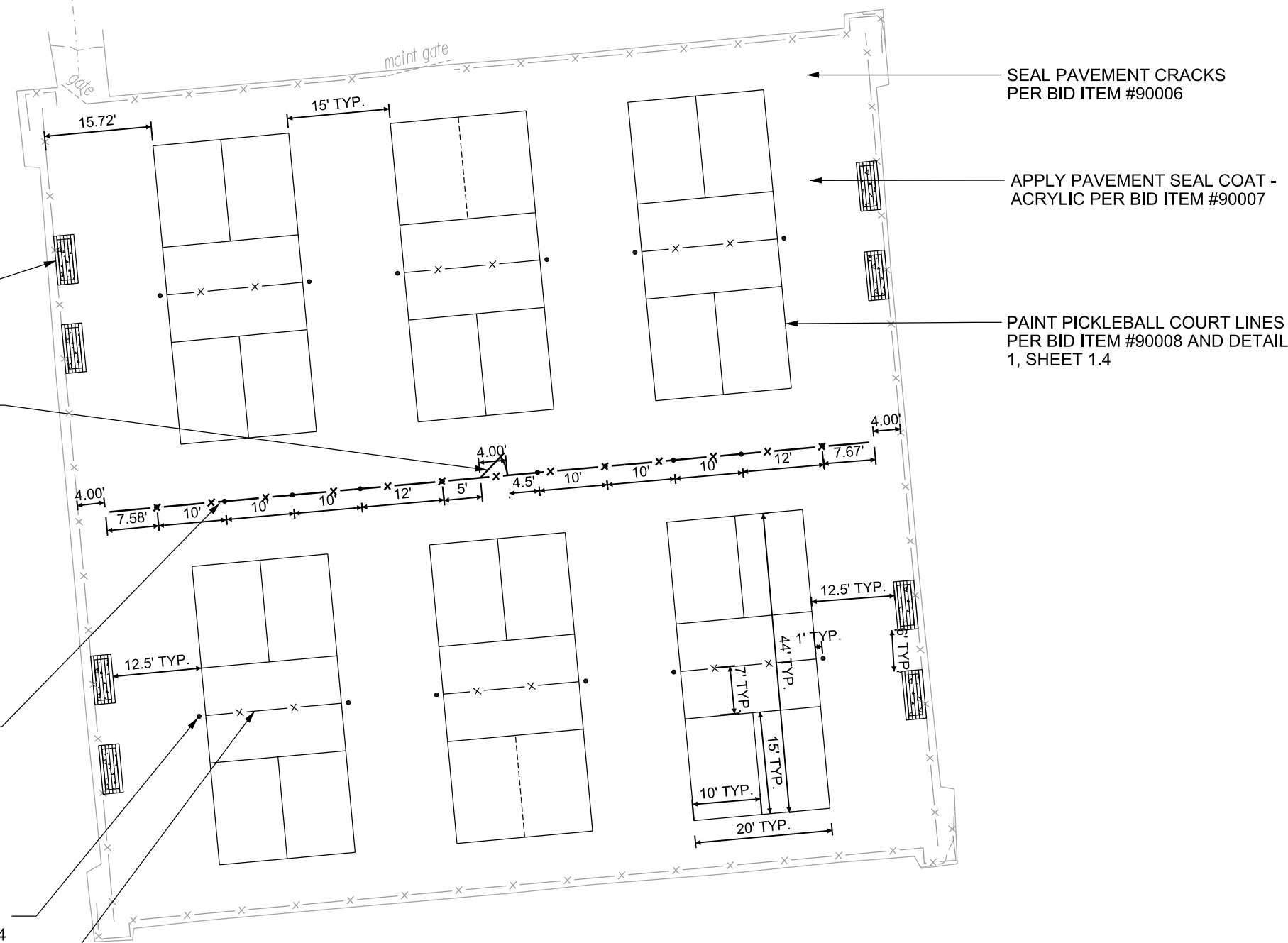

INSTALL BENCHES (TOTAL OF 8)
PER BID ITEMS #90005 & 30301

FURNISH AND INSTALL 4' WIDTH CHAIN LINK
GATE (TOTAL OF 1) PER BID ITEM #90003 AND
DETAIL 3, SHEET 1.4; PATCH WITH ASPHALT
FOLLOWING INSTALLATION OF DRIVE ANCHOR
FOOTINGS

FURNISH AND INSTALL 6' CHAIN LINK FENCE
(109 LF) PER BID ITEM #90002 AND DETAIL 2,
SHEET 1.4

FURNISH AND INSTALL PICKLEBALL NET
POSTS (TOTAL OF 12) PER BID ITEM #90004

NETS TO BE INSTALLED BY CONTRACTOR PER
MANUFACTURER'S INSTALLATION
INSTRUCTIONS, SUPPLIED BY CITY OF
MADISON PARKS DIVISION. PICK-UP NETS AT
GOODMAN MAINTENANCE FACILITY 1402
WINGRA CREEK PARKWAY, MADISON

SEAL PAVEMENT CRACKS
PER BID ITEM #90006

APPLY PAVEMENT SEAL COAT -
ACRYLIC PER BID ITEM #90007

PAINT PICKLEBALL COURT LINES
PER BID ITEM #90008 AND DETAIL
1, SHEET 1.4

NOTES

- 1.) STRIPING DIMENSIONS PER USAPA PICKLEBALL - SEE BID ITEM 90008 FOR MORE INFORMATION
- 2.) COURT DIMENSIONS SHOWN ARE INCLUSIVE OF LINES
- 3.) WIDTH FOR ALL COURT LINES IS TWO INCHES (2")

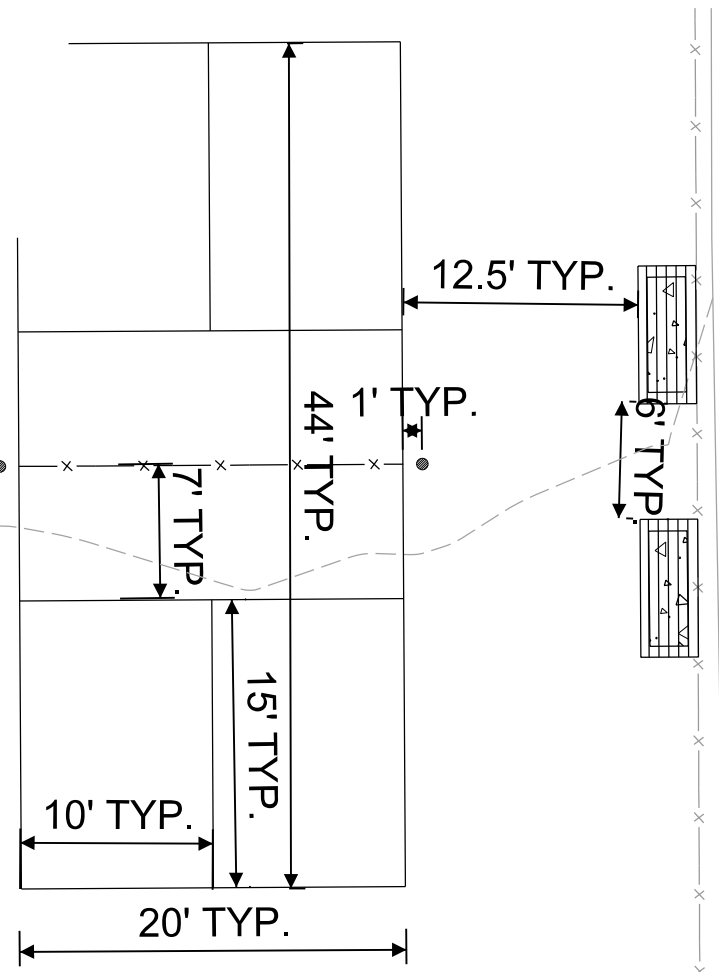

1

PICKLEBALL COURT STRIPING DETAIL

1'=10'-0"

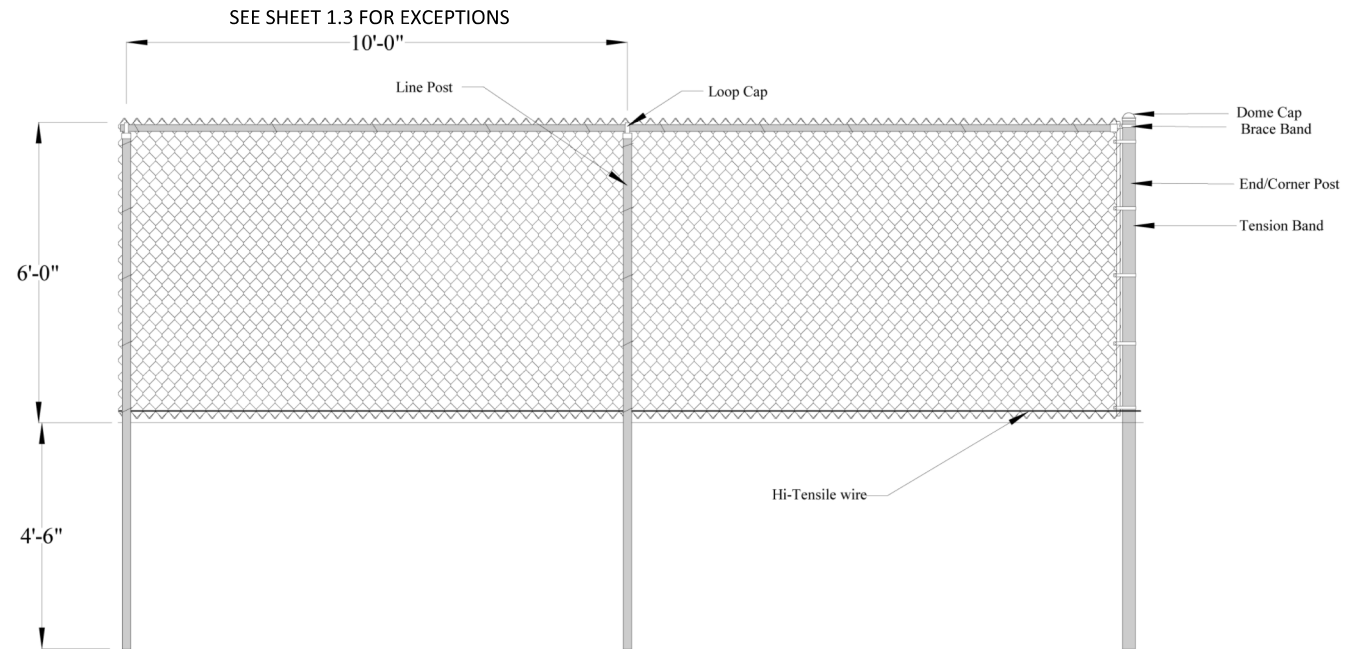

FABRIC:	Height 10'	Mesh 2"	Gage 9	Selvage KK	Finish ALUM	TYPE
						Schedule 40
FRAMEWORK:	O.D.	WALL	WT PER FT	LENGTH		Schedule 40
END/CORNER POST:	3"	.203	5.79	16'		Schedule 40
LINE POST:	2 1/2"	.154	3.65	16'		Schedule 40
RAILS:	1 5/8"	.140	2.27	10' TYP. (SEE PLANS FOR EXCEPTION)		Schedule 40

2

6' CHAIN LINK FENCE

NTS

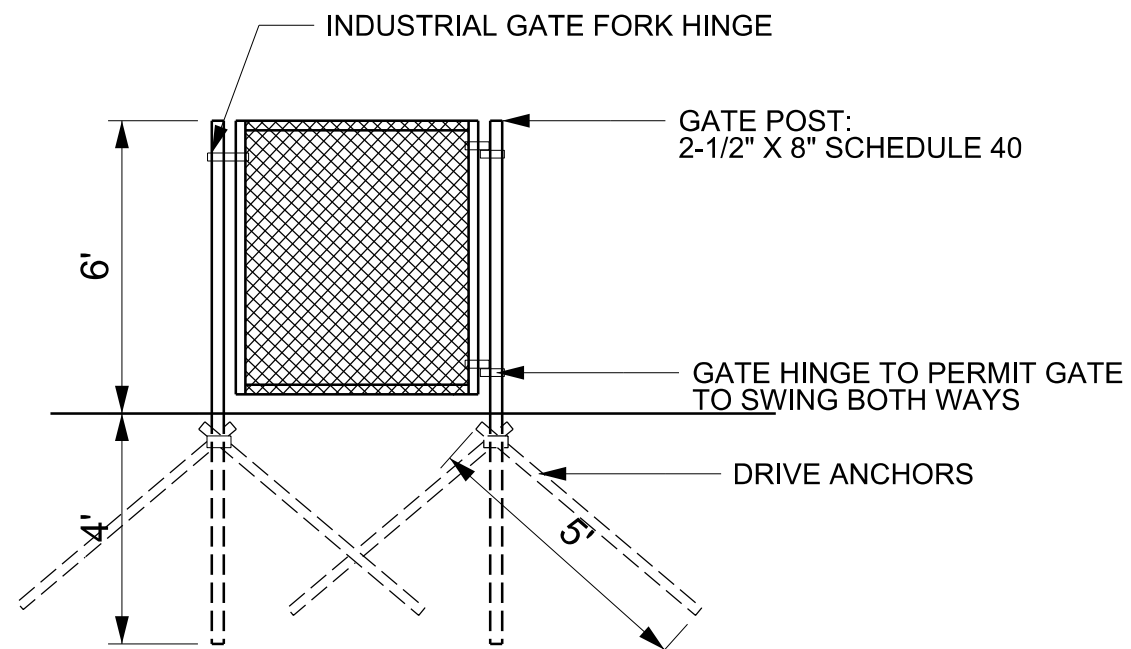

3

4' WIDTH FENCE GATE

NTS

City of Madison
Department of Public Works
PARKS DIVISION

City-County Building, Suite 104
210 Martin Luther King, Jr. Blvd.
PO Box 2987
Madison, WI 53701-2987

play
**MADISON
PARKS**

PROJECT:
**2016 GARNER
PARK TENNIS TO
PICKLEBALL-COURT
CONVERSION**

**GARNER PARK
333 S ROSA ROAD
MADISON, WI 53705**

Although every effort has been made in preparing these plans and checking them for accuracy, the contractor and subcontractors must check all details and dimensions of their trade and be responsible for the same.

ITEM	DATE
Rebid: KK	05-13-2016
For bid: KK	04-22-2016
Revised: KK	02-24-2016
Drawn by: KK	01-15-2016

PUBLIC WORKS PROJECT #:
7740

SHEET TITLE:
DETAILS

SHEET NUMBER:
1.4