

LEGEND

- ⊕ EX. ELECTRICAL HAND HOLE
- ⊕ EX. ELECTRICAL PEDESTAL
- ⊕ EX. TELEPHONE PEDESTAL
- ⊕ EX. TREE
- ⊕ EX. WATER HYDRANT
- ⊕ EX. WATER VALVE
- — — — — EX. PROPERTY LINE
- - - - - EX. EASEMENT
- X - - - - EX. FENCE LINE
- ~ ~ ~ ~ ~ EX. TREE LINE
- - - - - EX. CONTOUR (INDEX)
- - - - - EX. CONTOUR (INTER)
- EX. ABANDONED UTILITY
- E - - - - EX. ELECTRIC
- FO - - - - EX. FIBER OPTIC
- G - - - - EX. NATURAL GAS
- OH - - - - EX. OVERHEAD LINE
- SN - - - - EX. SANITARY SEWER
- ST - - - - EX. STORM SEWER
- TV - - - - EX. CABLE TV
- T - - - - EX. UNDERGROUND TELEPHONE
- W - - - - EX. WATER LINE
- ▨ EX. GRAVEL
- ▩ EX. CONCRETE

McPIKE PARK FENCE INSTALLATION AND SITE RESTORATION

MUNIS NUMBER: 10525 -51 -110

McPIKE PARK
202 S. INGERSOLL STREET

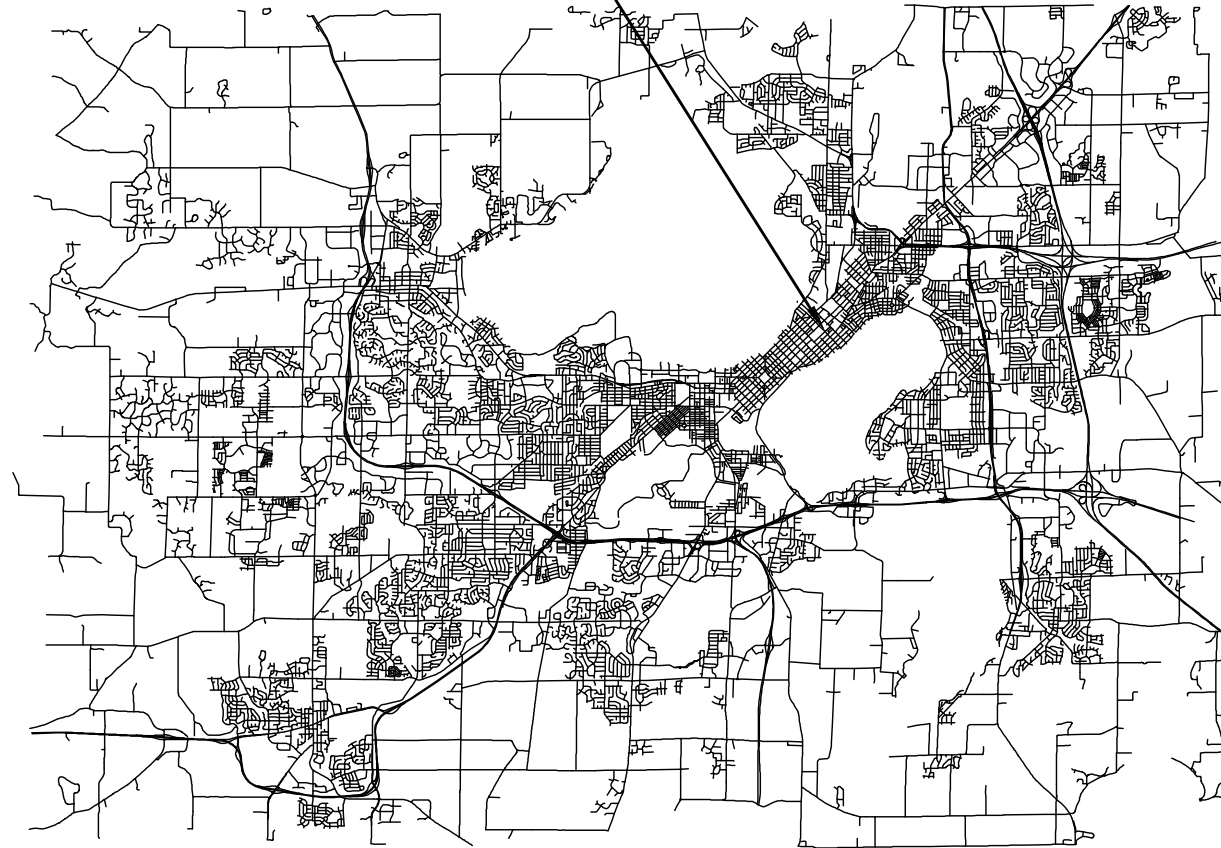

DESIGNED BY:

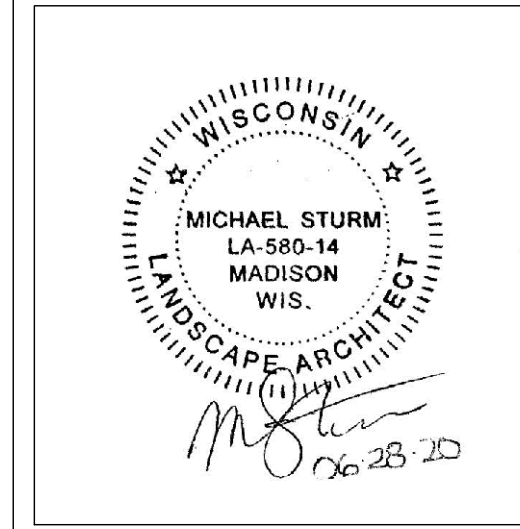

City of Madison
Department of Public Works
PARKS DIVISION
City-County Building, Suite 104
210 Martin Luther King, Jr. Blvd.
Madison, WI 53703



PROJECT:

*McPIKE PARK FENCE
INSTALLATION AND
SITE RESTORATION*

Although every effort has been made in preparing these plans and checking them for accuracy, the contractor and subcontractors must check all details and dimensions of their trade and be responsible for the same.

ITEM	DATE
ADVERTISED TO BID	2020-07-02

PUBLIC WORKS PROJECT #:
8922

SHEET TITLE:
COVER SHEET

SHEET NUMBER:

SHEET SCHEDULE

- 1.0 PROJECT LOCATION AND SITE ACCESS
- 1.1 SHEET TILING
- 1.2 EXISTING SITE CONDITIONS - AREA 1
- 1.3 EXISTING SITE CONDITIONS - AREA 2
- 1.4 EXISTING SITE CONDITIONS - AREA 3
- 1.5 EXISTING SITE CONDITIONS - AREA 4
- 2.1 DEMOLITION AND SITE PROTECTION - AREA 1
- 2.2 DEMOLITION AND SITE PROTECTION - AREA 2
- 3.1 FENCE INSTALLATION - AREA 1
- 3.2 FENCE INSTALLATION - AREA 2
- 3.3 FENCE INSTALLATION - AREA 3
- 3.4 FENCE INSTALLATION - AREA 4
- 4.1 SITE RESTORATION - AREA 1
- 4.2 SITE RESTORATION - AREA 2
- 4.3 SITE RESTORATION - AREA 3
- 4.4 SITE RESTORATION - AREA 4
- 5.1 FENCE DETAILS
- 6.1 EARTHWORK CALCULATIONS

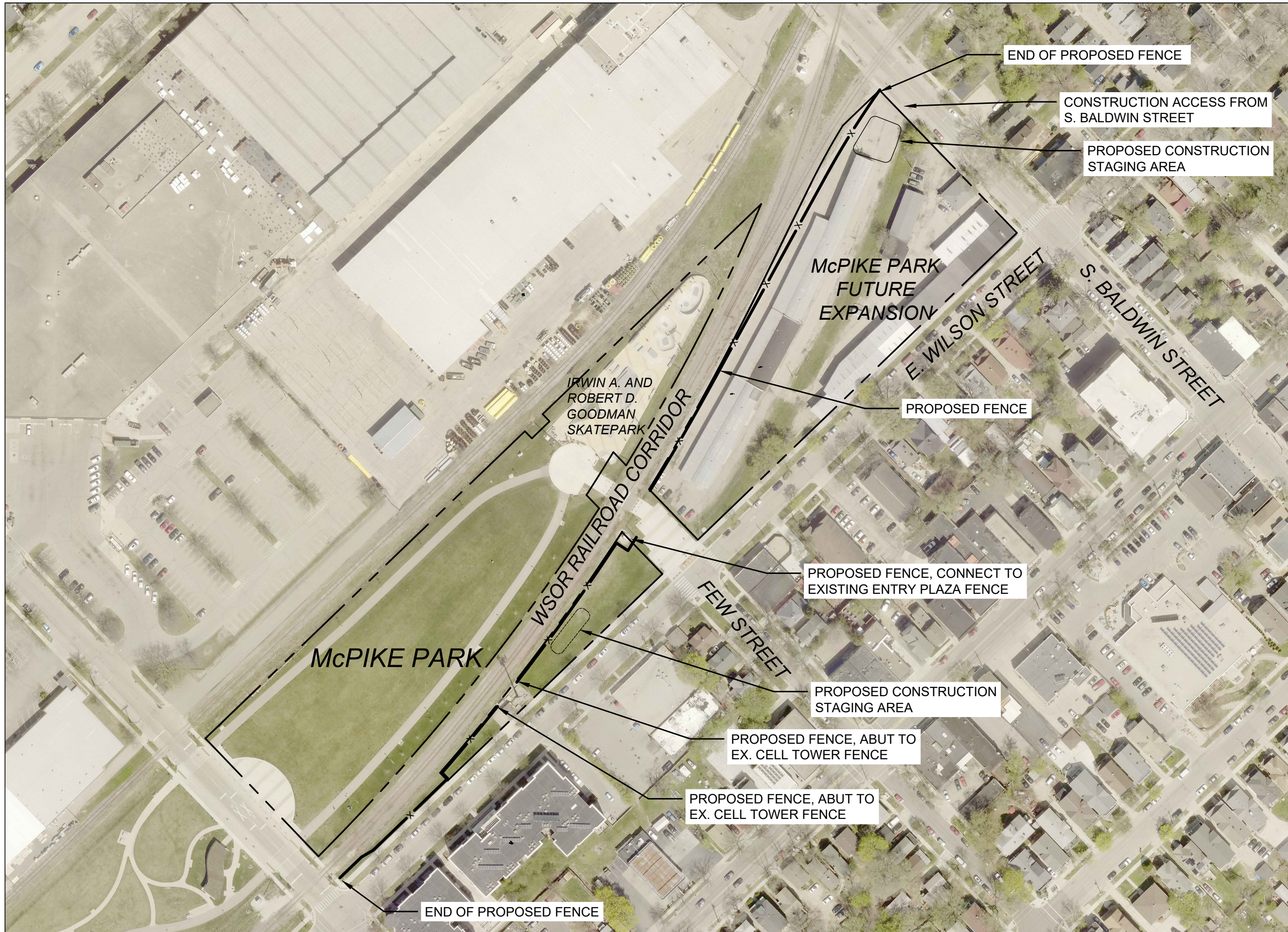

City of Madison
 Department of Public Works
PARKS DIVISION
 City-County Building, Suite 104
 210 Martin Luther King, Jr. Blvd.
 Madison, WI 53703

play
**MADISON
 PARKS**

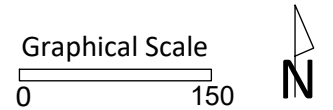

PROJECT:
*McPIKE PARK
 FENCE INSTALLATION
 AND SITE
 RESTORATION*

PROJECT ADDRESS:
*202 S. INGERSOLL ST.
 MADISON, WI 53703*

Although every effort has been made in preparing these plans and checking them for accuracy, the contractor and subcontractors must check all details and dimensions of their trade and be responsible for the same.

ITEM	DATE
ADVERTISED TO BID	2020-07-02

PUBLIC WORKS PROJECT #:
8922

SHEET TITLE:
*PROJECT LOCATON
 AND SITE ACCESS*

SHEET NUMBER:
1.0

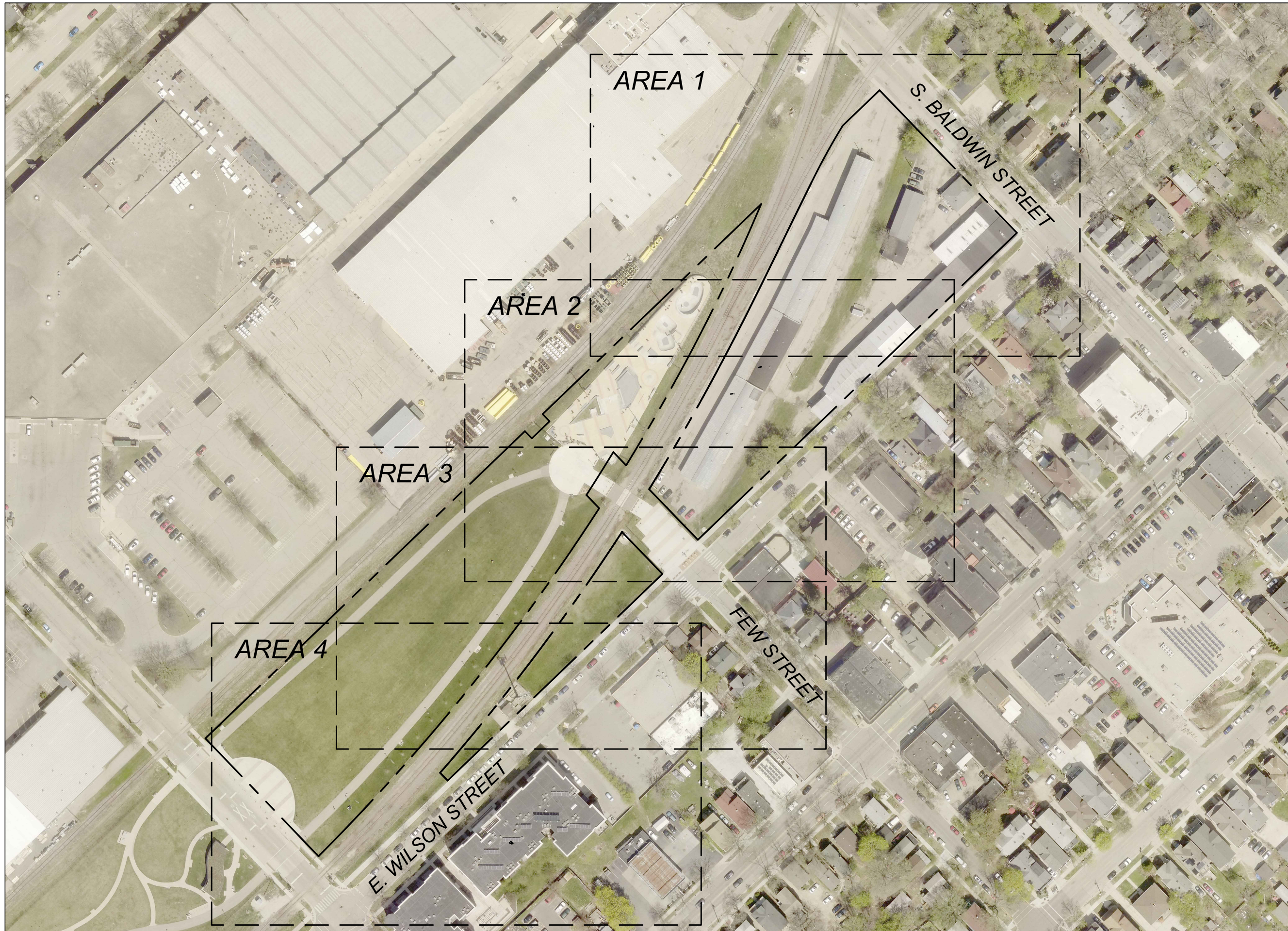

City of Madison
 Department of Public Works
PARKS DIVISION
 City-County Building, Suite 104
 210 Martin Luther King, Jr. Blvd.
 Madison, WI 53703

play
**MADISON
 PARKS**

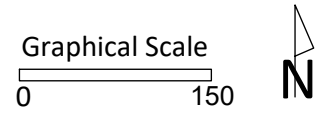

PROJECT:
*McPIKE PARK
 FENCE INSTALLATION
 AND SITE
 RESTORATION*

PROJECT ADDRESS:
*202 S. INGERSOLL ST.
 MADISON, WI 53703*

Although every effort has been made in preparing these plans and checking them for accuracy, the contractor and subcontractors must check all details and dimensions of their trade and be responsible for the same.

ITEM	DATE
ADVERTISED TO BID	2020-07-02

PUBLIC WORKS PROJECT #:
8922

SHEET TITLE:
SHEET TILING

SHEET NUMBER:
1.1

NOTES

1. CONTRACTOR IS RESPONSIBLE FOR REPAIRING ANY EXISTING UTILITIES, STRUCTURES, CURB, LAWN, PAVEMENT, ETC. DAMAGED THROUGH CONSTRUCTION ACTIVITIES AT THEIR OWN EXPENSE.
2. ALL WORK WITHIN 25 FT. OF WDOT/WSOR ROW CENTERLINE SHALL COMPLY WITH FLAGGING AND INSURANCE REQUIREMENTS PER BID ITEMS 10712 AND 10790.
3. MULTIPLE UNDERGROUND UTILITIES EXISTING WITHIN CLOSE PROXIMITY TO THE PROPOSED FENCE. THE CONTRACTOR SHALL CONTACT DIGGERS HOTLINE PRIOR TO COMMENCING WORK.

CAUTION: EX. UNDERGROUND UTILITY (TYP.)

CAUTION: EX. UNDERGROUND FIBER COMMUNICATION LINES (TYP.)

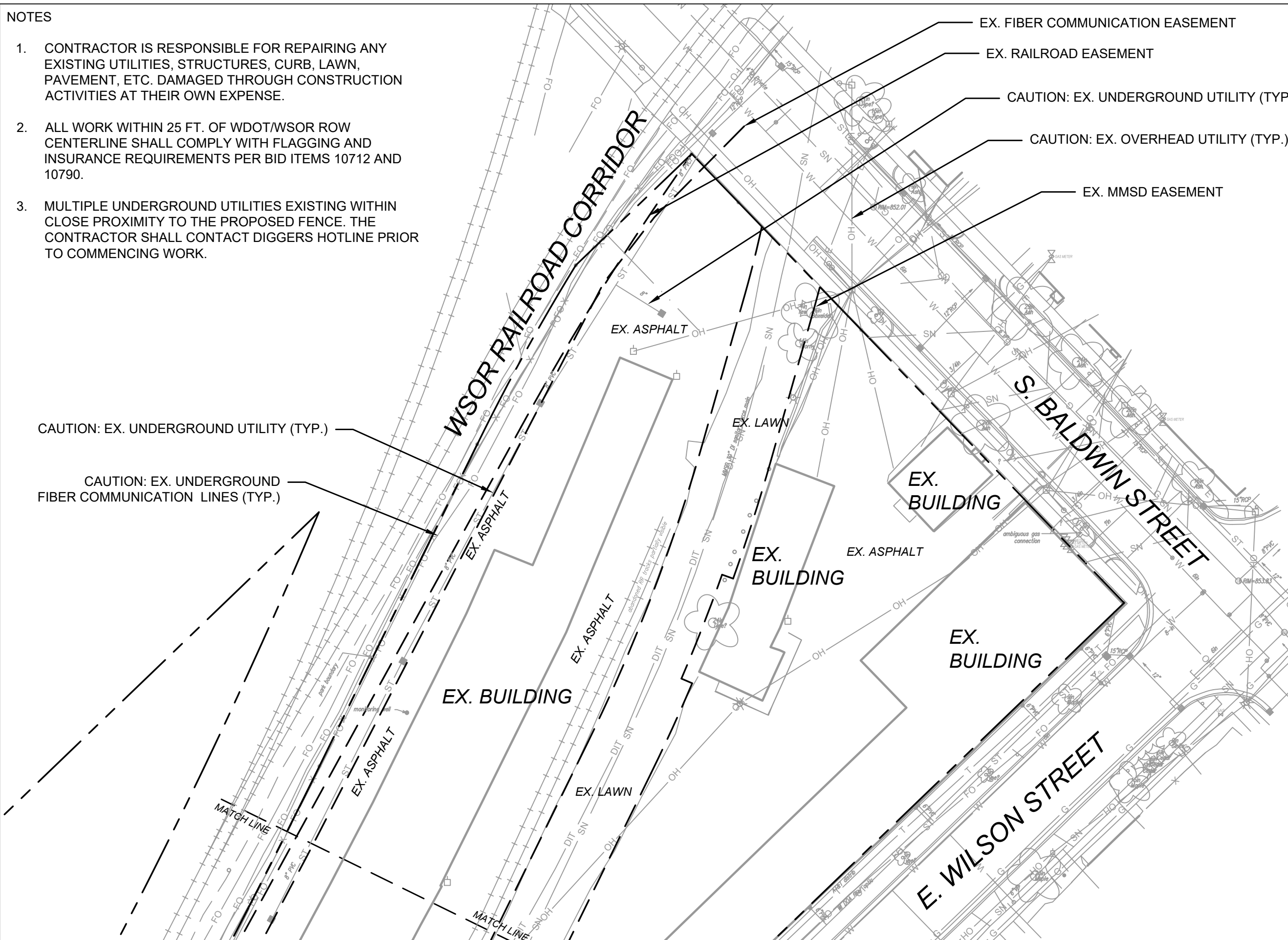

City of Madison
 Department of Public Works
PARKS DIVISION
 City-County Building, Suite 104
 210 Martin Luther King, Jr. Blvd.
 Madison, WI 53703

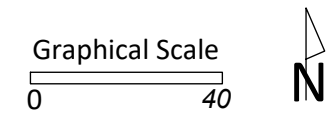

PROJECT:
*McPIKE PARK
 FENCE INSTALLATION
 AND SITE
 RESTORATION*

PROJECT ADDRESS:
*202 S. INGERSOLL ST.
 MADISON, WI 53703*

Although every effort has been made in preparing these plans and checking them for accuracy, the contractor and subcontractors must check all details and dimensions of their trade and be responsible for the same.

ITEM	DATE
ADVERTISED TO BID	2020-07-02

PUBLIC WORKS PROJECT #:
8922

SHEET TITLE:
*EXISTING SITE
 CONDITIONS - AREA 1*

SHEET NUMBER:
1.2

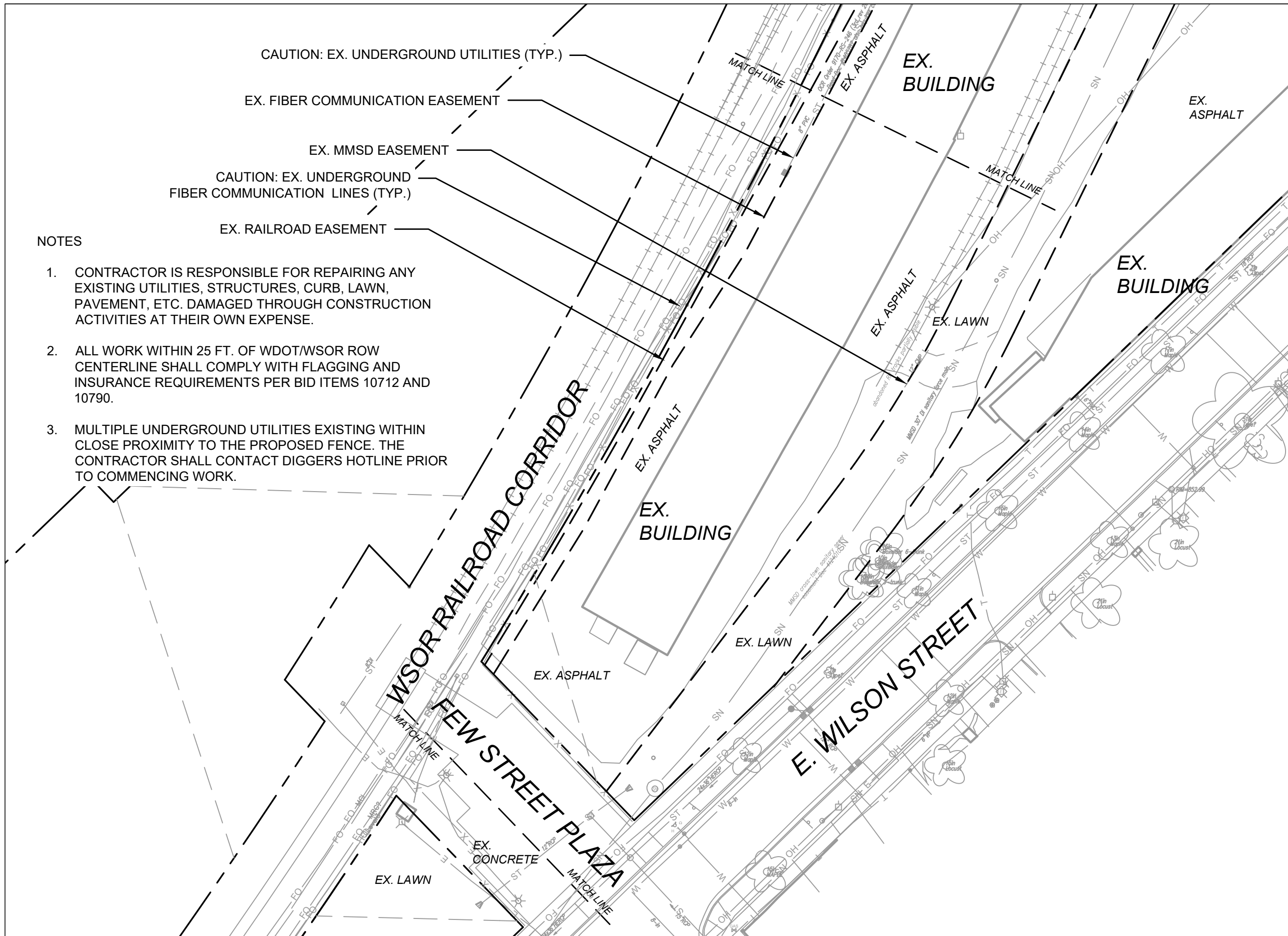

CAUTION: EX. UNDERGROUND UTILITIES (TYP.)

EX. FIBER COMMUNICATION EASEMENT

EX. MMSD EASEMENT

CAUTION: EX. UNDERGROUND FIBER COMMUNICATION LINES (TYP.)

EX. RAILROAD EASEMENT

NOTES

1. CONTRACTOR IS RESPONSIBLE FOR REPAIRING ANY EXISTING UTILITIES, STRUCTURES, CURB, LAWN, PAVEMENT, ETC. DAMAGED THROUGH CONSTRUCTION ACTIVITIES AT THEIR OWN EXPENSE.
2. ALL WORK WITHIN 25 FT. OF WDOT/WSOR ROW CENTERLINE SHALL COMPLY WITH FLAGGING AND INSURANCE REQUIREMENTS PER BID ITEMS 10712 AND 10790.
3. MULTIPLE UNDERGROUND UTILITIES EXISTING WITHIN CLOSE PROXIMITY TO THE PROPOSED FENCE. THE CONTRACTOR SHALL CONTACT DIGGERS HOTLINE PRIOR TO COMMENCING WORK.

City of Madison
 Department of Public Works
PARKS DIVISION
 City-County Building, Suite 104
 210 Martin Luther King, Jr. Blvd.
 Madison, WI 53703



Graphical Scale

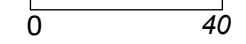

PROJECT:
*McPIKE PARK
 FENCE INSTALLATION
 AND SITE
 RESTORATION*

PROJECT ADDRESS:
*202 S. INGERSOLL ST.
 MADISON, WI 53703*

Although every effort has been made in preparing these plans and checking them for accuracy, the contractor and subcontractors must check all details and dimensions of their trade and be responsible for the same.

ITEM	DATE
ADVERTISED TO BID	2020-07-02

PUBLIC WORKS PROJECT #:
8922

SHEET TITLE:
*EXISTING SITE
 CONDITIONS - AREA 2*

SHEET NUMBER:
1.3

NOTES

1. CONTRACTOR IS RESPONSIBLE FOR REPAIRING ANY EXISTING UTILITIES, STRUCTURES, CURB, LAWN, PAVEMENT, ETC. DAMAGED THROUGH CONSTRUCTION ACTIVITIES AT THEIR OWN EXPENSE.
2. ALL WORK WITHIN 25 FT. OF WDOT/WSOR ROW CENTERLINE SHALL COMPLY WITH FLAGGING AND INSURANCE REQUIREMENTS PER BID ITEMS 10712 AND 10790.
3. MULTIPLE UNDERGROUND UTILITIES EXISTING WITHIN CLOSE PROXIMITY TO THE PROPOSED FENCE. THE CONTRACTOR SHALL CONTACT DIGGERS HOTLINE PRIOR TO COMMENCING WORK.

CAUTION: EX. UNDERGROUND UTILITIES (TYP.)

CAUTION: EX. UNDERGROUND FIBER COMMUNICATION LINES (TYP.)

CAUTION: EX. UNDERGROUND UTILITIES (TYP.)

EX. CELL TOWER AND SECURITY FENCE

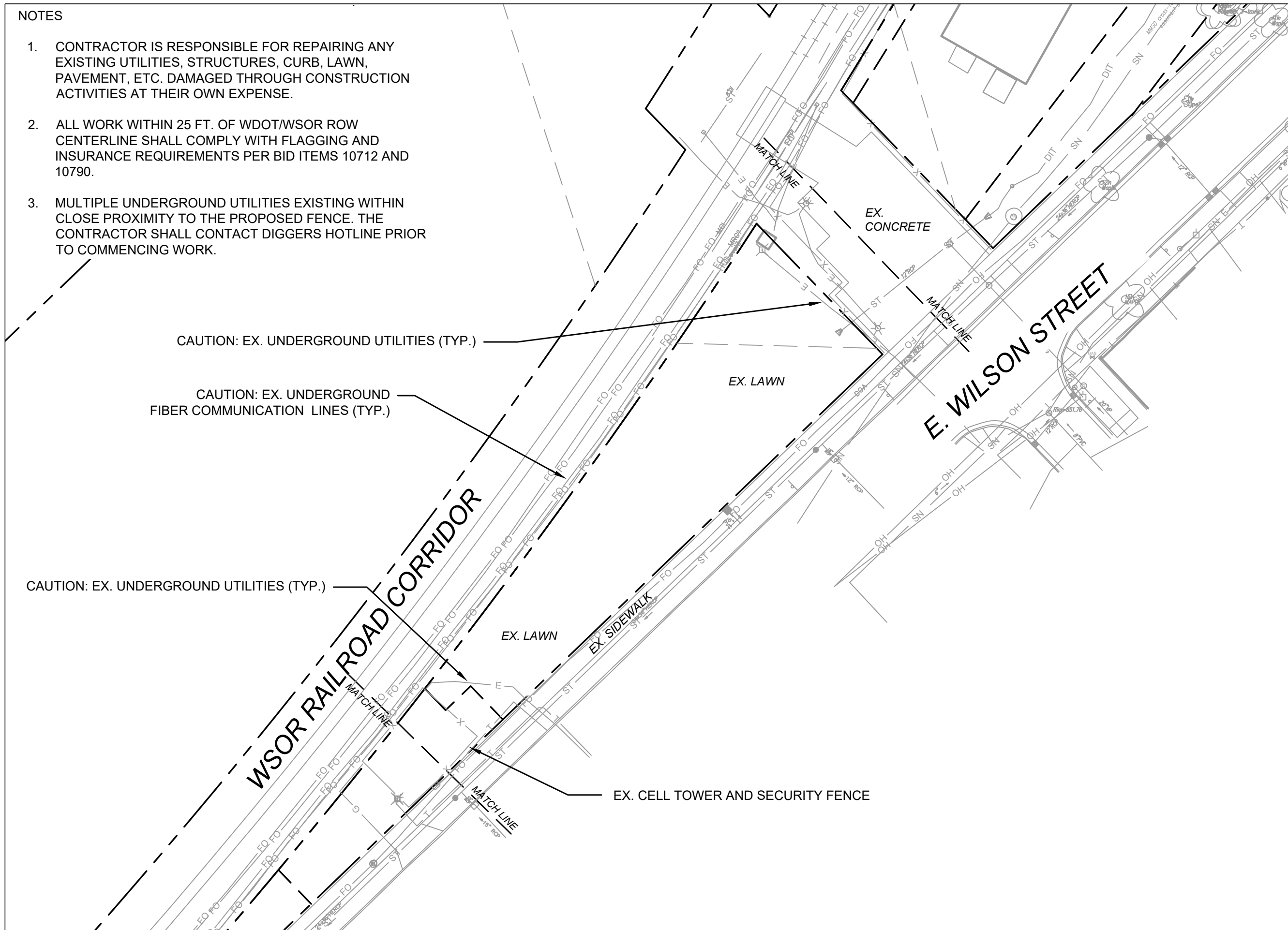

City of Madison
 Department of Public Works
PARKS DIVISION
 City-County Building, Suite 104
 210 Martin Luther King, Jr. Blvd.
 Madison, WI 53703

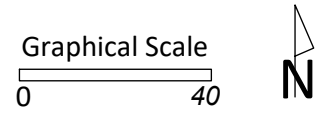

PROJECT:
*McPIKE PARK
 FENCE INSTALLATION
 AND SITE
 RESTORATION*

PROJECT ADDRESS:
*202 S. INGERSOLL ST.
 MADISON, WI 53703*

Although every effort has been made in preparing these plans and checking them for accuracy, the contractor and subcontractors must check all details and dimensions of their trade and be responsible for the same.

ITEM	DATE
ADVERTISED TO BID	2020-07-02

PUBLIC WORKS PROJECT #:
8922

SHEET TITLE:
*EXISTING SITE
 CONDITIONS - AREA 3*

SHEET NUMBER:
1.4

NOTES

1. CONTRACTOR IS RESPONSIBLE FOR REPAIRING ANY EXISTING UTILITIES, STRUCTURES, CURB, LAWN, PAVEMENT, ETC. DAMAGED THROUGH CONSTRUCTION ACTIVITIES AT THEIR OWN EXPENSE.
2. ALL WORK WITHIN 25 FT. OF WDOT/WSOR ROW CENTERLINE SHALL COMPLY WITH FLAGGING AND INSURANCE REQUIREMENTS PER BID ITEMS 10712 AND 10790.
3. MULTIPLE UNDERGROUND UTILITIES EXISTING WITHIN CLOSE PROXIMITY TO THE PROPOSED FENCE. THE CONTRACTOR SHALL CONTACT DIGGERS HOTLINE PRIOR TO COMMENCING WORK.

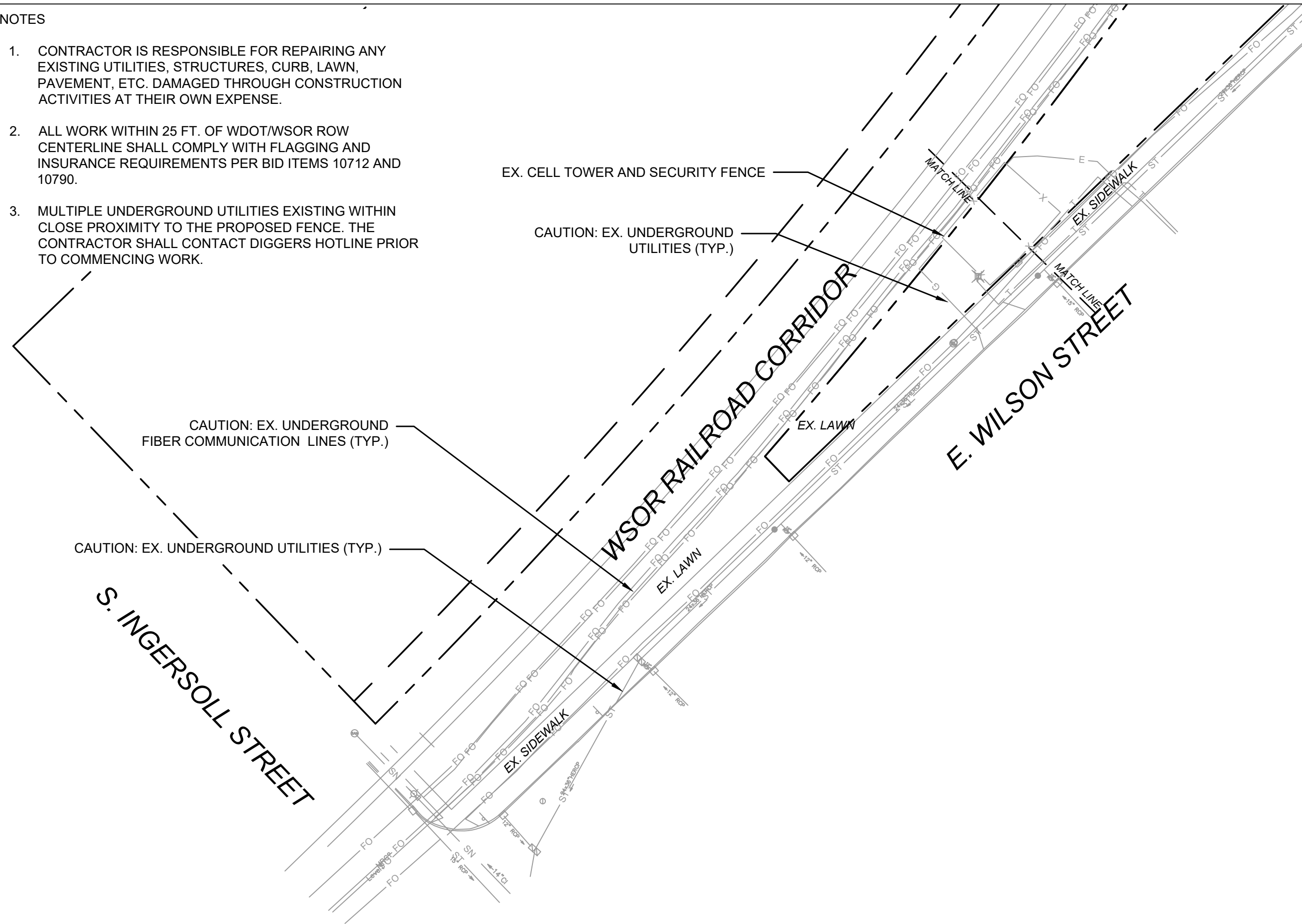

City of Madison
 Department of Public Works
PARKS DIVISION
 City-County Building, Suite 104
 210 Martin Luther King, Jr. Blvd.
 Madison, WI 53703



PROJECT:
*McPIKE PARK
 FENCE INSTALLATION
 AND SITE
 RESTORATION*

PROJECT ADDRESS:
*202 S. INGERSOLL ST.
 MADISON, WI 53703*

Although every effort has been made in preparing these plans and checking them for accuracy, the contractor and subcontractors must check all details and dimensions of their trade and be responsible for the same.

ITEM	DATE
ADVERTISED TO BID	2020-07-02

PUBLIC WORKS PROJECT #:
8922



SHEET TITLE:
*EXISTING SITE
 CONDITIONS - AREA 4*

SHEET NUMBER:
1.5

NOTES

1. CONTRACTOR IS RESPONSIBLE FOR REPAIRING ANY EXISTING UTILITIES, STRUCTURES, CURB, LAWN, PAVEMENT, ETC. DAMAGED THROUGH CONSTRUCTION ACTIVITIES AT THEIR OWN EXPENSE.
2. ALL WORK WITHIN 25 FT. OF WDOT/WSOR ROW CENTERLINE SHALL COMPLY WITH FLAGGING AND INSURANCE REQUIREMENTS PER BID ITEMS 10712 AND 10790.
3. MULTIPLE UNDERGROUND UTILITIES EXISTING WITHIN CLOSE PROXIMITY TO THE PROPOSED FENCE. THE CONTRACTOR SHALL CONTACT DIGGERS HOTLINE PRIOR TO COMMENCING WORK.
4. THE CONTRACTOR SHALL PROCEED WITH NECESSARY CAUTION TO AVOID DAMAGING EXISTING UTILITIES. FENCE FOOTING EXCAVATION MAY REQUIRE H-VAC AND/OR HAND EXCAVATION PER THE CONTRACTOR'S DISCRETION.

LEGEND

-  EX. ASPHALT REMOVAL AND EXCAVATION
-  INLET PROTECTION, TYPE D, COMPLETE

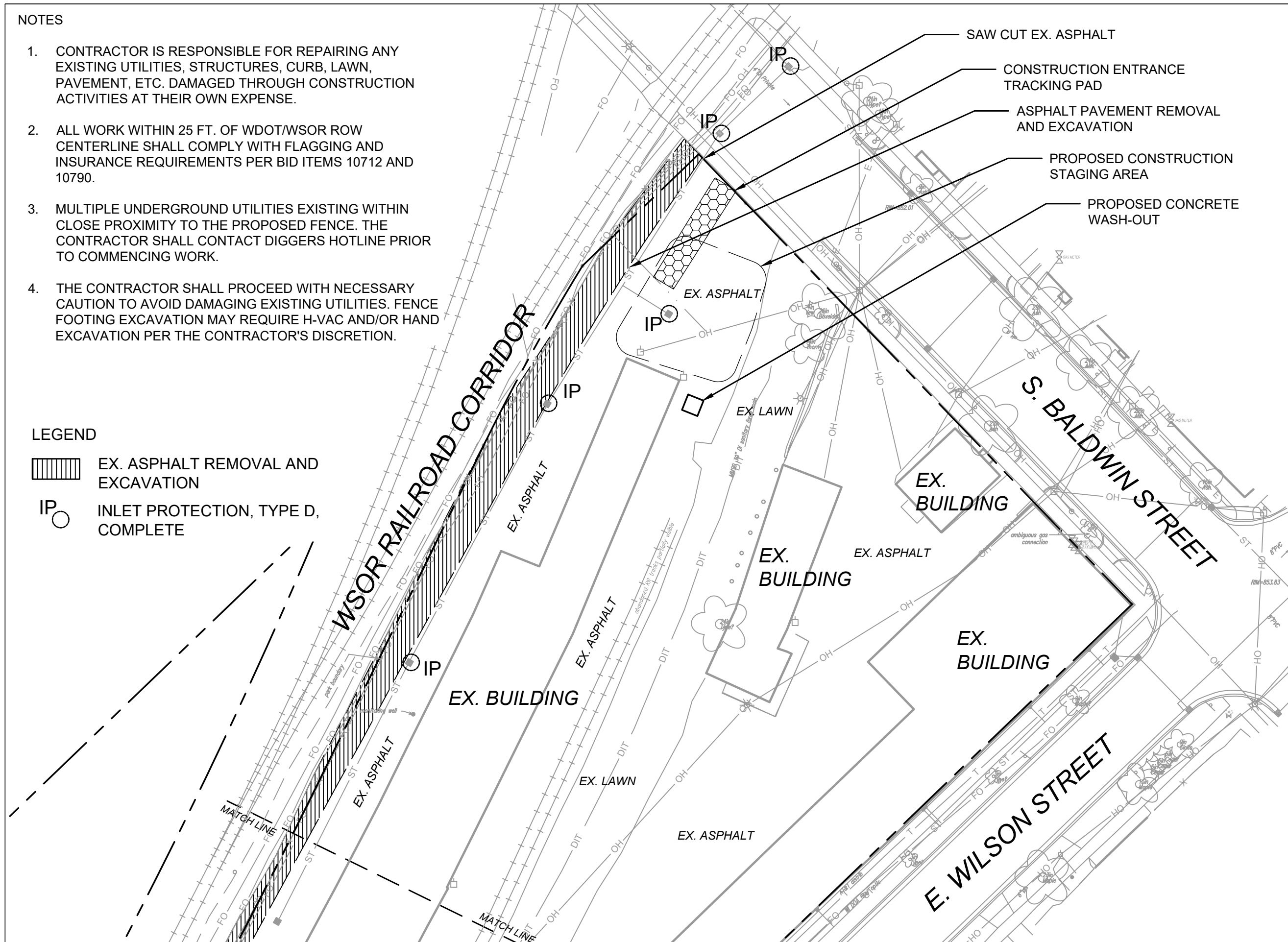

City of Madison
 Department of Public Works
PARKS DIVISION
 City-County Building, Suite 104
 210 Martin Luther King, Jr. Blvd.
 Madison, WI 53703

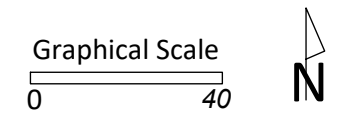

PROJECT:
*McPIKE PARK
 FENCE INSTALLATION
 AND SITE
 RESTORATION*

PROJECT ADDRESS:
*202 S. INGERSOLL ST.
 MADISON, WI 53703*

Although every effort has been made in preparing these plans and checking them for accuracy, the contractor and subcontractors must check all details and dimensions of their trade and be responsible for the same.

ITEM	DATE
ADVERTISED TO BID	2020-07-02

PUBLIC WORKS PROJECT #:
8922



SHEET TITLE:
**DEMOLITION AND
 SITE PROTECTION -
 AREA 1**

SHEET NUMBER:
2.1

NOTES

1. CONTRACTOR IS RESPONSIBLE FOR REPAIRING ANY EXISTING UTILITIES, STRUCTURES, CURB, LAWN, PAVEMENT, ETC. DAMAGED THROUGH CONSTRUCTION ACTIVITIES AT THEIR OWN EXPENSE.
2. ALL WORK WITHIN 25 FT. OF WDOT/WSOR ROW CENTERLINE SHALL COMPLY WITH FLAGGING AND INSURANCE REQUIREMENTS PER BID ITEMS 10712 AND 10790.
3. MULTIPLE UNDERGROUND UTILITIES EXISTING WITHIN CLOSE PROXIMITY TO THE PROPOSED FENCE. THE CONTRACTOR SHALL CONTACT DIGGERS HOTLINE PRIOR TO COMMENCING WORK.
4. THE CONTRACTOR SHALL PROCEED WITH NECESSARY CAUTION TO AVOID DAMAGING EXISTING UTILITIES. FENCE FOOTING EXCAVATION MAY REQUIRE H-VAC AND/OR HAND EXCAVATION PER THE CONTRACTOR'S DISCRETION.
5. ALL DISTURBED AREAS TO RECEIVE TURF SHALL BE SEEDED AND MATTED PER BID ITEMS 21071, 21061 AND 21071.

LEGEND

-  EX. ASPHALT REMOVAL AND EXCAVATION
-  INLET PROTECTION, TYPE D, COMPLETE

City of Madison
 Department of Public Works
PARKS DIVISION
 City-County Building, Suite 104
 210 Martin Luther King, Jr. Blvd.
 Madison, WI 53703

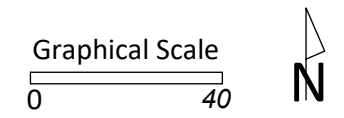

PROJECT:
*McPIKE PARK
 FENCE INSTALLATION
 AND SITE
 RESTORATION*

PROJECT ADDRESS:
*202 S. INGERSOLL ST.
 MADISON, WI 53703*

Although every effort has been made in preparing these plans and checking them for accuracy, the contractor and subcontractors must check all details and dimensions of their trade and be responsible for the same.

ITEM	DATE
ADVERTISED TO BID	2020-07-02

PUBLIC WORKS PROJECT #:
 8922

SHEET TITLE:
*DEMOLITION AND
 SITE PROTECTION -
 AREA 2*

SHEET NUMBER:
2.2

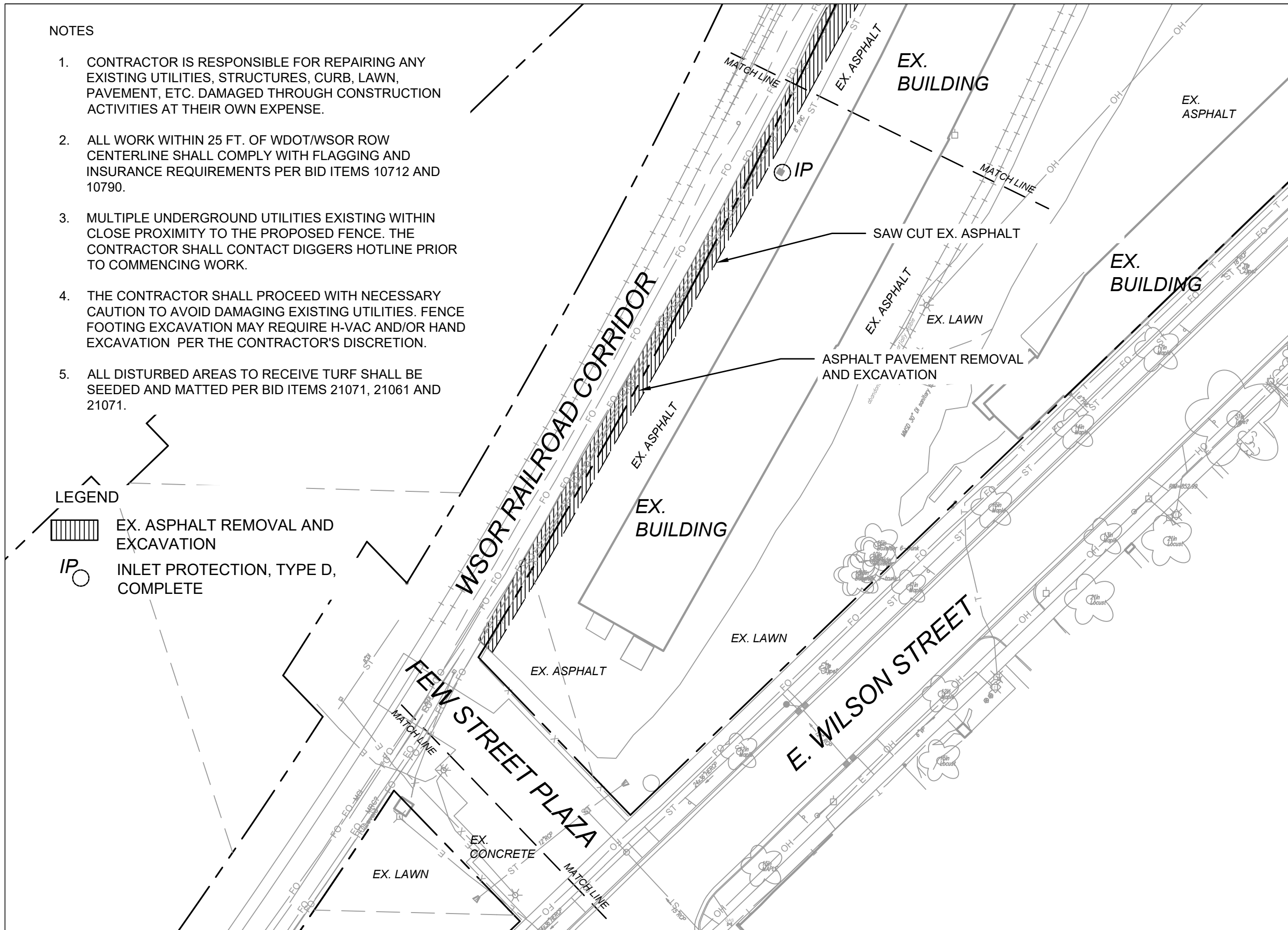

NOTES

1. CONTRACTOR IS RESPONSIBLE FOR REPAIRING ANY EXISTING UTILITIES, STRUCTURES, CURB, LAWN, PAVEMENT, ETC. DAMAGED THROUGH CONSTRUCTION ACTIVITIES AT THEIR OWN EXPENSE.
2. ALL WORK WITHIN 25 FT. OF WDOT/WSOR ROW CENTERLINE SHALL COMPLY WITH FLAGGING AND INSURANCE REQUIREMENTS PER BID ITEMS 10712 AND 10790.
3. MULTIPLE UNDERGROUND UTILITIES EXISTING WITHIN CLOSE PROXIMITY TO THE PROPOSED FENCE. THE CONTRACTOR SHALL CONTACT DIGGERS HOTLINE PRIOR TO COMMENCING WORK.
4. THE CONTRACTOR SHALL PROCEED WITH NECESSARY CAUTION TO AVOID DAMAGING EXISTING UTILITIES. FENCE FOOTING EXCAVATION MAY REQUIRE H-VAC AND/OR HAND EXCAVATION PER THE CONTRACTOR'S DISCRETION.
5. ALL DISTURBED AREAS TO RECEIVE TURF SHALL BE SEEDED AND MATTED PER BID ITEMS 21071, 21061 AND 21071.

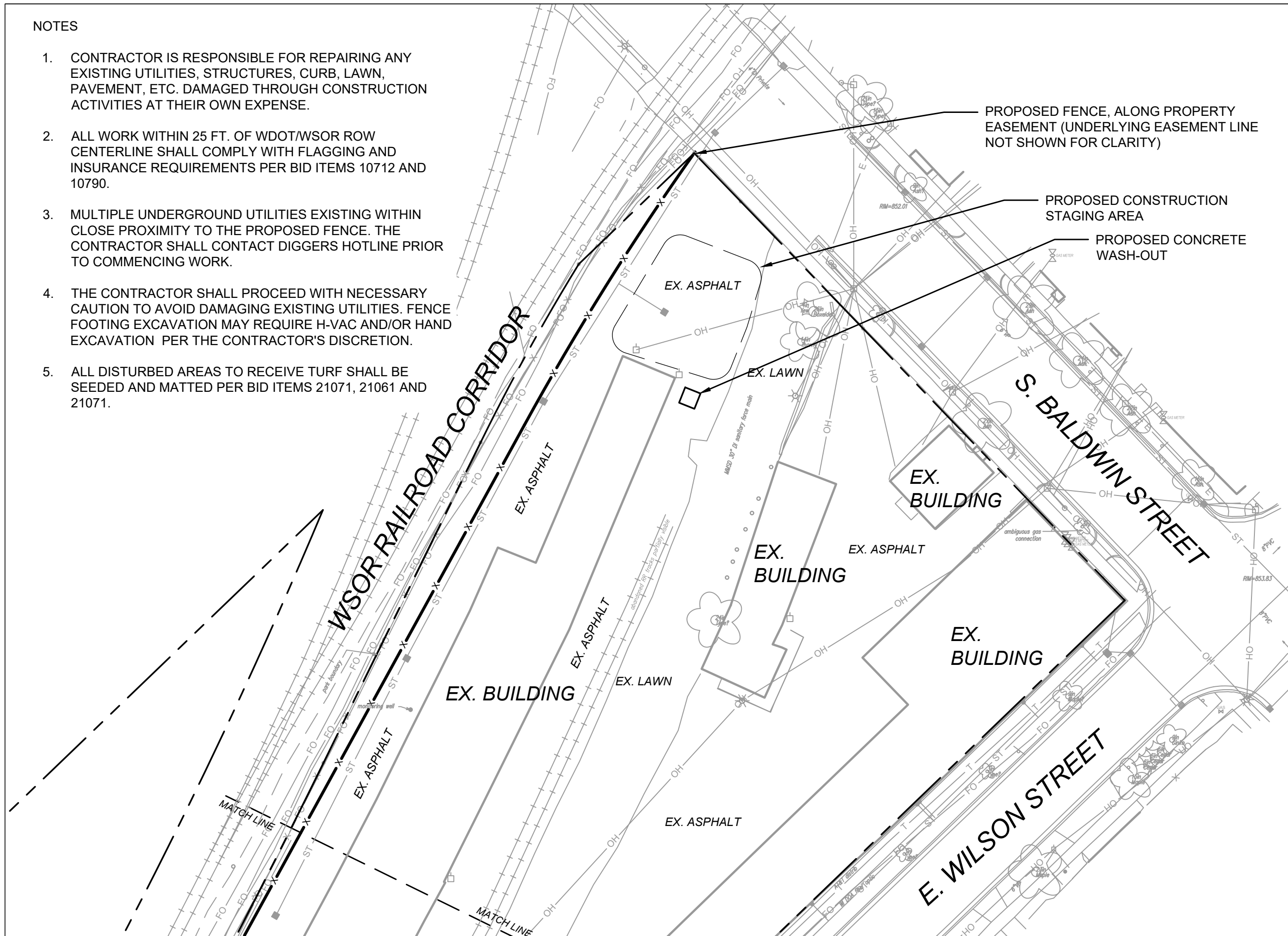

City of Madison
 Department of Public Works
PARKS DIVISION
 City-County Building, Suite 104
 210 Martin Luther King, Jr. Blvd.
 Madison, WI 53703

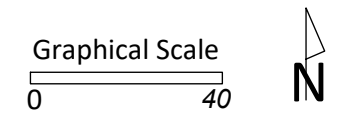

PROJECT:
*McPIKE PARK
 FENCE INSTALLATION
 AND SITE
 RESTORATION*

PROJECT ADDRESS:
*202 S. INGERSOLL ST.
 MADISON, WI 53703*

Although every effort has been made in preparing these plans and checking them for accuracy, the contractor and subcontractors must check all details and dimensions of their trade and be responsible for the same.

ITEM	DATE
ADVERTISED TO BID	2020-07-02

PUBLIC WORKS PROJECT #:
8922

SHEET TITLE:
*FENCE INSTALLATION -
 AREA 1*

SHEET NUMBER:
3.1

NOTES

1. CONTRACTOR IS RESPONSIBLE FOR REPAIRING ANY EXISTING UTILITIES, STRUCTURES, CURB, LAWN, PAVEMENT, ETC. DAMAGED THROUGH CONSTRUCTION ACTIVITIES AT THEIR OWN EXPENSE.
2. ALL WORK WITHIN 25 FT. OF WDOT/WSOR ROW CENTERLINE SHALL COMPLY WITH FLAGGING AND INSURANCE REQUIREMENTS PER BID ITEMS 10712 AND 10790.
3. MULTIPLE UNDERGROUND UTILITIES EXISTING WITHIN CLOSE PROXIMITY TO THE PROPOSED FENCE. THE CONTRACTOR SHALL CONTACT DIGGERS HOTLINE PRIOR TO COMMENCING WORK.
4. THE CONTRACTOR SHALL PROCEED WITH NECESSARY CAUTION TO AVOID DAMAGING EXISTING UTILITIES. FENCE FOOTING EXCAVATION MAY REQUIRE H-VAC AND/OR HAND EXCAVATION PER THE CONTRACTOR'S DISCRETION.
5. ALL DISTURBED AREAS TO RECEIVE TURF SHALL BE SEEDED AND MATTED PER BID ITEMS 21071, 21061 AND 21071.

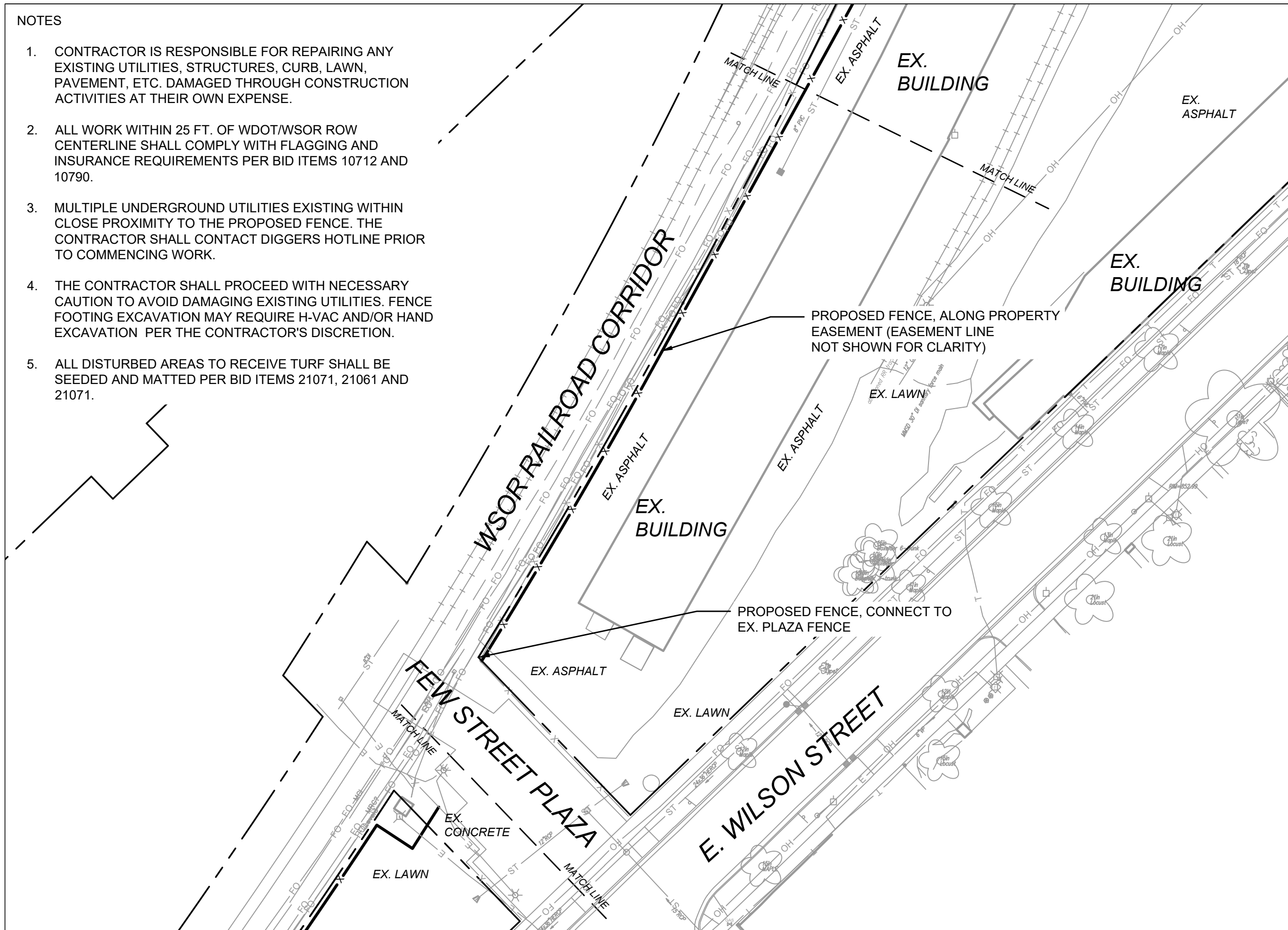

City of Madison
 Department of Public Works
PARKS DIVISION
 City-County Building, Suite 104
 210 Martin Luther King, Jr. Blvd.
 Madison, WI 53703

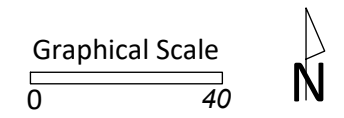

PROJECT:
*McPIKE PARK
 FENCE INSTALLATION
 AND SITE
 RESTORATION*

PROJECT ADDRESS:
*202 S. INGERSOLL ST.
 MADISON, WI 53703*

Although every effort has been made in preparing these plans and checking them for accuracy, the contractor and subcontractors must check all details and dimensions of their trade and be responsible for the same.

ITEM	DATE
ADVERTISED TO BID	2020-07-02

PUBLIC WORKS PROJECT #:
8922

SHEET TITLE:
*FENCE INSTALLATION -
 AREA 2*

SHEET NUMBER:
3.2

NOTES

1. CONTRACTOR IS RESPONSIBLE FOR REPAIRING ANY EXISTING UTILITIES, STRUCTURES, CURB, LAWN, PAVEMENT, ETC. DAMAGED THROUGH CONSTRUCTION ACTIVITIES AT THEIR OWN EXPENSE.
2. ALL WORK WITHIN 25 FT. OF WDOT/WSOR ROW CENTERLINE SHALL COMPLY WITH FLAGGING AND INSURANCE REQUIREMENTS PER BID ITEMS 10712 AND 10790.
3. MULTIPLE UNDERGROUND UTILITIES EXISTING WITHIN CLOSE PROXIMITY TO THE PROPOSED FENCE. THE CONTRACTOR SHALL CONTACT DIGGERS HOTLINE PRIOR TO COMMENCING WORK.
4. THE CONTRACTOR SHALL PROCEED WITH NECESSARY CAUTION TO AVOID DAMAGING EXISTING UTILITIES. FENCE FOOTING EXCAVATION MAY REQUIRE H-VAC AND/OR HAND EXCAVATION PER THE CONTRACTOR'S DISCRETION.
5. ALL DISTURBED AREAS TO RECEIVE TURF SHALL BE SEEDED AND MATTED PER BID ITEMS 21071, 21061 AND 21071.

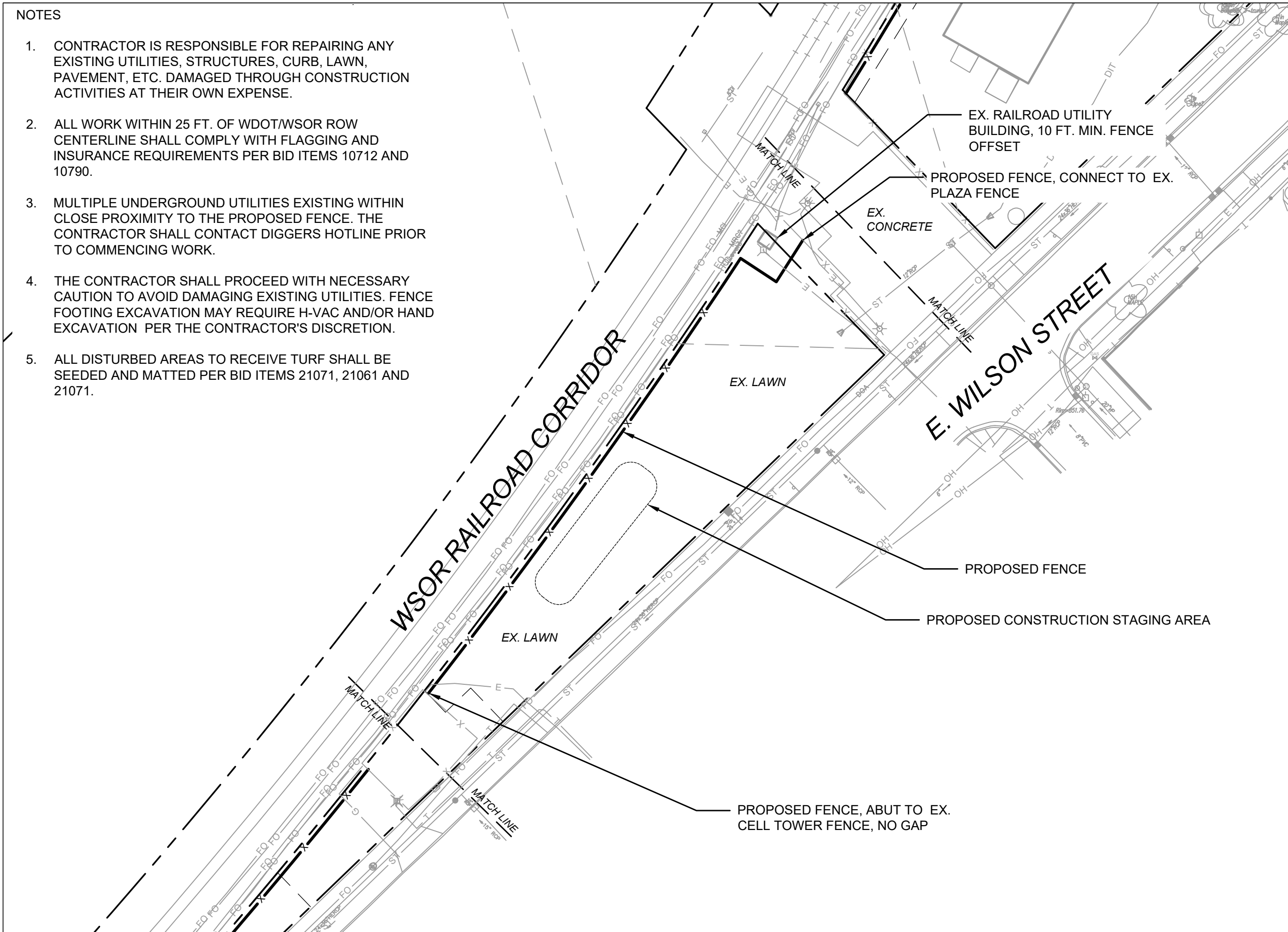

City of Madison
Department of Public Works
PARKS DIVISION

City-County Building, Suite 104
210 Martin Luther King, Jr. Blvd.
Madison, WI 53703



Graphical Scale

0 40



PROJECT:

*McPIKE PARK
FENCE INSTALLATION
AND SITE
RESTORATION*

PROJECT ADDRESS:

*202 S. INGERSOLL ST.
MADISON, WI 53703*

Although every effort has been made in preparing these plans and checking them for accuracy, the contractor and subcontractors must check all details and dimensions of their trade and be responsible for the same.

ITEM	DATE
ADVERTISED TO BID	2020-07-02

PUBLIC WORKS PROJECT #:
8922

SHEET TITLE:
*FENCE INSTALLATION -
AREA 3*

SHEET NUMBER:
3.3

NOTES

1. CONTRACTOR IS RESPONSIBLE FOR REPAIRING ANY EXISTING UTILITIES, STRUCTURES, CURB, LAWN, PAVEMENT, ETC. DAMAGED THROUGH CONSTRUCTION ACTIVITIES AT THEIR OWN EXPENSE.
2. ALL WORK WITHIN 25 FT. OF WDOT/WSOR ROW CENTERLINE SHALL COMPLY WITH FLAGGING AND INSURANCE REQUIREMENTS PER BID ITEMS 10712 AND 10790.
3. MULTIPLE UNDERGROUND UTILITIES EXISTING WITHIN CLOSE PROXIMITY TO THE PROPOSED FENCE. THE CONTRACTOR SHALL CONTACT DIGGERS HOTLINE PRIOR TO COMMENCING WORK.
4. THE CONTRACTOR SHALL PROCEED WITH NECESSARY CAUTION TO AVOID DAMAGING EXISTING UTILITIES. FENCE FOOTING EXCAVATION MAY REQUIRE H-VAC AND/OR HAND EXCAVATION PER THE CONTRACTOR'S DISCRETION.
5. ALL DISTURBED AREAS TO RECEIVE TURF SHALL BE SEEDED AND MATTED PER BID ITEMS 21071, 21061 AND 21071.

S. INGERSOLL STREET

PROPOSED FENCE, ABUT TO EXISTING CELL TOWER FENCE, NO GAP

WSOR RAILROAD CORRIDOR

E. WILSON STREET

PROPOSED FENCE TO FOLLOW PROPERTY BOUNDARY

PROPOSED FENCE

ULO - EX. FIBER CONDIUT

PROPOSED FENCE ALIGNMENT, FIELD ADJUST TO SPAN EXISTING FIBER LINES

END OF PROPOSED FENCE

City of Madison
 Department of Public Works
PARKS DIVISION
 City-County Building, Suite 104
 210 Martin Luther King, Jr. Blvd.
 Madison, WI 53703

play
MADISON
PARKS

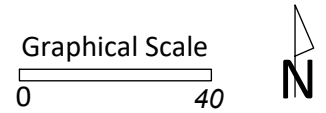

PROJECT:
*McPIKE PARK
 FENCE INSTALLATION
 AND SITE
 RESTORATION*

PROJECT ADDRESS:
*202 S. INGERSOLL ST.
 MADISON, WI 53703*

Although every effort has been made in preparing these plans and checking them for accuracy, the contractor and subcontractors must check all details and dimensions of their trade and be responsible for the same.

ITEM	DATE
ADVERTISED TO BID	2020-07-02

PUBLIC WORKS PROJECT #:
 8922

SHEET TITLE:
**FENCE INSTALLATION -
 AREA 4**

SHEET NUMBER:
3.4

NOTES

1. CONTRACTOR IS RESPONSIBLE FOR REPAIRING ANY EXISTING UTILITIES, STRUCTURES, CURB, LAWN, PAVEMENT, ETC. DAMAGED THROUGH CONSTRUCTION ACTIVITIES AT THEIR OWN EXPENSE.
2. ALL WORK WITHIN 25 FT. OF WDOT/WSOR ROW CENTERLINE SHALL COMPLY WITH FLAGGING AND INSURANCE REQUIREMENTS PER BID ITEMS 10712 AND 10790.
3. MULTIPLE UNDERGROUND UTILITIES EXISTING WITHIN CLOSE PROXIMITY TO THE PROPOSED FENCE. THE CONTRACTOR SHALL CONTACT DIGGERS HOTLINE PRIOR TO COMMENCING WORK.
4. THE CONTRACTOR SHALL PROCEED WITH NECESSARY CAUTION TO AVOID DAMAGING EXISTING UTILITIES. FENCE FOOTING EXCAVATION MAY REQUIRE H-VAC AND/OR HAND EXCAVATION PER THE CONTRACTOR'S DISCRETION.
5. ALL DISTURBED AREAS TO RECEIVE TURF SHALL BE SEEDED AND MATTED PER BID ITEMS 21071, 21061 AND 21071.
6. SITE GRADING SHALL BE RESTORED TO PREVIOUS ELEVATION AND DRAINAGE

LEGEND

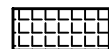
 SITE RESTORATION AREA: INCLUDES PLACEMENT OF CLEAN FILL, TOPSOIL, SEEDING AND EROSION MAT

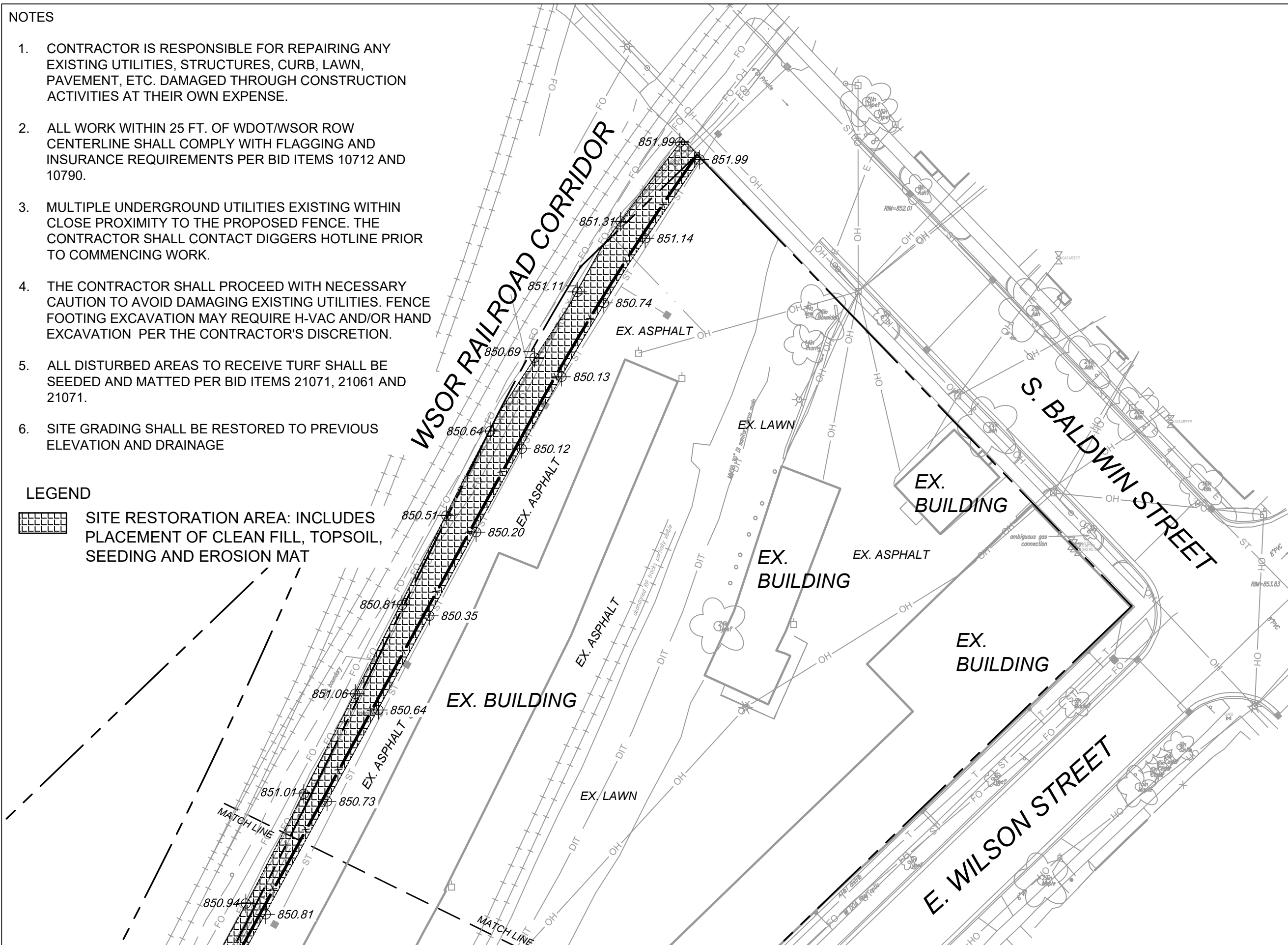

City of Madison
 Department of Public Works
PARKS DIVISION
 City-County Building, Suite 104
 210 Martin Luther King, Jr. Blvd.
 Madison, WI 53703

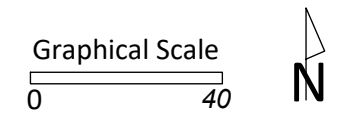

PROJECT:
*McPIKE PARK
 FENCE INSTALLATION
 AND SITE
 RESTORATION*

PROJECT ADDRESS:
*202 S. INGERSOLL ST.
 MADISON, WI 53703*

Although every effort has been made in preparing these plans and checking them for accuracy, the contractor and subcontractors must check all details and dimensions of their trade and be responsible for the same.

ITEM	DATE
ADVERTISED TO BID	2020-07-02

PUBLIC WORKS PROJECT #:
8922

SHEET TITLE:
**SITE RESTORATION -
 AREA 1**

SHEET NUMBER:
4.1

NOTES

1. CONTRACTOR IS RESPONSIBLE FOR REPAIRING ANY EXISTING UTILITIES, STRUCTURES, CURB, LAWN, PAVEMENT, ETC. DAMAGED THROUGH CONSTRUCTION ACTIVITIES AT THEIR OWN EXPENSE.
2. ALL WORK WITHIN 25 FT. OF WDOT/WSOR ROW CENTERLINE SHALL COMPLY WITH FLAGGING AND INSURANCE REQUIREMENTS PER BID ITEMS 10712 AND 10790.
3. MULTIPLE UNDERGROUND UTILITIES EXISTING WITHIN CLOSE PROXIMITY TO THE PROPOSED FENCE. THE CONTRACTOR SHALL CONTACT DIGGERS HOTLINE PRIOR TO COMMENCING WORK.
4. THE CONTRACTOR SHALL PROCEED WITH NECESSARY CAUTION TO AVOID DAMAGING EXISTING UTILITIES. FENCE FOOTING EXCAVATION MAY REQUIRE H-VAC AND/OR HAND EXCAVATION PER THE CONTRACTOR'S DISCRETION.
5. ALL DISTURBED AREAS TO RECEIVE TURF SHALL BE SEEDED AND MATTED PER BID ITEMS 21071, 21061 AND 21071.
6. SITE GRADING SHALL BE RESTORED TO PREVIOUS ELEVATION AND DRAINAGE

LEGEND



SITE RESTORATION AREA: INCLUDES PLACING CLEAN FILL, TOPSOIL, SEEDING AND EROSION MAT

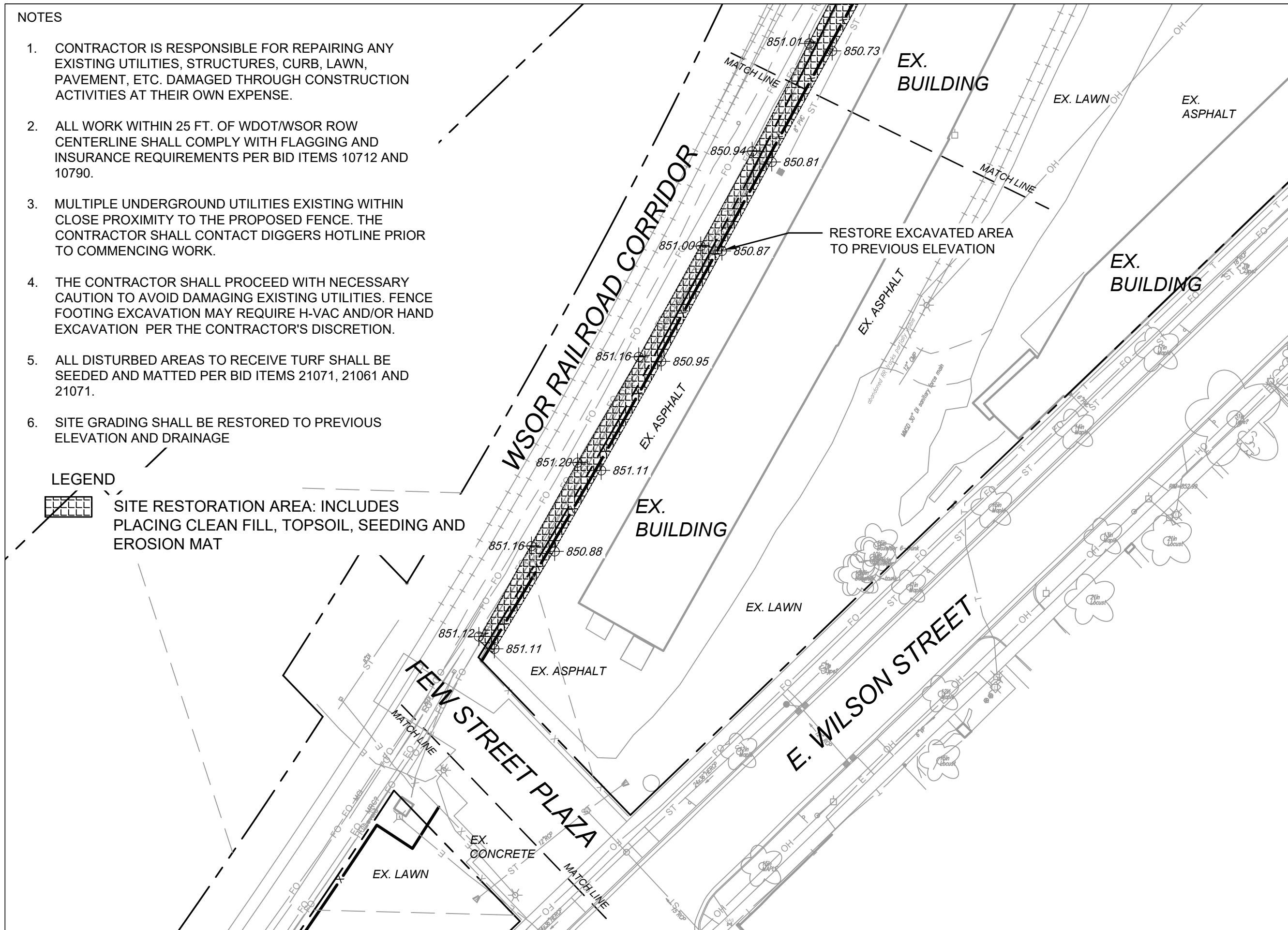

City of Madison
 Department of Public Works
PARKS DIVISION
 City-County Building, Suite 104
 210 Martin Luther King, Jr. Blvd.
 Madison, WI 53703

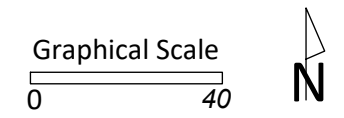

PROJECT:
*McPIKE PARK
 FENCE INSTALLATION
 AND SITE
 RESTORATION*

PROJECT ADDRESS:
*202 S. INGERSOLL ST.
 MADISON, WI 53703*

Although every effort has been made in preparing these plans and checking them for accuracy, the contractor and subcontractors must check all details and dimensions of their trade and be responsible for the same.

ITEM	DATE
ADVERTISED TO BID	2020-07-02

PUBLIC WORKS PROJECT #:
 8922

SHEET TITLE:
*SITE RESTORATION -
 AREA 2*

SHEET NUMBER:
4.2

NOTES

1. CONTRACTOR IS RESPONSIBLE FOR REPAIRING ANY EXISTING UTILITIES, STRUCTURES, CURB, LAWN, PAVEMENT, ETC. DAMAGED THROUGH CONSTRUCTION ACTIVITIES AT THEIR OWN EXPENSE.
2. ALL WORK WITHIN 25 FT. OF WDOT/WSOR ROW CENTERLINE SHALL COMPLY WITH FLAGGING AND INSURANCE REQUIREMENTS PER BID ITEMS 10712 AND 10790.
3. MULTIPLE UNDERGROUND UTILITIES EXISTING WITHIN CLOSE PROXIMITY TO THE PROPOSED FENCE. THE CONTRACTOR SHALL CONTACT DIGGERS HOTLINE PRIOR TO COMMENCING WORK.
4. THE CONTRACTOR SHALL PROCEED WITH NECESSARY CAUTION TO AVOID DAMAGING EXISTING UTILITIES. FENCE FOOTING EXCAVATION MAY REQUIRE H-VAC AND/OR HAND EXCAVATION PER THE CONTRACTOR'S DISCRETION.
5. ALL DISTURBED AREAS SHALL BE SEEDED AND MATTED PER BID ITEMS 21071, 21061 AND 21071.

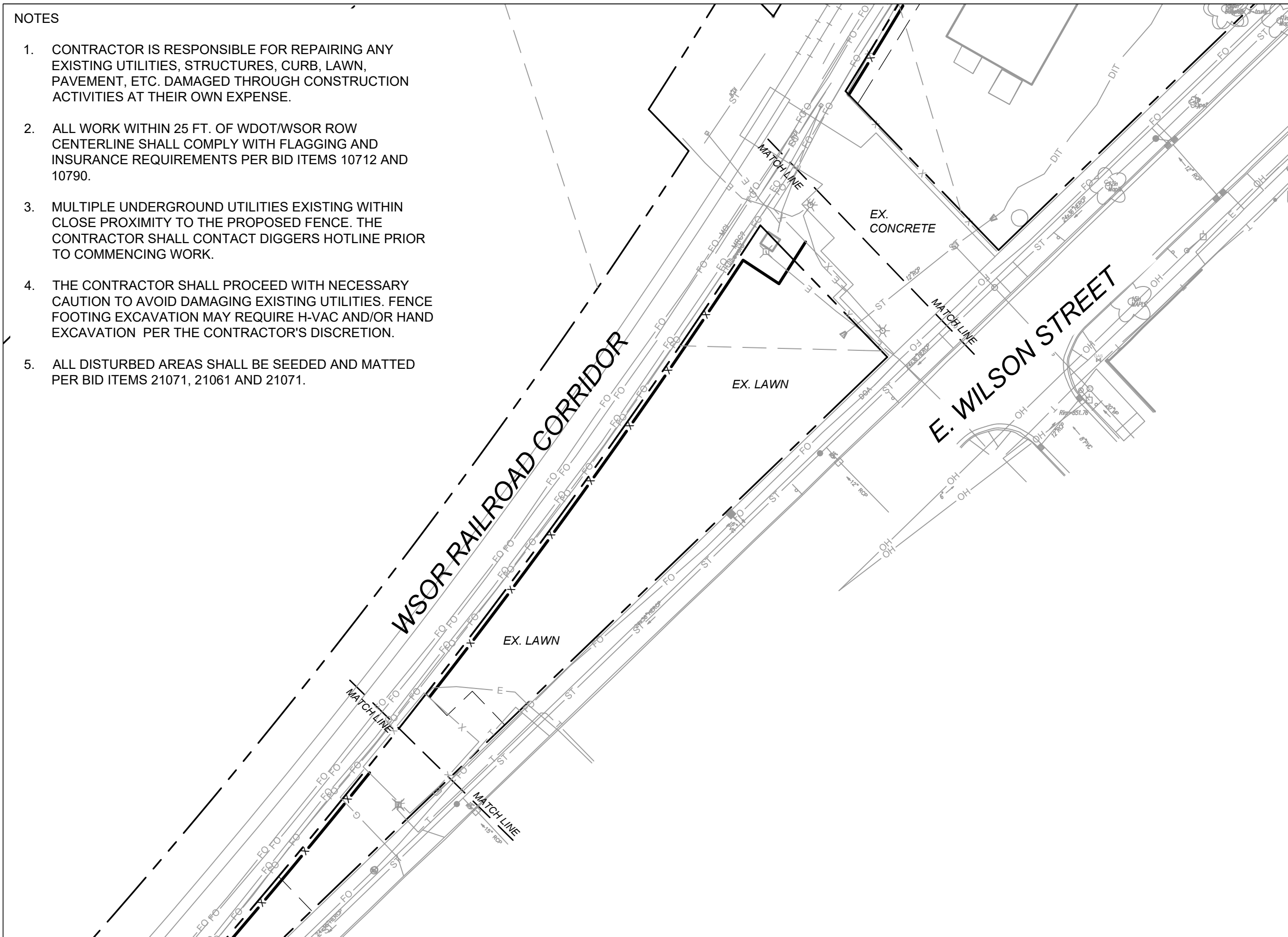

City of Madison
 Department of Public Works
PARKS DIVISION
 City-County Building, Suite 104
 210 Martin Luther King, Jr. Blvd.
 Madison, WI 53703

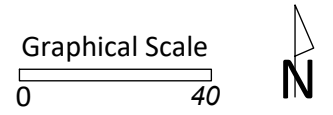

PROJECT:
*McPIKE PARK
 FENCE INSTALLATION
 AND SITE
 RESTORATION*

PROJECT ADDRESS:
*202 S. INGERSOLL ST.
 MADISON, WI 53703*

Although every effort has been made in preparing these plans and checking them for accuracy, the contractor and subcontractors must check all details and dimensions of their trade and be responsible for the same.

ITEM	DATE
ADVERTISED TO BID	2020-07-02

PUBLIC WORKS PROJECT #:
8922

SHEET TITLE:
*SITE RESTORATION -
 AREA 3*

SHEET NUMBER:
4.3

NOTES

1. CONTRACTOR IS RESPONSIBLE FOR REPAIRING ANY EXISTING UTILITIES, STRUCTURES, CURB, LAWN, PAVEMENT, ETC. DAMAGED THROUGH CONSTRUCTION ACTIVITIES AT THEIR OWN EXPENSE.
2. ALL WORK WITHIN 25 FT. OF WDOT/WSOR ROW CENTERLINE SHALL COMPLY WITH FLAGGING AND INSURANCE REQUIREMENTS PER BID ITEMS 10712 AND 10790.
3. MULTIPLE UNDERGROUND UTILITIES EXISTING WITHIN CLOSE PROXIMITY TO THE PROPOSED FENCE. THE CONTRACTOR SHALL CONTACT DIGGERS HOTLINE PRIOR TO COMMENCING WORK.
4. THE CONTRACTOR SHALL PROCEED WITH NECESSARY CAUTION TO AVOID DAMAGING EXISTING UTILITIES. FENCE FOOTING EXCAVATION MAY REQUIRE H-VAC AND/OR HAND EXCAVATION PER THE CONTRACTOR'S DISCRETION.
5. ALL DISTURBED AREAS SHALL BE SEEDED AND MATTED PER BID ITEMS 21071, 21061 AND 21071.

S. INGERSOLL STREET

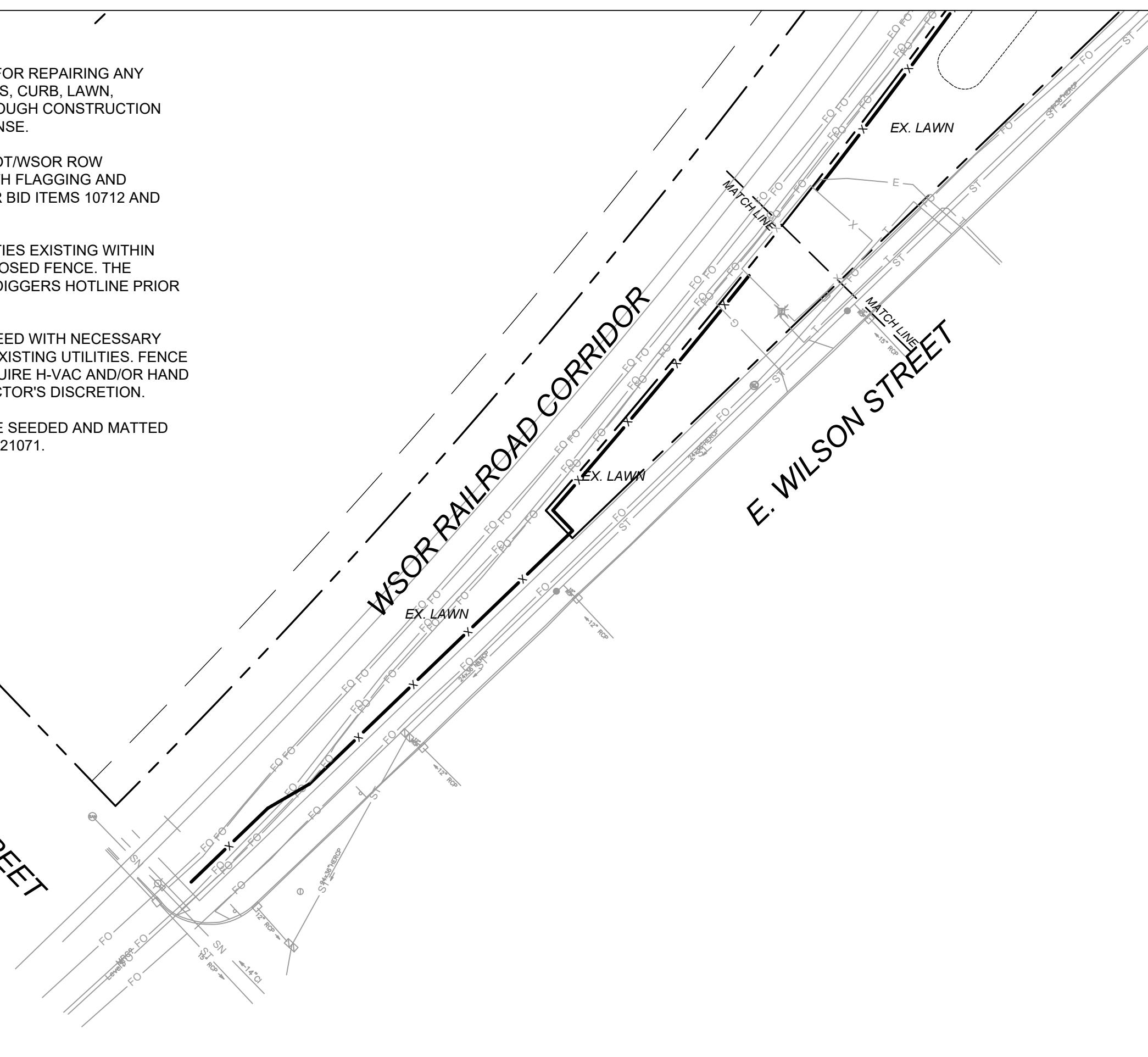

City of Madison
 Department of Public Works
PARKS DIVISION
 City-County Building, Suite 104
 210 Martin Luther King, Jr. Blvd.
 Madison, WI 53703

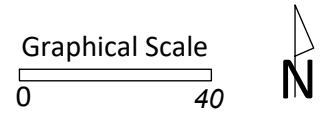

PROJECT:
*McPIKE PARK
 FENCE INSTALLATION
 AND SITE
 RESTORATION*

PROJECT ADDRESS:
*202 S. INGERSOLL ST.
 MADISON, WI 53703*

Although every effort has been made in preparing these plans and checking them for accuracy, the contractor and subcontractors must check all details and dimensions of their trade and be responsible for the same.

ITEM	DATE
ADVERTISED TO BID	2020-07-02

PUBLIC WORKS PROJECT #:
8922

SHEET TITLE:
*SITE RESTORATION -
 AREA 4*

SHEET NUMBER:
4.4

PROJECT:
**McPIKE PARK
 FENCE INSTALLATION
 AND SITE
 RESTORATION**

PROJECT ADDRESS:
**202 S. INGERSOLL ST.
 MADISON, WI 53703**

Although every effort has been made in preparing these plans and checking them for accuracy, the contractor and subcontractors must check all details and dimensions of their trade and be responsible for the same.

ITEM	DATE
ADVERTISED TO BID	2020-07-02

PUBLIC WORKS PROJECT #:
8922

SHEET TITLE:
FENCE DETAILS

SHEET NUMBER:
5.1

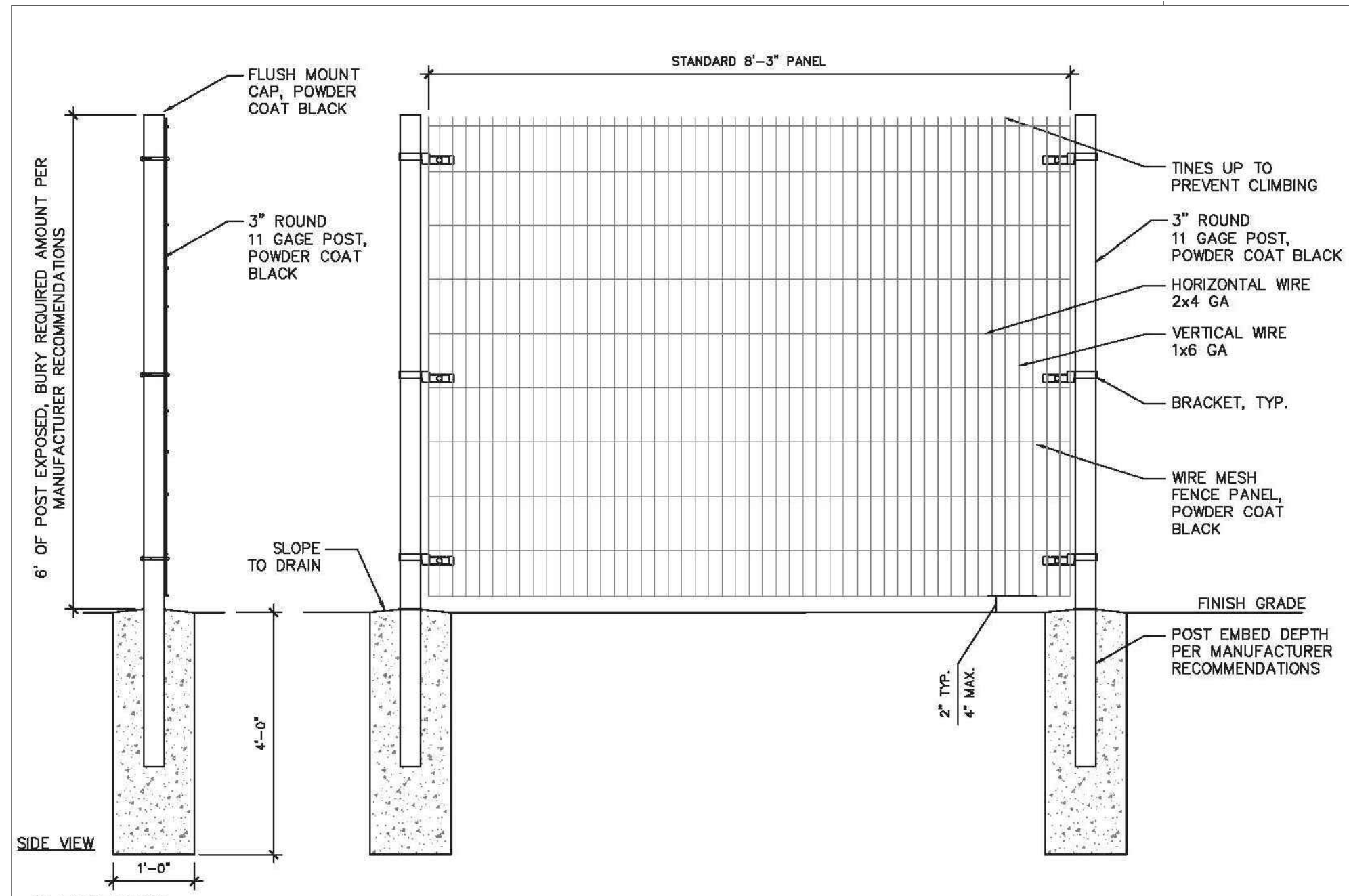

McPike Park Fence Installation and Site Restoration

City of Madison Public Works Contract
Date Revised: 6/18/2020

Notes:
Positive volumes are cuts, negative volumes are fills.
Not all parts of all surface models (Digital Terrain Models) are used for computations or intended for actual construction.

Sort	Grp	Material	Item	From Surface Model	To Surface Model	area (sq ft)	depth (ft)	Unfactored volume (cu ft)	Unfactored volume (cu yd)	Expansion Factor (%)	Factored (Uncompacted) Volume (cu yd)
1.1	Asphalt to Grass	Ex. Asphalt Excavate	Excavate 2" depth ex. asphalt	n/a	n/a	6882	0.17	1149.29	42.6	0%	42.6
1.2	Asphalt to Grass	Ex. Crushed Stone Excavate	Excavate 3" depth ex. crushed stone	n/a	n/a	6882	0.25	1720.50	63.7	0%	63.7
1.3	Asphalt to Grass	Subsoil Excavate	Excavate 7" depth ex. subsoil	n/a	n/a	6882	0.58	4012.21	148.6	0%	148.6
1.4	Asphalt to Grass	Subsoil Place	Place 6" subsoil	n/a	n/a	6882	-0.50	-3441.00	-127.4	0%	-127.4
1.5	Asphalt to Grass	Topsoil Place	Place 6" topsoil	n/a	n/a	6882	-0.50	-3441.00	-127.4	0%	-127.4
CHECK								0.00	0.0	0%	0.0

Computation Summary

Positive volumes are cuts (material available),
negative volumes are fills (material needed)

Row Labels	Sum of Factored (Uncompacted) Volume (cu yd)
Subsoil Place	-127.4
Topsoil Place	-127.4
Ex. Asphalt Excavate	42.6
Ex. Crushed Stone Excavate	63.7
Subsoil Excavate	148.6
Grand Total	0.0

Reorganized into bid table items

Bid Item	Quantity	Units	Relation to Table Above
20101 Excavation Cut	255	CY	= Ex.Asphalt Excavate + Ex. Crushed Stone Excavate + Subsoild Excavate
20202 Fill - Borrow	127	CY	= Subsoil Excavate + Subsoil Place
20221 Topsoil	763	SY	= (Topsoil Place)/-.167
90003 Stockpiling, Loading and Hauling of Solid Waste Materials	373.7	TON	= (Subsoil Excavate + fence post excavation (17.5 CY)) *2.25 TON/CY

City of Madison
Department of Public Works
PARKS DIVISION
City-County Building, Suite 104
210 Martin Luther King, Jr. Blvd.
Madison, WI 53703



PROJECT:
*McPIKE PARK
FENCE INSTALLATION
AND SITE
RESTORATION*

PROJECT ADDRESS:
*202 S. INGERSOLL ST.
MADISON, WI 53703*

Although every effort has been made in preparing these plans and checking them for accuracy, the contractor and subcontractors must check all details and dimensions of their trade and be responsible for the same.

ITEM DATE
ADVERTISED TO BID 2020-07-02

PUBLIC WORKS PROJECT #:
8922

SHEET TITLE:
*EARTHWORK
COMPUTATIONS*

SHEET NUMBER:
6.1