

Madison, Wisconsin

CITY OF MADISON

CITY ENGINEERING DIVISION

DEPARTMENT OF PUBLIC WORKS

PLAN OF PROPOSED IMPROVEMENT

PAUNACK PARK SHORELINE

INDEX OF SHEETS

SHEET NO. 1	PLAN (INCLUDING EROSION CONTROL)
SHEET NO. 2	DETAILS
SHEET NO. 3-4	CROSS-SECTIONS

CONVENTIONAL SIGNS	
FIELD VERIFY ALL UTILITY LOCATIONS	
GAS	— G —
STORM SEWER	— ST —
SANTARY SEWER	— SAN —
WATER	— W —
OVERHEAD ELECTRIC	— OH —
POWER POLE	— P —
HANDICAP RAMP	
COMBUSTIBLE FLUIDS	

CITY PROJECT NO. 53W1375

CONTRACT NO. 6834

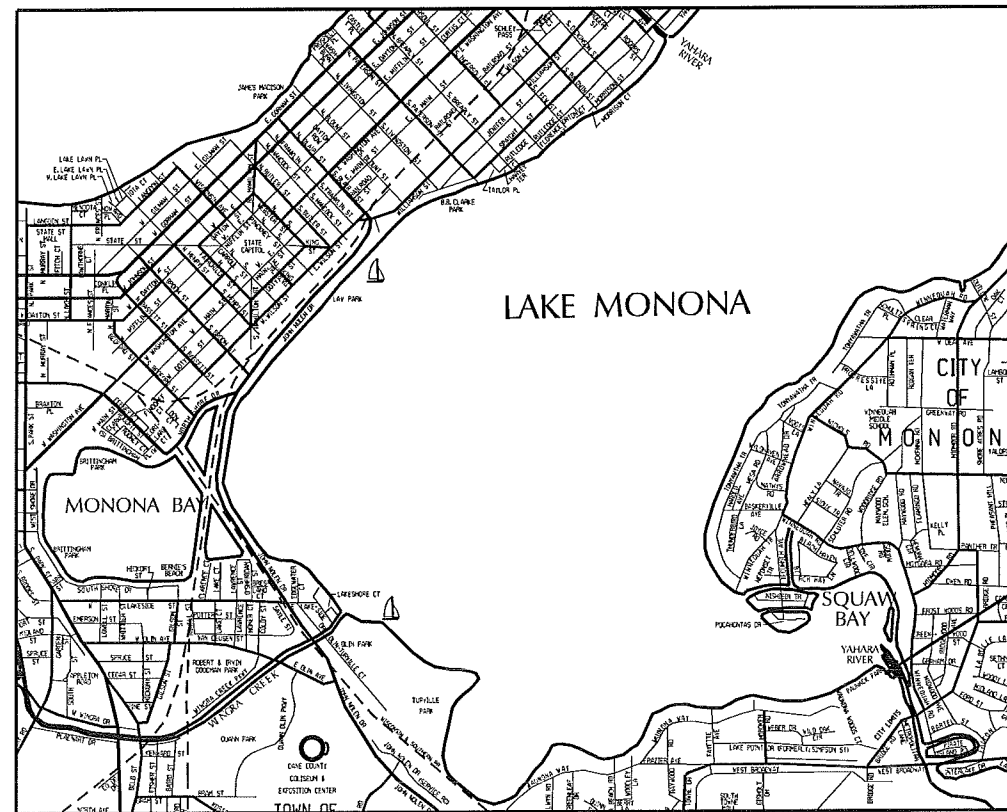

PROJECT LOCATION

PUBLIC IMPROVEMENT PROJECT APPROVED

DECEMBER 11, 2012

BY THE COMMON COUNCIL
OF MADISON, WISCONSIN

PUBLIC IMPROVEMENT DESIGN
APPROVED BY:

Michael R. Dailey 3/29/2013
City Engineer Date

STORM SEWER
APPROVED BY:

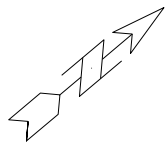

SCALE: 1" = 30'

NOTE:
PARK AREAS DISTURBED BY HAULING, BIKE PATH RESURFACING, OR STOCKPILING SHALL BE GRADED, TOPSOILED, SEEDED, AND PROTECTED WITH EROSION MATTING CLASS I URBAN TYPE A - ORGANIC. PAYMENT WILL BE PROVIDED UNDER THE APPROPRIATE BID ITEMS.

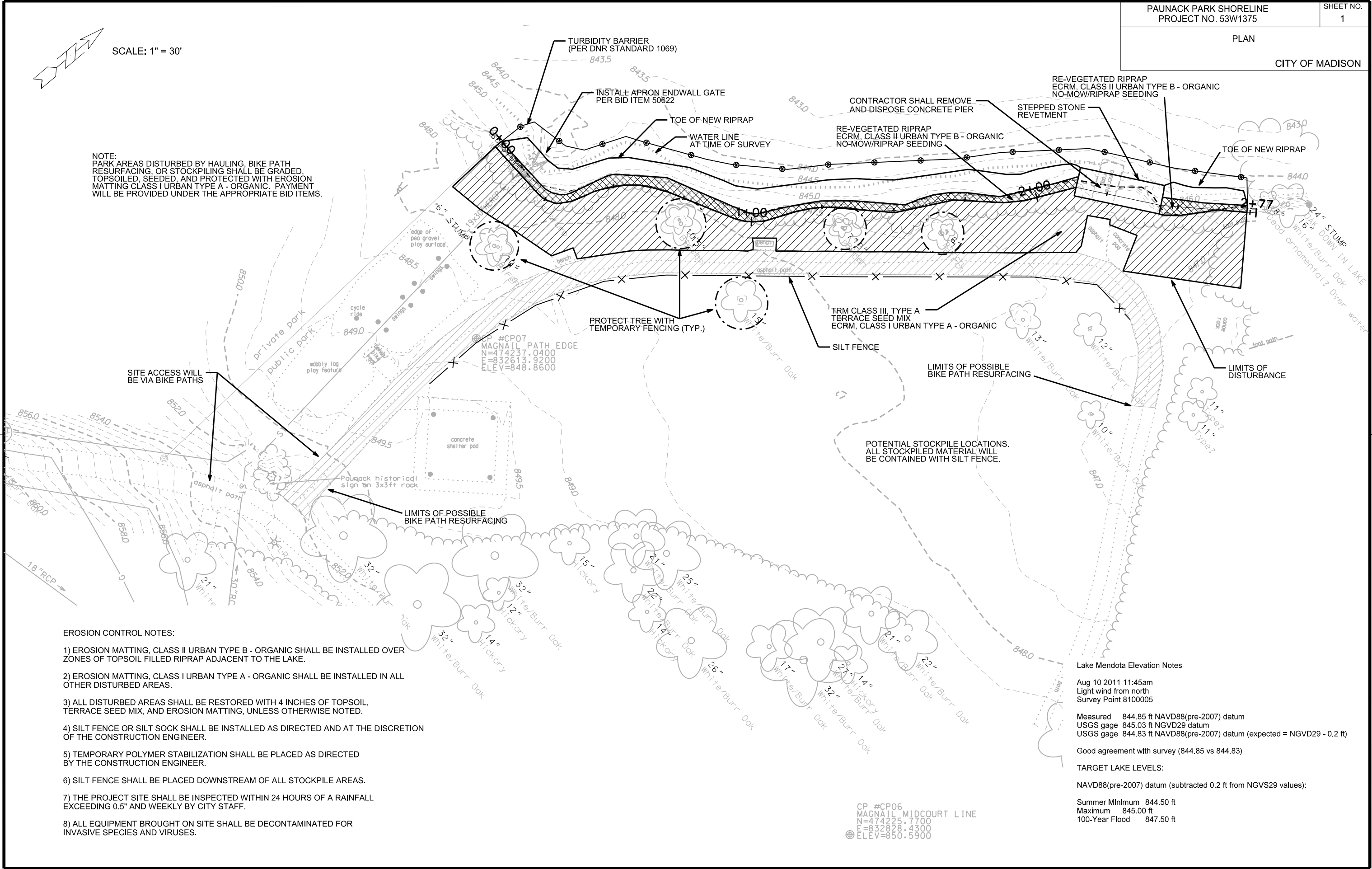

SITE ACCESS WILL BE VIA BIKE PATHS

PROTECT TREE WITH TEMPORARY FENCING (TYP.)

TRM CLASS III, TYPE A TERRACE SEED MIX
ECRM, CLASS I URBAN TYPE A - ORGANIC

LIMITS OF POSSIBLE BIKE PATH RESURFACING

LIMITS OF DISTURBANCE

POTENTIAL STOCKPILE LOCATIONS.
ALL STOCKPILED MATERIAL WILL BE CONTAINED WITH SILT FENCE.

LIMITS OF POSSIBLE BIKE PATH RESURFACING

EROSION CONTROL NOTES:

- 1) EROSION MATTING, CLASS II URBAN TYPE B - ORGANIC SHALL BE INSTALLED OVER ZONES OF TOPSOIL FILLED RIPRAP ADJACENT TO THE LAKE.
- 2) EROSION MATTING, CLASS I URBAN TYPE A - ORGANIC SHALL BE INSTALLED IN ALL OTHER DISTURBED AREAS.
- 3) ALL DISTURBED AREAS SHALL BE RESTORED WITH 4 INCHES OF TOPSOIL, TERRACE SEED MIX, AND EROSION MATTING, UNLESS OTHERWISE NOTED.
- 4) SILT FENCE OR SILT SOCK SHALL BE INSTALLED AS DIRECTED AND AT THE DISCRETION OF THE CONSTRUCTION ENGINEER.
- 5) TEMPORARY POLYMER STABILIZATION SHALL BE PLACED AS DIRECTED BY THE CONSTRUCTION ENGINEER.
- 6) SILT FENCE SHALL BE PLACED DOWNSTREAM OF ALL STOCKPILE AREAS.
- 7) THE PROJECT SITE SHALL BE INSPECTED WITHIN 24 HOURS OF A RAINFALL EXCEEDING 0.5" AND WEEKLY BY CITY STAFF.
- 8) ALL EQUIPMENT BROUGHT ON SITE SHALL BE DECONTAMINATED FOR INVASIVE SPECIES AND VIRUSES.

Lake Mendota Elevation Notes

Aug 10 2011 11:45am
Light wind from north
Survey Point 8100005

Measured 844.85 ft NAVD88(pre-2007) datum
USGS gage 845.03 ft NGVD29 datum
USGS gage 844.83 ft NAVD88(pre-2007) datum (expected = NGVD29 - 0.2 ft)

Good agreement with survey (844.85 vs 844.83)

TARGET LAKE LEVELS:

NAVD88(pre-2007) datum (subtracted 0.2 ft from NGVD29 values):

Summer Minimum 844.50 ft
Maximum 845.00 ft
100-Year Flood 847.50 ft

CP #CP06
MAGNAIL MIDCOURT LINE
N=474237.7100
E=832828.4300
ELEV=850.5900

PLOT SCALE:

PLOT NAME:

REV. DATE:

ORIGINATOR: CITY OF MADISON, STREETS DIVISION

STEPPED STONE REVETMENT TYPICAL SECTION

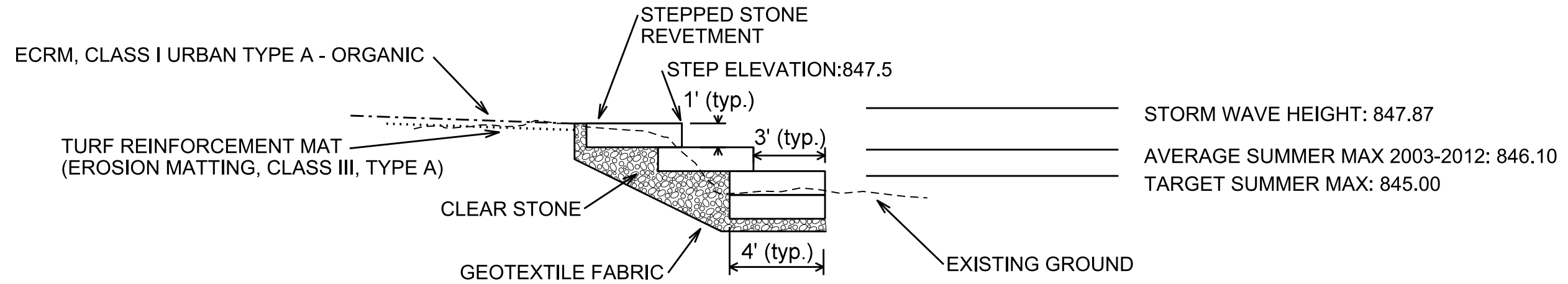

RIPRAP TYPICAL SECTION

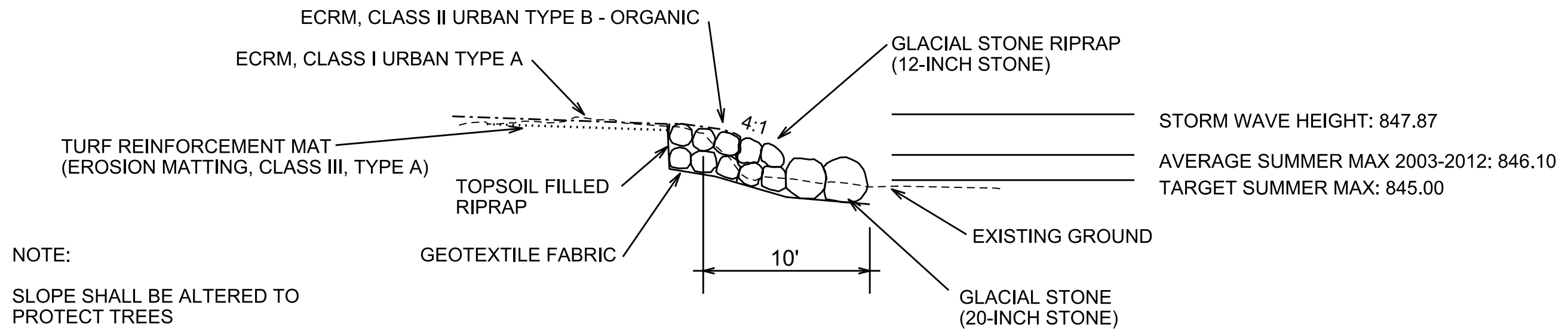

PLOT SCALE: _____

PLOT NAME: _____

REV. DATE: _____

ORIGINATOR: CITY OF MADISON, STREETS DIVISION

PLOT SCALE: _____

PLOT NAME: _____

REV. DATE: _____

ORIGINATOR: CITY OF MADISON, STREETS DIVISION

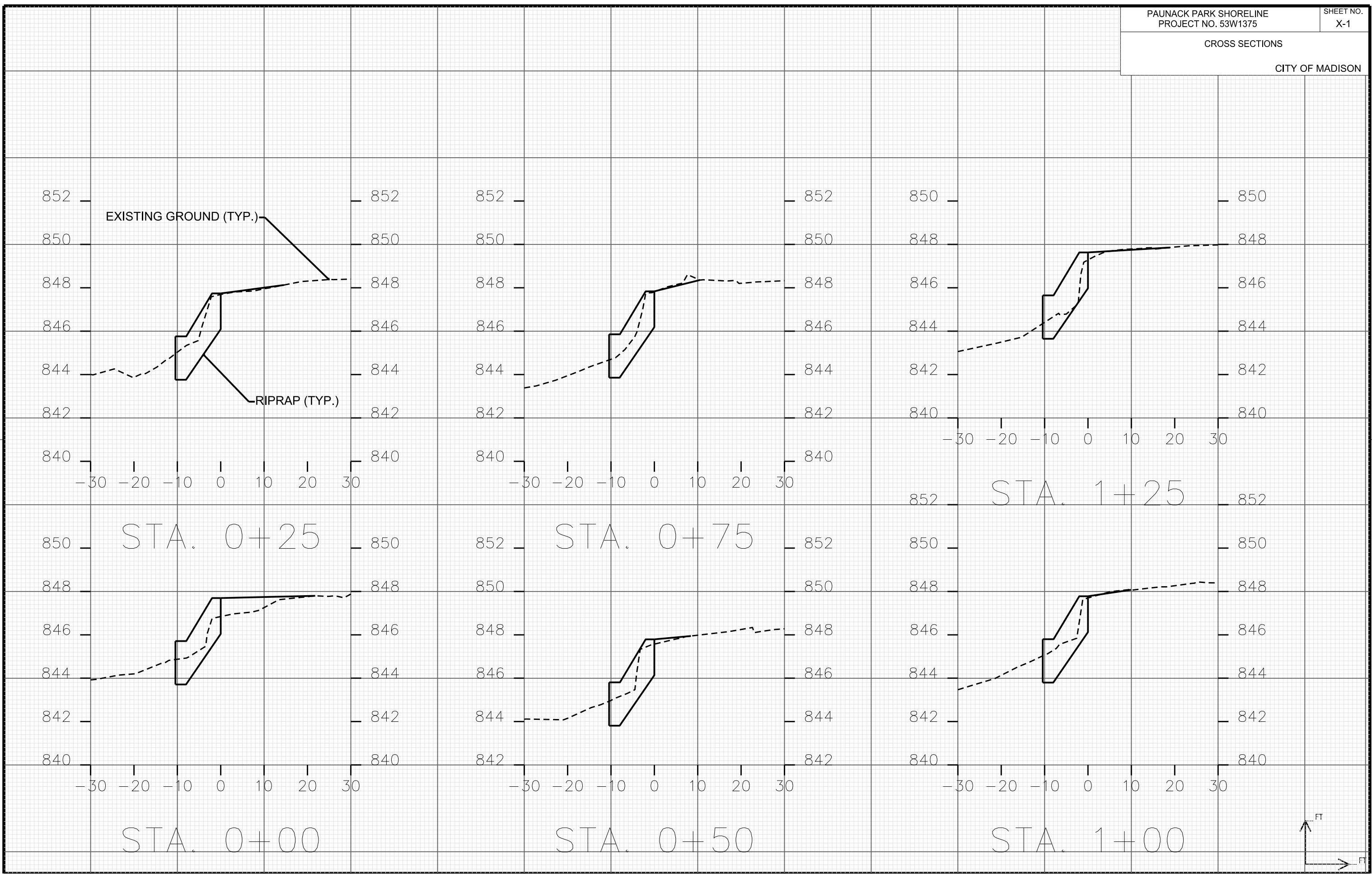

PLOT SCALE: _____

PLOT NAME: _____

REV. DATE: _____

ORIGINATOR: CITY OF MADISON, STREETS DIVISION

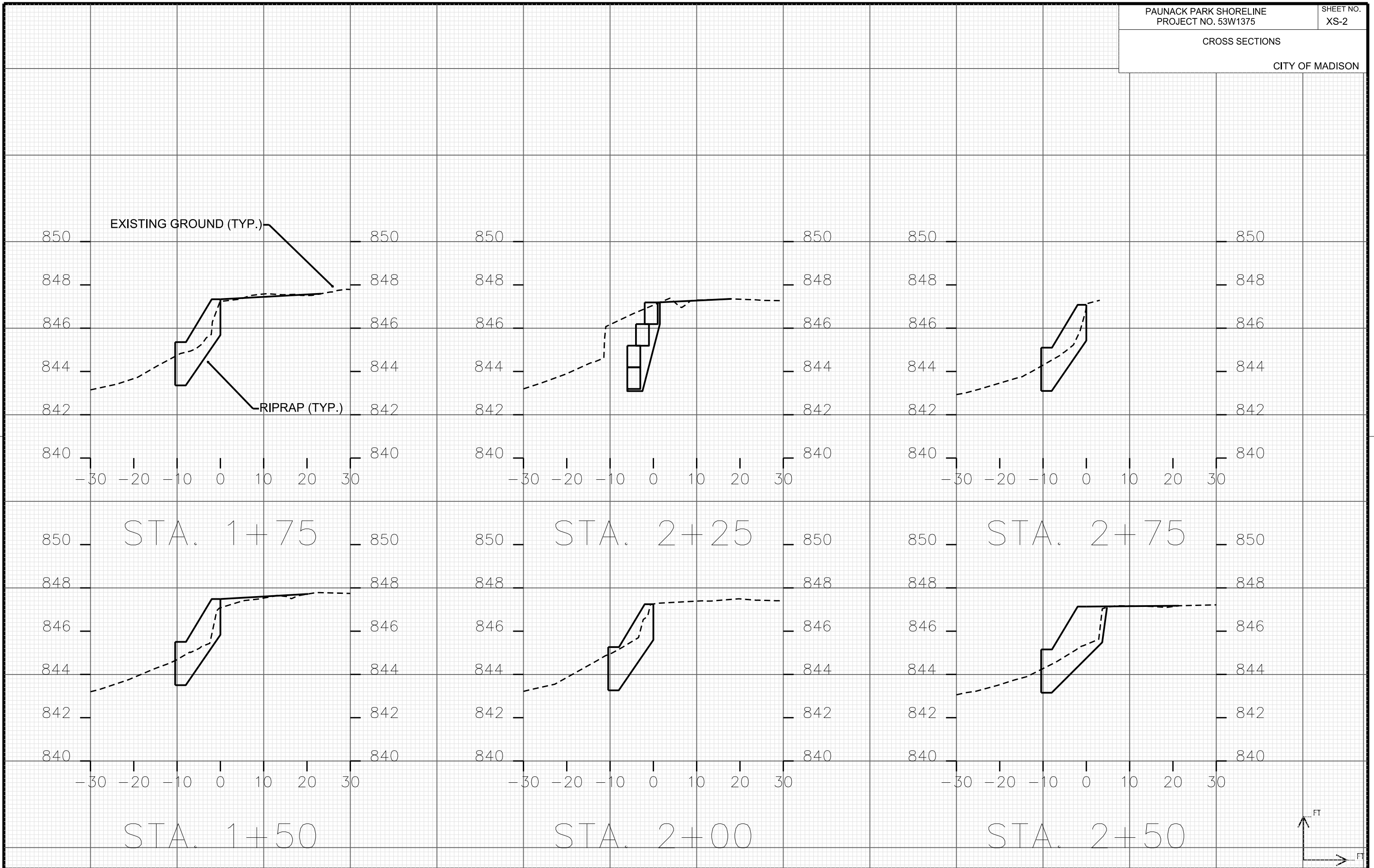

PLOT SCALE: _____

PLOT NAME: _____

REV. DATE: _____

ORIGINATOR: CITY OF MADISON, STREETS DIVISION

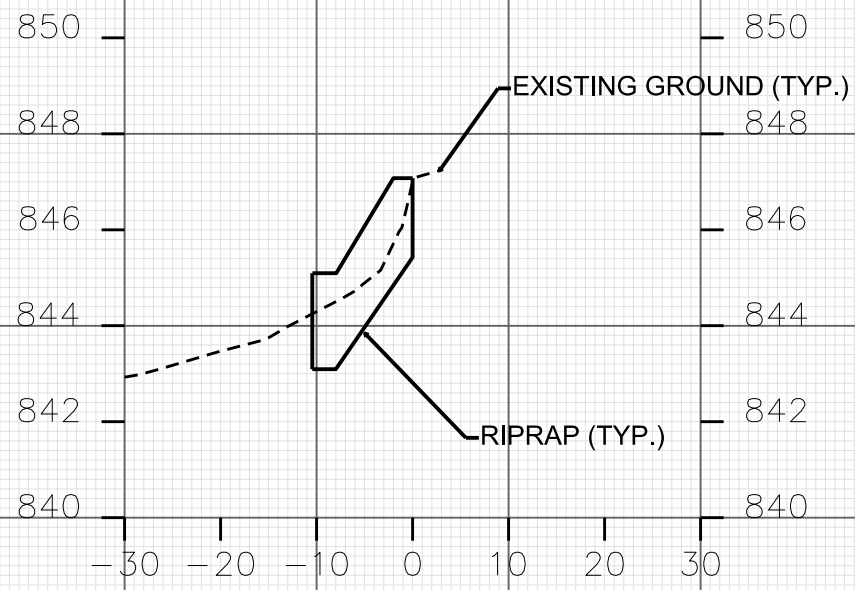

STA. 2+77

