

Madison, Wisconsin

Quality and Reliability since 1882

**Madison
Water
Utility**

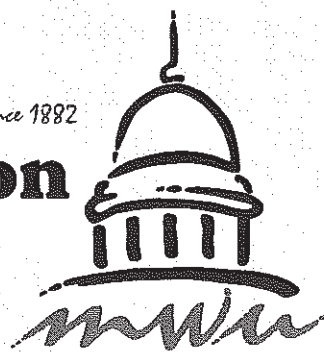

CITY OF MADISON

MADISON WATER UTILITY DEPARTMENT OF PUBLIC WORKS

PLAN OF PROPOSED IMPROVEMENT

CIPP REHABILITATION OF WATER MAINS – 2013

CONTRACT NO. 7124

CITY PROJECT NO. 53W1639

SUBPROJECTS:

- (1) LAKE MENDOTA DR
- (2) W BADGER RD
- (3) W MIFFLIN ST

INDEX OF SHEETS

SHEET NO.	1	TITLE SHEET
SHEET NO.	2	PROJECT LOCATION MAPS
SHEET NO.	3-4	LAKE MENDOTA DR WM REHAB PLAN
SHEET NO.	5-7	W BADGER RD WM REHAB PLAN
SHEET NO.	8	W MIFFLIN ST WM REHAB PLAN

PUBLIC IMPROVEMENT PROJECT
APPROVED

MAY 21, 2013

BY THE COMMON COUNCIL
OF MADISON, WISCONSIN

WATER SYSTEM IMPROVEMENTS
APPROVED BY:

[Signature] 6/7/13
Principal Engineer Date

WATER IMPROVEMENTS
DESIGNED BY:

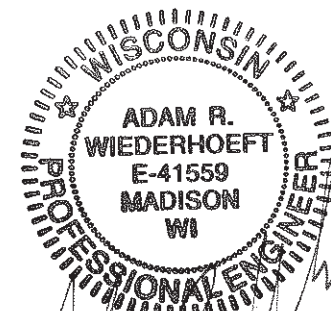

[Signature] 6-7-13

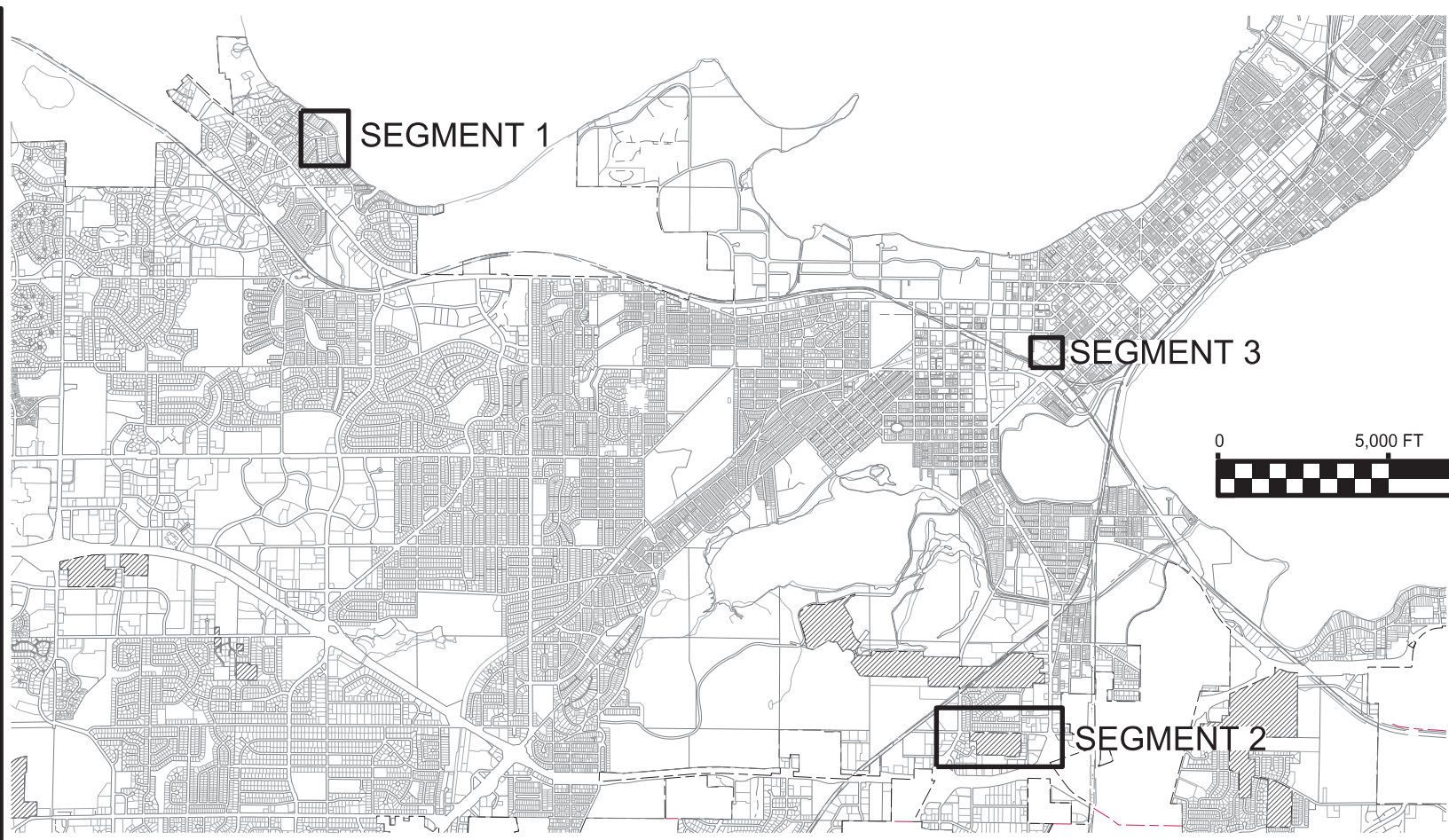

CIPP REHAB OF WATER MAINS - 2013
PROJECT: 53W1639 / CONTRACT: 7124

SHEET NO.
2

MADISON WATER UTILITY

PROJECT LOCATION MAPS CITY OF MADISON

TO OBTAIN LOCATION OF PARTICIPANTS' UNDERGROUND FACILITIES BEFORE YOU DIG IN WISCONSIN

CALL DIGGERS HOTLINE
TOLL FREE
811 OR 1-800-242-8511
FAX-A-LOCATE 1-800-338-3860
TDD (FOR HEARING IMPAIRED) 1-800-542-2289

WIS. STATUTE 182.0175 (1974)
REQUIRES MIN. OF 3 WORK DAYS
NOTICE BEFORE YOU EXCAVATE.

MEMBER
ONE CALL SYSTEMS INTERNATIONAL

DISCLAIMER NOTE:
UTILITY LOCATIONS SHOWN ARE APPROXIMATE ONLY. IT SHALL BE THE CONTRACTOR'S RESPONSIBILITY TO DETERMINE THE EXACT HORIZONTAL AND VERTICAL LOCATION OF ALL EXISTING UNDERGROUND AND OVERHEAD UTILITIES PRIOR TO COMMENCING WORK.

0 5,000 FT 10,000 FT

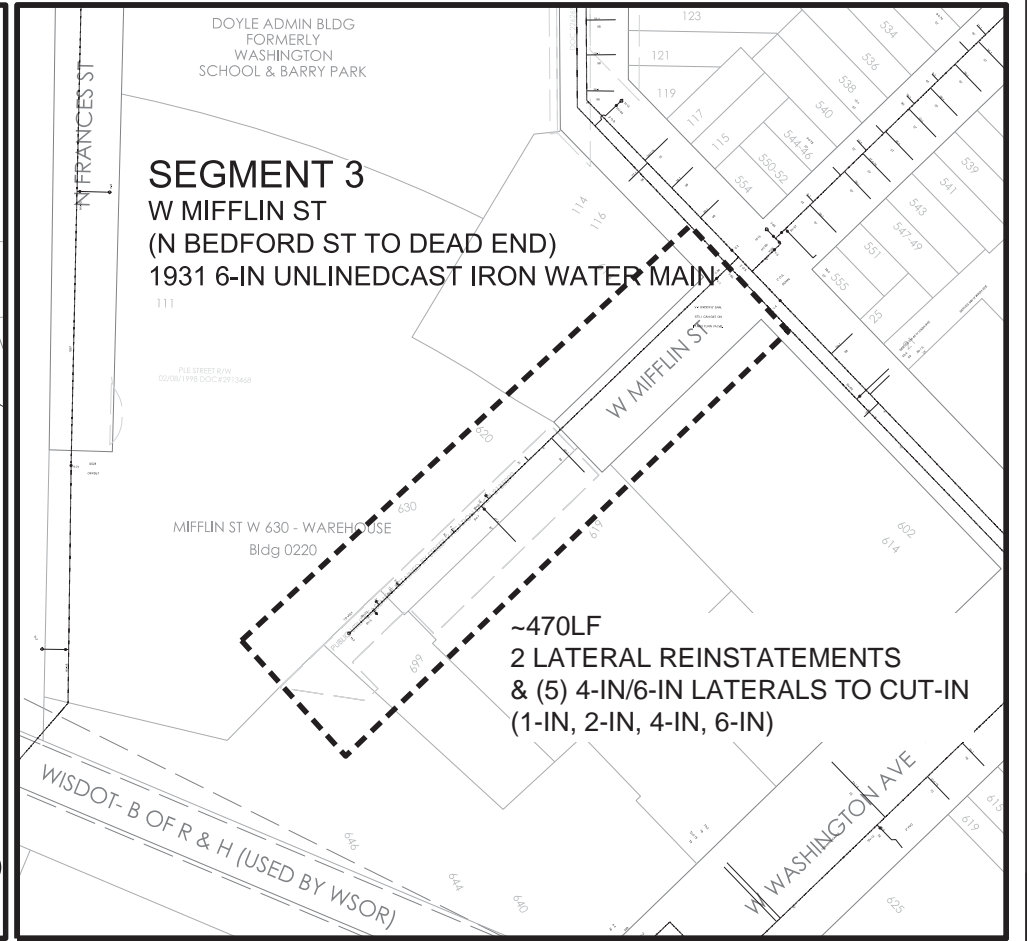
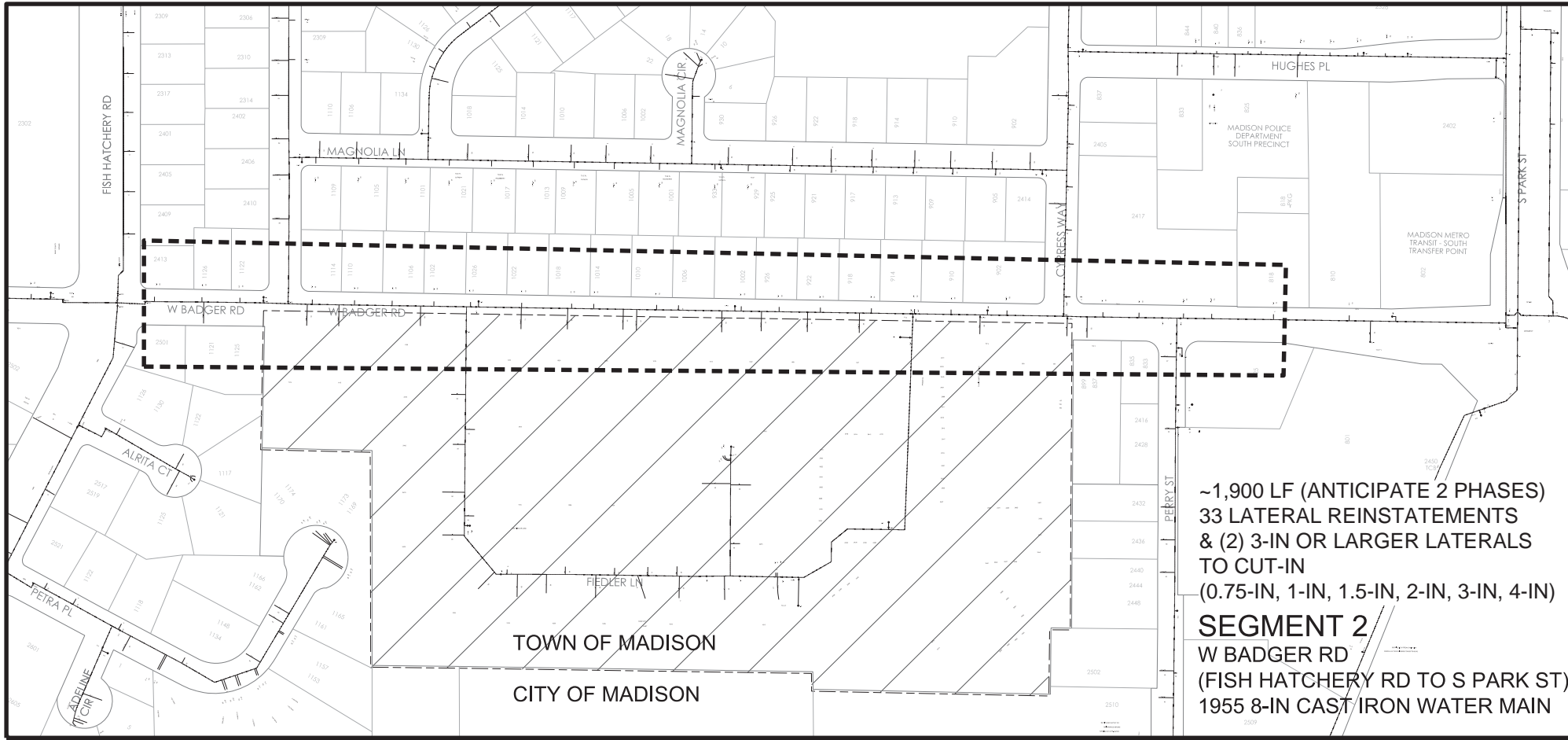

MADISON WATER UTILITY

LAKE MENDOTA DRIVECITY OF MADISON

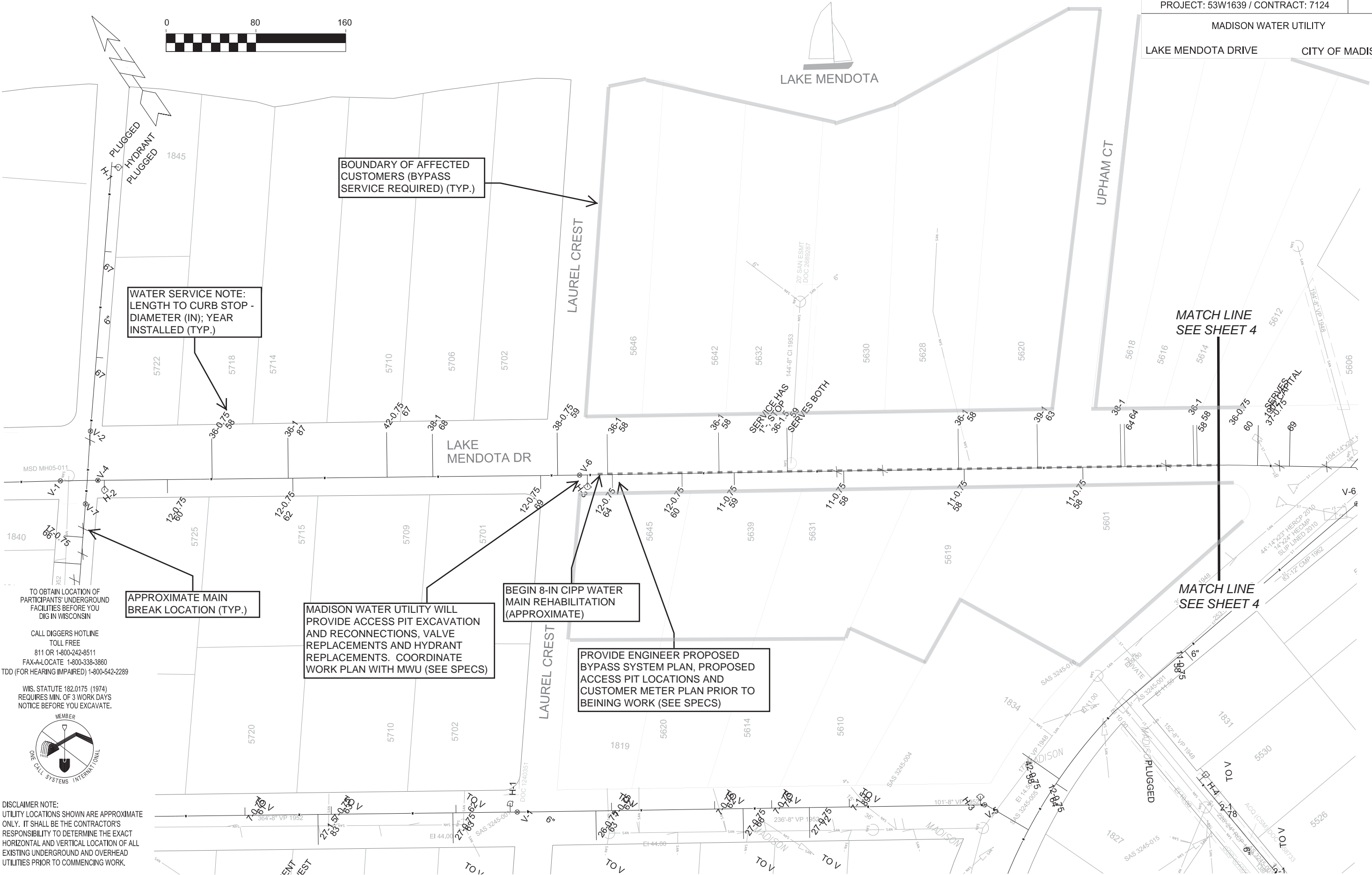

WATER SERVICE NOTE:
LENGTH TO CURB STOP -
DIAMETER (IN); YEAR
INSTALLED (TYP.)

BOUNDARY OF AFFECTED
CUSTOMERS (BYPASS
SERVICE REQUIRED) (TYP.)

APPROXIMATE MAIN
BREAK LOCATION (TYP.)

MADISON WATER UTILITY WILL
PROVIDE ACCESS PIT EXCAVATION
AND RECONNECTIONS, VALVE
REPLACEMENTS AND HYDRANT
REPLACEMENTS. COORDINATE
WORK PLAN WITH MWU (SEE SPECS)

BEGIN 8-IN CIPP WATER
MAIN REHABILITATION
(APPROXIMATE)

PROVIDE ENGINEER PROPOSED
BYPASS SYSTEM PLAN, PROPOSED
ACCESS PIT LOCATIONS AND
CUSTOMER METER PLAN PRIOR TO
BEING WORK (SEE SPECS)

TO OBTAIN LOCATION OF
PARTICIPANTS' UNDERGROUND
FACILITIES BEFORE YOU
DIG IN WISCONSIN

CALL DIGGERS HOTLINE
TOLL FREE
811 OR 1-800-242-8511
FAX-A-LOCATE 1-800-338-3860
TDD (FOR HEARING IMPAIRED) 1-800-542-2289

WIS. STATUTE 182.0175 (1974)
REQUIRES MIN. OF 3 WORK DAYS
NOTICE BEFORE YOU EXCAVATE.

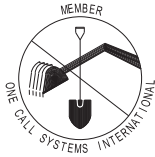

DISCLAIMER NOTE:
UTILITY LOCATIONS SHOWN ARE APPROXIMATE
ONLY. IT SHALL BE THE CONTRACTOR'S
RESPONSIBILITY TO DETERMINE THE EXACT
HORIZONTAL AND VERTICAL LOCATION OF ALL
EXISTING UNDERGROUND AND OVERHEAD
UTILITIES PRIOR TO COMMENCING WORK.

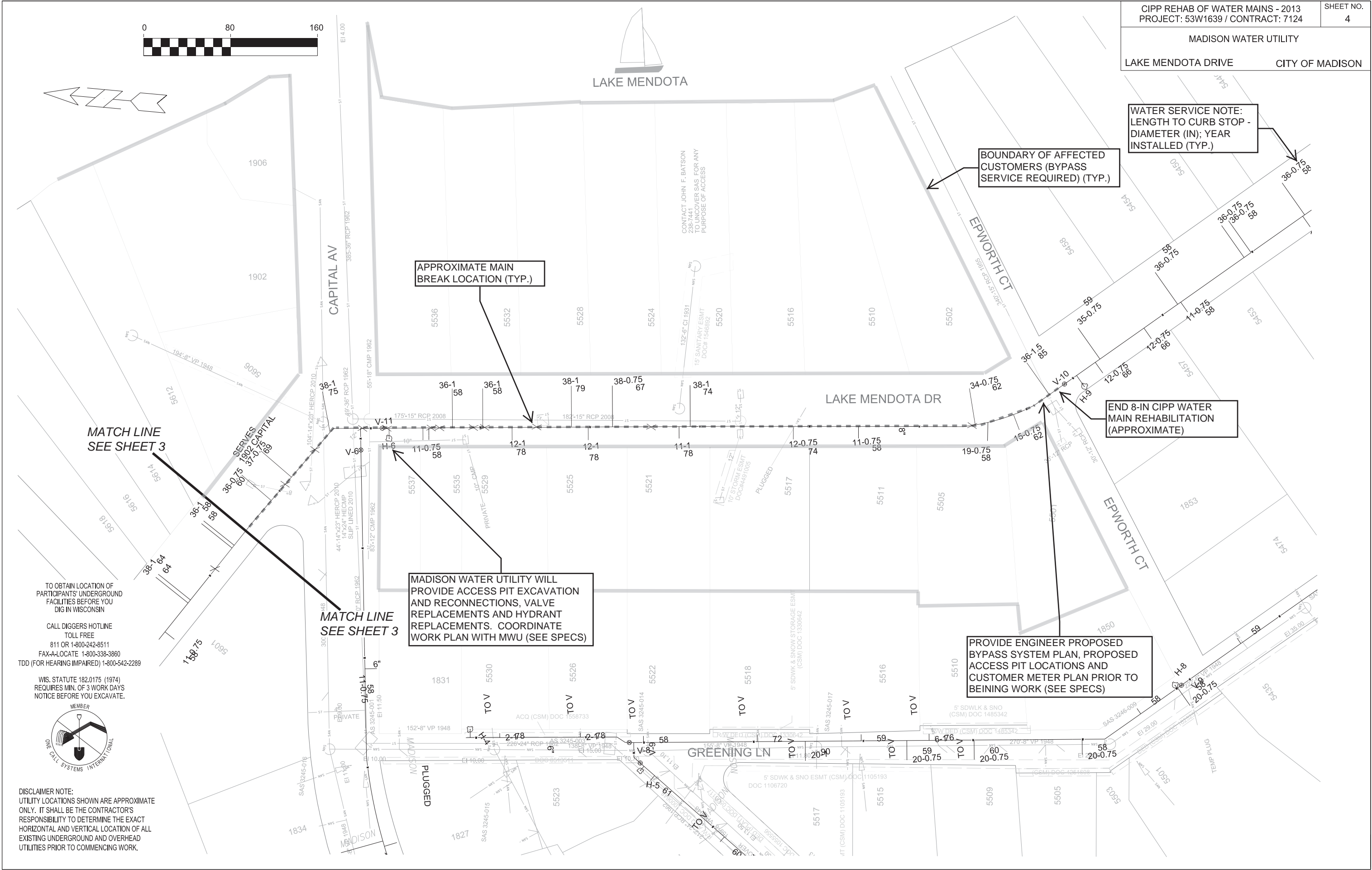

WATER SERVICE NOTE:
LENGTH TO CURB STOP -
DIAMETER (IN); YEAR
INSTALLED (TYP.)

BOUNDARY OF AFFECTED
CUSTOMERS (BYPASS
SERVICE REQUIRED) (TYP.)

APPROXIMATE MAIN
BREAK LOCATION (TYP.)

END 8-IN CIPP WATER
MAIN REHABILITATION
(APPROXIMATE)

PROVIDE ENGINEER PROPOSED
BYPASS SYSTEM PLAN, PROPOSED
ACCESS PIT LOCATIONS AND
CUSTOMER METER PLAN PRIOR TO
BEING WORK (SEE SPECS)

MADISON WATER UTILITY WILL
PROVIDE ACCESS PIT EXCAVATION
AND RECONNECTIONS, VALVE
REPLACEMENTS AND HYDRANT
REPLACEMENTS. COORDINATE
WORK PLAN WITH MWU (SEE SPECS)

MATCH LINE
SEE SHEET 3

MATCH LINE
SEE SHEET 3

TO OBTAIN LOCATION OF
PARTICIPANTS' UNDERGROUND
FACILITIES BEFORE YOU
DIG IN WISCONSIN

CALL DIGGERS HOTLINE
TOLL FREE
811 OR 1-800-242-8511
FAX-A-LOCATE 1-800-338-3860
TDD (FOR HEARING IMPAIRED) 1-800-542-2289

WIS. STATUTE 182.0175 (1974)
REQUIRES MIN. OF 3 WORK DAYS
NOTICE BEFORE YOU EXCAVATE.



DISCLAIMER NOTE:
UTILITY LOCATIONS SHOWN ARE APPROXIMATE
ONLY. IT SHALL BE THE CONTRACTOR'S
RESPONSIBILITY TO DETERMINE THE EXACT
HORIZONTAL AND VERTICAL LOCATION OF ALL
EXISTING UNDERGROUND AND OVERHEAD
UTILITIES PRIOR TO COMMENCING WORK.

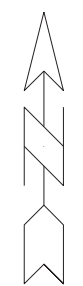
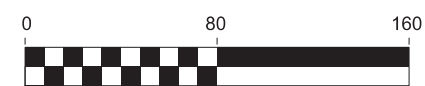

PLOT SCALE:

PLOT NAME:

REV. DATE:

ORIGINATOR: CITY OF MADISON, STREETS DIVISION

PROVIDE ENGINEER PROPOSED BYPASS SYSTEM PLAN, PROPOSED ACCESS PIT LOCATIONS AND CUSTOMER METER PLAN PRIOR TO BEINING WORK (SEE SPECS)

WATER SERVICE NOTE:
LENGTH TO CURB STOP -
DIAMETER (IN); YEAR
INSTALLED (TYP.)

APPROXIMATE MAIN
BREAK LOCATION (TYP.)

BOUNDARY OF AFFECTED
CUSTOMERS (BYPASS
SERVICE REQUIRED) (TYP.)

MATCH LINE
SEE SHEET 6

LIMITS OF TOWN OF MADISON -
SEE SPECS FOR EXCAVATION
PERMIT REQUIRMENTS IN TOWN
OF MADISON

BEGIN 8-IN CIPP WATER
MAIN REHABILITATION
(APPROXIMATE)

MATCH LINE
SEE SHEET 6

MADISON WATER UTILITY WILL
PROVIDE ACCESS PIT EXCAVATION
AND RECONNECTIONS, VALVE
REPLACEMENTS AND HYDRANT
REPLACEMENTS. COORDINATE
WORK PLAN WITH MWU (SEE SPECS)

TO OBTAIN LOCATION OF
PARTICIPANTS' UNDERGROUND
FACILITIES BEFORE YOU
DIG IN WISCONSIN

CALL DIGGERS HOTLINE
TOLL FREE
811 OR 1-800-242-8511
FAX-A-LOCATE 1-800-338-3860
TDD (FOR HEARING IMPAIRED) 1-800-542-2289

WIS. STATUTE 182.0175 (1974)
REQUIRES MIN. OF 3 WORK DAYS
NOTICE BEFORE YOU EXCAVATE.



DISCLAIMER NOTE:
UTILITY LOCATIONS SHOWN ARE APPROXIMATE
ONLY. IT SHALL BE THE CONTRACTOR'S
RESPONSIBILITY TO DETERMINE THE EXACT
HORIZONTAL AND VERTICAL LOCATION OF ALL
EXISTING UNDERGROUND AND OVERHEAD
UTILITIES PRIOR TO COMMENCING WORK.

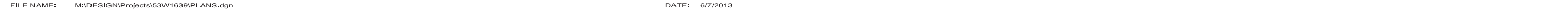

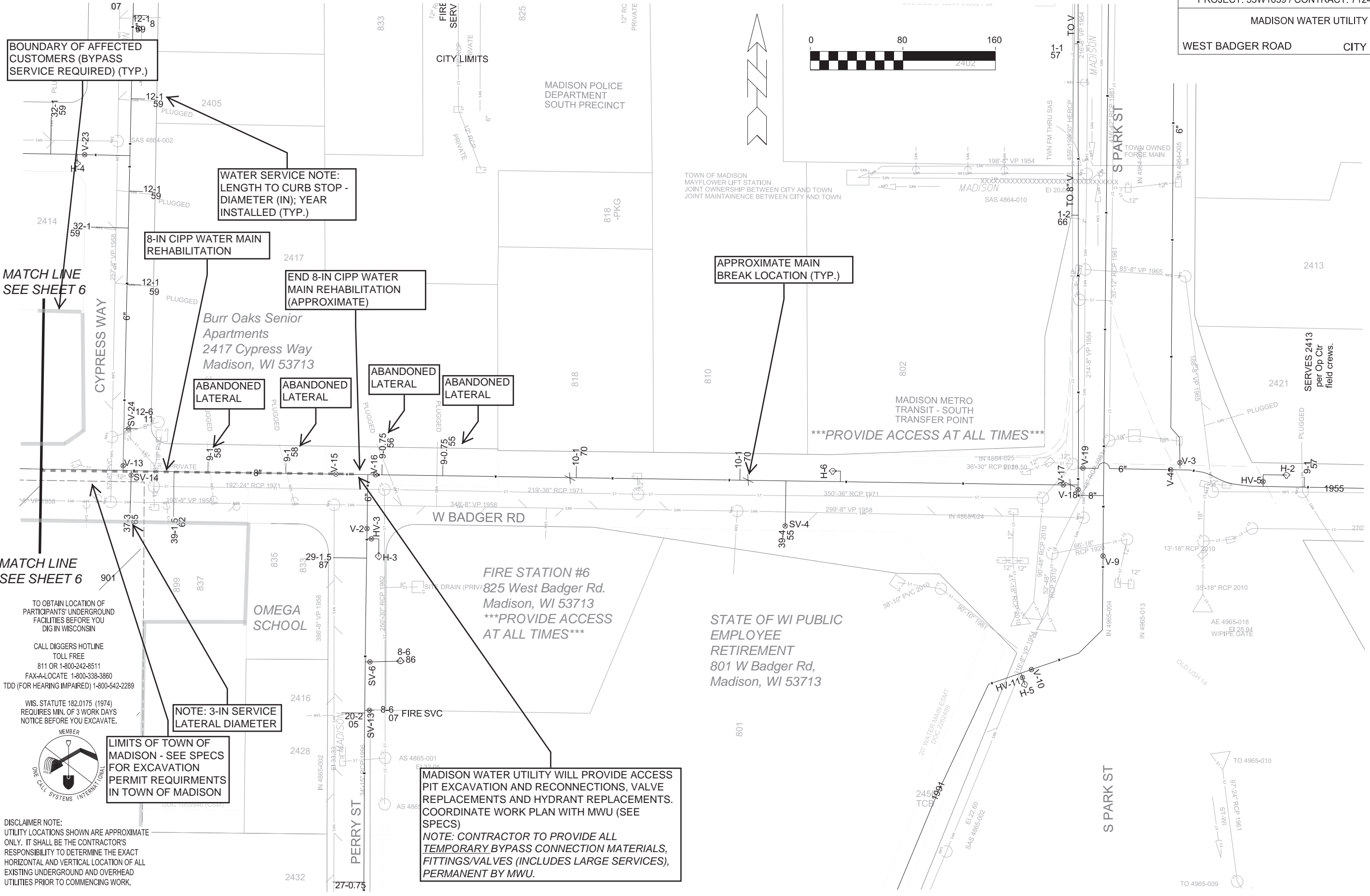

PLOT SCALE: PLOT NAME: REV. DATE: ORIGINATOR: CITY OF MADISON, STREETS DIVISION

