

4-7-77

CONTRACT 7185

1

<u>SHEET NO.</u>	<u>DRAWING NO.</u>	<u>DRAWING TITLE</u>
	<u>GENERAL</u>	
1	G0.1	TITLE SHEET, SITE LOCATION MAP, AND LIST OF DRAWINGS
	<u>ARCHITECTURAL/STRUCTURAL</u>	
2	AS1.1	RESERVOIR SECTION PLAN
3	AS3.1	RESERVOIR DETAIL AND DETAILS

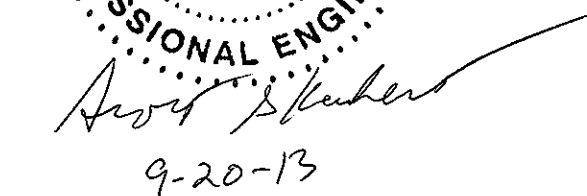

SHEET
1
GO.1

ISSUED FOR BIDDING: SEPTEMBER 20, 2013

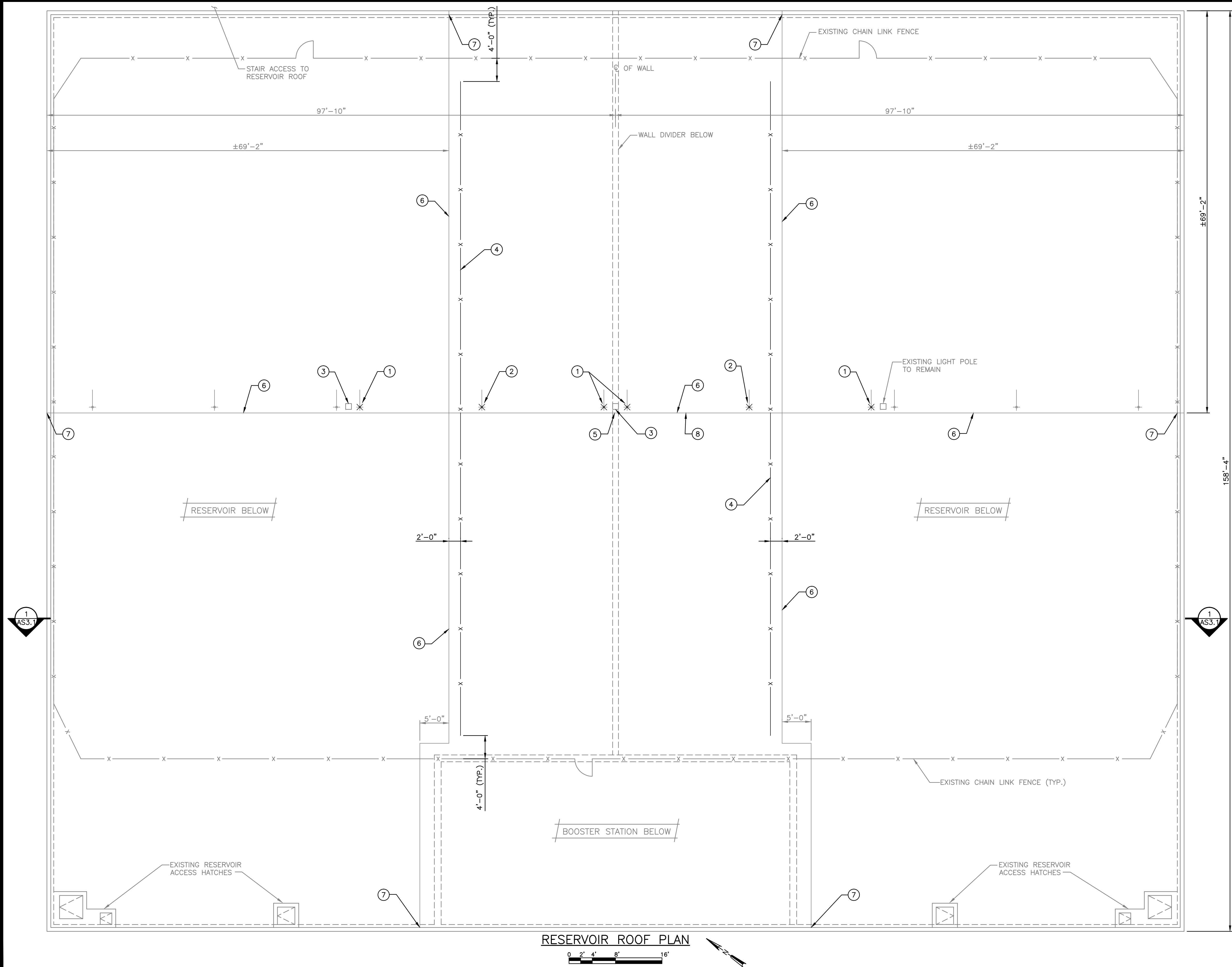

- GENERAL NOTES:**
1. THERE ARE MISCELLANEOUS AREAS WHERE REPAIRS WILL NEED TO BE PERFORMED ON CONCRETE SURFACES OF RESERVOIR TOP SLAB. SEE DETAIL FOR **D** AS3.1 WORK INCLUDED. SEE BID QUANTITIES FOR ASSUMED AMOUNT OF REPAIRS. COORDINATE ACTUAL LOCATION AND QUANTITIES WITH OWNER AND ENGINEER.
 2. THE ENTIRE CONCRETE TOP SLAB SURFACE OF THE RESERVOIR SHALL RECEIVE A PENETRATING SEALER COATING AS SPECIFIED. CONCRETE SEALER SHALL BE PLACED AFTER ALL OTHER WORK IS COMPLETE.
 3. REMOVE EXISTING MEMBRANE, COATING, EXPANSION JOINT MATERIALS AND OTHER ASSOCIATED ACCESSORIES AT ALL EXPANSION JOINTS BEING REPLACED.
 4. CONTRACTOR TO NOTE THERE ARE BURIED ELECTRICAL CONDUITS IN RESERVOIR TOP SLAB.
 5. ONLY ONE-HALF THE RESERVOIR CAN BE TAKEN DOWN AT ONE TIME. SEE SPECIFICATION FOR ADDITIONAL REQUIREMENTS.
 6. CONTRACTOR SHALL INCLUDE THE QUANTITY OF ROUTING AND CAULKING OF CRACKS AS LISTED IN CONTRACT DOCUMENTS. AS VERIFIED WITH ENGINEER AND OWNER, CRACKS WIDER THAN 1/36-INCH SHALL BE ROUTED 3/8-INCH WIDE X 1/2-INCH DEEP AND SEALED WITH CAULK.
 7. CONTRACTOR STAGING AREAS SHOULD BE NEAR/ON DRIVEWAY IN FRONT OF BOOSTER STATION ON WEST SIDE. CONTRACTOR SHALL MAINTAIN ACCESS TO BOOSTER STATION AT ALL TIMES FOR OWNER ACTIVITIES. THE DRIVE ON THE NORTHEAST CORNER IS CURRENTLY UNDER CONSTRUCTION. ANY USE OF THIS DRIVE WILL NEED TO BE COORDINATED WITH OTHER WORK AND OWNER.

- KEY NOTES:**
- 1 REMOVE TENNIS NET POSTS AND TURN OVER TO OWNER. REMOVE ANCHORS DOWN TO MIN. 2" BELOW TOP OF SLAB AND PATCH CONCRETE.
 - 2 REMOVE CENTER NET ANCHOR AND PATCH SURFACE.
 - 3 REMOVE EXISTING CONCRETE BASE AND ANCHORS FOR LIGHT POLE. REMOVE ANCHORS AND CONDUITS DOWN A MIN. 2" BELOW SURFACE. PATCH CONCRETE SURFACE AS REQUIRED.
 - 4 NEW 6'-0" HIGH CHAIN LINK FENCE ANCHORED TO ROOF DECK PER **G** AS3.1
 - 5 EXPANSION JOINT IN DIVIDER WALL BELOW SHALL HAVE ACTIVE WATER LEAKS SEALED FIRST BY CHEMICAL INJECTION. THEN THE JOINT SHALL HAVE A SUBMERGED EXPANSION JOINT MATERIAL PLACED PER **E** AS3.1
 - 6 ALL EXPANSION JOINTS IN TOP SLAB OF RESERVOIR SHALL BE REPAIRED AS NEEDED AND A NEW EXPANSION JOINT PLACED AS SHOWN IN DETAILS A/AS3.1, B/AS3.1, AND C/AS3.1. SEE BID QUANTITIES FOR ASSUMED AMOUNTS OF EACH REPAIR AND NEW EXPANSION JOINT. COORDINATE ACTUAL REPAIR DETAILS WITH OWNER AND ENGINEER DURING CONSTRUCTION.
 - 7 RUN EXPANSION JOINT MATERIAL UP WALL APPROXIMATELY 2.5 FT. TO TOP OF CONCRETE PARAPET WALL PER **F** AS3.1
 - 8 SEE DETAIL **J** AS3.1 FOR EXPANSION JOINT COVER PLATE IN THIS LOCATION.

Madison Water Utility
Quality and Reliability since 1982

DATE:									

REVISIONS									

NO.									

RESERVOIR ROOF PLAN

WELL NO. 24 - RESERVOIR TOP SLAB REPAIRS

115 N. LIVINGSTON STREET

MADISON WATER UTILITY

MADISON, WISCONSIN

JOB NO.

1020.077

PROJECT MGR.

SCOTT HERKERT

STRAND ASSOCIATES

SHEET

2

AS1.1

