

Madison, Wisconsin

CITY OF MADISON

CITY ENGINEERING DIVISION DEPARTMENT OF PUBLIC WORKS

PLAN OF PROPOSED IMPROVEMENT

OLBRICH CANOE LAUNCH

PROJECT NO. 53W1735
CONTRACT NO. 7401

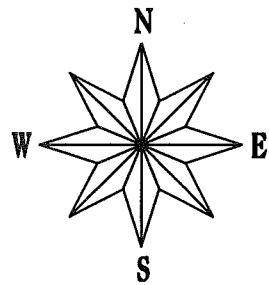

STREET PROJECT APPROVED
MARCH 5, 2014
BY THE COMMON COUNCIL
OF MADISON, WISCONSIN

DESIGN
APPROVED BY:



City Engineer

9/12/14
Date

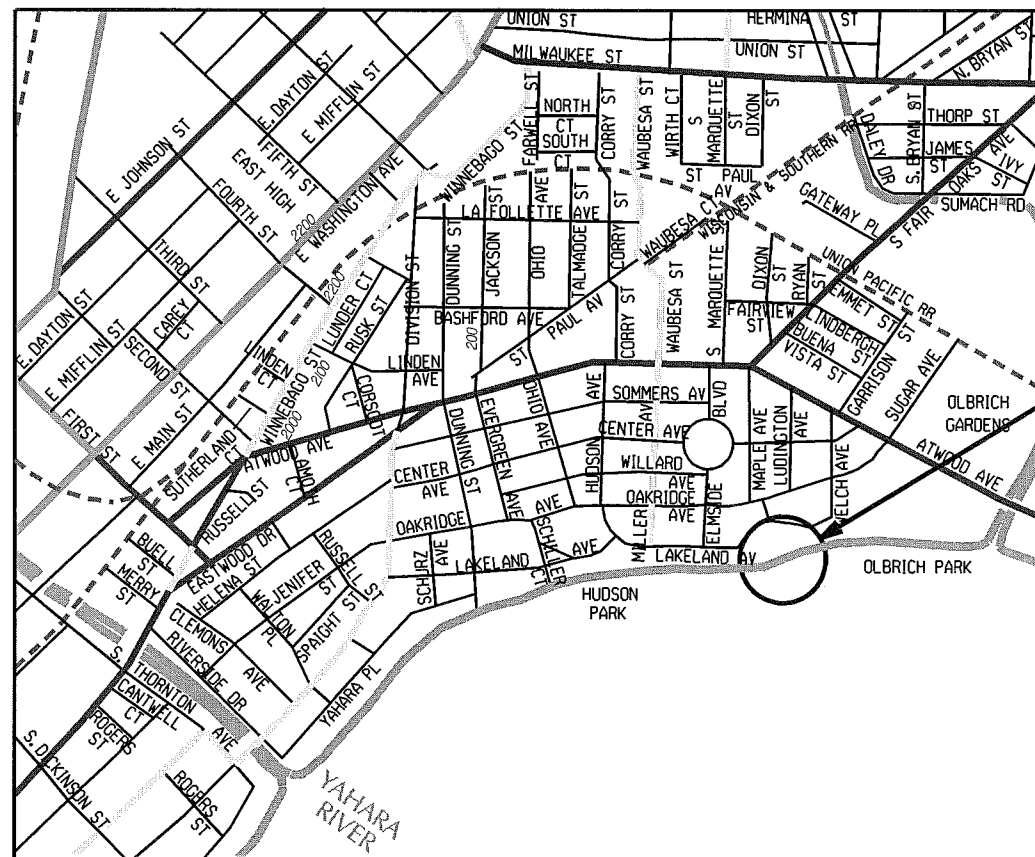
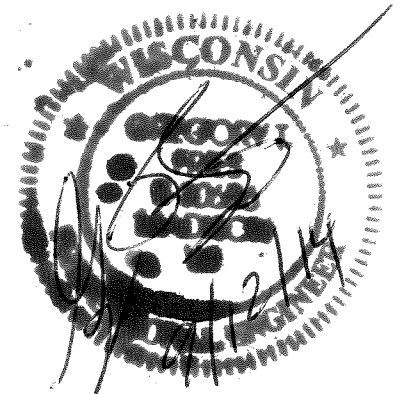
APPROVED BY:

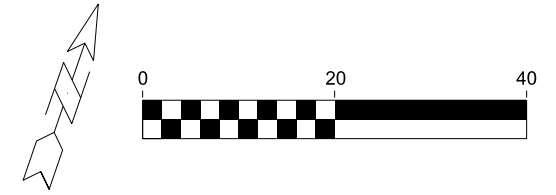
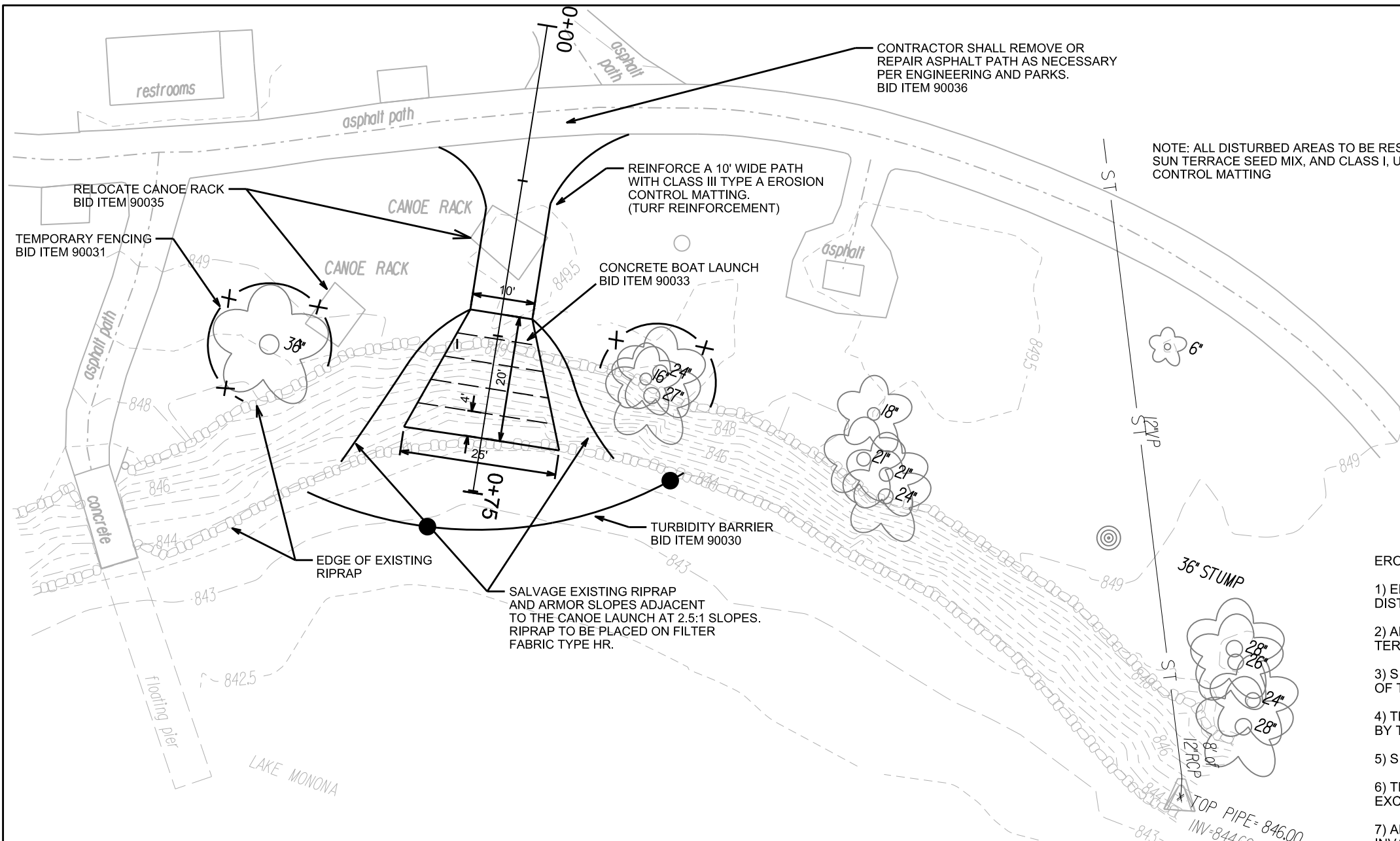

PROJECT AREA



EROSION CONTROL NOTES:

- 1) EROSION MATTING, CLASS I URBAN TYPE A - ORGANIC SHALL BE INSTALLED IN ALL DISTURBED AREAS.
- 2) ALL DISTURBED AREAS SHALL BE RESTORED WITH 4 INCHES OF TOPSOIL, TERRACE SEED MIX, AND EROSION MATTING, UNLESS OTHERWISE NOTED.
- 3) SILT FENCE OR SILT SOCK SHALL BE INSTALLED AS DIRECTED AND AT THE DISCRETION OF THE CONSTRUCTION ENGINEER.
- 4) TEMPORARY POLYMER STABILIZATION SHALL BE PLACED AS DIRECTED BY THE CONSTRUCTION ENGINEER.
- 5) SILT FENCE SHALL BE PLACED DOWNSTREAM OF ALL STOCKPILE AREAS.
- 6) THE PROJECT SITE SHALL BE INSPECTED WITHIN 24 HOURS OF A RAINFALL EXCEEDING 0.5" AND WEEKLY BY CITY STAFF.
- 7) ALL EQUIPMENT BROUGHT ON SITE SHALL BE DECONTAMINATED FOR INVASIVE SPECIES AND VIRUSES.
- 8) THE CONTRACTOR SHALL CHOOSE THE START DATE OF THE PROJECT BASED ON ANTICIPATED WEATHER CONDITIONS AND LAKE LEVEL.

CONCRETE CANOE LAUNCH DETAIL

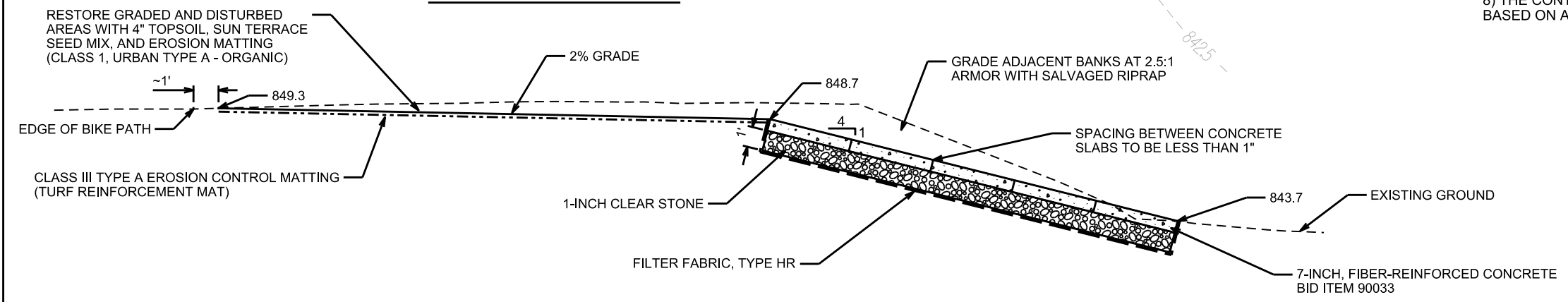

NOTE: NOT TO SCALE

PLOT SCALE: _____
 PLOT NAME: _____
 REV. DATE: _____
 ORIGINATOR: CITY OF MADISON, STREET'S DIVISION

FILE NAME:

DATE: