

Madison, Wisconsin

# CITY OF MADISON

## CITY ENGINEERING DIVISION

### DEPARTMENT OF PUBLIC WORKS

# PLAN OF PROPOSED IMPROVEMENT

PUBLIC IMPROVEMENT PROJECT APPROVED

APRIL 16, 2016

BY THE COMMON COUNCIL OF MADISON, WISCONSIN

PUBLIC IMPROVEMENT DESIGN APPROVED BY:

*Christy R. L.* 5-6-16  
City Engineer Date

GEOMETRICS DESIGNED BY:

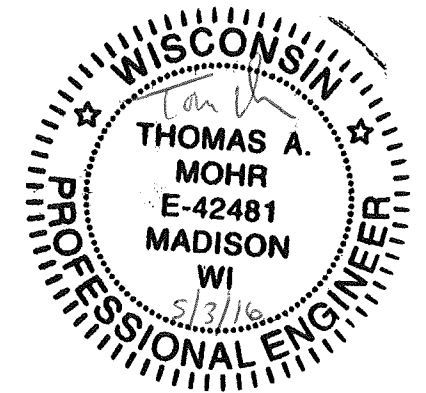

INDEX OF SHEETS

SHEET NO.	TITLE
1	PROJECT LOCATION MAP
LM1	CAMERON DR.
C1	DIVISION ST.
D1	DRAKE ST.
DR1	ELLEN AVE.
E1	FISH HATCHERY RD.
FH1	FRAZIER AVE.
FR1	JUNCTION RD.
J1	MANLEY ST.
M1	PFLAUM RD.
PF1	PRAIRIE RD.
PR1	

## LOCAL ROAD TRAFFIC CALMING & ARTERIAL PEDESTRIAN ENHANCEMENTS - 2016

CITY PROJECT NO. 11126

CITY CONTRACT NO. 7630

REV 5-17-16 JMW

PLOT SCALE: REV. DATE:

CONVENTIONAL SIGNS

FIELD VERIFY ALL UTILITY LOCATIONS

GAS	— G —
STORM SEWER	— ST —
SANITARY SEWER	— SAN —
WATER	— W —
OVERHEAD ELECTRIC	— OH —
POWER POLE	⊕
ADA COMPLIANT RAMP W/ DETECTABLE WARNING FIELD	
COMBUSTIBLE FLUIDS	

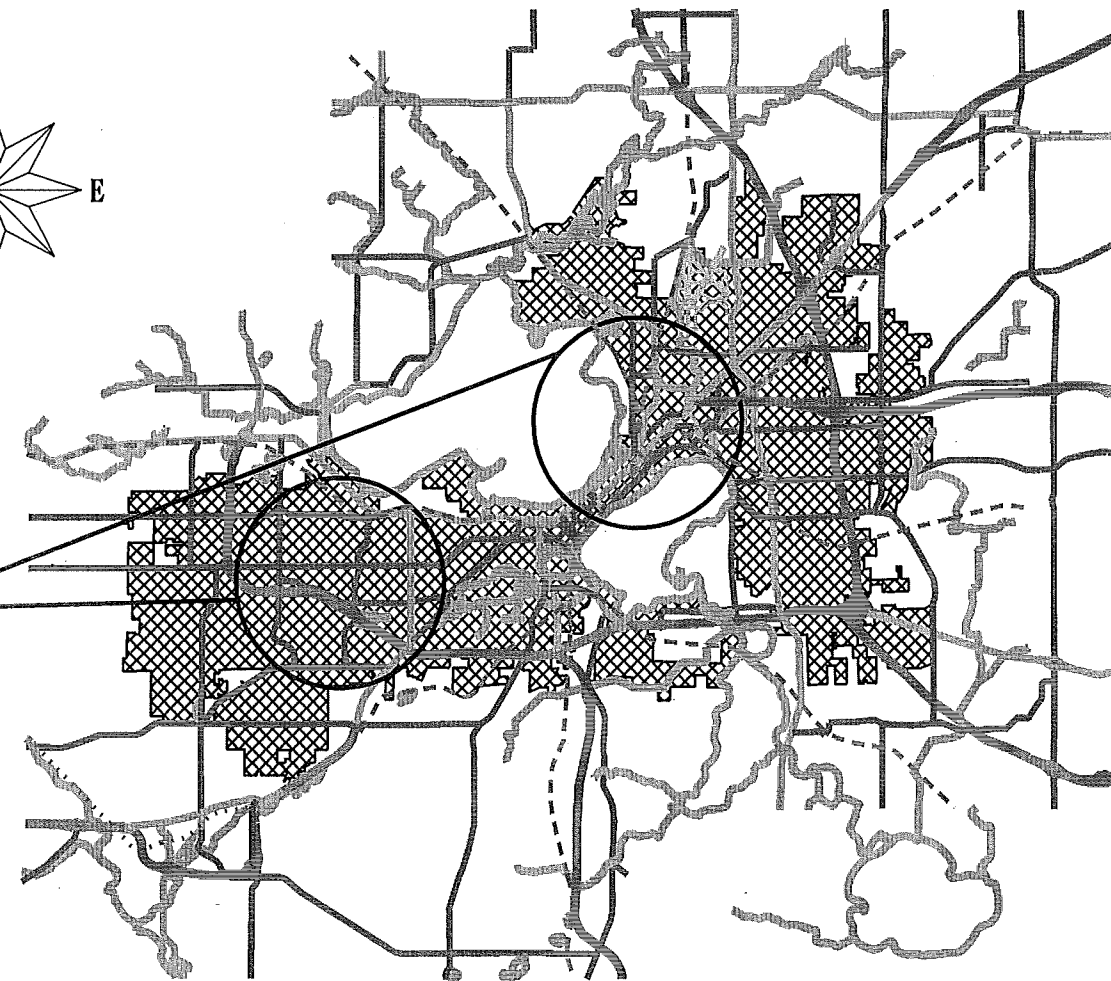
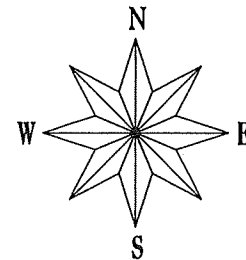

### CITY-WIDE PROJECT LOCATIONS

NOTES:

ALL GUTTERS SHALL DRAIN WITH A MINIMUM GRADE OF 0.50% TOWARD STORM SEWER INLETS.

SIDEWALK RAMPS AND CURB THRU SIDEWALK RAMPS SHALL HAVE A MAXIMUM SLOPE OF 1" PER 12". SIDEWALK AND CURB RAMPS SHALL BE CONSTRUCTED WITH A SIDE SLOPE OF 2.00%. SIDEWALK SHALL HAVE A MINIMUM LONGITUDINAL SLOPE OF 0.50% AND A MAXIMUM LONGITUDINAL SLOPE OF 5.00% EXCEPT WHERE STREET GRADES EXCEED 5.00%.

EARTH WORK SUMMARY:

EXCAVATION CUT (MEASURED PLAN QUANTITY)	284 C.Y.
ESTIMATED UNDISTRIBUTED UNDERCUT	0 C.Y.
TOTAL UNCLASSIFIED EXCAVATION CUT	284 C.Y.

REV 5-17-16 JMW

ORIGINATOR: CITY OF MADISON, STREETS DIVISION

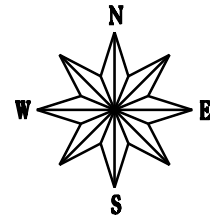

PLOT SCALE: \_\_\_\_\_

PLOT NAME: \_\_\_\_\_

REV. DATE: \_\_\_\_\_

ORIGINATOR: CITY OF MADISON, STREETS DIVISION

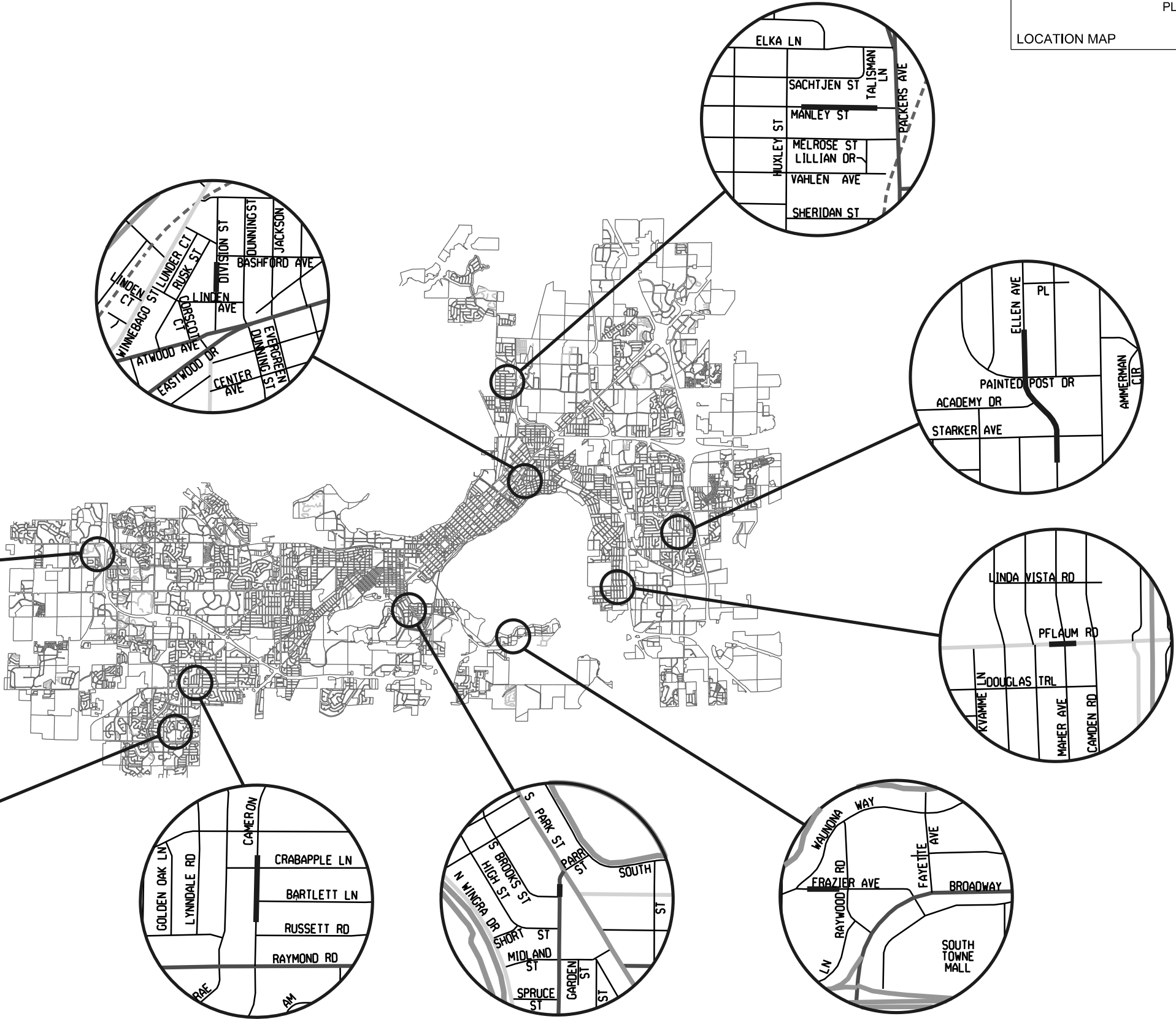



NOTES:  
1. INSTALL SPEED HUMPS PER  
S.D.D. 4.10 W/ FLOW THRU GUTTER  
2. SAWCUT PAVEMENT AT EDGE OF  
PROPOSED SPEED HUMP; RECORDS  
INDICATE ASPHALT PAVEMENT

PLOT SCALE:

PLOT NAME:

REV. DATE:

ORIGINATOR: CITY OF MADISON, STREETS DIVISION



NOTES:  
1. INSTALL SPEED HUMPS PER  
S.D.D. 4.10 W/ FLOW THRU GUTTER  
2. SAWCUT PAVEMENT AT EDGE OF  
PROPOSED SPEED HUMP; RECORDS  
INDICATE ASPHALT PAVEMENT

PROPOSED SPEED HUMP

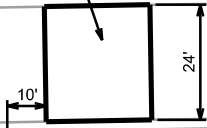

DIVISION STREET

LINDEN AVE

BASHFORD AVE

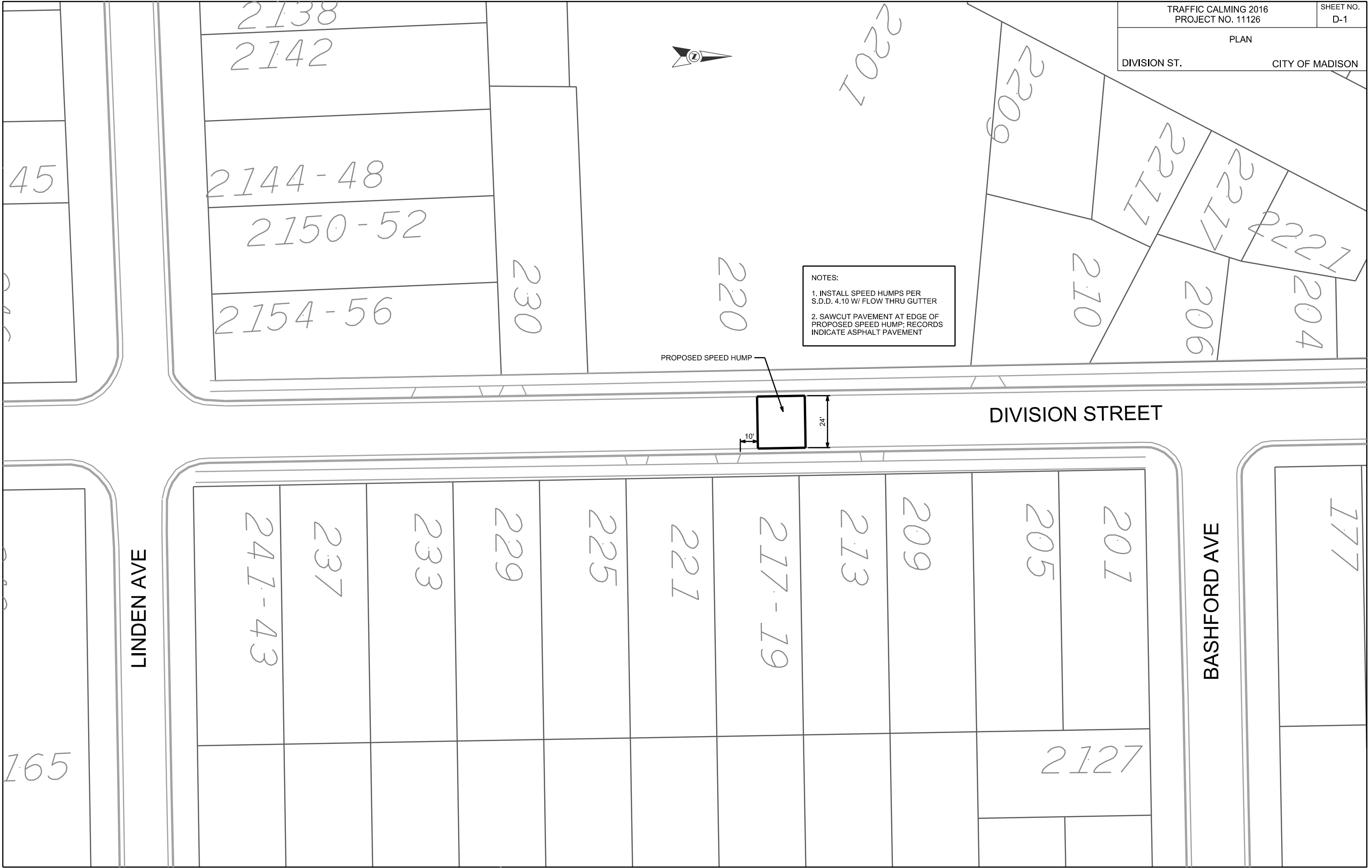

PLOT SCALE:

PLOT NAME:

REV. DATE:

ORIGINATOR: CITY OF MADISON, STREETS DIVISION

PLOT SCALE: \_\_\_\_\_

PLOT NAME: \_\_\_\_\_

REV. DATE: \_\_\_\_\_

ORIGINATOR: CITY OF MADISON, STREETS DIVISION

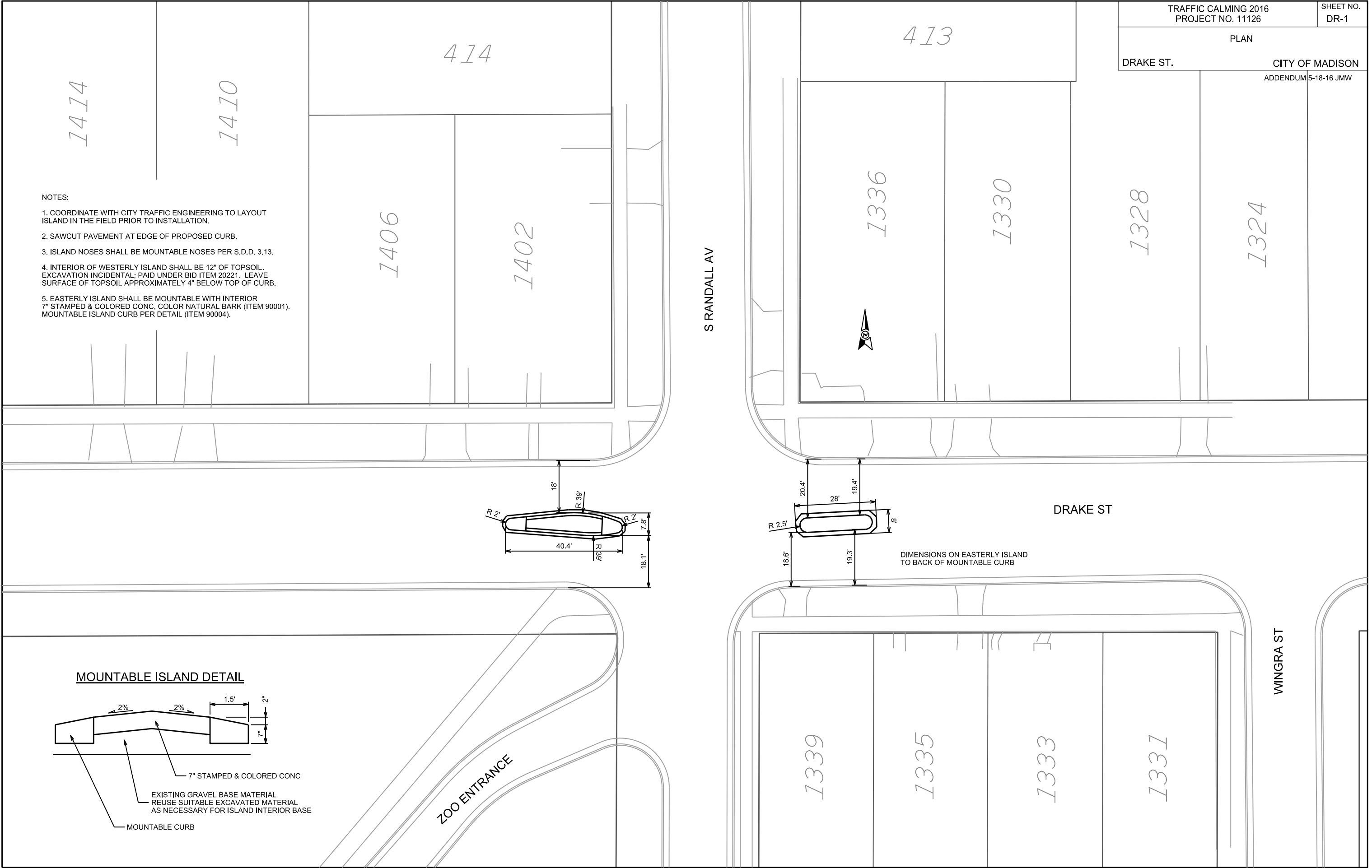

- NOTES:
1. COORDINATE WITH CITY TRAFFIC ENGINEERING TO LAYOUT ISLAND IN THE FIELD PRIOR TO INSTALLATION.
  2. SAWCUT PAVEMENT AT EDGE OF PROPOSED CURB.
  3. ISLAND NOSES SHALL BE MOUNTABLE NOSES PER S.D.D. 3.13.
  4. INTERIOR OF WESTERLY ISLAND SHALL BE 12" OF TOPSOIL. EXCAVATION INCIDENTAL; PAID UNDER BID ITEM 20221. LEAVE SURFACE OF TOPSOIL APPROXIMATELY 4" BELOW TOP OF CURB.
  5. EASTERLY ISLAND SHALL BE MOUNTABLE WITH INTERIOR 7" STAMPED & COLORED CONC. COLOR NATURAL BARK (ITEM 90001). MOUNTABLE ISLAND CURB PER DETAIL (ITEM 90004).

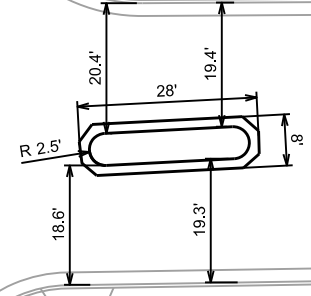
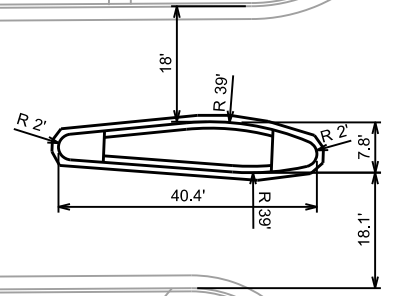

DIMENSIONS ON EASTERLY ISLAND TO BACK OF MOUNTABLE CURB

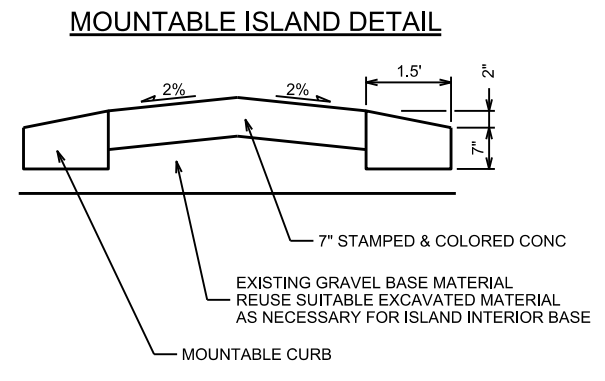

ZOO ENTRANCE



NOTES:

1. INSTALL SPEED HUMPS PER S.D.D. 4.10 W/ FLOW THRU GUTTER
2. SAWCUT PAVEMENT AT EDGE OF PROPOSED SPEED HUMP; RECORDS INDICATE ASPHALT PAVEMENT



PLOT SCALE:

PLOT NAME:

REV. DATE:

ORIGINATOR: CITY OF MADISON, STREETS DIVISION



1033

1008

S Brooks St

NOTES:

- 1. COORDINATE WITH CITY TRAFFIC ENGINEERING TO LAYOUT ISLAND IN THE FIELD PRIOR TO INSTALLATION.
- 2. SAWCUT PAVEMENT AT EDGE OF PROPOSED CURB.
- 3. ISLAND NOSES SHALL BE MOUNTABLE NOSES PER S.D.D. 3.13.
- 4. INTERIOR OF ISLAND TO BE STAMPED/COLORED 7" CONCRETE. PATTERN SHALL BE 6"X6" COBBLESTONE, COLOR SHALL BE TERRA COTTA

PLOT SCALE:

PLOT NAME:

REV. DATE:

ORIGINATOR: CITY OF MADISON, STREETS DIVISION

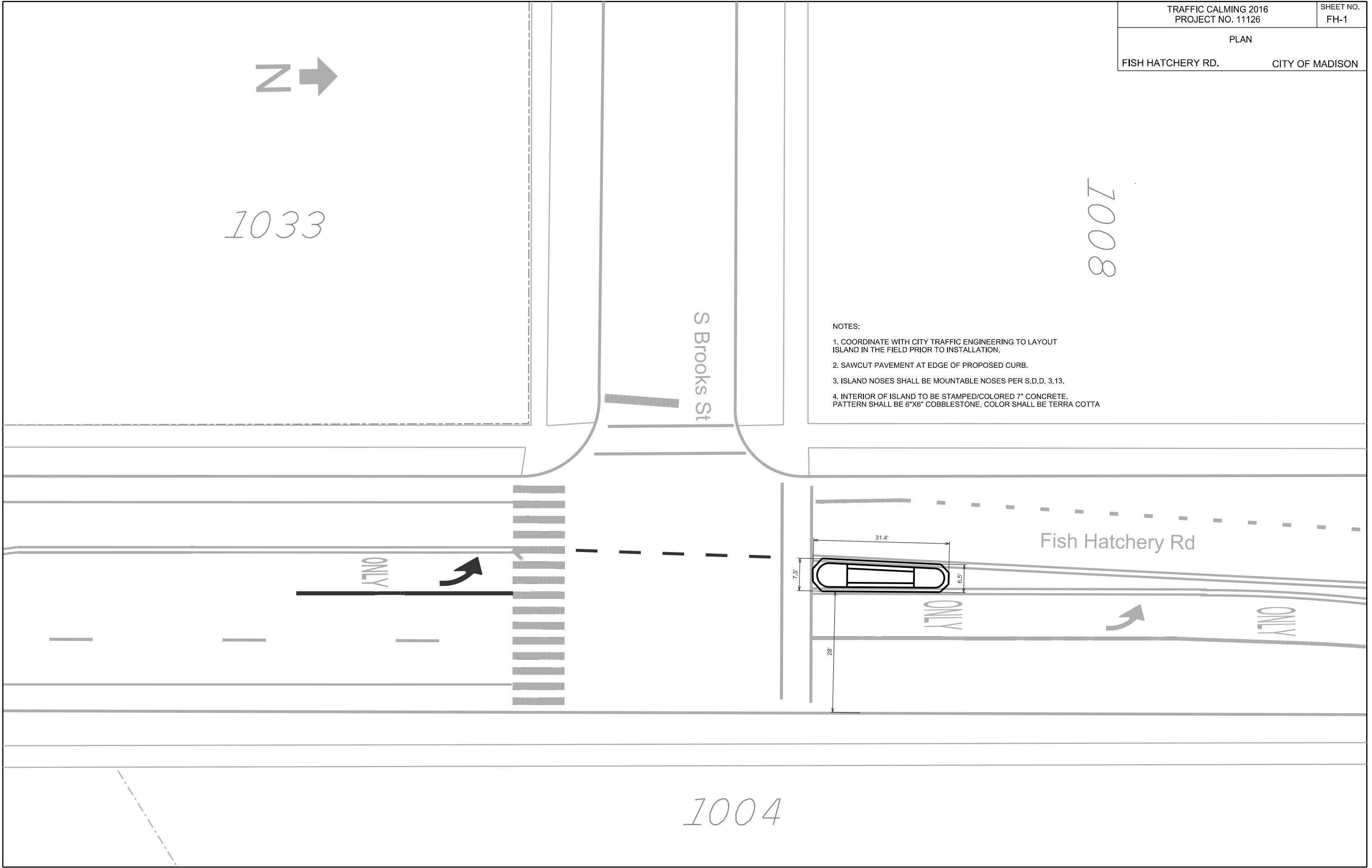

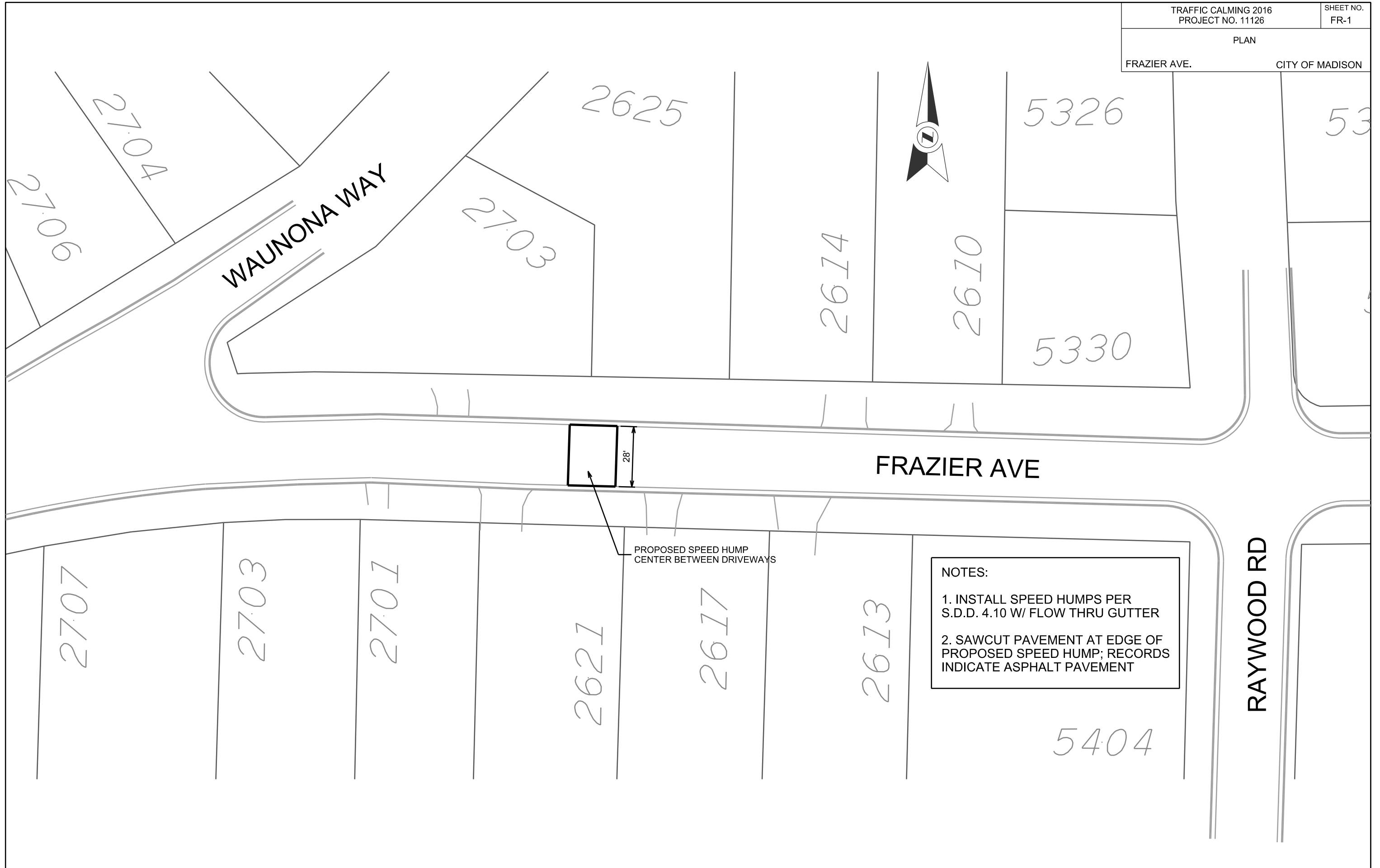

NOTES:  
1. INSTALL SPEED HUMPS PER S.D.D. 4.10 W/ FLOW THRU GUTTER  
2. SAWCUT PAVEMENT AT EDGE OF PROPOSED SPEED HUMP; RECORDS INDICATE ASPHALT PAVEMENT

PROPOSED SPEED HUMP  
CENTER BETWEEN DRIVEWAYS

PLOT SCALE:

PLOT NAME:

REV. DATE:

ORIGINATOR: CITY OF MADISON, STREETS DIVISION



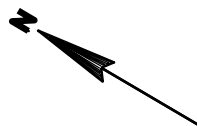

PLOT SCALE: \_\_\_\_\_

PLOT NAME: \_\_\_\_\_

REV. DATE: \_\_\_\_\_

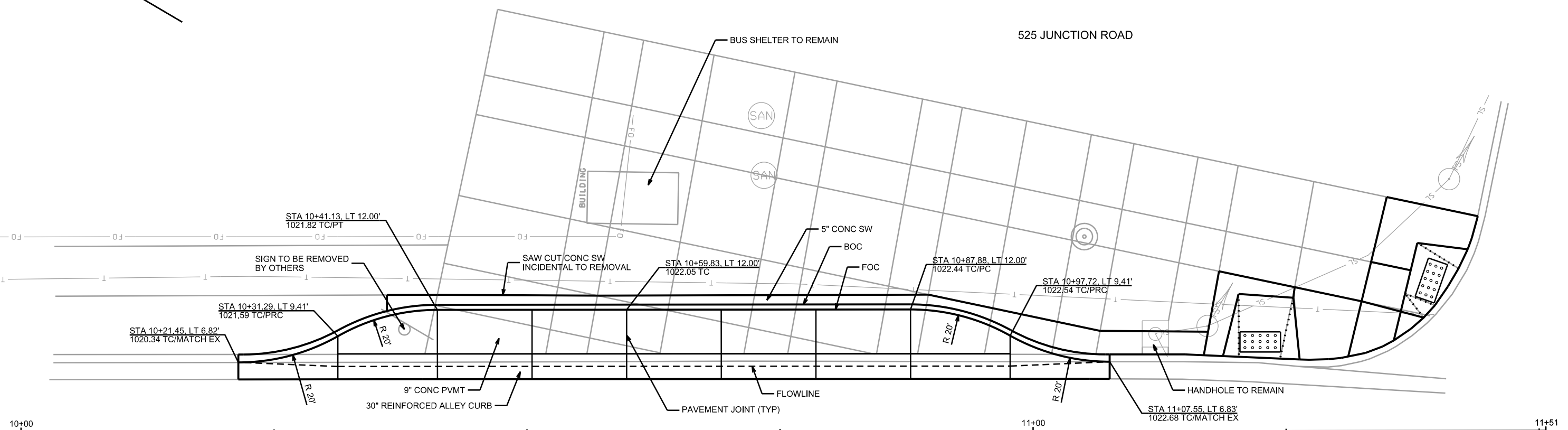

**TYPICAL SECTION DETAIL**

JUNCTION ROAD  
NOT TO SCALE

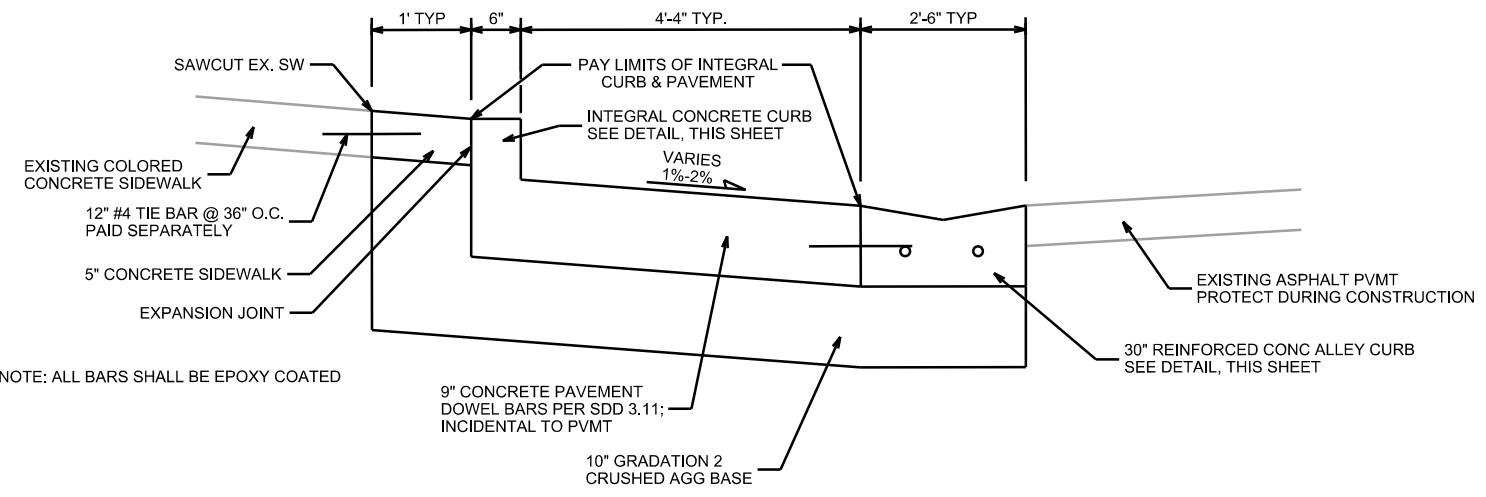

**INTEGRAL CONCRETE CURB DETAIL**

NOT TO SCALE

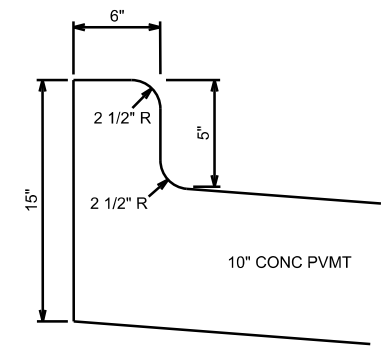

**REINFORCED ALLEY CURB DETAIL**

NOT TO SCALE

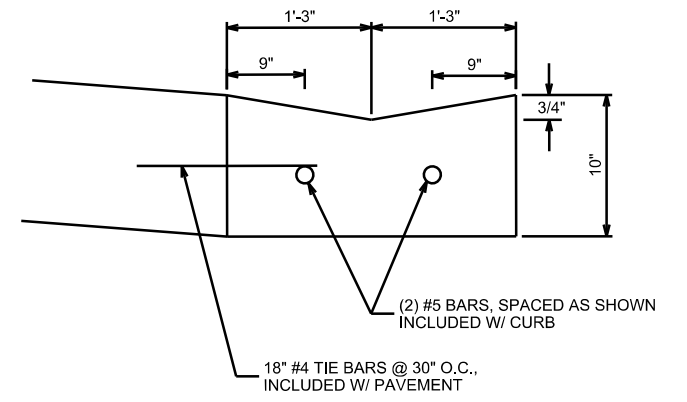

ORIGINATOR: CITY OF MADISON, STREETS DIVISION

PLOT SCALE:

PLOT NAME:

REV. DATE:

ORIGINATOR: CITY OF MADISON, STREETS DIVISION

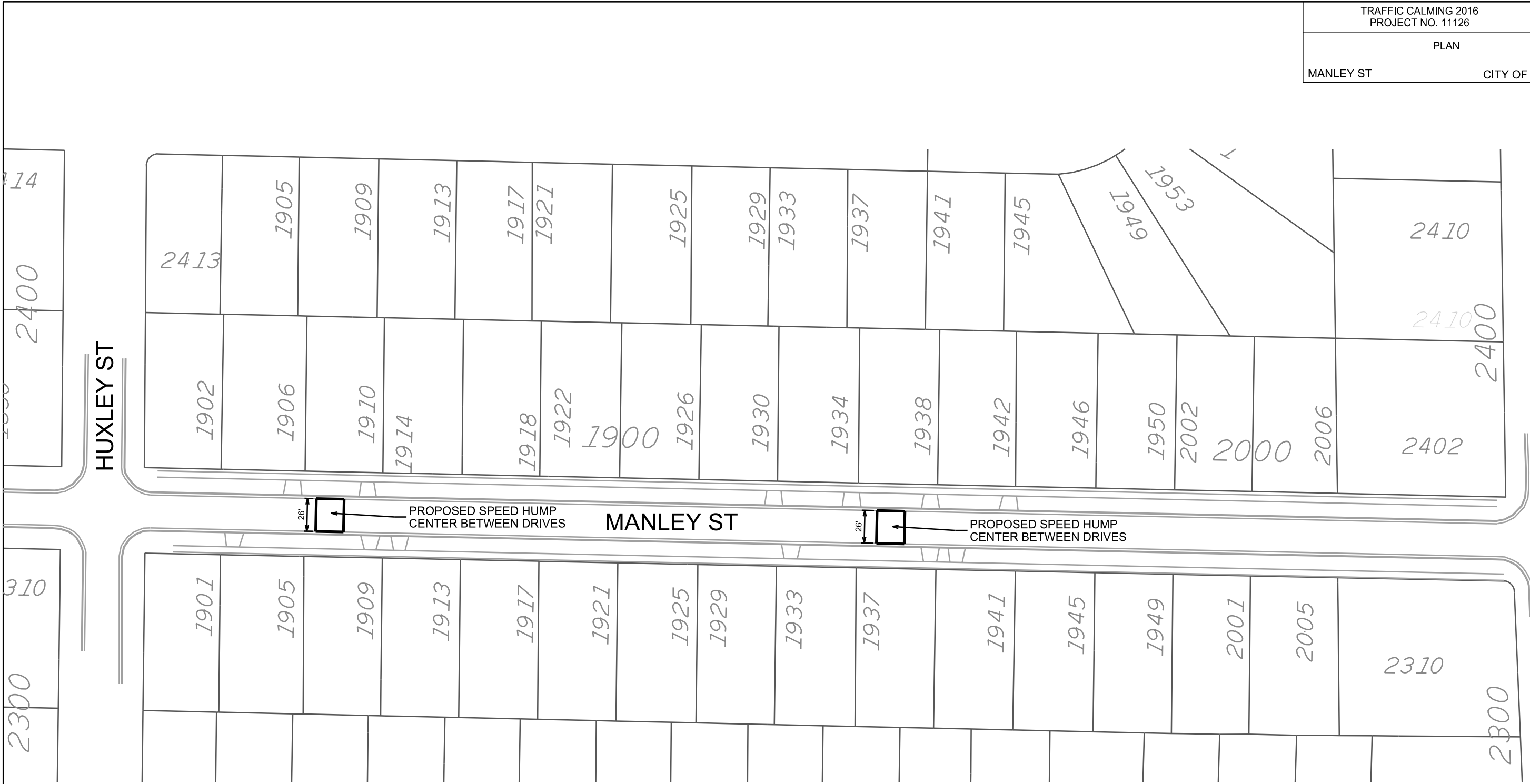

- NOTES:
1. INSTALL SPEED HUMPS PER S.D.D. 4.10 W/ FLOW THRU GUTTER
  2. SAWCUT PAVEMENT AT EDGE OF PROPOSED SPEED HUMP; RECORDS INDICATE ASPHALT PAVEMENT



NOTES:

1. COORDINATE WITH CITY TRAFFIC ENGINEERING TO LAYOUT ISLAND IN THE FIELD PRIOR TO INSTALLATION.
2. SAWCUT PAVEMENT AT EDGE OF PROPOSED CURB.
3. ISLAND NOSES SHALL BE MOUNTABLE NOSES PER S.D.D. 3.13.
4. INTERIOR OF ISLAND SHALL BE 12" OF TOPSOIL. EXCAVATION INCIDENTAL; PAID UNDER BID ITEM 20221. LEAVE SURFACE OF TOPSOIL APPROXIMATELY 4" BELOW TOP OF CURB.

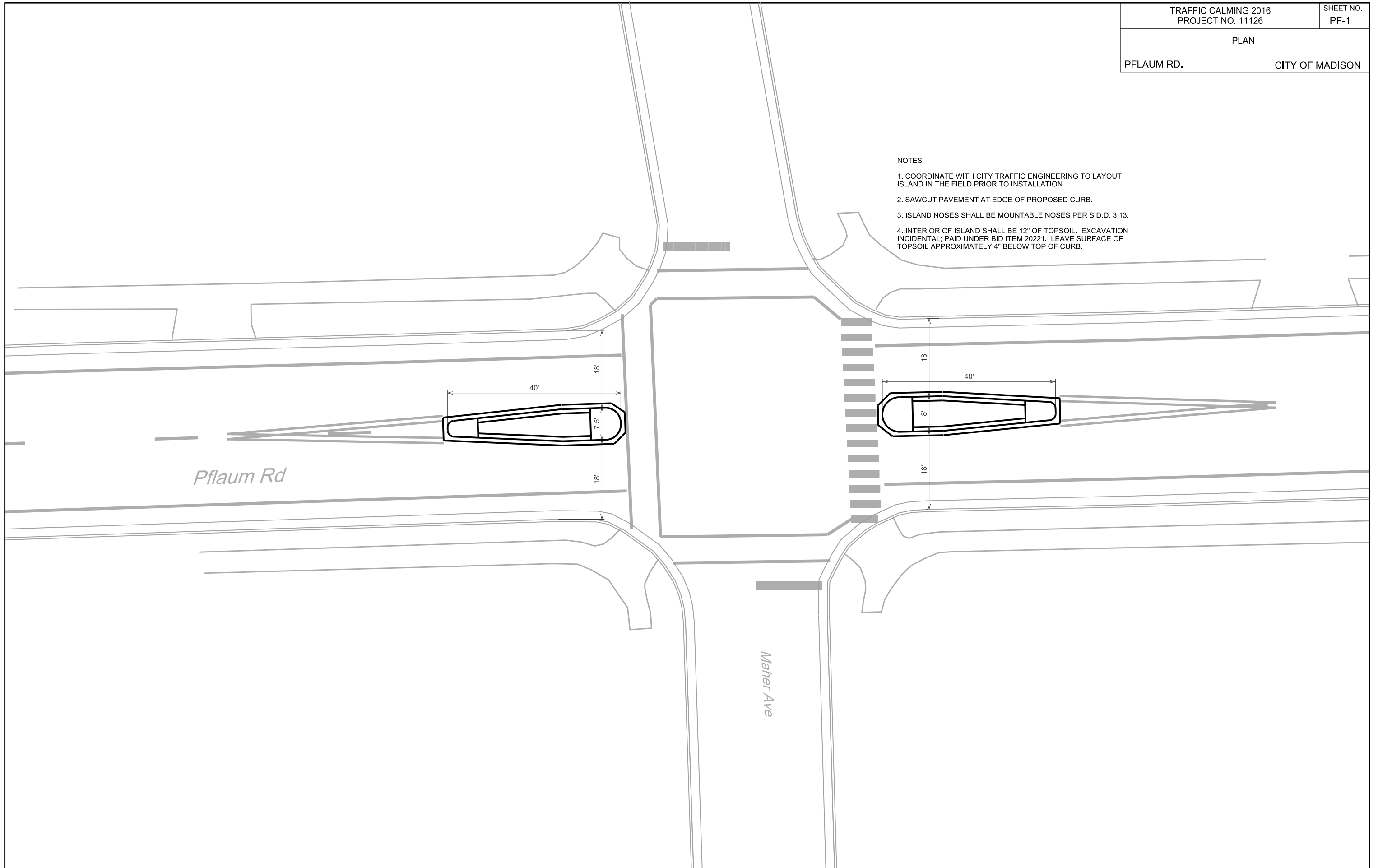

PLOT SCALE:

PLOT NAME:

REV. DATE:

ORIGINATOR: CITY OF MADISON, STREETS DIVISION

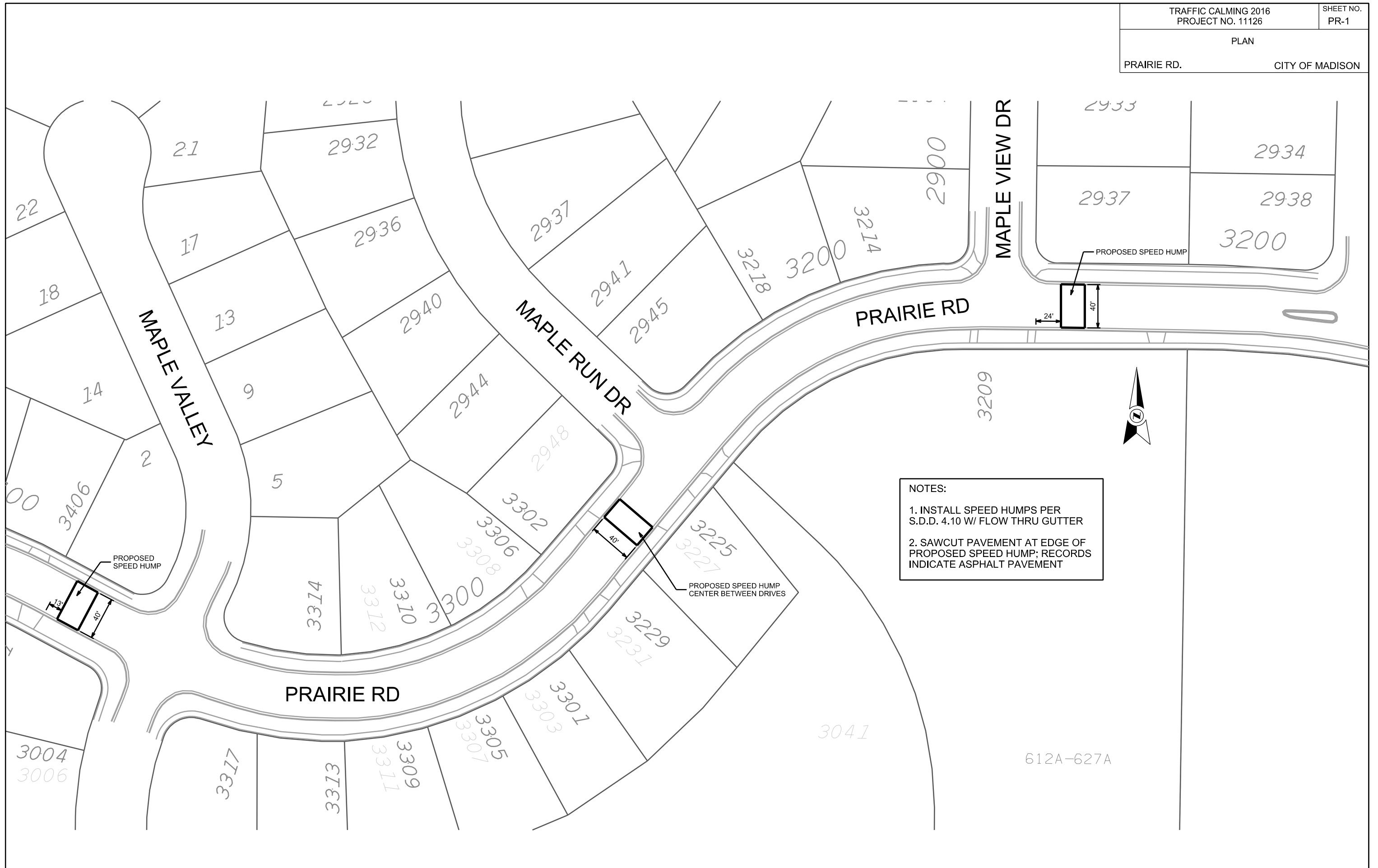

- NOTES:
1. INSTALL SPEED HUMPS PER S.D.D. 4.10 W/ FLOW THRU GUTTER
  2. SAWCUT PAVEMENT AT EDGE OF PROPOSED SPEED HUMP; RECORDS INDICATE ASPHALT PAVEMENT

PLOT SCALE:

PLOT NAME:

REV. DATE:

ORIGINATOR: CITY OF MADISON, STREETS DIVISION