



Madison, Wisconsin

CITY OF MADISON

CITY ENGINEERING DIVISION

DEPARTMENT OF PUBLIC WORKS

PLAN OF PROPOSED IMPROVEMENT

INDEX OF SHEETS

| | |
|-------------------|--|
| SHEET NO. P1-P4 | STREET PLAN & PROFILE |
| SHEET NO. PM1-PM2 | WAUBESA ST - PAVEMENT MARKINGS |
| SHEET NO. PM1-PM2 | RESEARCH PARK BLVD - PAVEMENT MARKINGS |
| SHEET NO. X1-X10 | CROSS SECTIONS |

RESURFACING 2026 - ASSESSMENT DISTRICT

CITY PROJECT NO. 15930
CONTRACT NO. 8832

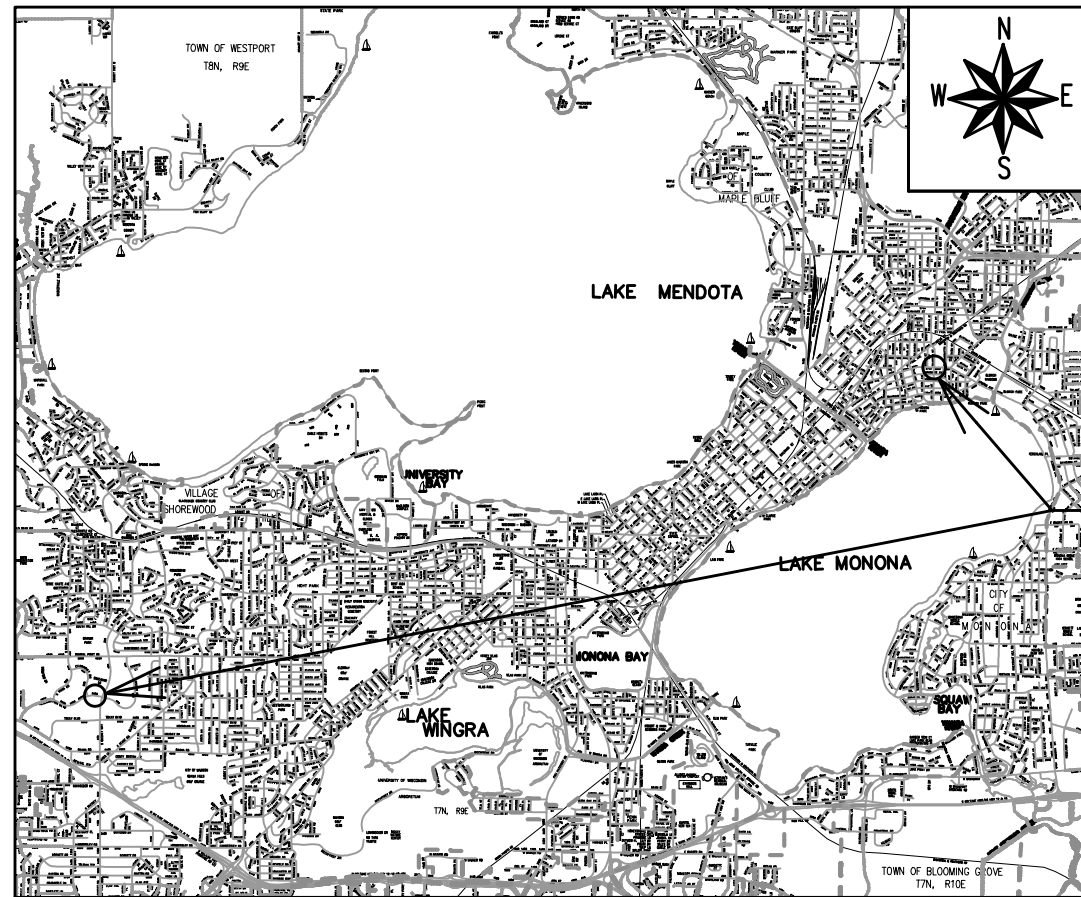

PROJECT LOCATIONS

| CONVENTIONAL SIGNS | |
|---|--------|
| FIELD VERIFY ALL UTILITY LOCATIONS | |
| GAS | — G — |
| STORM SEWER | — ST — |
| SANITARY SEWER | — SN — |
| WATER | — W — |
| BURIED ELECTRIC | — E — |
| OVERHEAD ELECTRIC | — OH — |
| POWER POLE | |
| ADA COMPLIANT RAMP W/ DETECTABLE WARNING FIELD | |
| COMBUSTIBLE FLUIDS | |

NOTES:

- ALL GUTTERS SHALL DRAIN WITH A MINIMUM GRADE OF 0.50% TOWARD STORM SEWER INLETS.
- SIDEWALK RAMPS SHALL HAVE A MAXIMUM SLOPE OF 1" PER 12". SIDEWALK AND CURB RAMPS SHALL BE CONSTRUCTED WITH A SIDE SLOPE OF 2.00%. SIDEWALK SHALL HAVE A MINIMUM LONGITUDINAL SLOPE OF 0.50% AND A MAXIMUM LONGITUDINAL SLOPE OF 5.00% EXCEPT WHERE STREET GRADES EXCEED 5.00%.

PUBLIC IMPROVEMENT PROJECT APPROVED

APRIL 21, 2026

BY THE COMMON COUNCIL OF MADISON, WISCONSIN

PUBLIC IMPROVEMENT DESIGN APPROVED BY:

 04/27/2026

City Engineer Date

STREET DESIGNED BY:

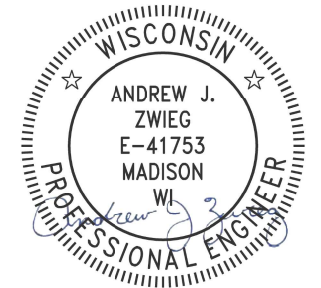

04/28/2026

PAVEMENT MARKING DESIGNED BY:



04/27/2026

PLOT SCALE: 1 IN. = 1 FT. XREF

PLOT NAME: ---

REV. DATE: 4/23/2026 9:59 AM

ORIGINATOR: CITY_OF_MADISON

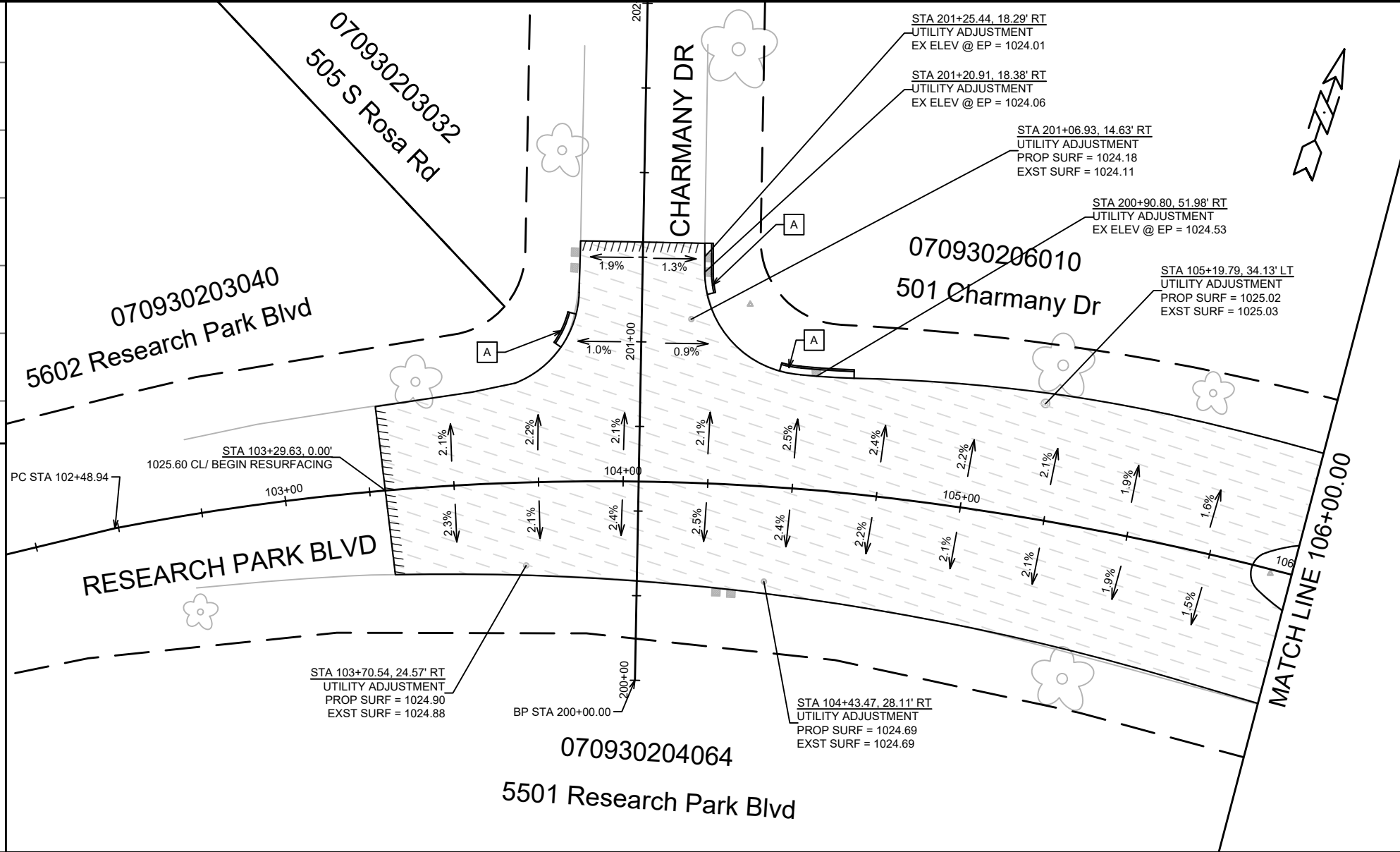
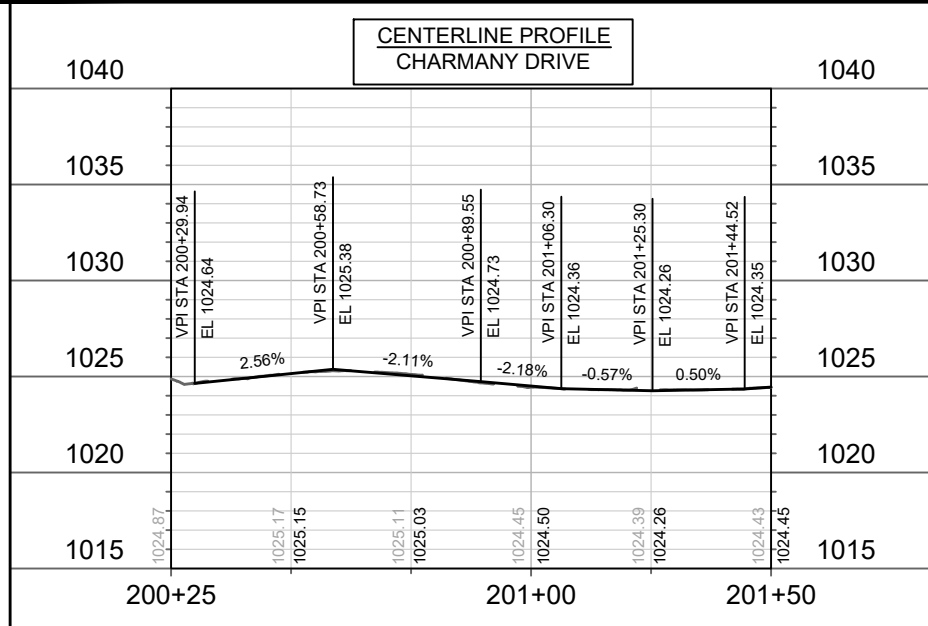

LEGEND

- =SAWCUT
- =TYPE 'A' CONCRETE CURB & GUTTER.
- =PULVERIZE & SHAPE WITH UNDERCUT AS NEEDED. PAID BY BID ITEMS IN CONTRACT.

NOTES:

- RESEARCH PARK BLVD RESURFACING LIMITS;
2" HMA UPPER LAYER - 4 MT 58 - 28 S
3.5" HMA LOWER LAYER - 3 MT 58 - 28 S
- ADJUST MANHOLES, INLETS, WATERVALVES AS NEEDED TO FINISH GRADES PRIOR TO PAVING. PAID BY BID ITEMS IN CONTRACT.

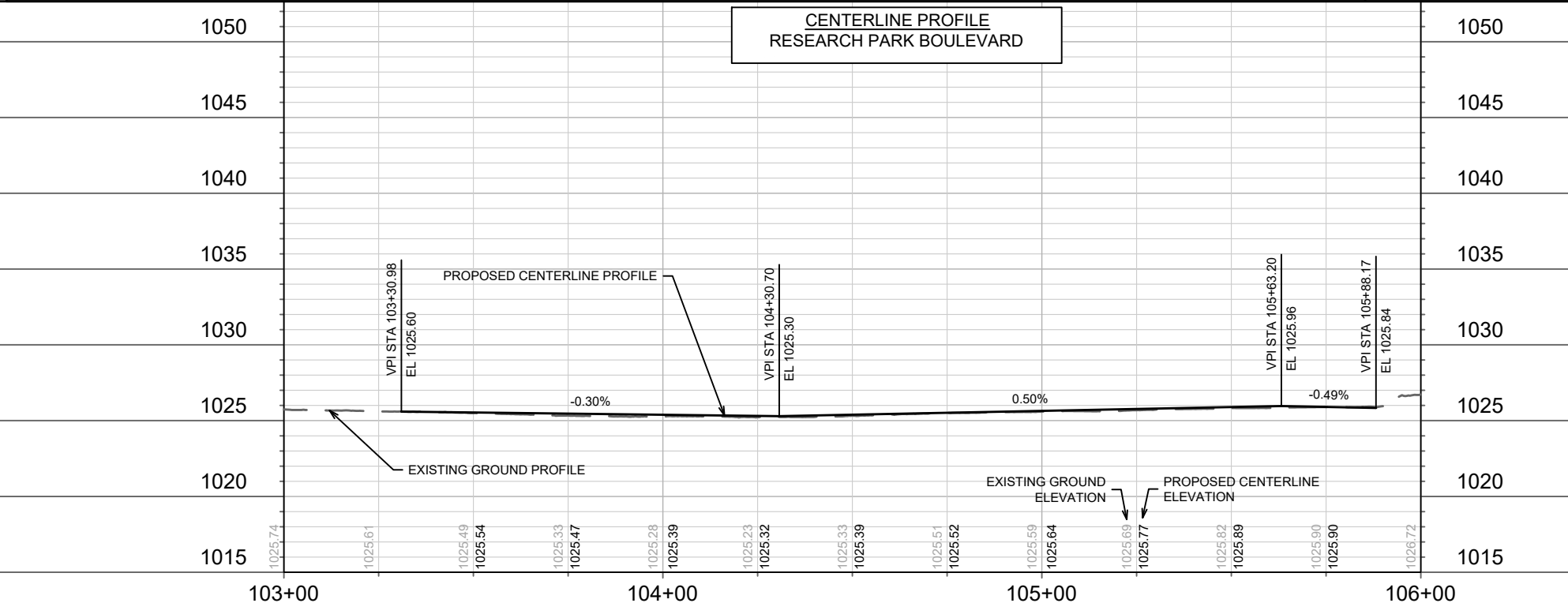

| | | | |
|--|-------|--------------|-----|
| 15930 | 15930 | 8832 | P-1 |
| STREET PLAN & PROFILE - RESEARCH PARK BOULEVARD | | MADISON, WI | |
| RESURFACING 2026 - ASSESSMENT DISTRICT | | CONTRACT NO: | |
| M:\DESIGN\Projects\15930\CAD\Streets\15930EN-PnP.dwg | | 15930 | |
| CITY OF MADISON WISCONSIN | | 15930 | |
| 15930 | | P-1 | |

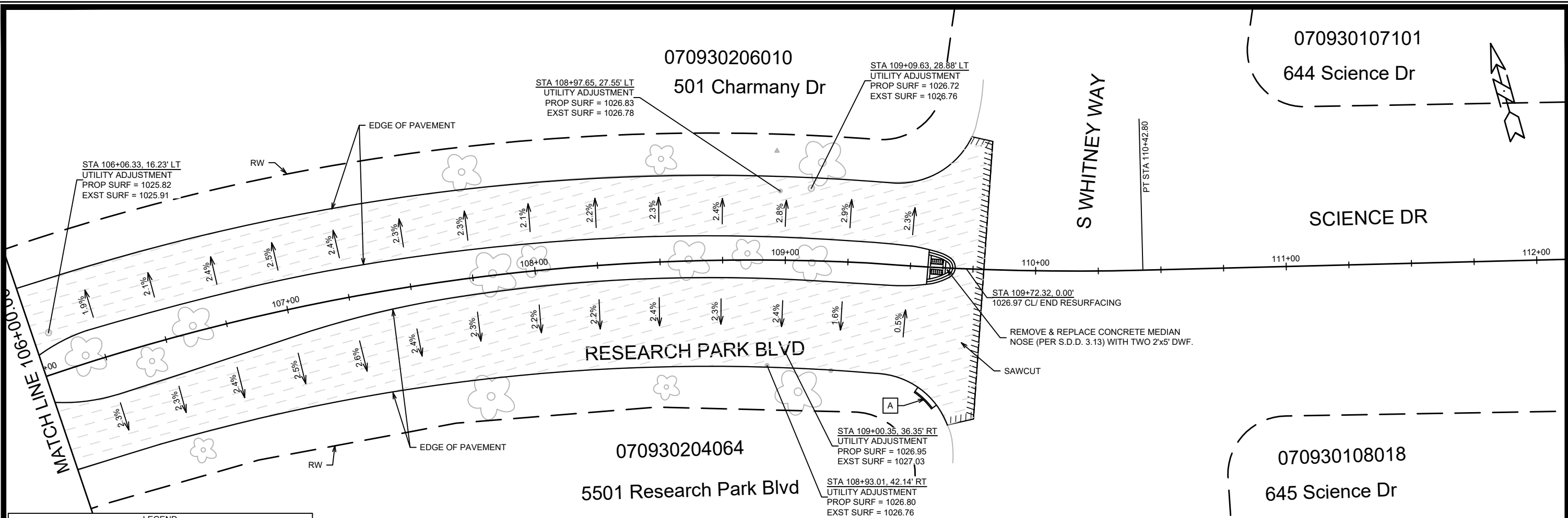

LEGEND

| | |
|--|---|
| | = SAWCUT |
| | = TYPE 'A' CONCRETE CURB & GUTTER. |
| | = PULVERIZE & SHAPE WITH UNDERCUT AS NEEDED. PAID BY BID ITEMS IN CONTRACT. |

**CENTERLINE PROFILE
RESEARCH PARK BOULEVARD**

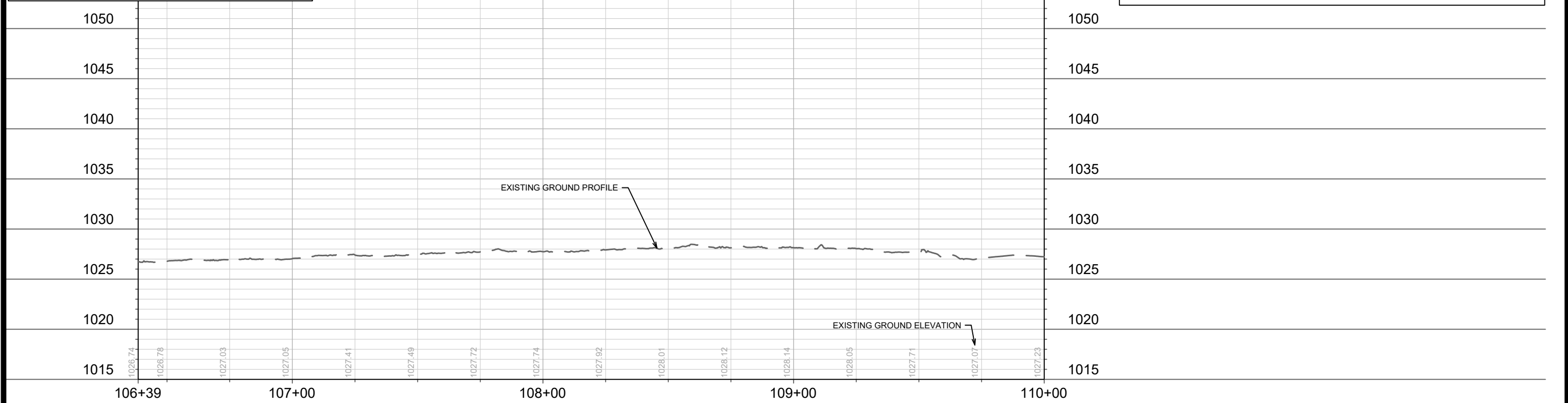

- NOTES:**
- RESEARCH PARK BLVD RESURFACING LIMITS;
2" HMA UPPER LAYER - 4 MT 58 - 28 S
3.5" HMA LOWER LAYER - 3 MT 58 - 28 S
 - ADJUST MANHOLES, INLETS, WATERVALVES AS NEEDED TO FINISH GRADES PRIOR TO PAVING. PAID BY BID ITEMS IN CONTRACT.

| | |
|-----------------|--------------------------|
| DATE | BY |
| REVISION | |
| MARK | |
| Designed By: ID | Date: 4/23/2026 10:10 AM |
| 15930 | P-2 |

15930
MADISON, WI
8832
CONTRACT NO:

STREET PLAN & PROFILE - RESEARCH PARK BOULEVARD
RESURFACING 2026 - ASSESSMENT DISTRICT
M:\DESIGN\Projects\15930\CAD\Streets\15930EN-PrP.dwg

15930
P-2

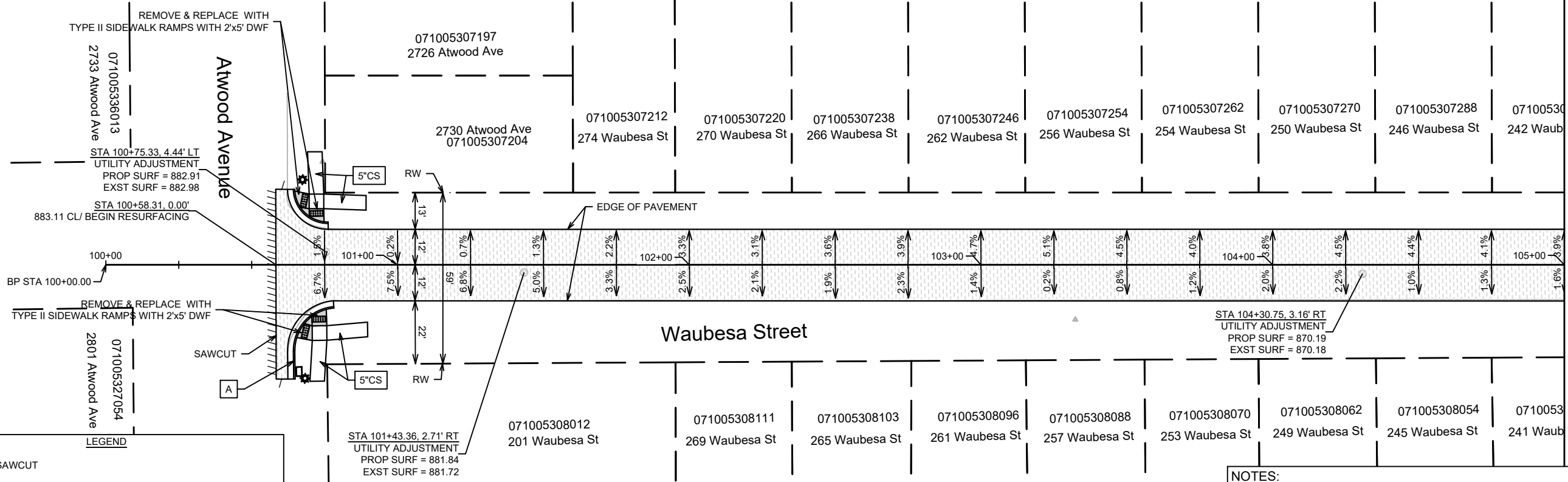
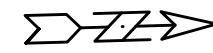

LEGEND

- = SAWCUT
- = 5-INCH CONCRETE SIDEWALK.
- = 6-INCH TOPSOIL, SEED & MATTING.
- = TYPE 'A' CONCRETE CURB & GUTTER.
- = 7" CONCRETE SIDEWALK, DRIVE APRON OR RAMP.
- = PULVERIZE & SHAPE WITH UNDERCUT AS NEEDED. PAID BY BID ITEMS IN CONTRACT.

NOTES:

- WAUBESA STREET RESURFACING LIMITS;
2.0" HMA UPPER LAYER - 4 MT 58 - 28 S
2.5" HMA LOWER LAYER - 3 MT 58 - 28 S
- ADJUST MANHOLES, INLETS, WATERVALVES AS NEEDED TO FINISH GRADES PRIOR TO PAVING. PAID BY BID ITEMS IN CONTRACT.

**CENTERLINE PROFILE
WAUBESA STREET**

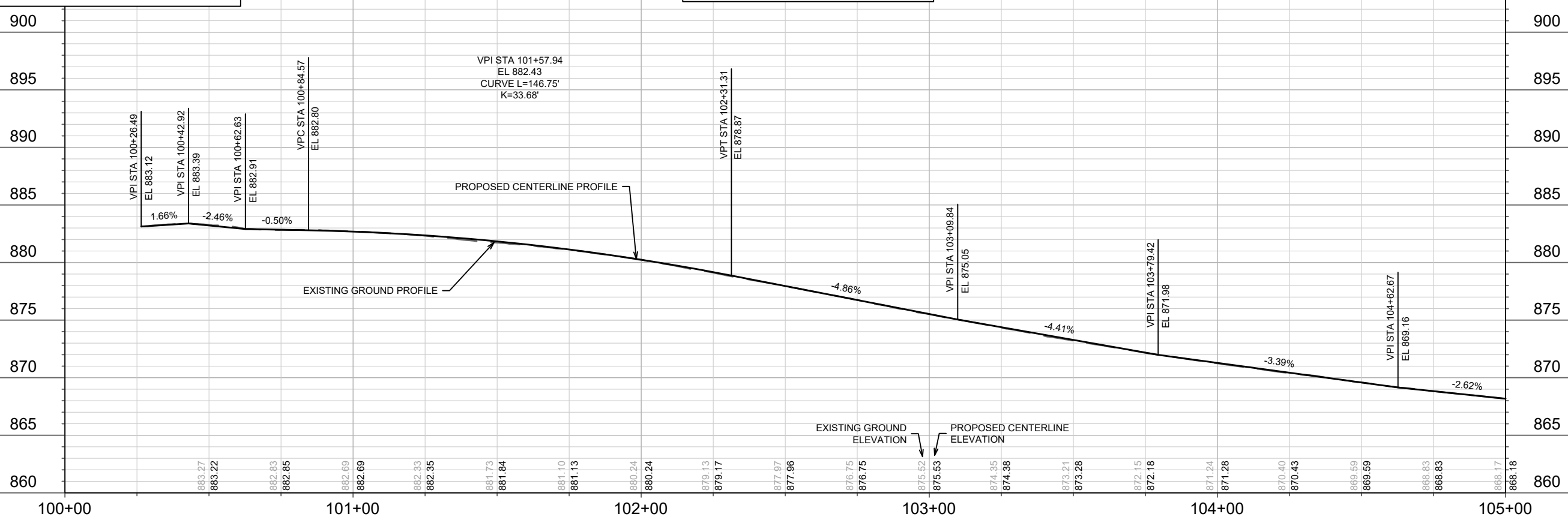

MATCH LINE 105+00.00

| MARK | REVISION | DATE | BY |
|------|----------|------|----|
| | | | |
| | | | |
| | | | |

Designed By: ID
Date: 4/23/2026 10:10 AM
Scale: 1" = 40'

15930

15930

MADISON, WI

8832

CONTRACT NO:

STREET PLAN & PROFILE - WAUBESA STREET

RESURFACING 2026 - ASSESSMENT DISTRICT

M:\DESIGN\Projects\15930\CAD\Streets\15930EN-PnP.dwg



15930

P-3

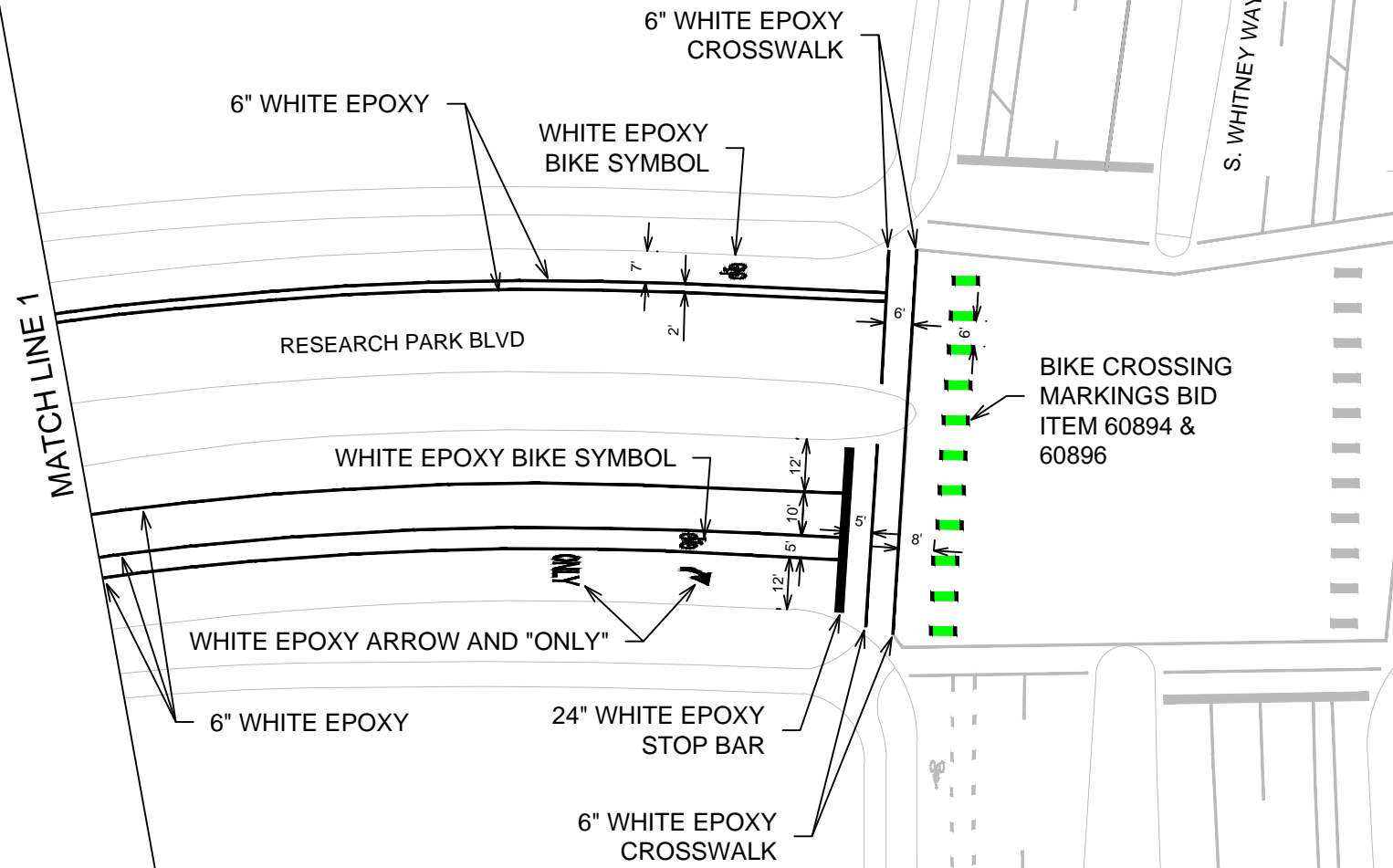

| MARK | REVISION | DATE | BY |
|-------|--------------------|------|------|
| 15930 | 4/27/2026 11:44 AM | | PM-2 |

RESEARCH PARK BLVD - PAVEMENT MARKINGS
2026 RESURFACING
 M:\DESIGN\Traffic\LMC\Construction Projects\2026 - Projects\15930 - Patching Marking Plans\15930 - Research Park Blvd - Resurfacing Contract No: 15930



15930
 PM-2

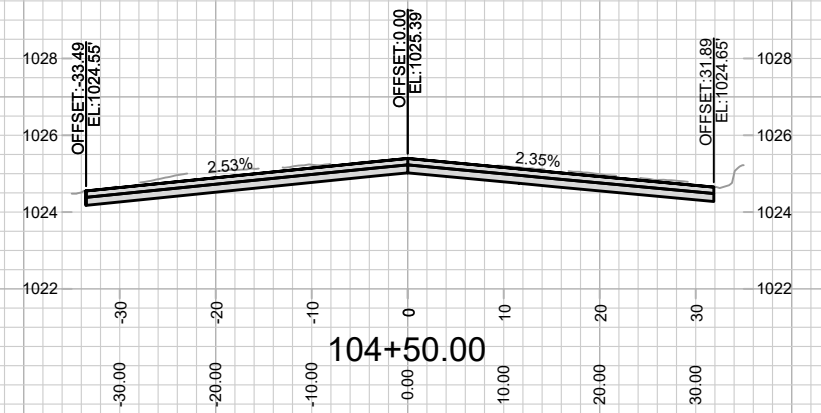
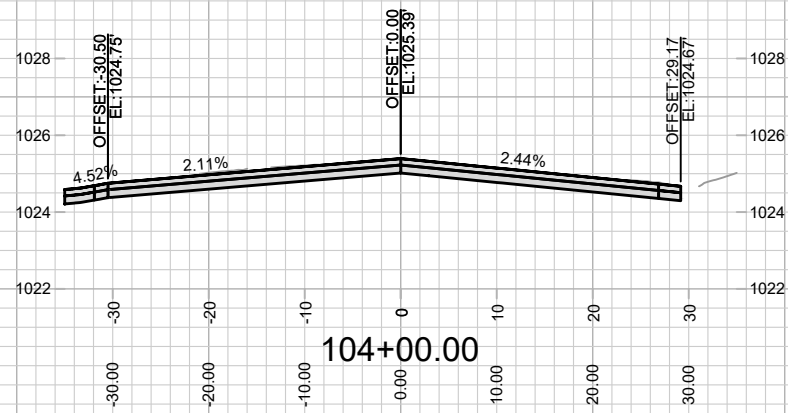
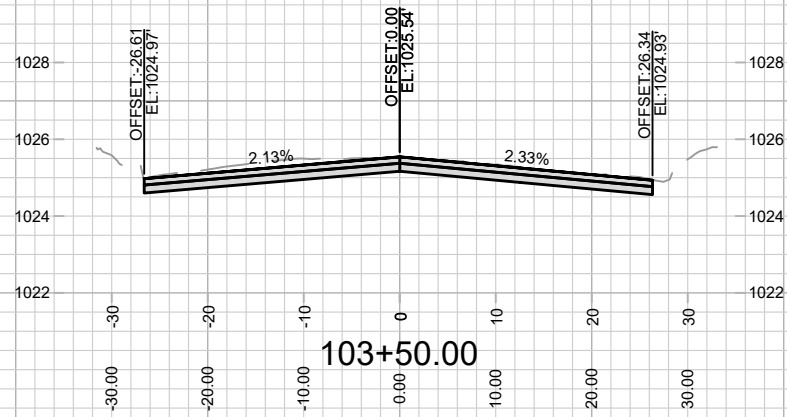
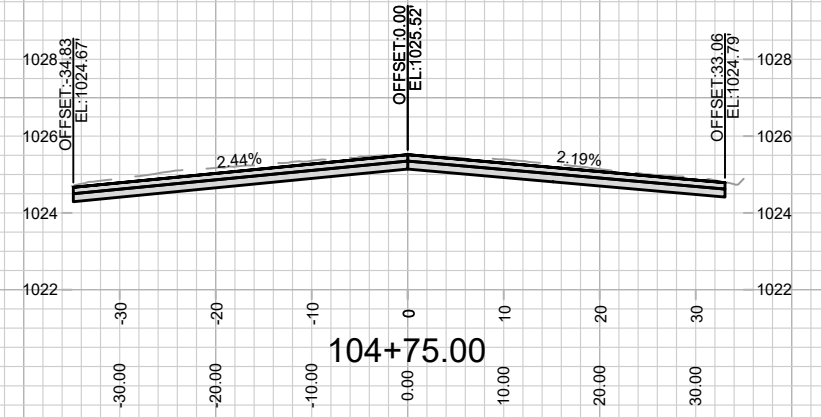
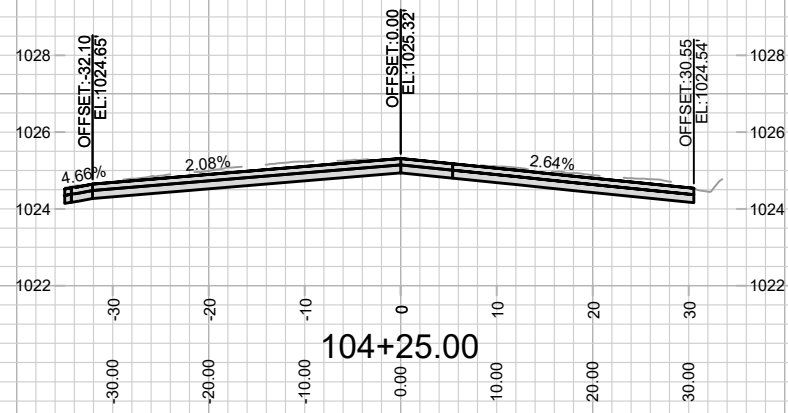
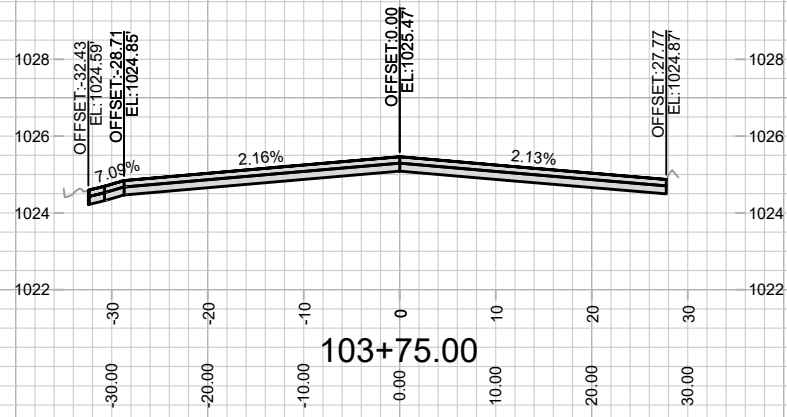

| MARK | REVISION | DATE | BY |
|------|----------|------|----|
| | | | |
| | | | |
| | | | |

15930
MADISON, WI
8832
CONTRACT NO:

CROSS SECTION - RESEARCH PARK BOULEVARD
2026 RESURFACING - ASPHALT PAVEMENT
M:\DESIGN\Projects\15930\CAD\Streets\15930\EN-Corridor_Research Park.dwg



15930
X-1

Designed By: 15930
Date: 4/27/2026 3:07 PM
Scale: 1" = 20'
X-1

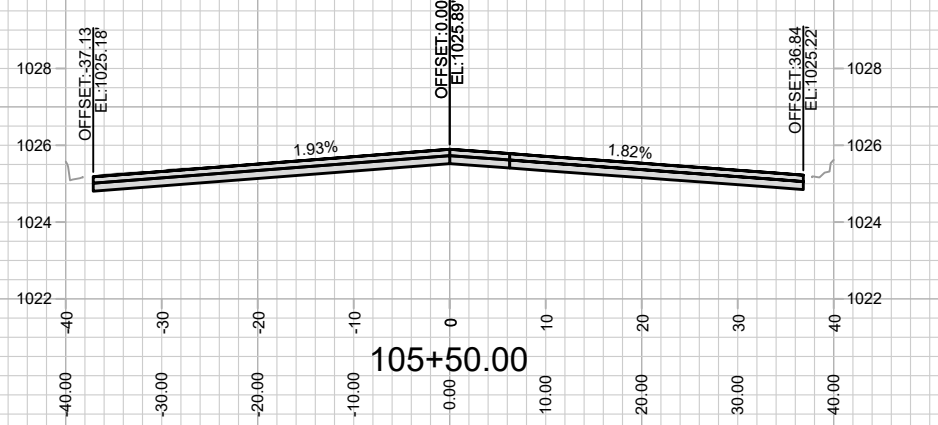
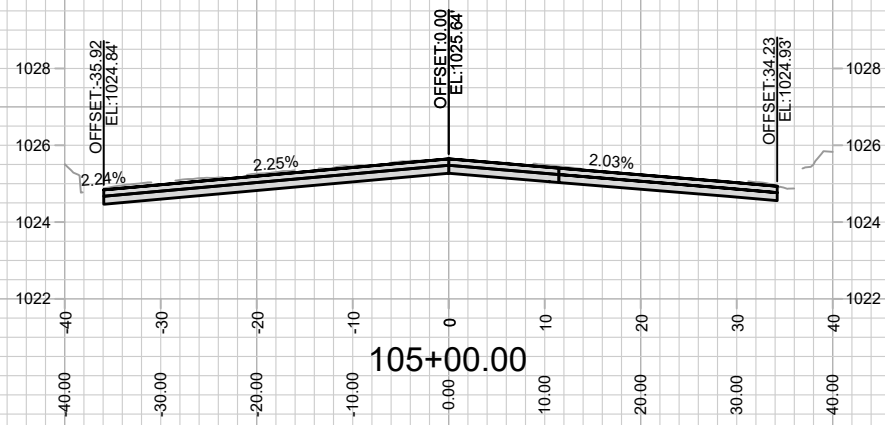
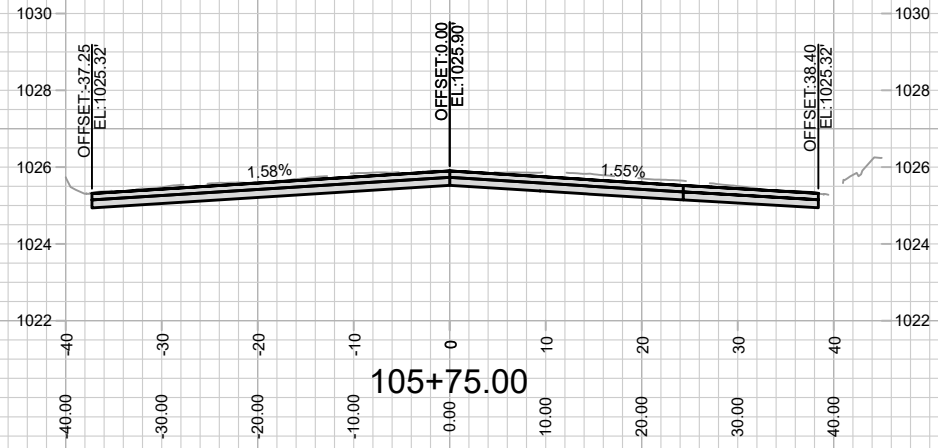
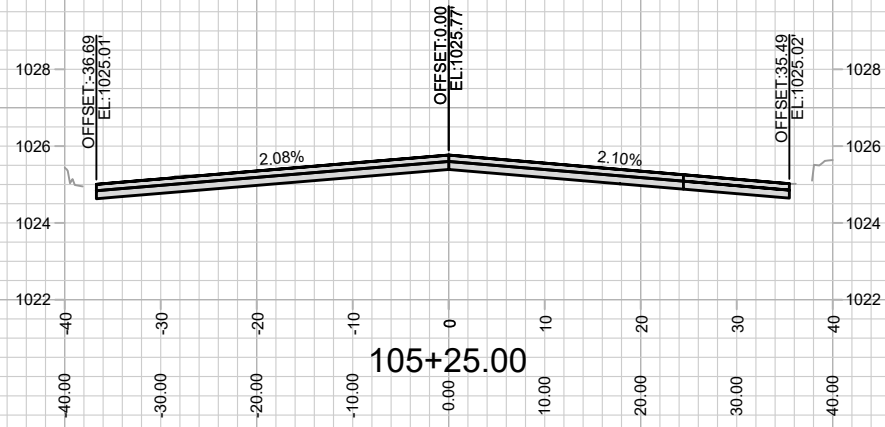

| | | | |
|-----------------|-------------------|------|-----------------|
| MARK | REVISION | DATE | BY |
| 15930 | 4/27/2026 3:07 PM | | |
| Designed By: ID | | | Scale: 1" = 20' |
| 15930 | | | X-2 |

15930
MADISON, WI
8832
CONTRACT NO:

CROSS SECTION - RESEARCH PARK BOULEVARD
2026 RESURFACING - ASPHALT PAVEMENT
M:\DESIGN\Projects\15930\CAD\Streets\15930\EN-Corridor_Research Park.dwg



15930
X-2

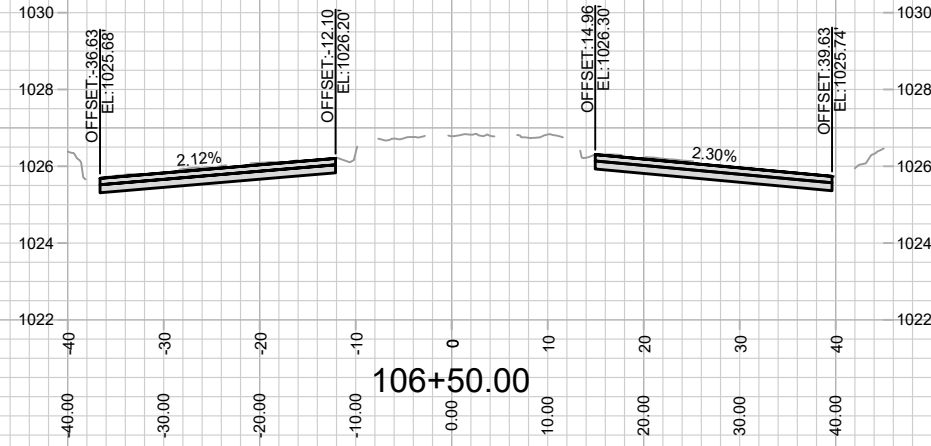
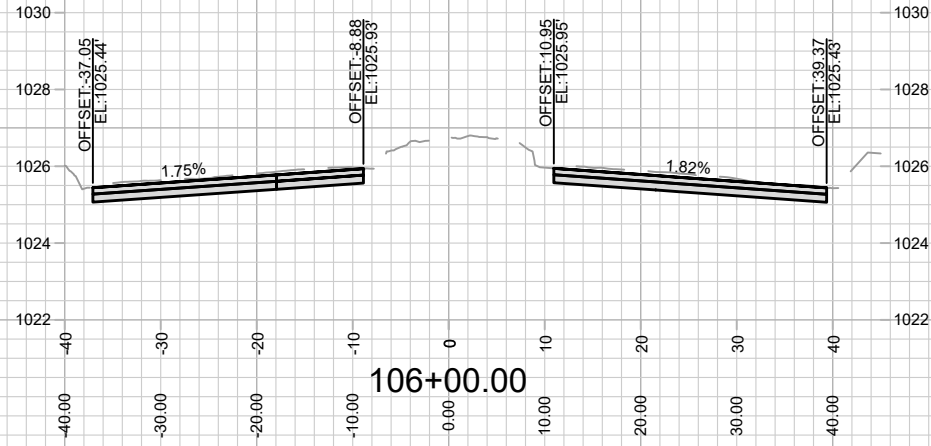
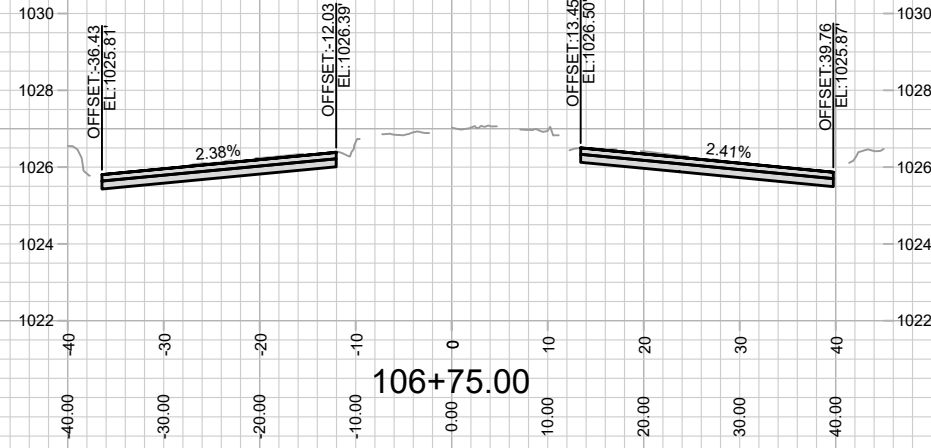
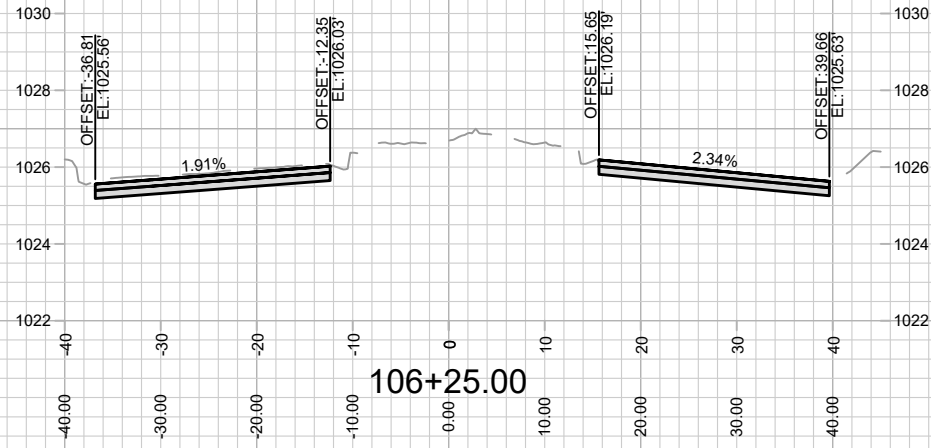

| MARK | REVISION | DATE | BY |
|------|----------|------|----|
| | | | |
| | | | |
| | | | |

15930
 MADISON, WI
 8832
 CONTRACT NO:

CROSS SECTION - RESEARCH PARK BOULEVARD
 2026 RESURFACING - ASPHALT PAVEMENT
 M:\DESIGN\Projects\15930\CAD\Streets\15930\EN-Corridor_Research Park.dwg



15930
 X-3

Designed By: 15930
 Date: 4/27/2026 3:07 PM
 Scale: 1" = 20'
 X-3

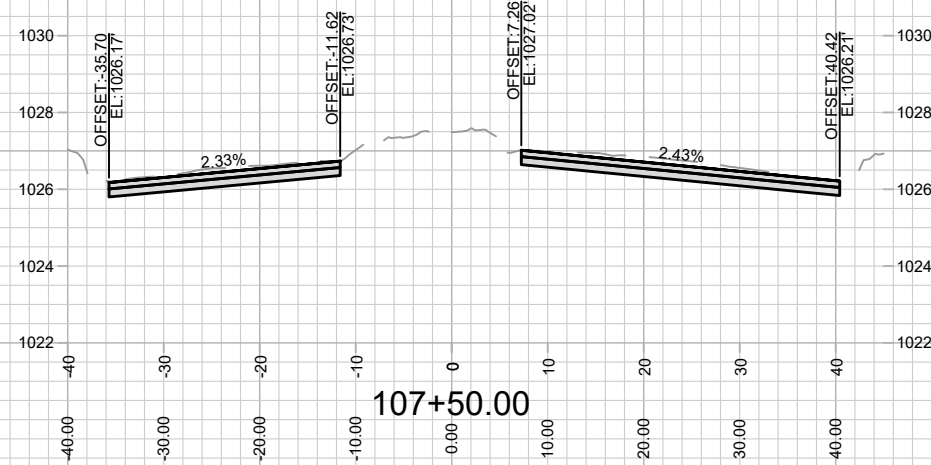
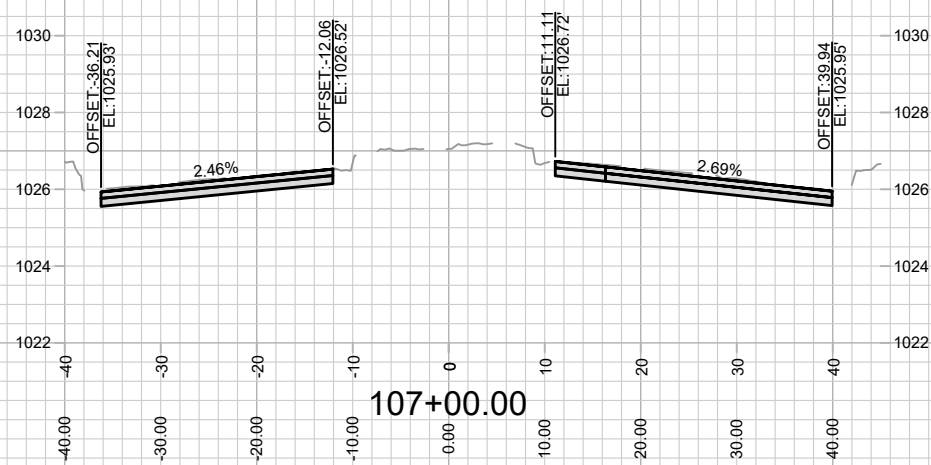
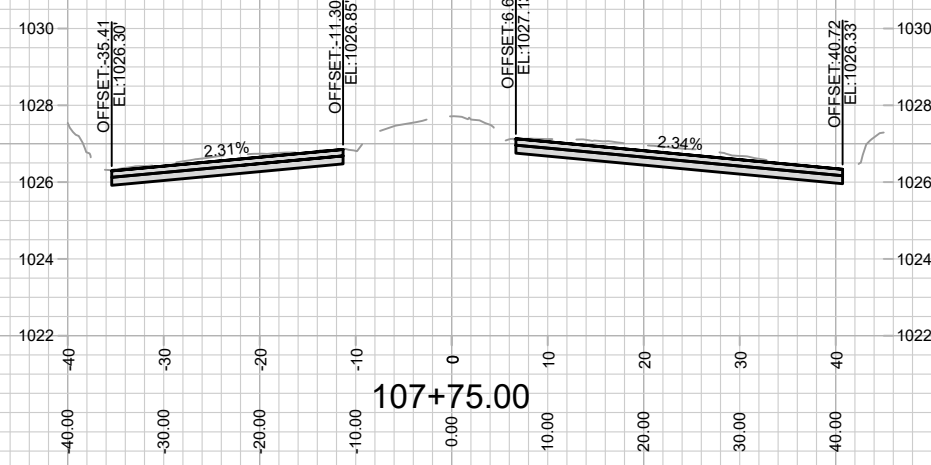
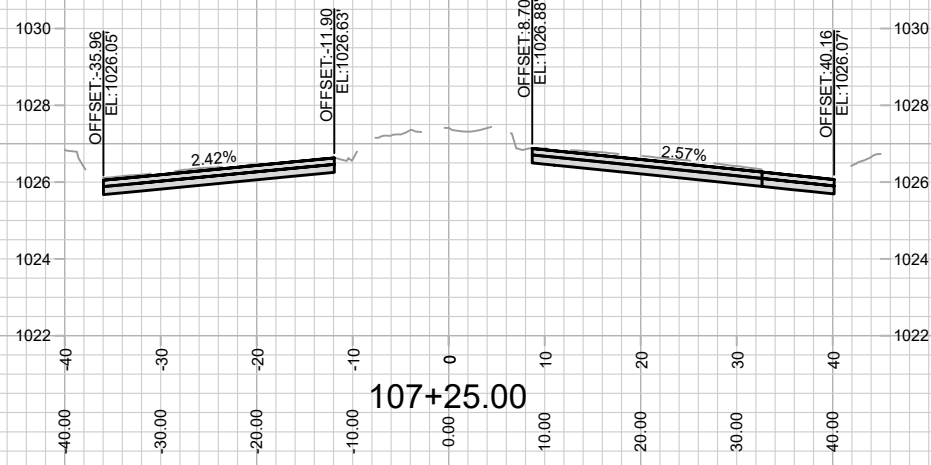

| MARK | REVISION | DATE | BY |
|------|----------|------|----|
| | | | |
| | | | |
| | | | |

15930
 MADISON, WI
 8832
 CONTRACT NO:

CROSS SECTION - RESEARCH PARK BOULEVARD
 2026 RESURFACING - ASPHALT PAVEMENT
 M:\DESIGN\Projects\15930\CAD\Streets\15930\EN-Corridor_Research Park.dwg



15930
 X-4

Designed By: 15930
 Date: 4/27/2026 3:09 PM
 Scale: 1" = 20'
 X-4

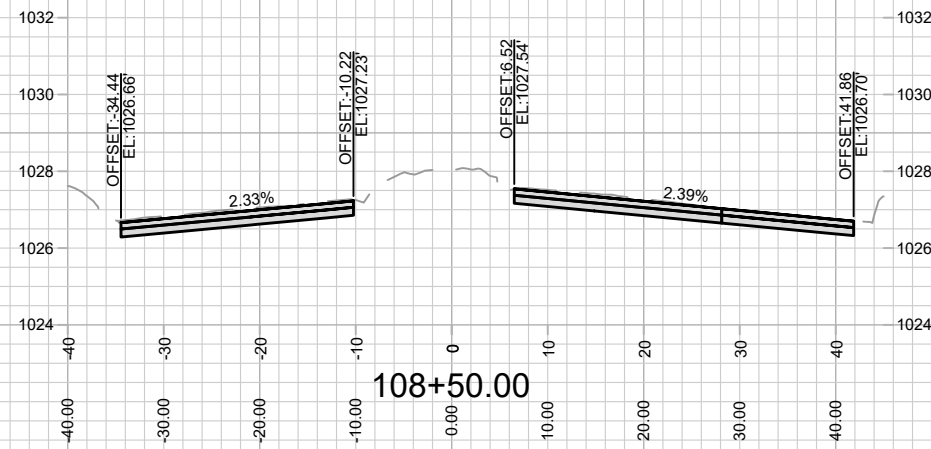
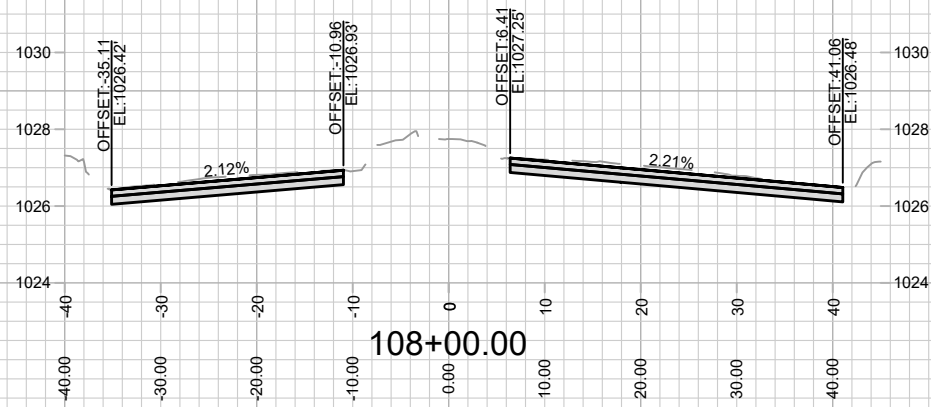
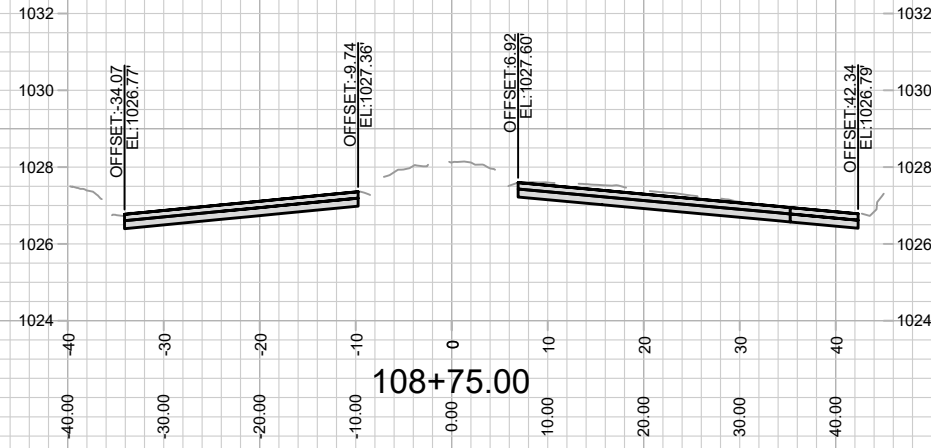
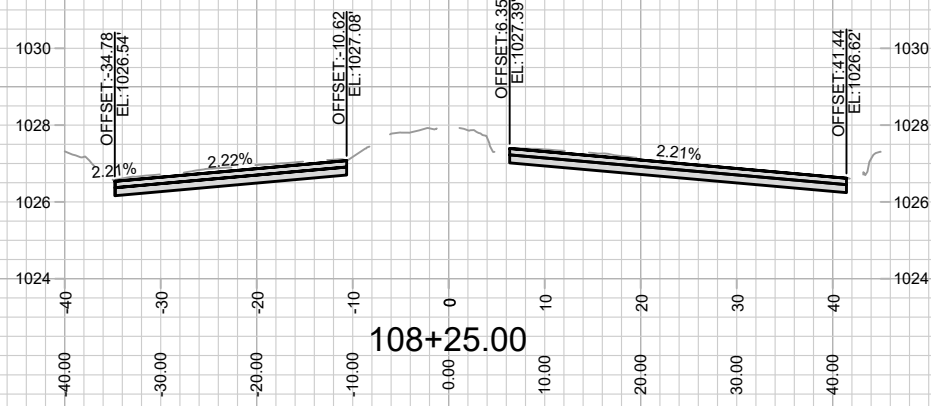

| MARK | REVISION | DATE | BY |
|------|----------|------|----|
| | | | |
| | | | |
| | | | |

15930
 MADISON, WI
 8832
 CONTRACT NO:
 M:\DESIGN\Projects\15930\CAD\Streets\15930\EN-Corridor_Research Park.dwg



15930
 X-5

Scale: 1" = 20'
 X-5

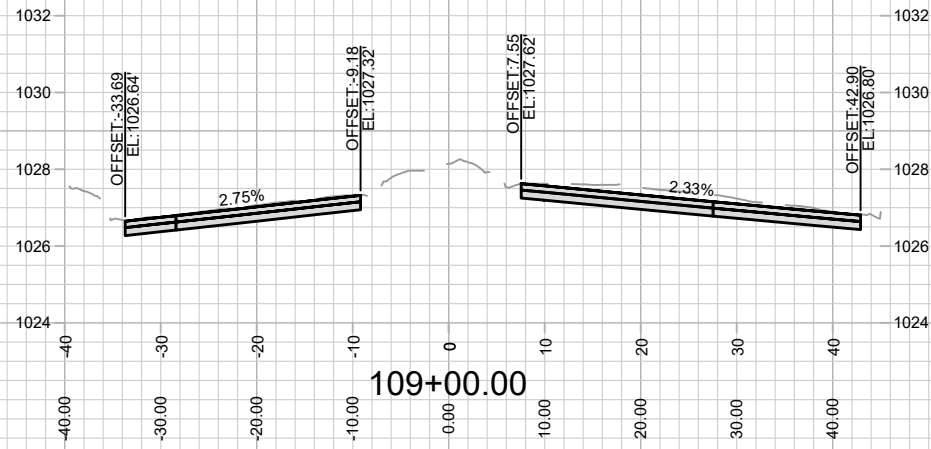
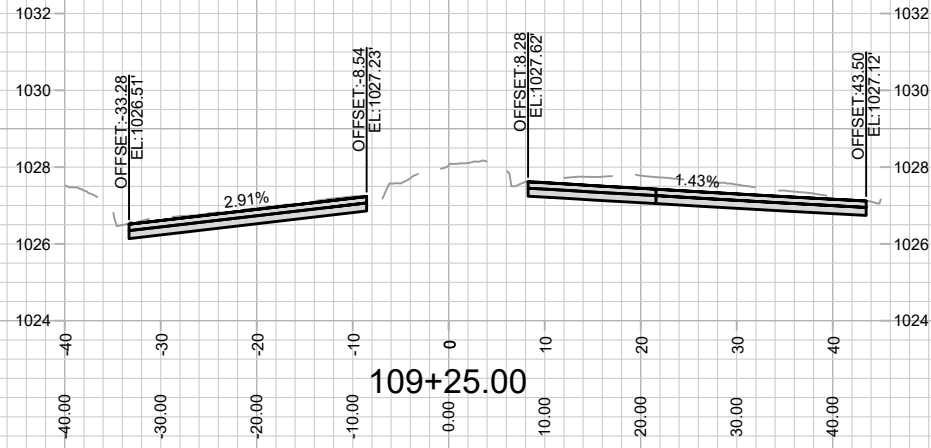

| MARK | REVISION | DATE | BY |
|------|----------|------|----|
| | | | |
| | | | |
| | | | |

15930
 MADISON, WI
 8832
 CONTRACT NO:

CROSS SECTION - RESEARCH PARK BOULEVARD
 2026 RESURFACING - ASPHALT PAVEMENT
 M:\DESIGN\Projects\15930\CAD\Streets\15930\EN-Corridor_Research Park.dwg



15930
 X-6

Designed By: ID
 15930
 Date: 4/27/2026 3:08 PM
 Scale: 1" = 20'
 X-6

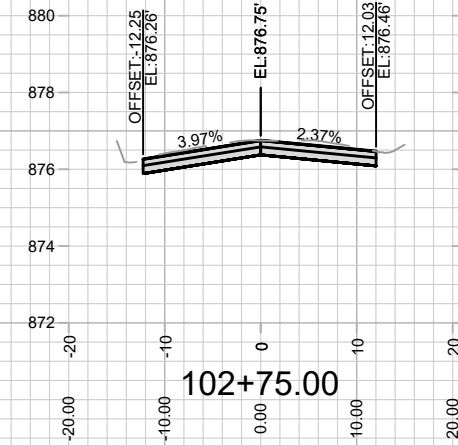
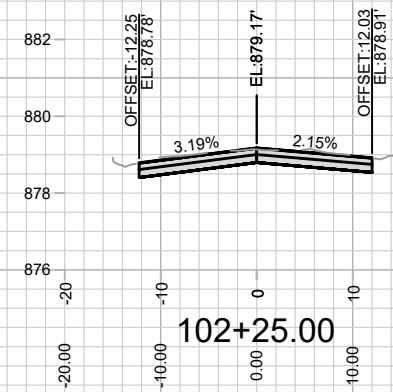
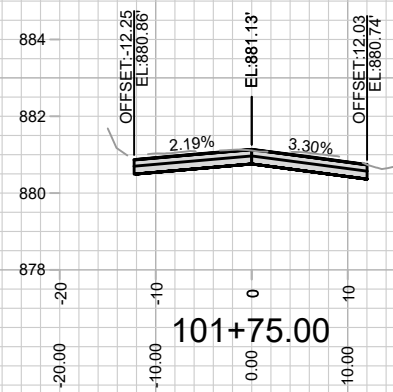
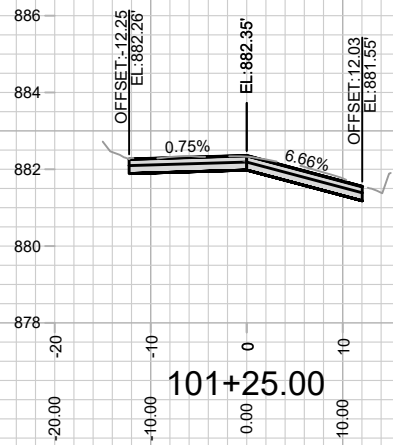
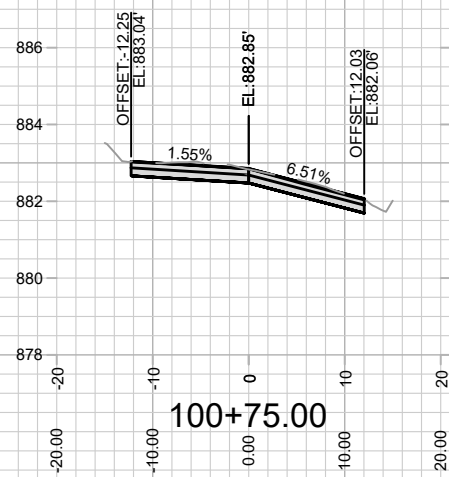
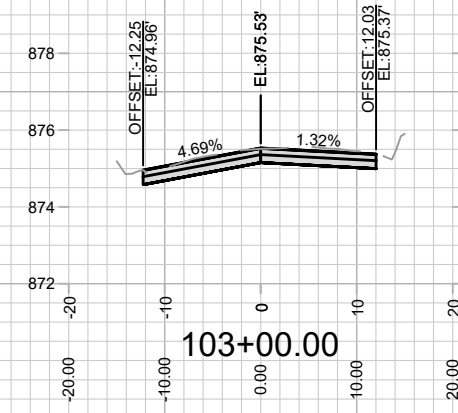
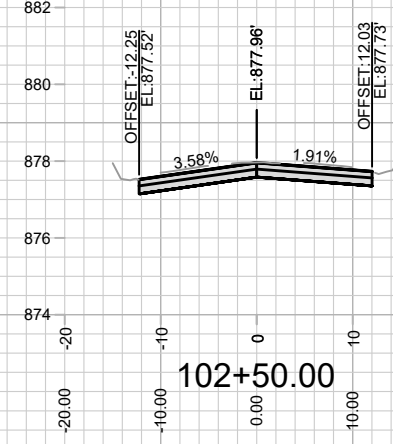
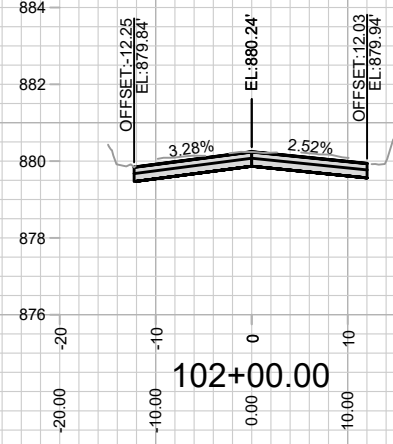
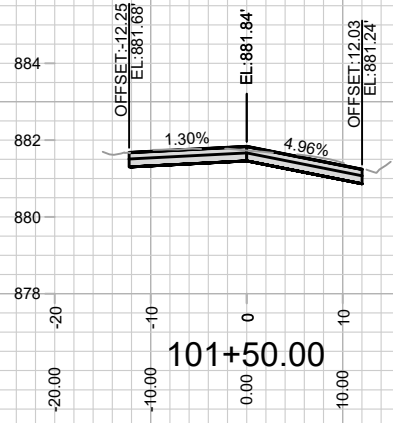
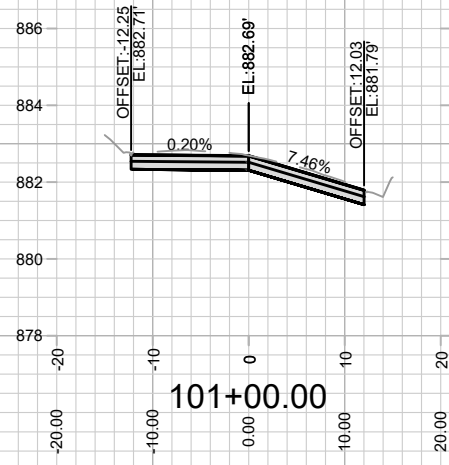

| MARK | REVISION | DATE | BY |
|------|----------|------|----|
| | | | |
| | | | |
| | | | |

15930
MADISON, WI
8832
CONTRACT NO:

CROSS SECTION - WAUBESA STREET
2026 RESURFACING - ASPHALT PAVEMENT
M:\DESIGN\Projects\15930\CAD\Streets\15930EN-Corridor_Waubesa St.dwg



15930
X-7

Date: 4/27/2026 3:08 PM
Scale: 1" = 20'

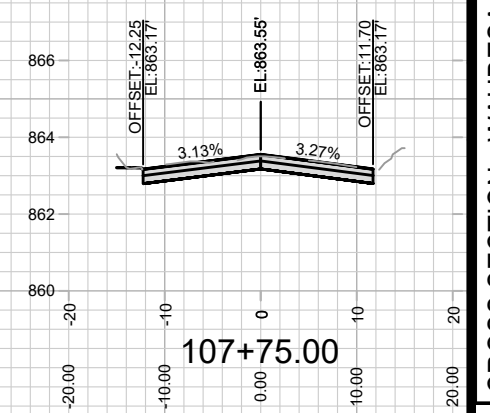
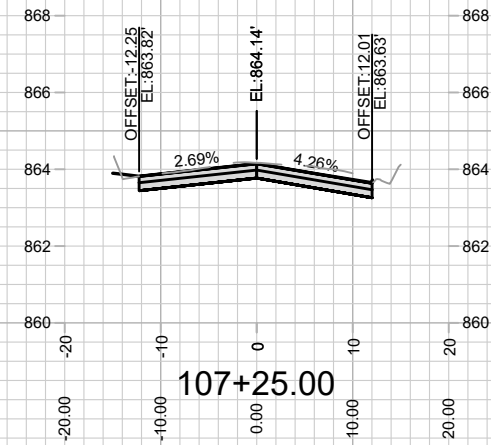
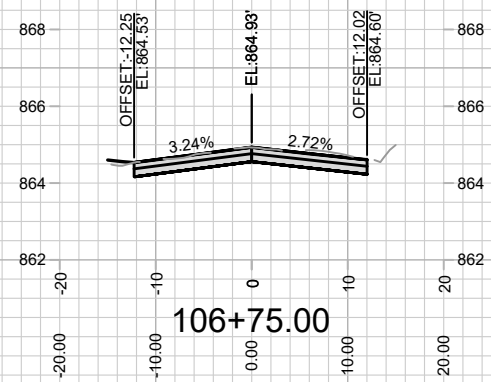
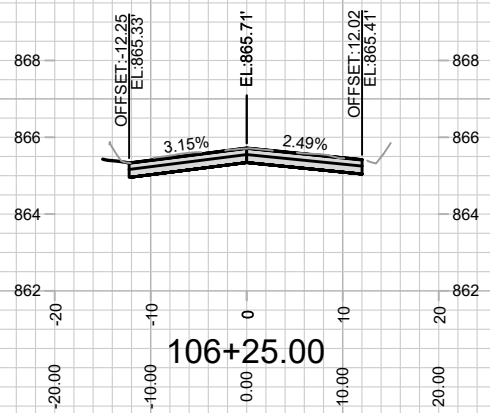
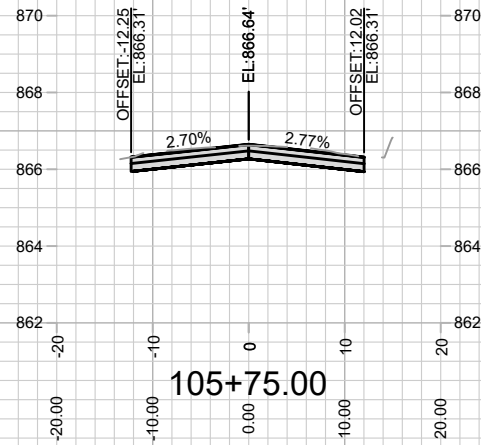
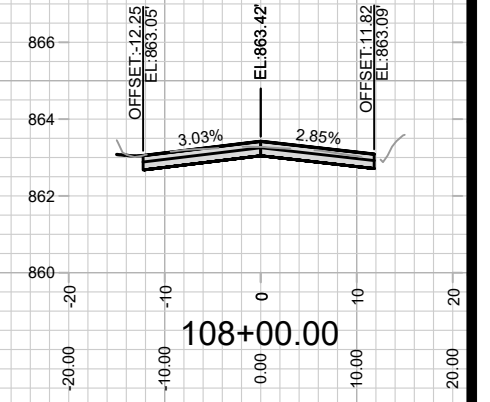
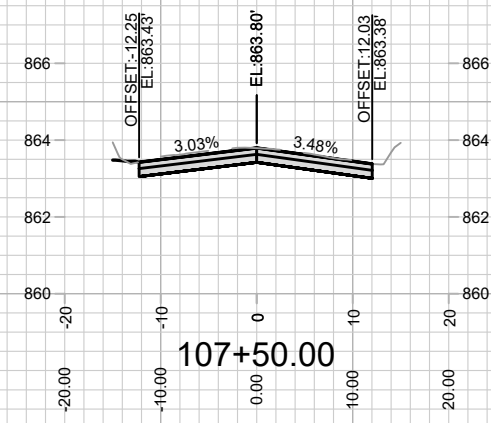
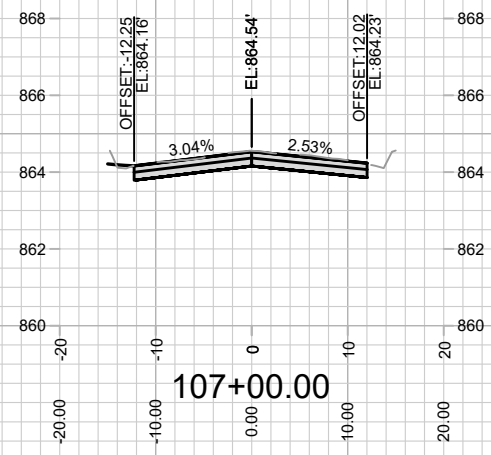
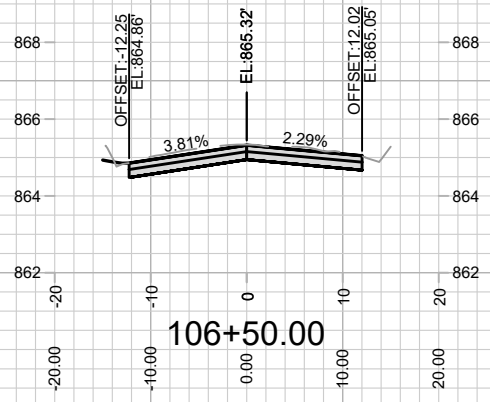
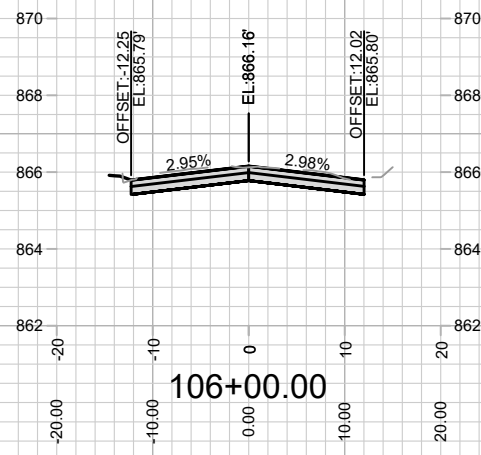

| MARK | REVISION | DATE | BY |
|------|----------|------|----|
| | | | |
| | | | |
| | | | |

15930
MADISON, WI
8832
CONTRACT NO:

CROSS SECTION - WAUBESA STREET
2026 RESURFACING - ASPHALT PAVEMENT
M:\DESIGN\Projects\15930\CAD\Streets\15930\EN-Corridor_Waubesa St.dwg



15930
X-9

