

5.4.7

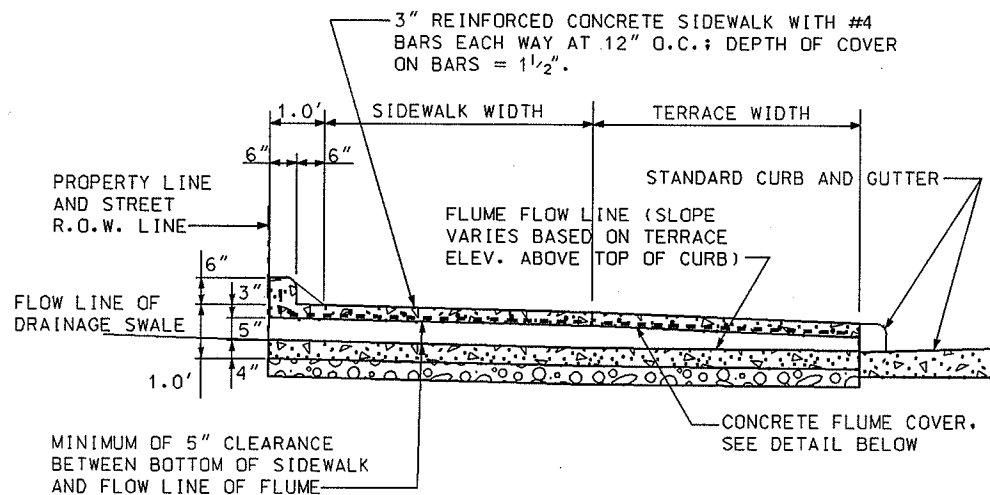

**DRAINAGE FLUME
LONGITUDINAL SECTION**

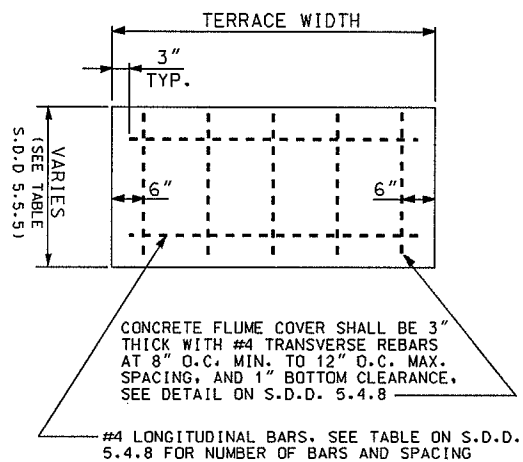

**TERRACE CONCRETE FLUME COVER
PLAN VIEW**

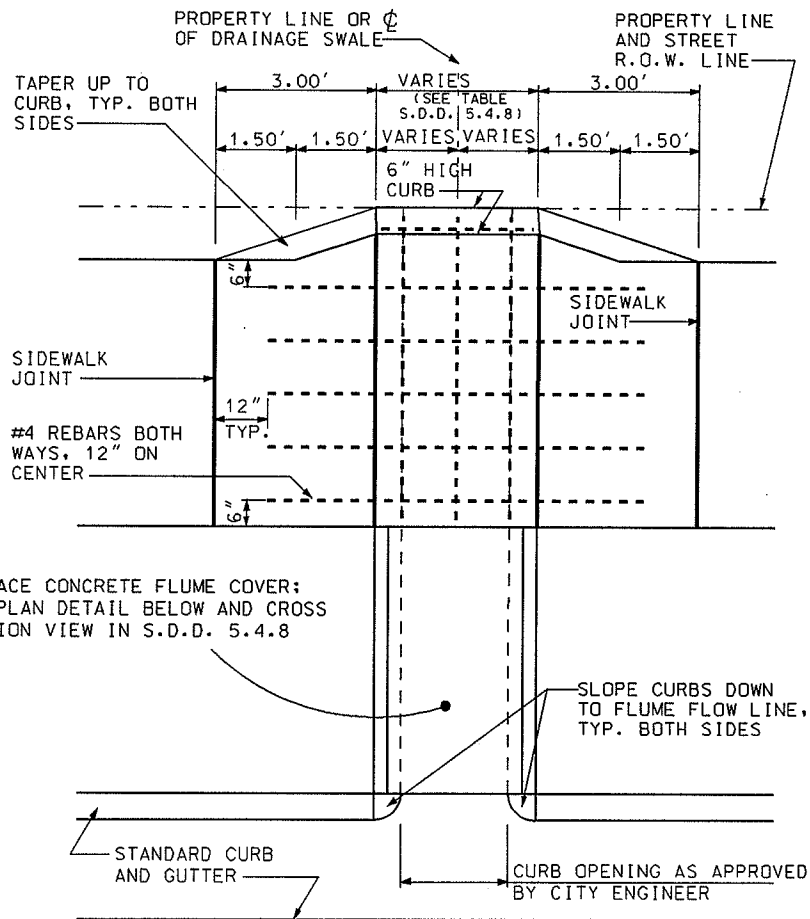

**DRAINAGE FLUME
PLAN VIEW**

NOTES:

1. A MINIMUM OF 2 SIDEWALK SECTIONS SHALL BE REMOVED AND REPLACED, UNLESS OTHERWISE DIRECTED BY THE CITY ENGINEER.
2. ALTERNATE ALIGNMENTS OF TERRACE PORTION OF FLUME SHALL BE ALLOWED WITH THE PRIOR APPROVAL OF THE CITY ENGINEER.
3. ALL REINFORCING BARS SHALL BE EPOXY COATED.
4. SIDEWALK AND SIDEWALK CURBING TO BE POURED MONOLITHIC.

2004

CITY OF MADISON
ENGINEERING DIVISION

**DRAINAGE FLUME
DETAIL**

PLATE 1 OF 2

STANDARD DETAIL DRAWING 5.4.7