



Madison, Wisconsin

INDEX OF SHEETS

SHEET NO.	TITLE
1	
D1	STANDARD NOTES
D2	TYPICAL SECTIONS
P1	PLAN & PROFILE
U1	UTILITIES PLAN
E1	ELECTRICAL PLAN
X1	CROSS SECTIONS

NO MAINTENANCE PLAN REQUIRED

# CITY OF MADISON

## CITY ENGINEERING DIVISION

### DEPARTMENT OF PUBLIC WORKS

# PLAN OF PROPOSED IMPROVEMENT

## 118 W WILSON STREET - DANE COUNTY JAIL CONSOLIDATION

CITY PROJECT NO. 14835  
 CONTRACT NO. 9345

PROJECT LOCATION

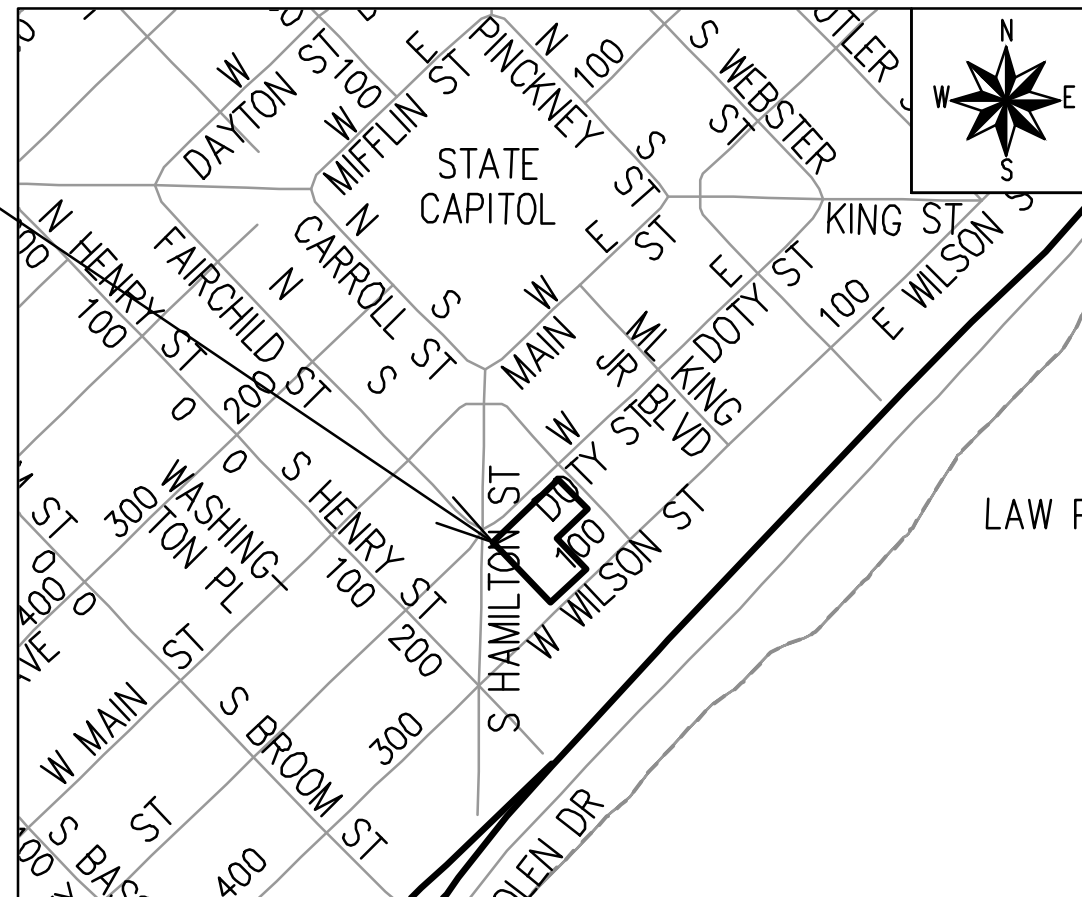

PUBLIC IMPROVEMENT PROJECT APPROVED

APPROVED DATE: AUGUST 1, 2023

BY THE COMMON COUNCIL OF MADISON, WISCONSIN

PUBLIC IMPROVEMENT DESIGN APPROVED BY:

Chris Potykowski Apr 23, 2024

City Engineer Date

STREET DESIGNED BY:



Apr 23, 2024

STORM & SANITARY SEWER DESIGNED BY:

LATERAL ONLY

ELECTRICAL DESIGNED BY:

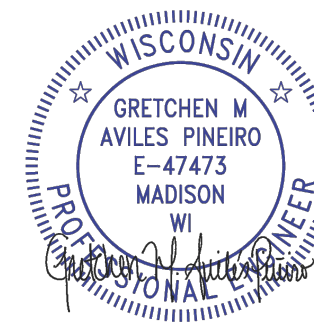

Apr 23, 2024

WATER DESIGNED BY:

LATERAL ONLY

PLOT SCALE: 1 IN = 100 FT

PLOT NAME: ---

REV. DATE: 4/22/2024 3:19 PM

ORIGINATOR: CITY OF MADISON

THE LOCATION AND INFORMATION FOR PROPOSED NEW TREES, IN THE PUBLIC RIGHT OF WAY OR ON PUBLIC LANDS ARE APPROXIMATE AND ARE SHOWN FOR REFERENCE ONLY. THE LOCATIONS, SPECIFICATIONS AND PLANTING METHODS OF ALL PROPOSED NEW OR REPLACEMENT TREES IN THE PUBLIC RIGHT OF WAY OR ON PUBLIC LANDS SHALL BE APPROVED BY THE CITY FORESTER PRIOR TO INSTALLATION.



NO TREES IN THE RIGHT OF WAY OR ON PUBLIC LANDS SHALL BE TRIMMED, PRUNED, REMOVED OR ADVERSELY AFFECTED IN ANY WAY UNTIL THE DEVELOPER HAS RECEIVED WRITTEN PERMISSION FROM THE CITY ENGINEER OR CITY FORESTER. SAID WRITTEN PERMISSION SHALL INCLUDE LANGUAGE INDICATING THAT SECTION 10.101 OF THE MADISON GENERAL ORDINANCES AND ADMINISTRATIVE PROCEDURE MEMORANDUM NO. 6-2, REFERRING TO NOTIFICATION OF PROPERTY OCCUPANTS AND/OR OWNERS, HAS BEEN COMPLIED WITH.

DEVELOPER MUST SUBMIT A TRAFFIC CONTROL PLAN TO CITY TRAFFIC ENGINEERING AT LEAST 14 DAYS PRIOR TO THE START OF WORK. WORK SHALL NOT PROCEED UNTIL AN APPROVED TRAFFIC CONTROL PLAN IS IN PLACE.

CONTACT THE PROJECT ENGINEER AND DESIGNER, NASHALY GUTIERREZ, AT NGUTIERREZ@CITYOFMADISON.COM FOR CAD FILES AND ALIGNMENT DATA PRIOR TO STAKING.

**CONVENTIONAL SIGNS**

**FIELD VERIFY ALL UTILITY LOCATIONS**

<b>GAS</b>	—— G ——
<b>STORM SEWER</b>	—— ST ——
<b>SANITARY SEWER</b>	—— SAN ——
<b>WATER</b>	—— W ——
<b>BURIED ELECTRIC</b>	—— E ——
<b>OVERHEAD ELECTRIC</b>	—— OH ——
<b>POWER POLE</b>	
<b>ADA COMPLIANT RAMP W/ DETECTABLE WARNING FIELD</b>	
<b>COMBUSTIBLE FLUIDS</b>	

UNDERDRAINS SHALL BE INSTALLED PER STANDARD DETAIL DRAWING 4.05 FOR 75' ON EACH SIDE OF THE LOW POINT, OR TO THE NEAREST CURB HIGH POINT. ALL UNDERDRAIN SHALL BE WRAPPED.

ALL GUTTERS SHALL DRAIN WITH A MINIMUM GRADE OF 0.5% TOWARD STORM SEWER INLETS.

ALL DITCHES SHALL DRAIN WITH A MINIMUM GRADE OF 0.5%

THE CROSS SLOPE OF SIDEWALKS AND BARRIER FREE SIDEWALK CURB RAMPS SHALL TYPICALLY BE 1.5%. THE LONGITUDINAL GRADE OF BARRIER FREE SIDEWALK CURB RAMPS SHALL NOT EXCEED 8.33%. ALL SIDEWALK RAMPS SHALL BE CONSTRUCTED ACCORDING TO S.D.D. 3.04. AT ALL OTHER LOCATIONS THE LONGITUDINAL GRADE OF SIDEWALKS SHALL NOT EXCEED 5.0 % OR THE ADJACENT STREET GRADE WHICHEVER IS GREATER NOR BE LESS THAN 0.5% AND SHALL DRAIN TOWARD STORM SEWER INLETS. SIDE SLOPES WITHIN TEN FEET OF A PUBLIC SIDEWALK SHALL NOT EXCEED 4:1. ALL SIDEWALK AND SIDEWALK RAMP ELEVATIONS AND GRADES SHALL BE FIELD VERIFIED AND SET TO COMPLY WITH THE CITY OF MADISON STANDARD SPECIFICATIONS AND THE A.D.A. GUIDELINES.

OBTAIN A PRINT OUT OF THE ALIGNMENTS FROM THE CITY PROJECT ENGINEER PRIOR TO STAKING THIS PROJECT. THE CITY PROJECT ENGINEER IS FADI EL MUSA, EMAIL: FELMUSAGONZALEZ@CITYOFMADISON.COM

CURB STATION AND OFFSETS SHALL BE TO THE EDGE OF PAVEMENT UNLESS OTHERWISE INDICATED. CURB ELEVATIONS SHALL BE TO THE EDGE OF PAVEMENT UNLESS OTHERWISE INDICATED.

POWER POLES AND OTHER OBSTRUCTIONS SHALL BE MOVED TO PROVIDE 2 FEET MINIMUM OF CLEAR DISTANCE FROM ANY FACE OF CURB OR EDGE OF SIDEWALK UNLESS OTHERWISE INDICATED ON THE PLANS.

ANY INFORMATION SHOWN ON THIS PLAN, WHICH IS NOT PART OF THIS RIGHT-OF-WAY PROJECT, IS PRELIMINARY AND NOT FOR CONSTRUCTION.

THERE MAY BE EXISTING UTILITIES OR OTHER FEATURES WHICH ARE EITHER NOT SHOWN OR SHOWN INCORRECTLY ON THIS PLAN. IT IS THE RESPONSIBILITY OF THE DEVELOPER TO LOCATE AND IDENTIFY ALL UTILITIES AND TOPOGRAPHY WHICH MAY AFFECT THE CONSTRUCTION OF THESE IMPROVEMENTS.

ALL PERMANENT SIGNING AND POSTING WILL BE DETERMINED AND PROVIDED BY THE TRAFFIC ENGINEERING DIVISION, FOLLOWING CONSTRUCTION OF THESE IMPROVEMENTS.

THE DEVELOPER SHALL PROVIDE, INSTALL AND MAINTAIN ALL STREET END BARRICADES, SIGNING AND TRAFFIC CONTROL, AS REQUIRED BY THE CITY TRAFFIC ENGINEER.

PAVEMENT SAWCUTS SHALL BE AS DIRECTED BY THE CITY CONSTRUCTION ENGINEER. SAWCUTS SHOWN ON THE PLAN ARE APPROXIMATE.

CURB ON CUL DE SACS SHALL BE INSTALLED ACCORDING TO S.D.D 3.05.

ALL WORK IN THE RIGHT OF WAY AND PUBLIC EASEMENTS SHALL BE IN ACCORDANCE WITH THE CITY OF MADISON STANDARD SPECIFICATIONS FOR PUBLIC WORKS CONSTRUCTION LATEST EDITION.

ALL PROPOSED IMPROVEMENTS IN THE RIGHT-OF-WAY ARE BASED ON SURVEY DATA PROVIDED BY THE DEVELOPER OR ITS CONSULTANT. IN THE CASE THAT THE PROPOSED IMPROVEMENTS CAN NOT BE INSTALLED PER THESE PLANS OR THE CITY OF MADISON STANDARD SPECIFICATION FOR PUBLIC WORKS CONSTRUCTION, LATEST EDITION, THE DEVELOPER SHALL BE RESPONSIBLE FOR THE COST OF EXTRA WORK DUE TO INACCURACIES OF THE SURVEY.

ALL UTILITY VERIFICATIONS AND ACCURACY OF THE DRAWINGS ARE THE RESPONSIBILITY OF THE DEVELOPER. ANY CONFLICTS THAT ARISE FROM MISSING OR ERRONEOUS INFORMATION WILL BE AT THE EXPENSE OF THE DEVELOPER. NO PRECAST STRUCTURES WILL BE APPROVED FOR STORM OR SANITARY SEWER UNTIL ALL POTENTIAL UTILITY CONFLICTS ARE RESOLVED.

IN LOCATIONS WHERE PAVEMENT RESTORATION IS NOT IDENTIFIED ADJACENT TO CURB AND GUTTER REPLACEMENT, IT IS ASSUMED THAT CURB AND GUTTER WILL BE REPLACED WITHOUT DAMAGING ADJACENT PAVEMENT. IF DAMAGED, THE MILL AND OVERLAY LIMITS SHALL BE EXTENDED BY THE CITY CONSTRUCTION ENGINEER AS NECESSARY TO MEET THE STANDARD PATCHING CRITERIA.

STANDARD NOTES	14835	MADISON, WI	9345	D-1
118 W WILSON STREET - DANE COUNTY JAIL CONSOLIDATION				
M:\DESIGN\Projects\14835\CAD\Streets\14835EN-Details.dwg				
14835				
D-1				

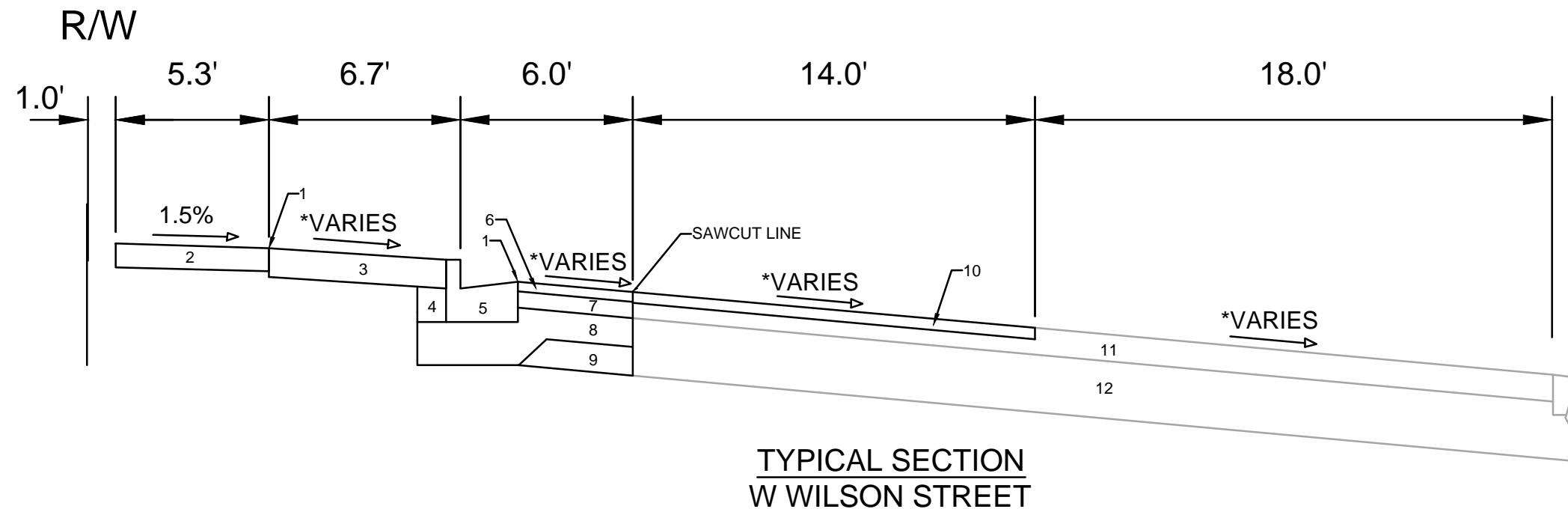

TYPICAL SECTION  
W WILSON STREET

SPECIAL NOTES:

\*SEE X-SHEETS FOR CROSS SLOPES

- 1 POINT REFERRED TO ON PROFILE FOR F.W. AND E.P.
- 2 5" CONCRETE SIDEWALK, 7" AT DRIVEWAYS
- 3 7" CONCRETE TERRACE OR 6" TOPSOIL, SEED & MAT. SEE SHEET P-1
- 4 FILL
- 5 TYPE "A" OR "X" CONCRETE CURB & GUTTER
- 6 2.00" H.M.A. PAVEMENT - TYPE 4 MT 58-28 S
- 7 3.50" H.M.A. PAVEMENT - TYPE 3 MT 58-28 S
- 8 6.00" CRUSHED AGGREGATE BASE COURSE GRADATION 2
- 9 6.00" CRUSHED AGGREGATE BASE COURSE GRADATION 1
- 10 2.25" MILL & OVERLAY, H.M.A. 4 MT 58-28 S
- 11 EX. PAVEMENT TO REMAIN
- 12 EX. ROAD BASE TO REMAIN

MARK	REVISION	DATE	BY
14835			

14835  
MADISON, WI  
118 W WILSON STREET - DANE COUNTY JAIL CONSOLIDATION  
CONTRACT NO: 9345  
M:\DESIGN\Projects\14835\CAD\Streets\14835EN-Details.dwg



14835  
D-2

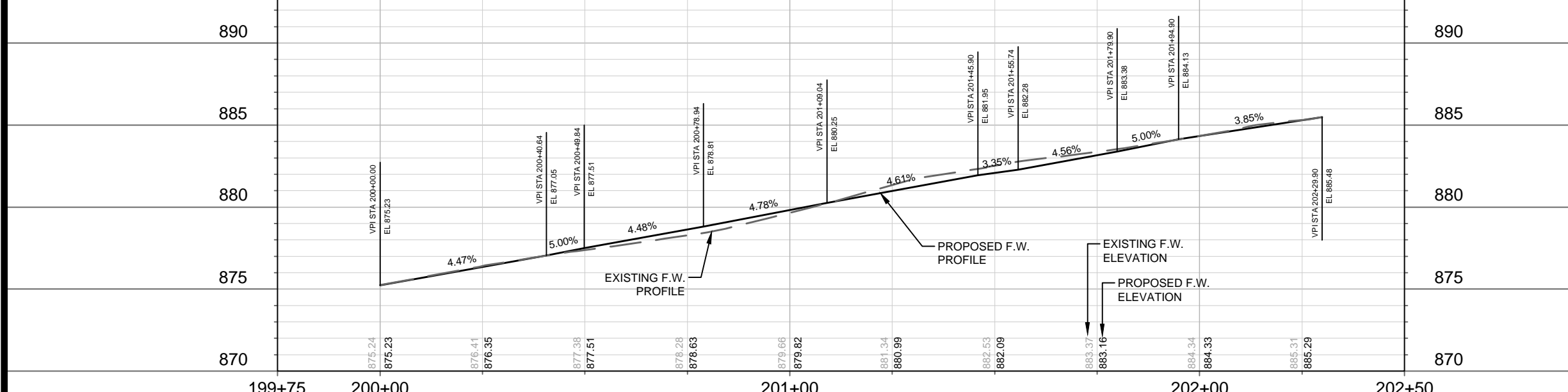
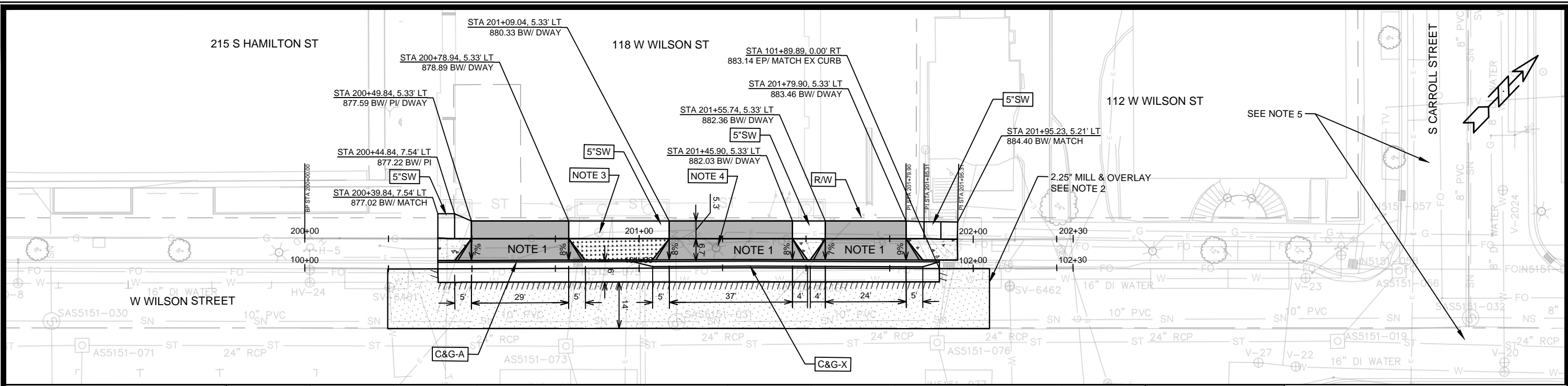

LEGEND

- SAWCUT ASPHALT PAVEMENT
- 7.00" CONCRETE SIDEWALK AND DRIVE
- 5.00" CONCRETE TERRACE
- MILL & OVERLAY PATCHING LIMITS. SEE NOTE 3
- 6.00" TOPSOIL, SEED, AND MAT
- 5"SW 5.00" CONCRETE SIDEWALK
- CONCRETE CURB & GUTTER TYPE 'A'
- CONCRETE CURB & GUTTER TYPE 'X'

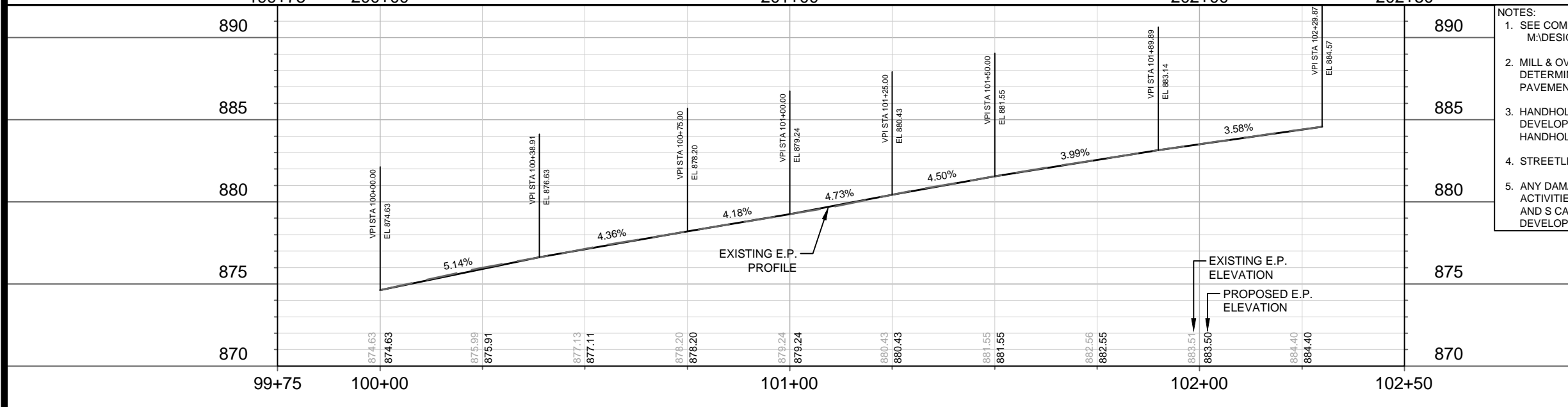

- NOTES:
1. SEE COMMERCIAL DRIVEWAY PERMIT LNDUSE-2022-00110  
M:\DESIGN\Traffic\Maps\_Plans\ParkingLotPlans\TEW\Wilson St W 114 to 120
  2. MILL & OVERLAY LIMITS SHOWN ARE ESTIMATED. ACTUAL LIMITS SHALL BE DETERMINED ON-SITE BY THE CONSTRUCTION ENGINEER. OVERLAY PAVEMENT MIX SHALL BE 4 MT 58-28 S.
  3. HANDHOLE REQUIRES ADJUSTMENT DUE TO NEW SIDEWALK GRADES. DEVELOPER SHALL COORDINATE THE RELOCATION OR ADJUSTMENT WITH HANDHOLE OWNER.
  4. STREETLIGHT TO BE RELOCATED. SEE SHEET E-1
  5. ANY DAMAGES TO CITY INFRASTRUCTURE CAUSED BY SITE CONSTRUCTION ACTIVITIES ALONG S CARROLL ST., W WILSON ST., AND AT THE W WILSON ST. AND S CARROLL ST. INTERSECTION SHALL BE RESTORED BY THE SITE DEVELOPER AS DETERMINED BY THE CITY CONSTRUCTION ENGINEER.

14835	MADISON, WI	9345	CONTRACT NO.:	P-1
<b>PLAN &amp; PROFILE - W WILSON STREET</b> <b>118 W WILSON STREET - DANE COUNTY JAIL CONSOLIDATION</b>				
M:\DESIGN\Projects\14835\CAD\Streets\14835EN-PnP.dwg				
14835 P-1				





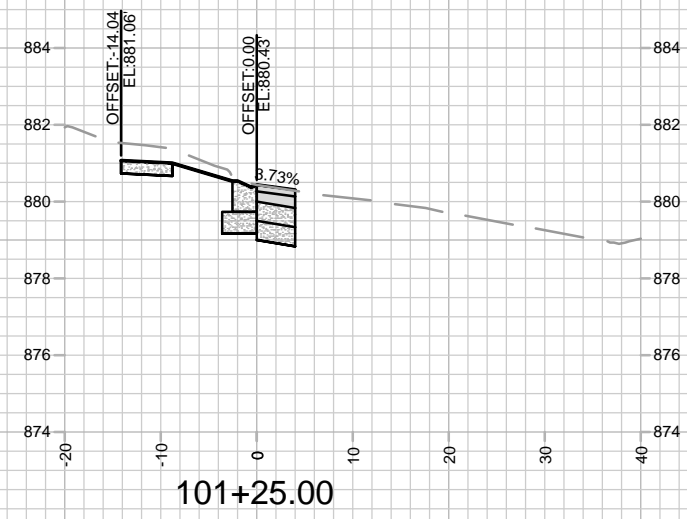
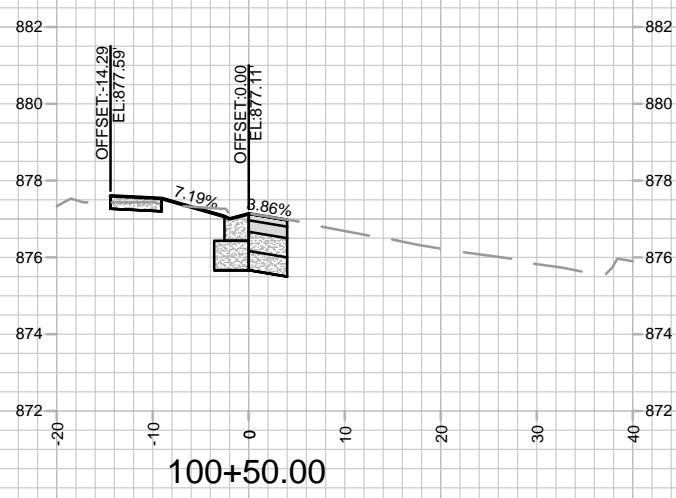
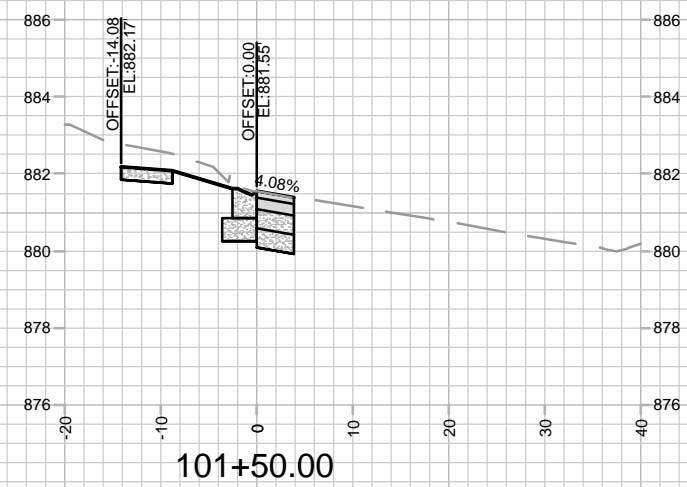
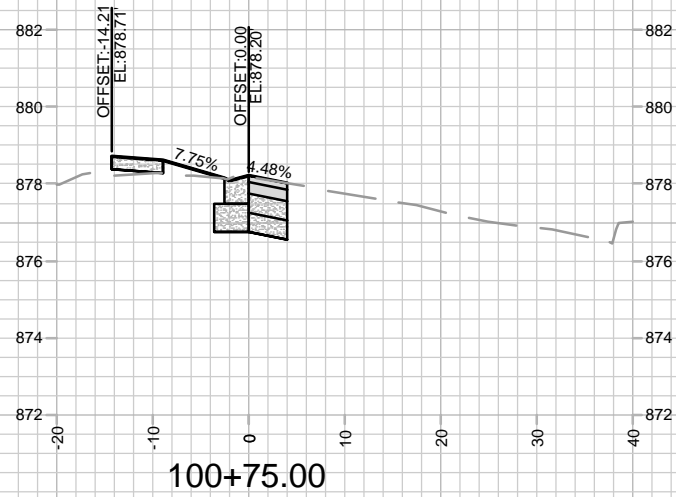
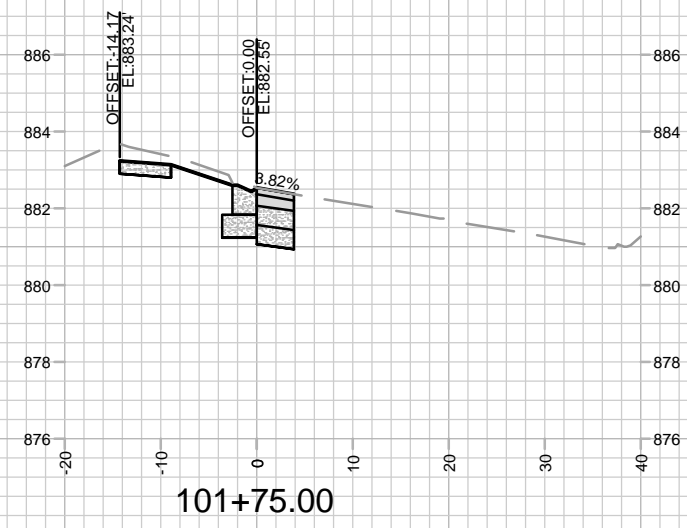
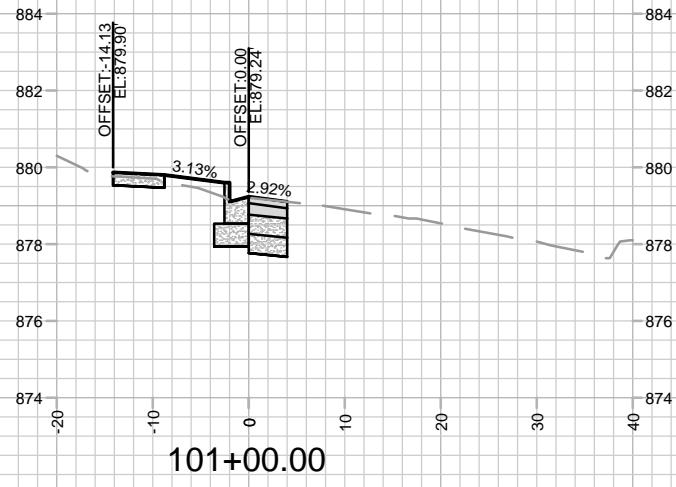

MARK	REVISION	DATE	BY

Designer: NGV  
 Date: 4/22/2024 3:11 PM  
 Scale: 1" = 20'  
 14835  
 X-1

14835  
 CROSS SECTION - W WILSON STREET  
 118 W WILSON STREET - DANE COUNTY JAIL CONSOLIDATION  
 MADISON, WI  
 CONTRACT NO: 9345  
 M:\DESIGN\Projects\14835\CAD\Streets\14835EN-Xsections.dwg