

Madison, Wisconsin

# CITY OF MADISON

## CITY ENGINEERING DIVISION

### DEPARTMENT OF PUBLIC WORKS

# PLAN OF PROPOSED IMPROVEMENT

#### INDEX OF SHEETS

SHEET NO.	D1	STANDARD NOTES
SHEET NO.	D2	TYPICAL SECTION
SHEET NO.	P1	PLAN & PROFILE
SHEET NO.	U1	SEWER PLAN & PROFILE
SHEET NO.	X1	CROSS SECTIONS
NO MAINTENANCE PLAN REQUIRED		

320 S BREARLY ST CSM

CITY PROJECT NO. 15593  
CONTRACT NO. 9629

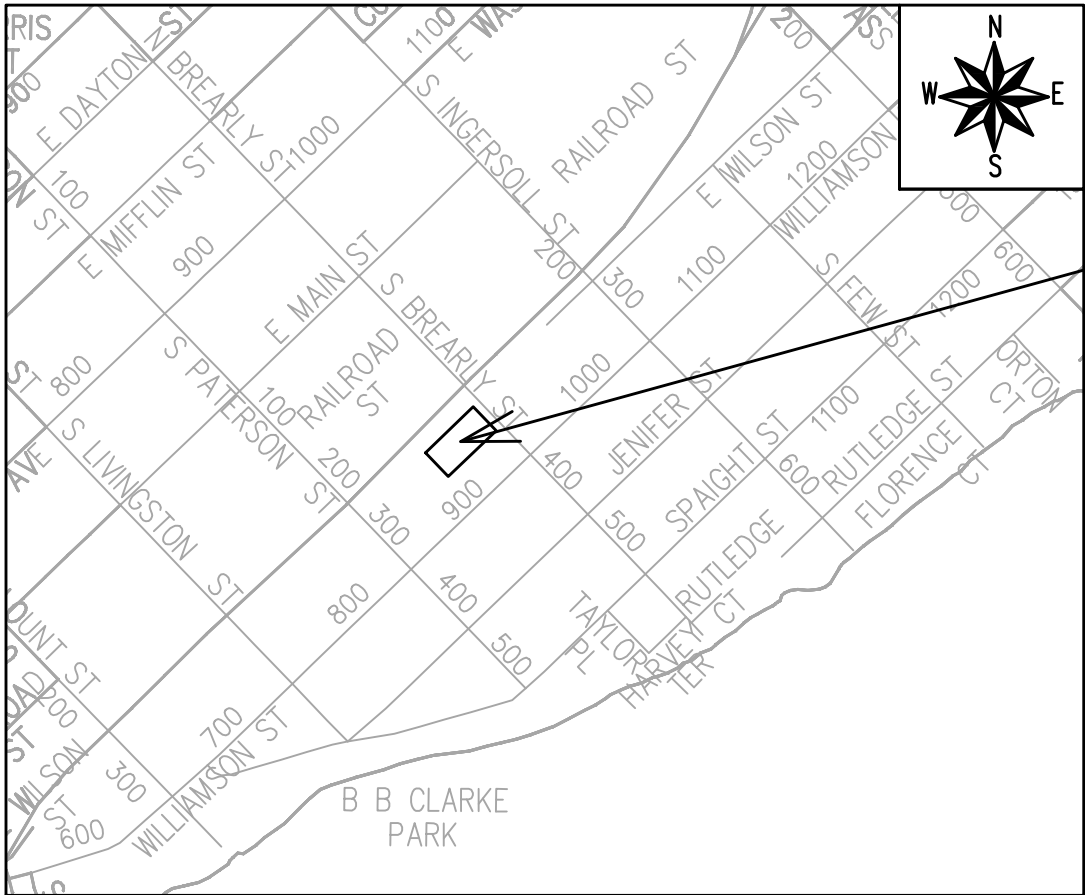

PROJECT  
LOCATION

- REVISION 1 - 11/20/2025  
SHEETS REPLACED: COVER, U1
- REVISION 2 - 11/24/2025  
SHEETS REPLACED: COVER, U1
- REVISION 3 - 01/28/2026  
SHEETS REPLACED: U1

PUBLIC IMPROVEMENT PROJECT  
APPROVED

FEBRUARY 25, 2025

BY THE COMMON COUNCIL  
OF MADISON, WISCONSIN

PUBLIC IMPROVEMENT DESIGN  
APPROVED BY:

11/06/2025

City Engineer

Date

STREET  
DESIGNED BY:



11/06/2025

SANITARY SEWER  
DESIGNED BY:

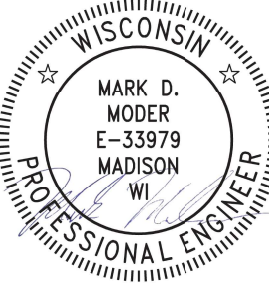

11/10/2025

WATER  
DESIGNED BY:

LATERAL ONLY

STORM SEWER  
DESIGNED BY:

LATERAL ONLY

PLOT SCALE: 1 IN. = 1 FT. XREF: PLOT NAME: REV. DATE: 11/5/2025 12:24 PM ORIGINATOR: CITY\_OF\_MADISON

D-1

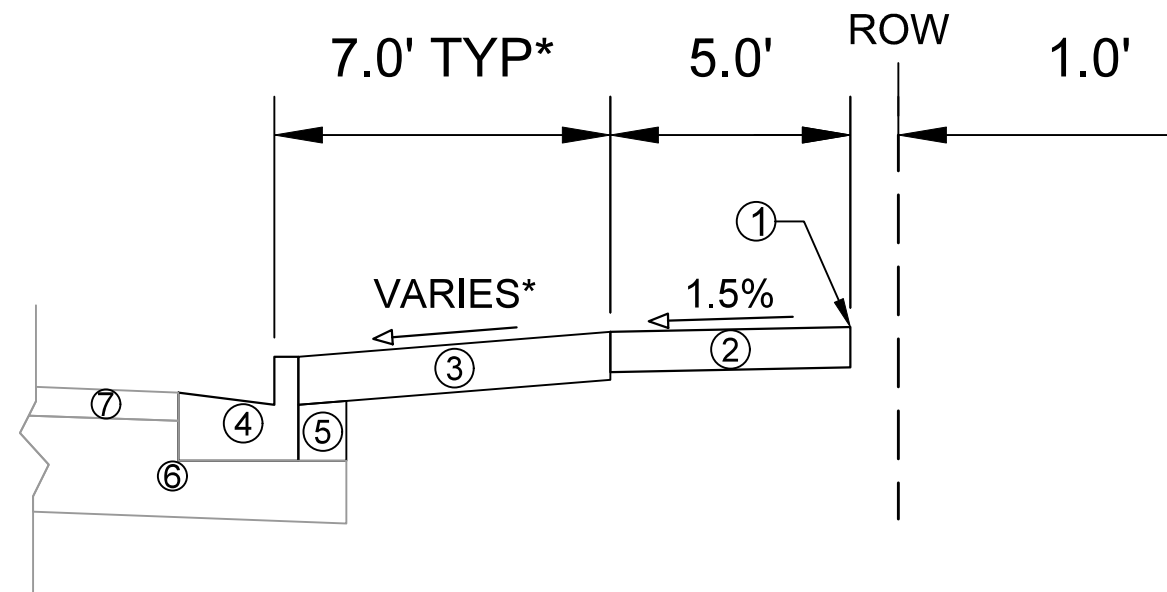

# TYPICAL SECTION S BREARLY ST

- ① POINT REFERRED TO ON PROFILE
- ② 5" CONCRETE SIDEWALK
- ③ 6" TOPSOIL, SEED AND MATT
- ④ EXISTING CURB AND GUTTER TYPE A, REPLACE AT LOCATIONS SHOW IN P-SHEET OR AS DETERMINED BY THE ENGINEER
- ⑤ EXISTING FILL TO REMAIN, INSTALL AT CURB REPLACEMENT LOCATIONS
- ⑥ EXISTING BASE ROAD TO REMAIN
- ⑦ EXISTING ASPHALTIC PAVEMENT TO REMAIN

## SPECIAL NOTES:

\* SEE X-SHEETS AND P-SHEETS FOR CROSS SECTIONS AND SLOPES

MARK	REVISION	DATE	BY
15593	10/31/2025	7:50 AM	Scale:
15593	10/31/2025	7:50 AM	Scale:

15593	MADISON, WI	9629
15593	MADISON, WI	9629
15593	MADISON, WI	9629



15593

D-2

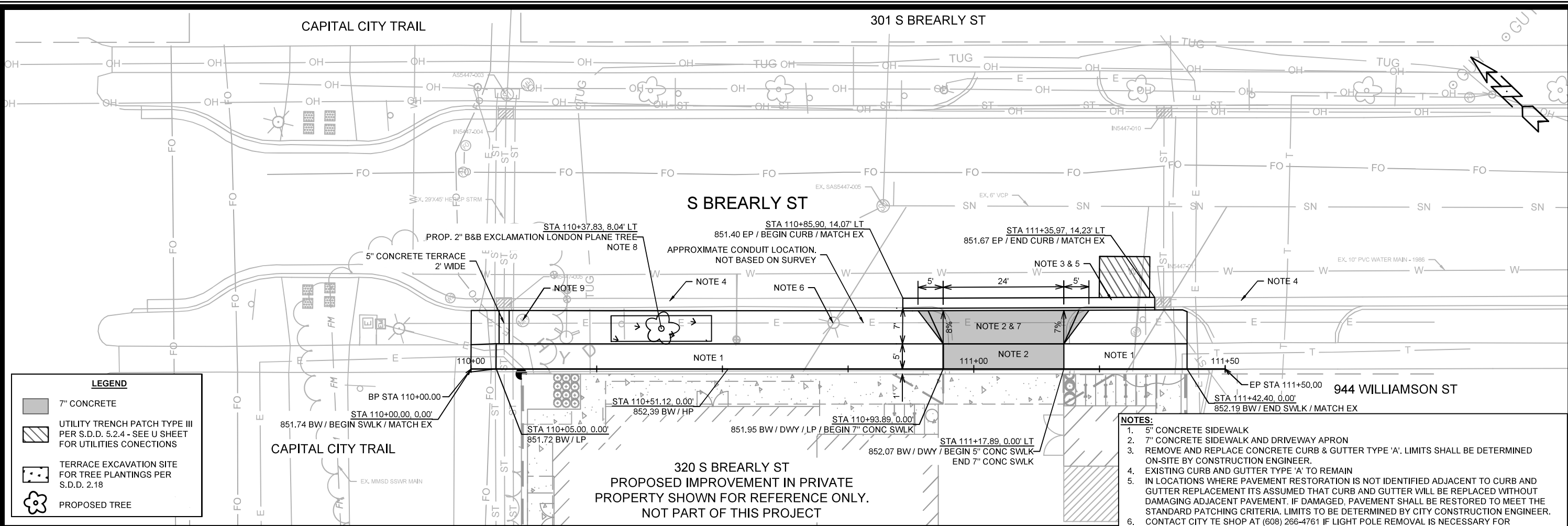

**LEGEND**

- 7" CONCRETE
- UTILITY TRENCH PATCH TYPE III PER S.D.D. 5.2.4 - SEE U SHEET FOR UTILITIES CONNECTIONS
- TERRACE EXCAVATION SITE FOR TREE PLANTINGS PER S.D.D. 2.18
- PROPOSED TREE

- NOTES:**
- 5' CONCRETE SIDEWALK
  - 7" CONCRETE SIDEWALK AND DRIVEWAY APRON
  - REMOVE AND REPLACE CONCRETE CURB & GUTTER TYPE 'A'. LIMITS SHALL BE DETERMINED ON-SITE BY CONSTRUCTION ENGINEER.
  - EXISTING CURB AND GUTTER TYPE 'A' TO REMAIN
  - IN LOCATIONS WHERE PAVEMENT RESTORATION IS NOT IDENTIFIED ADJACENT TO CURB AND GUTTER REPLACEMENT ITS ASSUMED THAT CURB AND GUTTER WILL BE REPLACED WITHOUT DAMAGING ADJACENT PAVEMENT. IF DAMAGED, PAVEMENT SHALL BE RESTORED TO MEET THE STANDARD PATCHING CRITERIA. LIMITS TO BE DETERMINED BY CITY CONSTRUCTION ENGINEER.
  - CONTACT CITY TE SHOP AT (608) 266-4761 IF LIGHT POLE REMOVAL IS NECESSARY FOR CONSTRUCTION. BASE, CONDUIT, AND WIRES SHALL BE MAINTAINED. ANY DAMAGE TO THE POLES, FIXTURES, BASES, CONDUITS OR WIRES DURING CONSTRUCTION SHALL BE MAINTAINED DURING CONSTRUCTION.
  - SEE COMMERCIAL DRIVEWAY PERMIT LNDUSE-2024-00088
  - CONTRACTOR SHALL CONTACT CITY FORESTRY (608) 266-4816 AT LEAST ONE WEEK PRIOR TO PLANTING TO SCHEDULE INSPECTING THE NURSERY STOCK AND REVIEW PLANTING SPECIFICATIONS WITH THE LANDSCAPER
  - DEVELOPER SHALL COORDINATE RELOCATION OR ADJUSTMENT OF ANY PRIVATE UTILITY INFRASTRUCTURE WITH UTILITY OWNER

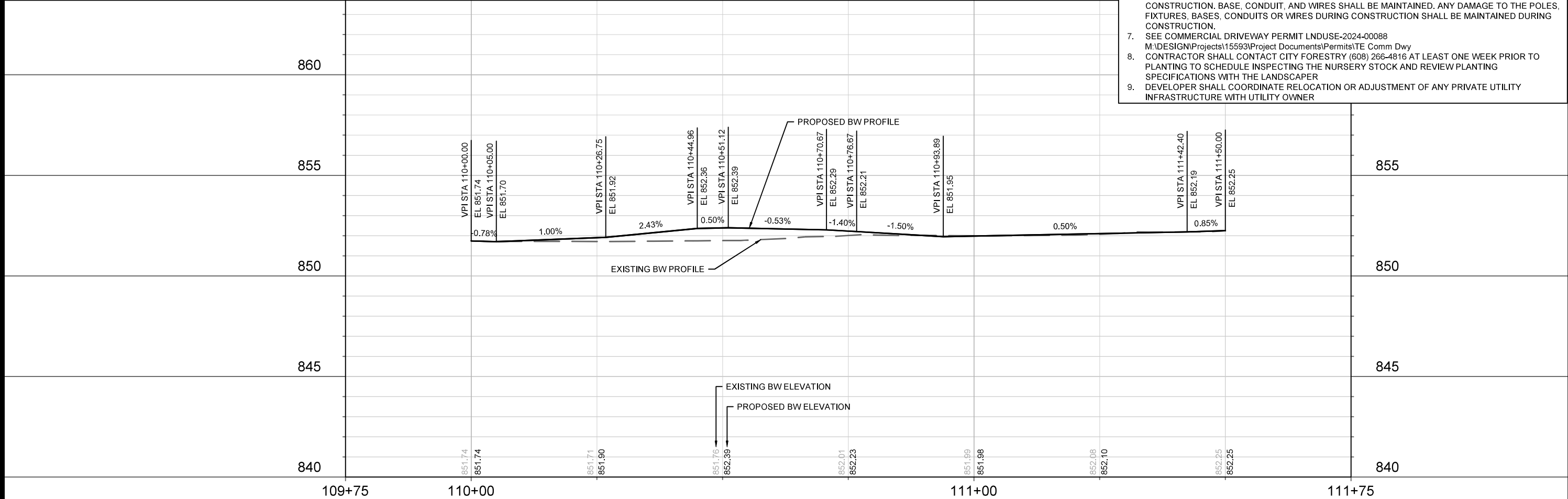

15593	MADISON, WI	9629	CONTRACT NO:
PLAN & PROFILE - S BREARLY ST			
320 S BREARLY ST CSM			
M:\DESIGN\Projects\15593\CAD\Streets\15593EN-PnP.dwg			
CITY OF MADISON WISCONSIN			
15593			
P-1			





