



Madison, Wisconsin

CITY OF MADISON

CITY ENGINEERING DIVISION

DEPARTMENT OF PUBLIC WORKS

PLAN OF PROPOSED IMPROVEMENT

INDEX OF SHEETS

SHEET NO.	STANDARD NOTES
D1	STANDARD NOTES
D2	TYPICAL SECTIONS
P1	PLAN & PROFILES
U1	UTILITY PLAN
L1	LANDSCAPING PLAN
X1	CROSS SECTIONS
CITY MAINTENANCE PLAN NOT REQUIRED	

121 N BUTLER STREET

CITY PROJECT NO. 16095
CONTRACT NO. 9736

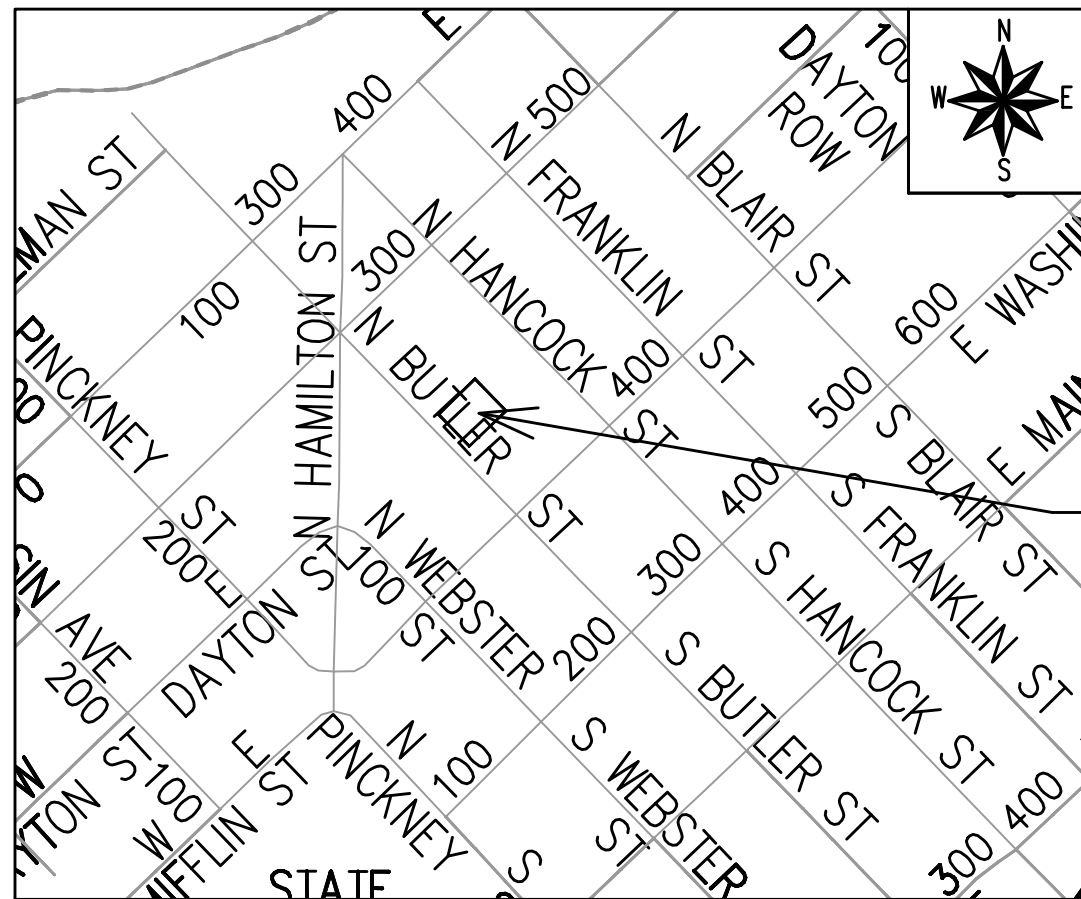

PROJECT LOCATION

PUBLIC IMPROVEMENT PROJECT APPROVED

APPROVED DATE:
FEBRUARY 10, 2026

BY THE COMMON COUNCIL
OF MADISON, WISCONSIN

PUBLIC IMPROVEMENT DESIGN APPROVED BY:

06/10/2026

City Engineer

Date

STREET DESIGNED BY:

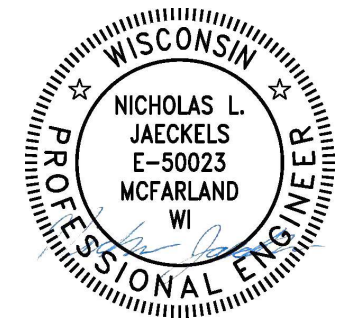

06/10/2026

STORM & SANITARY SEWER DESIGNED BY:

LATERALS ONLY

WATER DESIGNED BY:

LATERALS ONLY

PLOT SCALE: 1 IN.=1 FT., XREF

PLOT NAME: ---

REV. DATE: 2/19/2026 4:12 PM

ORIGINATOR: CITY_OF_MADISON

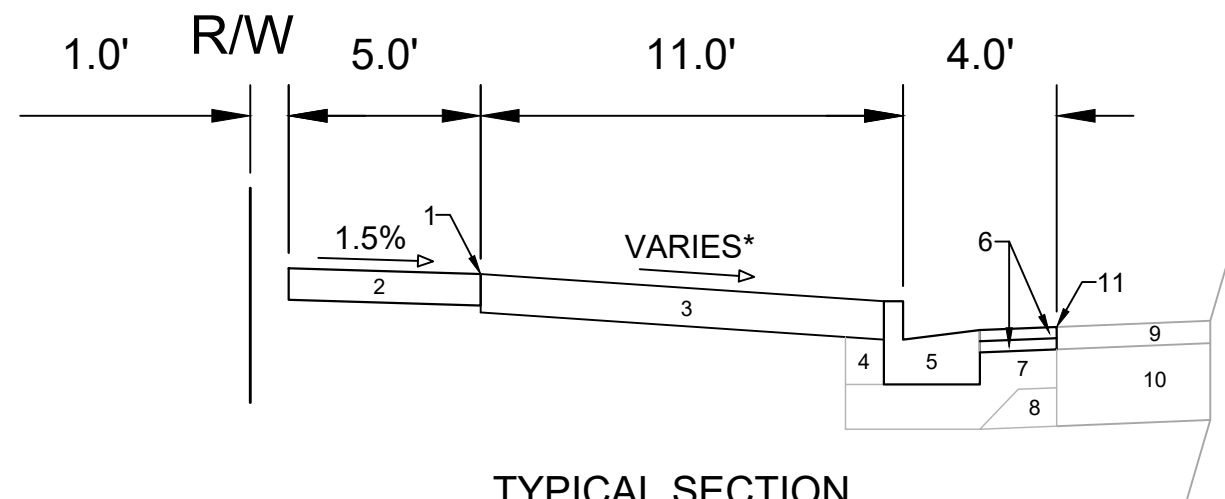

**TYPICAL SECTION
N BUTLER STREET**

- 1 POINT REFERRED TO ON PROFILE
- 2 5" CONCRETE SIDEWALK, 7" CONCRETE ADJACENT TO DRIVEWAYS
- 3 6" TOPSOIL, SEED AND MATTING
- 4 FILL
- 5 TYPE 'A' CONCRETE CURB & GUTTER
- 6 1.75" ASPHALTIC PAVEMENT 4 LT 58-28 S
- 7 6" CRUSHED AGGREGATE BASE COURSE GRADATION 2
- 8 6" CRUSHED AGGREGATE BASE COURSE GRADATION 1
- 9 EX. PAVEMENT SURFACE TO REMAIN
- 10 EX. ROAD BASE COURSE TO REMAIN
- 11 SAWCUT PAVEMENT LOCATION

SPECIAL NOTES:

* SEE X-SHEETS AND P-SHEETS FOR CROSS SECTIONS AND SLOPES

MARK	REVISION	DATE	BY
16095	Designed By: N.J.	Date: 3/13/2028 11:27 AM	Scale:

16095
MADISON, WI
CONTRACT NO: 9736

TYPICAL SECTIONS
121 N BUTLER STREET
M:\DESIGN\Projects\16095\CAD\Streets\16095EN-Details.dwg



16095
D-2

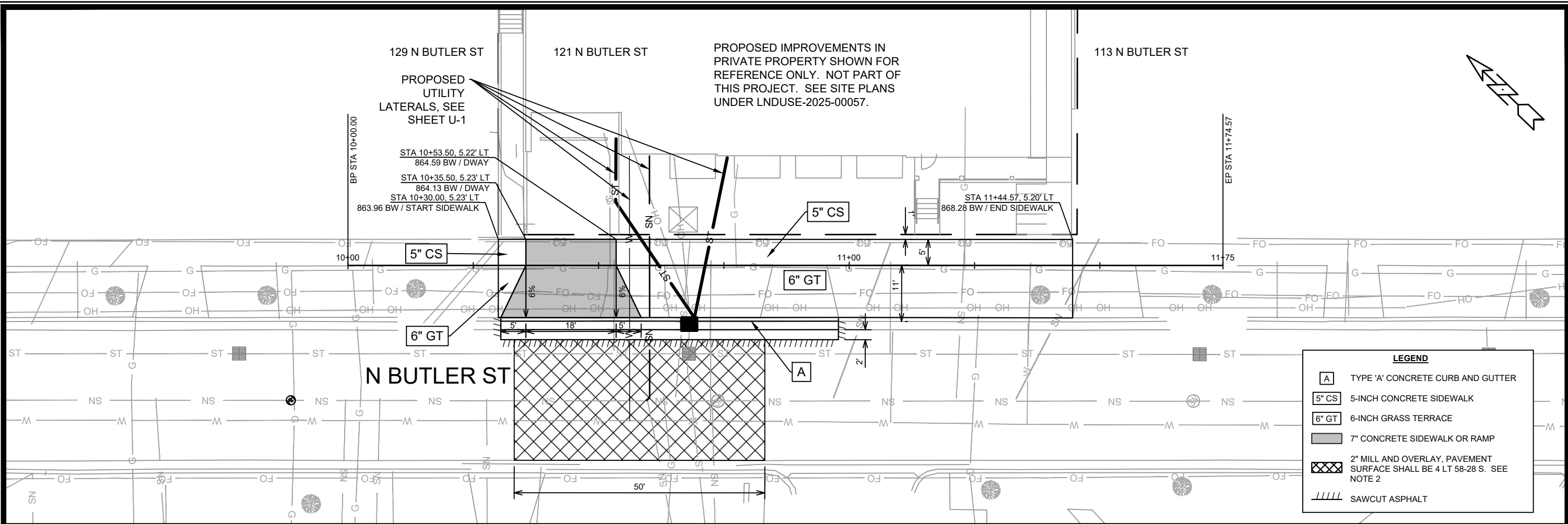

NOTES

- SEE COMMERCIAL DRIVEWAY PERMIT LNDUSE-2025-00057
 \\Gisserver\data\DESIGN\Projects\16095\Project Documents\Permits\Commercial Driveway Permit
- MILL & OVERLAY LIMITS ARE APPROXIMATE. FINAL LIMITS TO BE DETERMINED IN THE FIELD BY THE CITY CONSTRUCTION ENGINEER.

LEGEND

[A]	TYPE 'A' CONCRETE CURB AND GUTTER
[5" CS]	5-INCH CONCRETE SIDEWALK
[6" GT]	6-INCH GRASS TERRACE
[Solid Grey]	7" CONCRETE SIDEWALK OR RAMP
[Hatched]	2" MILL AND OVERLAY, PAVEMENT SURFACE SHALL BE 4 LT 58-28 S. SEE NOTE 2
[Diagonal Lines]	SAWCUT ASPHALT

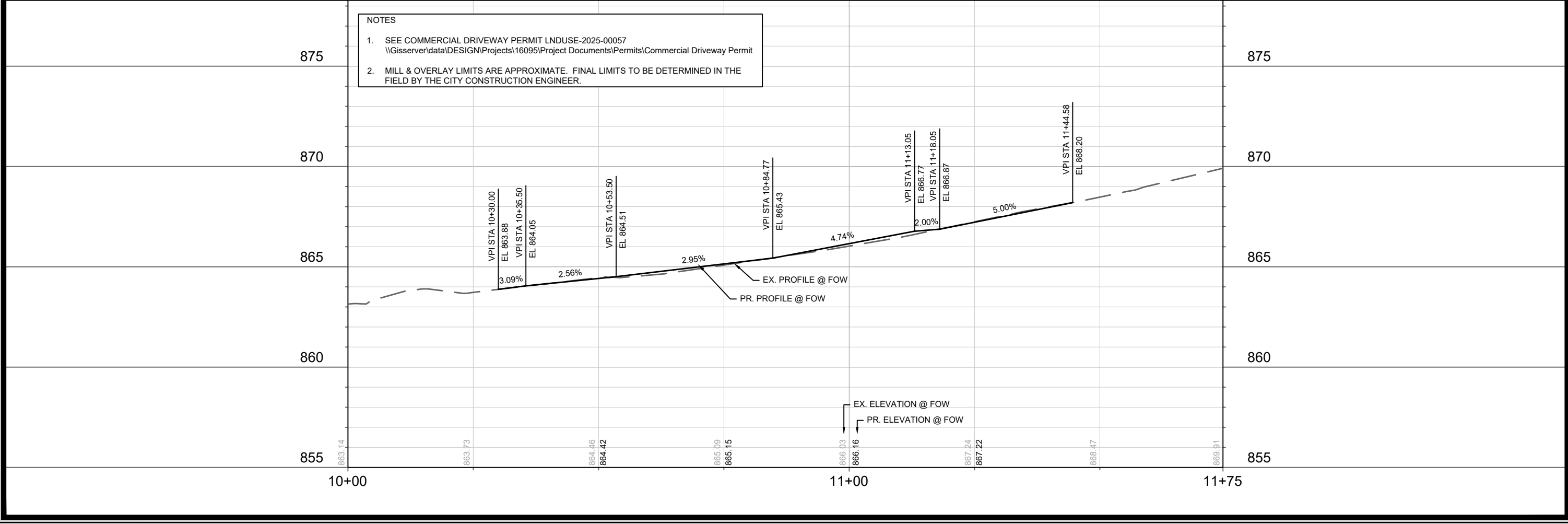

MARK	REVISION	DATE	BY
16095	16095	6/10/2026 9:29 AM	P-1

16095
 MADISON, WI
 CONTRACT NO: 9736

PLAN & PROFILE - N BUTLER STREET
 121 N BUTLER STREET
 M:\DESIGN\Projects\16095\CAD\Streets\16095EN-PrP.dwg

16095
P-1

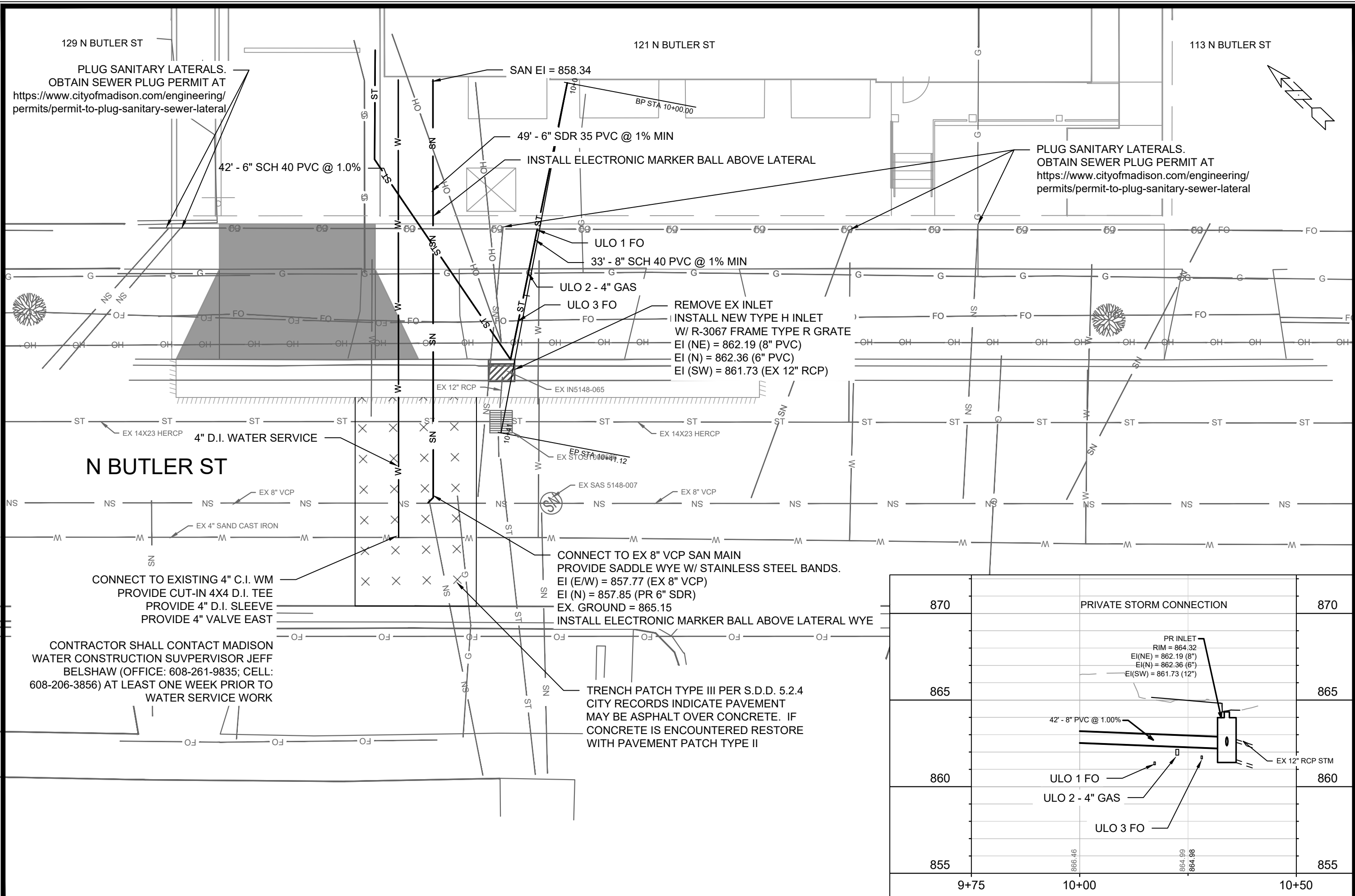

129 N BUTLER ST

PLUG SANITARY LATERALS.
OBTAIN SEWER PLUG PERMIT AT
<https://www.cityofmadison.com/engineering/permits/permit-to-plug-sanitary-sewer-lateral>

121 N BUTLER ST

113 N BUTLER ST

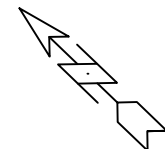

PLUG SANITARY LATERALS.
OBTAIN SEWER PLUG PERMIT AT
<https://www.cityofmadison.com/engineering/permits/permit-to-plug-sanitary-sewer-lateral>

N BUTLER ST

4" D.I. WATER SERVICE

CONNECT TO EXISTING 4" C.I. WM
PROVIDE CUT-IN 4X4 D.I. TEE
PROVIDE 4" D.I. SLEEVE
PROVIDE 4" VALVE EAST

CONTRACTOR SHALL CONTACT MADISON
WATER CONSTRUCTION SUPERVISOR JEFF
BELSHAW (OFFICE: 608-261-9835; CELL:
608-206-3856) AT LEAST ONE WEEK PRIOR TO
WATER SERVICE WORK

CONNECT TO EX 8" VCP SAN MAIN
PROVIDE SADDLE WYE W/ STAINLESS STEEL BANDS.
EI (E/W) = 857.77 (EX 8" VCP)
EI (N) = 857.85 (PR 6" SDR)
EX. GROUND = 865.15
INSTALL ELECTRONIC MARKER BALL ABOVE LATERAL WYE

TRENCH PATCH TYPE III PER S.D.D. 5.2.4
CITY RECORDS INDICATE PAVEMENT
MAY BE ASPHALT OVER CONCRETE. IF
CONCRETE IS ENCOUNTERED RESTORE
WITH PAVEMENT PATCH TYPE II

870	PRIVATE STORM CONNECTION	870
865		865
860		860
855		855
9+75		10+50

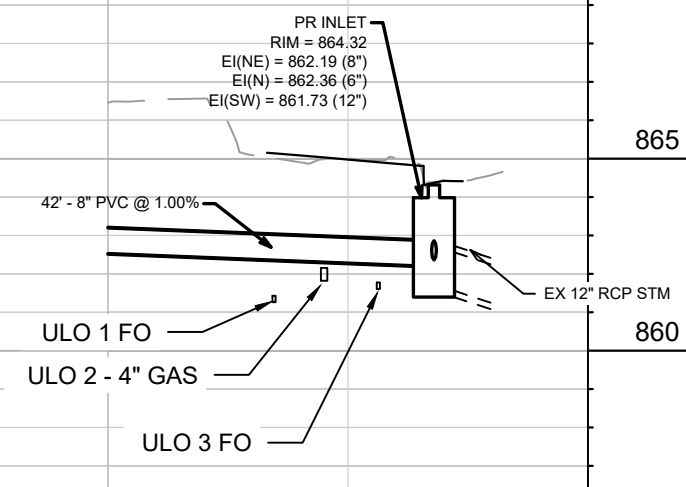

MARK	REVISION	DATE	BY
16095	U-1	4/16/2026 12:21 PM	Scale: 1" = 10'

16095
MADISON, WI
9736
CONTRACT NO.:

UTILITY PLAN - N BUTLER STREET
121 N BUTLER STREET
M:\DESIGN\Projects\16095\CAD\Severs\16095SWR-PnP.dwg



16095
U-1

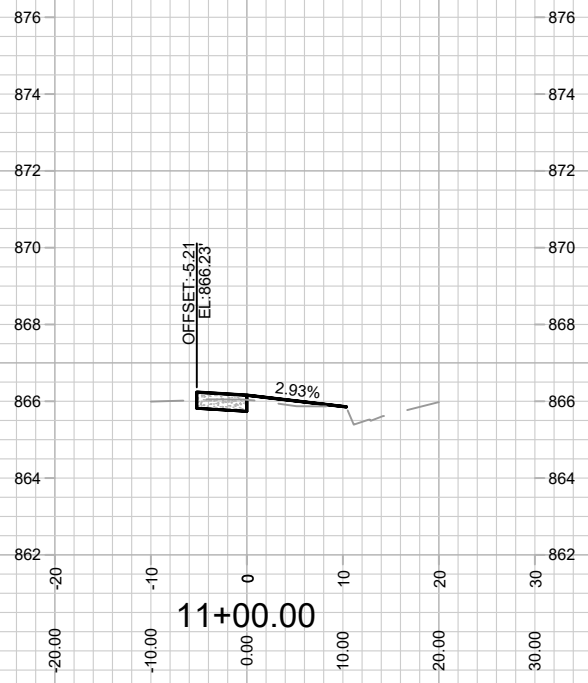
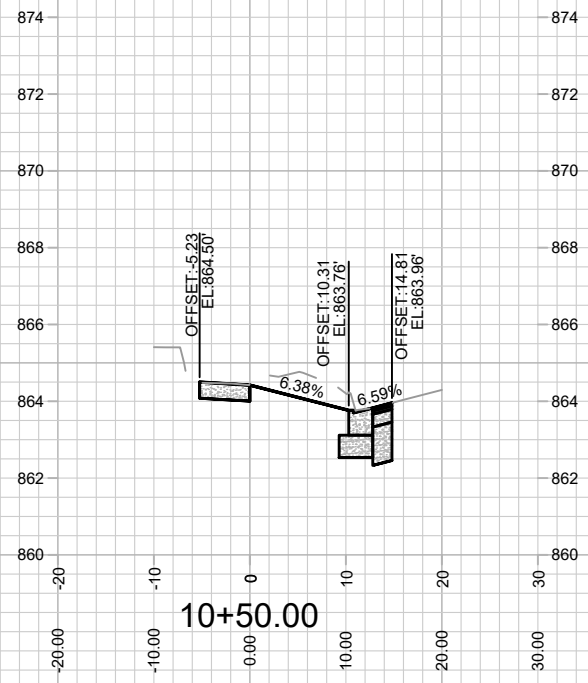
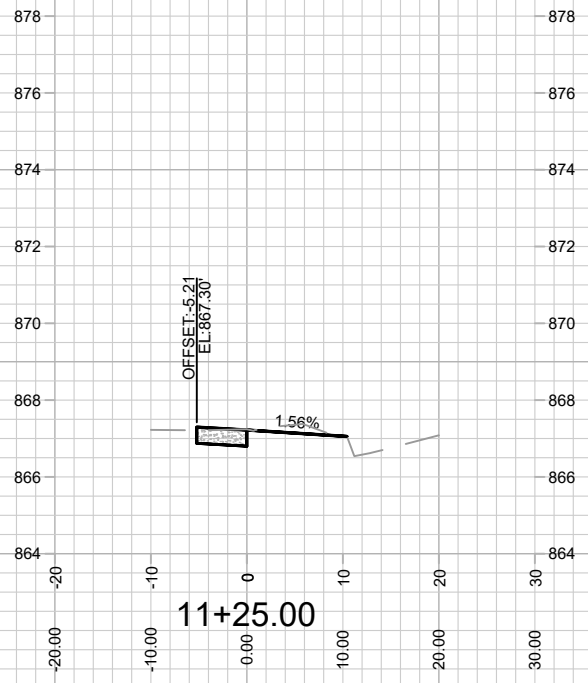
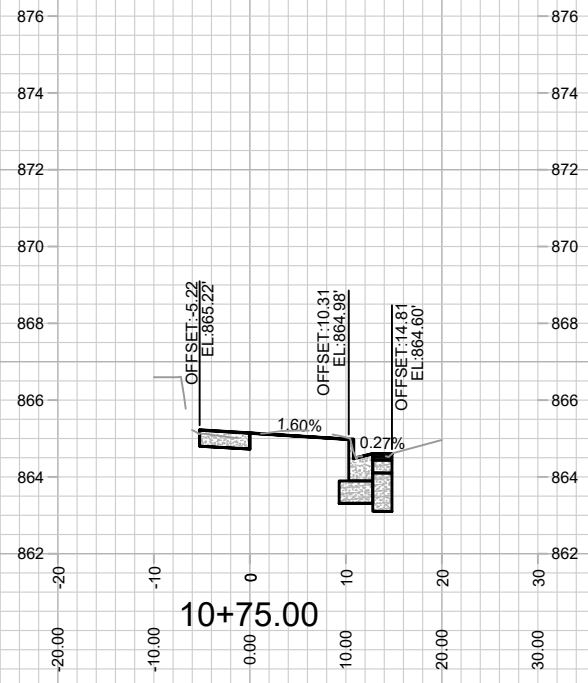

16095
X-1

CROSS SECTION - N BUTLER STREET
121 N BUTLER STREET
M:\DESIGN\Projects\16095\CAD\Streets\16095EN-Xsections.dwg

16095
MADISON, WI
CONTRACT NO: 9736

MARK	REVISION	DATE	BY
16095 <td>Designed By: NJJ <td>Date: 3/12/2026 11:53 AM <td>X-1</td> </td></td>	Designed By: NJJ <td>Date: 3/12/2026 11:53 AM <td>X-1</td> </td>	Date: 3/12/2026 11:53 AM <td>X-1</td>	X-1