

Madison, Wisconsin

CITY OF MADISON

CITY ENGINEERING DIVISION

DEPARTMENT OF PUBLIC WORKS

PLAN OF PROPOSED IMPROVEMENT

529-557 STATE STREET, 431-441 N. FRANCES STREET, AND 432 W. GILMAN STREET (THE HUB) —UTILITIES ONLY—

CITY PROJECT NO. 53B2363
CONTRACT NO. 2363

PUBLIC IMPROVEMENT PROJECT APPROVED

SEPTEMBER 17, 2013

BY THE COMMON COUNCIL OF MADISON, WISCONSIN

PUBLIC IMPROVEMENT DESIGN APPROVED BY:

[Signature] 11/12/13
City Engineer Date

SIDEWALK DESIGNED BY:

UTILITIES ONLY

ELECTRICAL DESIGNED BY:

To BE ISSUED SEPARATELY

STORM SEWER DESIGNED BY:

SANITARY SEWER DESIGNED BY:
[Signature]
LISA R. COLEMAN
E-37708
MADISON WI
11/7/13
PROFESSIONAL ENGINEER

STORM SEWER DESIGNED BY:
[Signature]
LISA R. COLEMAN
E-37708
MADISON WI
11/7/13
PROFESSIONAL ENGINEER

INDEX OF SHEETS

SHEET NO.	TITLE
1	STATE STREET UTILITIES
U1	FRANCES STREET UTILITIES
U2	GILMAN STREET UTILITIES
U3	

CONVENTIONAL SIGNS	
FIELD VERIFY ALL UTILITY LOCATIONS	
GAS	— G —
STORM SEWER	— ST —
SANITARY SEWER	— SAN —
WATER	— W —
OVERHEAD ELECTRIC	— OH —
POWER POLE	⊕
ADA COMPLIANT RAMP W/ DETECTABLE WARNING FIELD	
COMBUSTIBLE FLUIDS	

CONSTRUCTION PROJECT LOCATION

NOTES:

ALL GUTTERS SHALL DRAIN WITH A MINIMUM GRADE OF 0.50% TOWARD STORM SEWER INLETS.

SIDEWALK RAMPS AND CURB THRU SIDEWALK RAMPS SHALL HAVE A MAXIMUM SLOPE OF 1" PER 12". SIDEWALK AND CURB RAMPS SHALL BE CONSTRUCTED WITH A SIDE SLOPE OF 2.00%. SIDEWALK SHALL HAVE A MINIMUM LONGITUDINAL SLOPE OF 0.40% AND A MAXIMUM LONGITUDINAL SLOPE OF 5.00% EXCEPT WHERE STREET GRADES EXCEED 5.00%.

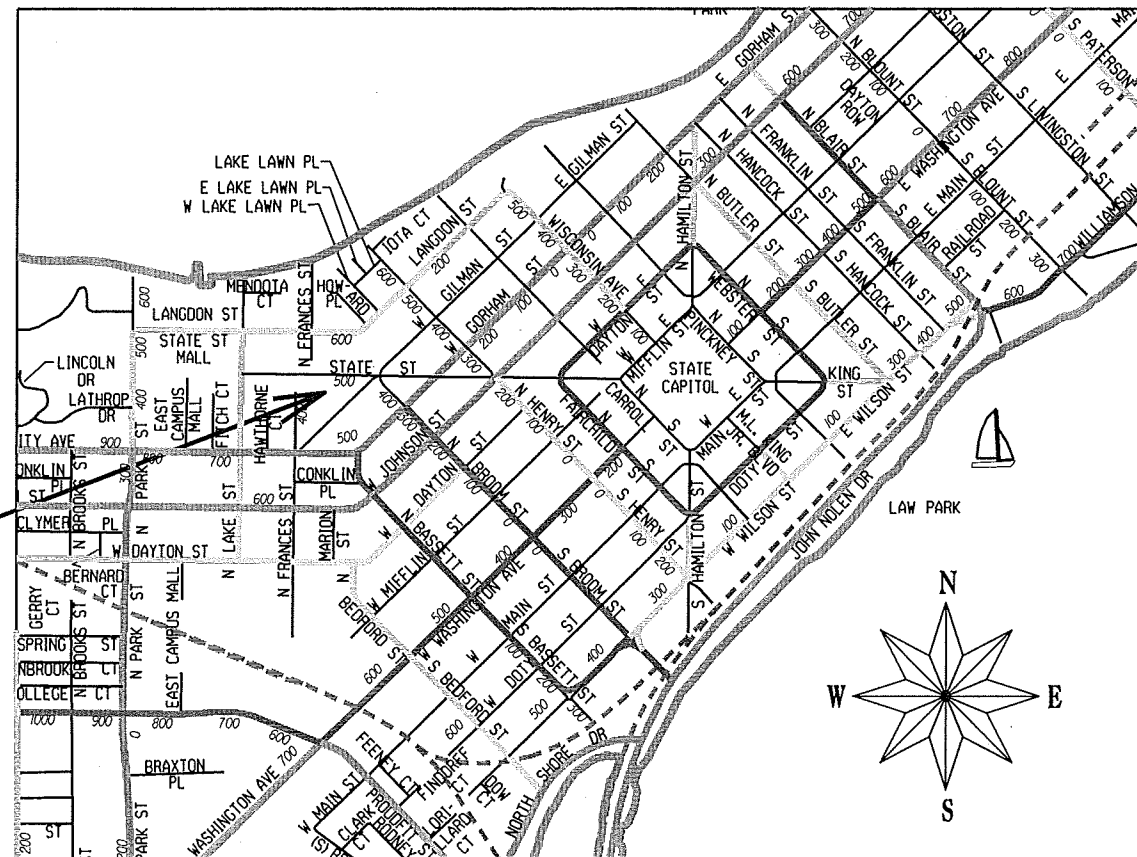

PLOT SCALE: _____
PLOT NAME: _____
REV. DATE: _____
ORIGINATOR: CITY OF MADISON-STREETS DIVISION

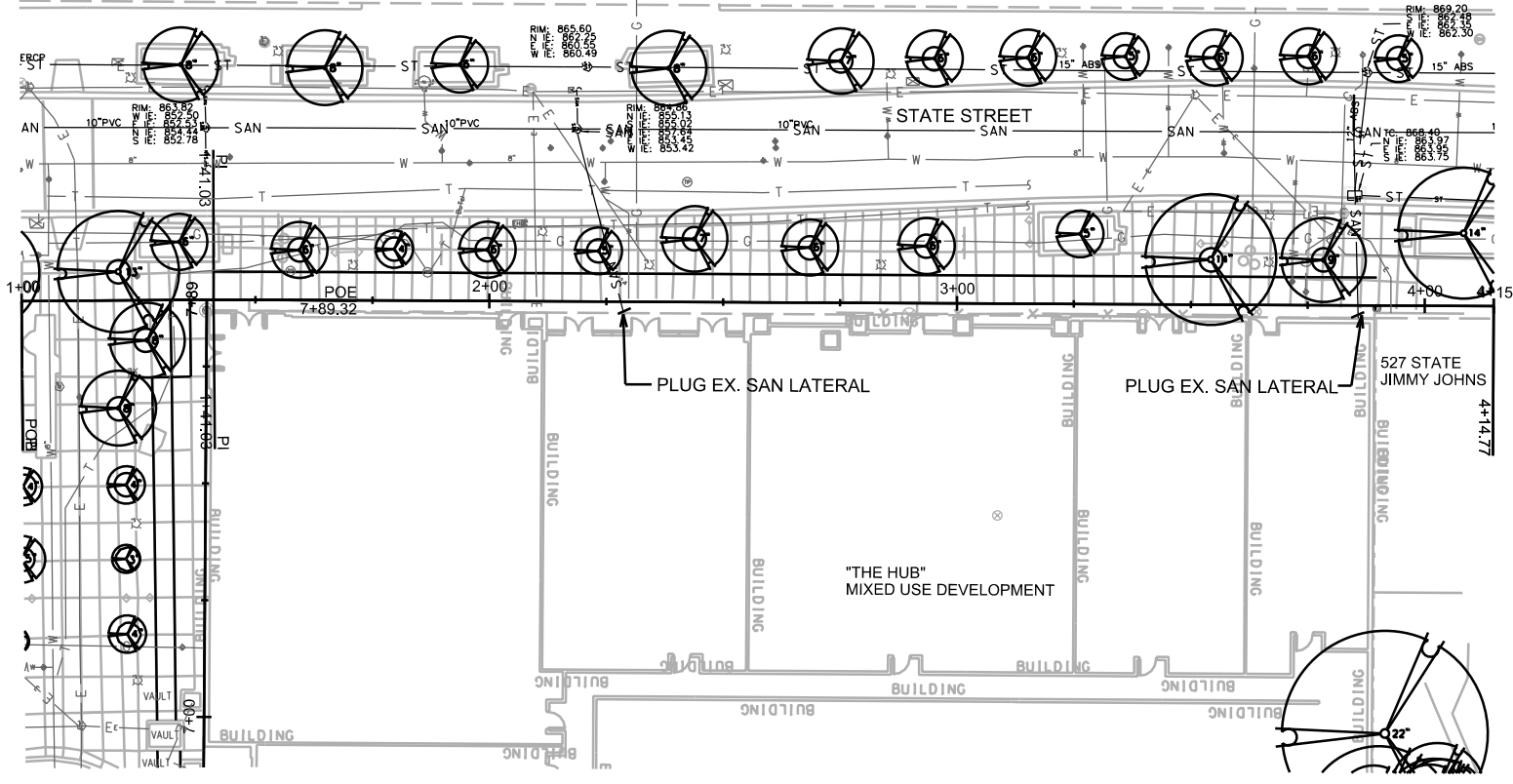

NOTE:

1. THIS PLAN IS FOR UTILITY CONNECTIONS ONLY, COMPLETE RESTORATION PLANS SHALL BE ISSUED SEPARATELY. UNTIL FINAL RESTORATION, AFFECTED STREET AND SIDEWALK IN THE ROW SHALL BE TEMPORARILY PATCHED AS NEEDED, AS DIRECTED BY THE CITY CONSTRUCTION ENGINEER.
2. CONTRACTOR SHALL INSTALL ELECTRONIC MARKER BALLS AT PROPERTY LINE ABOVE ALL PRIVATE STORM SEWER CONNECTIONS.
3. CONTRACTOR SHALL INSTALL ELECTRONIC MARKER BALLS AT PROPERTY LINE ABOVE ALL SANITARY LATERALS.
4. DEVELOPER/CONTRACTOR SHALL OBTAIN A STREET OCCUPANCY PERMIT FROM CITY BUILDING INSPECTION AND TRAFFIC ENGINEERING PRIOR TO BEGINNING ANY WORK WITHIN THE CITY RIGHT-OF-WAY. CONTACT MIKE DUHR WITH TRAFFIC ENGINEERING (267-8755) FOR STREET OCCUPANCY PERMIT.
5. CONTRACTOR SHALL CONTACT CITY PARKING UTILITY (DAN VALENZA 266-4767) FOR REMOVAL OF PARKING METER HEADS AND /OR MULTI-SPACE METER KIOSKS.
6. CONTRACTOR AND DEVELOPER SHALL BE RESPONSIBLE FOR COORDINATING AND SCHEDULING ANY REQUIRED RELOCATION OF PRIVATE UTILITIES WITH PRIVATE UTILITY COMPANIES.

PLOT SCALE: _____

PLOT NAME: _____

REV. DATE: _____

ORIGINATOR: CITY OF MADISON, STREETS DIVISION

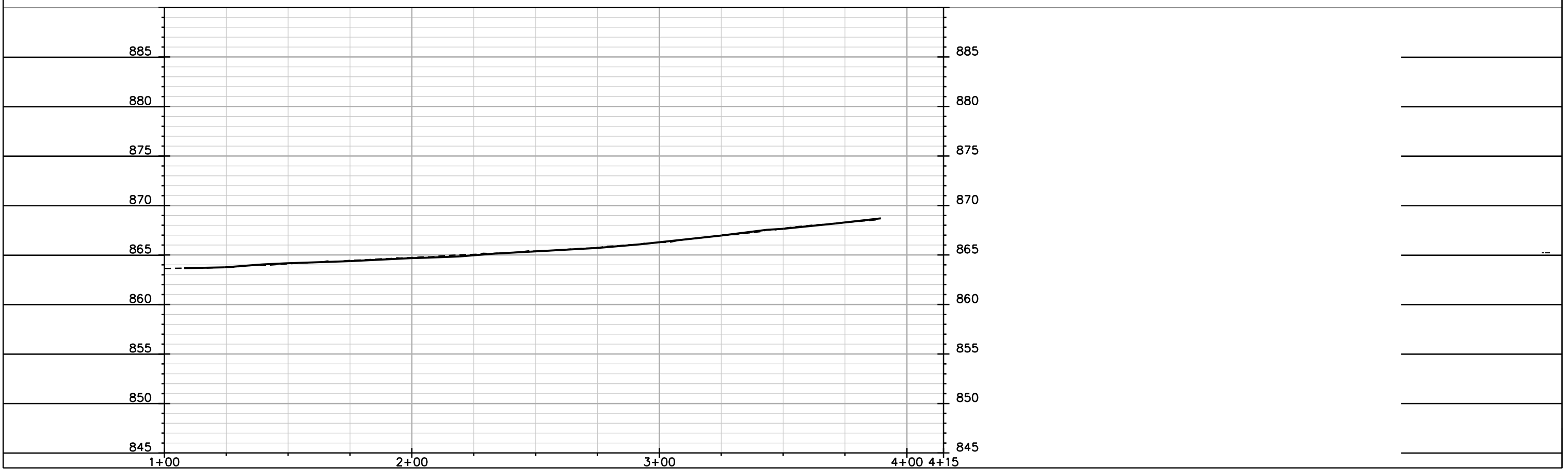

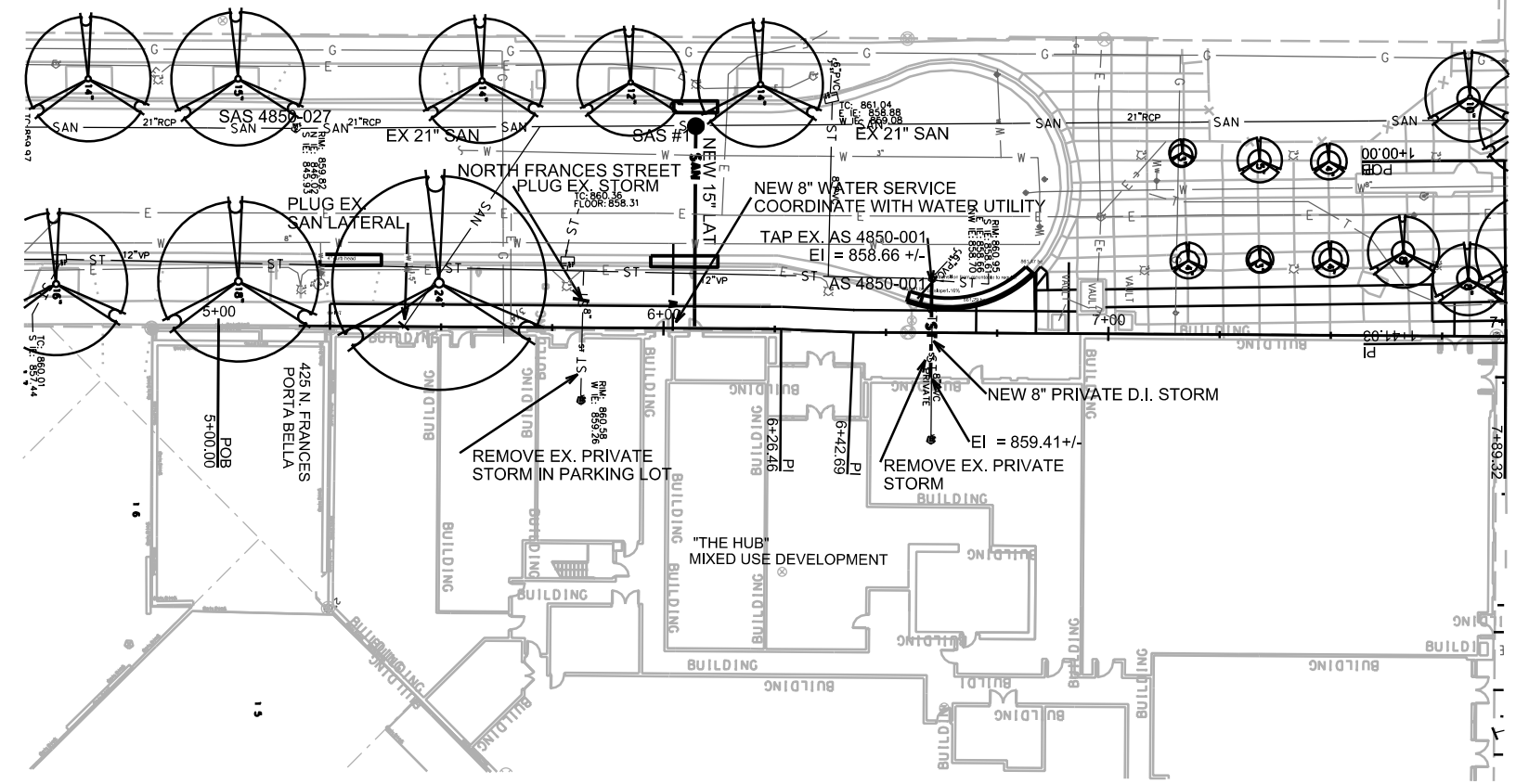

NOTE:

1. THIS PLAN IS FOR UTILITY CONNECTIONS ONLY. COMPLETE RESTORATION PLANS SHALL BE ISSUED SEPARATELY. UNTIL FINAL RESTORATION, AFFECTED STREET AND SIDEWALK IN THE ROW SHALL BE TEMPORARILY PATCHED AS NEEDED, AS DIRECTED BY THE CITY CONSTRUCTION ENGINEER.
2. CONTRACTOR SHALL INSTALL ELECTRONIC MARKER BALLS AT PROPERTY LINE ABOVE ALL PRIVATE STORM SEWER CONNECTIONS.
3. CONTRACTOR SHALL INSTALL ELECTRONIC MARKER BALLS AT PROPERTY LINE ABOVE ALL SANITARY LATERALS.
4. DEVELOPER/CONTRACTOR SHALL OBTAIN A STREET OCCUPANCY PERMIT FROM CITY BUILDING INSPECTION AND TRAFFIC ENGINEERING PRIOR TO BEGINNING ANY WORK WITHIN THE CITY RIGHT-OF-WAY. CONTACT MIKE DUHR WITH TRAFFIC ENGINEERING (267-8755) FOR STREET OCCUPANCY PERMIT.
5. CONTRACTOR SHALL CONTACT CITY PARKING UTILITY (DAN VALENZA 266-4767) FOR REMOVAL OF PARKING METER HEADS AND /OR MULTI-SPACE METER KIOSKS.
6. CONTRACTOR AND DEVELOPER SHALL BE RESPONSIBLE FOR COORDINATING AND SCHEDULING ANY REQUIRED RELOCATION OF PRIVATE UTILITIES WITH PRIVATE UTILITY COMPANIES.

PLOT SCALE: _____

PLOT NAME: _____

REV. DATE: _____

ORIGINATOR: CITY OF MADISON, STREETS DIVISION

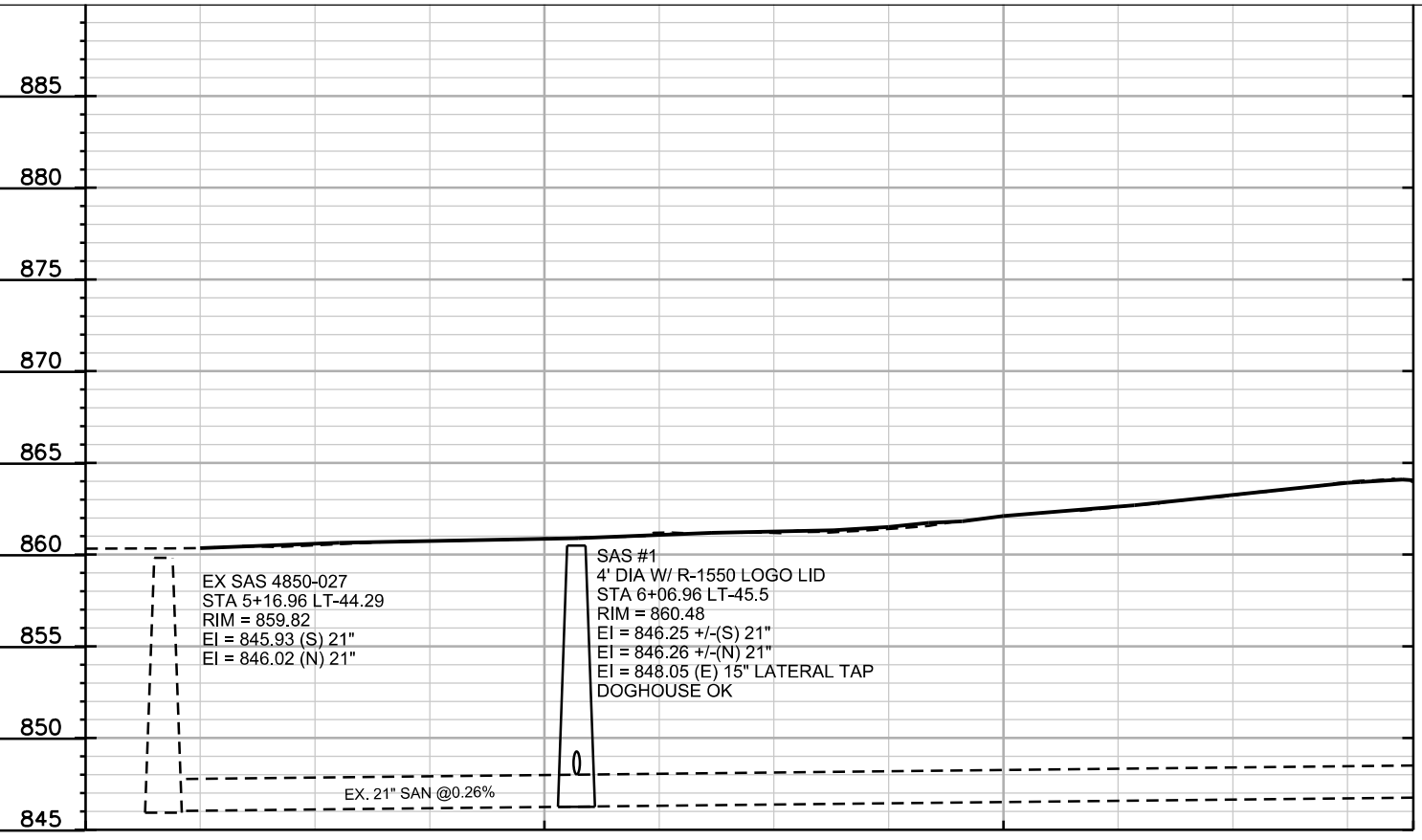

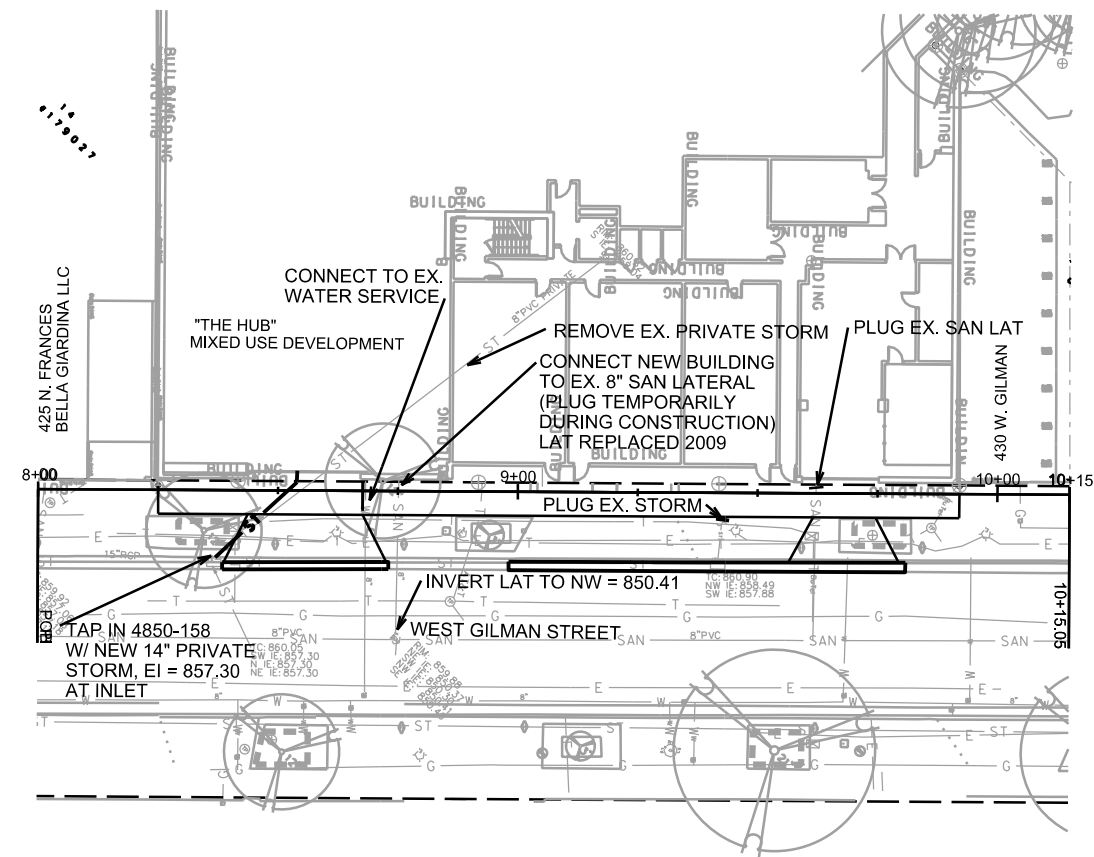
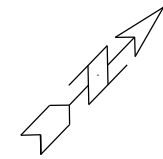

NOTE:

1. THIS PLAN IS FOR UTILITY CONNECTIONS ONLY. COMPLETE RESTORATION PLANS SHALL BE ISSUED SEPARATELY. UNTIL FINAL RESTORATION, AFFECTED STREET AND SIDEWALK IN THE ROW SHALL BE TEMPORARILY PATCHED AS NEEDED, AS DIRECTED BY THE CITY CONSTRUCTION ENGINEER.
2. CONTRACTOR SHALL INSTALL ELECTRONIC MARKER BALLS AT PROPERTY LINE ABOVE ALL PRIVATE STORM SEWER CONNECTIONS.
3. CONTRACTOR SHALL INSTALL ELECTRONIC MARKER BALLS AT PROPERTY LINE ABOVE ALL SANITARY LATERALS.
4. DEVELOPER/CONTRACTOR SHALL OBTAIN A STREET OCCUPANCY PERMIT FROM CITY BUILDING INSPECTION AND TRAFFIC ENGINEERING PRIOR TO BEGINNING ANY WORK WITHIN THE CITY RIGHT-OF-WAY. CONTACT MIKE DUHR WITH TRAFFIC ENGINEERING (267-8755) FOR STREET OCCUPANCY PERMIT.
5. CONTRACTOR SHALL CONTACT CITY PARKING UTILITY (DAN VALENZA 266-4767) FOR REMOVAL OF PARKING METER HEADS AND /OR MULTI-SPACE METER KIOSKS.
6. CONTRACTOR AND DEVELOPER SHALL BE RESPONSIBLE FOR COORDINATING AND SCHEDULING ANY REQUIRED RELOCATION OF PRIVATE UTILITIES WITH PRIVATE UTILITY COMPANIES.

PLOT SCALE: _____

PLOT NAME: _____

REV. DATE: _____

ORIGINATOR: CITY OF MADISON, STREETS DIVISION

