

CITY OF MADISON

CITY ENGINEERING DIVISION

DEPARTMENT OF PUBLIC WORKS

PLAN OF PROPOSED IMPROVEMENT

PUBLIC IMPROVEMENT PROJECT APPROVED

BY THE COMMON COUNCIL OF MADISON, WISCONSIN

PUBLIC IMPROVEMENT DESIGN APPROVED BY:

[Signature] 6/18/15
City Engineer Date

SANITARY SEWER DESIGNED BY:

SANITARY SEWER DESIGNED BY CONSULTANT PLAN & PROFILE SHEET STAMPED & SIGNED

INDEX OF SHEETS

SHEET NO.	TITLE
1	
UI	UTILITY PLAN & PROFILES

1802 MAPLECREST DRIVE- PHASE 4

CITY PROJECT NO. 53B2427

MUNIS NO. 10831

CONSTRUCTION PROJECT LOCATION

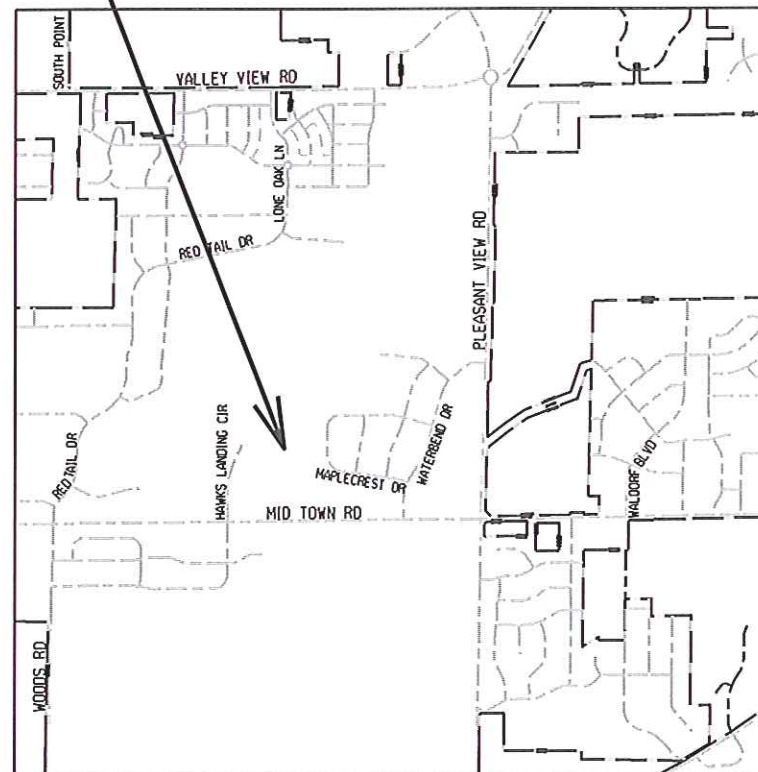
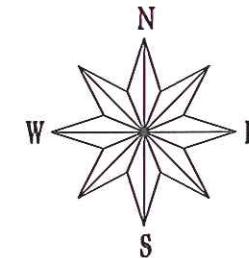

PROJECT LOCATION

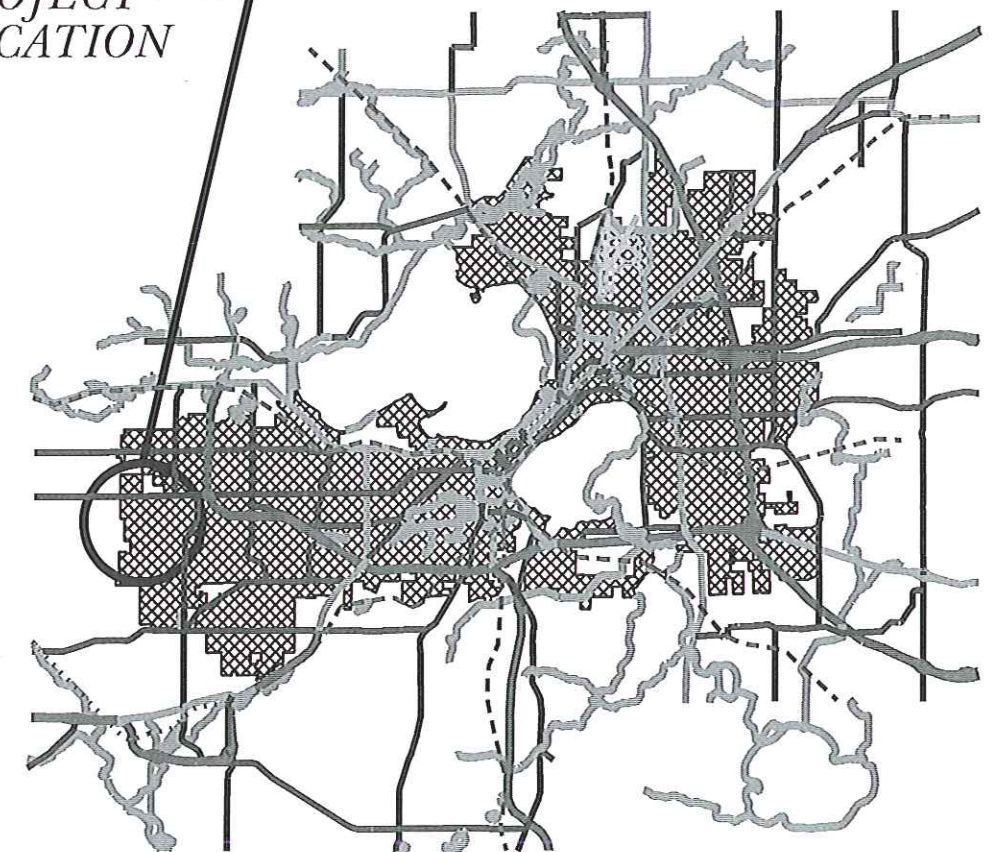

CONVENTIONAL SIGNS

FIELD VERIFY ALL UTILITY LOCATIONS

GAS	— G —
STORM SEWER	— ST —
SANITARY SEWER	— SAN —
WATER	— W —
OVERHEAD ELECTRIC	— OH —
POWER POLE	⊕
ADA COMPLIANT RAMP W/ DETECTABLE WARNING FIELD	
COMBUSTIBLE FLUIDS	

PLOT SCALE: _____

PLOT NAME: _____

REV. DATE: _____

ORIGINATOR: CITY OF MADISON, STREETS DIVISION

