

LEGEND (EXISTING)

- EX CONTOUR (1' INTERVAL)
- ▬ EXISTING STONE RETAINING WALL
- ⋯ EXISTING SAND
- ☼ EXISTING TREE
- EXISTING RAILING
- ⋯ EXISTING EDGE OF WATER

LEGEND (PROPOSED)

- ▬ PROPOSED CONCRETE
- ▬ PROPOSED SHORELINE ARMORING
- x- PROPOSED RAILING
- ▬ PROPOSED STONE RETAINING WALL

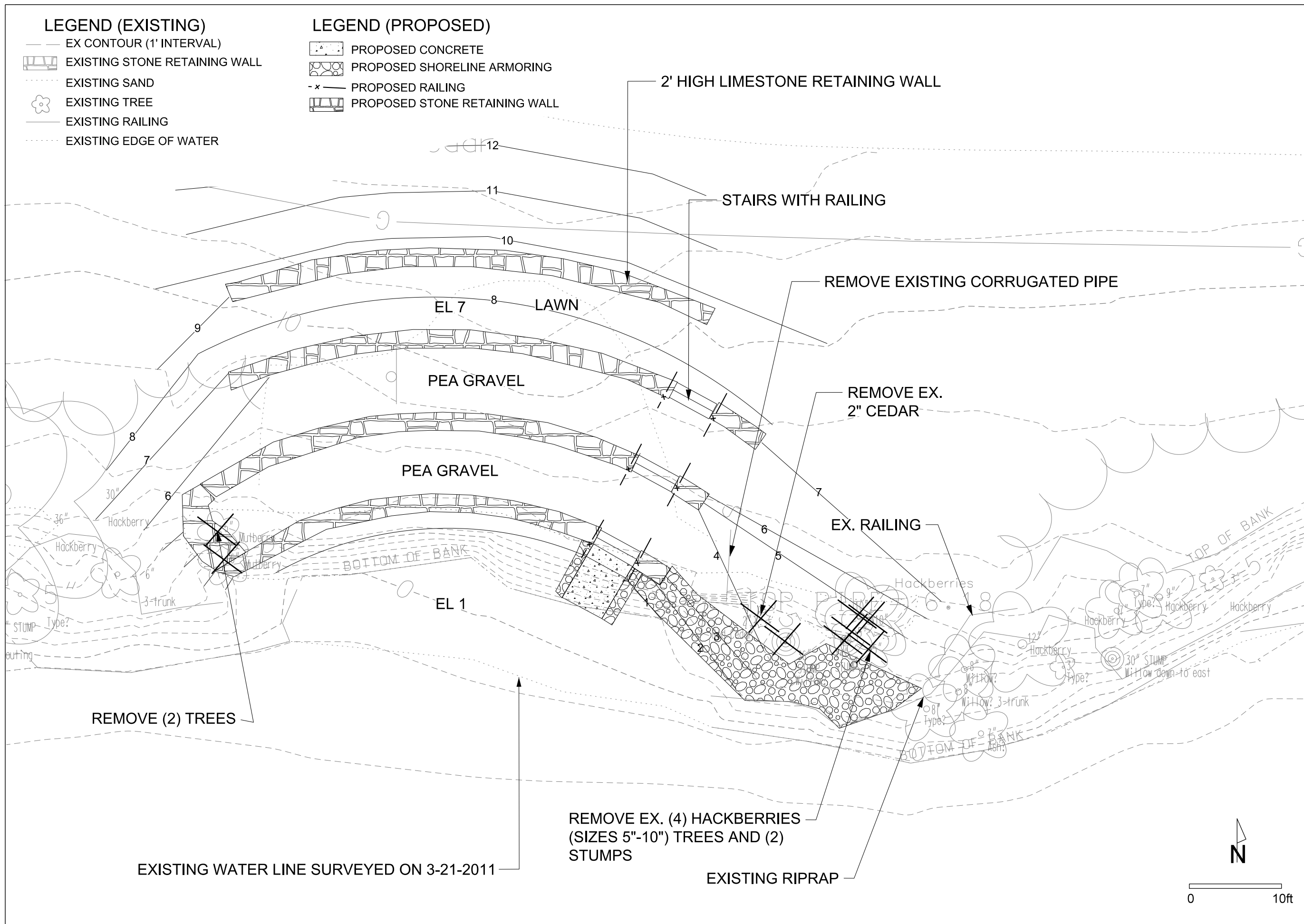

City of Madison
 Department of Public Works
PARK DIVISION
 City-County Building, Suite 104
 210 Martin Luther King, Jr. Blvd.
 PO Box 2987
 Madison, WI 53701-2987



PROJECT:
HUDSON BEACH IMPROVEMENTS

HUDSON PARK
 2713 Lakeland Ave.
 Madison, WI 53704

DRAFT CONCEPT PLAN

Although every effort has been made in preparing these plans and checking them for accuracy, the contractor and subcontractors must check all details and dimensions of their trade and be responsible for the same.

ITEM	DATE
Drawn by: SCL	08-15-2011
Revised by: SCL	10-10-2011

PUBLIC WORKS PROJECT #:

SHEET TITLE:
OPTION B

SHEET NUMBER: