

# Traffic Control & Staging (Overview)

- **Vehicles**

- One (1) Travel Lane in Each Direction

- Traffic Crossovers

- Turn Lane Restrictions at Intersections

- **Pedestrians & Bicycles**

- Existing - Temporary - Proposed - Detoured

- **Boats**

- Restrictions during Bridge Structure Construction

- **Railroad Crossings**

- Complete Closures for Crossing Construction



# Traffic Control & Staging (Stage 1: October 2025 - November 2025)

## Traffic:

One Lane in Each Direction  
Intersections Open  
Existing Capital City Trail Open

## Construction:

Traffic Crossovers  
Temporary Pavement  
Storm Sewer Connections  
Temporary Traffic Signals

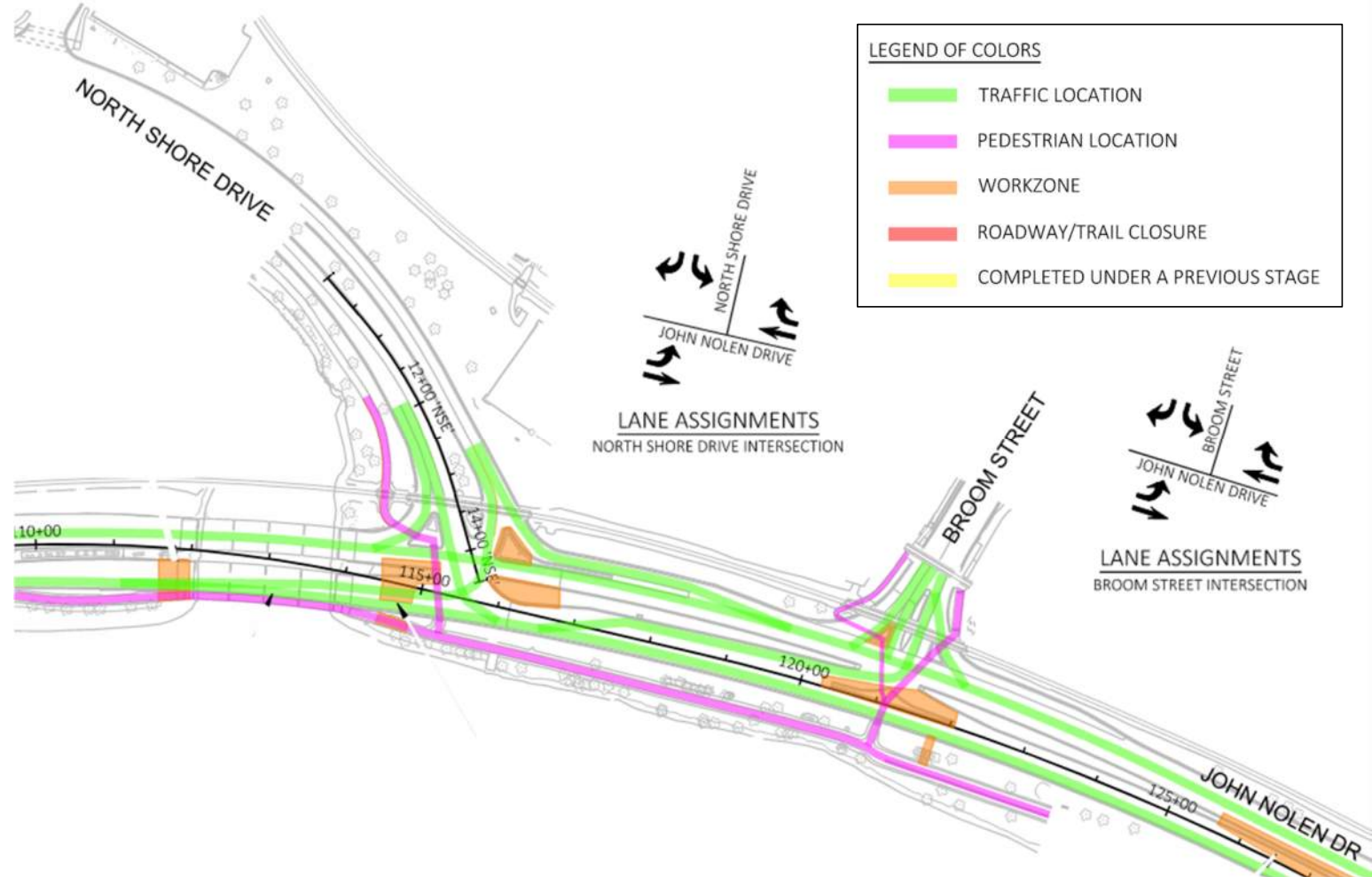

# Traffic Control & Staging (Stage 2: November 2025 - July 2026)

## Traffic:

- One Lane in Each Direction (Bi-Directional)
- Intersections Open (Turn Lanes Restricted)
- Close North Shore Drive or Broom Street (One-At-A-Time)
- Bicycle/Pedestrian Detour During RR Crossings
- Existing Capital City Trail Open

## Construction:

- Southbound Roadway & Bridges
- North Shore Drive Path
- North Shore Drive Intersection
- Broom Street Intersection
- Railroad Crossings

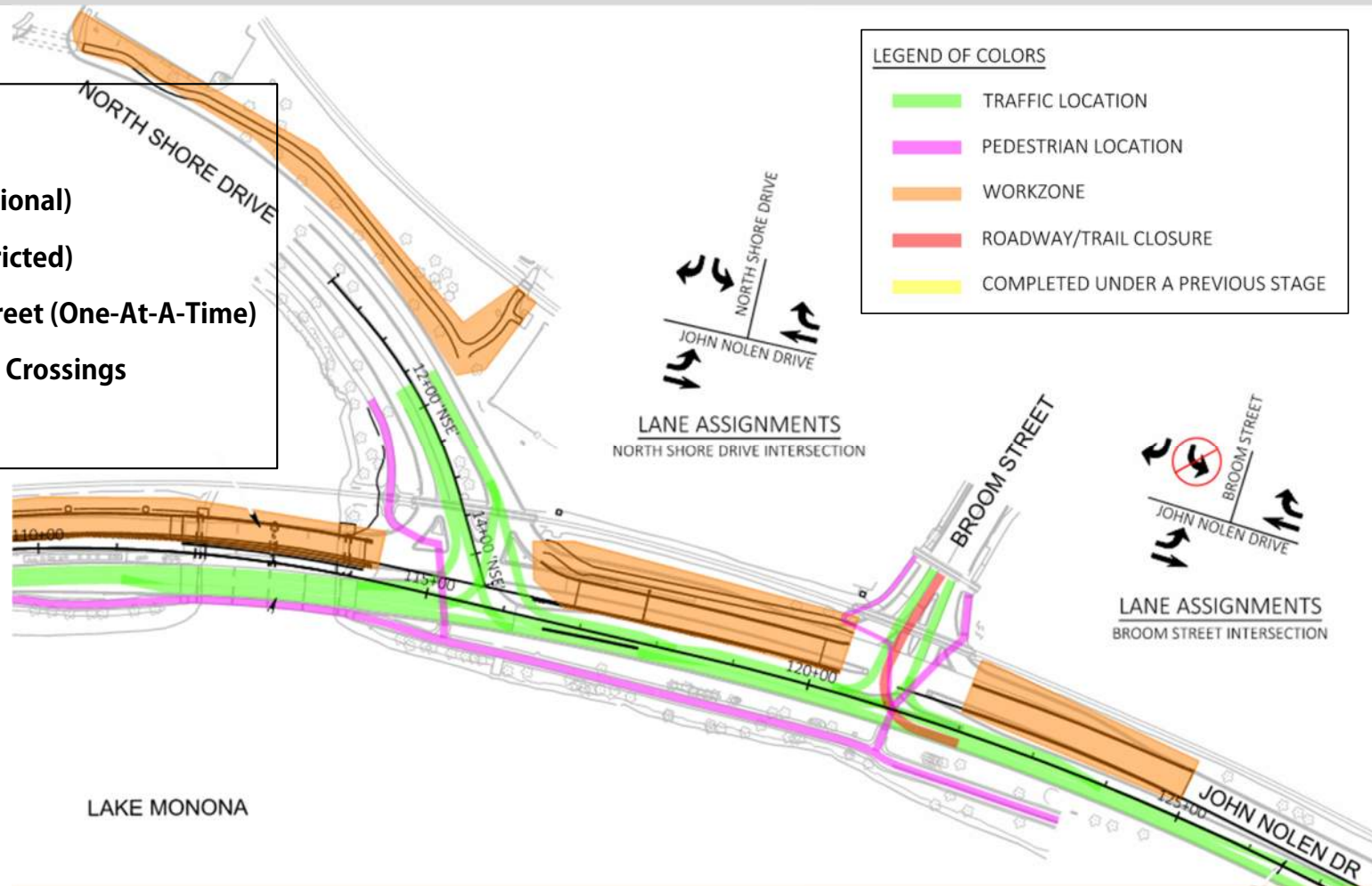



# Traffic Control & Staging (Railroad Crossing Detours)

## North Shore Drive (Summer 2026)

Roadway Closure: 60 Calendar Days  
Sidewalk Closure: 10 Calendar Days



## Broom Street (Summer 2026)

Roadway Closure: 50 Calendar Days  
Sidewalk Closure: 10 Calendar Days



### Legend

Work Zone  
Detour Route

Railroad Crossing Construction



# Traffic Control & Staging (Stage 3: July 2026 - June 2027)

## Traffic:

One Lane in Each Direction (Bi-Directional)  
Intersections Open (Turn Lanes Restricted)  
Capital City Trail Detoured

## Construction:

Northbound Roadway & Bridges  
Capital City Trail  
Shoreline Stone Revetment

Madison LakeWay Improvements  
(By Others)

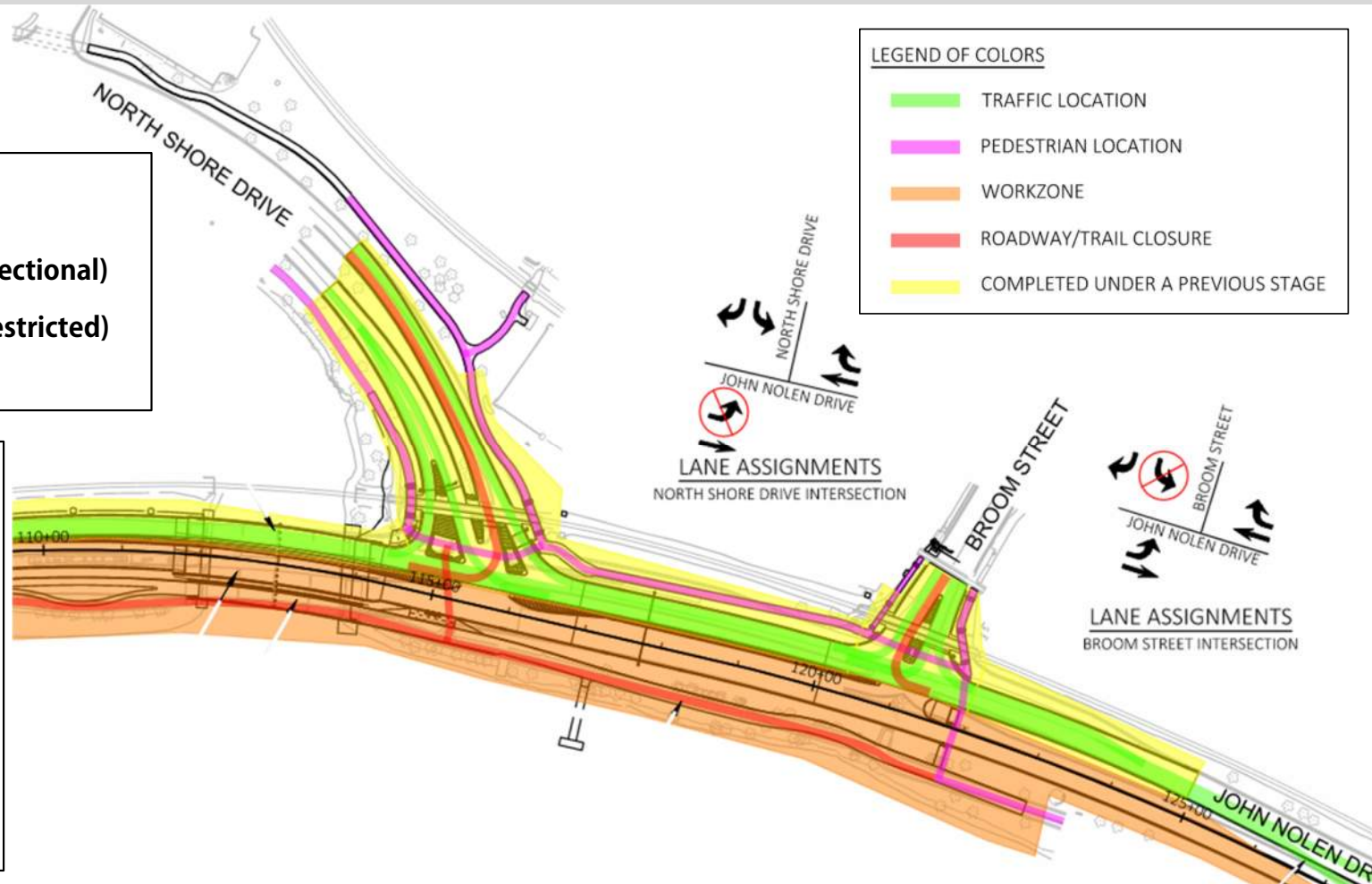

# Traffic Control & Staging (Capital City Trail Detour)



## Capital City Trail Closure

(Approximately July 2026 to July 2027)

### Legend

Work Zone

Detour Route

Capital City Trail Construction





# Traffic Control & Staging (Stage 4: June 2027 - July 2027)

## Traffic:

One Lane in Each Direction  
Intersections Open  
Capital City Trail Detoured

## Construction:

Median  
Final HMA Surface & Finishing

Madison LakeWay Improvements  
(By Others)

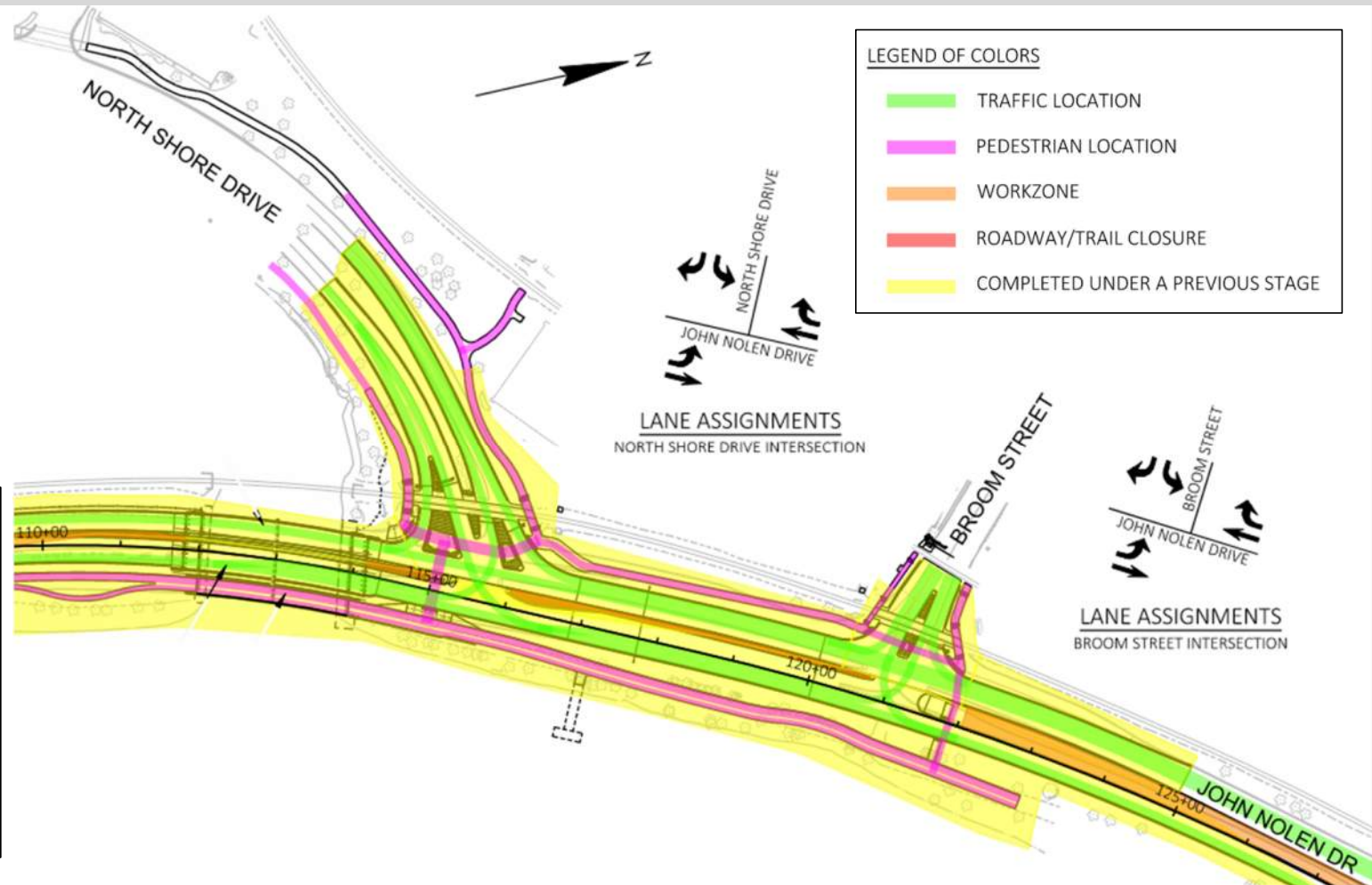

# Traffic Control & Staging (Boat Navigation)

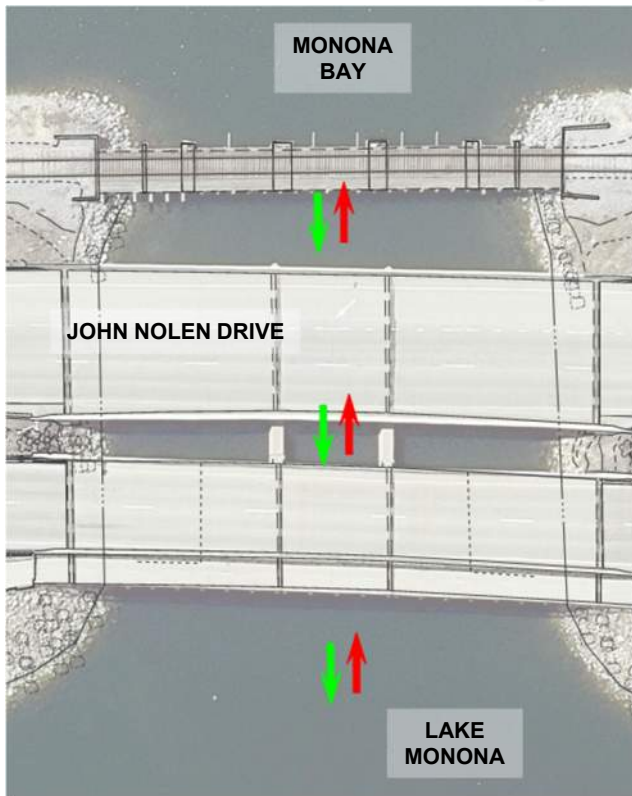

**EXISTING**  
(SHARE MIDDLE SPAN)

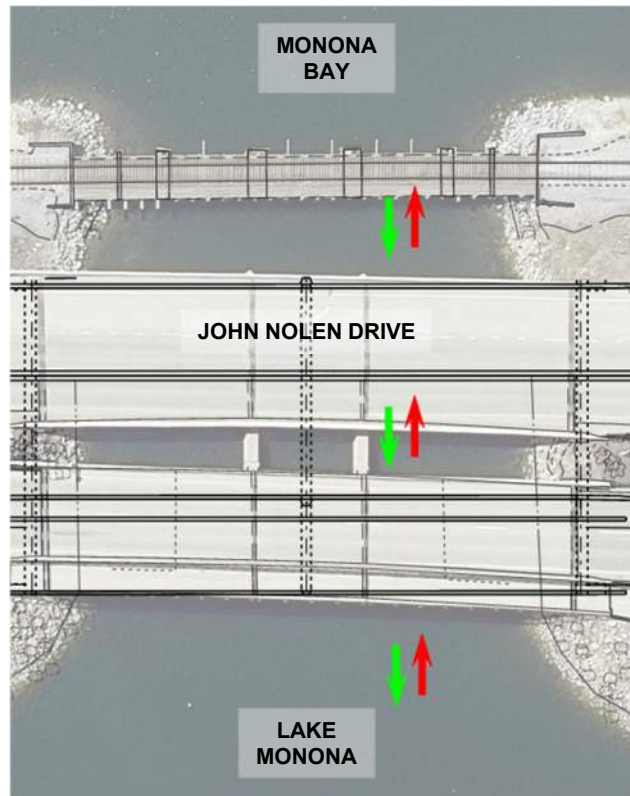

**DURING CONSTRUCTION**  
(SHARE EXTERIOR SPAN)

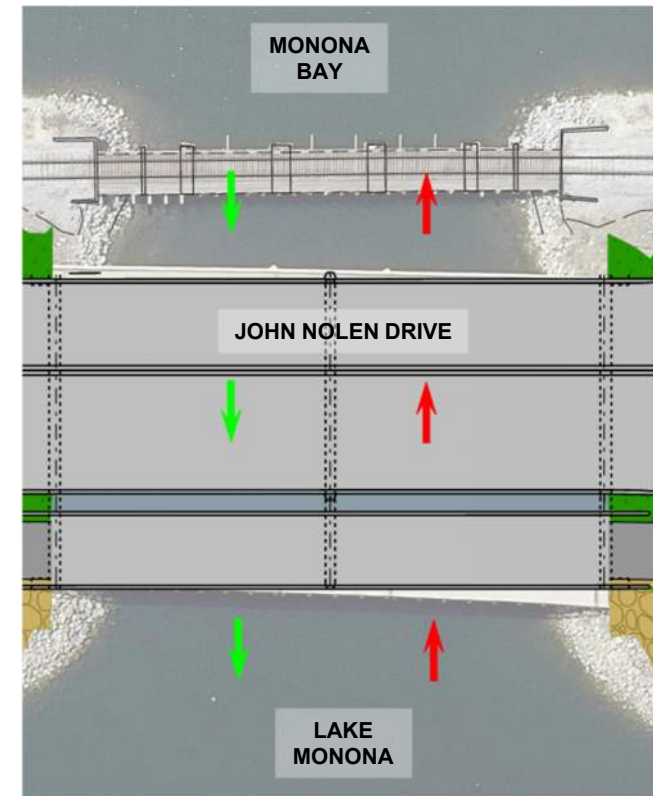

**AFTER CONSTRUCTION**  
(SEPARATE OWN SPAN)