

Welcome!

We will begin shortly...

Virtual Meeting Schedule

5:30 – 5:35	Welcome
5:35 – 6:00	Presentation
6:00 – 6:30	Table Top Design Review
6:30 – 7:00	Come Back Together/Q&A & Wrap-Up

City of Madison Staff at Tonight's Meeting

- **Sarah Lerner, PLA, LEED AP, ENV SP** is a landscape architect and graduated with a degree in Landscape Architecture from UW-Madison and is currently pursuing a graduate certificate in Sustainable Cities from Harvard Extension School. Prior to joining Engineering, she worked for 10 years at Madison Parks, and 5 years in the private sector.
- **Maddie Dumas, Greenway Vegetation Coordinator** has a Master's of Science from UW-Madison. She joined the City of Madison in 2018, and previously managed 660 acres of restored prairie and wetland for a non-profit.
- **Grant Pokos, PE** is a civil engineer with the City of Madison Engineering. He has over 20 years of experience and has designed many of the stormwater ponds in the City of Madison while working in the private sector.
- **Greg Fries, PE** is the Deputy City Engineer for the Engineering Division. He is a Professional Civil Engineer and a graduate from the University of Wisconsin-Madison with a B.S. Degree in Civil & Environmental Engineering and a Masters Degree in Business. Greg has worked for the City of Madison Engineering Division for 31 years.

CITY OF **MADISON**





Robin Greenway & Orchard Drive Culvert Public Information Meeting No. 2

City of Madison Engineering Division
March 14, 2023

CITY OF **MADISON**



Today's Agenda

- Summarize PIM Comments
- Present Two Concepts
- Table Exercise
- Come Back and iclicker Polling
- Q&A

We want to hear
from you!

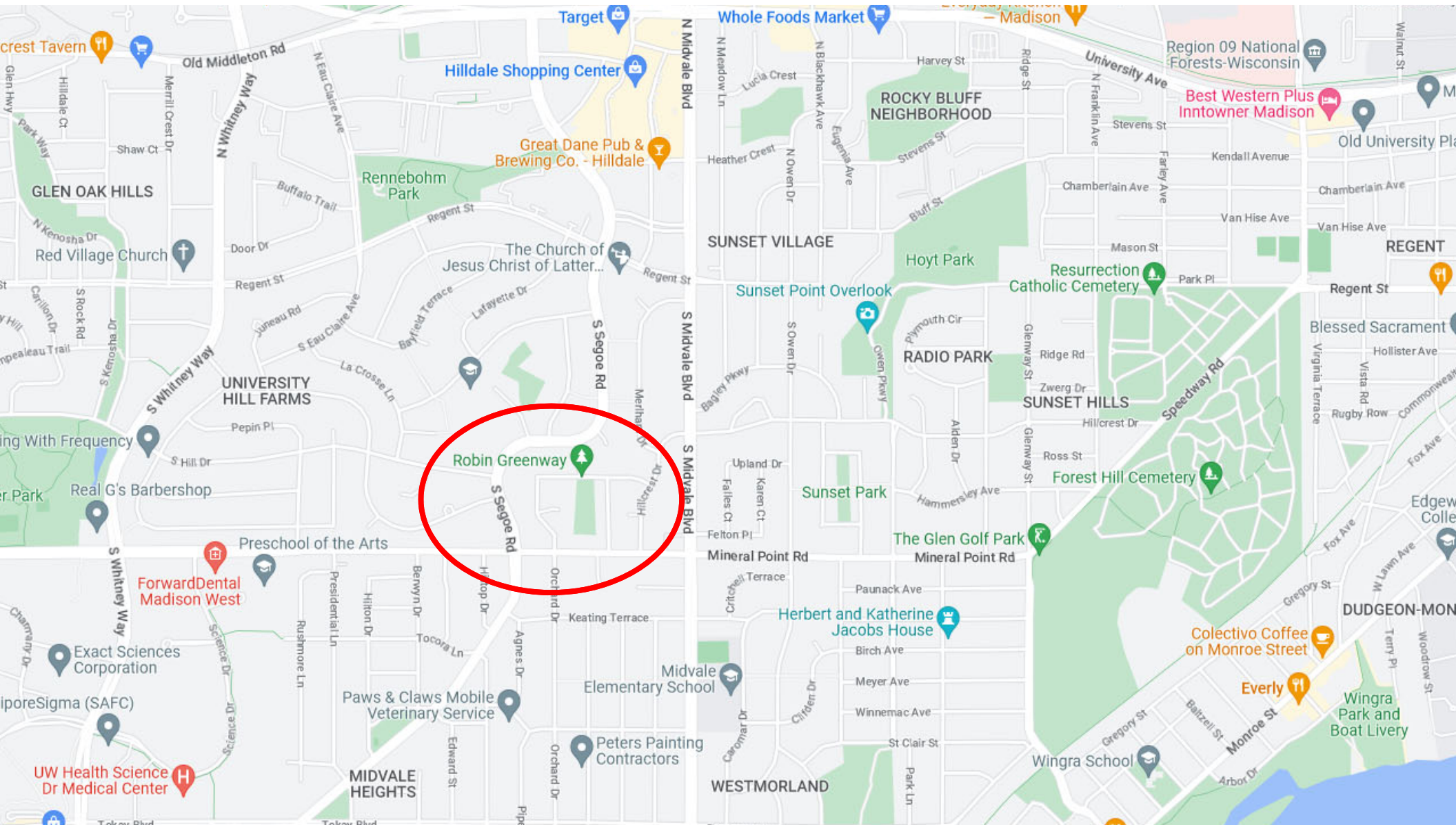

Rank the following goals of this project. This project should....

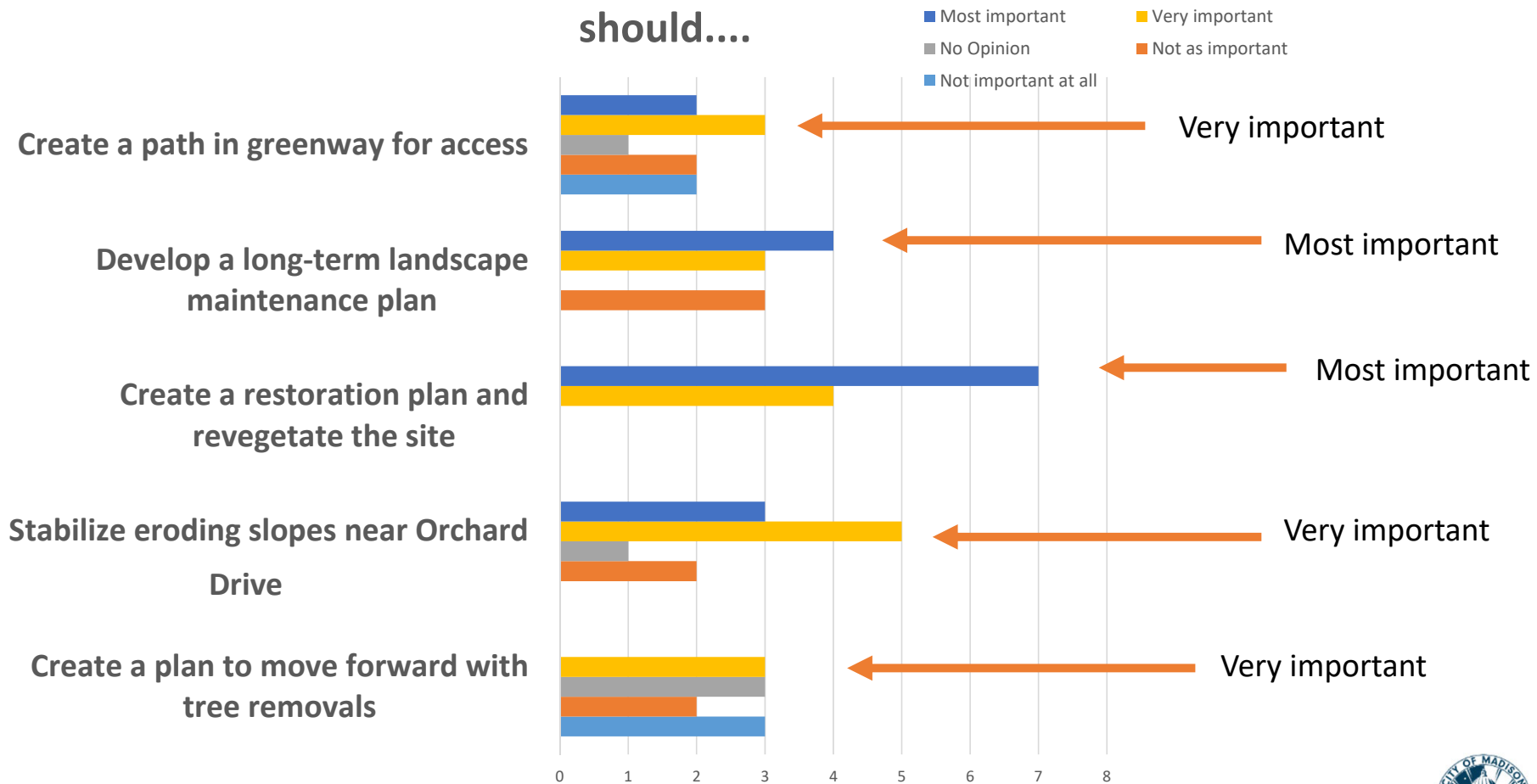

CITY OF MADISON



What do you feel are the **MOST** important roles of greenways in the City of Madison. Select your top 3 choices.

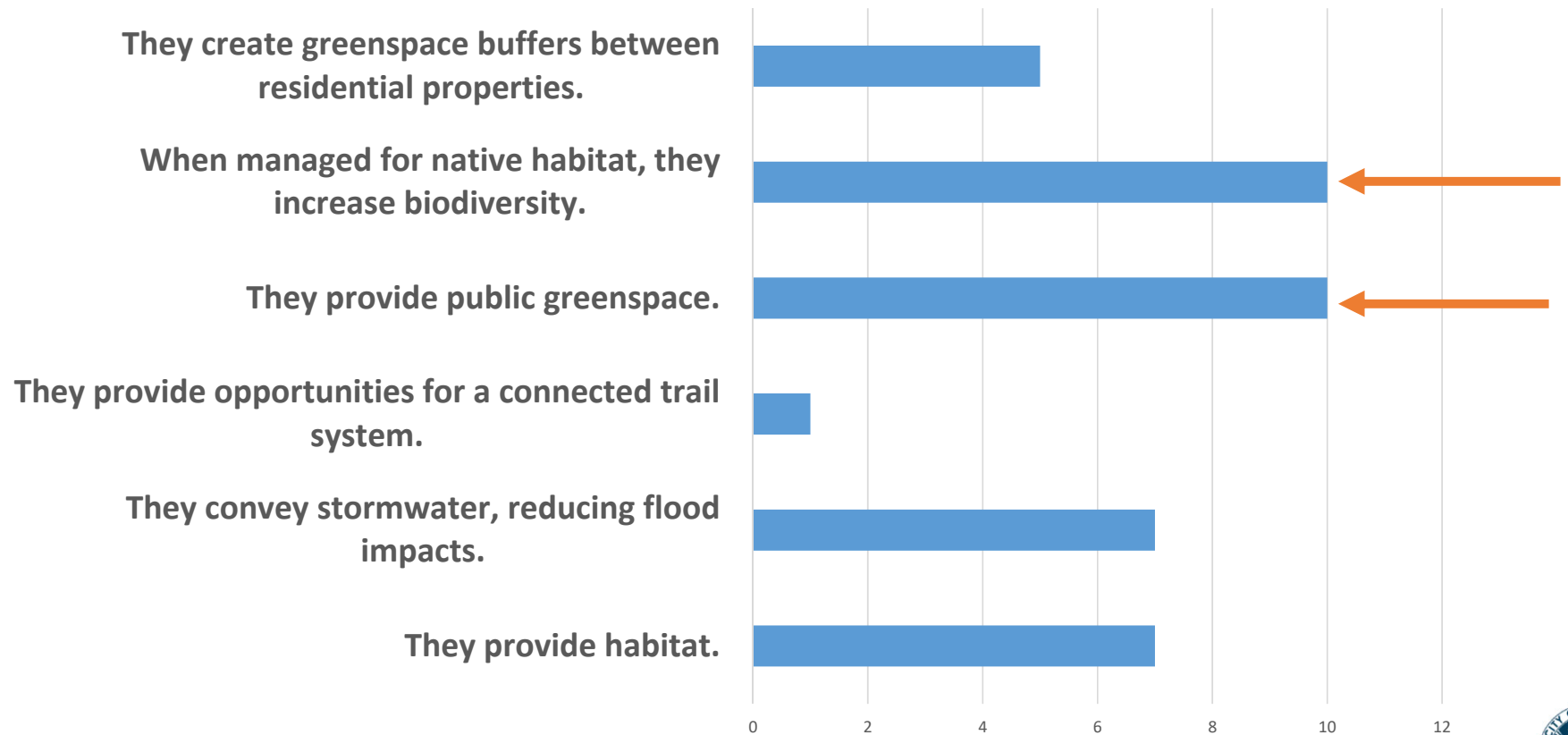

CITY OF **MADISON**



What do you feel are the LEAST important roles for greenways in the City of Madison?

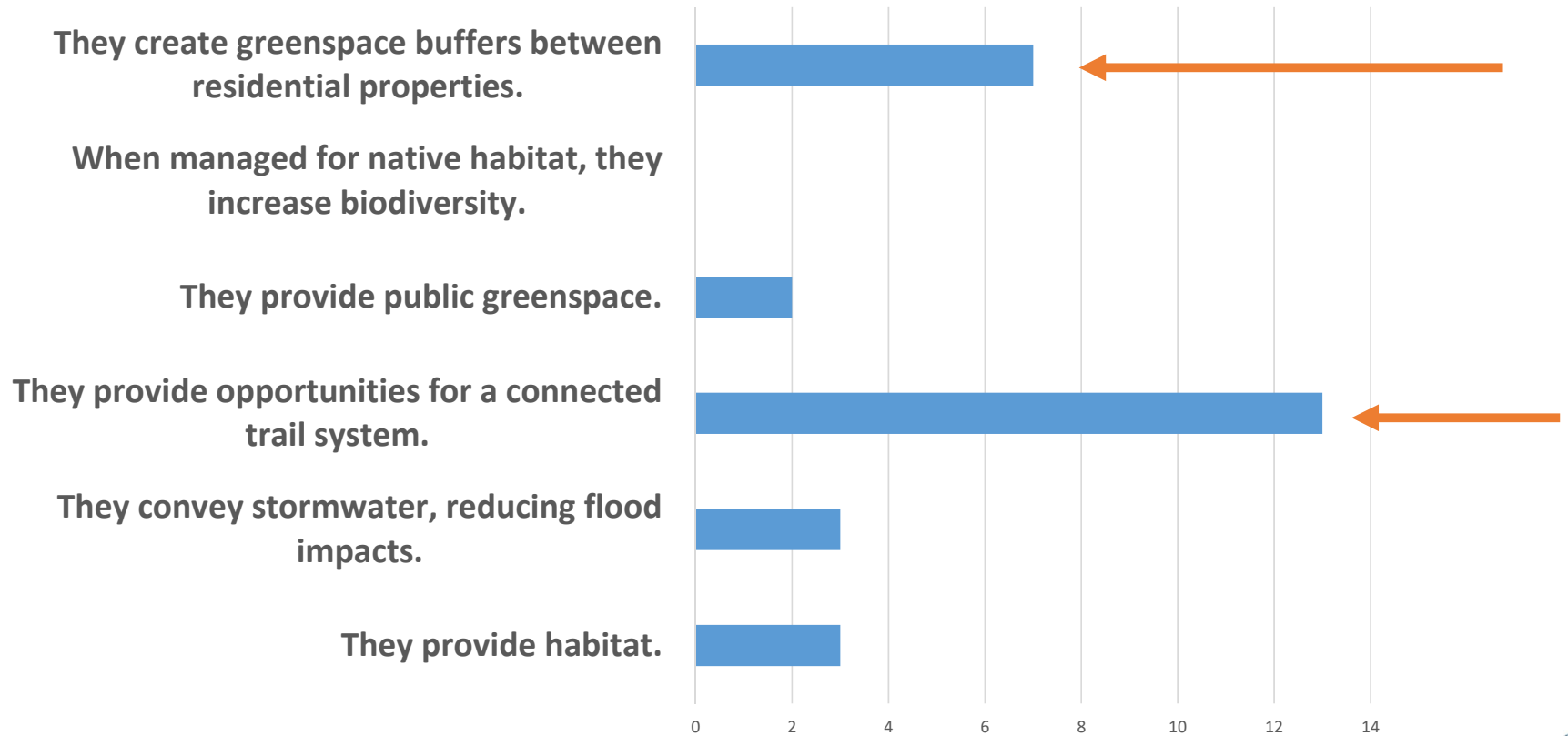

CITY OF **MADISON**



Vegetation Overview

- Consider this is Urban Woods, not currently a native forest community
- 184 Trees – Parcel east of Orchard Drive
 - 63 Listed on WDNR NR 40 as invasive
 - 53 trees listed as “regulated”
 - 10 trees listed as “non regulated” (Norway Maple)
 - 143 trees are native to Dane County
 - 134 are both native and invasive trees....this gets complicated
 - 40 Black locust (both native and invasive)
 - 31 Box elder (invasive, not WDNR listed, and native)

Wisconsin DNR NR 40 Invasive Trees

- Regulated and Restricted
 - Black locust *Robinia pseudocacia* (40)
 - Burning bush *Euonymous alatus* (2)
 - Common buckthorn *Rhamnus cathartica* (3)
 - Siberian elm *Ulmus pumila* (4)
 - White mulberry *Morus alba* (6)
- Non-regulated
 - Norway Maple *Acer platanoides* (10)

Restricted Invasive Species*

- Already widely established in the state
- High environmental and/or economic impacts are evident with these species
- Complete eradication is unlikely

Regulations: Cannot transport, transfer, or introduce without a permit.**

Possession is allowed except for fish or crayfish.

Control is encouraged but not required.

Trees – Southern Dry-mesic Forest

- Southeast Glacial Plains Ecological Landscape which includes:
 - Southern Dry-mesic Forest – Red oak, white oak, basswood, sugar and red maples, white ash, hickory and black cherry, American elm, butternut, ash, ironwood
 - Robin Greenway: ash, basswood, black cherry, black locust, black walnut, box elder, buckthorn, bur oak, Canadian hemlock, cottonwood, crabapple, eastern red cedar, American elm, euonymous, hackberry, mulberry, Norway maple, red elm, red maple, redbud, red oak, shagbark hickory, Siberian elm, silver maple, spruce, western red cedar, white oak, yew

Definition	Rare animals	Rare plants	Landscapes	Threats/Actions	Considerations	Photos
------------	--------------	-------------	------------	-----------------	----------------	--------

The following Ecological Landscapes have the best opportunities to manage for **Southern Dry-mesic Forest**, based on the [Ecological Landscapes of Wisconsin Handbook](#).

Ecological Landscape	Opportunity
Central Sand Plains	Major
Southeast Glacial Plains	Major
Western Coulee and Ridges	Major
Central Lake Michigan Coastal	Important
Central Sand Hills	Important
Southern Lake Michigan Coastal	Important
Southwest Savanna	Important
Western Prairie	Important
Forest Transition	Present

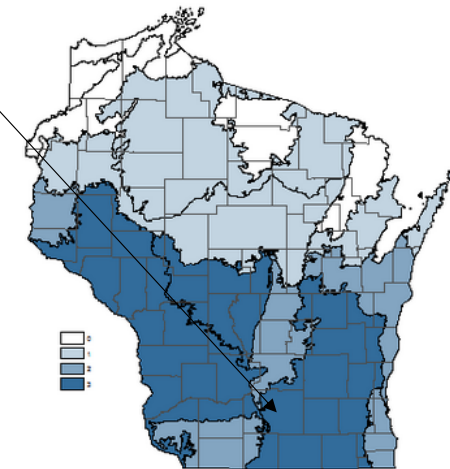

WDNR,

<https://dnr.wi.gov/topic/EndangeredResources/Communities.asp?mode=detail&Code=CTFO R016W>

CITY OF MADISON



What are your preferences on removing invasive trees/shrubs at Robin Greenway?

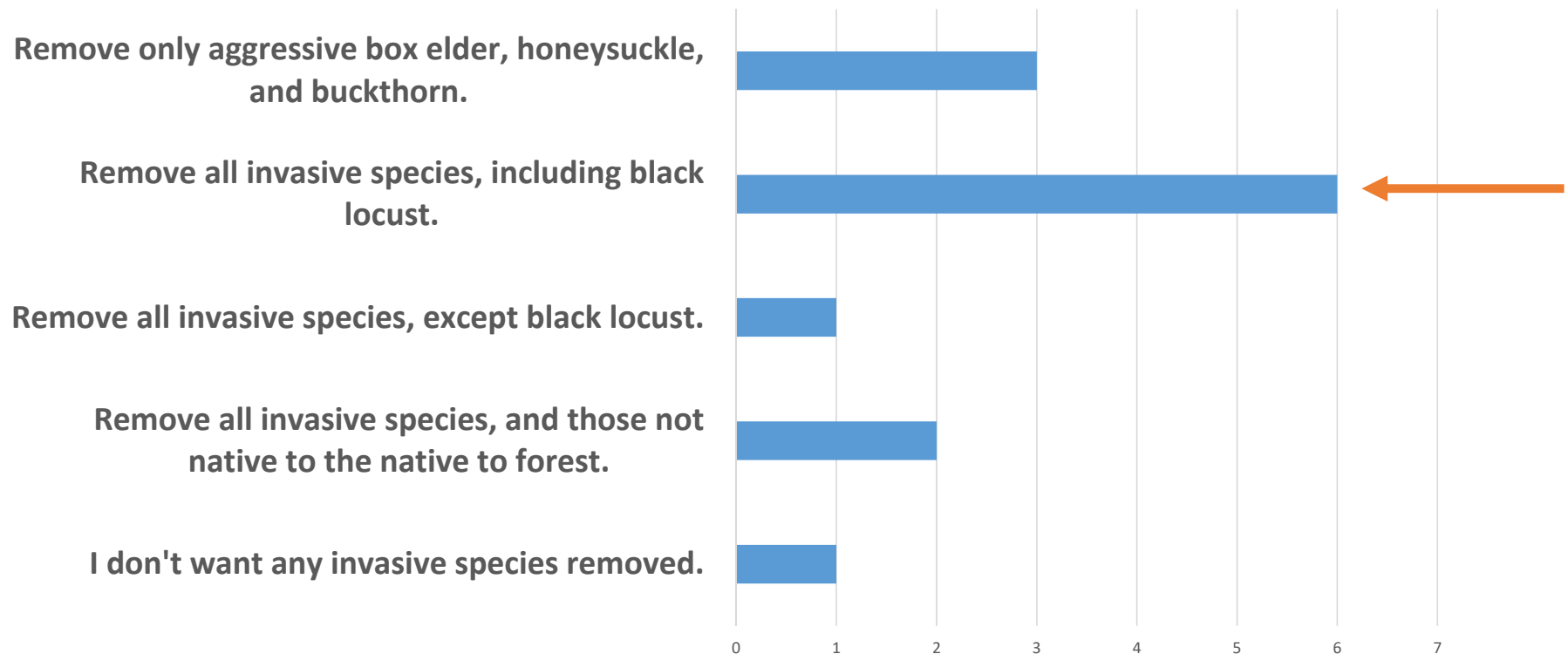

Tree Condition

- 184 TREES

- Excellent – 1 Tree (1 of these are WDNR invasives)
- Good – 39 Trees (19 of these are WDNR invasives)
- Fair – 100 Trees (38 of these are WDNR invasives)
- Poor – 24 Trees (3 of these are WDNR invasives)
- Very Poor – 9 Tree (3 of these are WDNR invasives)
- Dead – 11 Trees

Legend

Arborist Condition Report

- Excellent (1)
- Good (39)
- Fair (100)
- Poor (24)
- Very Poor (9)
- Dead (11)



What are your preferences on tree removals related to tree condition?

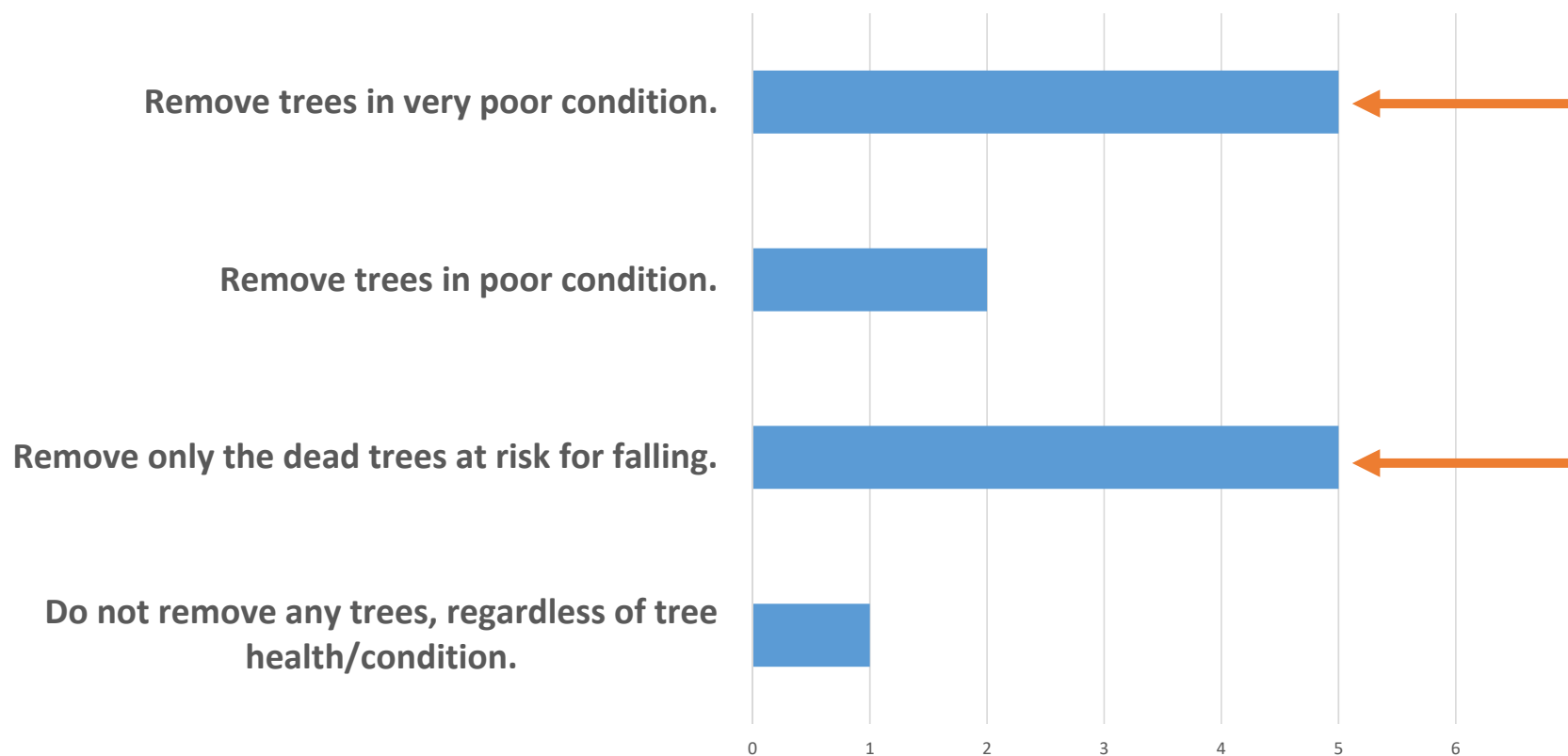

The certified arborist has identified two trees that conflict with power lines.

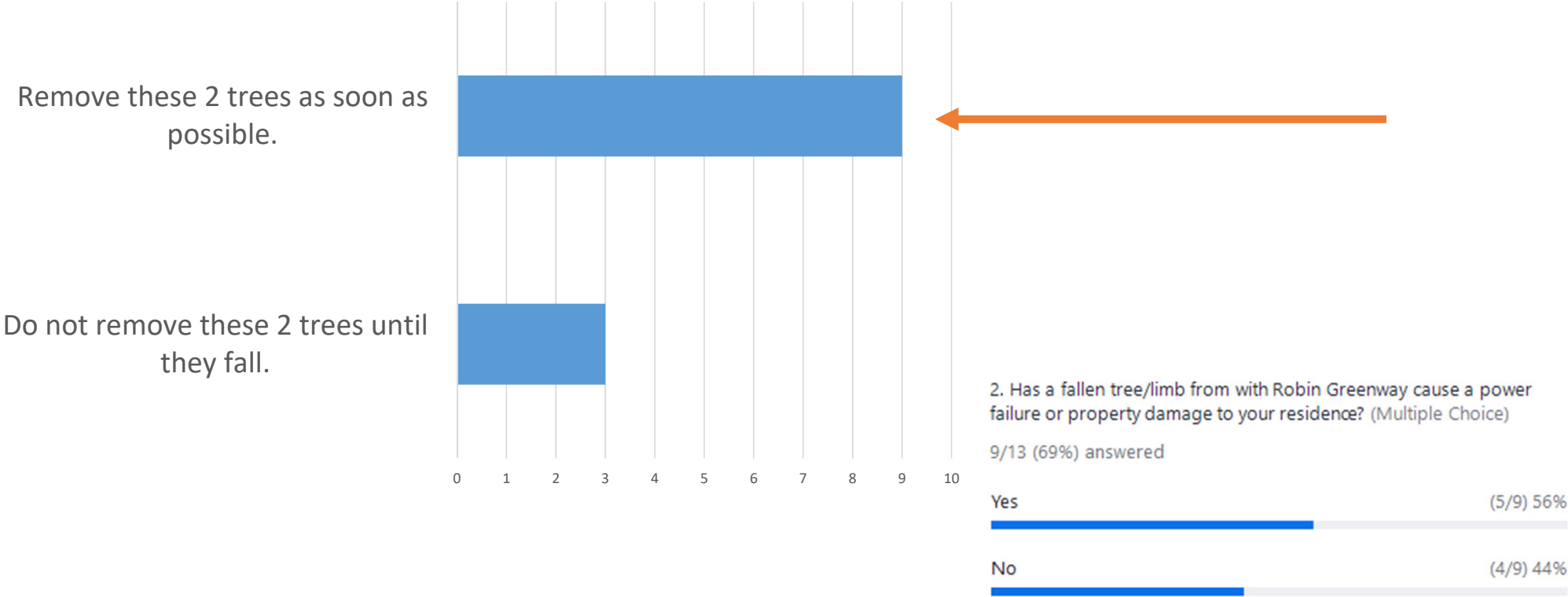

I prefer any tree removals be completed all at once, rather than phased.

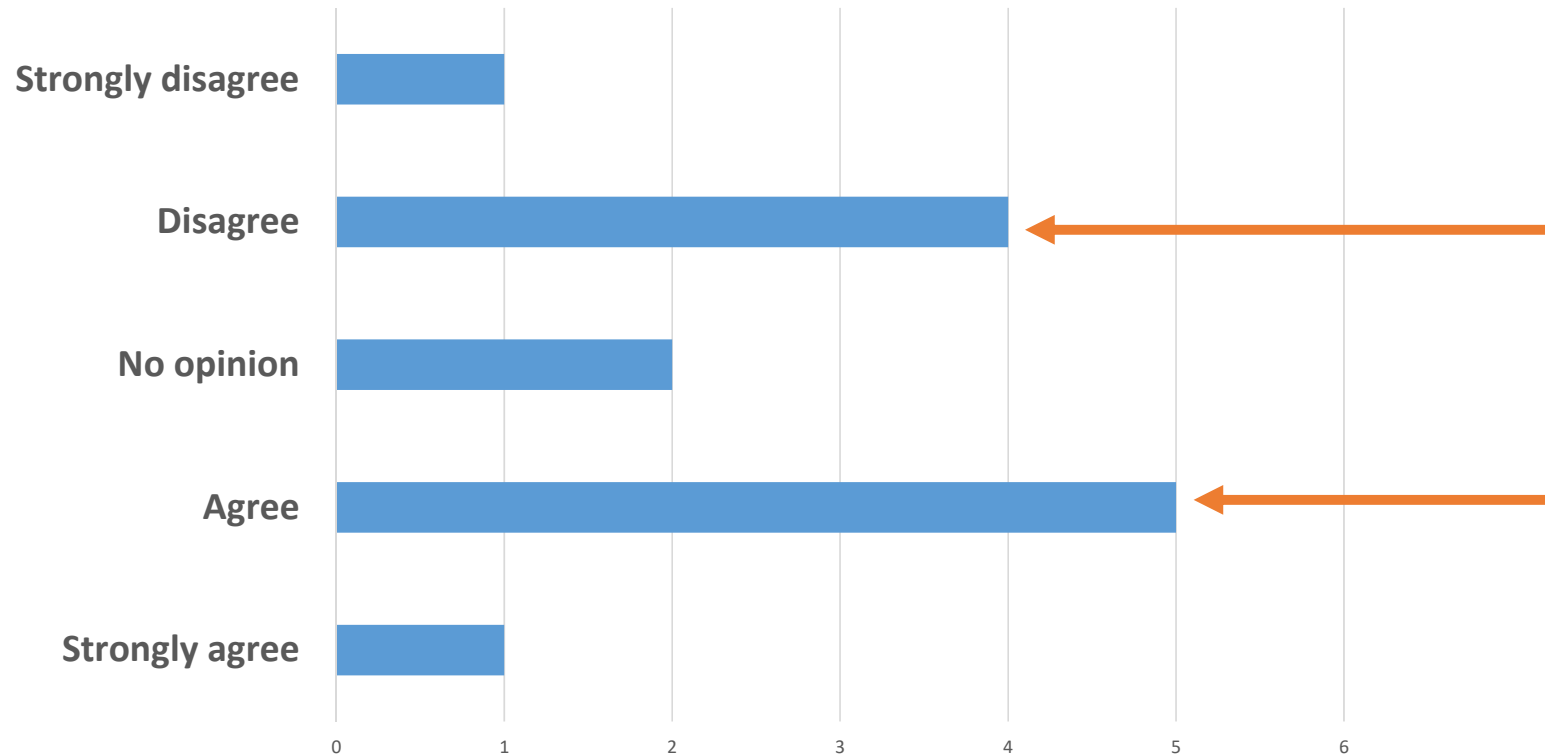

An important goal for the City for this project is to replant native trees, while also providing tree spacing to allow sunlight for healthy understory vegetation. Is this important to you?

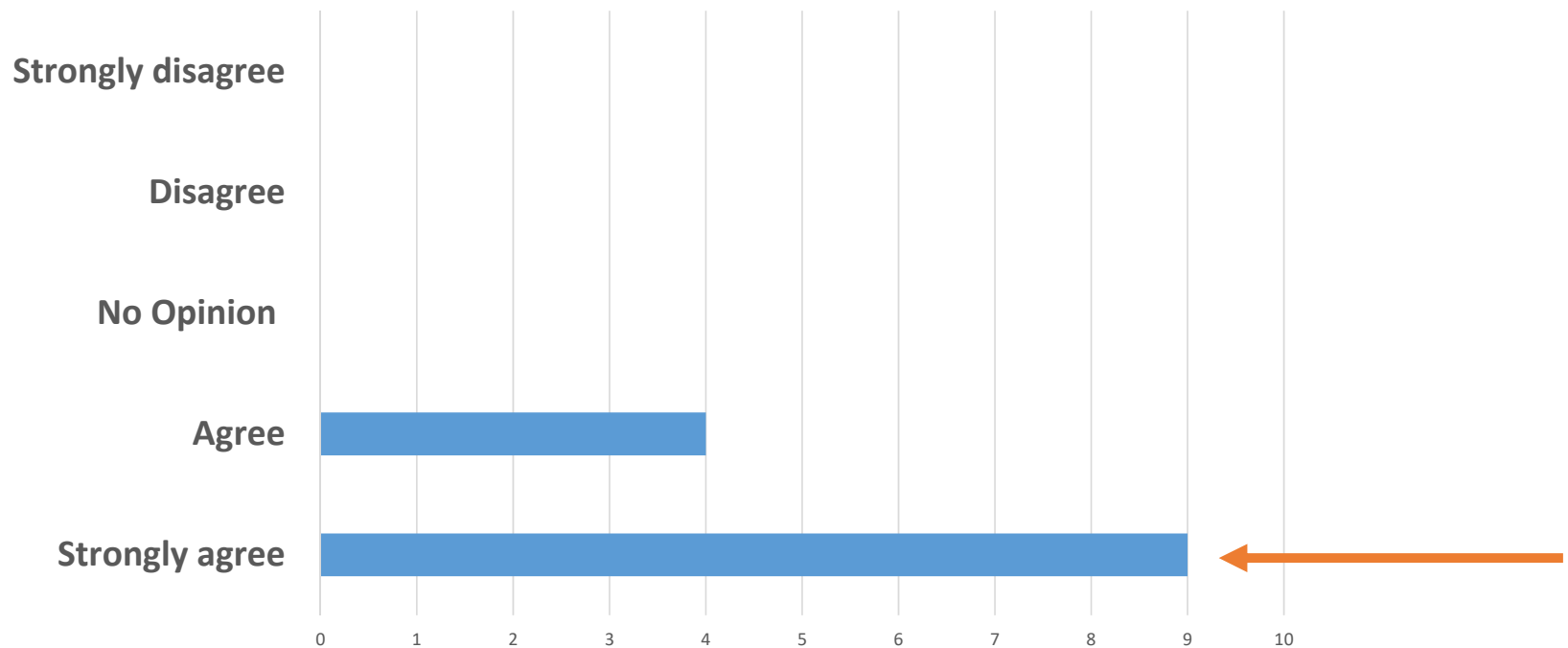

An important goal for the City with this project is to establish native groundlayer vegetation to minimize erosion. Is this important to you?

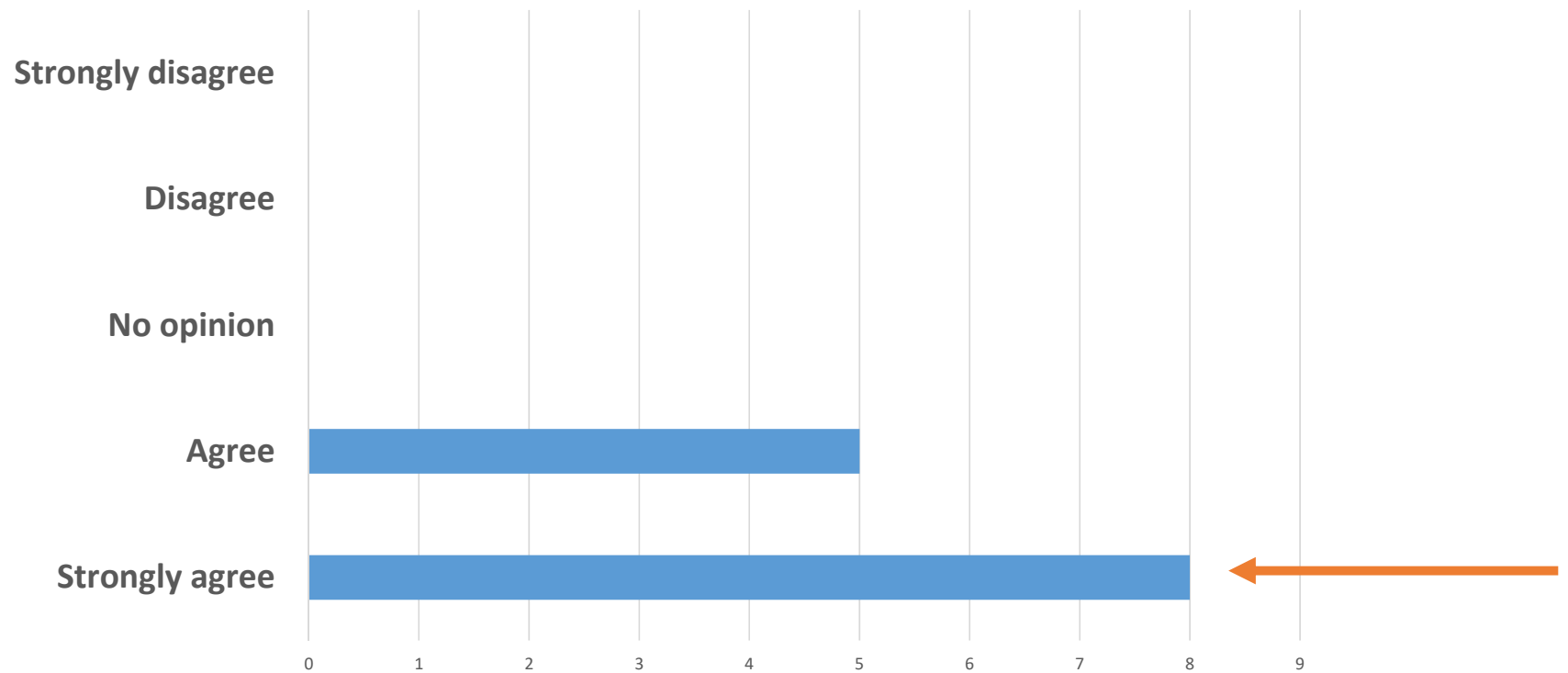

Which image represents the vegetation aesthetic you prefer for Robin Greenway?

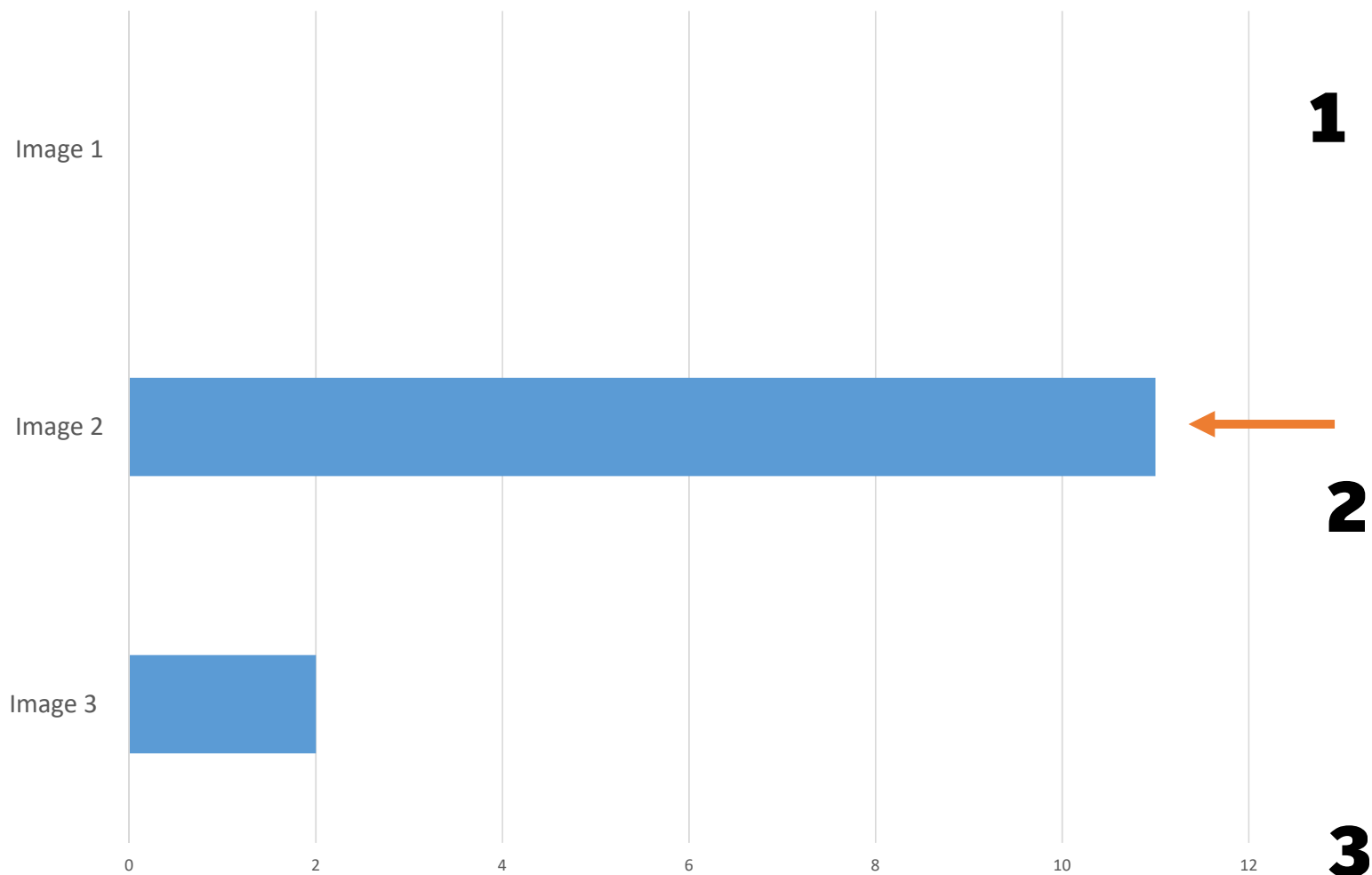

1



2



3



An important goal for the City with this project is to safely convey stormwater to avoid flooding streets and homes. Is this important to you?

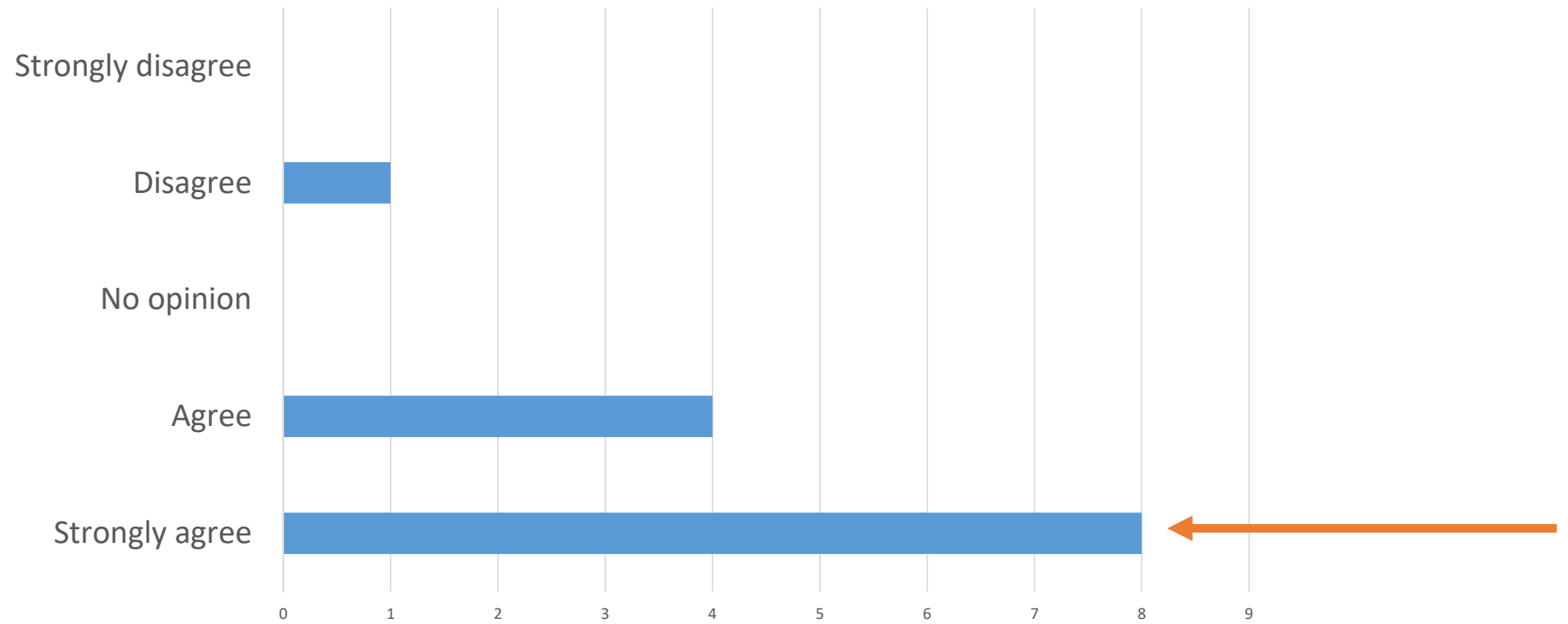

CITY OF MADISON



An important goal for the City for this project is to provide a long-term plan for maintenance access and land management.

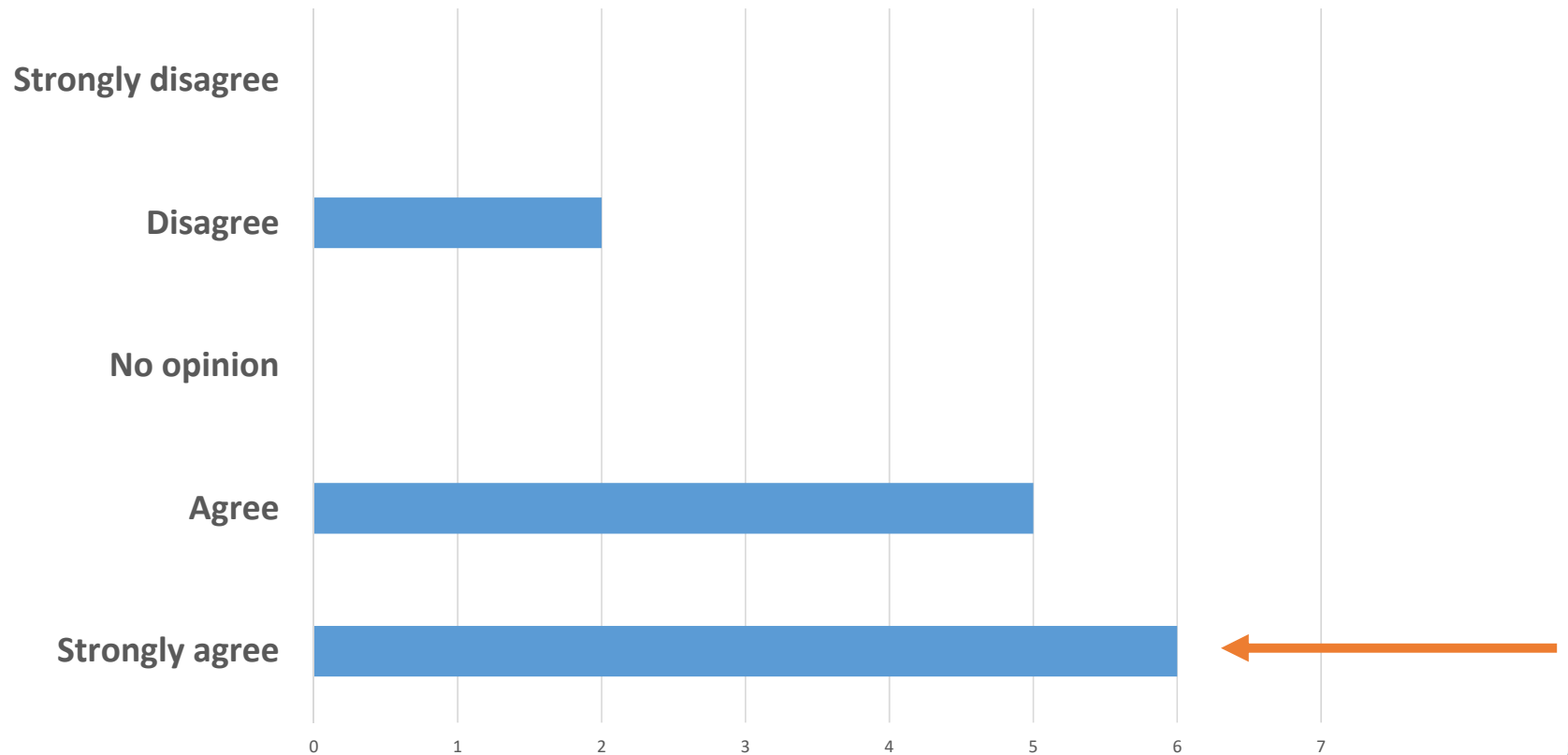

CITY OF MADISON



Which image represents the access aesthetic experience you prefer for Robin Greenway?

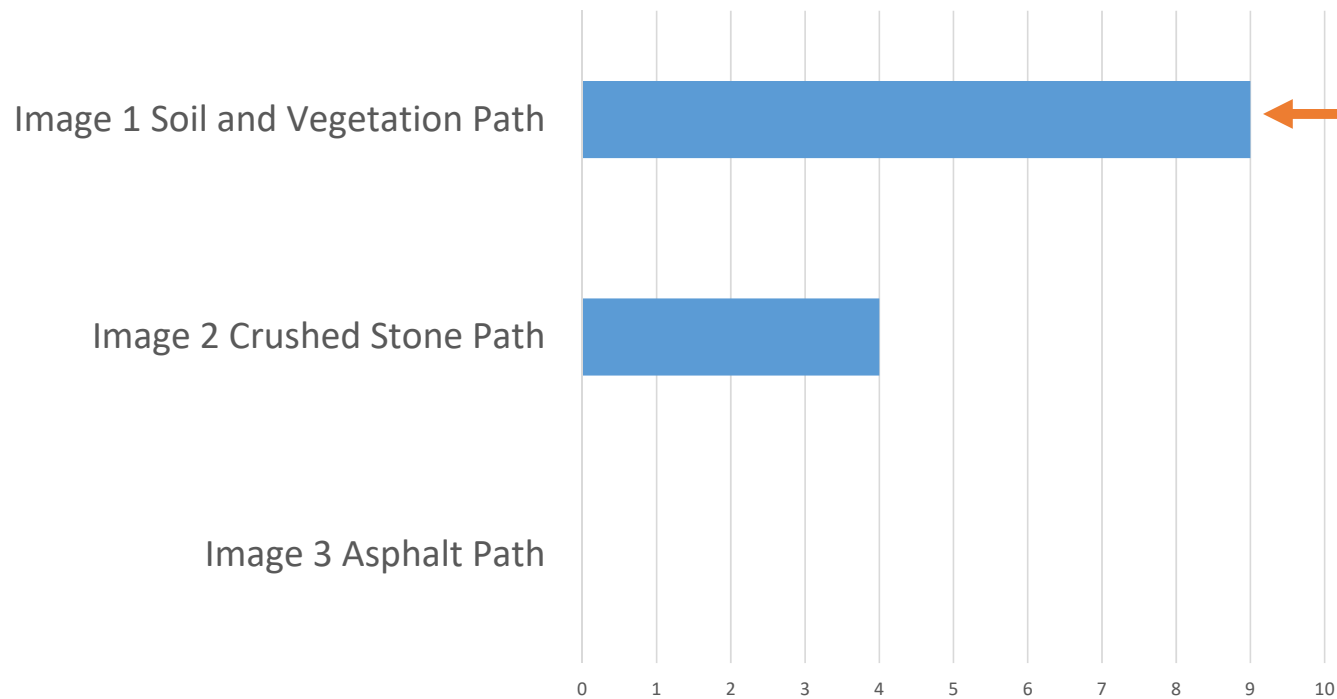

Breakout Rooms

- Finish Three Sentences
 - This greenway benefits the community by.....
 - I am most concerned that the city considers....with this project...
 - I am most looking forward to...with this project...

When we come back, we will report out what people came up with, then open it up to questions and comments and suggestions for the city in looking at this project.

Something missing? Feel free to email!
slerner@cityofmadison.com

CITY OF **MADISON**



Breakout Rooms Report Out

- This greenway benefits the community by....
 - Group One: Providing a safe place for kids to play, for people to go and enjoy nature.
 - Group Two: Providing great greenspace for families to enjoy nature and animal habitat, and shade and cooling space, and it provides recreation and understory plantings.
 - Group Three: Being a natural oasis, play area for kids, for dog walking, for greenspace, for ecological oasis, it benefits the community by bringing the community together.
- I am most concerned that the city considers....with this project...
 - Group One: Stormwater runoff is one consideration, providing enough attention to the vegetation (tree and what is under the trees) is another.
 - Group Two: The runoff conveyance and keeping it an urban retreat. Access is important for the power outages.
 - Group Three: Flood prevention, a resident was impacted by severe floods. Make sure to keep area conveying stormwater, keep natural restoration and aesthetic pleasing. Concerned that the city follows up on these comments so the meeting is productive, and possibly incorporating edible landscaping.
- I am most looking forward to...with this project...
 - Group One: Getting it done and getting greenspace back so the neighborhood can enjoy it.
 - Group Two: A healthy ecosystem greenspace, and thought in the planning has been helpful.
 - Group Three: Enjoying the space, making it accessible, restoring it to native, have nice trails and circular walk.

CITY OF **MADISON**



Summary for Public Engagement

- General Consensus:
 - Most important goals are to create a plan to revegetate the site, development land management plan, and stabilize slopes near Orchard Drive.
 - Greenways should be to create public greenspace and promote biodiversity.
 - Connected trails and residential greenspace buffers are least important roles for greenways.
 - Trees that impact power lines should be removed right away and 5 meeting attendees have had damages/outtages related to tree fells within Robin Greenway.
 - It is important to replant native trees, but also to build a healthy understory vegetation that receives sunlight and to minimize erosion.
 - It's important this space conveys stormwater to avoid flooding in streets and homes.
 - This project needs to create a long term plan for maintenance access and land management.
- Mixed Consensus:
 - Invasive species should be removed, but opinions vary on which ones and how many.
 - Mixed opinion on removing trees in dead or very poor condition.
 - Mixed opinion on phased removals or all at once removals.
 - Majority preferred vegetated access path but also some votes for gravel maintenance access.
 - Majority preferred native woodland aesthetic, but also some for prairie aesthetic.

Orchard Drive Culvert

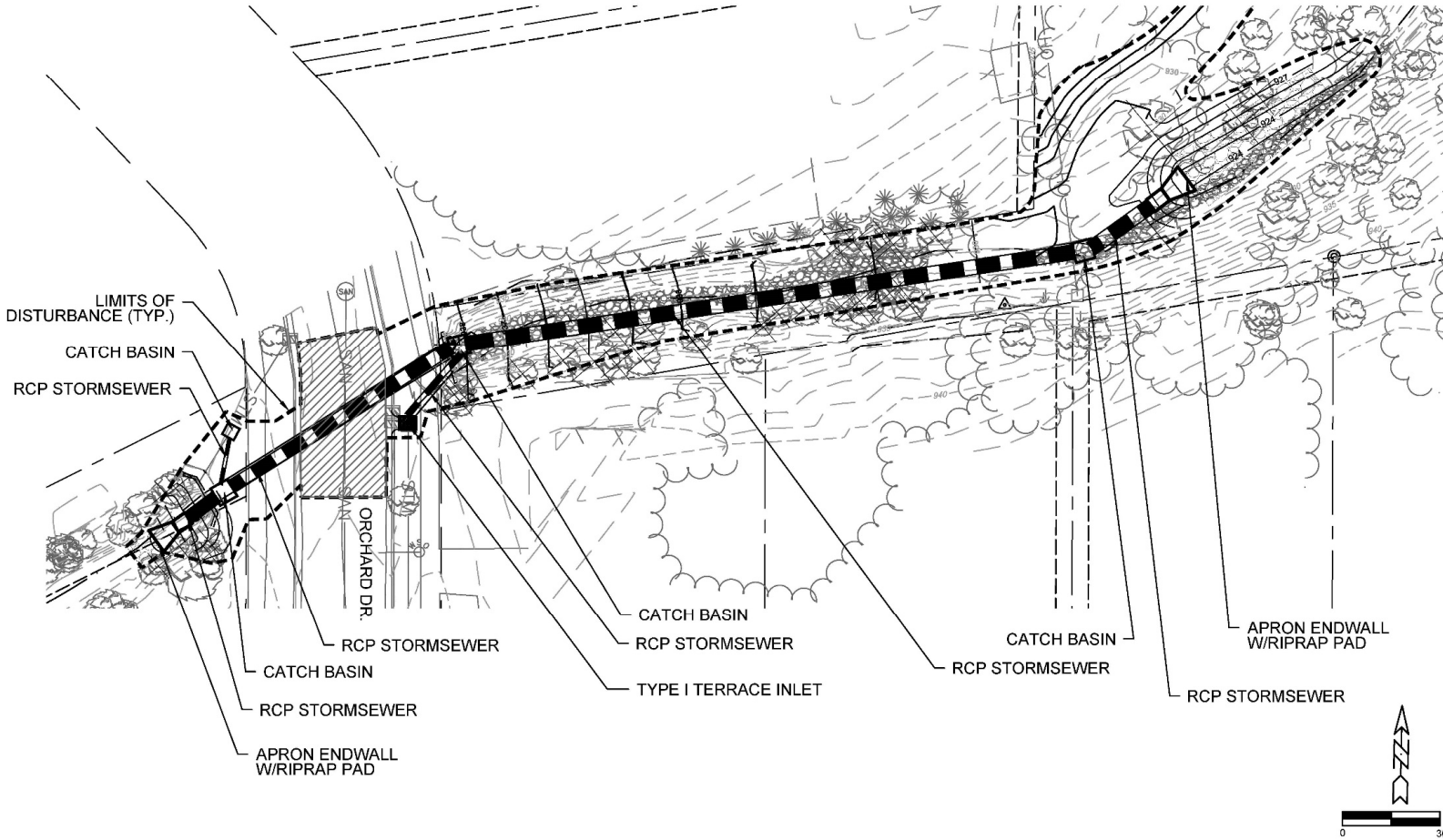

Concept One

- General Consensus (in both concepts):
 - Create a plan to revegetate the site.
 - Goals should be to create public greenspace and promote biodiversity.
 - Connected trails are least important goal for this project.
 - Build a healthy understory vegetation that receives sunlight and to minimize erosion.
 - It's important this space conveys stormwater.
 - This project needs to create a long term plan for land management.
 - Remove trees that have power line conflicts as soon as possible.
- Mixed Consensus:
 - Concept one **recognizes views from those who lean towards removing all WDNR invasive species.**
 - Concept one, would **include a phased removal of invasive trees and planting to minimize residential impact.**
 - Concept one would **remove both trees that are dead or in very poor condition.**
 - Concept one recognizes views from those would **want vegetated path for maintenance access.**
 - Concept one recognizes aesthetic that includes **both understory woodland and prairie plantings.**

Concept 1

- Remove all WDNR Invasives (70)
- Phased removals
- Remove dead and very poor condition trees (15)
- Vegetated Path
- Restore understory woodland/prairie
- Replant trees (34)

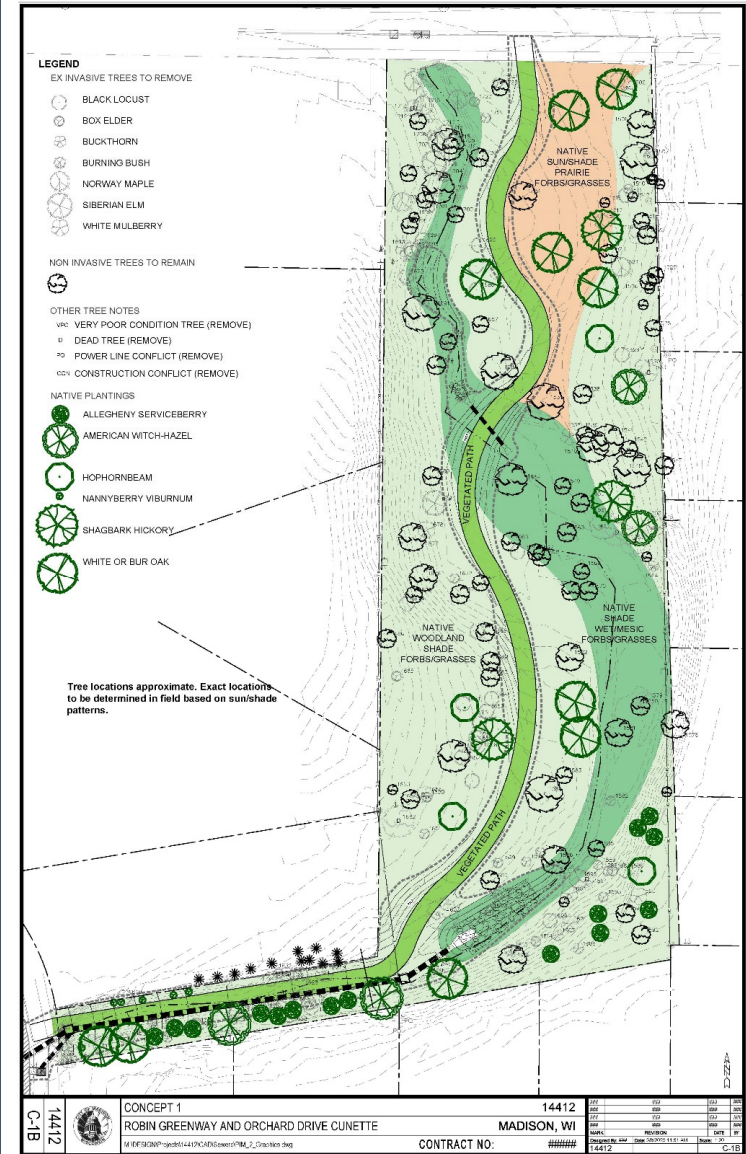
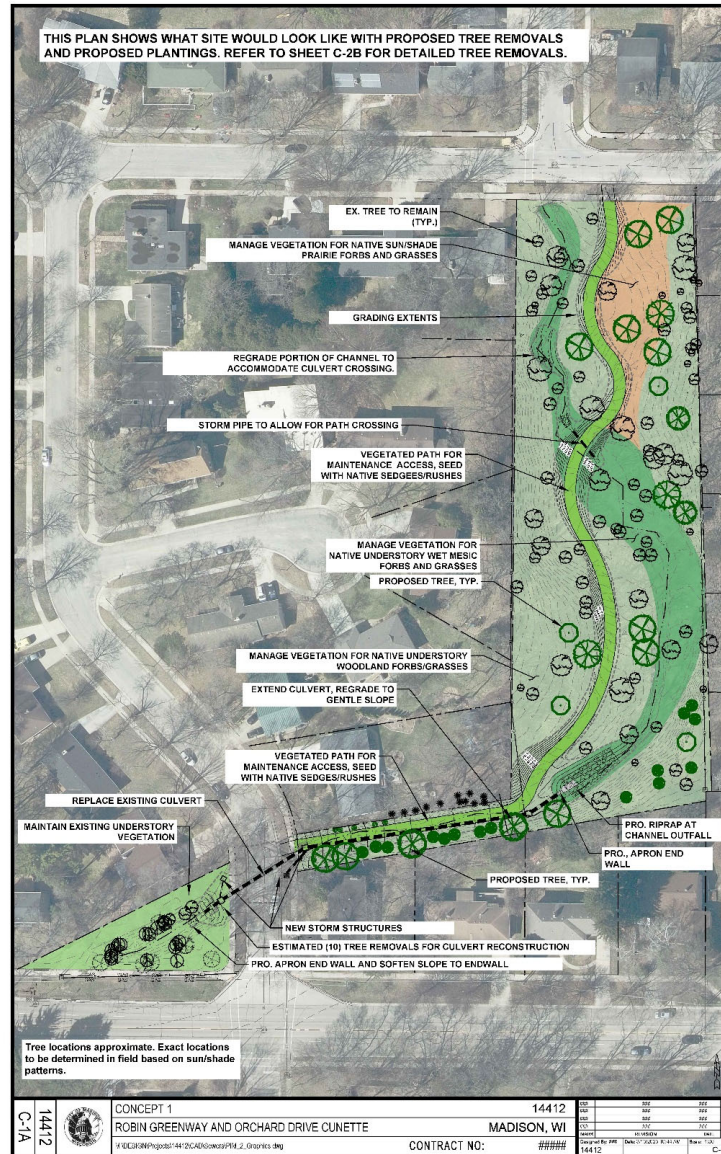

Concept 1 – Design Response Based on Feedback

- **Native Understory Plantings:**
 - Native woodland and oak savanna understory.
 - Higher biodiversity with mixture of native understory types.
 - Easier to maintain once black locust colony removed.
- **Maintenance Access: Vegetated path with stone base to hold of weight of maintenance vehicles**
 - Preserve natural aesthetic by seeding over path with native sedge/grass/rush.
 - Provides access to maintenance vehicles on limited basis.
 - Provides “invisible” structural base to minimize rutting and erosion when vehicles need to access site.
 - Allows for informal walking path.



Concept 1 – Design Response Based on Feedback

- **Trees on Parcel East of Orchard Drive Today: 184**
 - Invasive Tree Removals*: 70
 - 27 black locust , 21 box elder, 2 buckthorn, 2 burning bush, 8 white mulberry, 8 Norway maple, 2 Siberian elm
 - Construction Removals: 31
 - 26 of these are invasive, 2 are invasive and in very poor condition
 - Other Tree Removals: 17
 - 10 that are dead, 1 Power line conflict, and 6 additional trees in very poor condition
- **Total Proposed Removals for Concept 1: 117**
 - 99 are invasive species, 7 very poor condition, 10 dead – not exclusive
- **Total New Trees Proposed for Concept 1: 34 Native Trees**
- **Total Trees Remaining with Removals and Plantings: 101**

* Excludes invasive trees removed for construction conflicts, dead trees, very poor condition trees.

An important goal for the City for this project is to replant native trees, while also providing tree spacing to allow sunlight for healthy understory vegetation. Is this important to you?

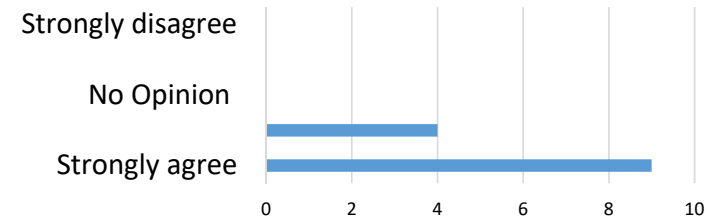

What are your preferences on removing invasive trees/shrubs at Robin Greenway?

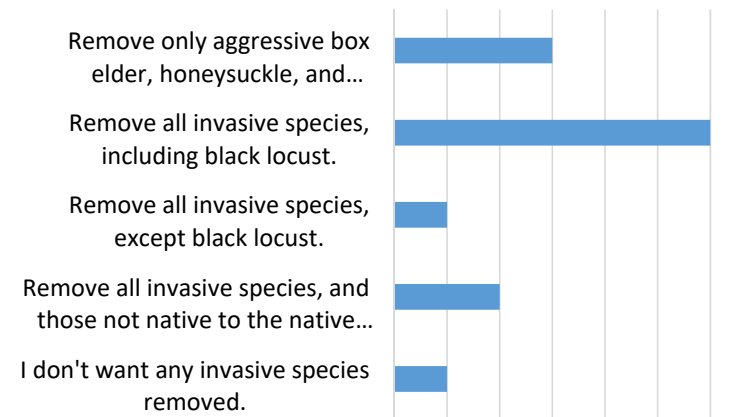

Concept Two

- General Consensus (in both concepts):
 - Create a plan to revegetate the site.
 - Goals should be to create public greenspace and promote biodiversity.
 - Connected trails are least important goal for this project.
 - Build a healthy understory vegetation that receives sunlight and to minimize erosion.
 - It's important this space conveys stormwater.
 - This project needs to create a long term plan for land management.
 - Remove trees that have power line conflicts as soon as possible.
- Mixed Consensus:
 - Concept two recognizes views from those who lean towards **less invasive species removed – allowing Norway Maple and Black Locust to remain, but still removing invasive species of box elder, buckthorn, Siberian elm, white mulberry, and burning bush based on public input.**
 - Concept two would **remove invasives trees all at once with construction of the culvert.**
 - Concept two would **remove only dead trees.**
 - Concept two recognizes views from those would **want gravel path for maintenance access.**
 - Concept two recognizes **understory woodland aesthetic.**

Concept 2

- Remove select invasive trees (33)
- Remove only dead trees (10)
- Perform all removals at once
- Gravel access
- Restore understory with woodland native plants
- Replant trees (17)

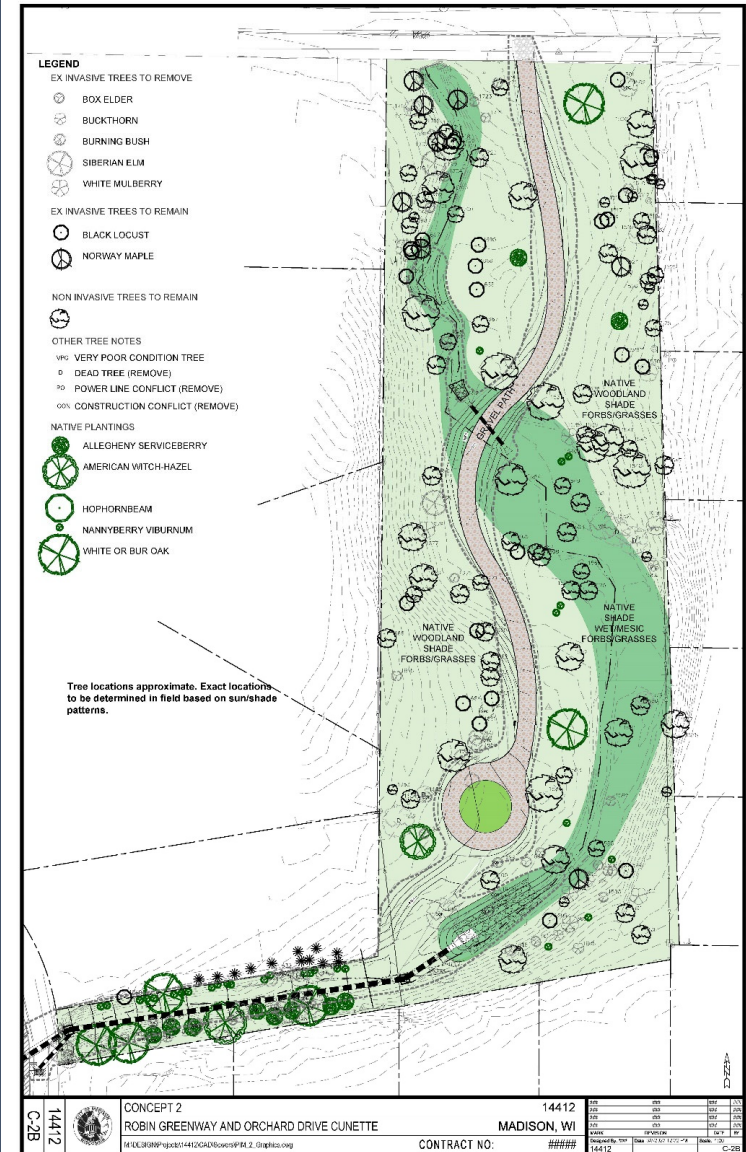

Concept 2 – Design Response Based on Feedback

- **Native Understory Plantings:**
 - Less sunlight, keep to Native woodland plantings.
- **Maintenance Access: Gravel path**
 - Preserve natural aesthetic with a gravel path.
 - Less sunlight for vegetative path.
 - Formal path helps designate space as communal.
 - Path dead-ends within the greenway.

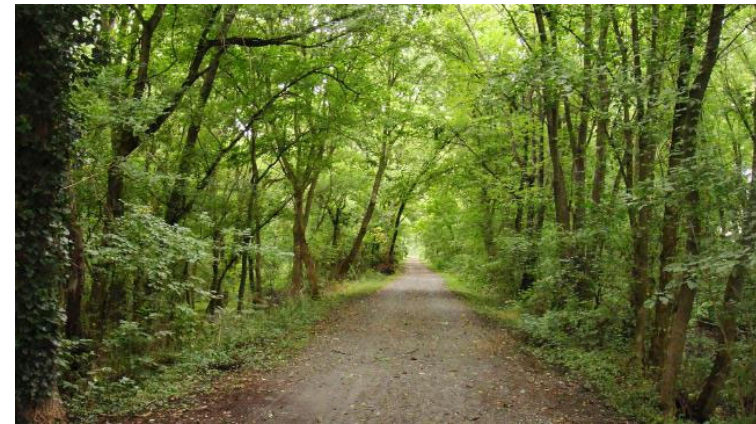

Concept 2 – Design Response Based on Feedback

- **Trees on Parcel East of Orchard Drive : 184**
 - Invasive Tree Removals*: 33
 - 19 box elder, 2 buckthorn, 2 burning bush, 8 white mulberry, 2 Siberian elm
 - Keep invasive Norway Maple and Black Locust
 - Construction Removals: 35
 - 29 of these are invasive, 2 are invasive and in very poor condition
 - Other Tree Removals: 11
 - 10 that are dead, 1 Power line conflict
- **Total Proposed Removals for Concept 2: 79**
 - 62 are invasive species, 10 dead, 2 in very poor condition – not exclusive
- **Total New Trees Proposed for Concept 1: 17 Native Trees**
- **Total Trees Remaining with Removals and Plantings: 122**
 - * Excludes invasive trees removed for construction conflicts, dead trees, very poor condition trees.

An important goal for the City for this project is to replant native trees, while also providing tree spacing to allow sunlight for healthy understory vegetation. Is this important to you?

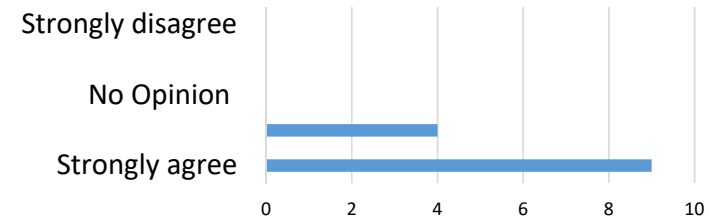

What are your preferences on removing invasive trees/shrubs at Robin Greenway?

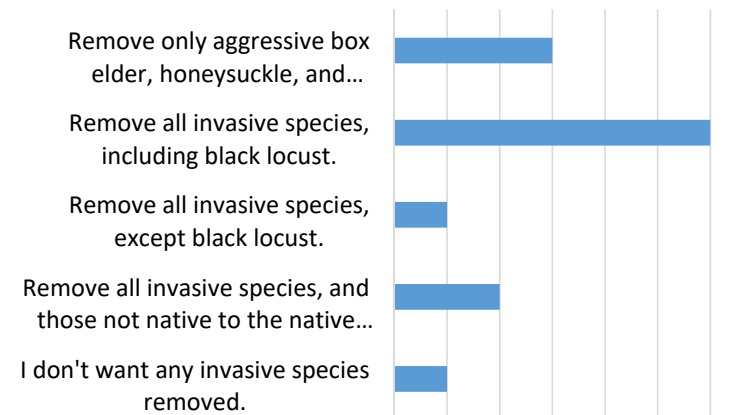

Concept 2 – Design Response Based on Feedback

- Black Locust Management Requires Volunteer Assistance
 - Disturbance to mature trees stimulates vegetative sprouts that can grow 6 – 10' in six months
 - Able to aggressively outcompete most other native tree species



Long Term Restoration – What to Expect

- Remaining trees are not in great condition.
- Anticipate by leaving poor and fair quality trees, that storm events may cause future limb loss and fell trees.
- Less tree removal = loss of mowing as a tool for vegetation management
 - Need at least 40' between trees for mowers.
- Ongoing assessments by certified arborist to remove immediate risks as poorer quality trees decline.



Long Term Restoration – What to Expect

- **This summer/fall:** Invasive pokeweed control. Continued Japanese knotweed control. Reseeding undisturbed areas.
- **1-2 years of follow-up maintenance** by Ecological Restoration firm contracted by City following reconstruction and restoration
- **Engineering Conservation staff *and* volunteers to perform longer term future maintenance.** Eng staff to offer the following:
 - Annual weed sweep early or mid-season to control difficult to manage weeds such as pokeweed, Canada thistle
 - Annual Japanese knotweed control
 - Annual or bi-annual brush control visit by Operation Fresh Start youth crew



Long Term Restoration – What to Expect

Why do we need volunteers?

- 1,600+ acres stormwater land
- Two full-time conservation staff
- Two seasonal interns
- Operations staff (mowing)
- Operation Fresh Start (OFS) youth crew



~350 hours spent on manual weed removal
by Conservation staff + interns = 35% of time

We need your help to maintain this as native vegetation!

CITY OF **MADISON**



Volunteer Opportunities

- Will need help from volunteers:
 - Weed “Sweeps”: With training from Engineering Conservation staff, volunteers can regularly patrol the greenway, pulling and digging common problem weeds such as burdock, garlic mustard, bull thistle, etc.
 - Plant Growing: Volunteers may wish to grow native plants for installation on the greenway. Possibility to include area students in this project under guidance from Engineering Conservation staff.
 - Watering: Monitor and water newly planted trees, shrubs and perennials, or water during future years in periods of drought as needed.
 - Trash pick up
 - Grate Monitoring: Monitor grates for clogs and report to Engineering Operations

We need your help to maintain this as native vegetation!

CITY OF **MADISON**



Breakout Sessions

- To do:
 - Place green dots and notes on aspects you like
 - Place red dots and notes on aspects you don't like
 - Write comments on plans
- Report Out
 - Select one person to report out

Clickers – Real Time Polling

IClicker QUESTIONS – SIX QUESTIONS

- Push orange button to turn on
- When poll is opened, choose response with A-E buttons
- Display will show a “v” when your response is received
- You can change your answer until the poll closes



Troubleshooting:

- Display says “Closed” – Poll is closed
- Clicker isn’t working – Push power button to turn off; turn on again
- Clicker still isn’t working – push and hold power button for two seconds, then press A twice to reconnect to receiver.
- Clickers turn off after 10 minutes; Push power button to turn back on.

IClicker QUESTIONS

Checking in,
have opinions
changed?



**What are your preferences on removing
invasive trees/shrubs at Robin Greenway?**

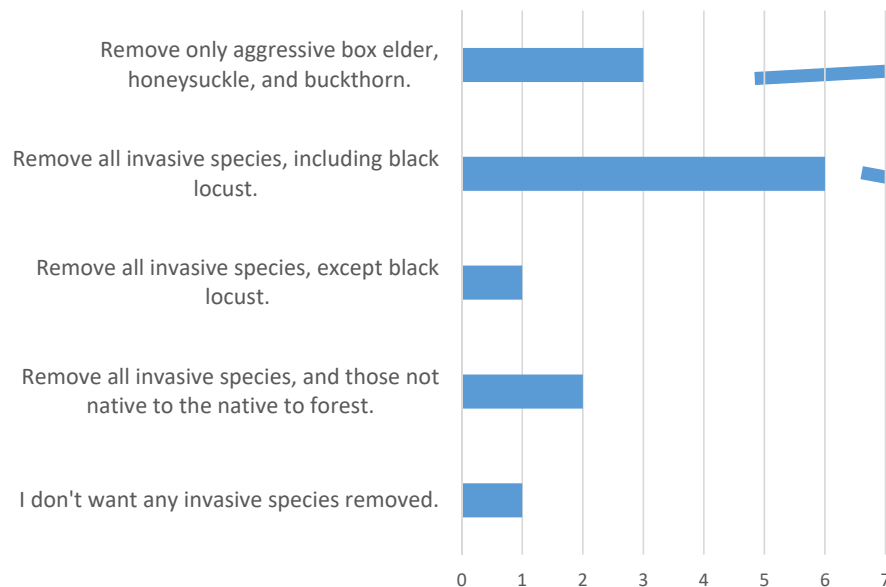

A. Remove only aggressive box elder, honeysuckle, and buckthorn.

B. Remove all invasive species, including black locust. ← Concept One

C. Remove all invasives excluding black locust and (Norway maple) ← Concept Two

D. Remove all invasive species, and those not native to forest.

E. I don't want any invasive species removed.

CITY OF **MADISON**



IClicker RESPONSE DURING MEETING

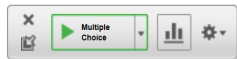

IClicker QUESTIONS

What are your preferences on removing
invasive trees/shrubs at Robin Greenway?

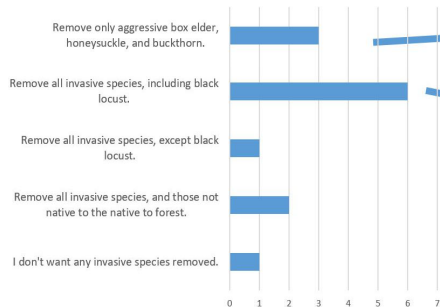

Checking in,
have opinions
changed?



- A. Remove only aggressive box elder, honeysuckle, and buckthorn.
- B. Remove all invasive species, including black locust. ← Concept One
- C. Remove all invasives excluding black locust and (Norway maple) ← Concept Two
- D. Remove all invasive species, and those not native to forest.
- E. I don't want any invasive species removed.

CITY OF MADISON

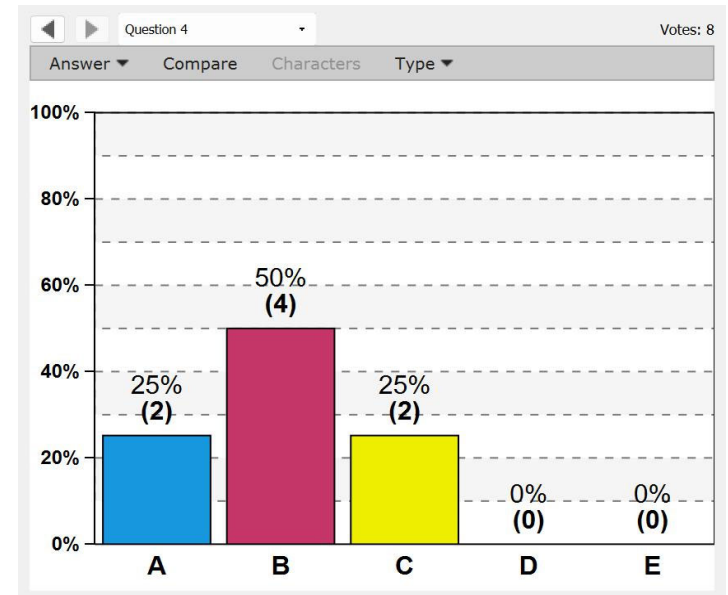

CITY OF MADISON



IClicker QUESTIONS

Checking in,
have opinions
changed?



What are your preferences on tree
removals related to tree
condition?

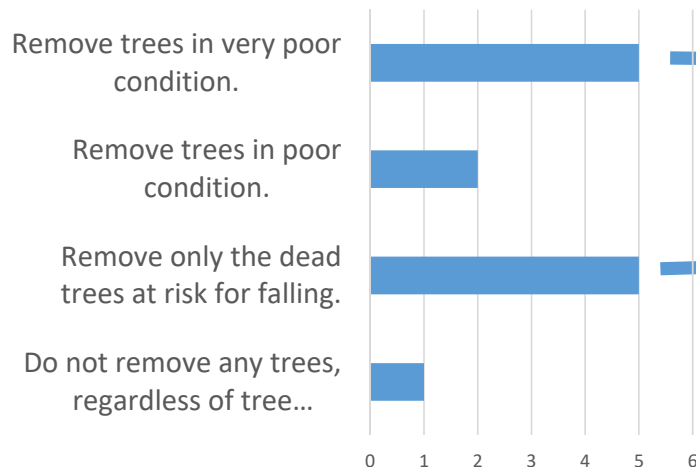

A. Remove trees in very poor
condition (includes also dead
trees).

← Concept
One

B. Remove trees in poor condition
(includes also very poor
condition trees and dead trees).

← Concept
Two

C. Remove only the dead trees at
risk for falling.

D. Do not remove any trees,
regardless of condition.

CITY OF **MADISON**



IClicker RESPONSE DURING MEETING

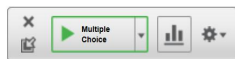

IClicker QUESTIONS

What are your preferences on tree removals related to tree condition?

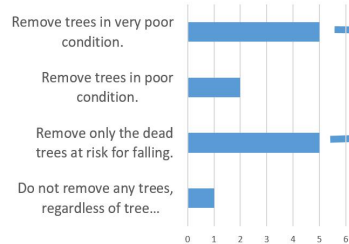

Checking in,
have opinions
changed?



- A. Remove trees in very poor condition (includes also dead trees). ← Concept One
- B. Remove trees in poor condition (includes also very poor condition trees and dead trees). ← Concept Two
- C. Remove only the dead trees at risk for falling.
- D. Do not remove any trees, regardless of condition.

CITY OF MADISON

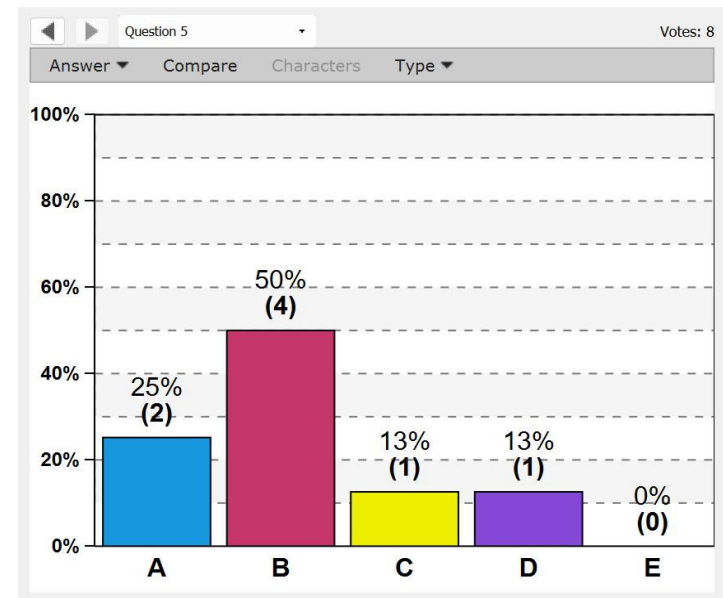

CITY OF MADISON



IClicker QUESTIONS

Checking in,
have opinions
changed?



I prefer any tree removals be completed all at once, rather than phased.

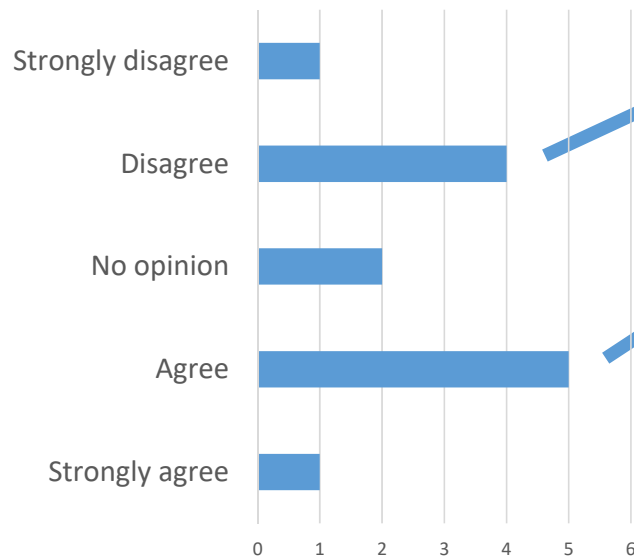

A. Strong disagree

B. Disagree



Concept One: Phased Removals

C. No opinion

D. Agree



Concept Two: Removed with Construction

E. Strongly agree

CITY OF **MADISON**



IClicker RESPONSE DURING MEETING

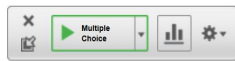

IClicker QUESTIONS

I prefer any tree removals be completed all at once, rather than phased.

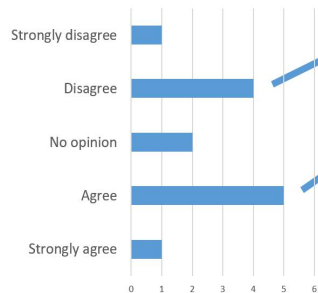

Checking in,
have opinions
changed?

A. Strong disagree

B. Disagree ← Concept One: Phased Removals

C. No opinion

D. Agree ← Concept Two: Removed with Construction

E. Strongly agree



CITY OF MADISON

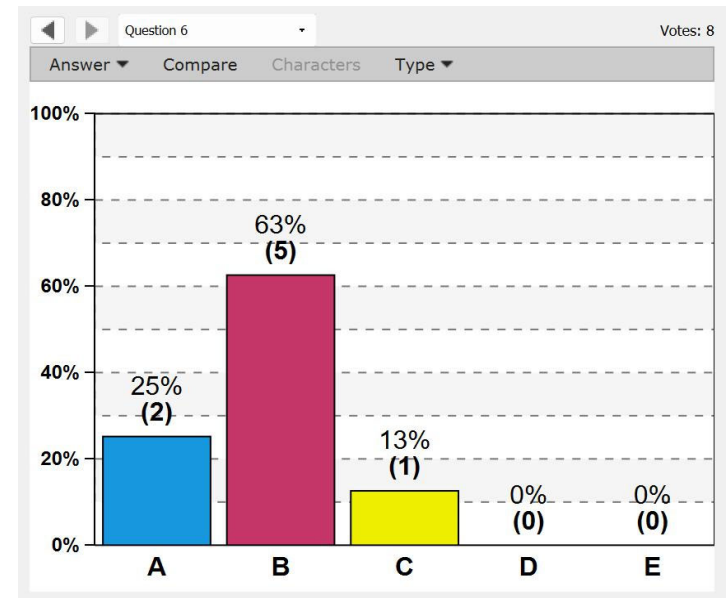

CITY OF MADISON



IClicker QUESTIONS

**Which path design
(not material) do you
prefer?**



- A: Path from Gregg Street through to Orchard Drive ← Concept One
- B: Path that terminates in Robin Greenway and does not formally connect ← Concept Two

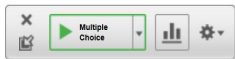

IClicker RESPONSE DURING MEETING



IClicker QUESTIONS

**Which path design
(not material) do you
prefer?**



- A: Path from Gregg Street through to Orchard Drive  Concept One
- B: Path that terminates in Robin Greenway and does not formally connect  Concept Two

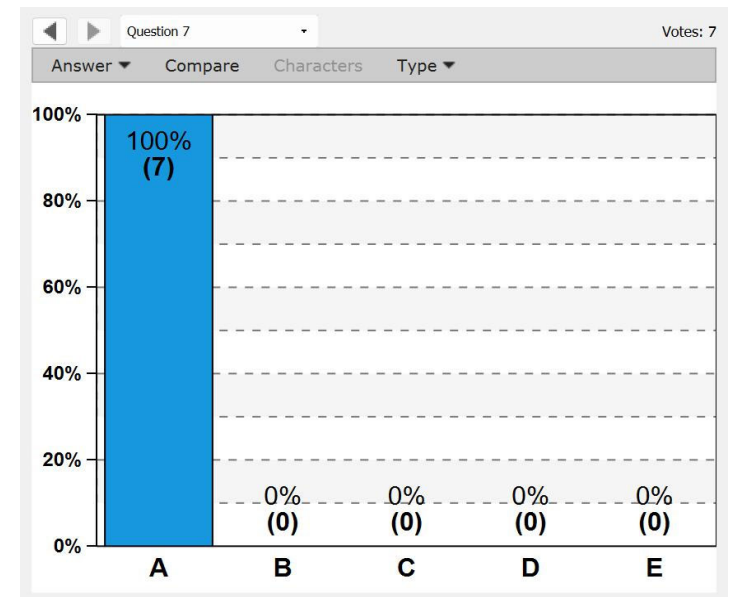

IClicker QUESTIONS

Checking in,
have opinions
changed?



Which image represents the access
aesthetic experience you prefer for Robin
Greenway?

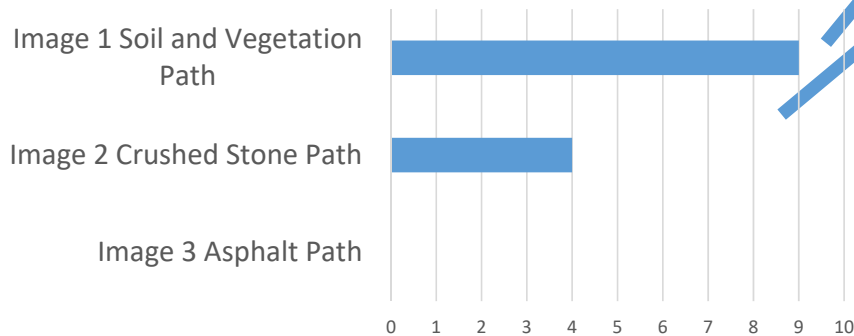

- A. Soil and Vegetation ← Concept One
- B. Crushed Stone ← Concept Two
- C. No opinion

IClicker RESPONSE DURING MEETING

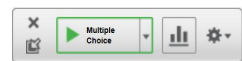

IClicker QUESTIONS

Which image represents the access aesthetic experience you prefer for Robin Greenway?

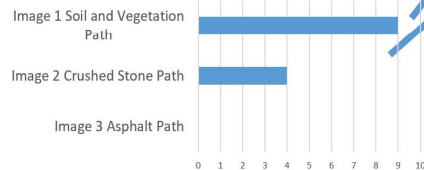

A.
B.
C.

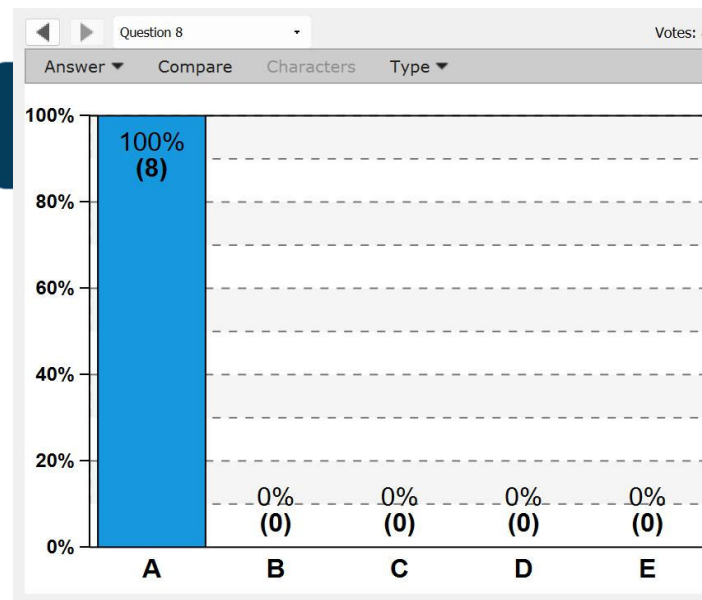

CITY OF MADISON 

CITY OF MADISON



IClicker QUESTIONS

Feedback from this meeting will be used to create a final plan. How would you like to be notified of the final plan?

- A – Email
- B – Mailing
- C – Another Public Input Meeting
- D – I do not need to be notified of the final plan



IClicker RESPONSE DURING MEETING

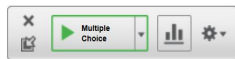

IClicker QUESTIONS

Feedback from this meeting will be used to create a final plan. How would you like to be notified of the final plan?

- A – Email
- B – Mailing
- C – Another Public Input Meeting
- D – I do not need to be notified of the final plan



CITY OF MADISON 

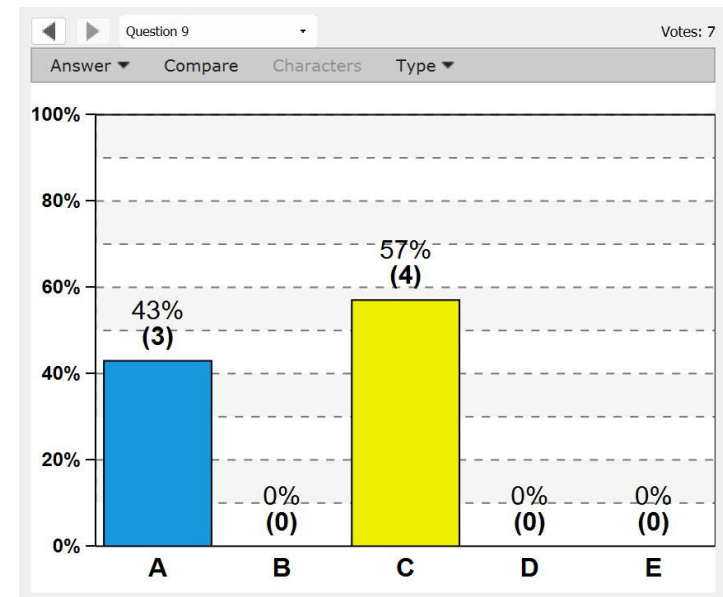

Note after results of poll discussions followed indicating general consensus for onsite meeting with neighborhood members.

CITY OF MADISON



Next Steps

- Potential PIM #3
- Spring Summer 2023: Land Restoration
 - Upland seeding of native species
 - Understory invasive plant including pokeweed and garlic mustard and reseeding in locations where invasive plants removed
- Fall/Winter 2023 - 2024 (pending frozen ground conditions)
 - Construction
- Spring 2024: Land restoration
 - Native seeding of disturbed construction areas
 - Native tree plantings
 - Understory invasive plant removals and reseeding in locations where invasive plants removed
- Summer 2024 – Summer 2026
 - Annual mowing, and ongoing spot invasive removals of understory and reseeding to focus efforts on biodiverse understory
 - If Phased tree removals, these may begin during this time
- After Summer 2026
 - Once a year mowing to control invasive species, volunteer support for ongoing invasive removals to leverage staff time

Contact Information and Resources

- Project Manager: Sarah Lerner, slerner@cityofmadison.com
- Project Webpage: <https://www.cityofmadison.com/engineering/projects/robin-greenway-and-orchard-drive-culvert>
- Public Information Officer: Hannah Mohelnitzky, hmohelnitzky@cityofmadison.com
- Sign-up for project email updates on the website
- Everyday Engineering Podcast
- Facebook – City of Madison Engineering
- Twitter – @MadisonEngr



CITY OF **MADISON**

